

# PRIME DESIGN™

A Safe Fleet Brand

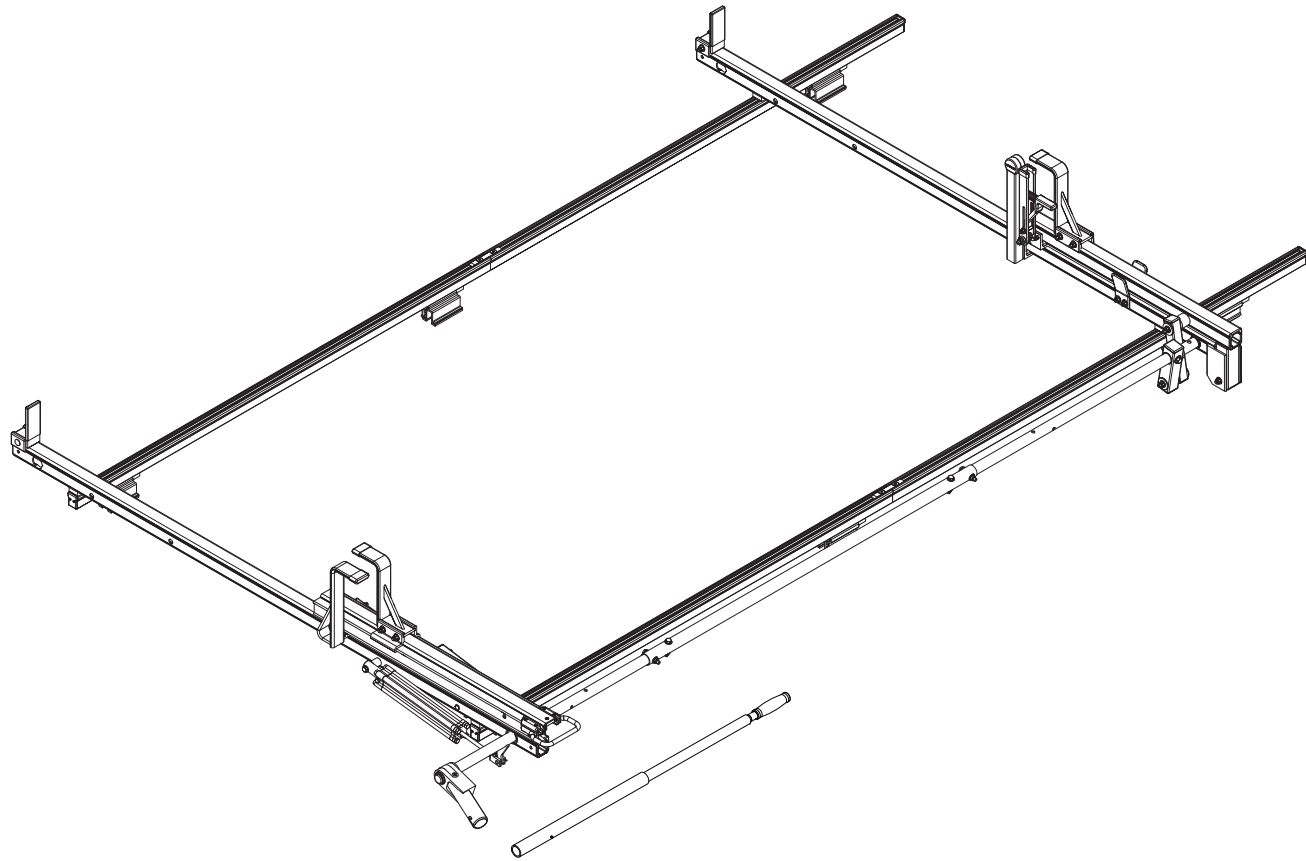

**PRIME**  
**VBI-E**

## CONTENTS OVERVIEW

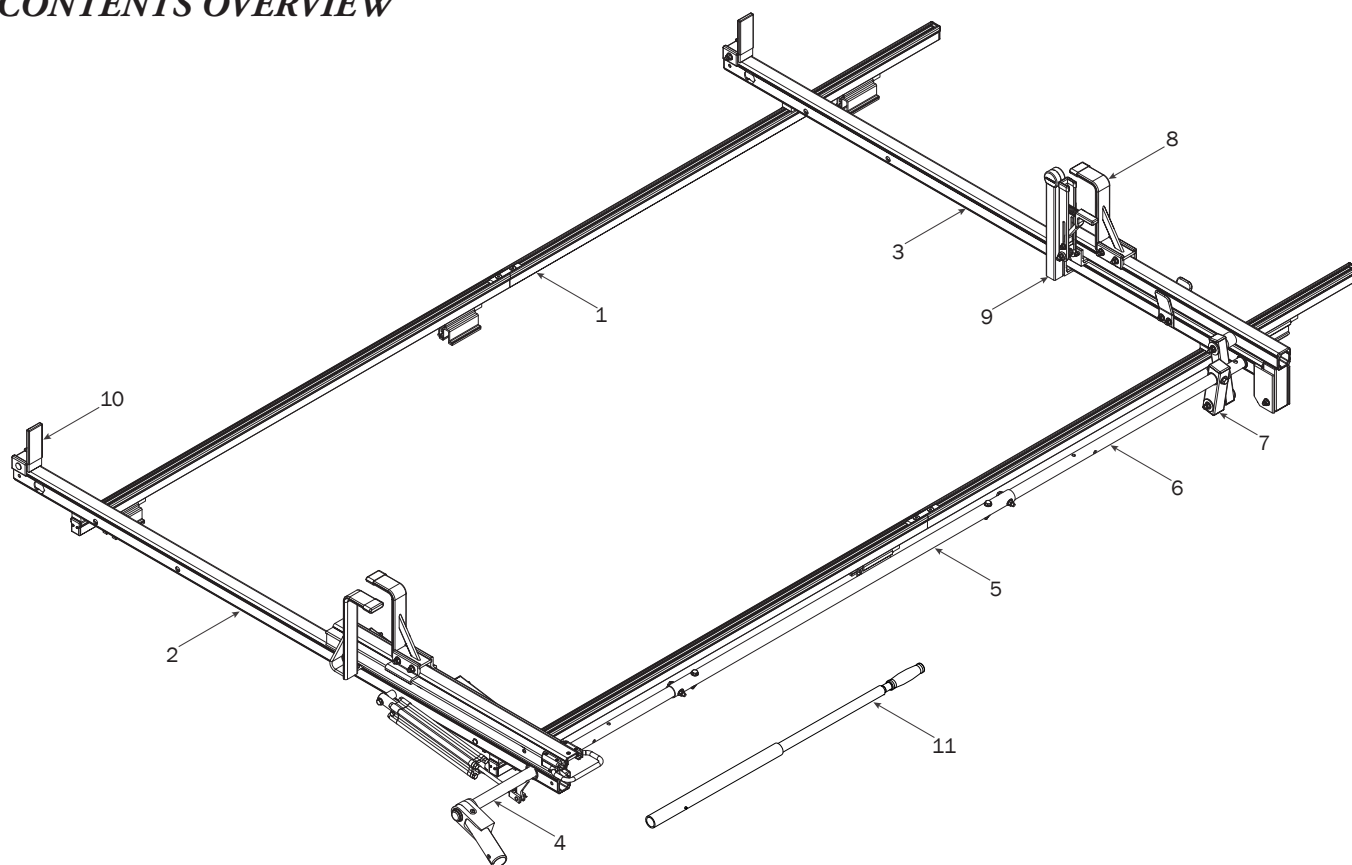

- 1—FBM-0020 ..... (Qty 1)  
Channels with hardware

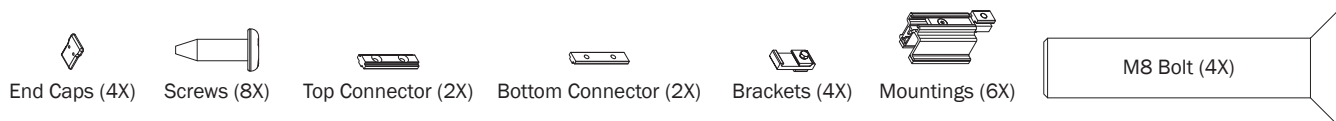

- 2—Rear Crossbar Assembly ..... (Qty 1)

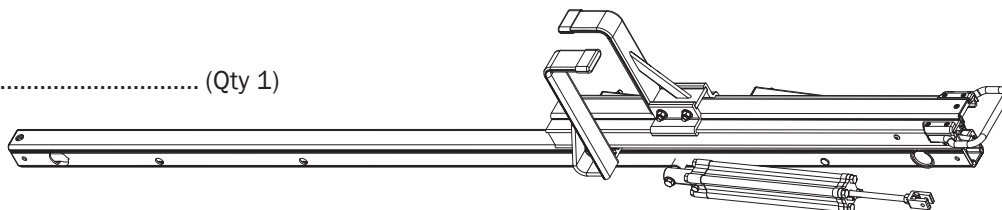

- 3—Front Crossbar Assembly ..... (Qty 1)

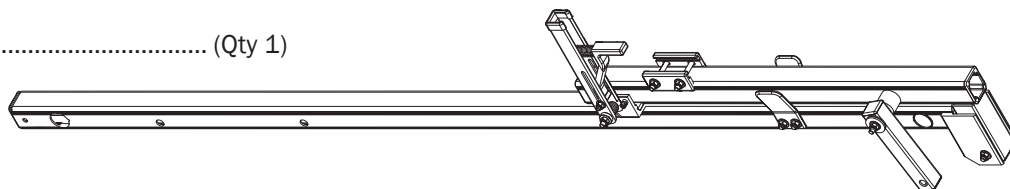

- 4—Drive Shaft..... (Qty 1)  
Rear, Right Hand, 34.00"

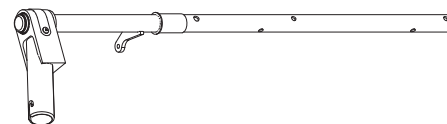

5—Connecting Bar..... (Qty 1)  
48.00"

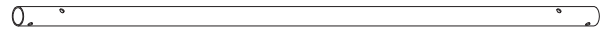

6—Front Drive Shaft..... (Qty 1)  
38.75"

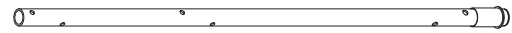

7—Drive Arm ..... (Qty 1)  
Incline Version with Bushing and Hardware

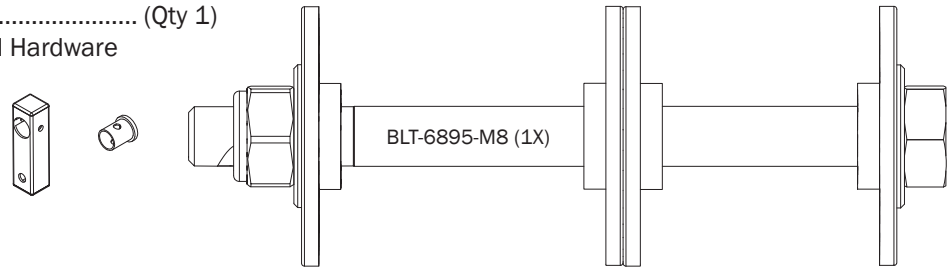

8—Z Post ..... (Qty 1)  
Adjustable, 7.25"

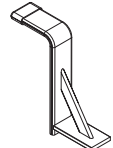

9—L Post..... (Qty 2)  
US3, Roller Cap, 11.25"

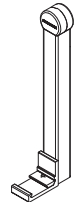

10—Ladder Stop Assembly..... (Qty 2)  
1.75"

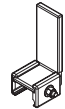

11—Removeable Handle ..... (Qty 1)

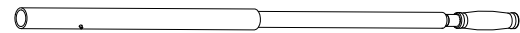

12—HKT-8163-Rotation Hardware Kit ..... (Qty 1)  
(Not called out in Overview)

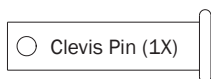

Clevis Pin (1X)

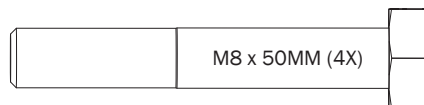

M8 x 50MM (4X)

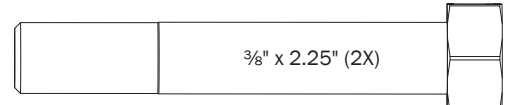

3/8" x 2.25" (2X)

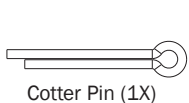

Cotter Pin (1X)

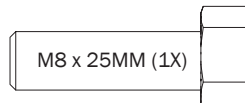

M8 x 25MM (1X)

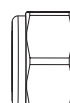

M8 Lock Nut (5X)

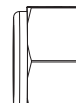

3/8" Lock Nut (2X)

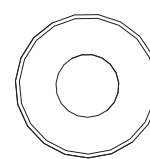

5/16" Flat Washer (10X)

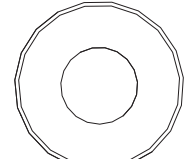

3/8" Flat Washer (4X)

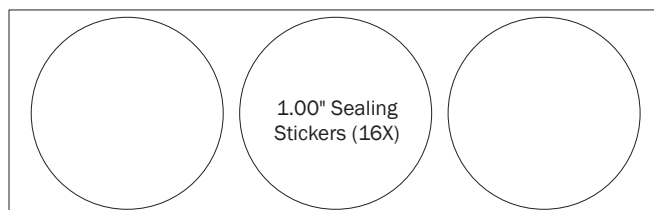

1.00" Sealing  
Stickers (16X)



Anti-Seize (1X)

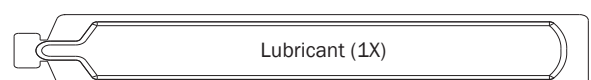

Lubricant (1X)

## FBM-0020 MOUNTING BRACKETS

**INSTALLER NOTE:** Mounting Brackets must be disassembled for installation onto the vehicle's roof.

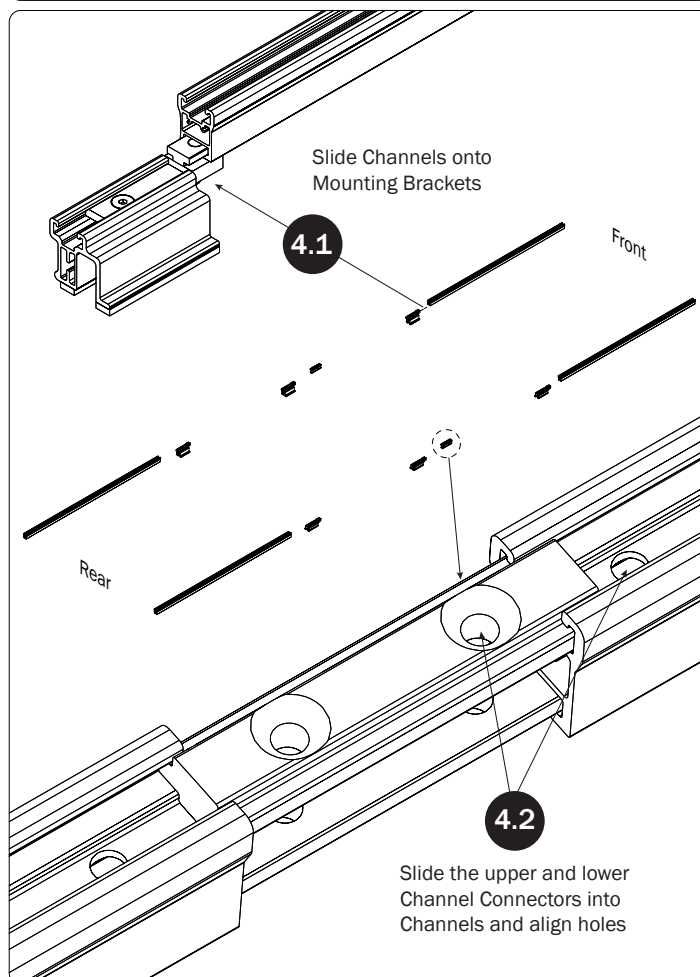
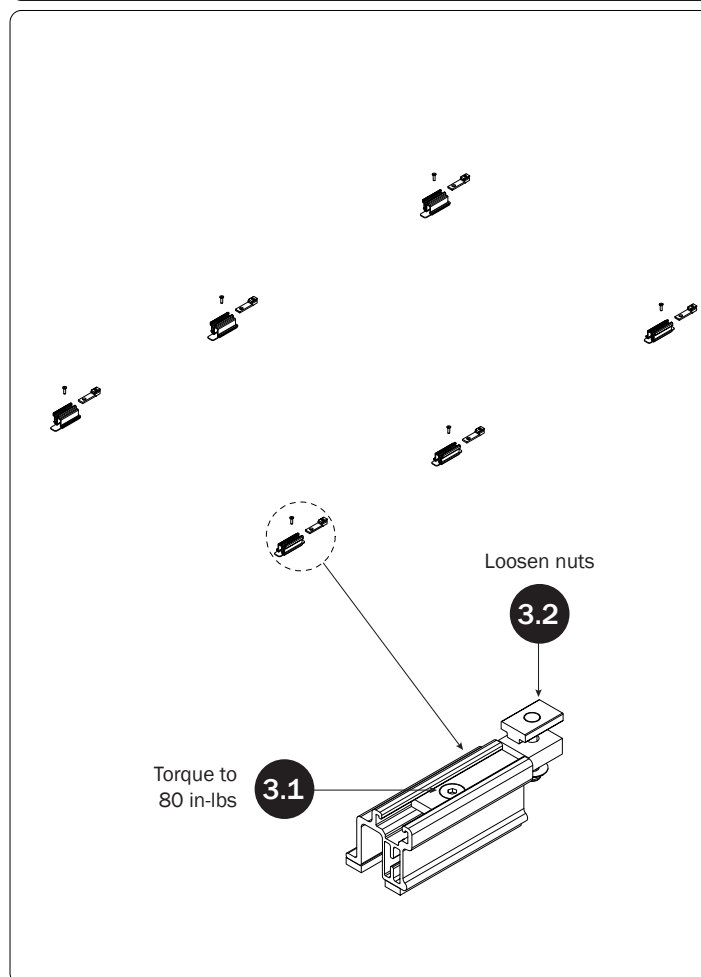
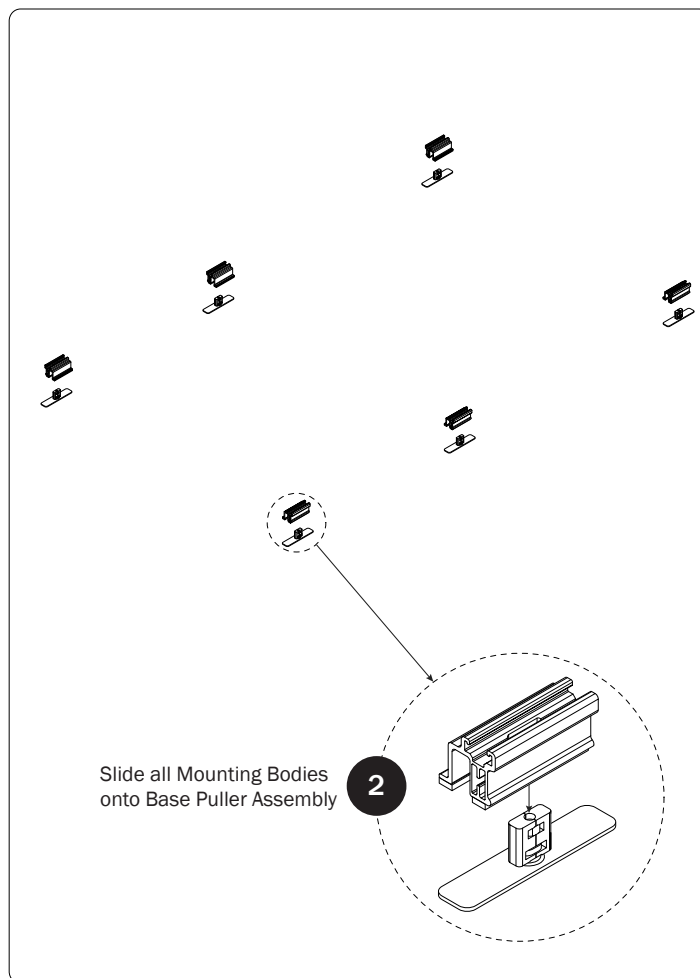
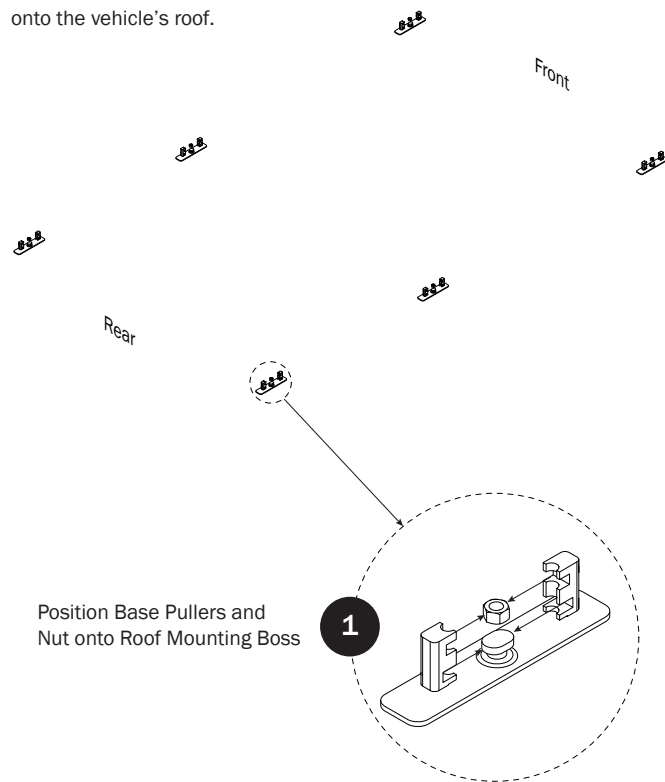

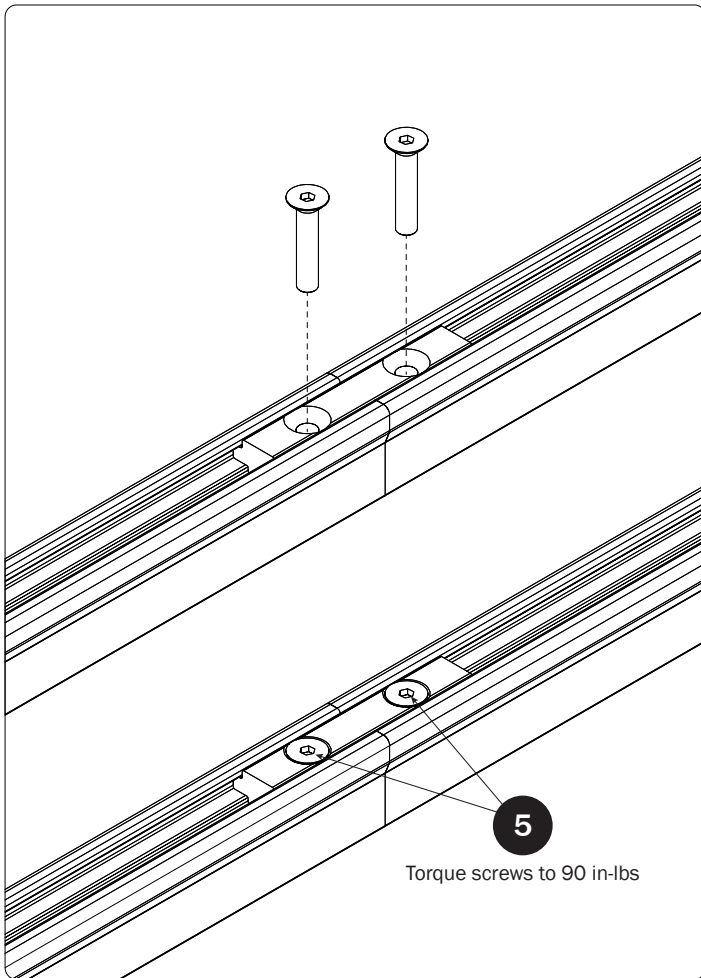

6 Set to distances then torque Mounting Bracket nuts to 80 in-lbs

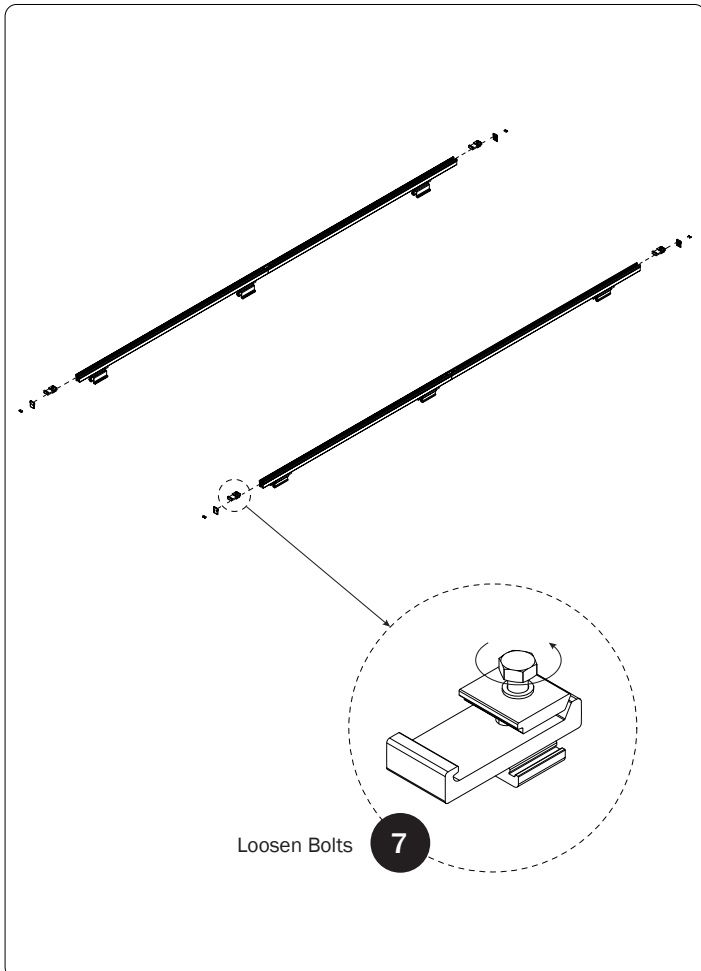
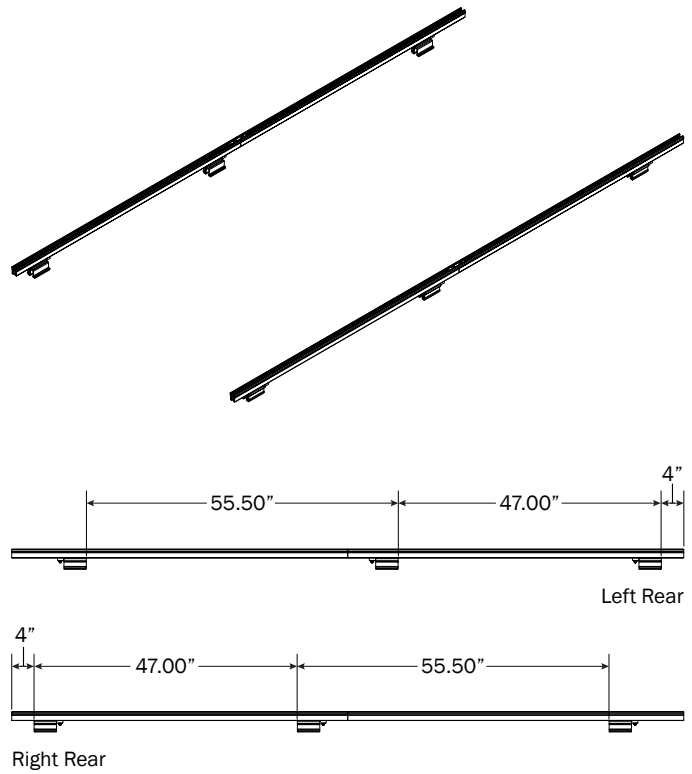

8 Set to distances shown, but do not tighten at this time

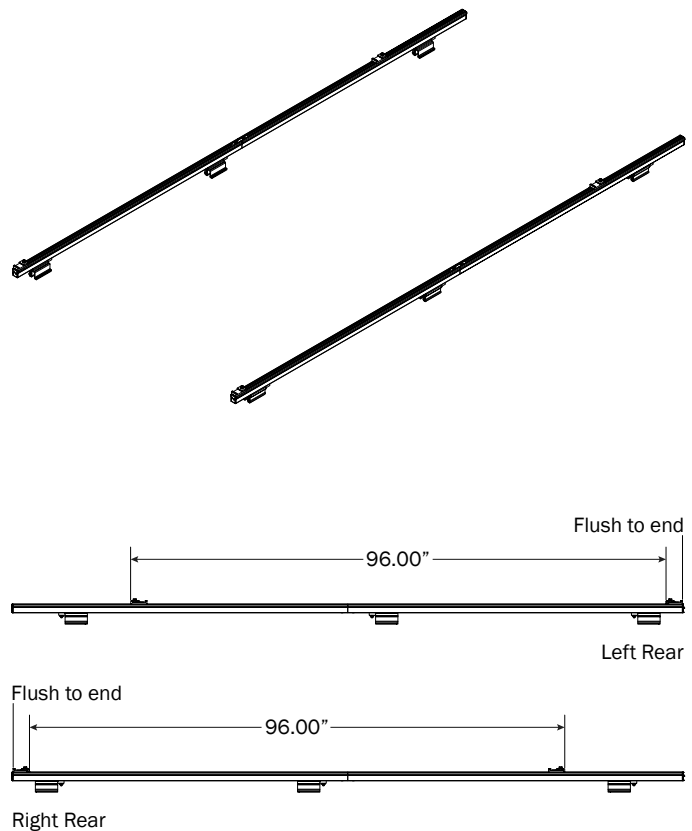

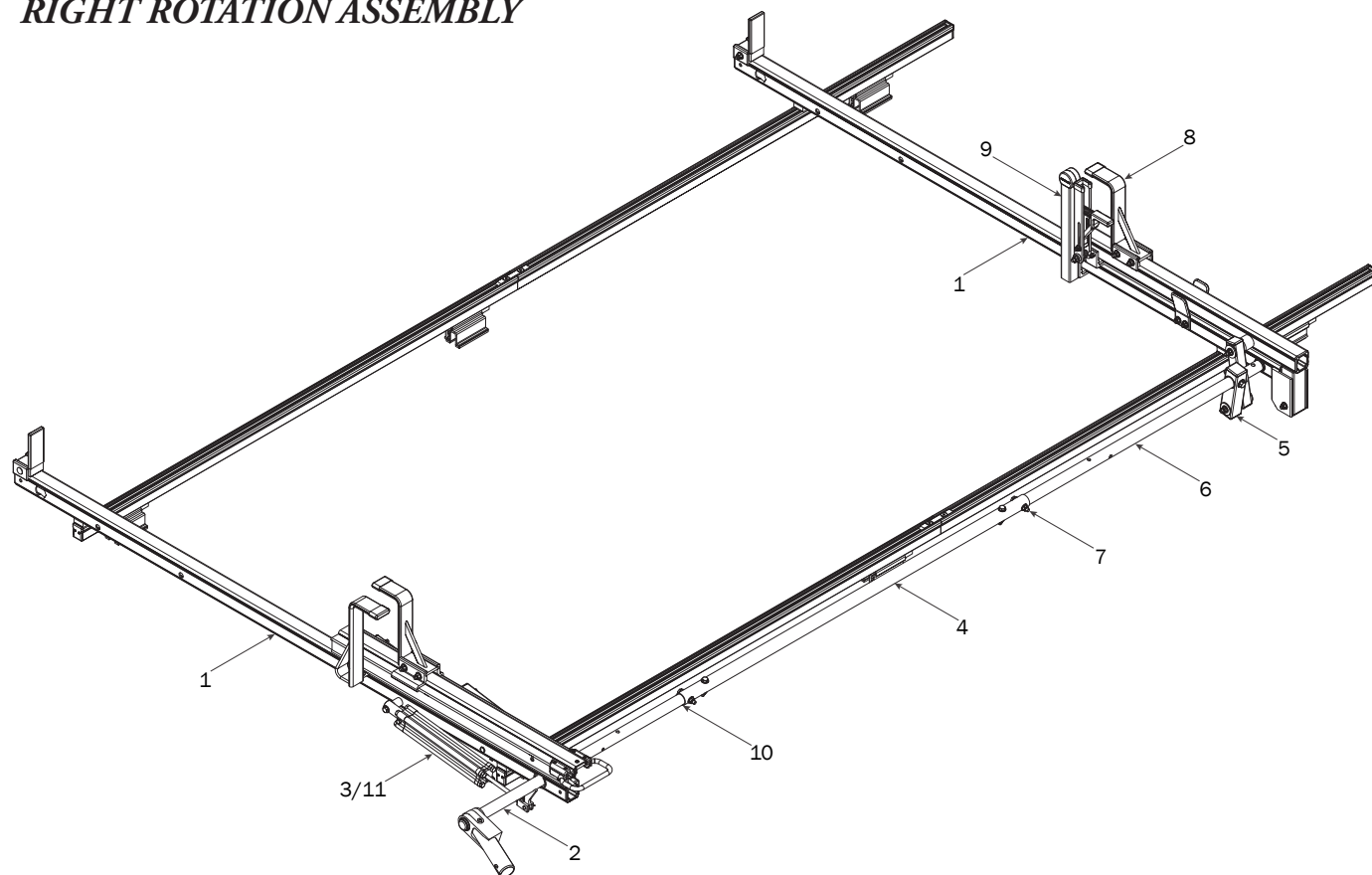
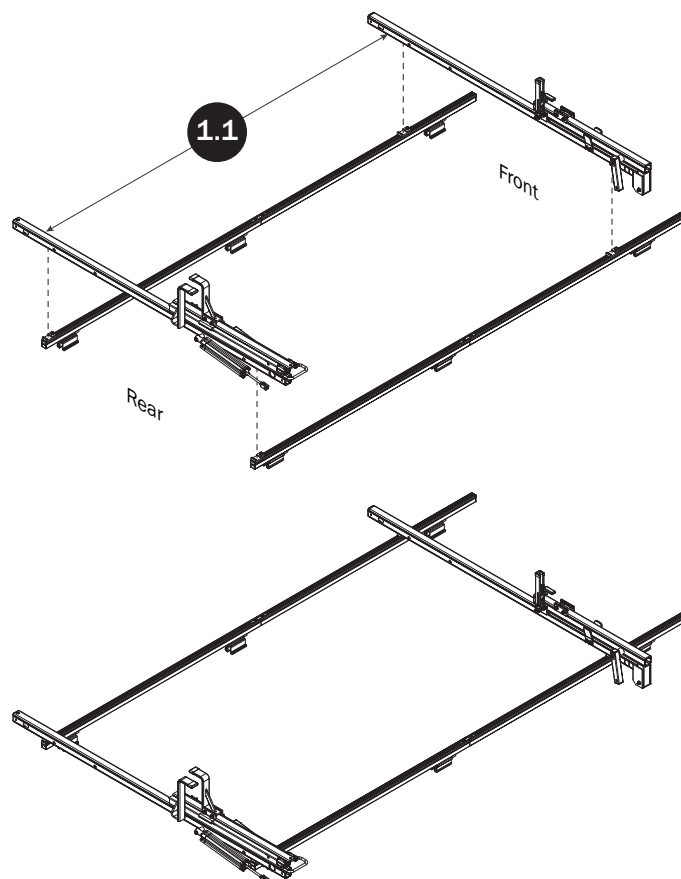
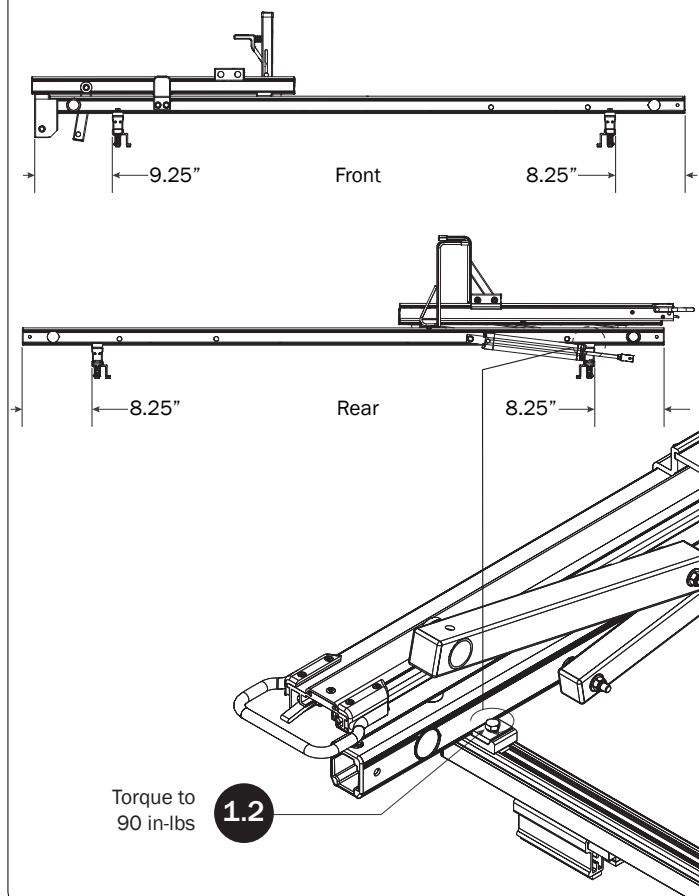
**RIGHT ROTATION ASSEMBLY****CROSSBARS****CROSSBAR ADJUSTMENT**

## REAR DRIVE SHAFT

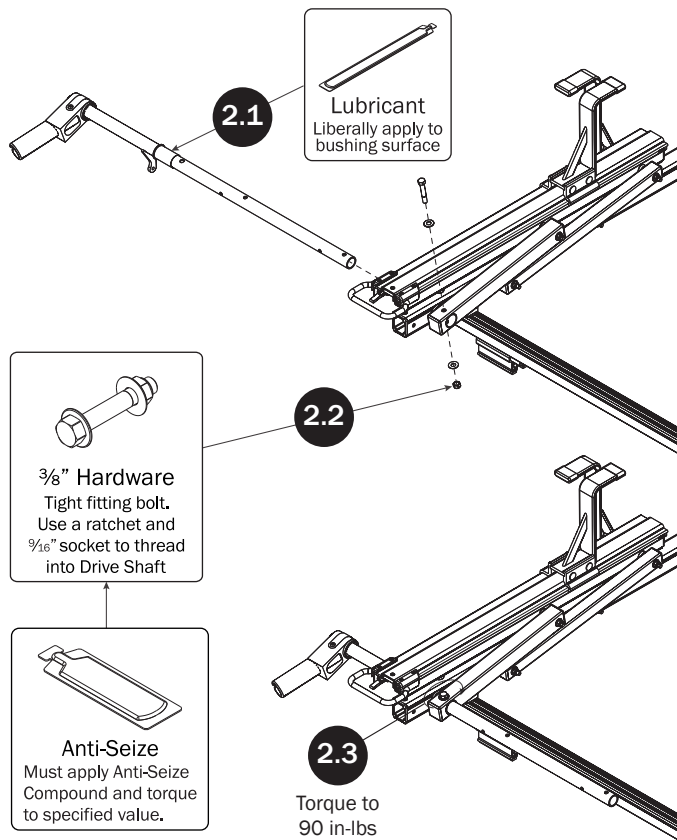

## CYLINDER HARDWARE

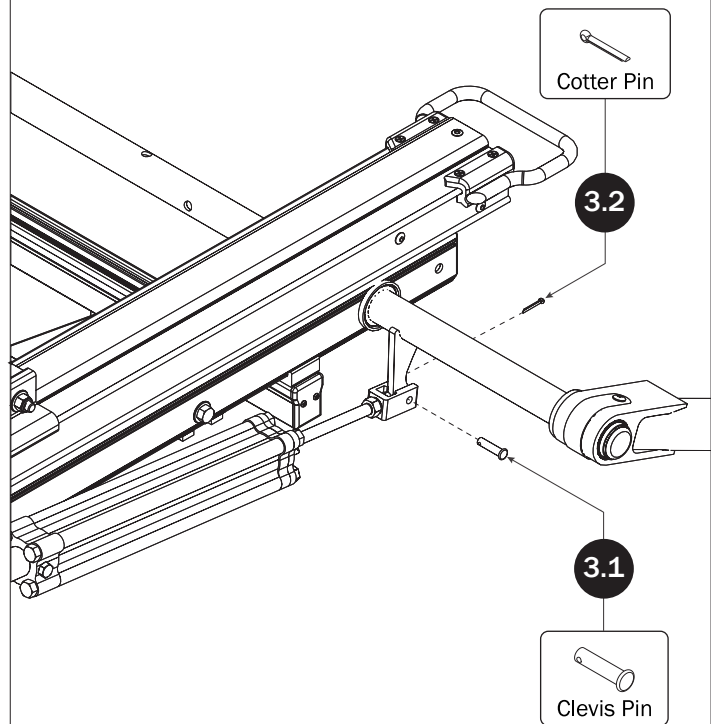

## CONNECTING BAR

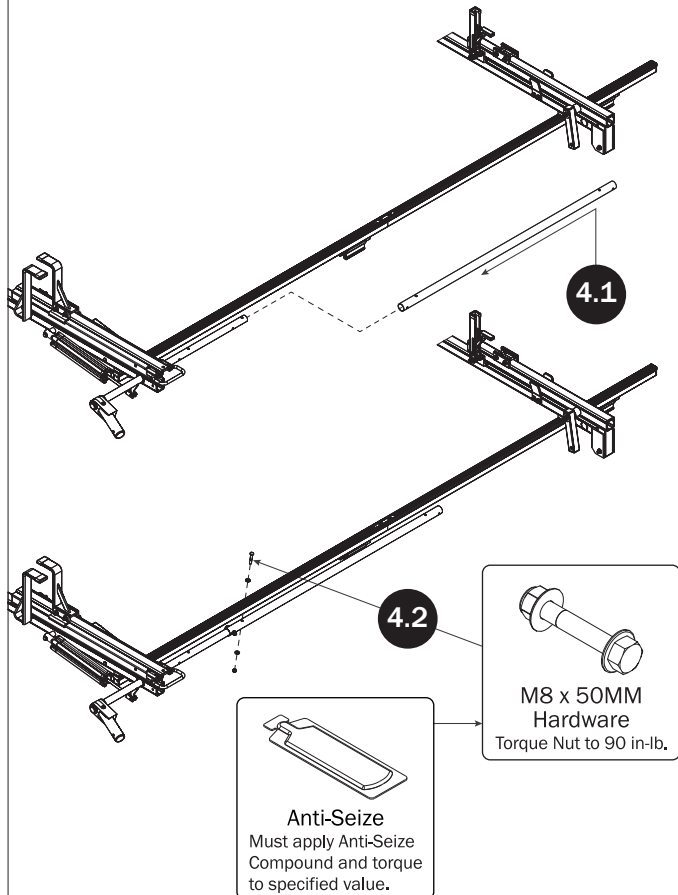

## FRONT DRIVE ARM

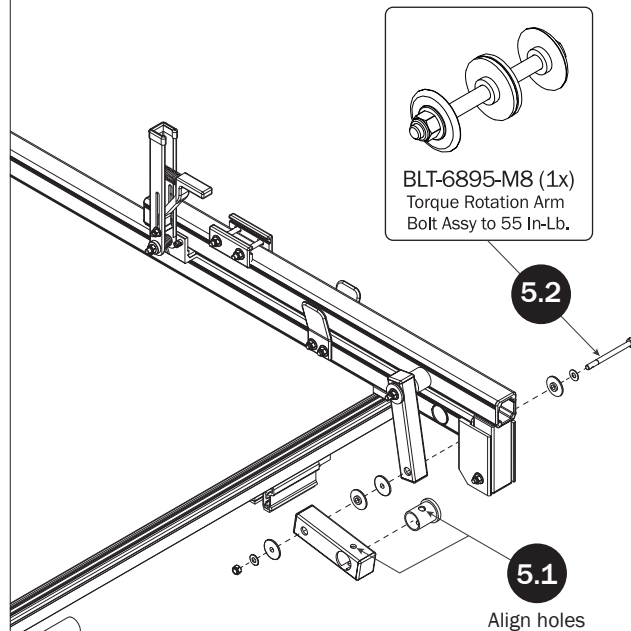



## FRONT DRIVE SHAFT

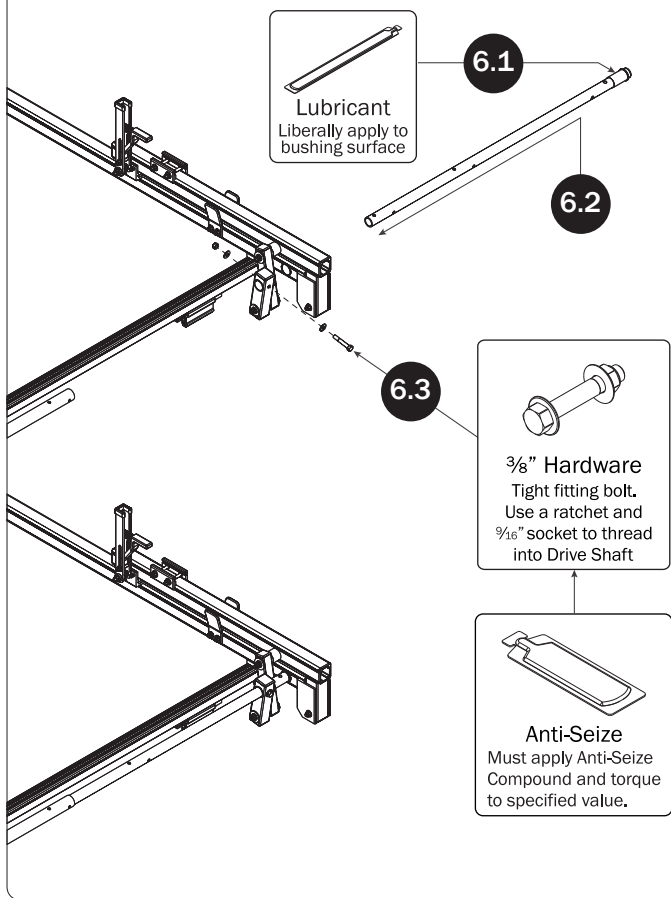

## CONNECTING BAR FASTENERS

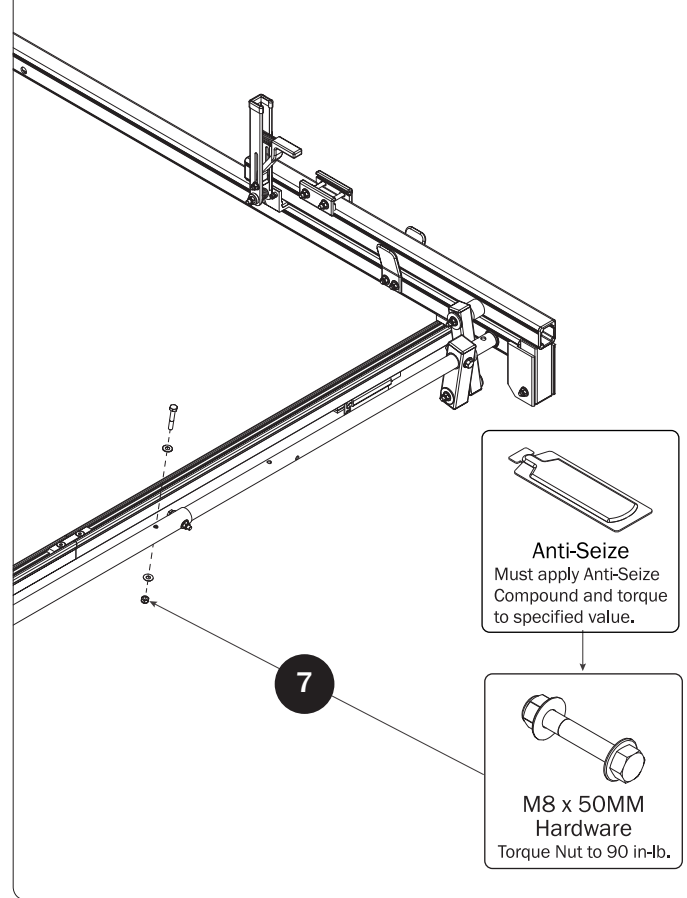

## Z POSTS

SEE QUICK START GUIDE FOR ADJUSTMENTS

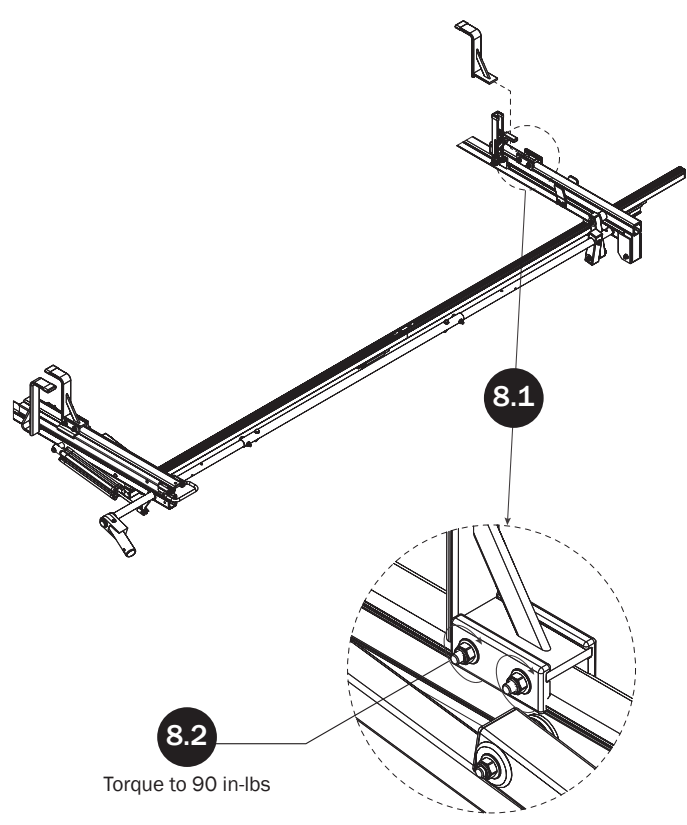

## L POSTS

SEE QUICK START GUIDE FOR ADJUSTMENTS

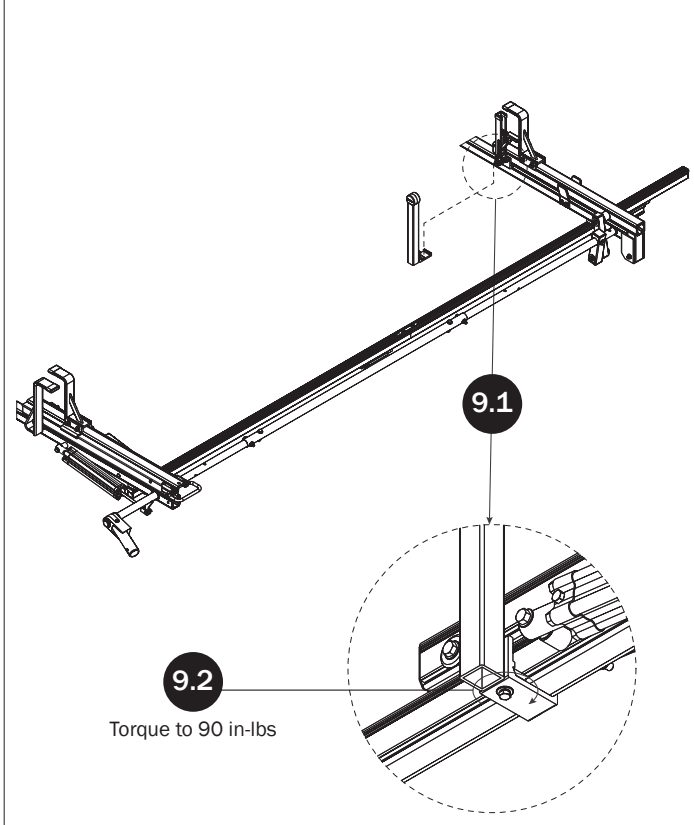



## DRIVE SHAFT SEALING

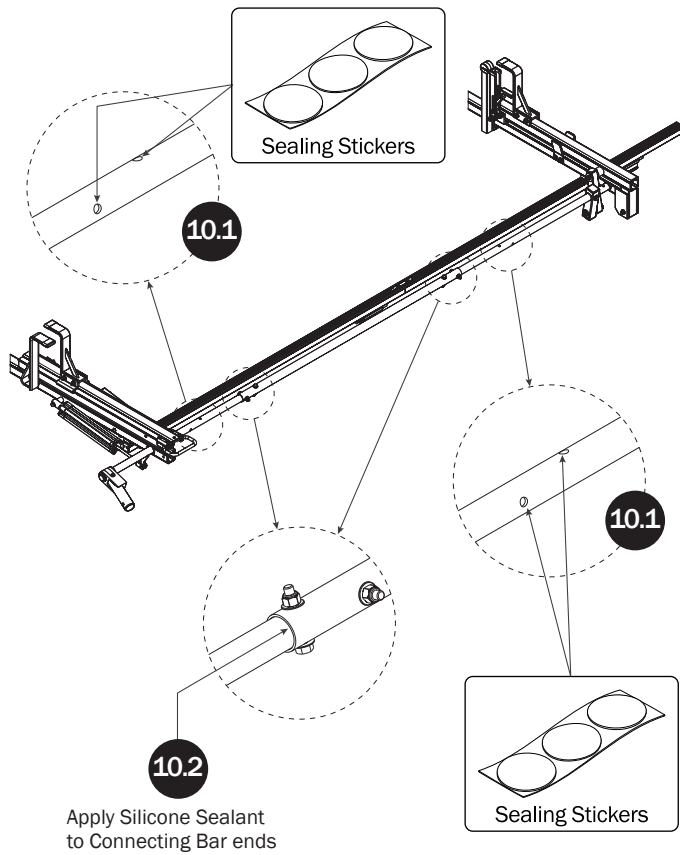

## CYLINDER ADJUSTMENT

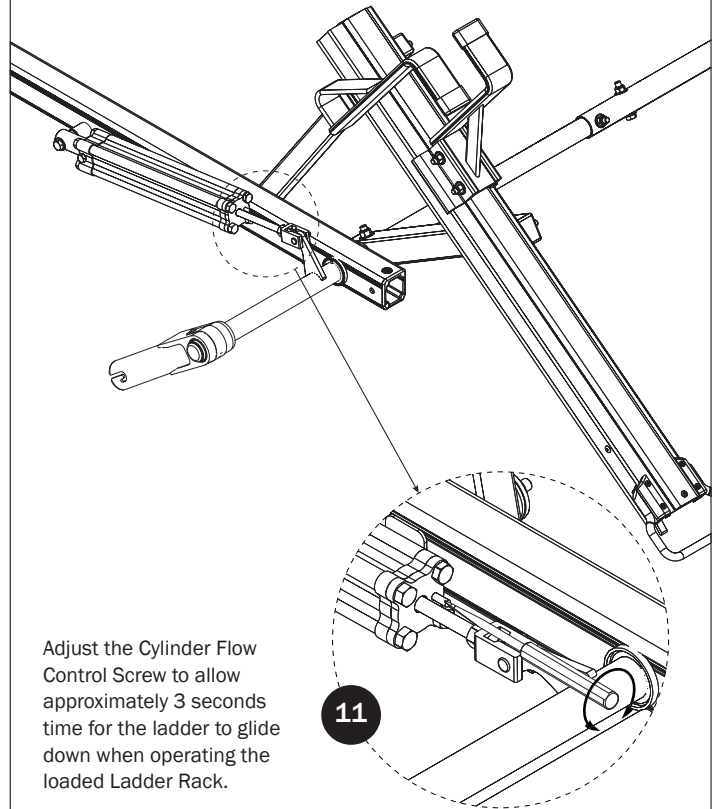

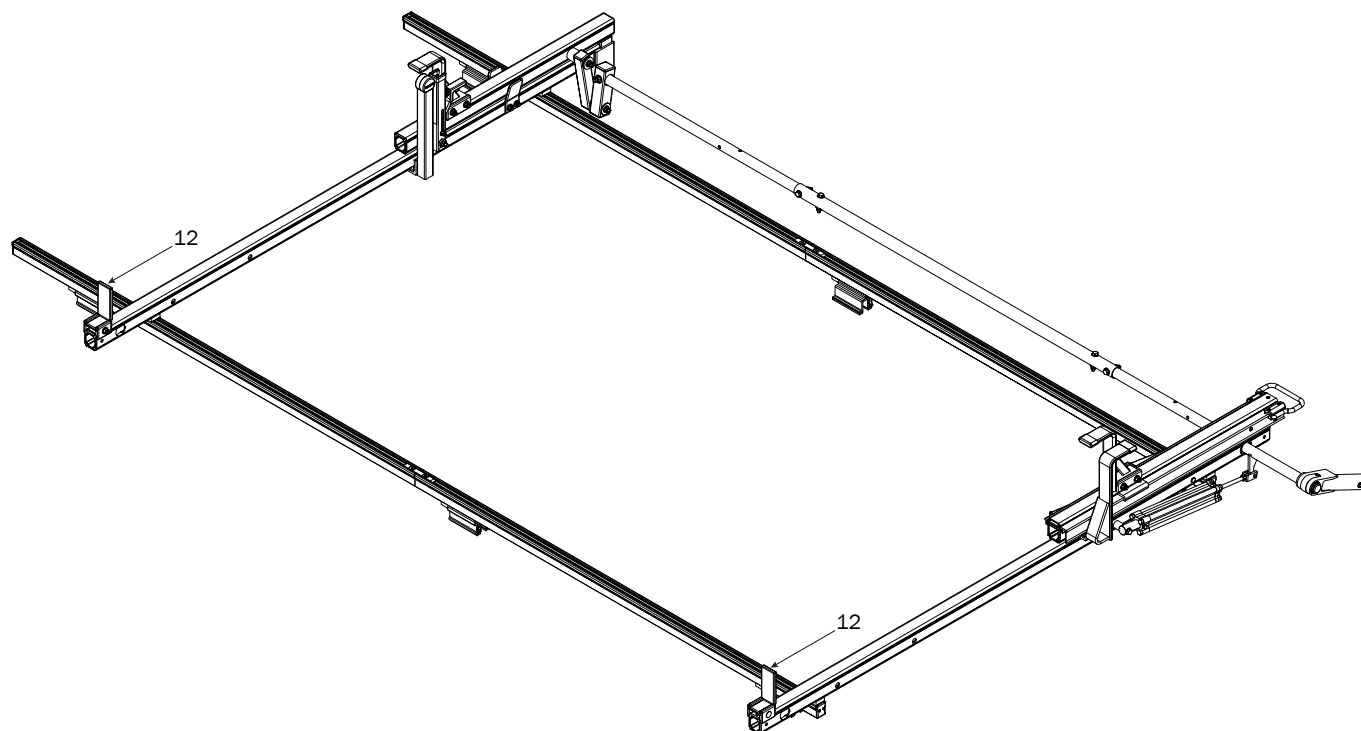
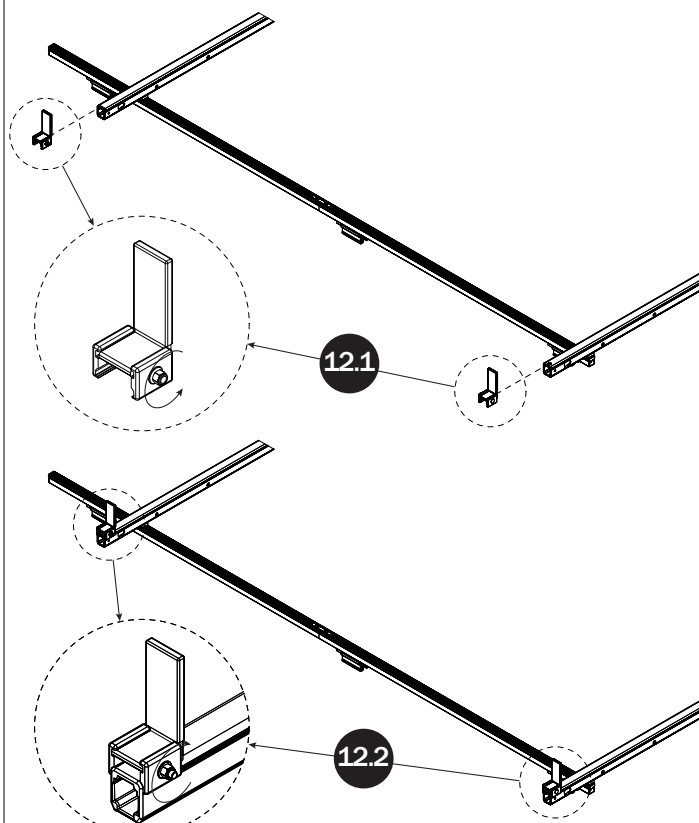
*LEFT SIDE BASE**LADDER STOPS*

Page Intentionally Left Blank

