

PRIME DESIGN™

A Safe Fleet Brand

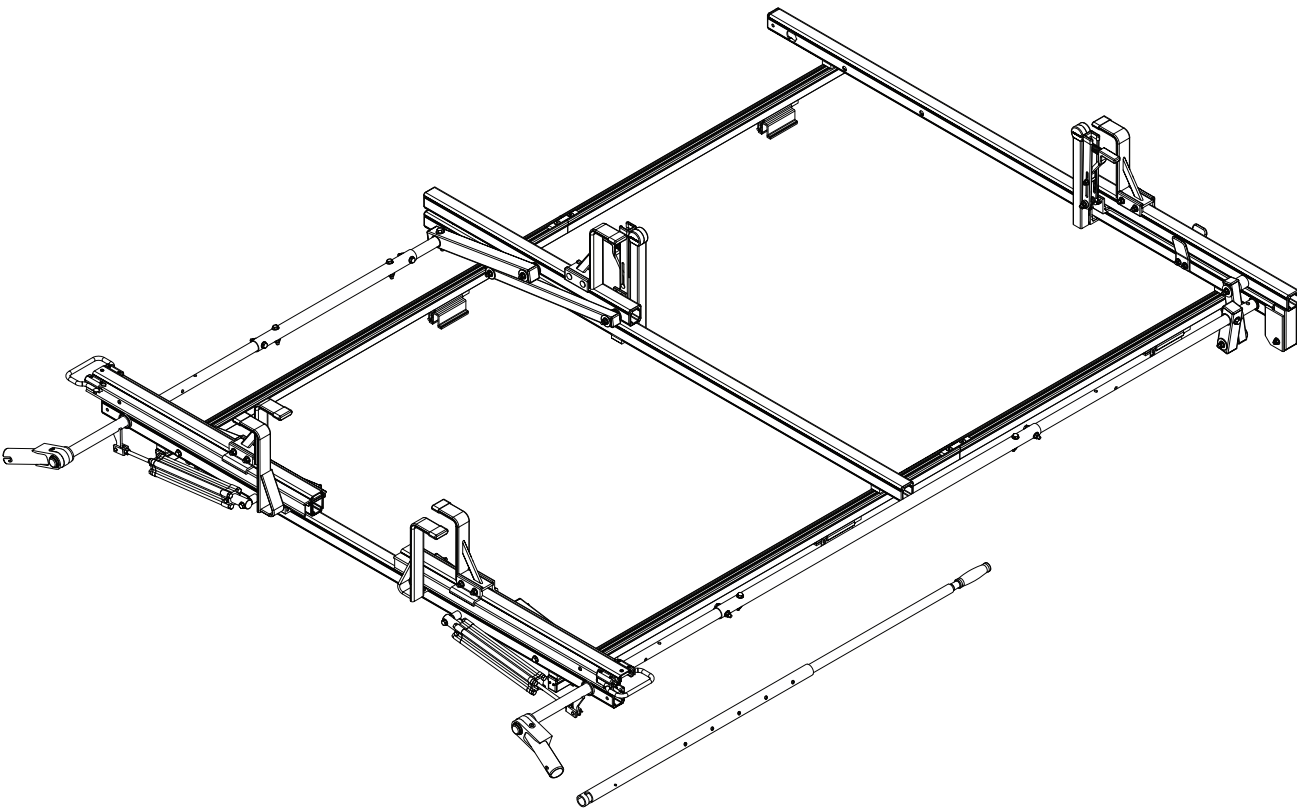

VRI3-E

CONTENTS OVERVIEW

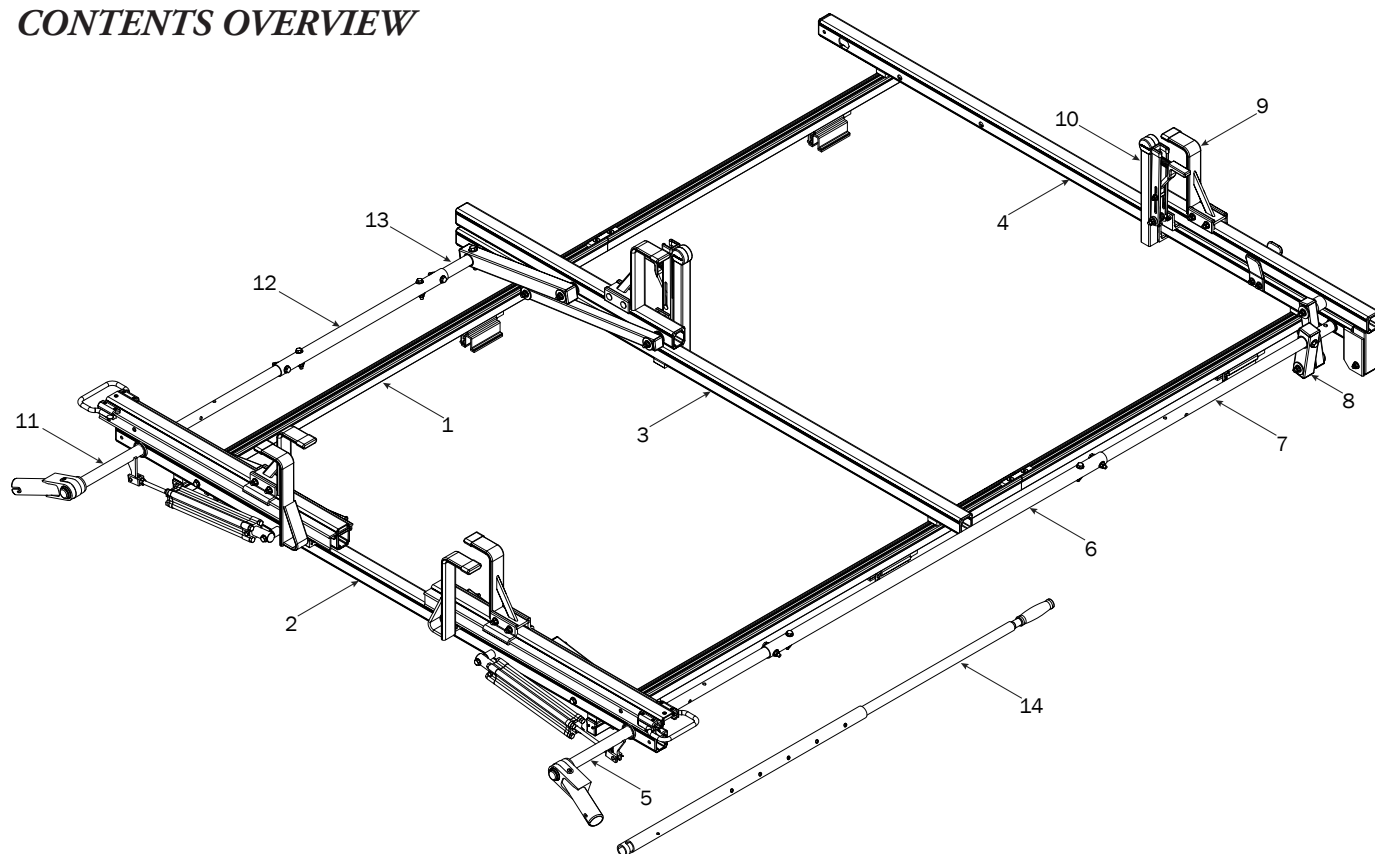

1—FBM3-0012 (Qty 1)
Channels with Hardware

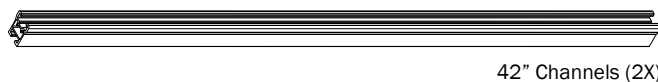

42" Channels (2X)



60" Channels (2X)



End Caps (4X)



Screws (8X)



Top Connector (2X)



Bottom Connector (2X)



Brackets (6X)



Mountings (6X)

M8 Bolt (4X)

2—Rear Crossbar Assembly (Qty 1)

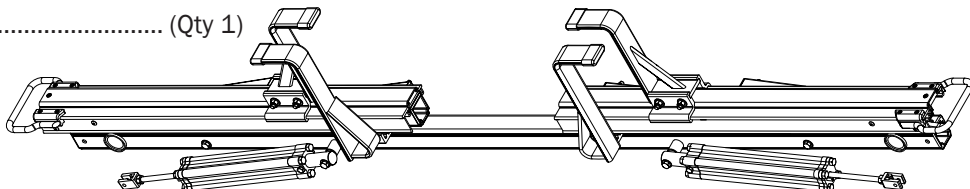

3—Center Crossbar Assembly (Qty 1)

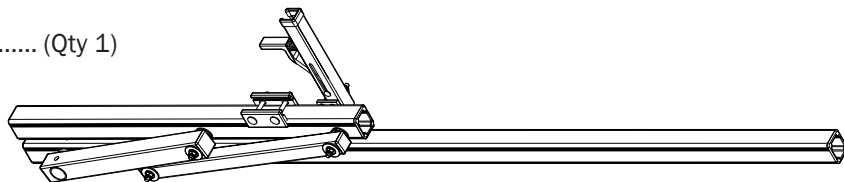

4—Front Crossbar Assembly (Qty 1)

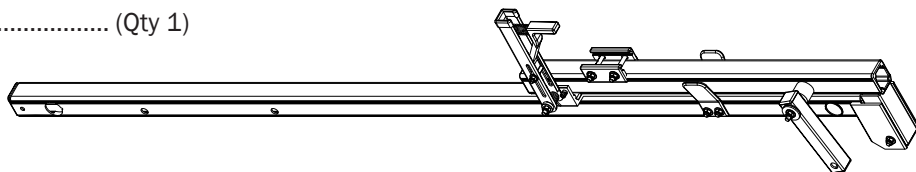

5—Drive Shaft..... (Qty 1)
Rear, Right Hand, 34.00"

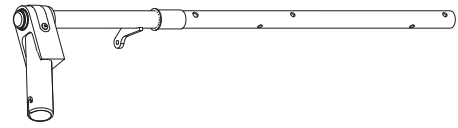

6—Connecting Bar..... (Qty 1)
48.00"

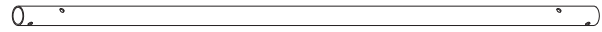

7—Front Drive Shaft..... (Qty 1)
38.75"

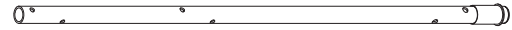

8—Drive Arm..... (Qty 1)
Incline Version with Bushing and Hardware

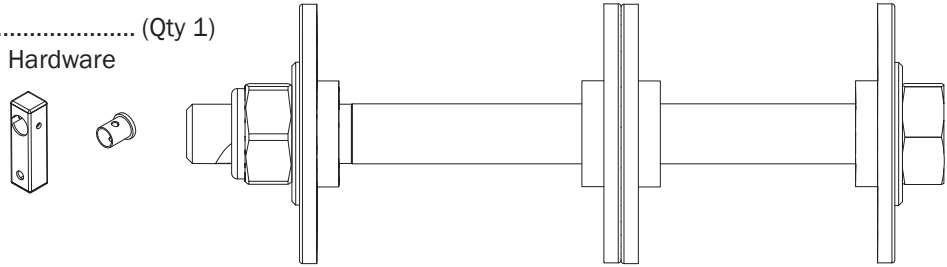

9—Z Post..... (Qty 2)
Adjustable, 7.25"

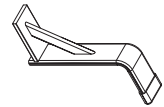

10—L Post..... (Qty 2)
US3, Square Cap, 11.25"

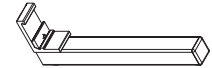

11—Drive Shaft..... (Qty 1)
Rear, Left Hand, 34.00"

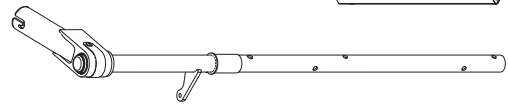

12—Connecting Bar..... (Qty 1)
24.00"

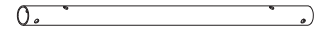

13—Front Drive Shaft..... (Qty 1)
B Version, 11.75"

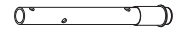

14—HRR Removeable Handle Assembly..... (Qty 1)

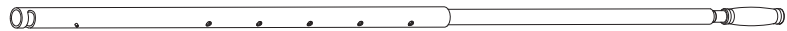

15—HKT-8163-Rotation Hardware Kit..... (Qty 2)
(Not called out in Overview)

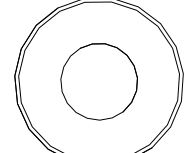
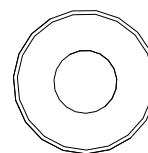
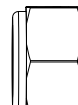
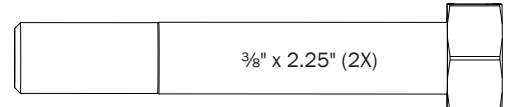
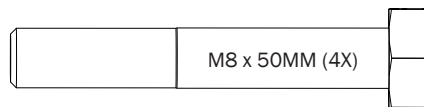

M8 Lock Nut (5X)

3/8" Lock Nut (2X)

5/16" Flat Washer (10X)

3/8" Flat Washer (4X)

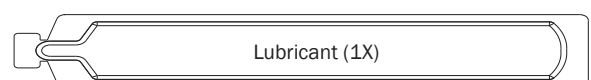
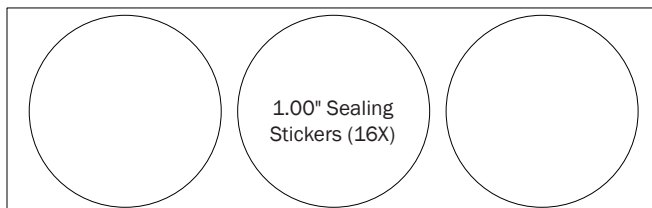

FBM3-0012
MOUNTING BRACKETS

INSTALLER NOTE: Mounting Brackets must be disassembled for installation onto the vehicle's roof.

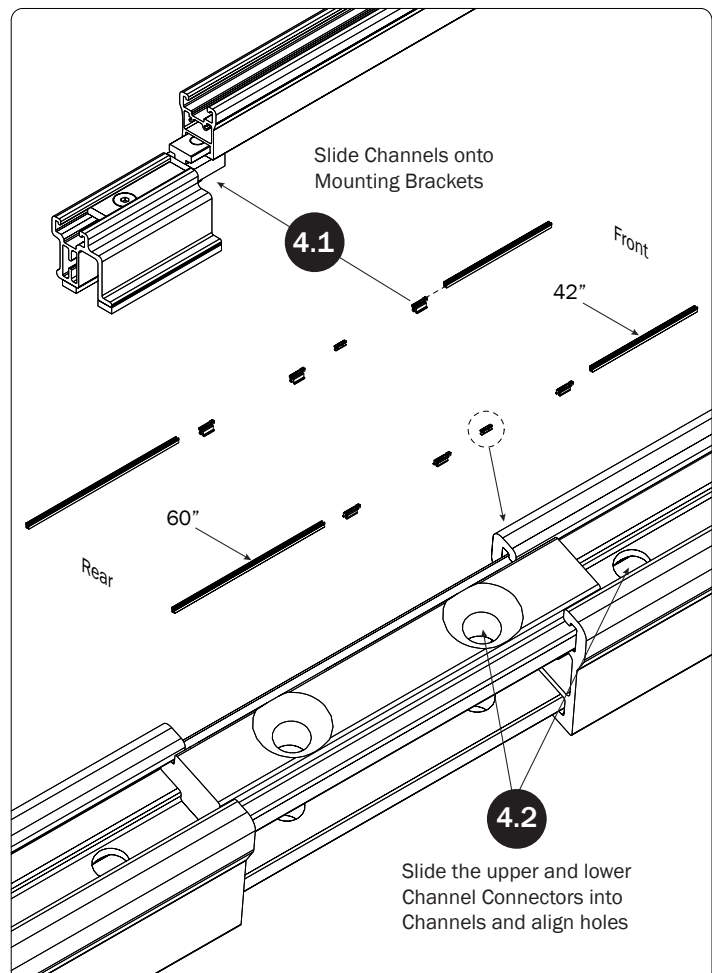
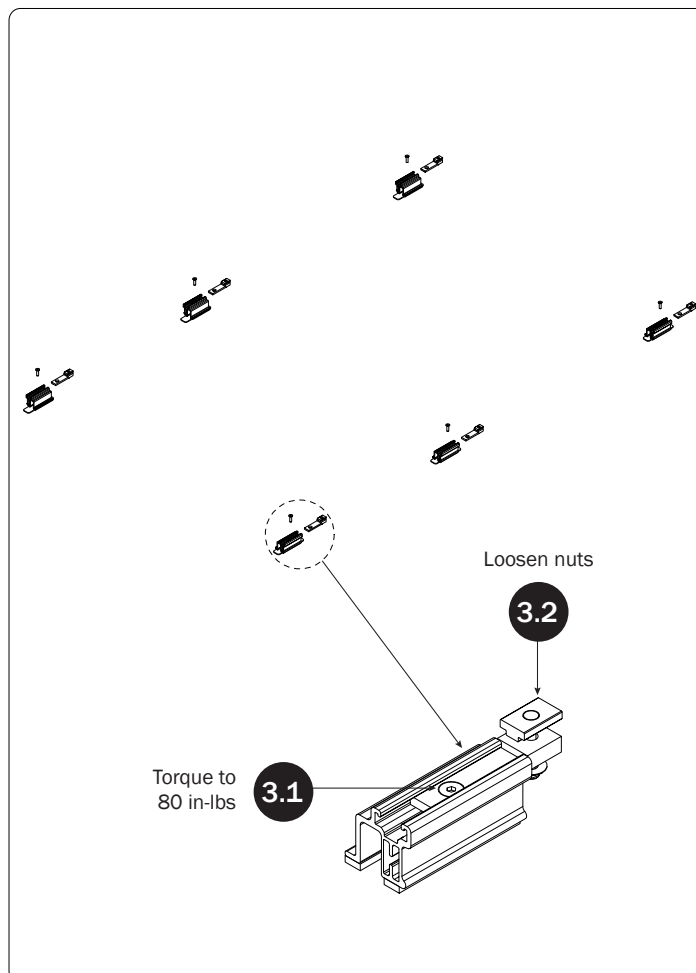
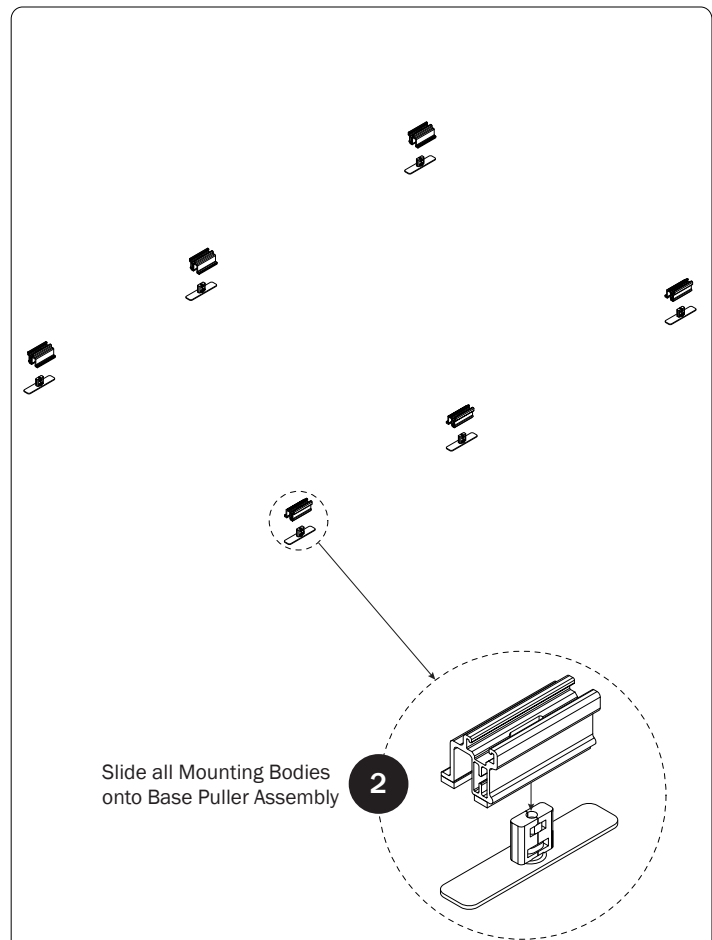
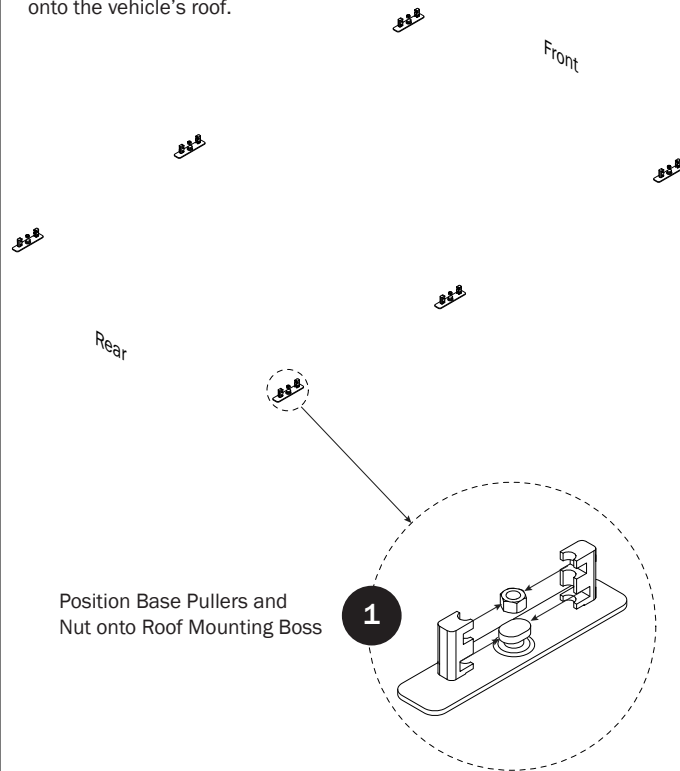

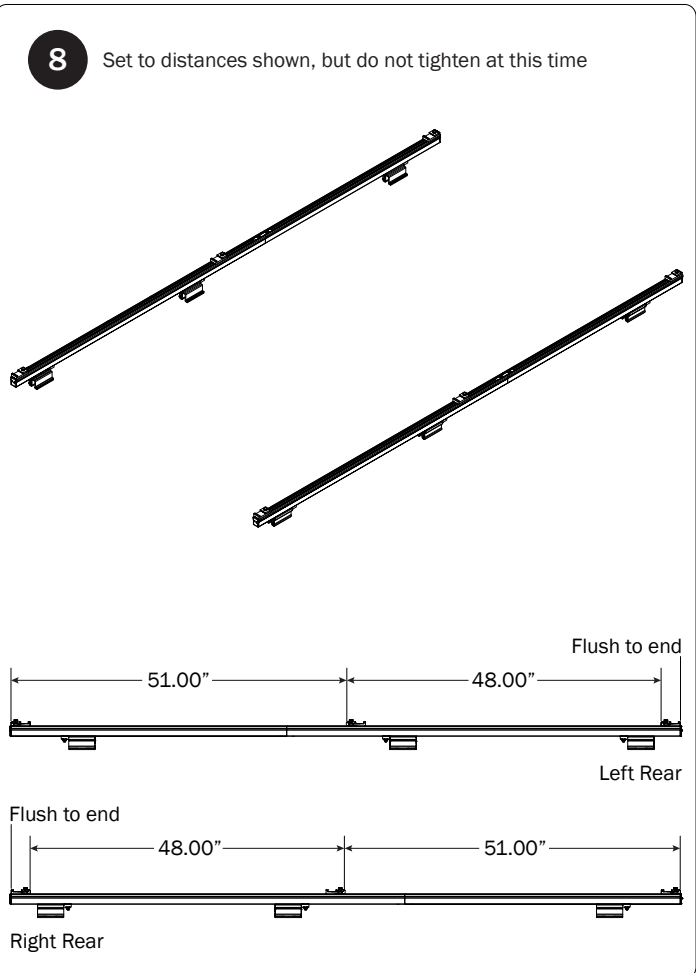
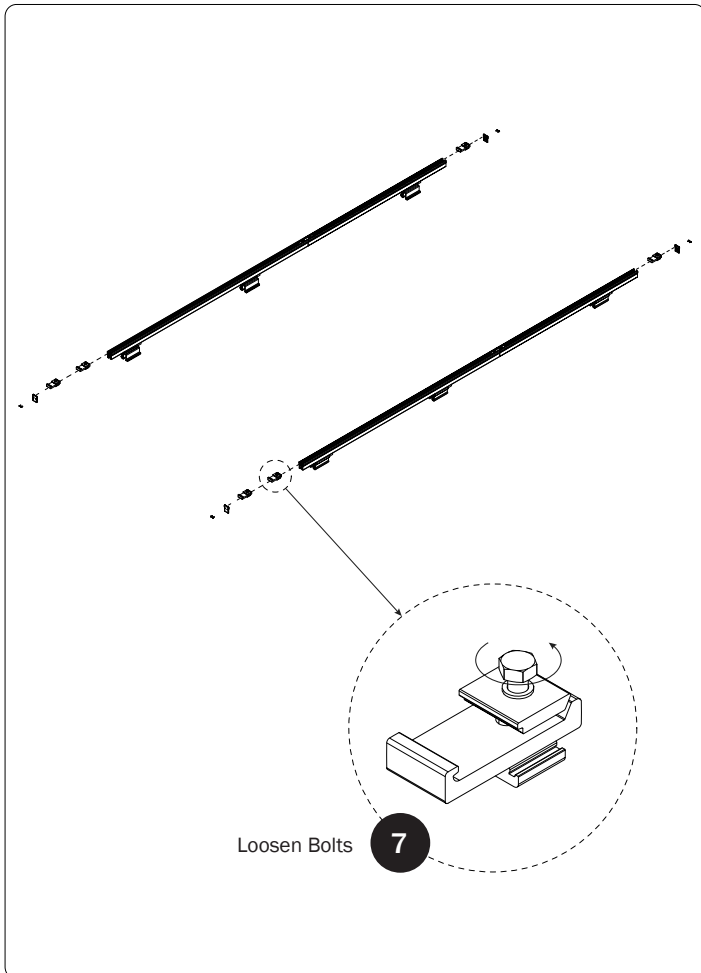
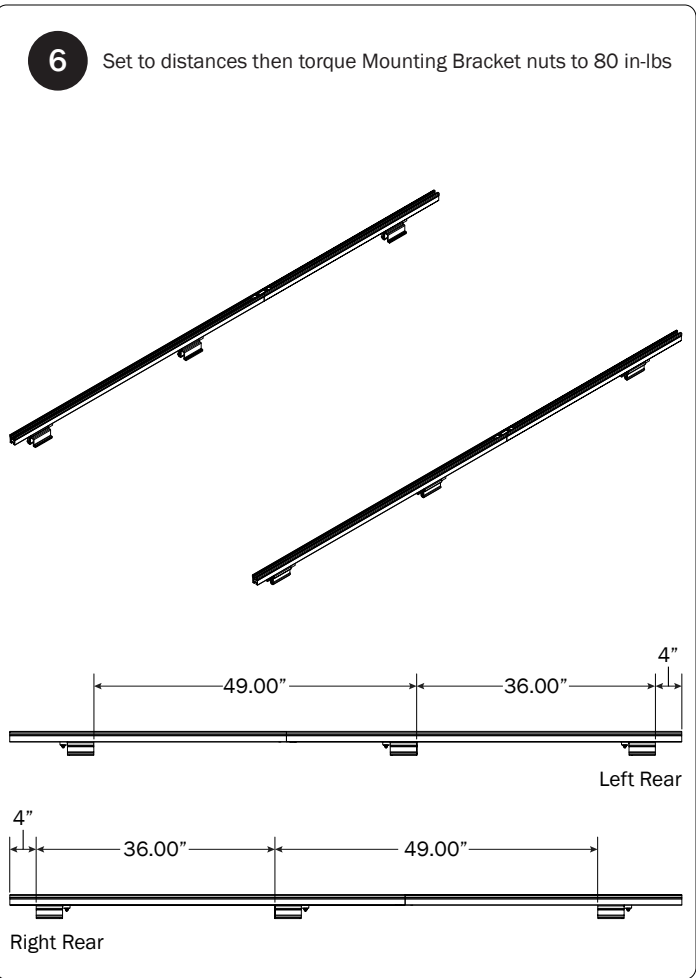
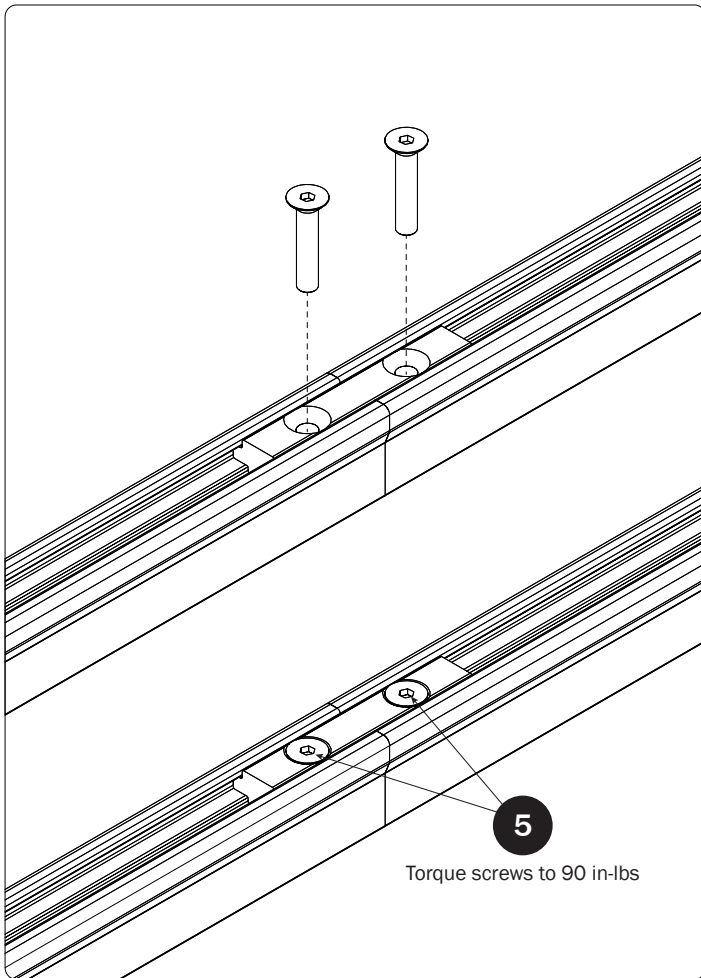

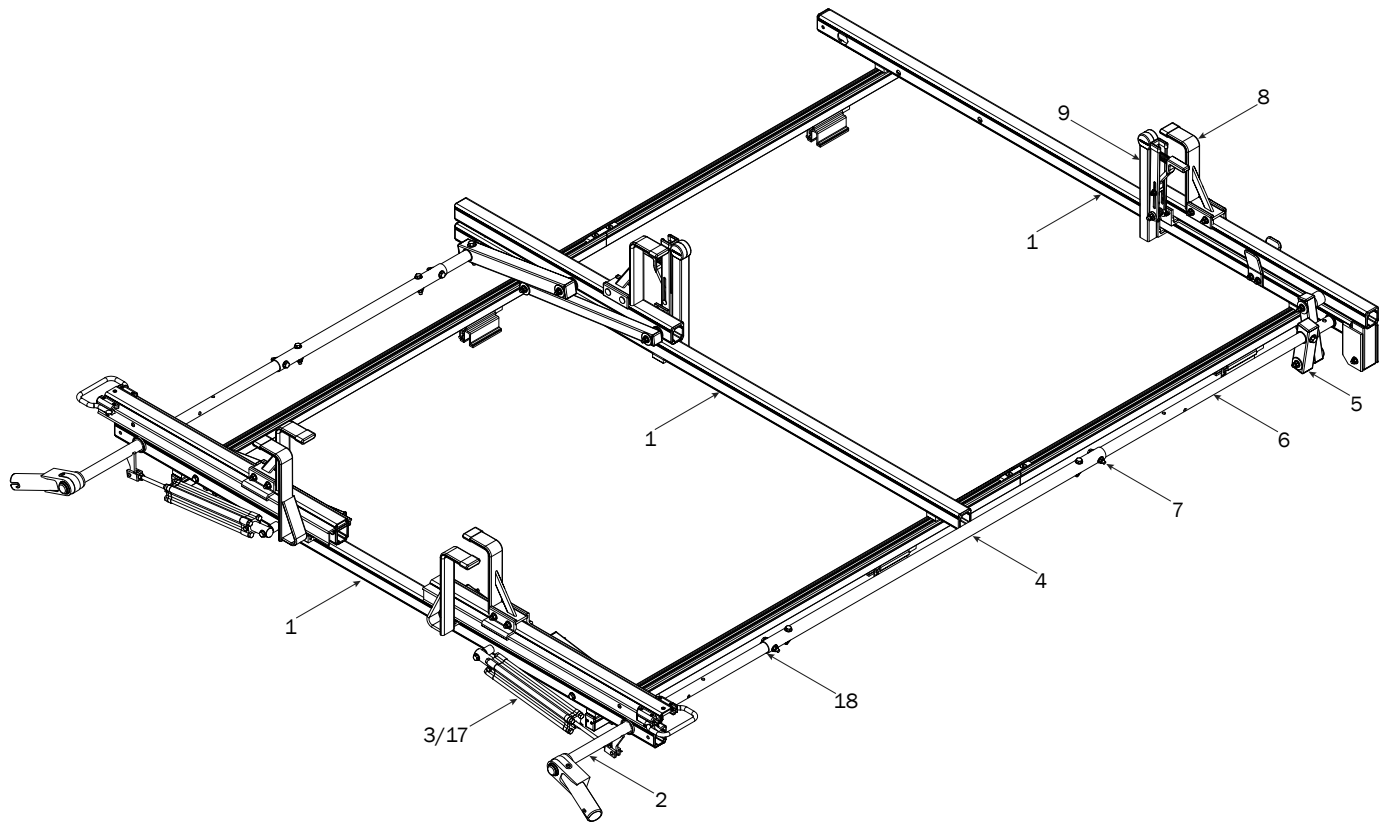

CROSSBARS

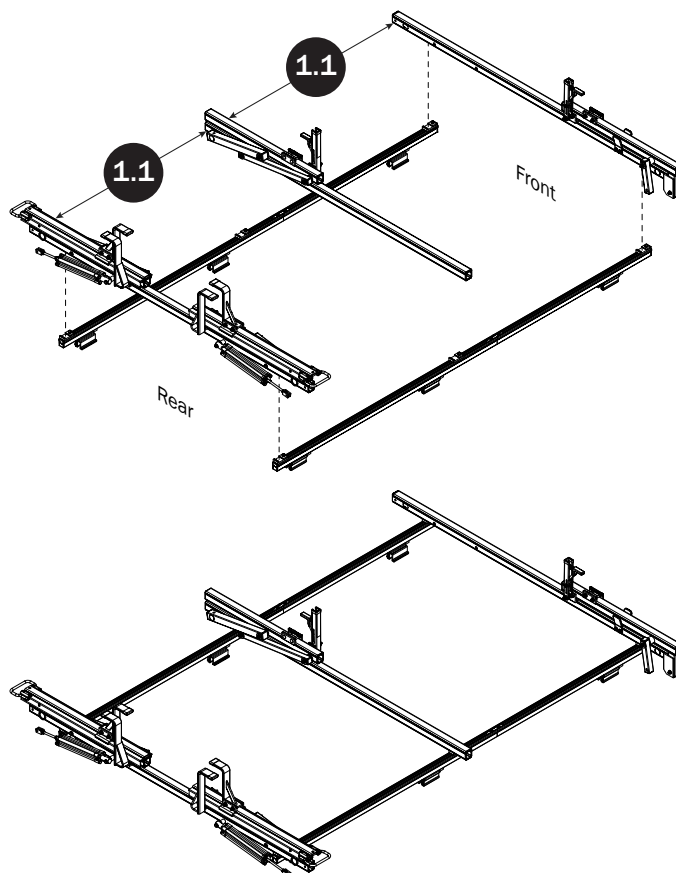

CROSSBAR ADJUSTMENT

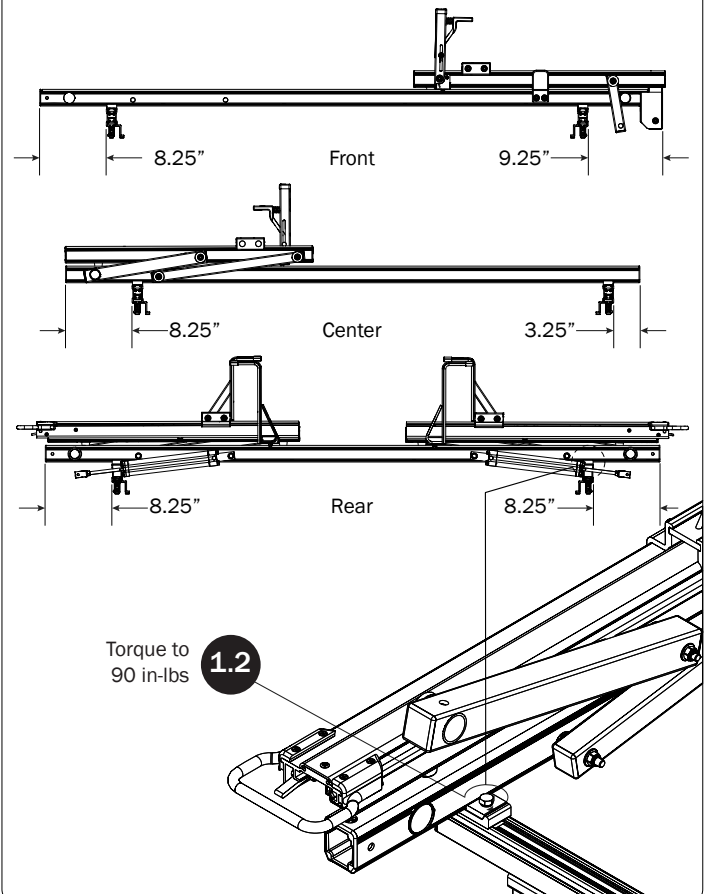

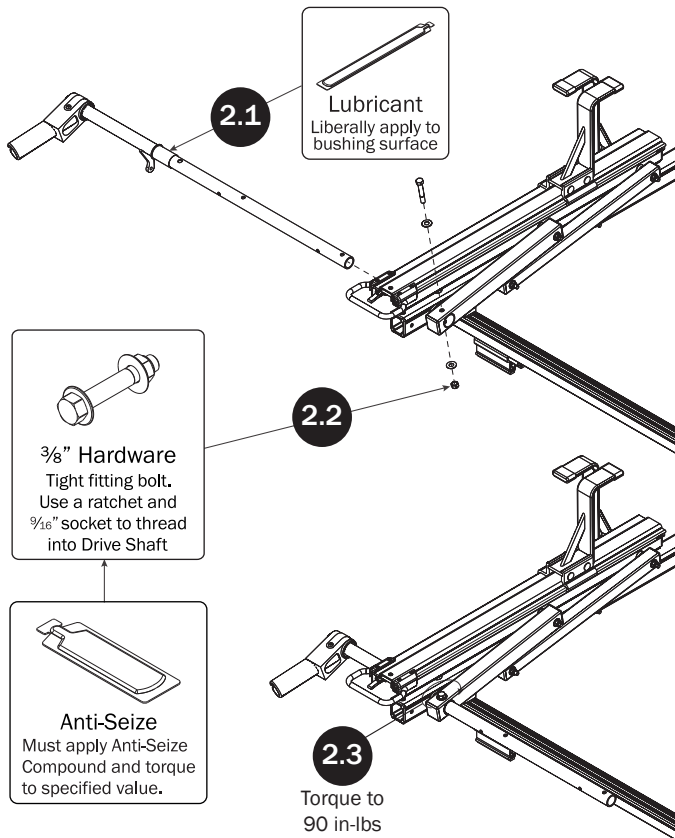
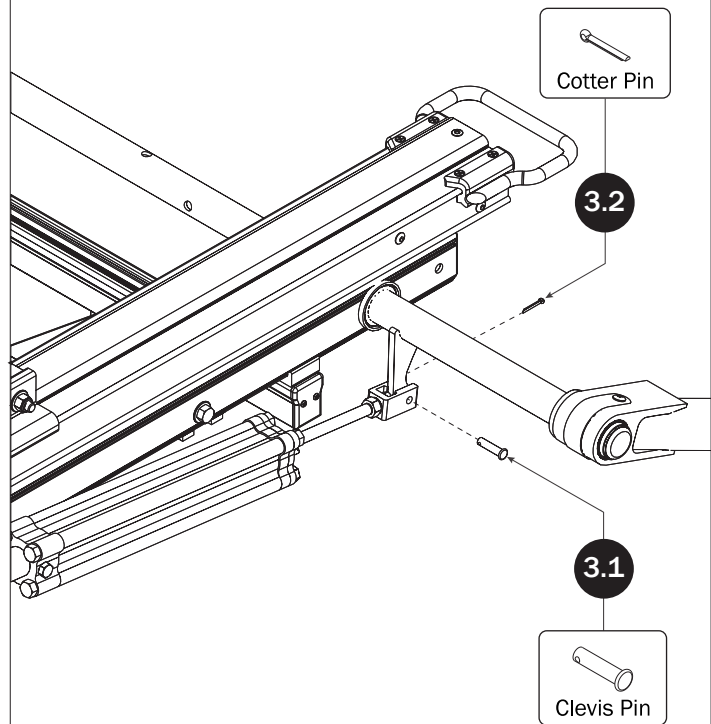
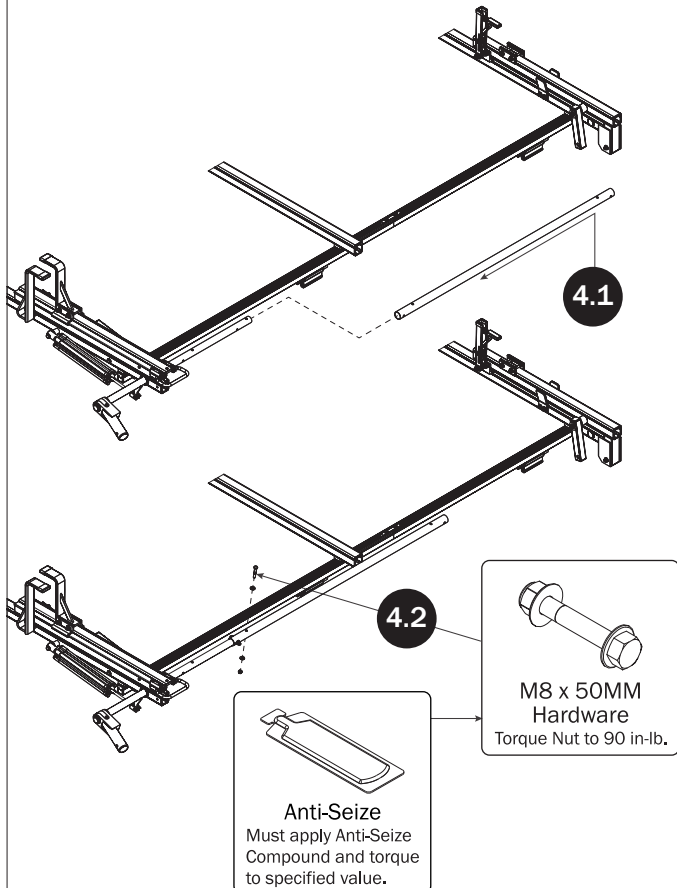
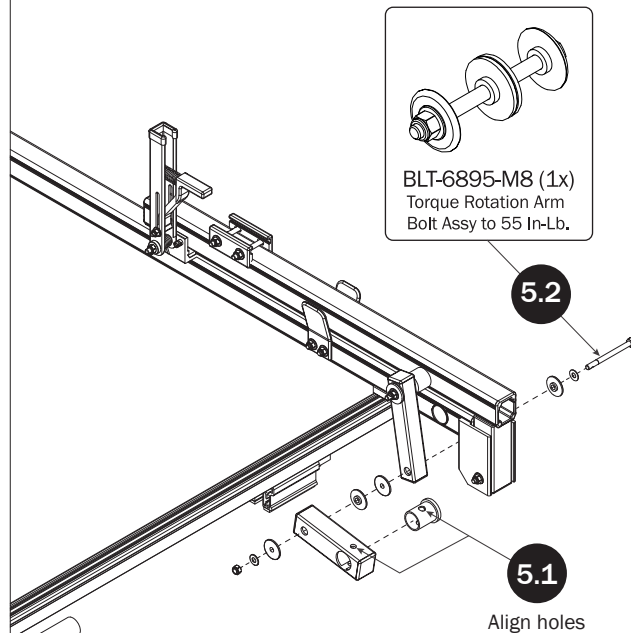
REAR DRIVE SHAFT**CYLINDER HARDWARE****CONNECTING BAR****FRONT DRIVE ARM**

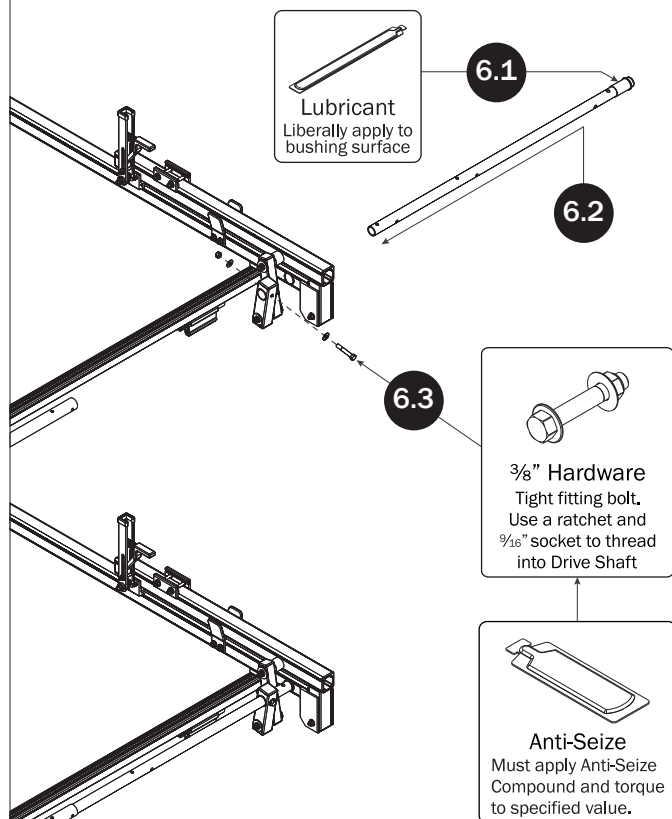
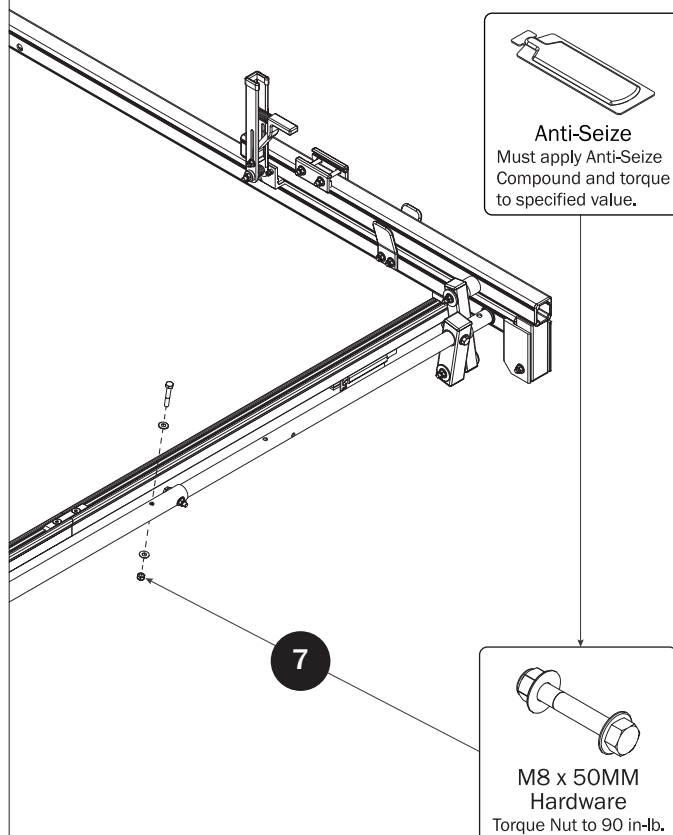
FRONT DRIVE SHAFT**CONNECTING BAR FASTENERS****Z POSTS**

SEE QUICK START GUIDE FOR ADJUSTMENTS

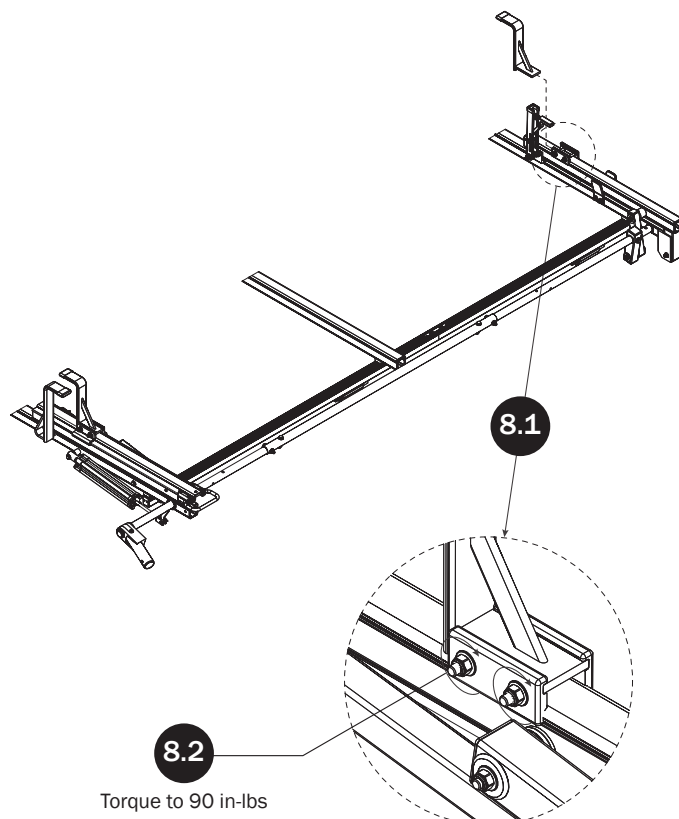
**L POSTS**

SEE QUICK START GUIDE FOR ADJUSTMENTS

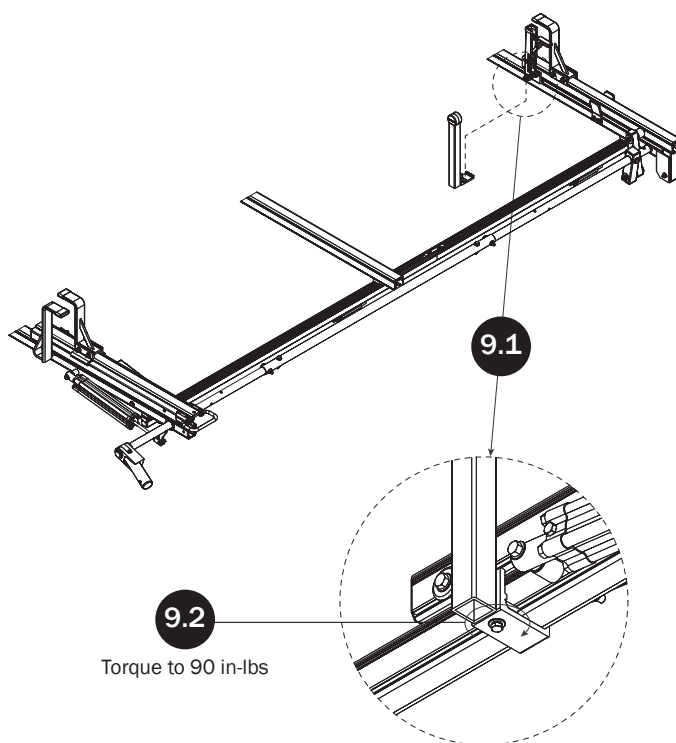

LEFT ROTATION ASSEMBLY

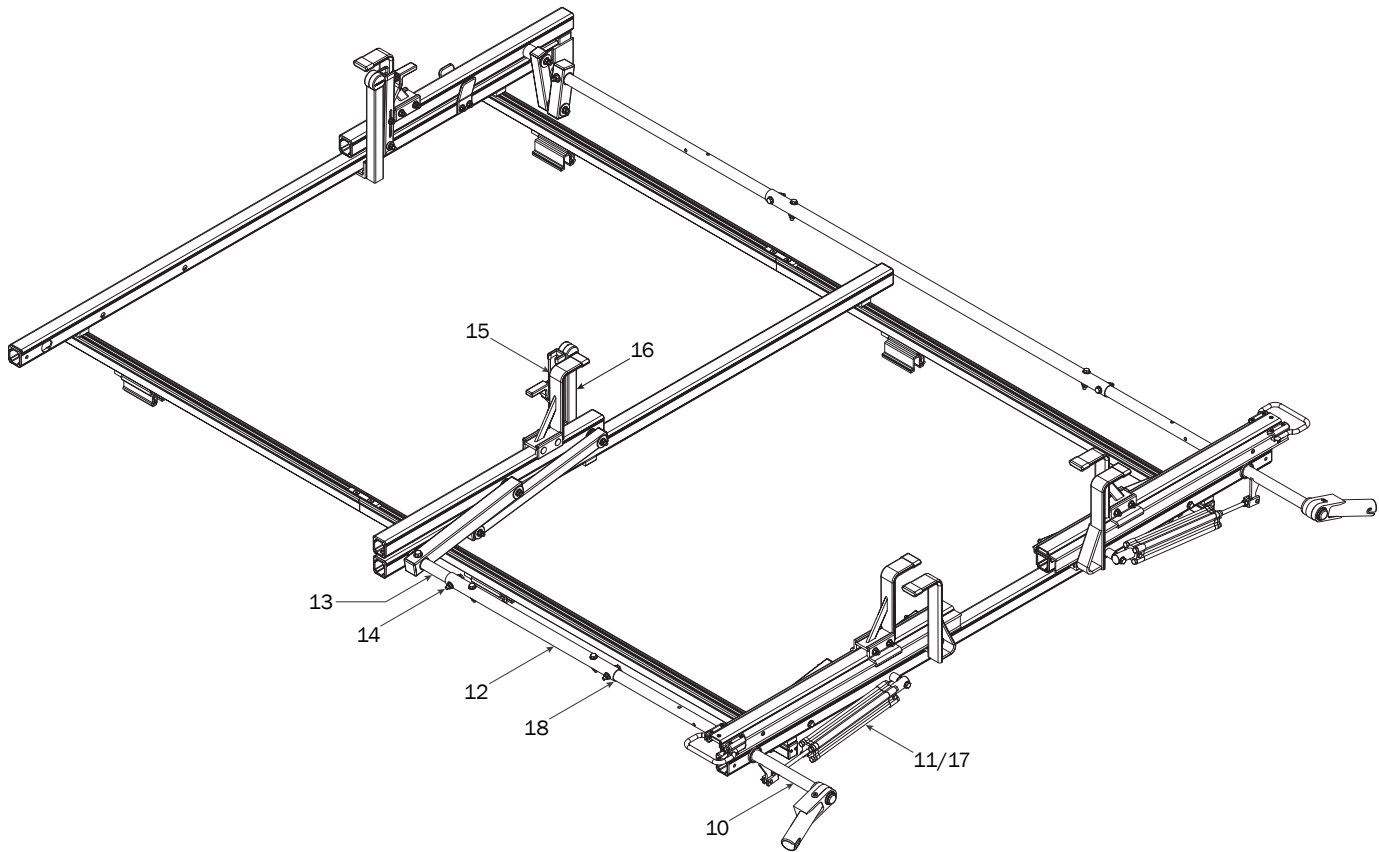

REAR DRIVE SHAFT

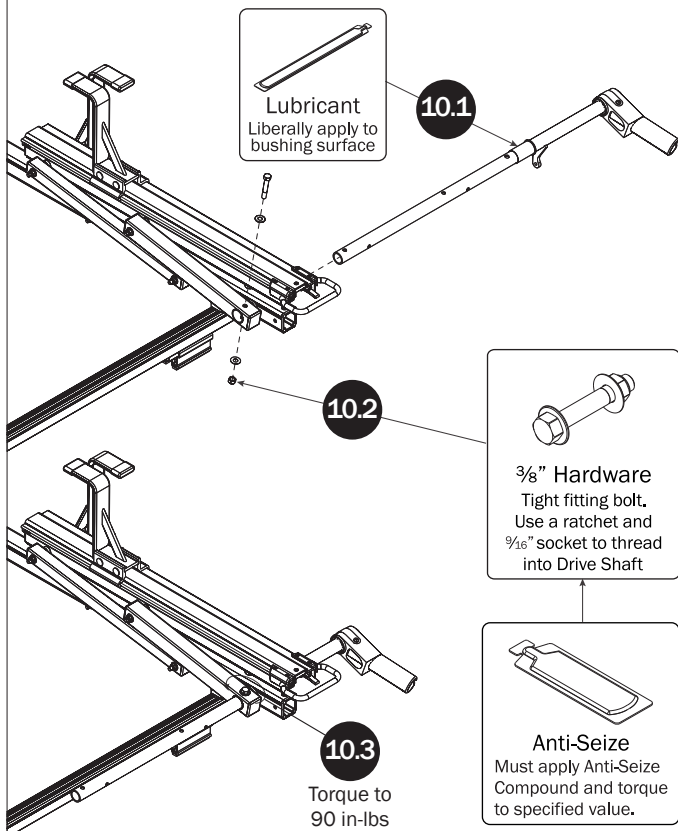

CYLINDER HARDWARE

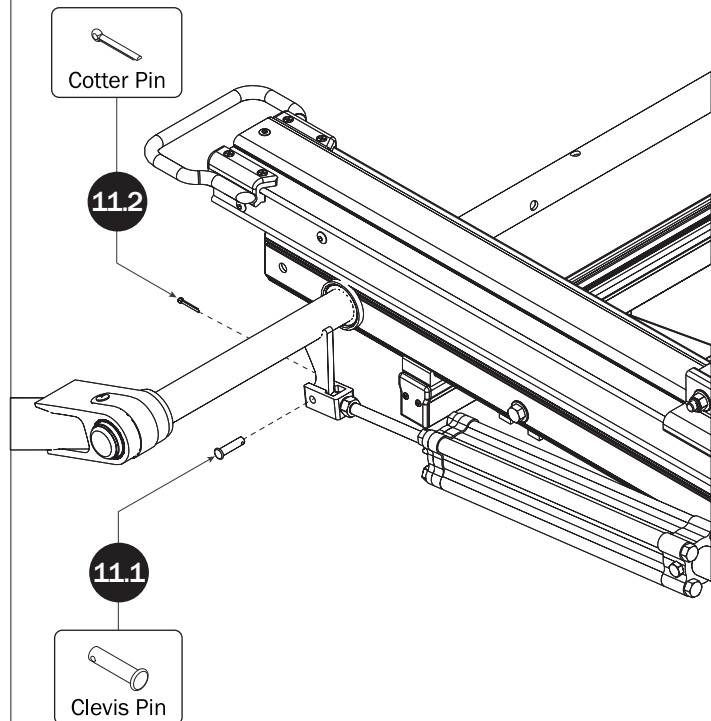

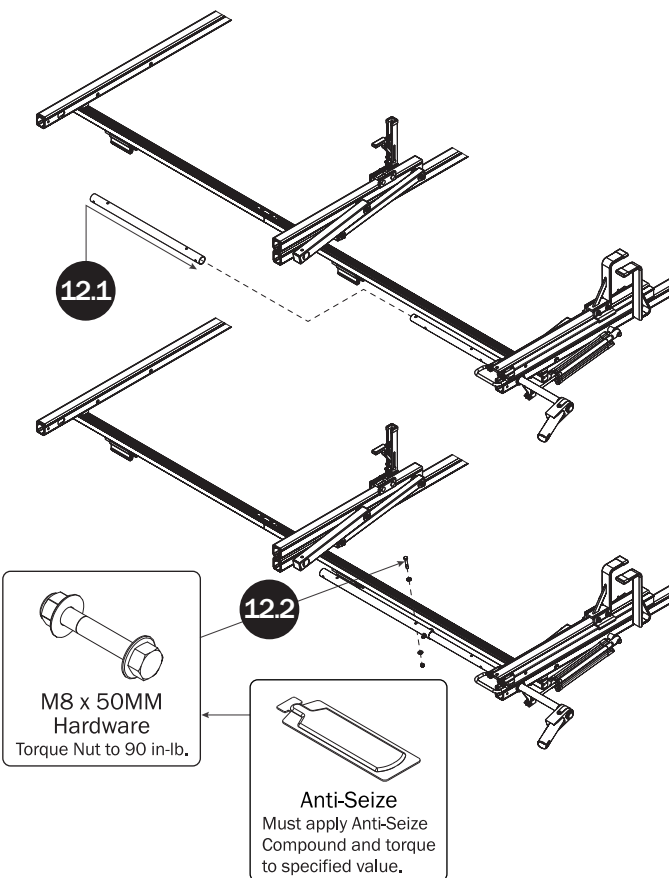
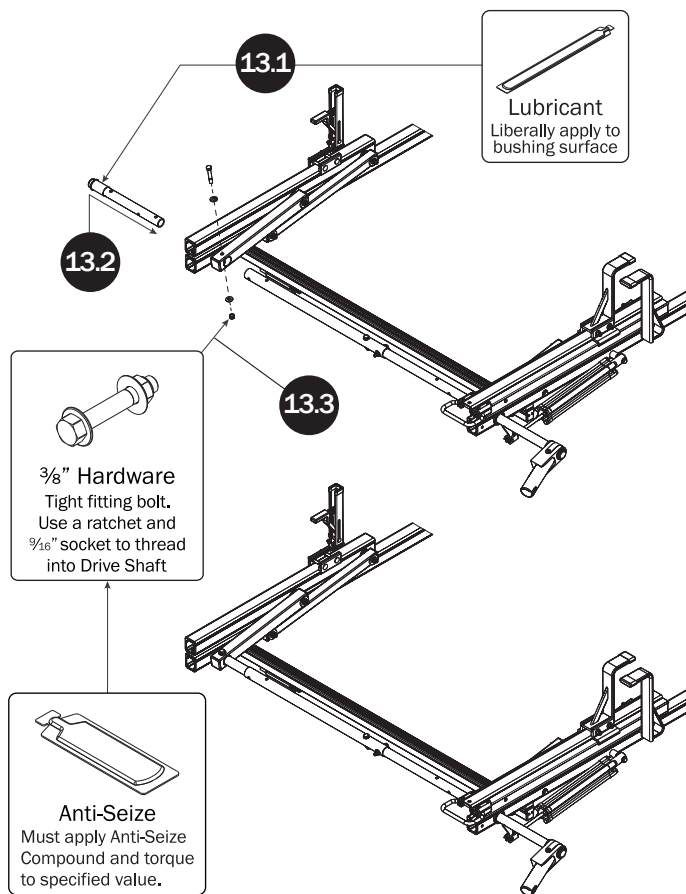
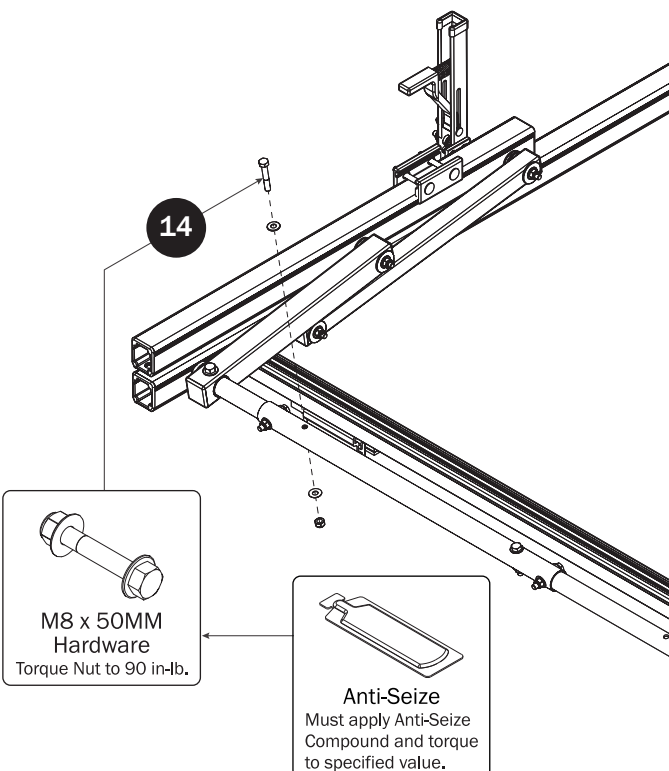
CONNECTING BAR**FRONT DRIVE SHAFT****CONNECTING BAR FASTENERS****Z POSTS**

SEE QUICK START GUIDE FOR ADJUSTMENTS

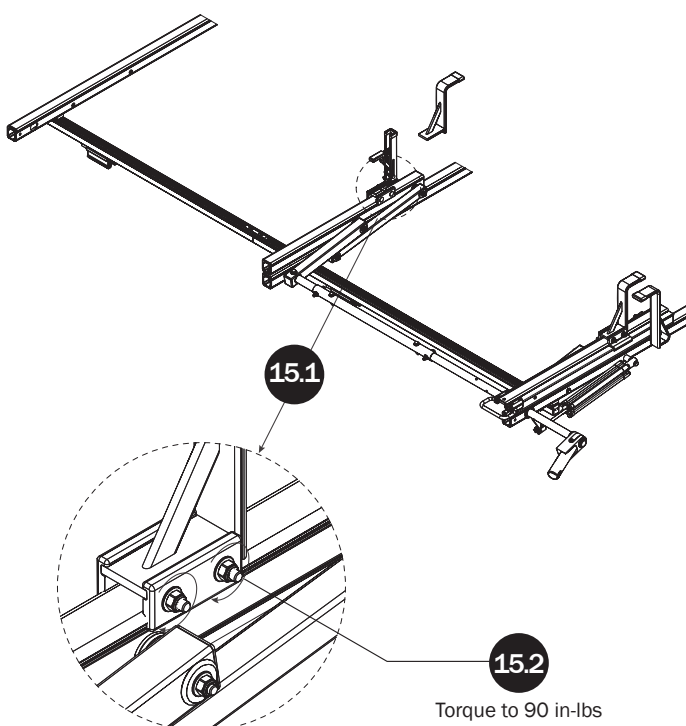

SEE QUICK START GUIDE FOR ADJUSTMENTS

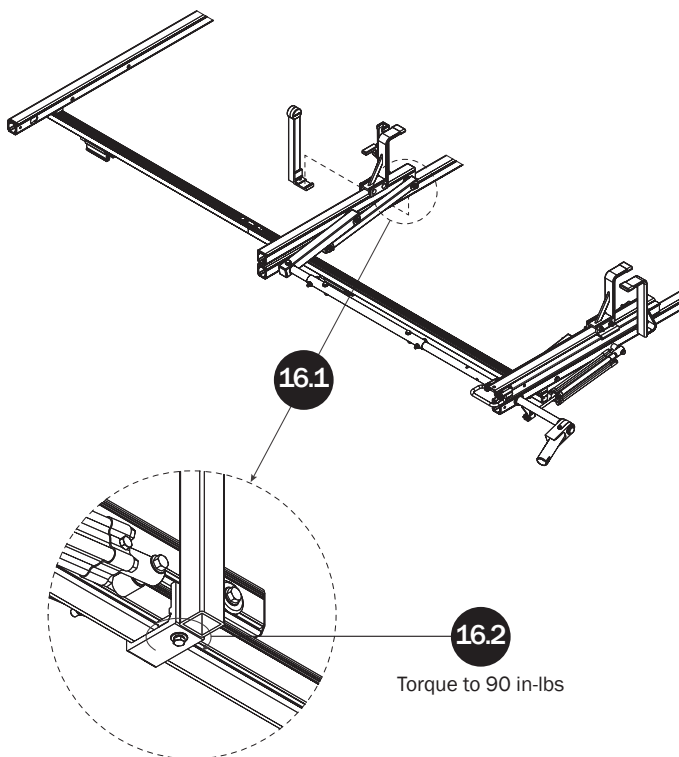

Adjust the Cylinder Flow Control Screw to allow approximately 3 seconds time for the ladder to glide down when operating the loaded Ladder Rack.

17

The diagram illustrates the assembly of the 1800 Series Sliding Glass Door. It shows a perspective view of the door frame with two main tracks. Callout 18.1 points to the application of 'Sealing Stickers' to the inner track. Callout 18.2 points to the application of 'Silicone Sealant to Connecting Bar ends' at the junctions of the connecting bars. Detailed insets for 18.1 and 18.2 show the specific application points and the components involved.

