

PRIME DESIGN™

A Safe Fleet Brand

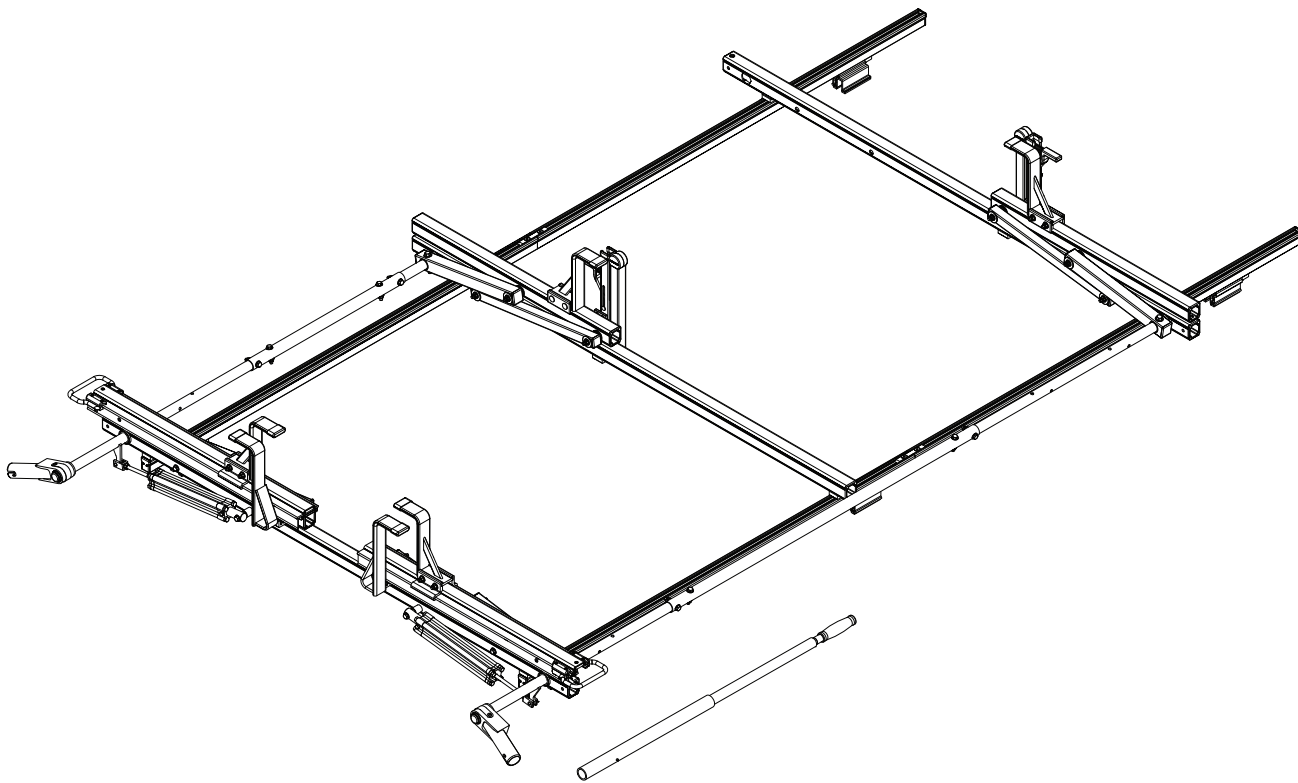

VR3-E

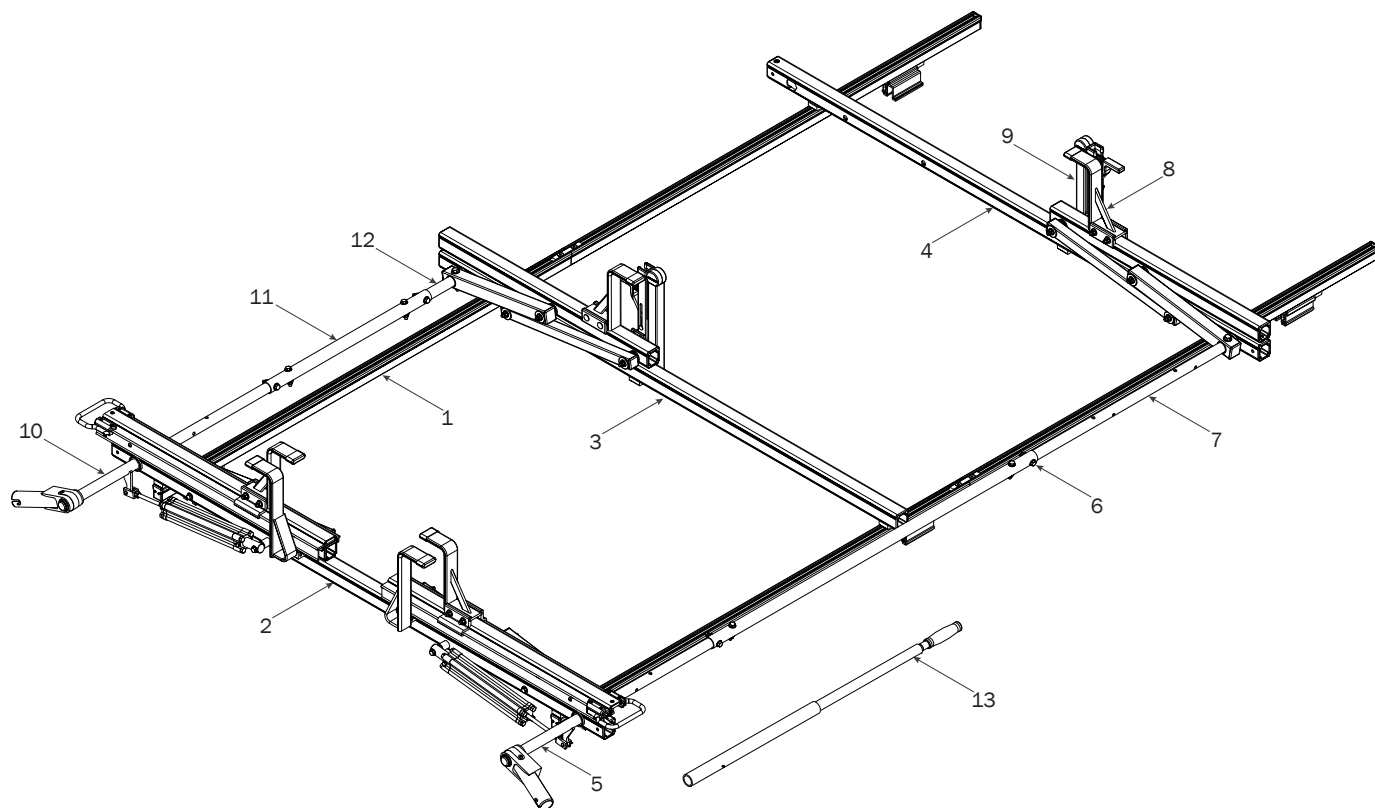

1—FBM3-0020 (Qty 1)
Channels w/Hardware



60" Channels (4X)



End Caps (4X)



Screws (8X)



Top Connector (2X)



Bottom Connector (2X)



Brackets (6X)



Mountings (6X)

M8 Bolt (4X)

2—Rear Crossbar Assembly (Qty 1)

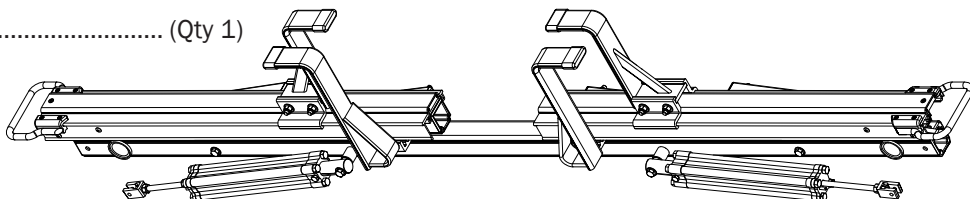

3—Center Crossbar Assembly (Qty 1)

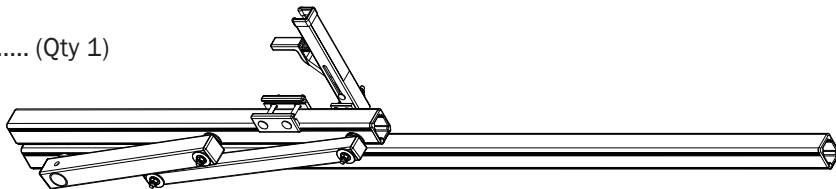

4—Front Crossbar Assembly (Qty 1)

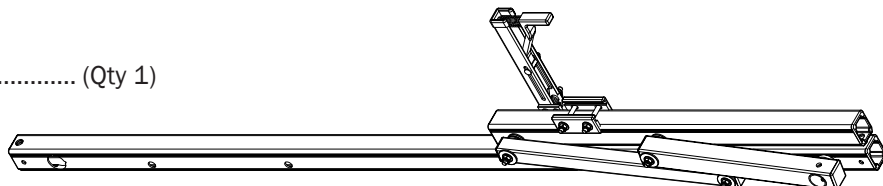

5—Drive Shaft..... (Qty 1)
Rear, Right Hand, 34.00"

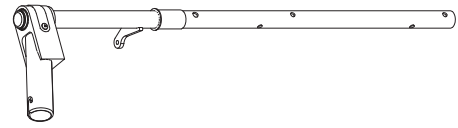

6—Connecting Bar..... (Qty 2)
48.00"

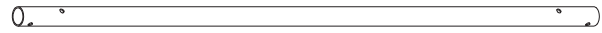

7—Front Drive Shaft..... (Qty 2)
B Version, 35.75"

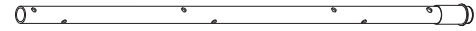

8—Z Post..... (Qty 2)
Adjustable, 7.25"

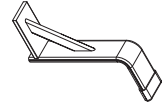

9—L Post..... (Qty 2)
US3, Square Cap, 11.25"



10—Drive Shaft..... (Qty 1)
Rear, Left Hand, 34.00"

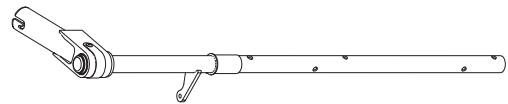

11—Connecting Bar..... (Qty 1)
24.00"

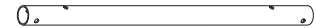

12—Front Drive Shaft..... (Qty 1)
B Version, 11.75"



13—Removeable Handle..... (Qty 1)



HKT-8163 Rotation Hardware Kit



Cotter Pin (2X)

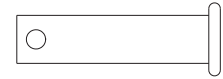

Clevis Pin (2X)

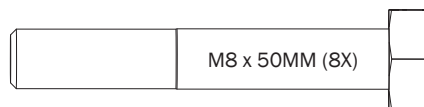

M8 x 50MM (8X)

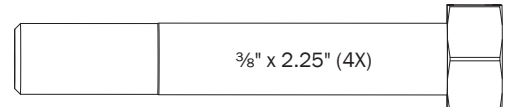

3/8" x 2.25" (4X)

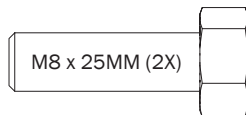

M8 x 25MM (2X)

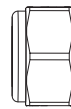

M8 Lock Nut (10X)



3/8" Lock Nut (4X)

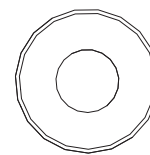

5/16" Flat Washer (20X)

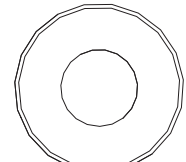

3/8" Flat Washer (8X)

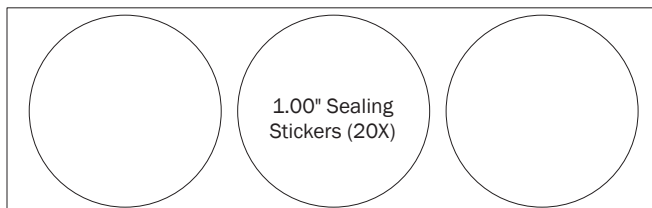

1.00" Sealing
Stickers (20X)



Anti-Seize (2X)

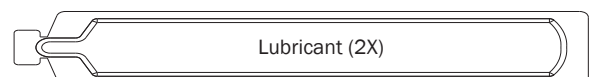

Lubricant (2X)

FBM3-0020 MOUNTING BRACKETS

INSTALLER NOTE: Mounting Brackets must be disassembled for installation onto the vehicle's roof.

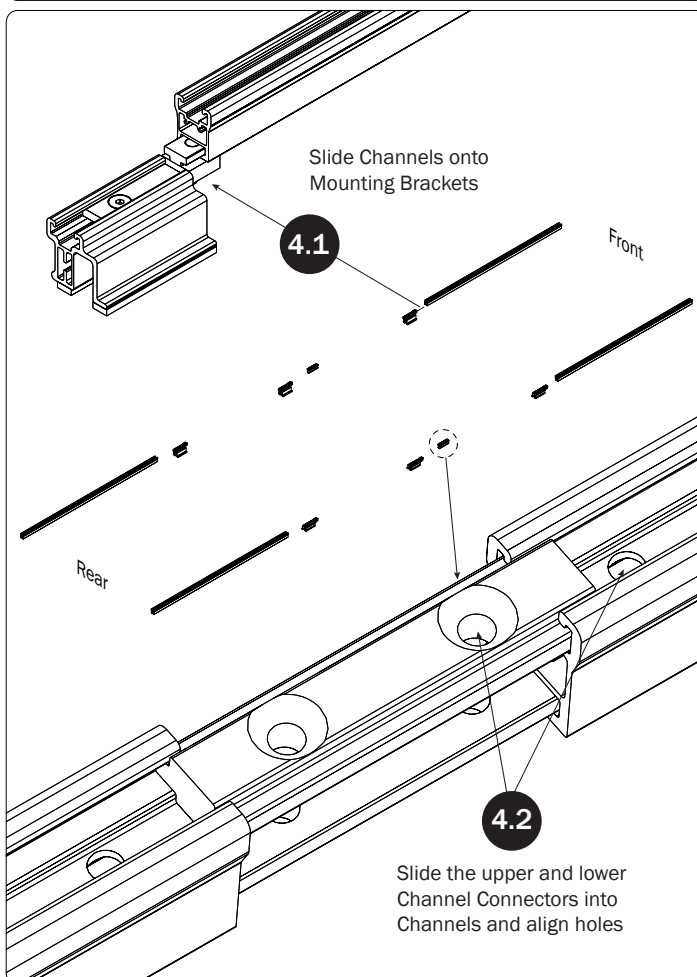
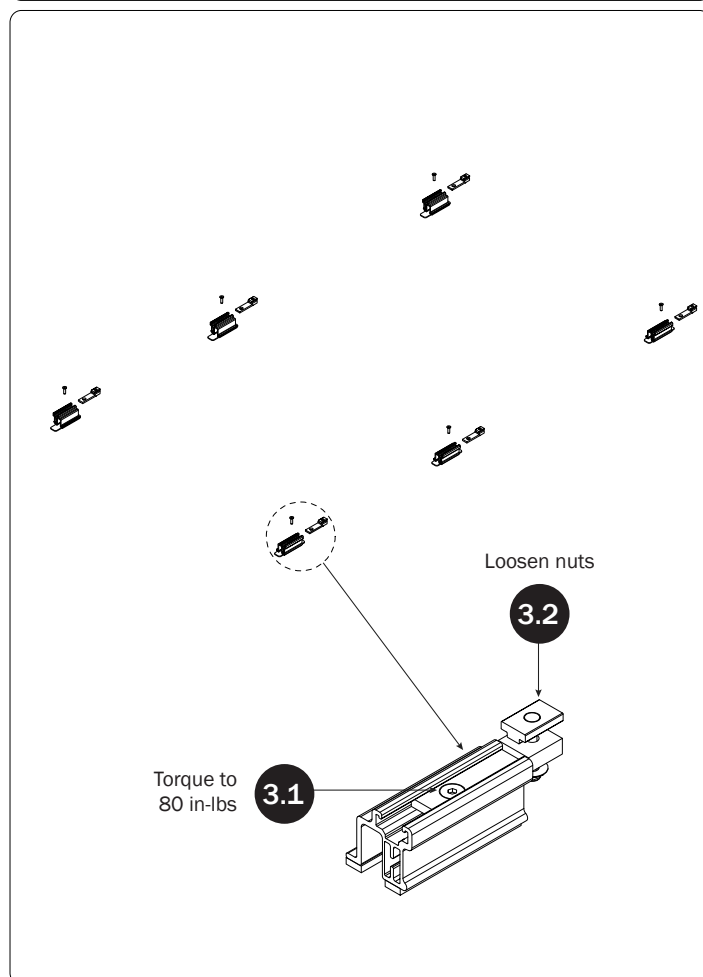
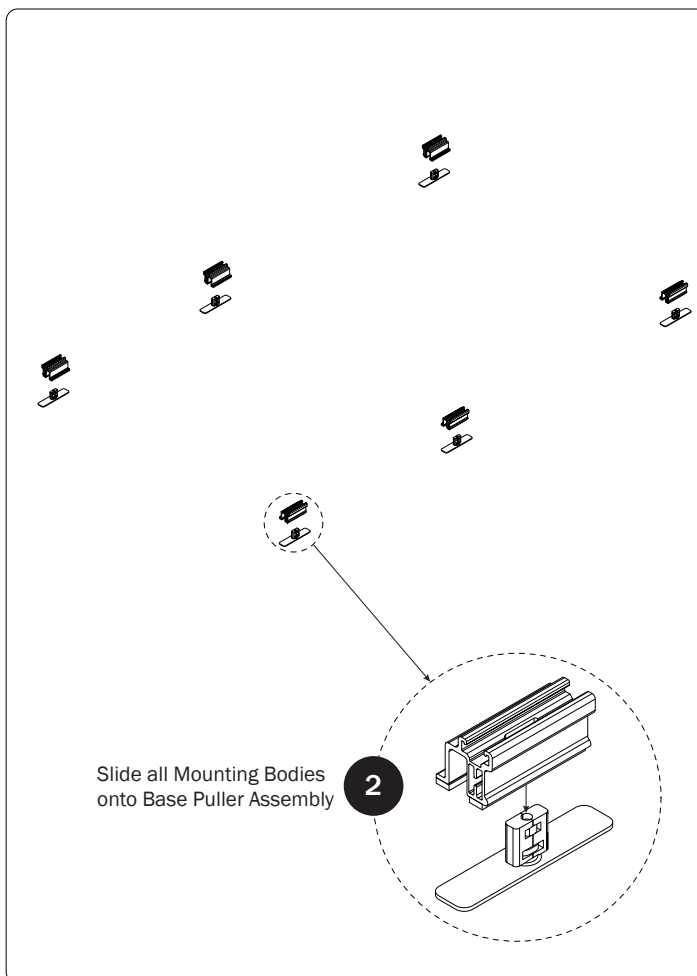
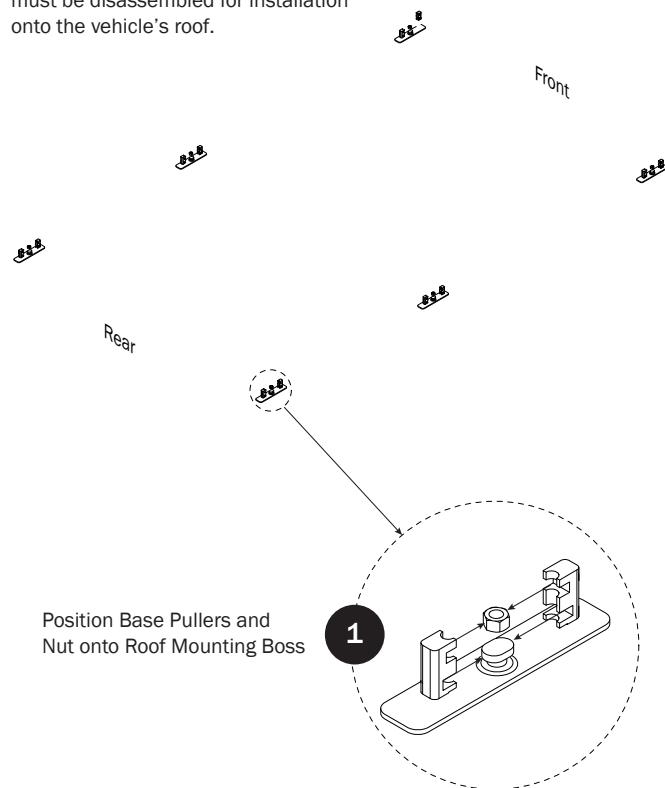

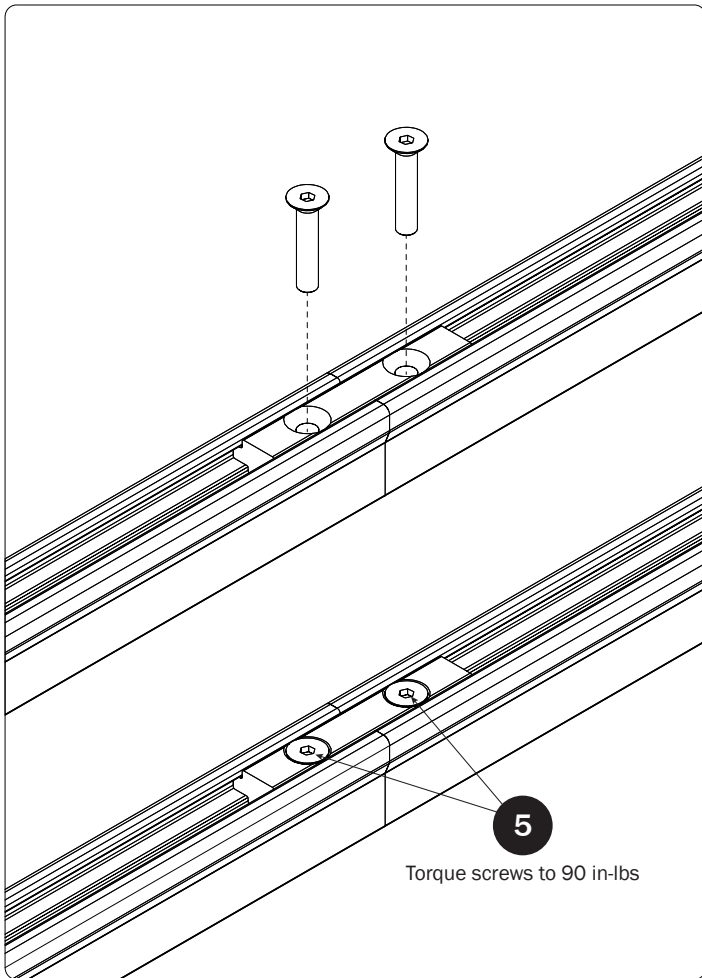

6 Set to distances then torque Mounting Bracket nuts to 80 in-lbs

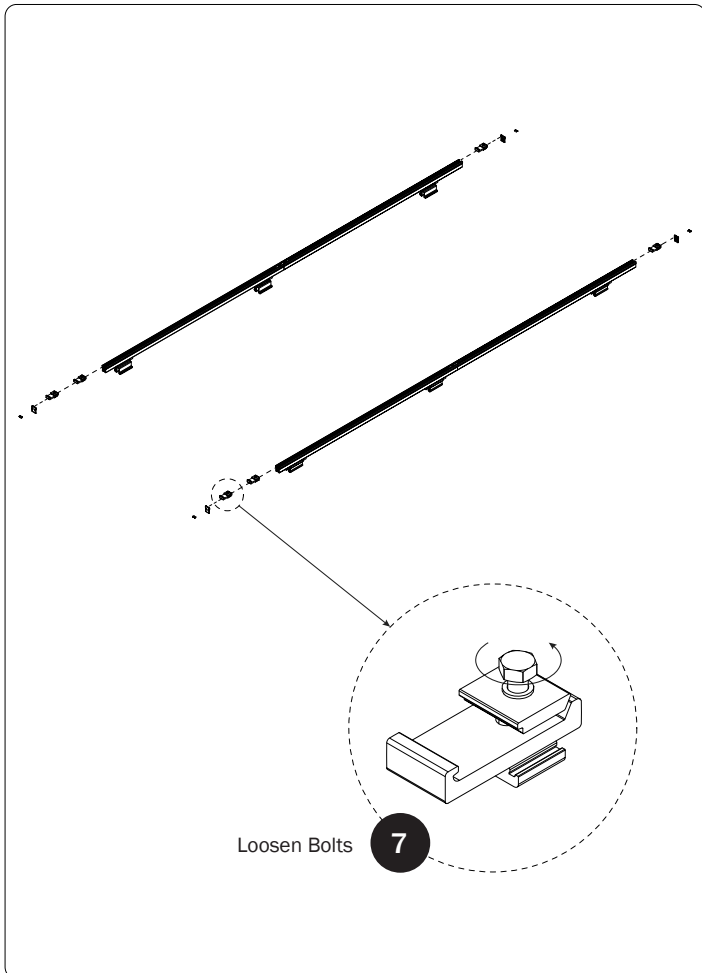
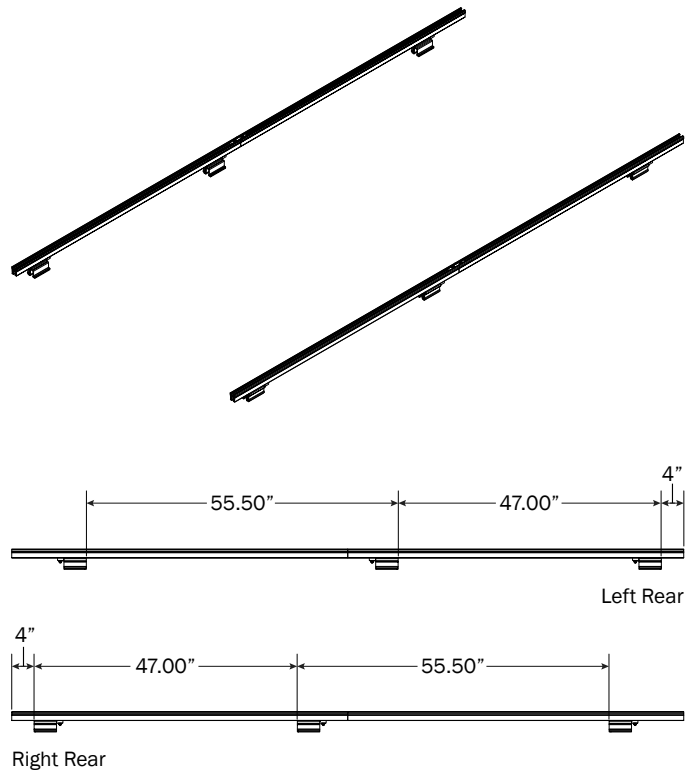

8 Set to distances shown, but do not tighten at this time

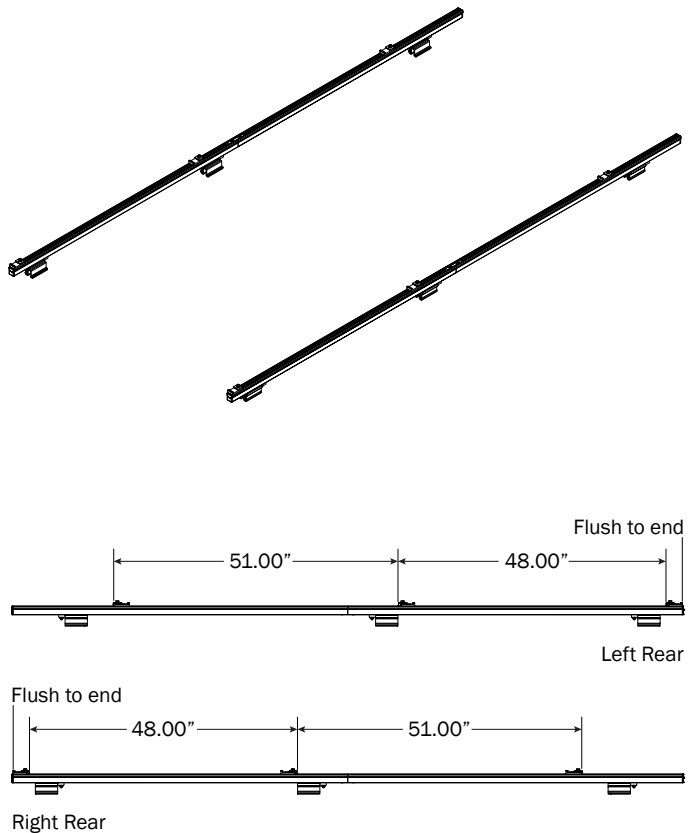

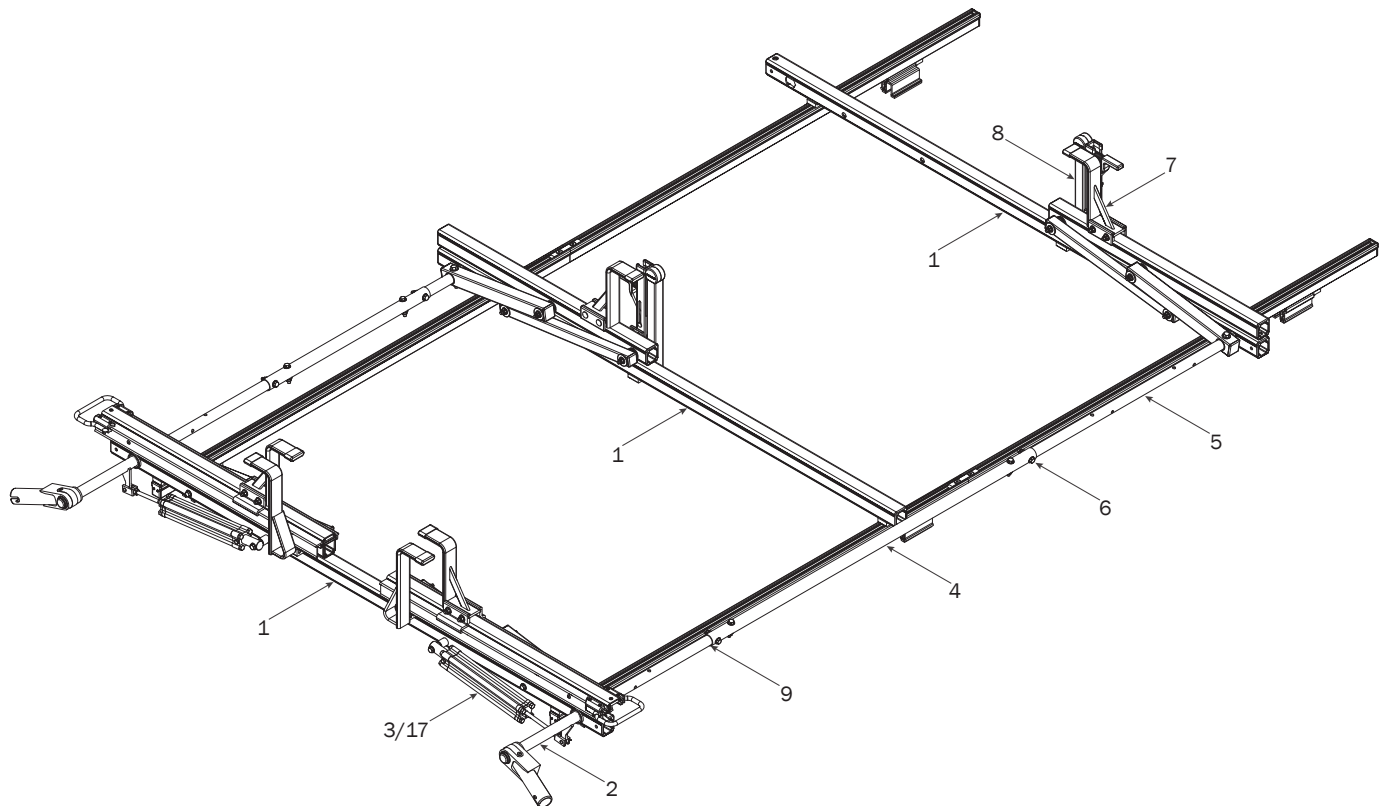
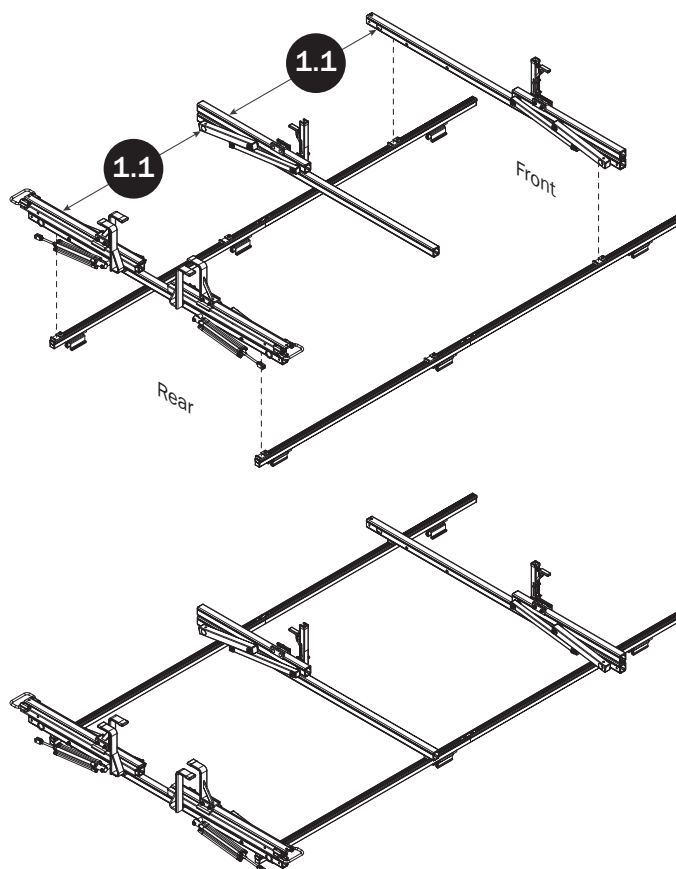
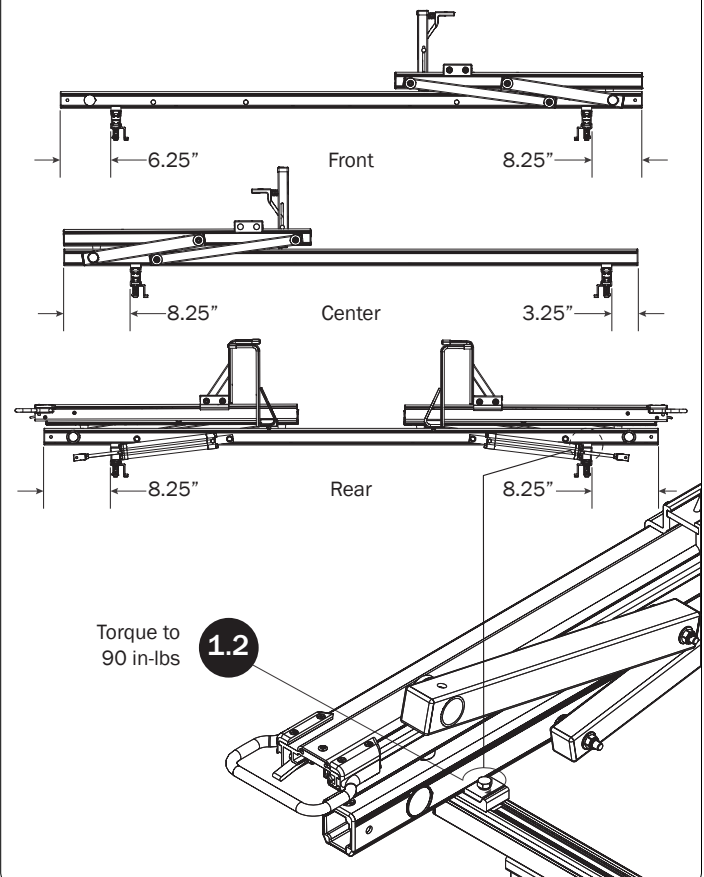
RIGHT ROTATION ASSEMBLY**CROSSBARS****CROSSBAR ADJUSTMENT**

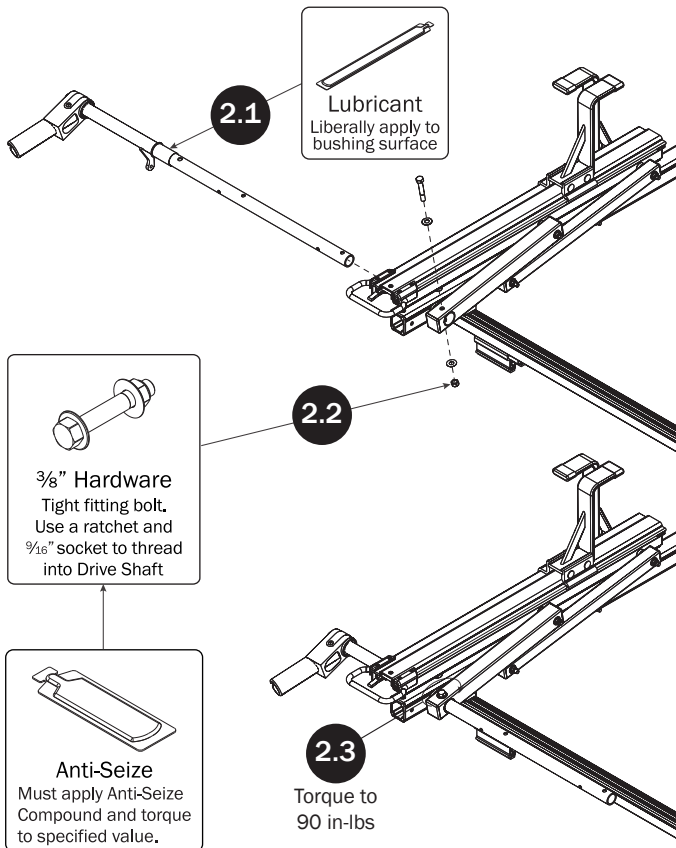
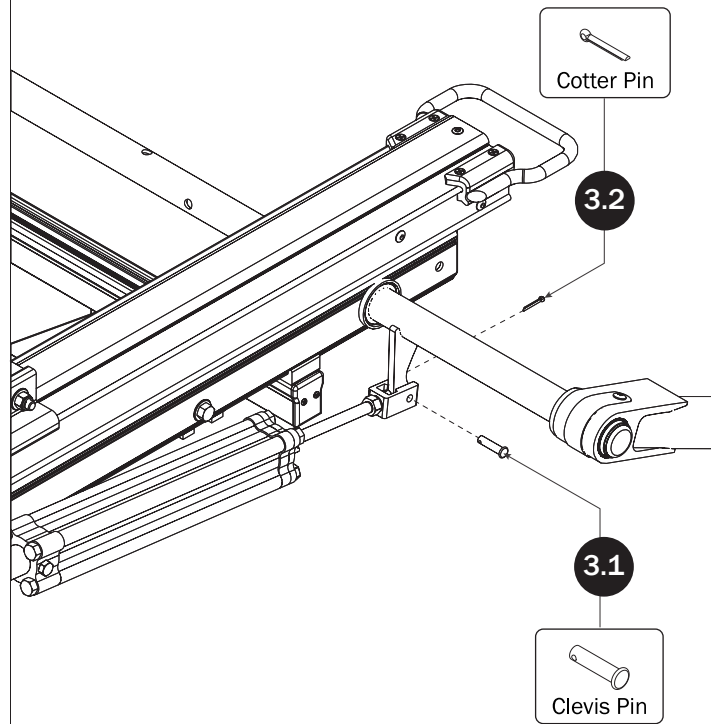
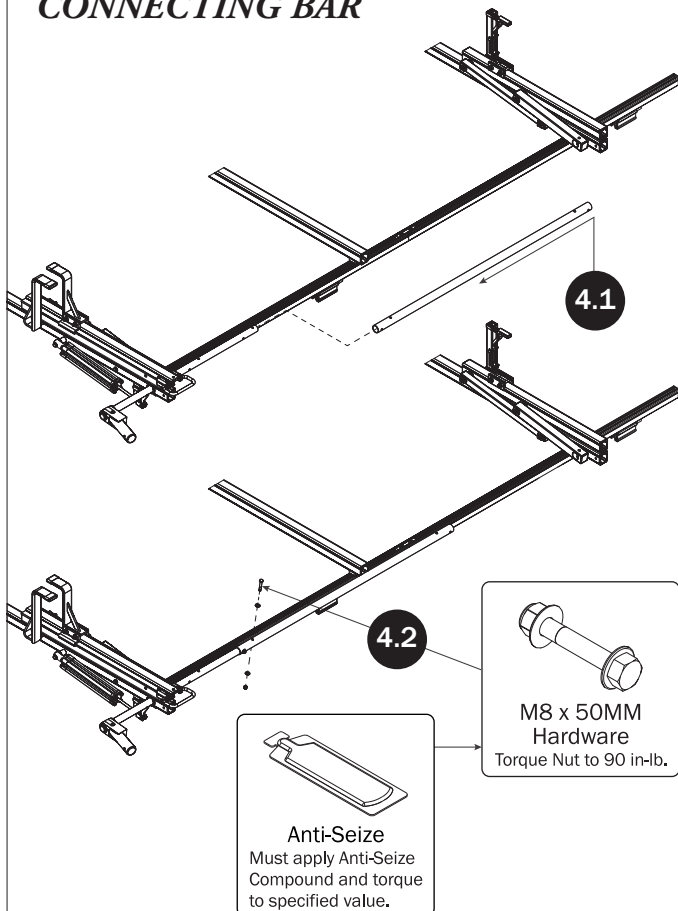
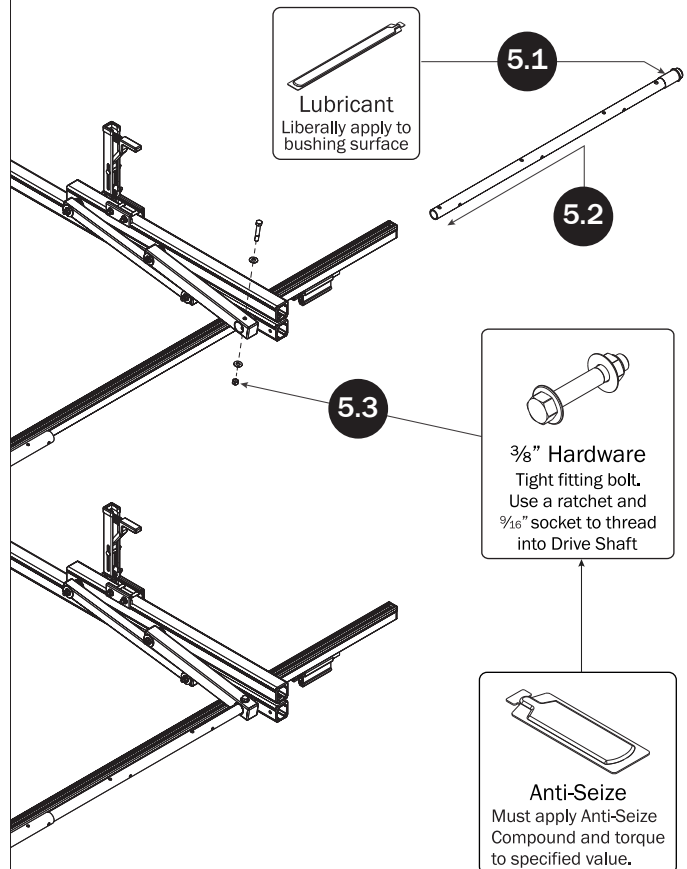
REAR DRIVE SHAFT**CYLINDER HARDWARE****CONNECTING BAR****FRONT DRIVE SHAFT**

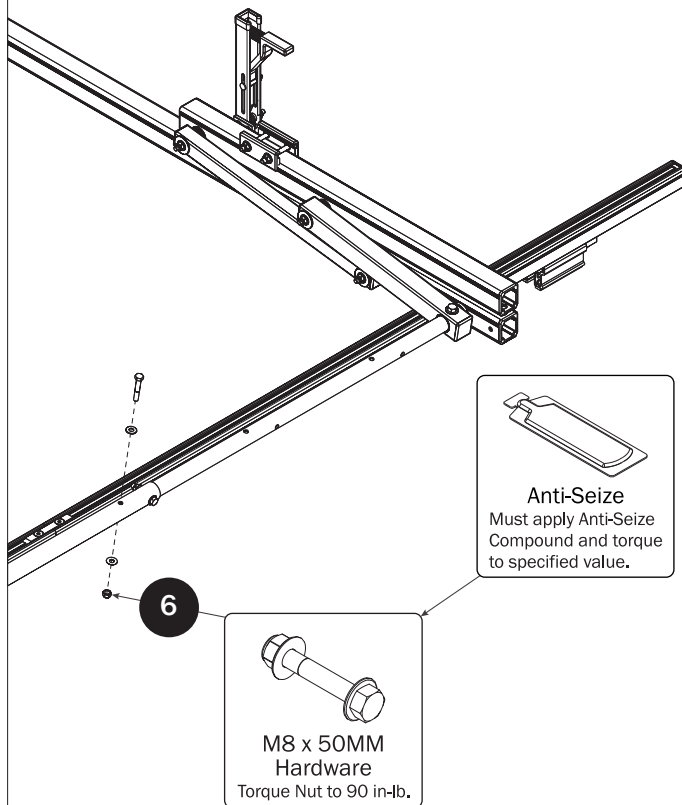
CONNECTING BAR FASTENERS**Z POSTS**

SEE QUICK START GUIDE FOR ADJUSTMENTS

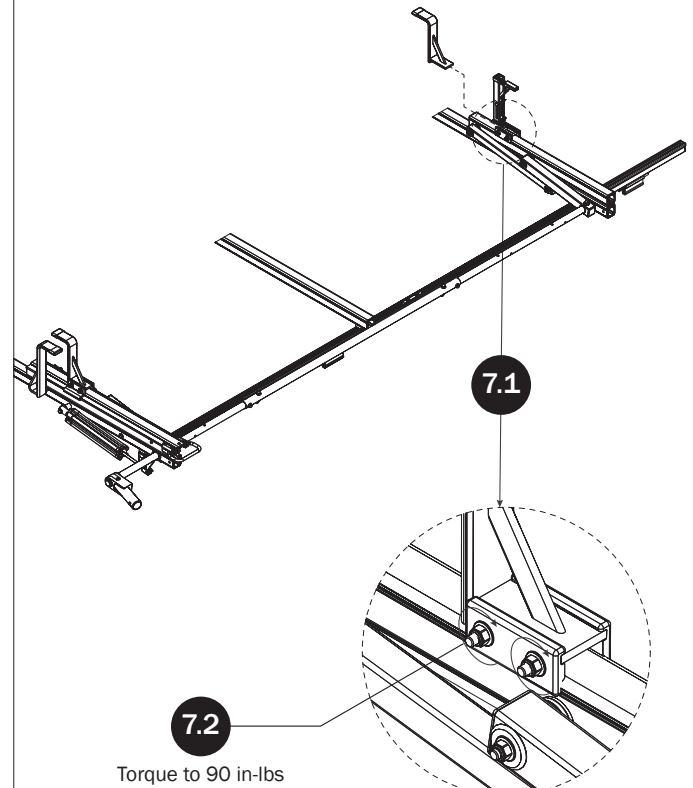
**L POSTS**

SEE QUICK START GUIDE FOR ADJUSTMENTS

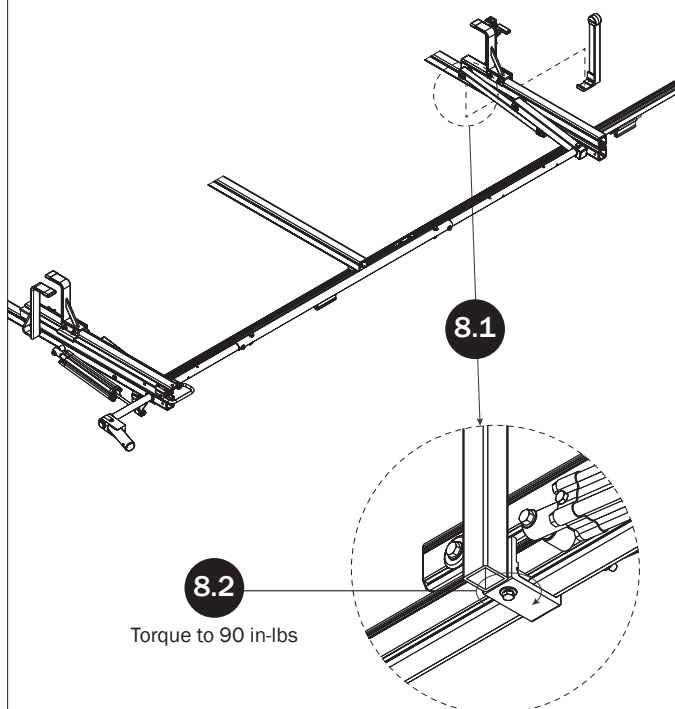
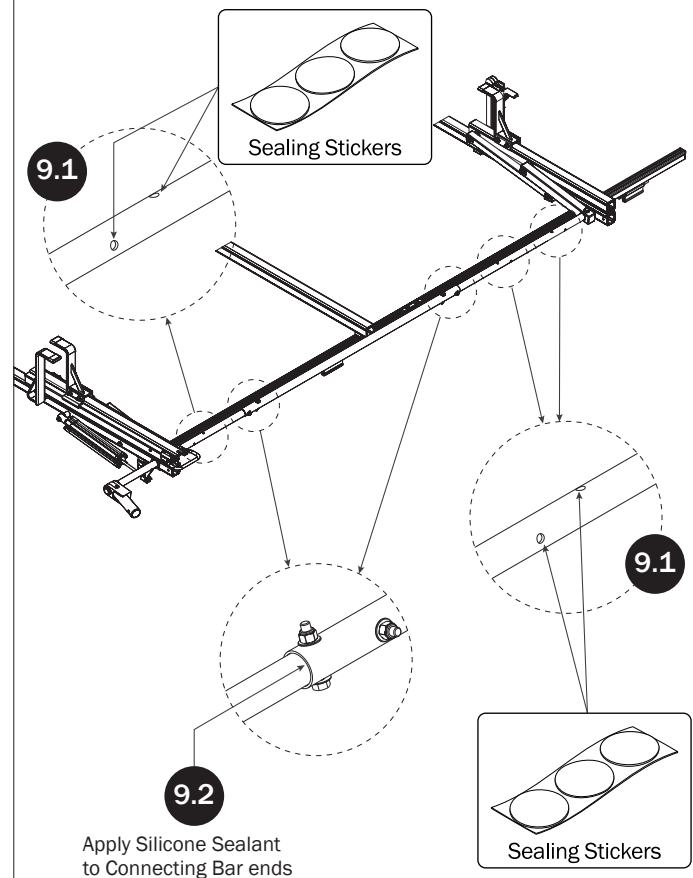
**DRIVE SHAFT SEALING**

LEFT ROTATION ASSEMBLY

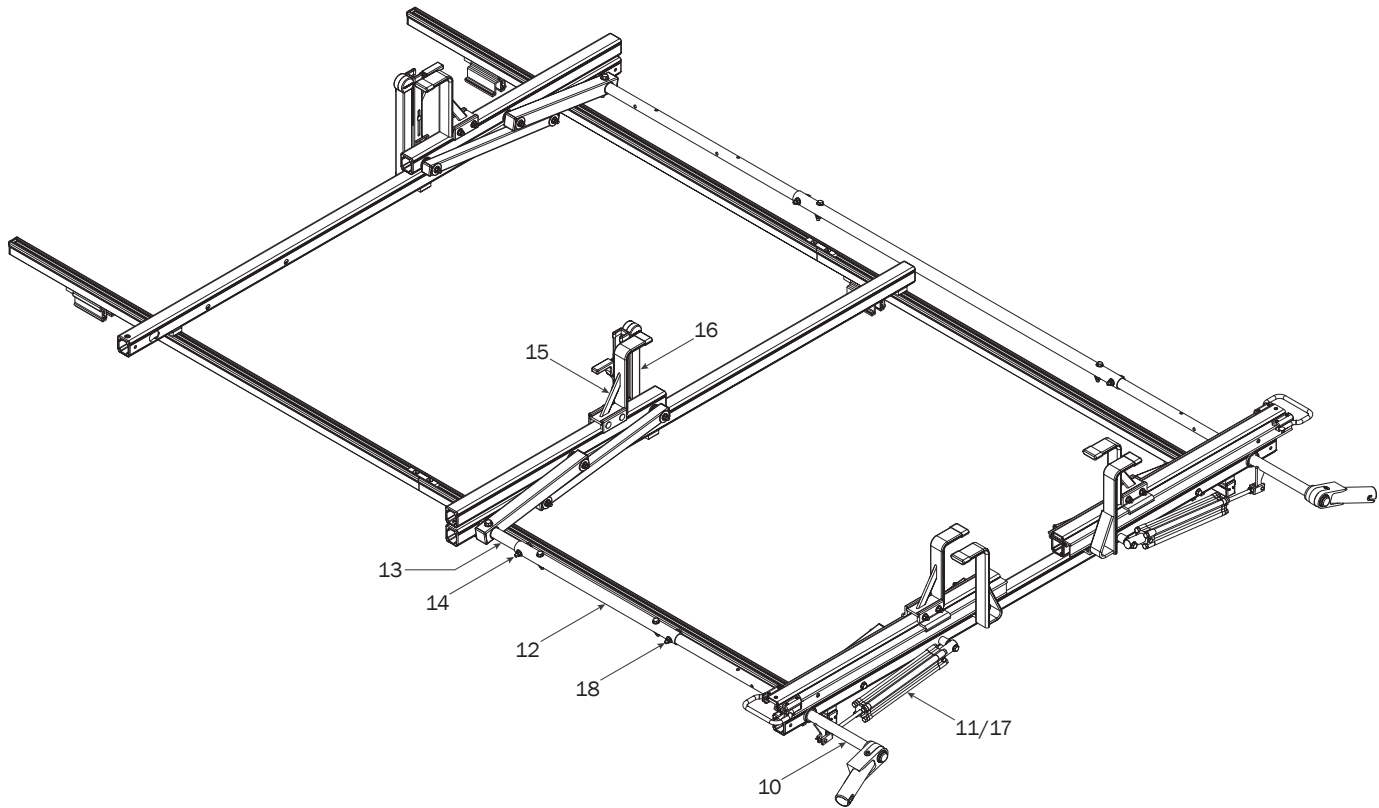

REAR DRIVE SHAFT

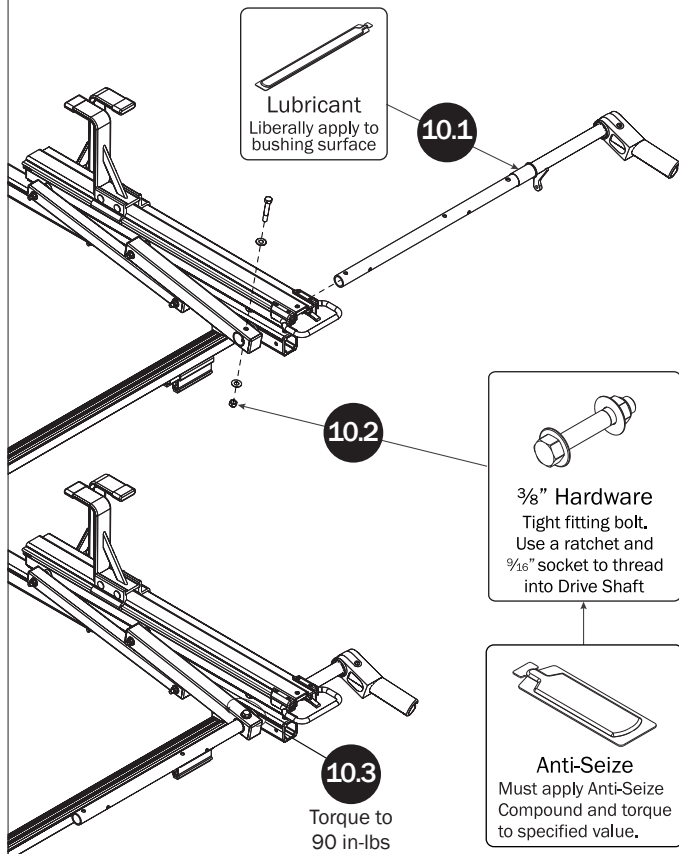

CYLINDER HARDWARE

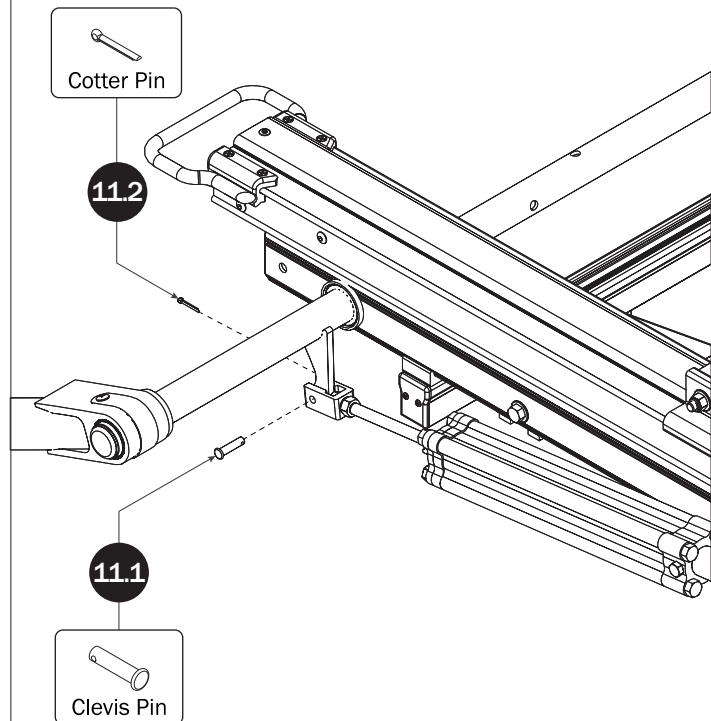

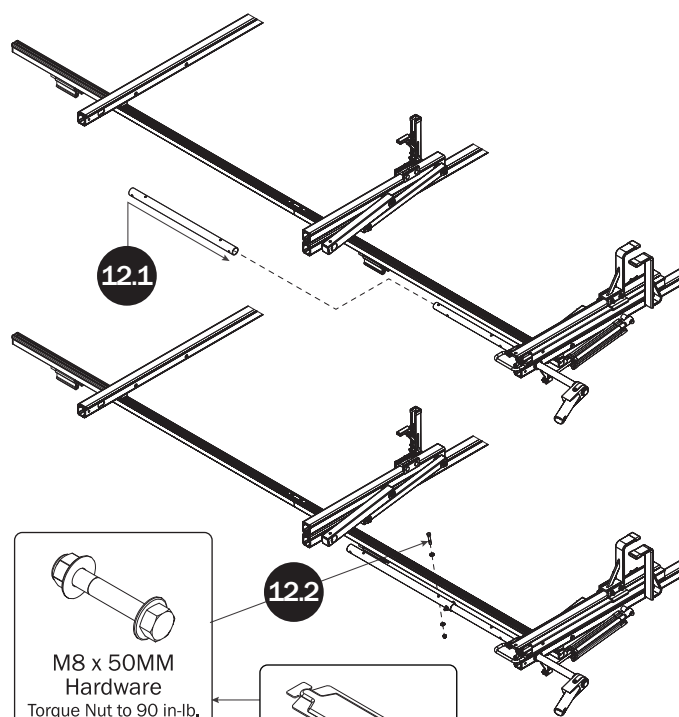
CONNECTING BAR

M8 x 50MM Hardware
Torque Nut to 90 in-lb.

Anti-Seize
Must apply Anti-Seize Compound and torque to specified value.

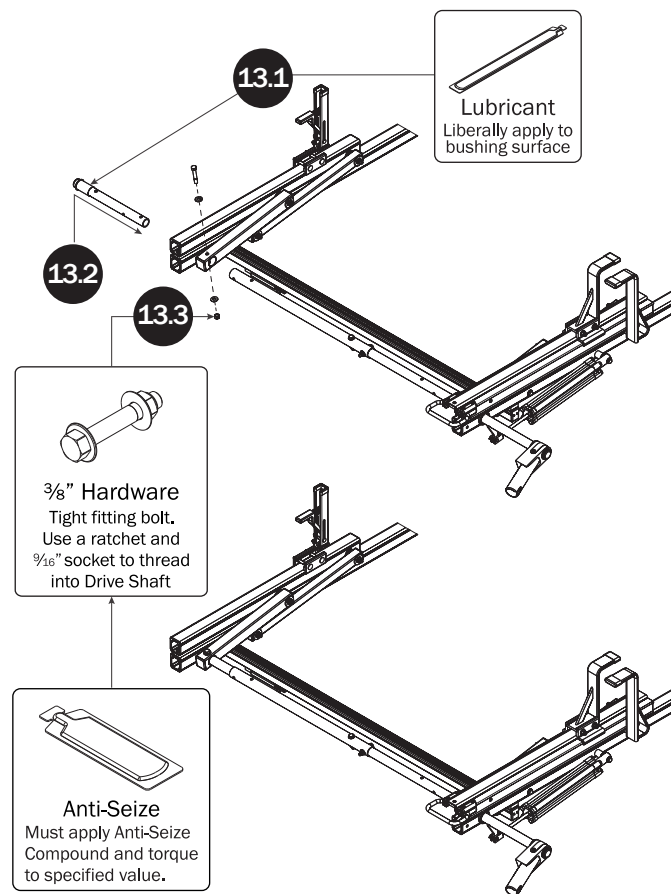
FRONT DRIVE SHAFT

Lubricant
Liberal apply to bushing surface

3/8" Hardware
Tight fitting bolt. Use a ratchet and 3/16" socket to thread into Drive Shaft

Anti-Seize
Must apply Anti-Seize Compound and torque to specified value.

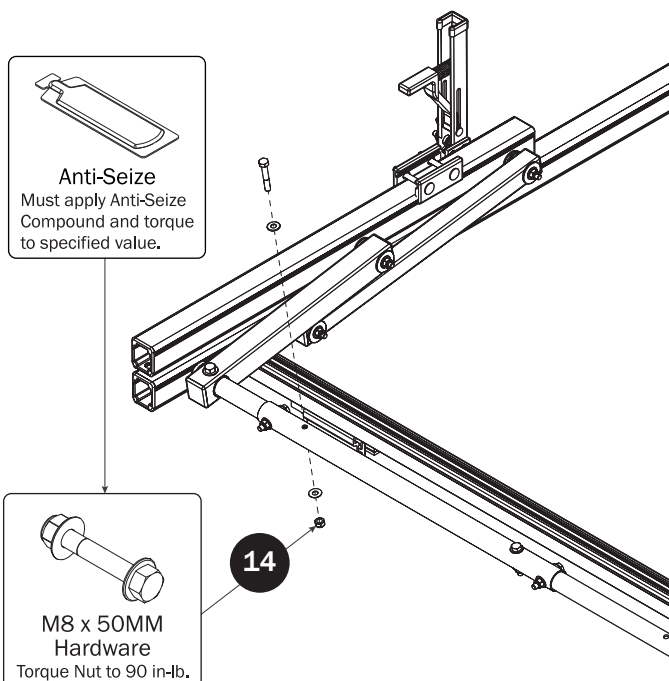
CONNECTING BAR FASTENERS

Anti-Seize
Must apply Anti-Seize Compound and torque to specified value.

M8 x 50MM Hardware
Torque Nut to 90 in-lb.

Z POSTS

SEE QUICK START GUIDE FOR ADJUSTMENTS

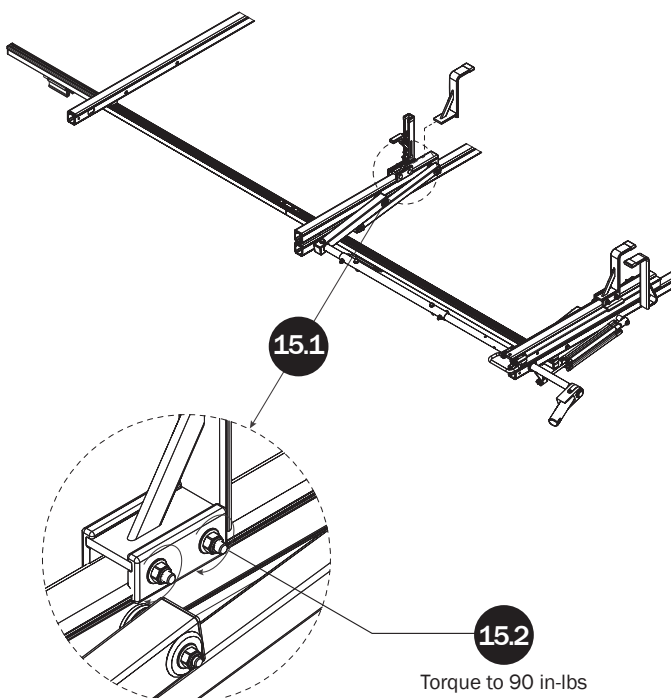

Torque to 90 in-lbs

L POSTS

SEE QUICK START GUIDE FOR ADJUSTMENTS

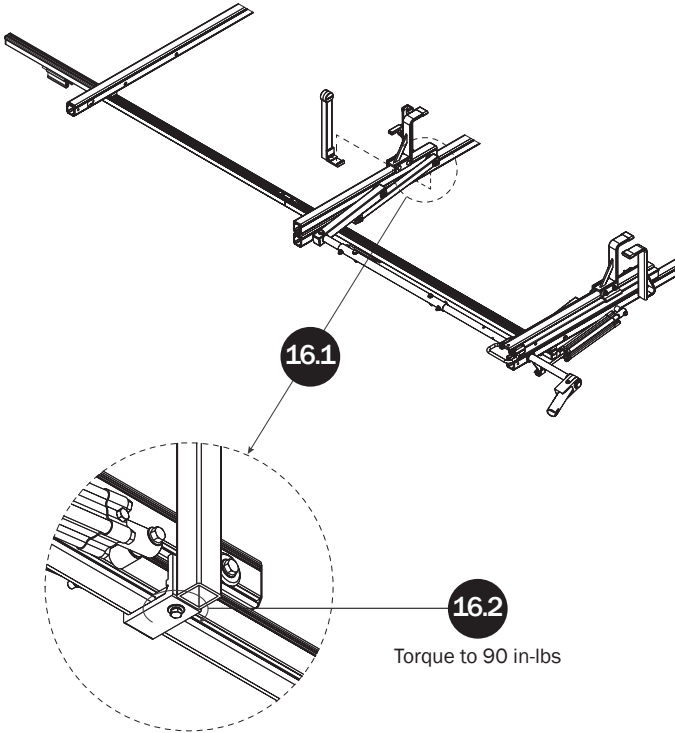

CYLINDER ADJUSTMENT

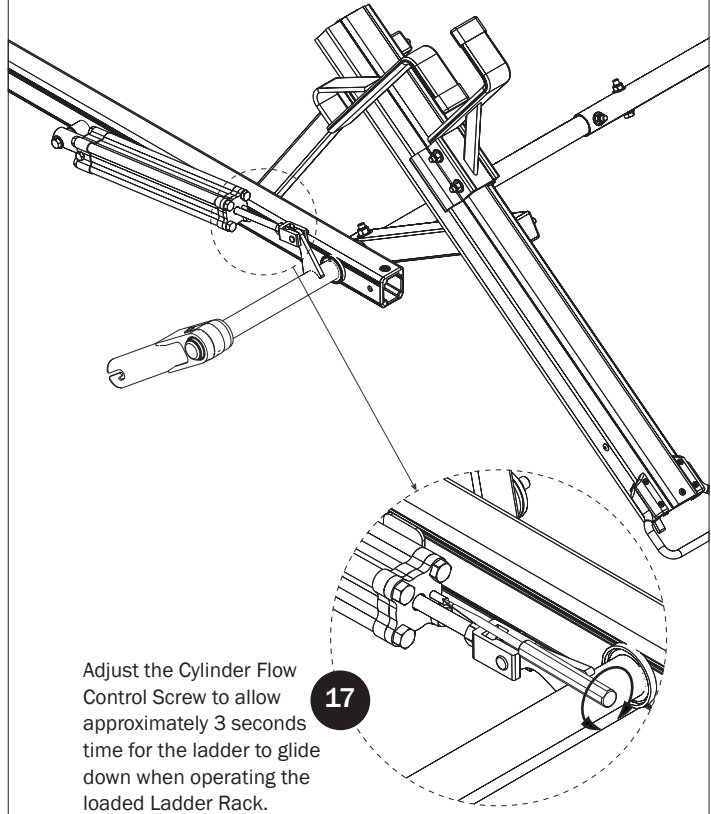

DRIVE SHAFT SEALING

