

PRIME DESIGN™

A Safe Fleet Brand

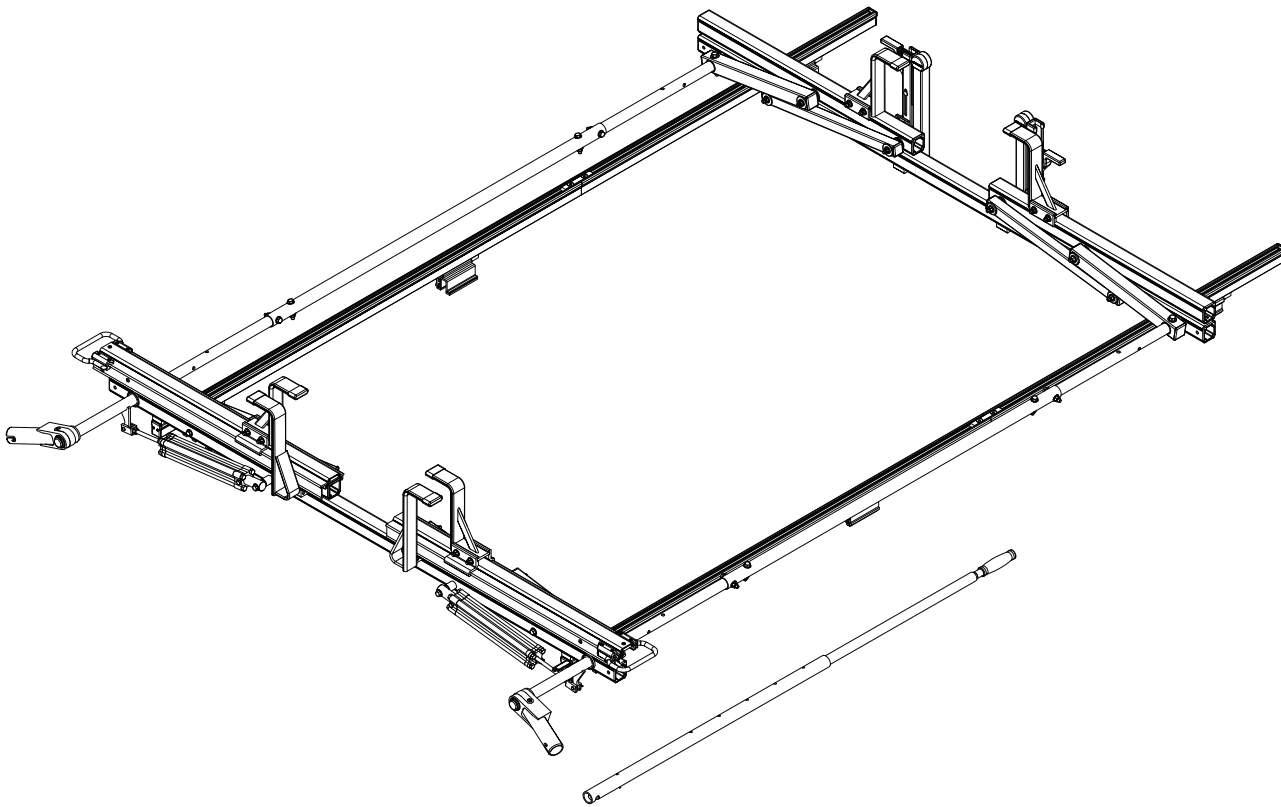

VRR-E

CONTENTS OVERVIEW

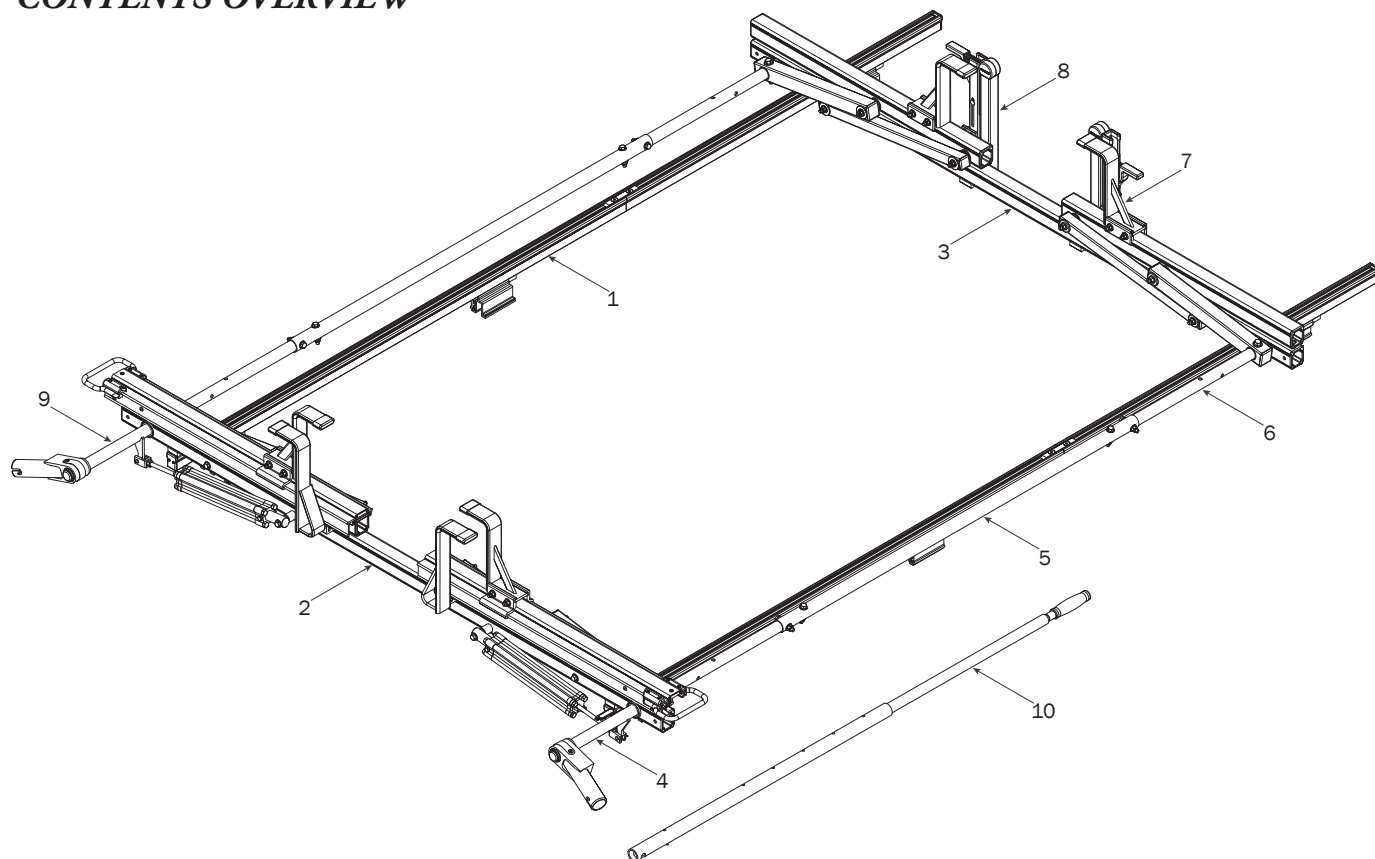

1—FBM-0012 (Qty 1)
Channels with Hardware



42" Channels (2X)



60" Channels (2X)



End Caps (4X)



Screws (8X)



Top Connector (2X)



Bottom Connector (2X)



Brackets (4X)

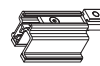

Mountings (6X)

M8 Bolt (4X)

2—Rear Crossbar Assembly (Qty 1)

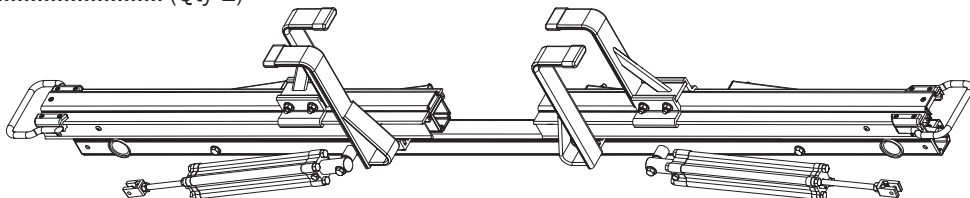

3—Front Crossbar Assembly (Qty 1)

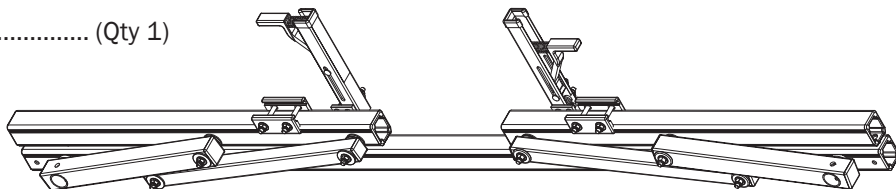

4—Drive Shaft..... (Qty 1)
Rear, Right Hand, 34.00"

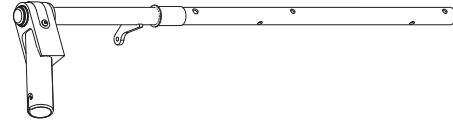

5—Connecting Bar..... (Qty 2)
48.00"



6—Front Drive Shaft..... (Qty 2)
B Version, 35.75"

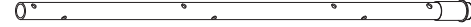

7—Z Post..... (Qty 2)
Adjustable, 7.25"

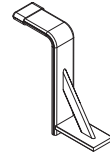

8—L Post..... (Qty 2)
US3, Square Cap, 11.25"

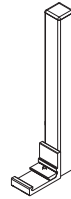

9—Drive Shaft..... (Qty 1)
Rear, Left Hand, 34.00"

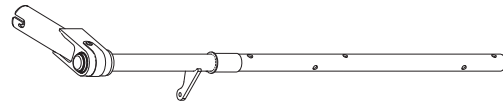

10—HRR Removeable Handle Assembly..... (Qty 1)

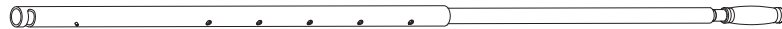

HKT-8163 Rotation Hardware Kit



Cotter Pin (2X)

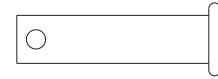

Clevis Pin (2X)

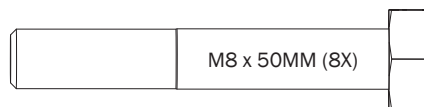

M8 x 50MM (8X)

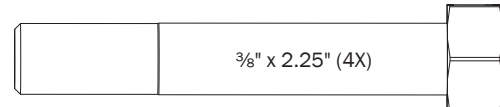

3/8" x 2.25" (4X)



M8 x 25MM (2X)

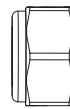

M8 Lock Nut (10X)



3/8" Lock Nut (4X)

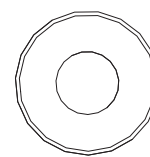

5/16" Flat Washer (20X)

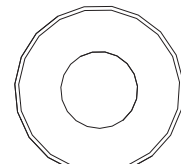

3/8" Flat Washer (8X)

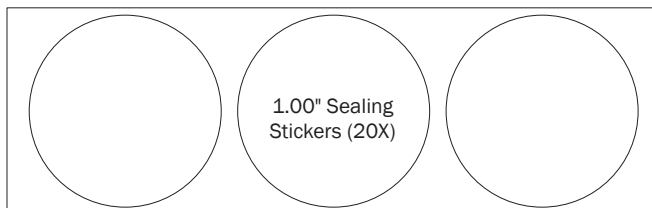

1.00" Sealing
Stickers (20X)



Anti-Seize (2X)

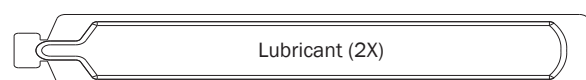

Lubricant (2X)

FBM-0012
MOUNTING BRACKETS

INSTALLER NOTE: Mounting Brackets must be disassembled for installation onto the vehicle's roof.

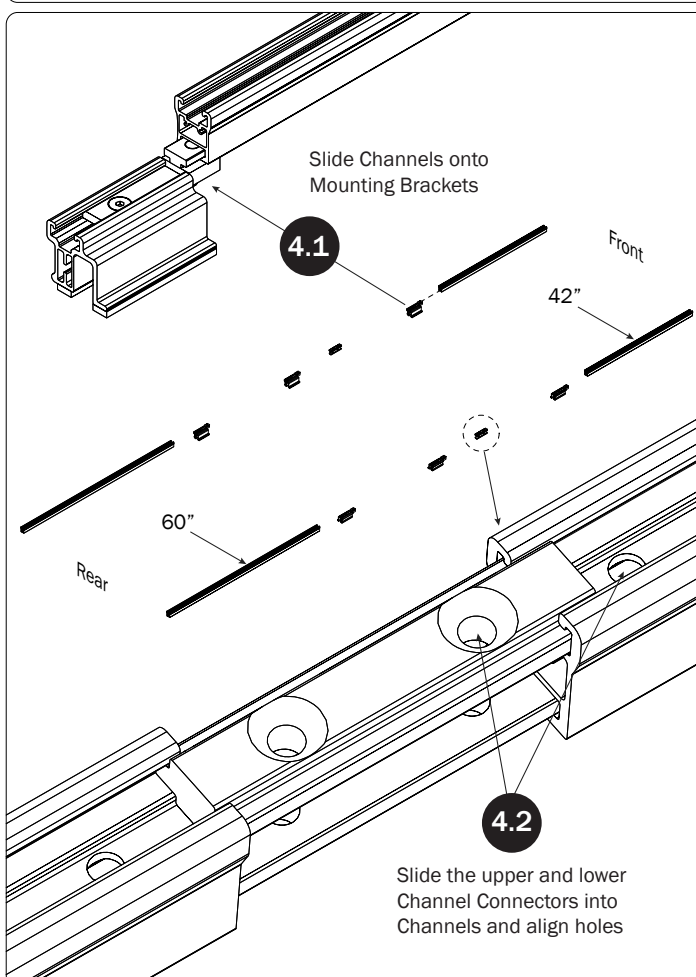
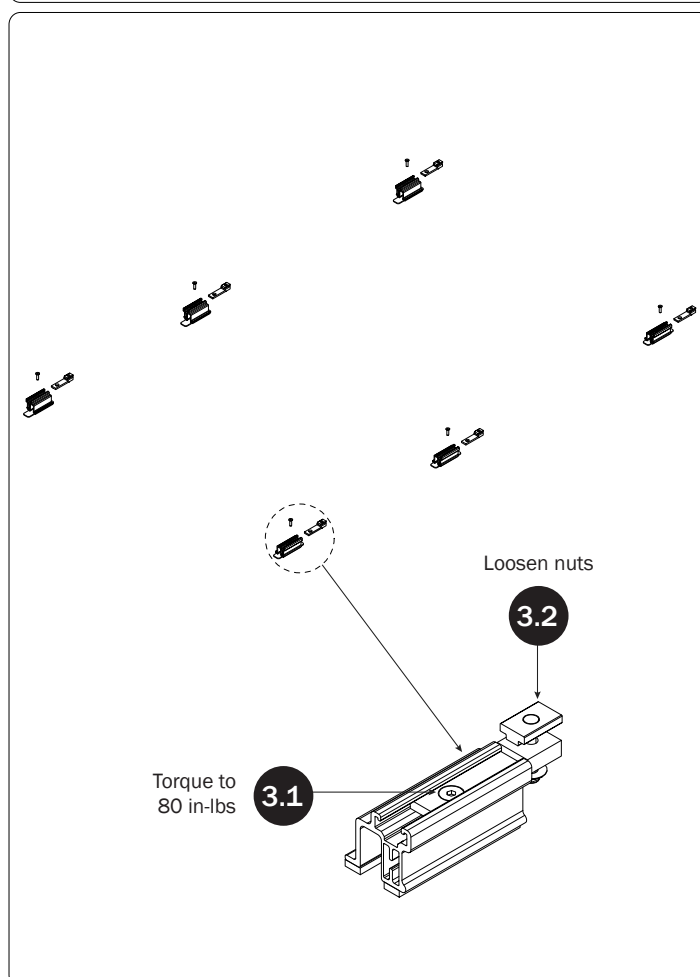
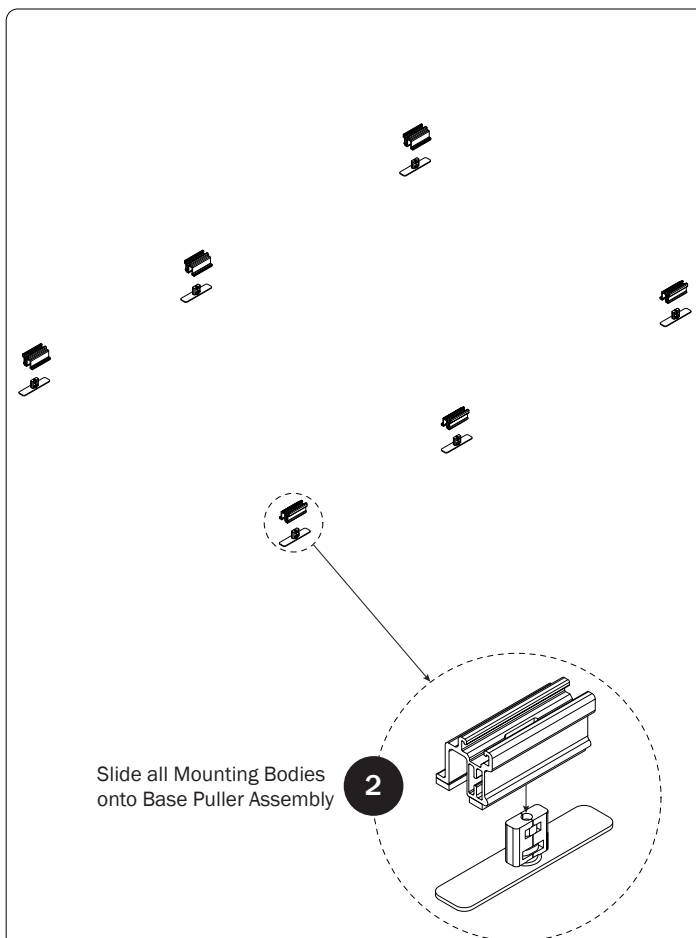
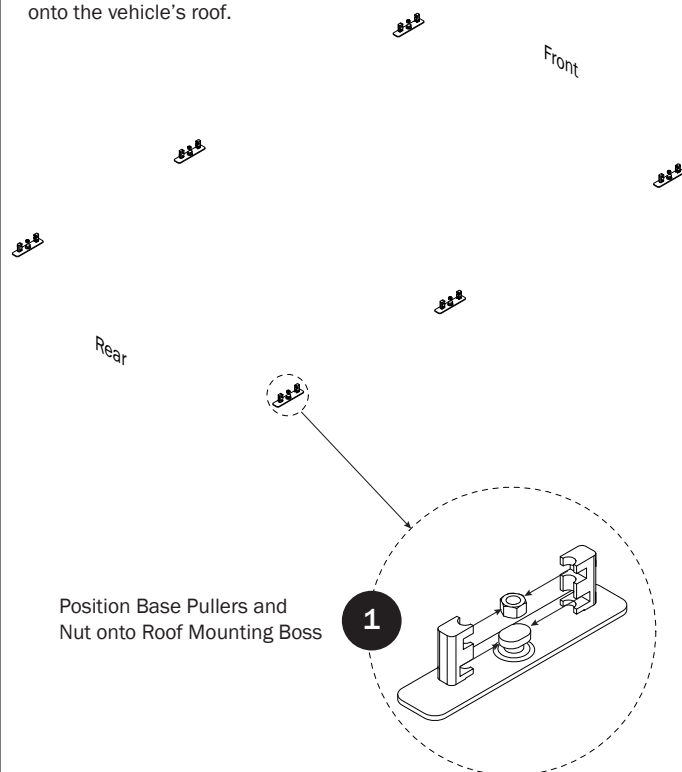

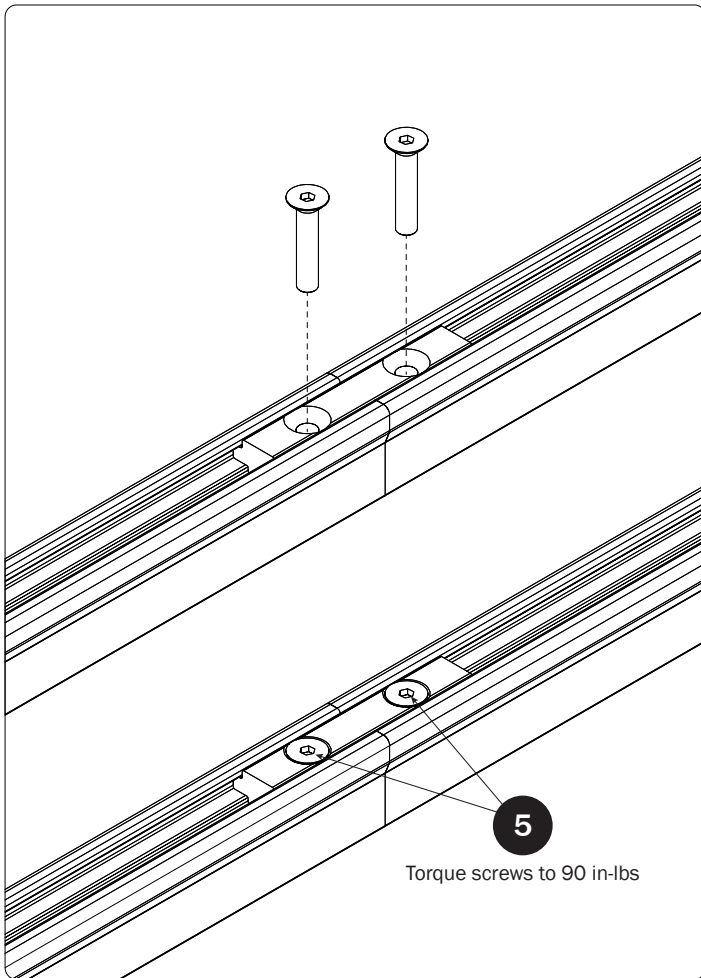

6 Set to distances then torque Mounting Bracket nuts to 80 in-lbs

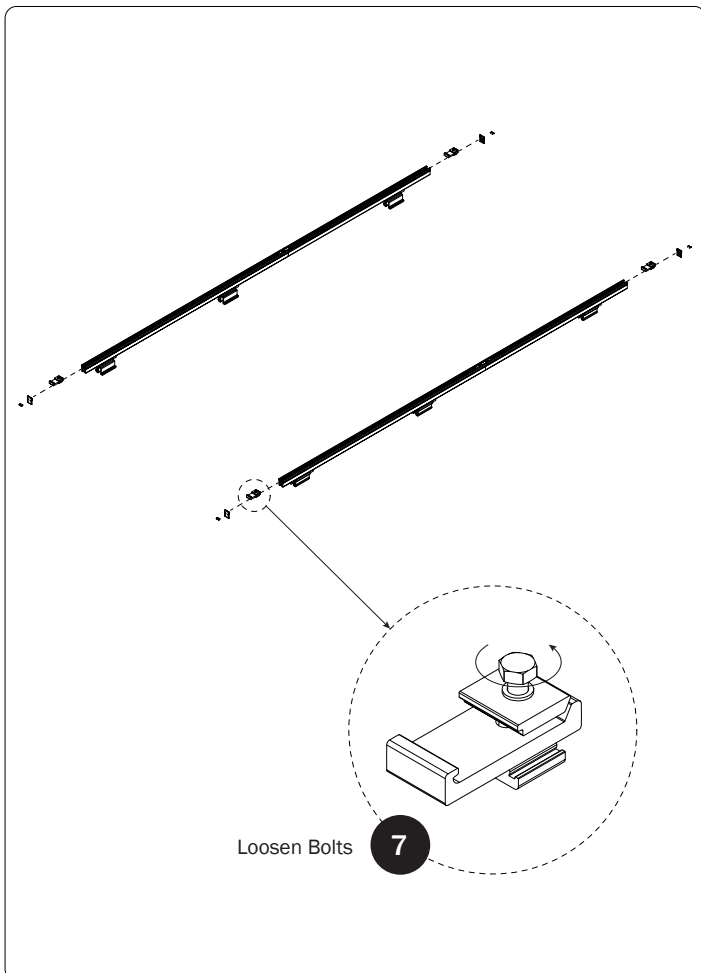
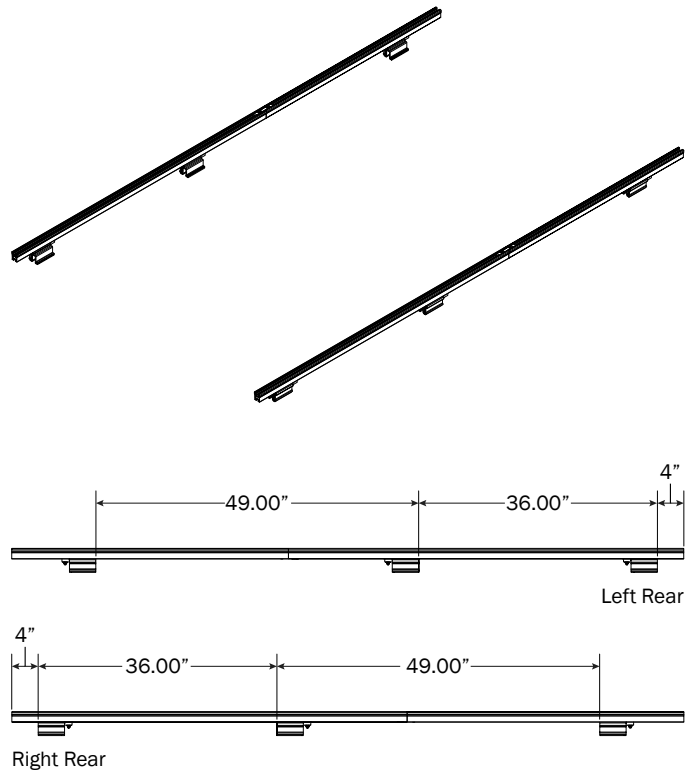

8 Set to distances shown, but do not tighten at this time

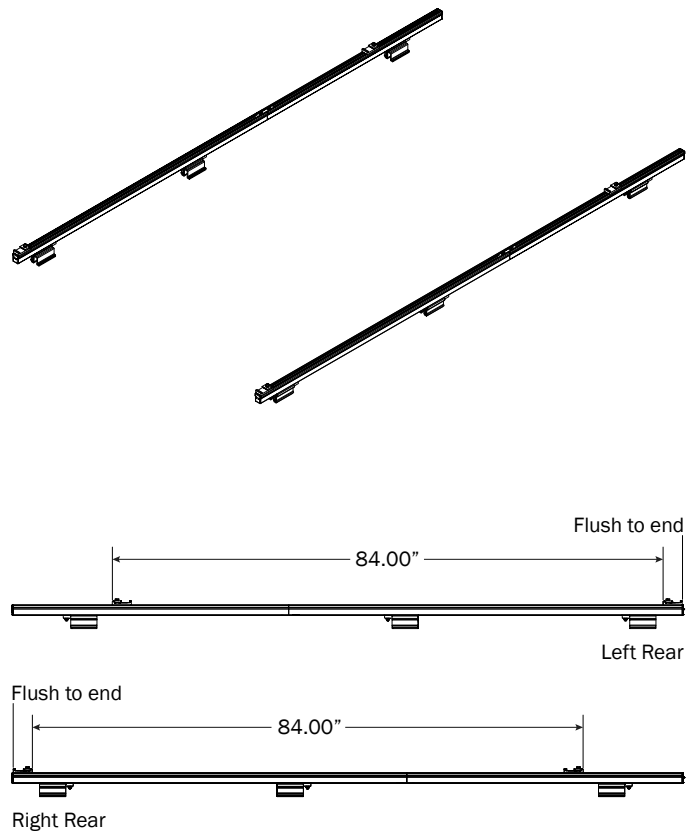

RIGHT ROTATION ASSEMBLY

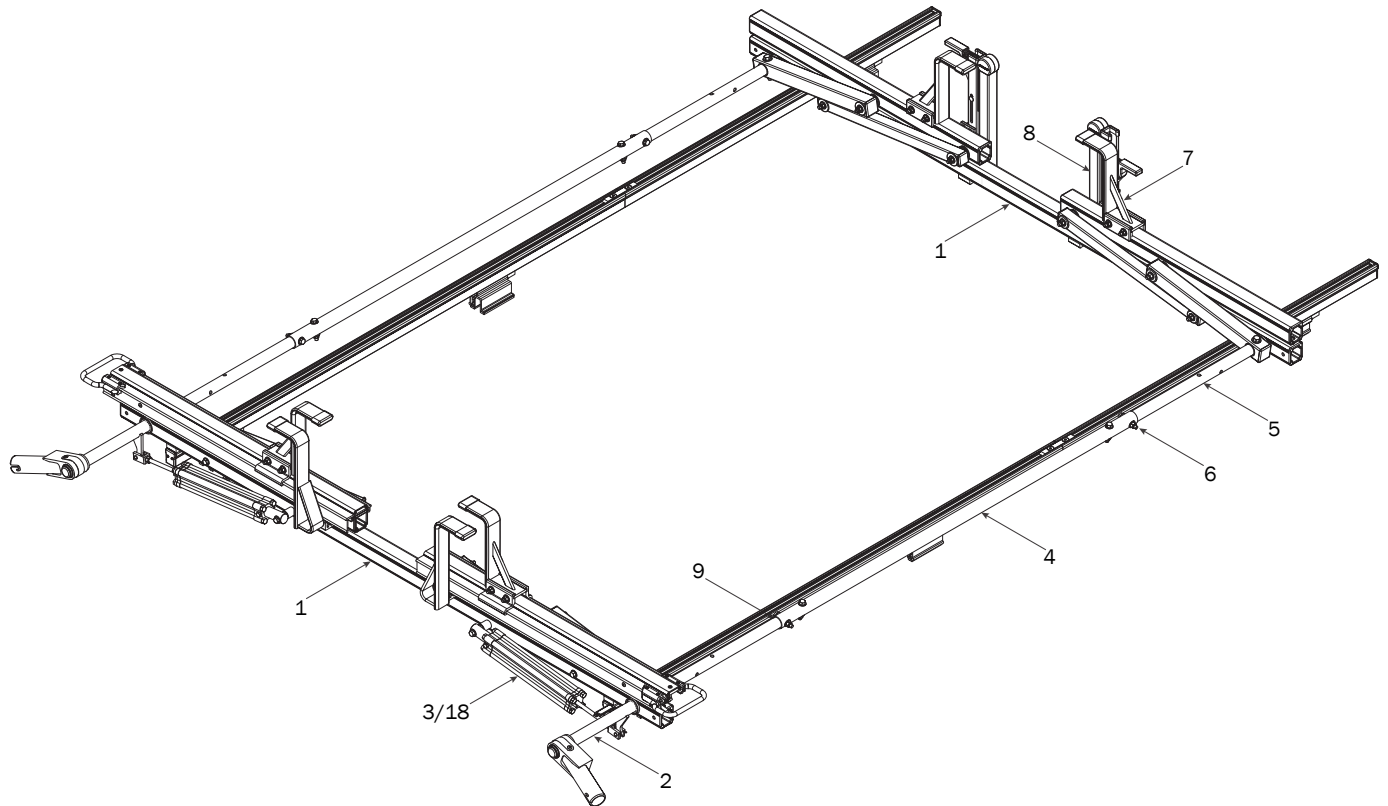

CROSSBARS

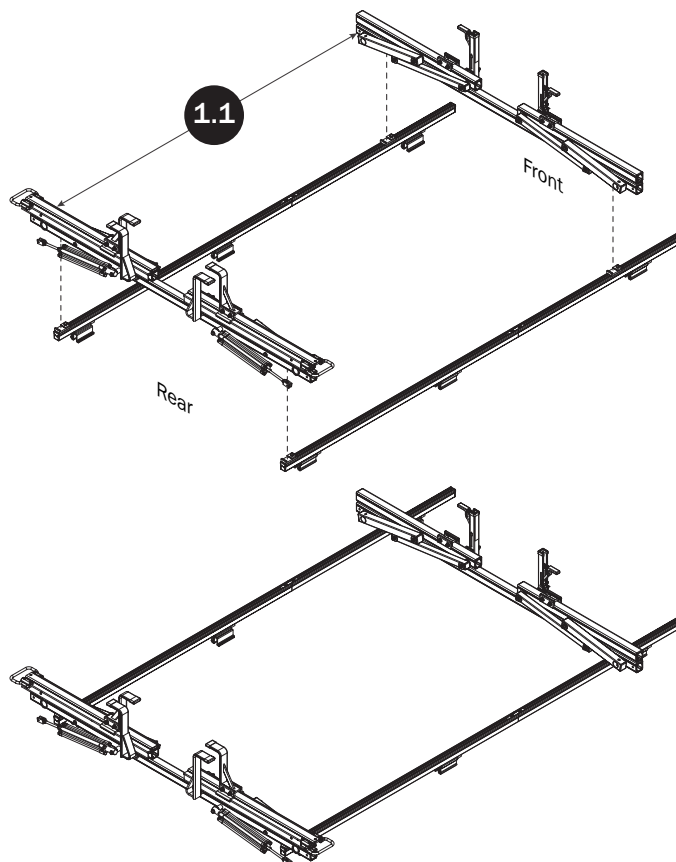

CROSSBAR ADJUSTMENT

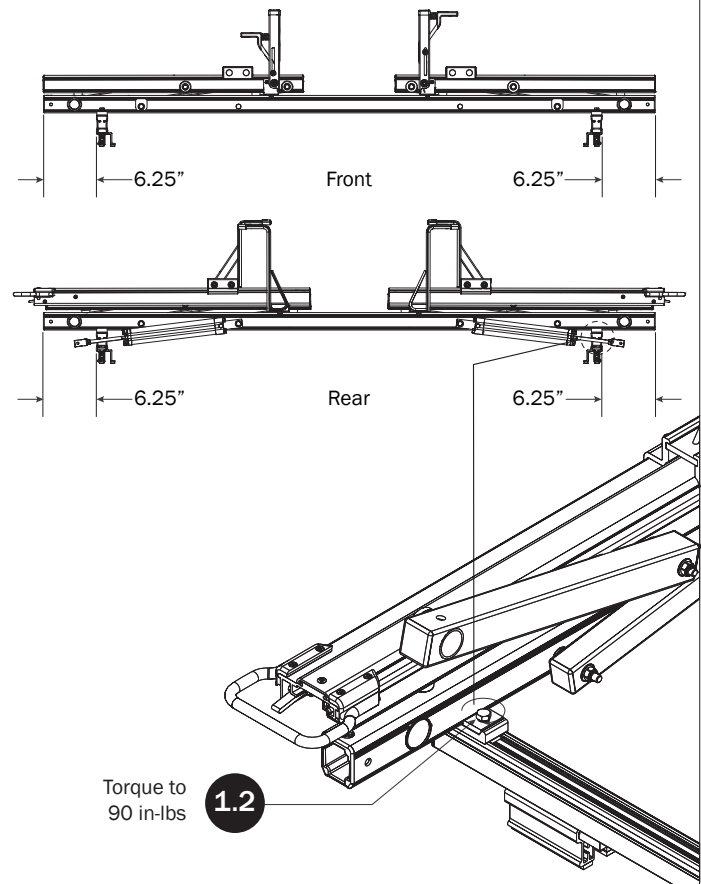

REAR DRIVE SHAFT

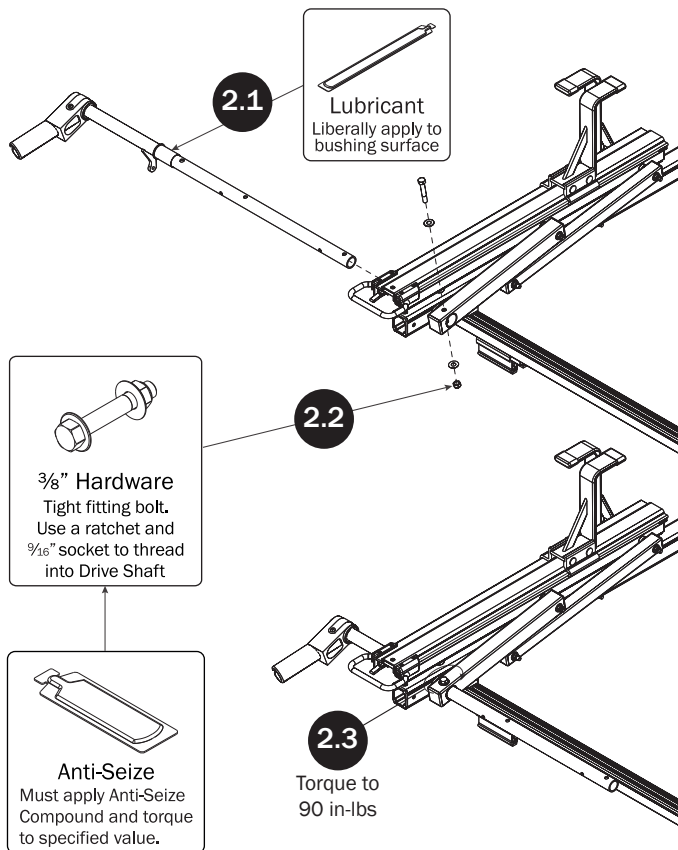

CYLINDER HARDWARE

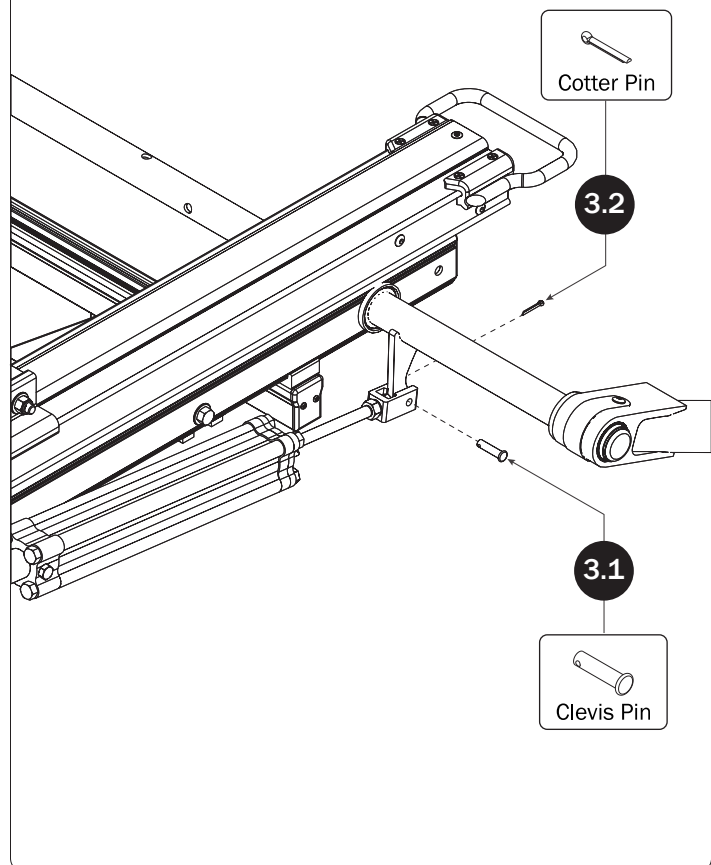

CONNECTING BAR

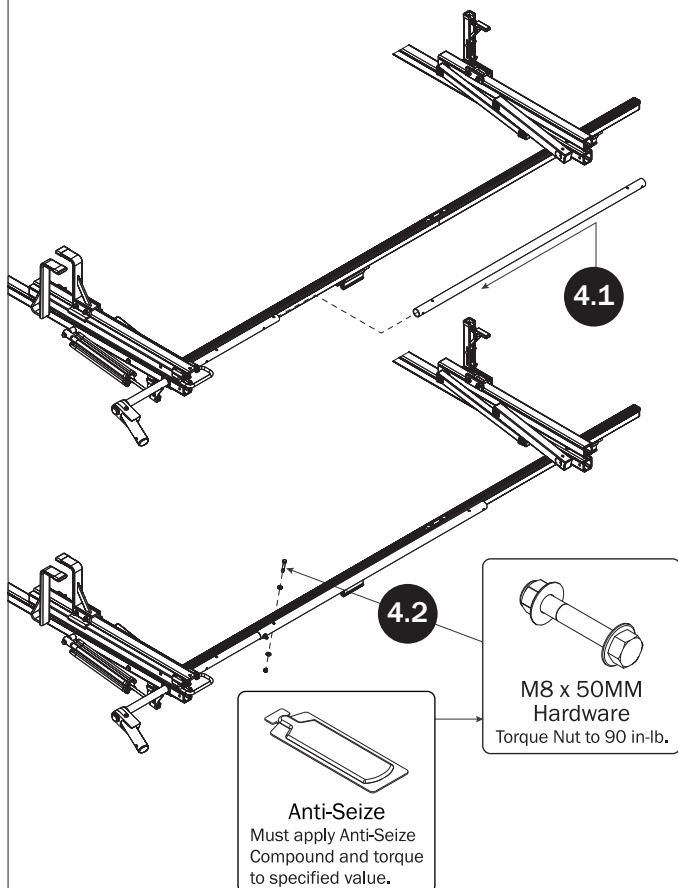

FRONT DRIVE SHAFT

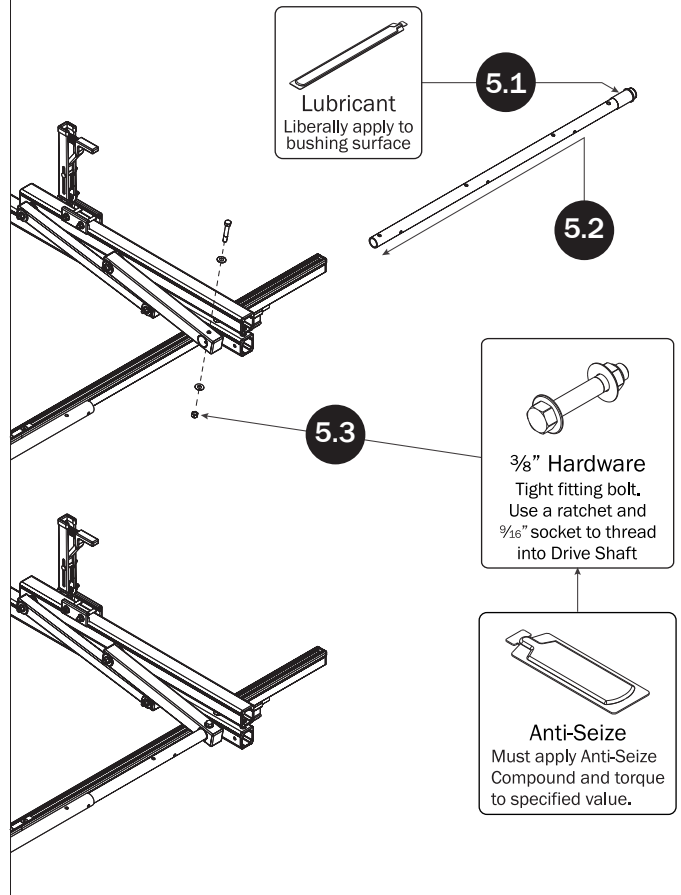

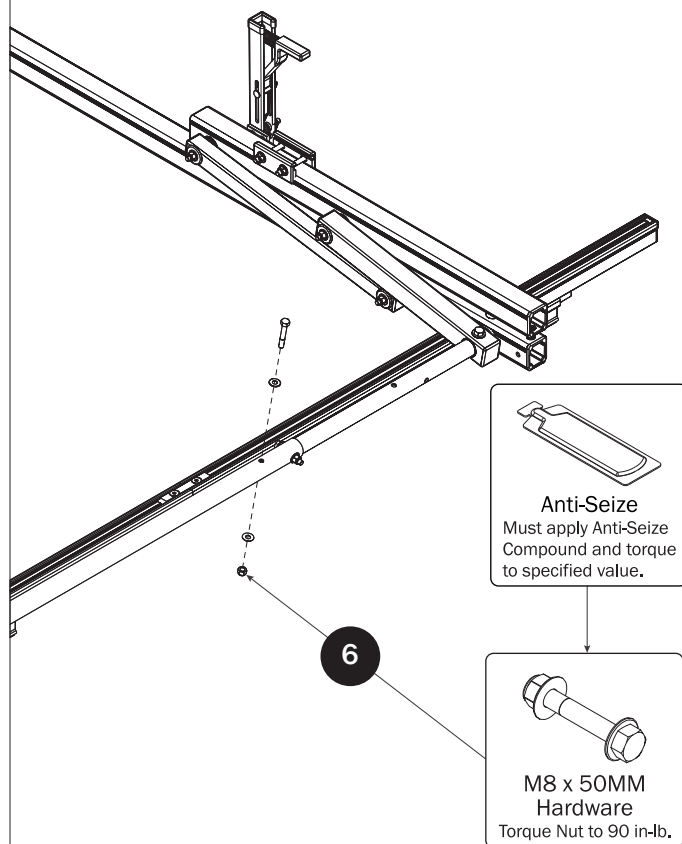
CONNECTING BAR FASTENERS**Z POSTS**

SEE QUICK START GUIDE FOR ADJUSTMENTS

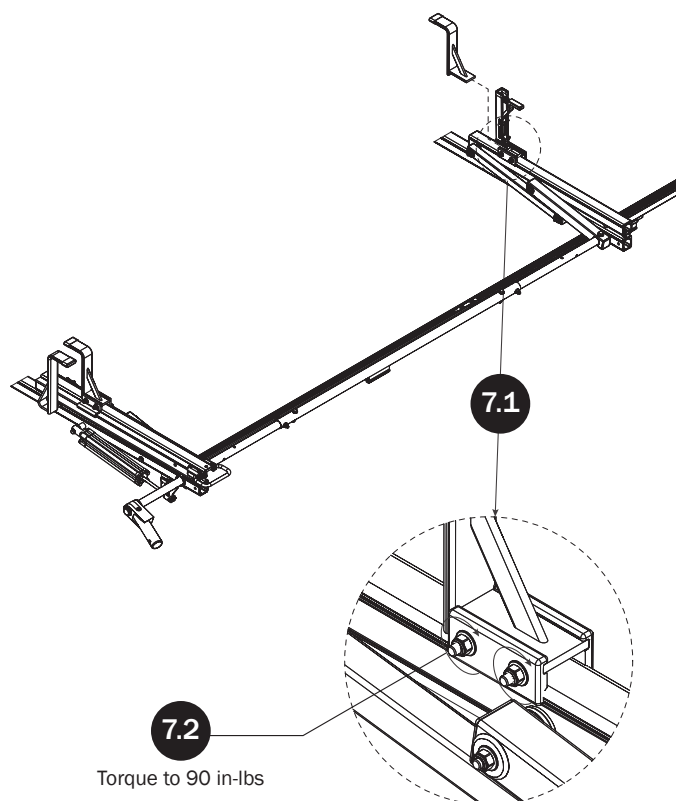
**L POSTS**

SEE QUICK START GUIDE FOR ADJUSTMENTS

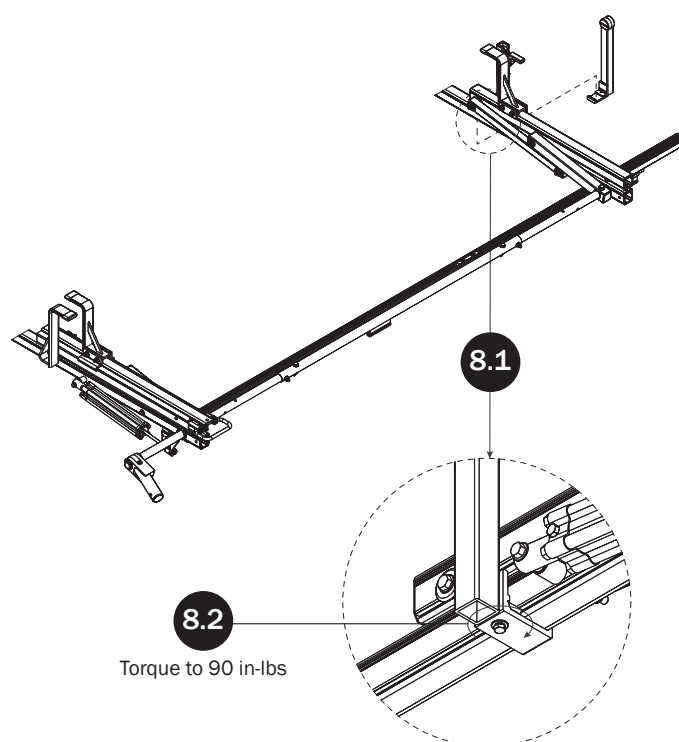
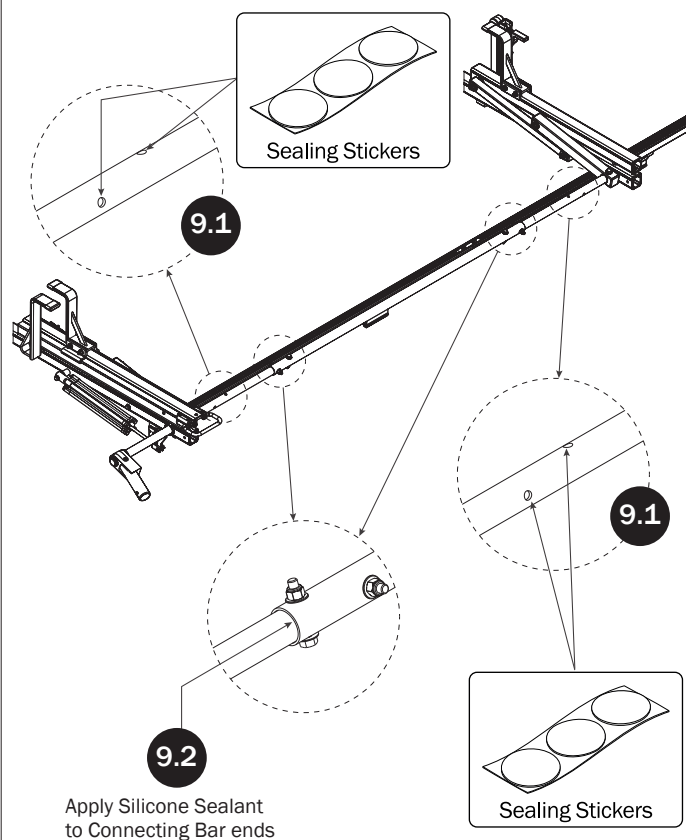
**DRIVE SHAFT SEALING**

LEFT ROTATION ASSEMBLY

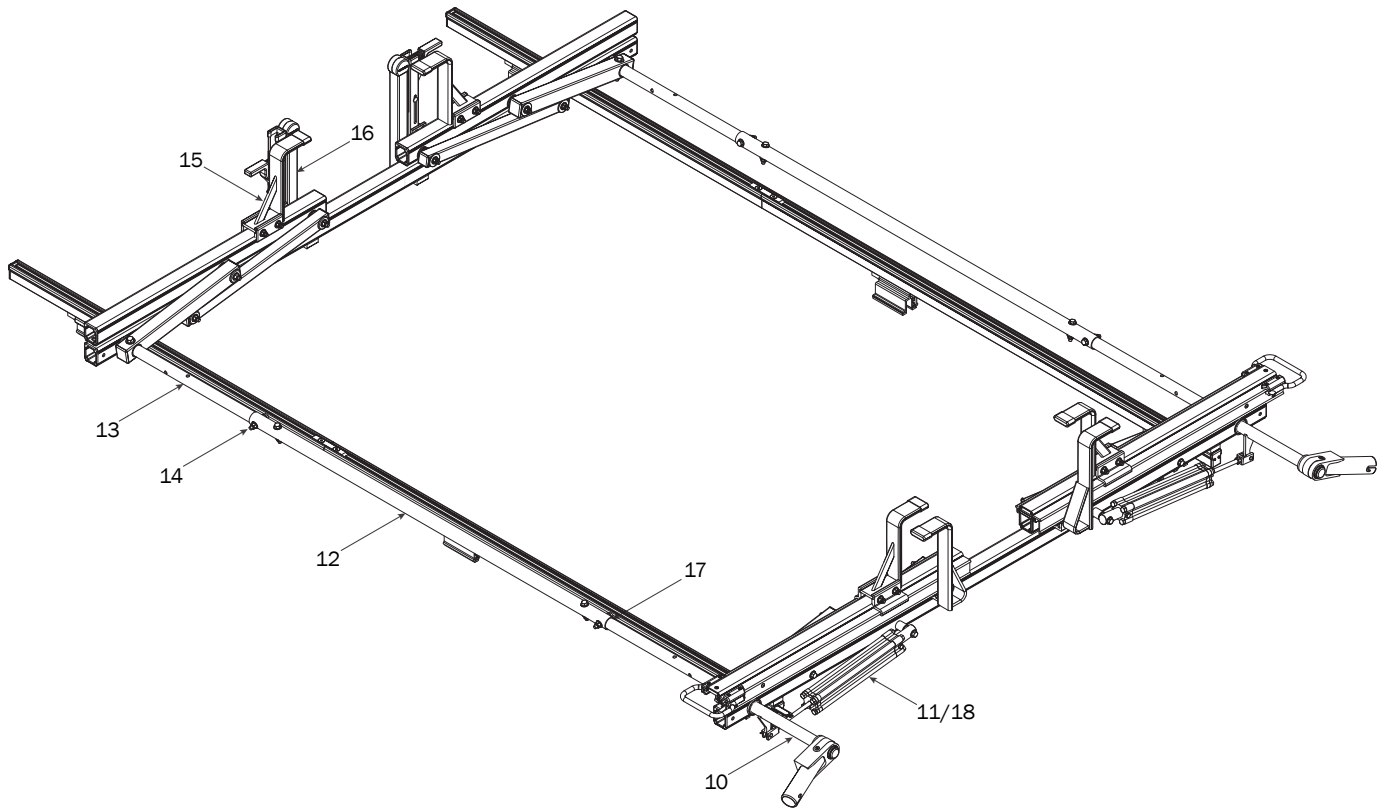

REAR DRIVE SHAFT

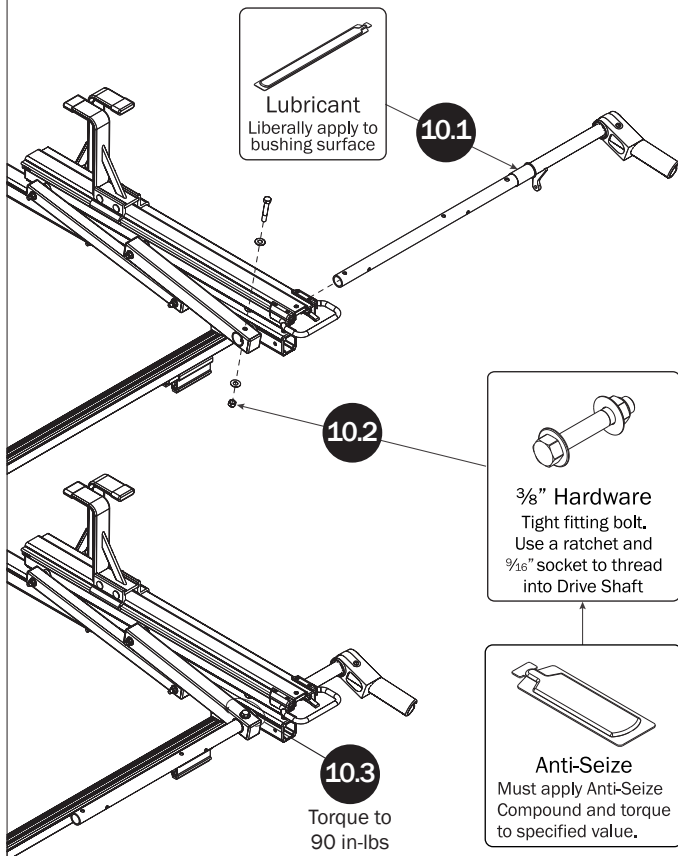

CYLINDER HARDWARE

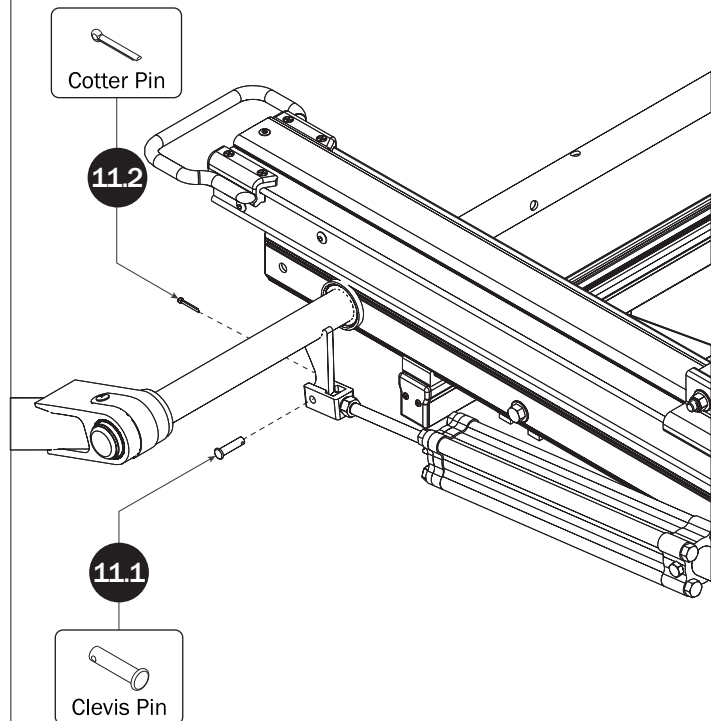

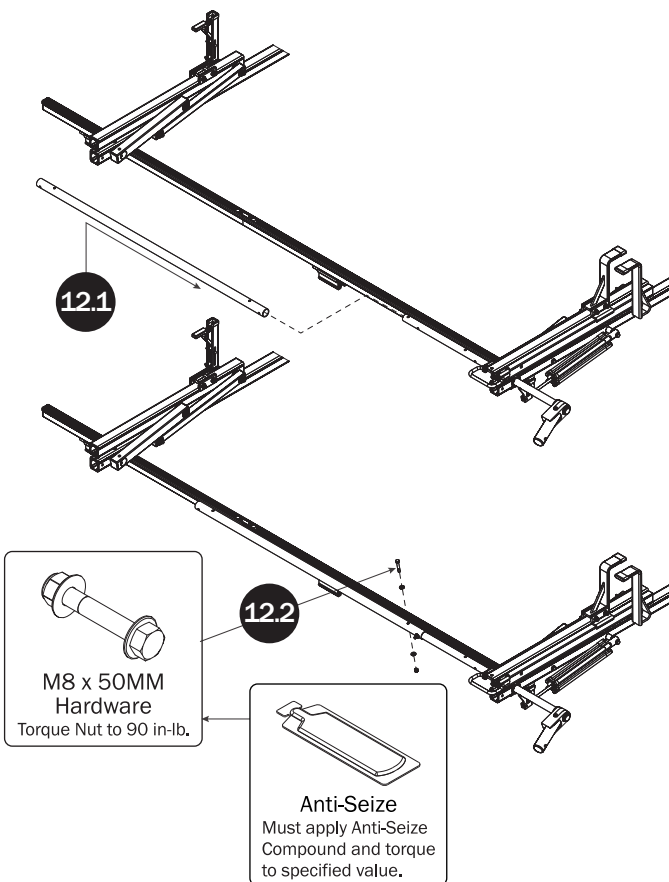
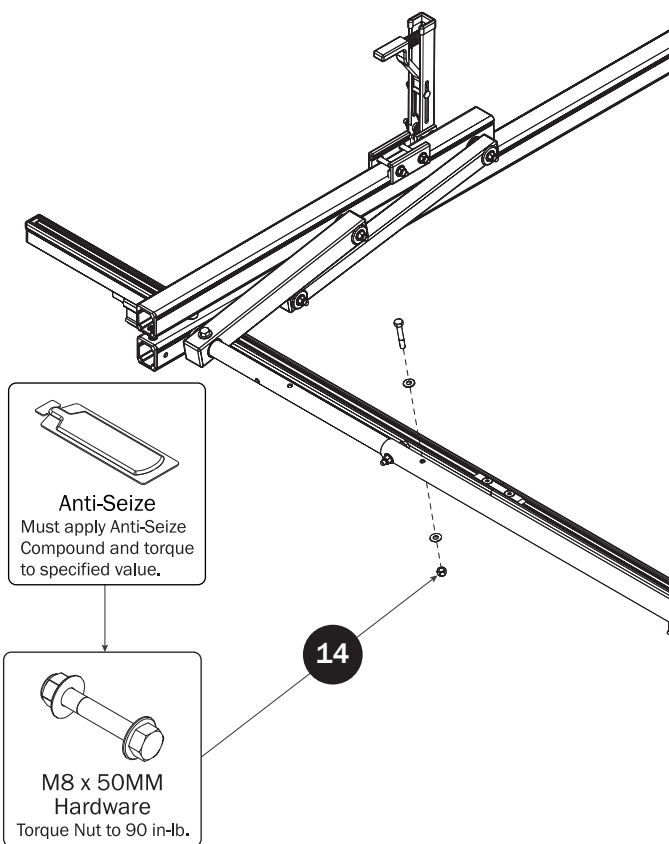
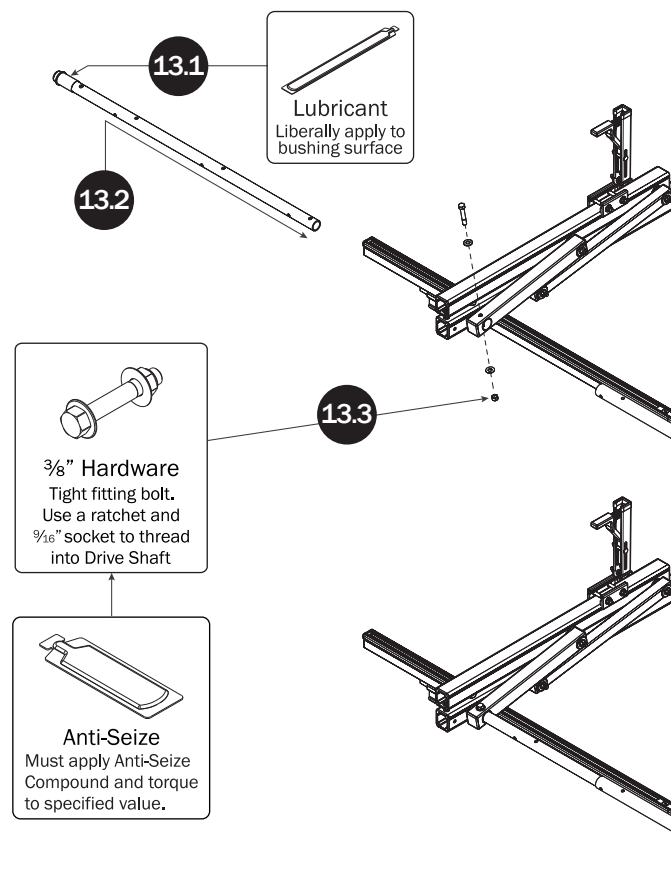
CONNECTING BAR**CONNECTING BAR FASTENERS****FRONT DRIVE SHAFT****Z POSTS**

SEE QUICK START GUIDE FOR ADJUSTMENTS

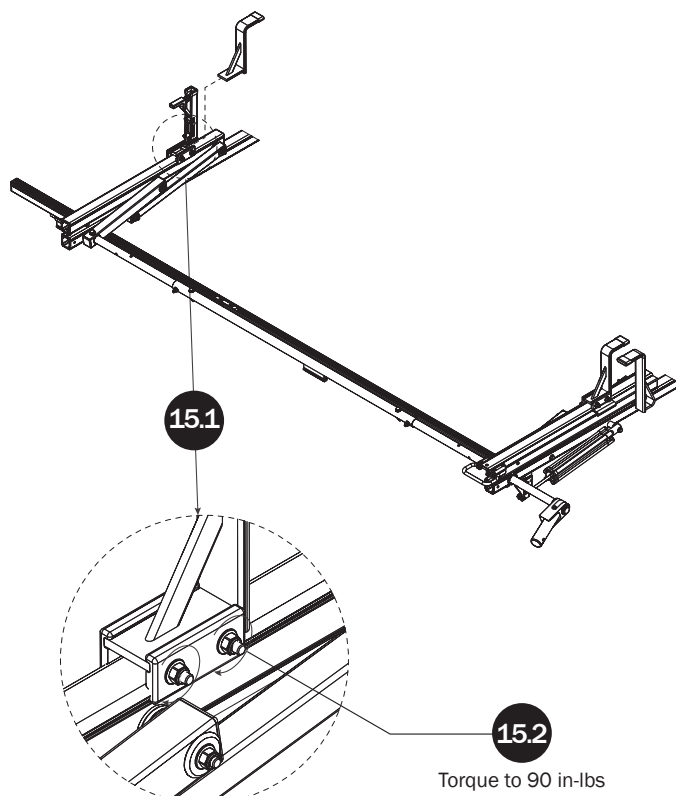

L POSTS

SEE QUICK START GUIDE FOR ADJUSTMENTS

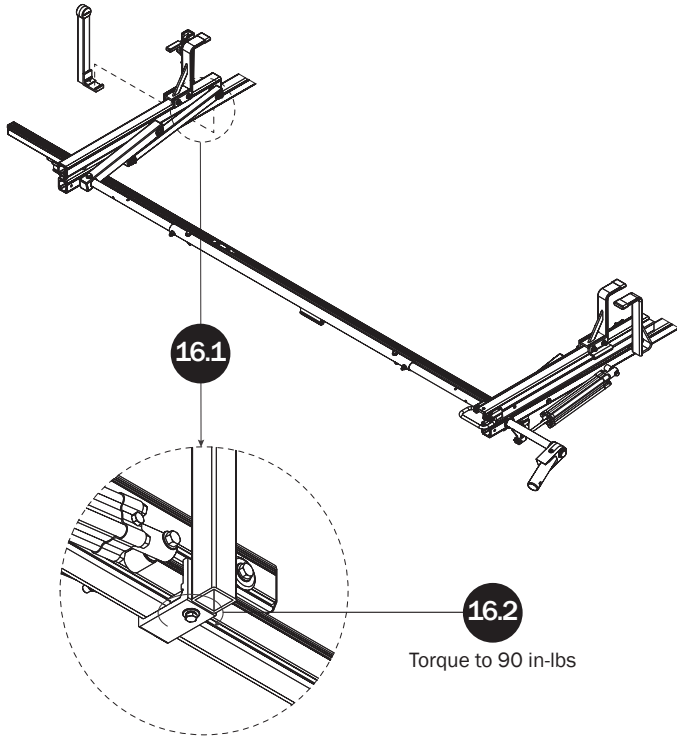

DRIVE SHAFT SEALING

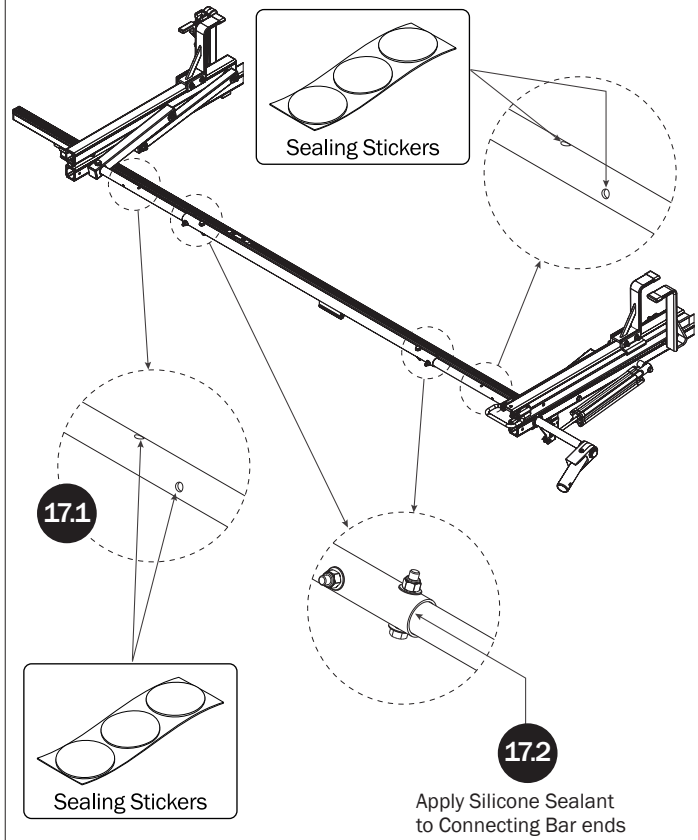

CYLINDER ADJUSTMENT

