

PRIME DESIGN™

A Safe Fleet Brand

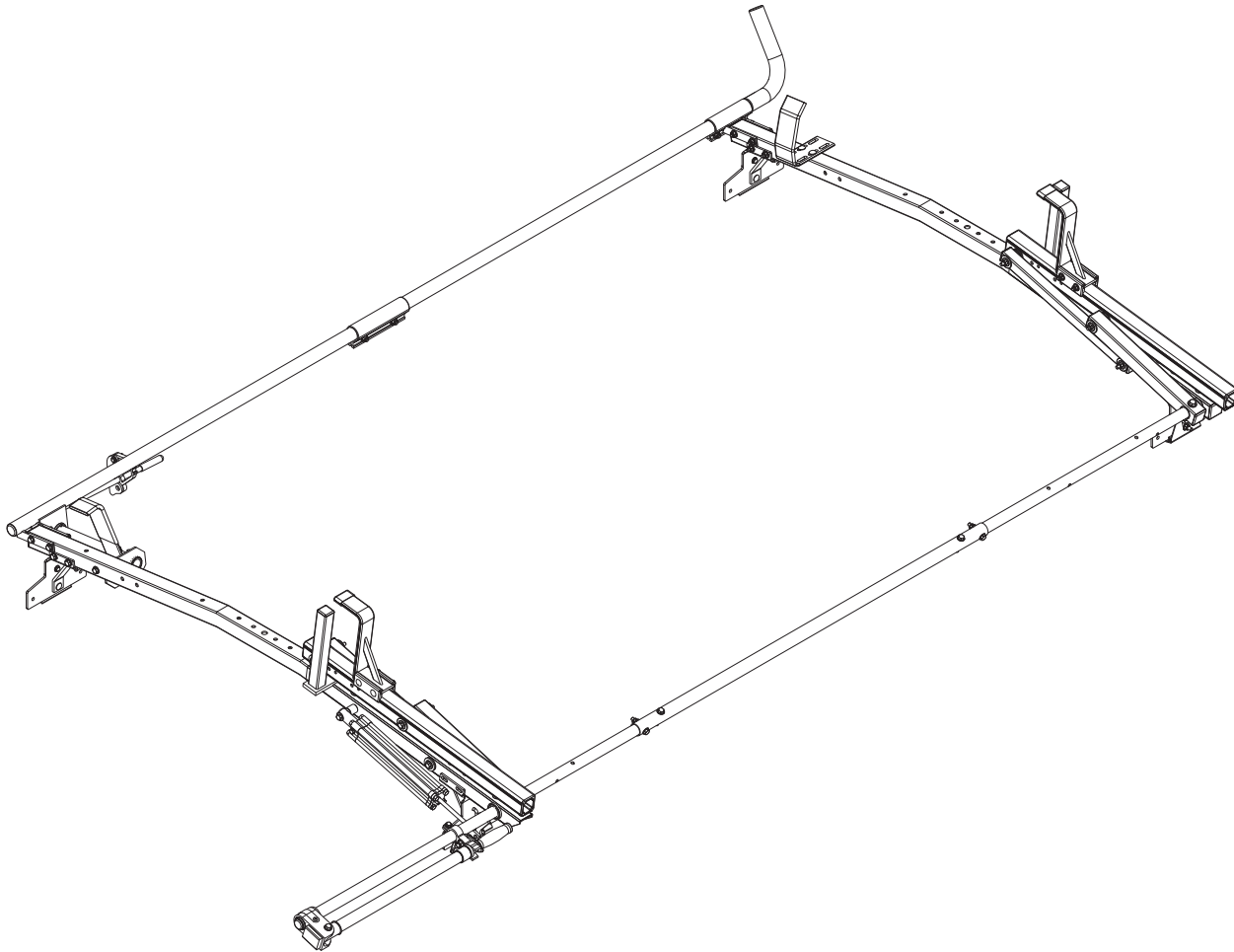

VCR 226

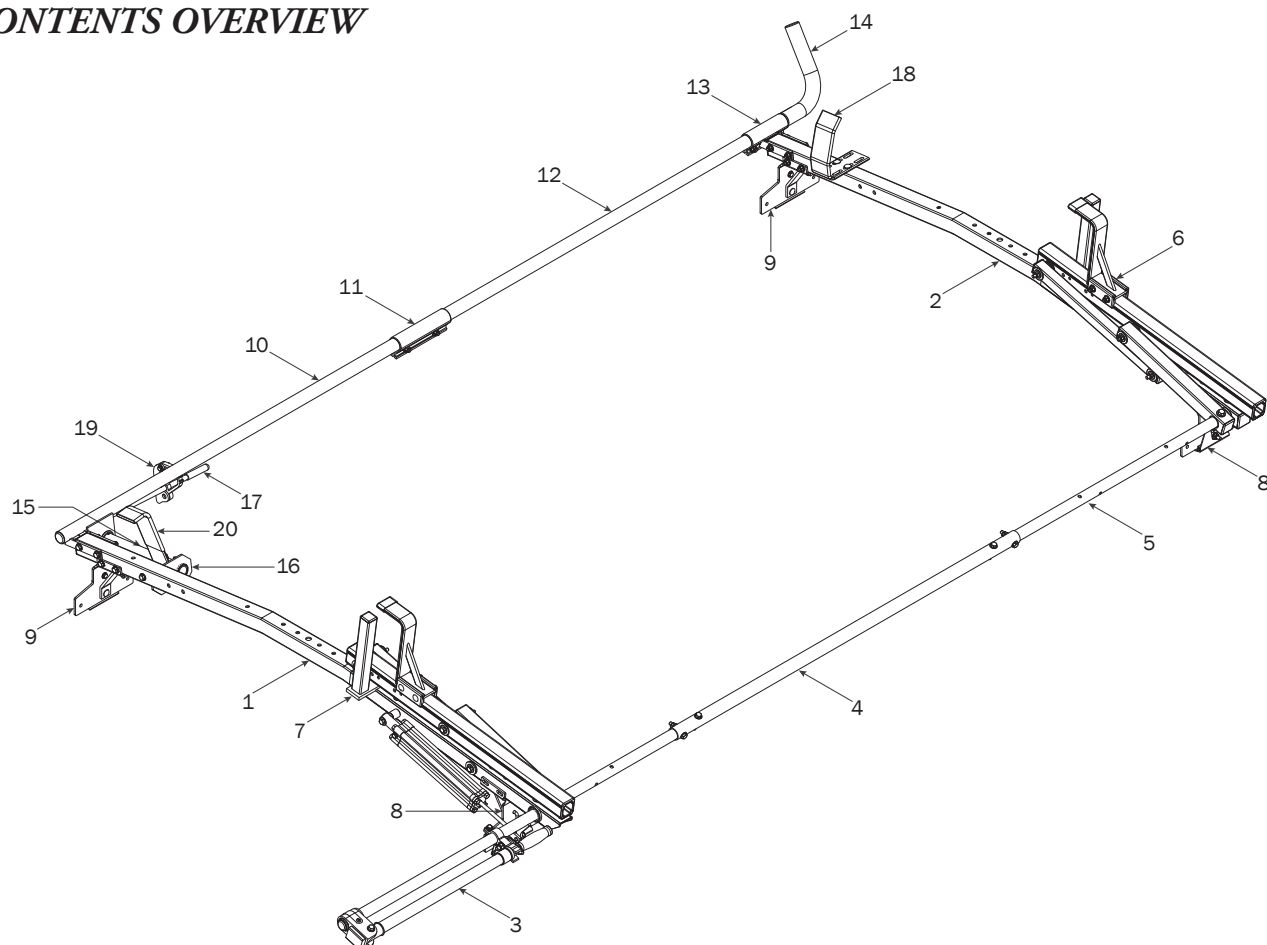

1—Rear Crossbar Assembly..... (Qty 1)

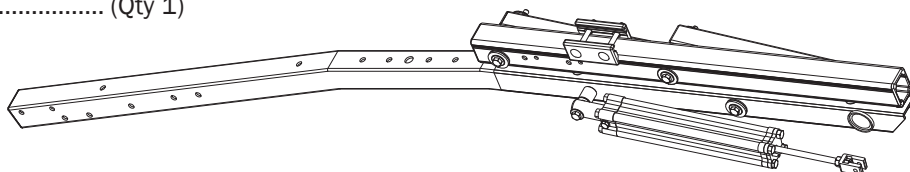

2—Front Crossbar Assembly..... (Qty 1)

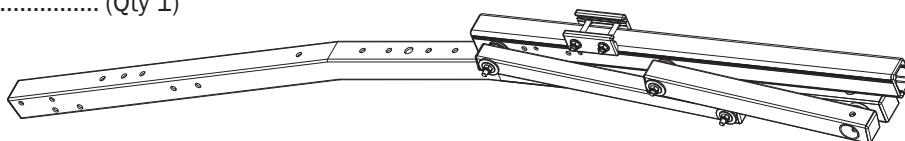

3—Rear Drive Shaft..... (Qty 1)
Right Hand, B4 Version, 50.00"

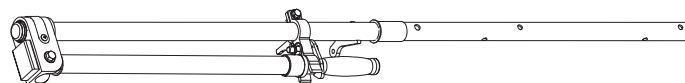

4—Connecting Bar..... (Qty 1)
48.00"



5—Front Drive Shaft..... (Qty 1)
B Version, 35.75"



6—Z Post (Qty 2)
Adjustable, 7.25"

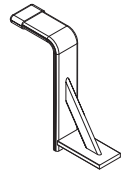

7—L Post (Qty 2)
Top Mount, 9.25"

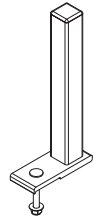

8—Mounting Bracket Assembly.....(Qty 2)
Vertical, Low Mounting, 4.50", GM

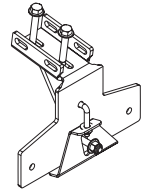

9—Mounting Bracket Assembly.....(Qty 2)
Horizontal, Low Mounting, 4.50", GM

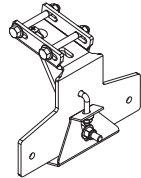

10—Clamp Down Tube Assembly(Qty 1)
Rear, Left Hand, 50.00"

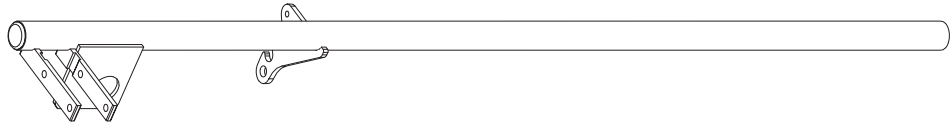

11—Clamp Down Tube Splice.....(Qty 1)
7.00"



12—Clamp Down Tube(Qty 1)
Front, 48.00"



13—Clamp Down Tube Splice.....(Qty 1)
Welded, 5.00"

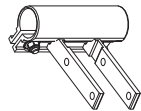

14—Clamp Down Horn(Qty 1)
Left Hand, with Cap, 15.00"

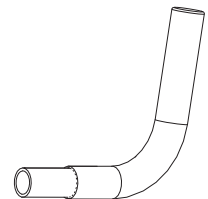

15—Clamp Down Handle Tube(Qty 1)
14.50"



16—Clamp Down Handle Tube Bracket(Qty 1)
Rear, Left Hand

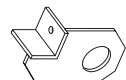

17—Clamp Down Handle(Qty 1)
With Black Grip, 18.00"

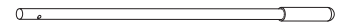

18—Clamp Down Hook(Qty 1)
Front, Slotted

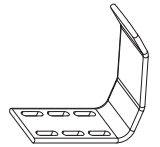

19—Handle Latch Lock Plate (Qty 1)
With Hardware, Gen1

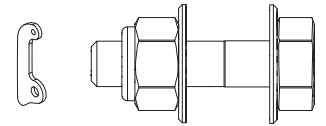

20—Clamp Down Hook..... (Qty 1)
Rear

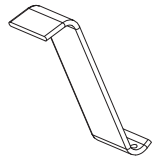

HKT-8112-Clamp Down Hardware Kit

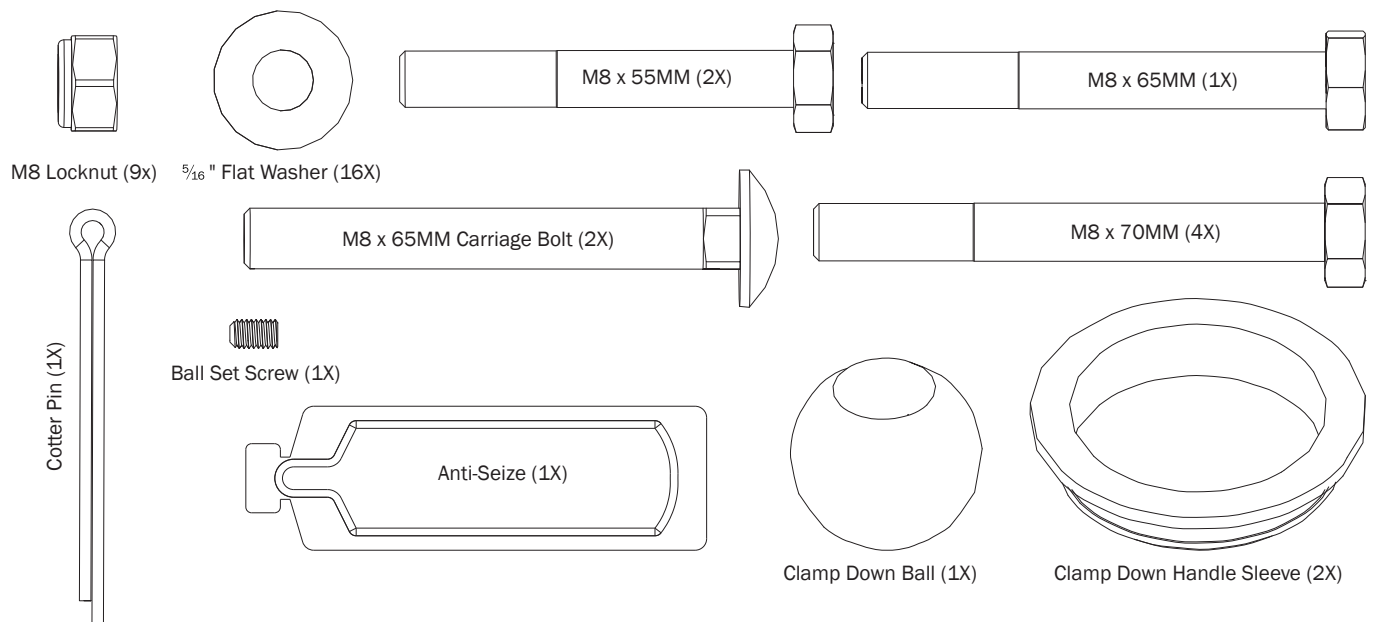

HKT-8163-Rotation Hardware Kit

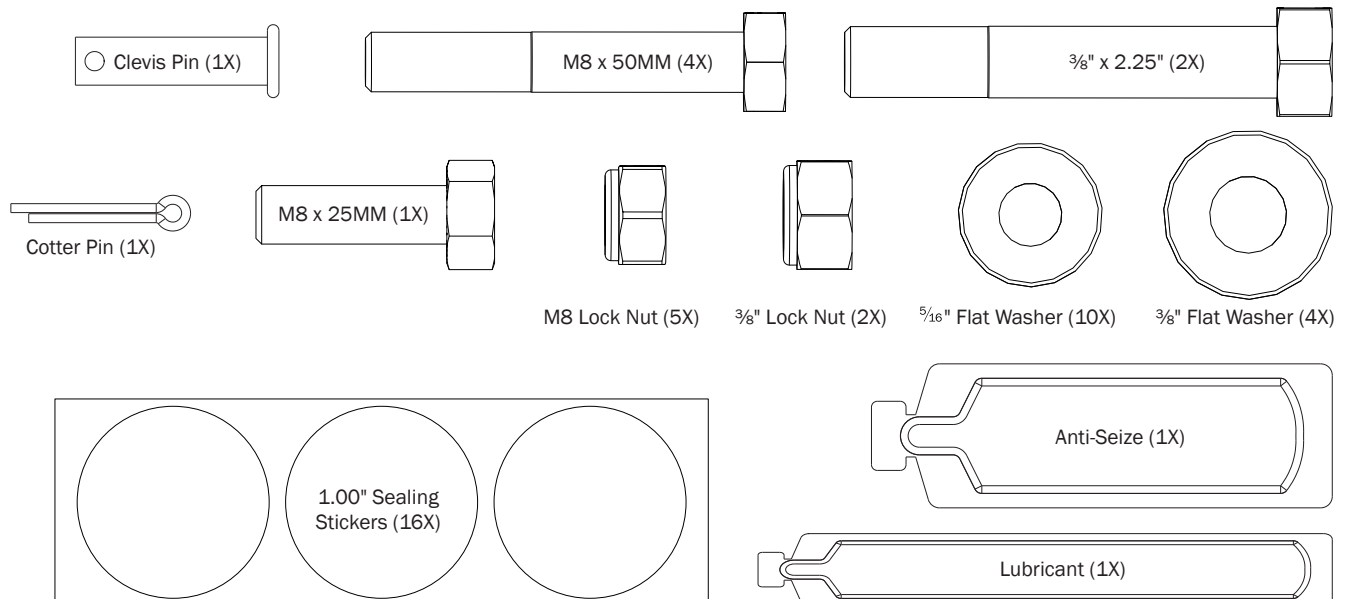

MOUNTING BRACKETS—VERTICAL BRACKET PRE-ASSEMBLY

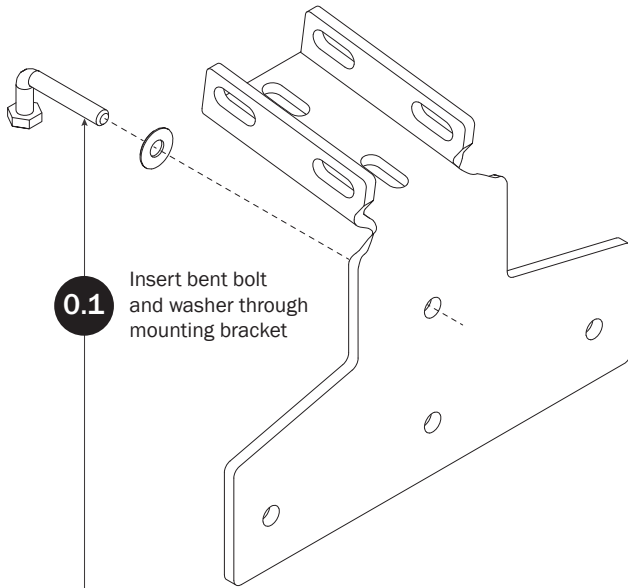

0.1 Insert bent bolt and washer through mounting bracket

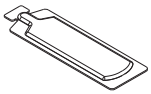

Anti-Seize
Must apply Anti-Seize Compound and torque to specified value.

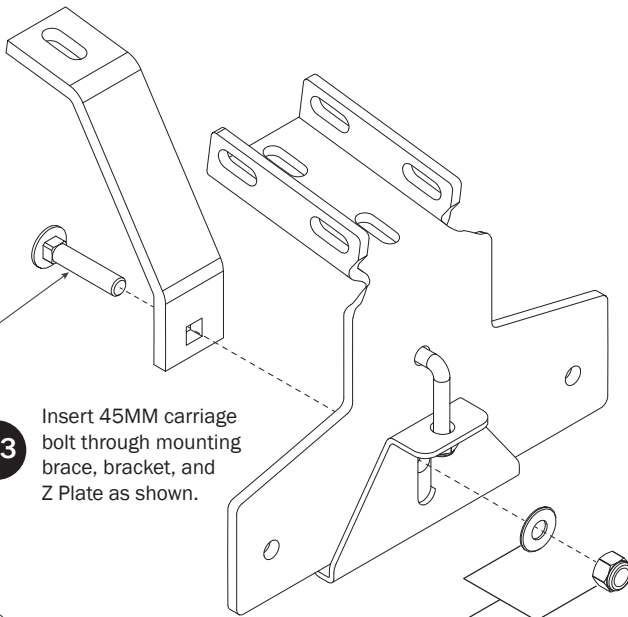

0.3 Insert 45MM carriage bolt through mounting brace, bracket, and Z Plate as shown.

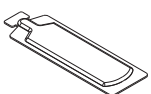

Anti-Seize
Must apply Anti-Seize Compound and torque to specified value.

0.4

Secure mounting assembly with washer and nut. Do not tighten until installed on vehicle roof.

0.2

Assemble the Z Plate and secure with washer and nut. Do not tighten until installed on vehicle roof.

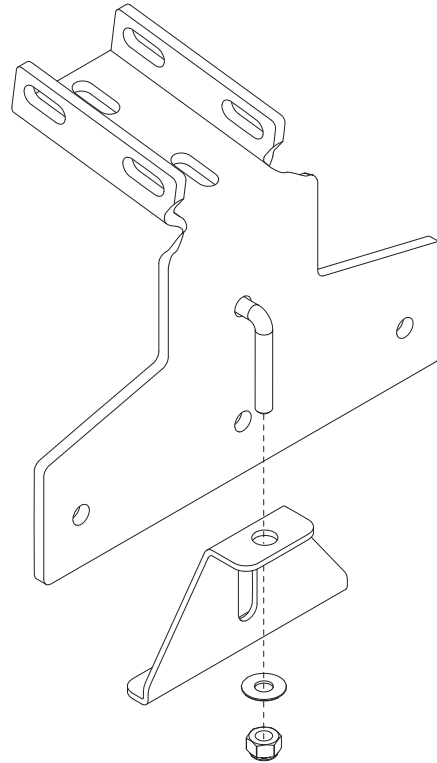

0.5

Repeat Steps 0.1–0.4 to assemble the remaining Vertical Mounting Brackets.

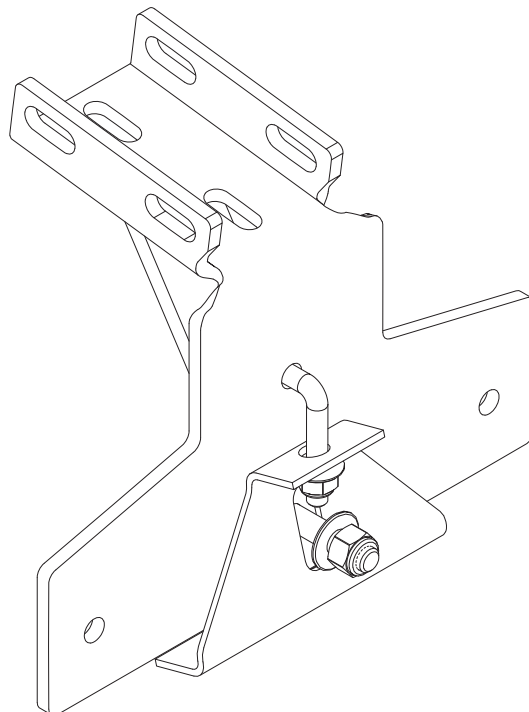

5

VCR-226 ASSEMBLY INSTRUCTIONS—VERTICAL MOUNTING BRACKETS

PRIME DESIGN
A Safe Fleet Brand

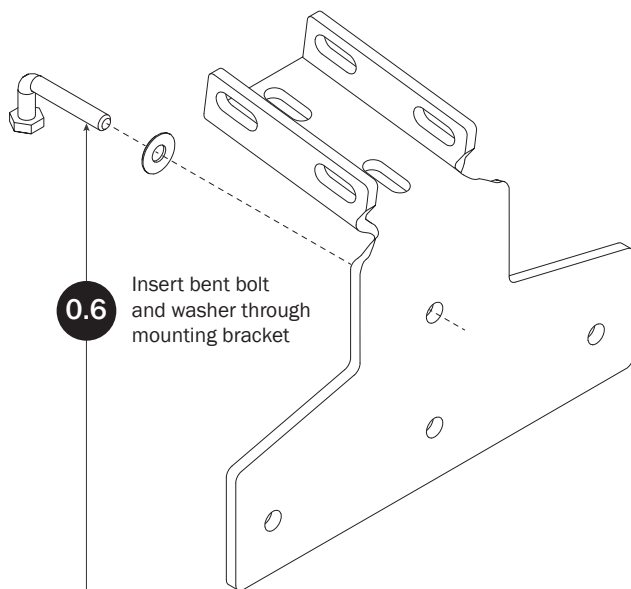
**MOUNTING BRACKETS—HORIZONTAL
BRACKET PRE-ASSEMBLY****0.6**

Insert bent bolt
and washer through
mounting bracket

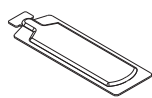

Anti-Seize
Must apply Anti-Seize
Compound and torque
to specified value.

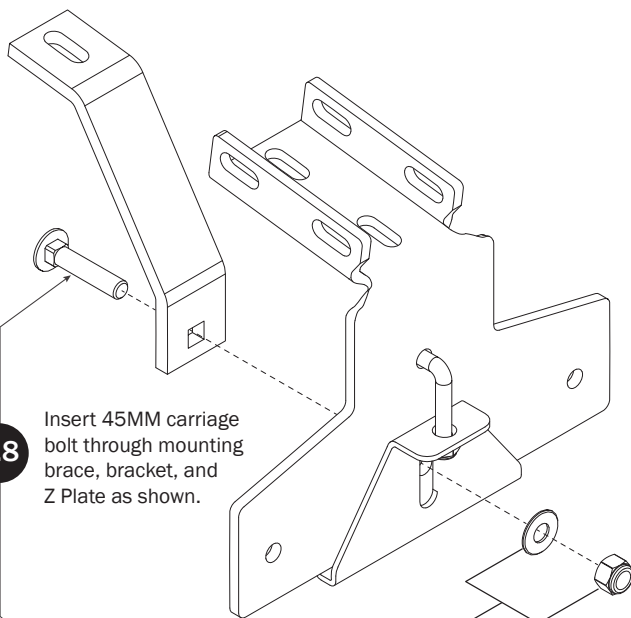
**0.8**

Insert 45MM carriage
bolt through mounting
brace, bracket, and
Z Plate as shown.

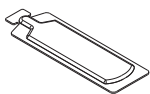

Anti-Seize
Must apply Anti-Seize
Compound and torque
to specified value.

0.9

Secure mounting assembly
with washer and nut. Do
not tighten until installed on
vehicle roof.

0.7

Assemble the Z Plate and secure with washer and nut. Do not
tighten until installed on vehicle roof.

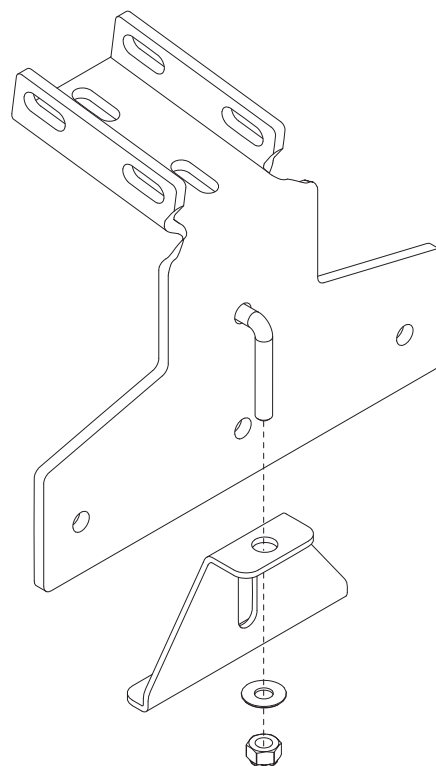
**0.10**

Repeat Steps 0.6–0.10 to assemble the remaining Horizontal
Mounting Brackets.

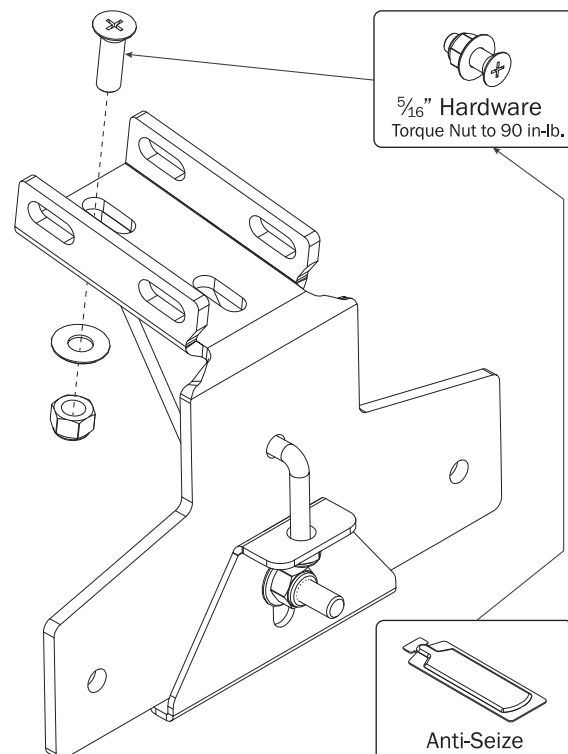

5/16" Hardware
Torque Nut to 90 in-lb.

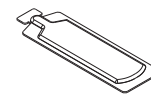

Anti-Seize
Must apply Anti-Seize
Compound and torque
to specified value.

RIGHT ROTATION ASSEMBLY SEQUENCE

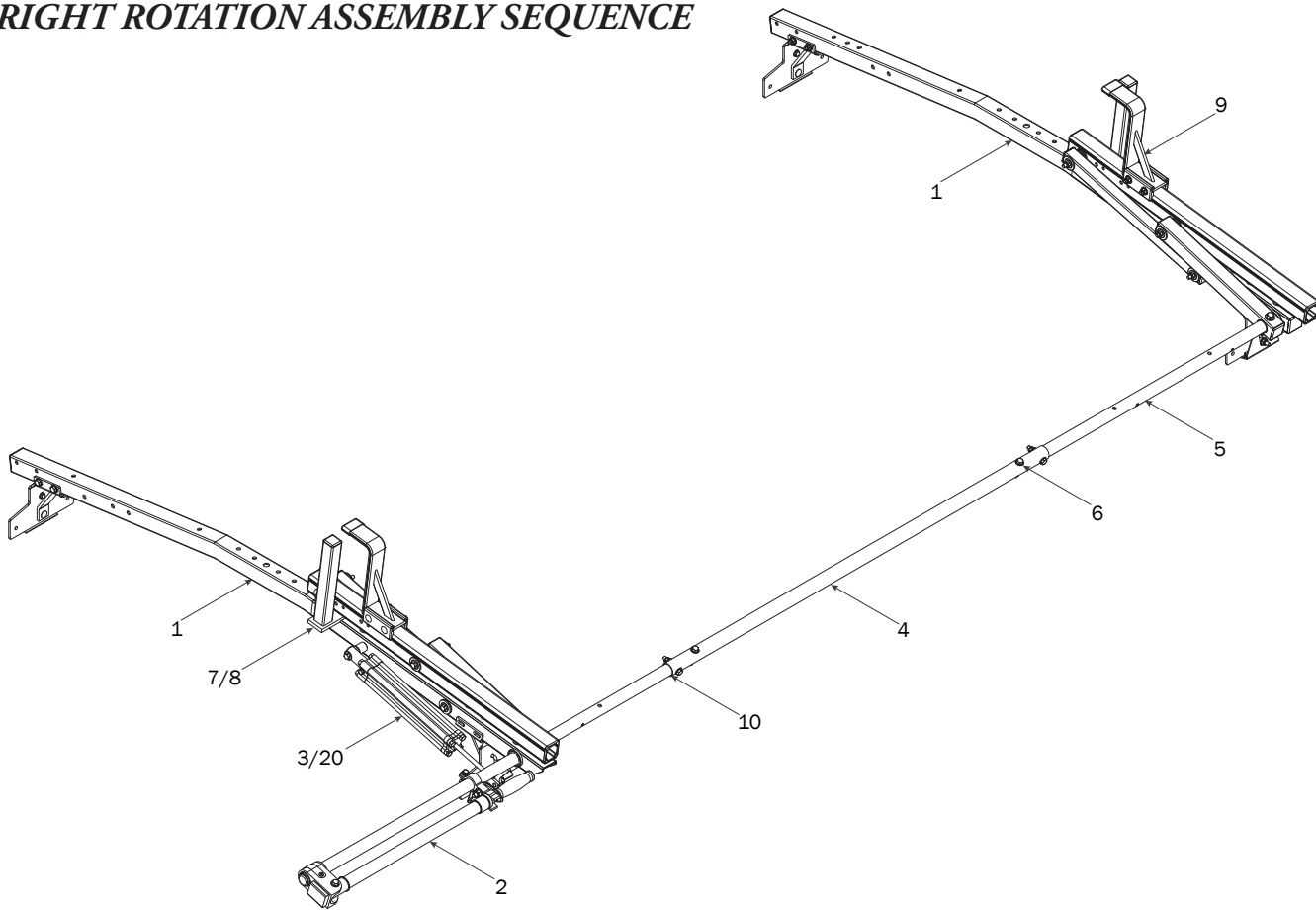

CROSSBARS

- 1.1** Apply Anti-Seize compound to Mounting Bracket bolts.

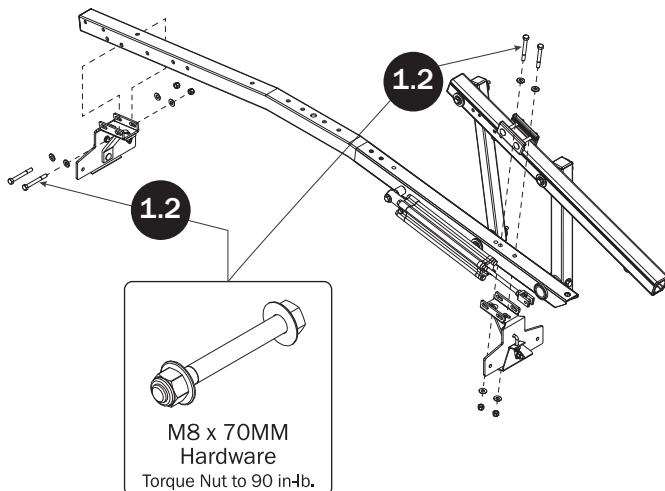

- 1.3** Repeat Steps 1.1-1.3 to install the remaining Mounting Brackets onto the front Crossbar.

REAR DRIVE SHAFT

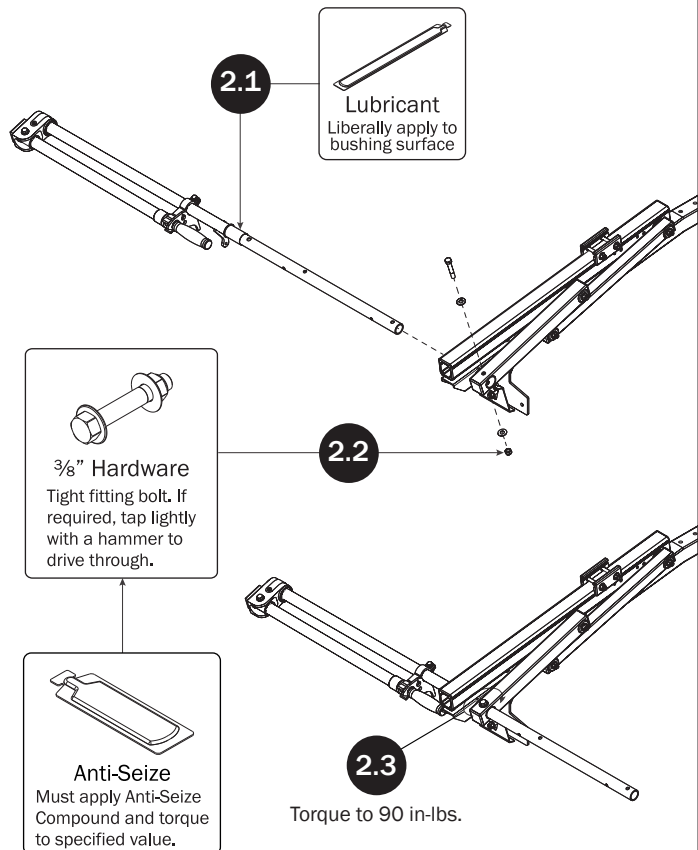

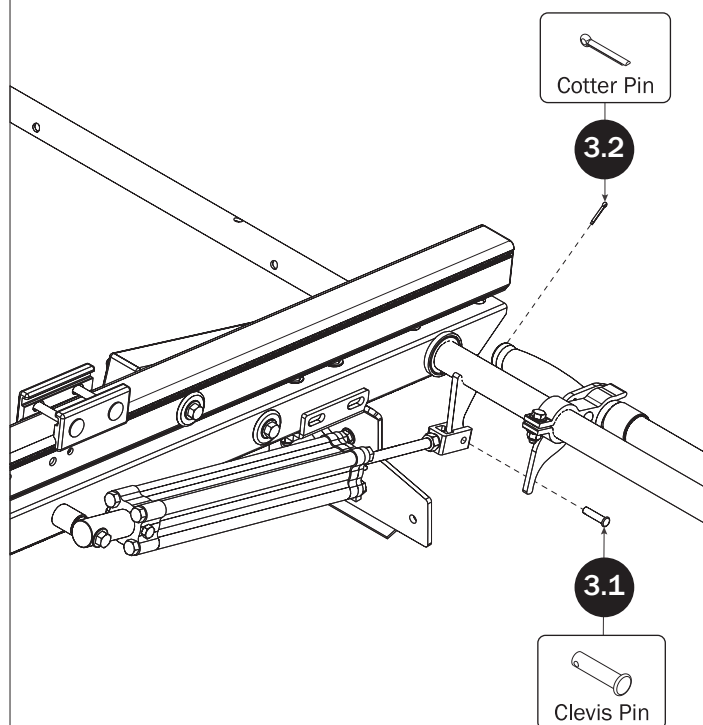
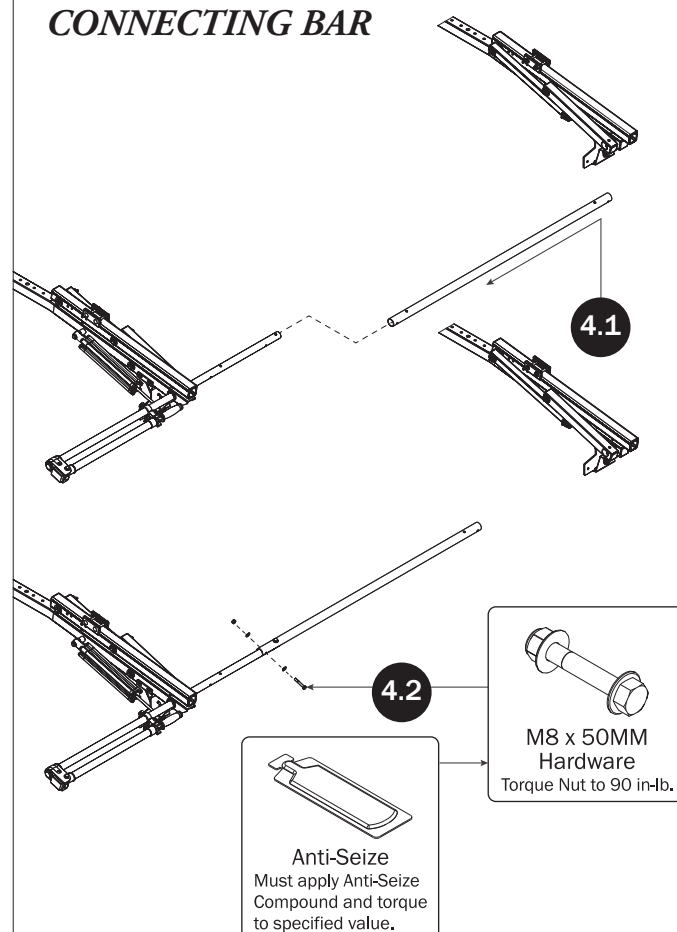
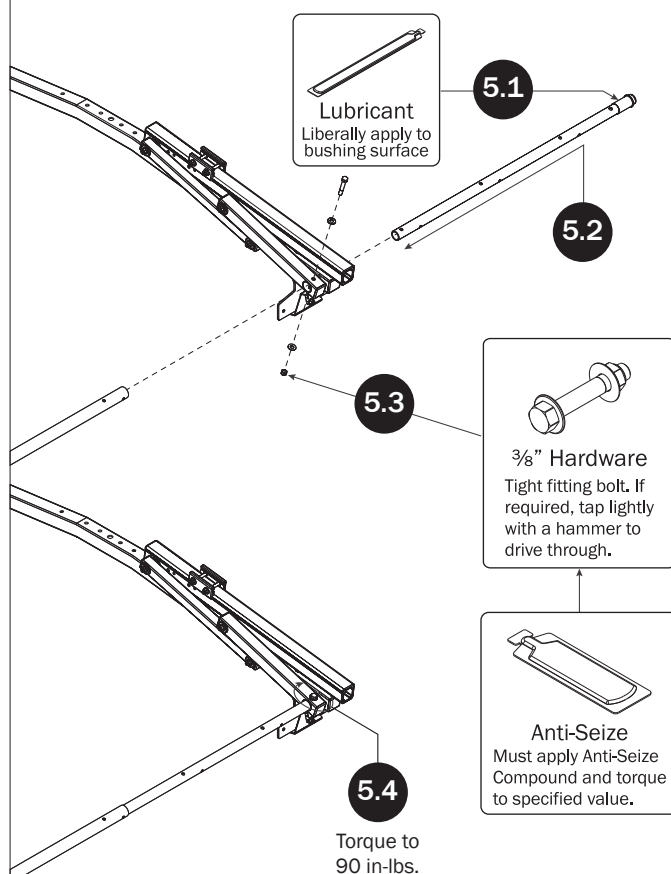
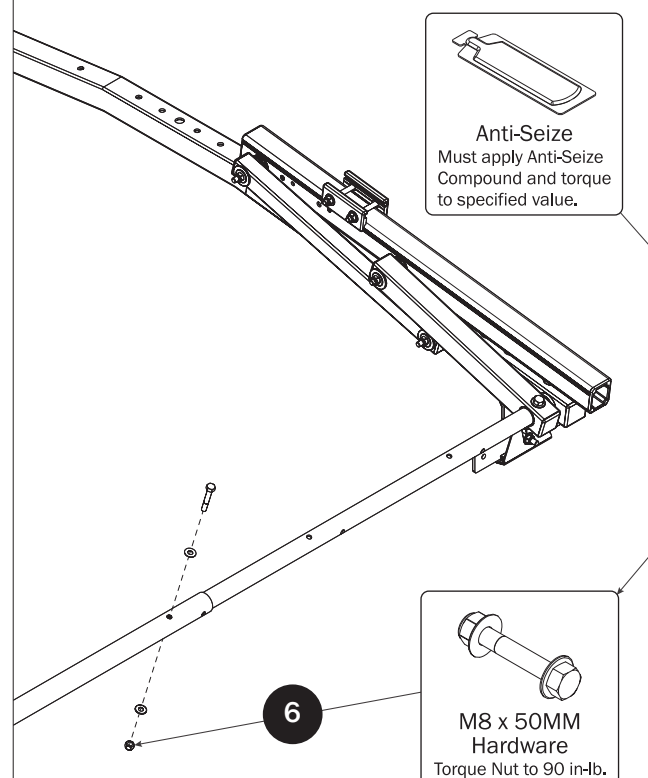
CYLINDER ASSEMBLY**CONNECTING BAR****FRONT DRIVE SHAFT****CONNECTING BAR FASTENERS**

CROSSBAR SEALING

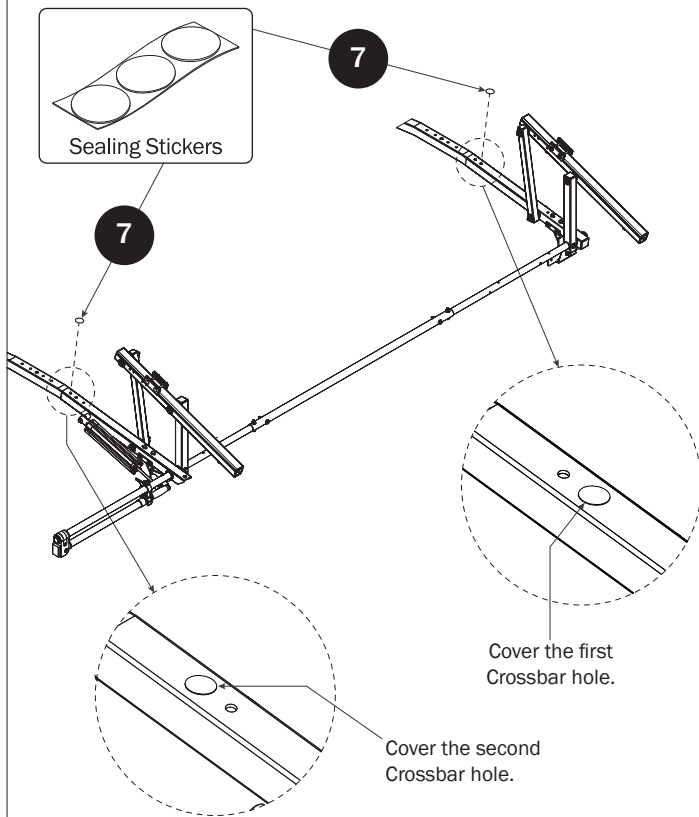

L POSTS

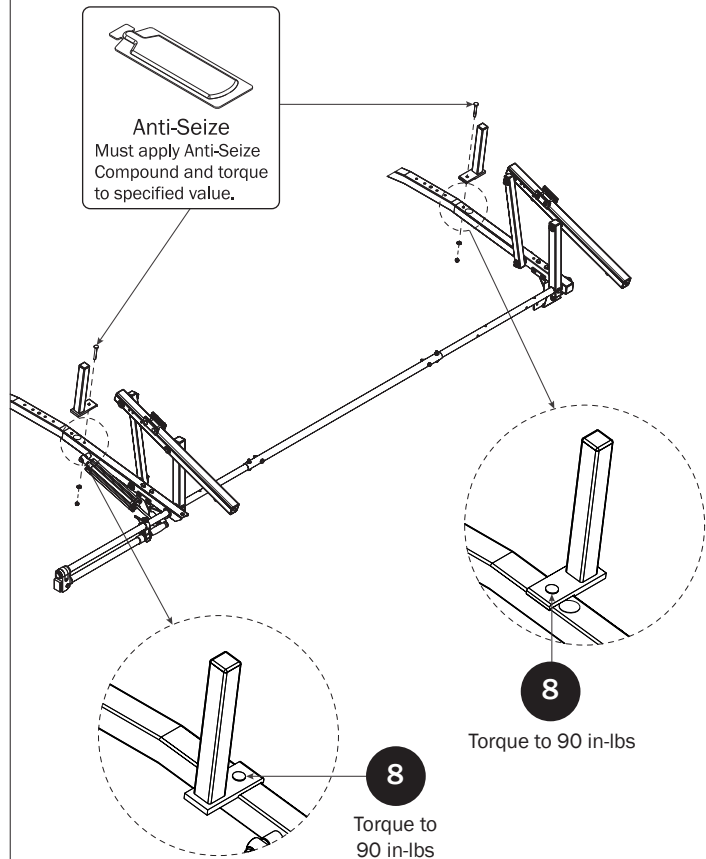

Z POSTS

SEE QUICK START GUIDE FOR ADJUSTMENTS

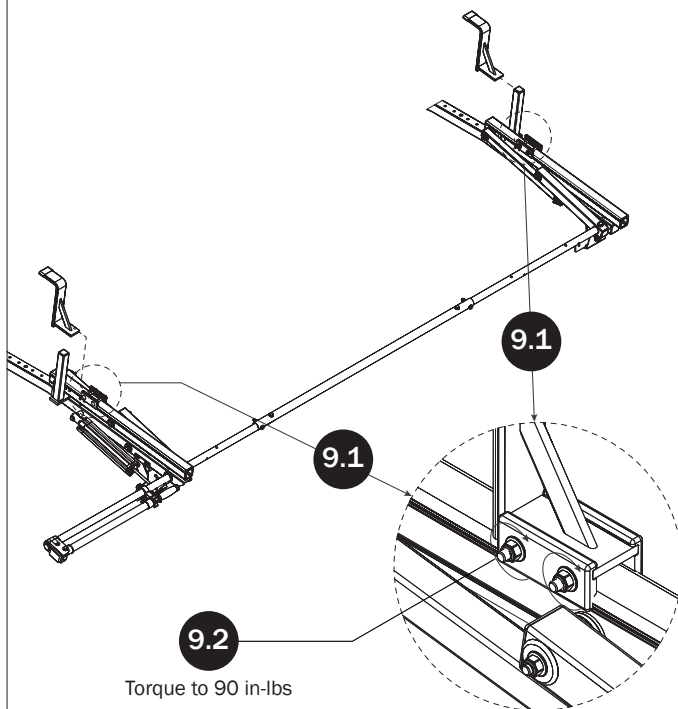

DRIVE SHAFT SEALING

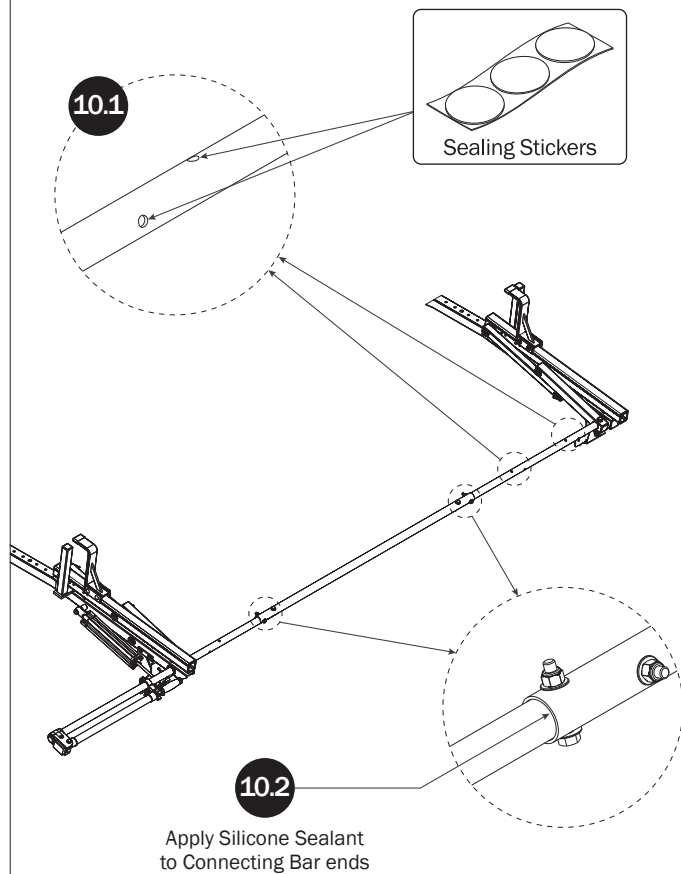

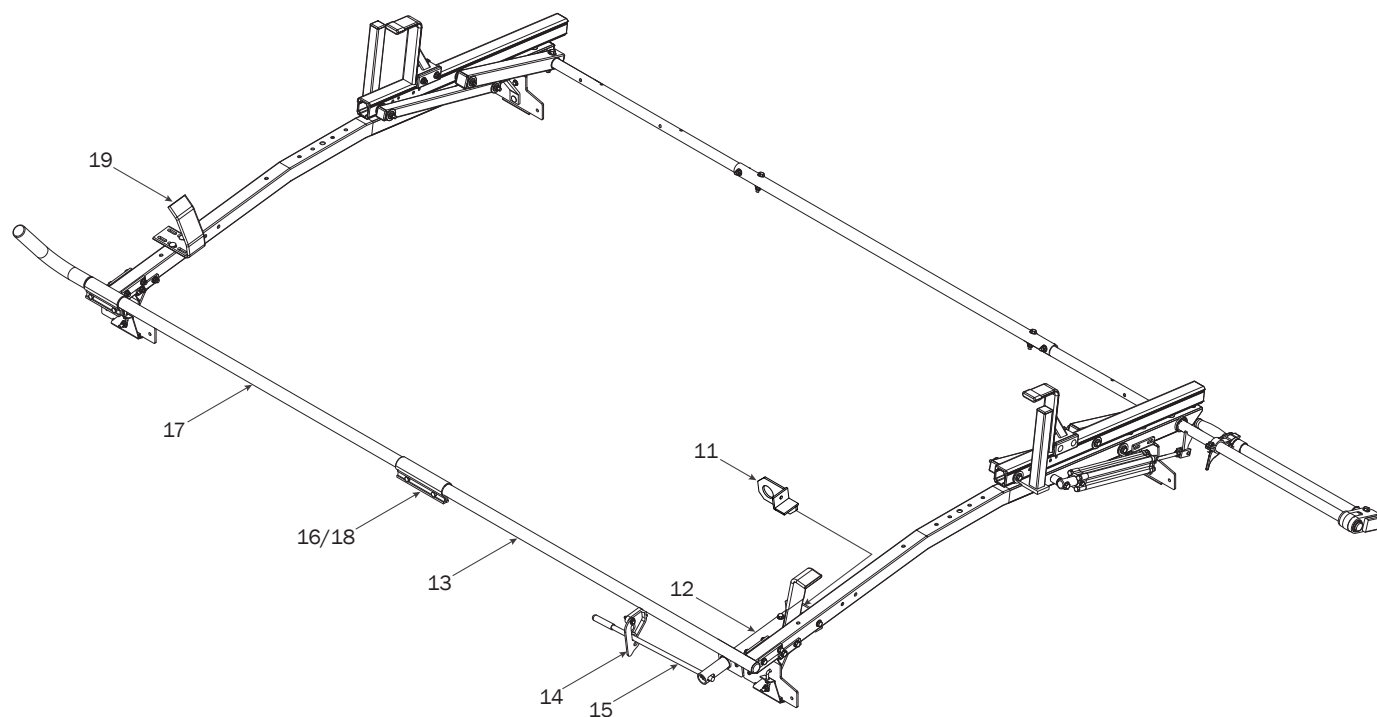
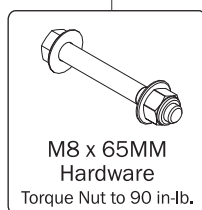
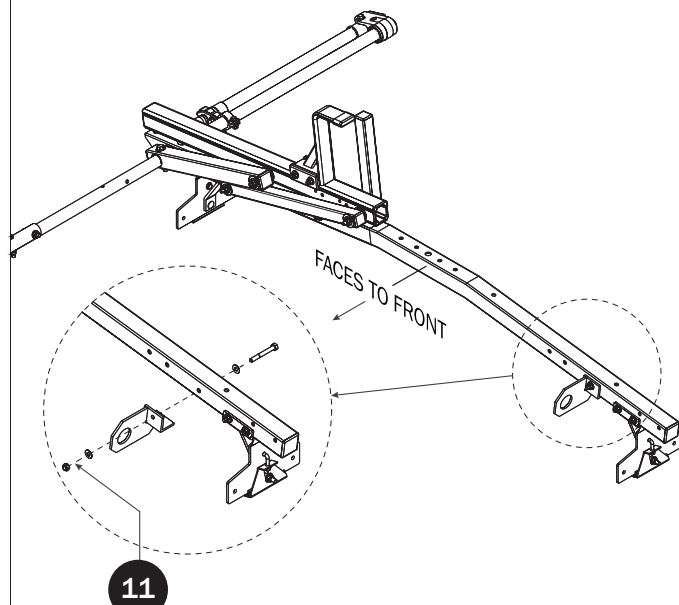
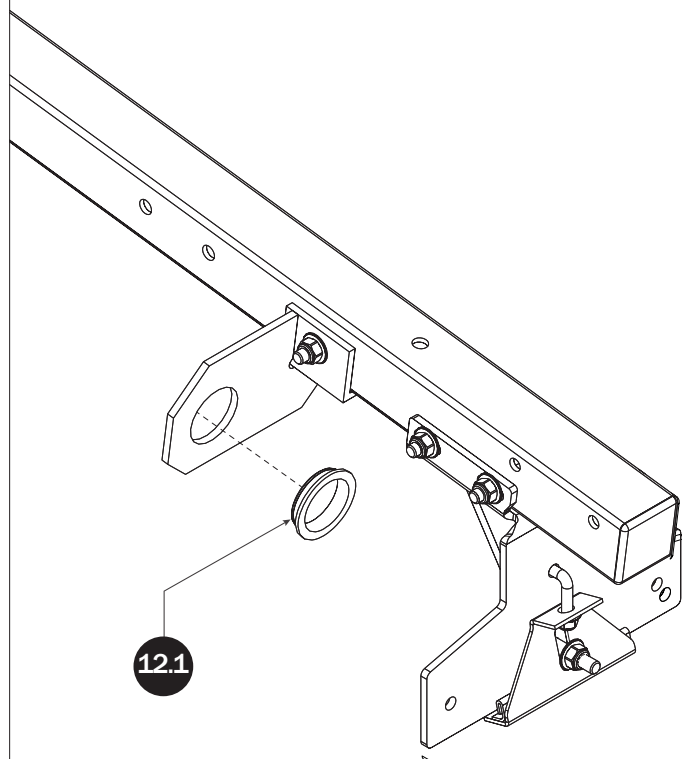
LEFT CLAMP DOWN ASSEMBLY SEQUENCE**CLAMP DOWN HANDLE
TUBE BRACKET****CLAMP DOWN HANDLE TUBE**

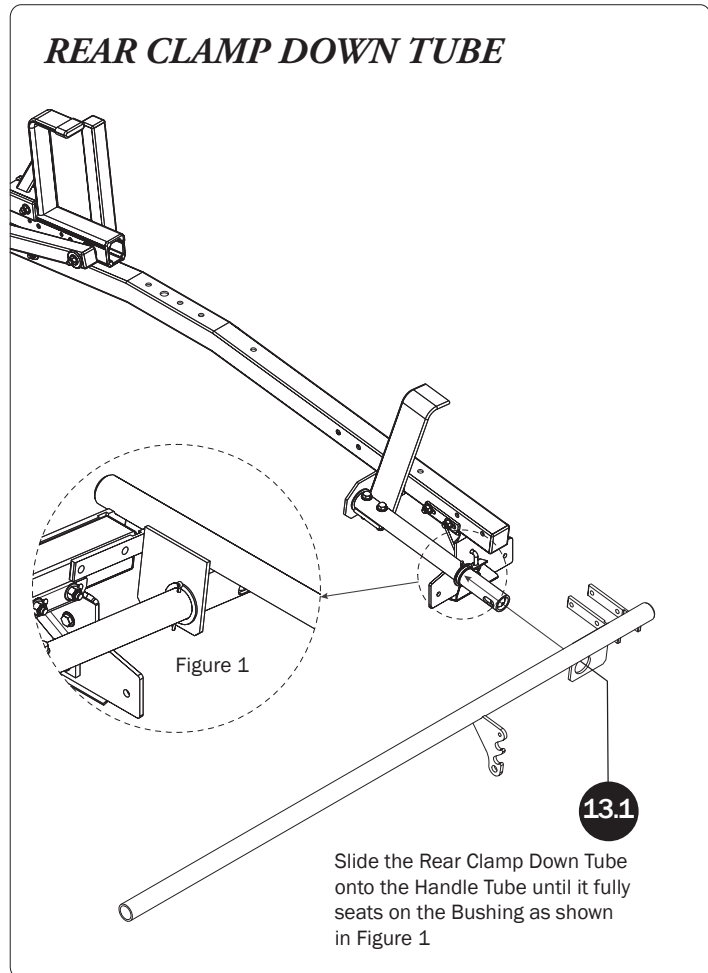
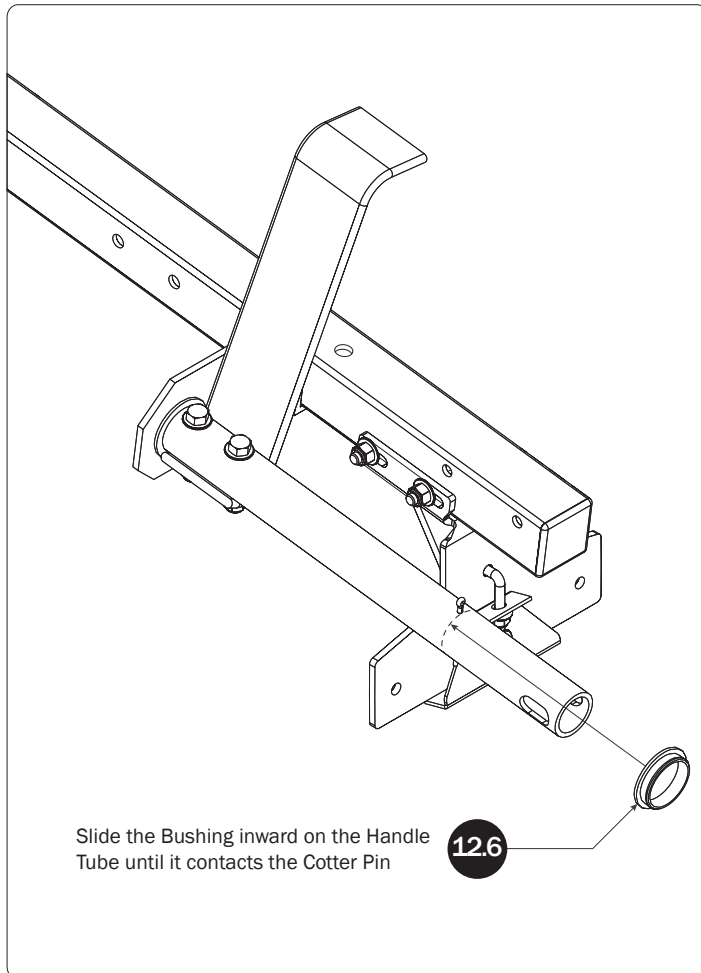
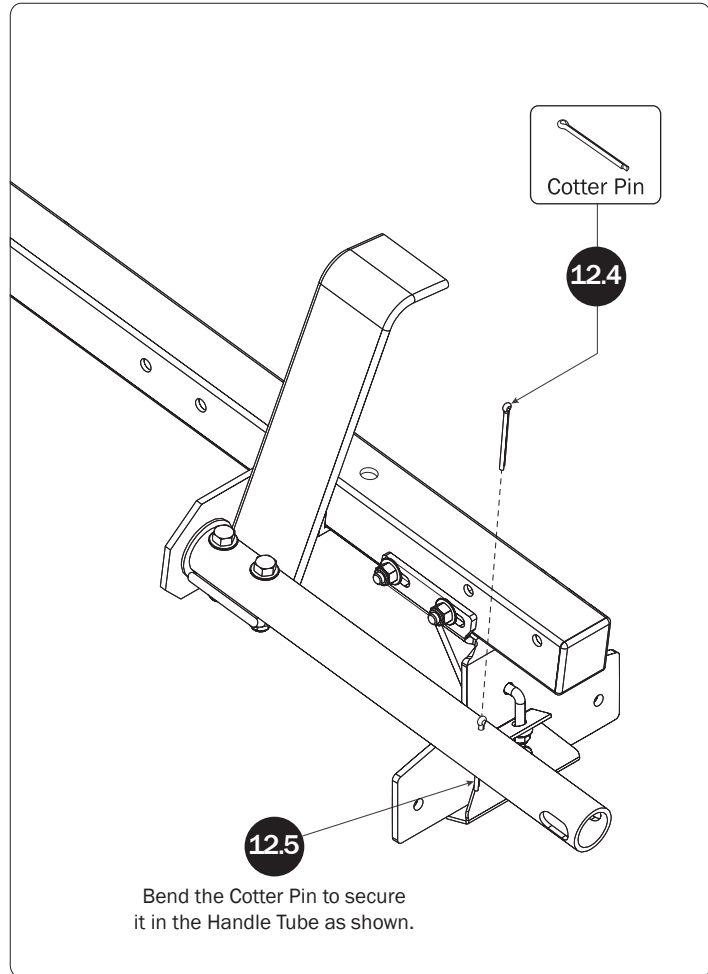
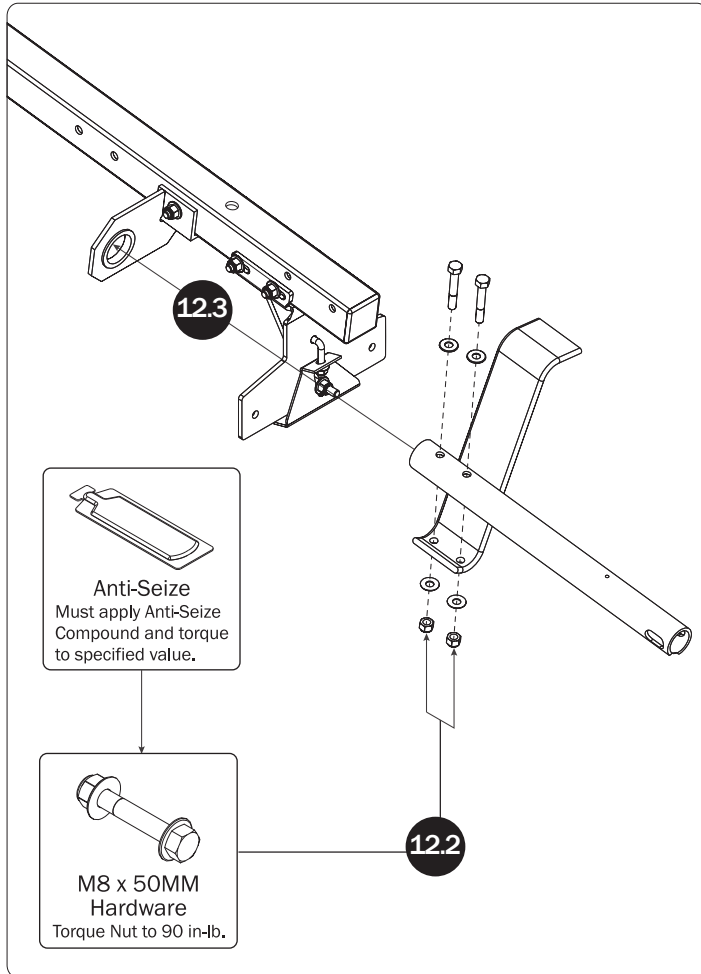

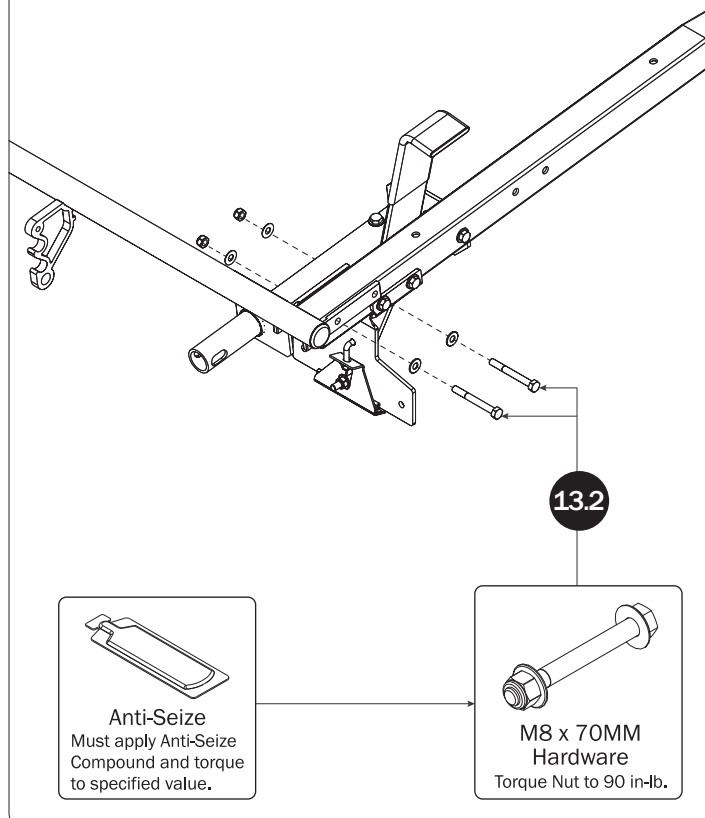
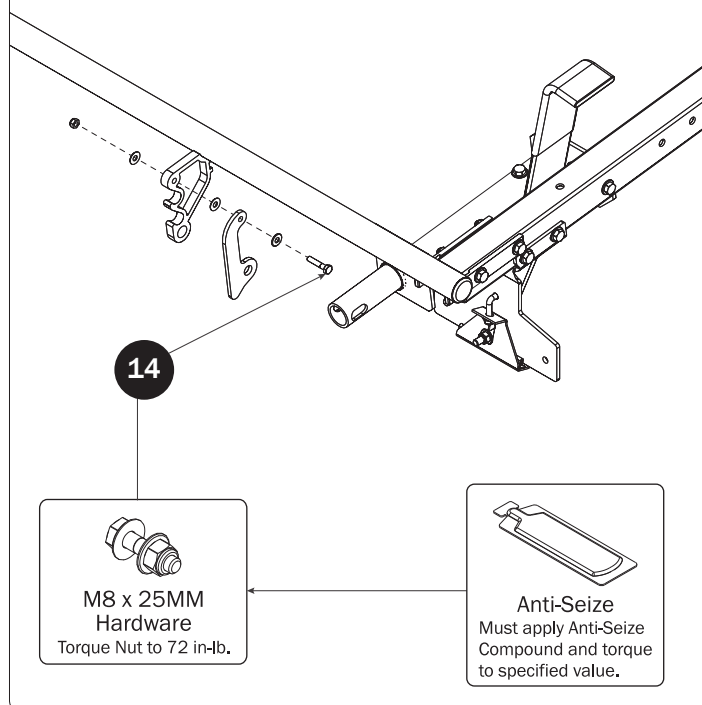
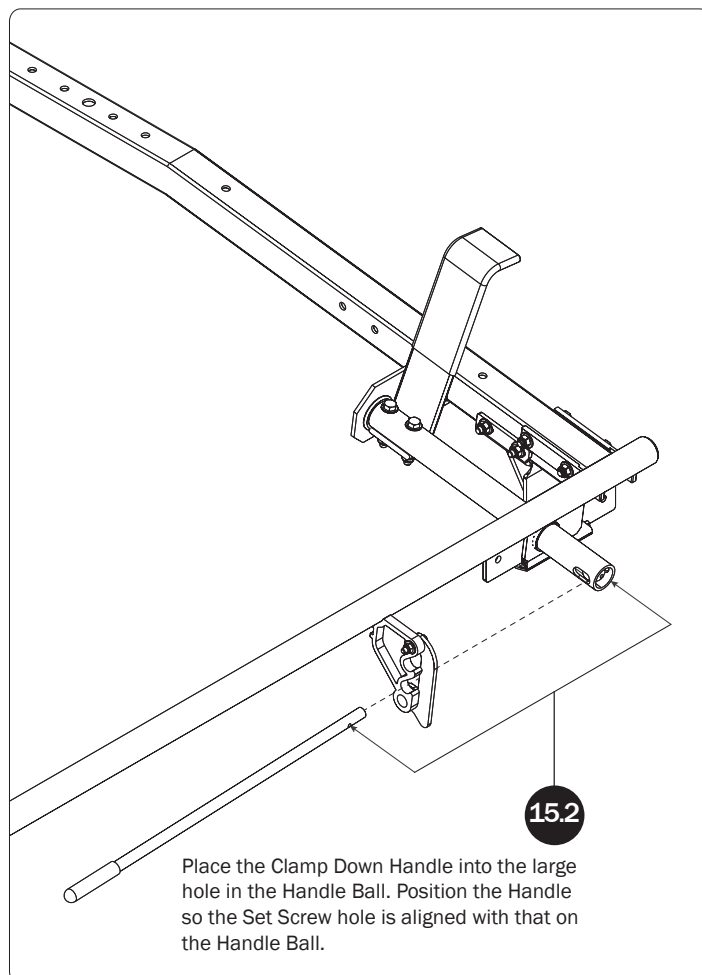
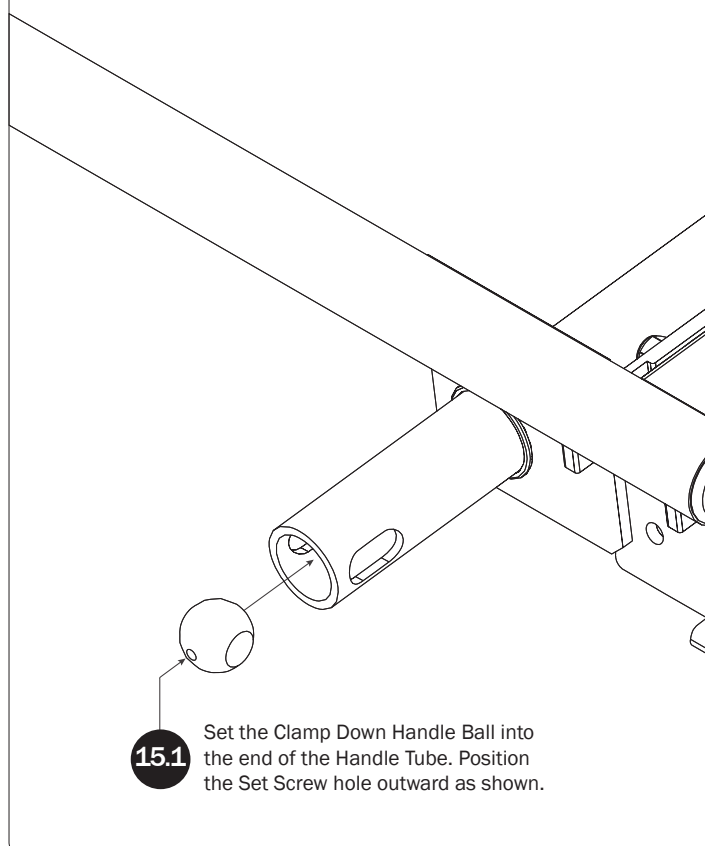
**HANDLE LATCH****CLAMP DOWN HANDLE**

15.3

Using an Allen Wrench, insert the Handle Set Screw through the Tube Ball and into the Handle. Torque to 55 in-lbs.

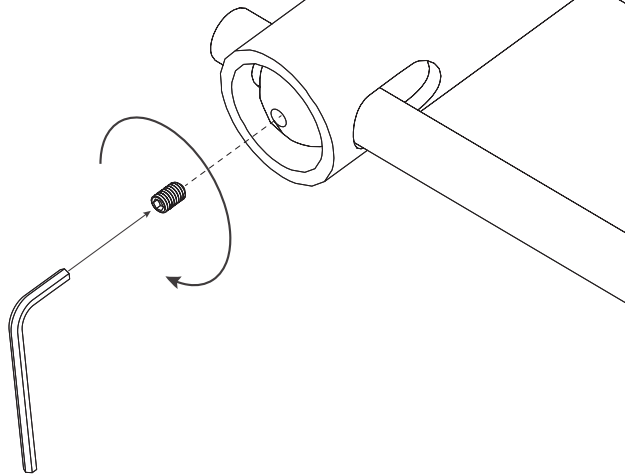

CLAMP DOWN TUBE SPLICE

16

Slide the Tube Splice onto the Rear Clamp Down Tube, but do not tighten until Step 18

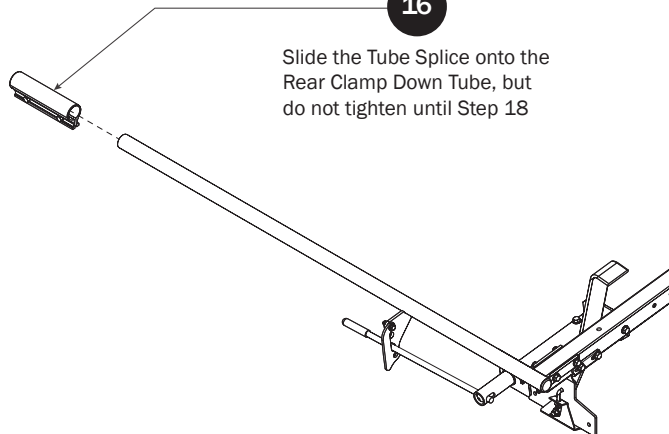

FRONT CLAMP DOWN TUBE

Align Clamp Tube tang holes to Crossbar.

17.1

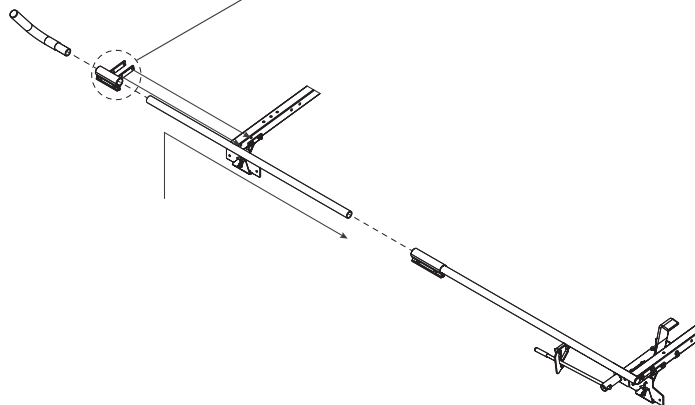
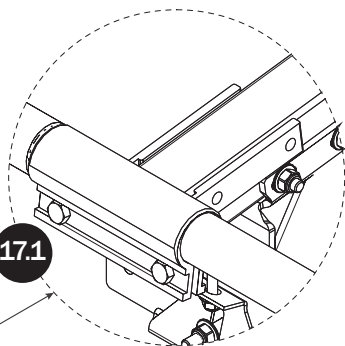

M8 x 70MM
Hardware

Torque Nut to 90 in-lb.

17.2

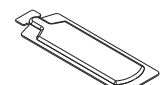
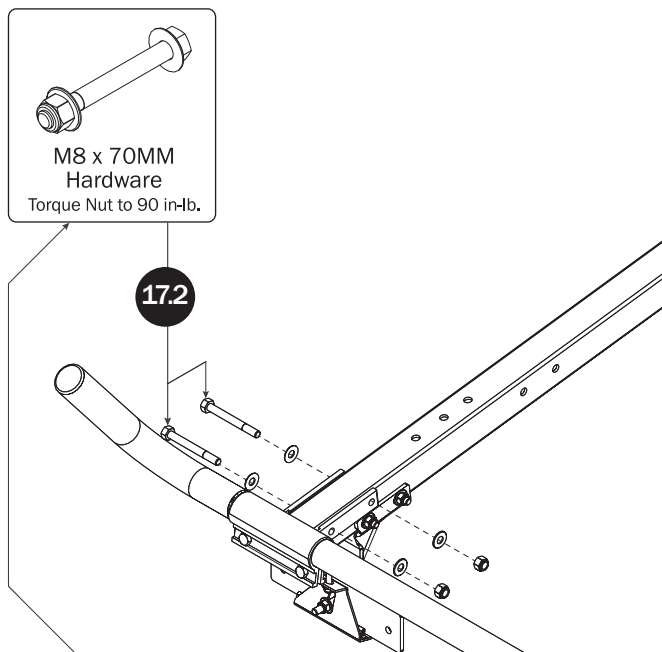

Anti-Seize
Must apply Anti-Seize
Compound and torque
to specified value.

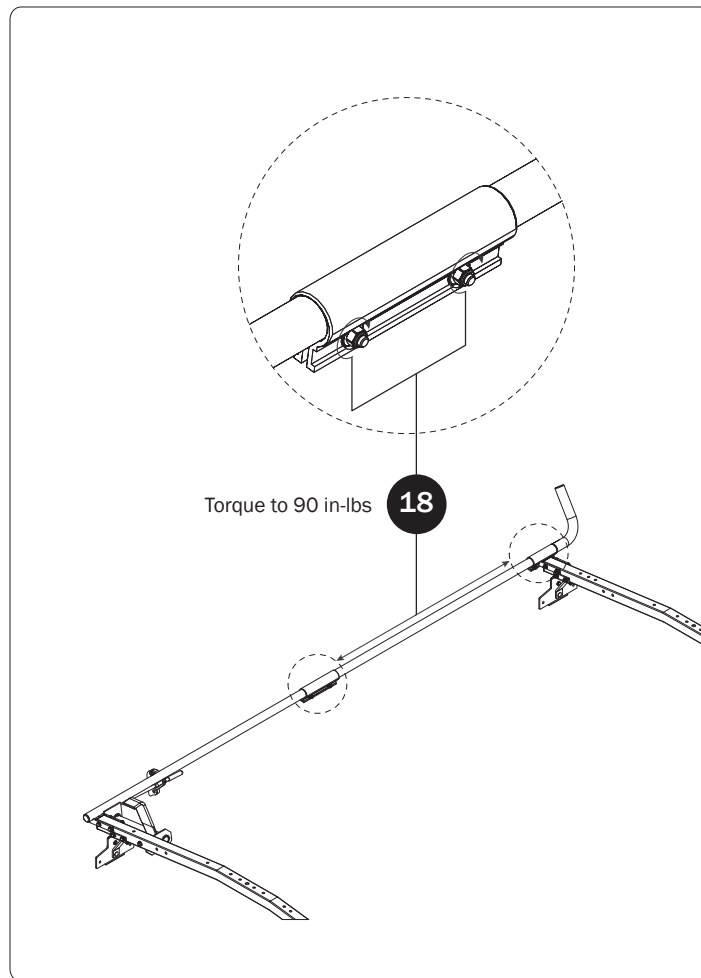

CYLINDER ADJUSTMENT

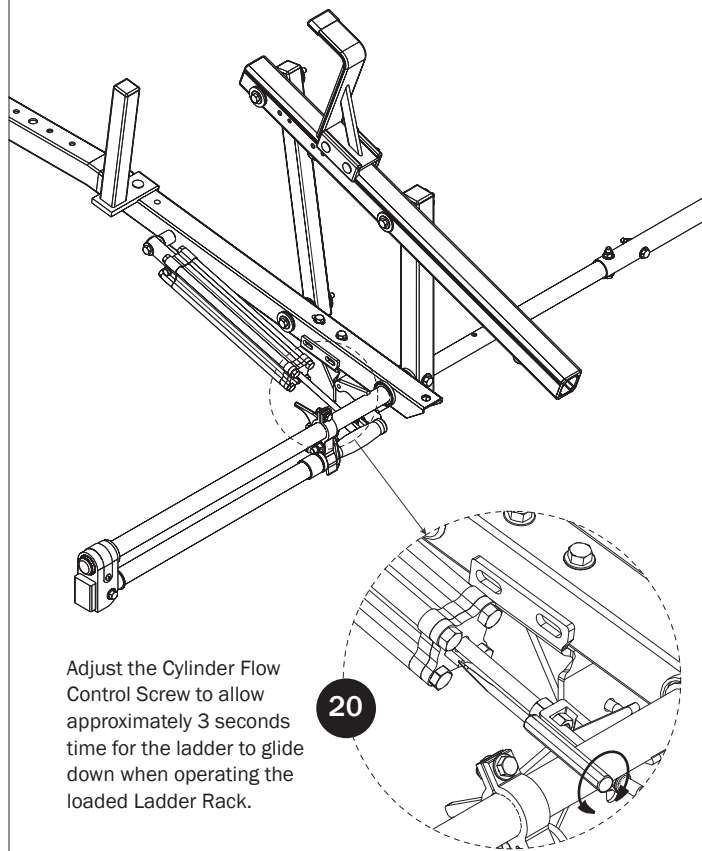

FRONT LADDER HOOK

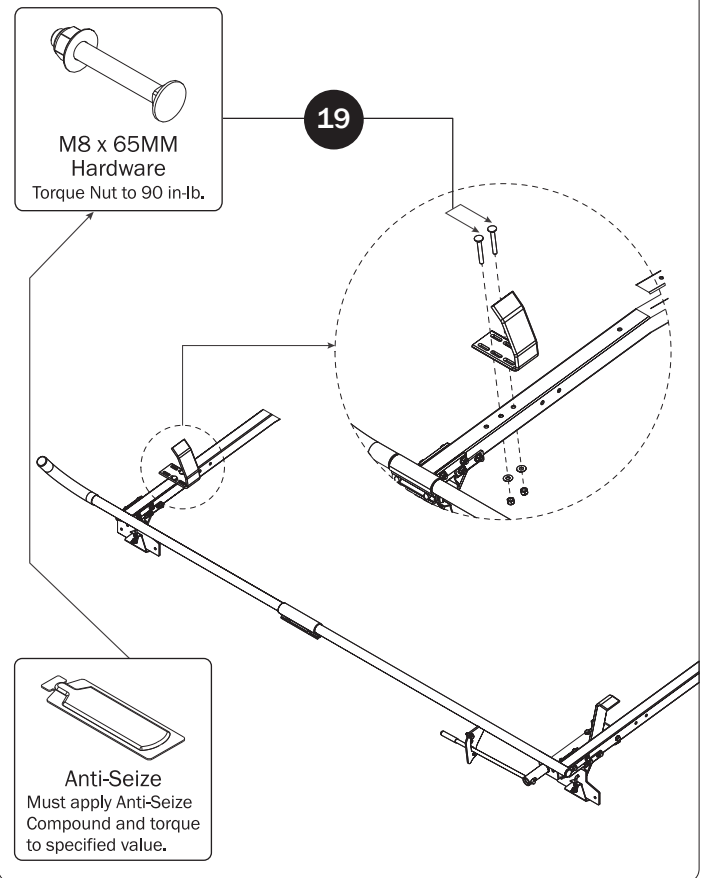

Page Intentionally Left Blank

