

PRIME DESIGN™

A Safe Fleet Brand

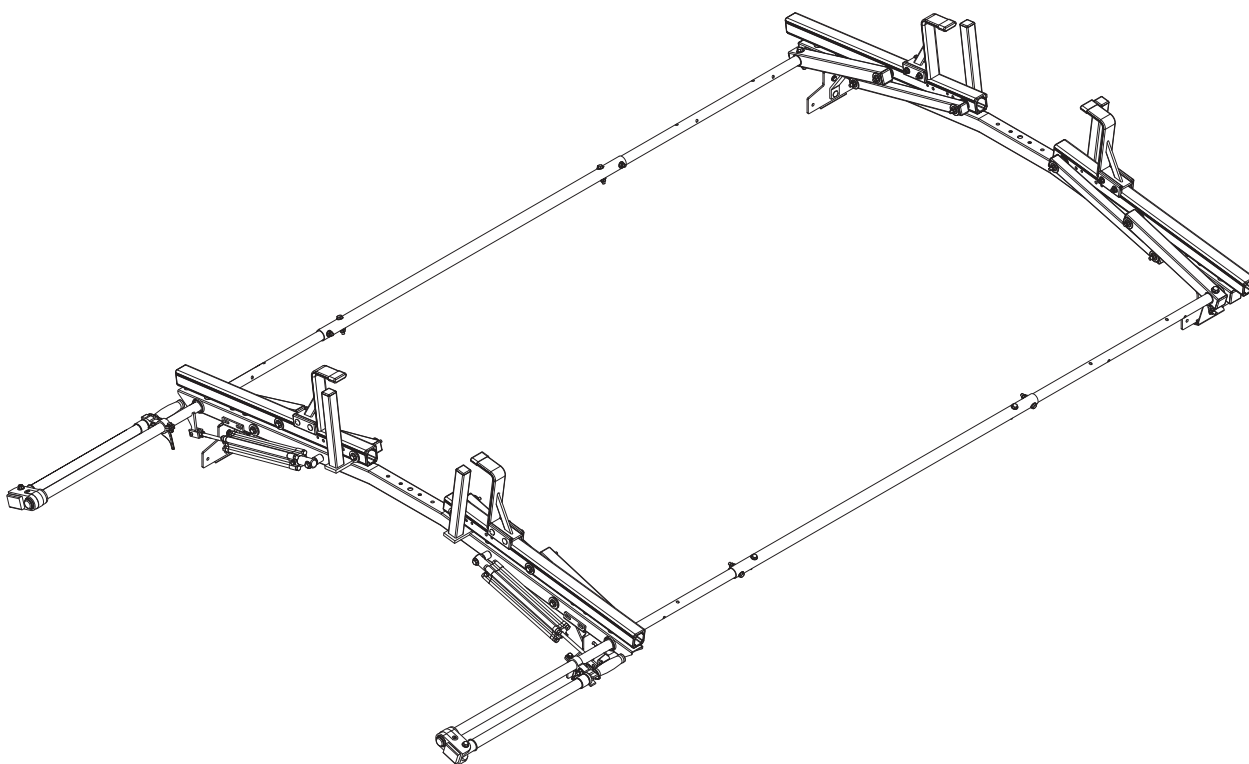

VRP 226

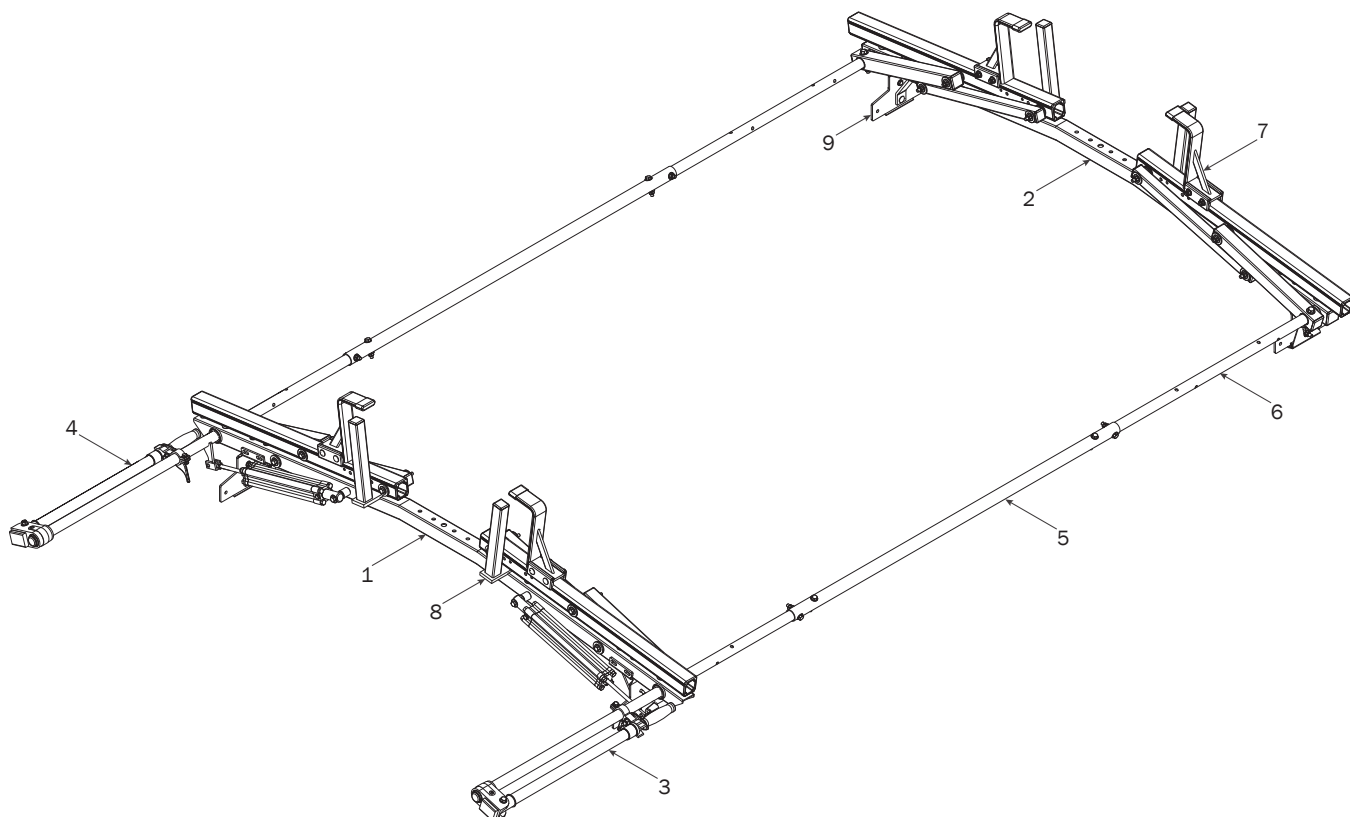

1—Rear Crossbar..... (Qty 1)

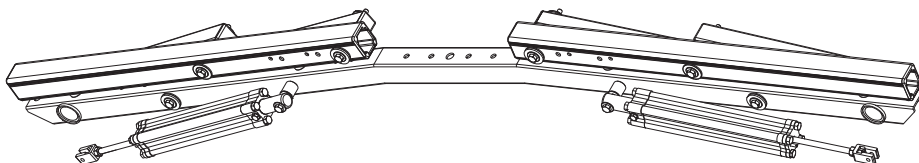

2—Front Crossbar (Qty 1)

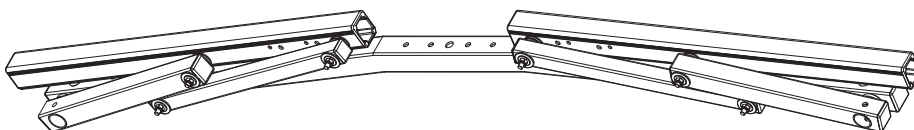

3—Rear Drive Shaft..... (Qty 1)
Right Hand, B4 Version, 50.00"

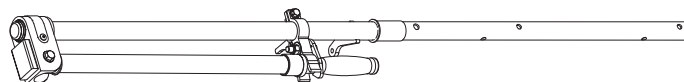

4—Rear Drive Shaft..... (Qty 1)
Left Hand, B4 Version, 50.00"

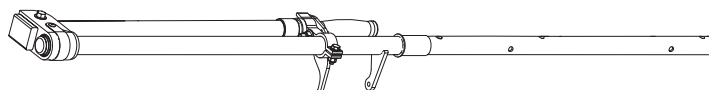

5—Connecting Bar..... (Qty 2)
48.00"

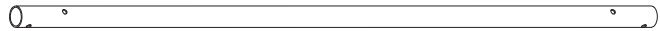

6—Front Drive Shaft..... (Qty 2)
B Version, 35.75"

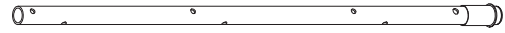

7—Z Post..... (Qty 4)
Adjustable, 7.25"

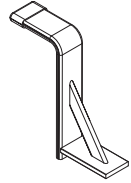

8—L Post..... (Qty 4)
9.25", Gen1

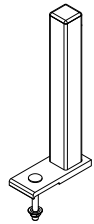

9—Mounting Bracket Assembly..... (Qty 4)
Low Mounting, 4.5", GM

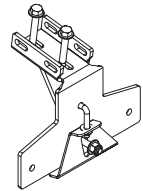

10—HKT-8163-Rotation Hardware Kit..... (Qty 2)
(Not called out in Overview)

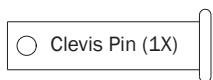

Clevis Pin (1X)

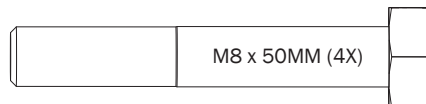

M8 x 50MM (4X)

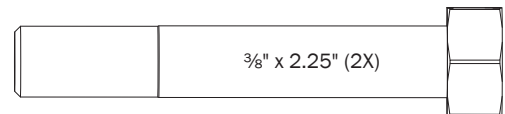

3/8" x 2.25" (2X)

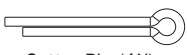

Cotter Pin (1X)

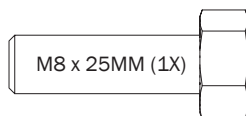

M8 x 25MM (1X)

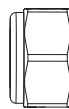

M8 Lock Nut (5X)



3/8" Lock Nut (2X)

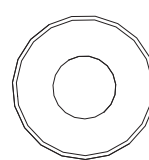

5/16" Flat Washer (10X)

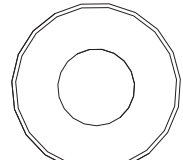

3/8" Flat Washer (4X)

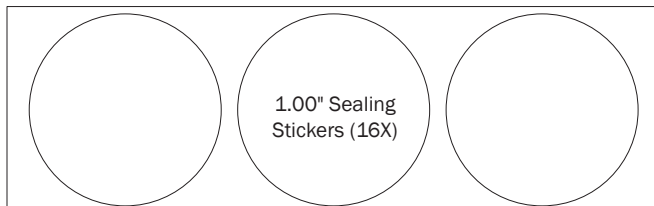

1.00" Sealing
Stickers (16X)



Anti-Seize (1X)

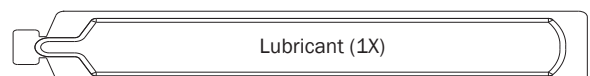

Lubricant (1X)

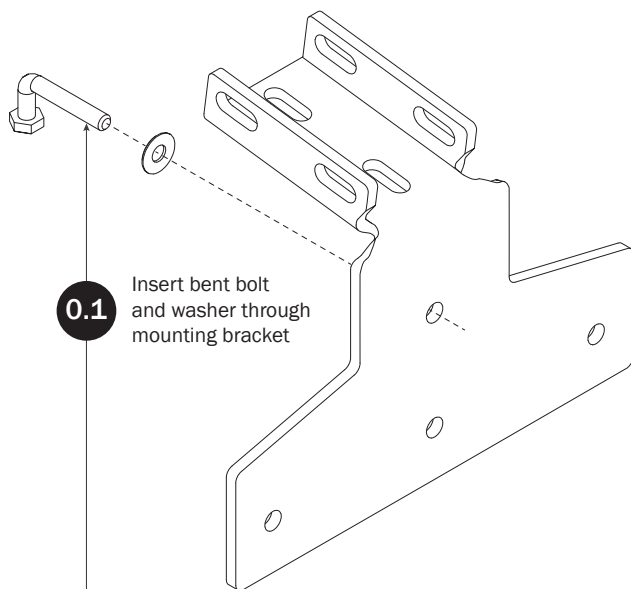
MOUNTING BRACKETS
BRACKET PRE-ASSEMBLY

0.1 Insert bent bolt and washer through mounting bracket

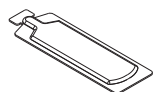

Anti-Seize
Must apply Anti-Seize Compound and torque to specified value.

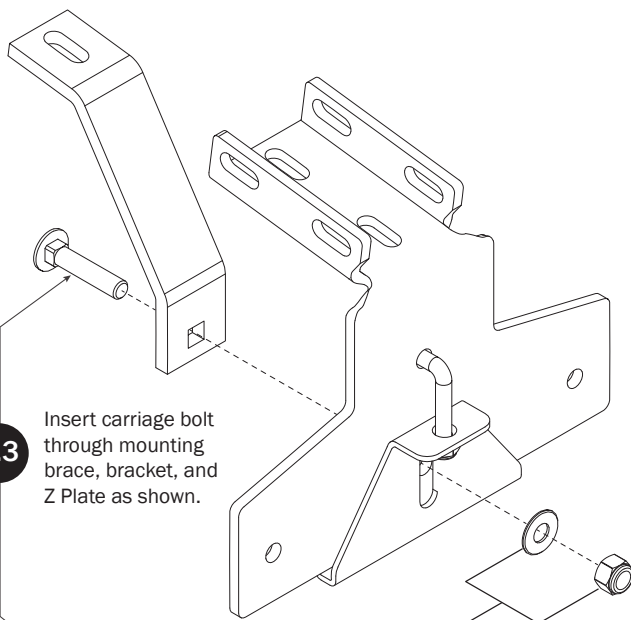

0.3 Insert carriage bolt through mounting brace, bracket, and Z Plate as shown.

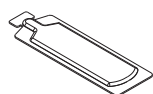

Anti-Seize
Must apply Anti-Seize Compound and torque to specified value.

0.4

Secure mounting assembly with washer and nut. Do not tighten until the rack is mounted onto the vehicle.

0.2

Assemble the Z Plate and secure with washer and nut. Do not tighten until the rack is mounted onto the vehicle.

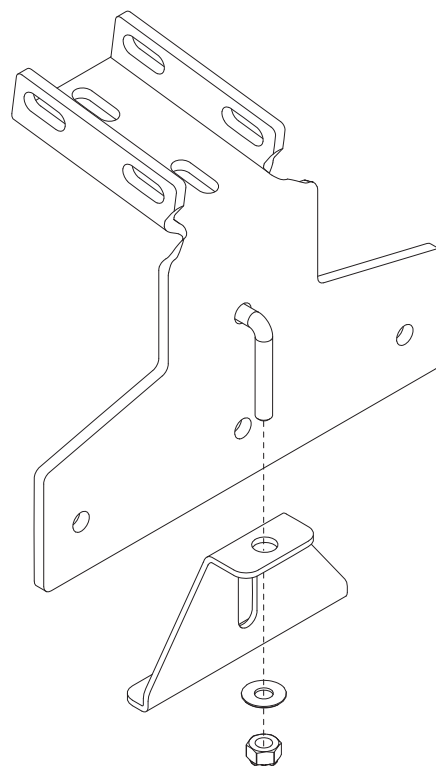

0.5

Repeat Steps 0.1–0.4 to assemble the remaining Mounting Brackets.

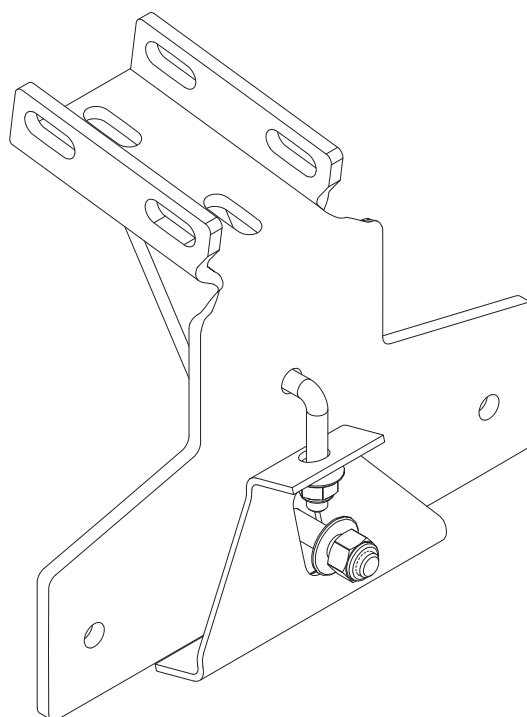

RIGHT ROTATION ASSEMBLY SEQUENCE

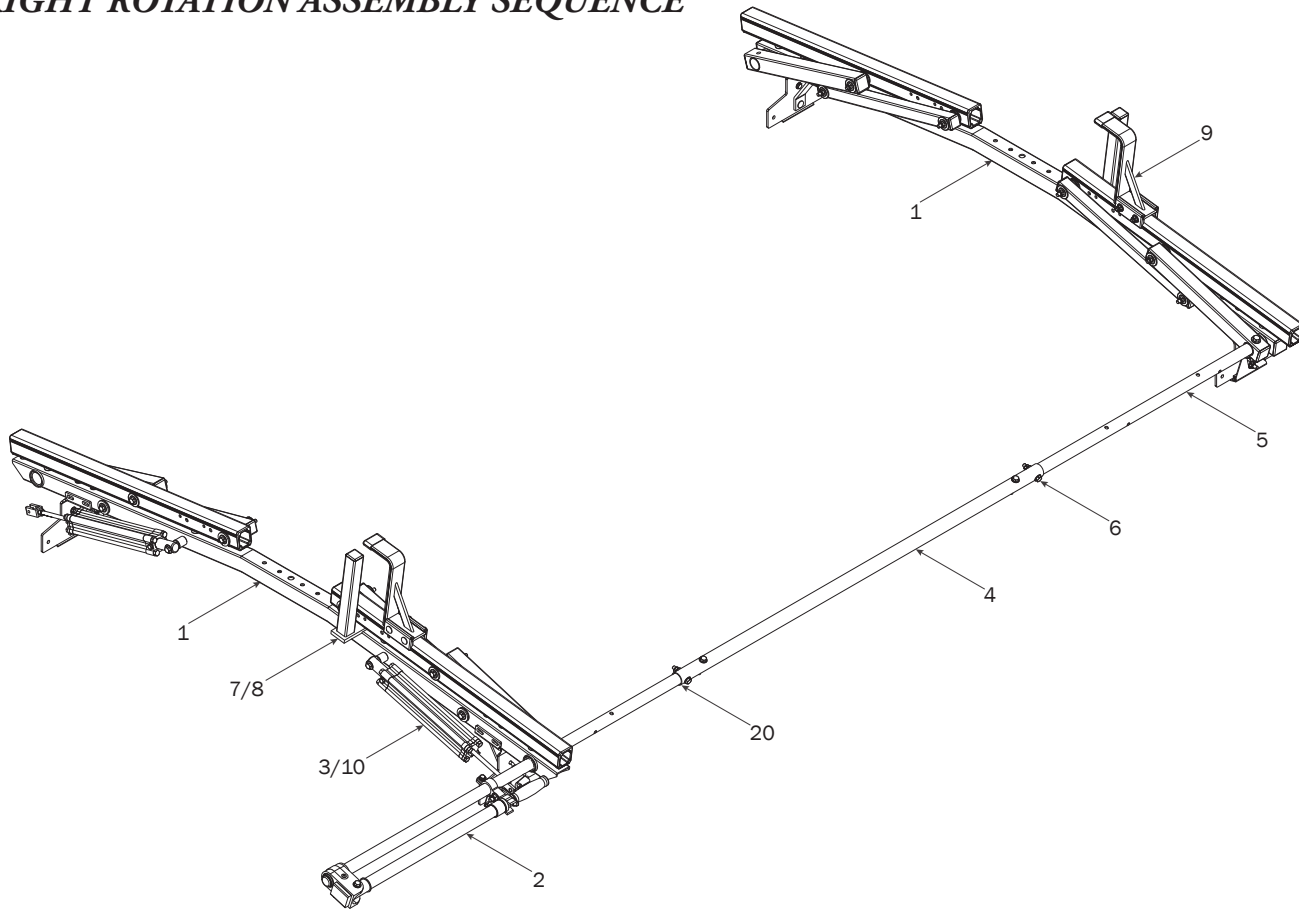

CROSSBARS

- 1.1** Apply Anti-Seize compound to Mounting Bracket bolts

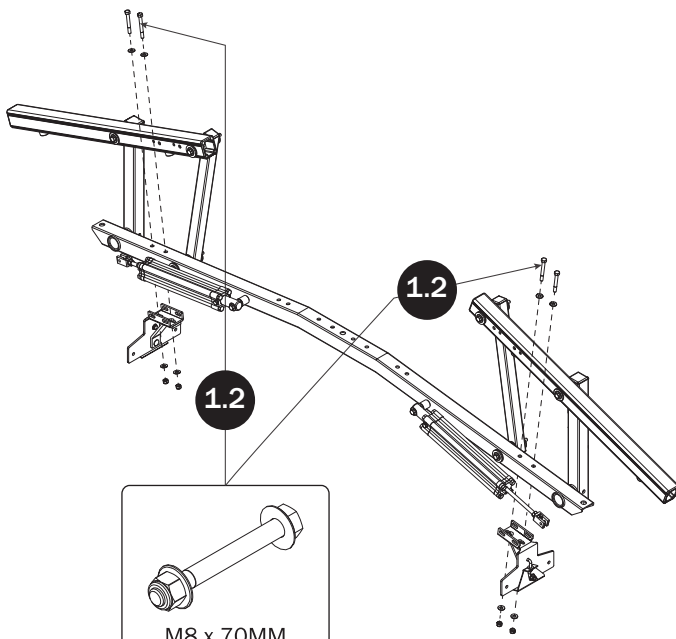

M8 x 70MM Hardware
Torque Nut to 90 in-lb.

- 1.3** Repeat Steps 1.1 - 1.2 to install the remaining Mounting Brackets onto the Front Crossbars.

REAR DRIVE SHAFT

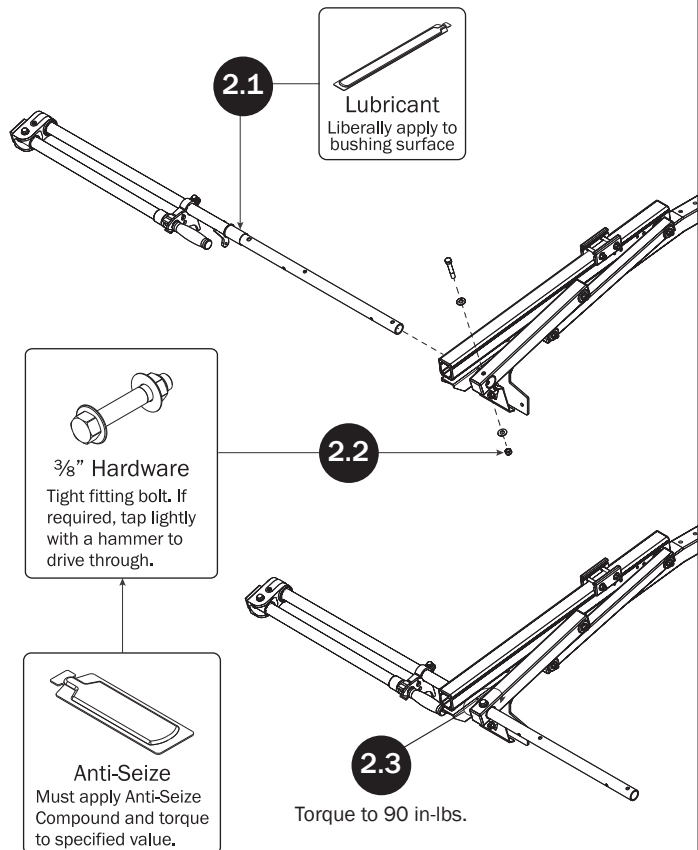

2.1 Lubricant
Liberal apply to bushing surface

3/8" Hardware
Tight fitting bolt. If required, tap lightly with a hammer to drive through.

Anti-Seize
Must apply Anti-Seize Compound and torque to specified value.

2.2

2.3
Torque to 90 in-lbs.

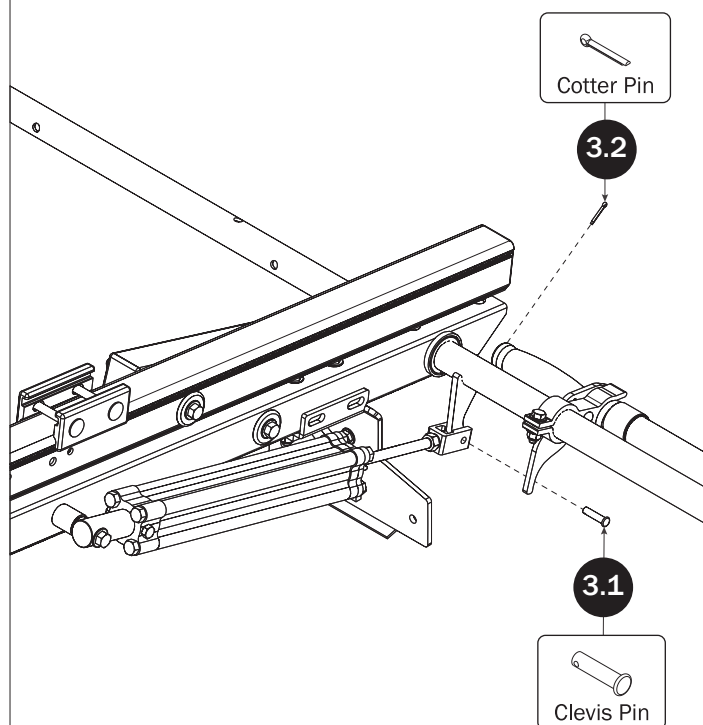
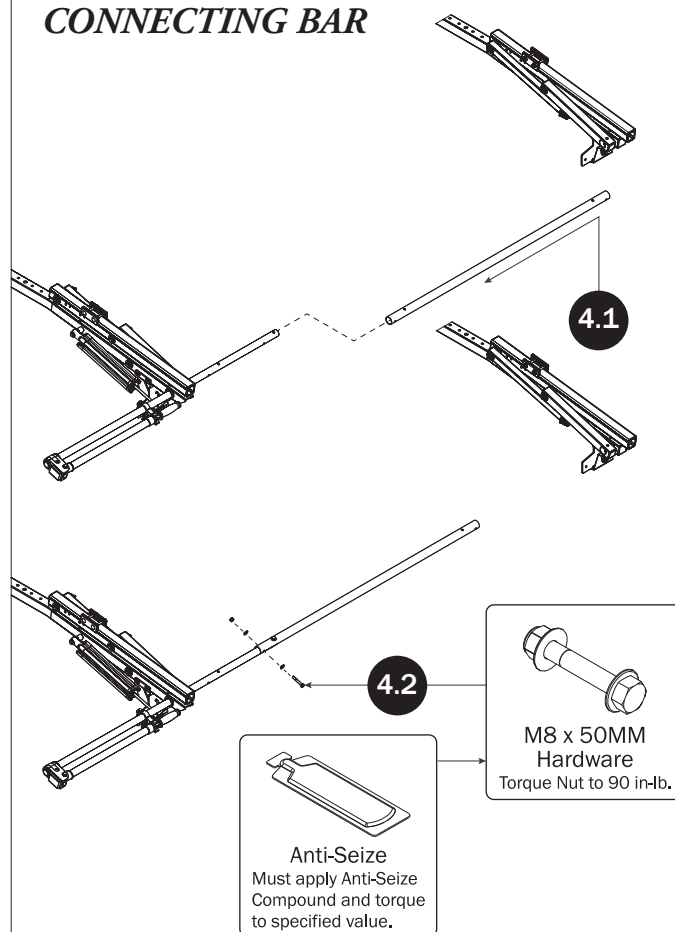
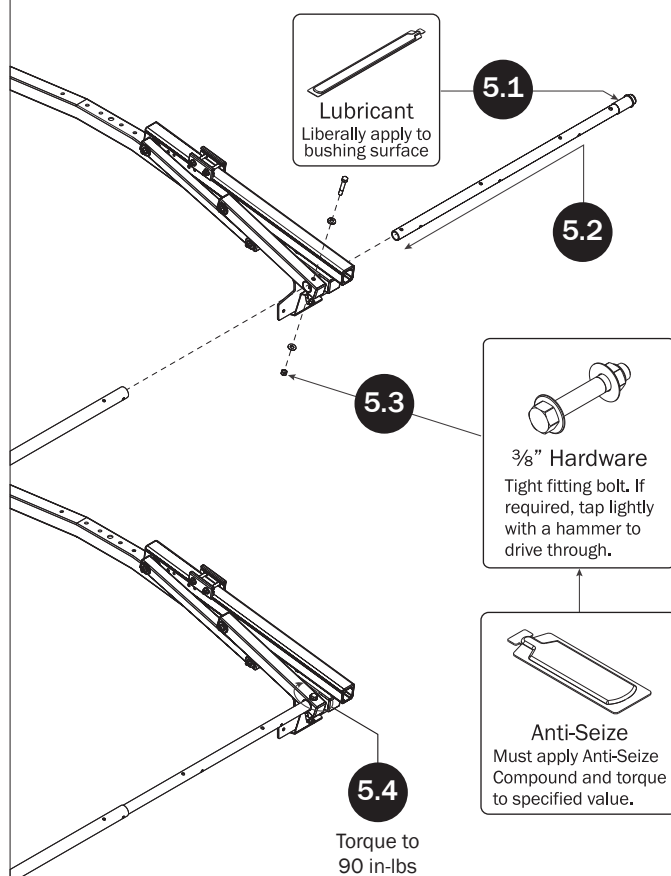
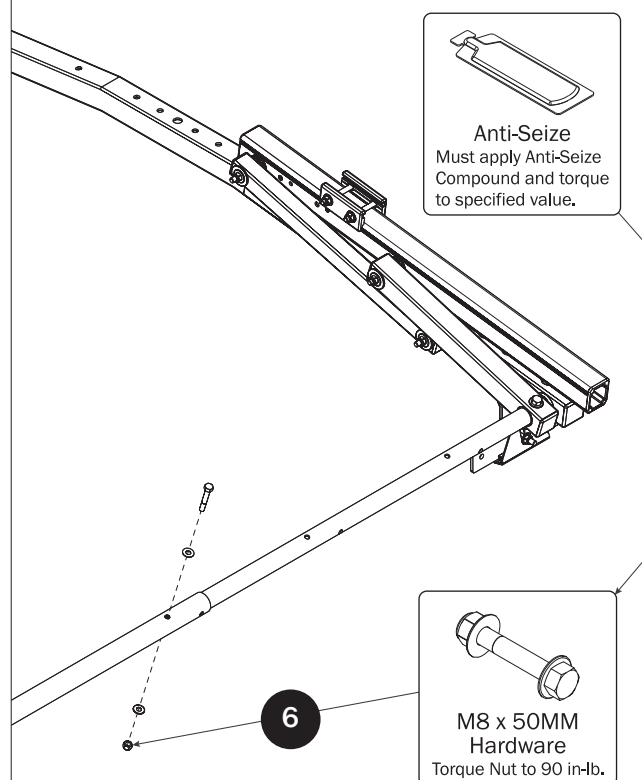
CYLINDER ASSEMBLY**CONNECTING BAR****FRONT DRIVE SHAFT****CONNECTING BAR FASTENERS**

CROSSBAR SEALING

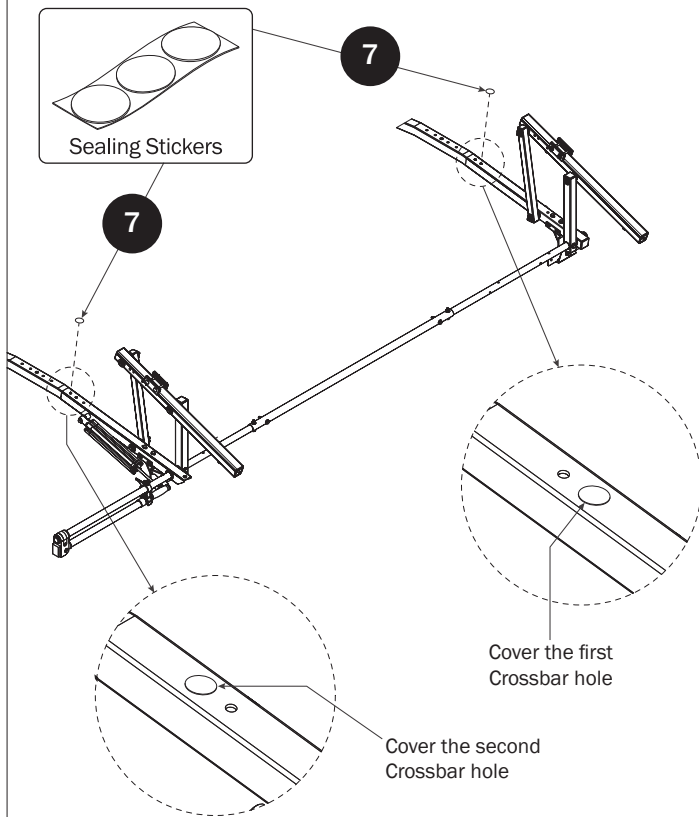

L POSTS

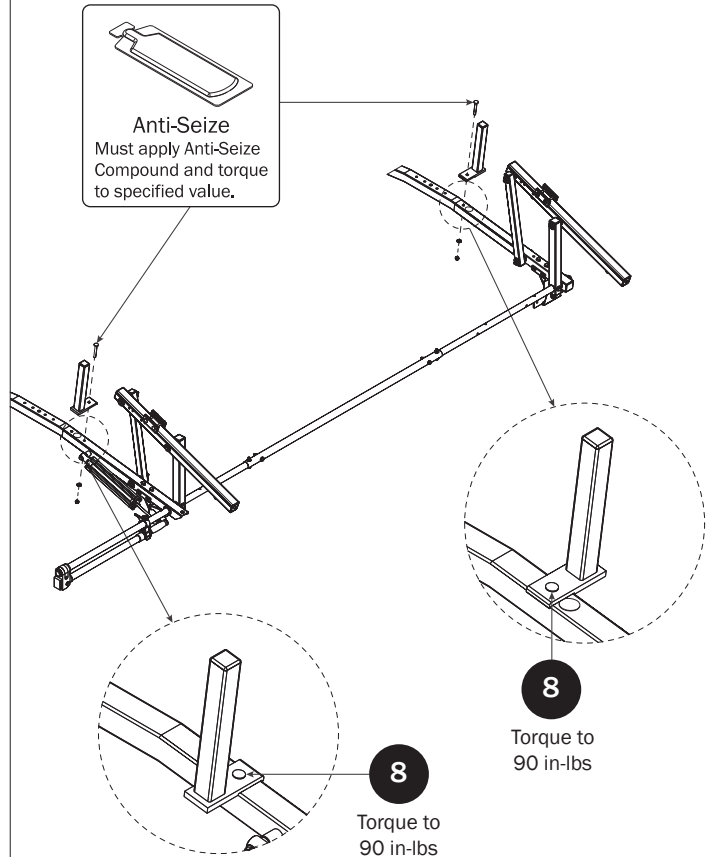

Z POSTS

SEE QUICK START GUIDE FOR ADJUSTMENTS

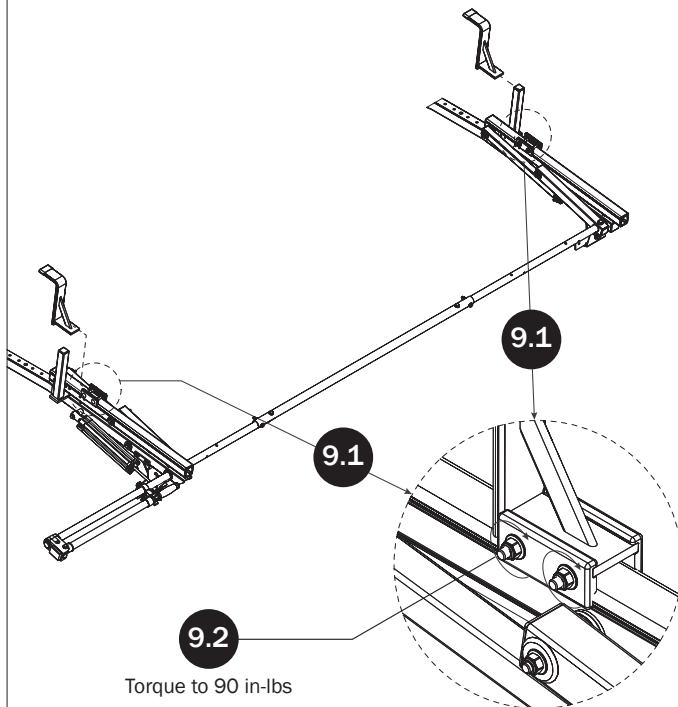

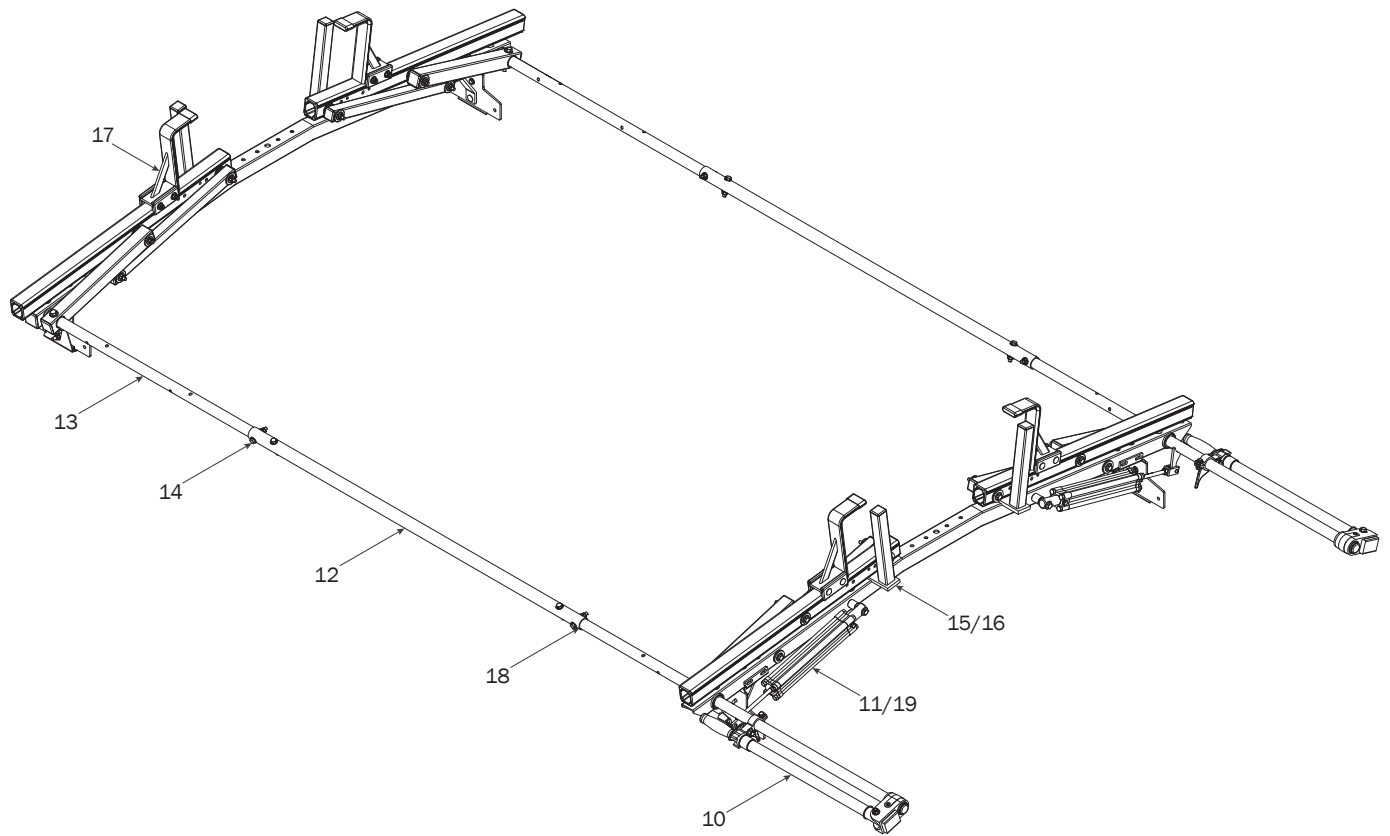
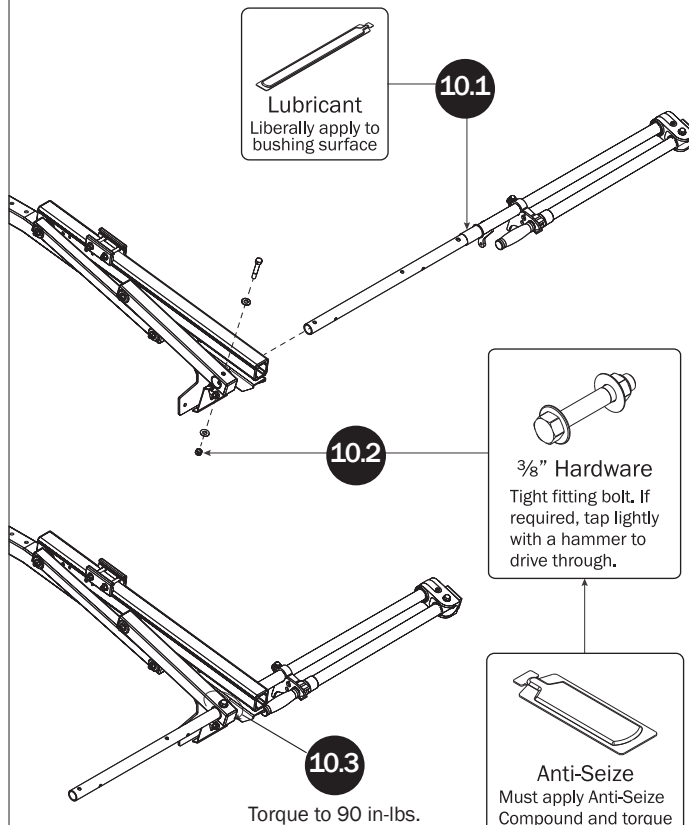
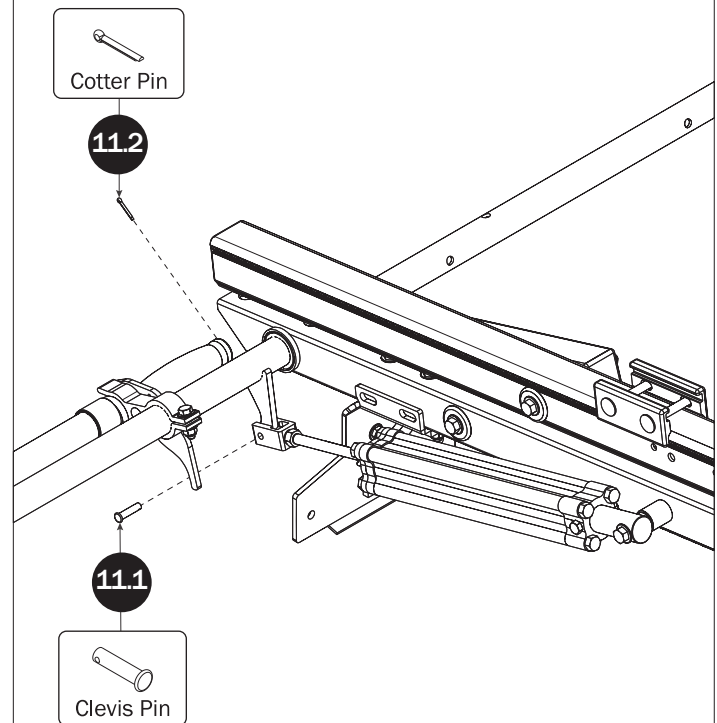
LEFT ROTATION ASSEMBLY SEQUENCE**REAR DRIVE SHAFT****CYLINDER ASSEMBLY**

CONNECTING BAR

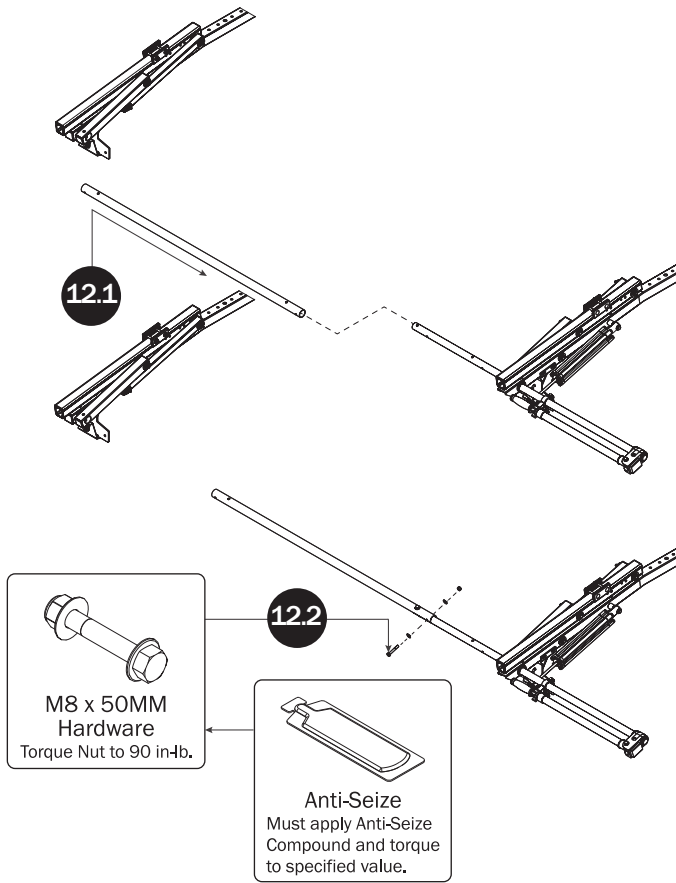

FRONT DRIVE SHAFT

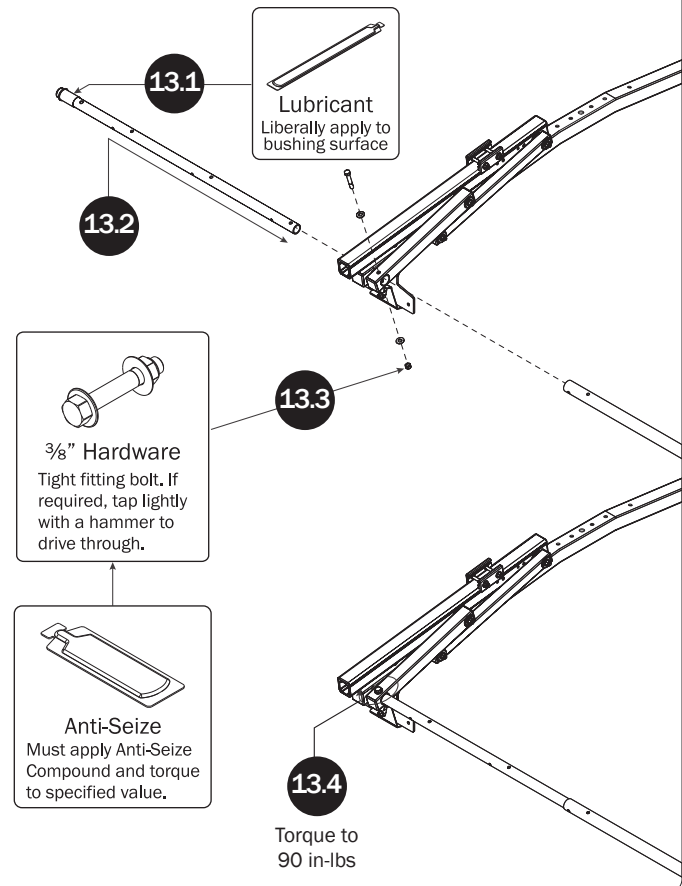

CONNECTING BAR FASTENERS

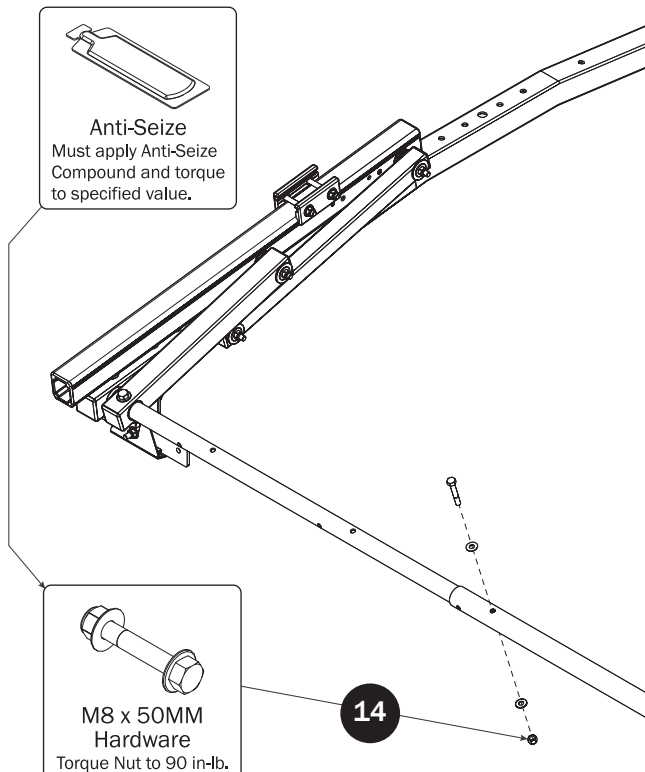

CROSSBAR SEALING

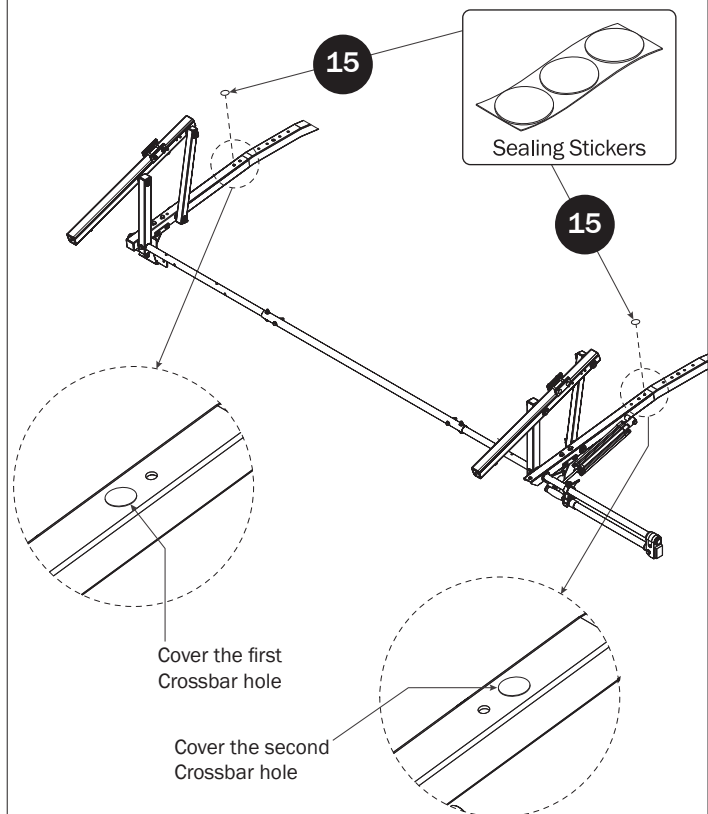

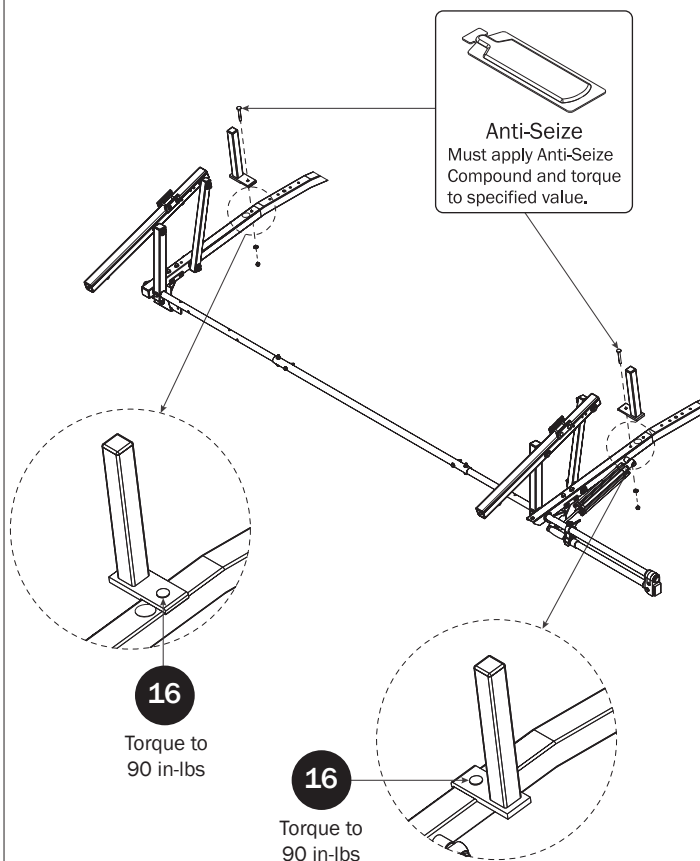
L POSTS**Z POSTS**

SEE QUICK START GUIDE FOR ADJUSTMENTS

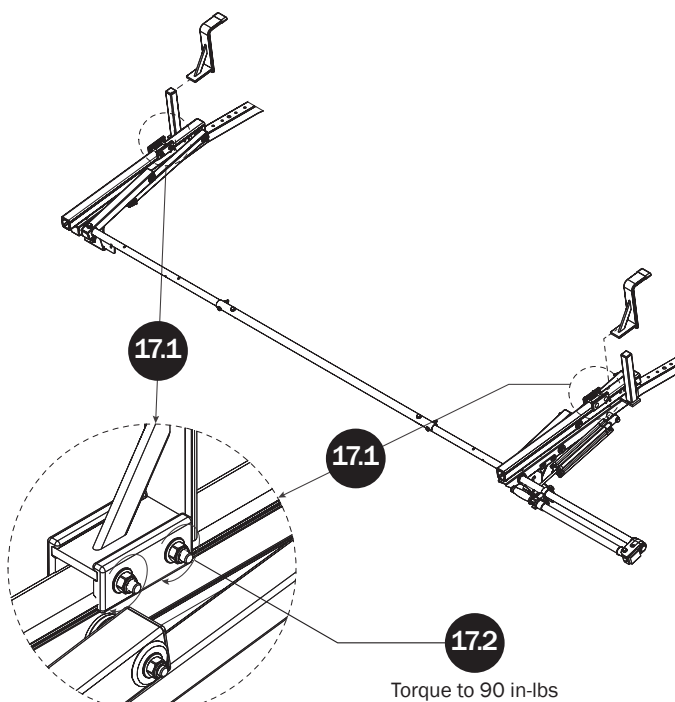
**DRIVE SHAFT SEALING**

***Installer Note:** The Left and Right Hand Rear Drive Shafts may have additional bolt holes. If present, cover those holes with Stickers to prevent water intrusion.

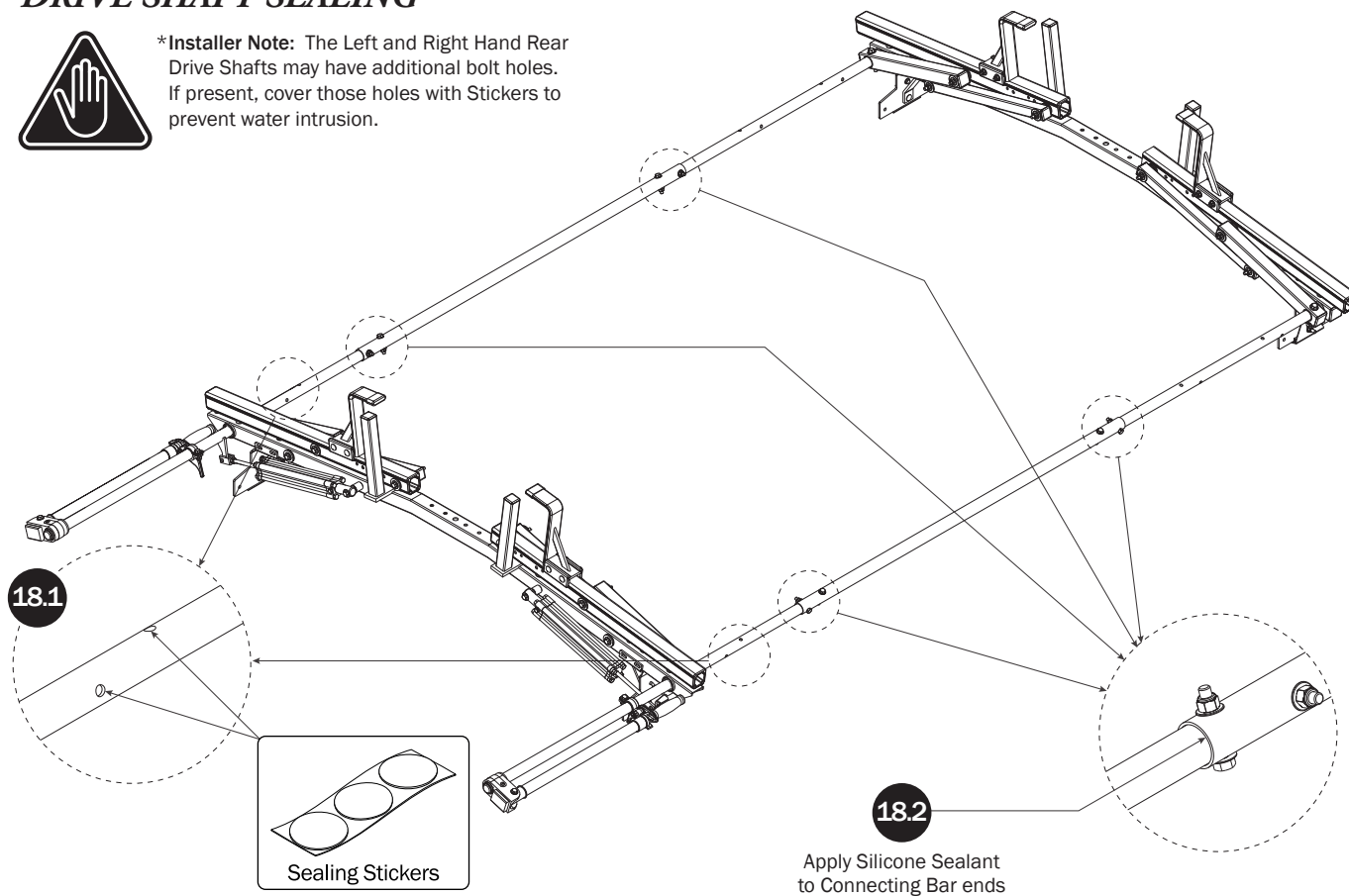

CYLINDER ADJUSTMENT

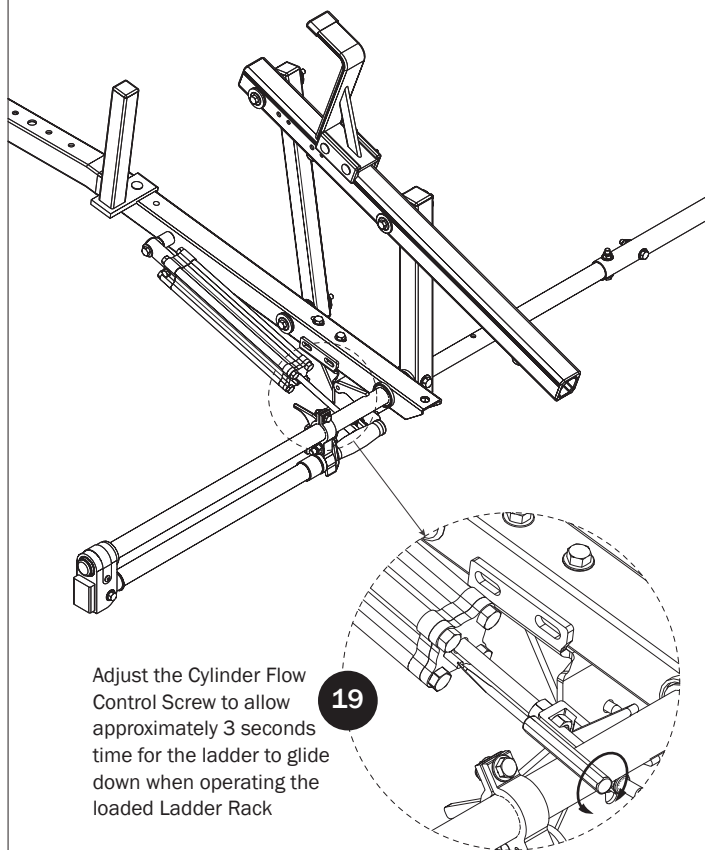

Adjust the Cylinder Flow Control Screw to allow approximately 3 seconds time for the ladder to glide down when operating the loaded Ladder Rack

19

