

PRIME DESIGN™

A Safe Fleet Brand

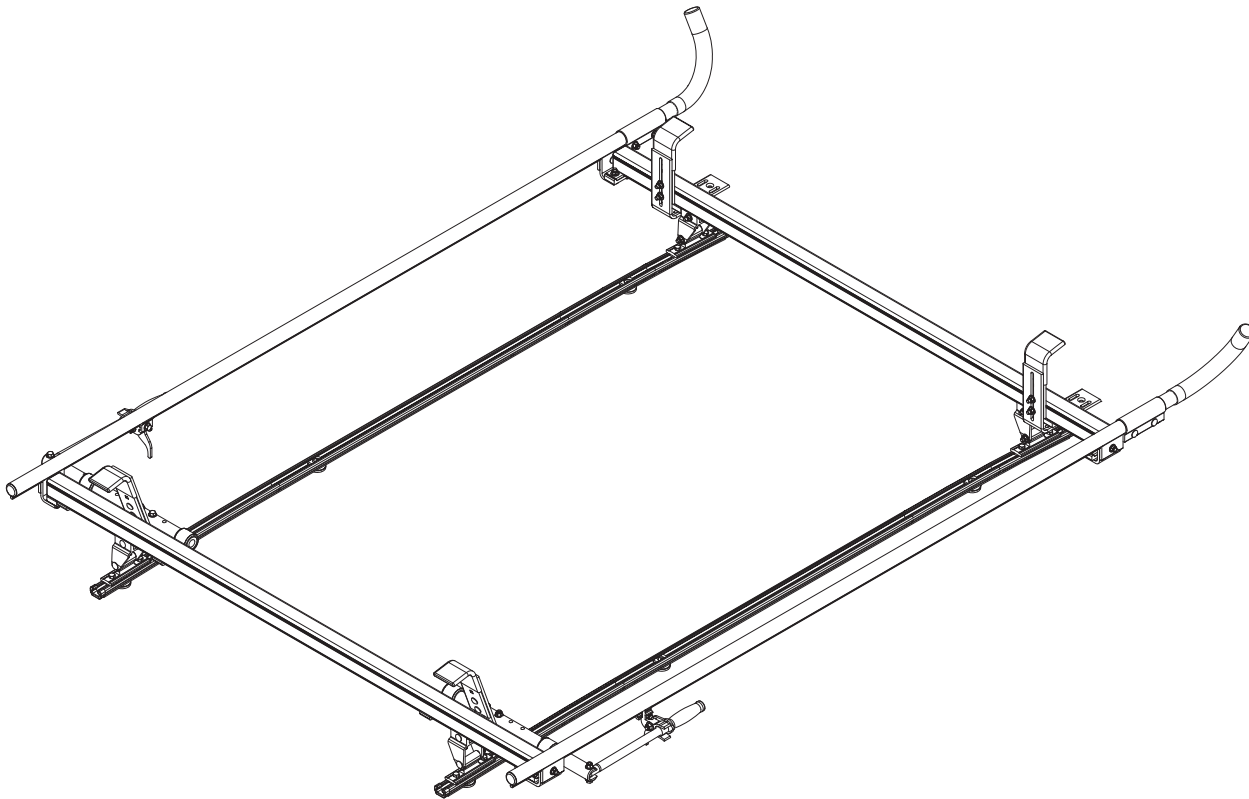

VCC **W200**

CONTENTS OVERVIEW

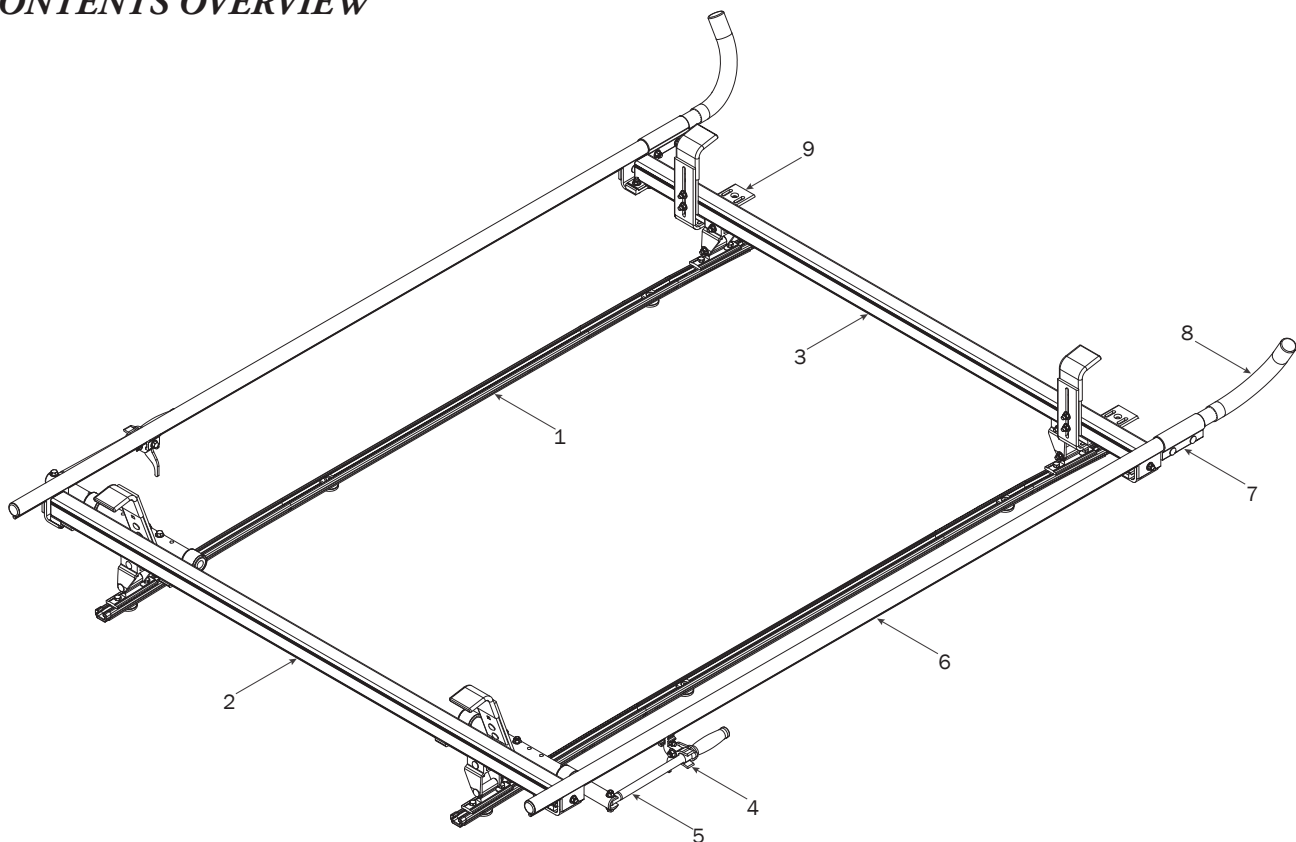

1—FBM-0045 (Qty 1)
Channels w/Hardware



Channels (2X)

End Caps (4X)

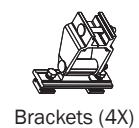

Brackets (4X)

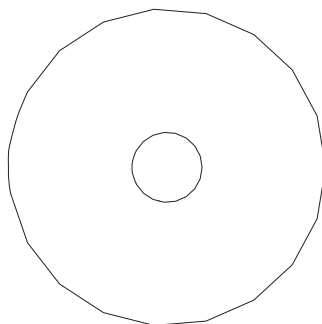

Nylon Washer (6X)

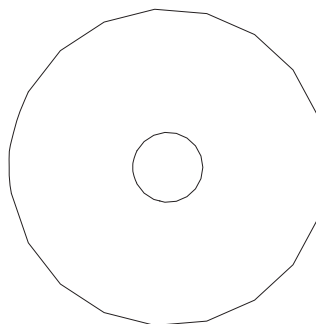

Foam Gasket (6X)

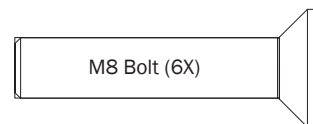

M8 Bolt (6X)

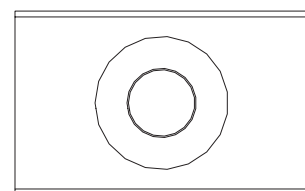

Flex Channel Connector (6X)

2—Rear Crossbar Assembly (Qty 1)



3—Front Crossbar Assembly (Qty 1)



4—Handle Latch Assembly (Qty 2)



5—Clamp Down Handle Assembly (Qty 2)
With Hardware

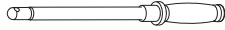

M8 Lock Nut (4X)

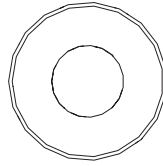

Flat Washer (8X)



M8 x 45MM (1X)

6—Clamp Down Tube (Qty 2)
80.00" Long



7—Quick Clamp Tube Splice Assembly (Qty 2)
5.00" Long



8—Removeable Horn..... (Qty 2)
With Cap, 15.00"

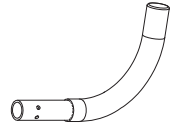

9—HD Front Hook Assembly (Qty 2)

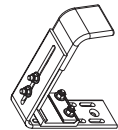

10—Anti-Seize..... (Qty 1)



Anti-Seize (1X)

FBM-0045
CHANNELS TO ROOF

- 0.1** Position Channels as shown below in Fig.1

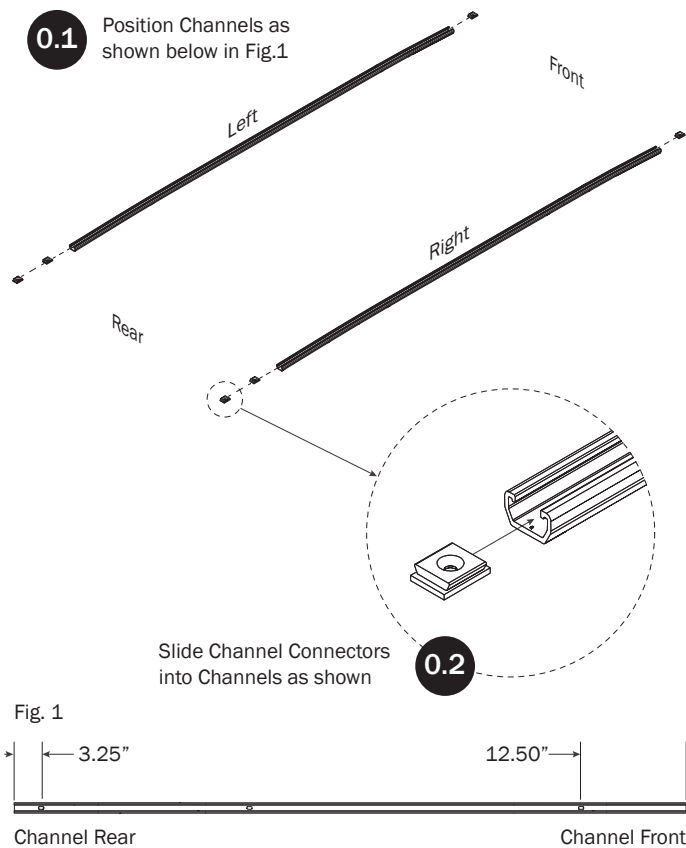

Slide Channel Connectors into Channels as shown

0.2

- 0.3** Install Channels into roof Channel groove as shown

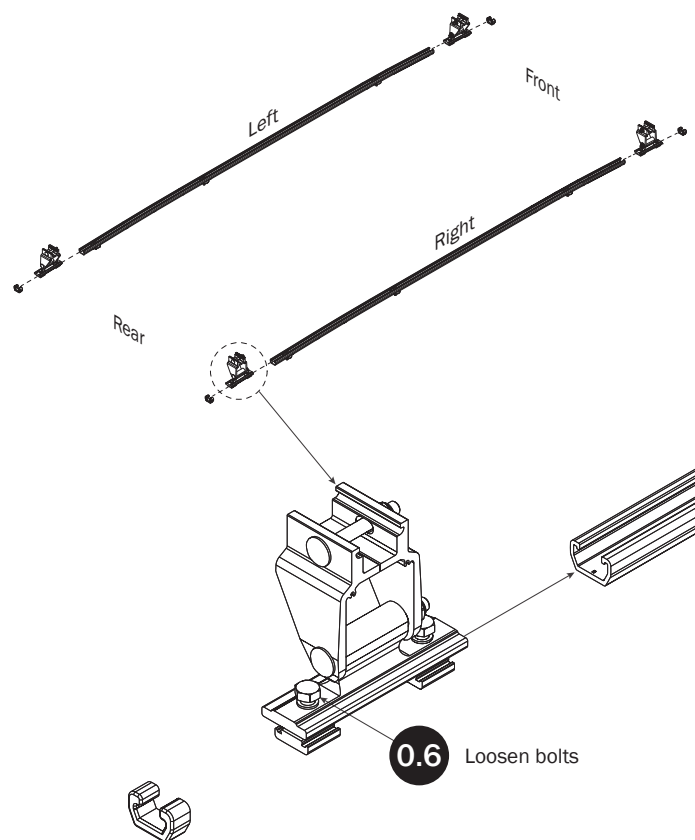
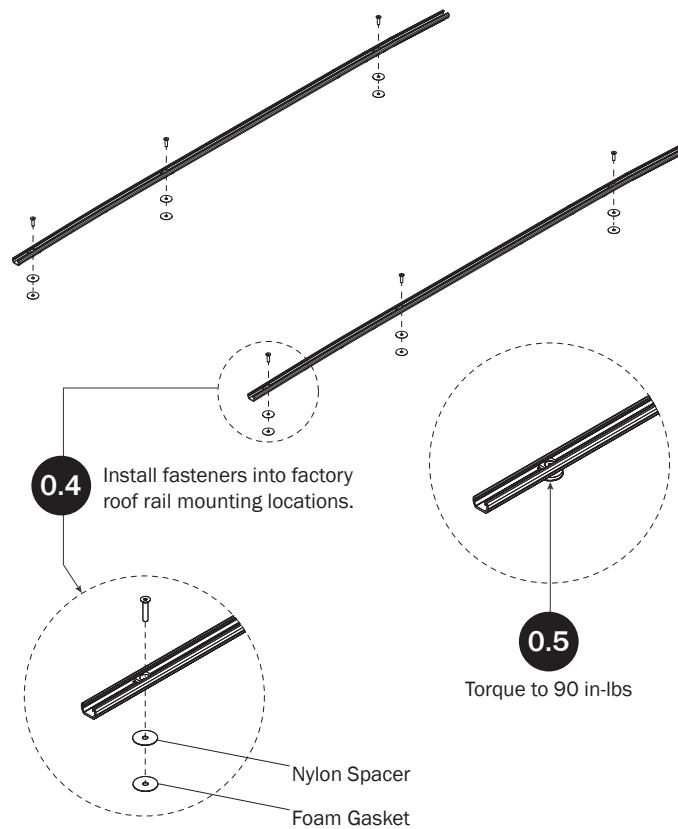

- 0.7** Set to distances then torque Rear Bracket nuts to 90 in-lbs

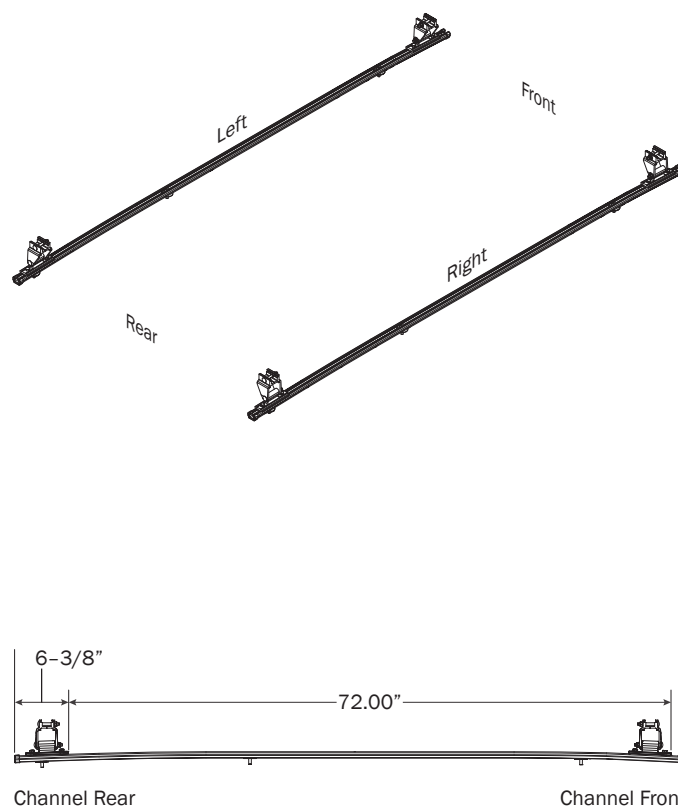

RIGHT CLAMP DOWN ASSEMBLY

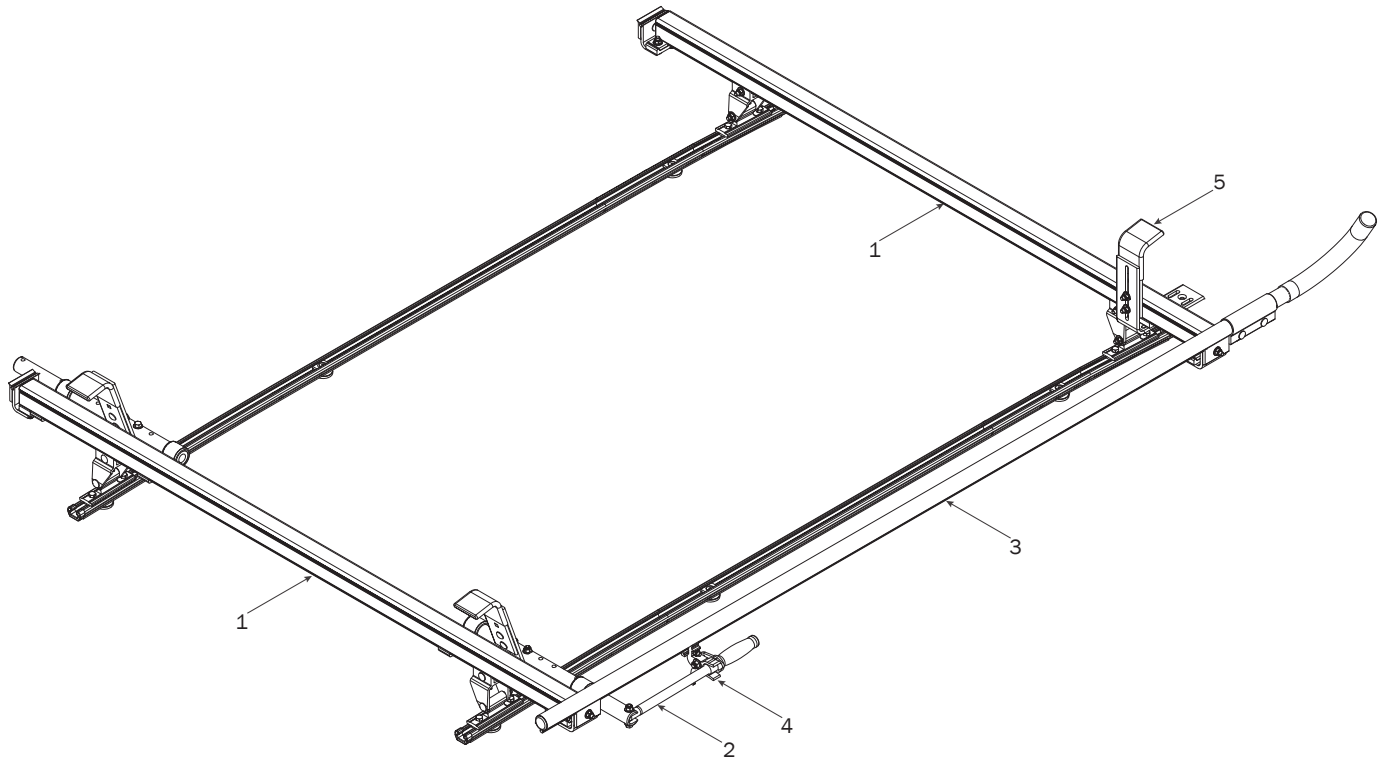

CROSSBARS

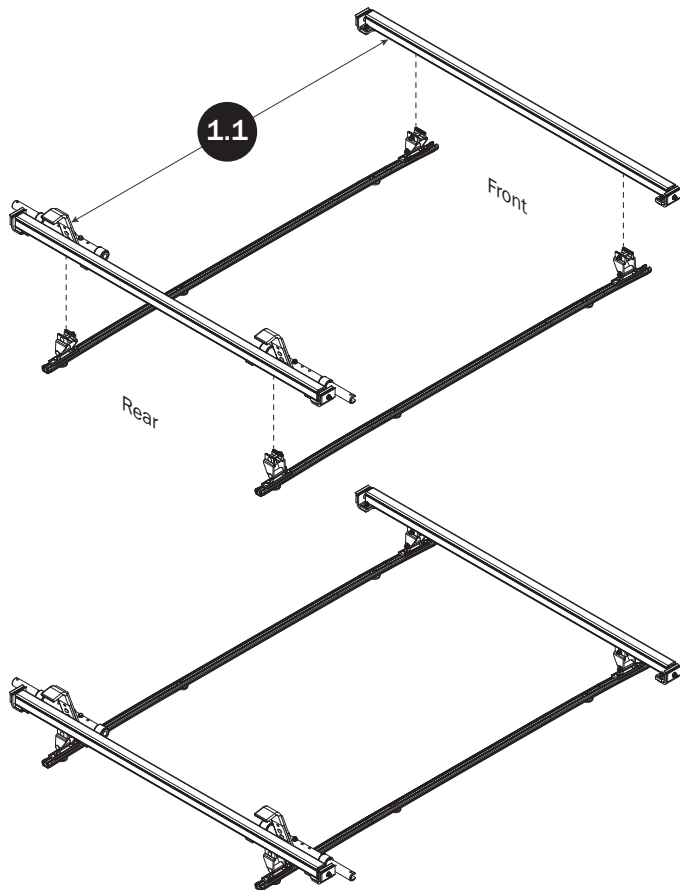

CROSSBAR ADJUSTMENT

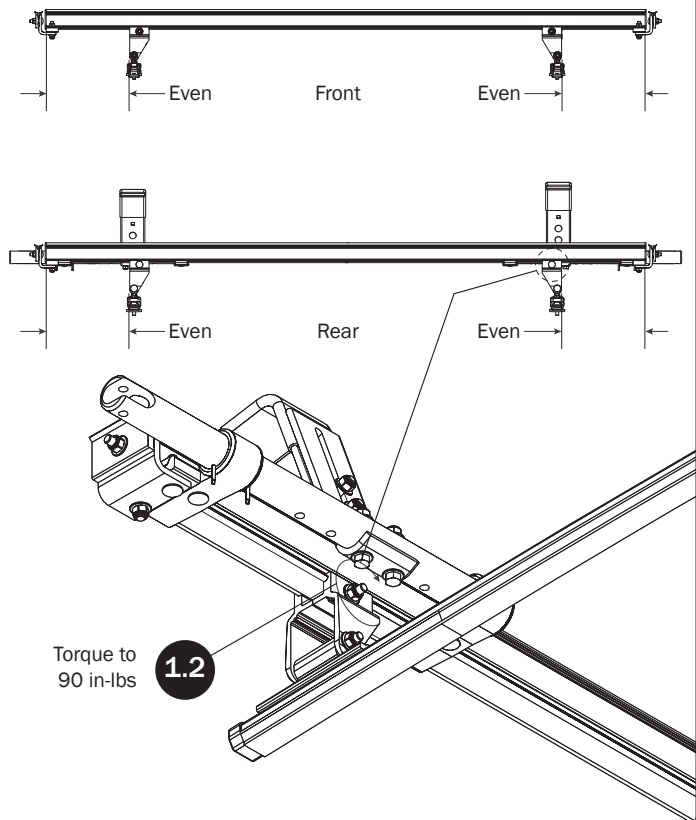

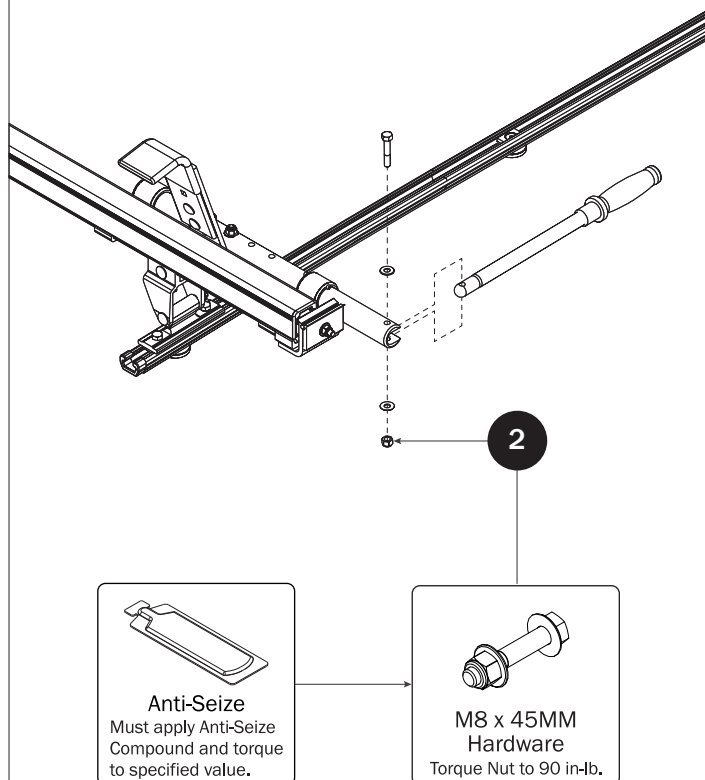
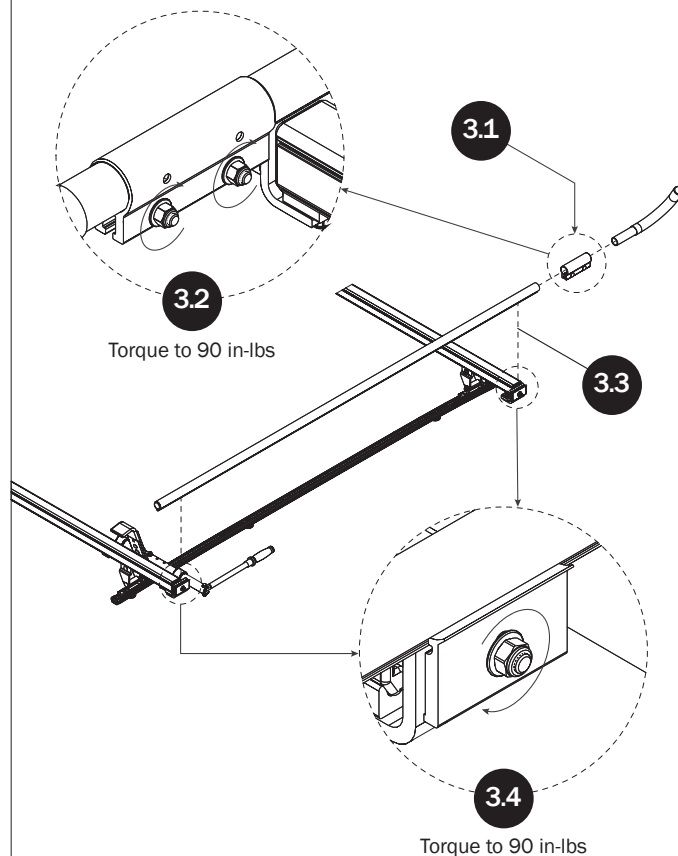
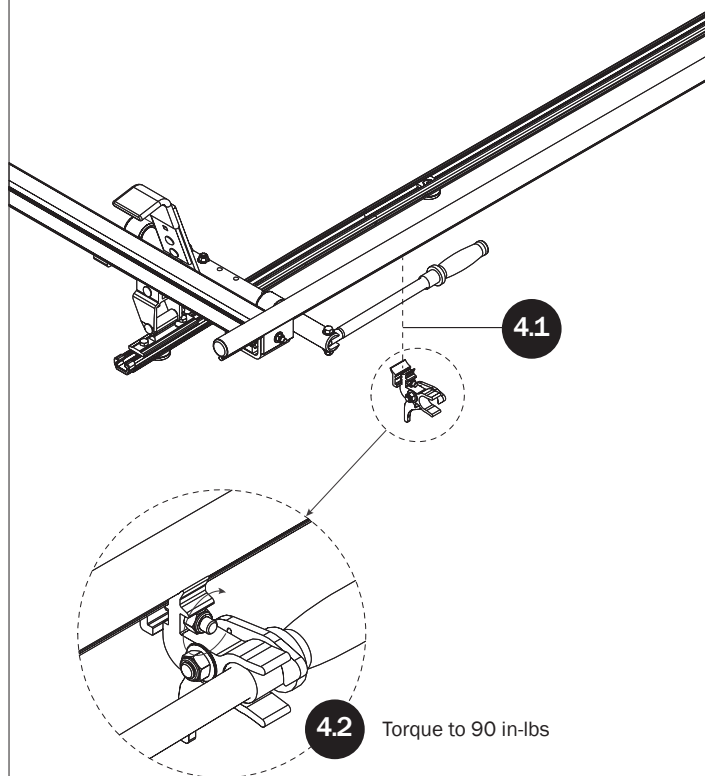
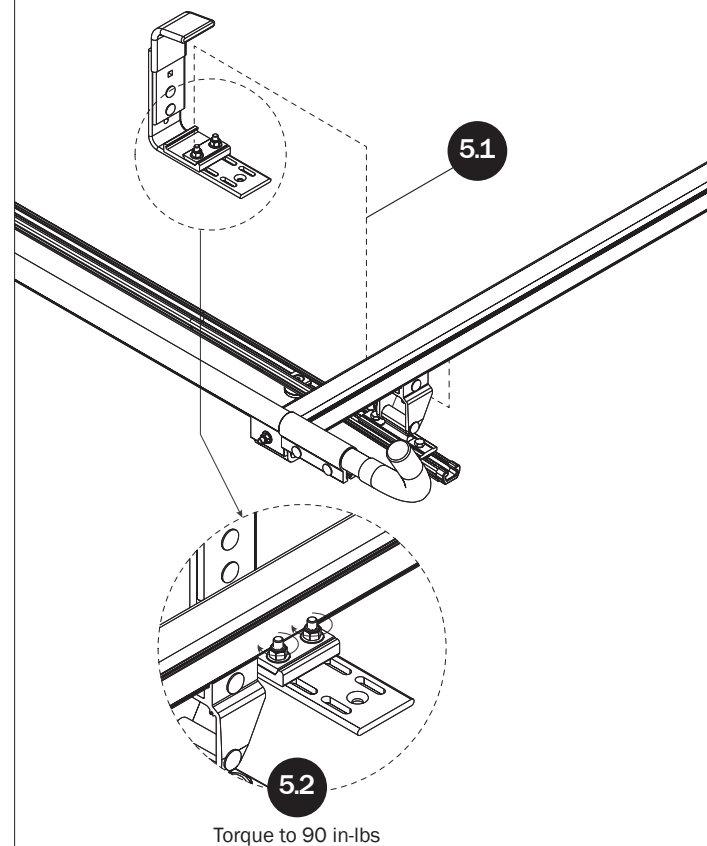
CLAMP DOWN HANDLE**CLAMP DOWN TUBE****HANDLE LATCH****FRONT LADDER HOOK**
SEE QUICK START GUIDE FOR ADJUSTMENTS

LEFT CLAMP DOWN ASSEMBLY SEQUENCE

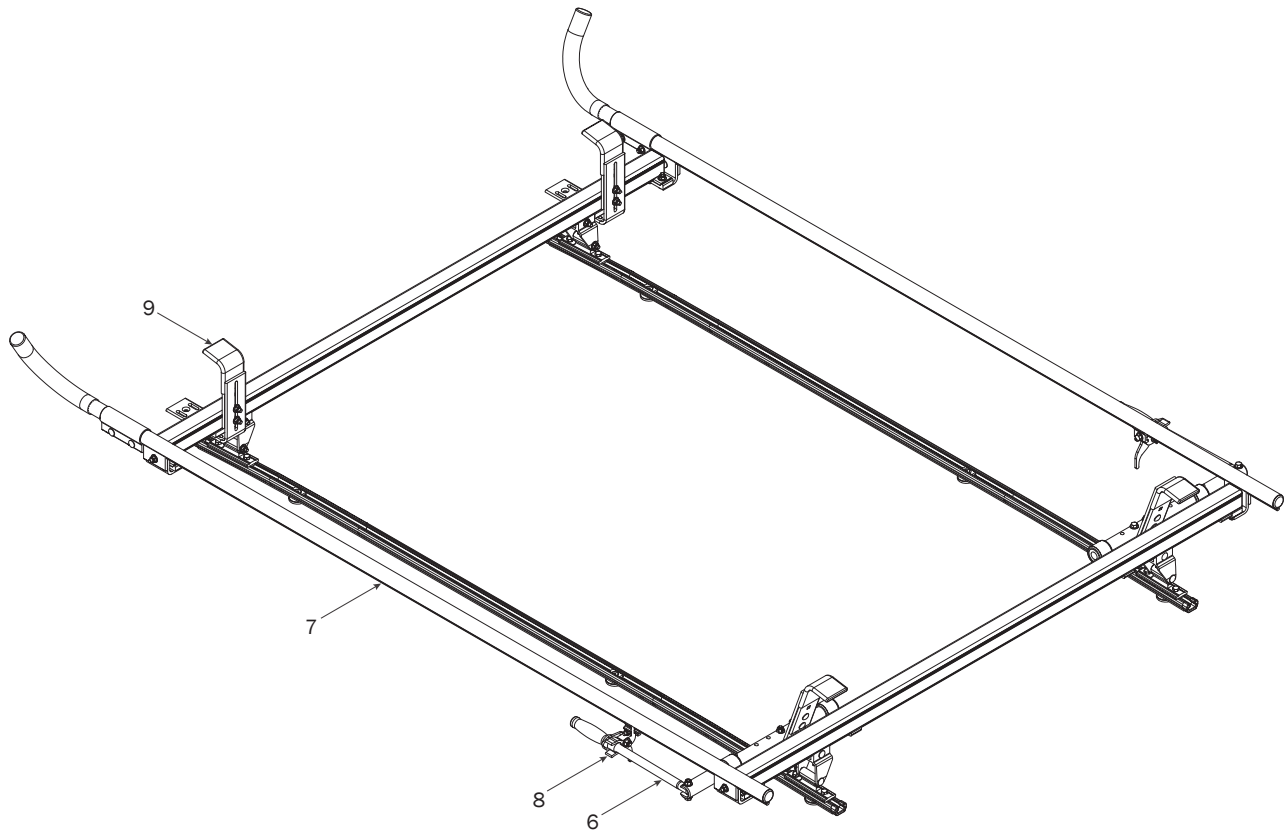

CLAMP DOWN HANDLE

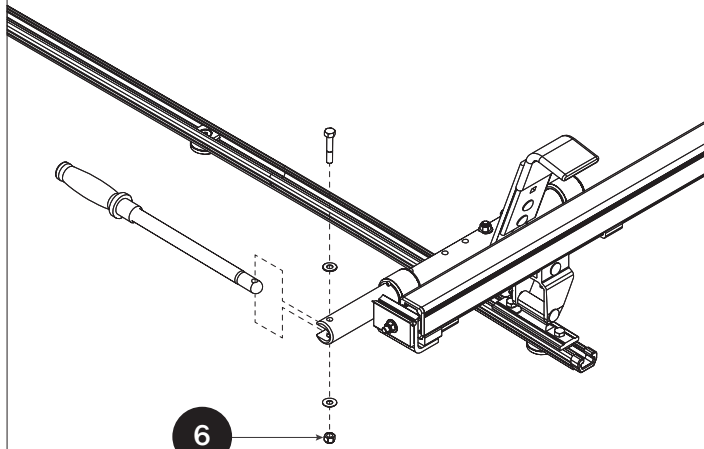

6

M8 x 45MM
Hardware
Torque Nut to 90 in-lb.

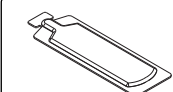

Anti-Seize
Must apply Anti-Seize
Compound and torque
to specified value.

CLAMP DOWN TUBE

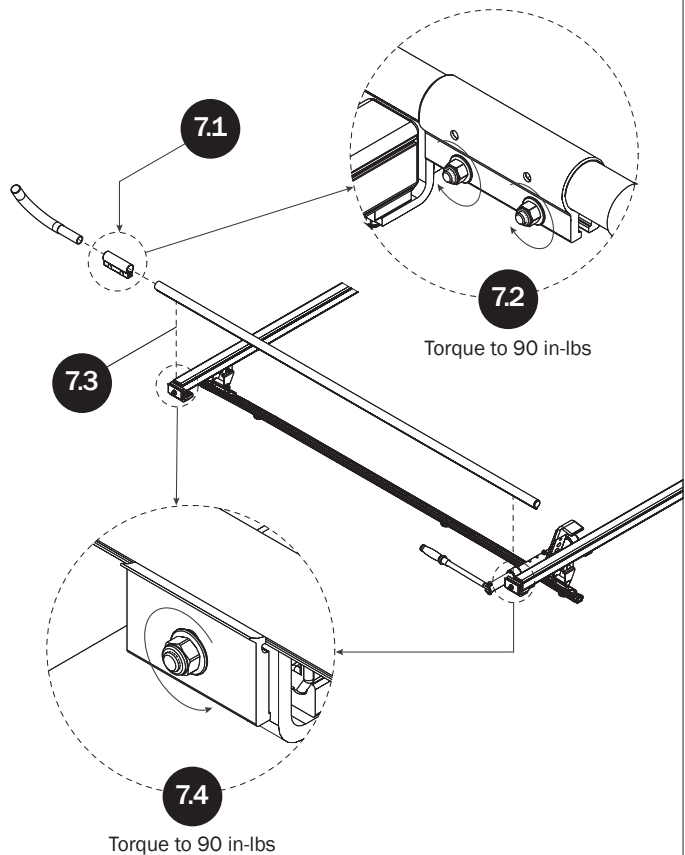

7.1

7.2

Torque to 90 in-lbs

7.3

7.4

Torque to 90 in-lbs

HANDLE LATCH

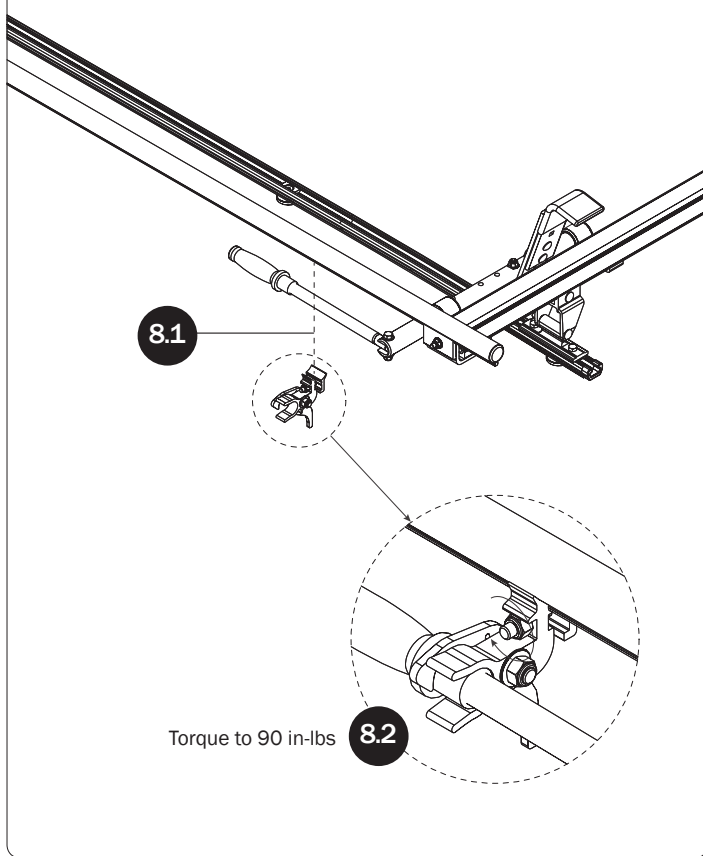

FRONT LADDER HOOK SEE QUICK START GUIDE FOR ADJUSTMENTS

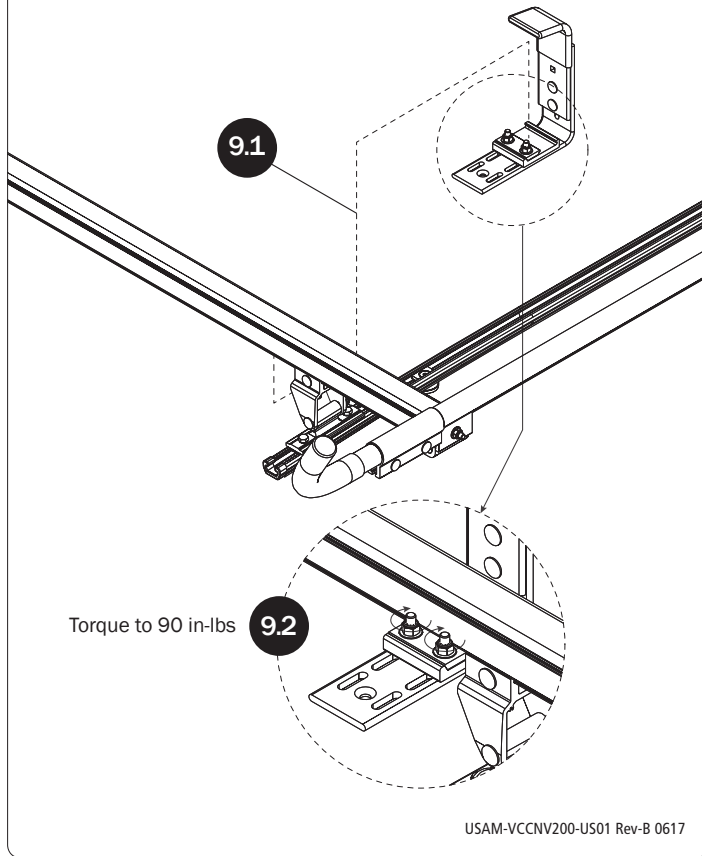

USAM-VCCNV200-US01 Rev-B 0617