

PRIME DESIGN™

A Safe Fleet Brand

VN200

VRR

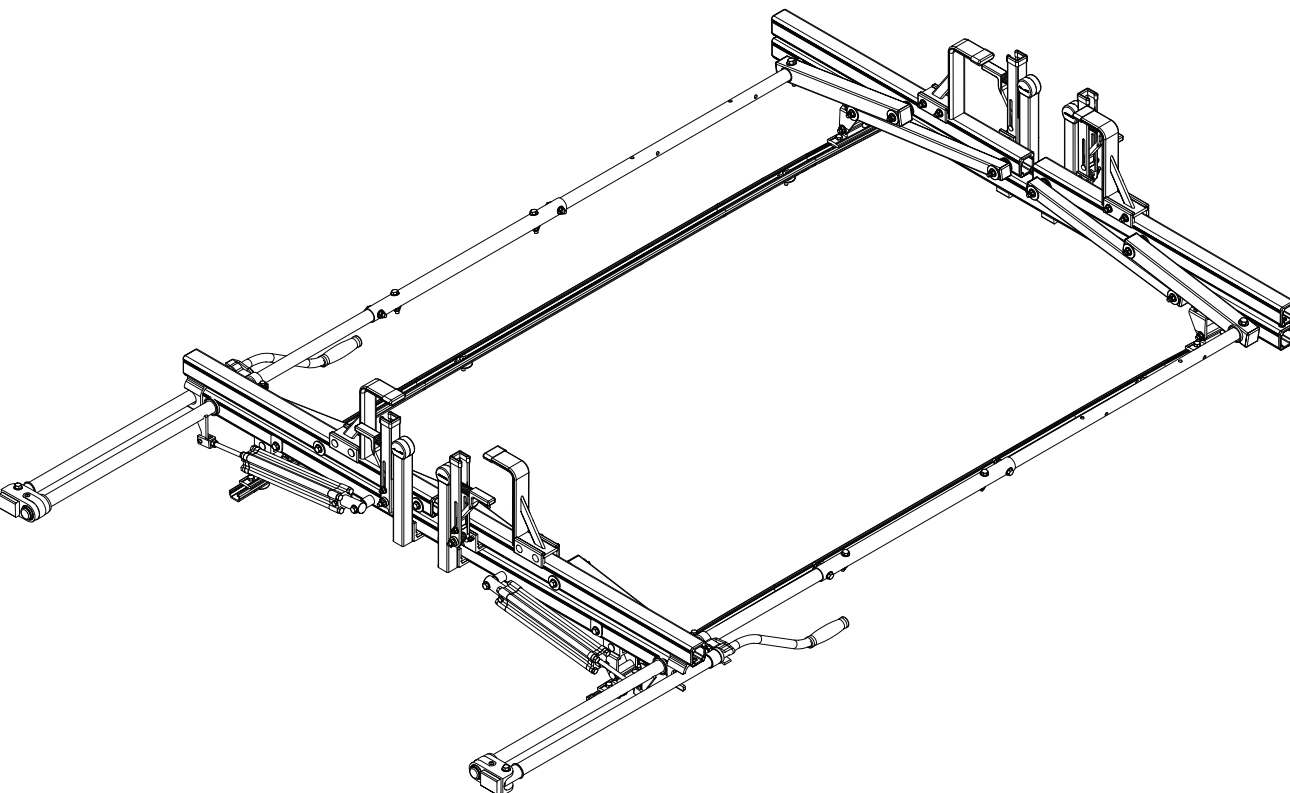

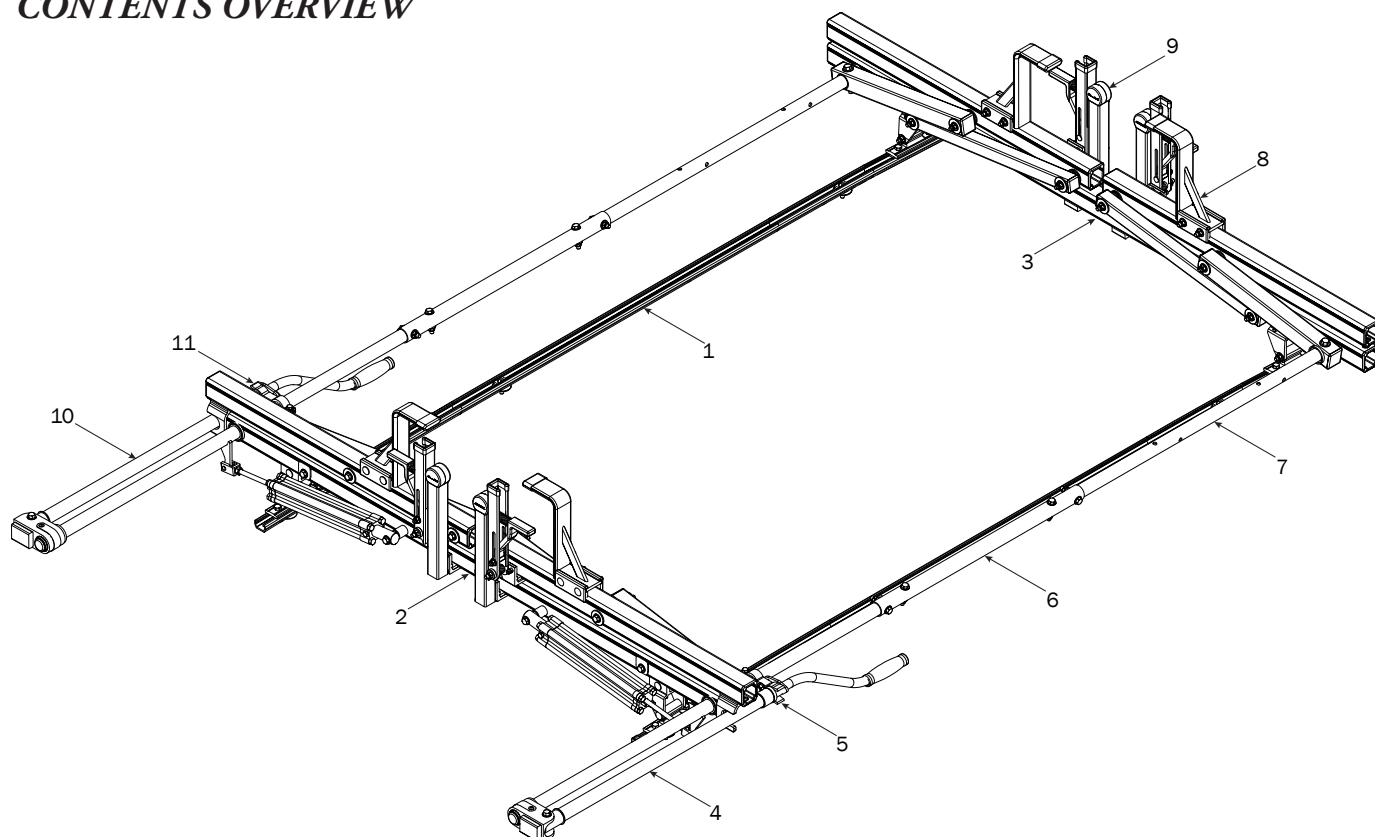

1—FBM-0045 (Qty 1)
Channels with Hardware



Channels (2X)

End Caps (4X)

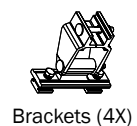

Brackets (4X)

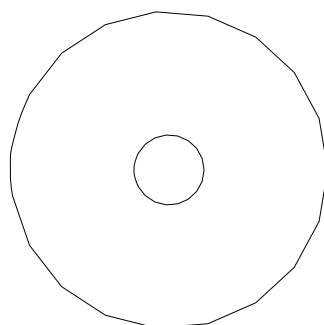

Nylon Washer (6X)

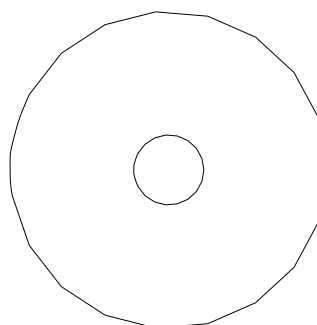

Foam Gasket (6X)

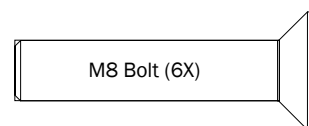

M8 Bolt (6X)

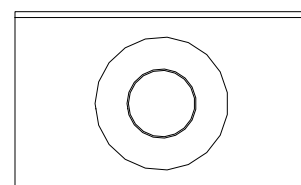

Flex Channel Connector (6X)

2—Rear Crossbar Assembly (Qty 1)

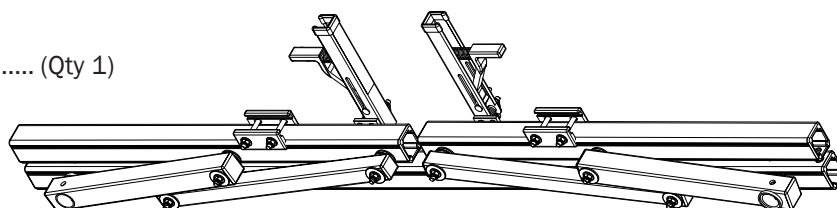

3—Front Crossbar Assembly (Qty 1)

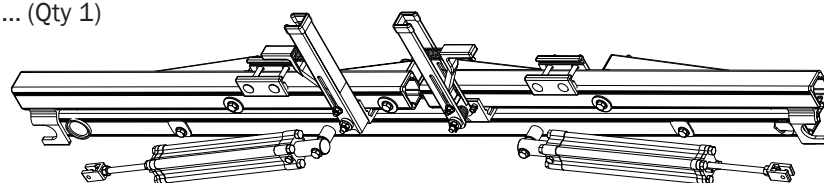

4—Rear Drive Shaft..... (Qty 1)
Right Hand, B4 Version, 46.00"

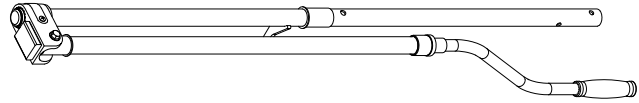

5—Handle Latch Assembly (Qty 1)
Right Hand



6—Connecting Bar..... (Qty 2)
24.00"

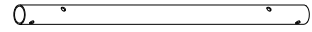

7—Front Drive Shaft (Qty 2)
B Version, 35.75"

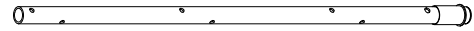

8—Z Post (Qty 4)
Adjustable, 7.25"

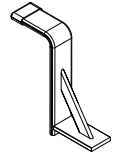

9—L Post (Qty 4)
Gen2, Roller Cap , 9.25"

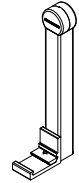

10—Rear Drive Shaft..... (Qty 1)
Right Hand, B4 Version, 46.00"

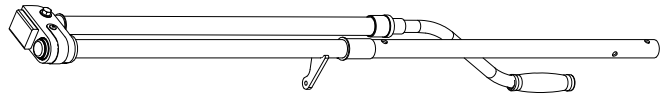

11—Handle Latch Assembly (Qty 1)
Left Hand



12—HKT-8163-Rotation Hardware Kit (Qty 2)
(Not called out in Overview)



Clevis Pin (1X)

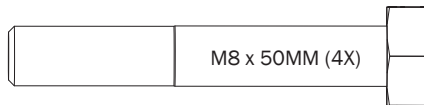

M8 x 50MM (4X)

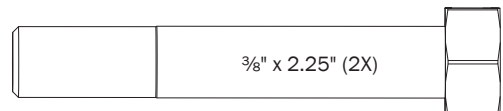

3/8" x 2.25" (2X)

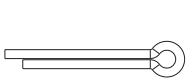

Cotter Pin (1X)



M8 x 25MM (1X)

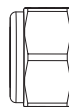

M8 Lock Nut (5X)



3/8" Lock Nut (2X)

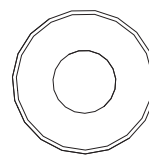

5/16" Flat Washer (10X)

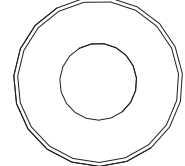

3/8" Flat Washer (4X)

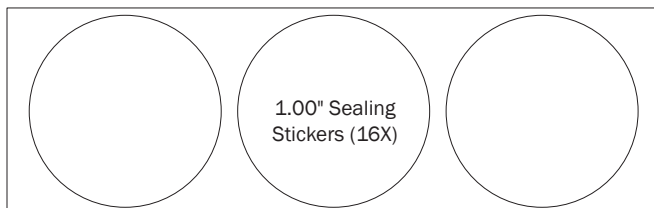

1.00" Sealing
Stickers (16X)



Anti-Seize (1X)

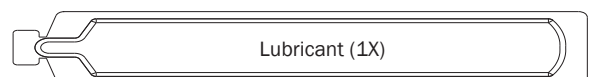

Lubricant (1X)

FBM-0045
CHANNELS TO ROOF

- 0.1** Position Channels as shown below in Fig.1

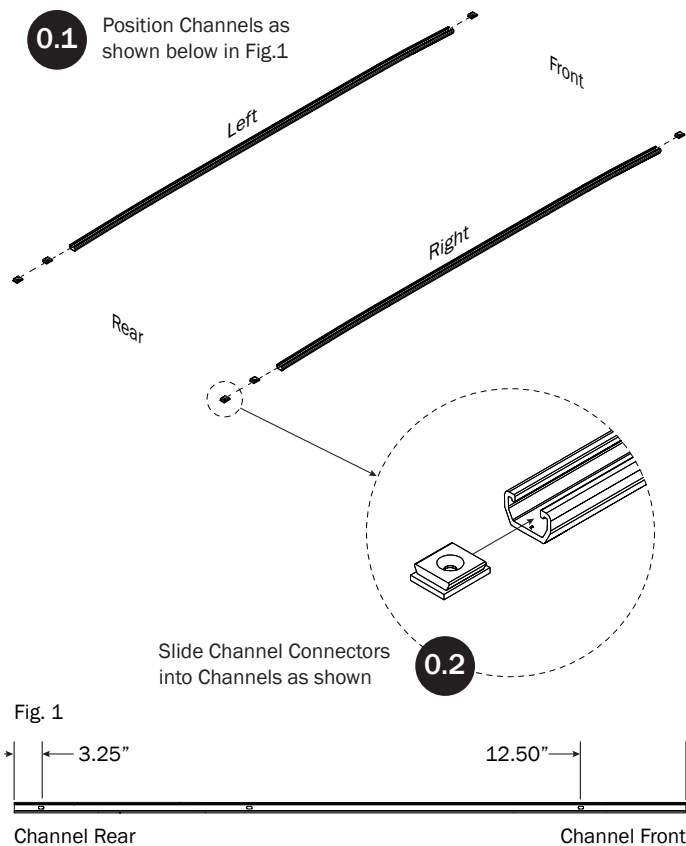

Fig. 1

3.25"

12.50"

Channel Rear

Channel Front

0.2Slide Channel Connectors
into Channels as shown

- 0.3** Install Channels into roof Channel groove as shown

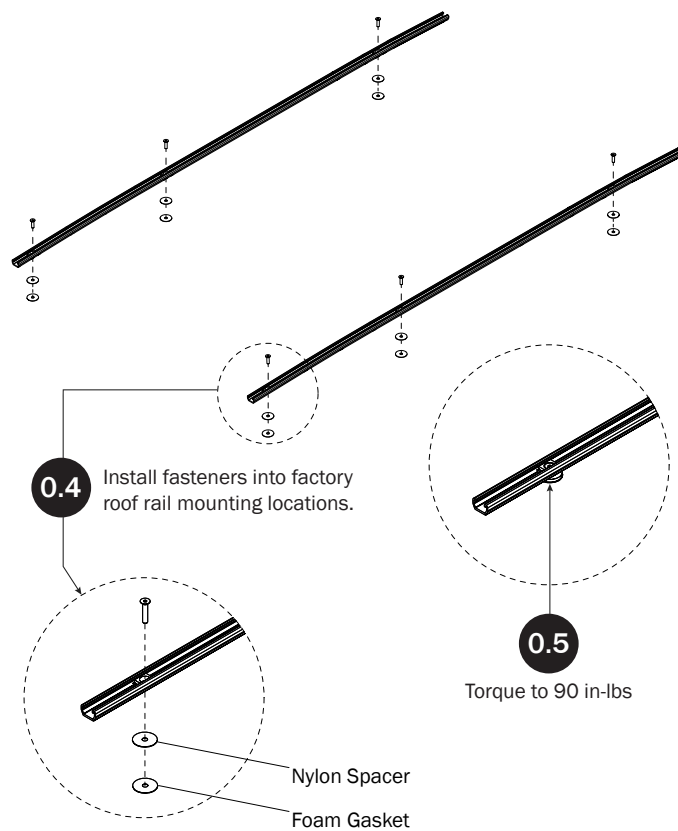
**0.4**Install fasteners into factory
roof rail mounting locations.**0.5**

Torque to 90 in-lbs

Nylon Spacer
Foam Gasket**0.7**

Set to distances then torque Rear Bracket nuts to 90 in-lbs

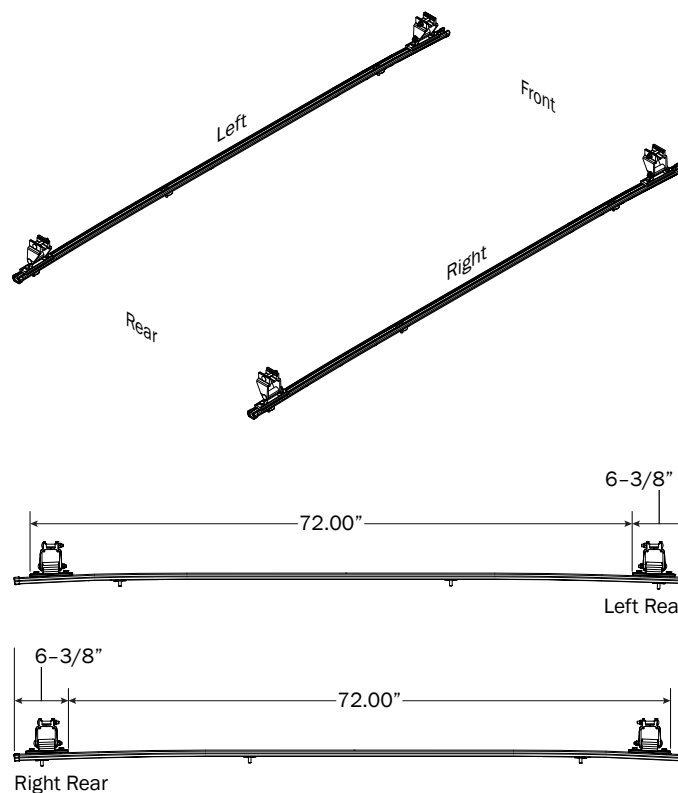

6-3/8"

72.00"

Left Rear

6-3/8"

72.00"

Right Rear

0.6

Loosen bolts

RIGHT ROTATION ASSEMBLY SEQUENCE

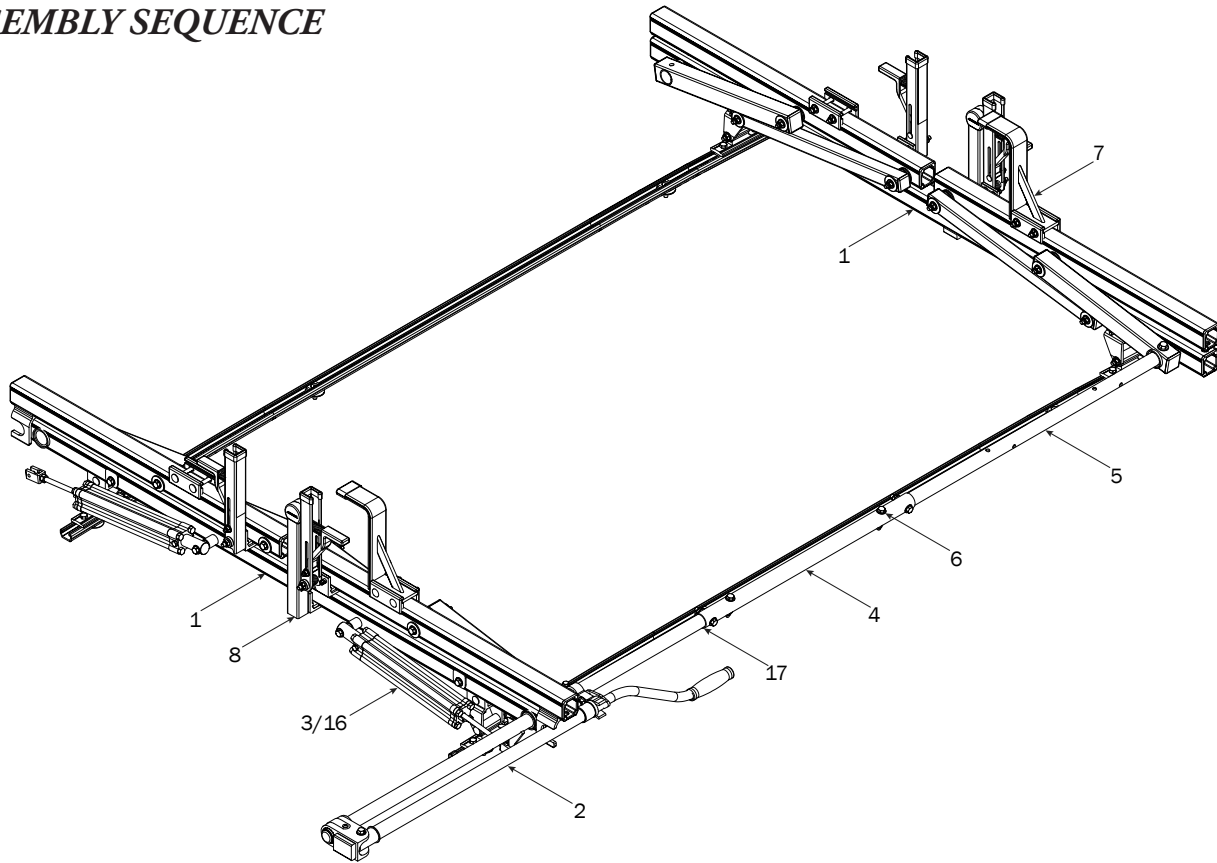

CROSSBARS

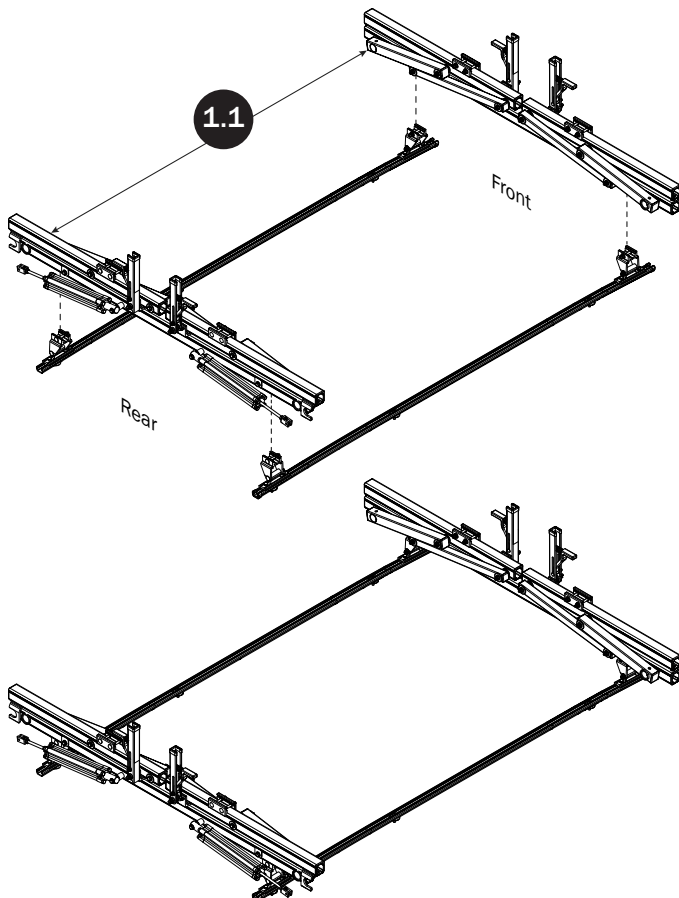

CROSSBAR ADJUSTMENT

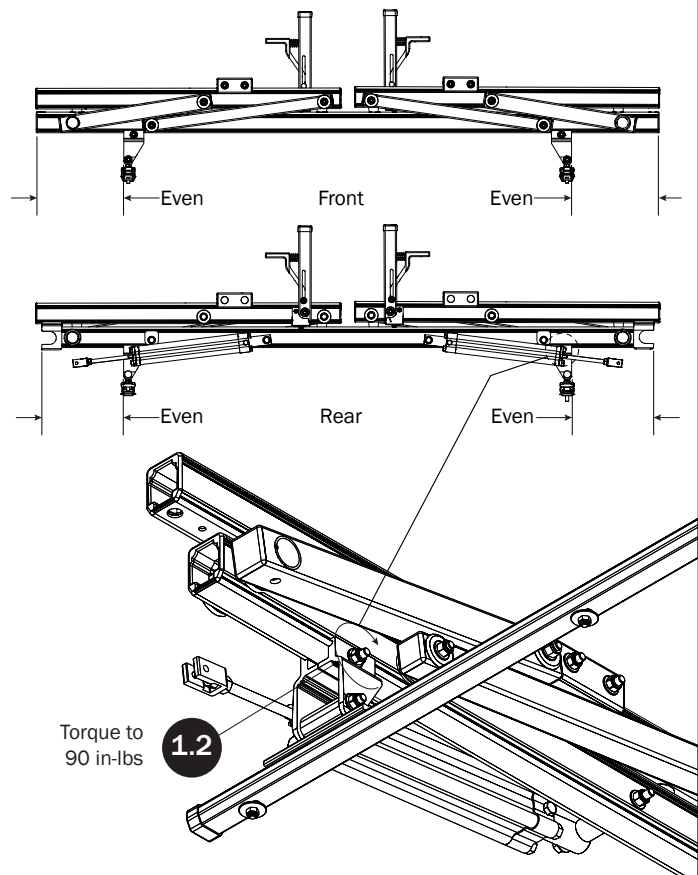

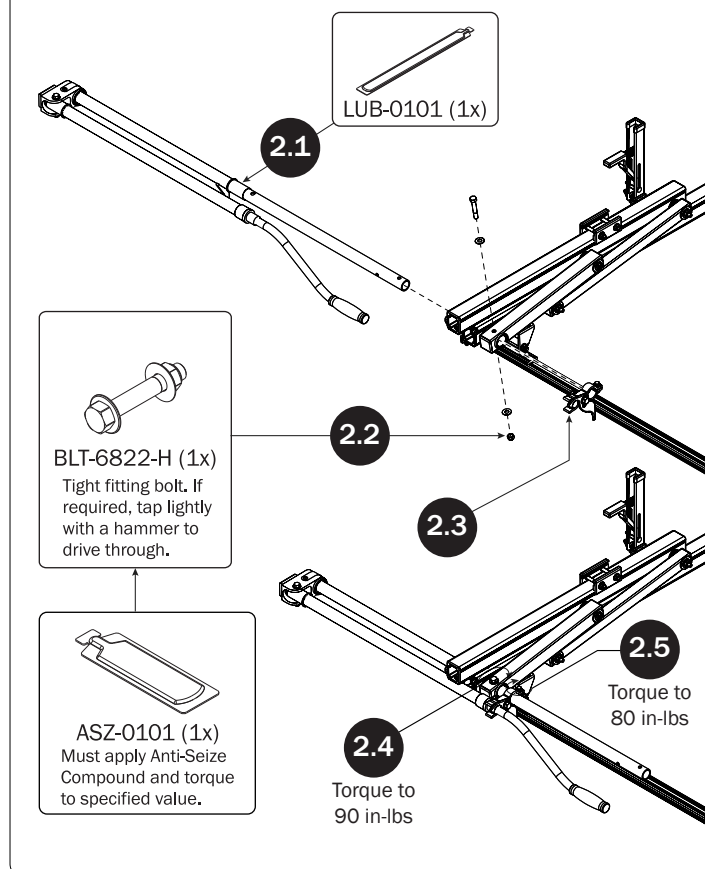
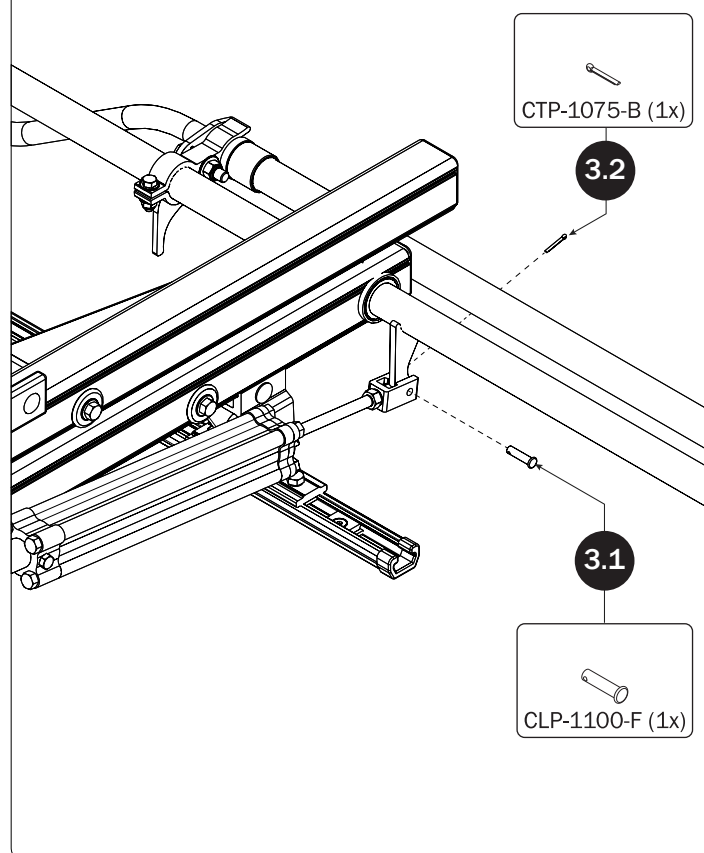
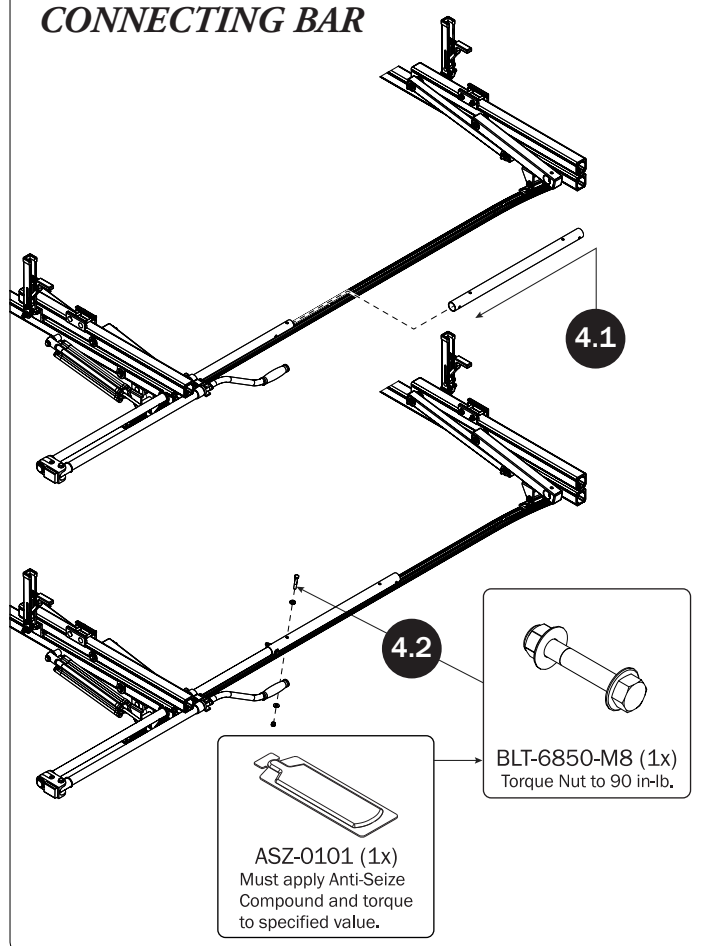
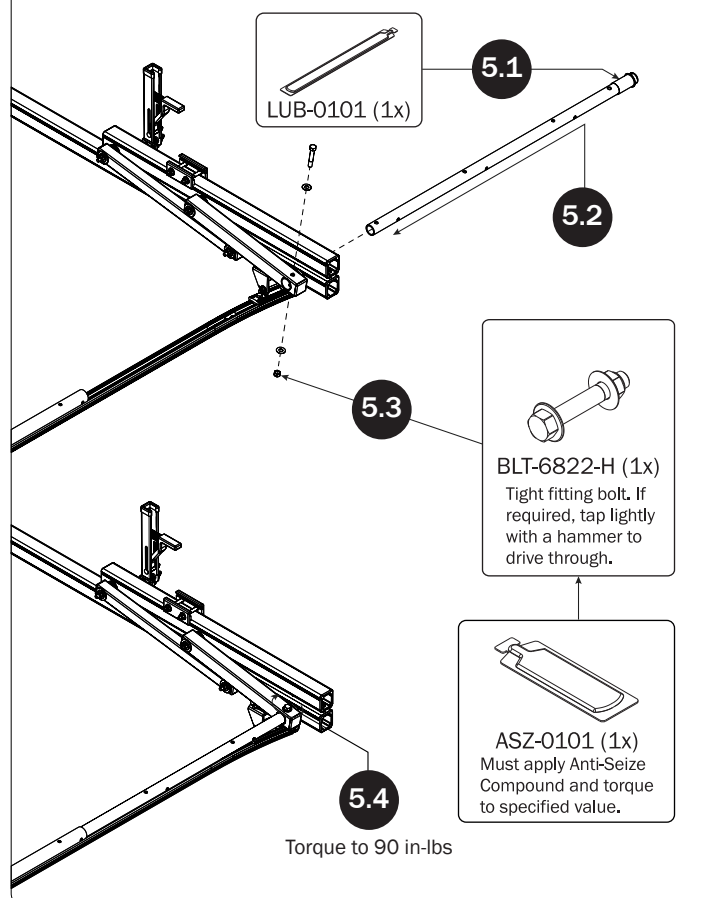
REAR DRIVE SHAFT**CYLINDER HARDWARE****CONNECTING BAR****FRONT DRIVE SHAFT**

CONNECTING BAR FASTENERS

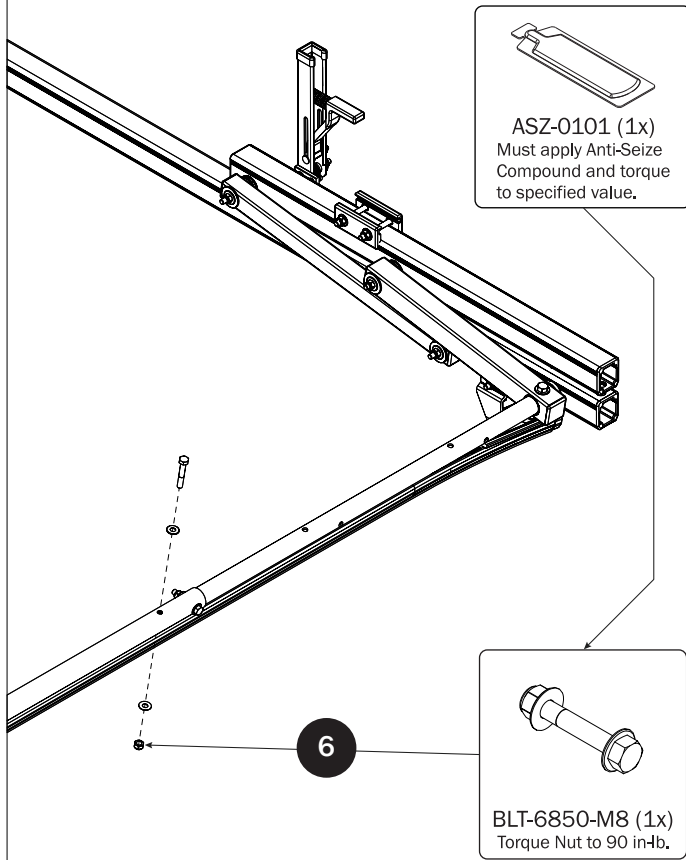

Z POSTS

SEE QUICK START GUIDE FOR ADJUSTMENTS

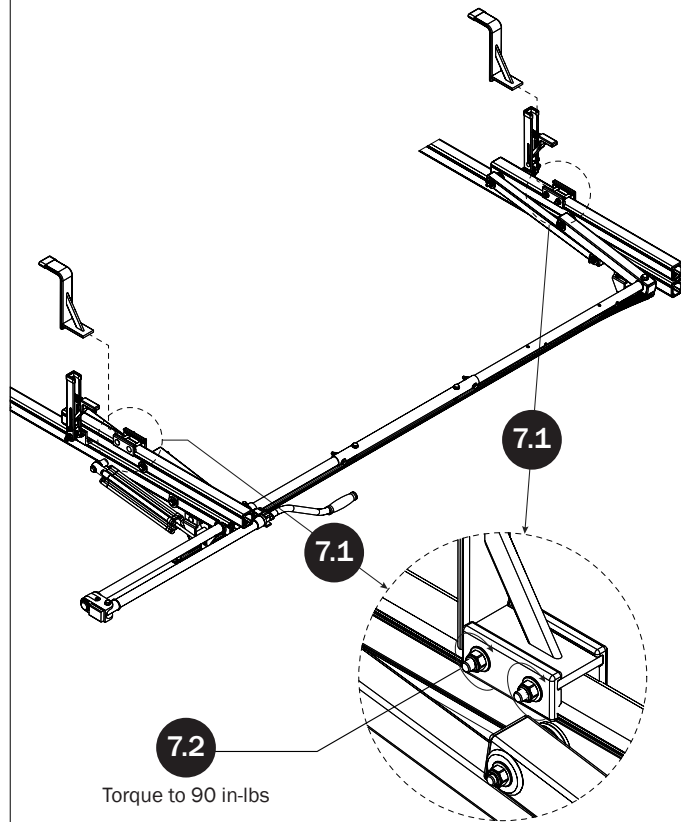

L POSTS

SEE QUICK START GUIDE FOR ADJUSTMENTS

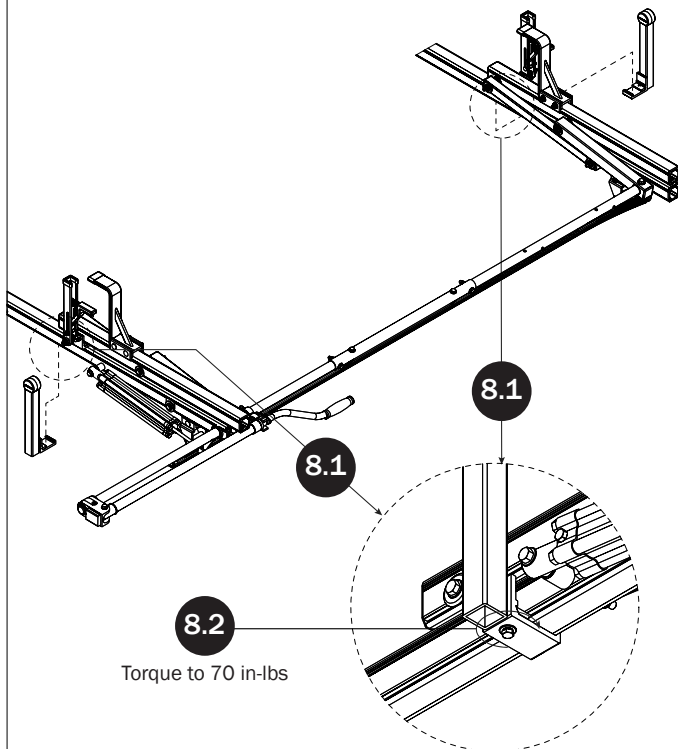

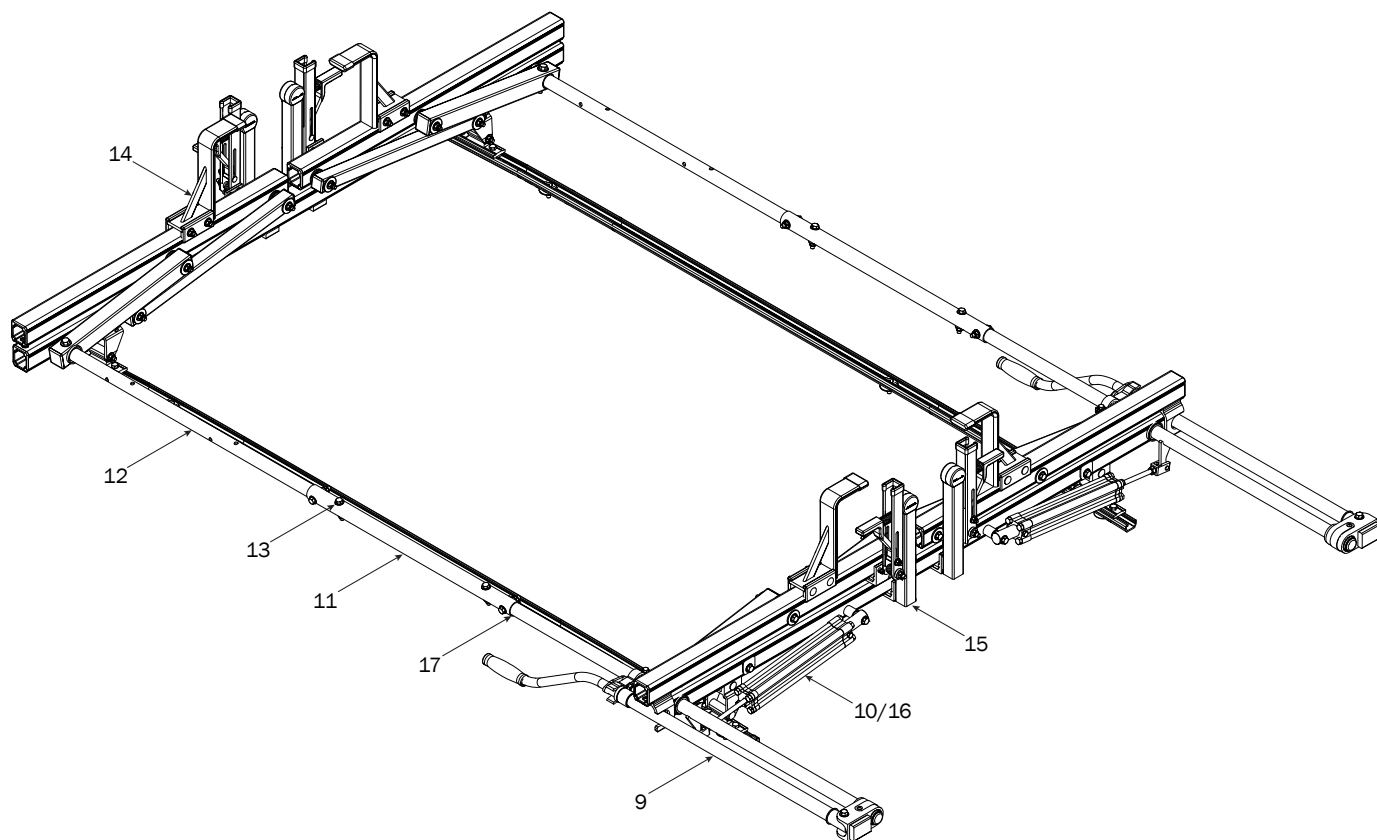
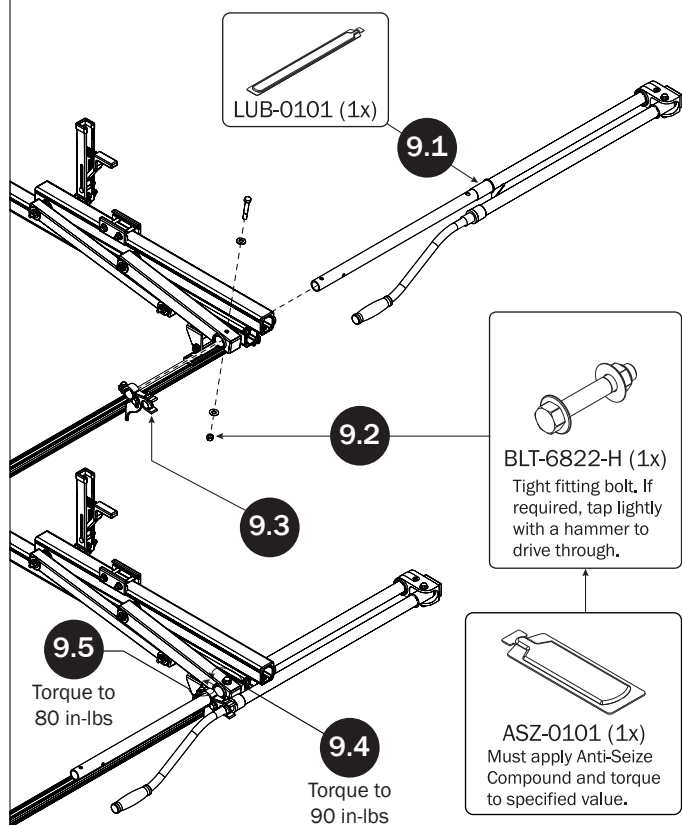
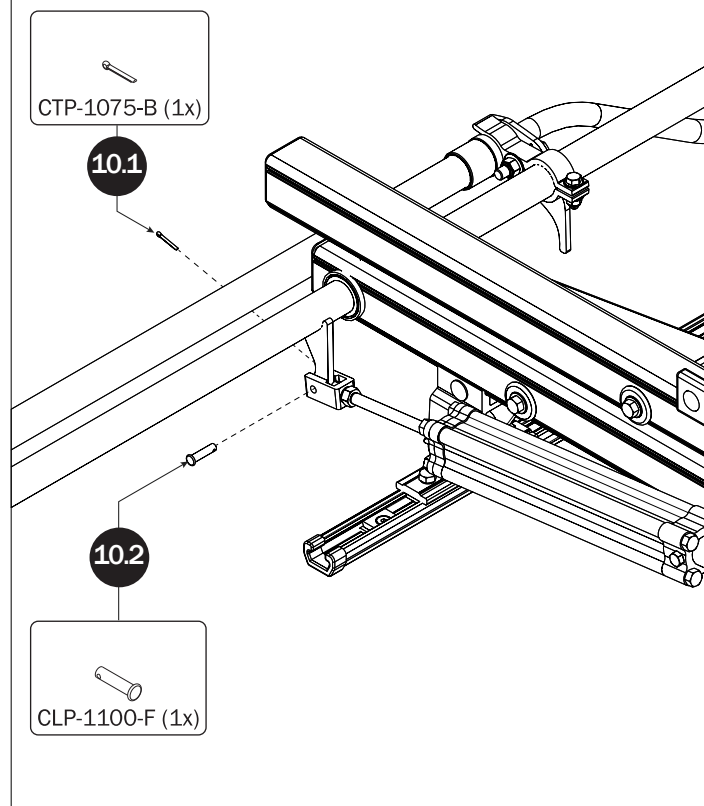
LEFT ROTATION ASSEMBLY SEQUENCE**REAR DRIVE SHAFT****CYLINDER HARDWARE**

CONNECTING BAR

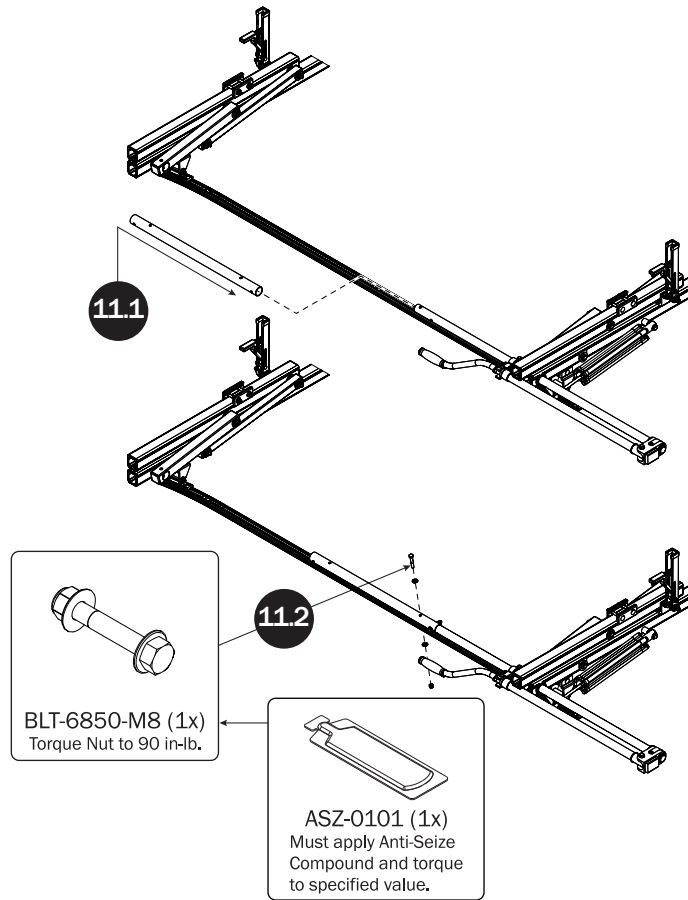

FRONT DRIVE SHAFT

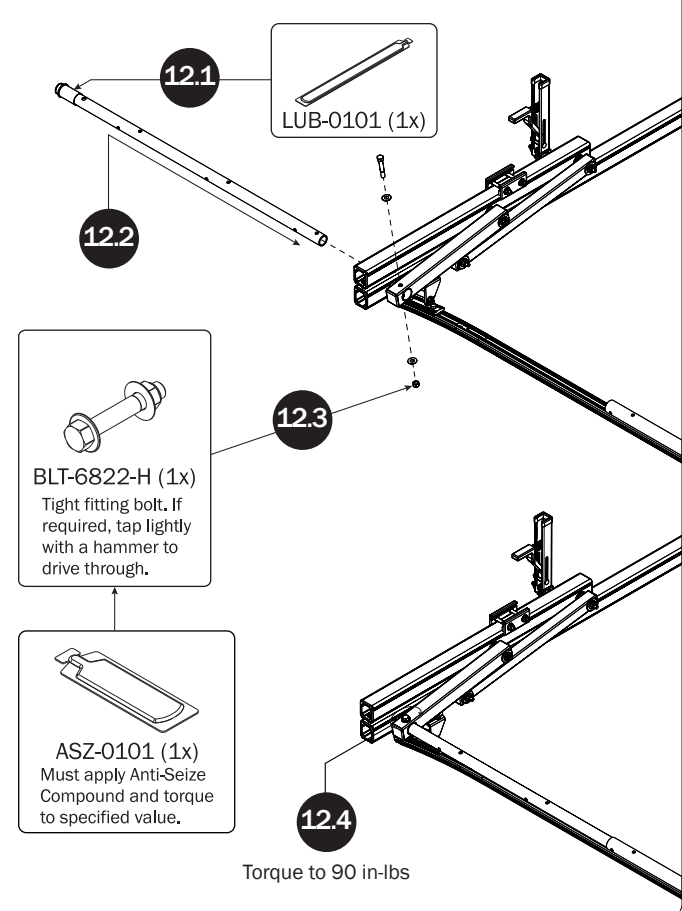

CONNECTING BAR FASTENERS

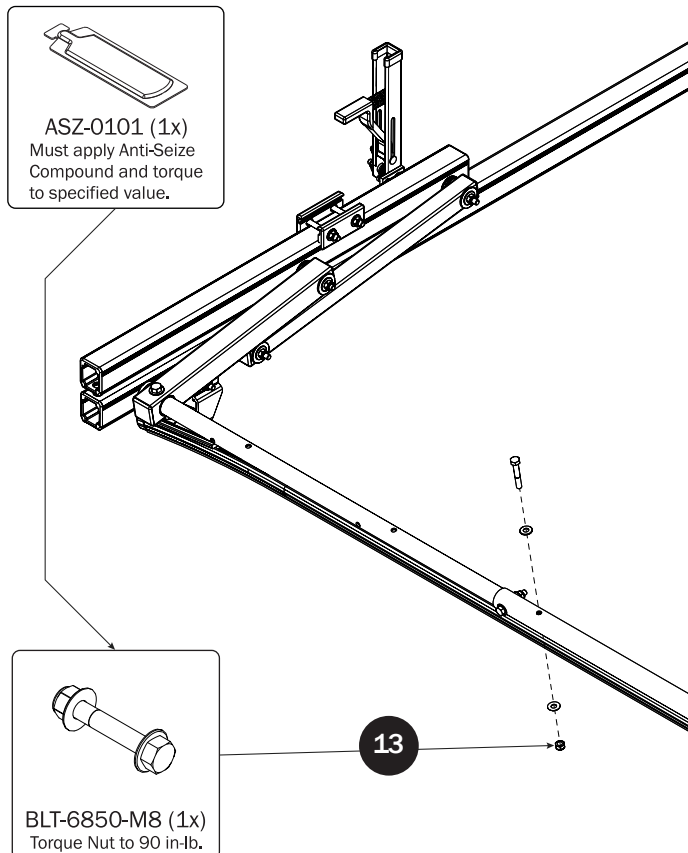

Z POSTS

SEE QUICK START GUIDE FOR ADJUSTMENTS

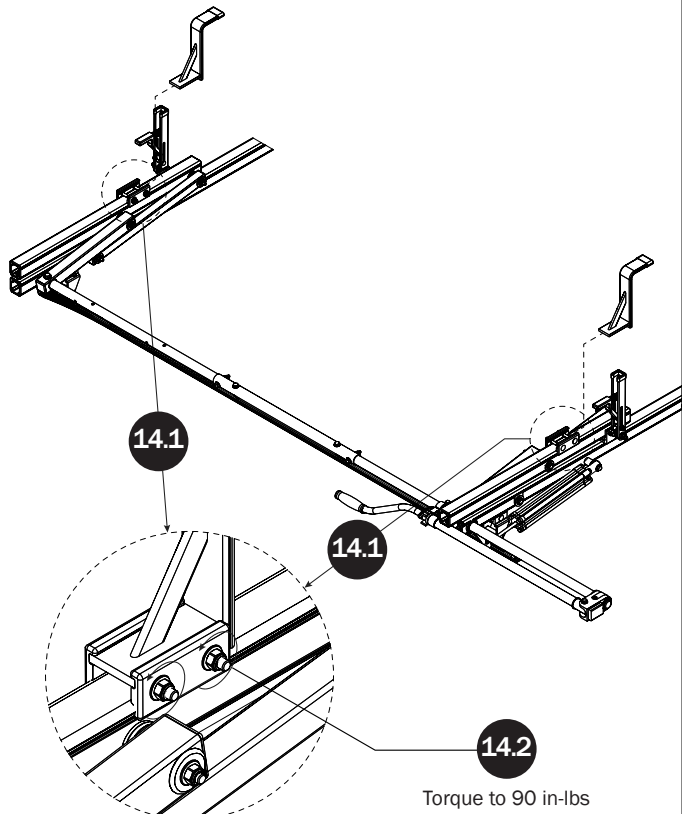

L POSTS

SEE QUICK START GUIDE FOR ADJUSTMENTS

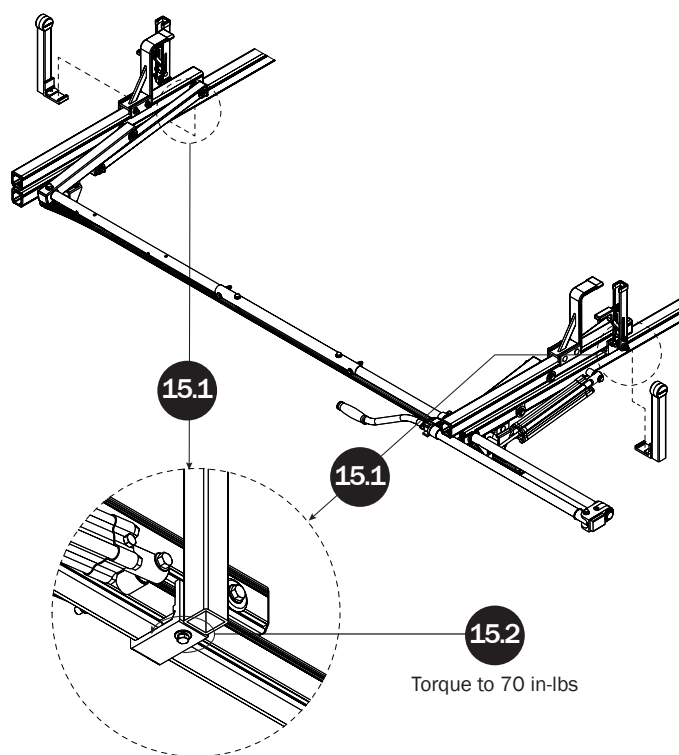
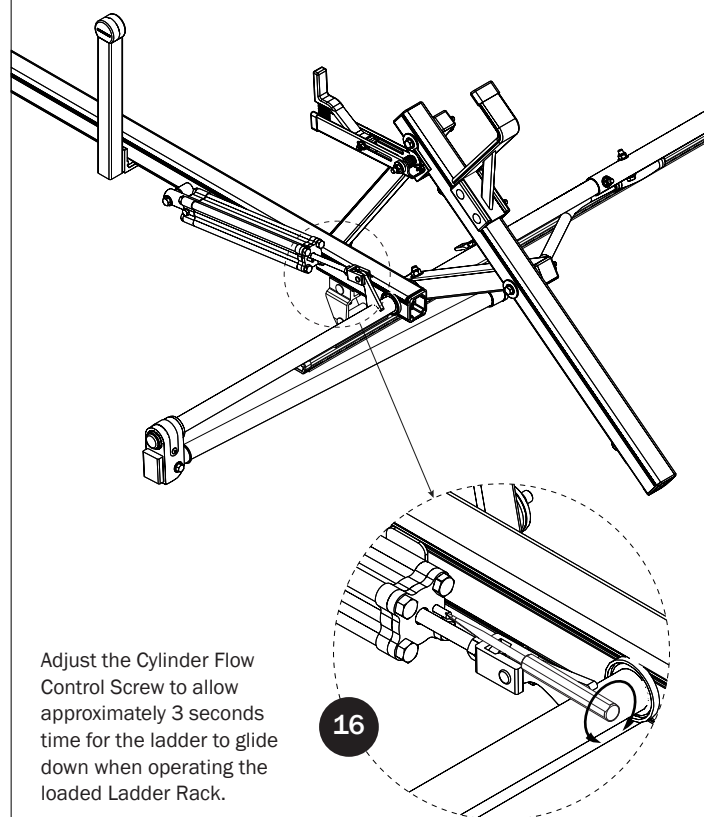
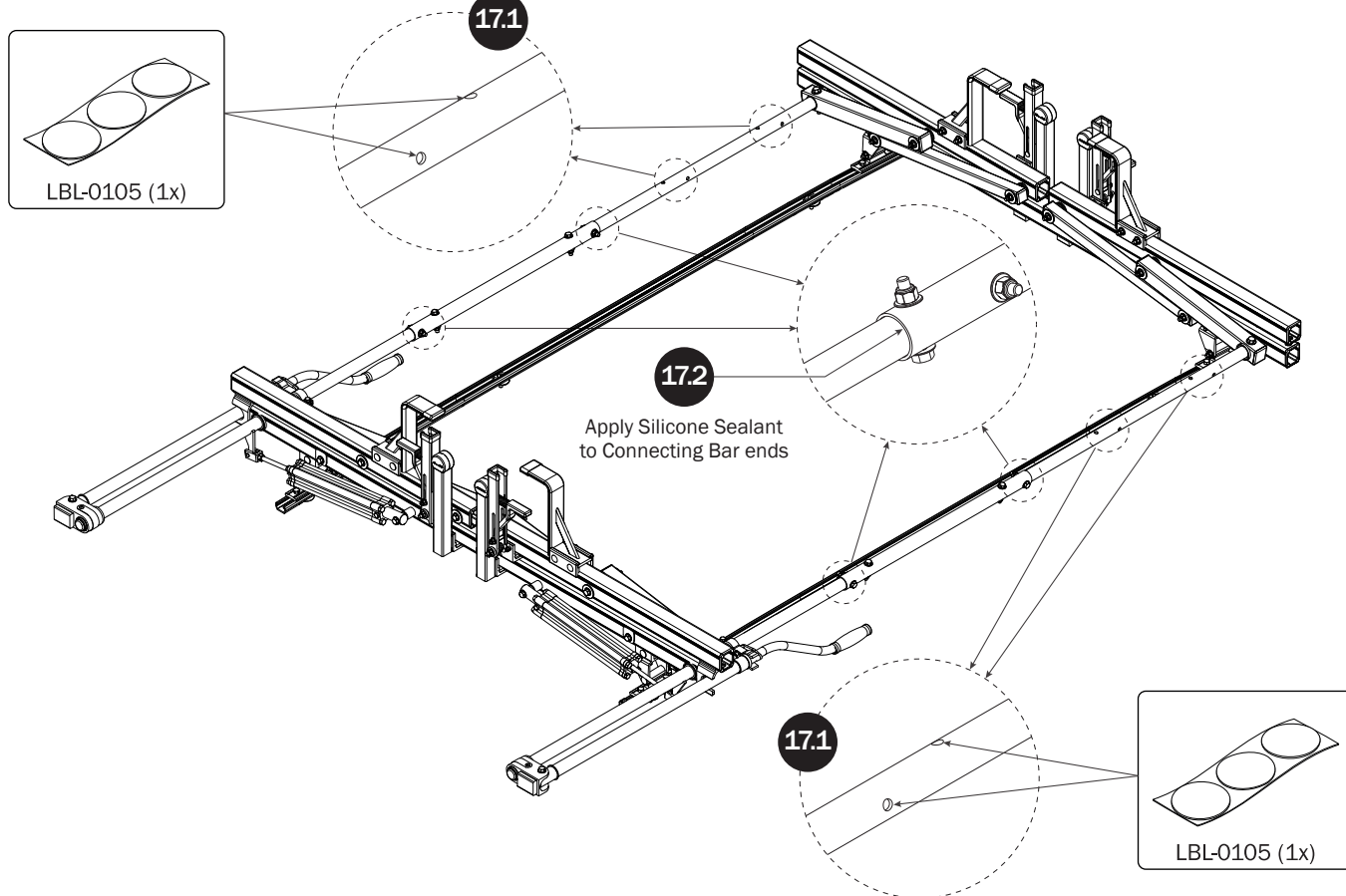
**CYLINDER ADJUSTMENT****DRIVE SHAFT SEALING**

Page Intentionally Left Blank

