

PRIME DESIGN™

A Safe Fleet Brand

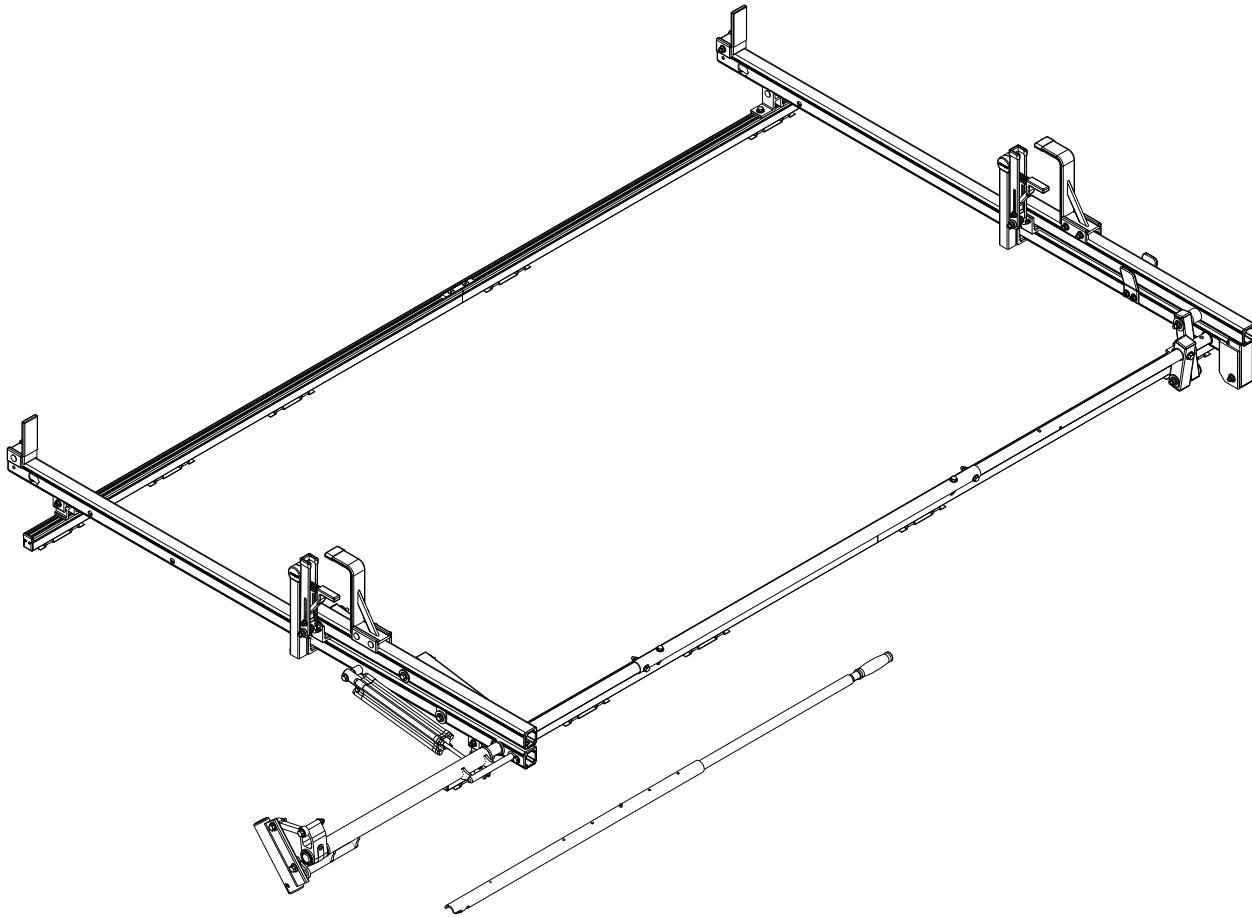

CONTENTS OVERVIEW

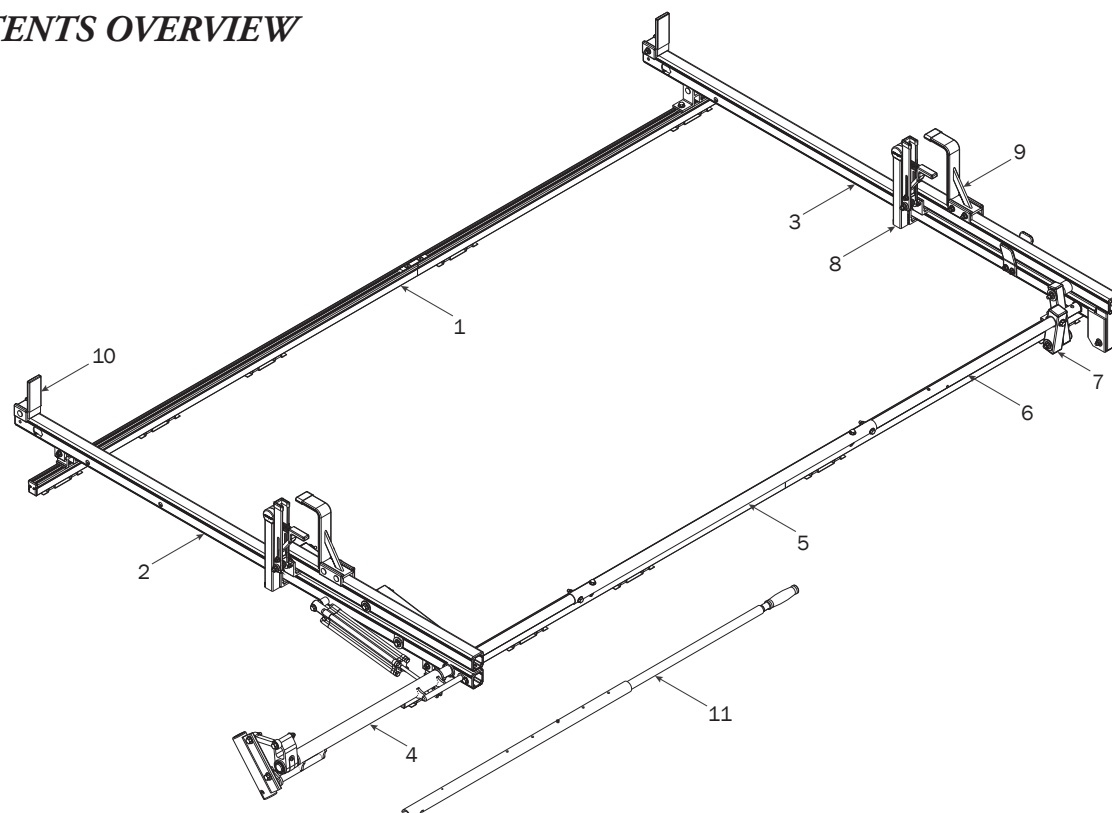

1—FBM-0048 (Qty 1)
Channels with hardware

Channels (2X)

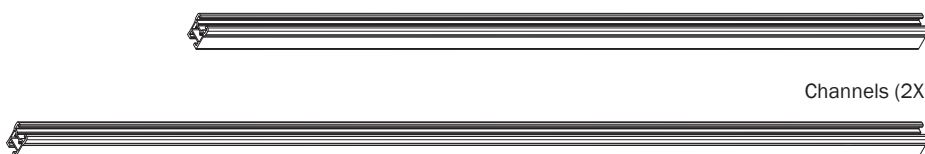

Channels (2X)

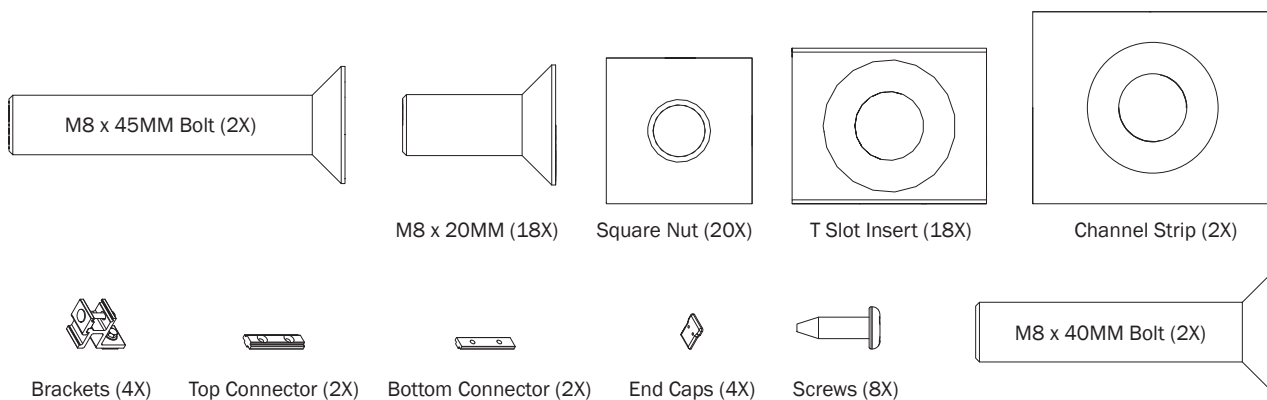

2—Rear Crossbar Assembly..... (Qty 1)

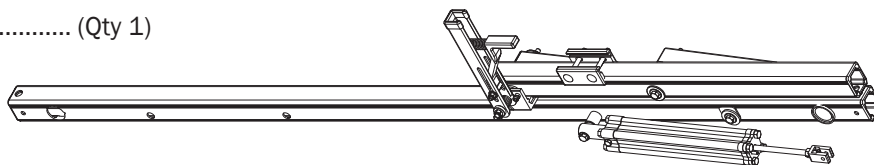

3—Front Crossbar Assembly (Qty 1)

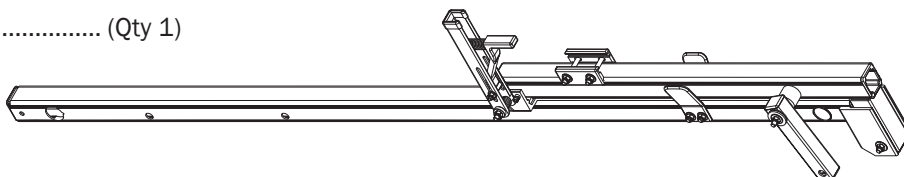

4—Rear Drive Shaft (Qty 1)
Right Hand, A Version, 50.00"

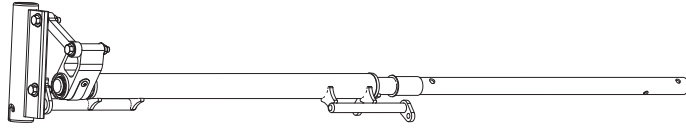

5—Connecting Bar (Qty 1)
48.00"

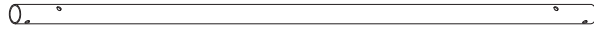

6—Front Drive Shaft (Qty 1)
B Version, 38.75"

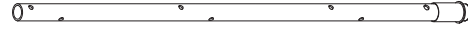

7—Drive Arm (Qty 1)
Incline Version with Bushing and Hardware

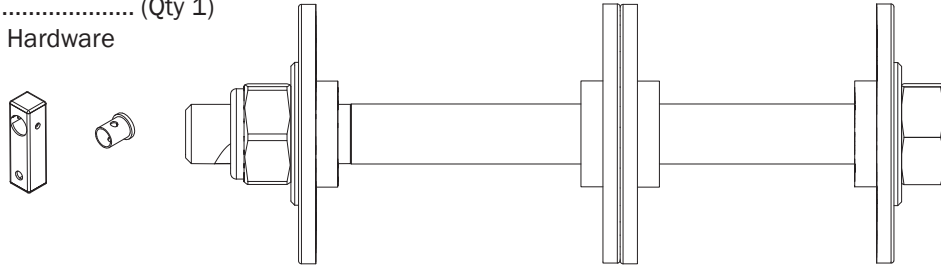

8—Z Post (Qty 2)
Adjustable, 7.25"

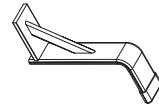

9—L Post (Qty 2)
Gen2, Roller Cap, 9.25"

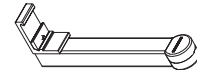

10—Ladder Stop Assembly (Qty 2)
1.75"

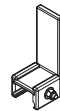

11—HRR Removeable Handle Assembly (Qty 1)

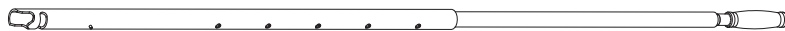

HKT-8163-Rotation Hardware Kit

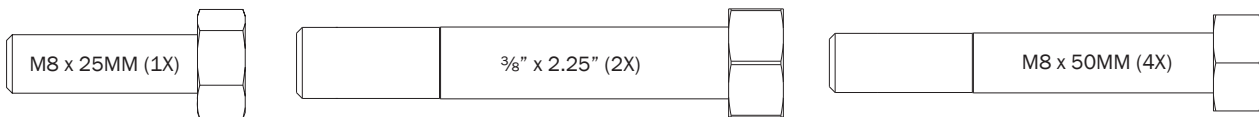

Cotter Pin (1X)

Clevis Pin (1X)

M8 Lock Nut (5X)

3/8" Lock Nut (2X)

5/16" Flat Washer (10X)

3/8" Flat Washer (4X)

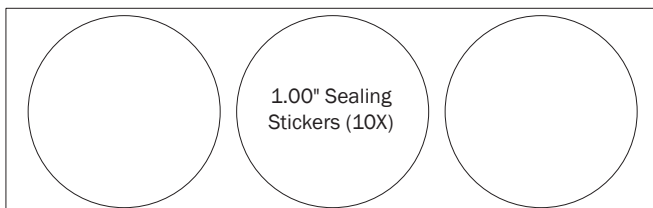

1.00" Sealing
Stickers (10X)

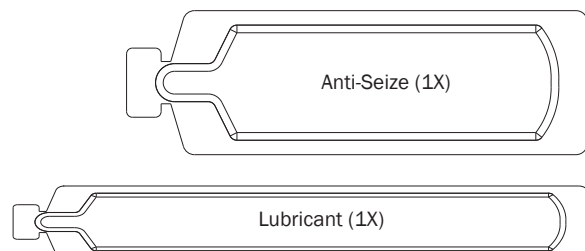

Anti-Seize (1X)

Lubricant (1X)

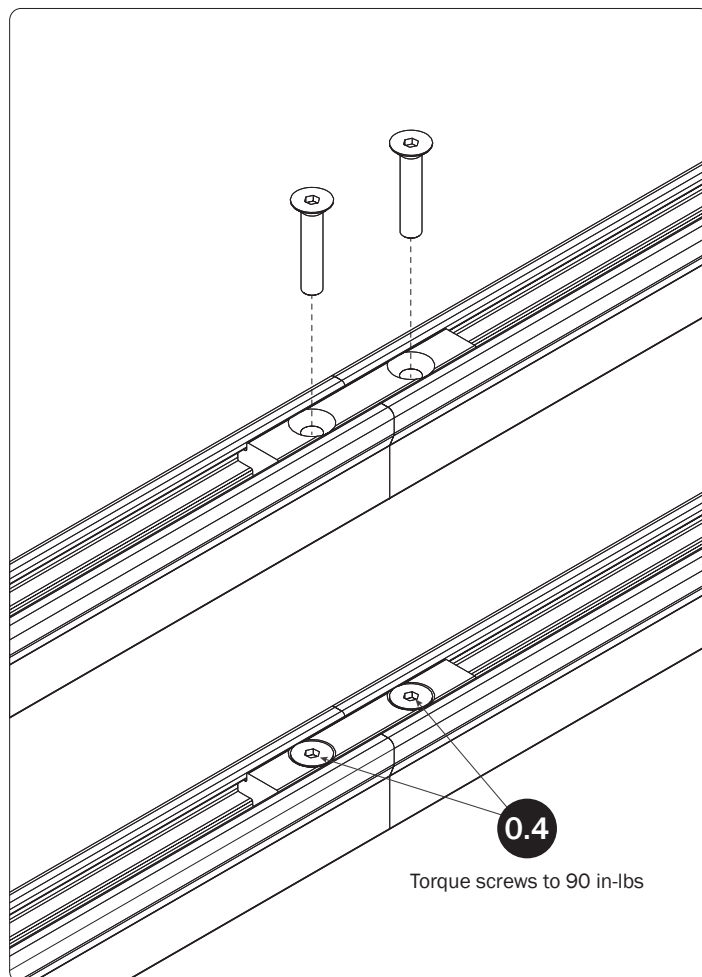
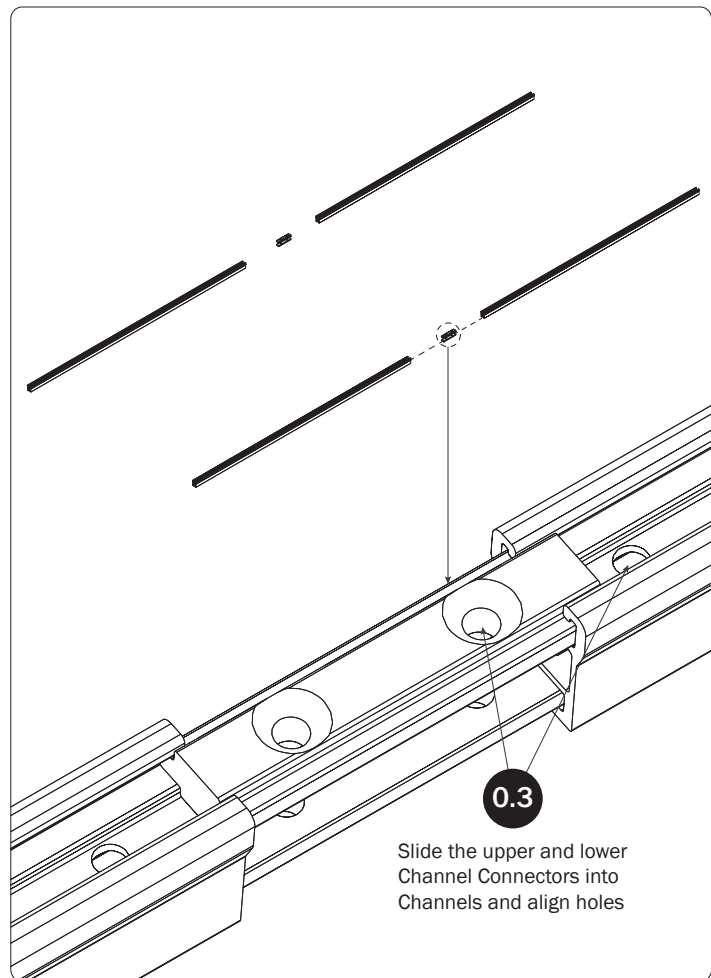
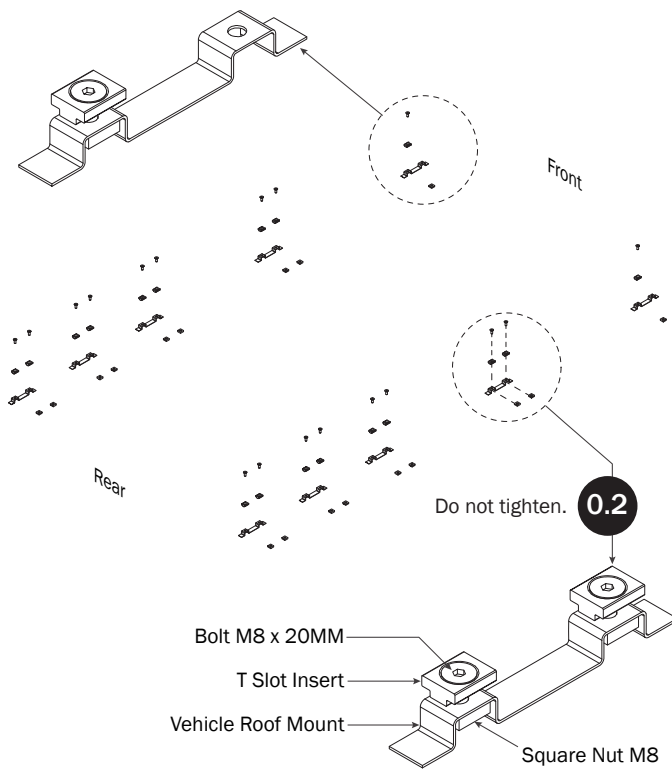
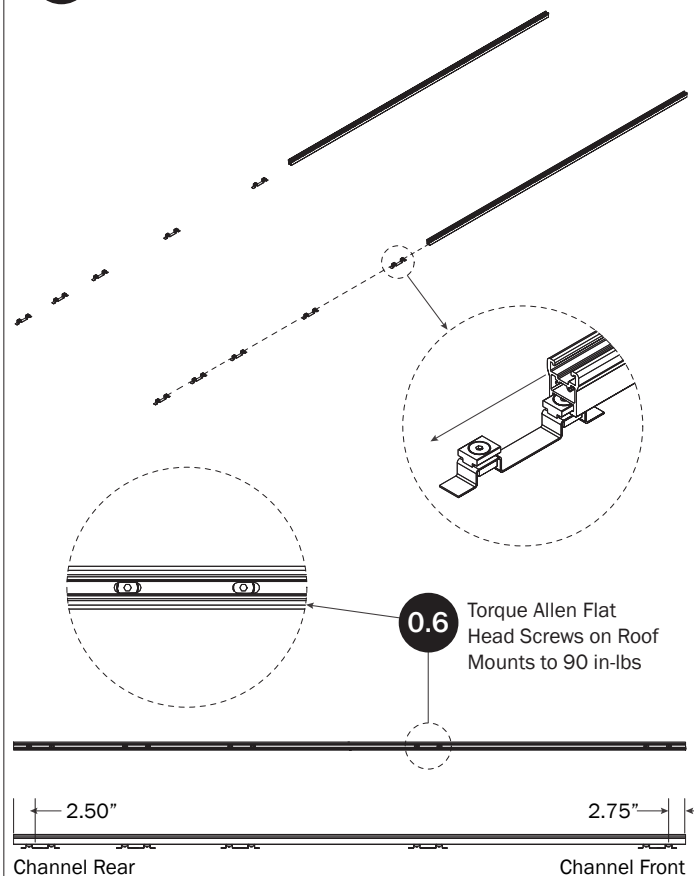
FBM-0048 MOUNTING SYSTEM
CHANNELS TO ROOF**0.1** Assemble Mounts as shown below.**0.5** Slide Channels onto roof Mounts and set distances as shown.

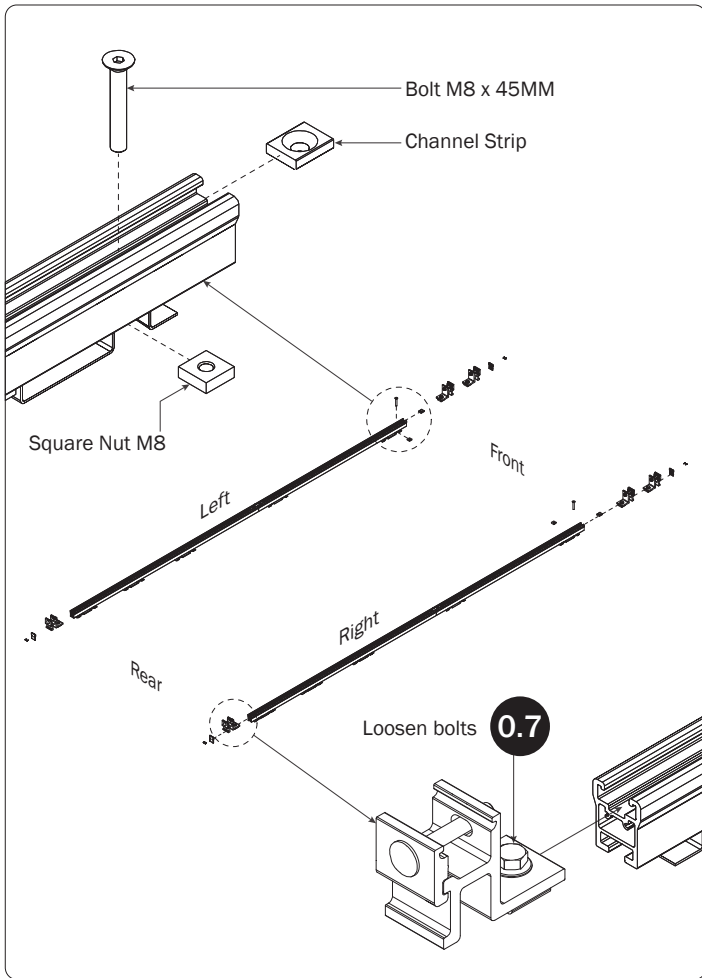

0.8 Finger-tighten to retain positions. Do not torque until Step 1.2

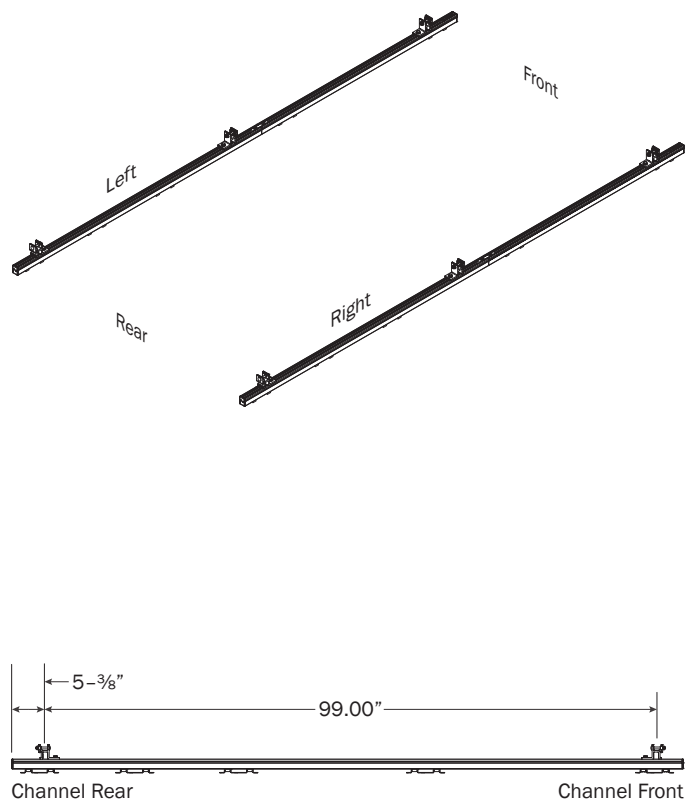

RIGHT INCLINE ROTATION ASSEMBLY SEQUENCE

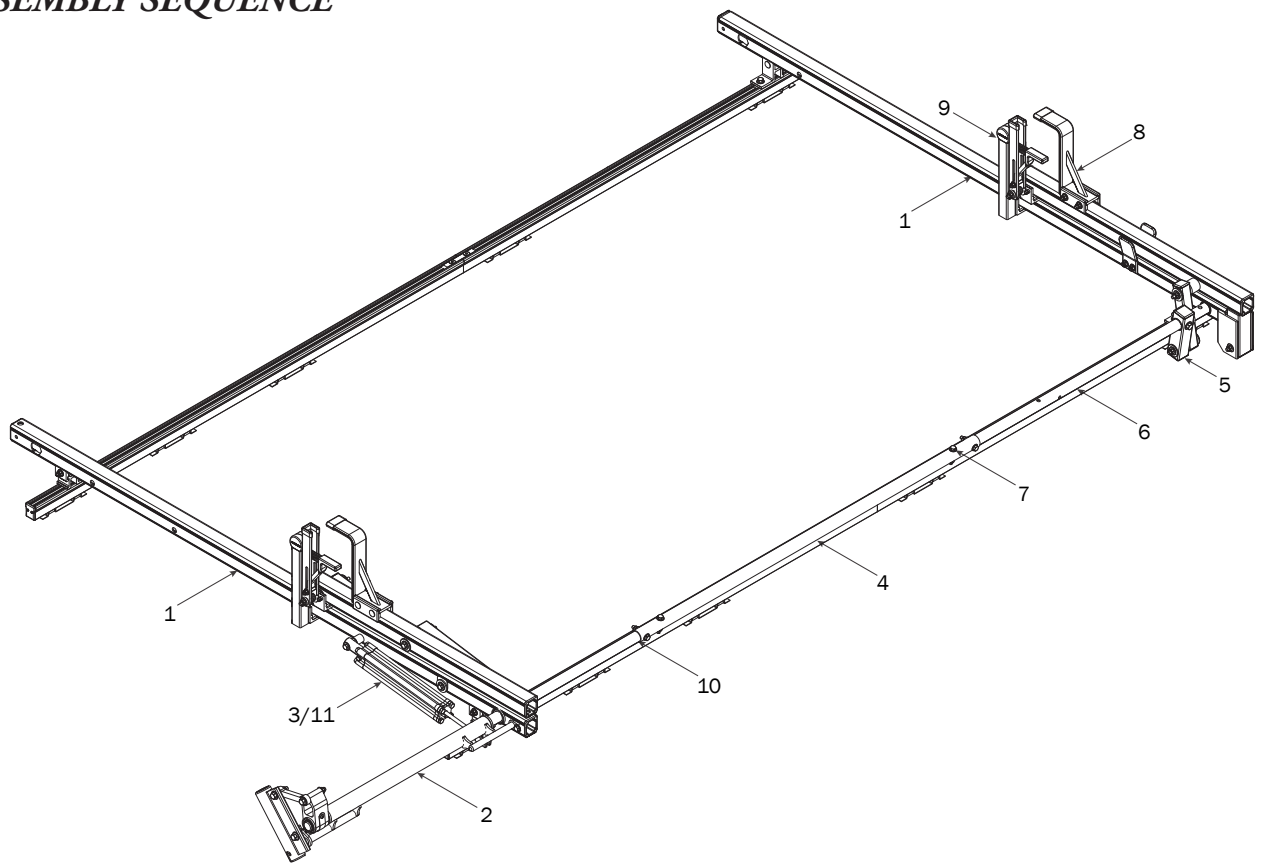

CROSSBARS

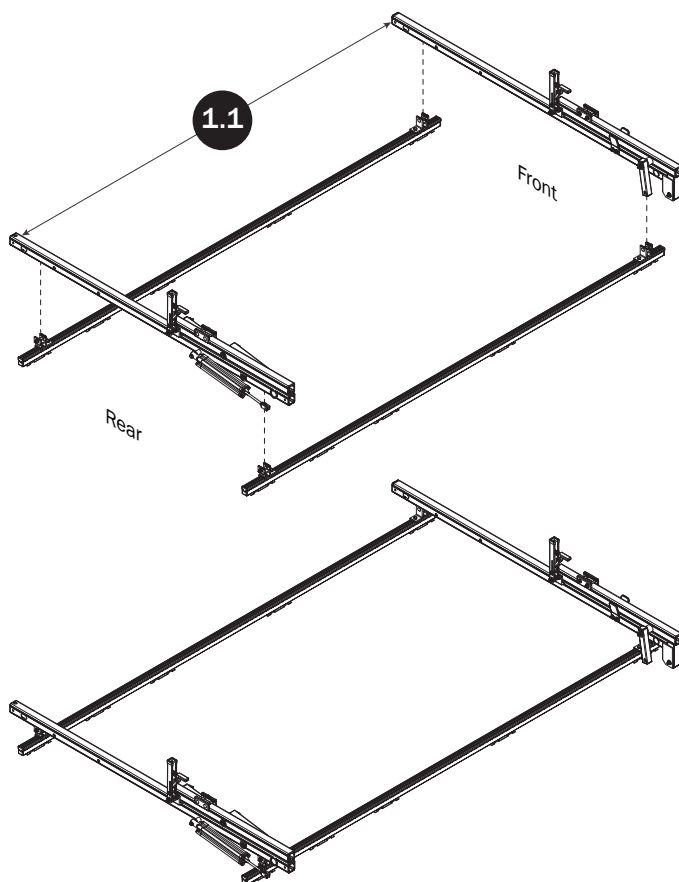

CROSSBAR ADJUSTMENT

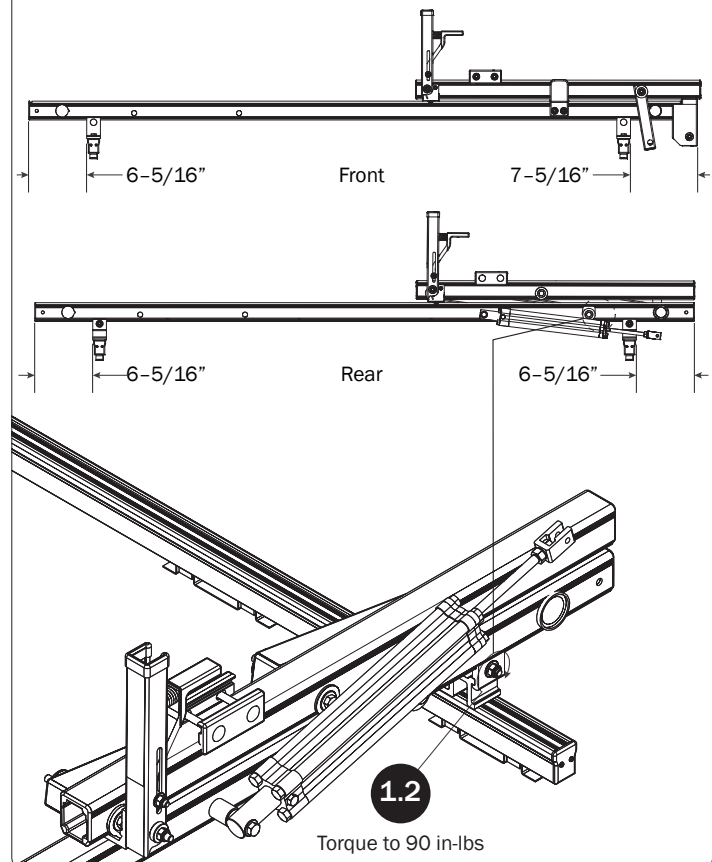

REAR DRIVE SHAFT

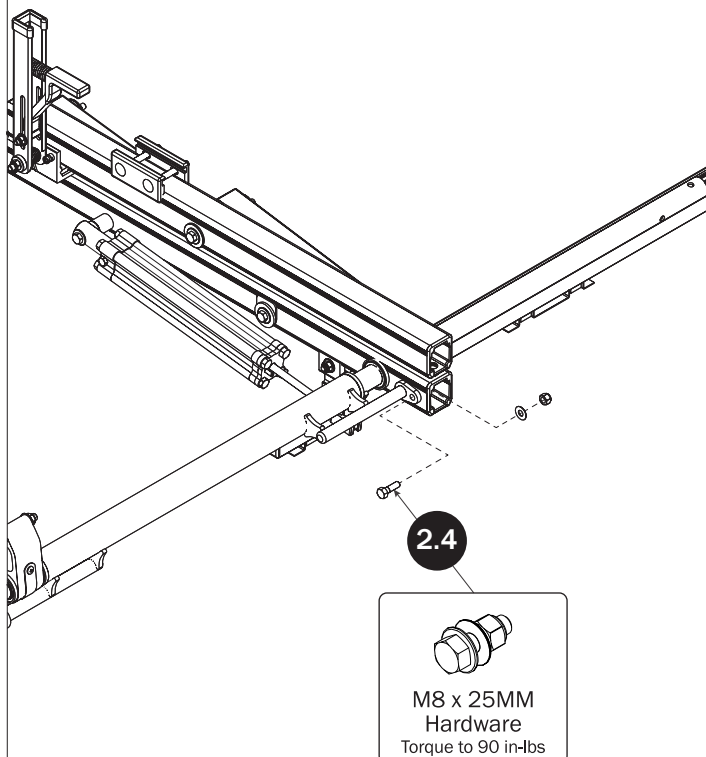
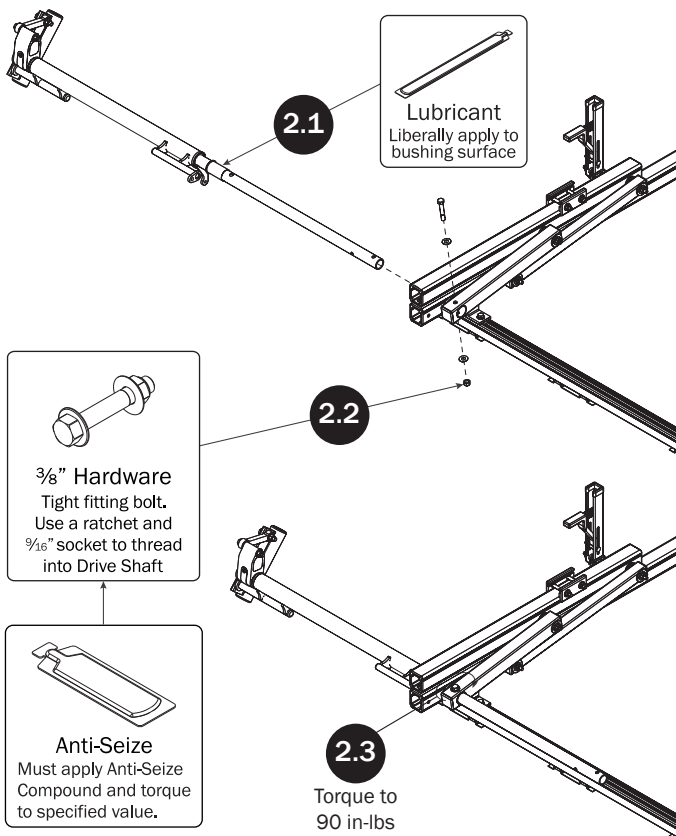

CYLINDER HARDWARE

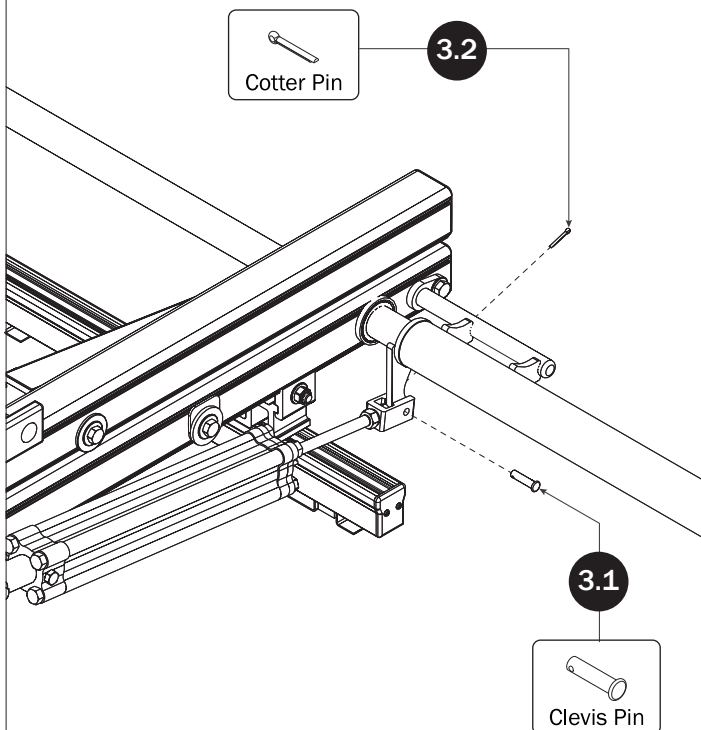

CONNECTING BAR

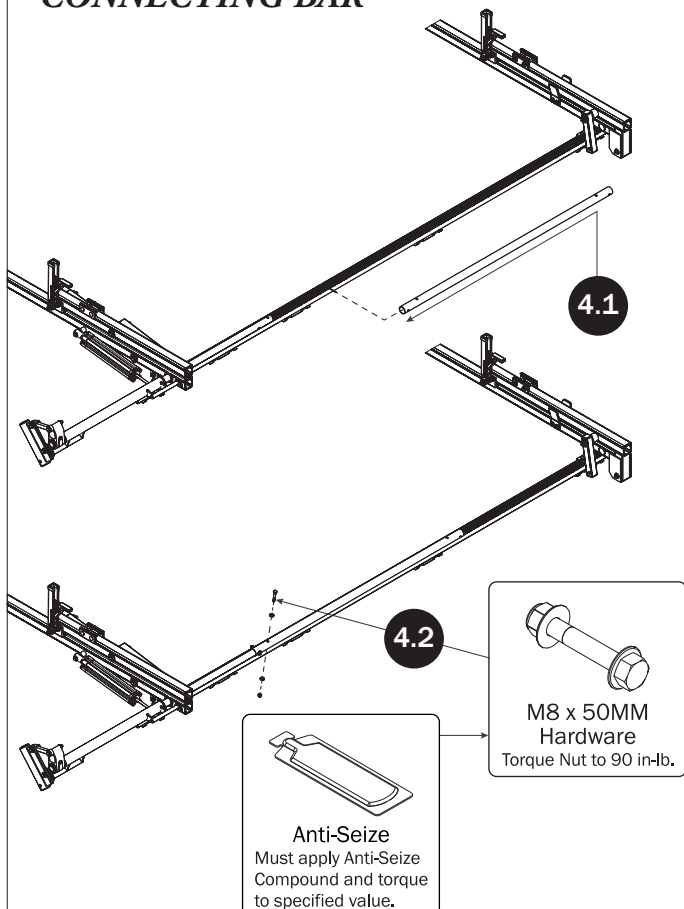

FRONT DRIVE ARM

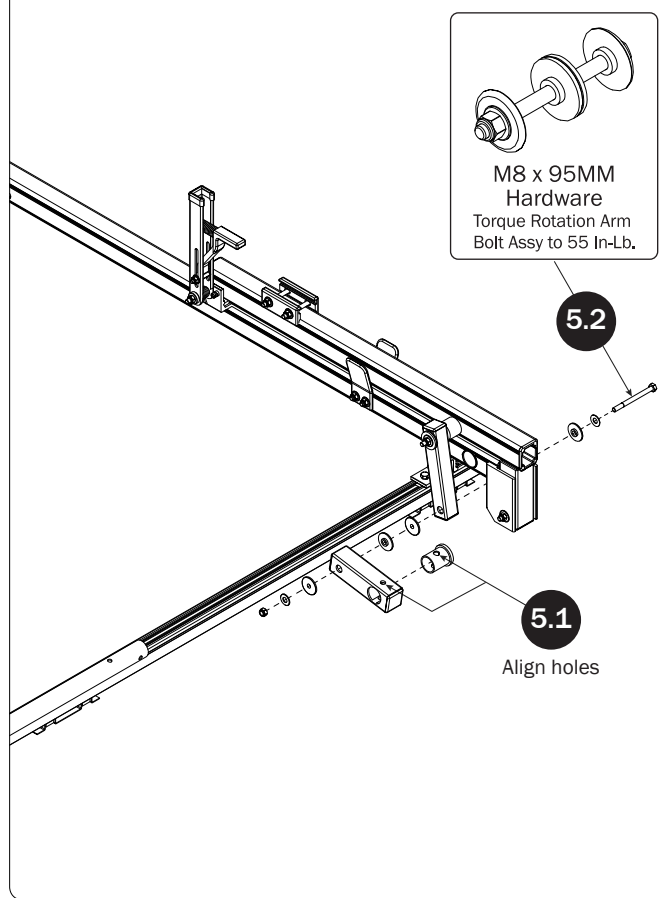

FRONT DRIVE SHAFT

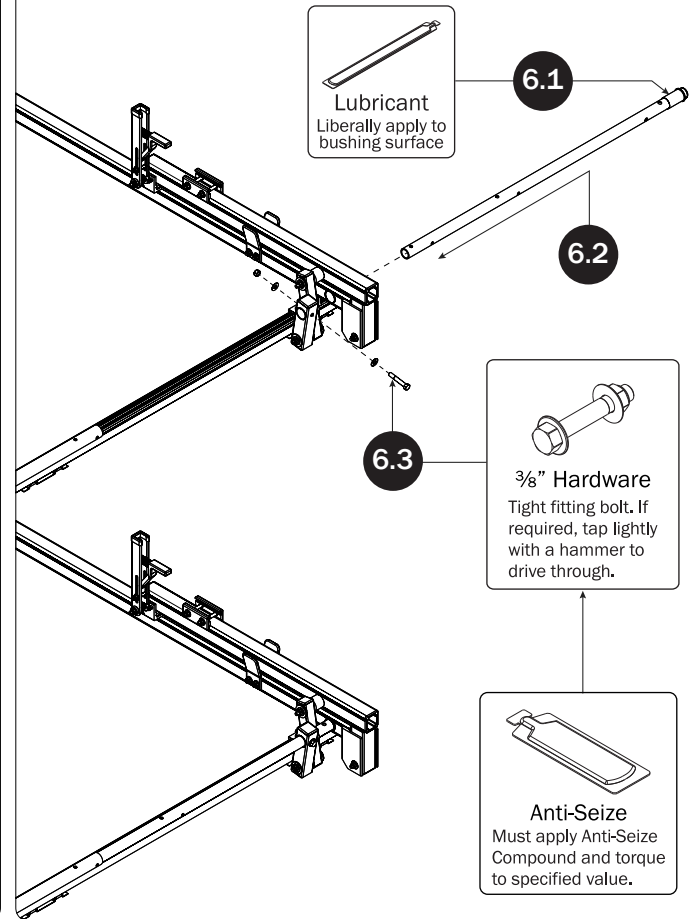

CONNECTING BAR FASTENERS

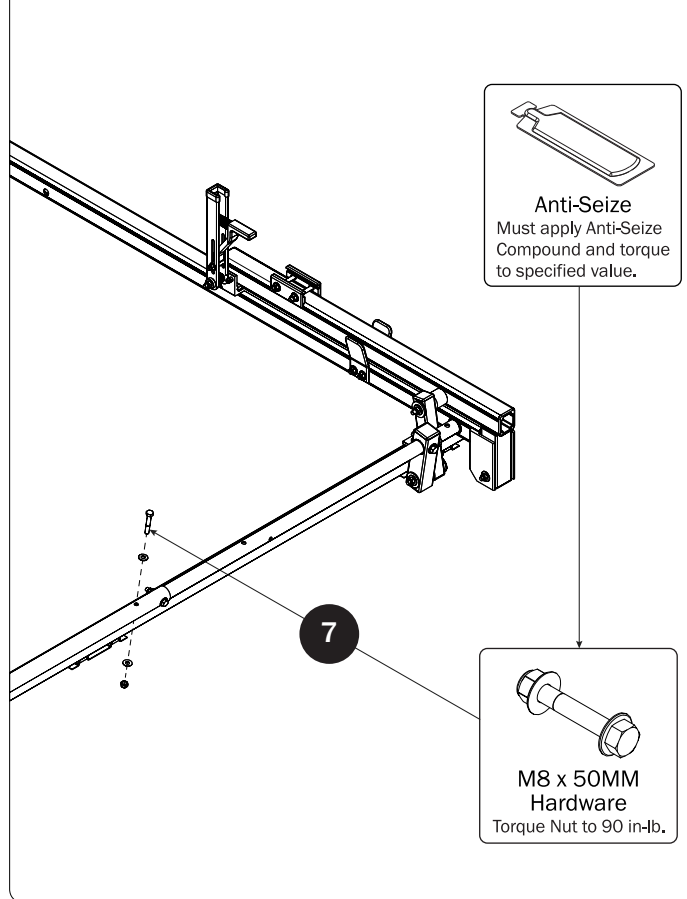

Z POST SEE QUICK START GUIDE FOR ADJUSTMENTS

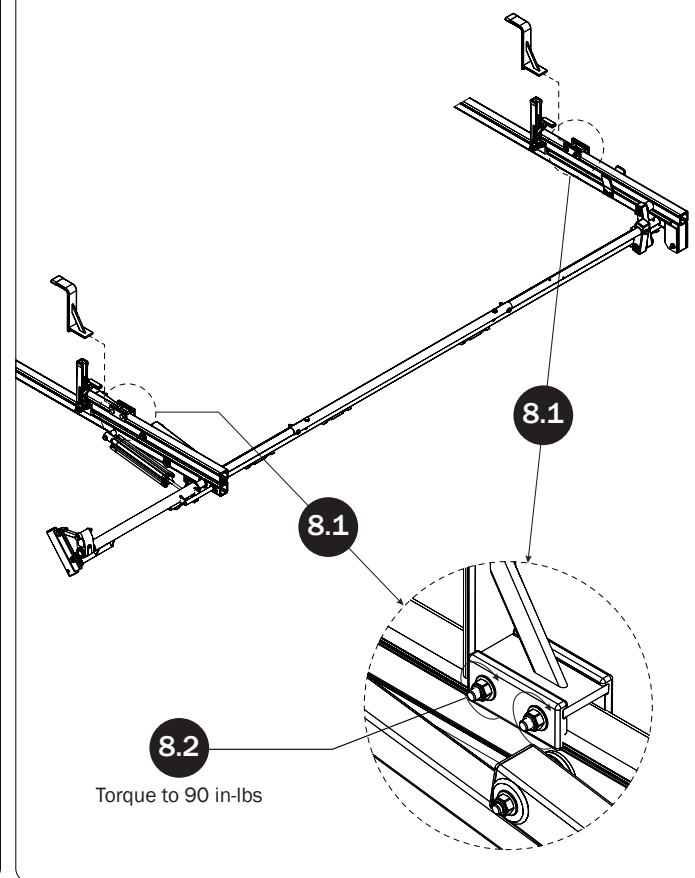

L POST

SEE QUICK START GUIDE FOR ADJUSTMENTS

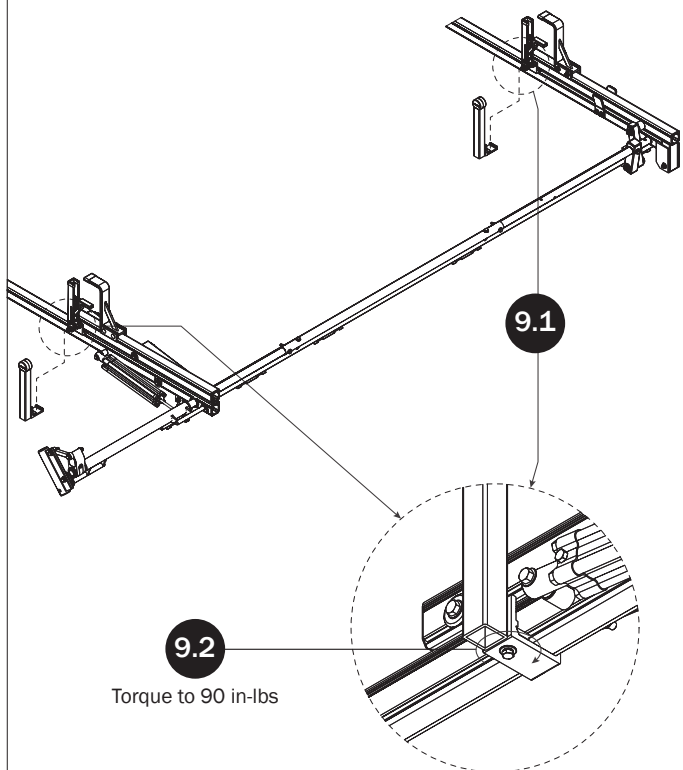

DRIVE SHAFT SEALING

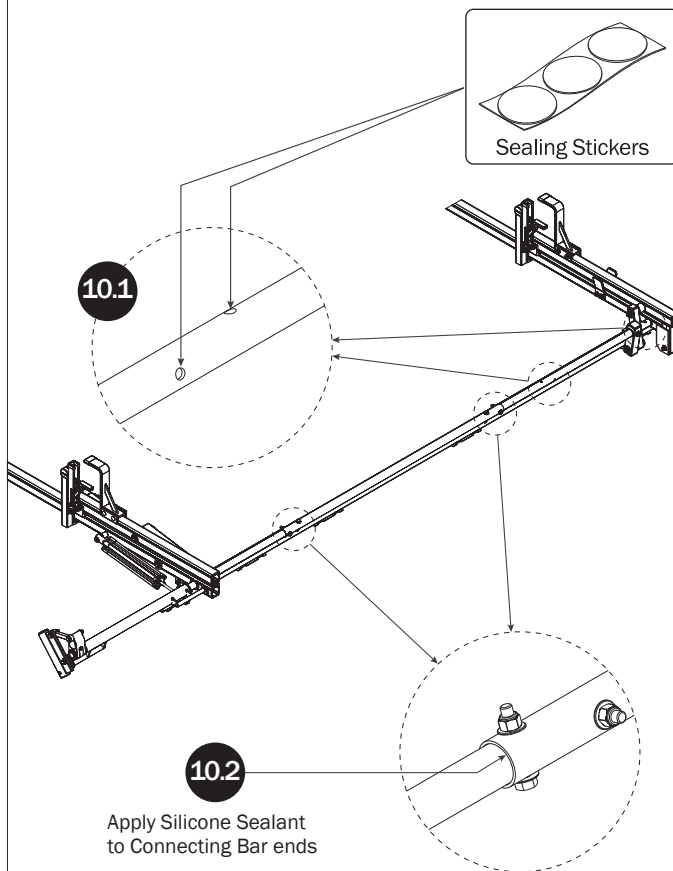

CYLINDER ADJUSTMENT

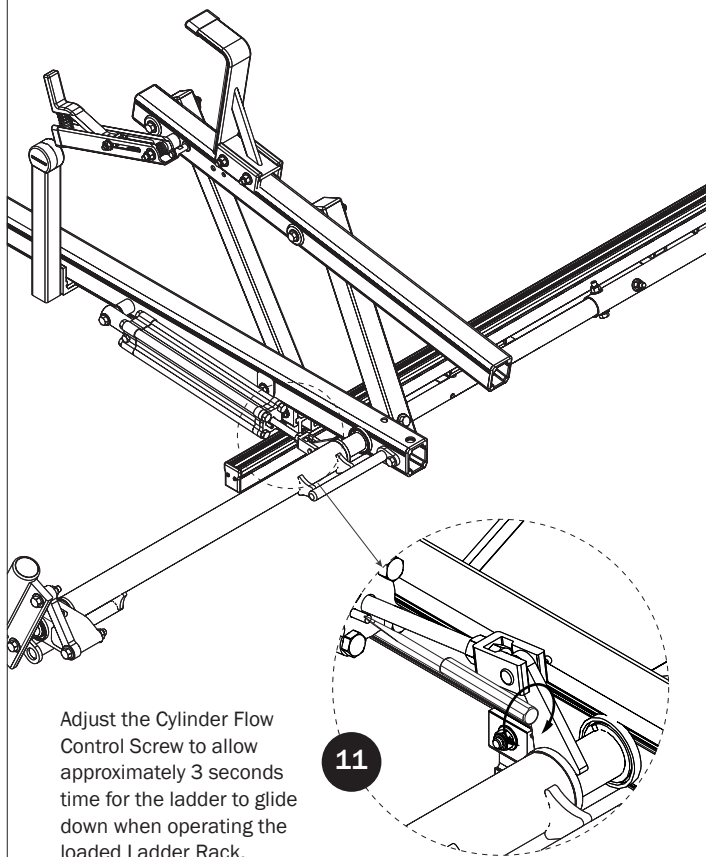

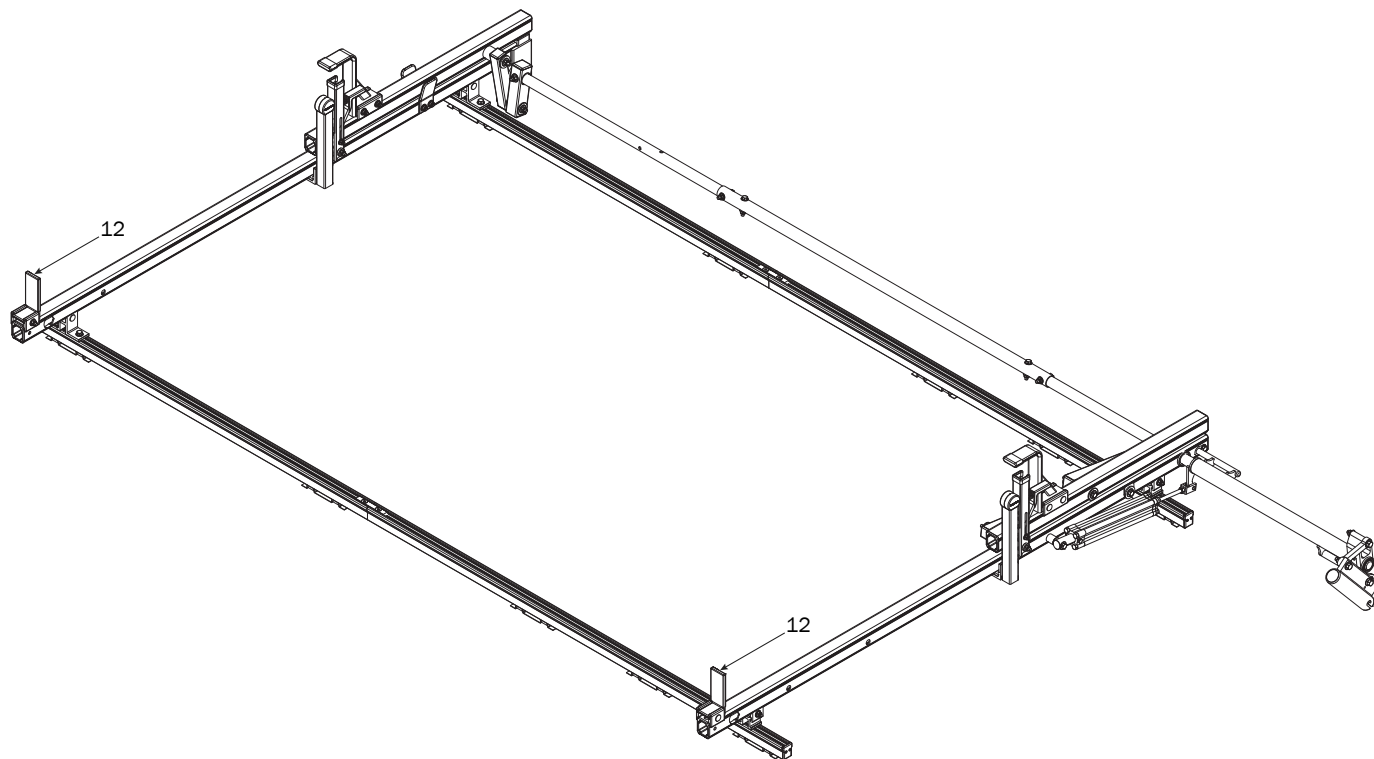
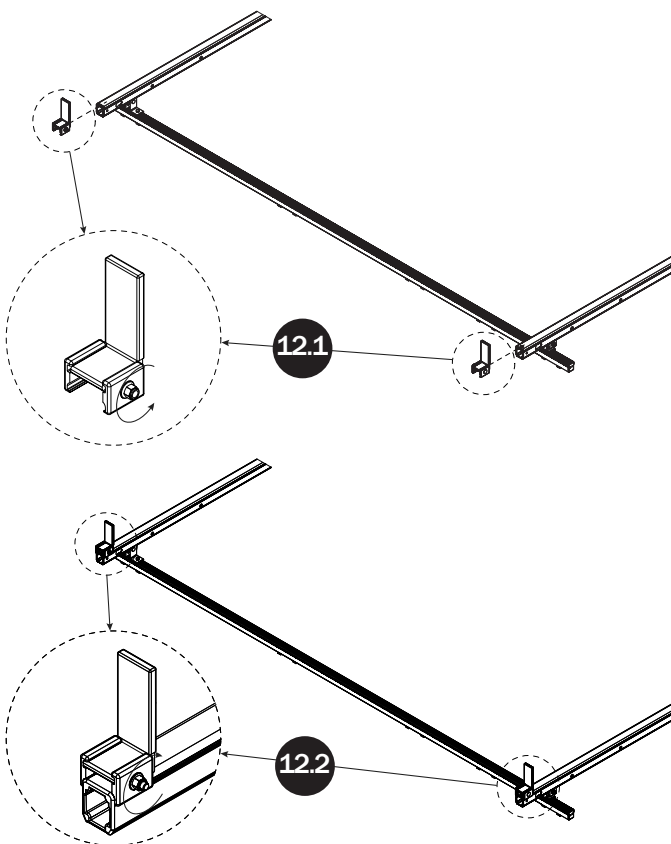
LEFT SIDE BASE**LADDER STOPS**

Page Intentionally Left Blank

