

PRIME DESIGN™

A Safe Fleet Brand

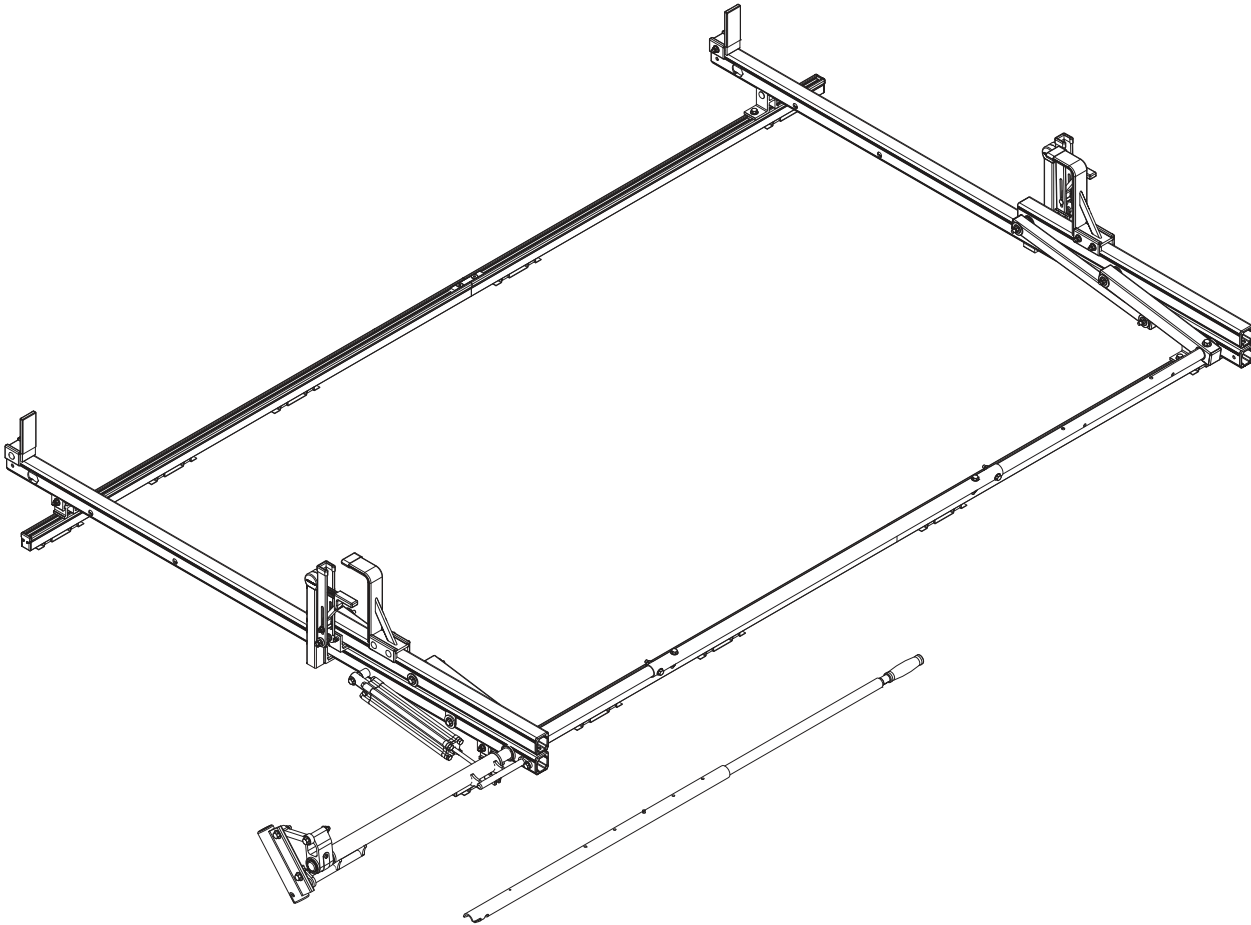

HBR VAN B

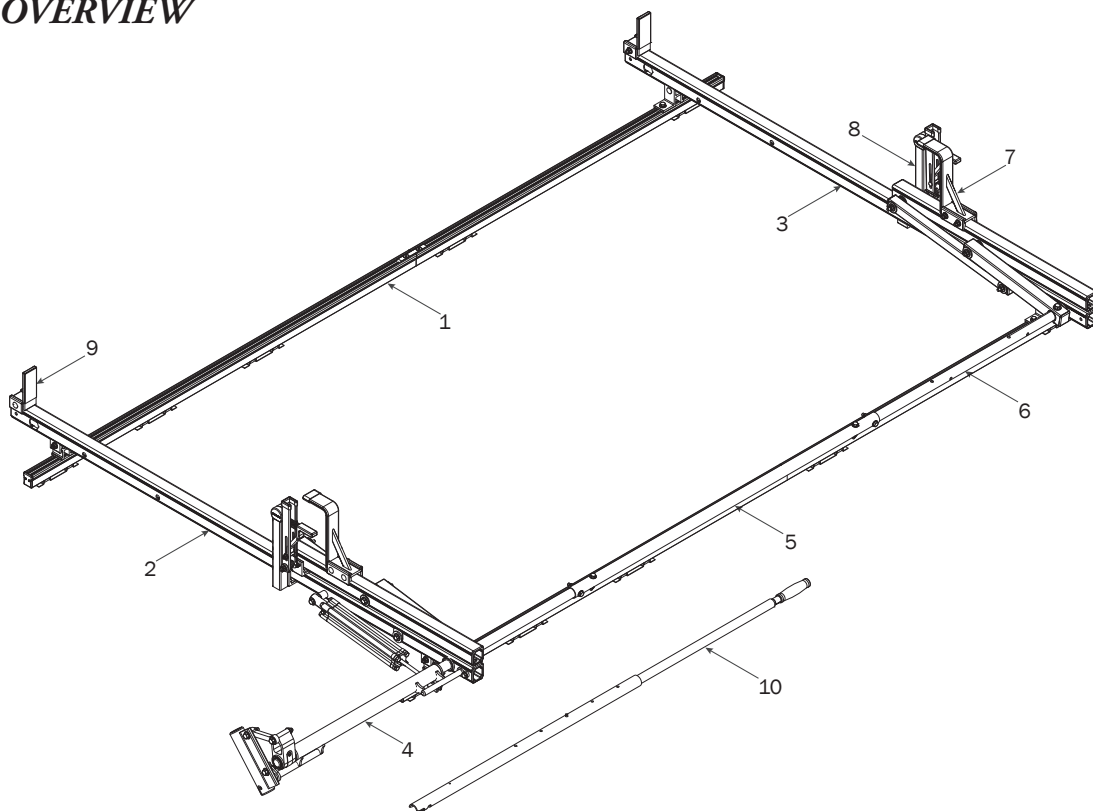

1—FBM-0048 (Qty 1)
Channels with hardware

Channels (2X)

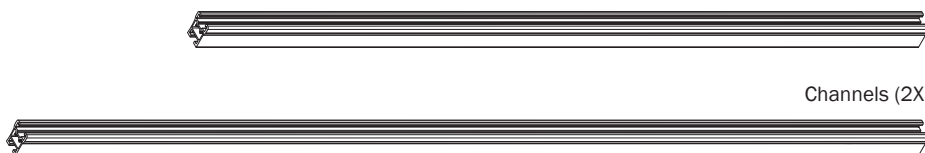

Channels (2X)



M8 x 45MM Bolt (2X)

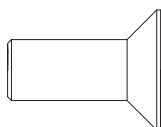

M8 x 20MM (18X)

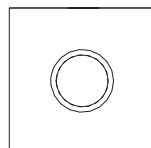

Square Nut (20X)

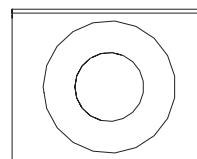

T Slot Insert (18X)

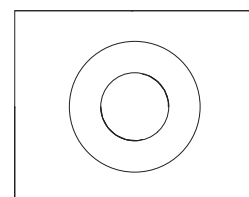

Channel Strip (2X)



Brackets (4X)



Top Connector (2X)



Bottom Connector (2X)



End Caps (4X)



Screws (8X)

M8 x 40MM Bolt (2X)

2—Rear Crossbar Assembly (Qty 1)

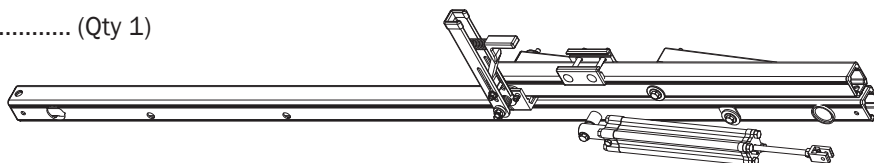

3—Front Crossbar Assembly (Qty 1)

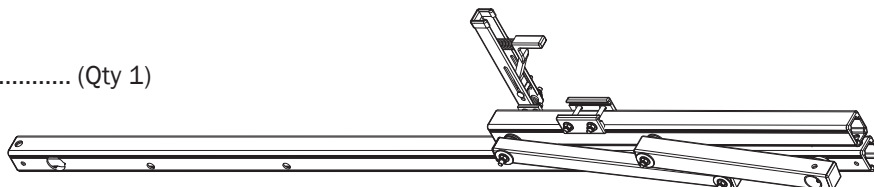

4—Drive Shaft (Qty 1)
Rear, Right Hand, 50.00"

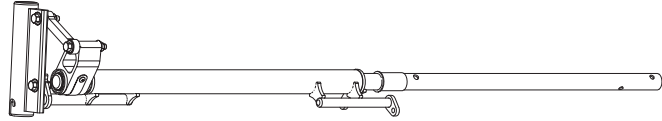

5—Connecting Bar (Qty 1)
48.00"



6—Front Drive Shaft (Qty 1)
B Version, 35.75"



7—Z Post (Qty 1)
Adjustable, 7.25"

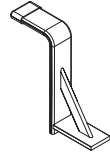

8—L Post (Qty 1)
Gen2, Roller Cap, 9.25"

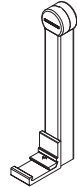

9—Ladder Stop Assembly (Qty 2)
1.75"

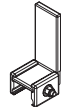

10—HRR Removeable Handle Assembly (Qty 1)

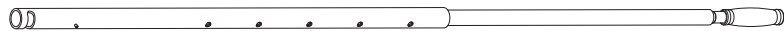

11—HKT-8163 (Not called out in Overview) (Qty 1)

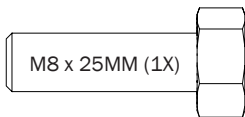

M8 x 25MM (1X)



M8 x 50MM (4X)

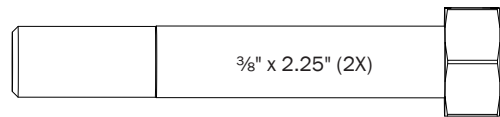

3/8" x 2.25" (2X)



Cotter Pin (1X)

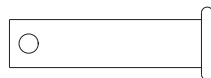

Clevis Pin (1X)

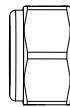

M8 Lock Nut (5X)



3/8" Lock Nut (2X)

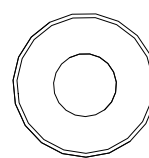

5/16" Flat Washer (10X)

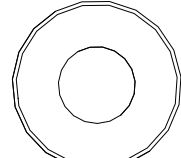

3/8" Flat Washer (4X)

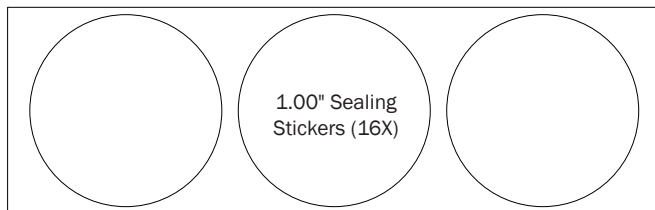

1.00" Sealing
Stickers (16X)



Anti-Seize (1X)

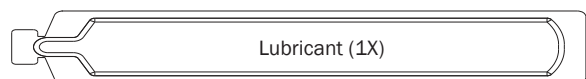

Lubricant (1X)

FBM-0048 MOUNTING SYSTEM CHANNELS TO ROOF

0.1 Assemble Mounts as shown below.

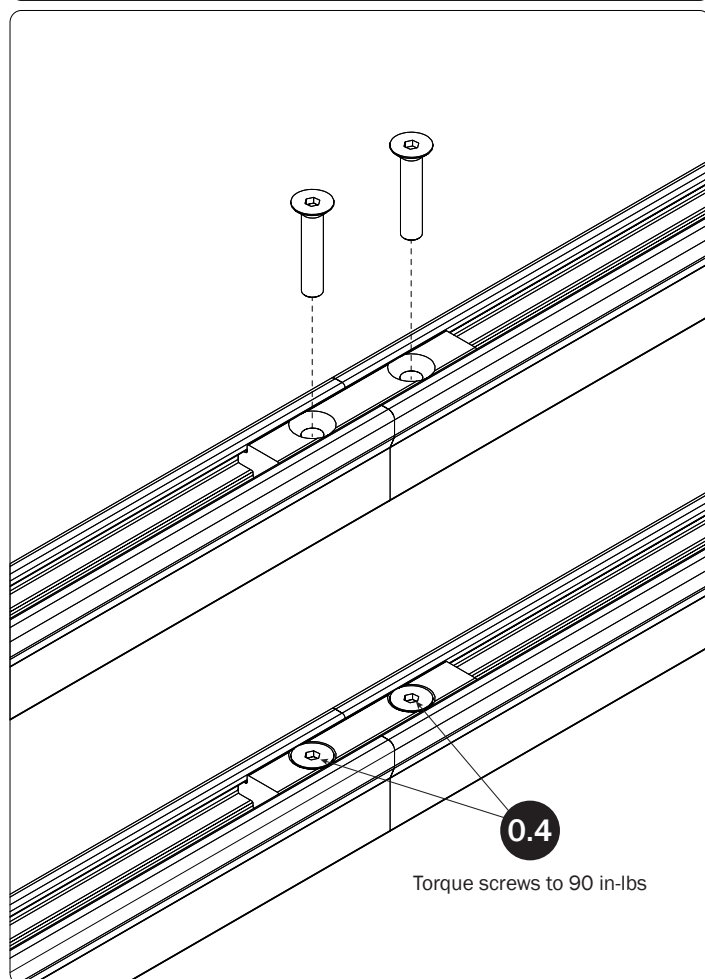
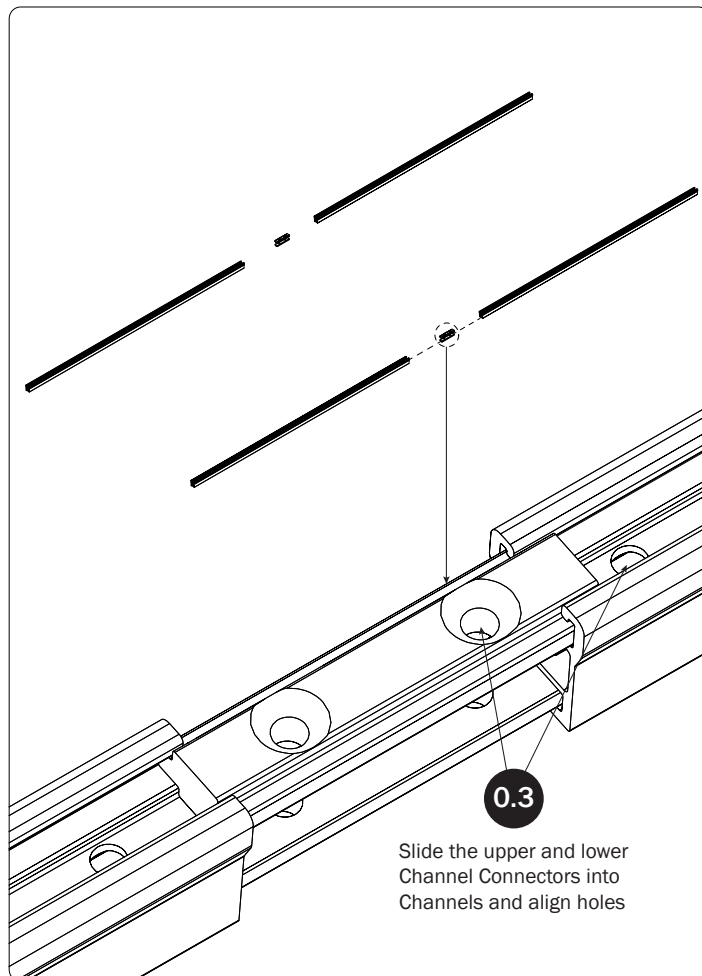
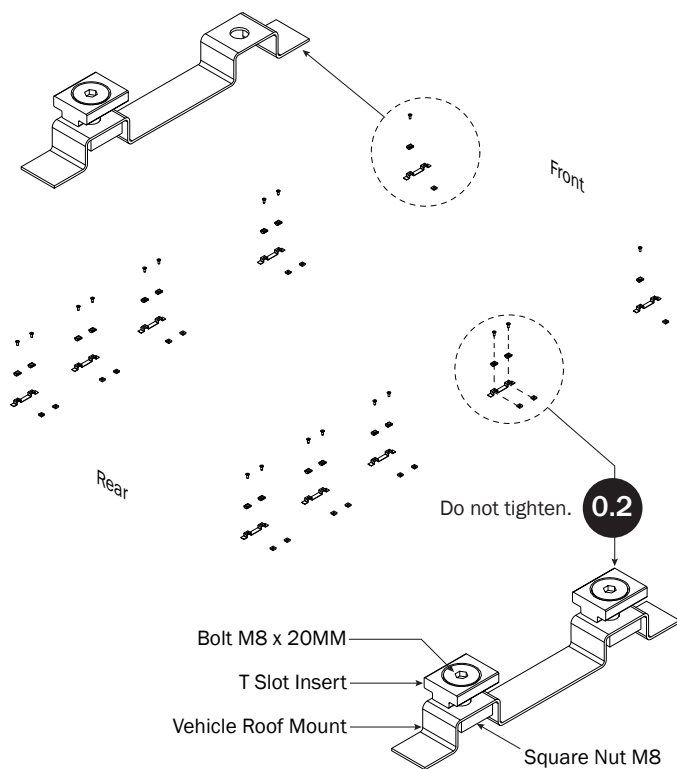

0.5 Slide Channels onto roof Mounts and set distances as shown.

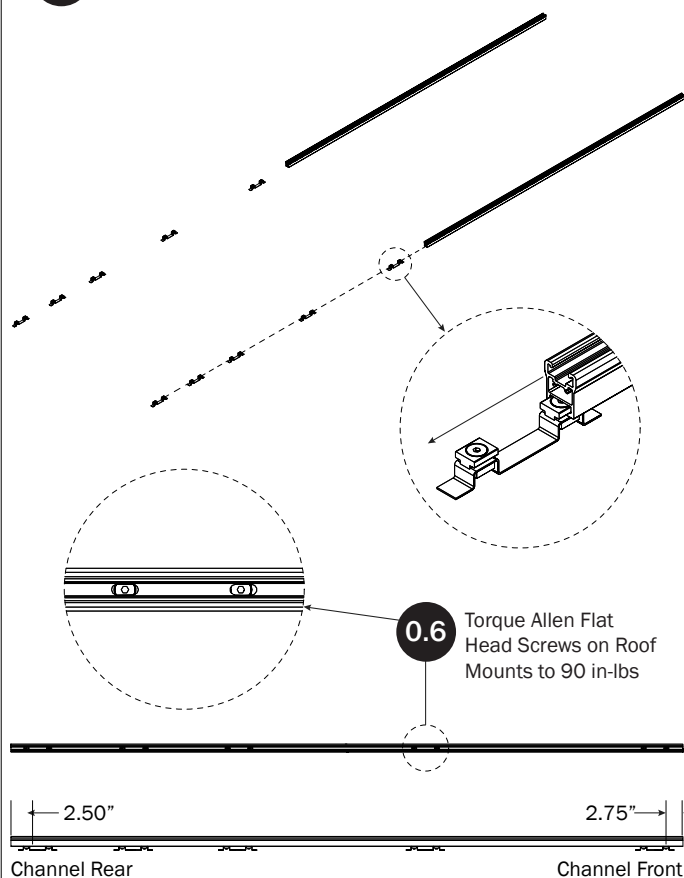

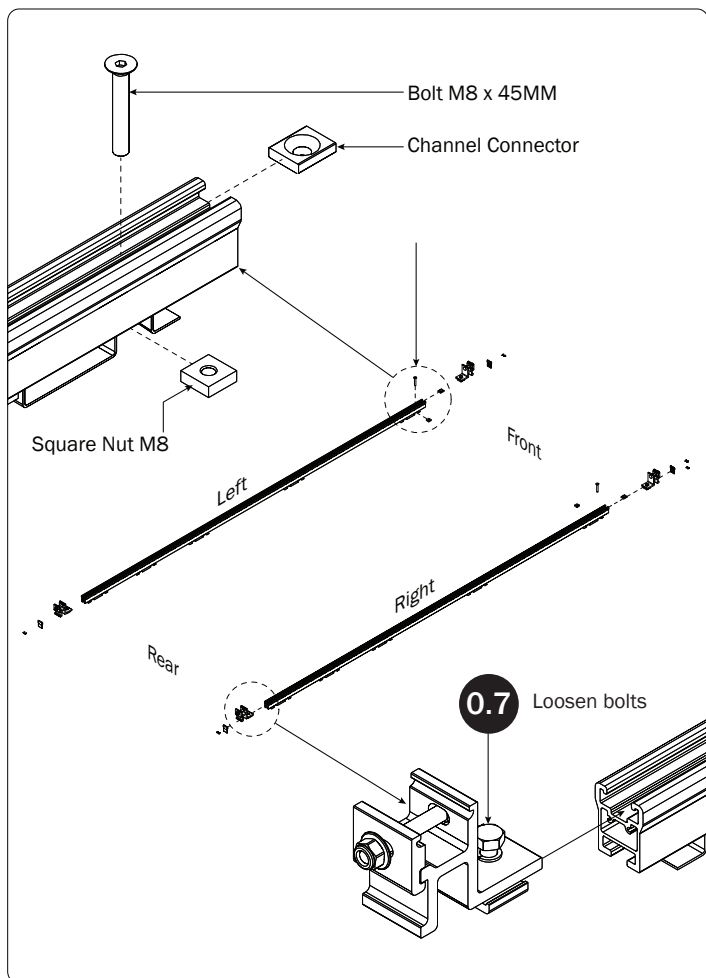

0.8 Finger-tighten to retain positions. Do not torque until Step 1.2

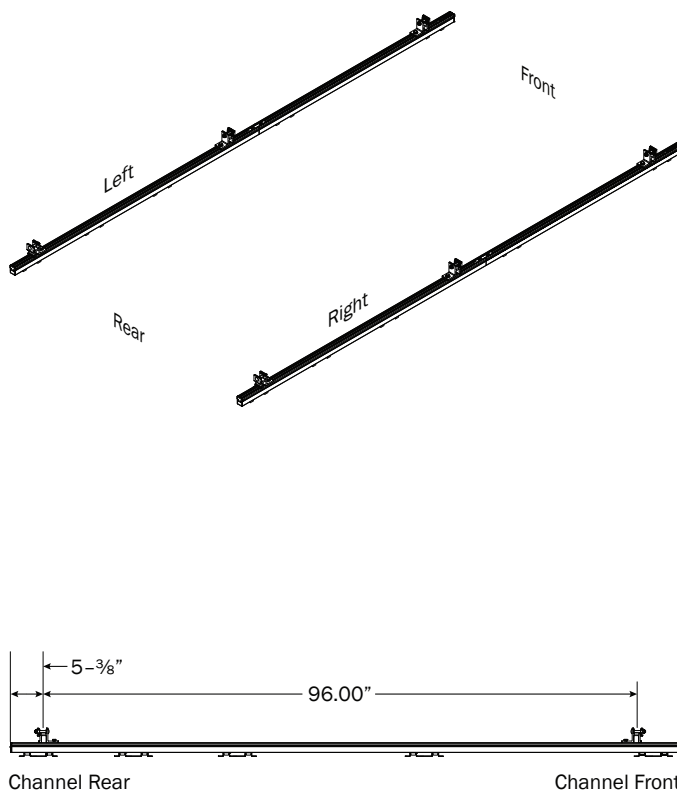

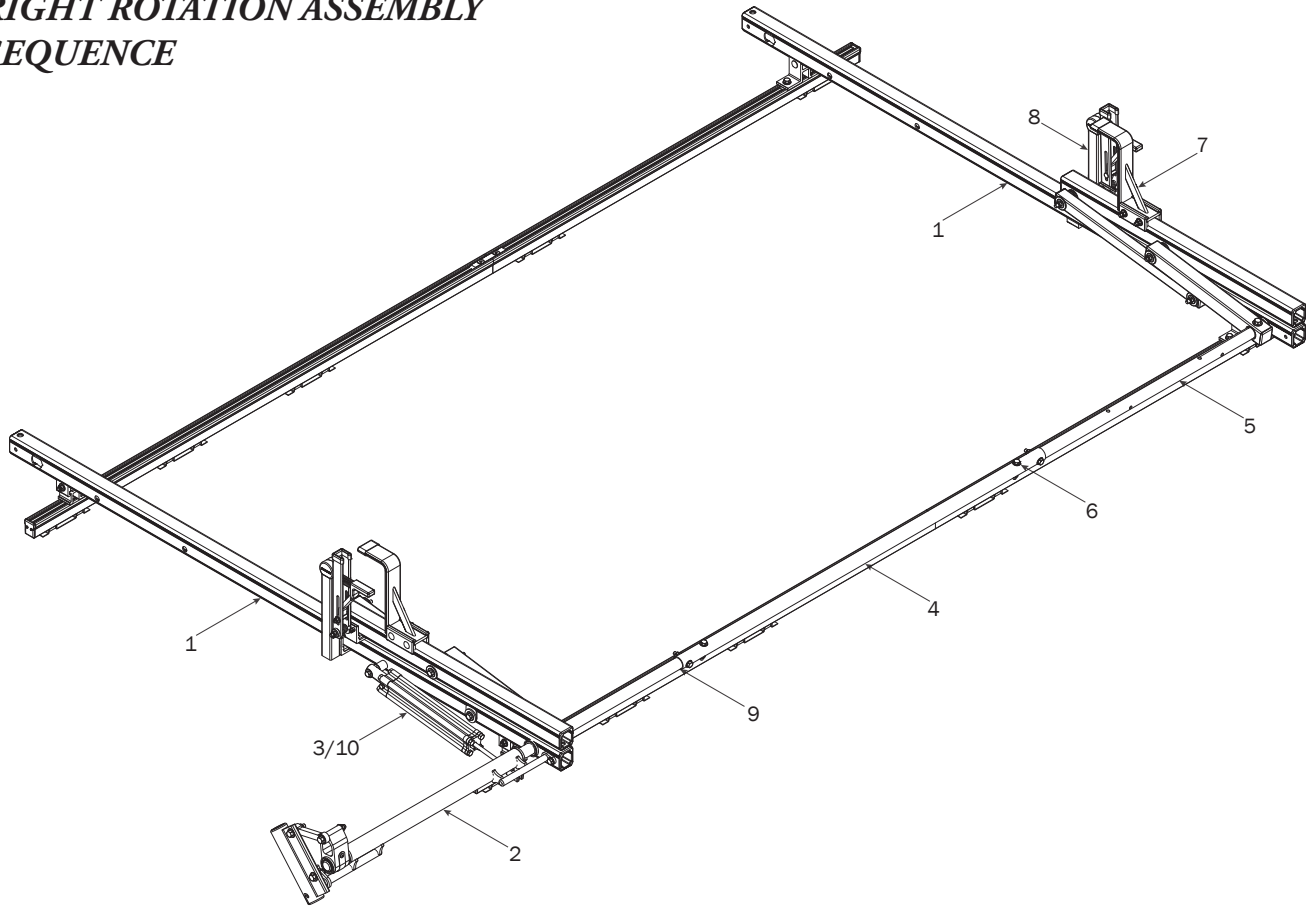
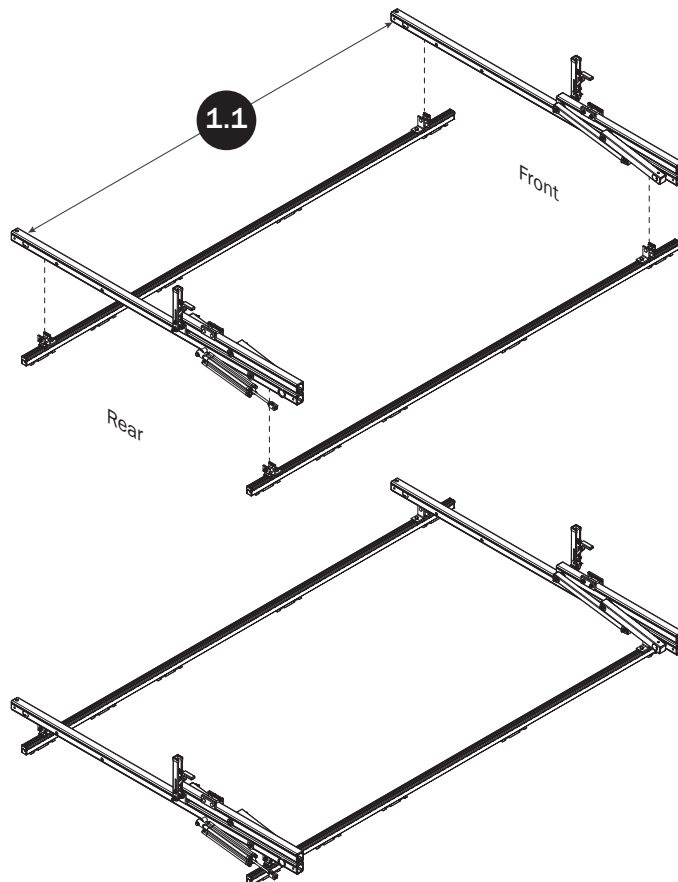
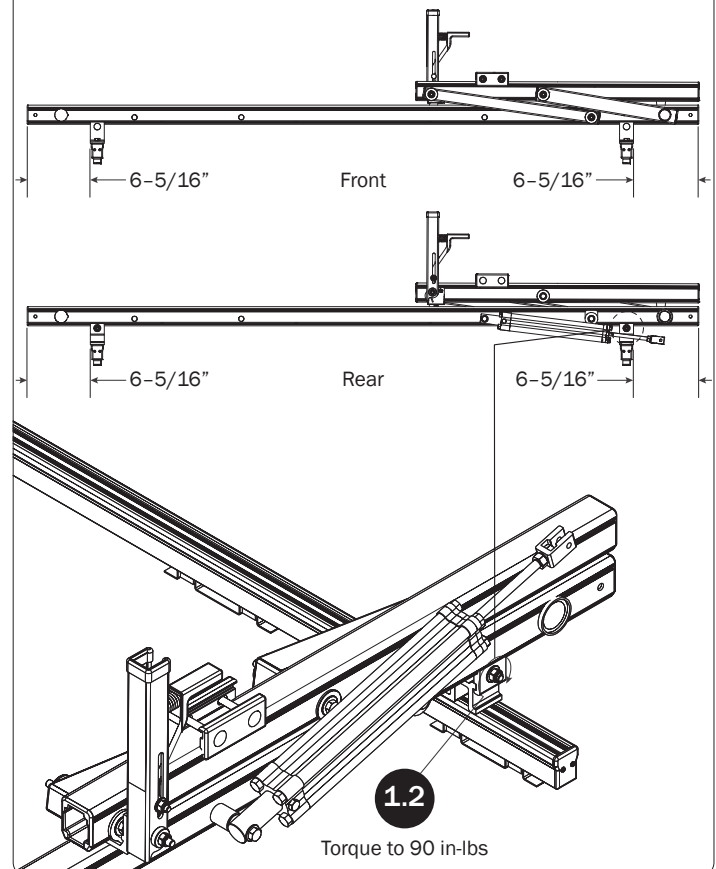
**RIGHT ROTATION ASSEMBLY
SEQUENCE****CROSSBARS****CROSSBAR ADJUSTMENT**

REAR DRIVE SHAFT

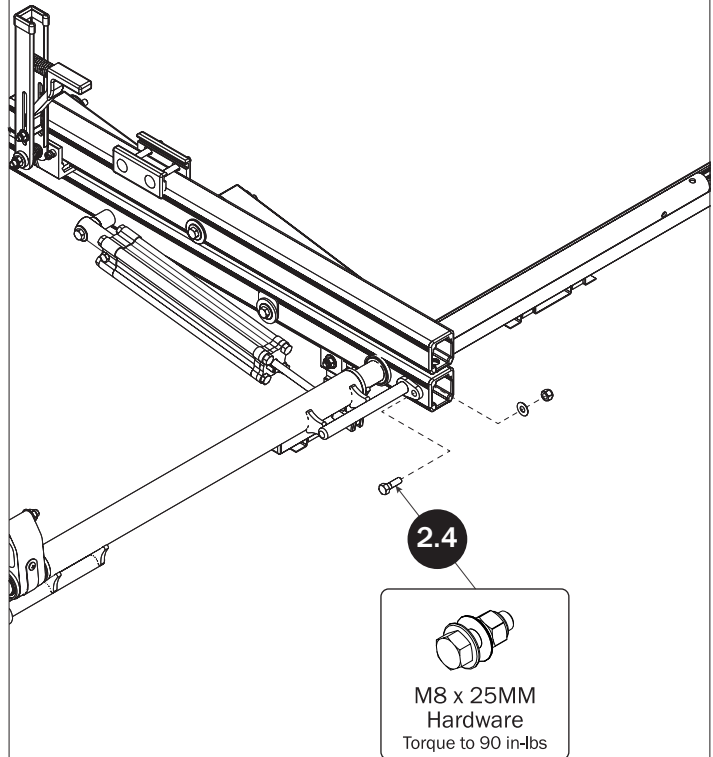
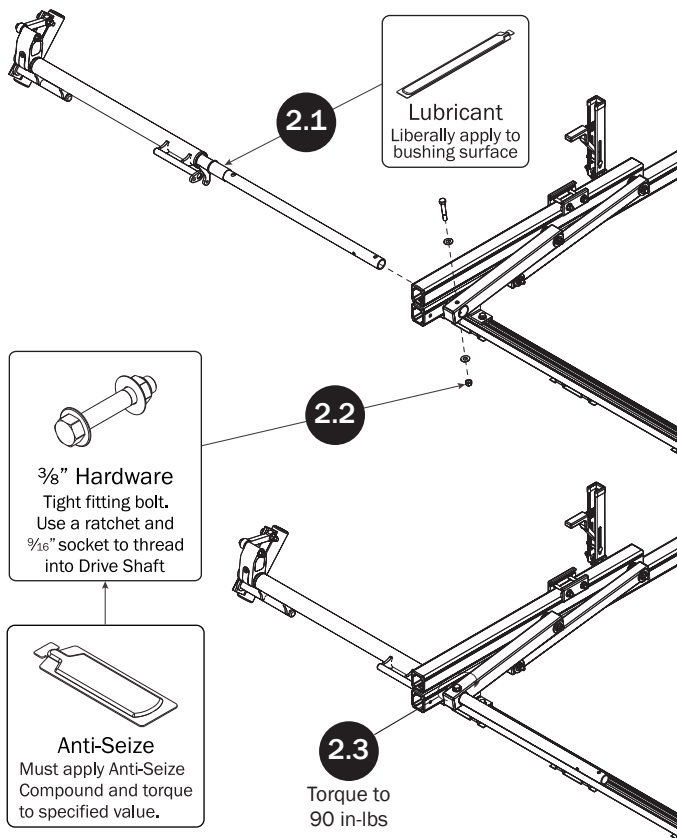

CYLINDER HARDWARE

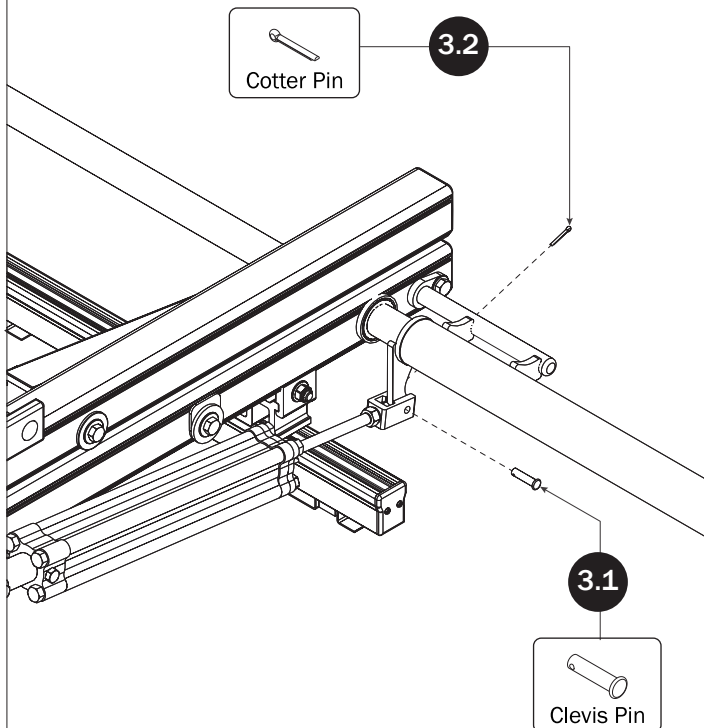

CONNECTING BAR

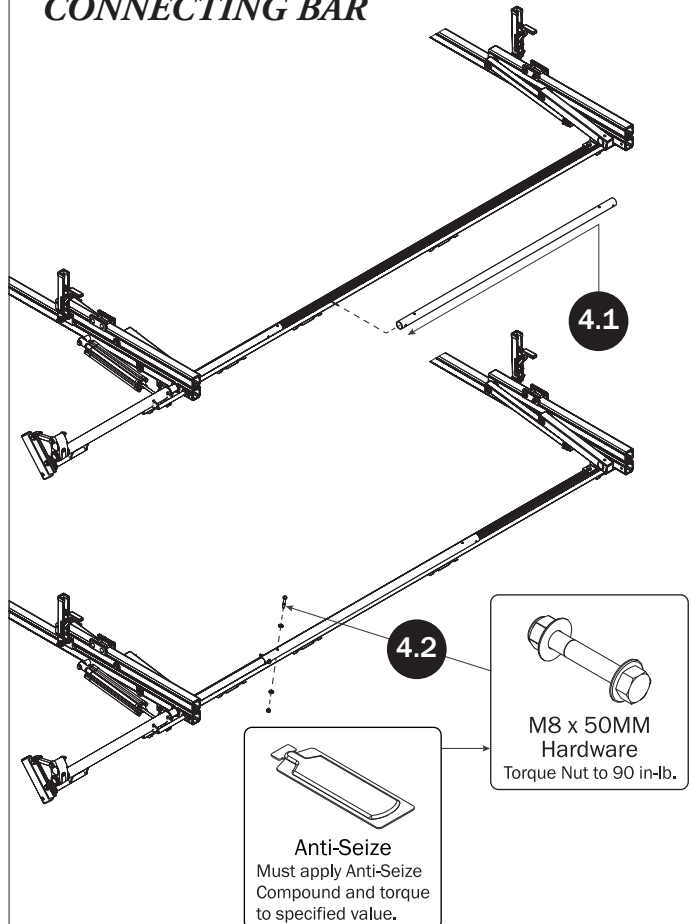

FRONT DRIVE SHAFT

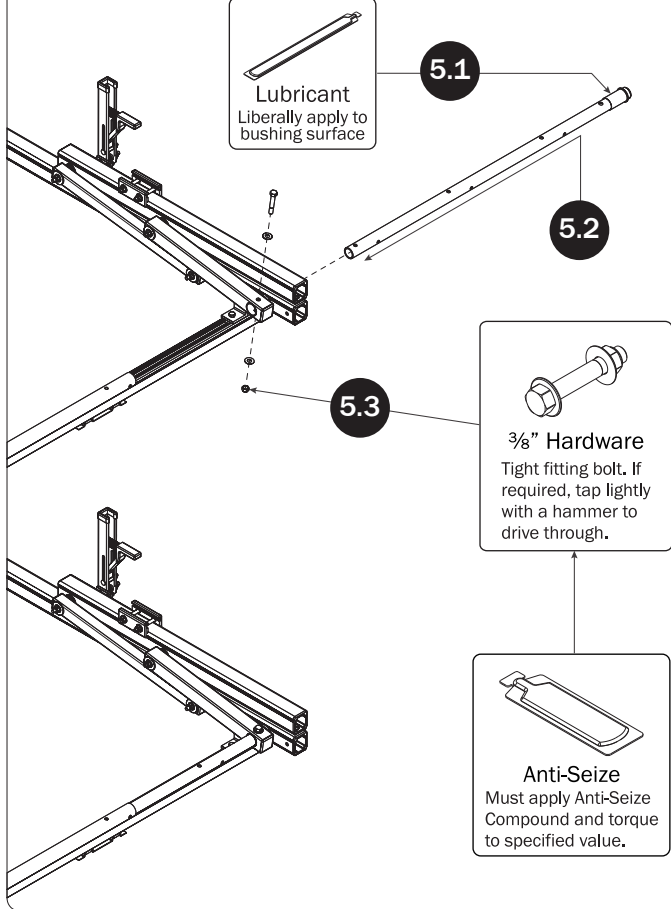

CONNECTING BAR FASTENERS

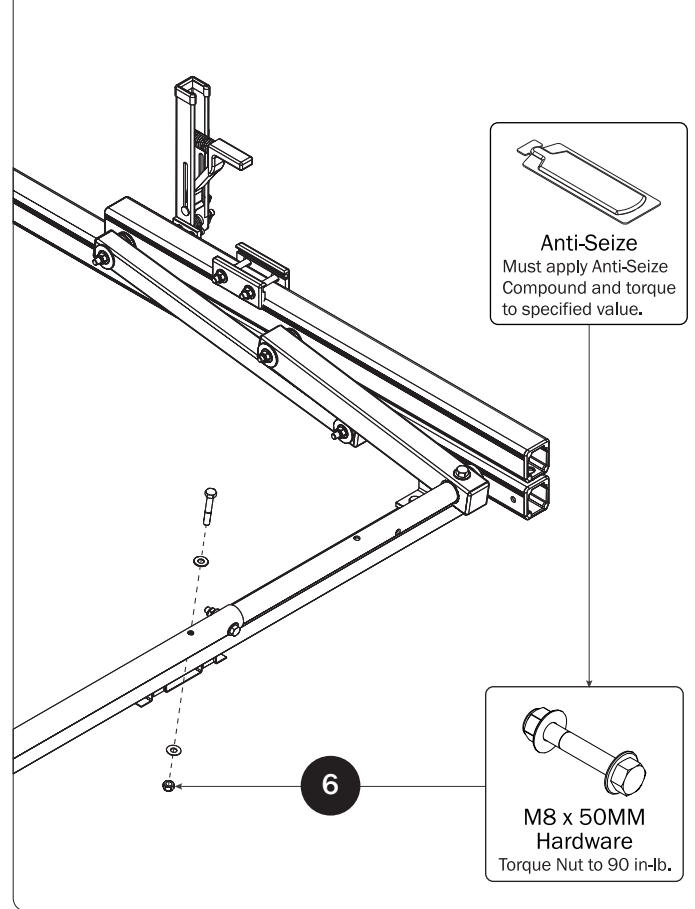

Z POST SEE QUICK START GUIDE FOR ADJUSTMENTS

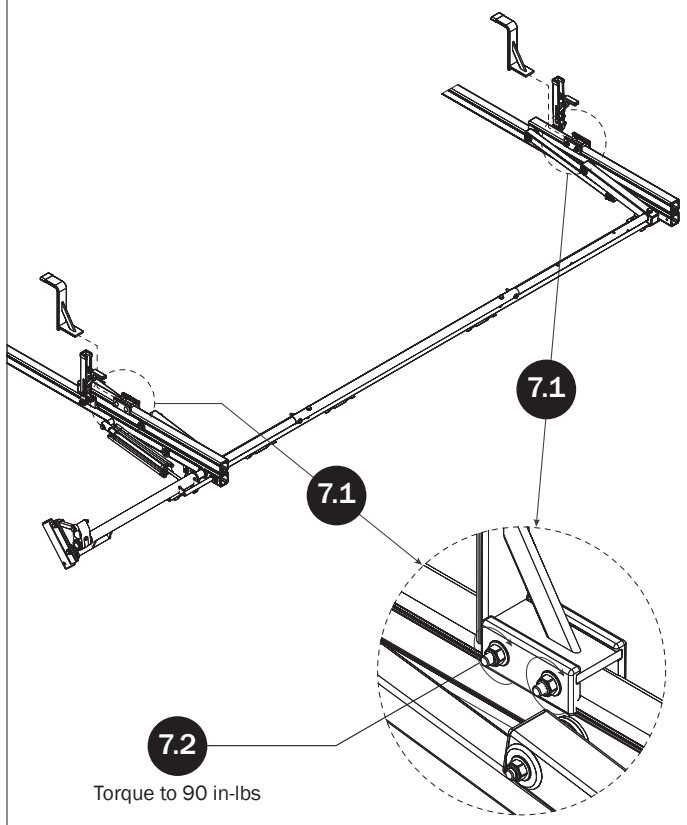

L POST SEE QUICK START GUIDE FOR ADJUSTMENTS

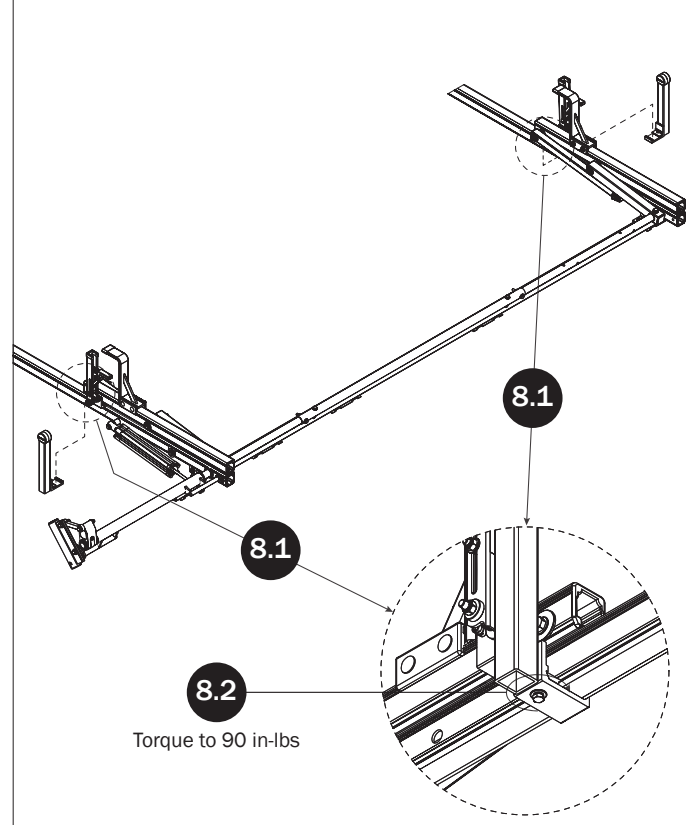

DRIVE SHAFT SEALING

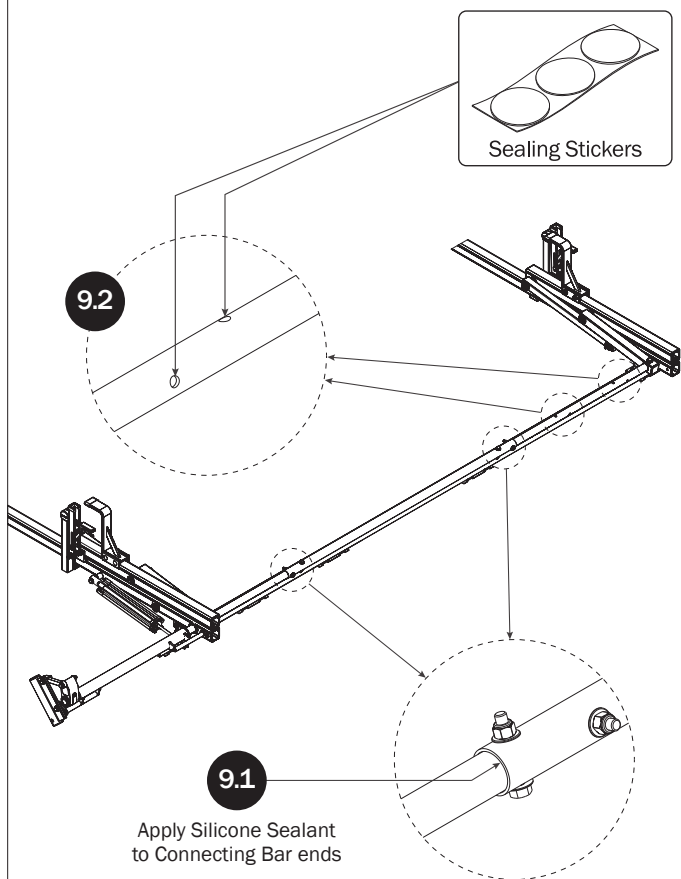

CYLINDER ADJUSTMENT

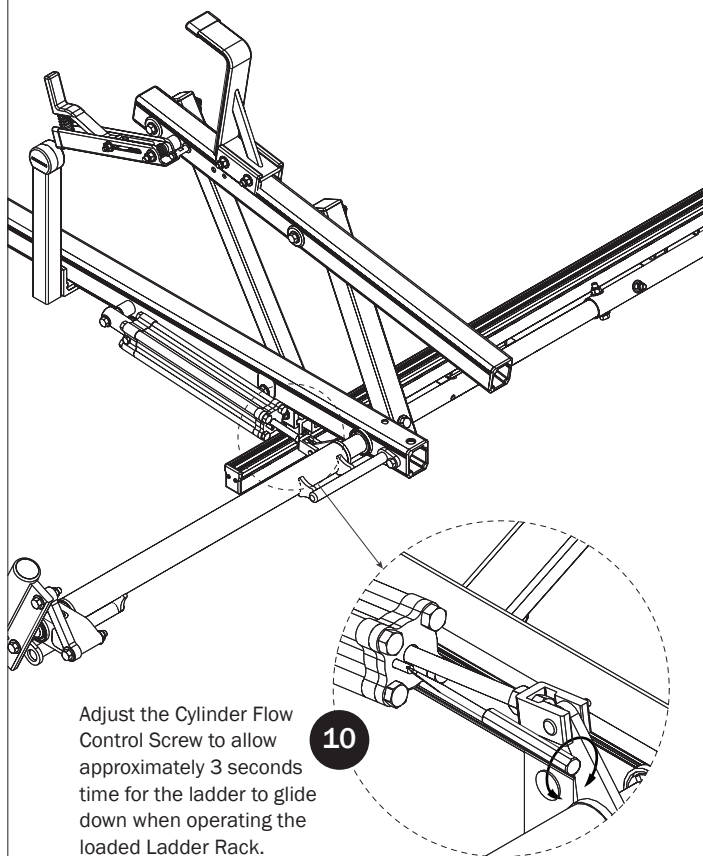

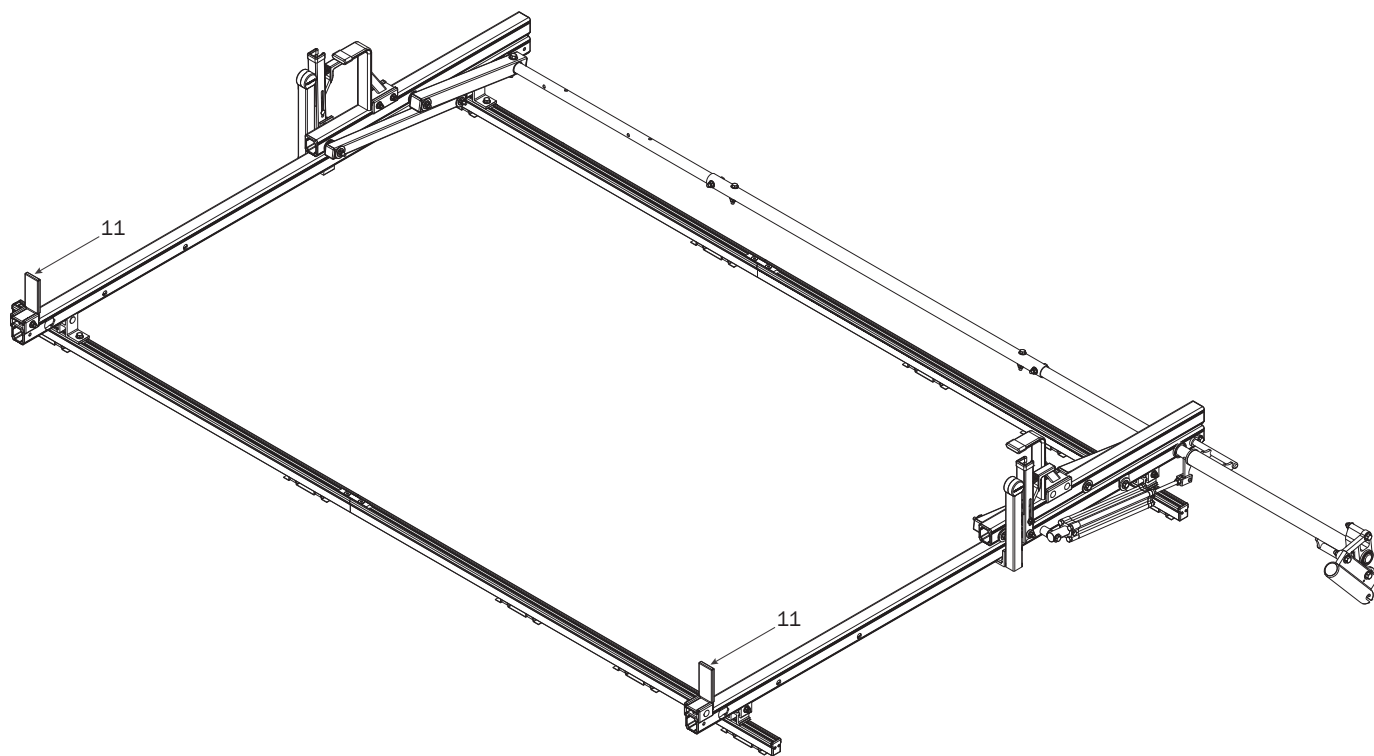
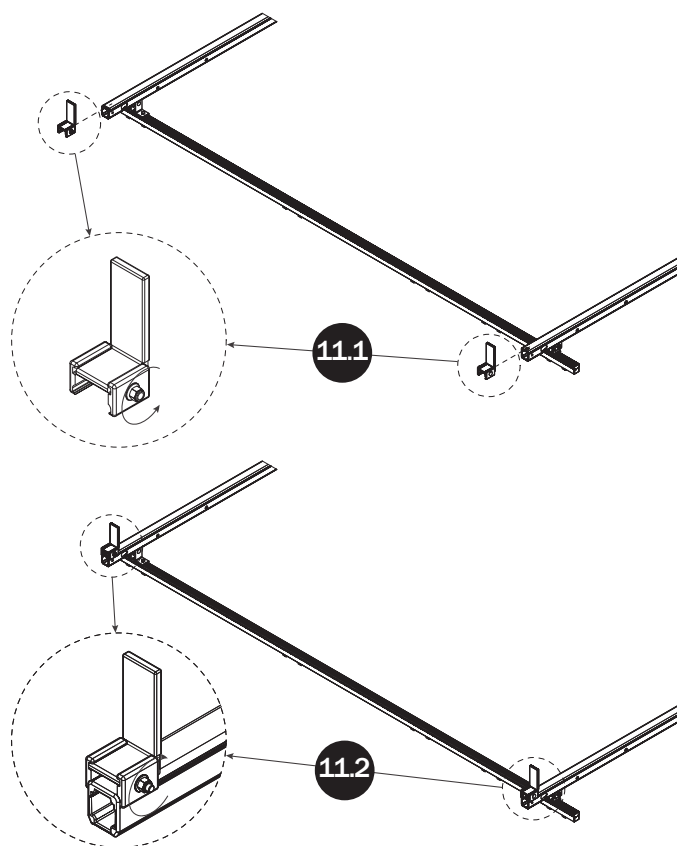
LEFT SIDE BASE*LADDER STOPS*

Page Intentionally Left Blank

