

# PRIME DESIGN™

A Safe Fleet Brand

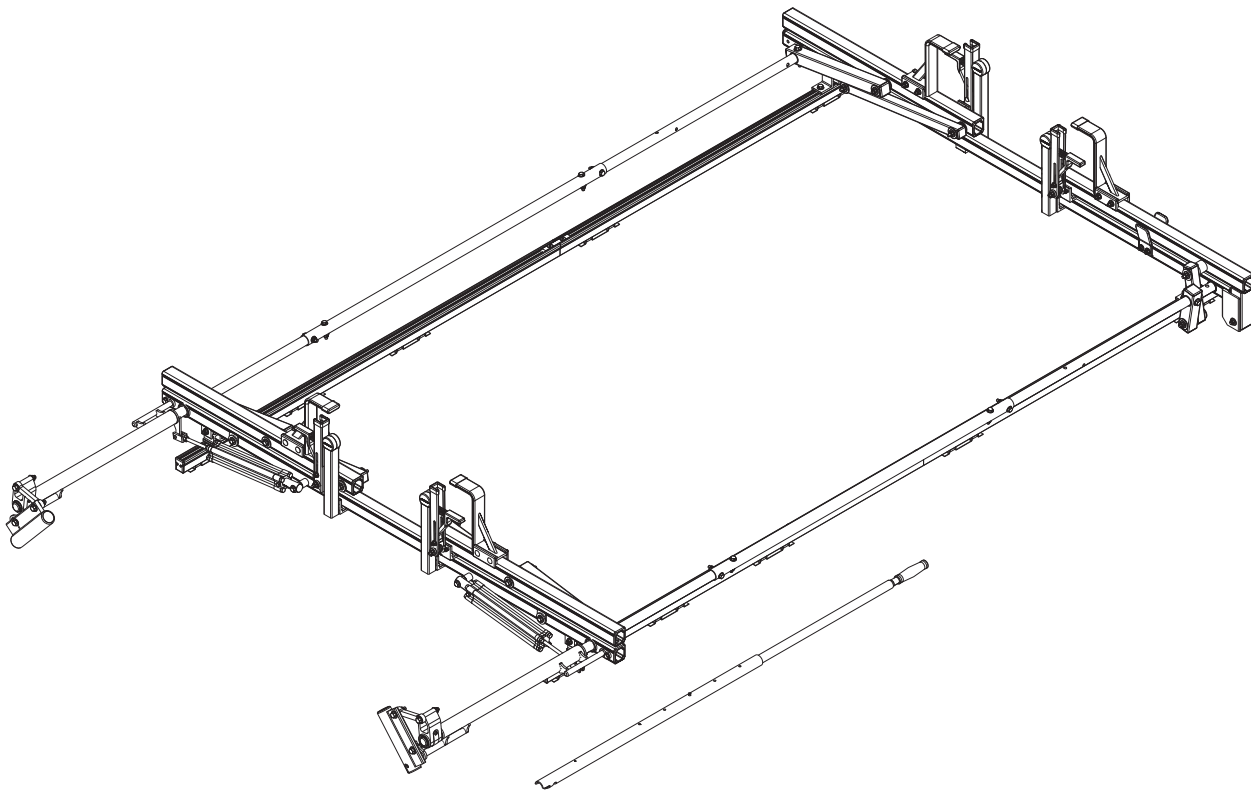

MANITEX

## CONTENTS OVERVIEW

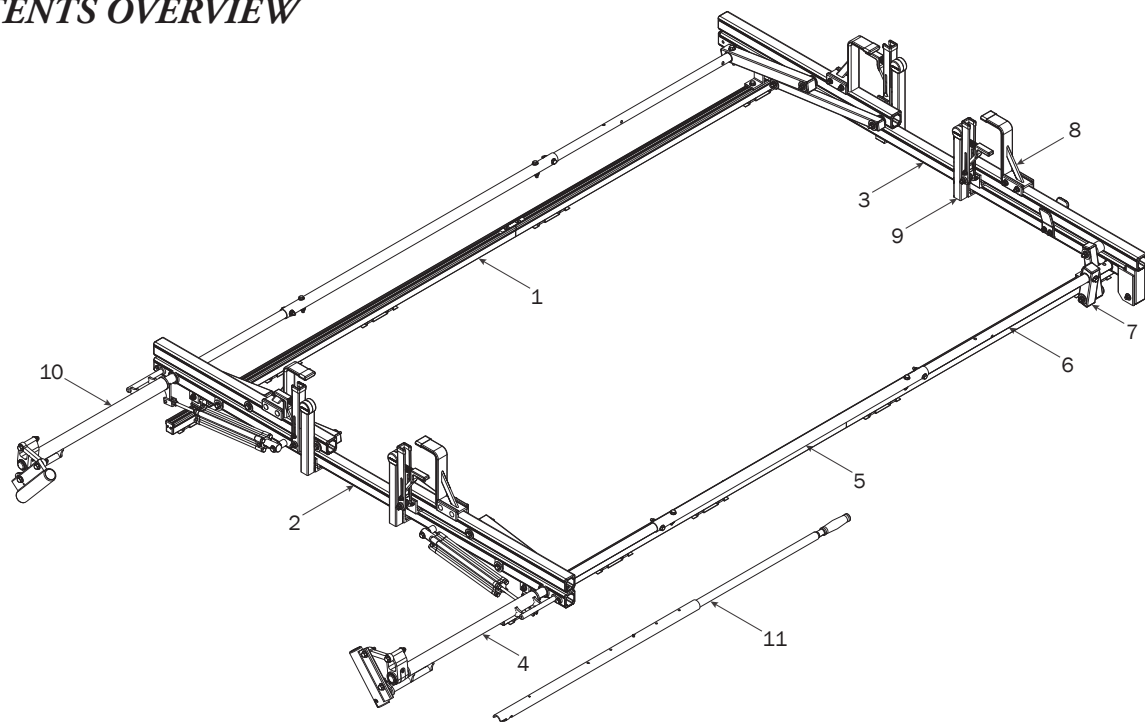

1—FBM-0048 ..... (Qty 1)  
Channels with hardware

Channels (2X)



Channels (2X)



M8 x 45MM Bolt (2X)

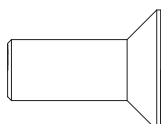

M8 x 20MM (18X)

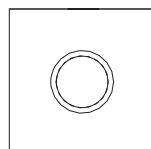

Square Nut (20X)

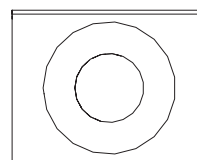

T Slot Insert (18X)

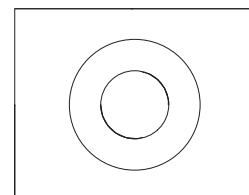

Channel Strip (2X)



Brackets (4X)



Top Connector (2X)



Bottom Connector (2X)



End Caps (4X)



Screws (8X)

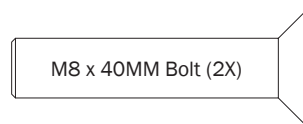

M8 x 40MM Bolt (2X)

2—Rear Crossbar Assembly ..... (Qty 1)

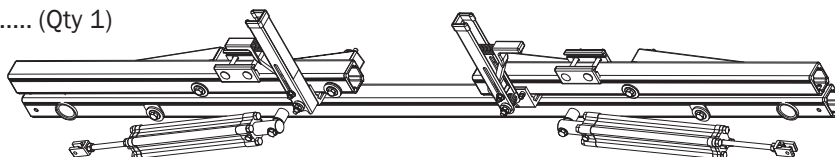

3—Front Crossbar Assembly ..... (Qty 1)

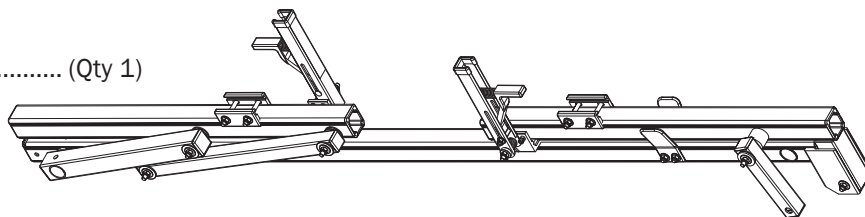

- 4—Rear Drive Shaft ..... (Qty 1)  
Right Hand, A Version, 50.00"

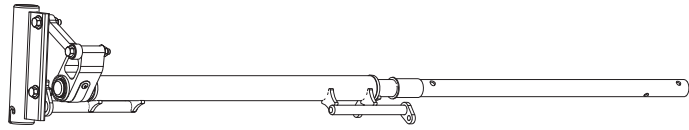

- 5—Connecting Bar ..... (Qty 2)  
48.00"

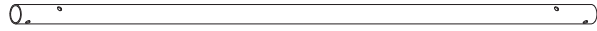

- 6—Front Drive Shaft ..... (Qty 2)  
B Version, 38.75"

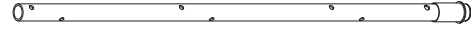

- 7—Drive Arm ..... (Qty 1)  
Incline Version with Bushing and Hardware

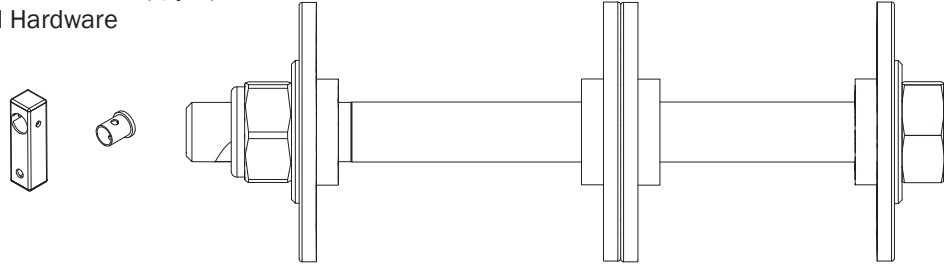

- 8—Z Post ..... (Qty 4)  
Adjustable, 7.25"

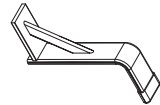

- 9—L Post ..... (Qty 4)  
Gen2, Roller Cap , 9.25"

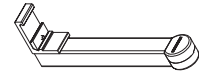

- 10—Rear Drive Shaft ..... (Qty 1)  
Left Hand, A Version, 50.00"

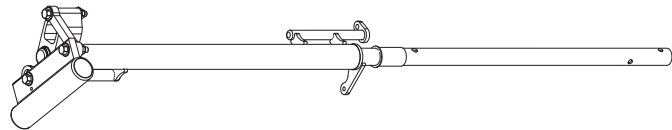

- 11—HRR Removeable Handle Assembly ..... (Qty 1)



- 12—HKT-8163 (Not called out in Overview)..... (Qty 2)

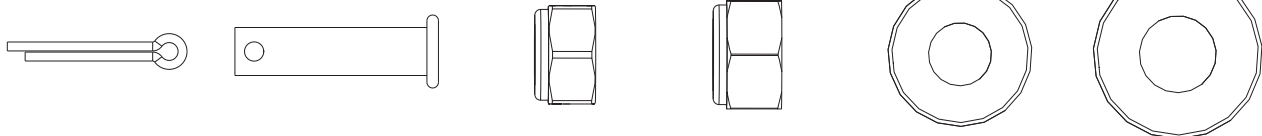
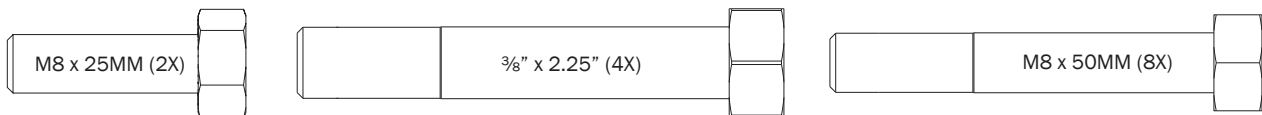

Cotter Pin (2X)

Clevis Pin (2X)

M8 Lock Nut (10X)

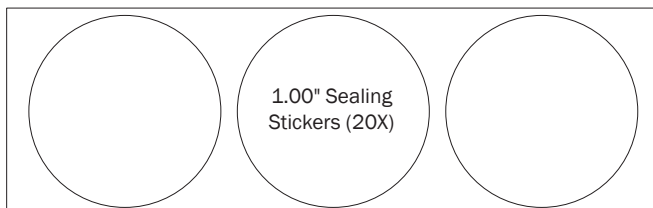
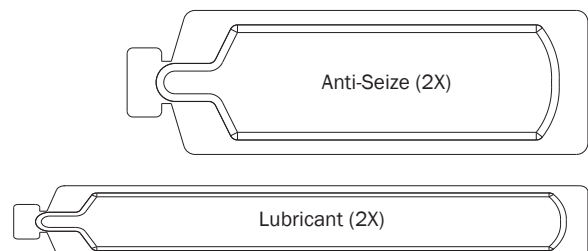
 $\frac{3}{8}$ " Lock Nut (4X) $\frac{5}{16}$ " Flat Washer (20X) $\frac{3}{8}$ " Flat Washer (8X)1.00" Sealing  
Stickers (20X)

Anti-Seize (2X)

Lubricant (2X)

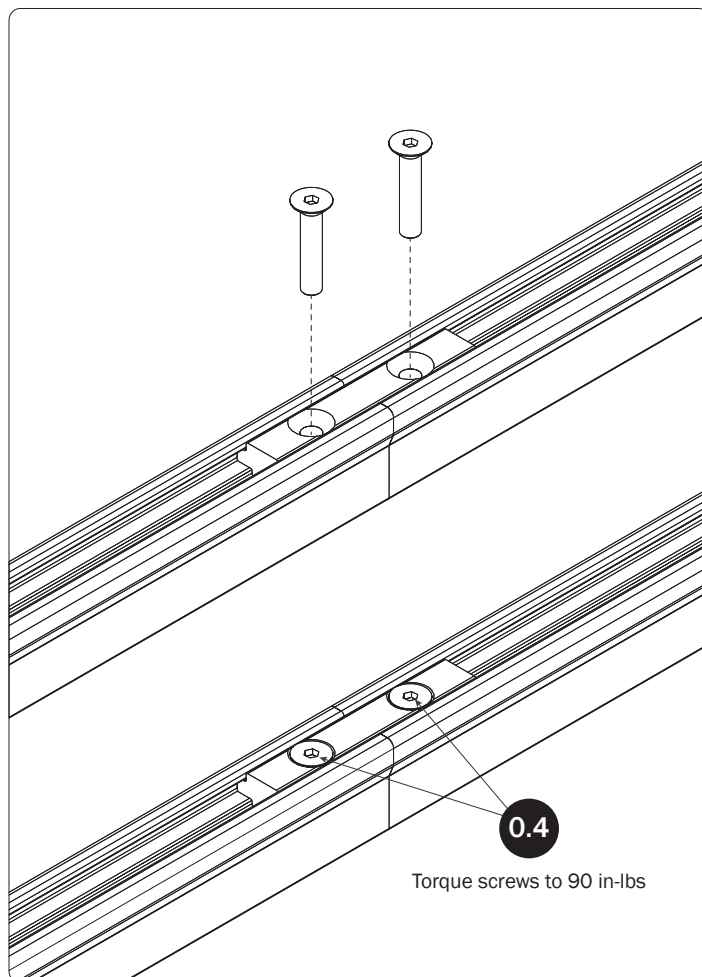
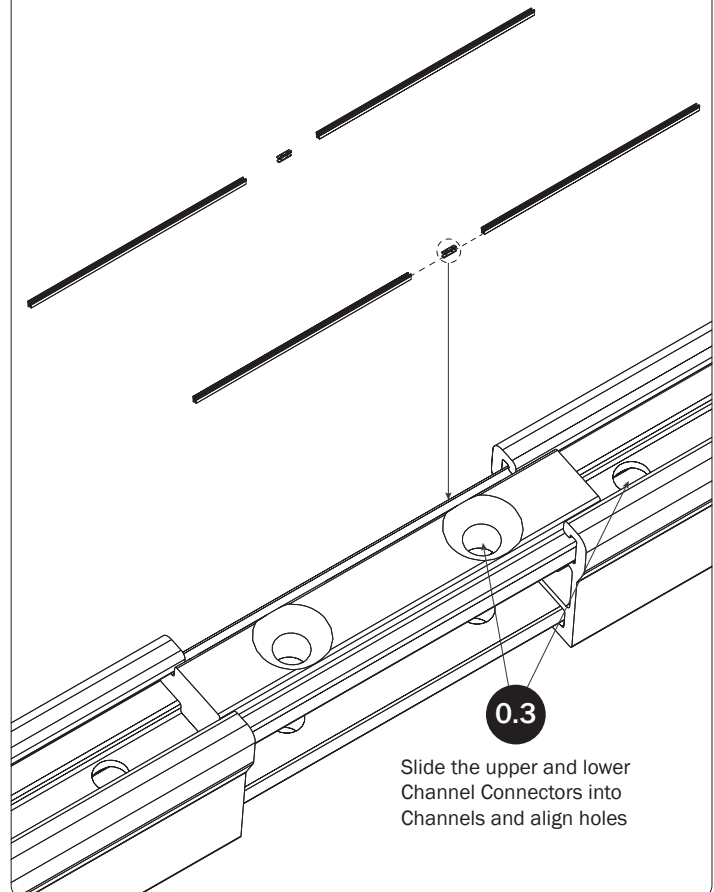
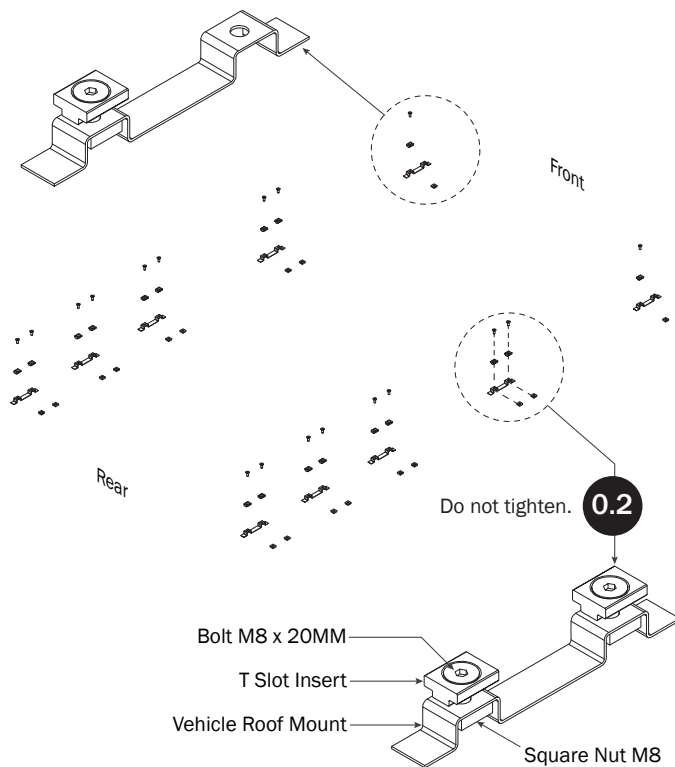
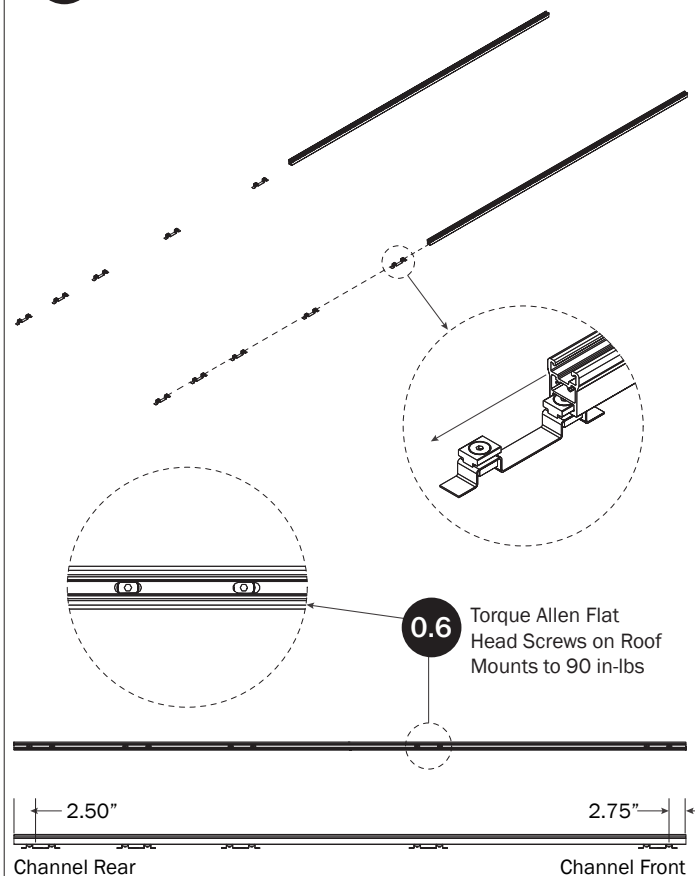
**FBM-0048 MOUNTING SYSTEM**  
**CHANNELS TO ROOF****0.1** Assemble Mounts as shown below.**0.5** Slide Channels onto roof Mounts and set distances as shown.

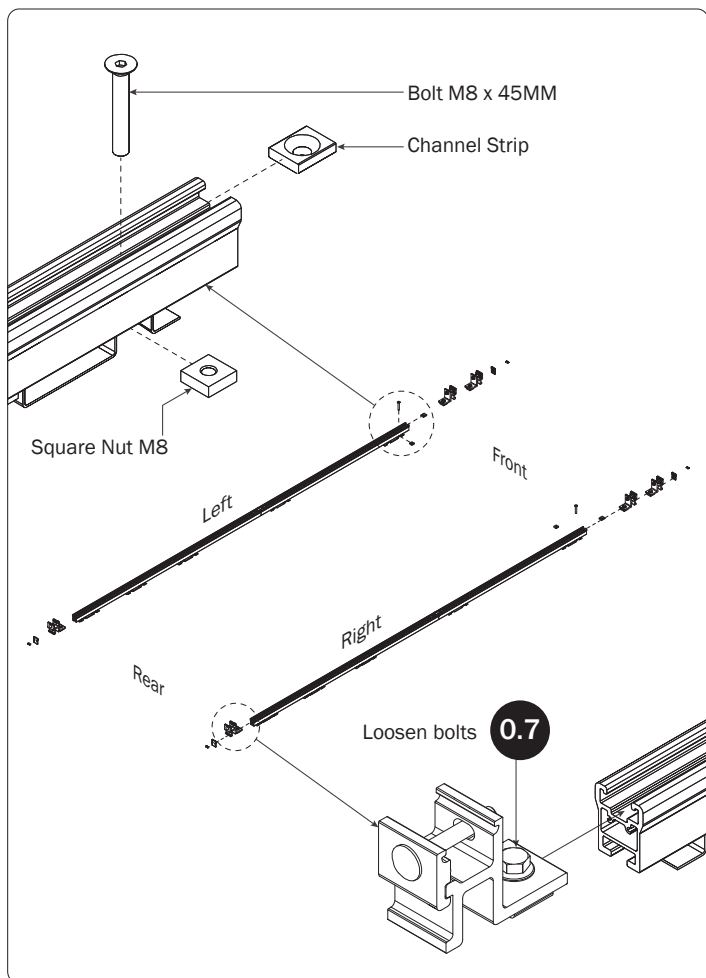

**0.8** Finger-tighten to retain positions. Do not torque until Step 1.2

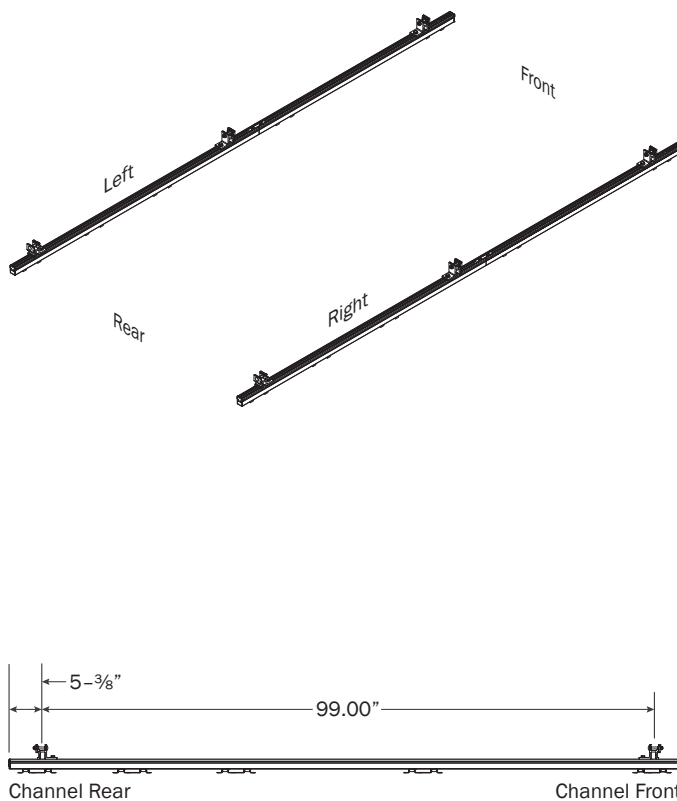

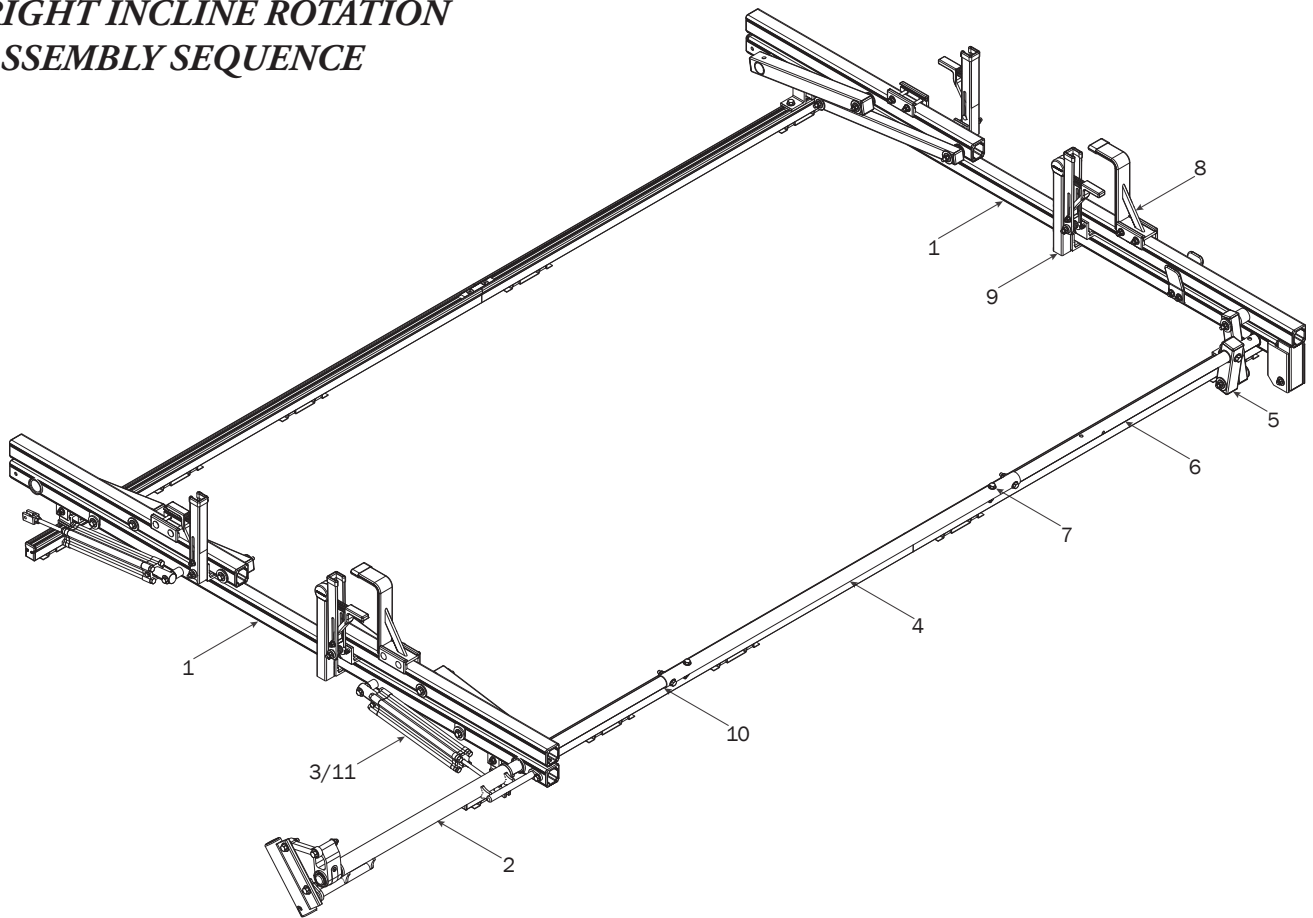
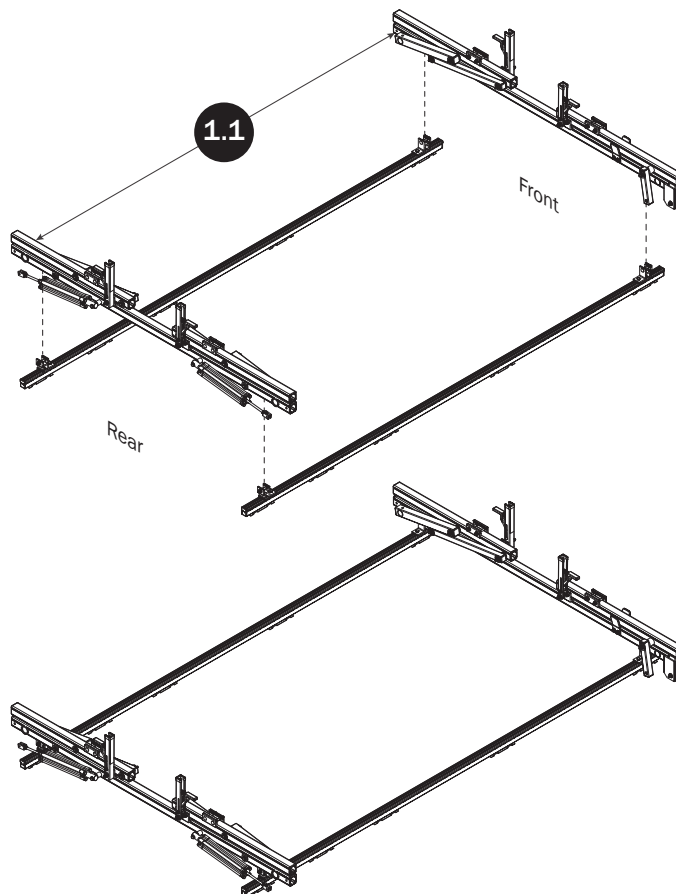
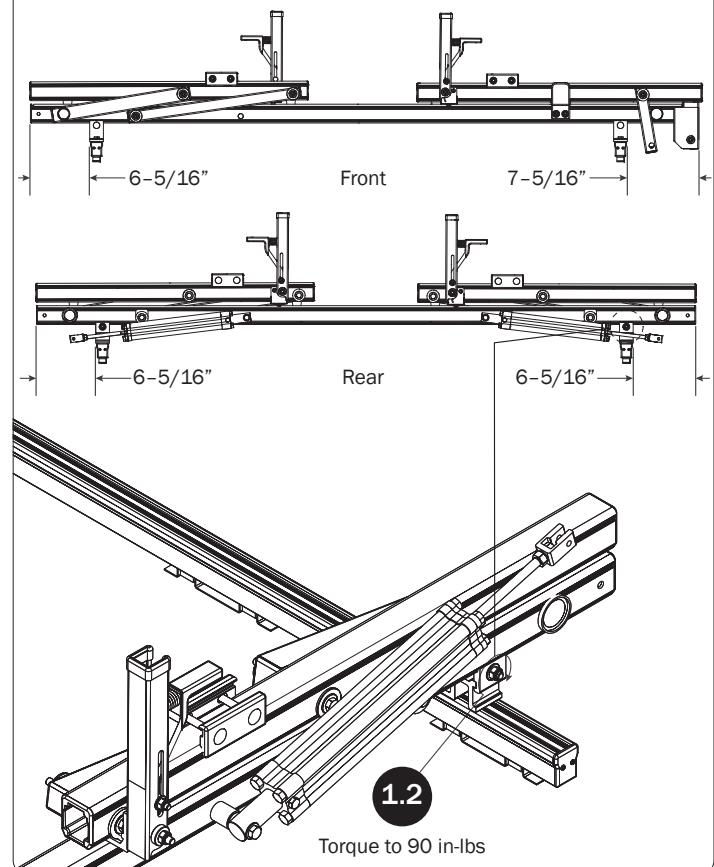
**RIGHT INCLINE ROTATION  
ASSEMBLY SEQUENCE****CROSSBARS****CROSSBAR ADJUSTMENT**

## REAR DRIVE SHAFT

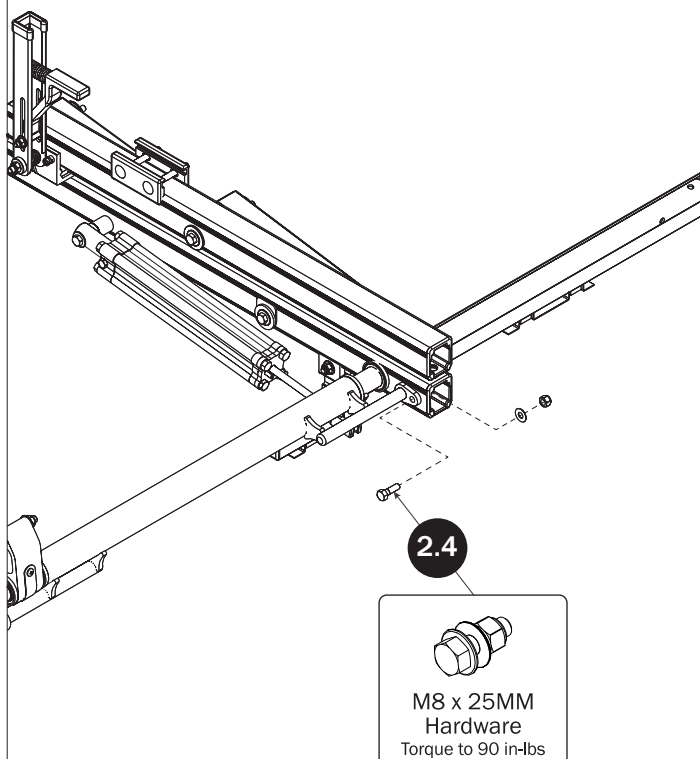
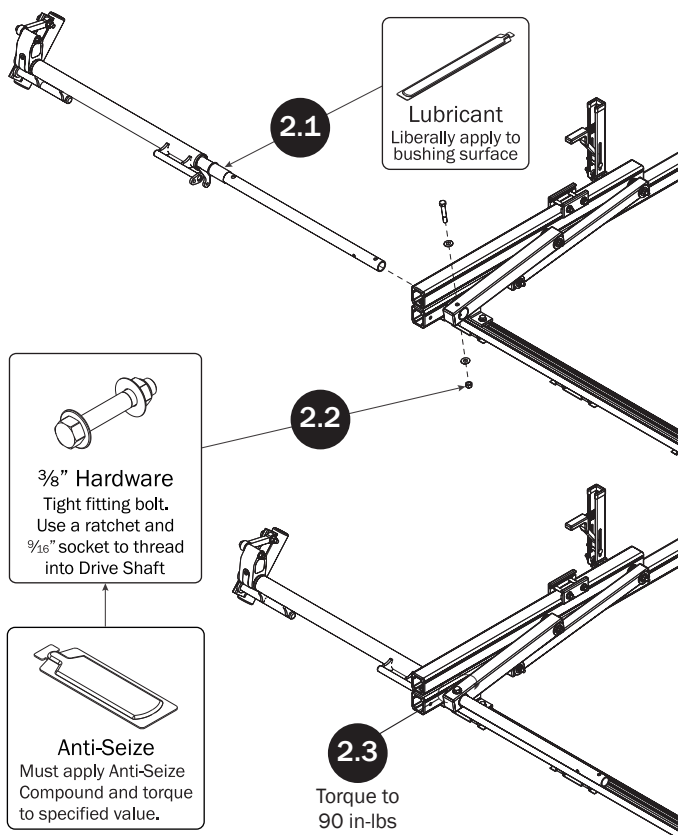

## CYLINDER HARDWARE

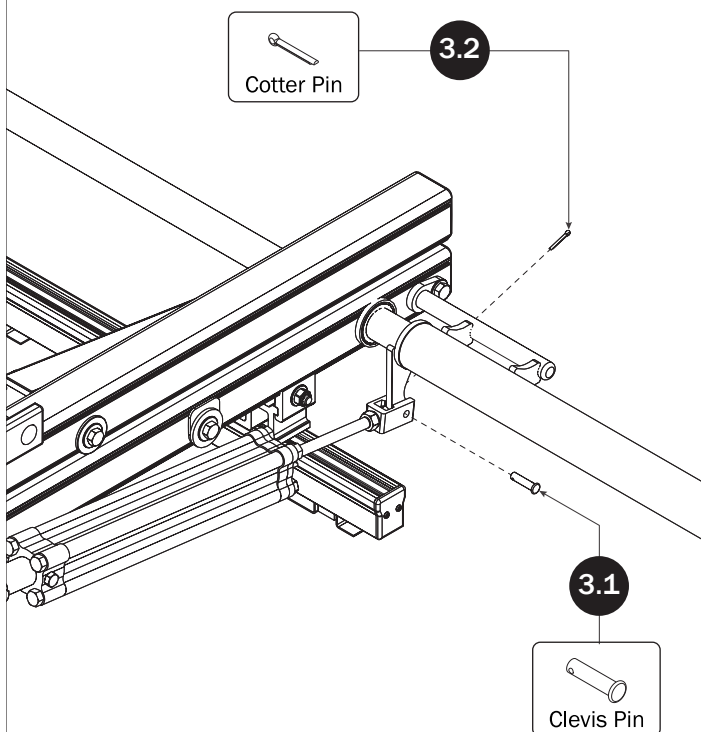

## CONNECTING BAR

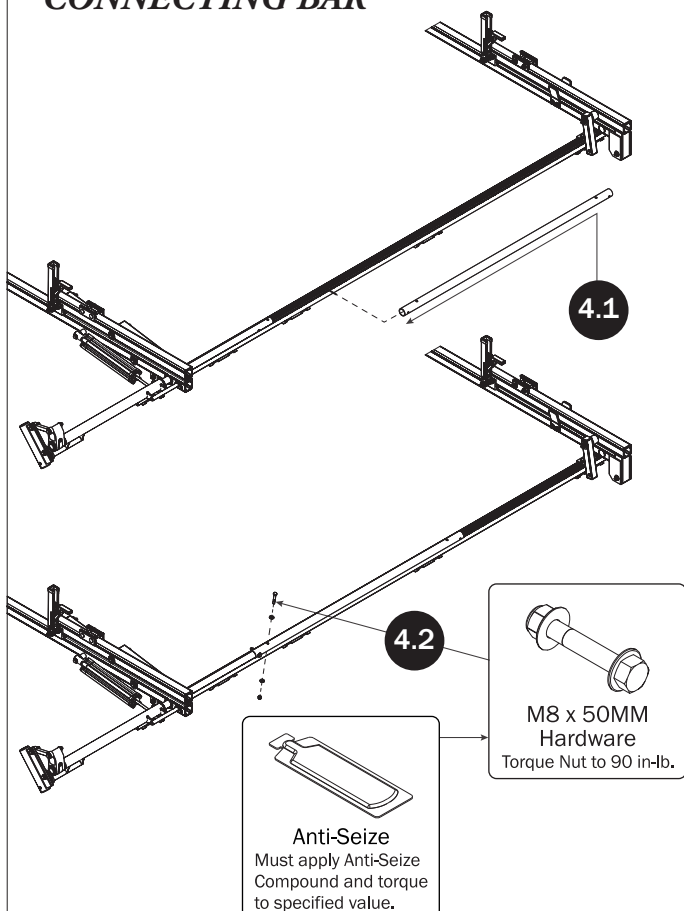

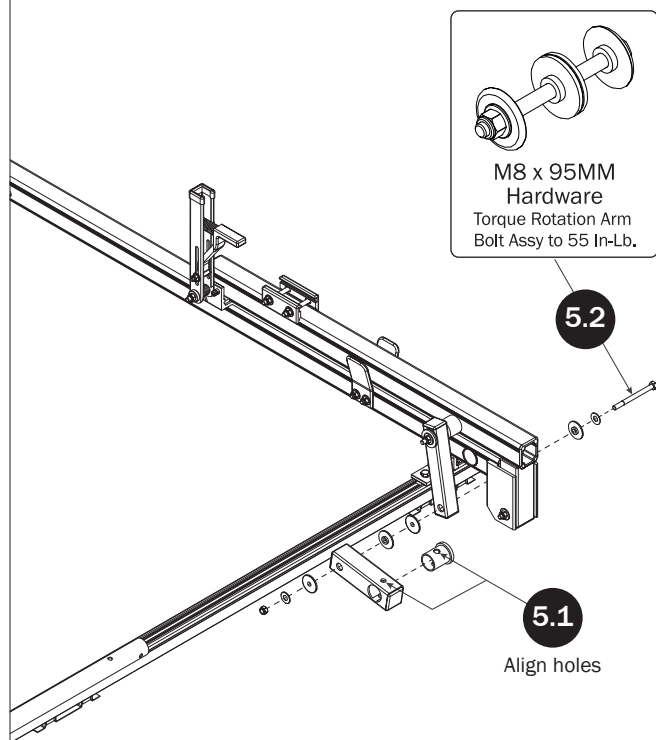
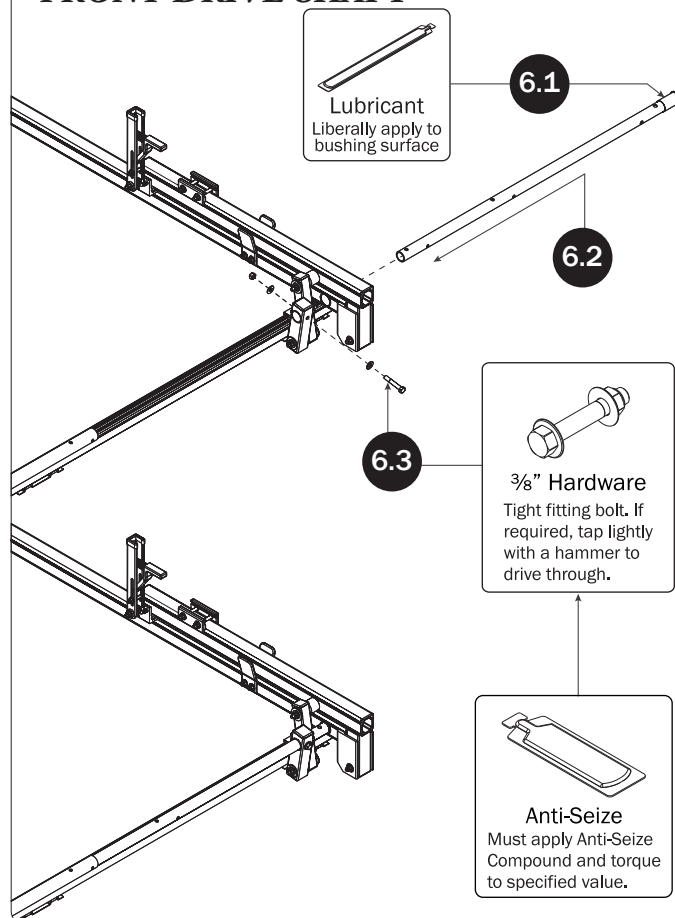
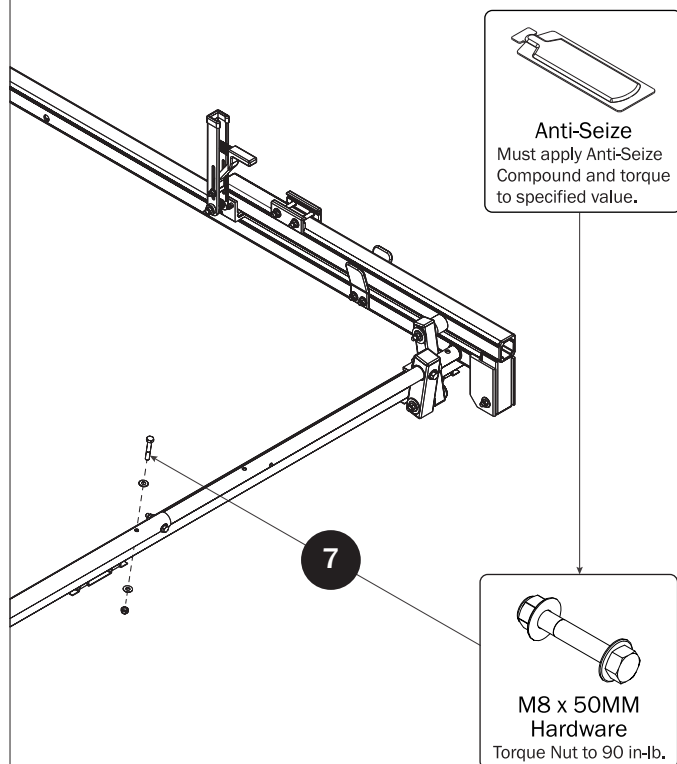

**FRONT DRIVE ARM****FRONT DRIVE SHAFT****CONNECTING BAR FASTENERS****Z POST**

SEE QUICK START GUIDE FOR ADJUSTMENTS

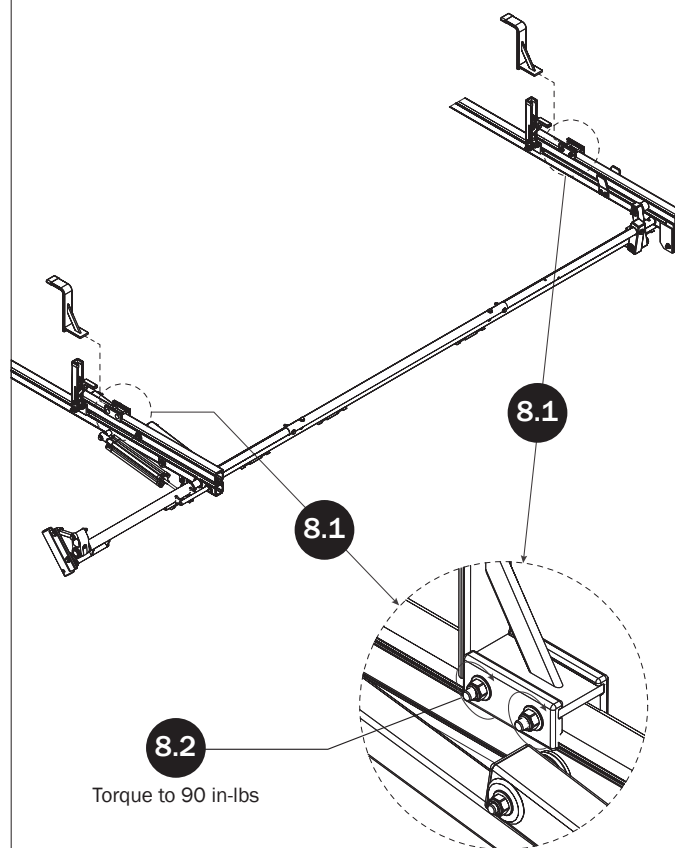



## L POST

SEE QUICK START GUIDE FOR ADJUSTMENTS

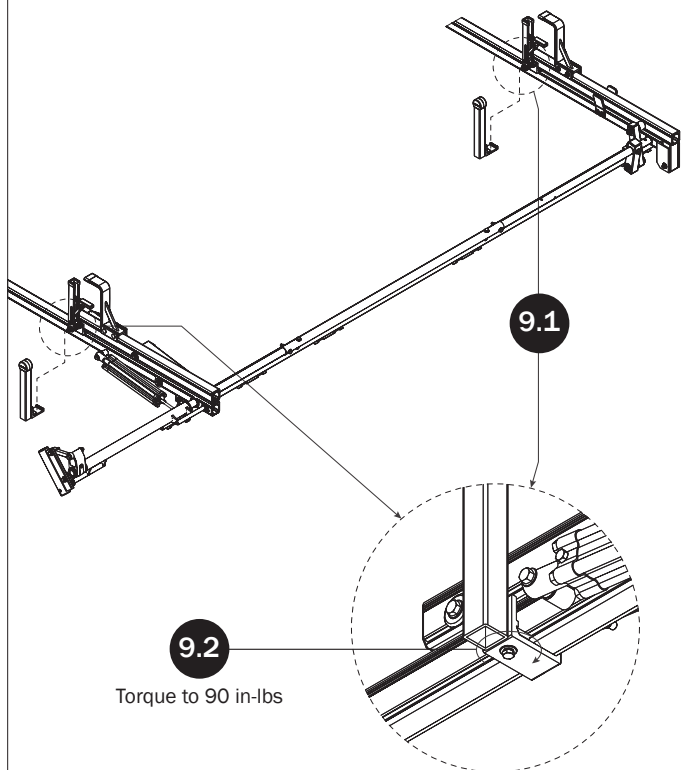

## DRIVE SHAFT SEALING

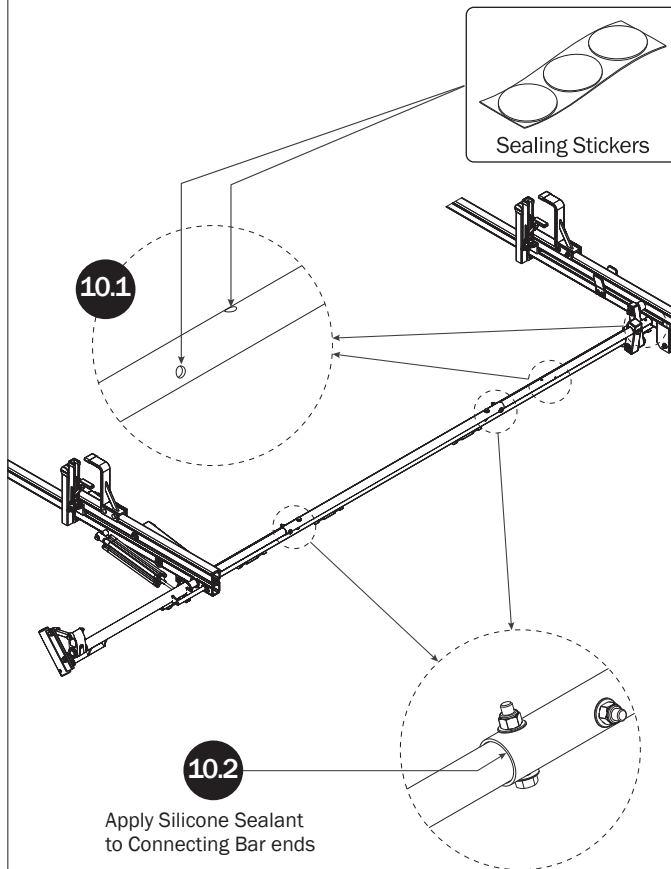

## CYLINDER ADJUSTMENT

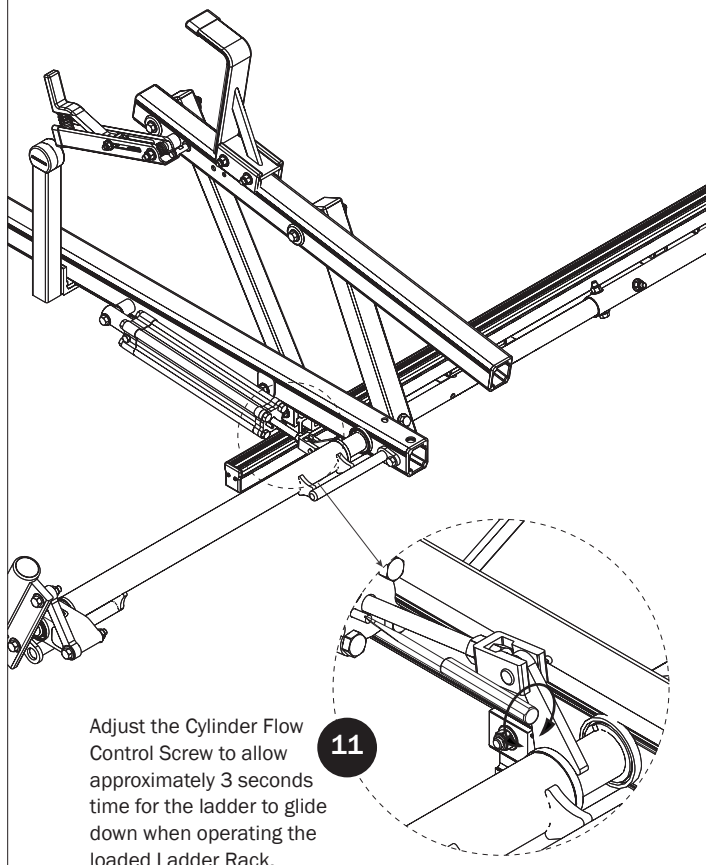

## LEFT ROTATION ASSEMBLY SEQUENCE

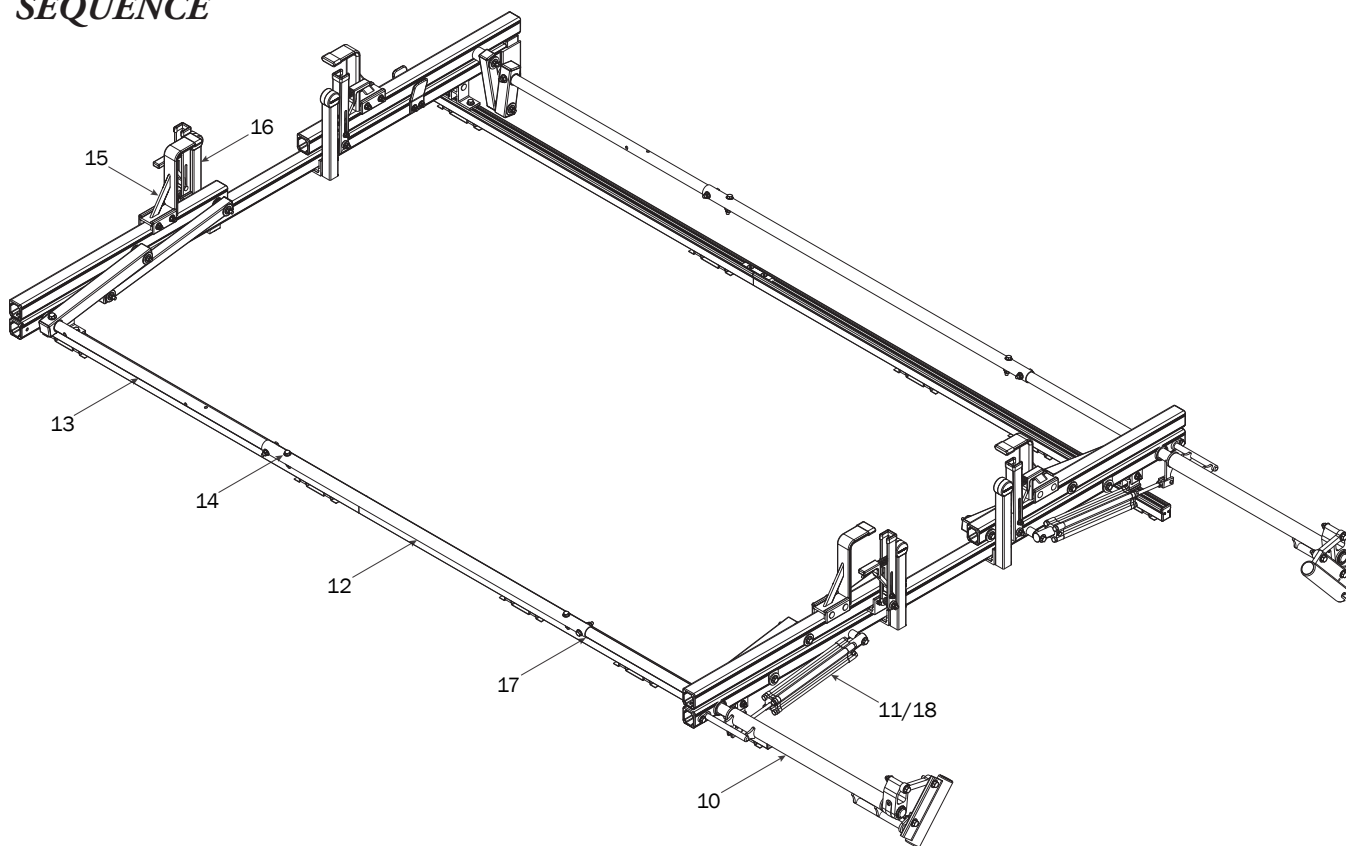

### REAR DRIVE SHAFT

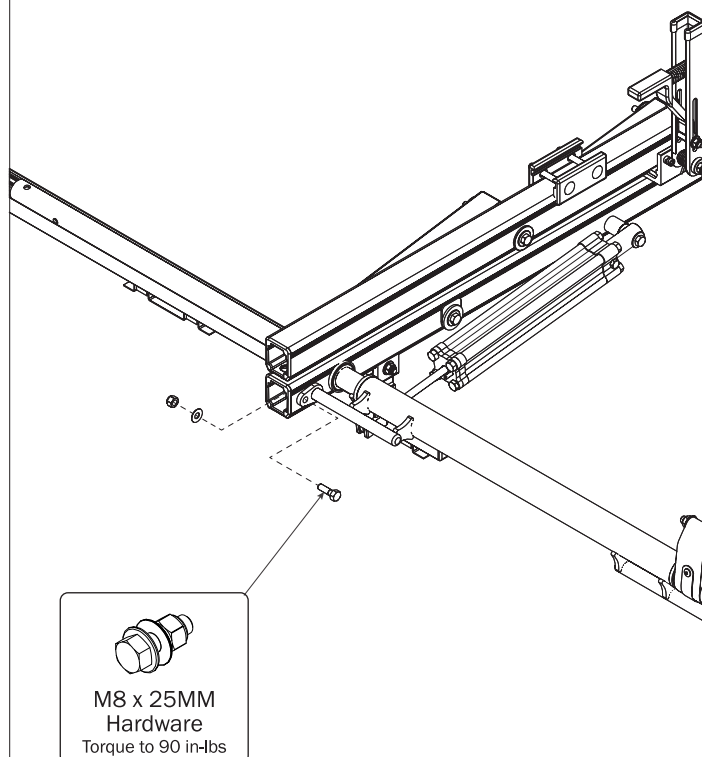
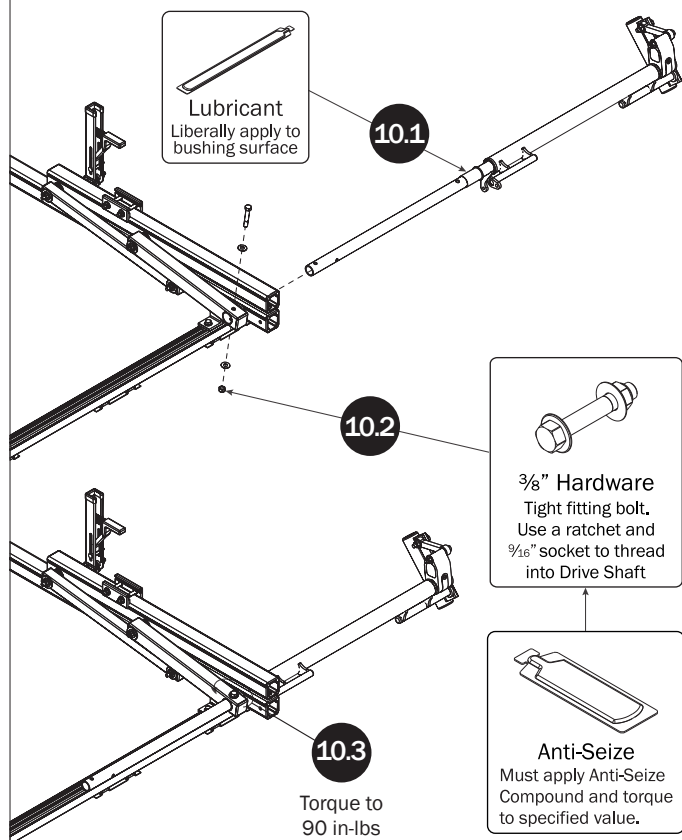

## CYLINDER HARDWARE

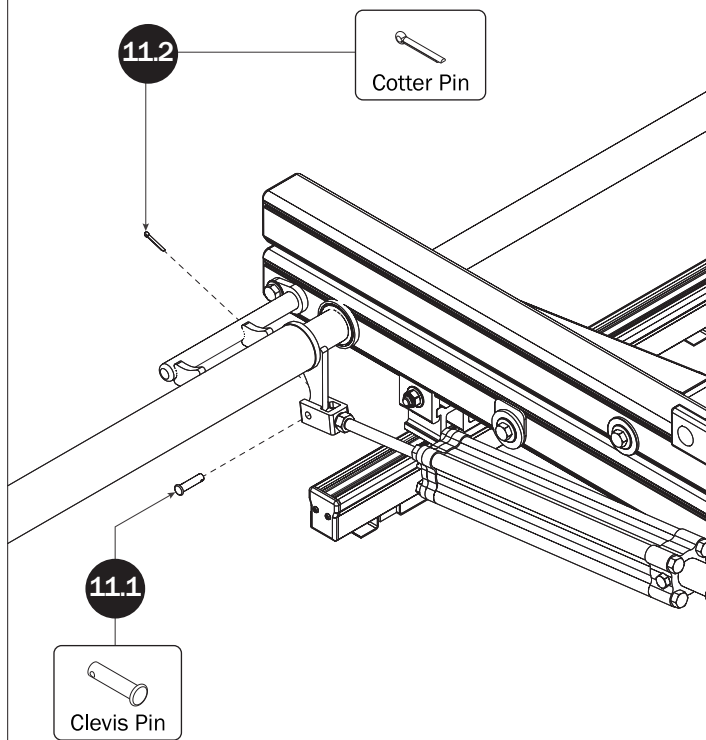

## CONNECTING BAR

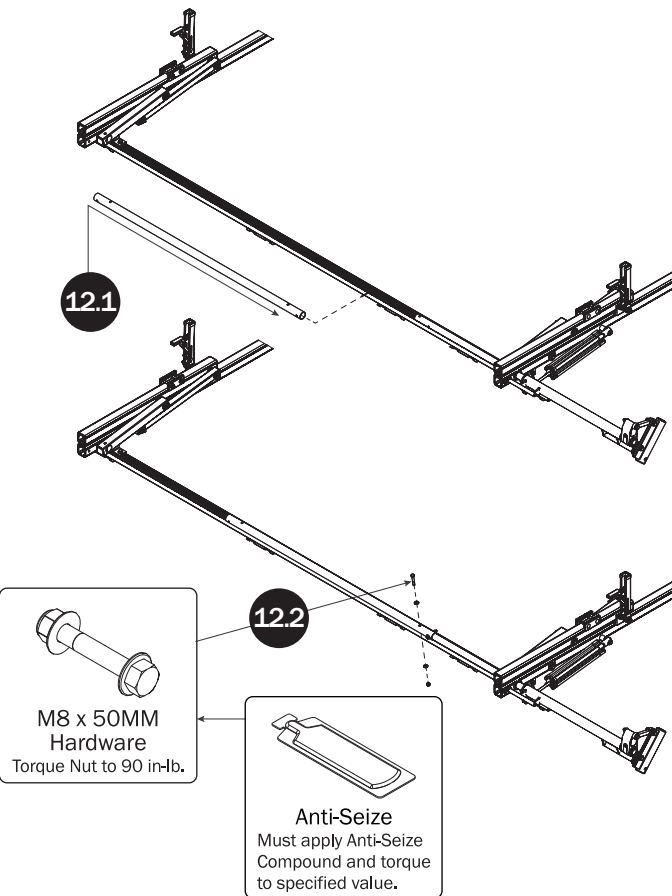

## FRONT DRIVE SHAFT

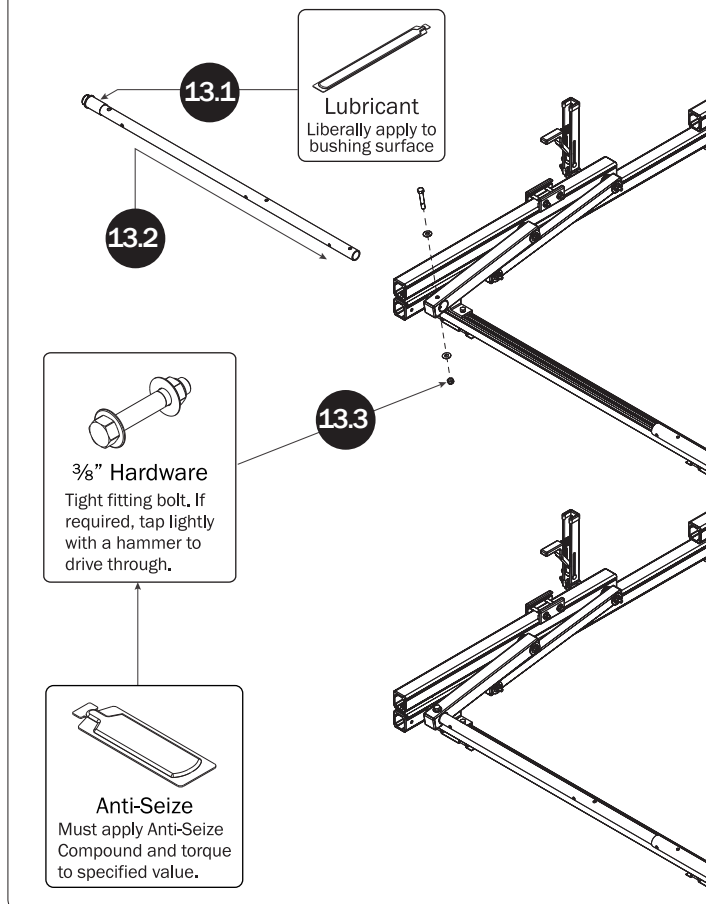

## CONNECTING BAR FASTENERS

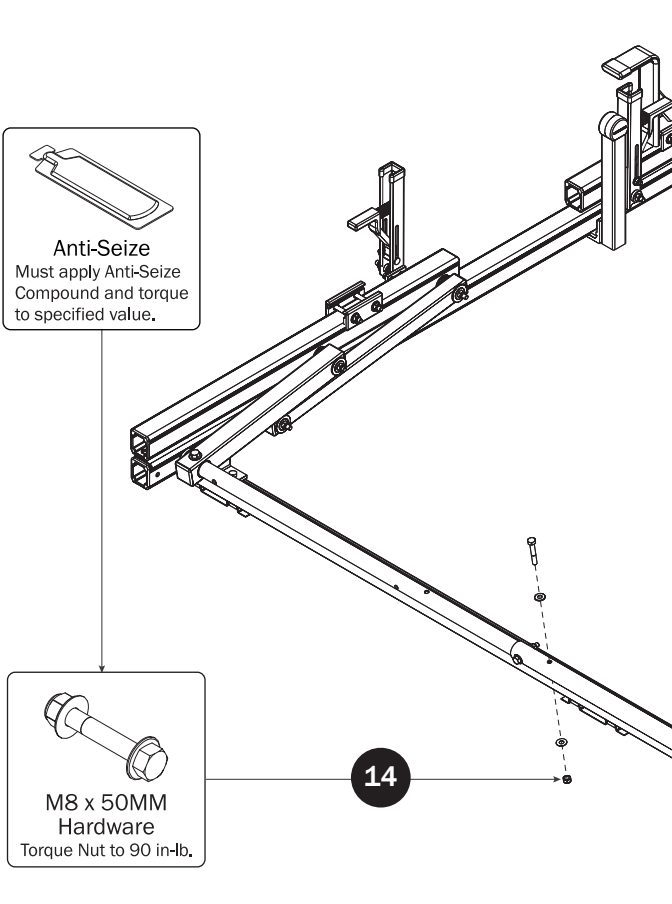

**Z POSTS**

SEE QUICK START GUIDE FOR ADJUSTMENTS

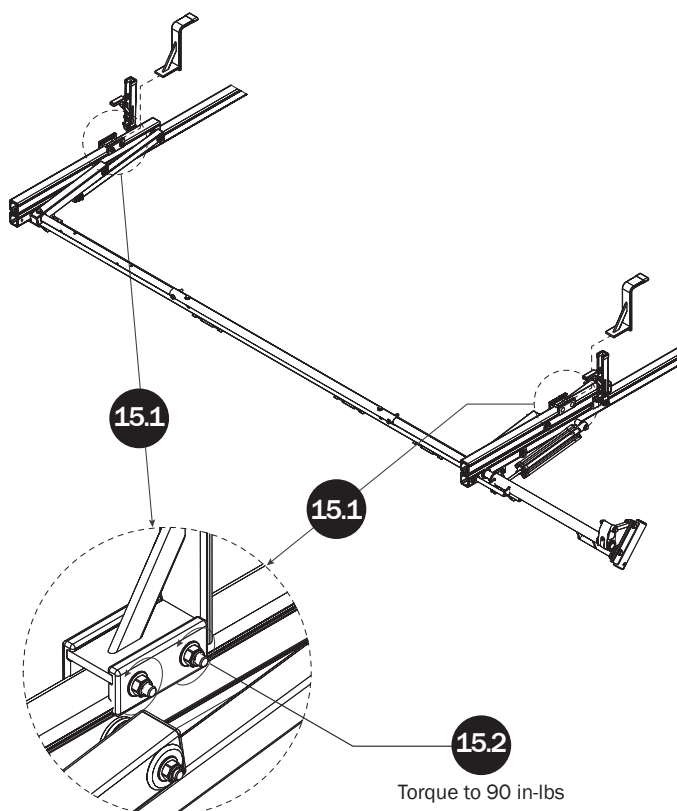
**L POSTS**

SEE QUICK START GUIDE FOR ADJUSTMENTS

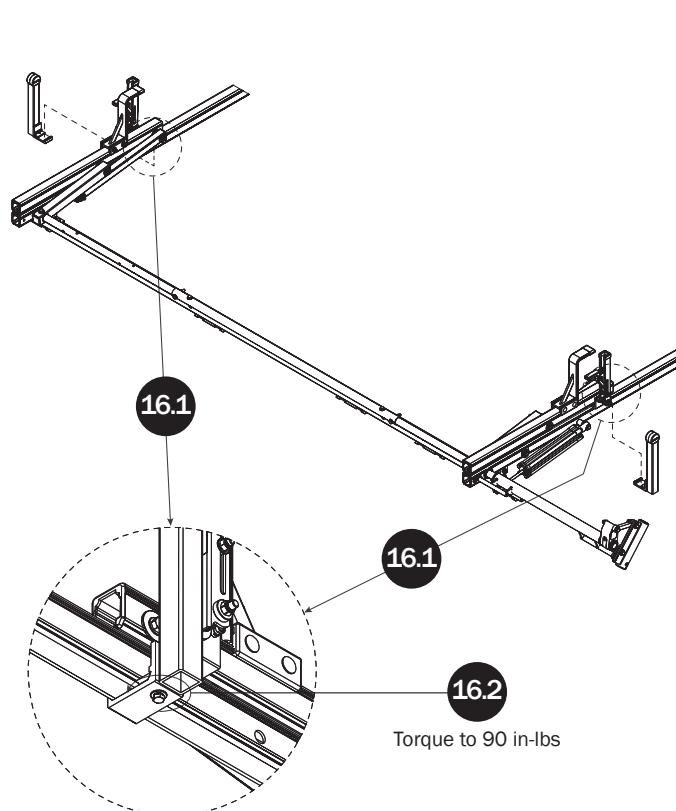
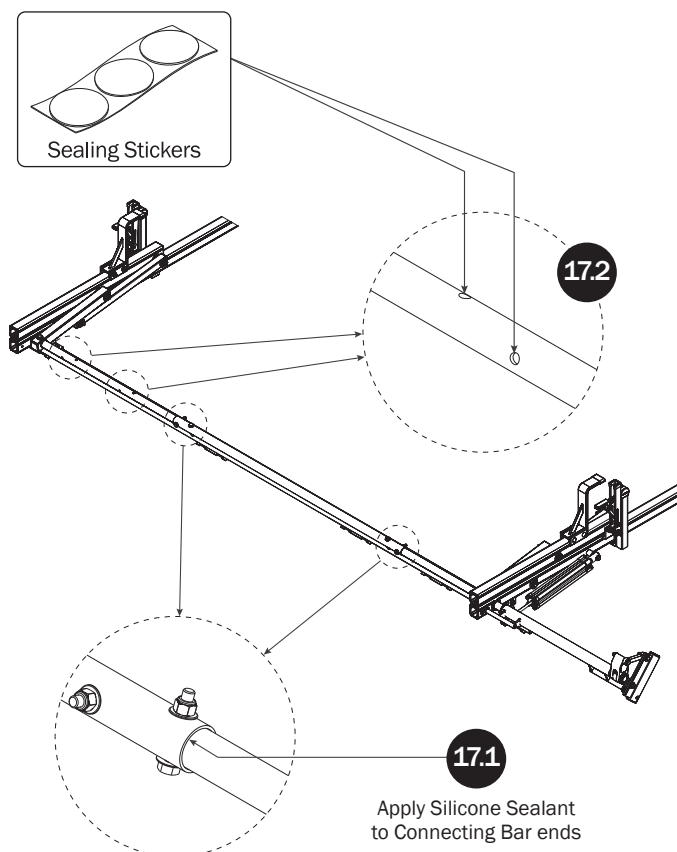
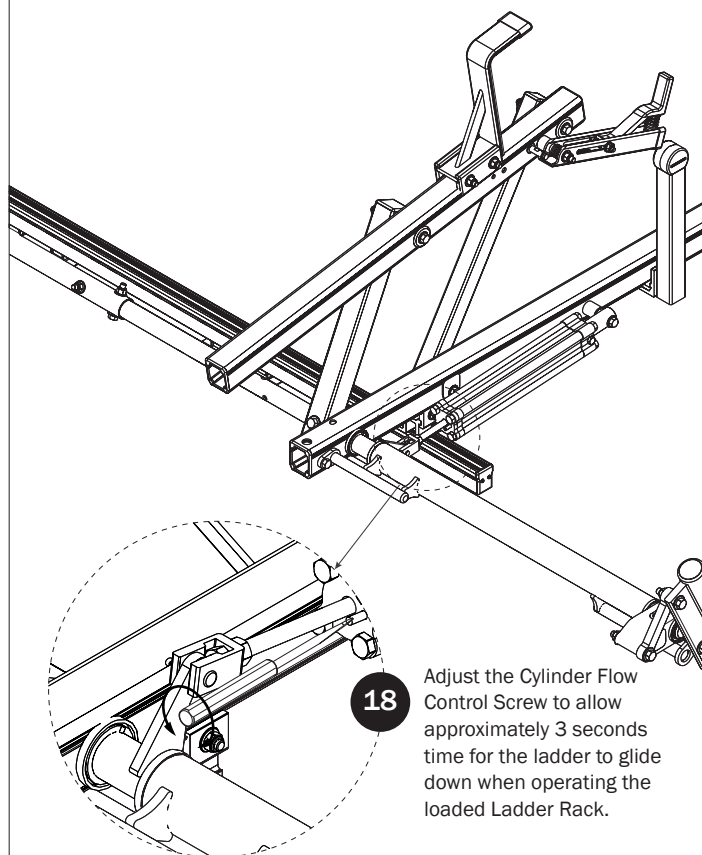
**DRIVE SHAFT SEALING****CYLINDER ADJUSTMENT**

USAM-HRINV11B-US01 Rev-A 0118