

**PRIME DESIGN™**

A Safe Fleet Brand

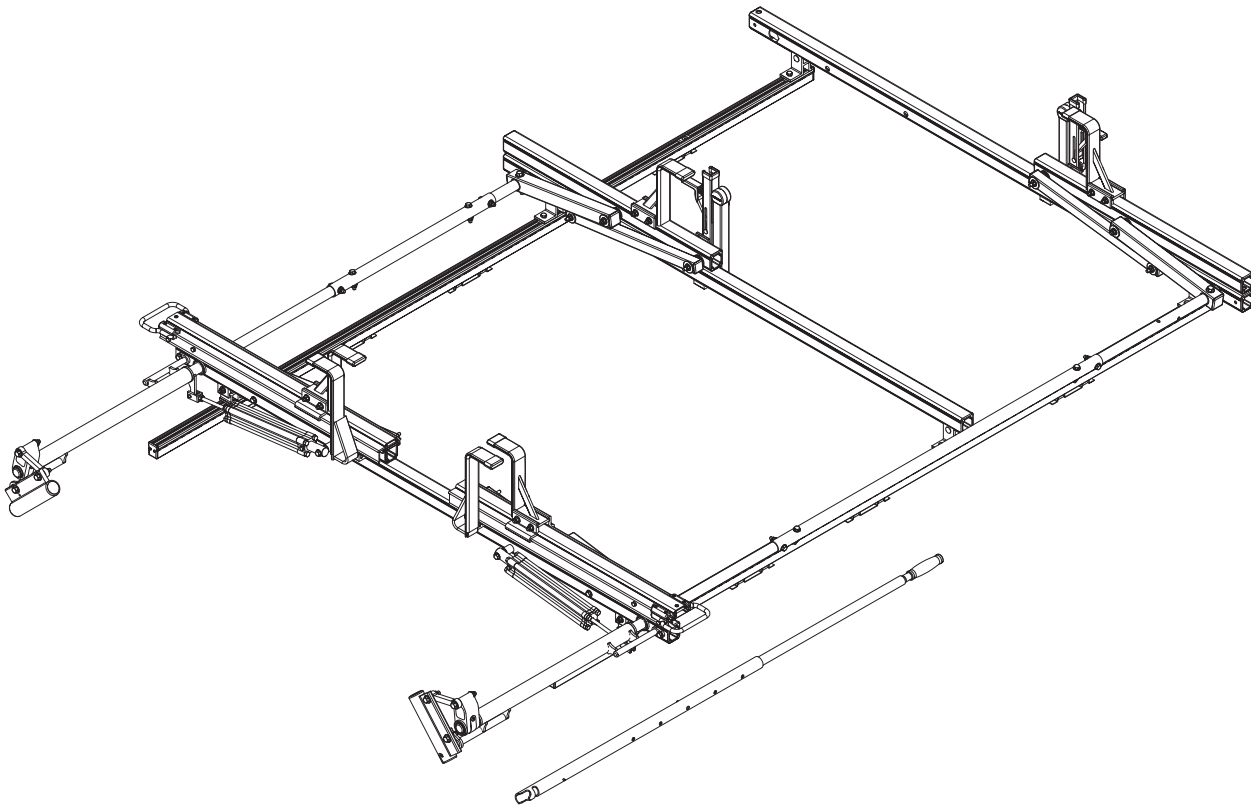

**HRR3-E**

**MAN2B**

## CONTENTS OVERVIEW

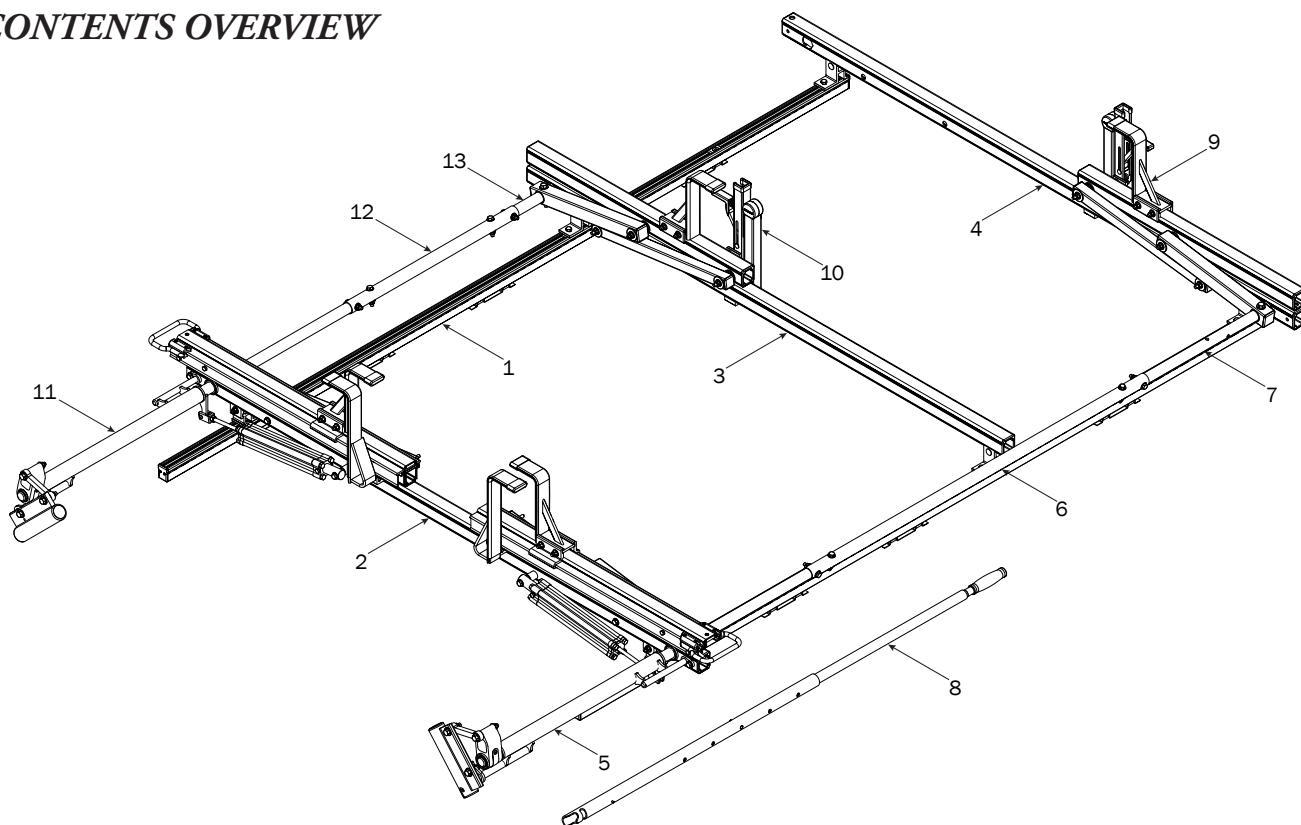

1—FBM3-0049 ..... (Qty 1)

Channels with hardware

Channels (2X)



End Caps (4X)



Screws (8X)



Brackets (6X)

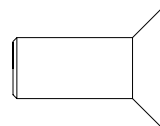

M8 Bolt (14X)

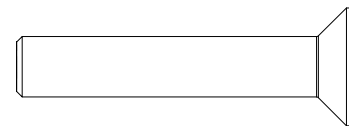

M8 Bolt (2X)

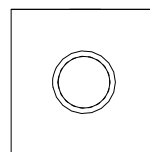

Square Nut (16X)

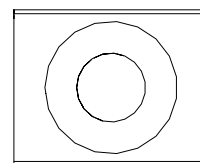

T Slot Insert (14X)

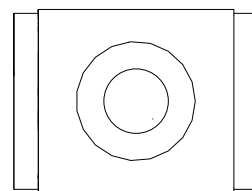

Connector Plate (2X)

2—Rear Crossbar Assembly ..... (Qty 1)

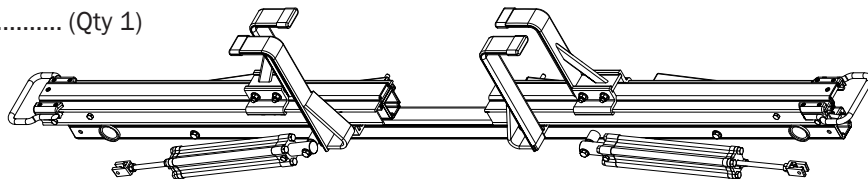

3—Center Crossbar Assembly ..... (Qty 1)

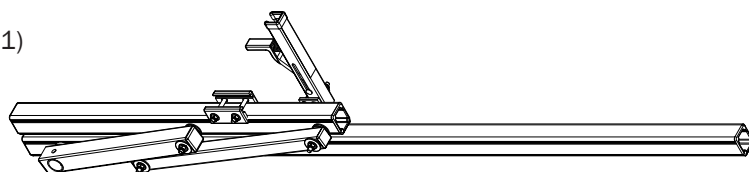

4—Front Crossbar Assembly ..... (Qty 1)

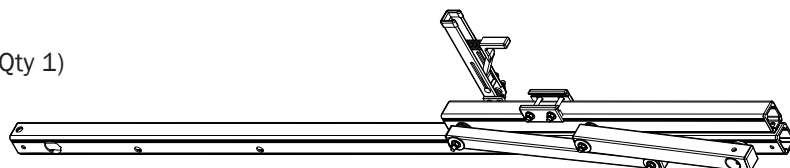

5—Rear Drive Shaft ..... (Qty 1)  
Right Hand, A Version, 50.00"

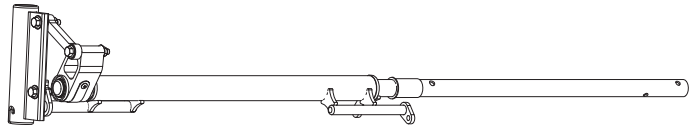

6—HHR Handle Assembly ..... (Qty 1)  
35.00"

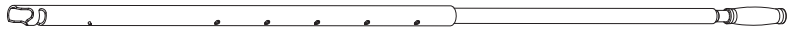

7—Connecting Bar ..... (Qty 1)  
4.00"



8—Front Drive Shaft ..... (Qty 1)  
B Version, 35.75"

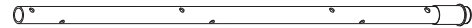

9—Z Post ..... (Qty 2)  
Adjustable, 7.25"

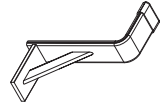

10—L Post ..... (Qty 2)  
Roller Cap, 9.25"



11—Rear Drive Shaft ..... (Qty 1)  
Left Hand, A Version, 50.00"

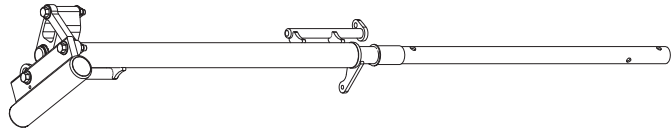

12—Connecting Bar ..... (Qty 1)  
24.00"

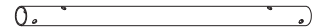

13—Front Drive Shaft ..... (Qty 1)  
B Version, 11.75"

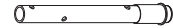

14—HKT-8163 (Not called out in Overview) ..... (Qty 2)



Clevis Pin (1X)



M8 x 50MM (4X)

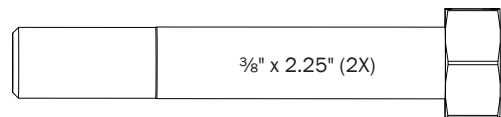

$\frac{3}{8}$ " x 2.25" (2X)



Cotter Pin (1X)

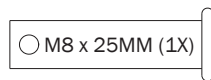

M8 x 25MM (1X)



M8 Lock Nut (5X)

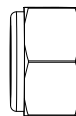

$\frac{3}{8}$ " Lock Nut (2X)

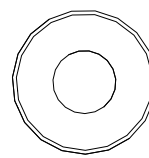

$\frac{5}{16}$ " Flat Washer (10X)

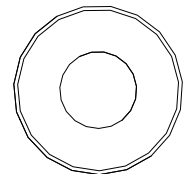

$\frac{3}{8}$ " Flat Washer (4X)

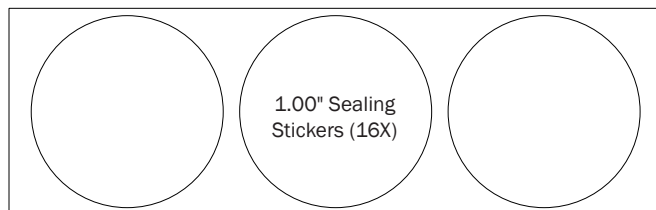

1.00" Sealing  
Stickers (16X)



Anti-Seize (1X)

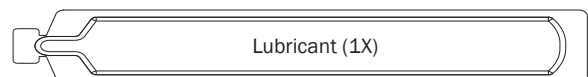

Lubricant (1X)

## FBM3-0049 CHANNELS TO ROOF

- 0.1** Assemble Mounts as shown below. Front Mount Bracket's holes do not receive hardware until Step 0.5

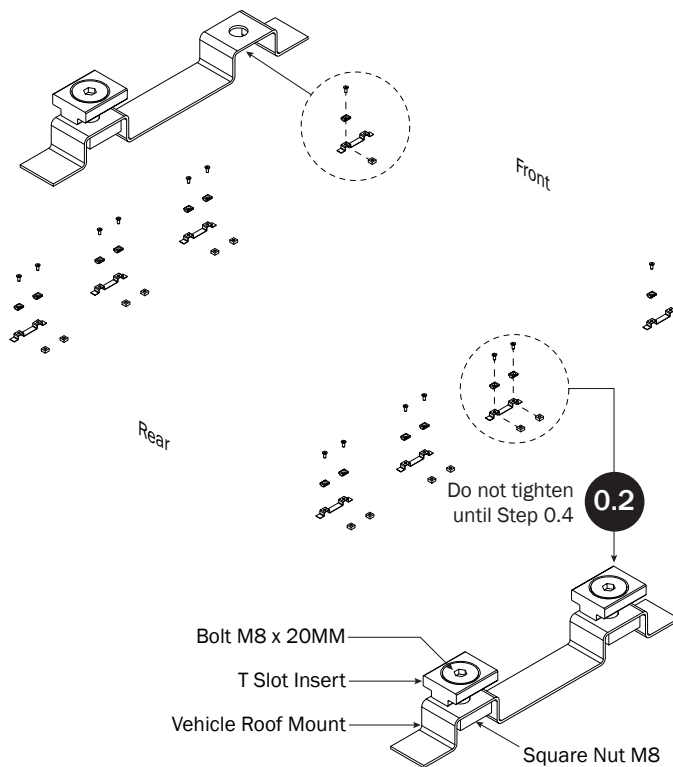

- 0.3** Slide Channels onto Roof Mounts and set distances as shown.

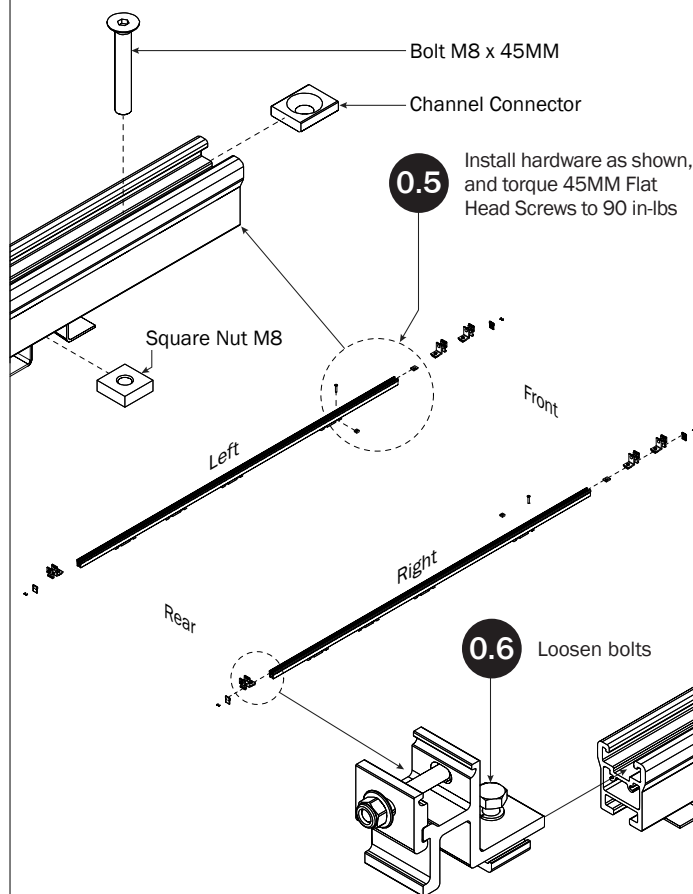
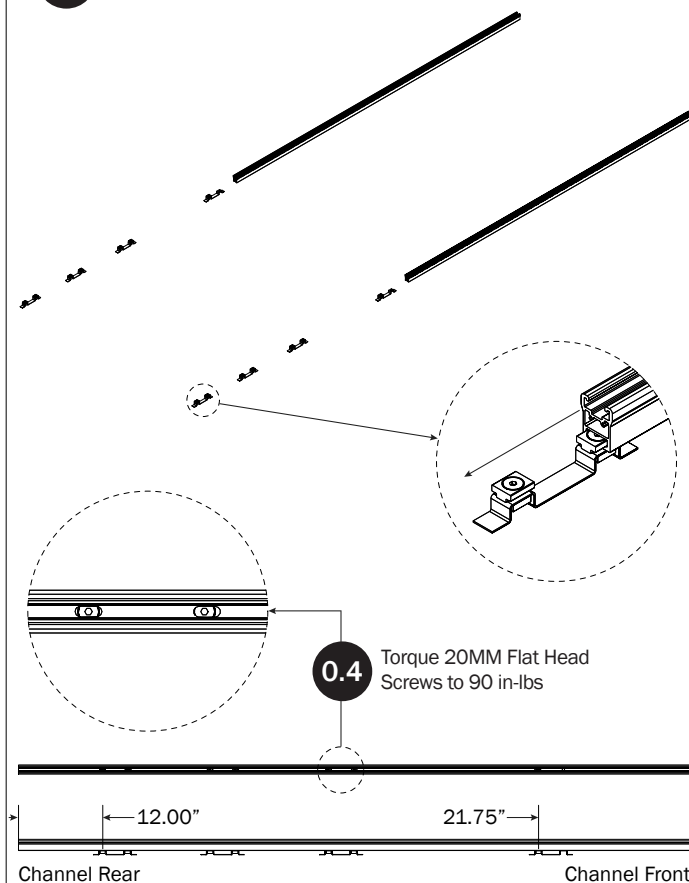

- 0.7** Set to distances then torque the Rear Bracket nuts to 90 in-lb.

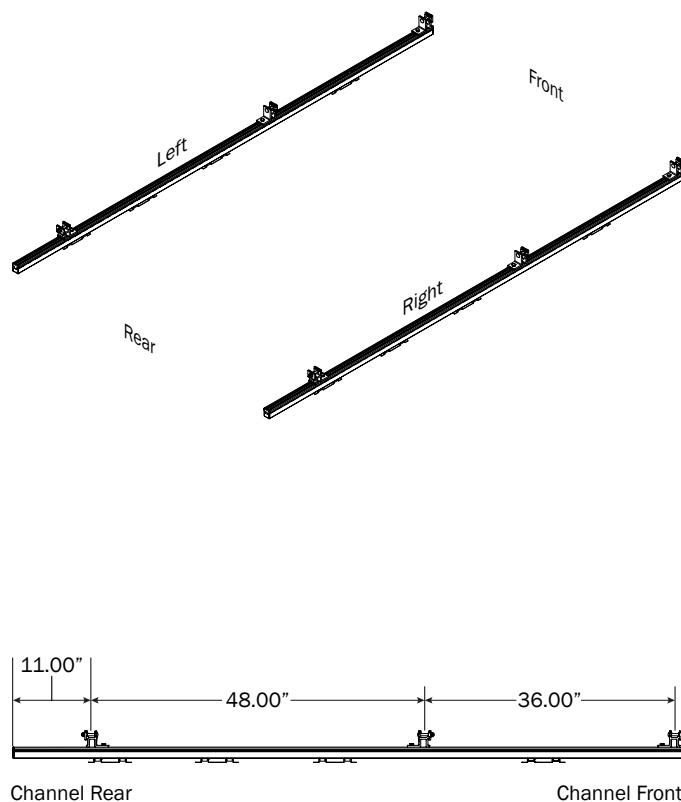

## RIGHT ROTATION ASSEMBLY SEQUENCE

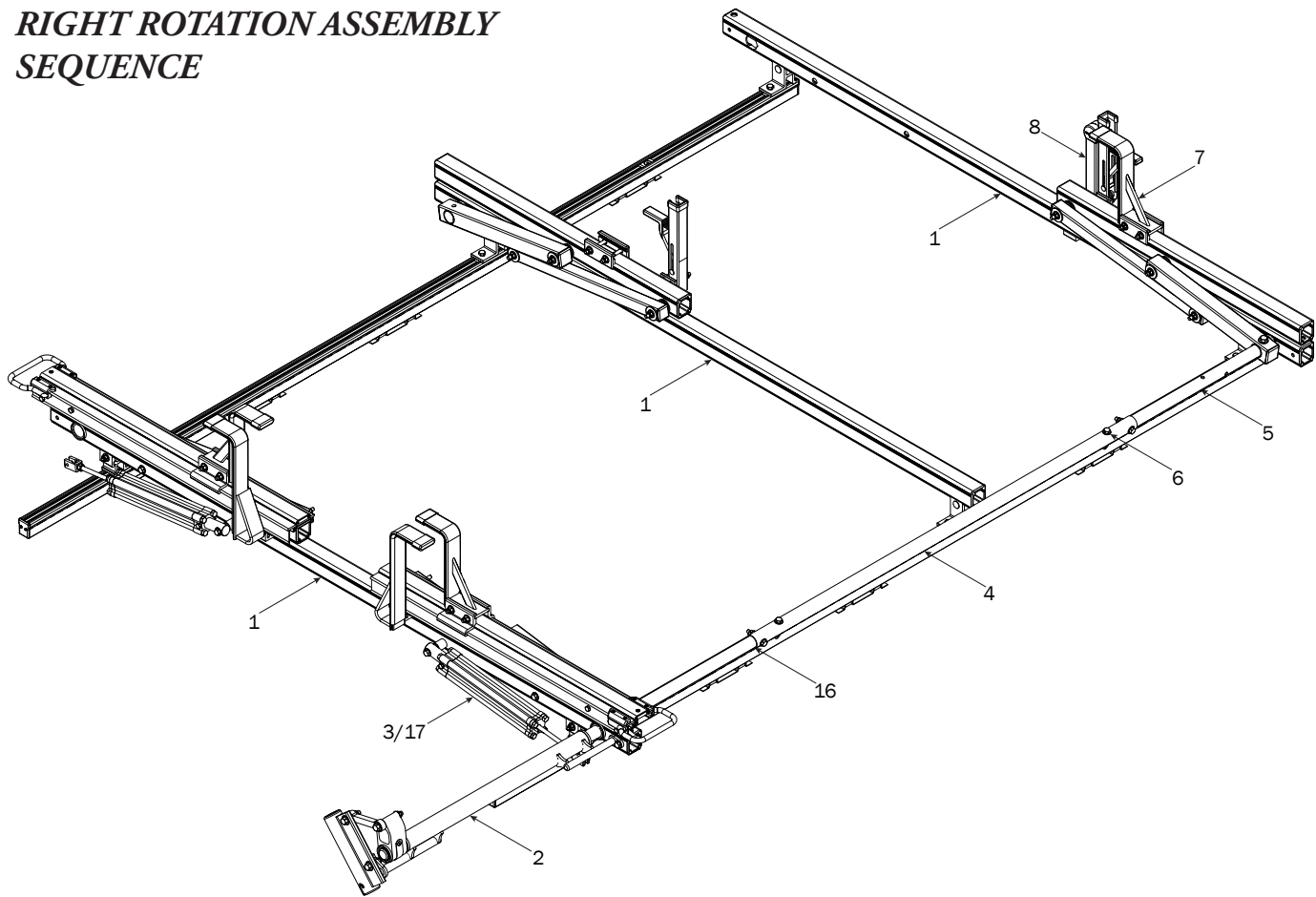

## CROSSBARS

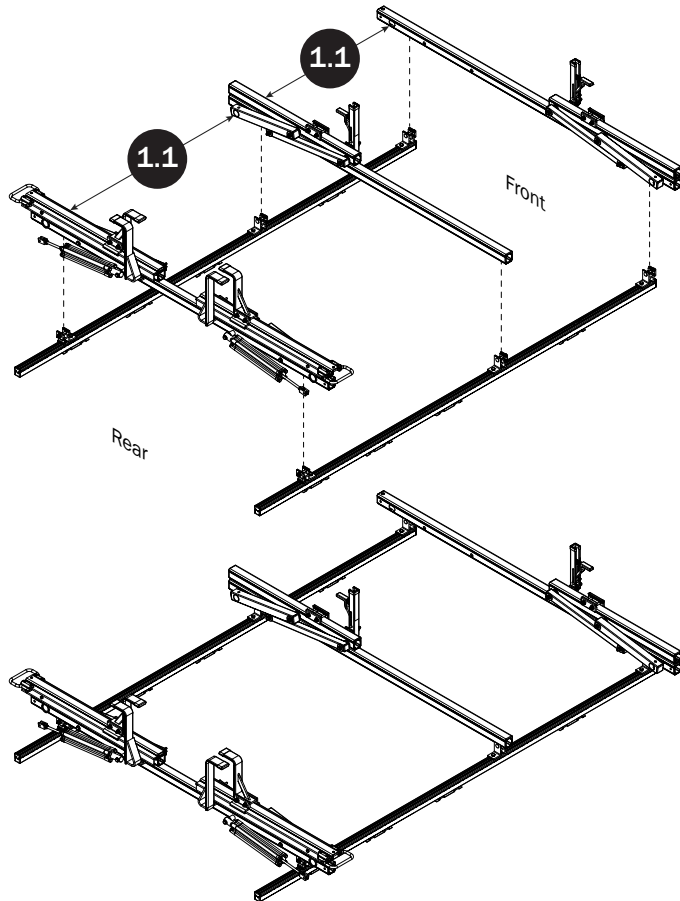

## CROSSBAR ADJUSTMENT

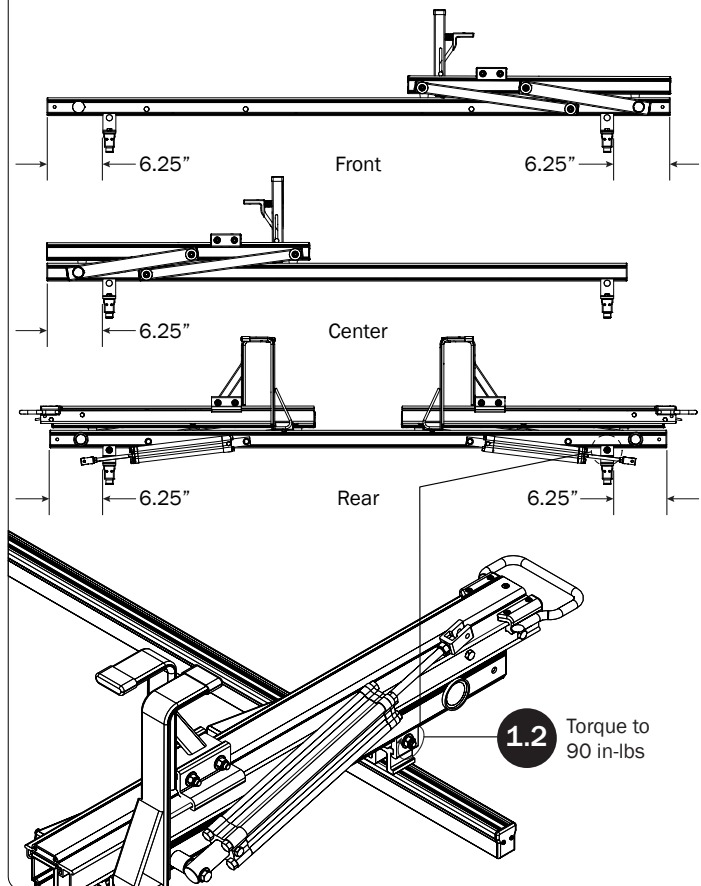

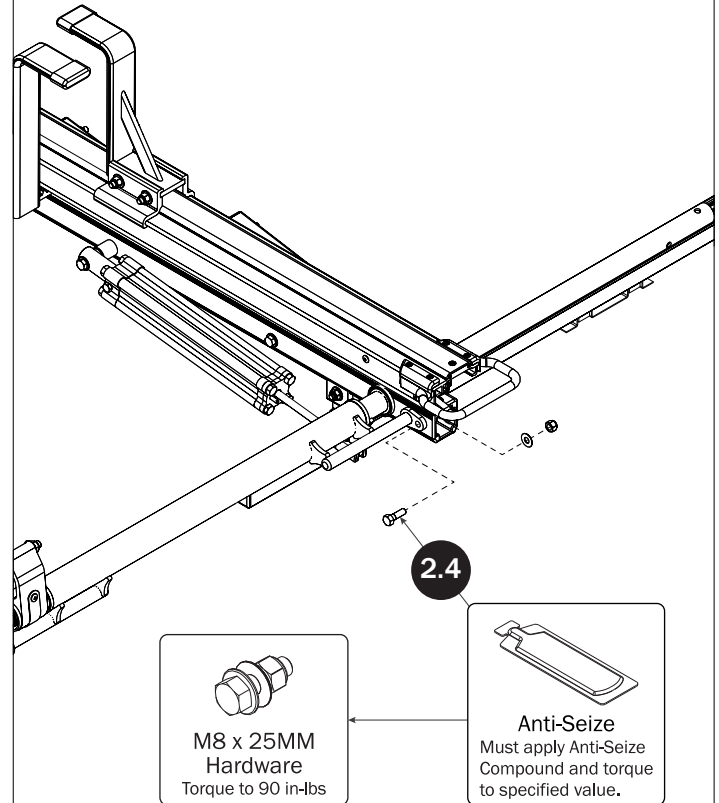
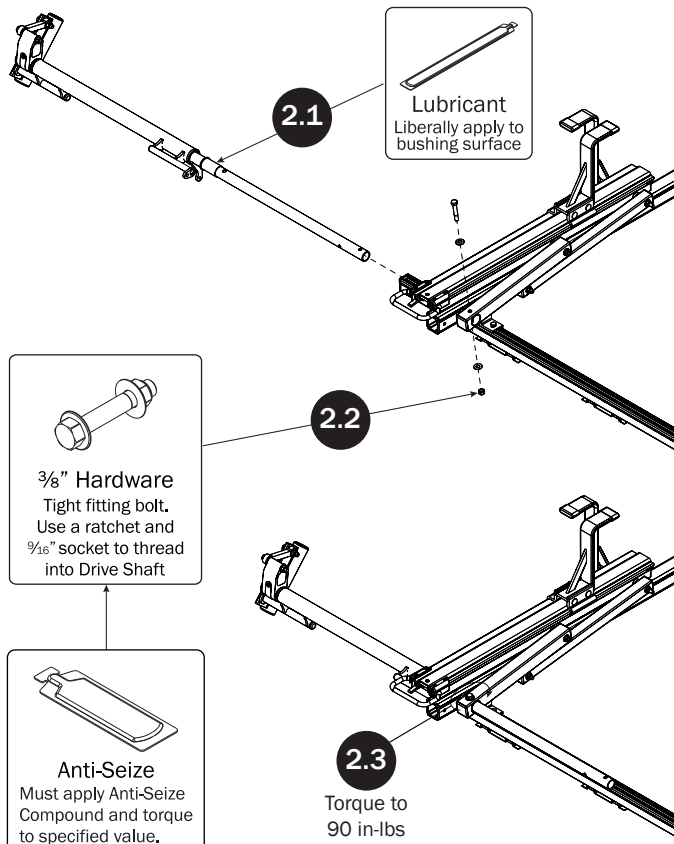
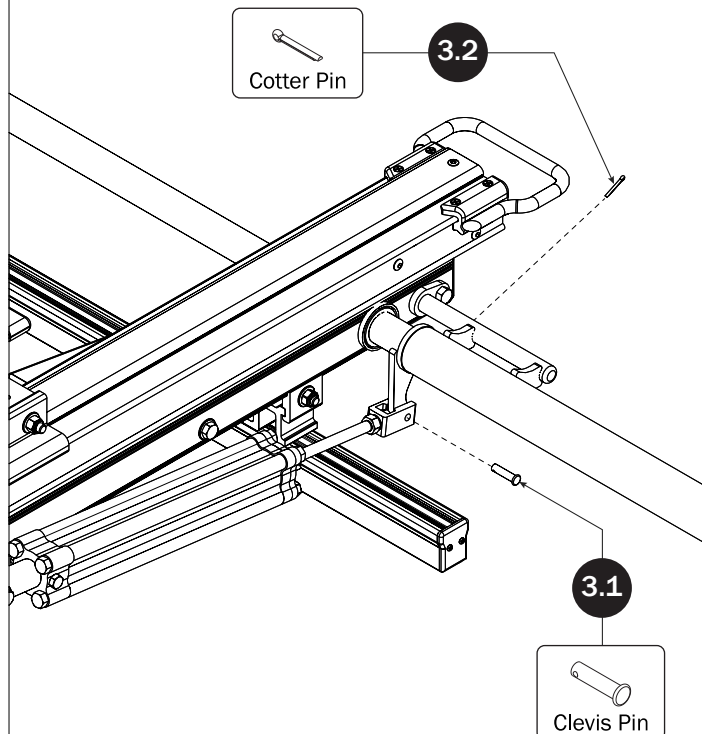
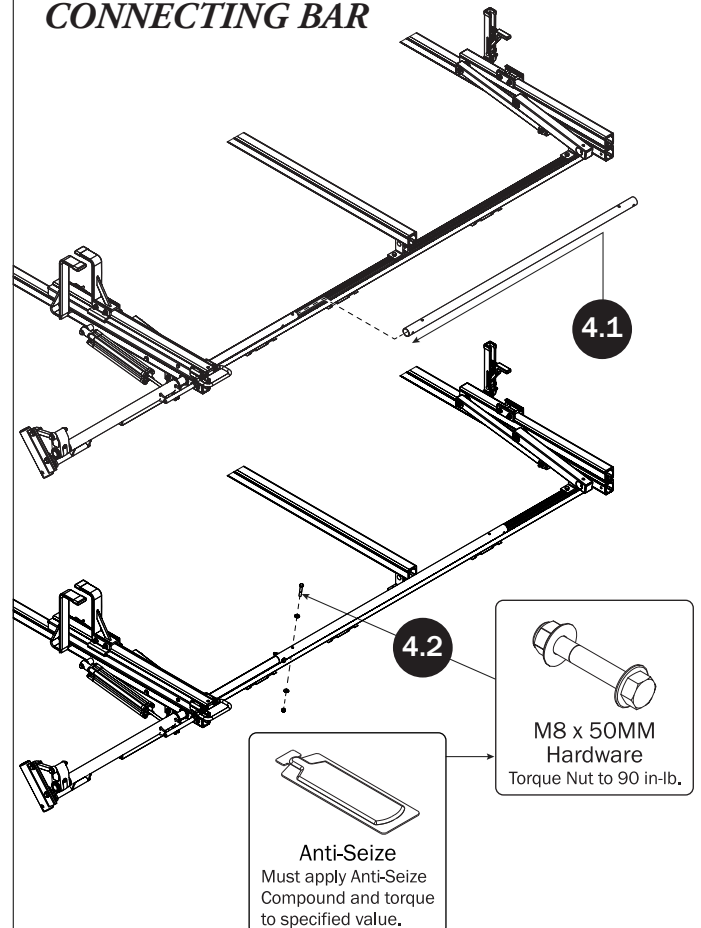
**REAR DRIVE SHAFT****CYLINDER HARDWARE****CONNECTING BAR**



## FRONT DRIVE SHAFT

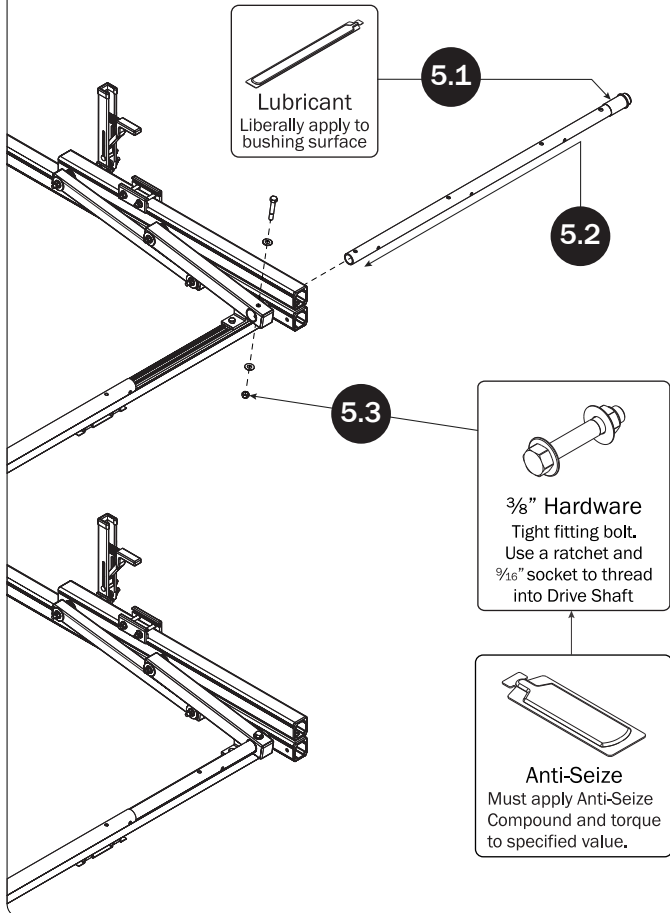

## CONNECTING BAR FASTENERS

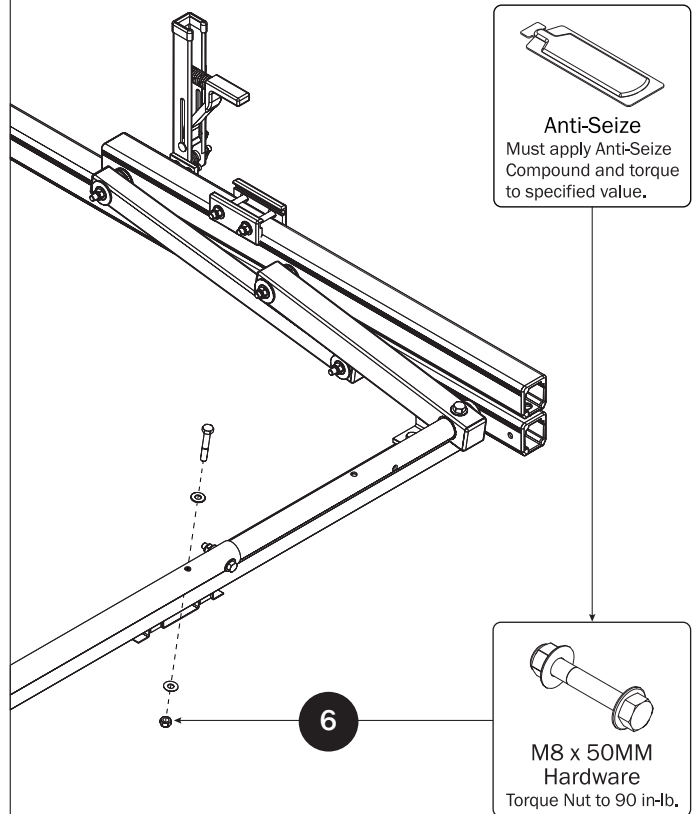

## Z POST

SEE QUICK START GUIDE FOR ADJUSTMENTS

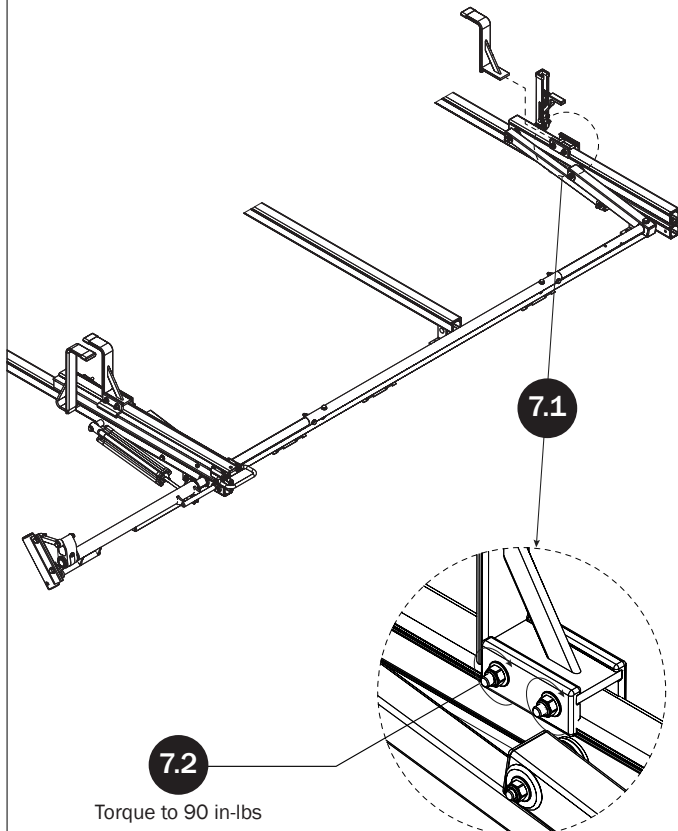

## L POST

SEE QUICK START GUIDE FOR ADJUSTMENTS

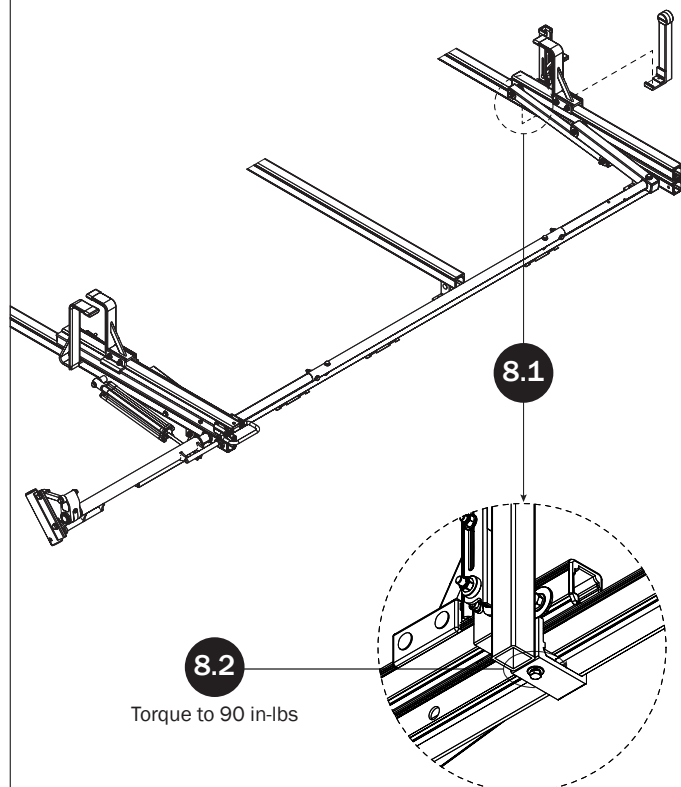

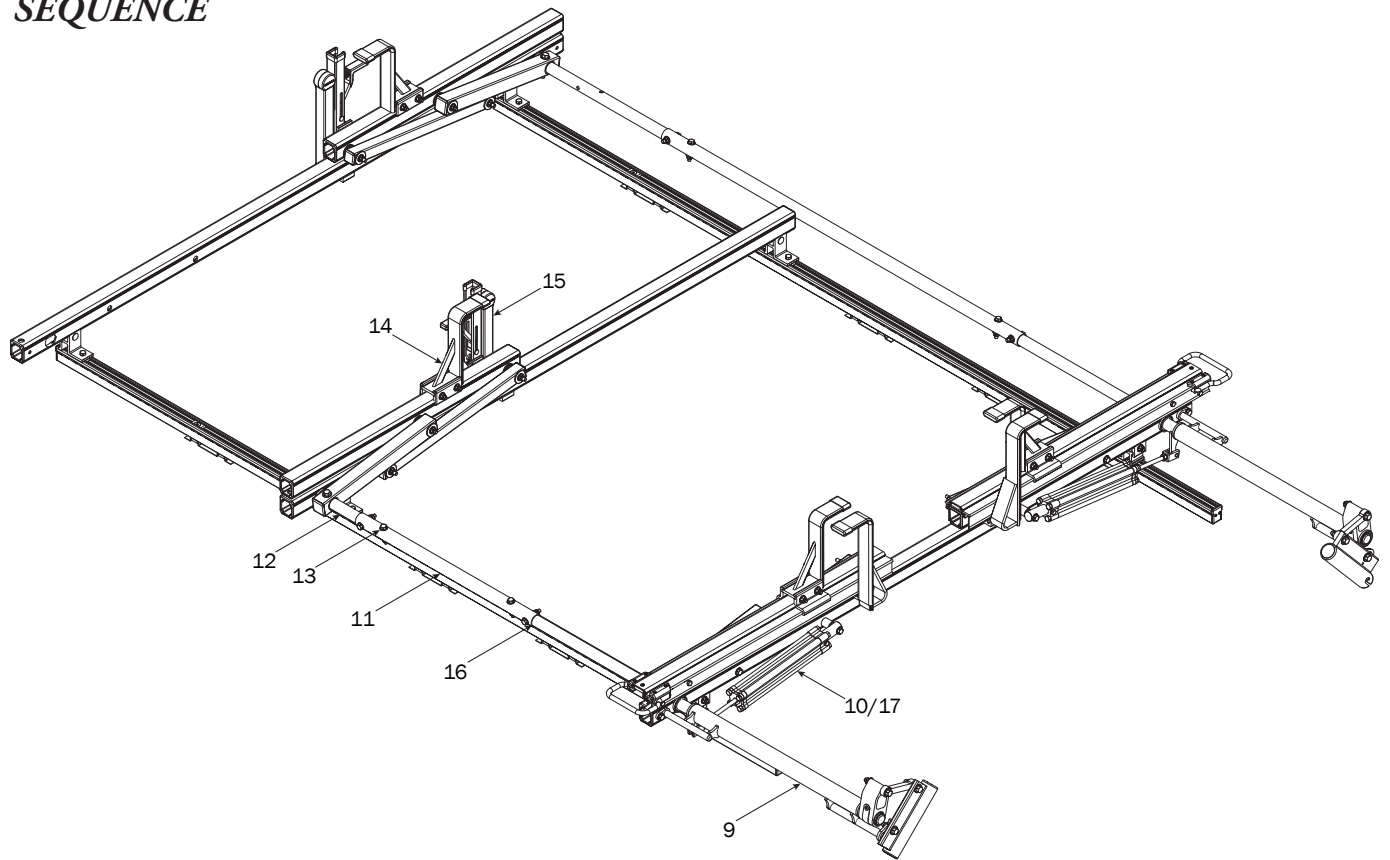
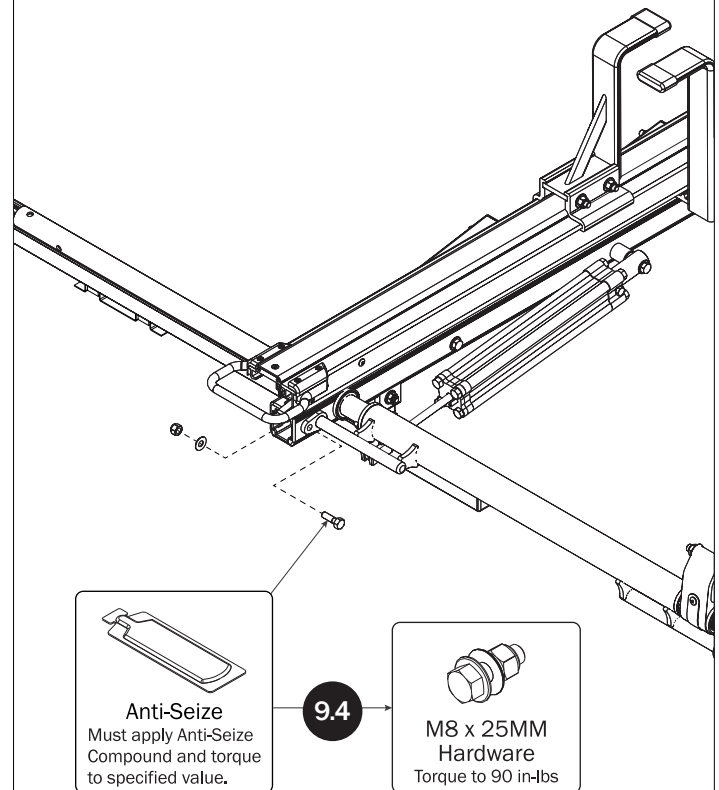
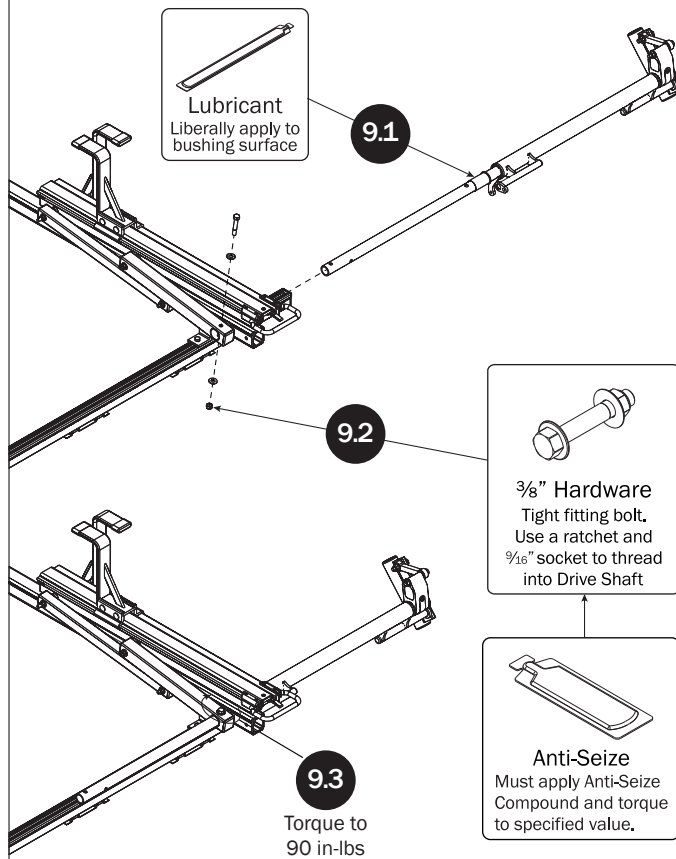
**LEFT ROTATION ASSEMBLY  
SEQUENCE****REAR DRIVE SHAFT**



## CYLINDER HARDWARE

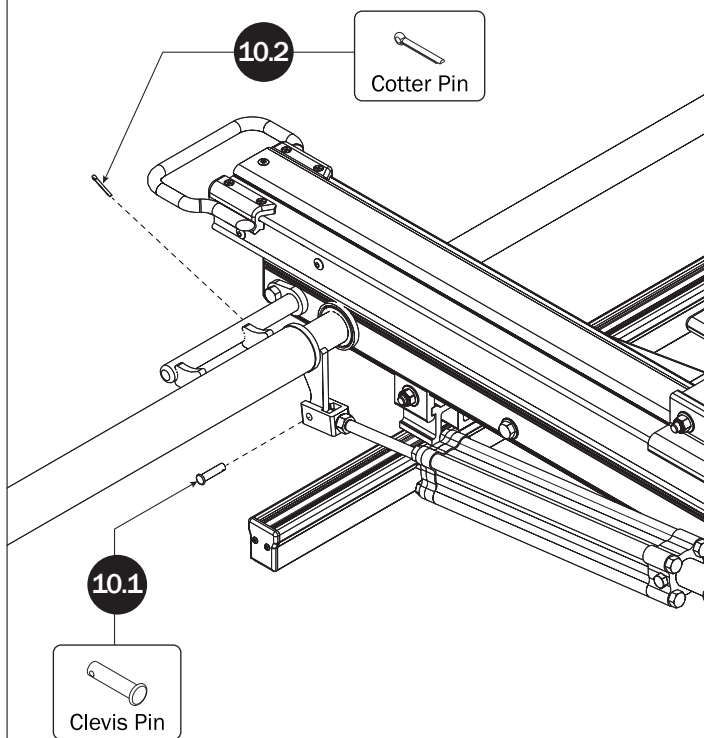

## CONNECTING BAR

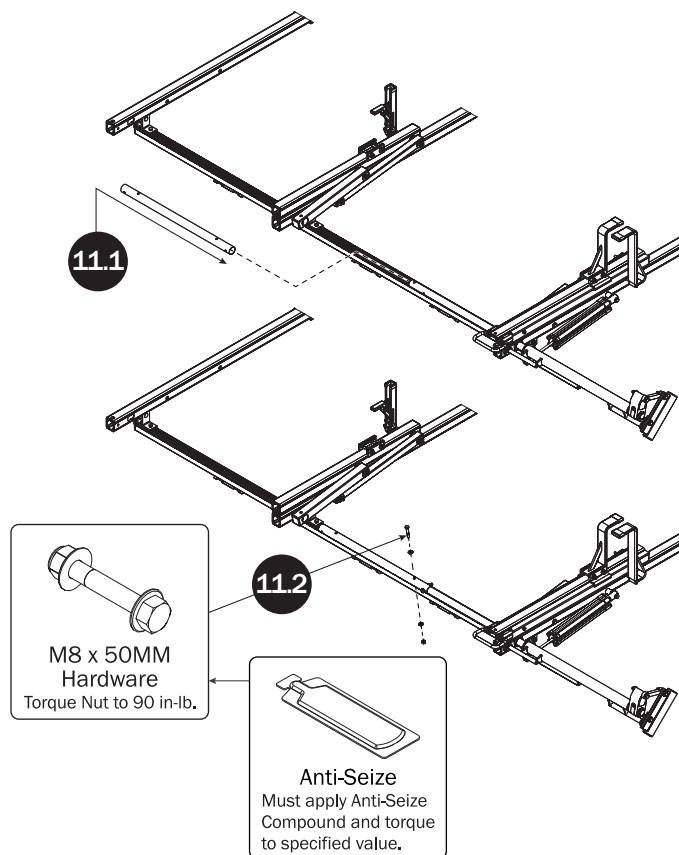

## FRONT DRIVE SHAFT

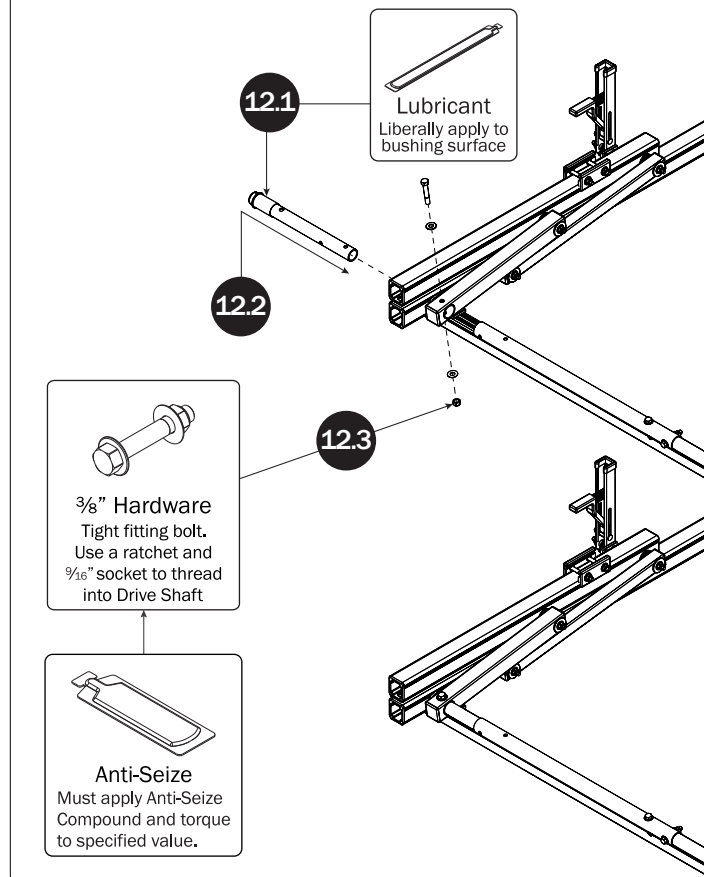

## CONNECTING BAR FASTENERS

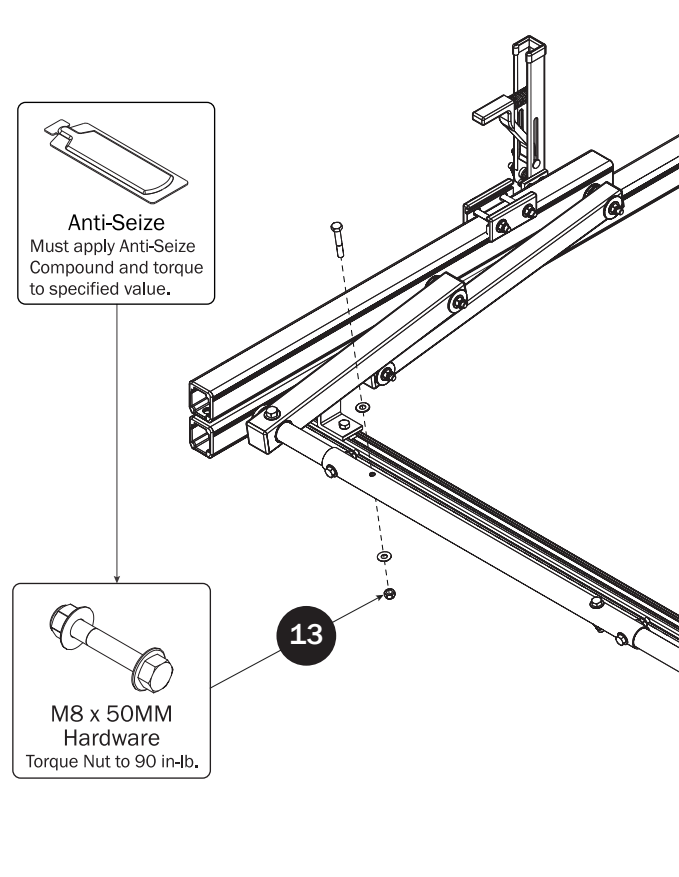

**Z POSTS**

SEE QUICK START GUIDE FOR ADJUSTMENTS

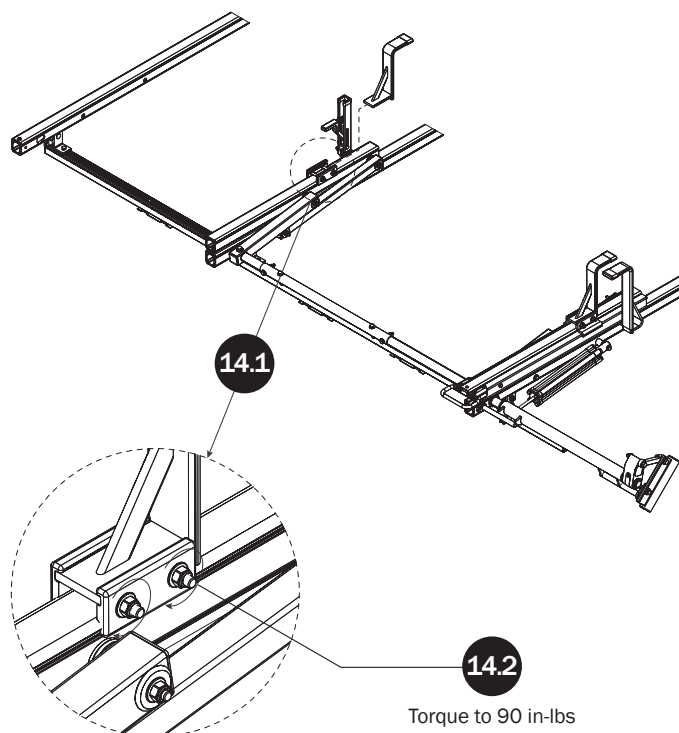
**L POSTS**

SEE QUICK START GUIDE FOR ADJUSTMENTS

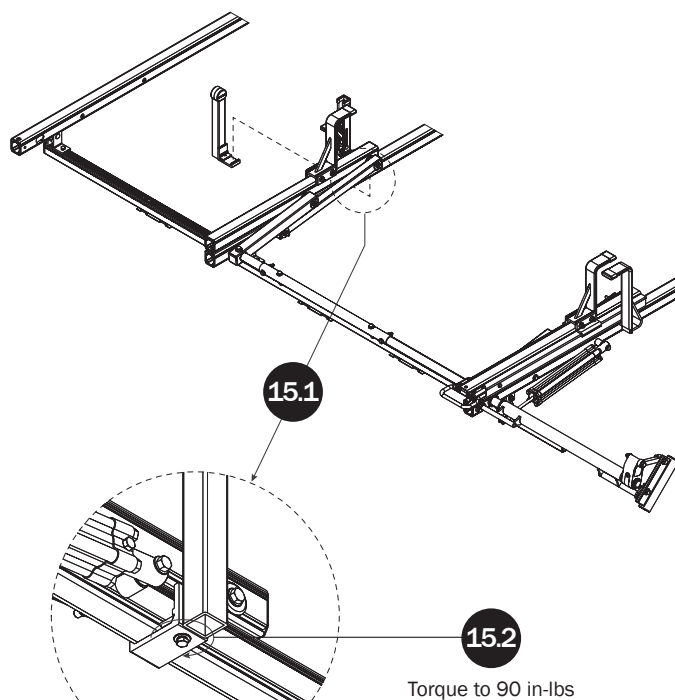
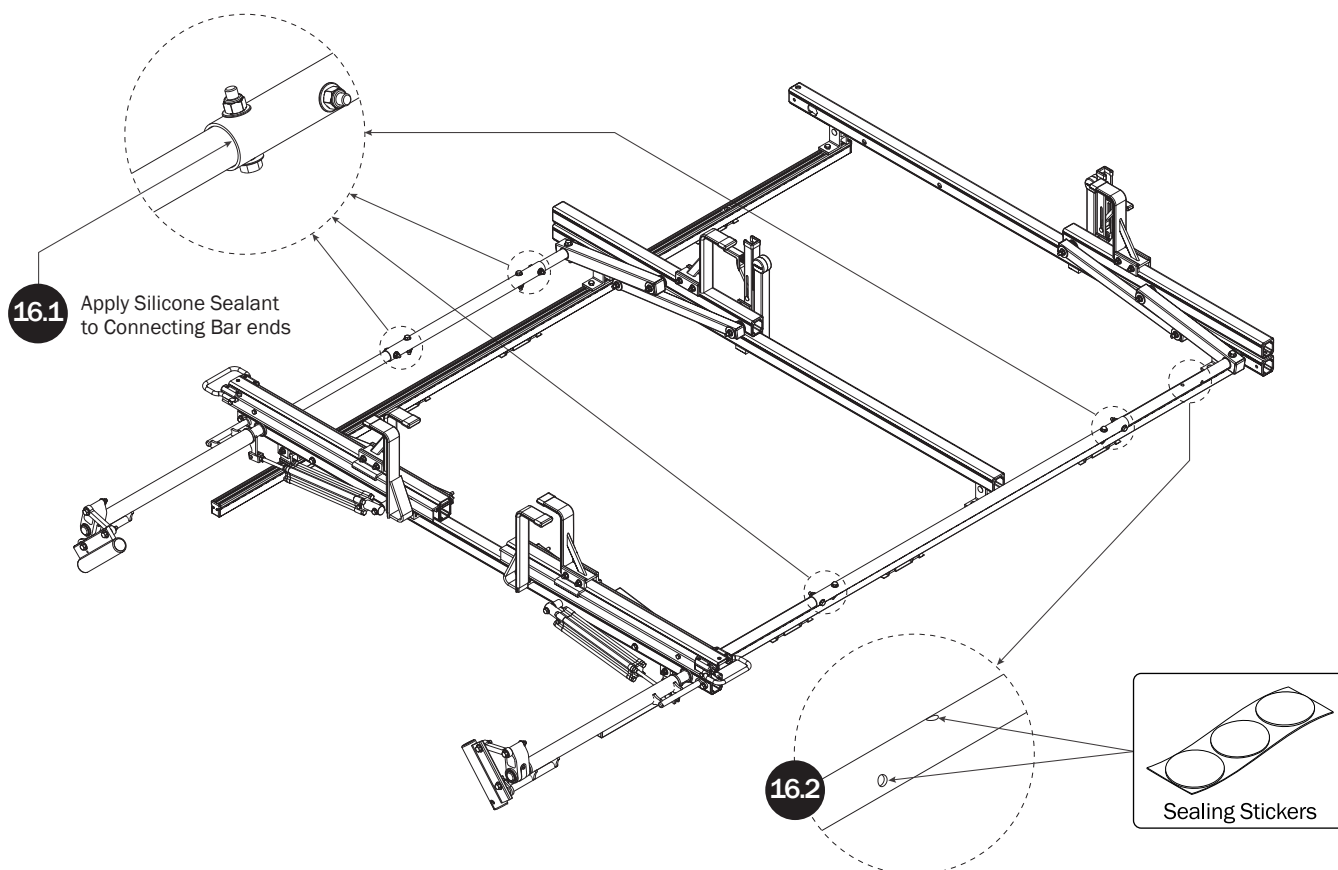
**DRIVE SHAFT SEALING**

## CYLINDER ADJUSTMENT

