

PRIME DESIGN™

A Safe Fleet Brand

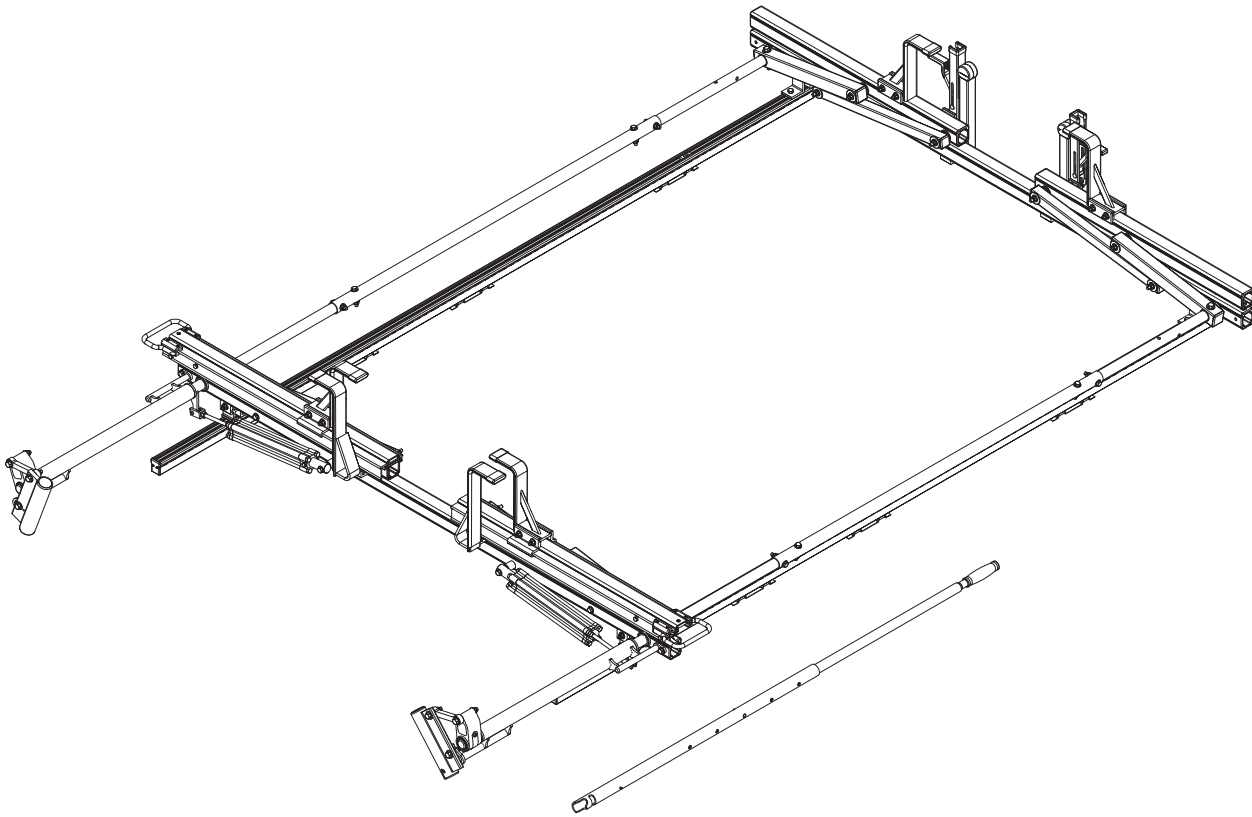

HRR-E

2B

CONTENTS OVERVIEW

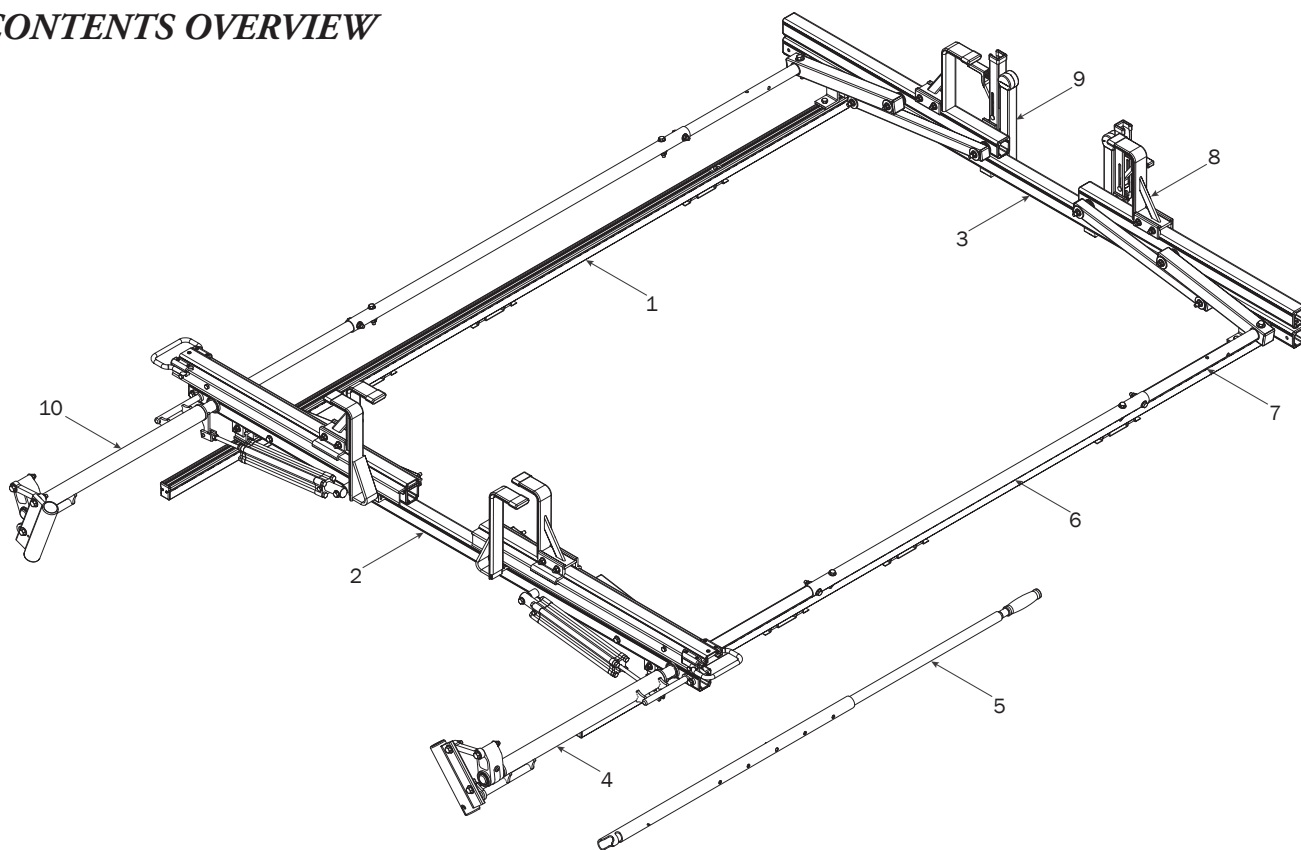

1—FBM-0049 (Qty 1)

Channels with hardware

Channels (2X)



End Caps (4X)



Screws (8X)



Brackets (4X)

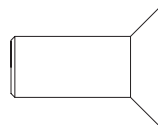

M8 Bolt (14X)

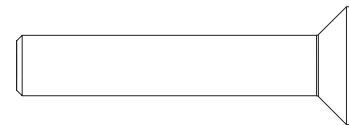

M8 Bolt (2X)

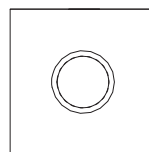

Square Nut (16X)

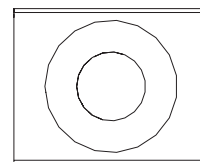

T Slot Insert (14X)

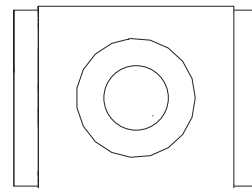

Connector Plate (2X)

2—Rear Crossbar Assembly (Qty 1)

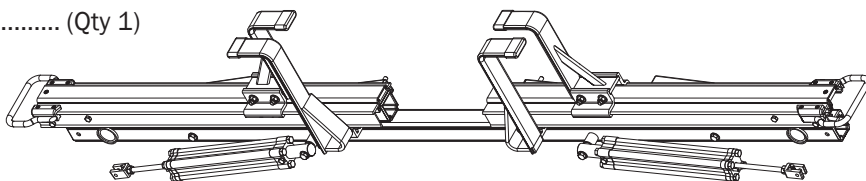

3—Front Crossbar Assembly (Qty 1)

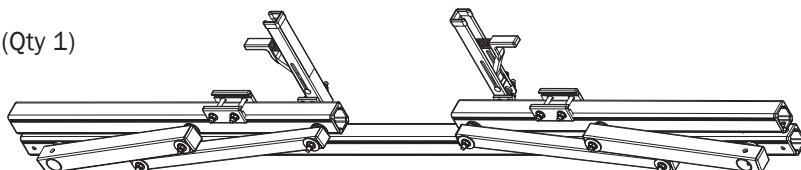

4—Rear Drive Shaft (Qty 1)
Right Hand, A Version, 50.00"

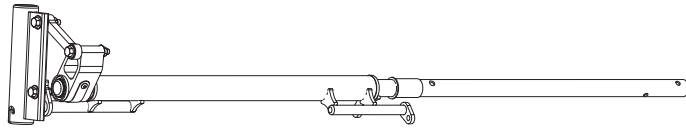

5—HHR Handle Assembly (Qty 1)
35.00"

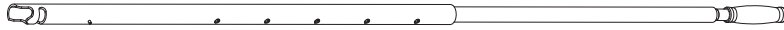

6—Connecting Bar (Qty 2)
4.00'



7—Front Drive Shaft (Qty 2)
B Version, 35.75"



8—Z Post (Qty 2)
Adjustable, 7.25"

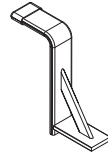

9—L Post (Qty 2)
Roller Cap, 9.25"



10—Rear Drive Shaft (Qty 1)
Left Hand, A Version, 50.00"

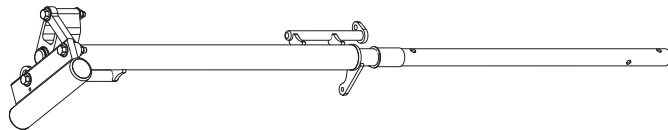

11—HKT-8163 (Not called out in Overview)..... (Qty 2)

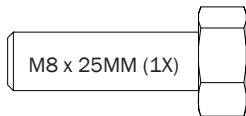

M8 x 25MM (1X)

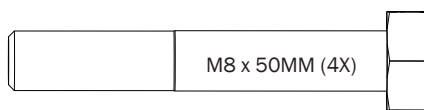

M8 x 50MM (4X)

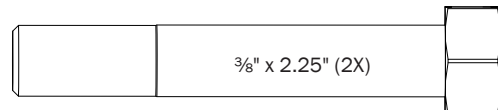

3/8" x 2.25" (2X)



Cotter Pin (1X)

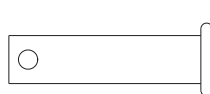

Clevis Pin (1X)

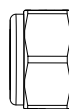

M8 Lock Nut (5X)

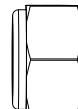

3/8" Lock Nut (2X)

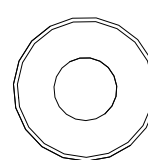

5/16" Flat Washer (10X)

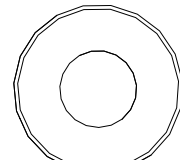

3/8" Flat Washer (4X)

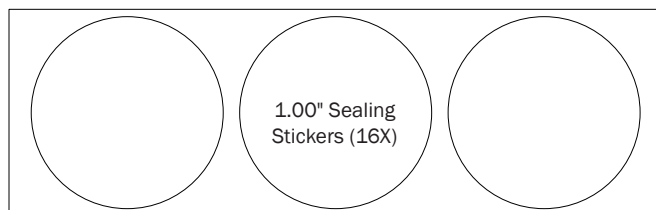

1.00" Sealing
Stickers (16X)



Anti-Seize (2X)

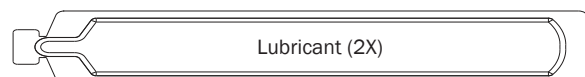

Lubricant (2X)

FBM-0049**CHANNELS TO ROOF**

- 0.1** Assemble Mounts as shown below. Front Mount Bracket's holes do not receive hardware until Step 0.5

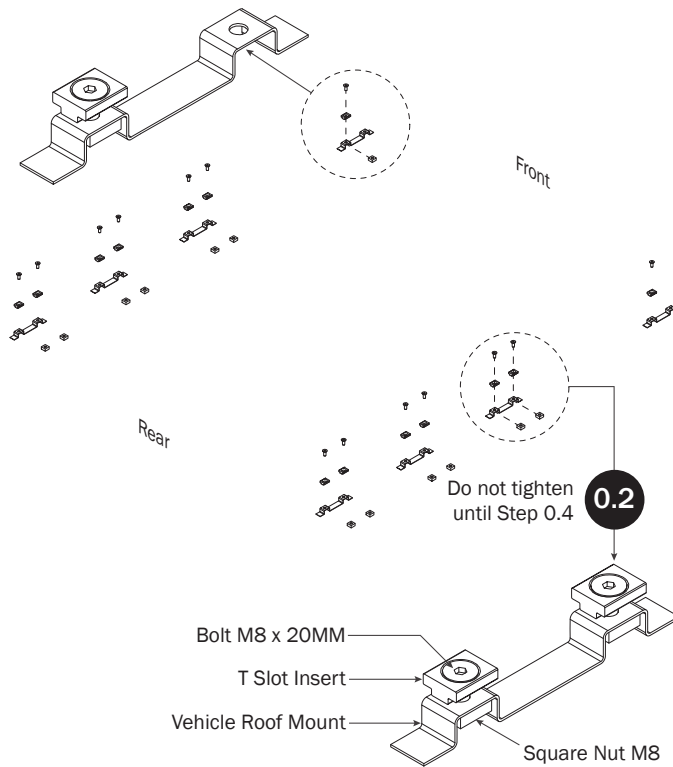

- 0.3** Slide Channels onto Roof Mounts and set distances as shown.

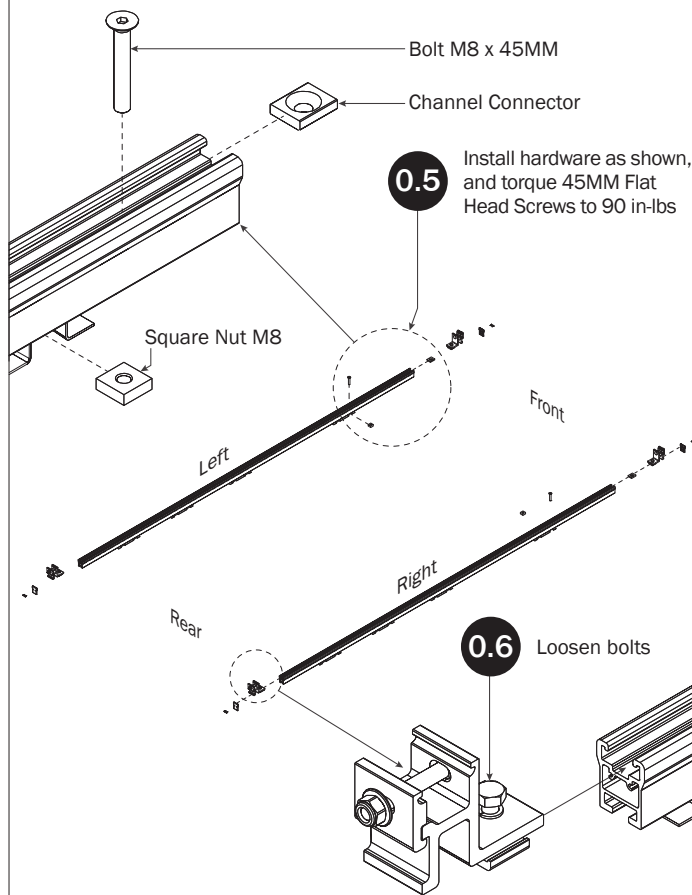
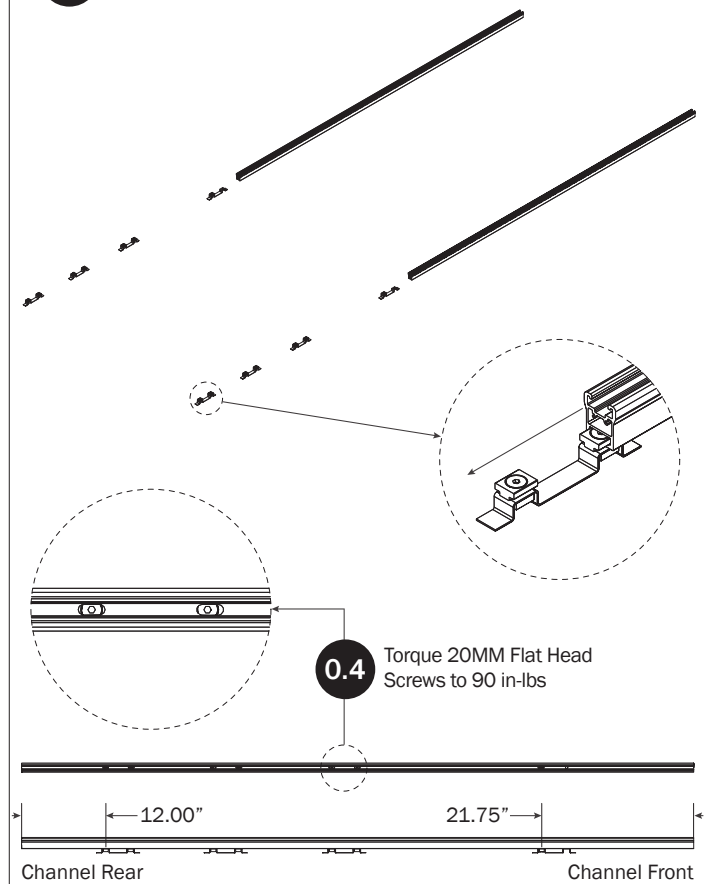

- 0.7** Set to distances then torque the Rear Bracket nuts to 90 in-lb.

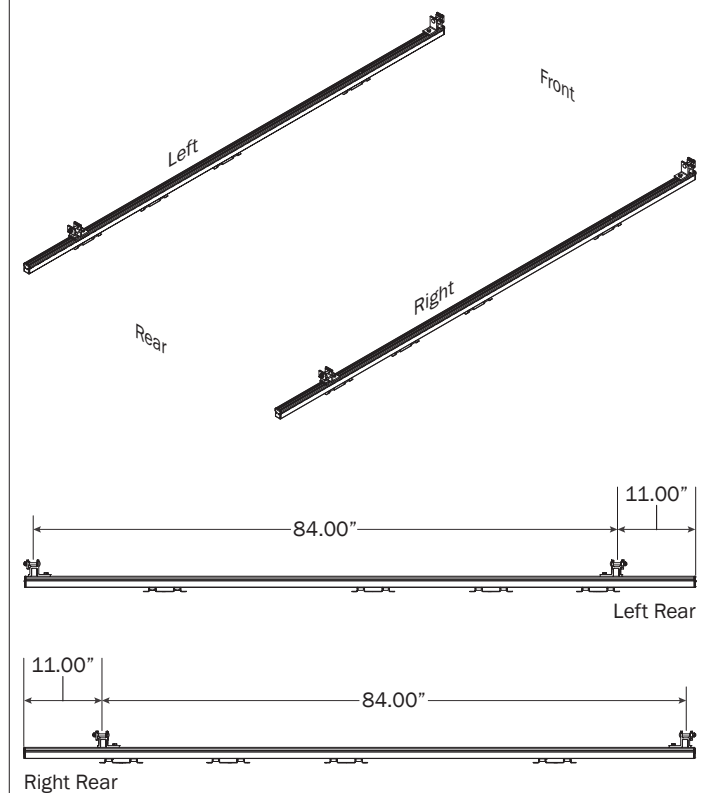

RIGHT ROTATION ASSEMBLY SEQUENCE

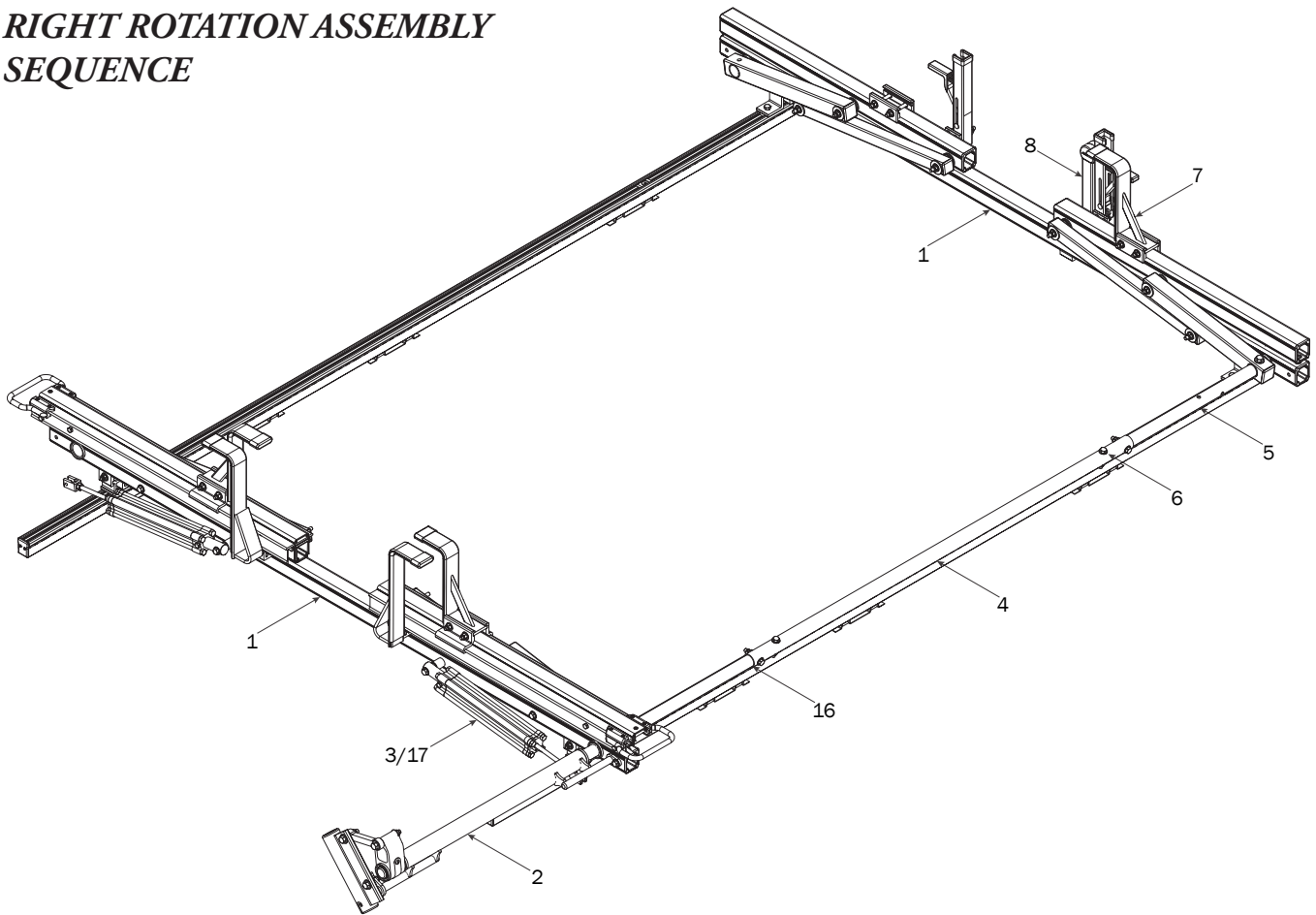

CROSSBARS

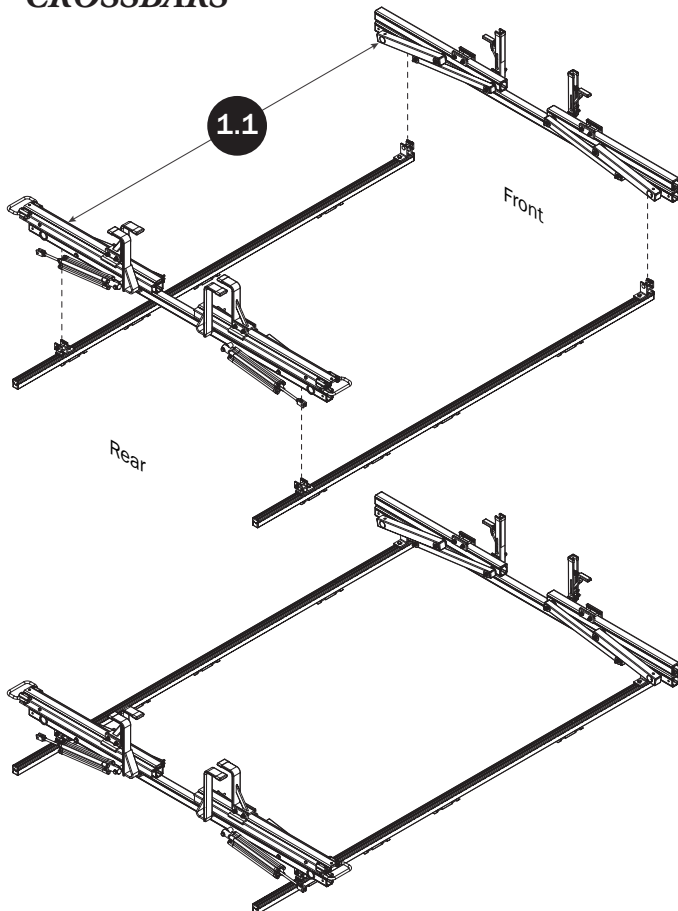

CROSSBAR ADJUSTMENT

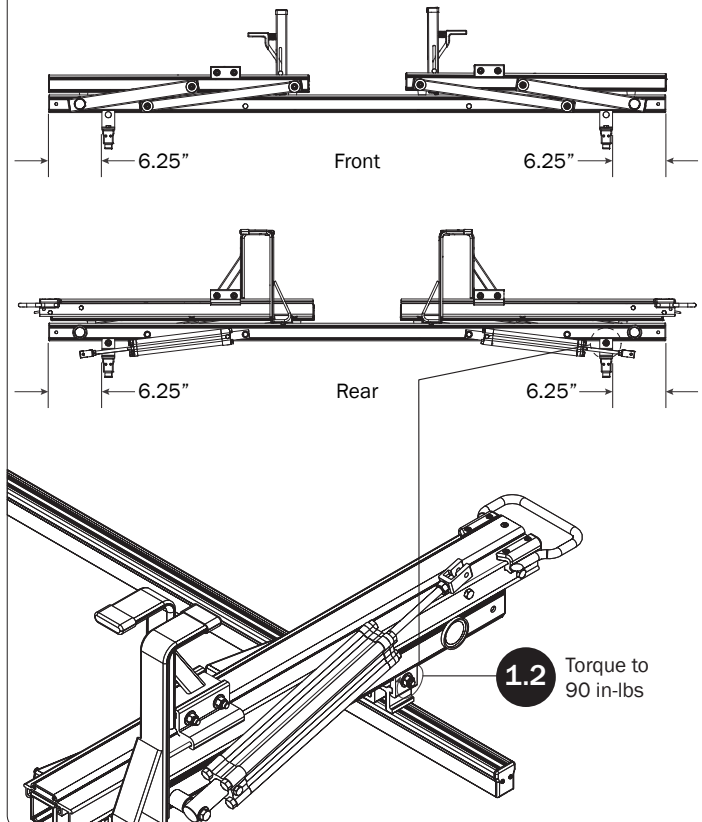

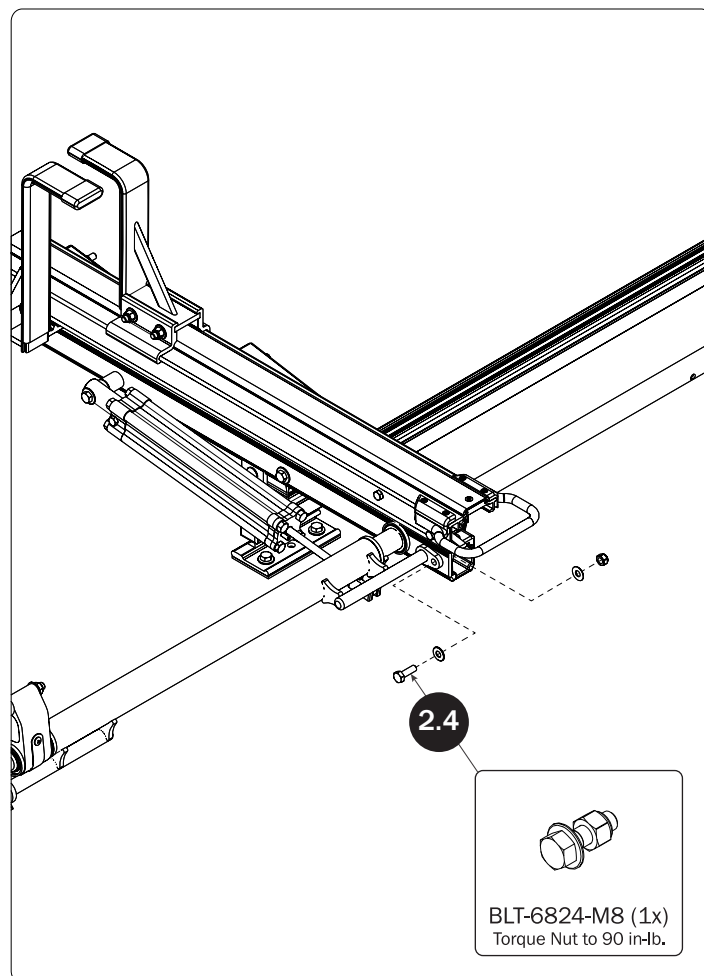
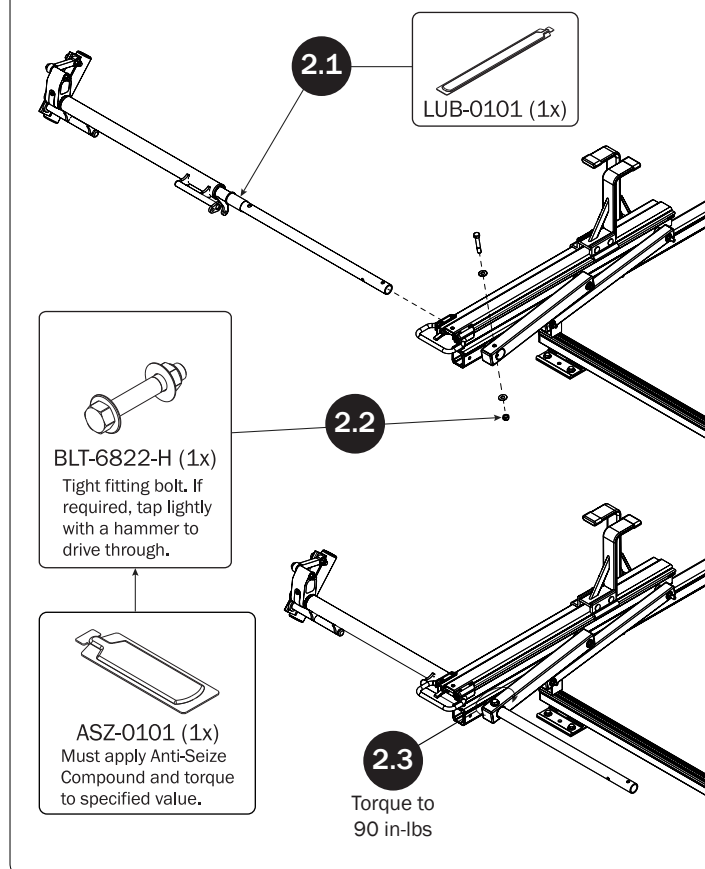
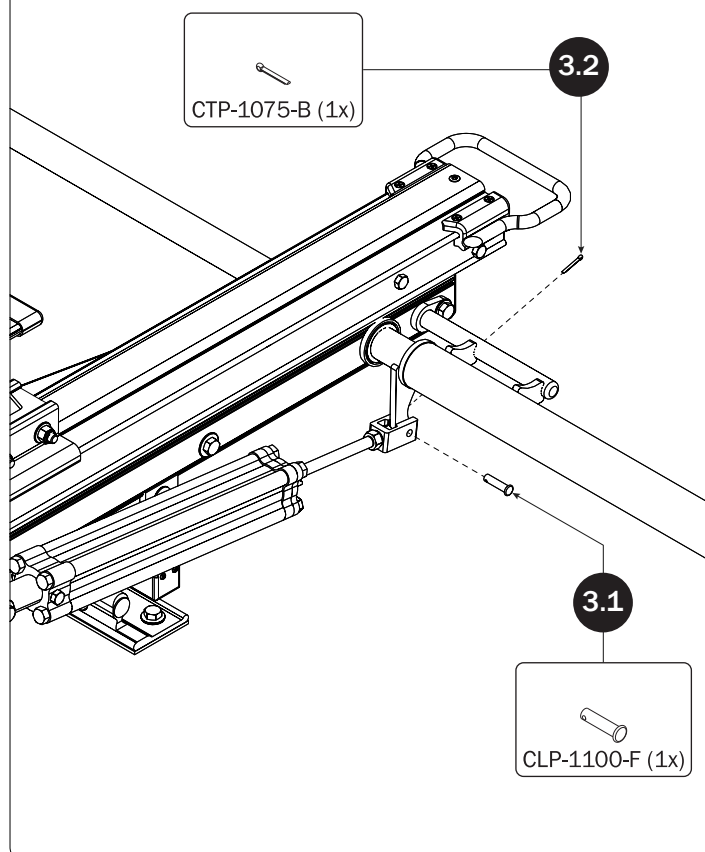
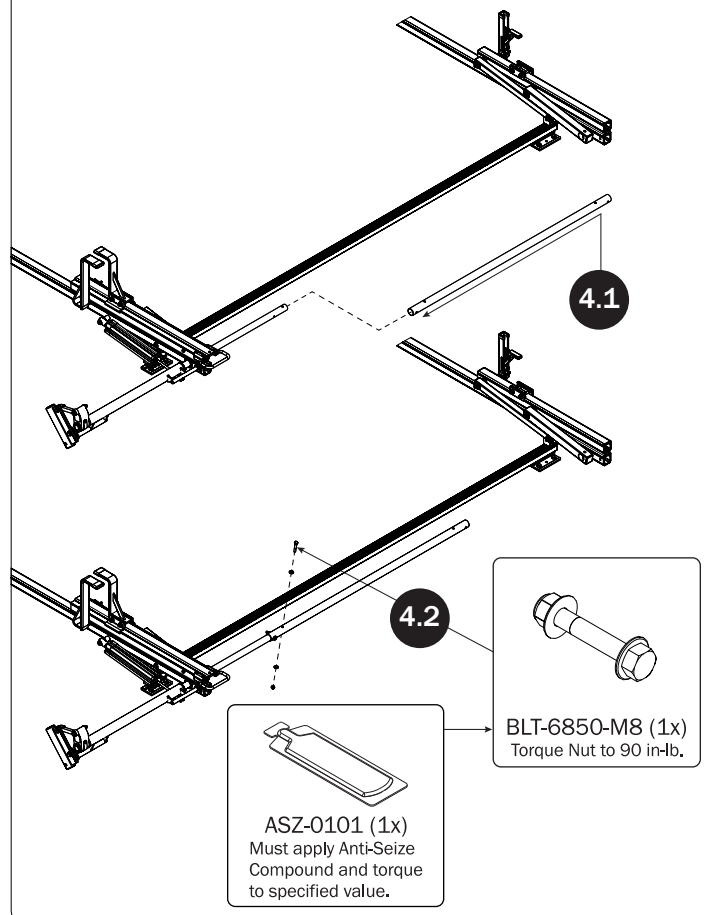
REAR DRIVE SHAFT**CYLINDER HARDWARE****CONNECTING BAR**

FRONT DRIVE SHAFT

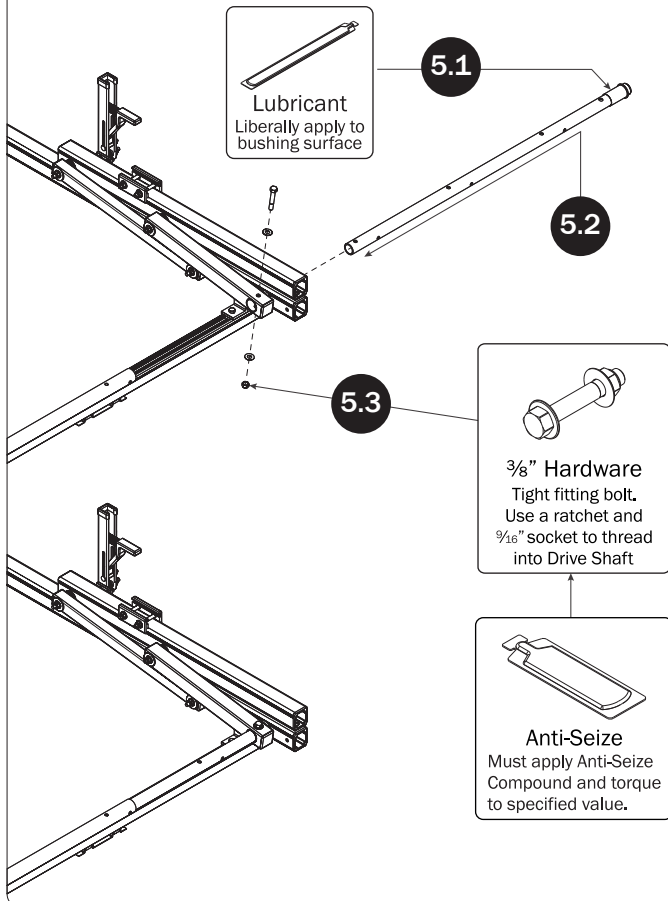

CONNECTING BAR FASTENERS

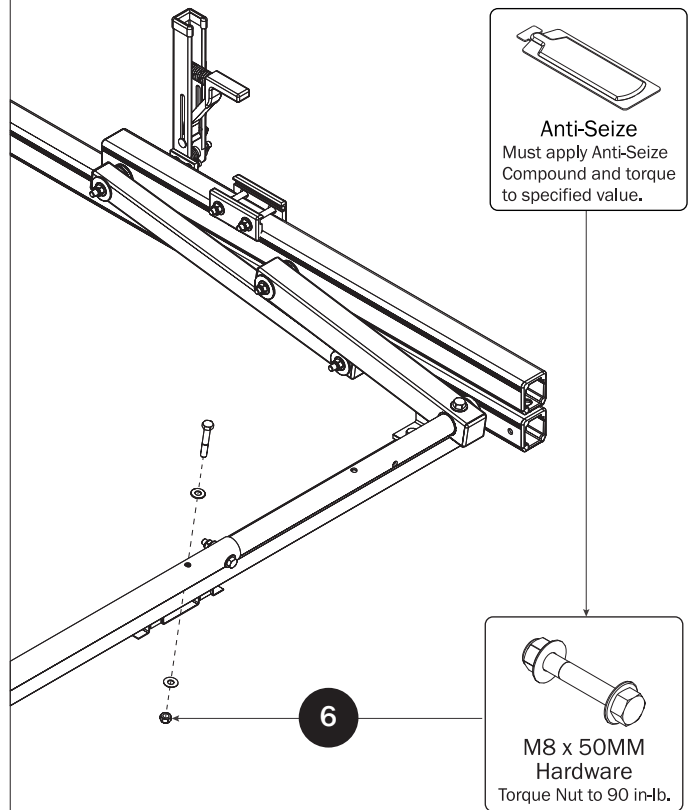

Z POST

SEE QUICK START GUIDE FOR ADJUSTMENTS

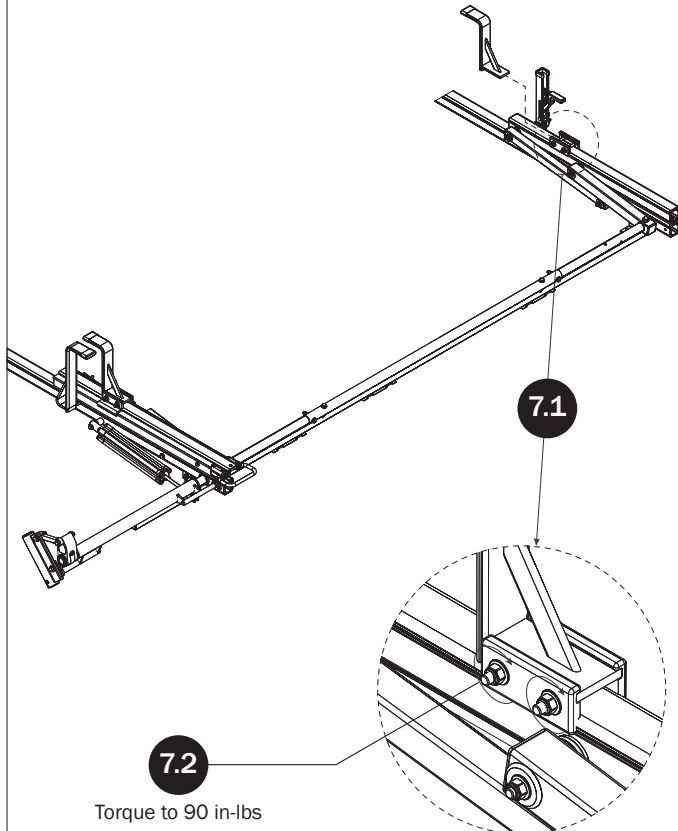

L POST

SEE QUICK START GUIDE FOR ADJUSTMENTS

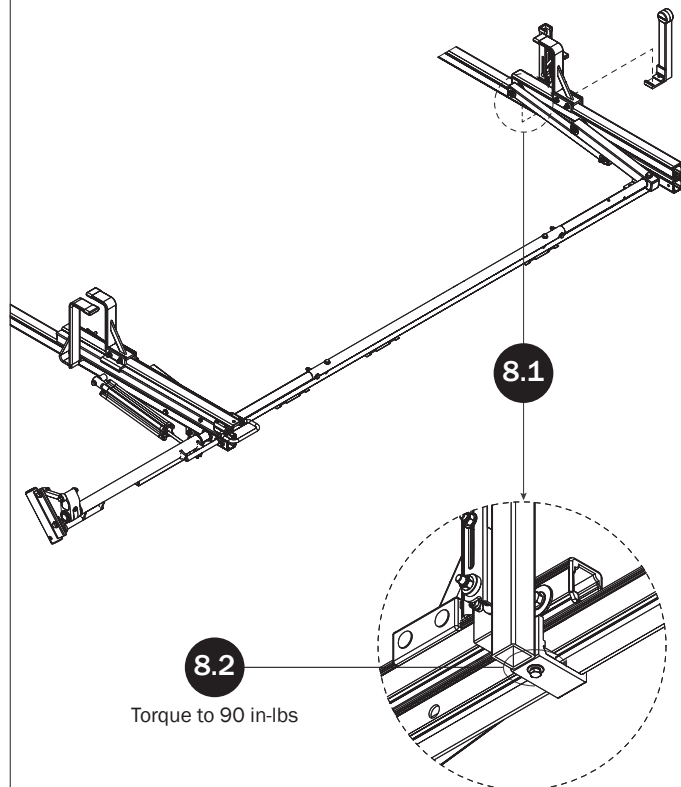

LEFT ROTATION ASSEMBLY SEQUENCE

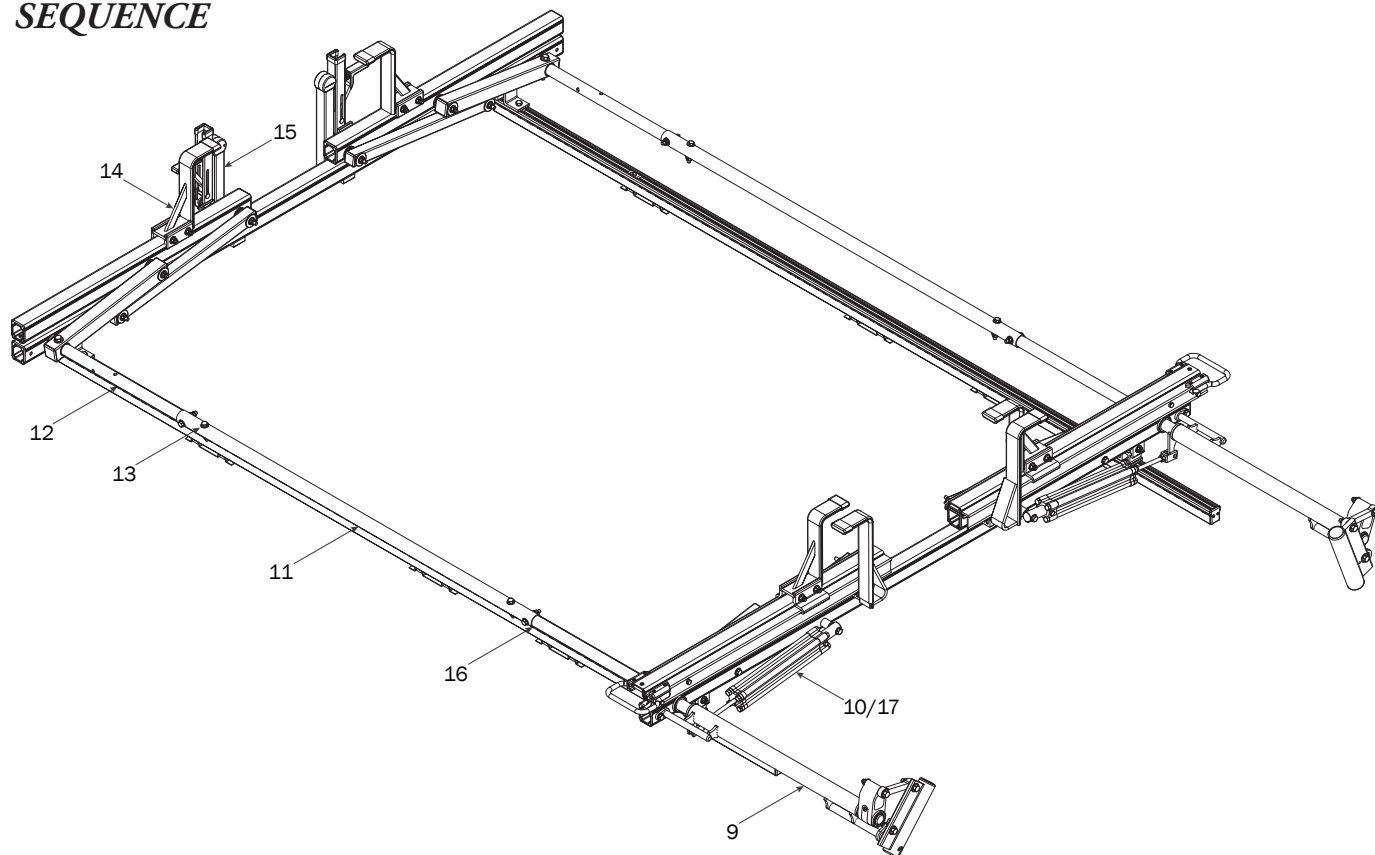

REAR DRIVE SHAFT

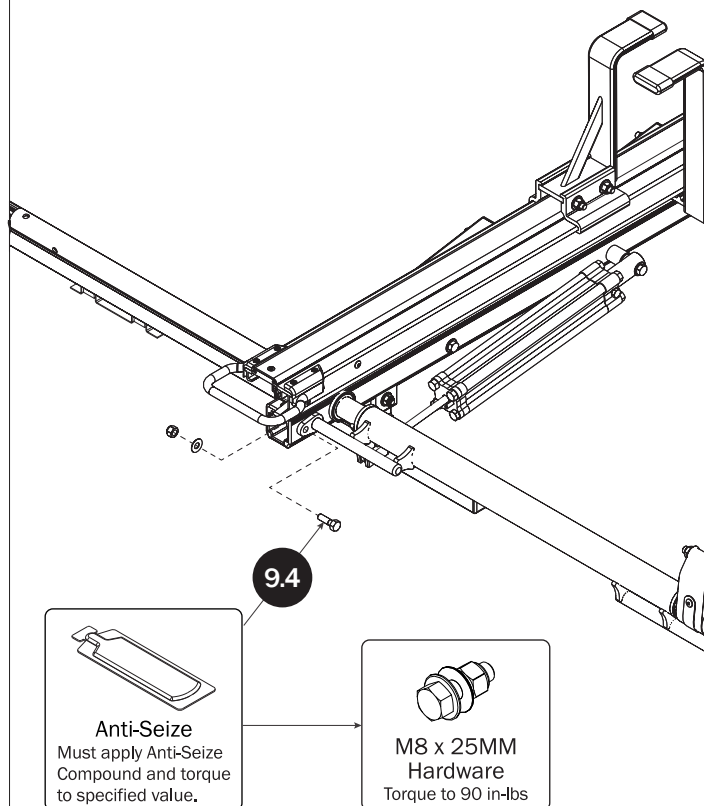
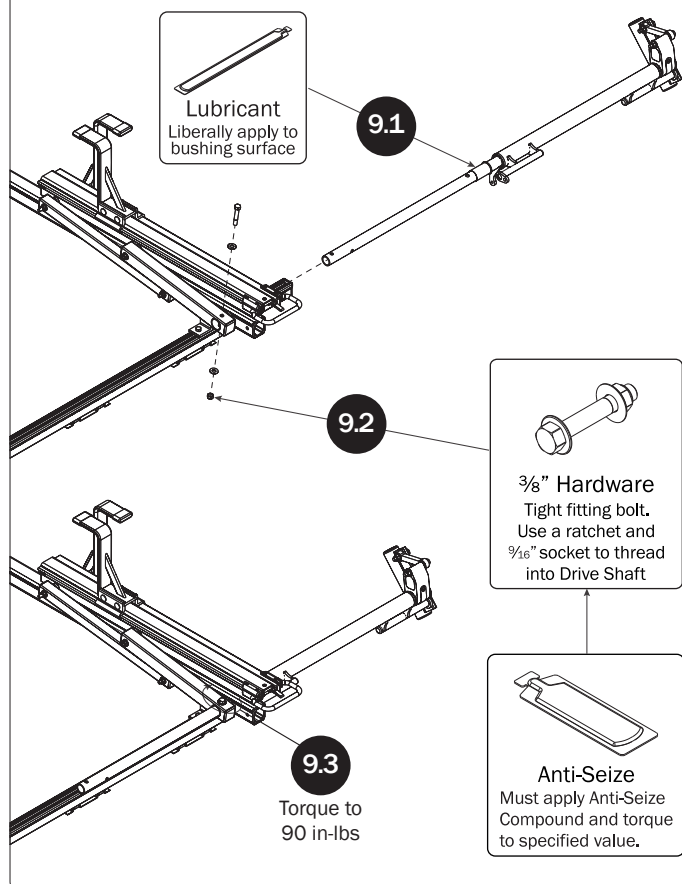

CYLINDER HARDWARE

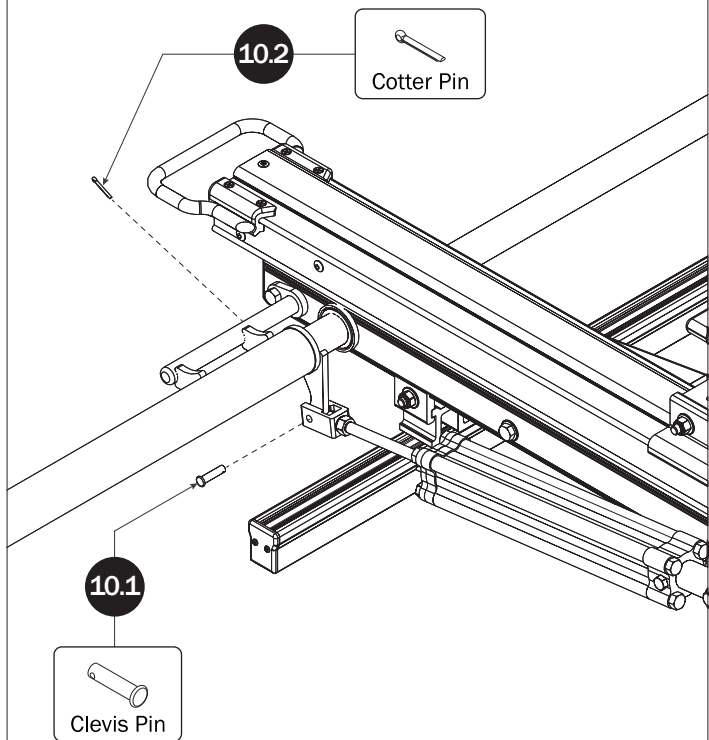

CONNECTING BAR

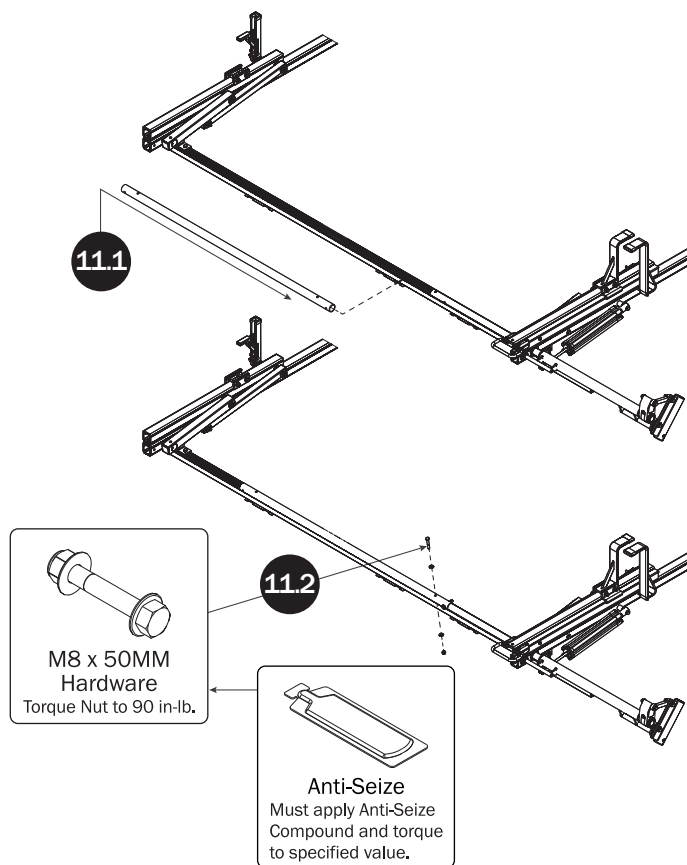

FRONT DRIVE SHAFT

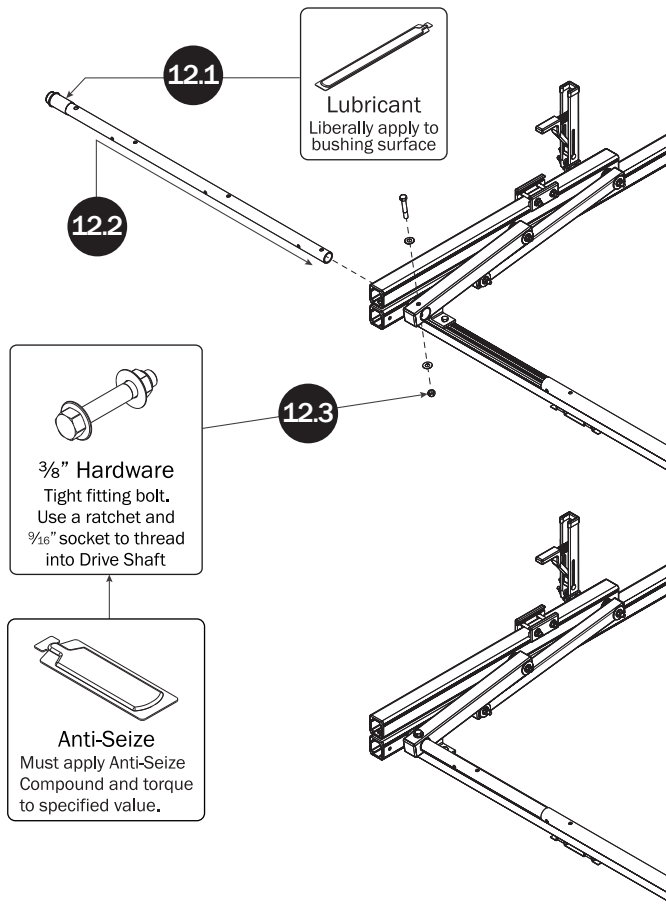

CONNECTING BAR FASTENERS

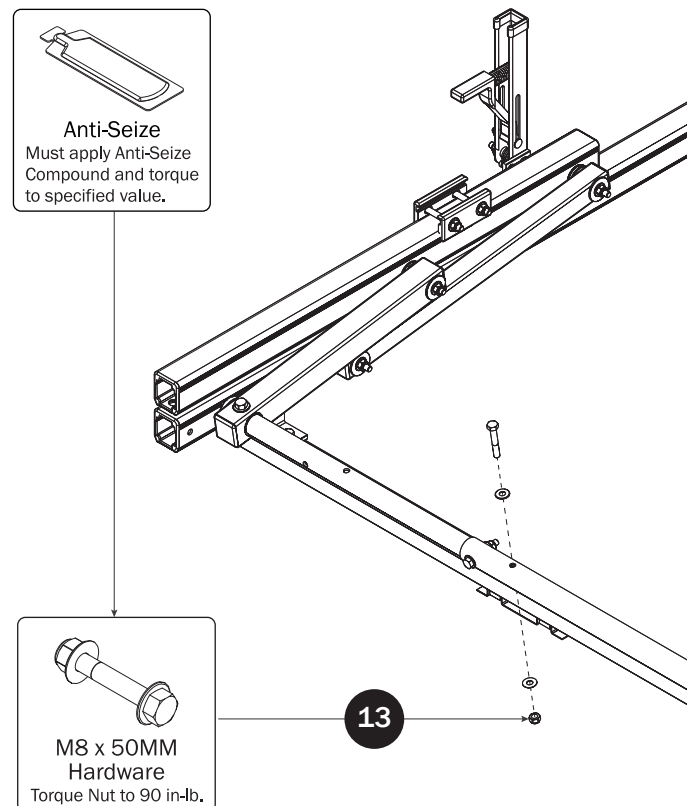

Z POSTS

SEE QUICK START GUIDE FOR ADJUSTMENTS

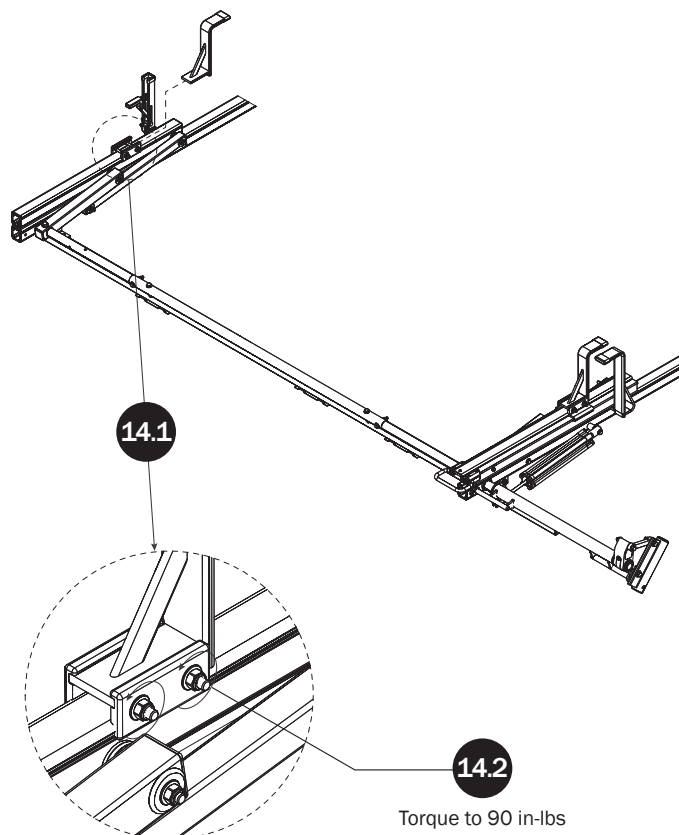
**L POSTS**

SEE QUICK START GUIDE FOR ADJUSTMENTS

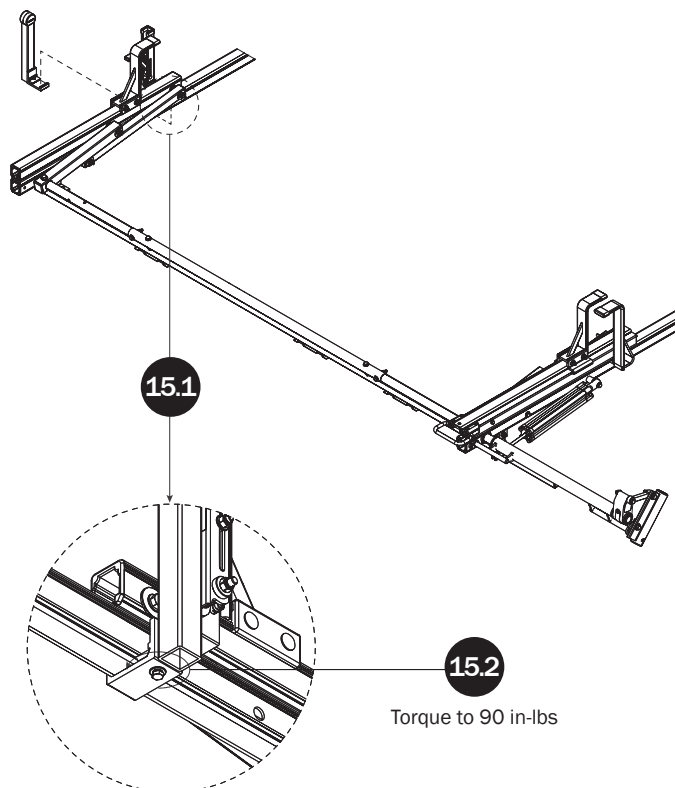
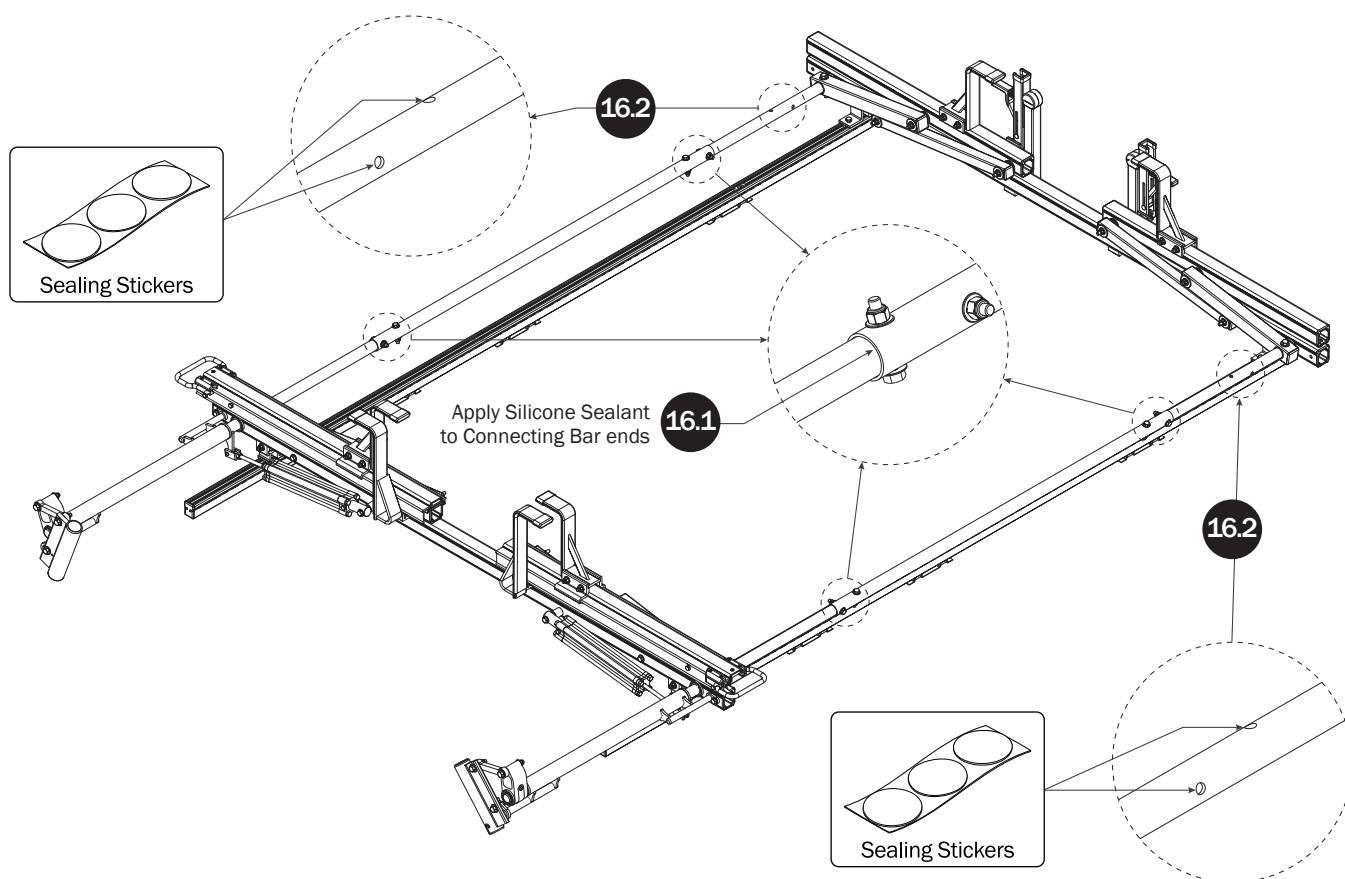
**DRIVE SHAFT SEALING**

CYLINDER ADJUSTMENT

