

PRIME DESIGN™

A Safe Fleet Brand

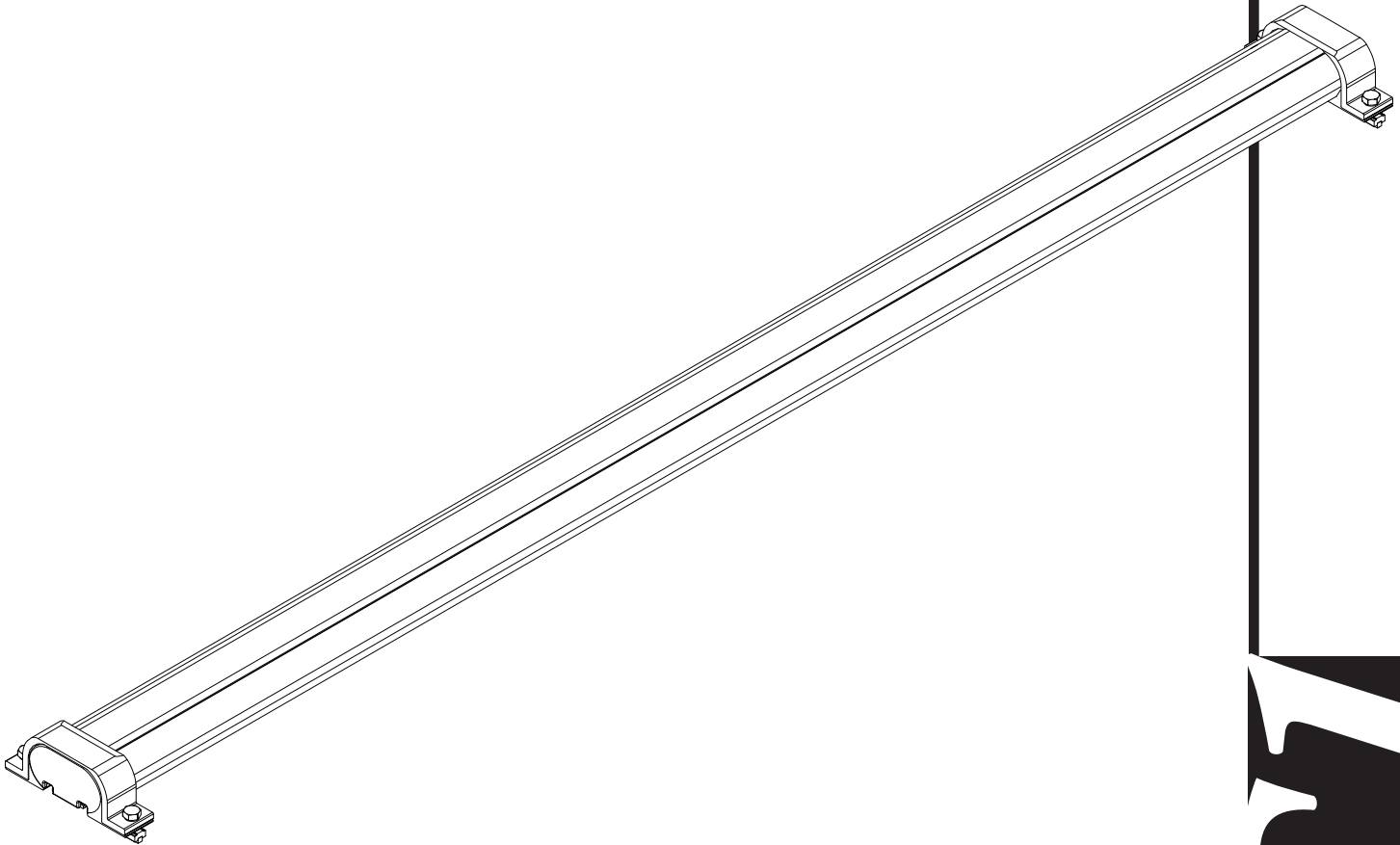

PTR

PRIME DESIGN, A SAFE FLEET BRAND

Address: 580 Opperman Drive, Eagan, MN 55123 • Toll Free: 1.8.PRIME.RACK
Fax: 651-552-1799 • Email: info@primedesign.net • Website: www.primedesign.net

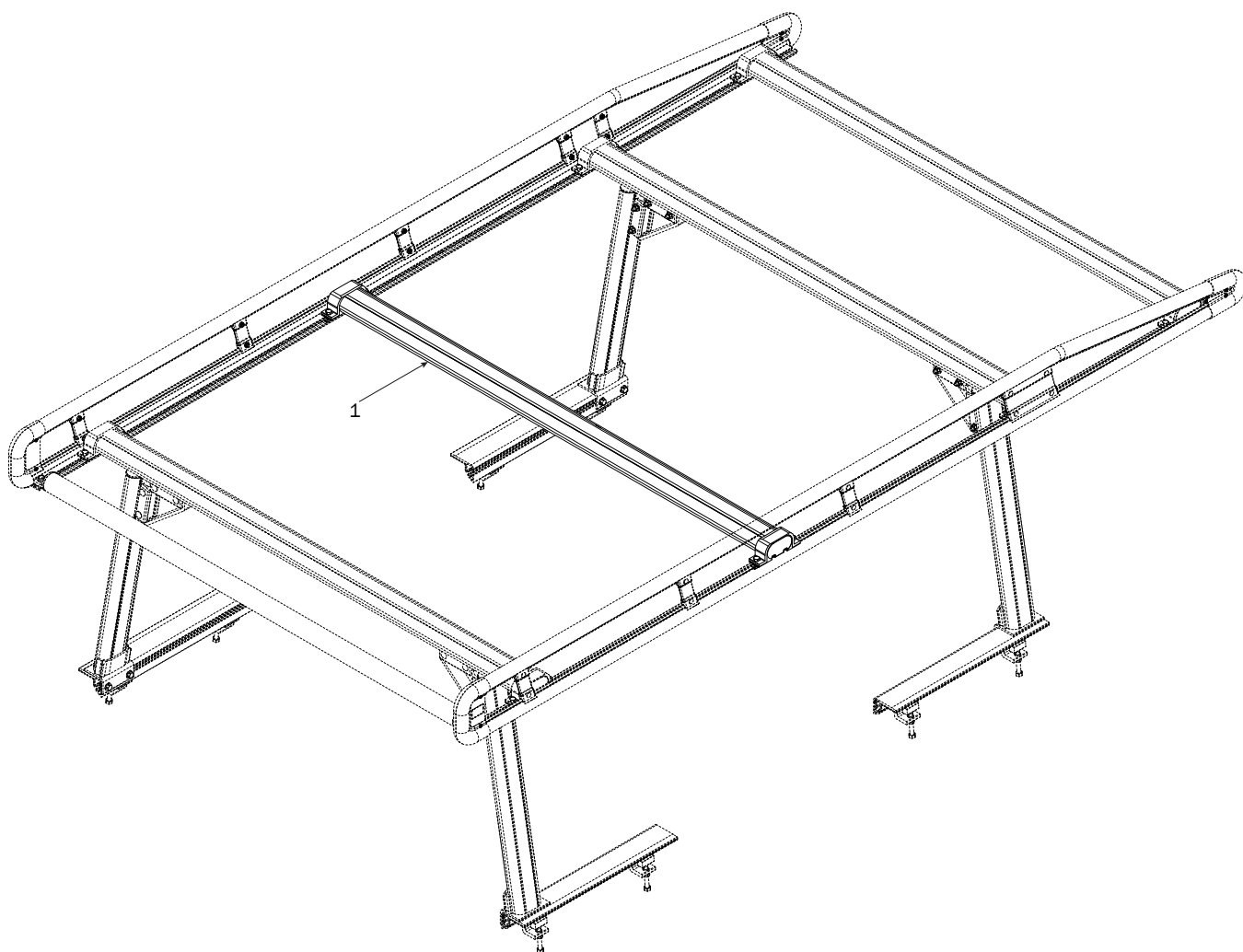

1—Add-On Crossbar (Qty 1)
Mid Size, 57.00" with Mounting Brackets

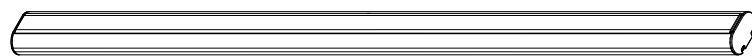

57" Crossbar (1X)

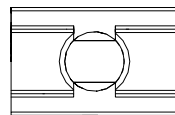

M8 Strip Nut (4X)

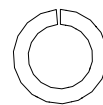

M8 Lock Washer (4X)

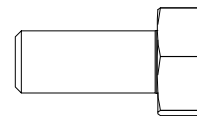

M8 Hex Head Bolt (4X)



Bracket Wedge (4X)



Mounting Bracket (2X)

PTR-C1 ADD-ON CROSSBAR ASSEMBLY SEQUENCE

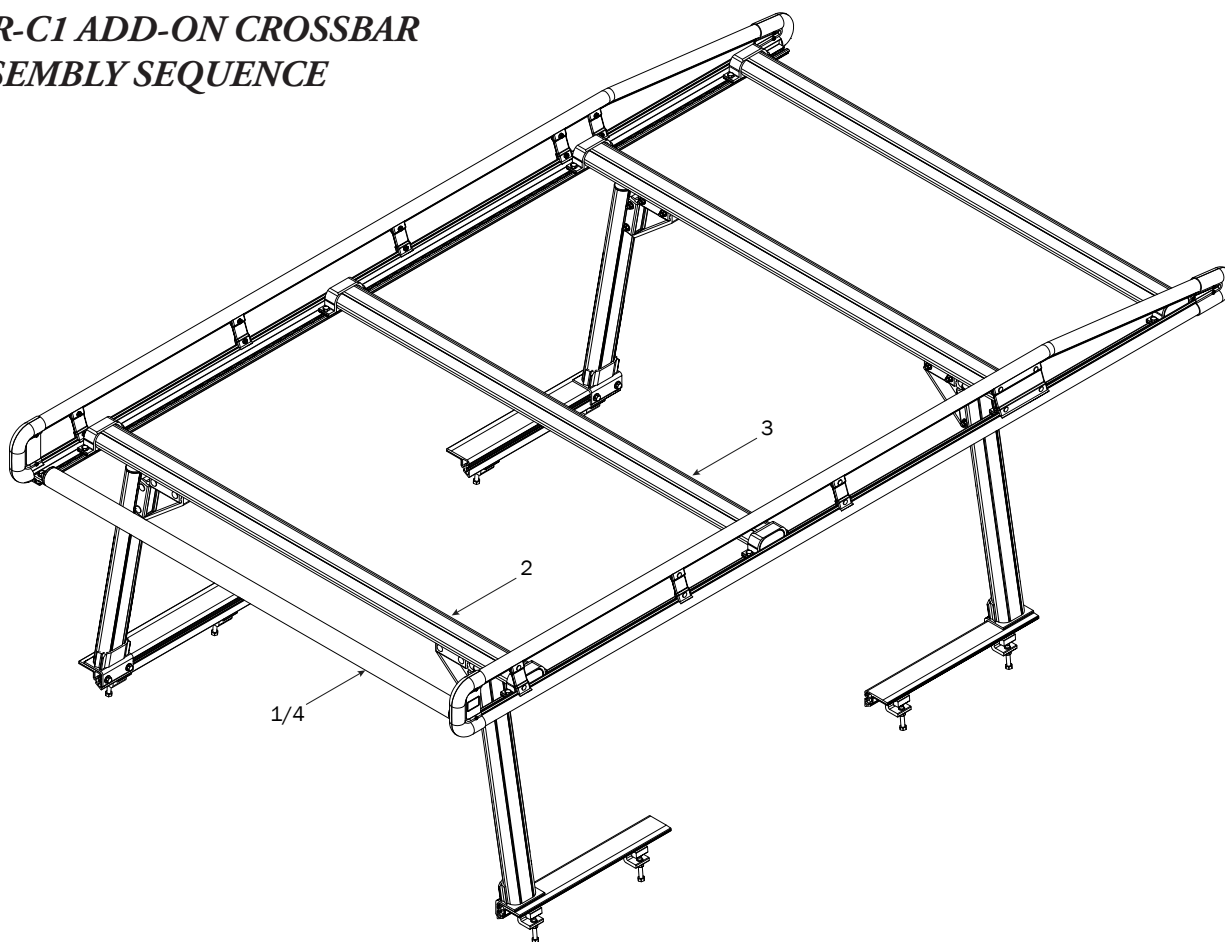

ROLLER ASSEMBLY REMOVAL

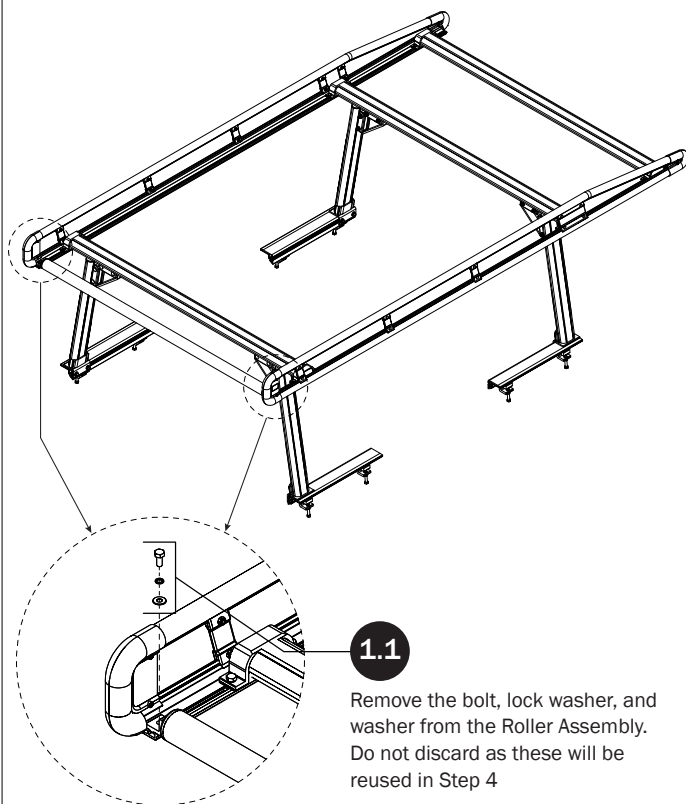

1.1

Remove the bolt, lock washer, and washer from the Roller Assembly. Do not discard as these will be reused in Step 4

1.2

Remove and set aside the Roller Assembly making sure to retain the pins, spring, and brackets. This assembly is to be reused, and will be reinstalled in Step 4.

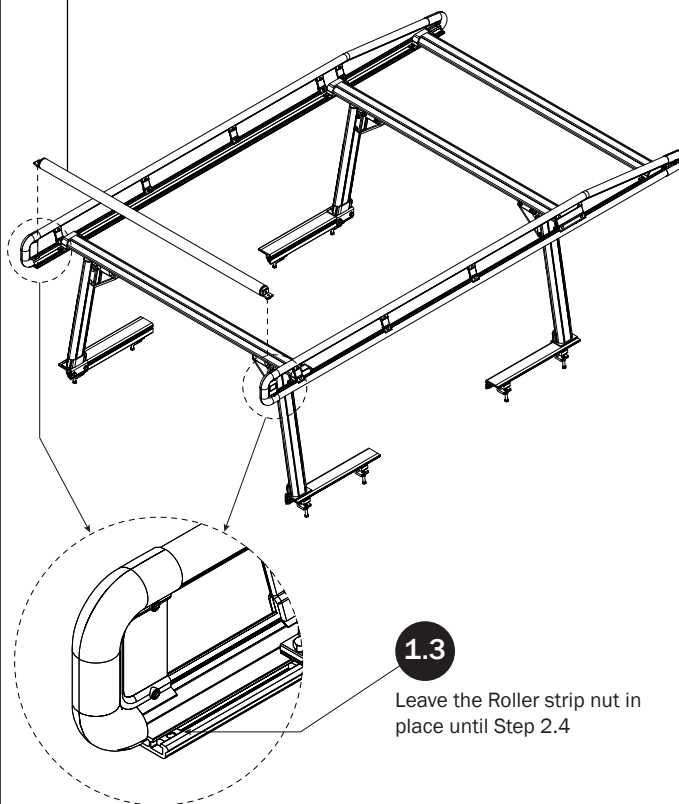

1.3

Leave the Roller strip nut in place until Step 2.4

PTR LEFT SIDE RAIL CROSSBAR CLAMP

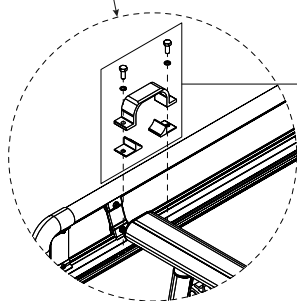
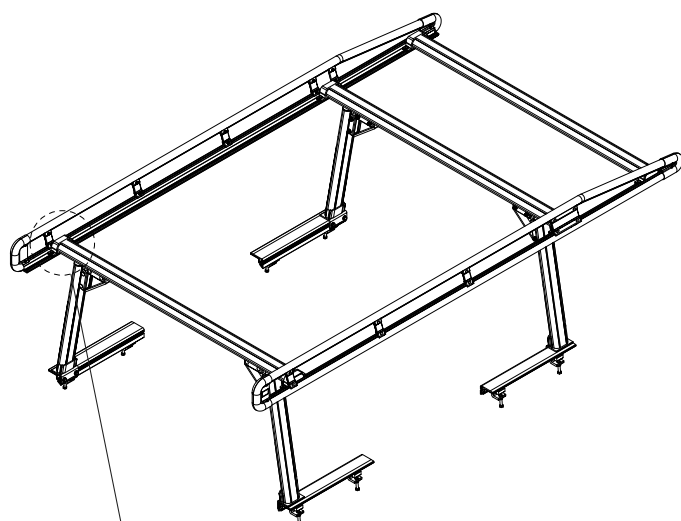

2.1

Remove the Crossbar Hanger Clamp Assembly as shown. Leave the Mounting Bracket Strip Nuts in place for the next step. Retain all Clamp parts and hardware for reinstallation during Step 2.6.

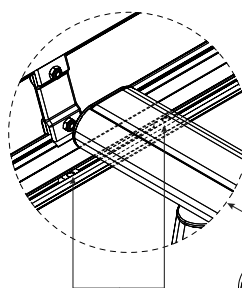

2.2

Slide both Crossbar Hanger Strip Nuts forward as shown.

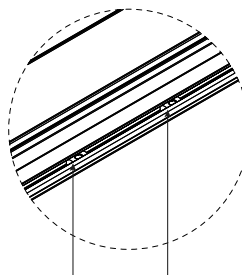

2.3

Leave Strip Nuts in place until Step 3.1.

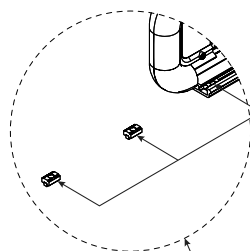

2.4

Place the new Strip Nuts into the end of the Side Rail as shown, and slide the Roller Assembly Strip Nut slightly forward of the Crossbar in the side rail.

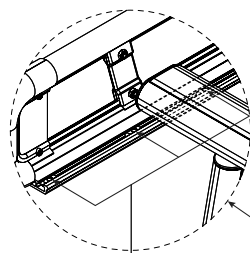

2.5

Position all the Strip Nuts on the Side Rail as shown.

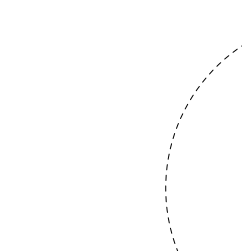

2.6

Assemble Crossbar Hanger Clamp as shown, then torque the Crossbar Clamp nuts to 90 in-lbs.

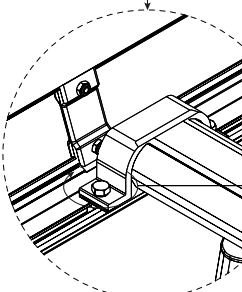

2.7

Repeat Steps 2.1–2.6 for Right Side Crossbar Add-On.

3.1

Place the PTR Add-On Crossbar between the Side Rails in any preferred position. Attach the Crossbar Hanger Clamps leaving the bolts loose until Step 3.3.

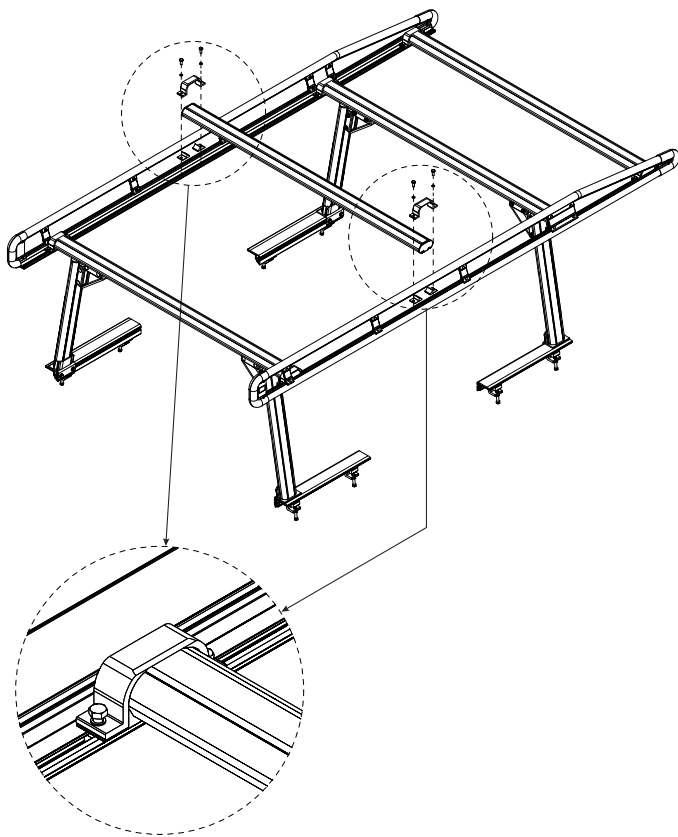

3.2

Position the Add-On Crossbar in any preferred position. Evenly set the distances to assure the new Crossbar is parallel to the other Crossbars and perpendicular to the Side Rails.

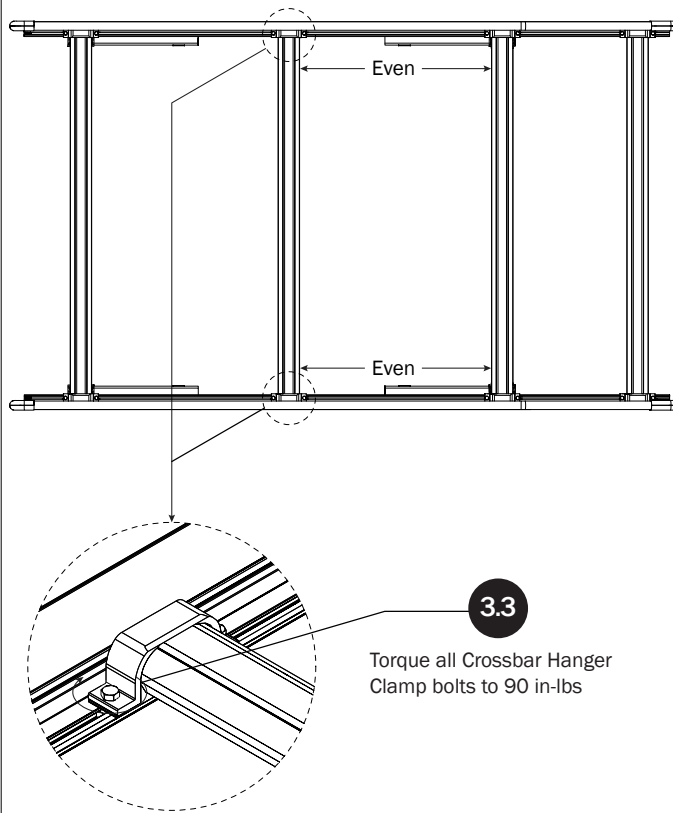

3.3

Torque all Crossbar Hanger Clamp bolts to 90 in-lbs

4

Position Roller Assembly flush to rear of Side Rails, and torque Roller bolts to 90 in-lbs.

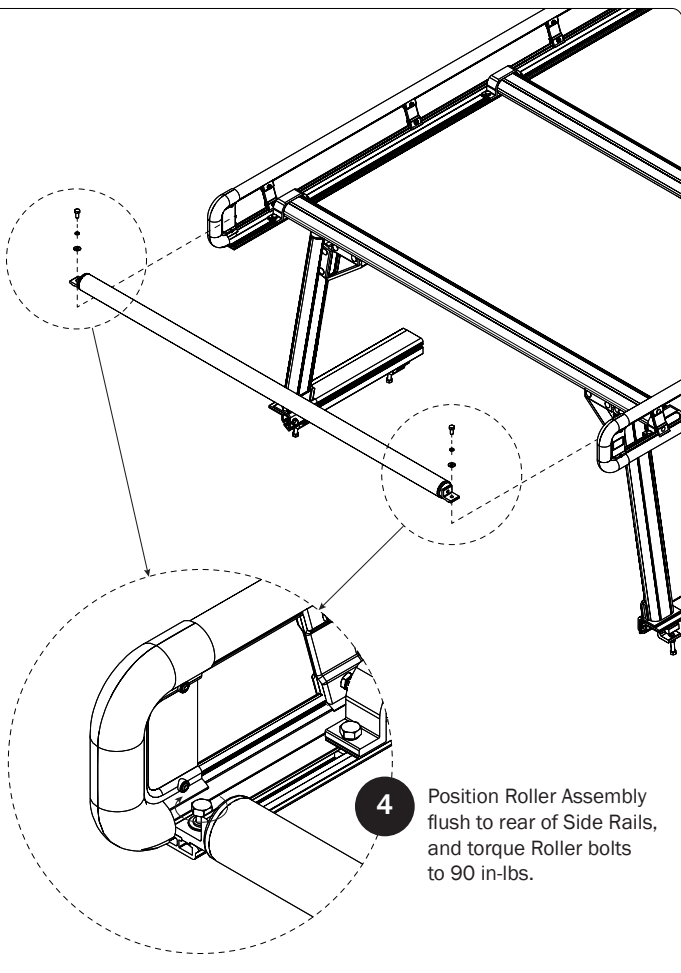

Page Intentionally Left Blank

Page Intentionally Left Blank

