

PRIME DESIGN™

A Safe Fleet Brand

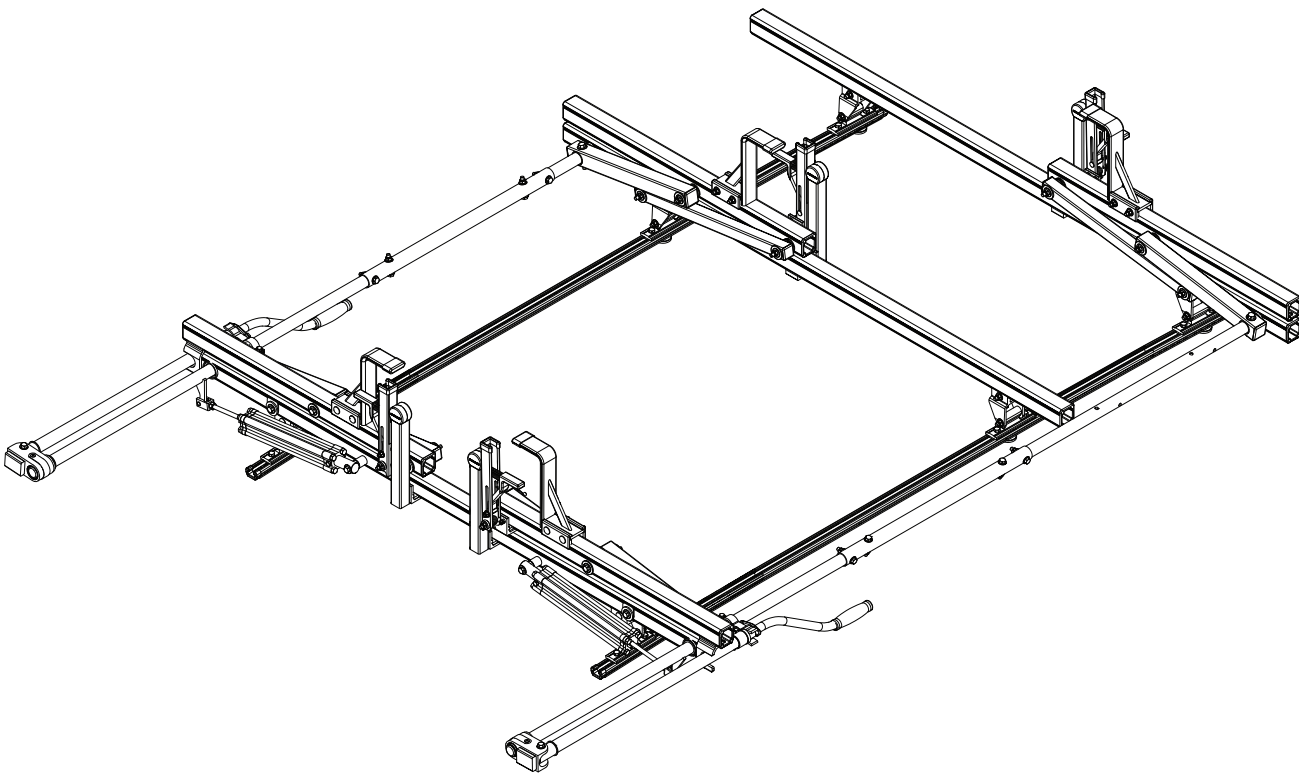

VRR3
CH1B

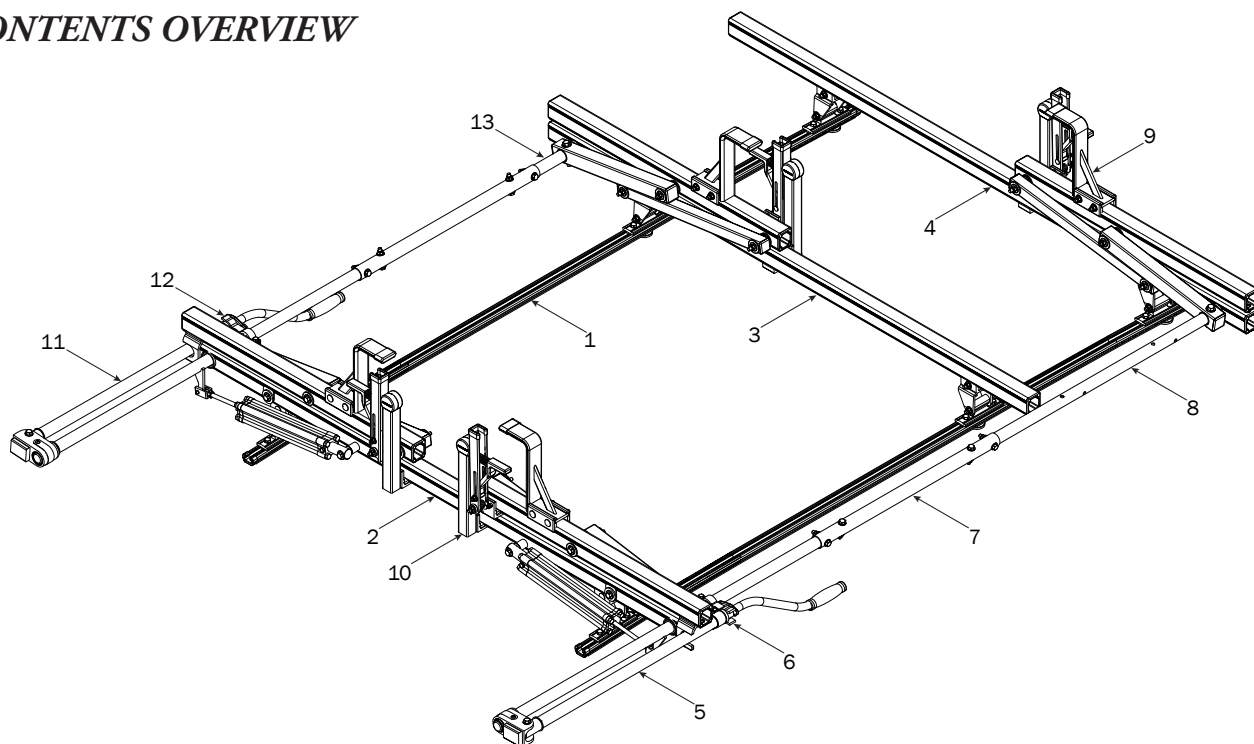

1—FBM3-0045 (Qty 1)

Channels w/Hardware

Channels (2X)



End Caps (4X)

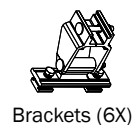

Brackets (6X)

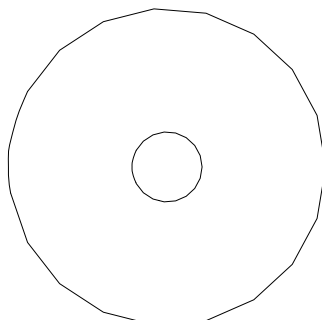

Nylon Washer (6X)

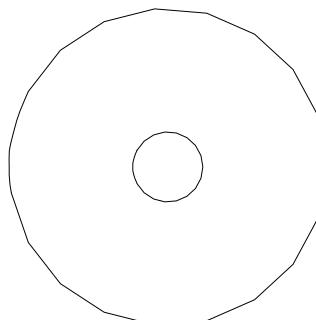

Foam Gasket (6X)

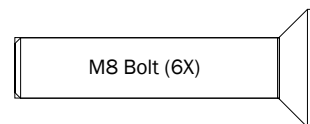

M8 Bolt (6X)

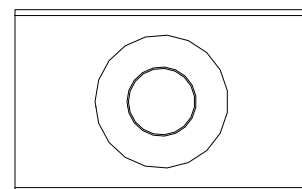

Flex Channel Connector (6X)

2—Rear Crossbar Assembly (Qty 1)

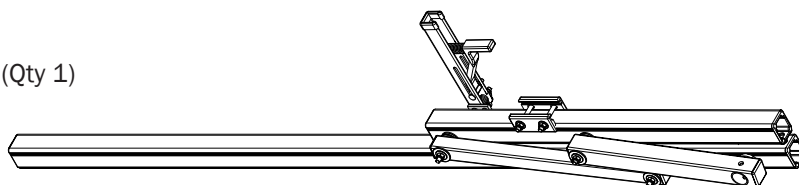

3—Center Crossbar Assembly (Qty 1)

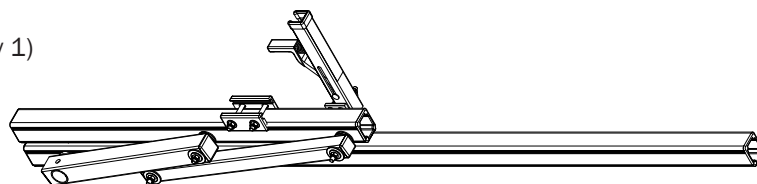

4—Front Crossbar Assembly (Qty 1)

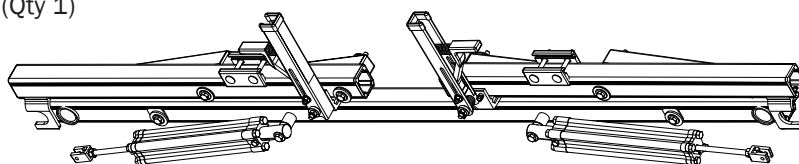

5—Rear Drive Shaft..... (Qty 1)
RH, B4 Version, 46.00"

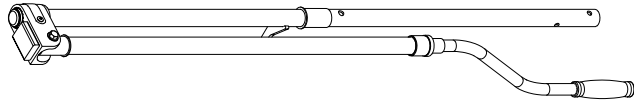

6—Handle Latch Assembly (Qty 1)
Right Hand



7—Connecting Bar..... (Qty 2)
24.00"

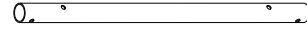

8—Front Drive Shaft..... (Qty 1)
B Version, 35.75"

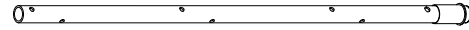

9—Z Post..... (Qty 4)
Adjustable, 7.25"

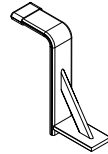

10—L Post..... (Qty 4)
Gen2, Roller Cap , 9.25"



11—Rear Drive Shaft..... (Qty 1)
LH, B4 Version, 46.00"

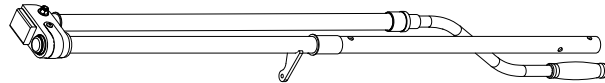

12—Handle Latch Assembly (Qty 1)
Left Hand



13—Front Drive Shaft..... (Qty 1)
B Version, 11.75"

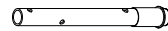

14—HKT-8163-Rotation Hardware Kit (Qty 2)
(Not called out in Overview)

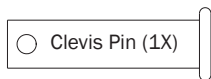

Clevis Pin (1X)

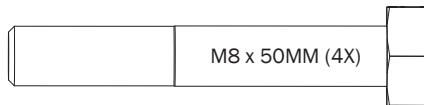

M8 x 50MM (4X)

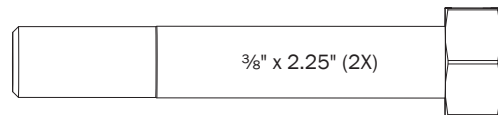

3/8" x 2.25" (2X)

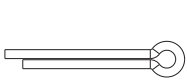

Cotter Pin (1X)

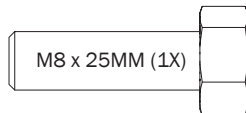

M8 x 25MM (1X)

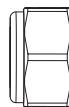

M8 Lock Nut (5X)

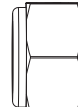

3/8" Lock Nut (2X)

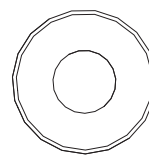

5/16" Flat Washer (10X)

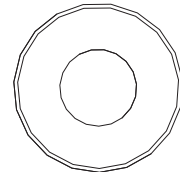

3/8" Flat Washer (4X)

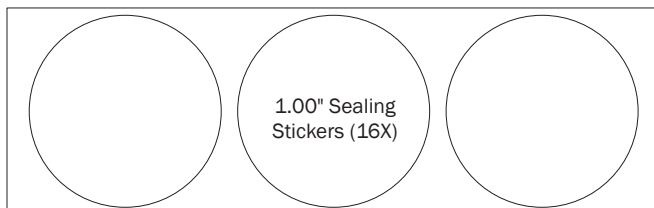

1.00" Sealing
Stickers (16X)



Anti-Seize (1X)

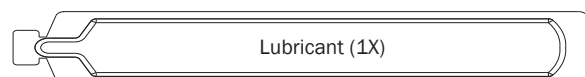

Lubricant (1X)

FBM3-0045
CHANNELS TO ROOF

- 0.1**
- Position Channels as shown below in Fig.1

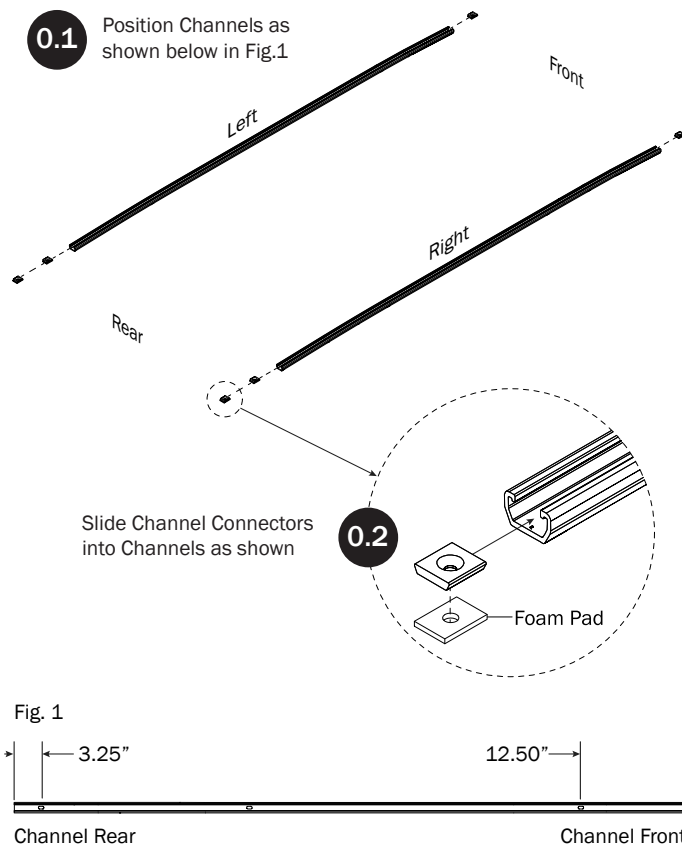

- 0.3**
- Install Channels into roof Channel groove as shown

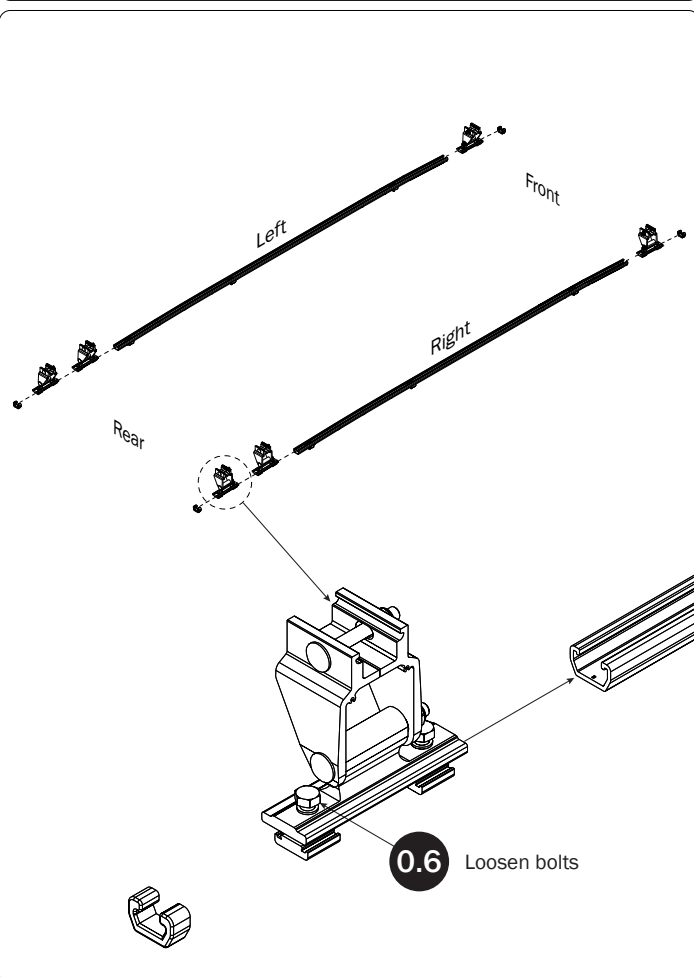
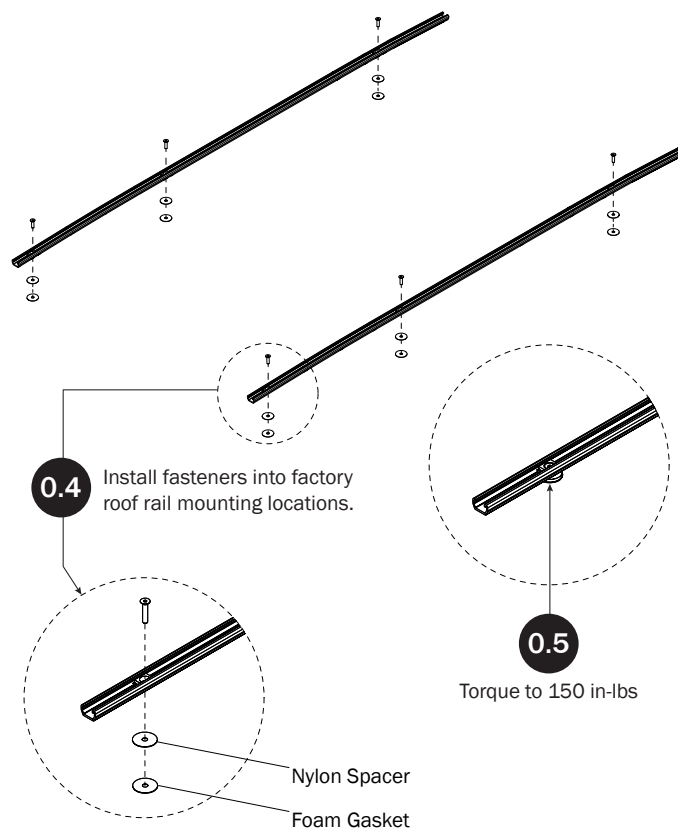

- 0.7**
- Set to distances then torque Rear Bracket nuts to 90 in-lbs

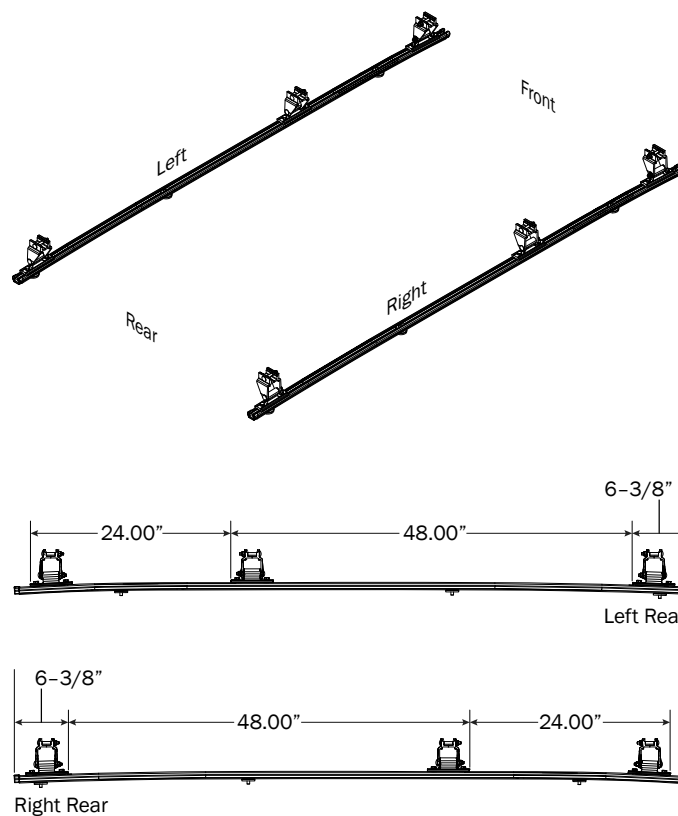

RIGHT ROTATION ASSEMBLY SEQUENCE

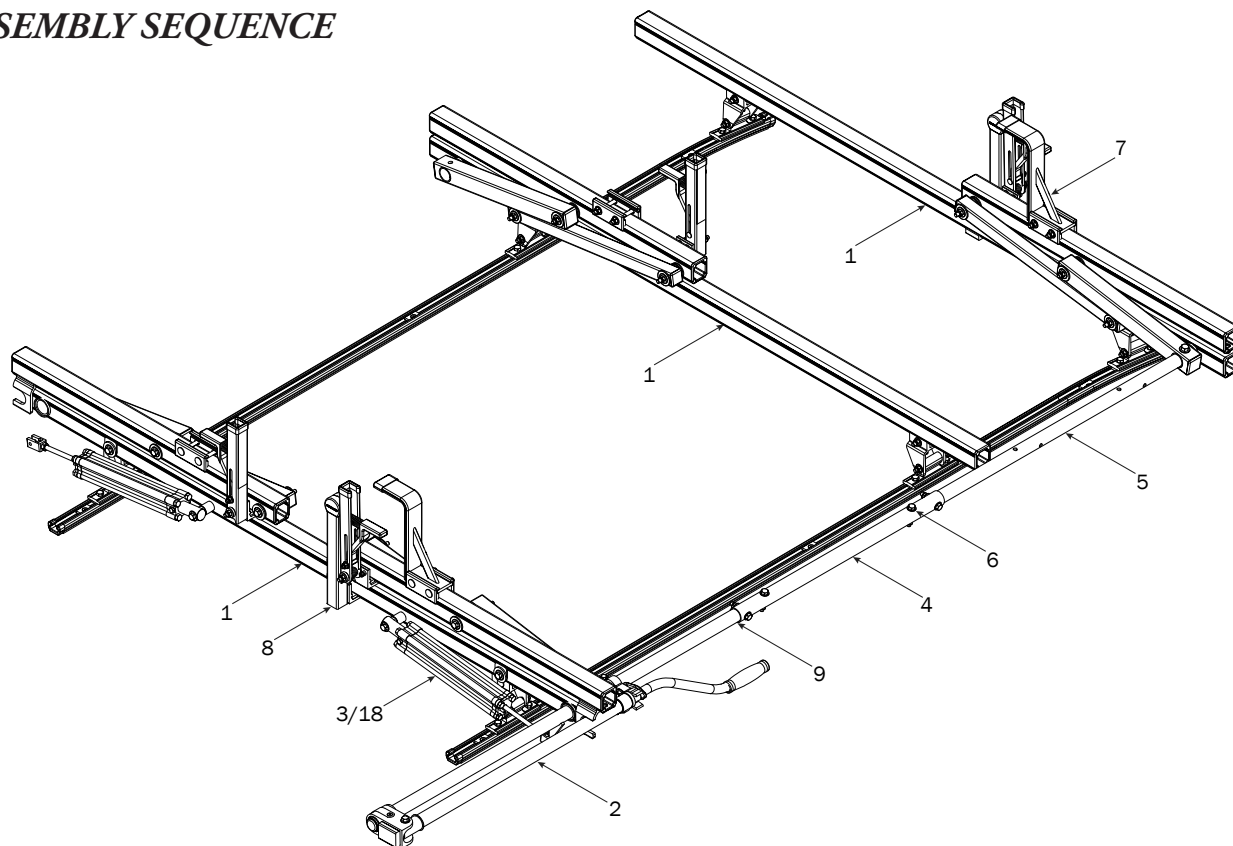

CROSSBARS

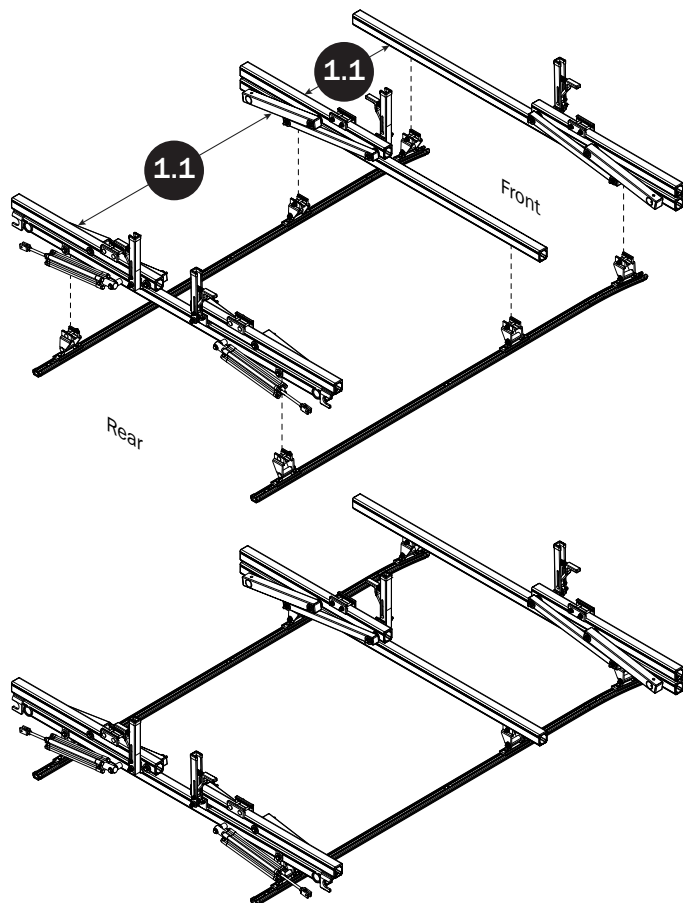

CROSSBAR ADJUSTMENT

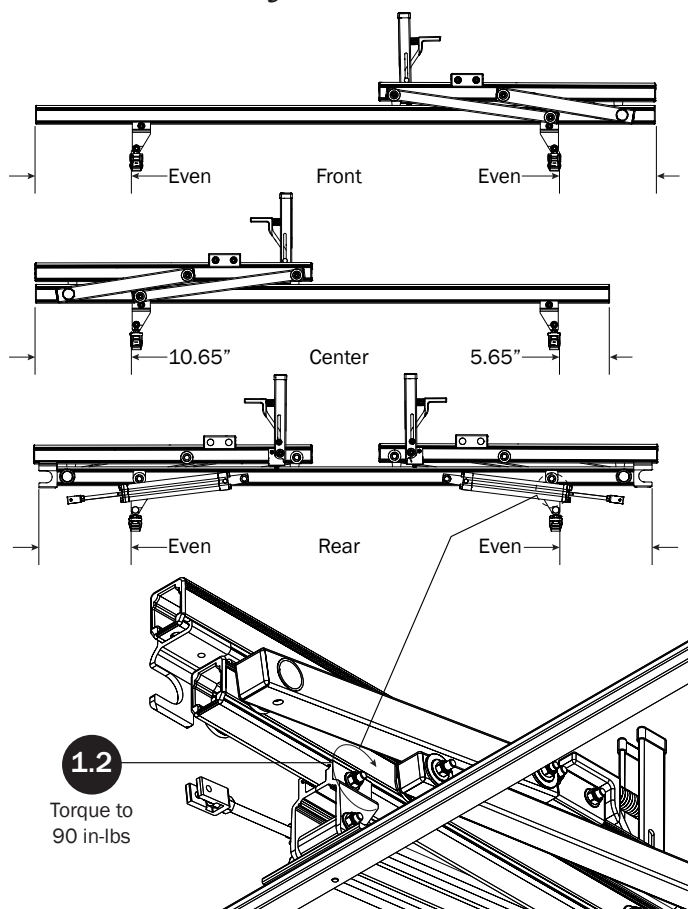

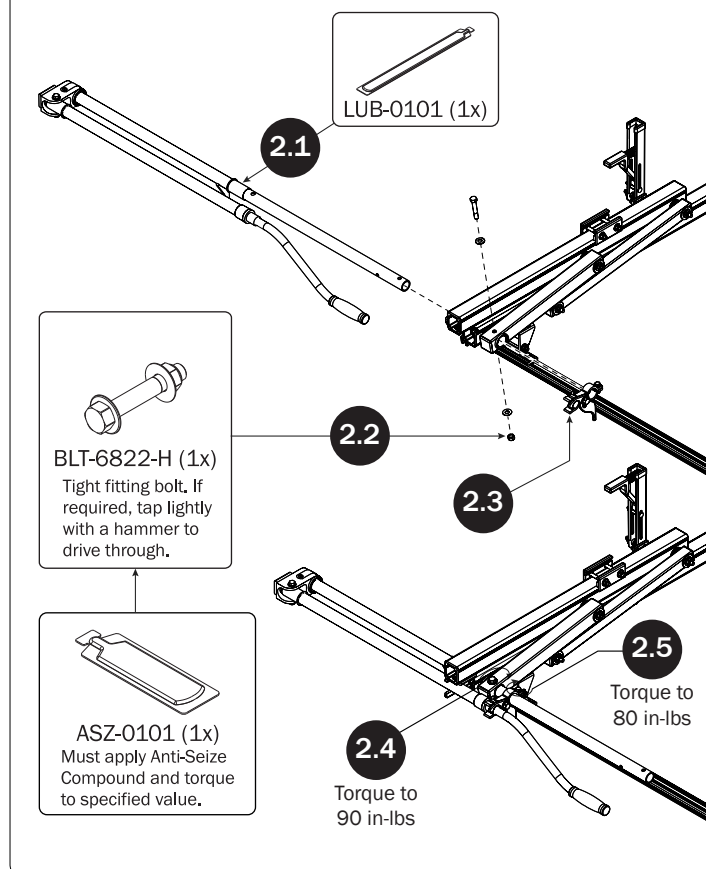
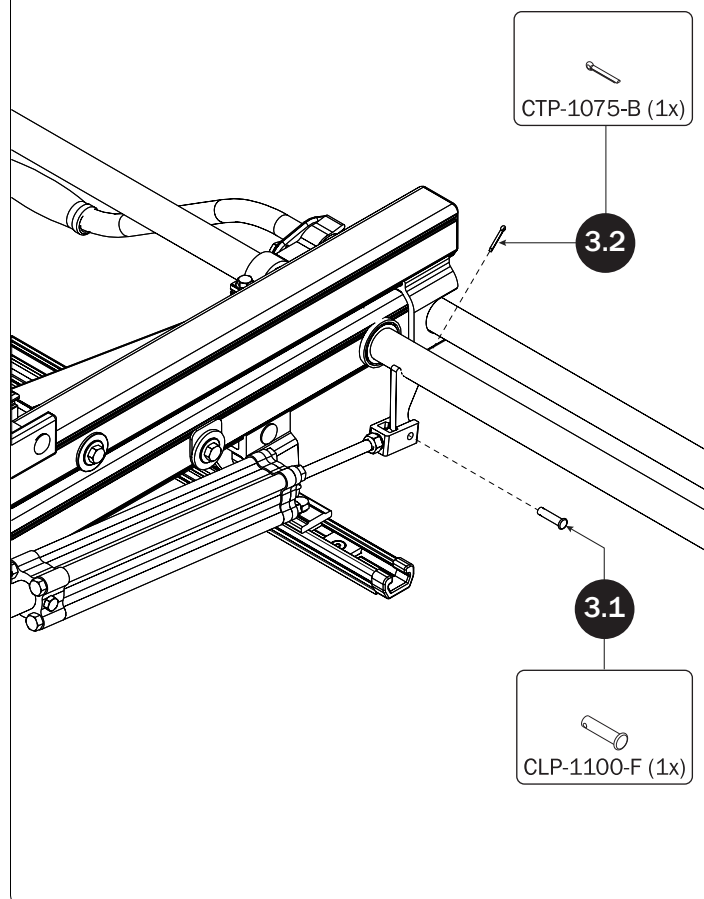
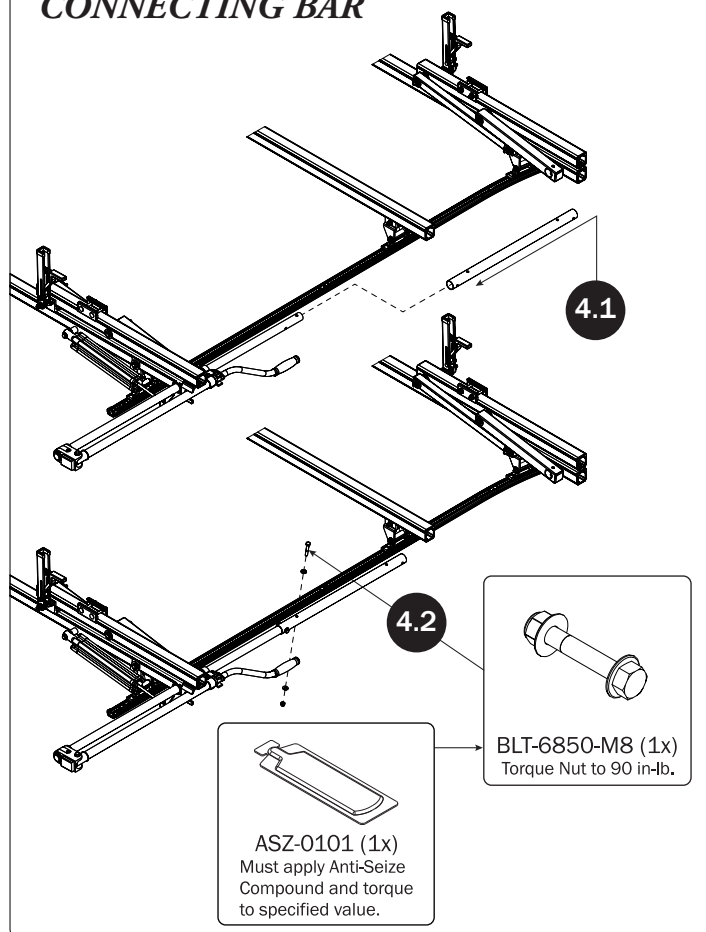
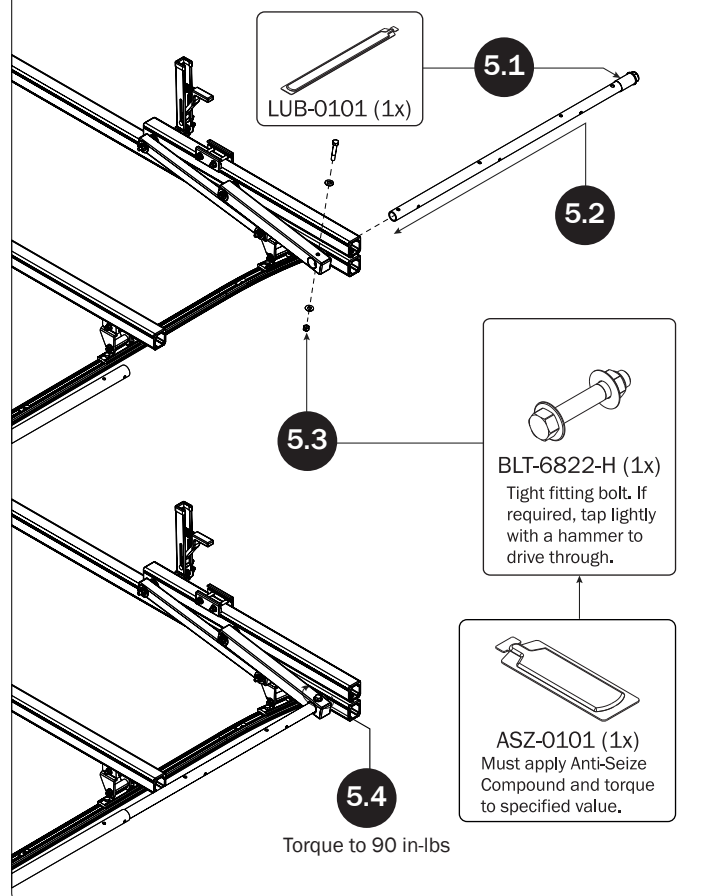
REAR DRIVE SHAFT**CYLINDER HARDWARE****CONNECTING BAR****FRONT DRIVE SHAFT**

CONNECTING BAR FASTENERS

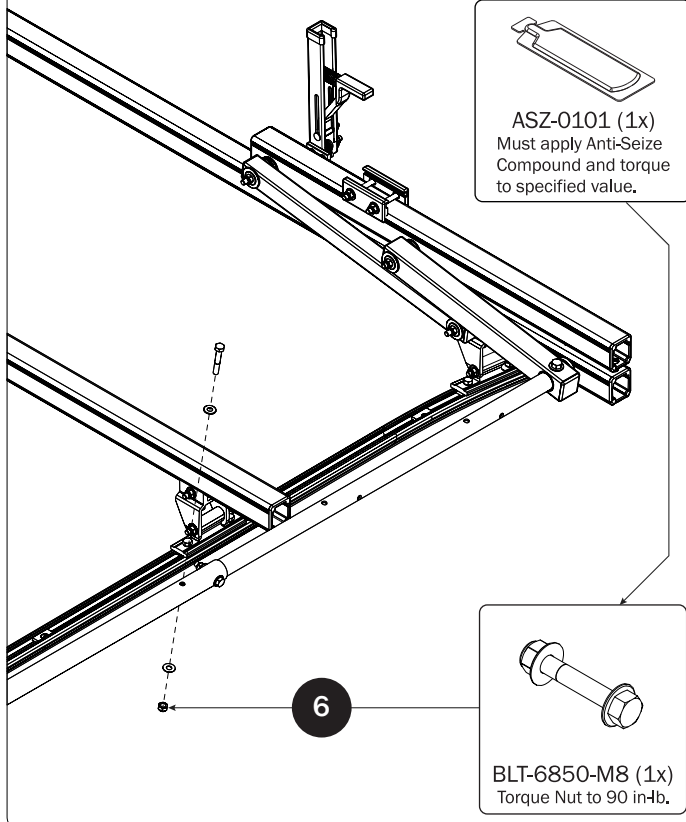

Z POSTS

SEE QUICK START GUIDE FOR ADJUSTMENTS

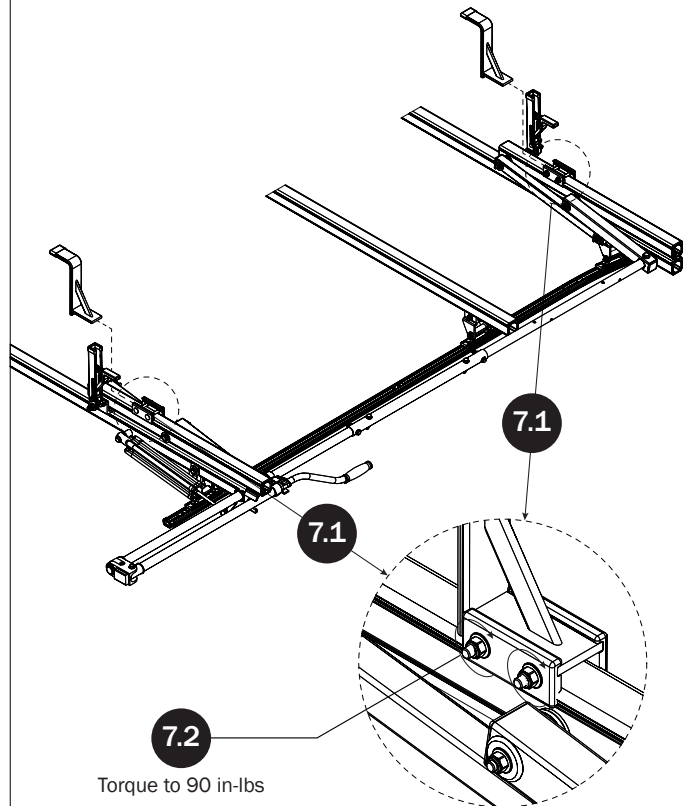

L POSTS

SEE QUICK START GUIDE FOR ADJUSTMENTS

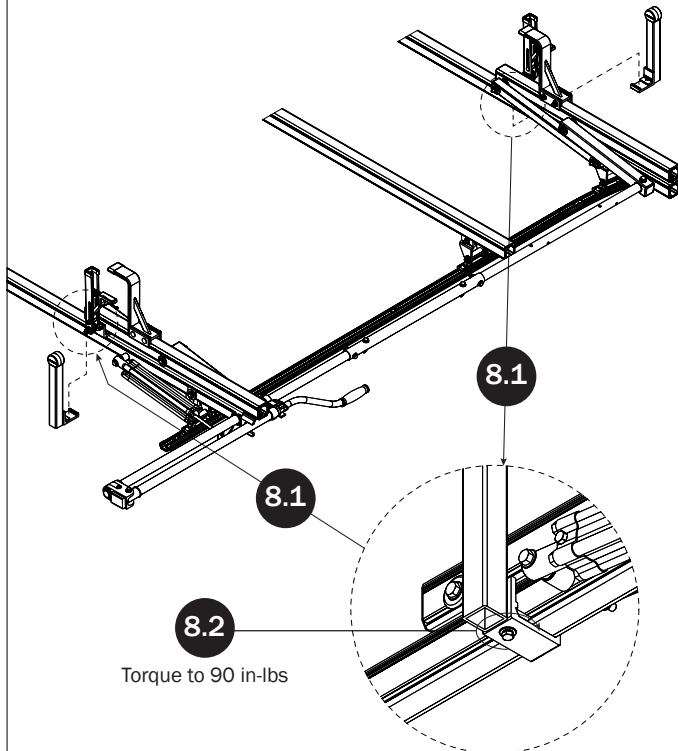

DRIVE SHAFT SEALING

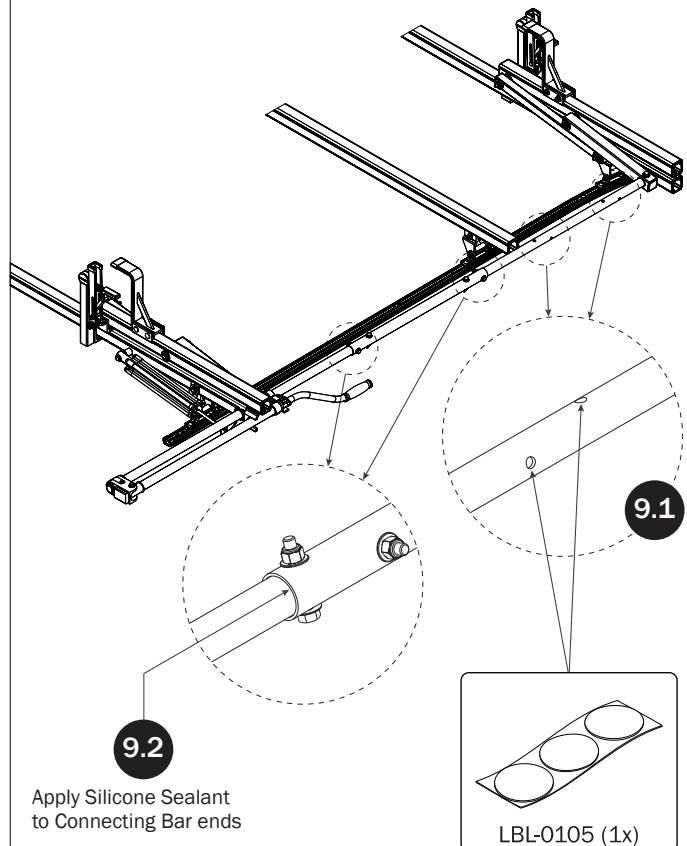

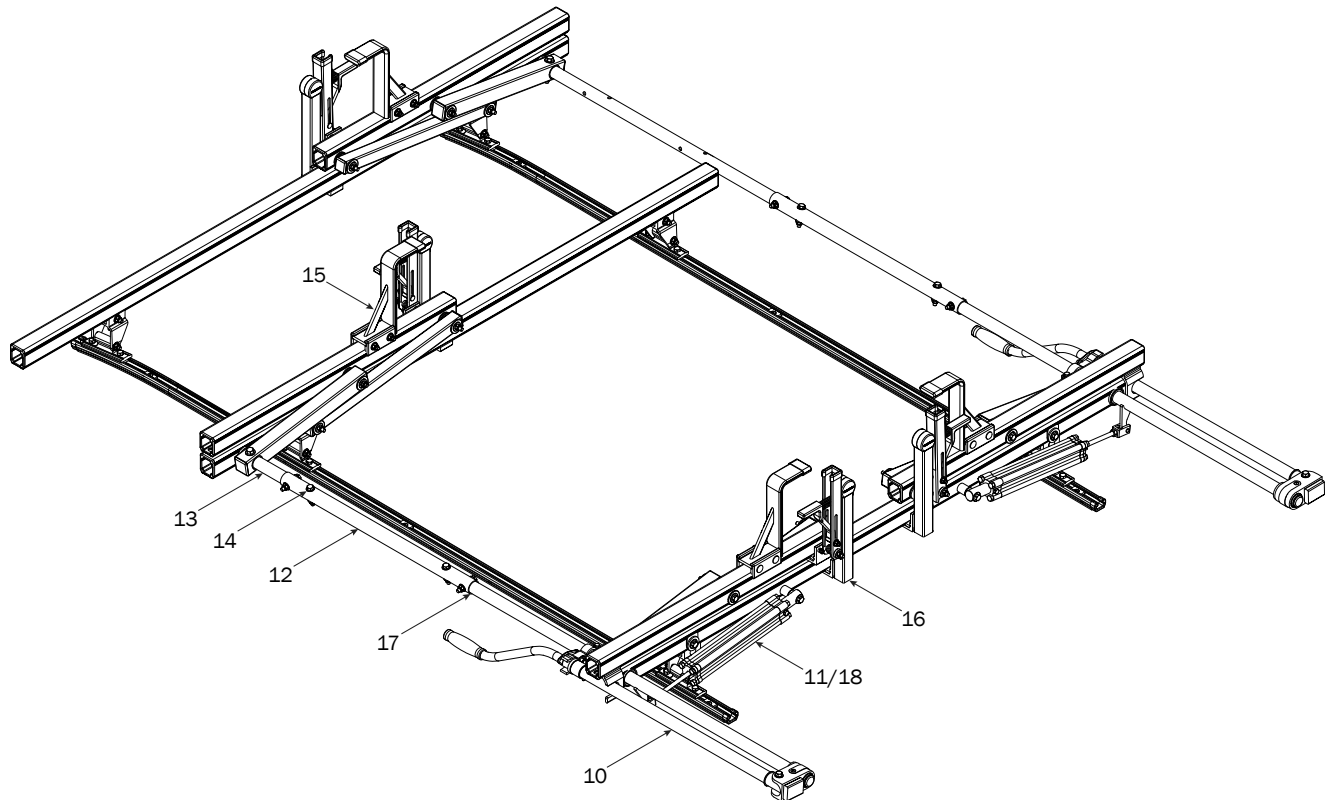
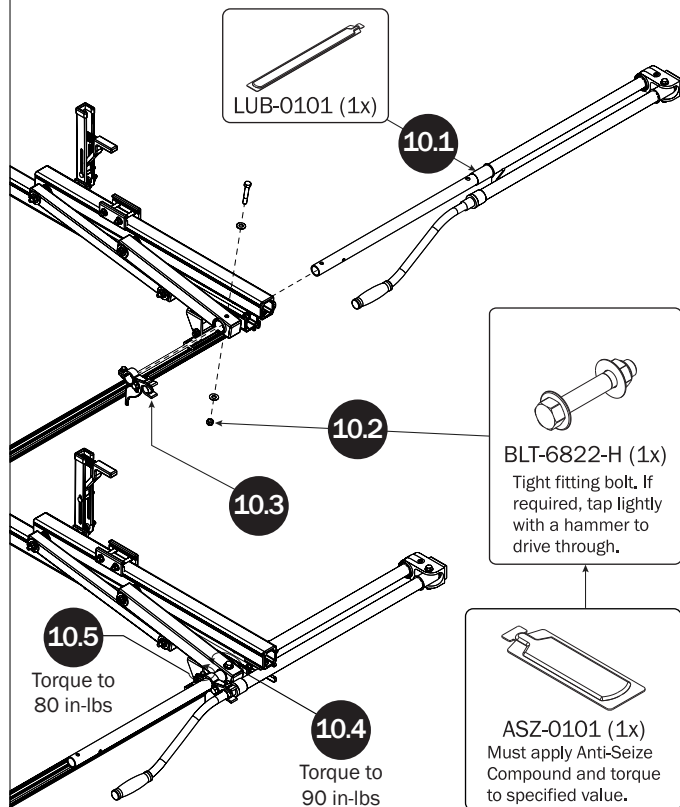
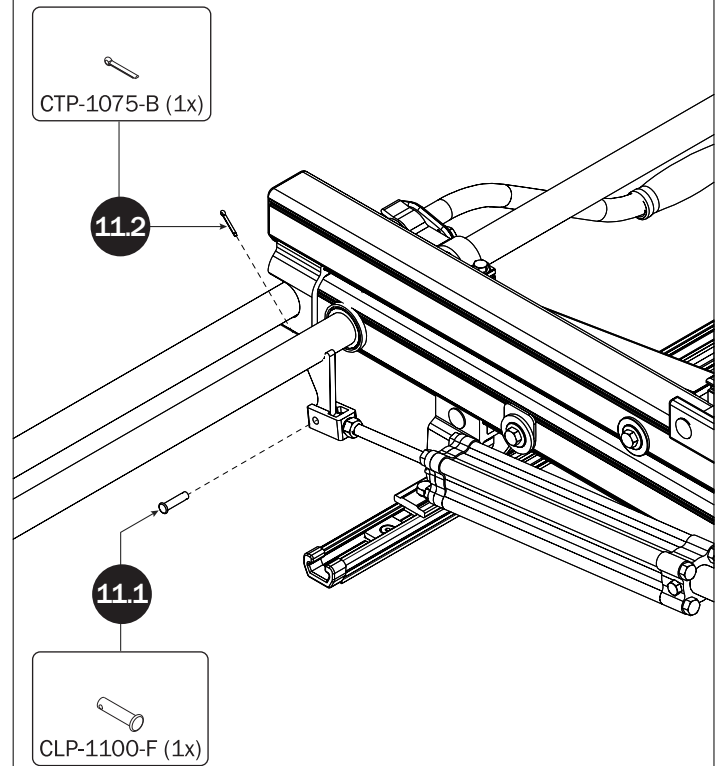
LEFT ROTATION ASSEMBLY SEQUENCE**REAR DRIVE SHAFT****CYLINDER HARDWARE**

CONNECTING BAR

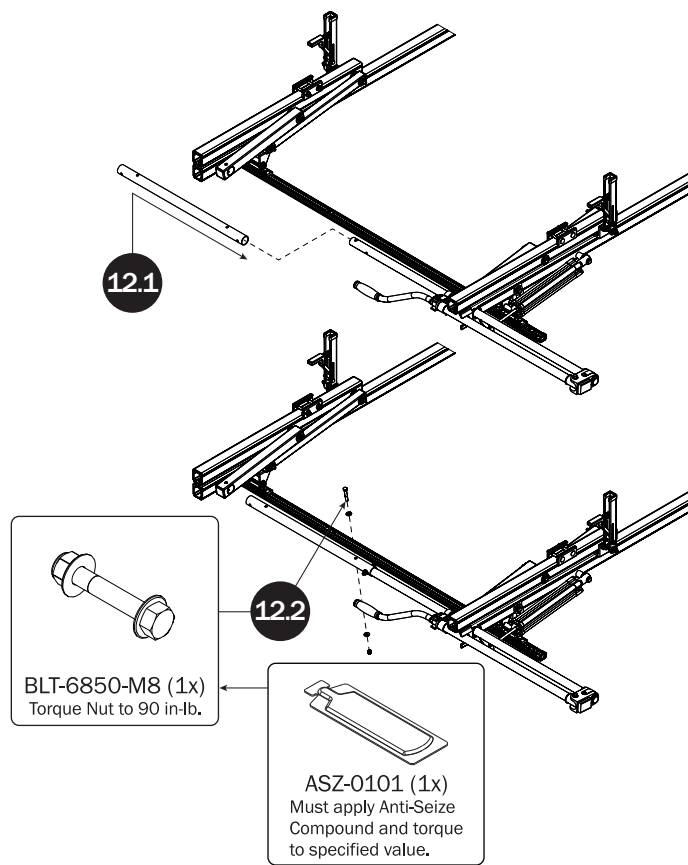

FRONT DRIVE SHAFT

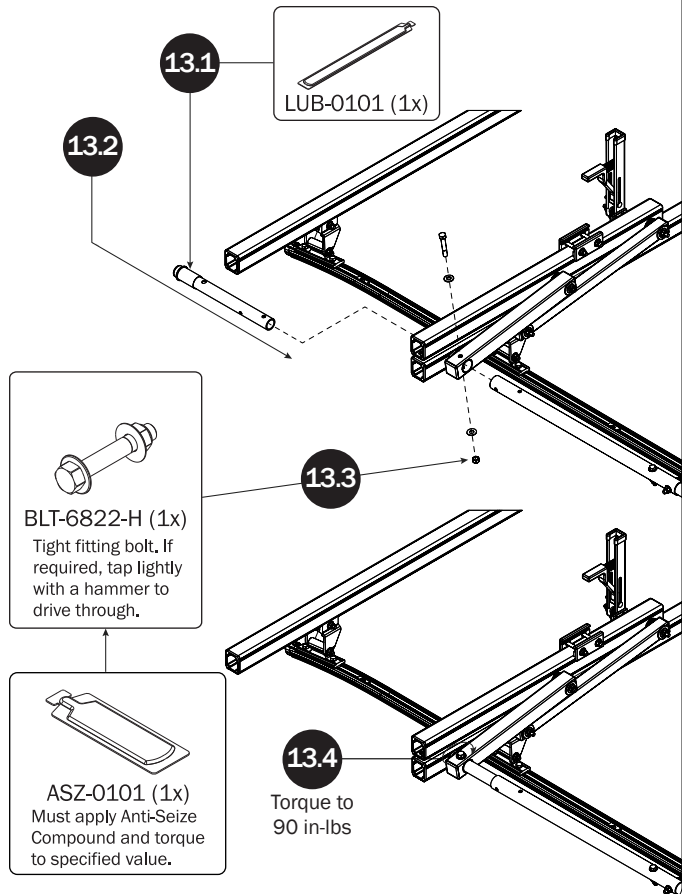

CONNECTING BAR FASTENERS

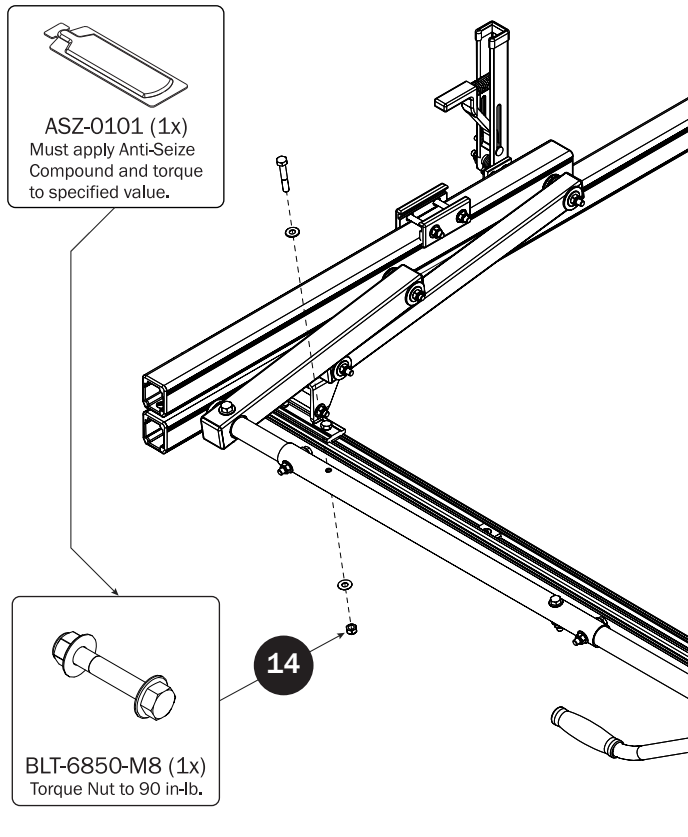

Z POSTS

SEE QUICK START GUIDE FOR ADJUSTMENTS

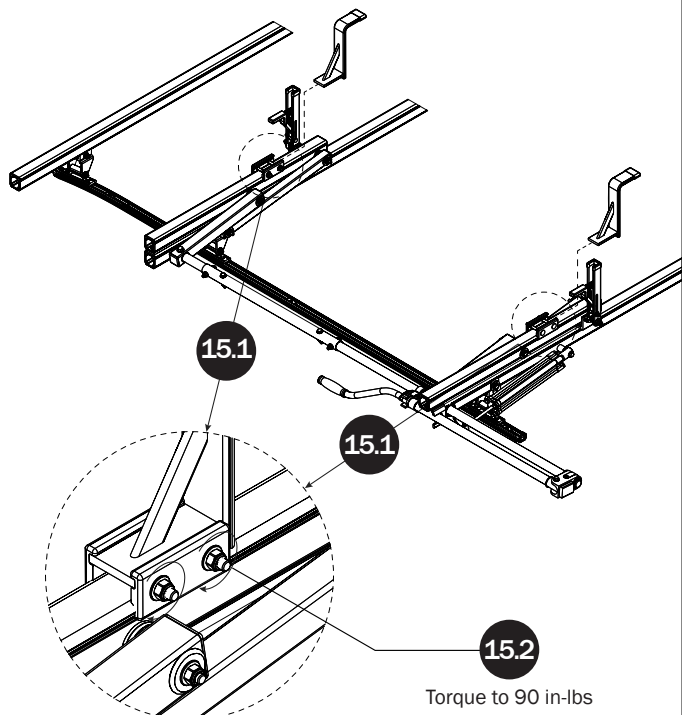

L POSTS

SEE QUICK START GUIDE FOR ADJUSTMENTS

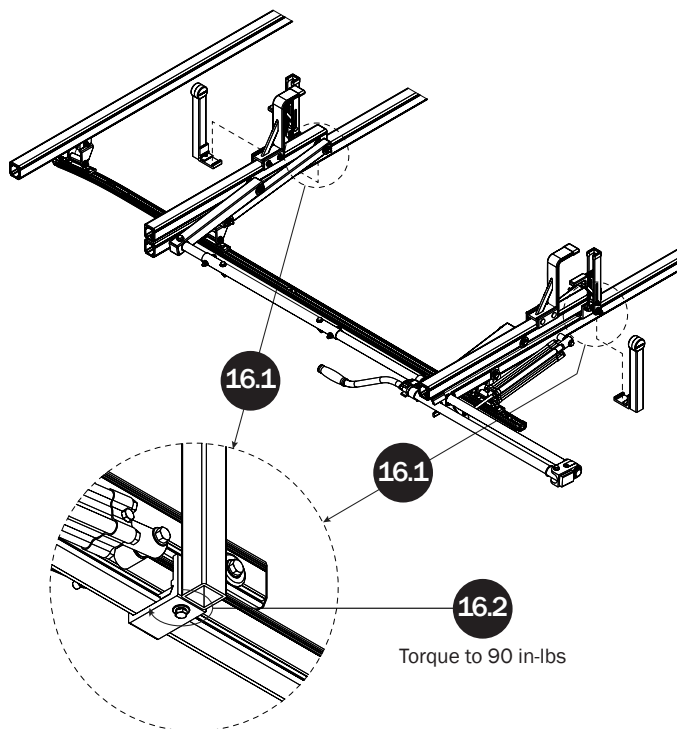
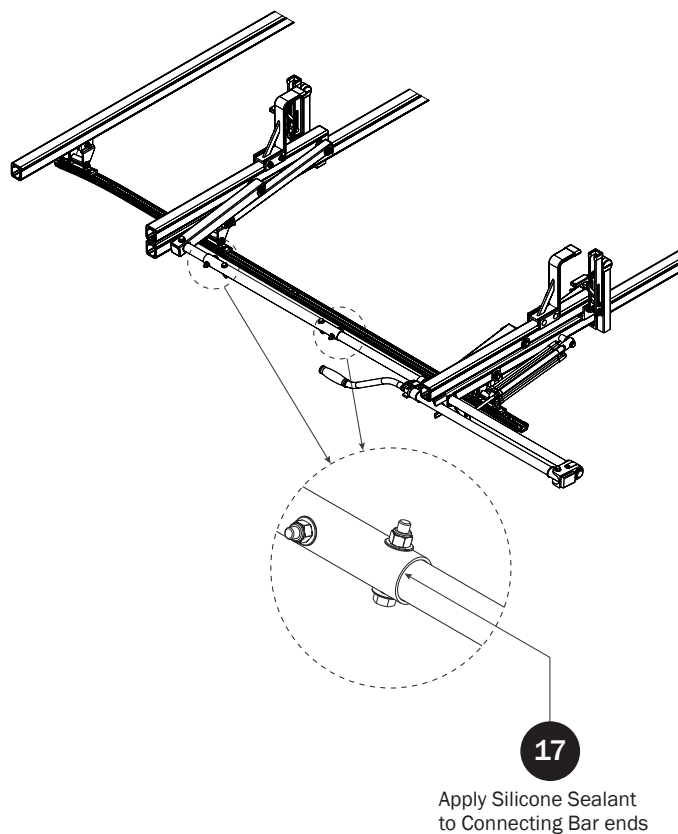
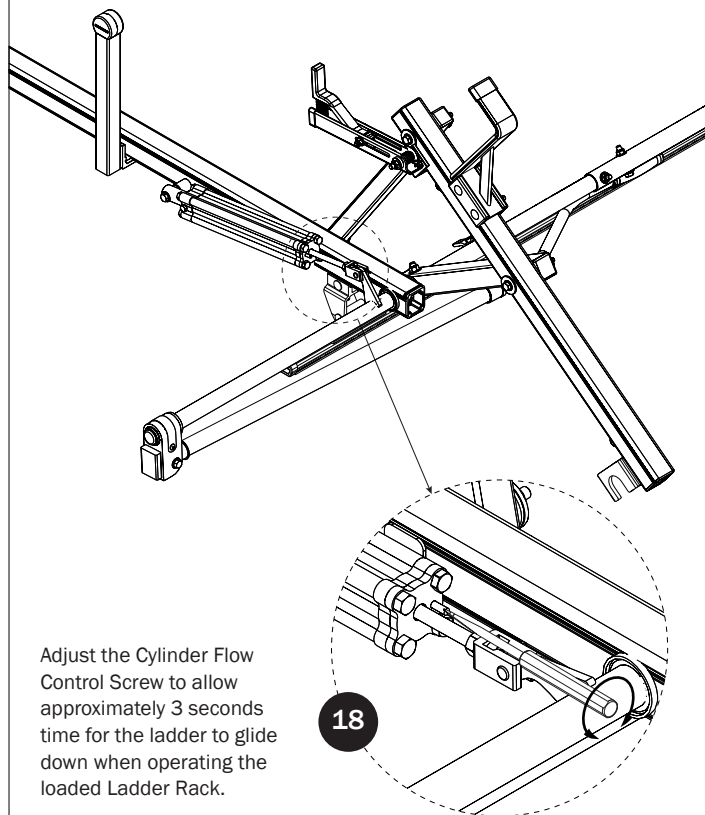
**DRIVE SHAFT SEALING****CYLINDER ADJUSTMENT**

Adjust the Cylinder Flow Control Screw to allow approximately 3 seconds time for the ladder to glide down when operating the loaded Ladder Rack.

Page Intentionally Left Blank

