

**PRIME DESIGN™**

A Safe Fleet Brand

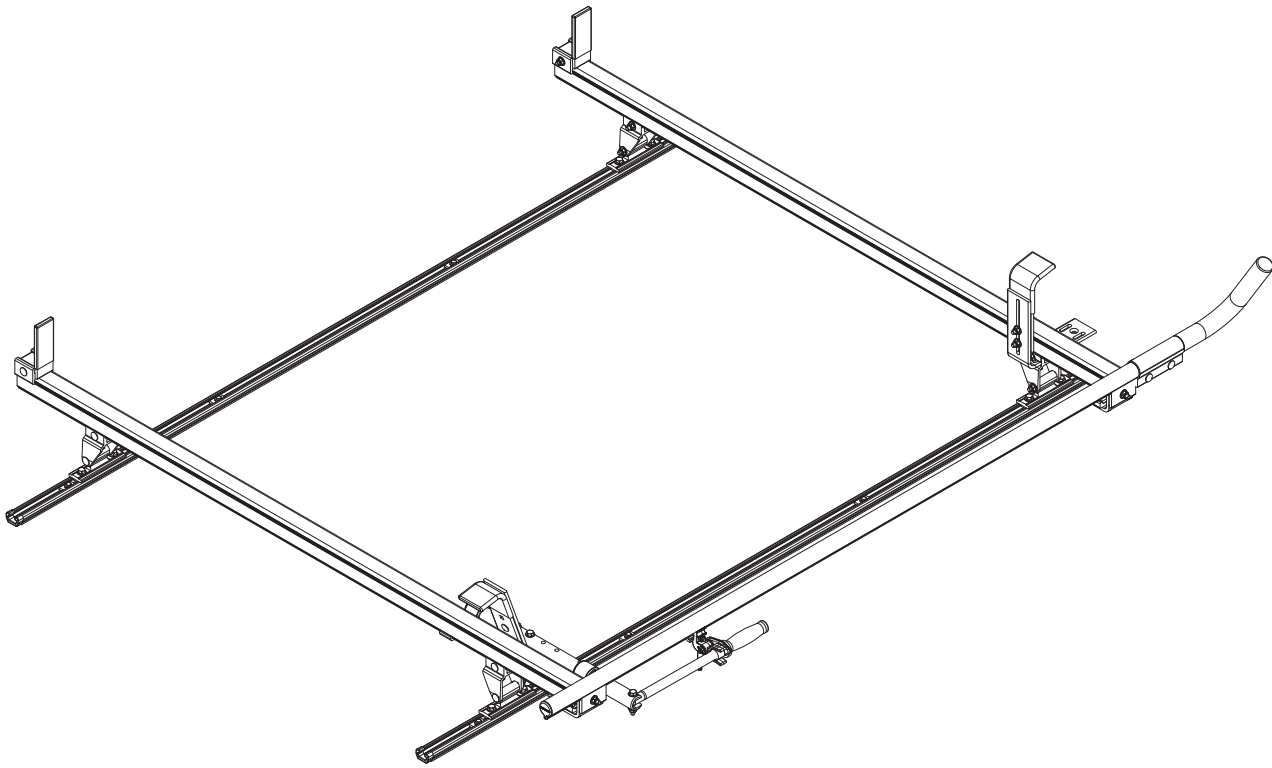

**VBC**  
**RC11B**

## CONTENTS OVERVIEW

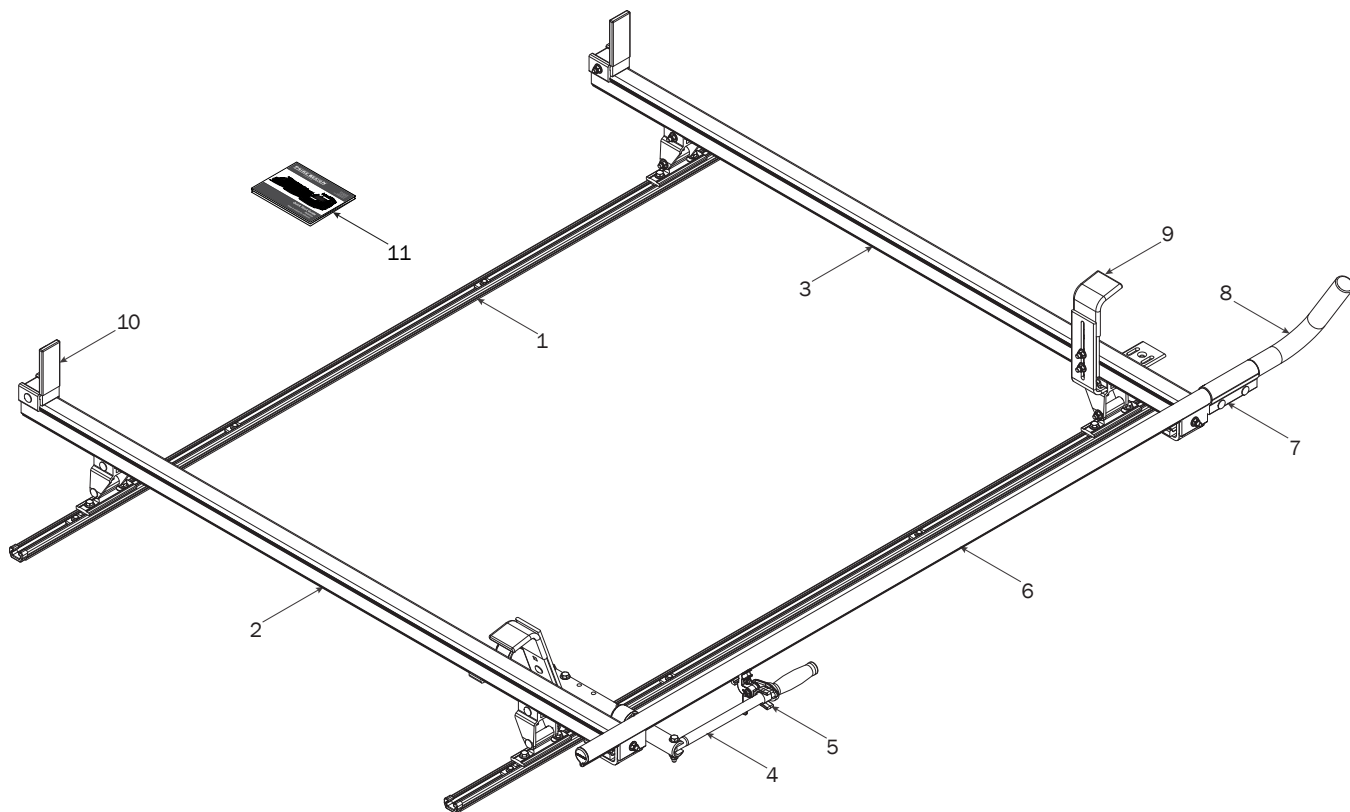

1—FBM-0006 ..... (Qty 1)  
Channels with hardware



M6 Locknut (8X)

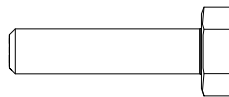

M6 x 30MM Bolt (8X)



End Caps (4X)



Brackets (4X)

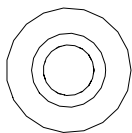

M6 Sealing Washer (8X)

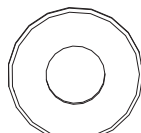

1/4" Flat Washer (8X)

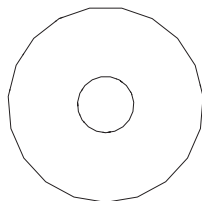

1/4" Washer (8X)

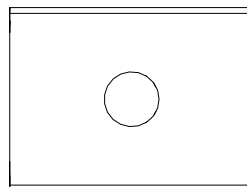

Mounting Plate (8X)

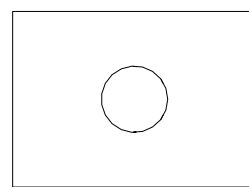

Foam Pad (8X)

2—Rear Crossbar Assembly..... (Qty 1)



3—Front Crossbar Assembly ..... (Qty 1)



4—Handle Latch Assembly ..... (Qty 1)

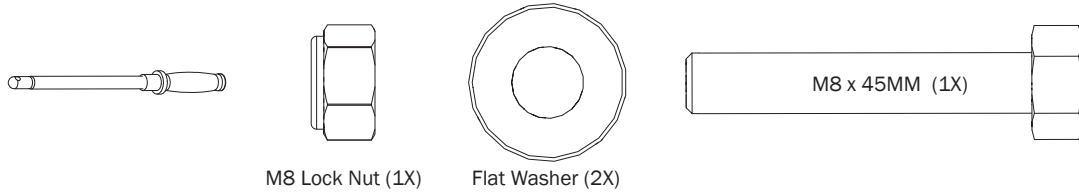
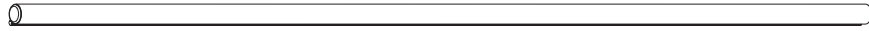
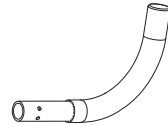

## 5—Clamp Down Handle Assembly ..... (Qty 1)

6—Clamp Down Tube ..... (Qty 1)  
68.00"7—Quick Clamp Tube Splice Assembly ..... (Qty 1)  
5.00"8—Removeable Horn with Cap ..... (Qty 1)  
15.00"

## 9—Front Hook Assembly ..... (Qty 1)

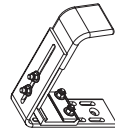
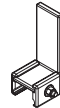
10—Ladder Stop Assembly ..... (Qty 2)  
1.75"11—USQSG-Ergorack ..... (Qty 1)  
Quick Start Guide, Clamp Down

## 12—Anti-Seize..... (Qty 1)



## RIGHT CLAMP DOWN ASSEMBLY SEQUENCE

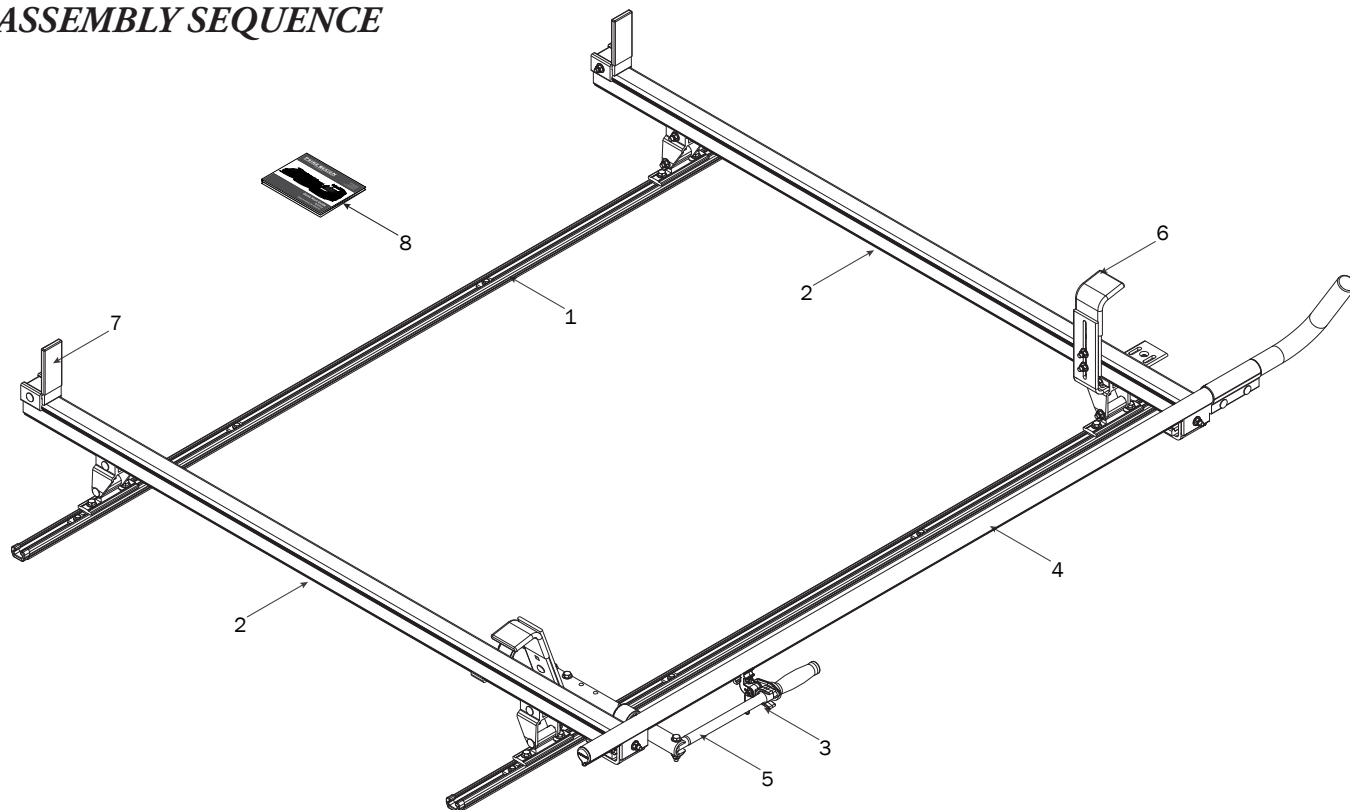

### FBM-0006 CHANNELS TO ROOF

- 1.1** Front Mounting Brackets only: remove and save the hardware from the rear Bracket Nut as shown.

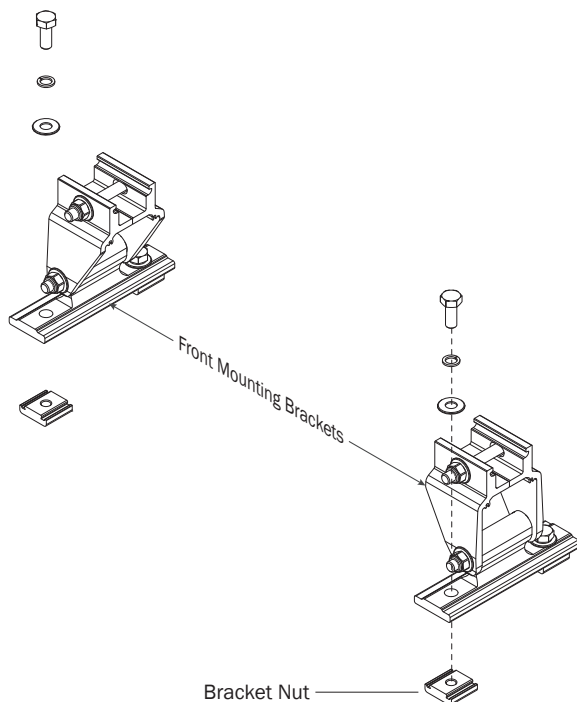

- 1.2** Slide the Bracket Nuts into the Channels as shown.

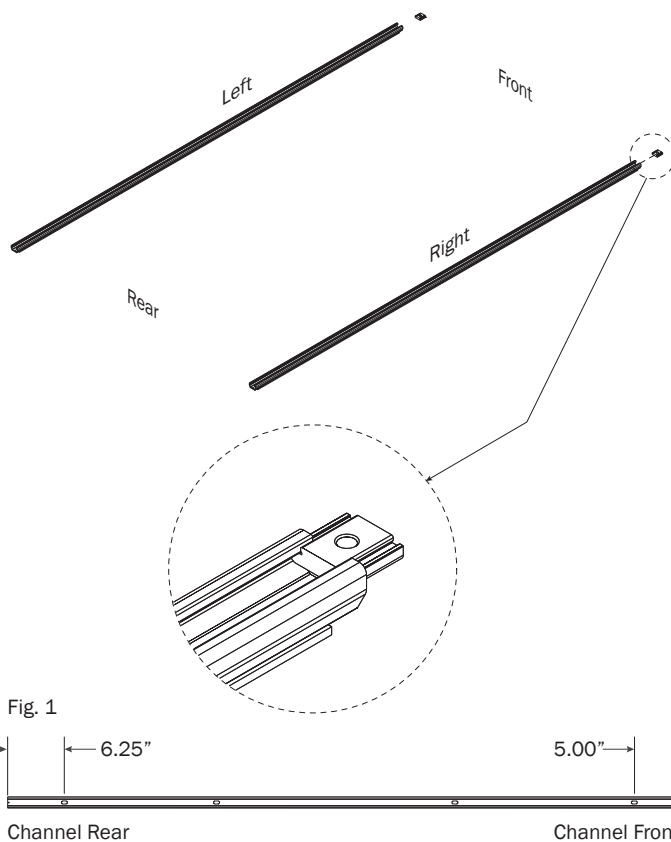

- 1.3** Install three sets of Channel Hardware per channel as shown below.

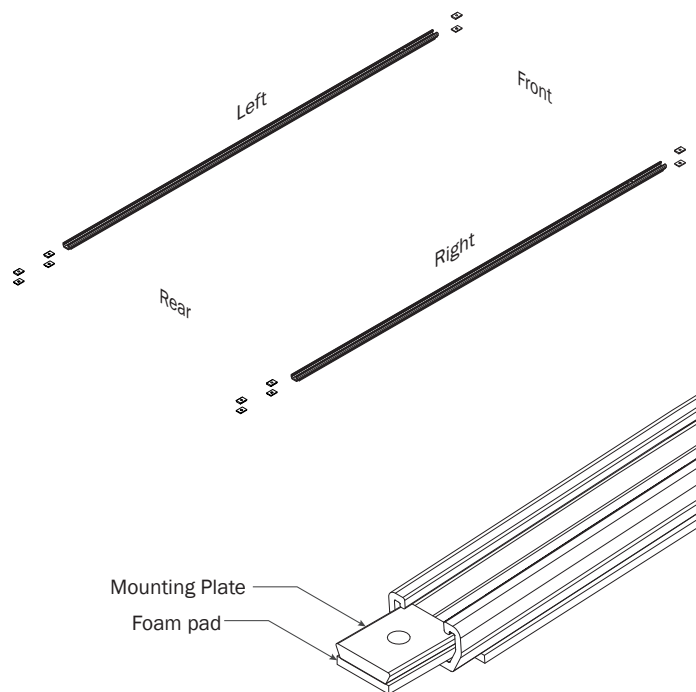

- 1.4** Install the fasteners through the innermost factory roof holes as shown then torque the nuts to 60 in-lbs.

Do not install or fasten Hardware to the outer front and rear roof holes until Step 1.9.

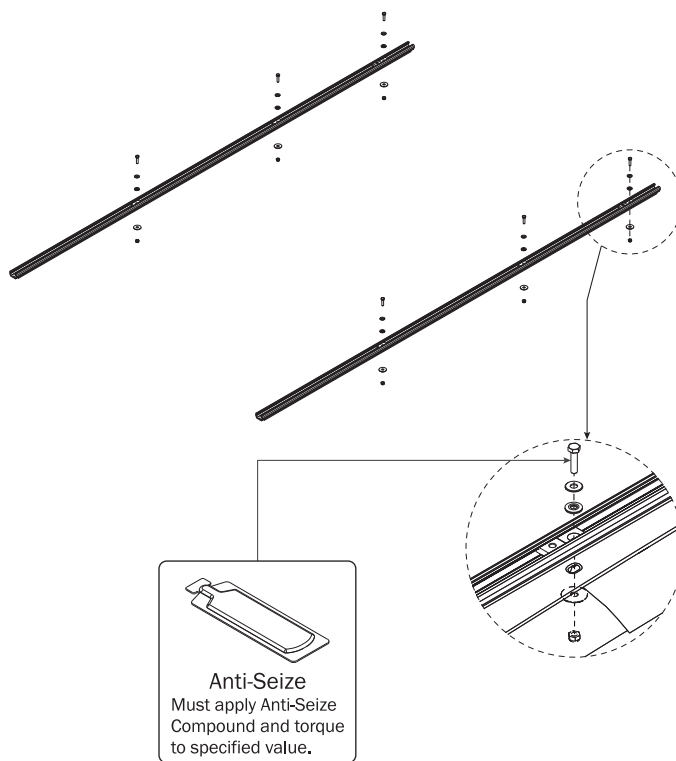

- 1.5** Install the front Mounting Brackets as shown and slide into position over the Bracket Nut.

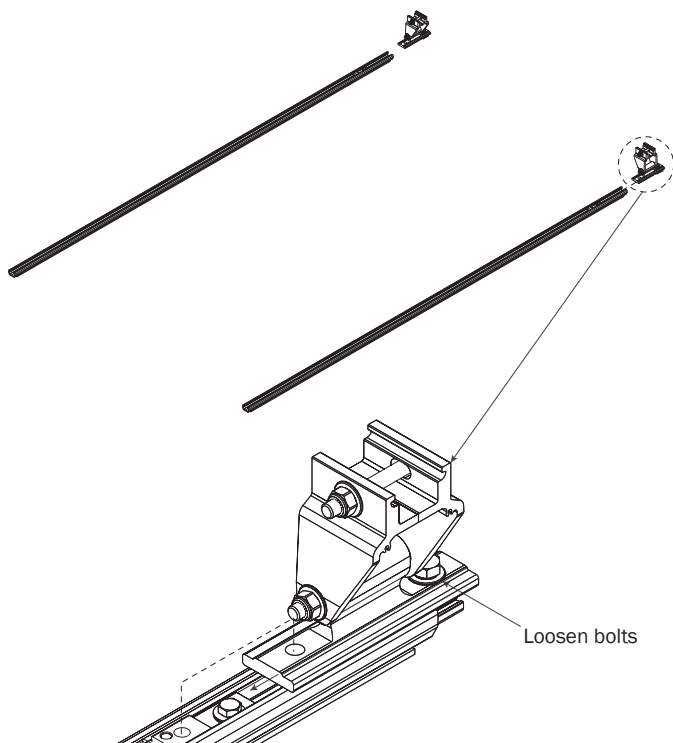

- 1.6** Reinstall the Mounting Bracket Nut hardware as shown, but do not tighten.

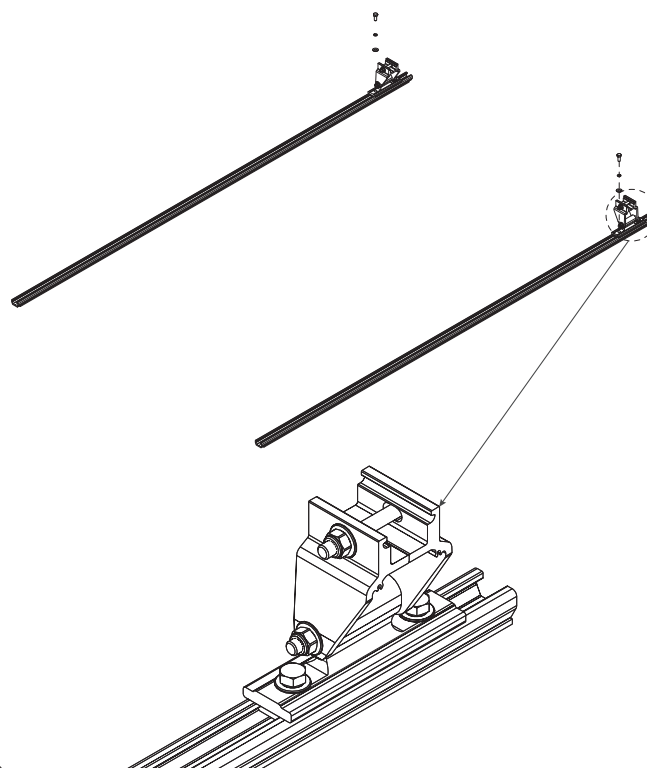

**1.7**

Install the rear Mounting Brackets along with the remaining Channel Hardware as shown below.

Do not tighten the Mounting Brackets until Step 1.9.

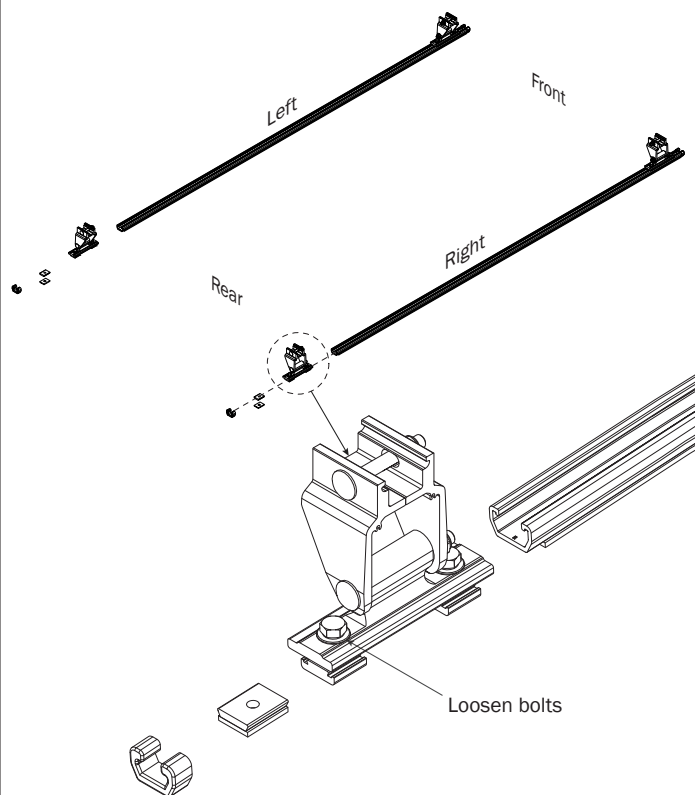
**1.8**

Install the remaining rear fasteners through the factory roof holes then torque the nuts to 60 in-lbs.

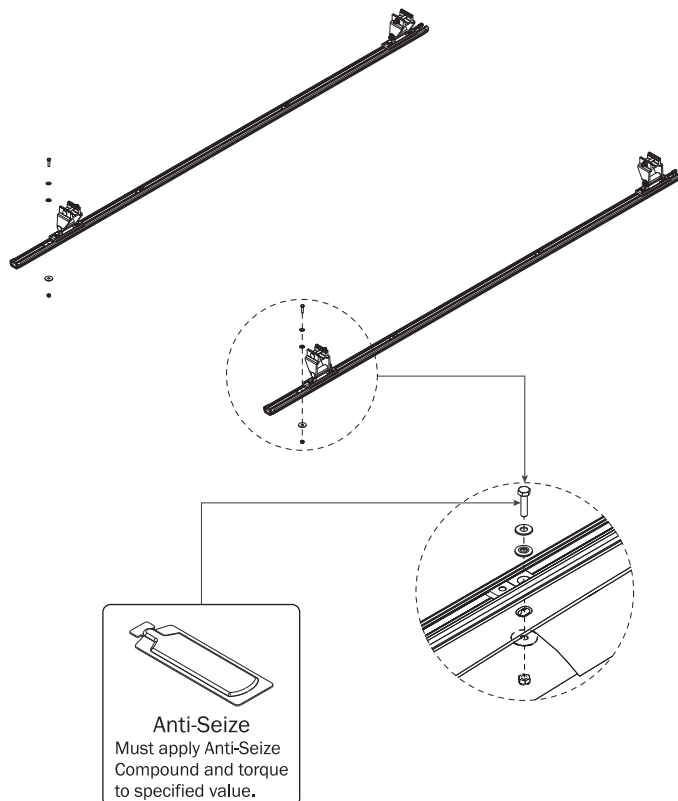
**1.9**

Set to distances then torque all the Mounting Brackets to 90 in-lbs.

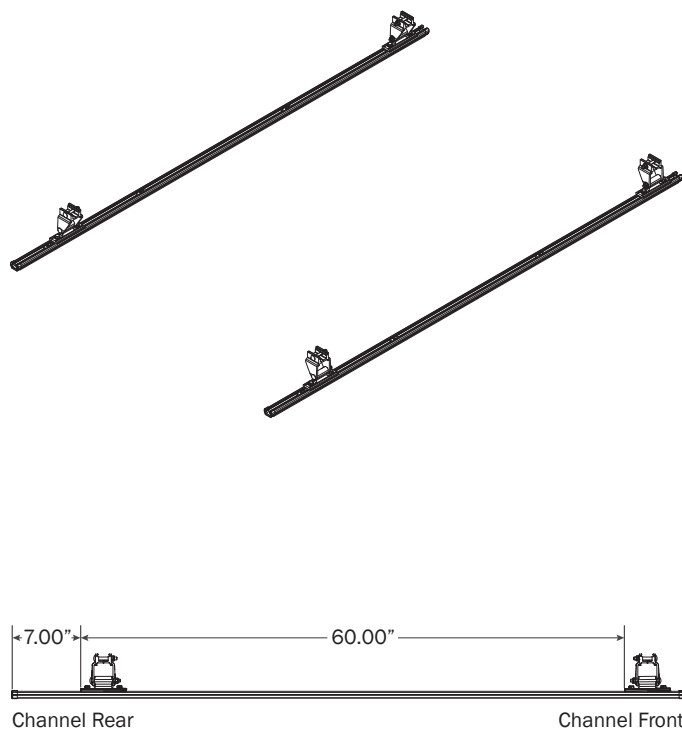

## CROSSBARS

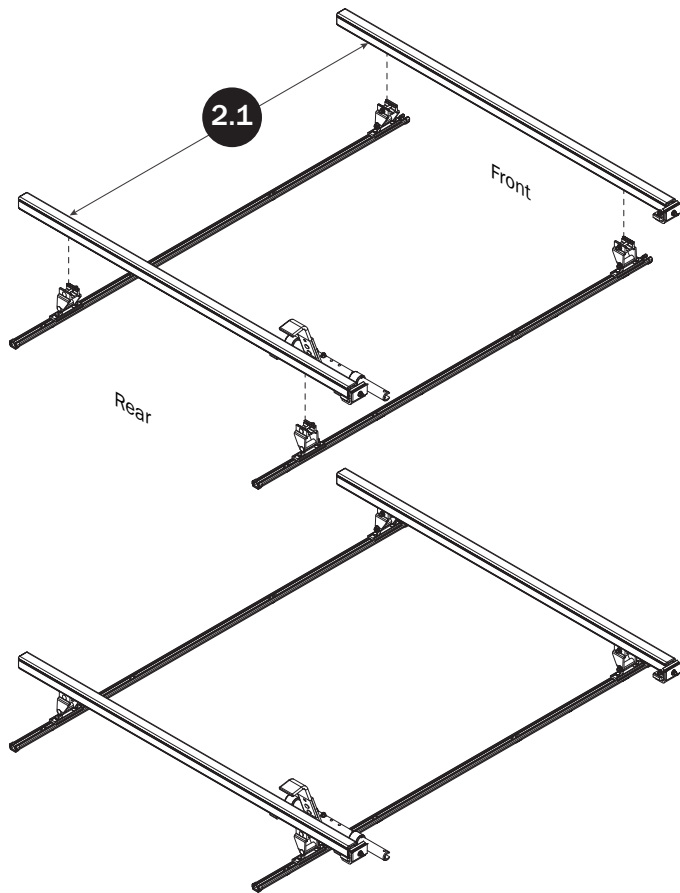

## CROSSBAR ADJUSTMENT

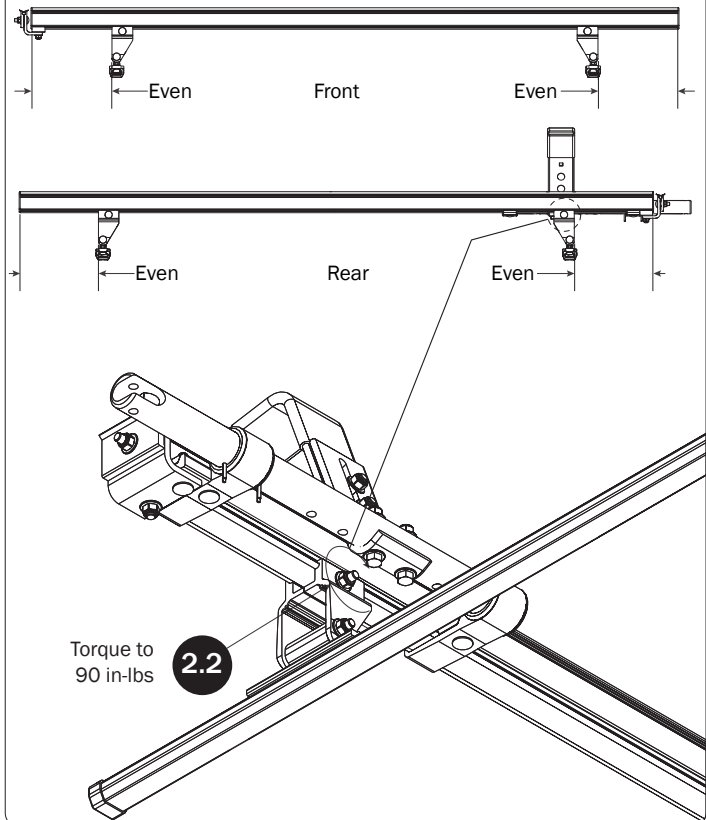

## CLAMP DOWN HANDLE

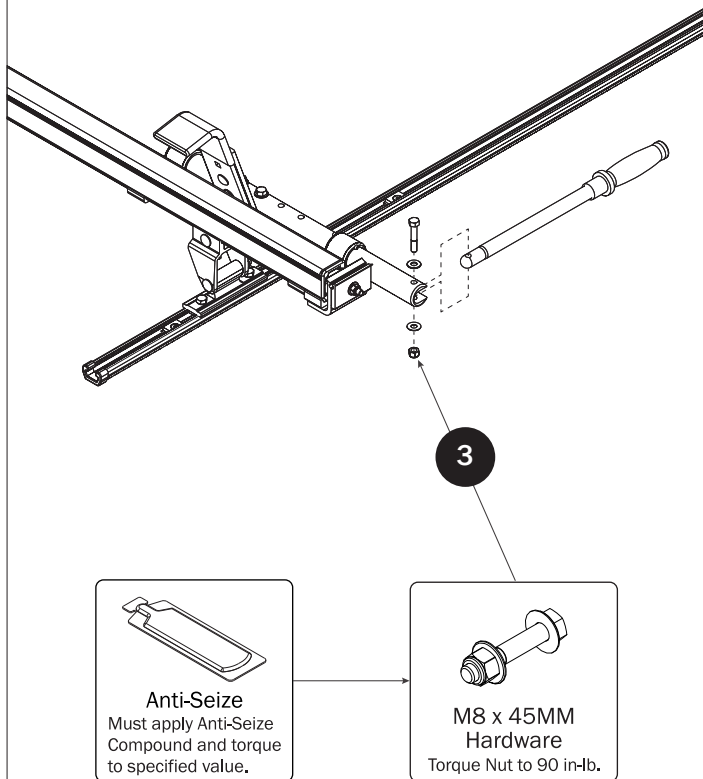

## CLAMP DOWN TUBE

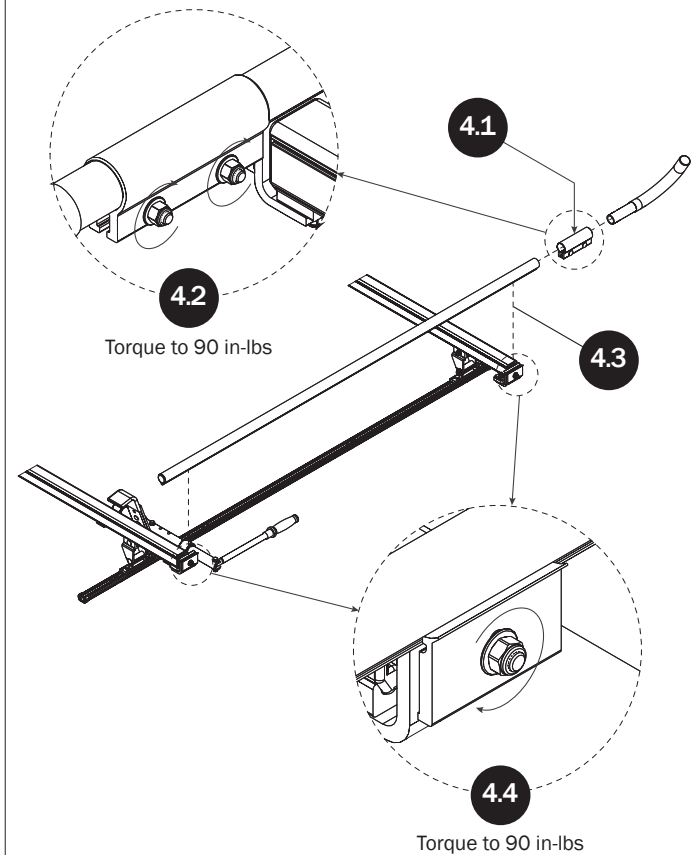

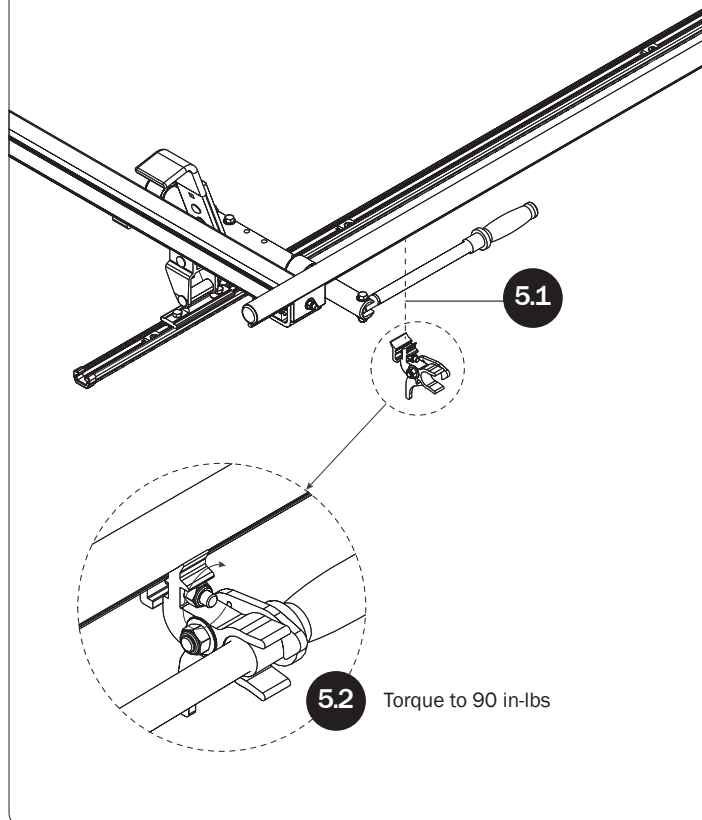
**HANDLE LATCH****FRONT LADDER HOOK**

SEE QUICK START GUIDE FOR ADJUSTMENTS

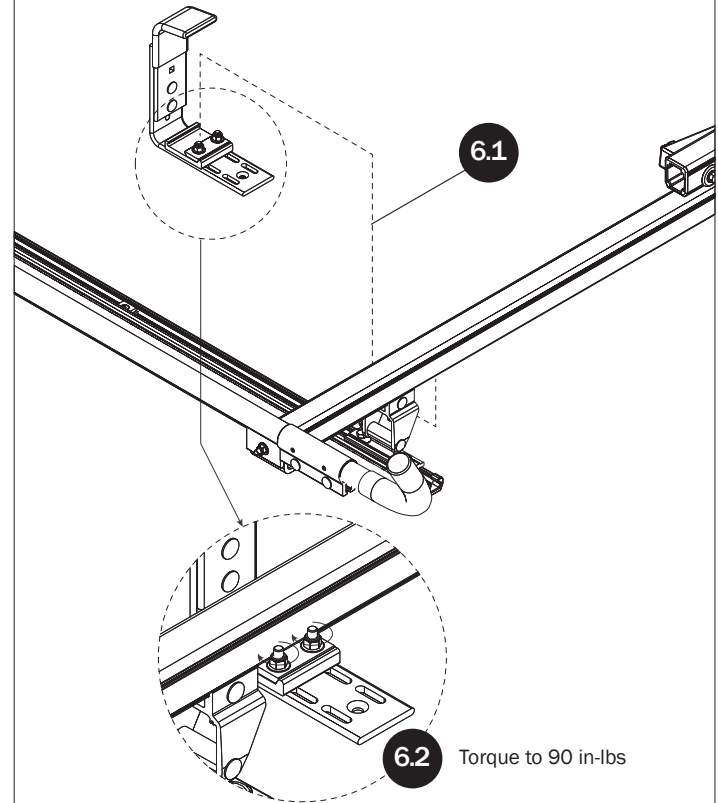
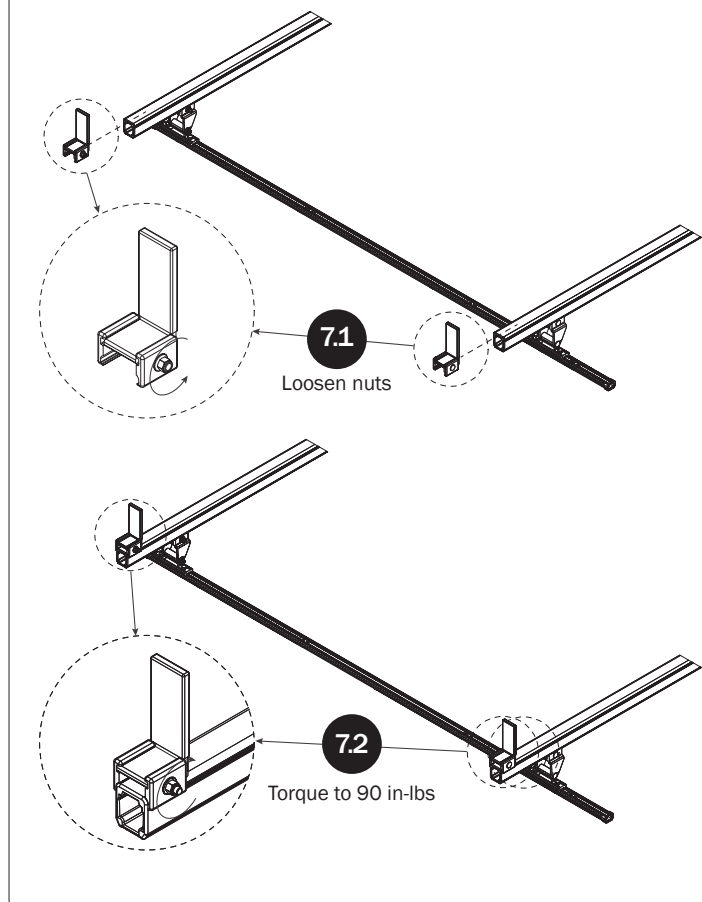
**LADDER STOPS****QUICK START GUIDE**

8

Place the Quick Start Guide into the vehicle's glove box for ladder setup and adjustment.

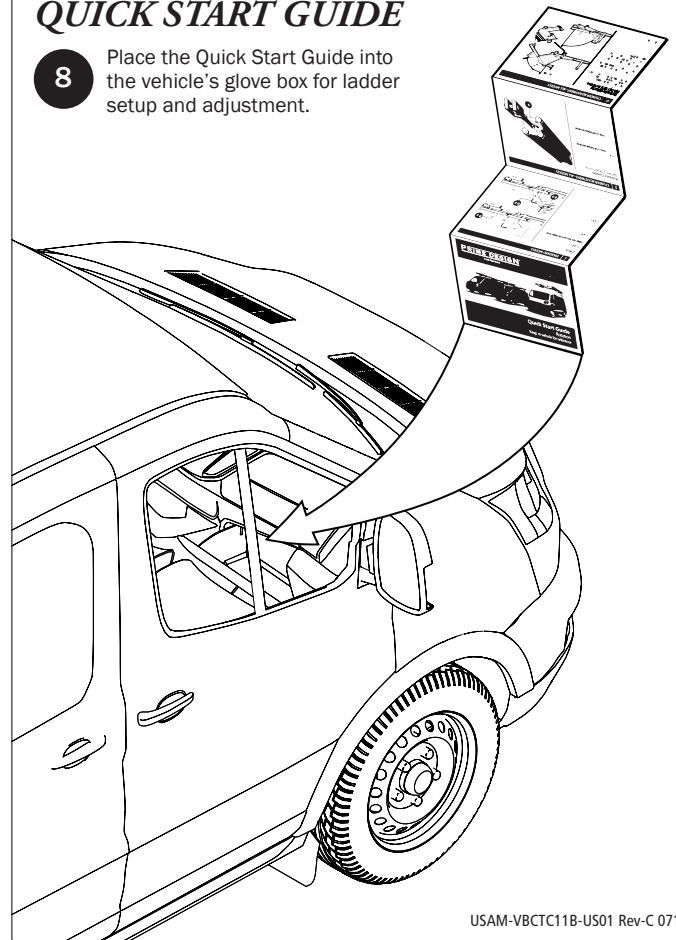

USAM-VBCTC11B-US01 Rev-C 0718