

PRIME DESIGN™

A Safe Fleet Brand

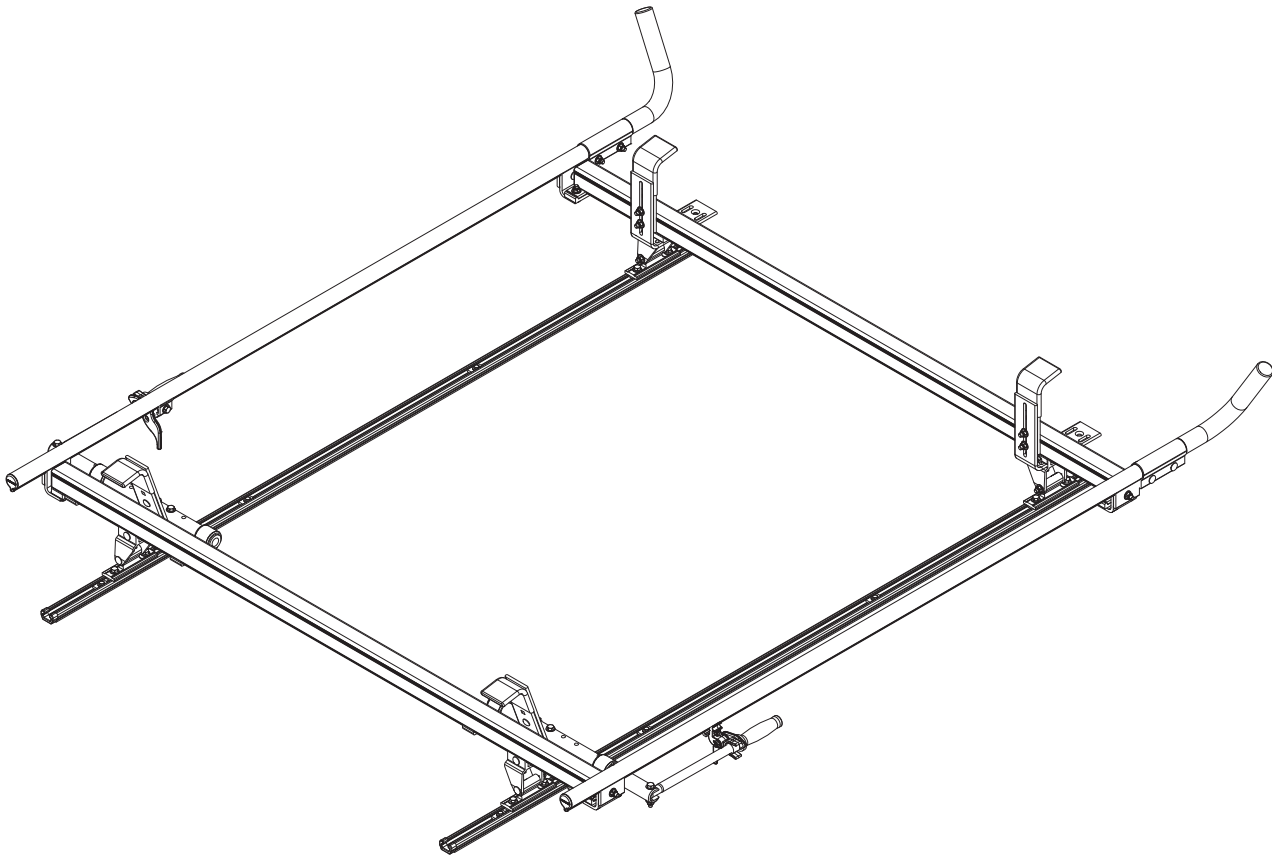

VCC
Roller

CONTENTS OVERVIEW

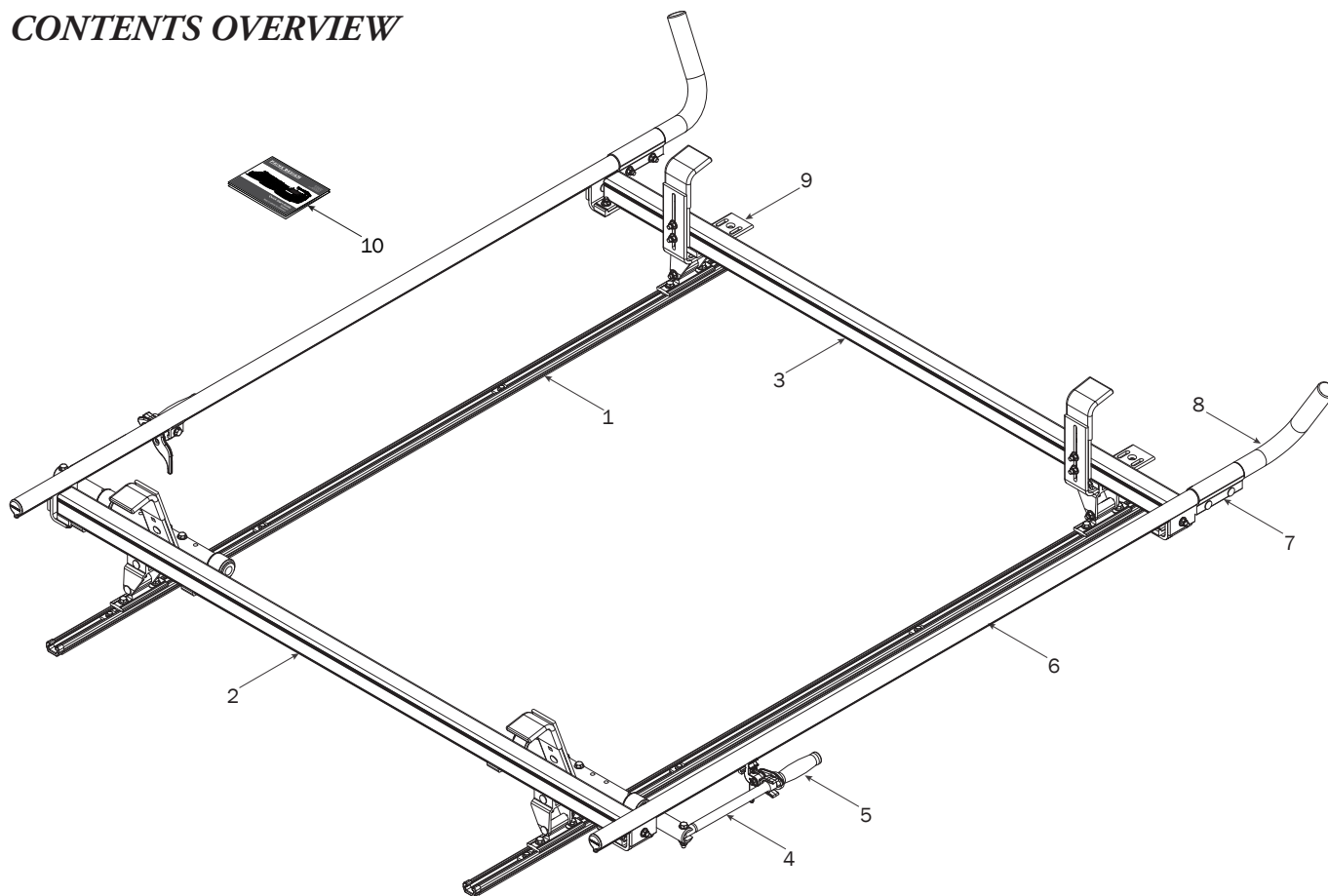

1—FBM-0006 (Qty 1)
Channels with hardware



Channels (2X)



M6 Locknut (8X)

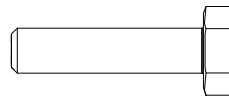

M6 x 30MM Bolt (8X)



End Caps (4X)



Brackets (4X)

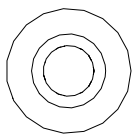

M6 Sealing Washer (8X)

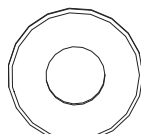

1/4" Flat Washer (8X)

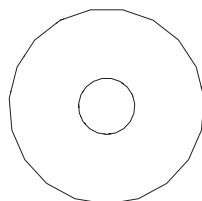

1/4" Washer (8X)

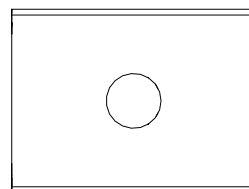

Mounting Plate (8X)

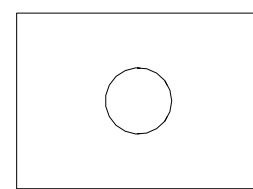

Foam Pad (8X)

2—Rear Crossbar Assembly (Qty 1)



3—Front Crossbar Assembly (Qty 1)



4—Handle Latch Assembly (Qty 2)



5—Clamp Down Handle Assembly (Qty 2)

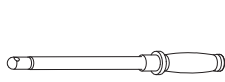

M8 Lock Nut (1X)

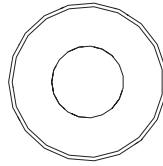

Flat Washer (2X)

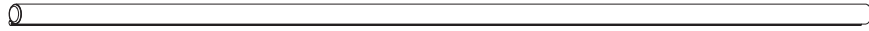
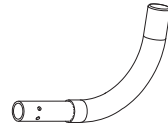

M8 x 45MM (1X)

6—Clamp Down Tube (Qty 2)
68.00"7—Quick Clamp Tube Splice Assembly (Qty 2)
5.00"8—Removeable Horn with Cap (Qty 2)
15.00"

9—HD Front Hook Assembly (Qty 2)

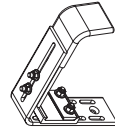
10—USQSG-Ergorack (Qty 1)
Quick Start Guide, Clamp Down

* Once rack installation is complete, place the Quick Start Guide into the vehicle's glove box for future ladder setup and adjustment.

11—Anti-Seize (Qty 1)



Anti-Seize (1X)

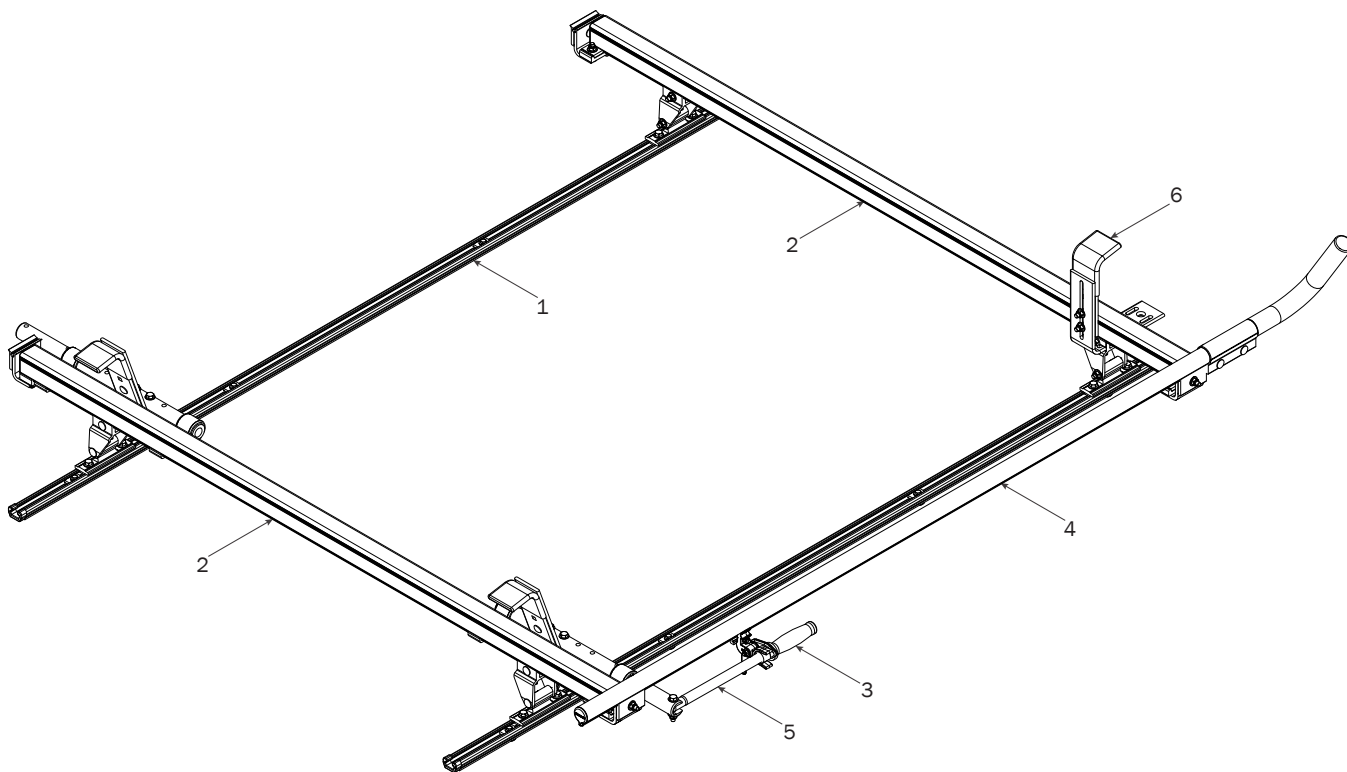

FBM-0006 CHANNELS TO ROOF

- 1.1** Front Mounting Brackets only: remove and save the hardware from the rear Bracket Nut as shown.

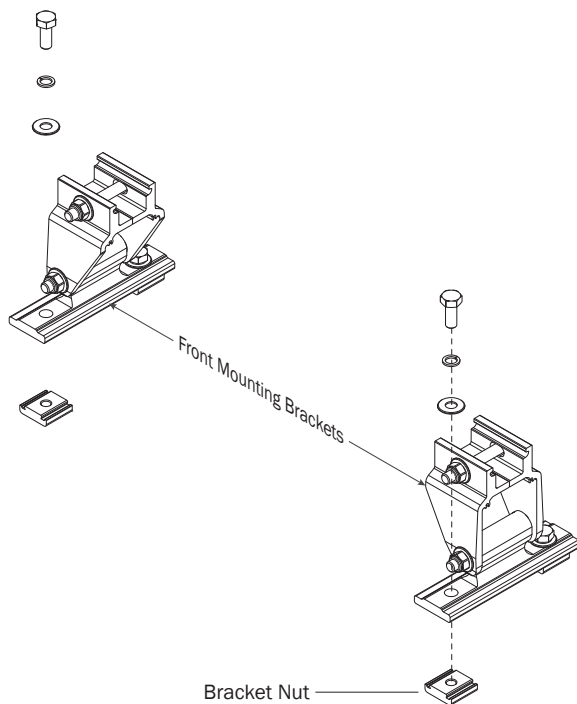

- 1.2** Slide the Bracket Nuts into the Channels as shown.

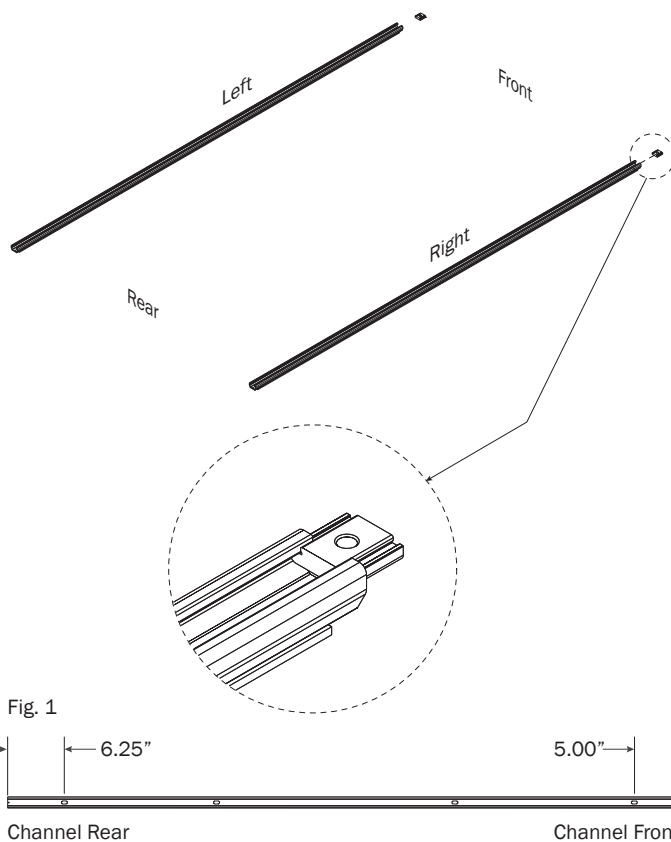

- 1.3** Install three sets of Channel Hardware per channel as shown below.

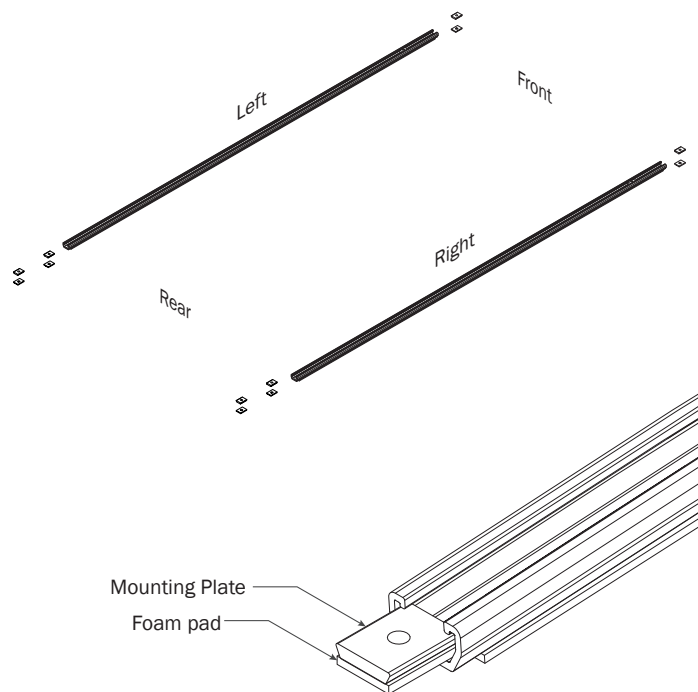

- 1.4** Install the fasteners through the innermost factory roof holes as shown then torque the nuts to 60 in-lbs.

Do not install or fasten Hardware to the outer front and rear roof holes until Step 1.9.

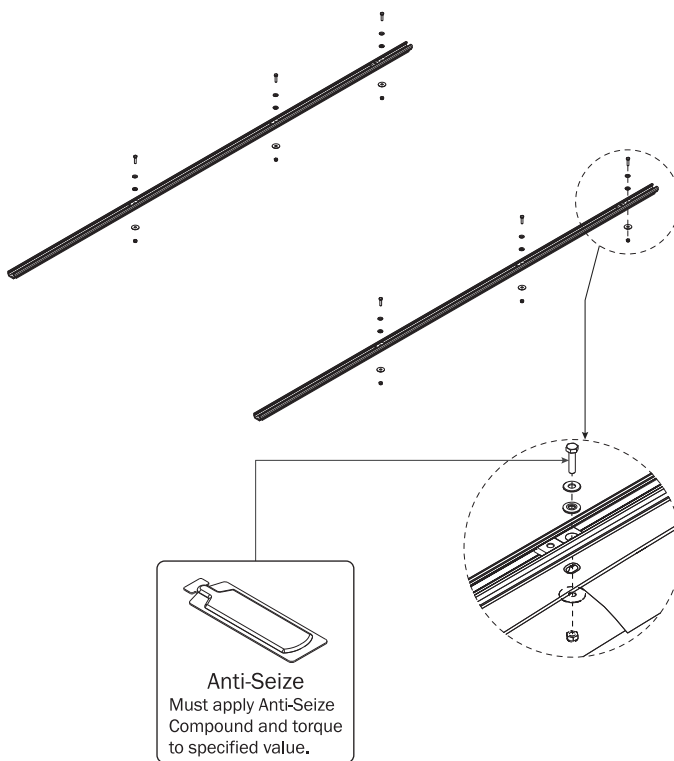

- 1.5** Install the front Mounting Brackets as shown and slide into position over the Bracket Nut.

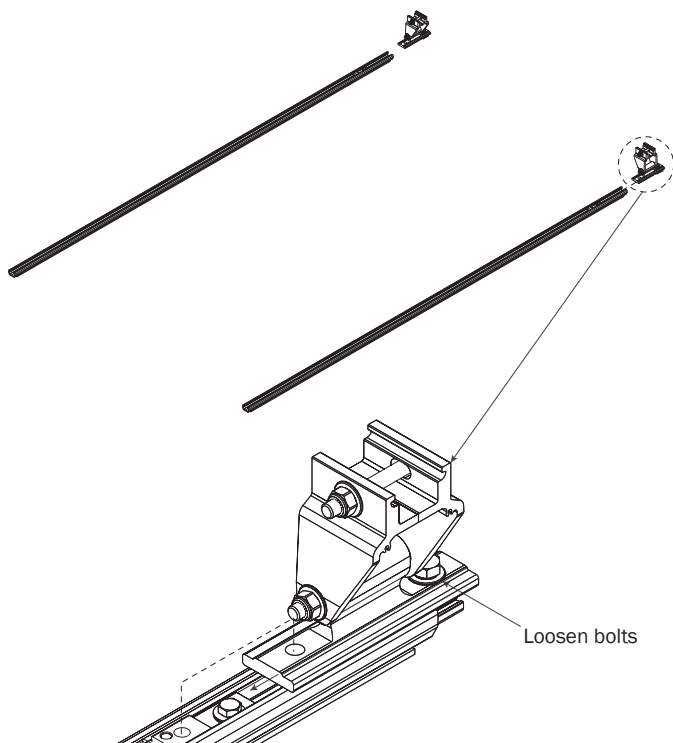

- 1.6** Reinstall the Mounting Bracket Nut hardware as shown, but do not tighten.

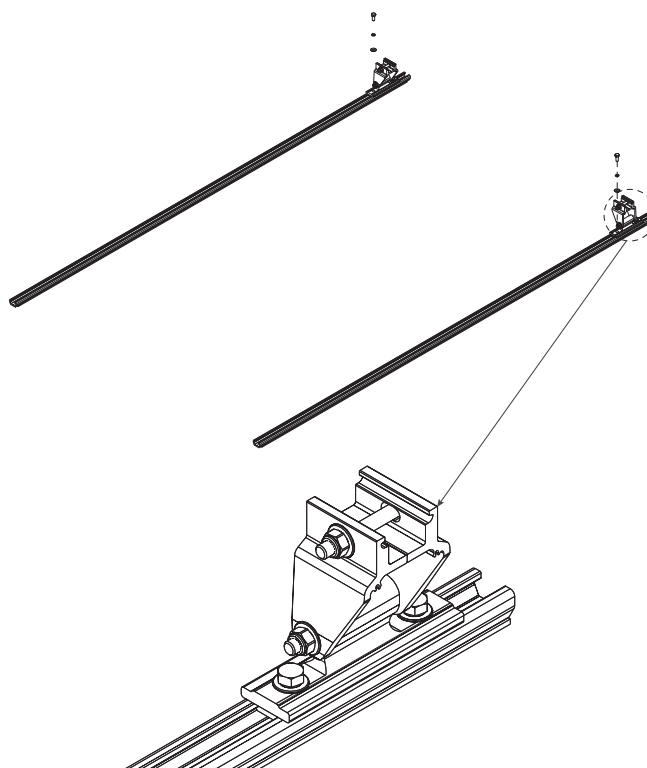

PRIME DESIGN, A SAFE FLEET BRAND • Address: 1689 Oakdale Avenue #102, West St Paul, Minnesota 55118 • Phone: 651-552-8554 • Toll Free: 1.8.PRIME.RACK • Fax: 651-552-1799 • Email: info@primedesign.net • Website: www.primedesign.net
TM & © 2018 PRIME DESIGN. PROTECTED BY ONE OR MORE OF THE FOLLOWING PATENT NO.'S: 6764268, 6971563, 2364879, 8857689, 8511525, 8991889, 2271515, 2364897, 9506292, 9481313, 9481314, 9796340, 6202807, 6427889, 9415726 AND OTHER PATENTS PENDING

CROSSBARS

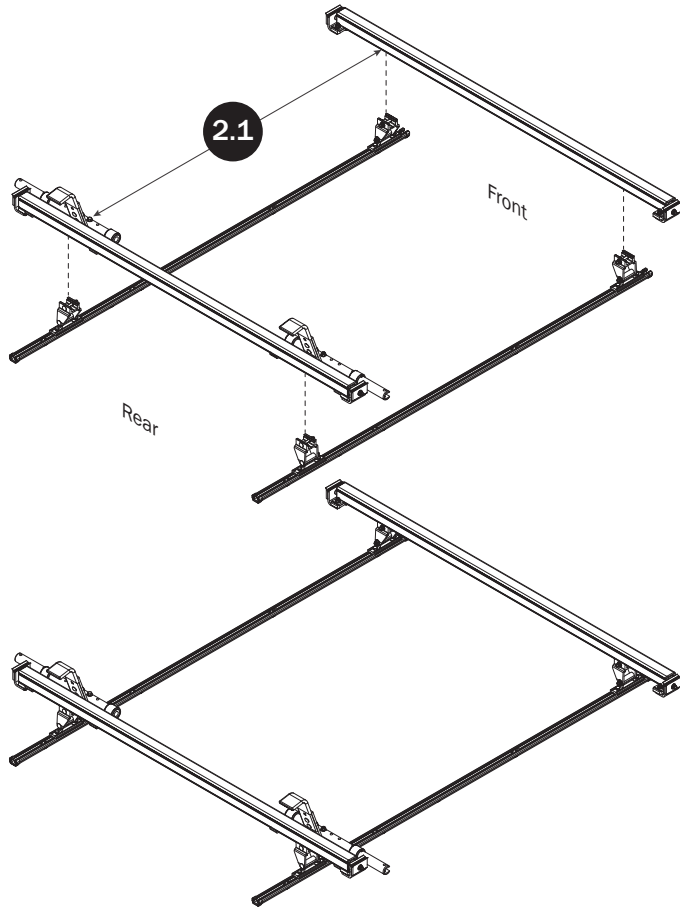

CROSSBAR ADJUSTMENT

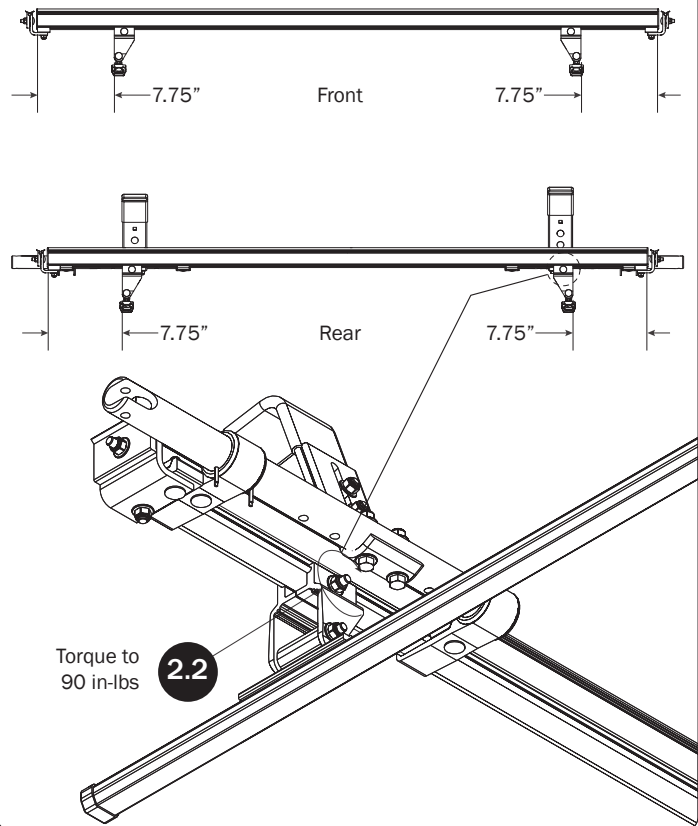

CLAMP DOWN HANDLE

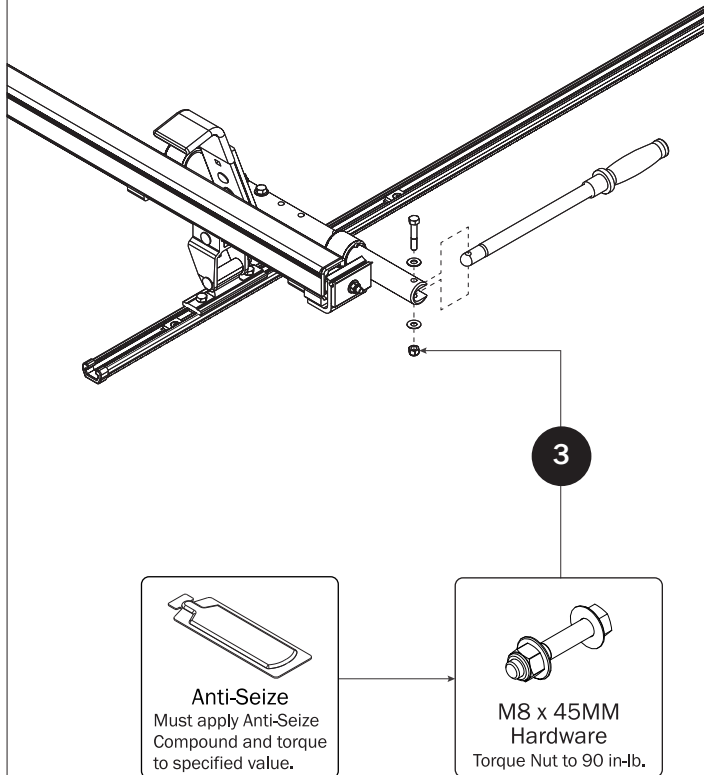

CLAMP DOWN TUBE

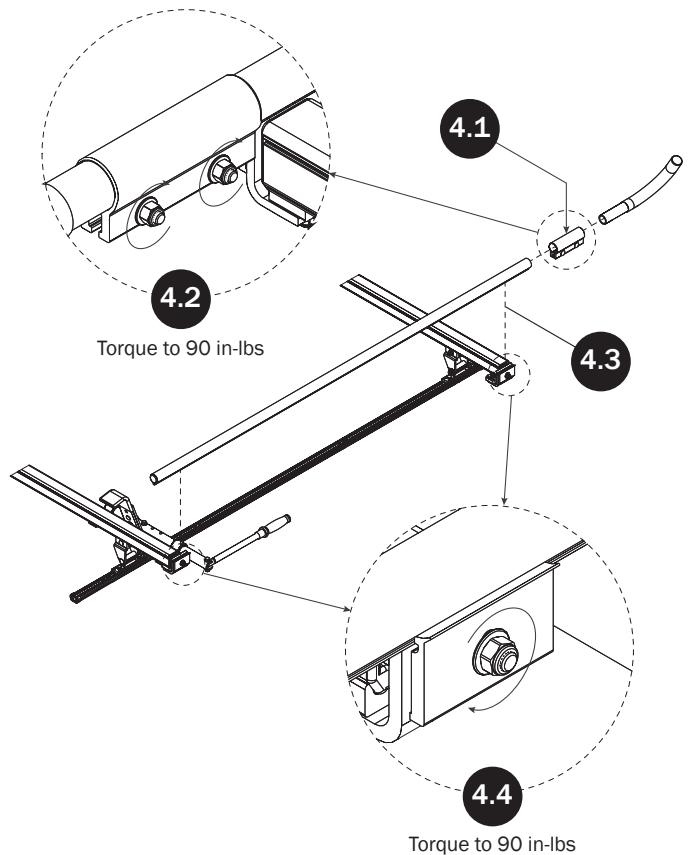

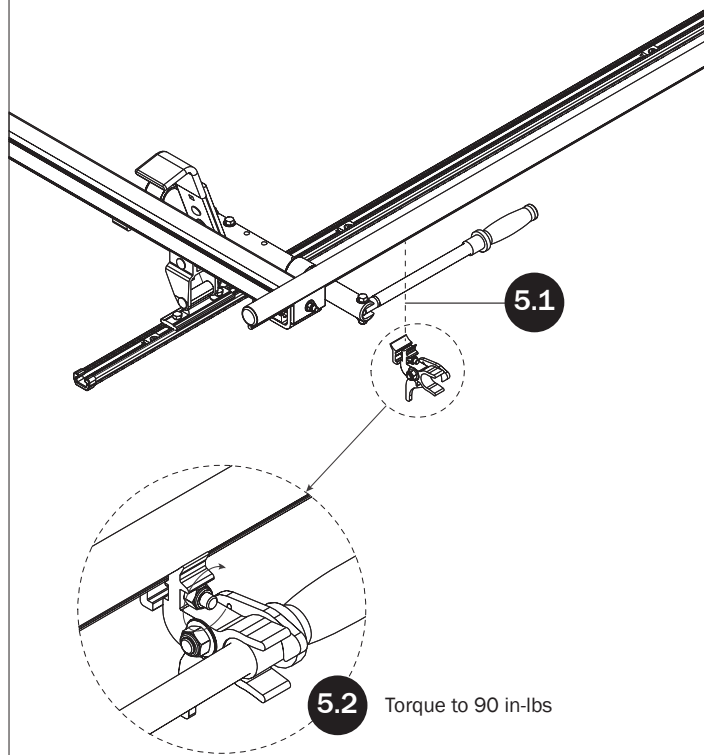
HANDLE LATCH**FRONT LADDER HOOK**

SEE QUICK START GUIDE FOR ADJUSTMENTS

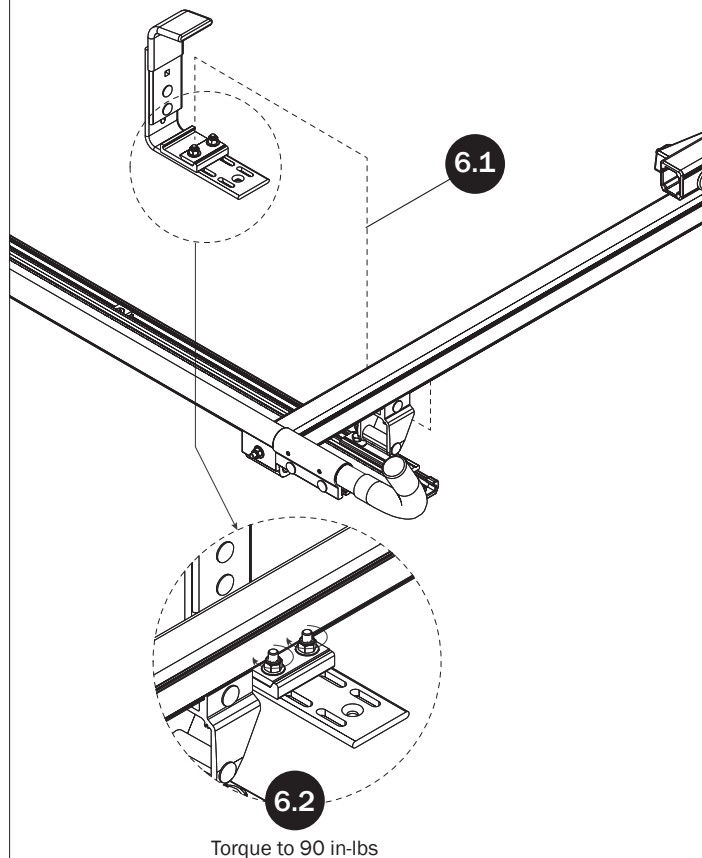

LEFT CLAMP DOWN ASSEMBLY

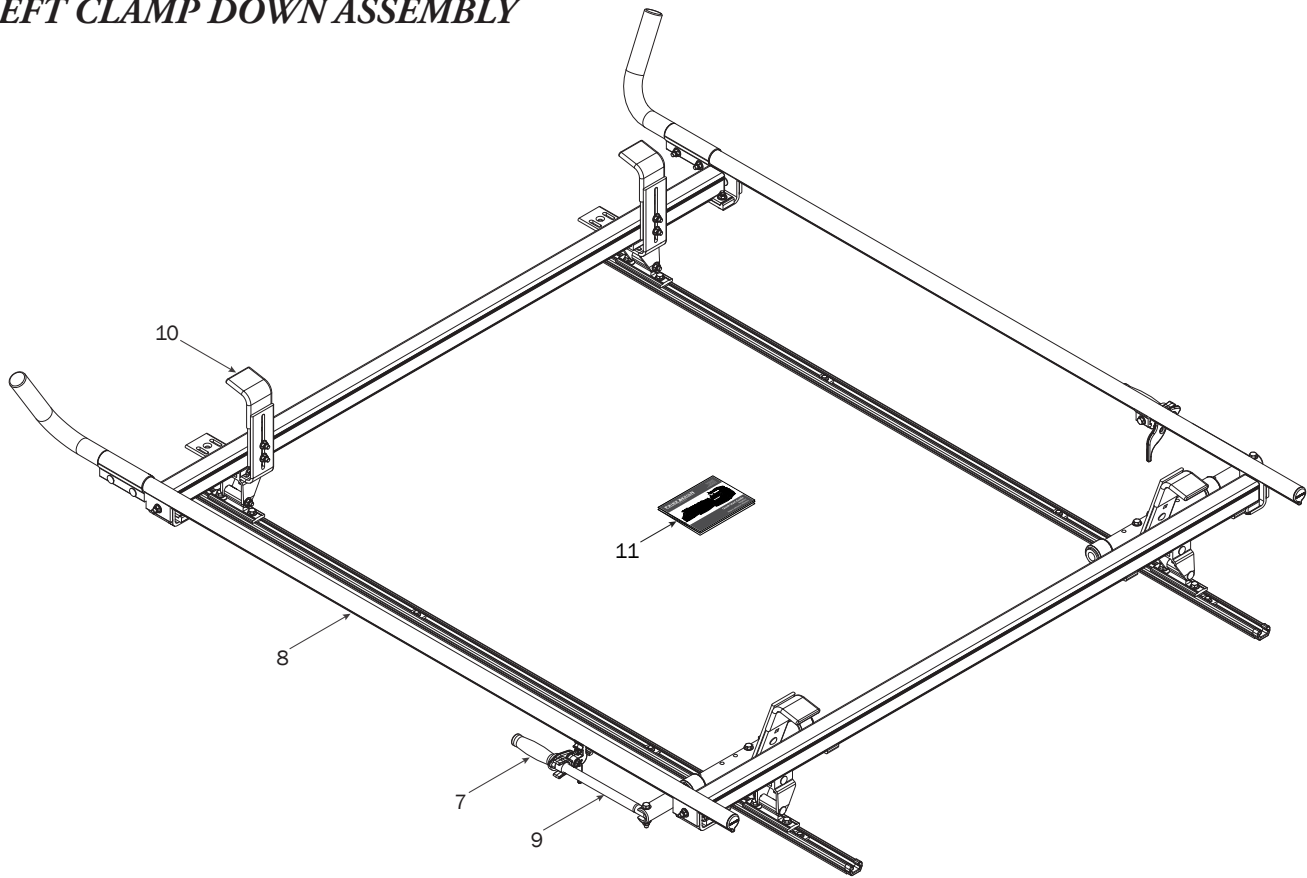

CLAMP DOWN HANDLE

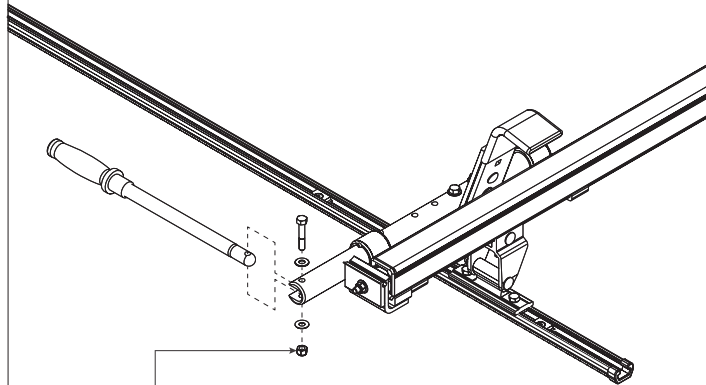

7

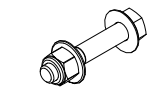

**M8 x 45MM
Hardware**
Torque Nut to 90 in-lb.

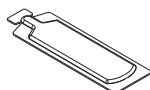

Anti-Seize
Must apply Anti-Seize
Compound and torque
to specified value.

CLAMP DOWN TUBE

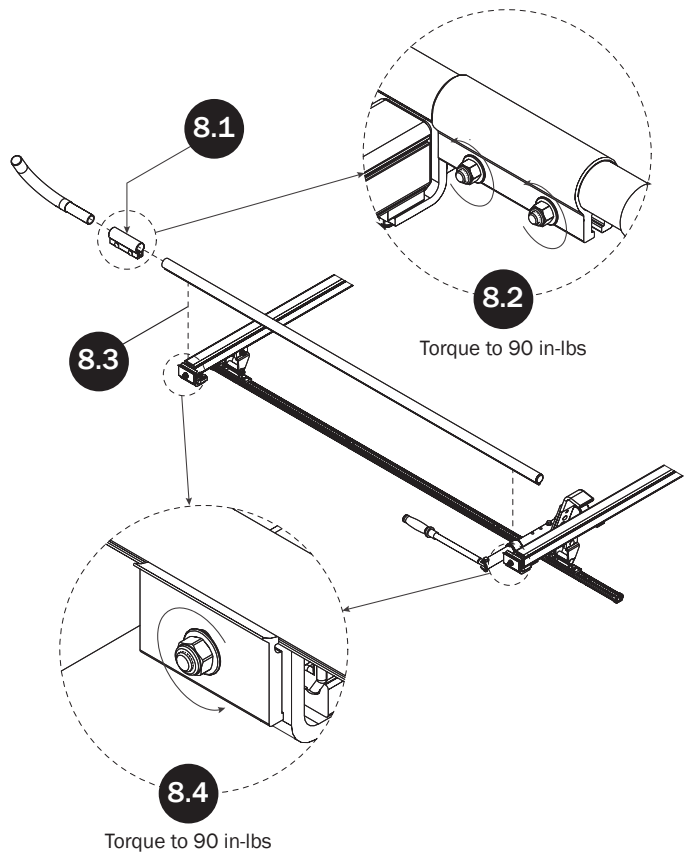

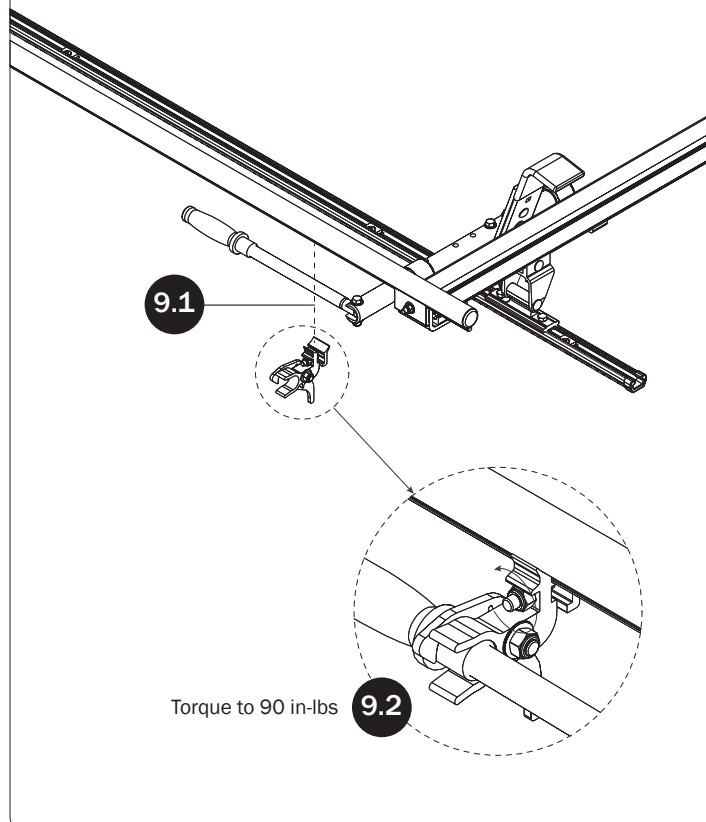
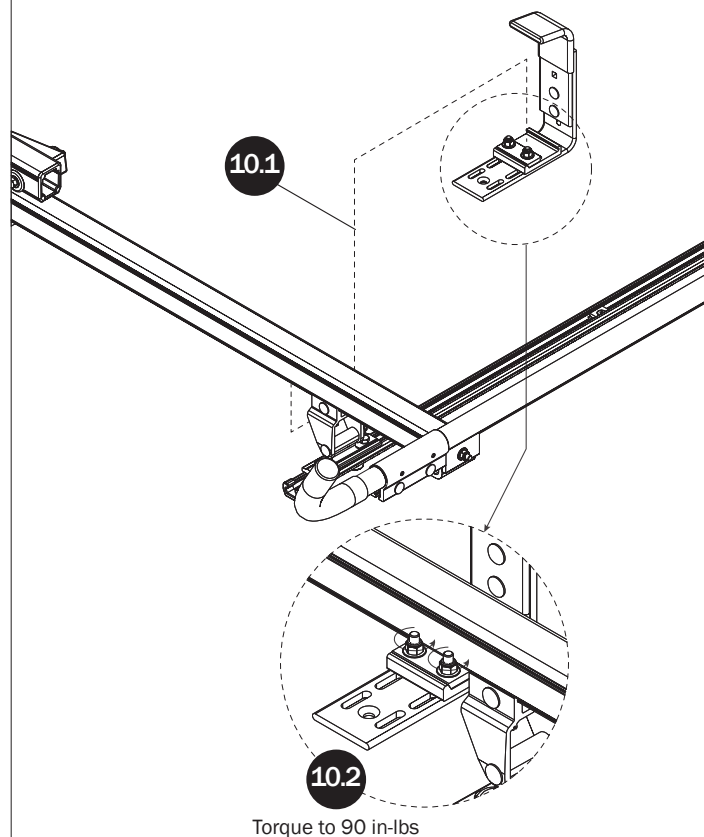
HANDLE LATCH**FRONT LADDER HOOK**
SEE QUICK START GUIDE FOR ADJUSTMENTS**QUICK START GUIDE**

11

Place the Quick Start Guide into the vehicle's glove box for ladder setup and adjustment.

