

# PRIME DESIGN™

A Safe Fleet Brand

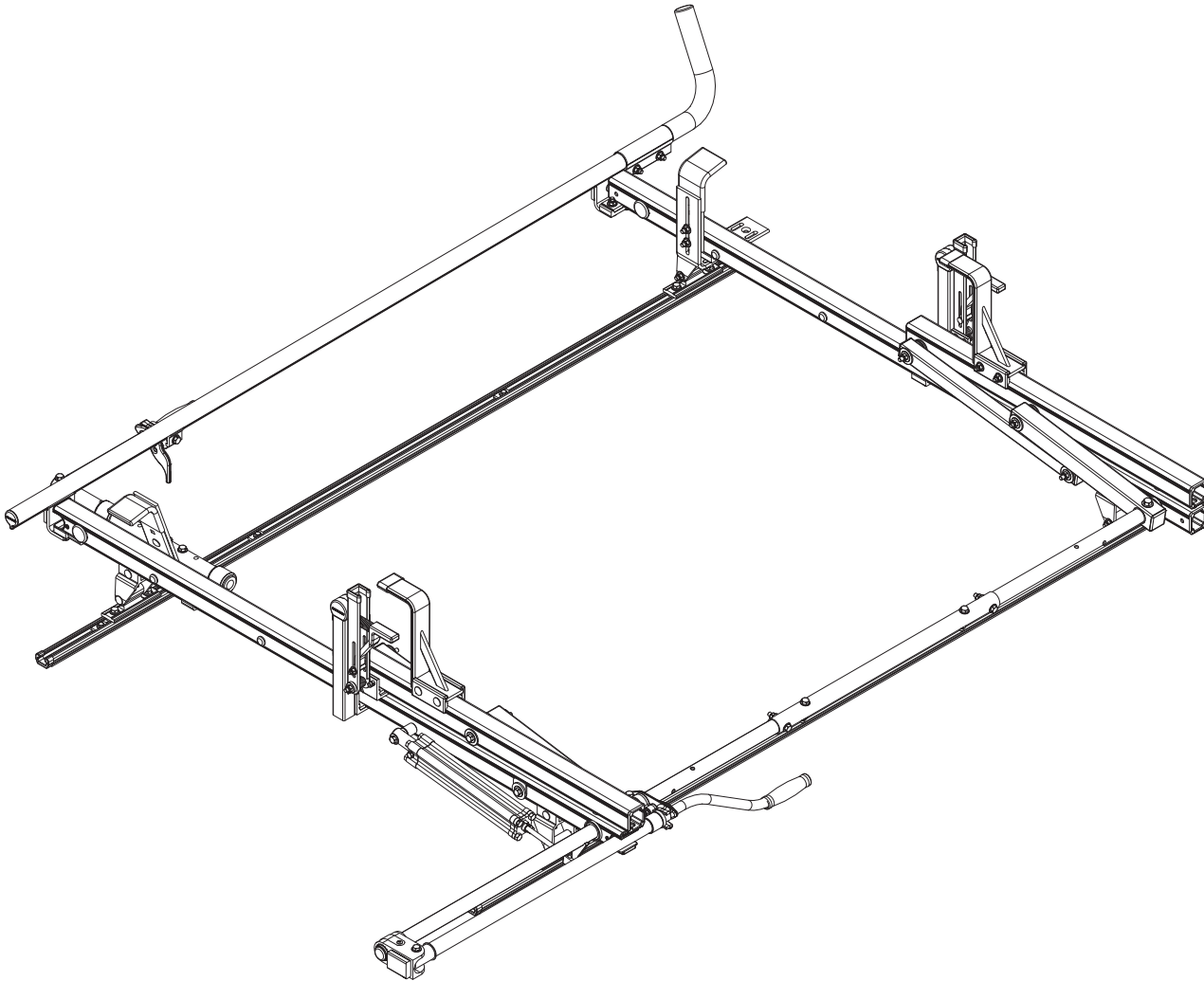

# VCR

## CONTENTS OVERVIEW

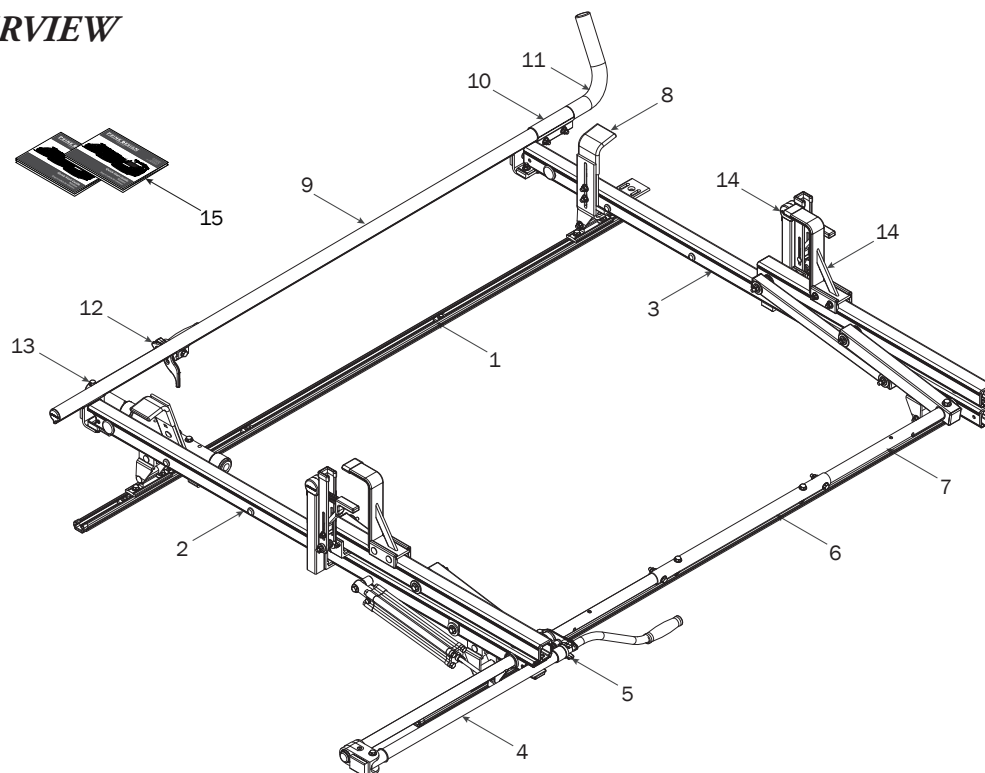

1—FBM-0006 ..... (Qty 1)

Channels with Hardware



Channels (2X)



M6 Locknut (8X)

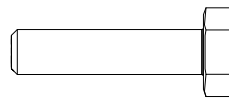

M6 x 30MM Bolt (8X)



End Caps (4X)



Brackets (4X)

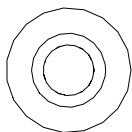

M6 Sealing Washer (8X)

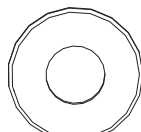

1/4" Flat Washer (8X)

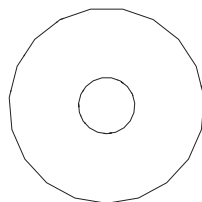

1/4" Washer (8X)

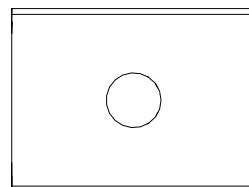

Mounting Plate (8X)

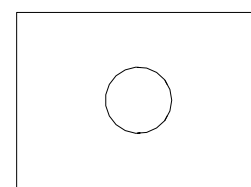

Foam Pad (8X)

2—Rear Crossbar Assembly..... (Qty 1)

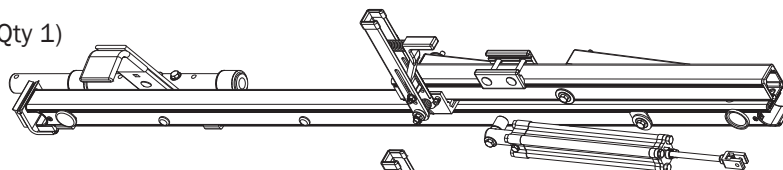

3—Front Crossbar Assembly ..... (Qty 1)

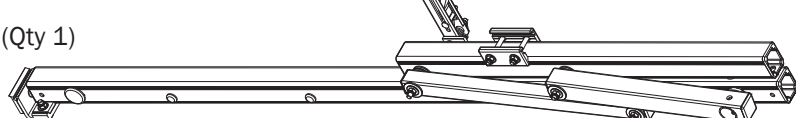
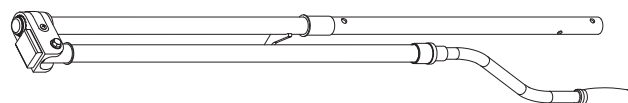
4—Rear Drive Shaft..... (Qty 1)  
Right Hand, B4 Version, 46.00"

5—Handle Latch Assembly ..... (Qty 1)

6—Connecting Bar..... (Qty 1)  
2.00'

7—Front Drive Shaft ..... (Qty 1)  
B Version, 35.75"

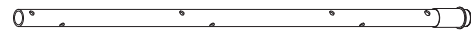

8—HD Front Hook Assembly ..... (Qty 1)

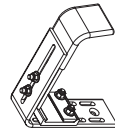

9—Clamp Down Tube ..... (Qty 1)  
68.00"



10—Quick Clamp Tube Splice Assembly ..... (Qty 1)  
5.00"



11—Removeable Horn with Cap..... (Qty 1)  
15.00"

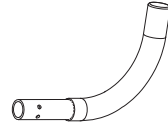

12—Clamp Down Handle Latch Assembly..... (Qty 1)



13—Clamp Down Handle Assembly ..... (Qty 1)

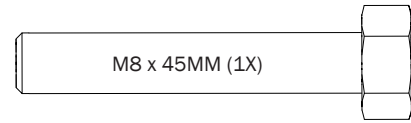
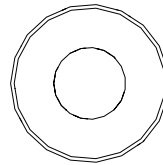
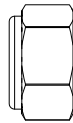
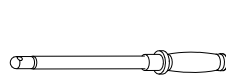

Clamp Down Handle (1X)

M8 Lock Nut (1X)

5/16" Flat Washer (2X)

14—L & Z Post Kit..... (Qty 1)  
Adj. Z Post, 7.25", L Post, w/HKT-0160

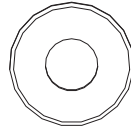

M6 x 20MM (2X)

1/4 Lock Washer (2X)

1/4 Flat Washer (2X)

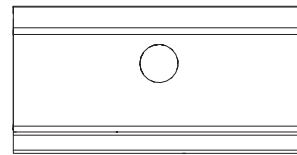

L Post Bracket Clamp (2X)

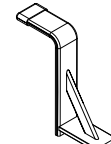

Z Post (2X)

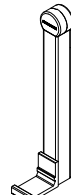

L Post (2X)

15—USQSG-Ergorack ..... (Qty 1)  
Quick Start Guide, Clamp Down, Rotation

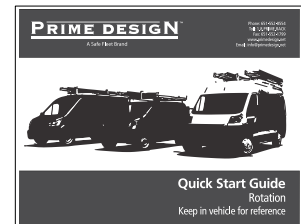
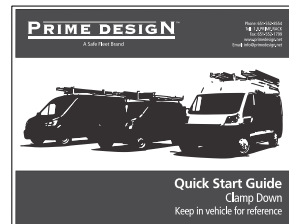

16—HKT-8163 (Not called out in Overview) ..... (Qty 1)



Clevis Pin (1X)

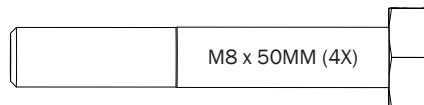

M8 x 50MM (4X)

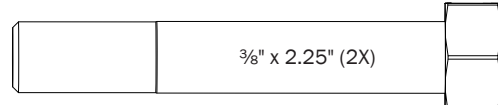

3/8" x 2.25" (2X)



Cotter Pin (1X)

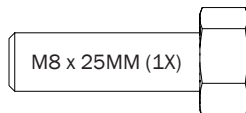

M8 x 25MM (1X)

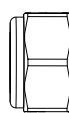

M8 Lock Nut (5X)

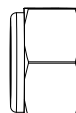

3/8" Lock Nut (2X)

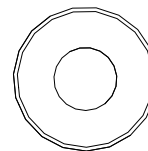

5/16" Flat Washer (10X)

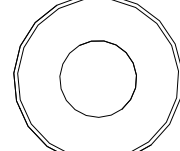

3/8" Flat Washer (4X)

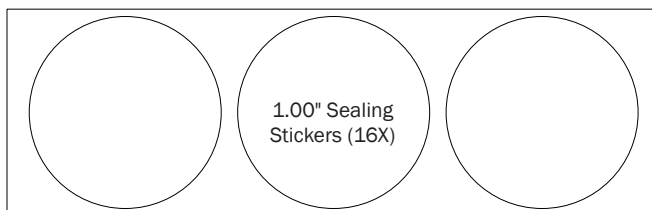

1.00" Sealing  
Stickers (16X)



Anti-Seize (1X)

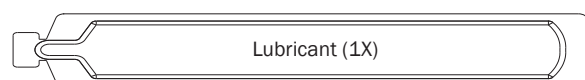

Lubricant (1X)

**RIGHT ROTATION ASSEMBLY SEQUENCE**

Prior to assembling the Channels and hardware, the OEM roof holes must be chased using an M8 x 1.25 Chasing or Thread Cleaning tap and fluid. Doing so will ensure accurate torque is achieved.

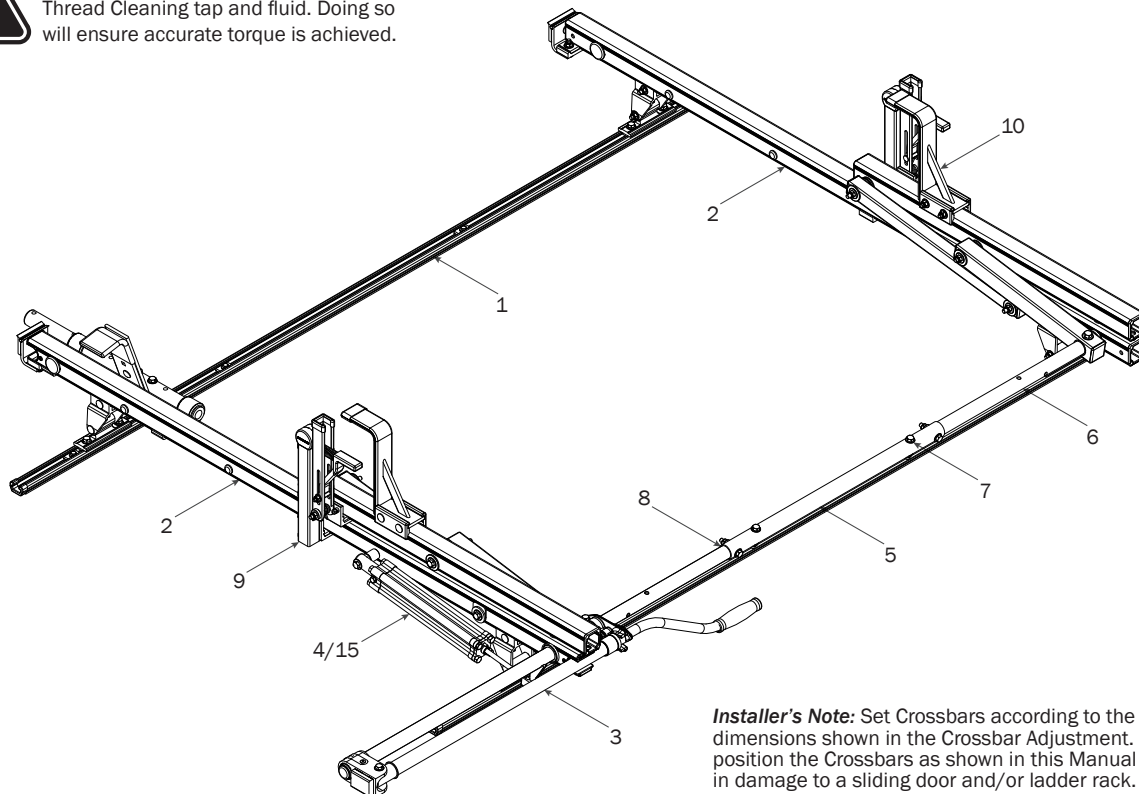

**Installer's Note:** Set Crossbars according to the left hand dimensions shown in the Crossbar Adjustment. Failure to position the Crossbars as shown in this Manual may result in damage to a sliding door and/or ladder rack.

**FBM-0006**  
**CHANNELS TO ROOF**

- 1.1** Front Mounting Brackets only: remove and save the hardware from the rear Bracket Nut as shown.

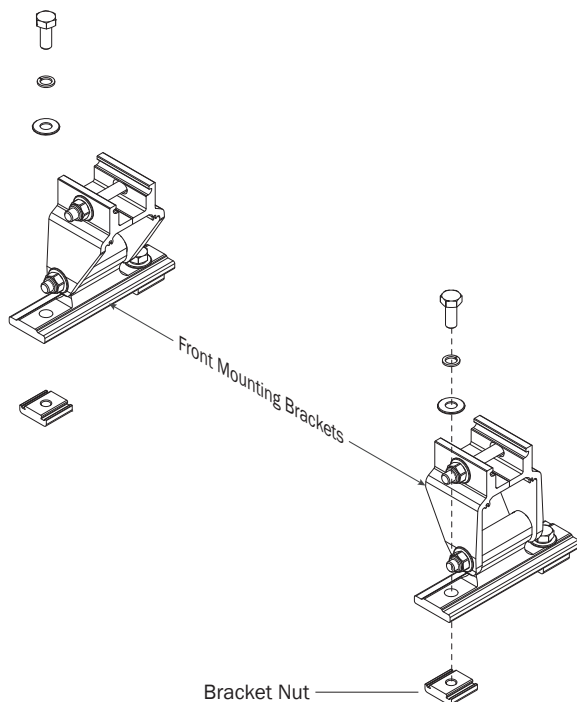

- 1.2** Slide the Bracket Nuts into the Channels as shown.

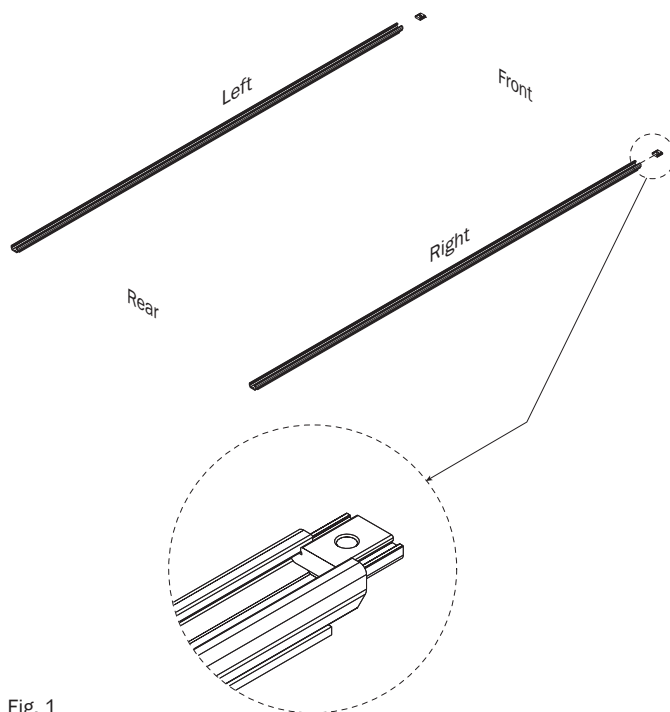
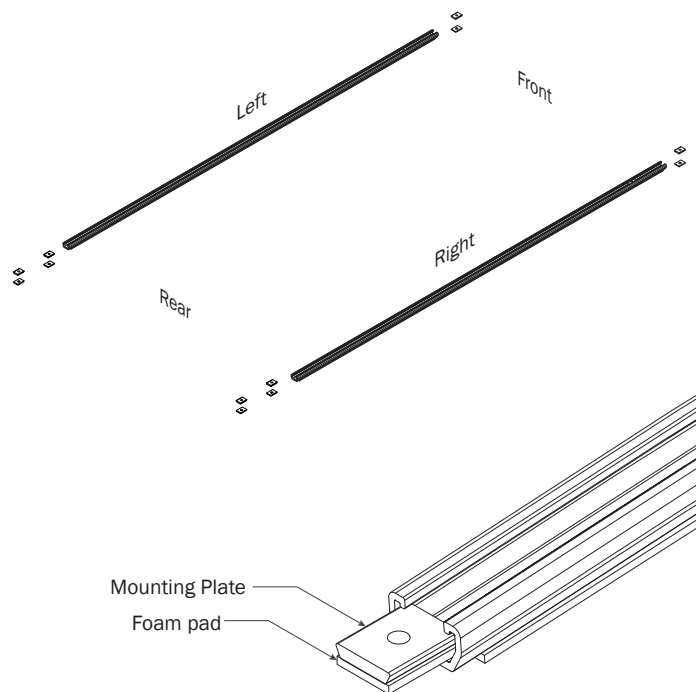

Fig. 1



1.3

Install three sets of Channel Hardware per channel as shown below.



1.4

Install the fasteners through the innermost factory roof holes as shown then torque the nuts to 60 in-lbs.

Do not install or fasten Hardware to the outer front and rear roof holes until Step 1.9.

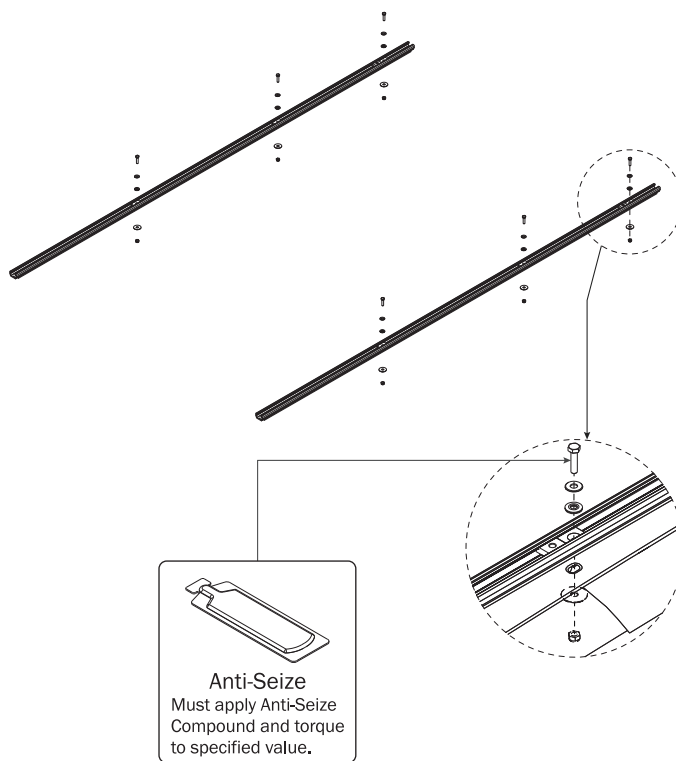

1.5

Install the front Mounting Brackets as shown and slide into position over the Bracket Nut.

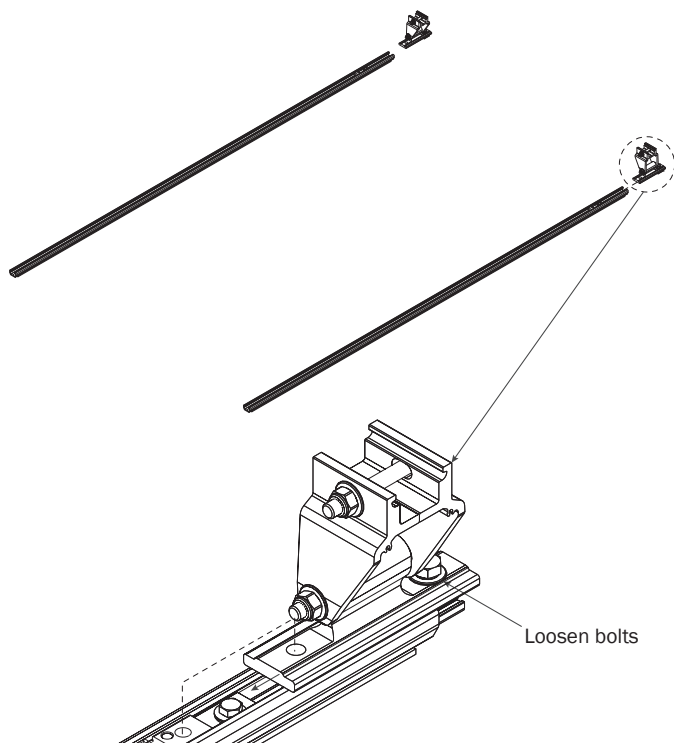

1.6

Reinstall the Mounting Bracket Nut hardware as shown, but do not tighten.

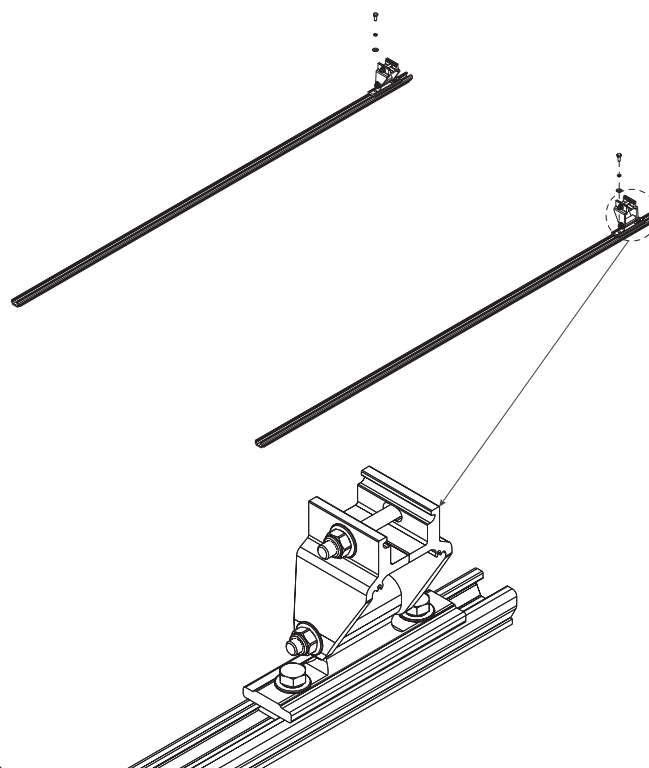



## CROSSBARS

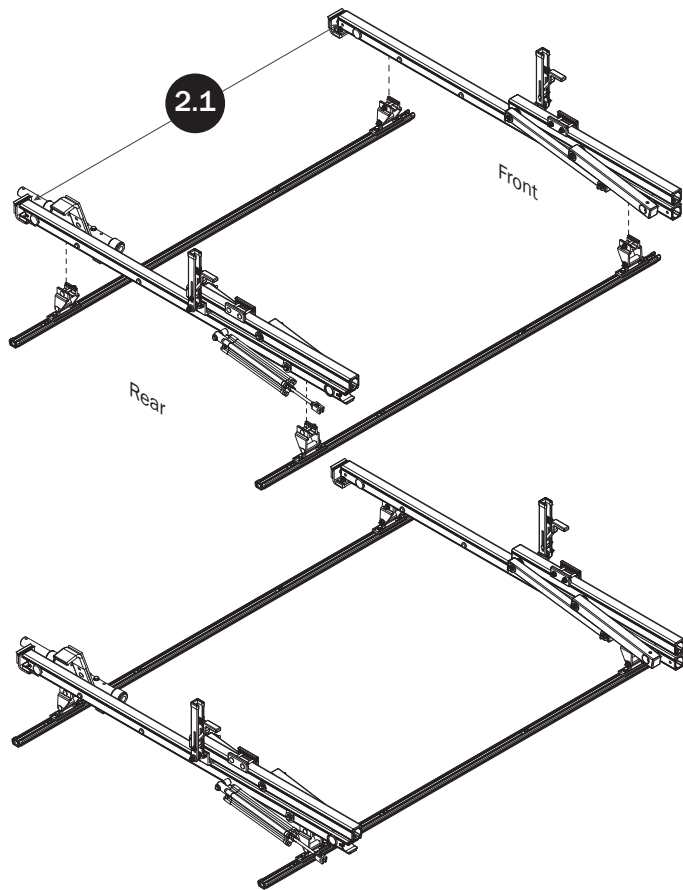

## CROSSBAR ADJUSTMENT

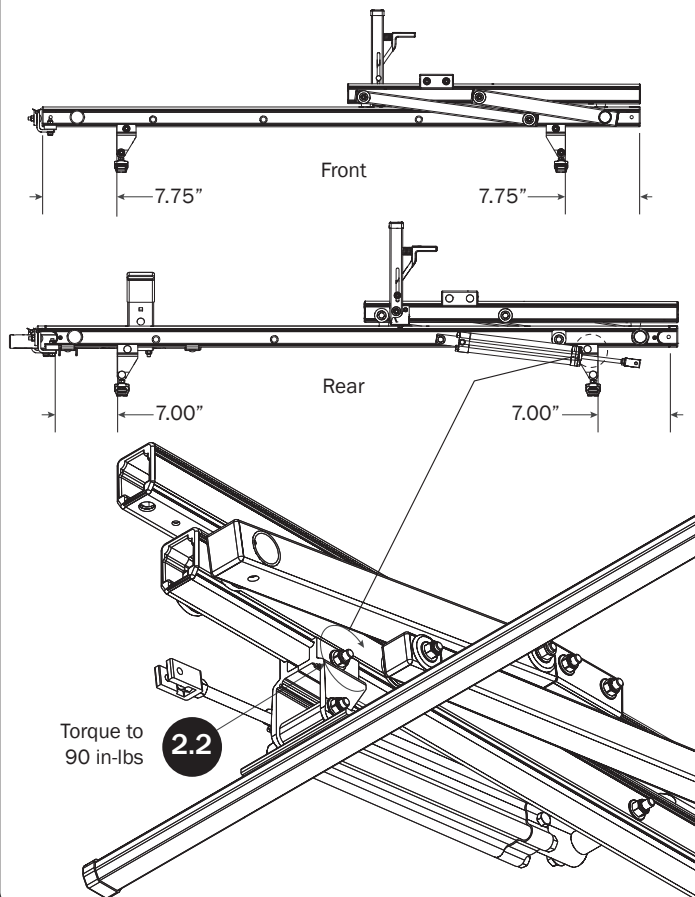

## REAR DRIVE SHAFT

NOTE: For instructional clarity, the FBM Mounting System will not be shown.

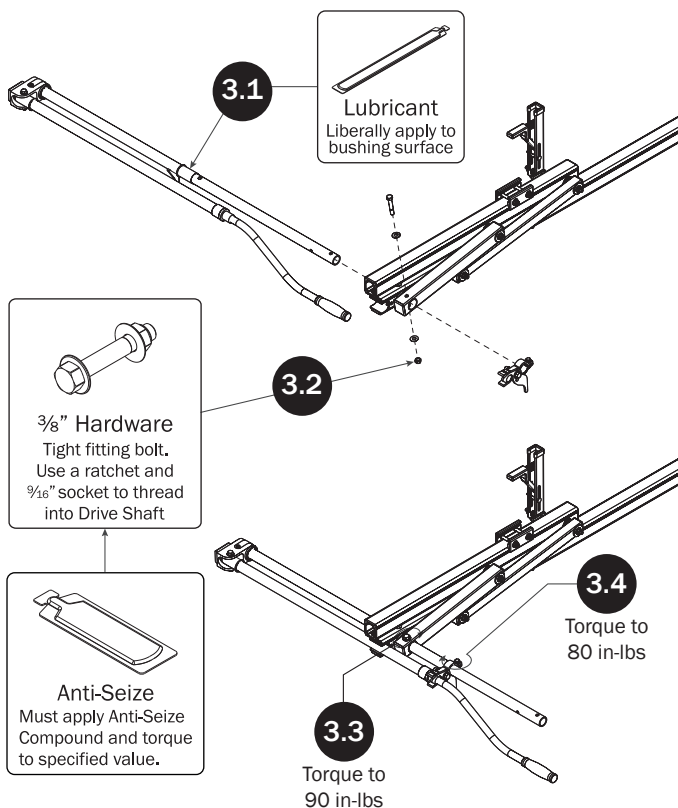

## CYLINDER HARDWARE

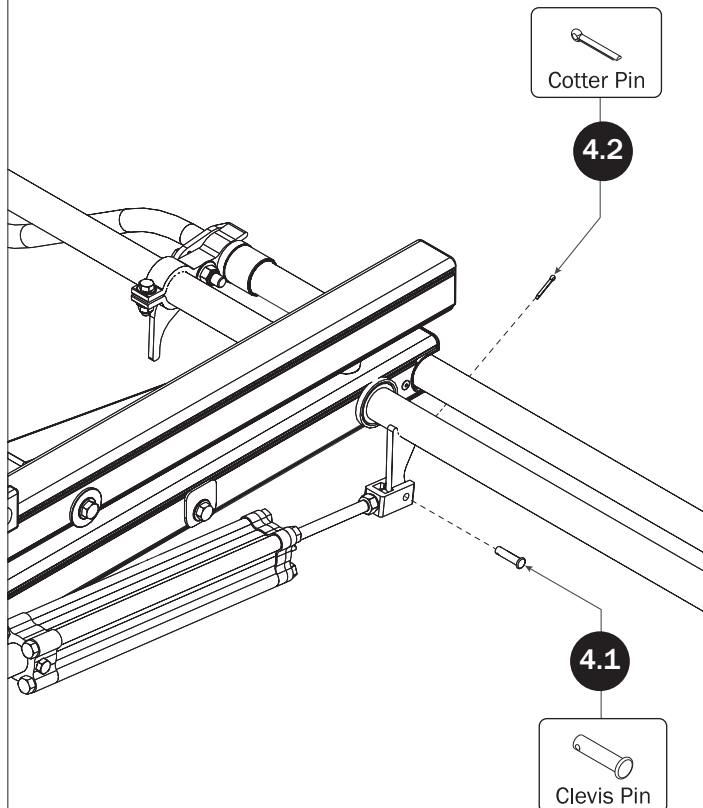

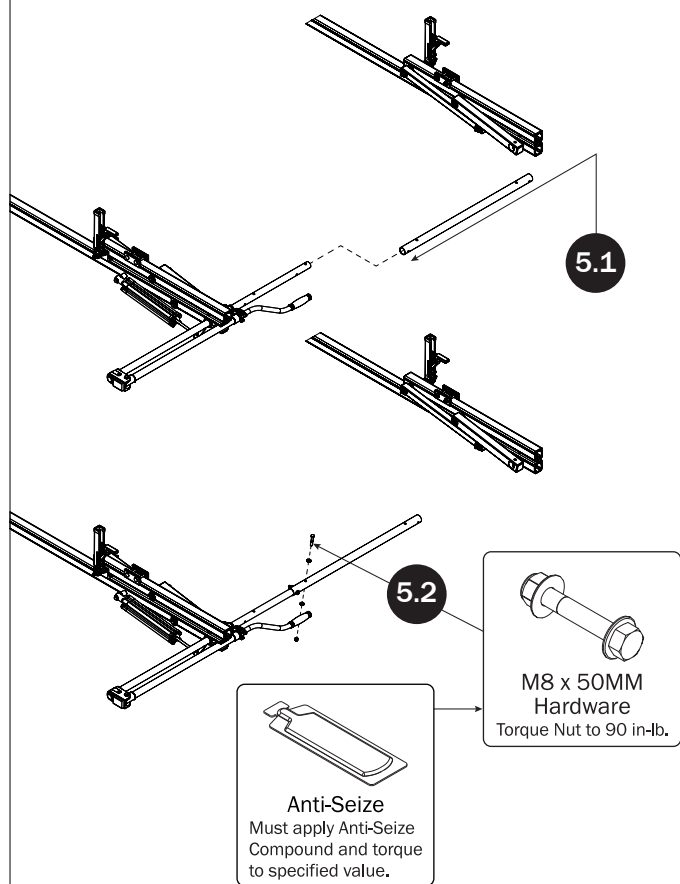
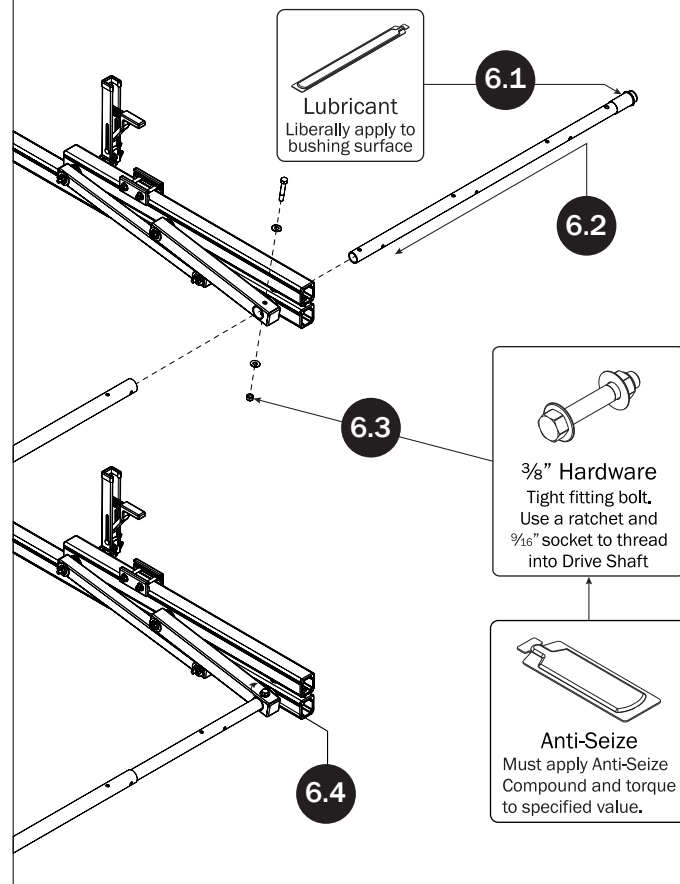
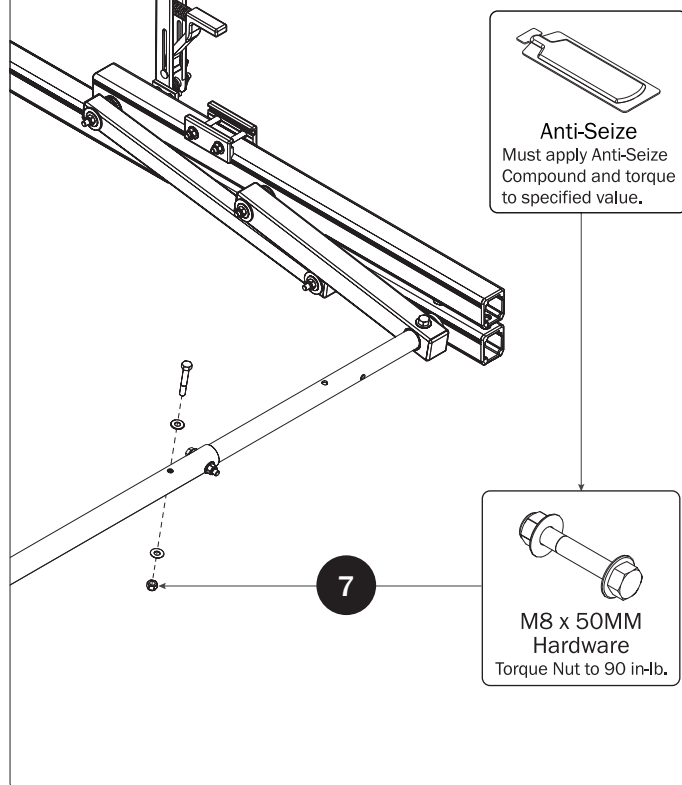
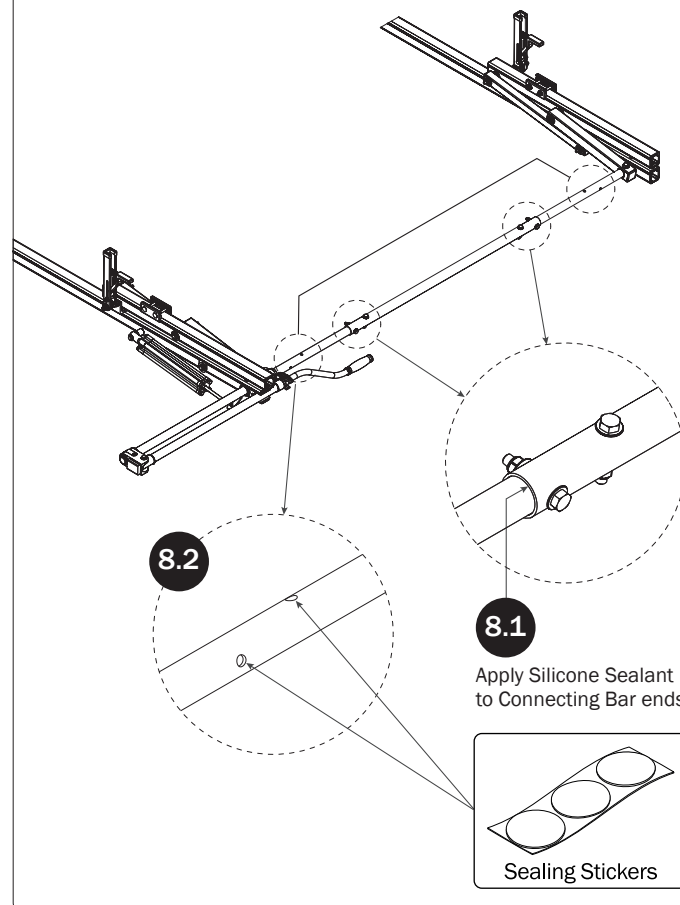

**CONNECTING BAR****FRONT DRIVE SHAFT****CONNECTING BAR FASTENERS****DRIVE SHAFT SEALING**



## L POSTS

### SEE QUICK START GUIDE FOR ADJUSTMENTS

**NOTE:** The Auto Clamps may come preset from the factory for packaging purposes only. To assemble the L Posts to the Crossbars, the Auto Clamps may need to be repositioned.

Ensure the Auto Clamp Spring is seated into the spring catch

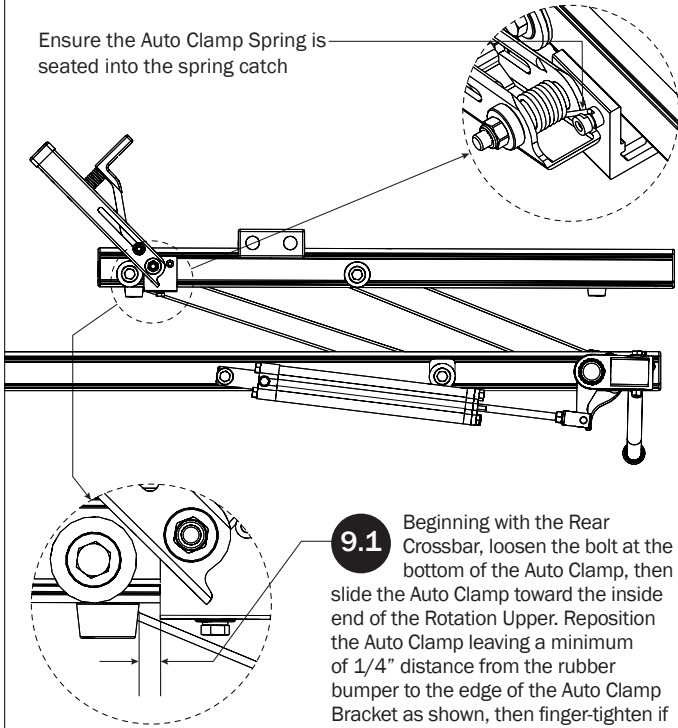

- 9.1** Beginning with the Rear Crossbar, loosen the bolt at the bottom of the Auto Clamp, then slide the Auto Clamp toward the inside end of the Rotation Upper. Reposition the Auto Clamp leaving a minimum of 1/4" distance from the rubber bumper to the edge of the Auto Clamp Bracket as shown, then finger-tighten if adjusting later, or torque to 80 in-lbs.

**9.2**

Prepare the L Post by removing the hex head bolt, lock washer, flat washer, and Bracket Clamp. Retain for installation Steps 9.4—9.8.

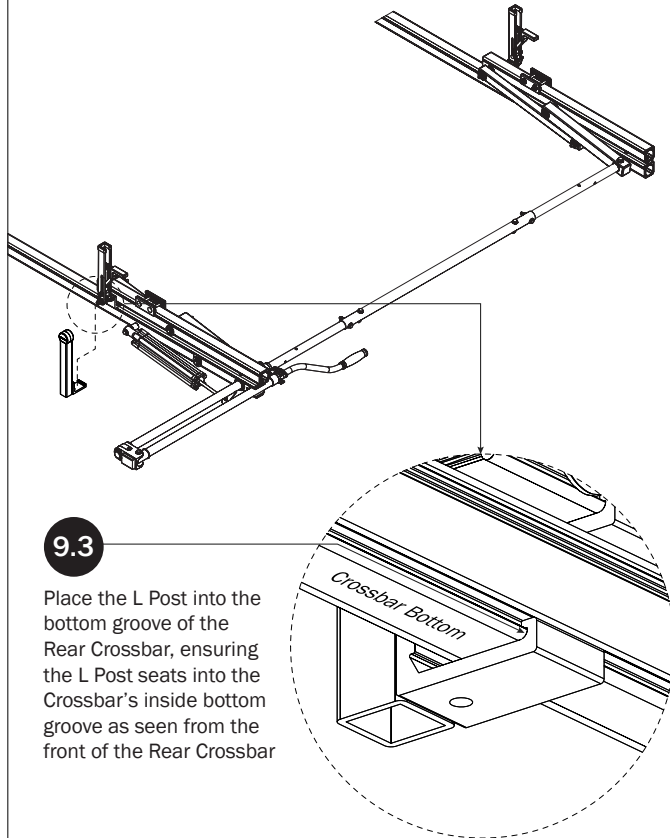

**9.3**

Place the L Post into the bottom groove of the Rear Crossbar, ensuring the L Post seats into the Crossbar's inside bottom groove as seen from the front of the Rear Crossbar

**9.4**

Slide L Post Bracket Clamp into bottom groove, then slide into L Post Bracket as shown

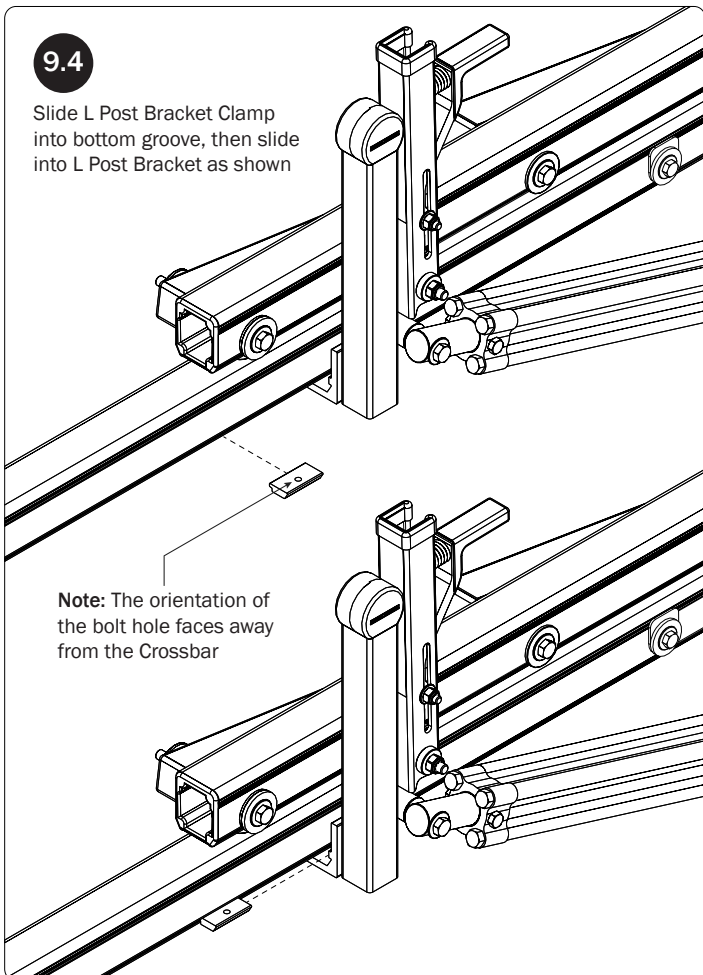

**Note:** The orientation of the bolt hole faces away from the Crossbar

**9.5**

Bracket Clamp sits in L Post Bracket as shown

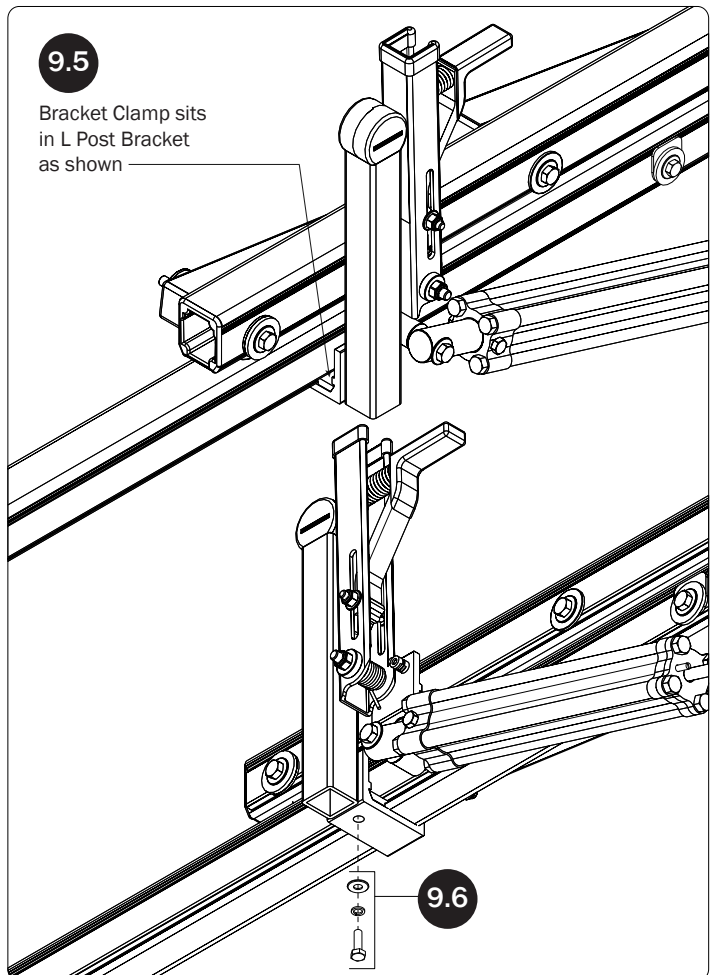

**9.6**

9.7

Slide the L Post until parallel to the Auto Clamp and the gap between the two is even from top to bottom

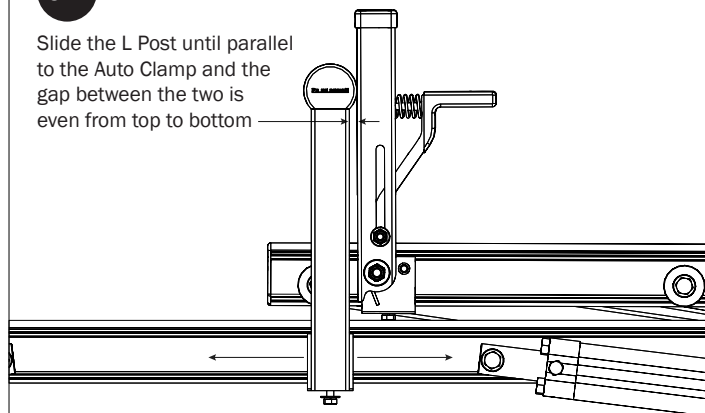

Torque to 80 in-lbs

9.8

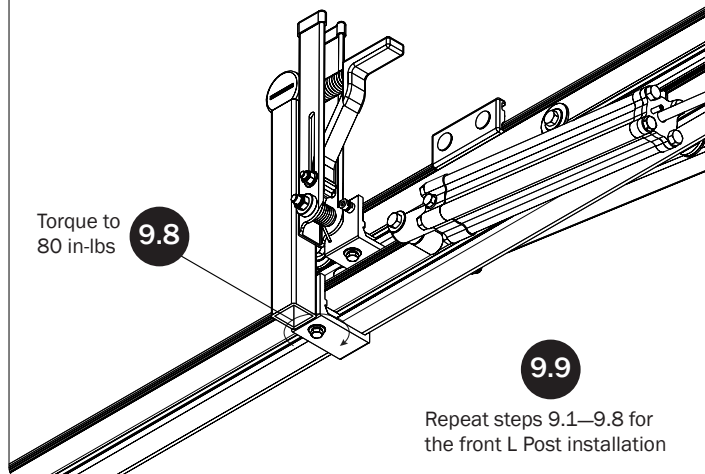

9.9

Repeat steps 9.1—9.8 for the front L Post installation

10.2

Refer to the Quick Start Guide for Z Post positioning.

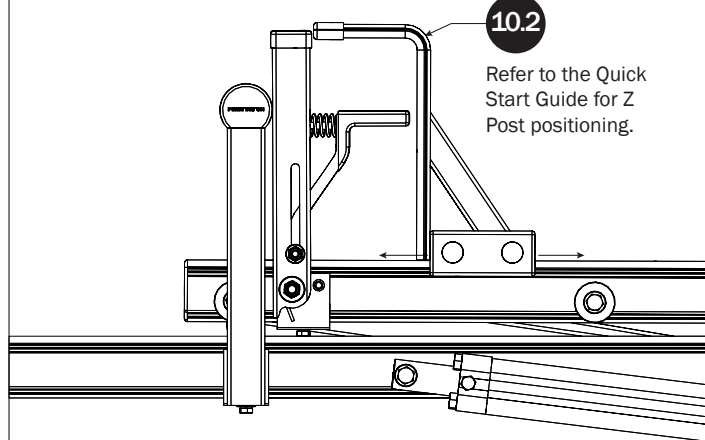

10.3

Torque to 90 in-lbs

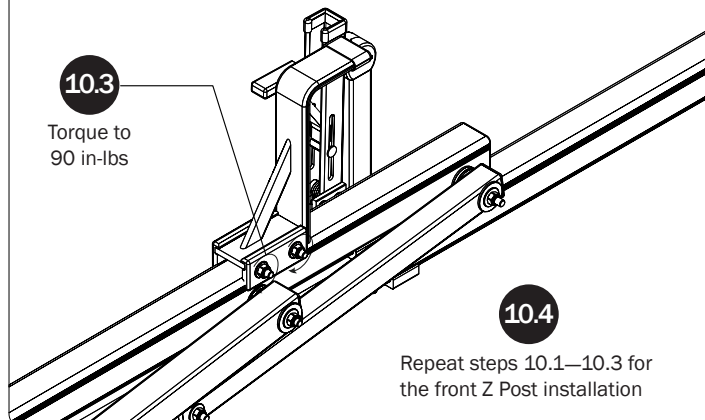

10.4

Repeat steps 10.1—10.3 for the front Z Post installation

## Z POSTS

SEE QUICK START GUIDE FOR ADJUSTMENTS

10.1

Slide the Z Post into the Mounting Clamp Assembly

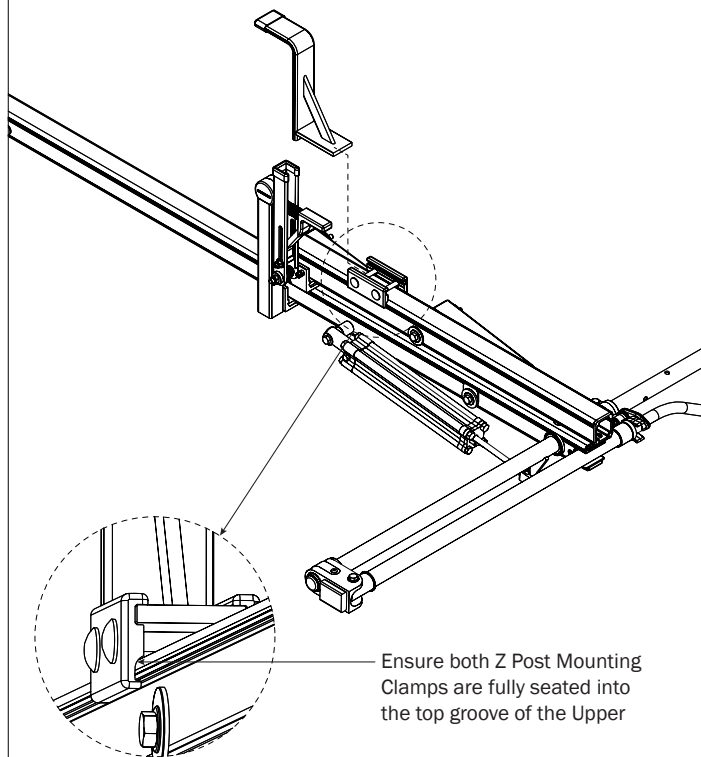

Ensure both Z Post Mounting Clamps are fully seated into the top groove of the Upper

## LEFT CLAMP DOWN

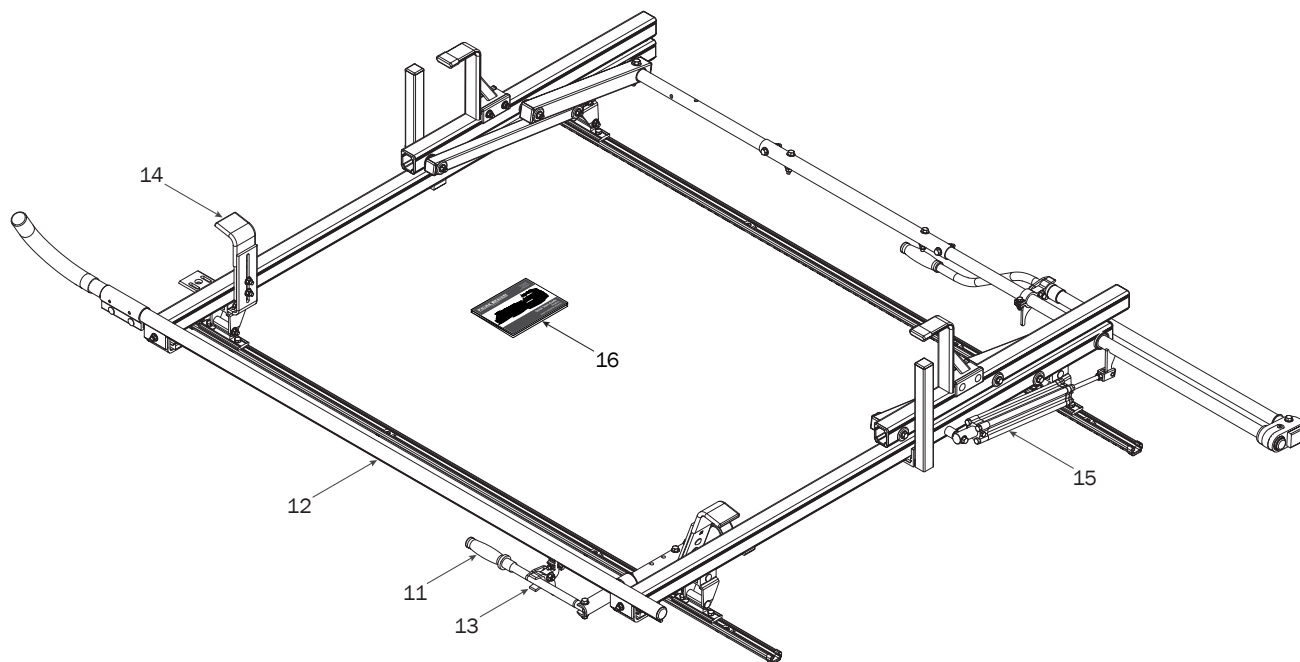

## CLAMP DOWN HANDLE

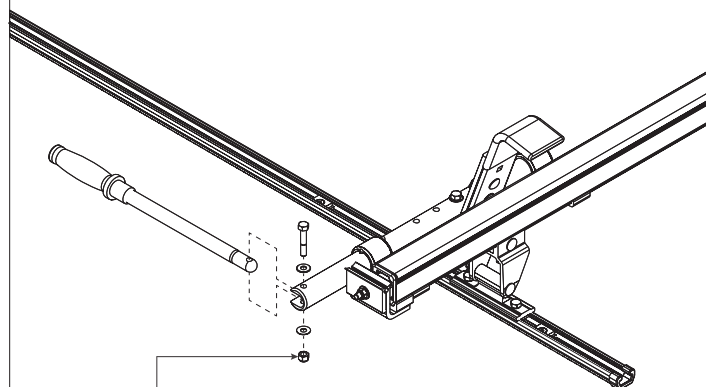

11

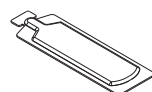

Anti-Seize  
Must apply Anti-Seize  
Compound and torque  
to specified value.

## CLAMP DOWN TUBE

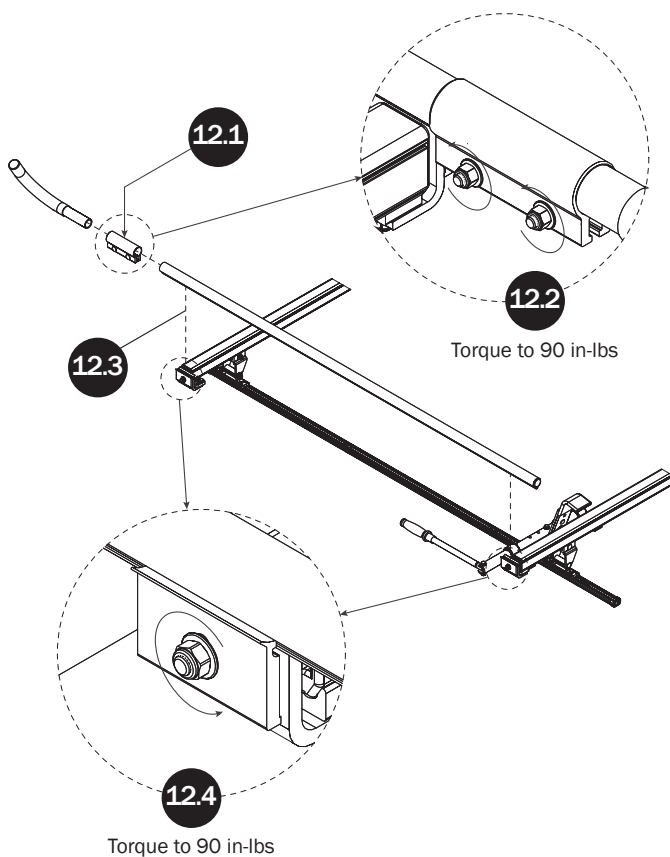

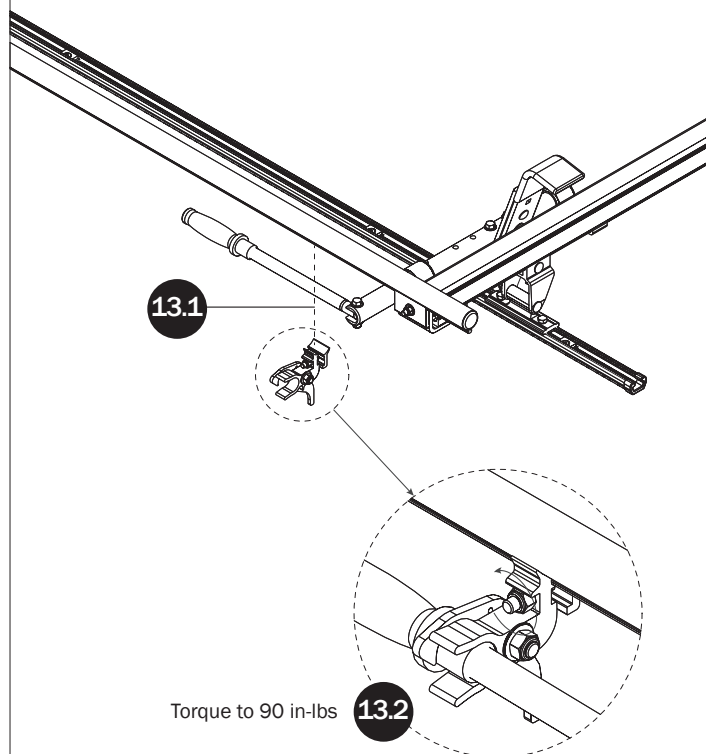
**HANDLE LATCH****FRONT LADDER HOOK**

SEE QUICK START GUIDE FOR ADJUSTMENTS

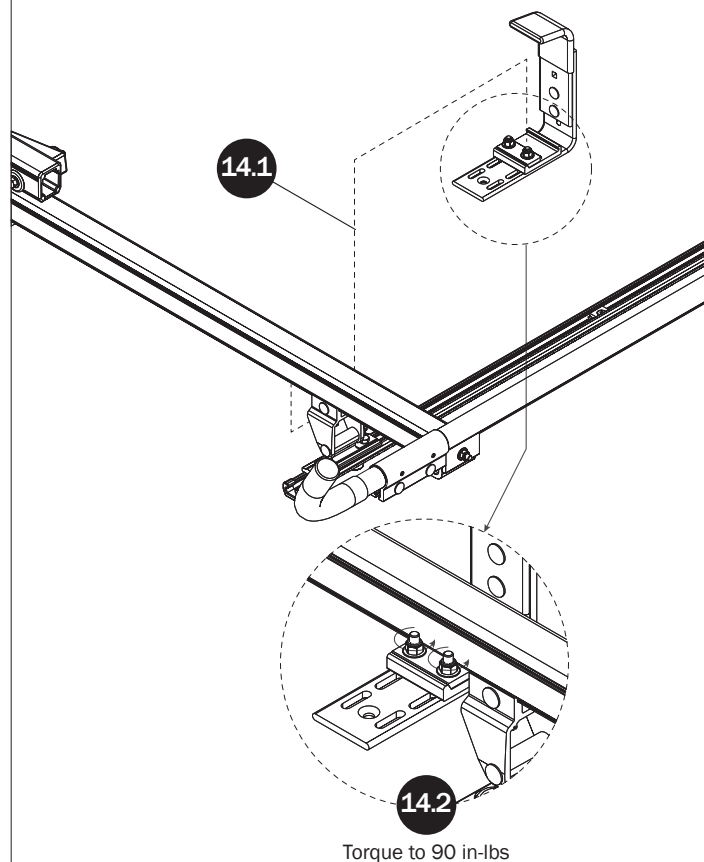
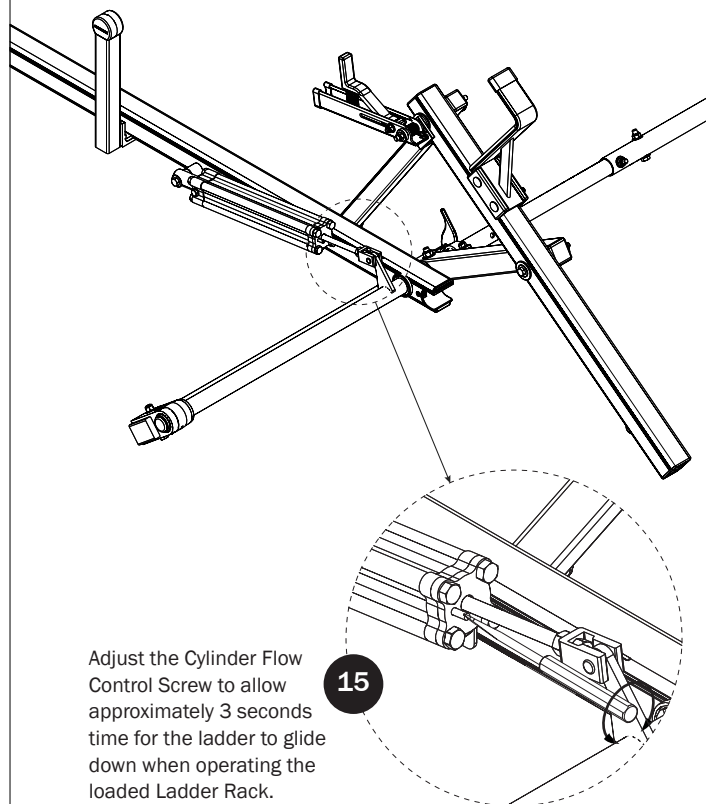
**CYLINDER ADJUSTMENT****QUICK START GUIDE**

- 16 Place the Quick Start Guide into the vehicle's glove box for ladder setup and adjustment.

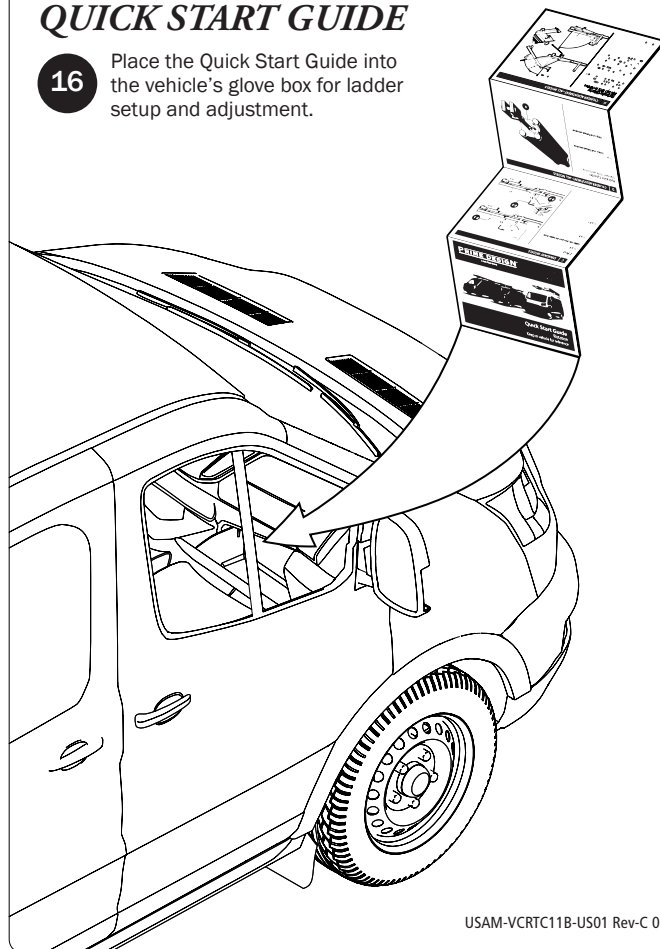

USAM-VCRTC11B-US01 Rev-C 0718