

# PRIME DESIGN™

A Safe Fleet Brand

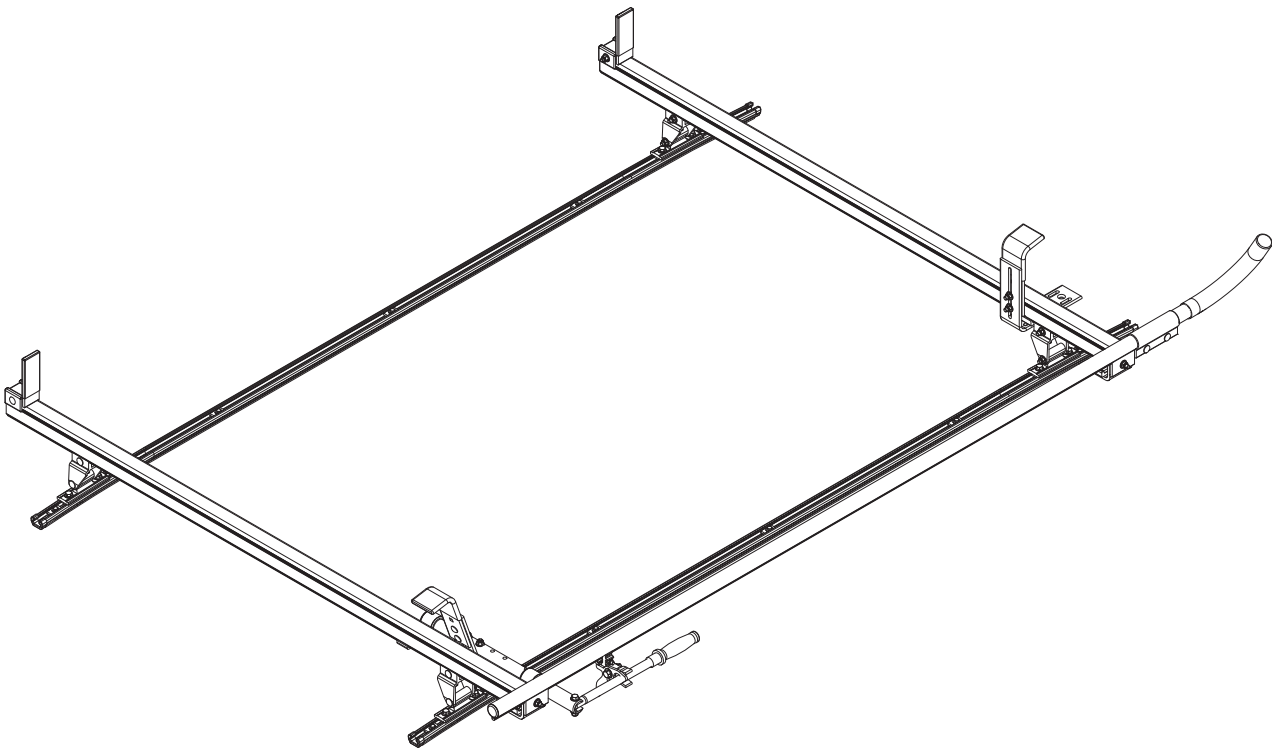

# VBC RCB

## CONTENTS OVERVIEW

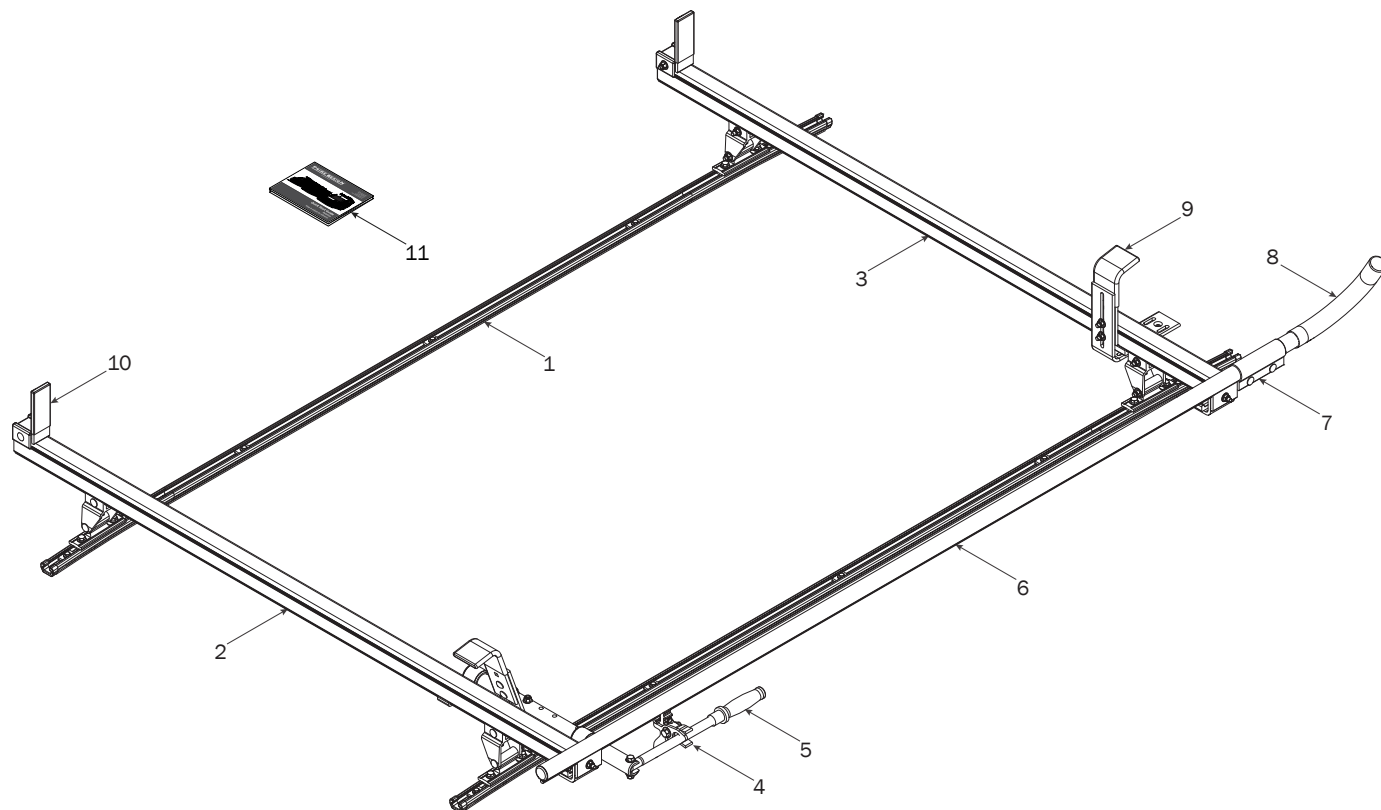

- 1—FBM-0007 ..... (Qty 1)  
Channels with hardware



Channels (2X)



M6 Locknut (10X)

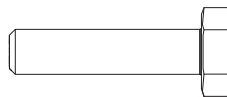

M6 x 30MM Bolt (10X)



End Caps (4X)



Brackets (4X)

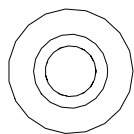

M6 Sealing Washer (10X)

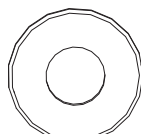

1/4" Flat Washer (10X)

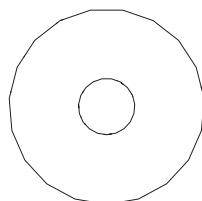

1/4" Washer (10X)

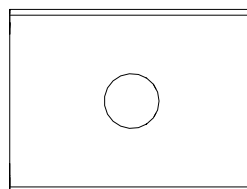

Mounting Plate (10X)

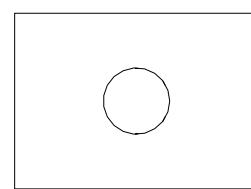

Foam Pad (10X)

- 2—Rear Crossbar Assembly ..... (Qty 1)



- 3—Front Crossbar Assembly ..... (Qty 1)



- 4—Handle Latch Assembly ..... (Qty 1)

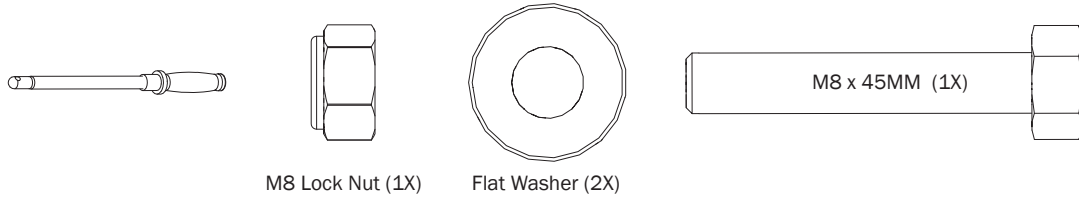
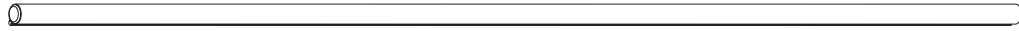
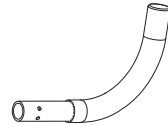

## 5—Clamp Down Handle Assembly ..... (Qty 1)

6—Clamp Down Tube ..... (Qty 1)  
80.00"7—Quick Clamp Tube Splice Assembly ..... (Qty 1)  
5.00"8—Removeable Horn with Cap ..... (Qty 1)  
15.00"

## 9—Front Hook Assembly ..... (Qty 1)

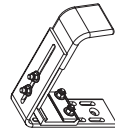
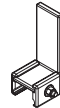
10—Ladder Stop Assembly ..... (Qty 2)  
1.75"11—USQSG-Ergorack ..... (Qty 1)  
Quick Start Guide, Clamp Down

## 12—Anti-Seize..... (Qty 1)

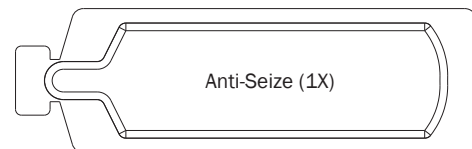

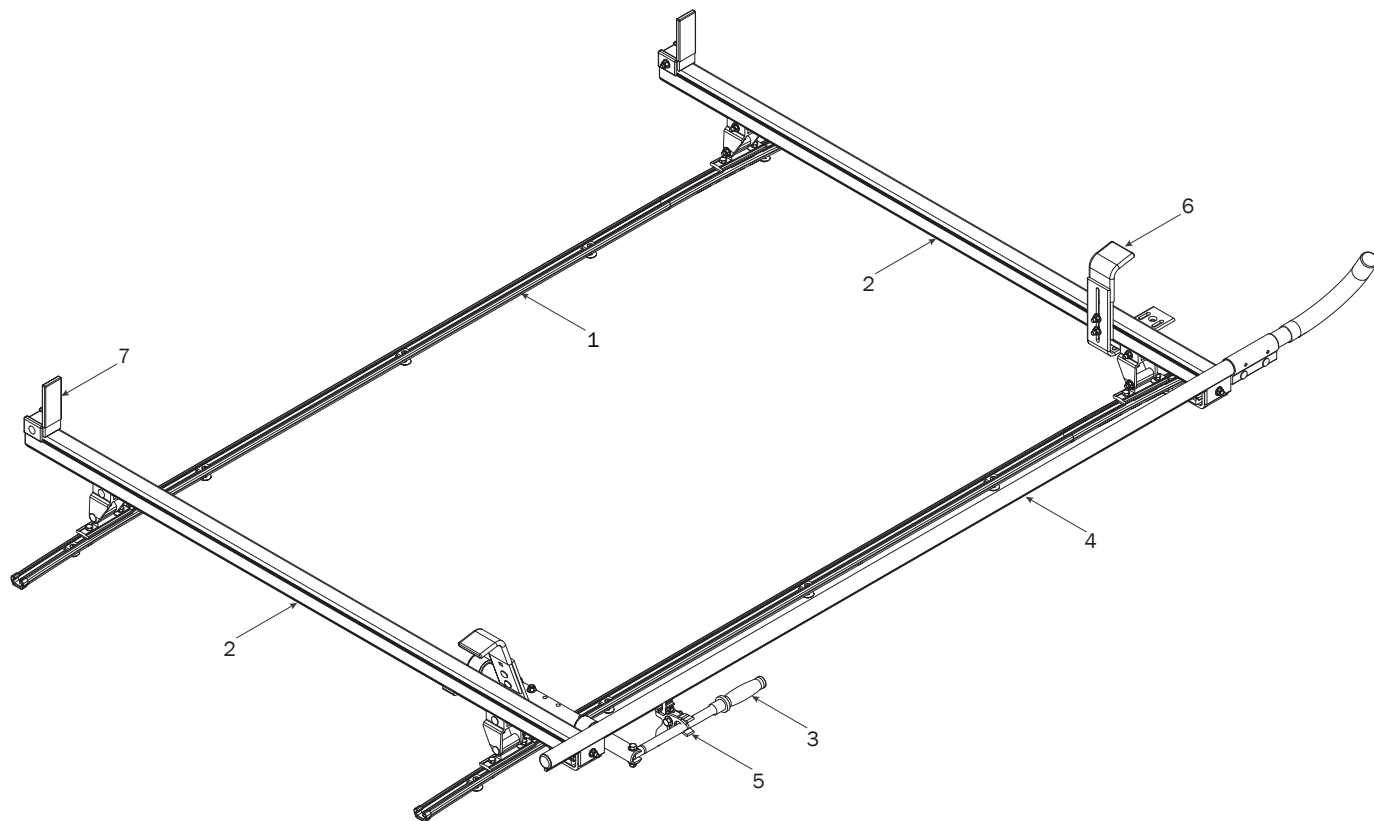
**RIGHT CLAMP DOWN ASSEMBLY****FBM-0007**

- 1.1** Install three sets of Channel Hardware per channel as shown below.

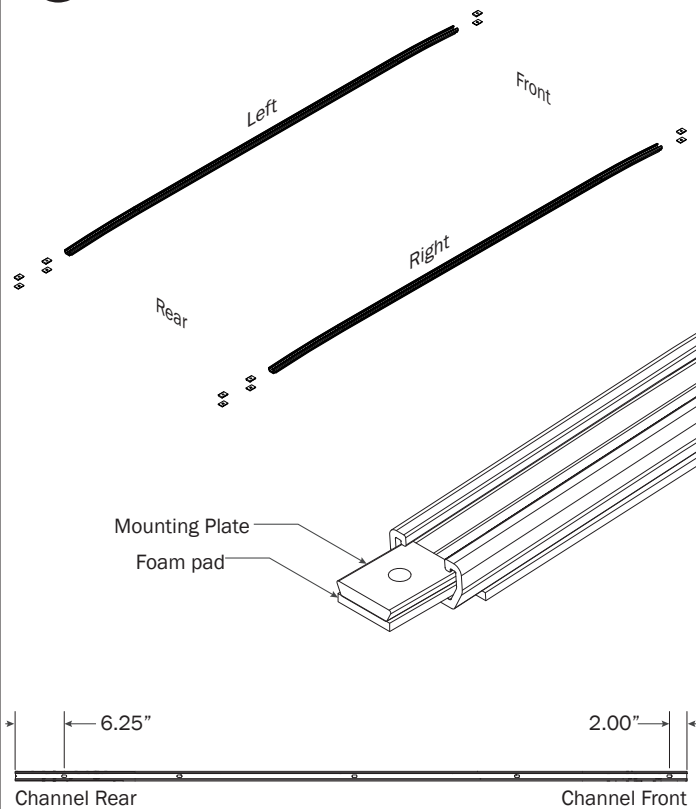

- 1.2** Install the fasteners through the innermost factory roof holes as shown then torque the nuts to 60 in-lbs.

Do not install or fasten Hardware to the outer front and rear roof holes until Step 1.4.

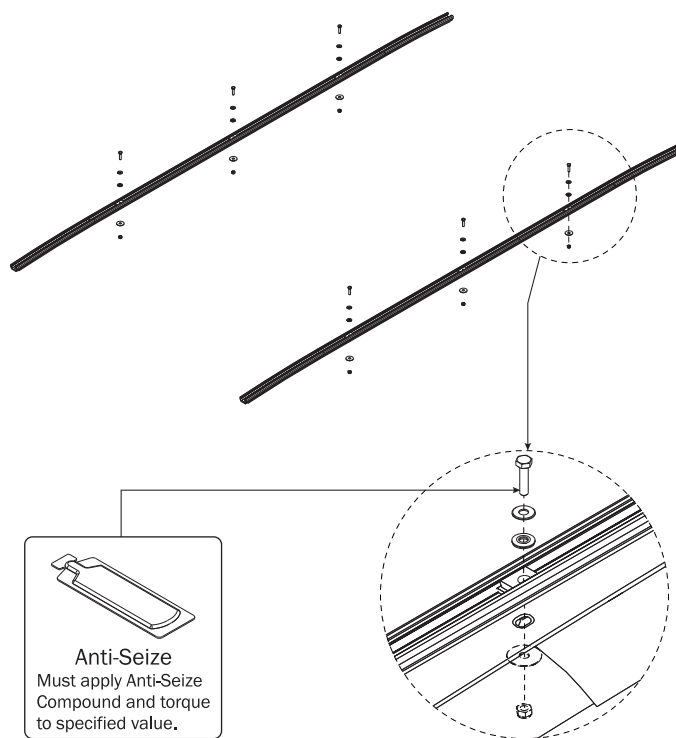

1.3

Install the Mounting Brackets along with the remaining Channel Hardware as shown below.

Do not tighten the Mounting Brackets until Step 1.5.

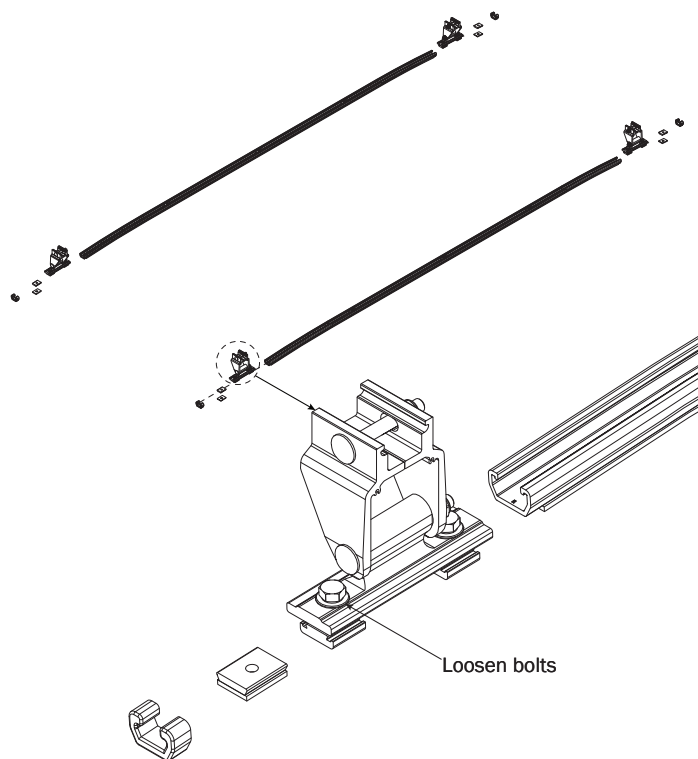

1.4

Install the remaining front and rear fasteners through the factory roof holes as shown then torque the nuts to 60 in-lbs.

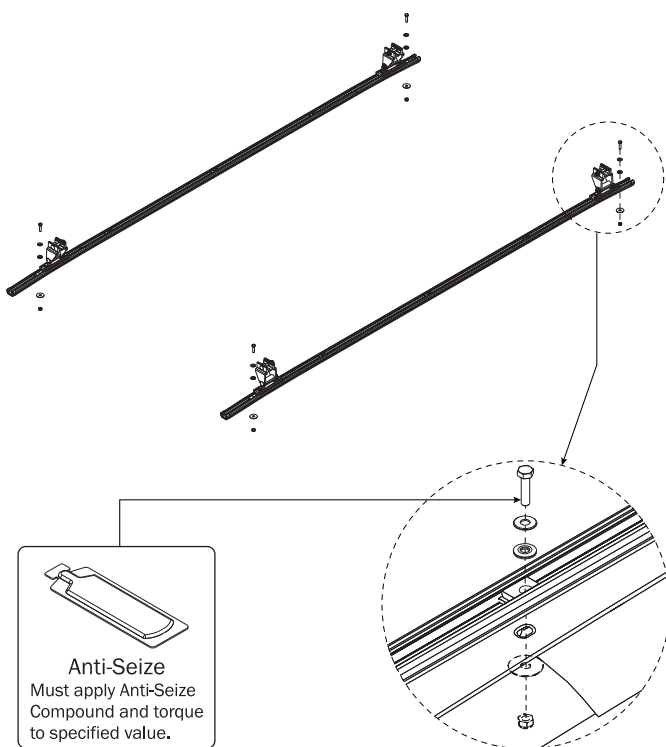

1.5

Set to distances then torque all the Mounting Brackets to 90 in-lbs.

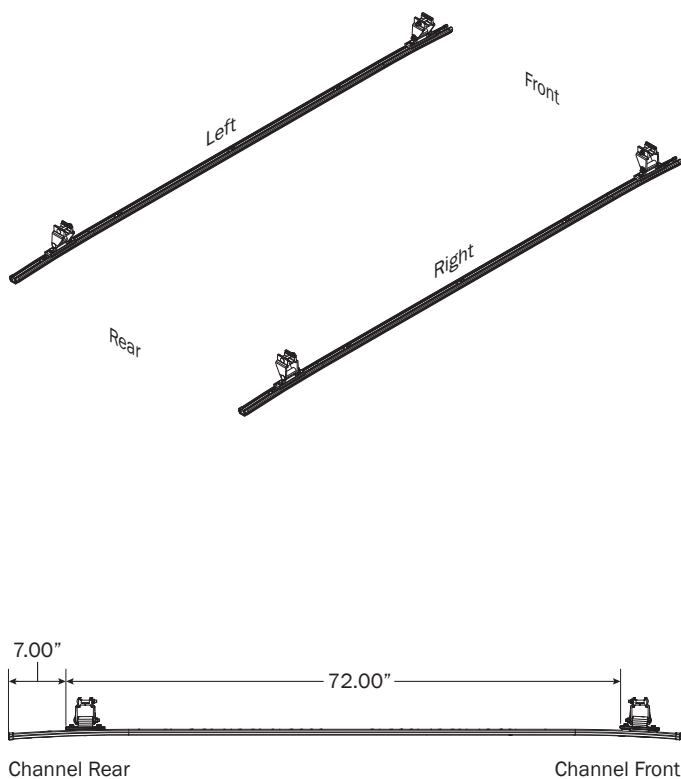

5

VBC-TC11B ASSEMBLY INSTRUCTIONS—RIGHT SIDE CLAMP DOWN

**PRIME DESIGN**  
A Safe Fleet Brand

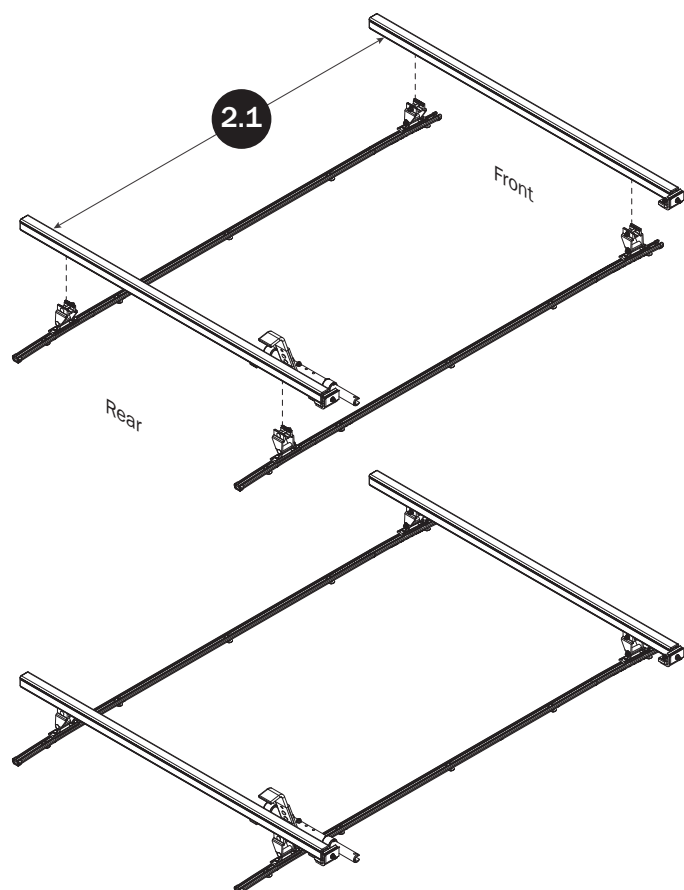
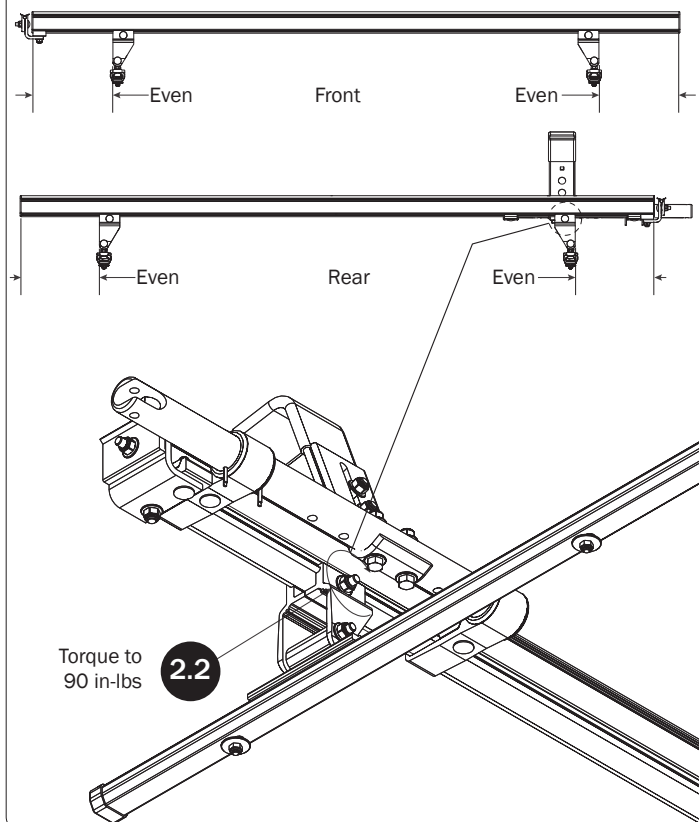
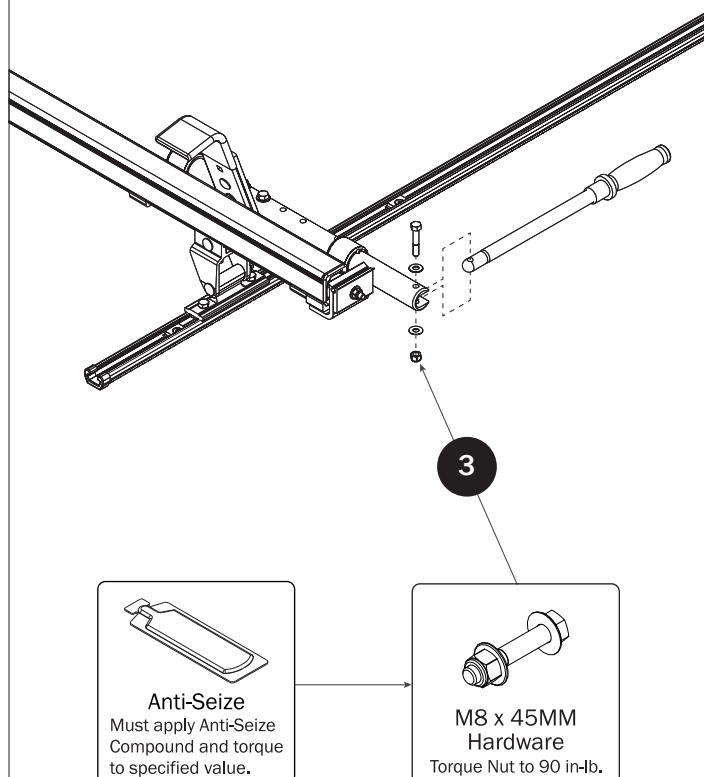
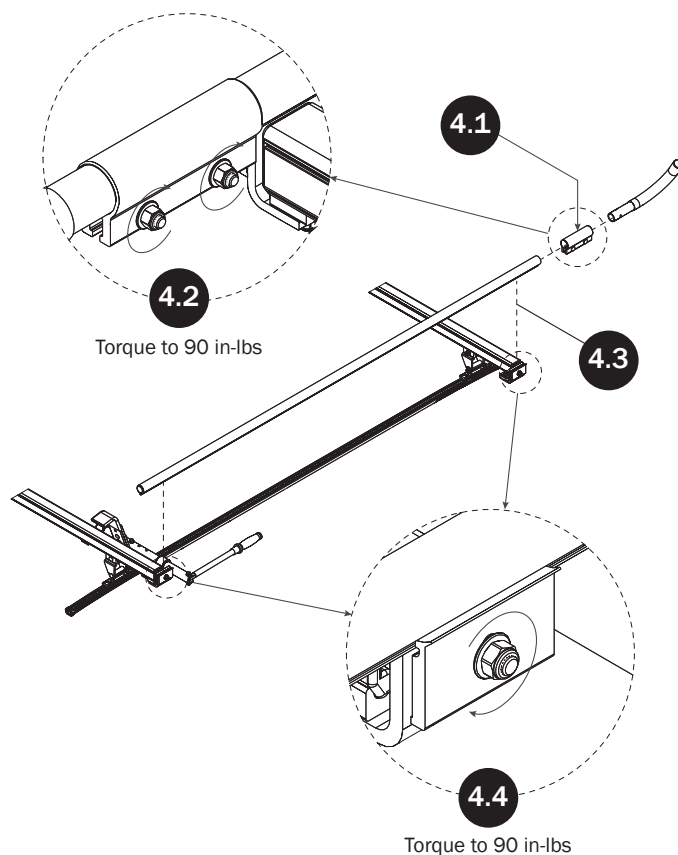
**CROSSBARS****CROSSBAR ADJUSTMENT****CLAMP DOWN HANDLE****CLAMP DOWN TUBE**

## HANDLE LATCH

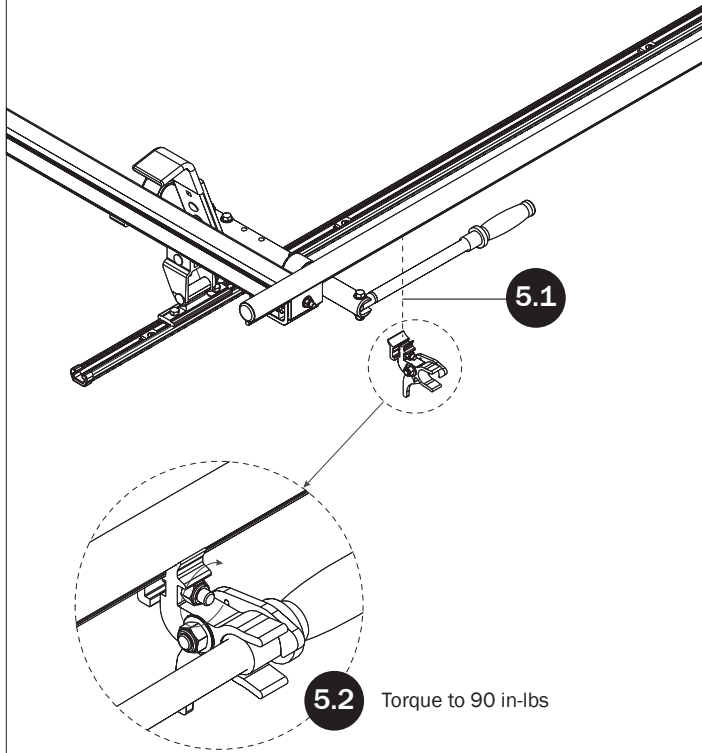

## FRONT LADDER HOOK

SEE QUICK START GUIDE FOR ADJUSTMENTS

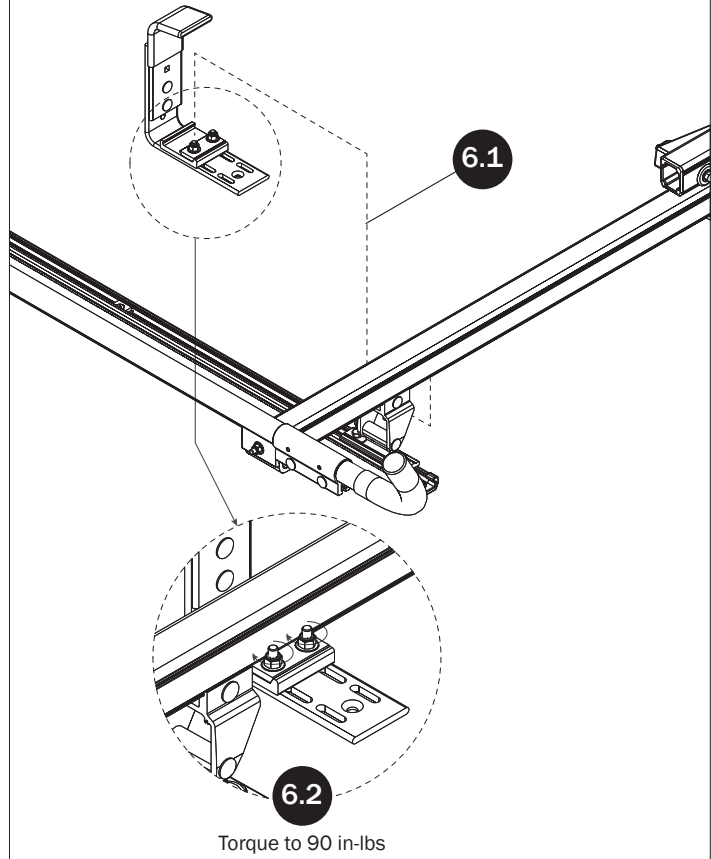

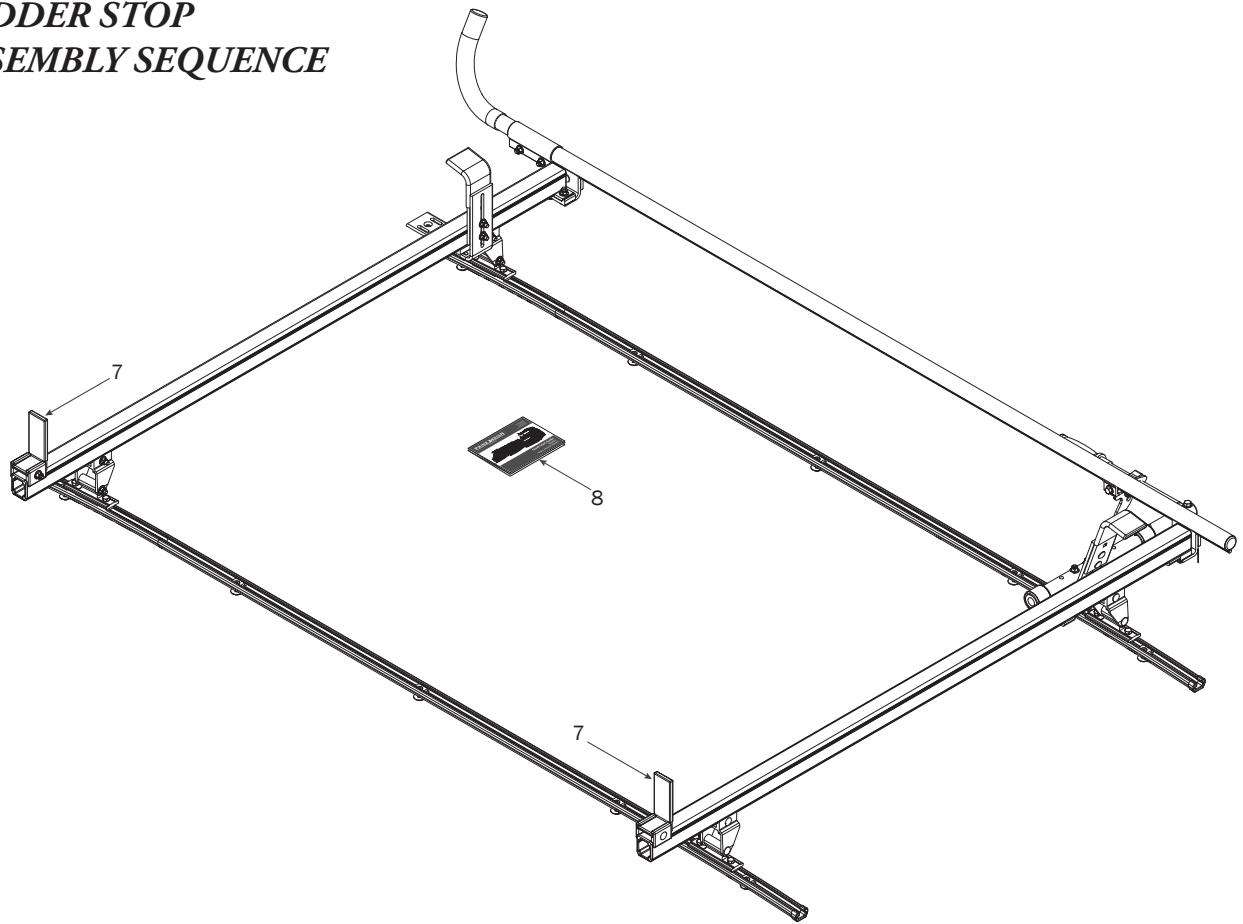
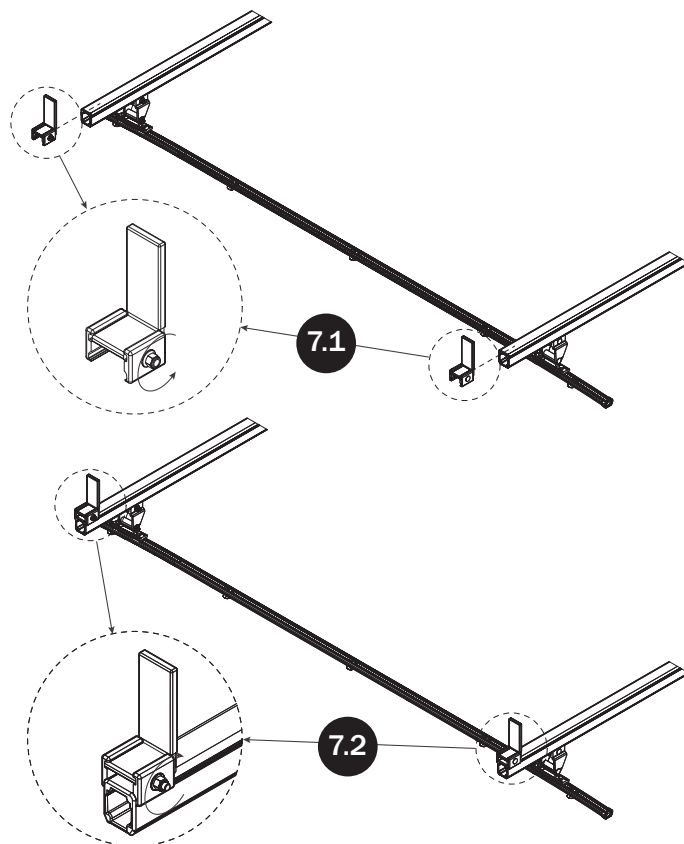
**LADDER STOP  
ASSEMBLY SEQUENCE****LADDER STOPS****QUICK START GUIDE****8**

Place the Quick Start Guide into the vehicle's glove box for ladder setup and adjustment.

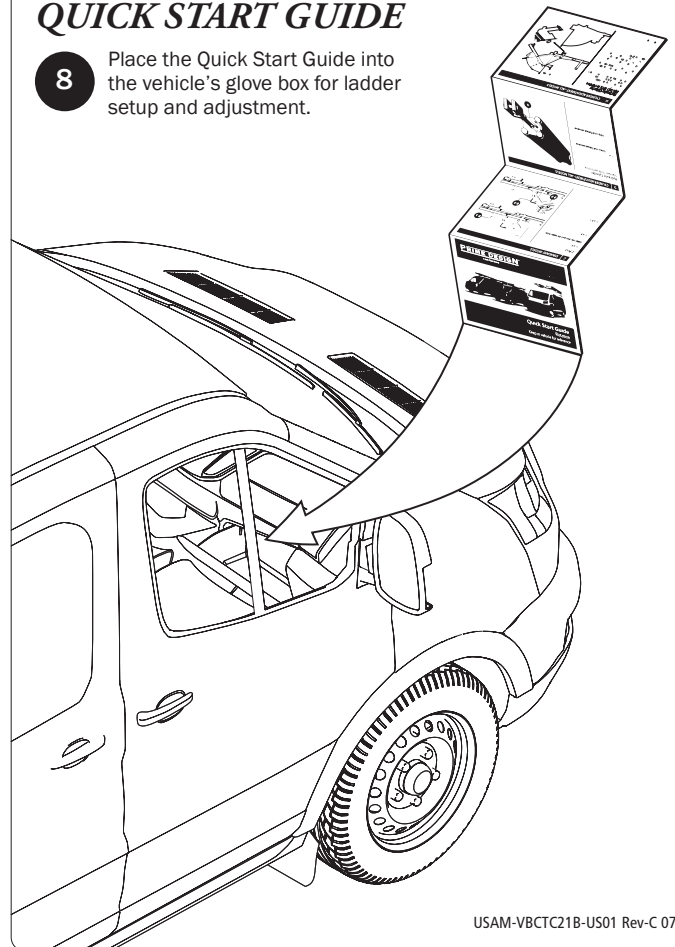

USAM-VBCTC21B-US01 Rev-C 0718