

PRIME DESIGN™

A Safe Fleet Brand

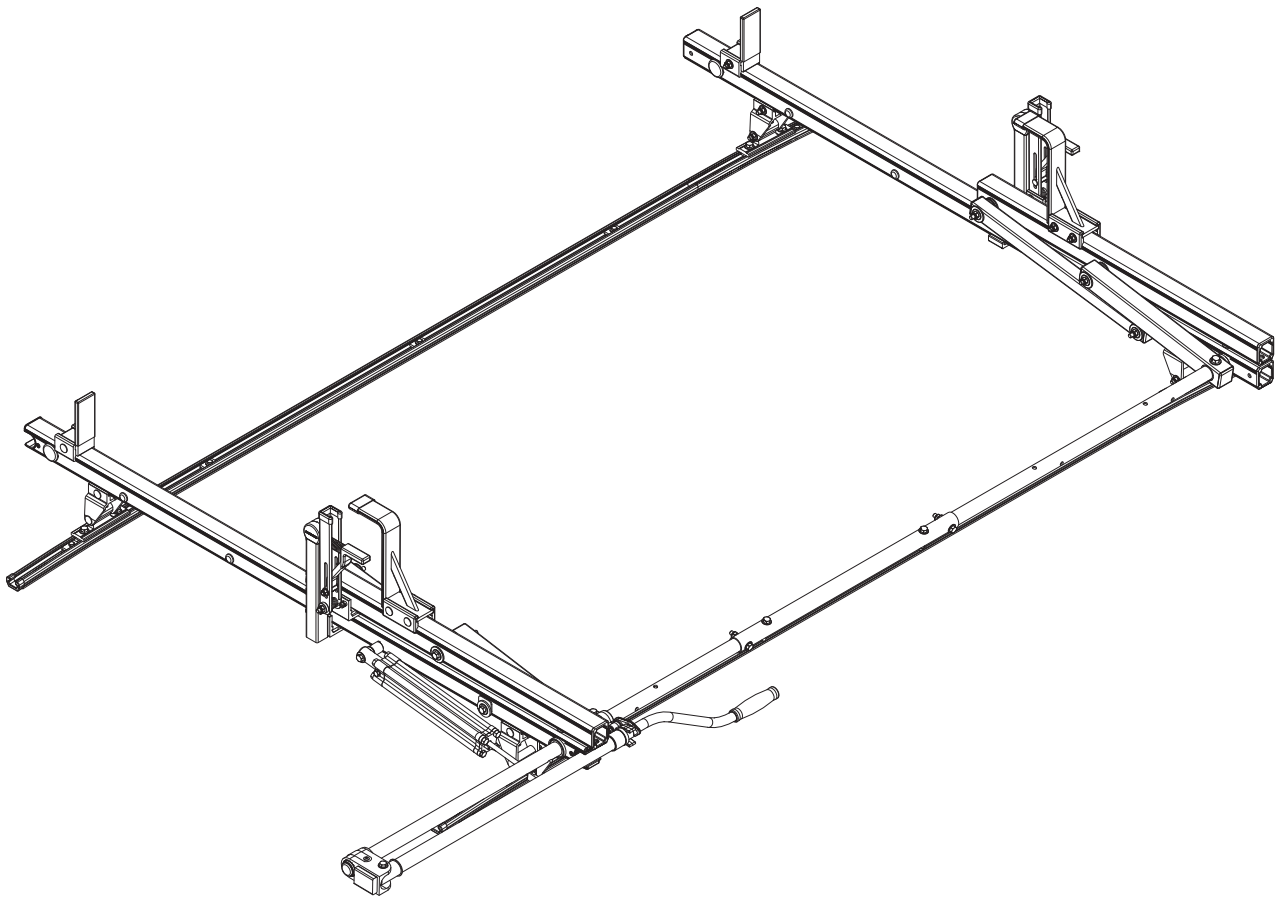

VBR CORP

CONTENTS OVERVIEW

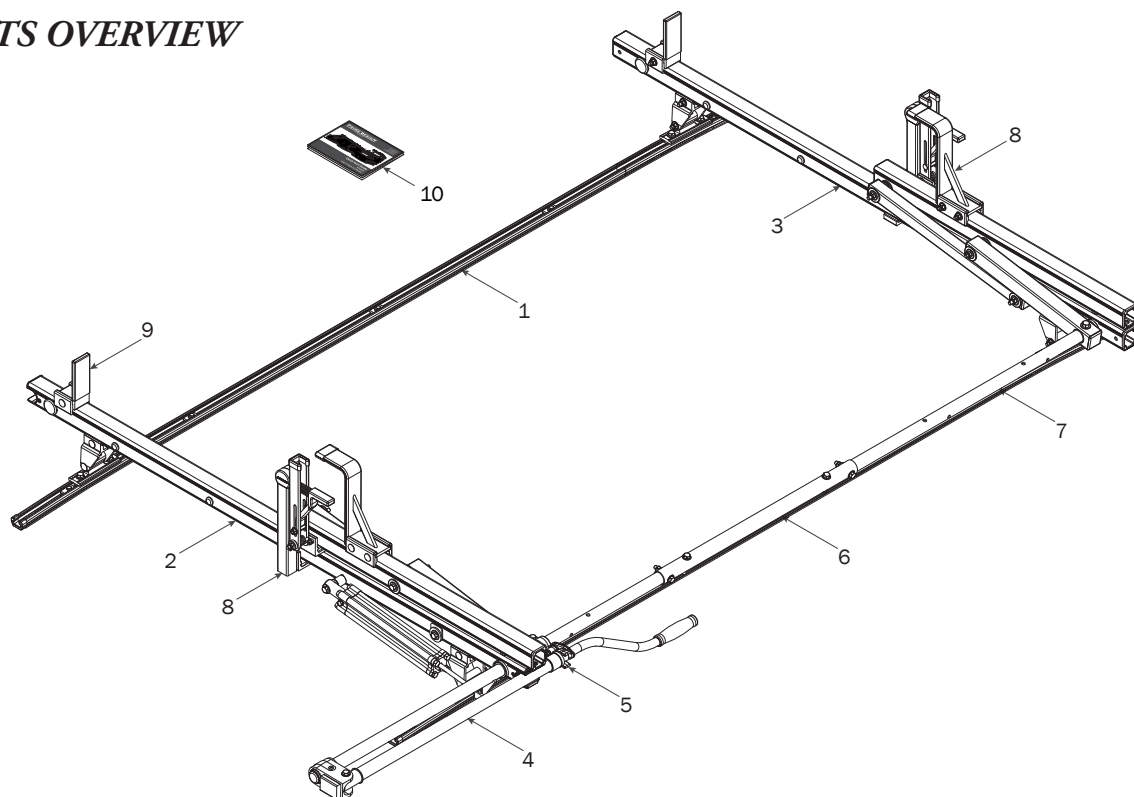

1—FBM-0007 (Qty 1)
Channels with hardware



Channels (2X)

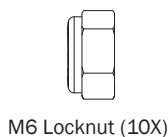

M6 Locknut (10X)

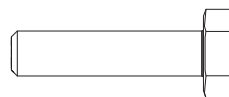

M6 x 30MM Bolt (10X)



End Caps (4X)



Brackets (4X)

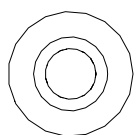

M6 Sealing Washer (10X)

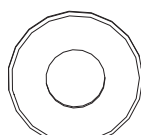

1/4" Flat Washer (10X)

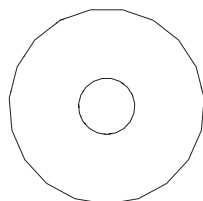

1/4" Washer (10X)

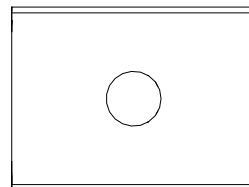

Mounting Plate (10X)

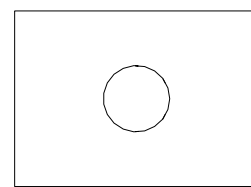

Foam Pad (10X)

2—Rear Crossbar Assembly (Qty 1)

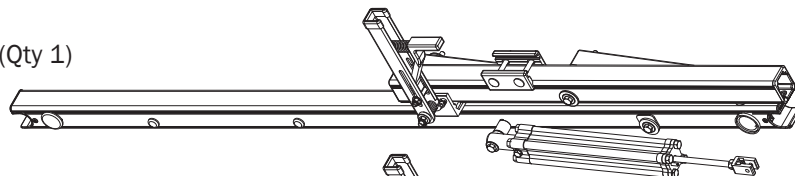

3—Front Crossbar Assembly (Qty 1)

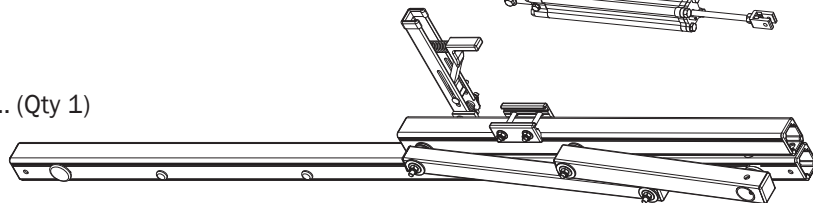

4—Rear Drive Shaft (Qty 1)
Right Hand, B4 Version, 46.00"

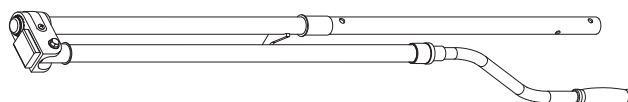

5—Handle Latch Assembly (Qty 1)



6—Connecting Bar..... (Qty 1)
2.00'



7—Front Drive Shaft..... (Qty 1)
B Version, 35.75"



8—L & Z Post Kit..... (Qty 1)
Adj. Z Post, 7.25", L Post, w/HKT-0160

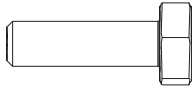

M6 x 20MM (2X)



1/4 Lock Washer (2X)

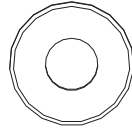

1/4 Flat Washer (2X)

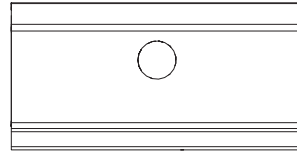

L Post Bracket Clamp (2X)

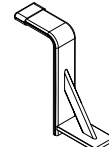

Z Post (2X)

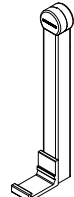

L Post (2X)

9—Ladder Stop Assembly..... (Qty 2)
1.75"

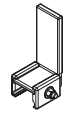

10—USQSG-Ergorack..... (Qty 1)
Quick Start Guide, Rotation



* Once rack installation is complete, place the Quick Start Guide into the vehicle's glove box for future ladder setup and adjustment.

11—HKT-8163-Rotation Hardware Kit..... (Qty 1)
(Not called out in Overview)



Clevis Pin (1X)

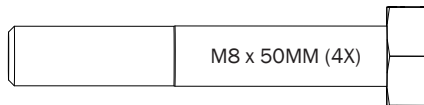

M8 x 50MM (4X)

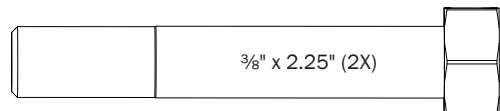

3/8" x 2.25" (2X)

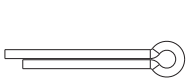

Cotter Pin (1X)

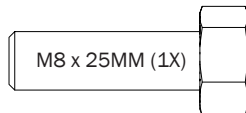

M8 x 25MM (1X)

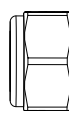

M8 Lock Nut (5X)

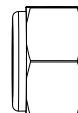

3/8" Lock Nut (2X)

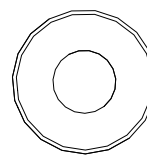

5/16" Flat Washer (10X)

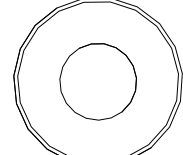

3/8" Flat Washer (4X)

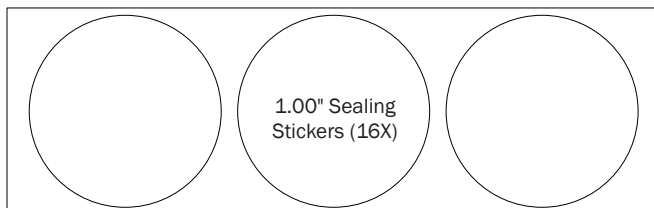

1.00" Sealing
Stickers (16X)



Anti-Seize (1X)

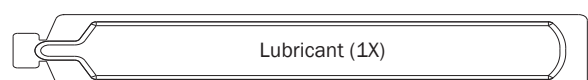

Lubricant (1X)

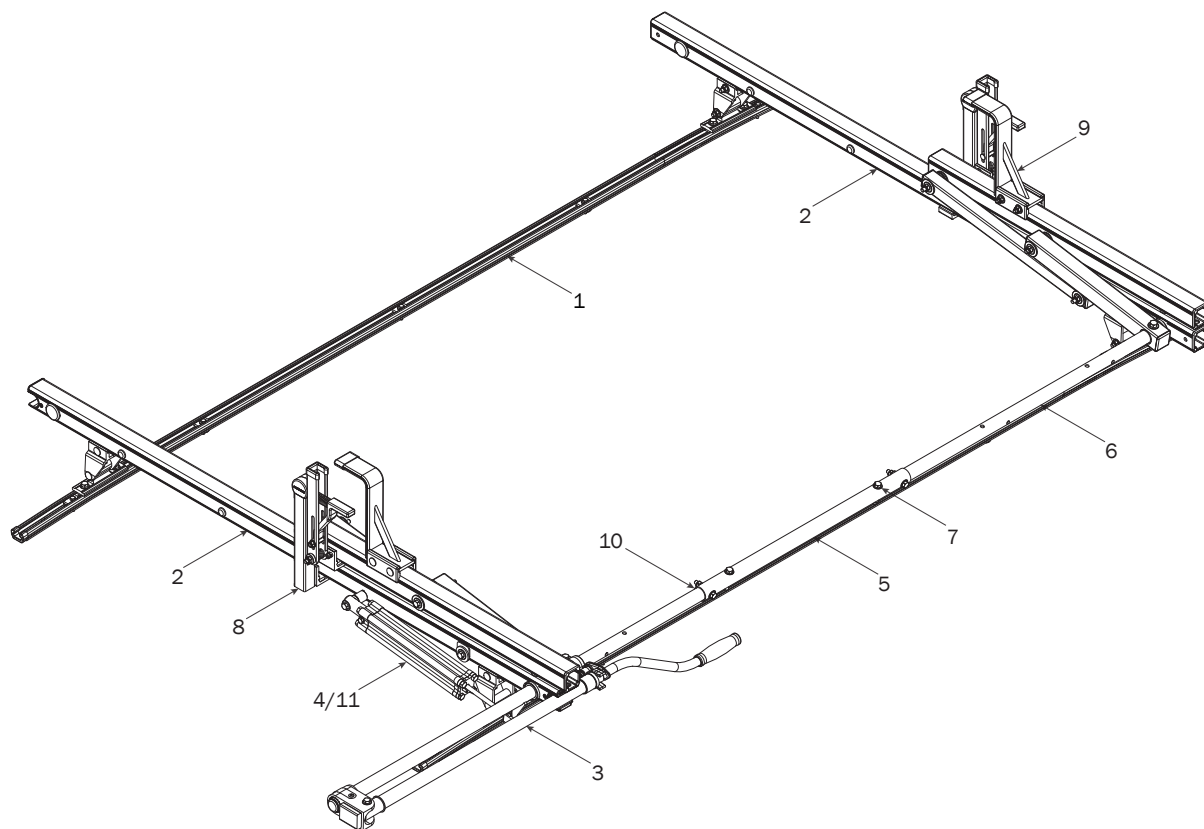
**FBM-0007**

- 1.1** Install three sets of Channel Hardware per channel as shown below.

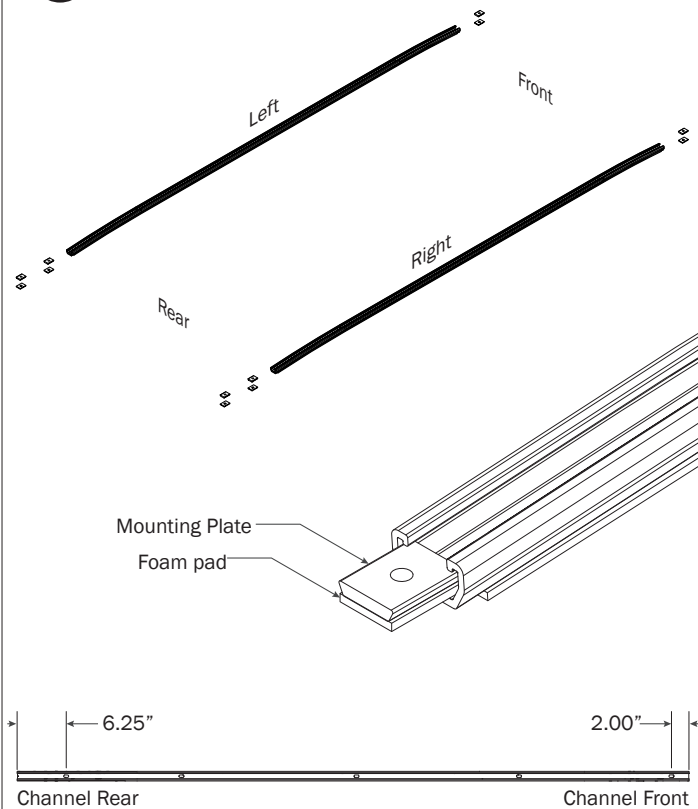

- 1.2** Install the fasteners through the innermost factory roof holes as shown then torque the nuts to 60 in-lbs.

Do not install or fasten Hardware to the outer front and rear roof holes until Step 1.4.

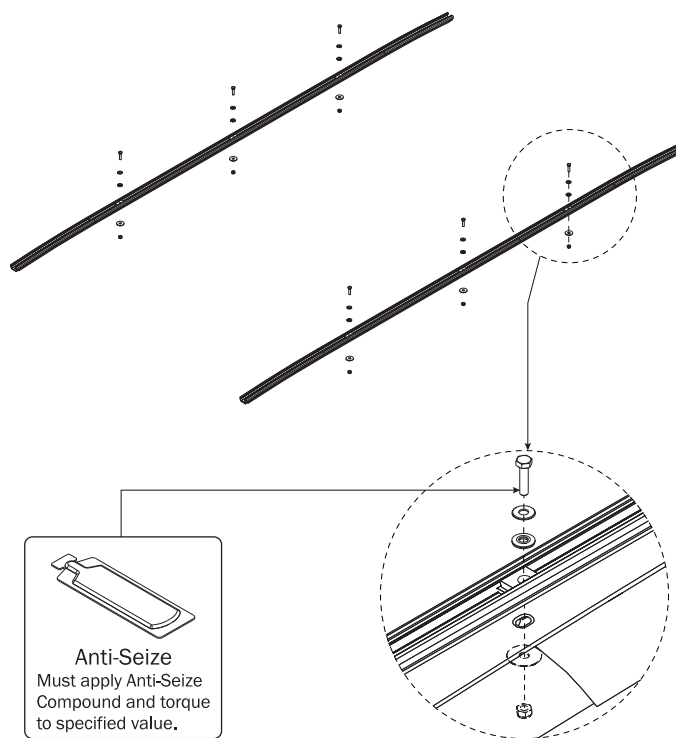

1.3

Install the Mounting Brackets along with the remaining Channel Hardware as shown below.

Do not tighten the Mounting Brackets until Step 1.5.

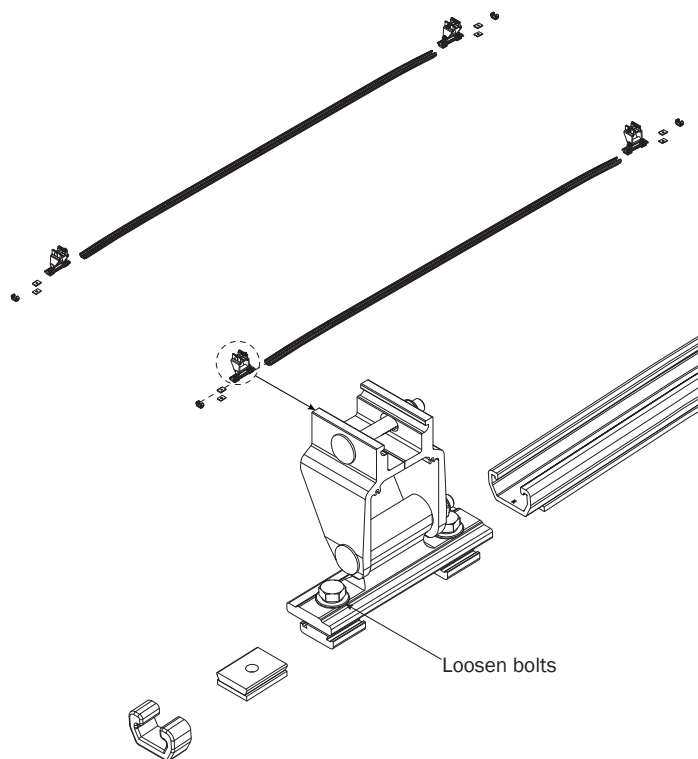

1.4

Install the remaining front and rear fasteners through the factory roof holes as shown then torque the nuts to 60 in-lbs.

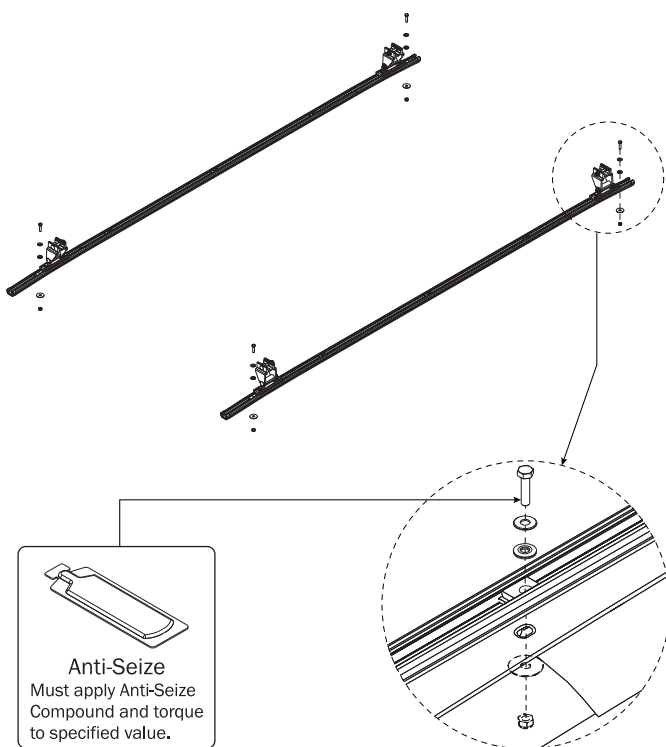

1.5

Set to distances then torque all the Mounting Brackets to 90 in-lbs.

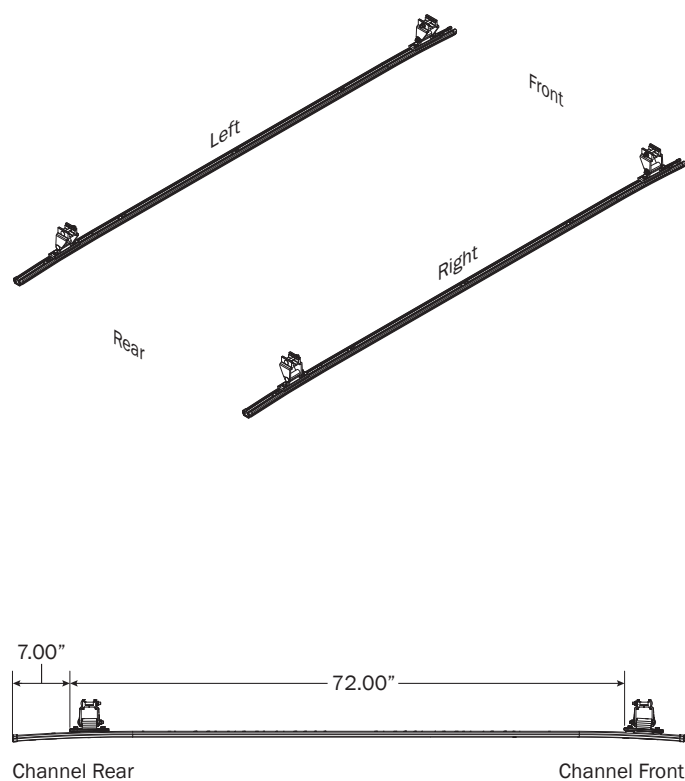

5

VBR-TC21B ASSEMBLY INSTRUCTIONS—FBM MOUNTINGS

PRIME DESIGN
A Safe Fleet Brand

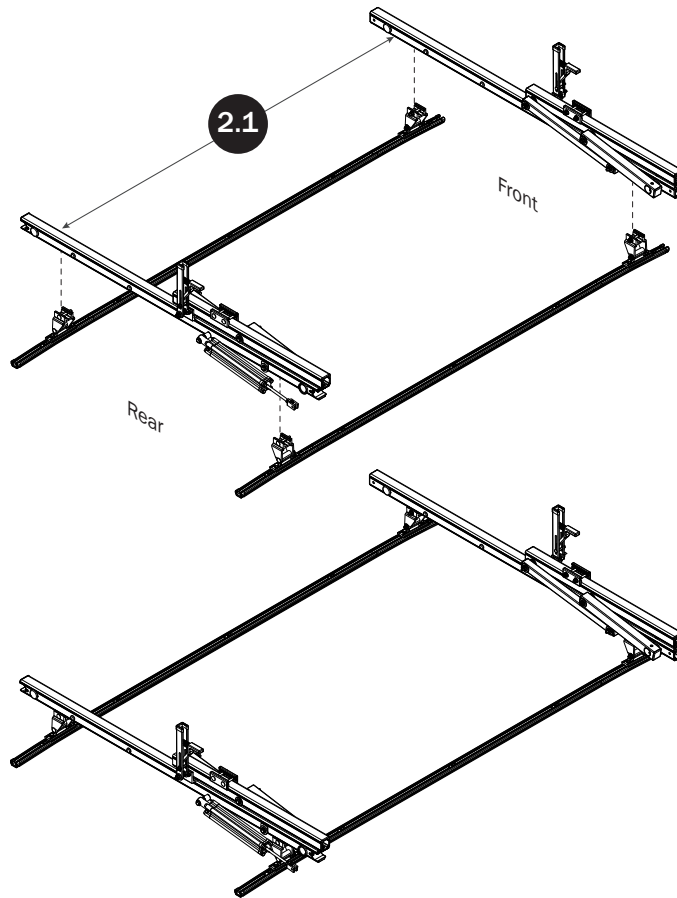
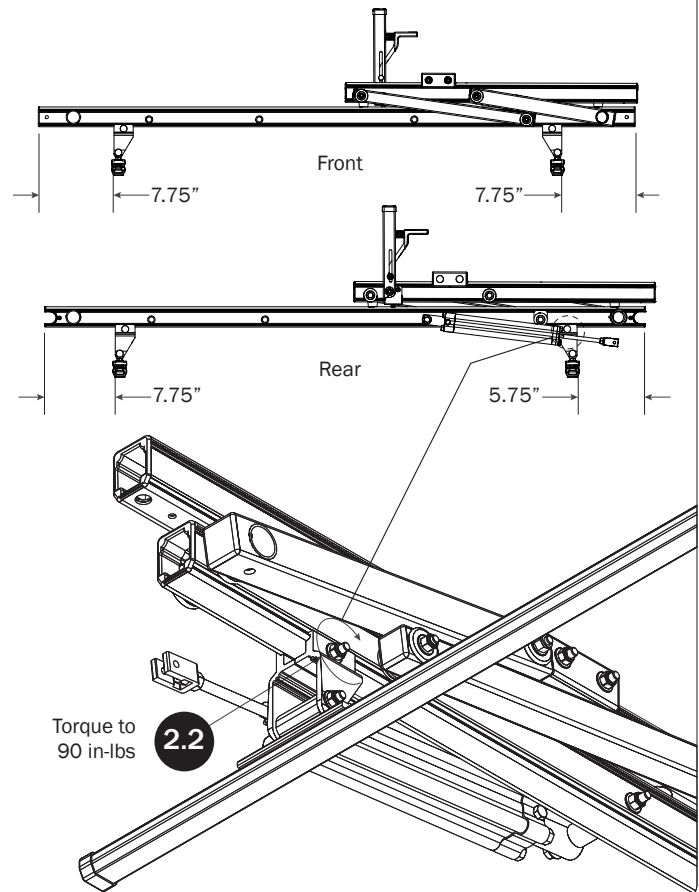
CROSSBARS**CROSSBAR ADJUSTMENT****REAR DRIVE SHAFT**

NOTE: For instructional clarity, the FBM Mounting System will not be shown.

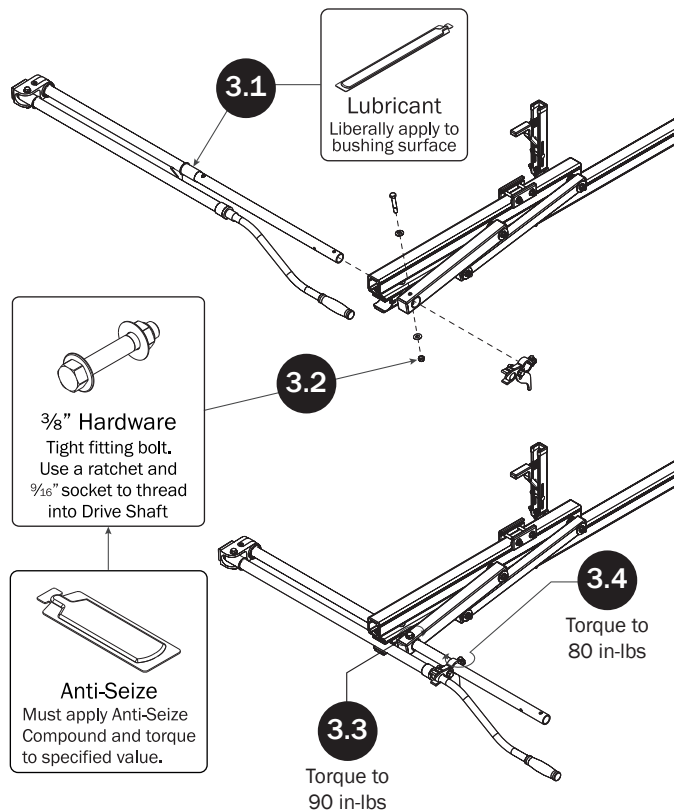
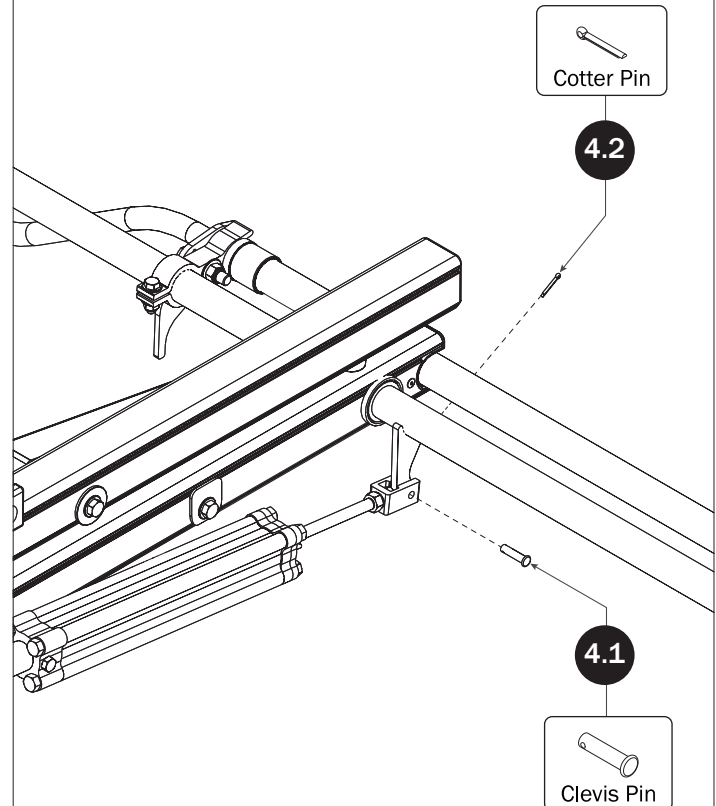
**CYLINDER HARDWARE**

CONNECTING BAR

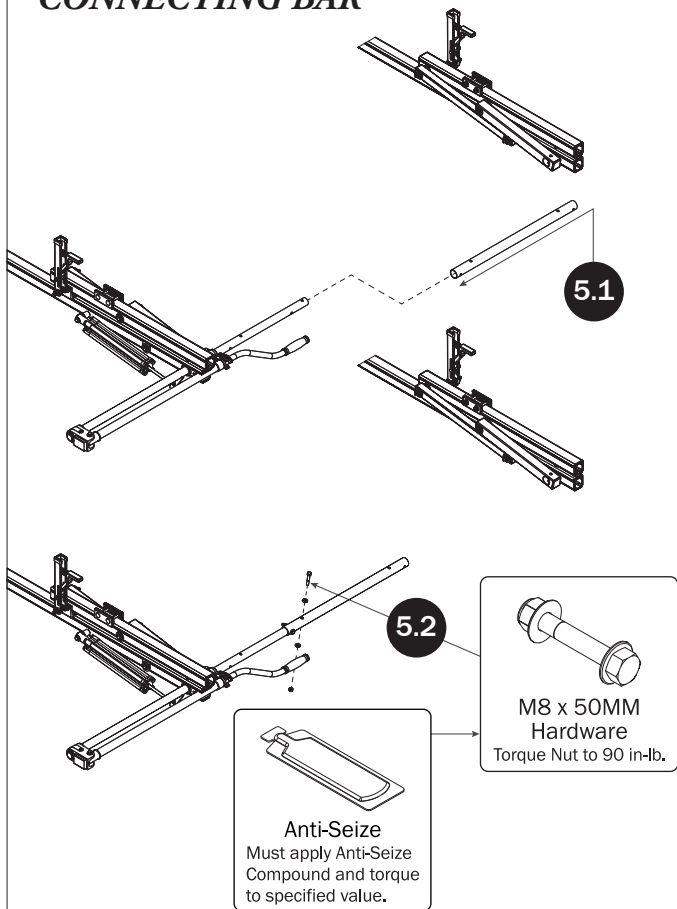

FRONT DRIVE SHAFT

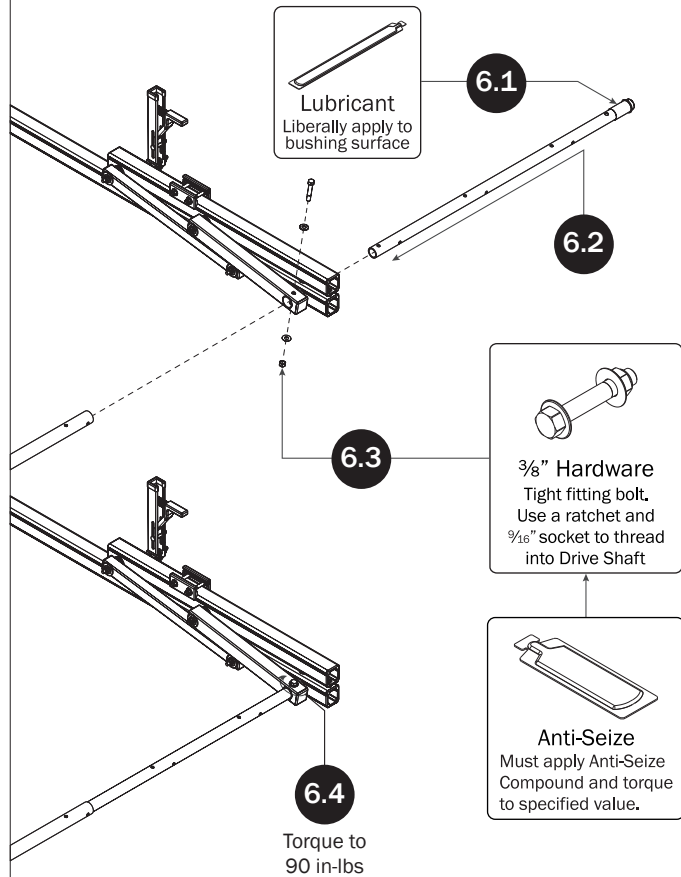

CONNECTING BAR FASTENERS

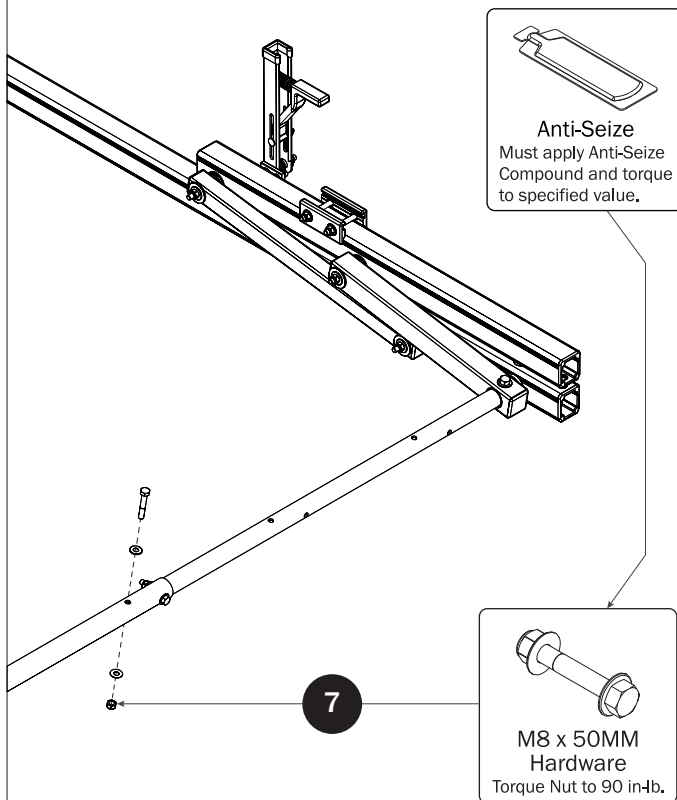

DRIVE SHAFT SEALING

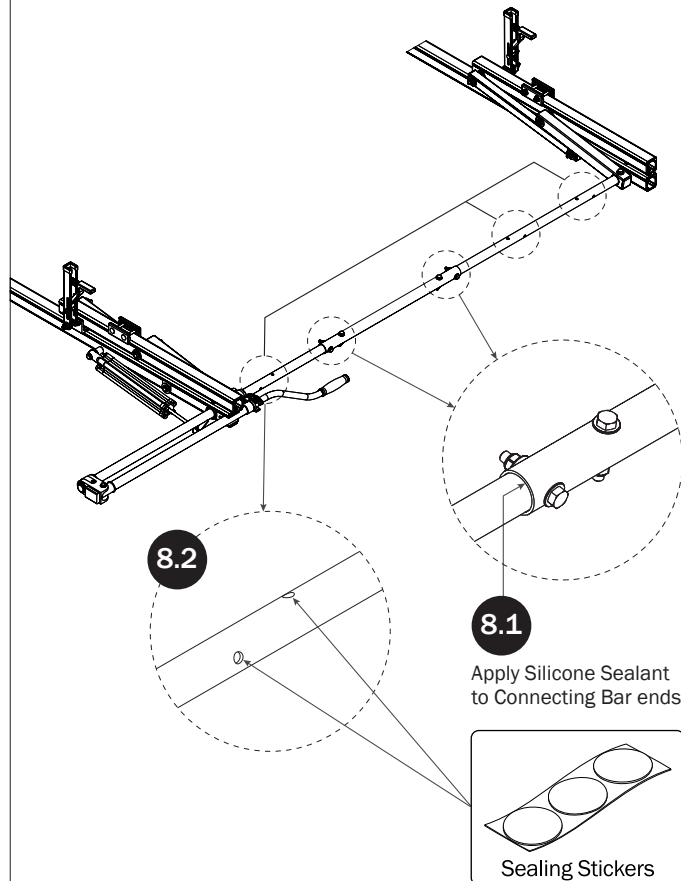

L POSTS**SEE QUICK START GUIDE FOR ADJUSTMENTS**

NOTE: The Auto Clamps may come preset from the factory for packaging purposes only. To assemble the L Posts to the Crossbars, the Auto Clamps may need to be repositioned.

Ensure the Auto Clamp Spring is seated into the spring catch

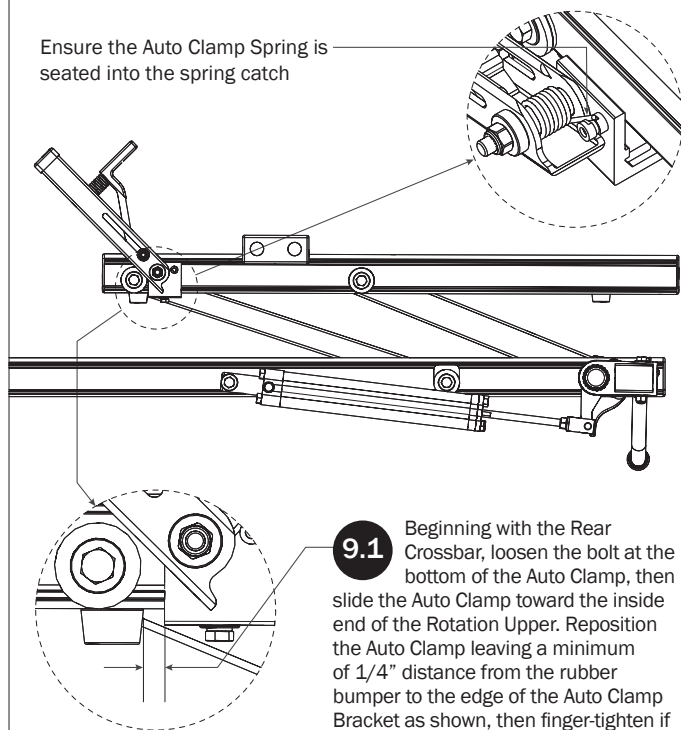

- 9.1** Beginning with the Rear Crossbar, loosen the bolt at the bottom of the Auto Clamp, then slide the Auto Clamp toward the inside end of the Rotation Upper. Reposition the Auto Clamp leaving a minimum of 1/4" distance from the rubber bumper to the edge of the Auto Clamp Bracket as shown, then finger-tighten if adjusting later, or torque to 80 in-lbs.

9.2

Prepare the L Post by removing the hex head bolt, lock washer, flat washer, and Bracket Clamp. Retain for installation Steps 9.4—9.8.

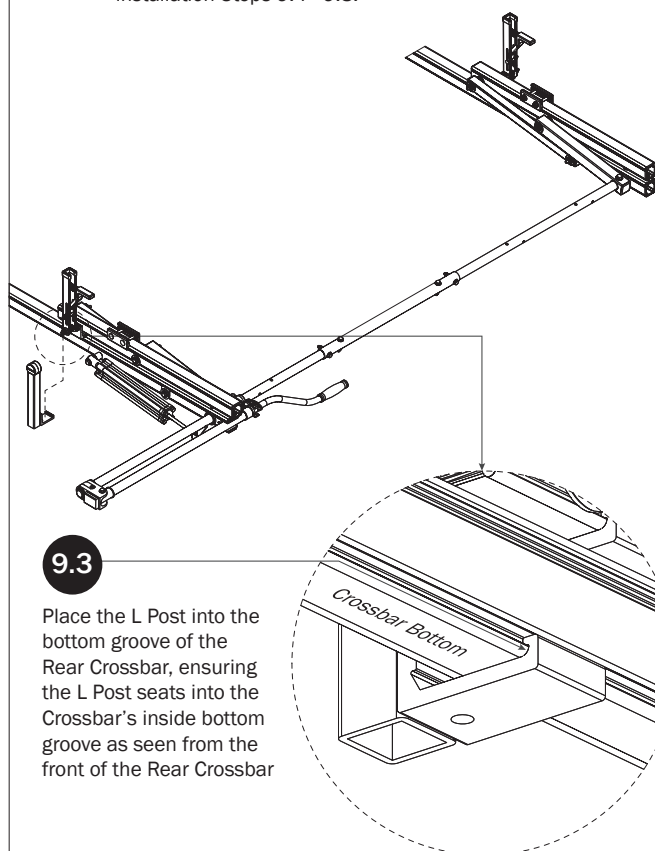
**9.3**

Place the L Post into the bottom groove of the Rear Crossbar, ensuring the L Post seats into the Crossbar's inside bottom groove as seen from the front of the Rear Crossbar

9.4

Slide L Post Bracket Clamp into bottom groove, then slide into L Post Bracket as shown

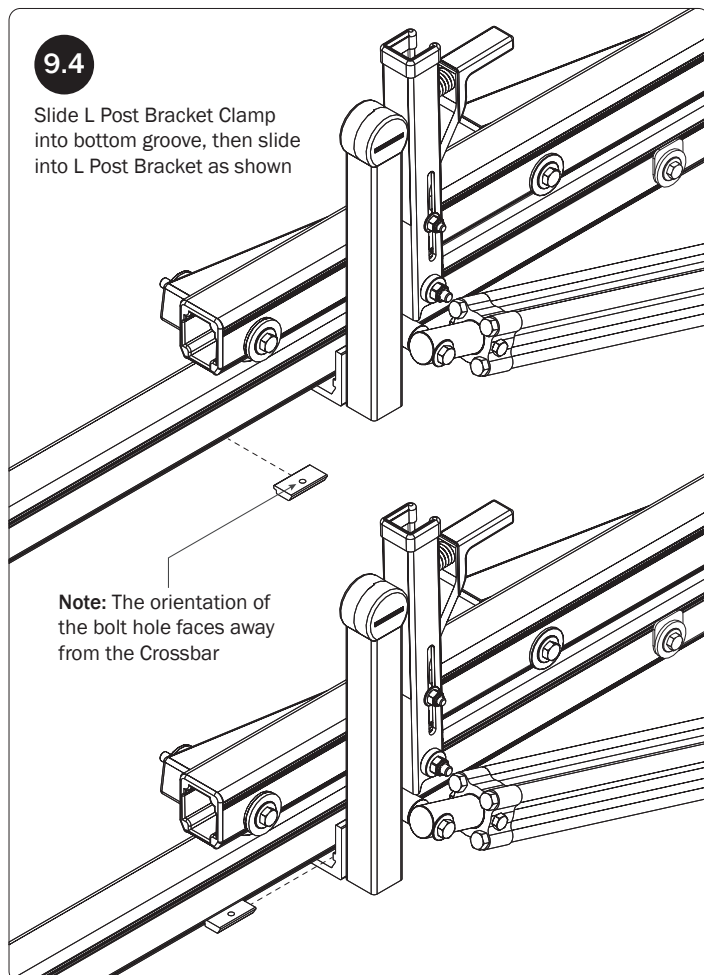

Note: The orientation of the bolt hole faces away from the Crossbar

9.5

Bracket Clamp sits in L Post Bracket as shown

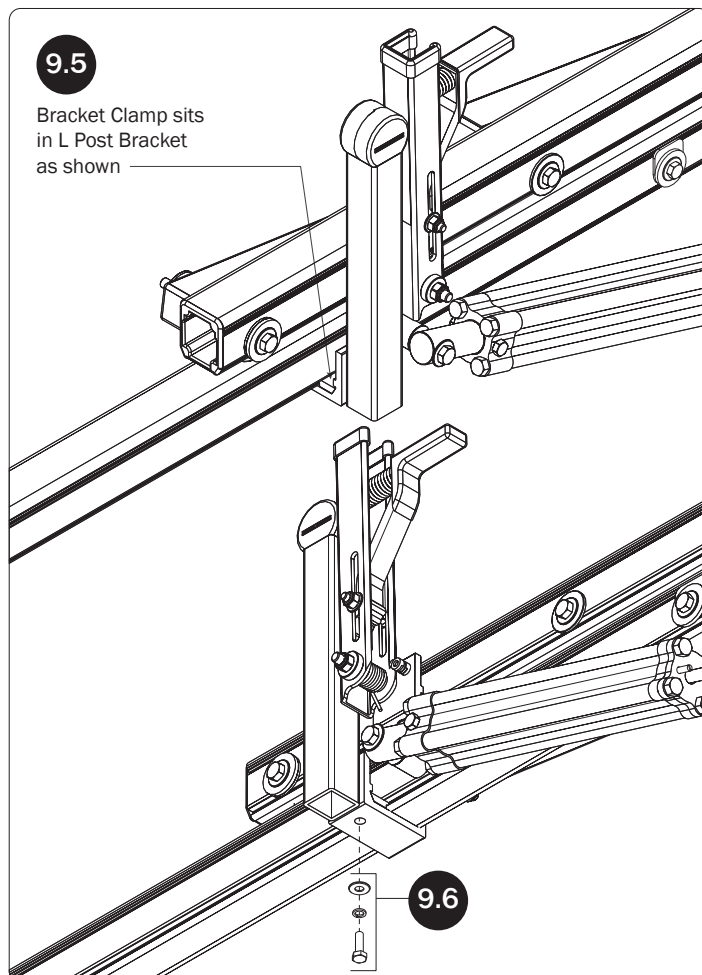
**9.6**

Z POSTS

SEE QUICK START GUIDE FOR ADJUSTMENTS

- 10.1** Slide the Z Post into the Mounting Clamp Assembly

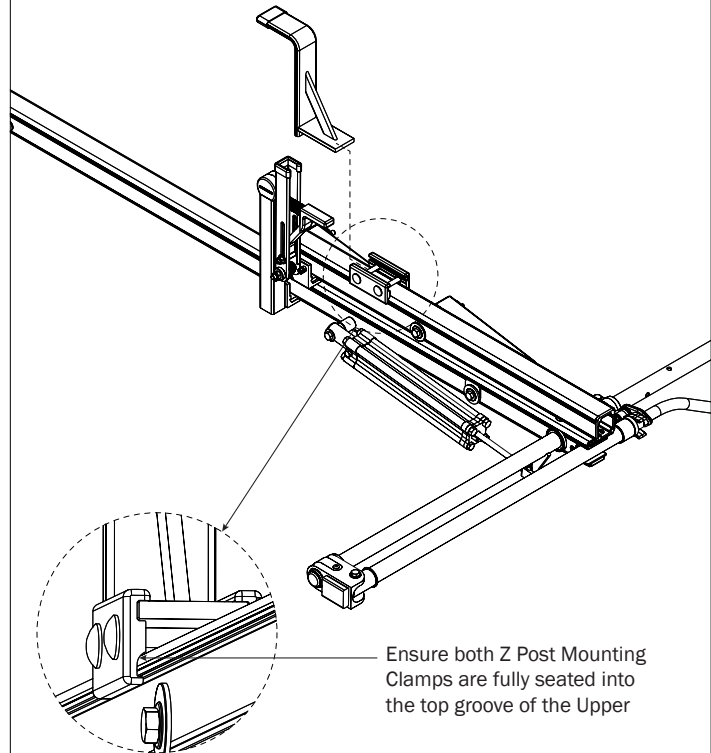
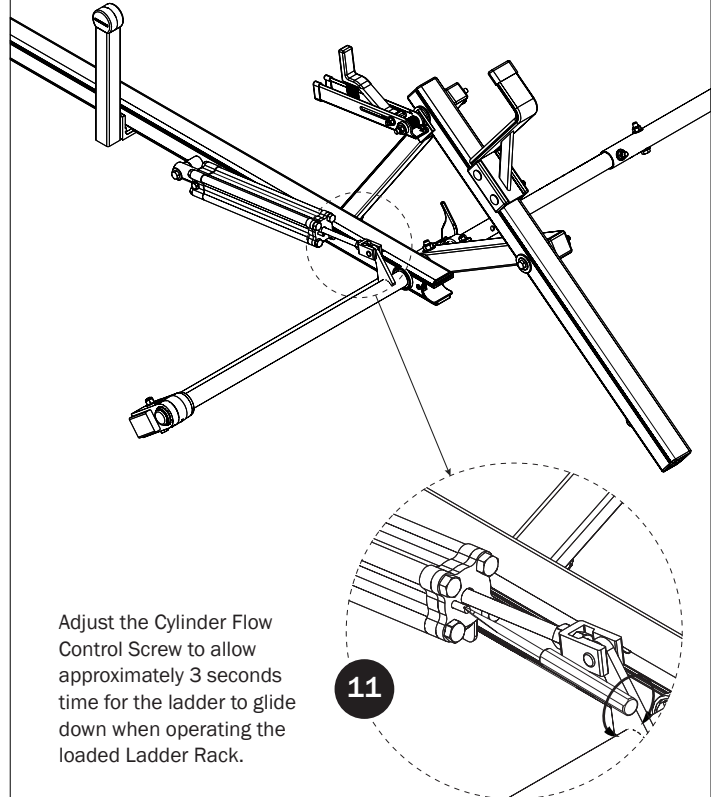
**CYLINDER ADJUSTMENT****9.7**

Slide the L Post until parallel to the Auto Clamp and the gap between the two is even from top to bottom.

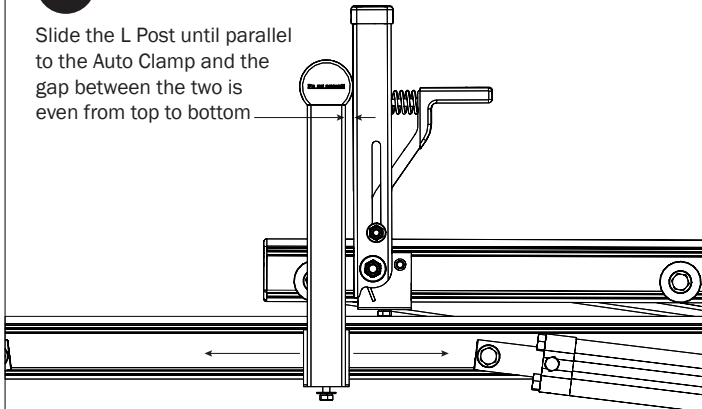

Torque to 80 in-lbs **9.8**

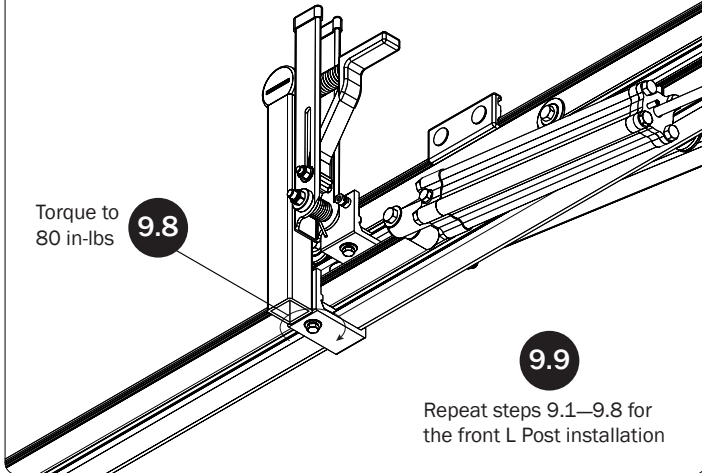
**9.9**

Repeat steps 9.1—9.8 for the front L Post installation

10.2

Refer to the Quick Start Guide for Z Post positioning.

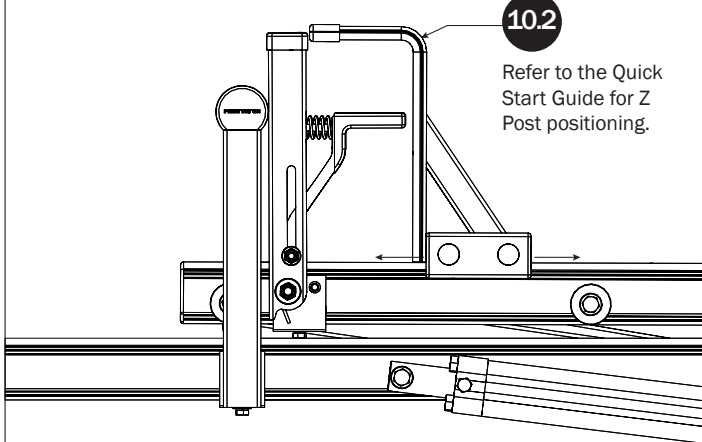
**10.3**

Torque to 90 in-lbs

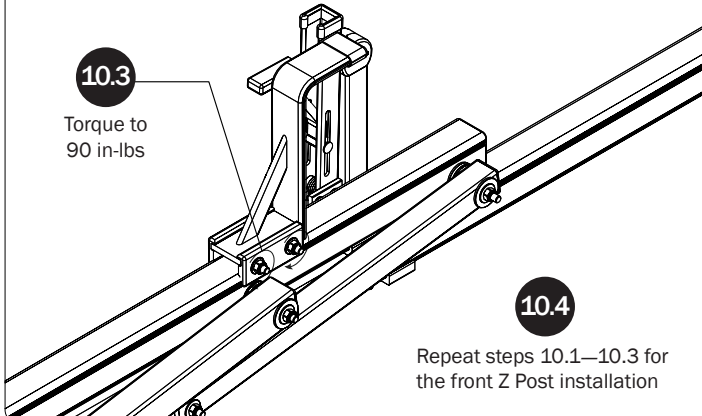
**10.4**

Repeat steps 10.1—10.3 for the front Z Post installation

LADDER STOP ASSEMBLY SEQUENCE

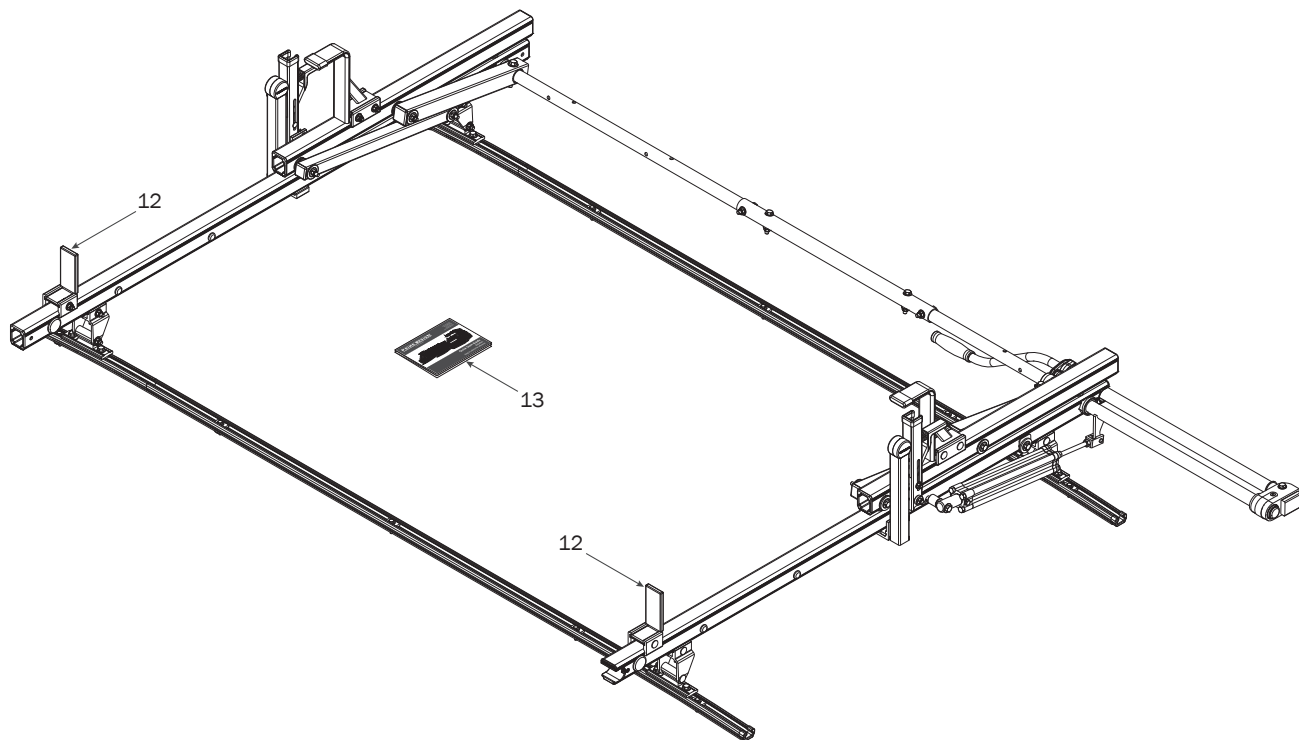

LADDER STOPS

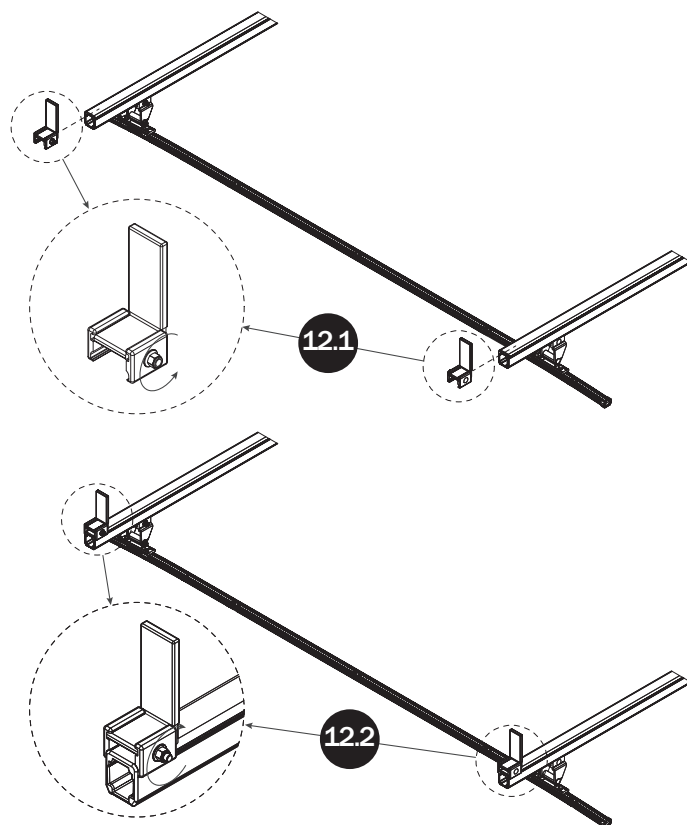

QUICK START GUIDE

13

Place the Quick Start Guide into the vehicle's glove box for ladder setup and adjustment.

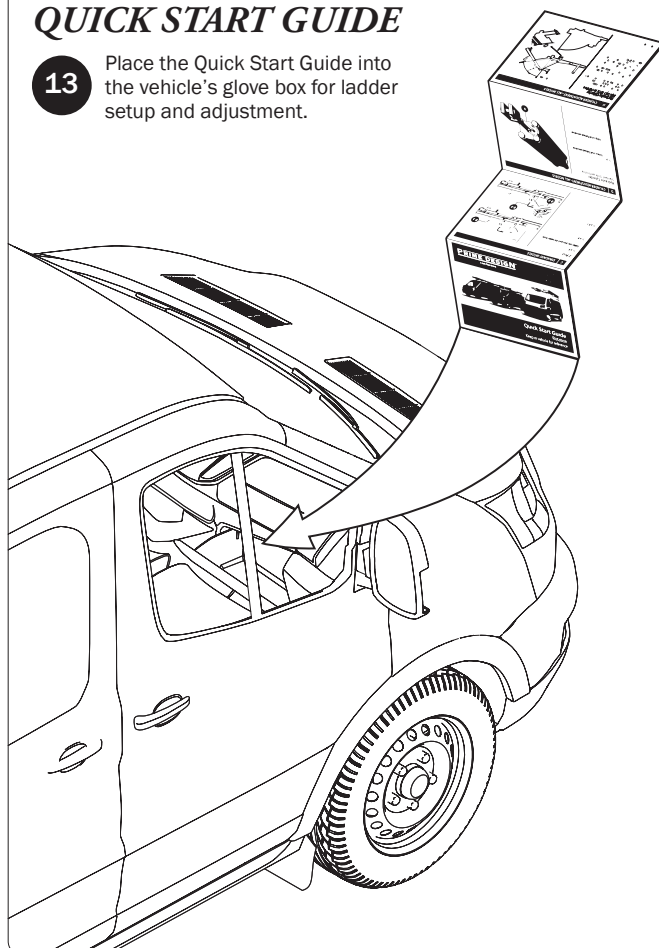

Page Intentionally Left Blank

