

PRIME DESIGN™

A Safe Fleet Brand

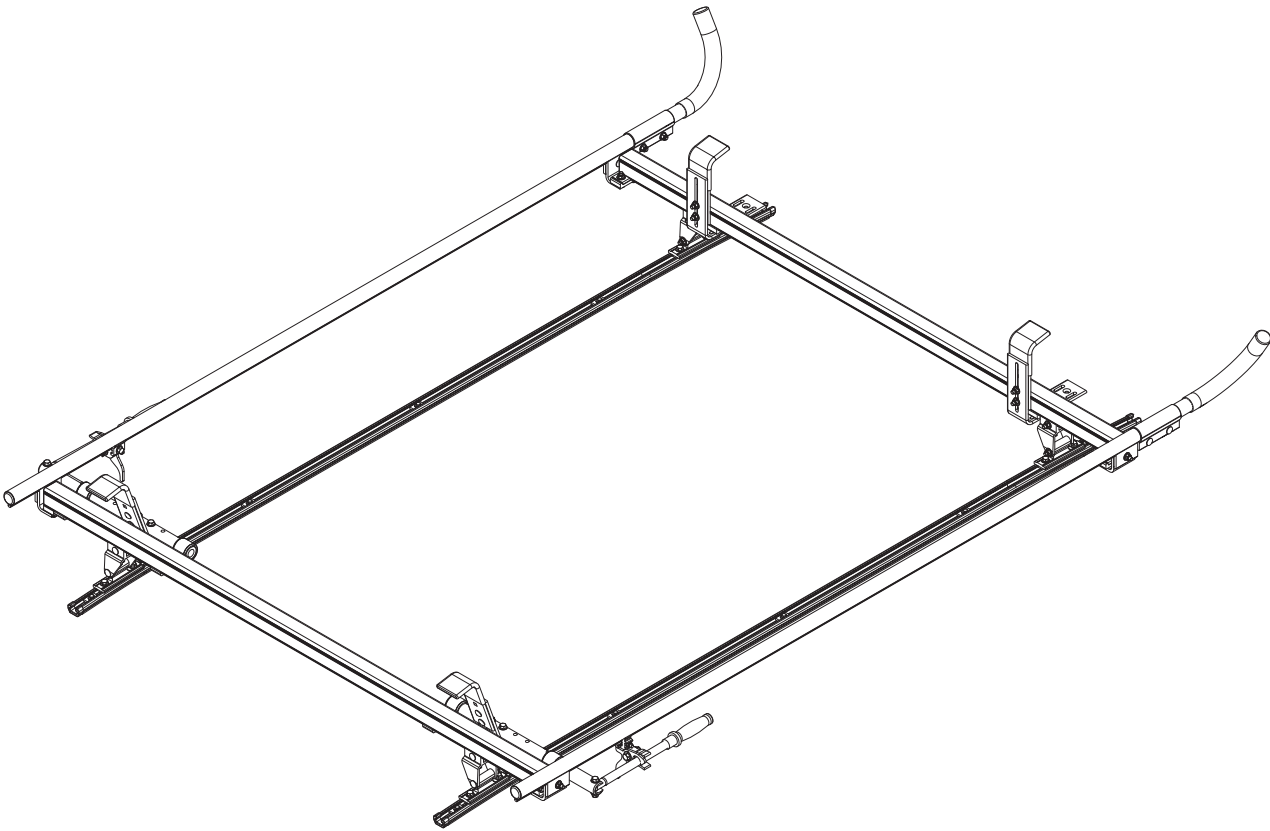

VCC **RC21B**

CONTENTS OVERVIEW

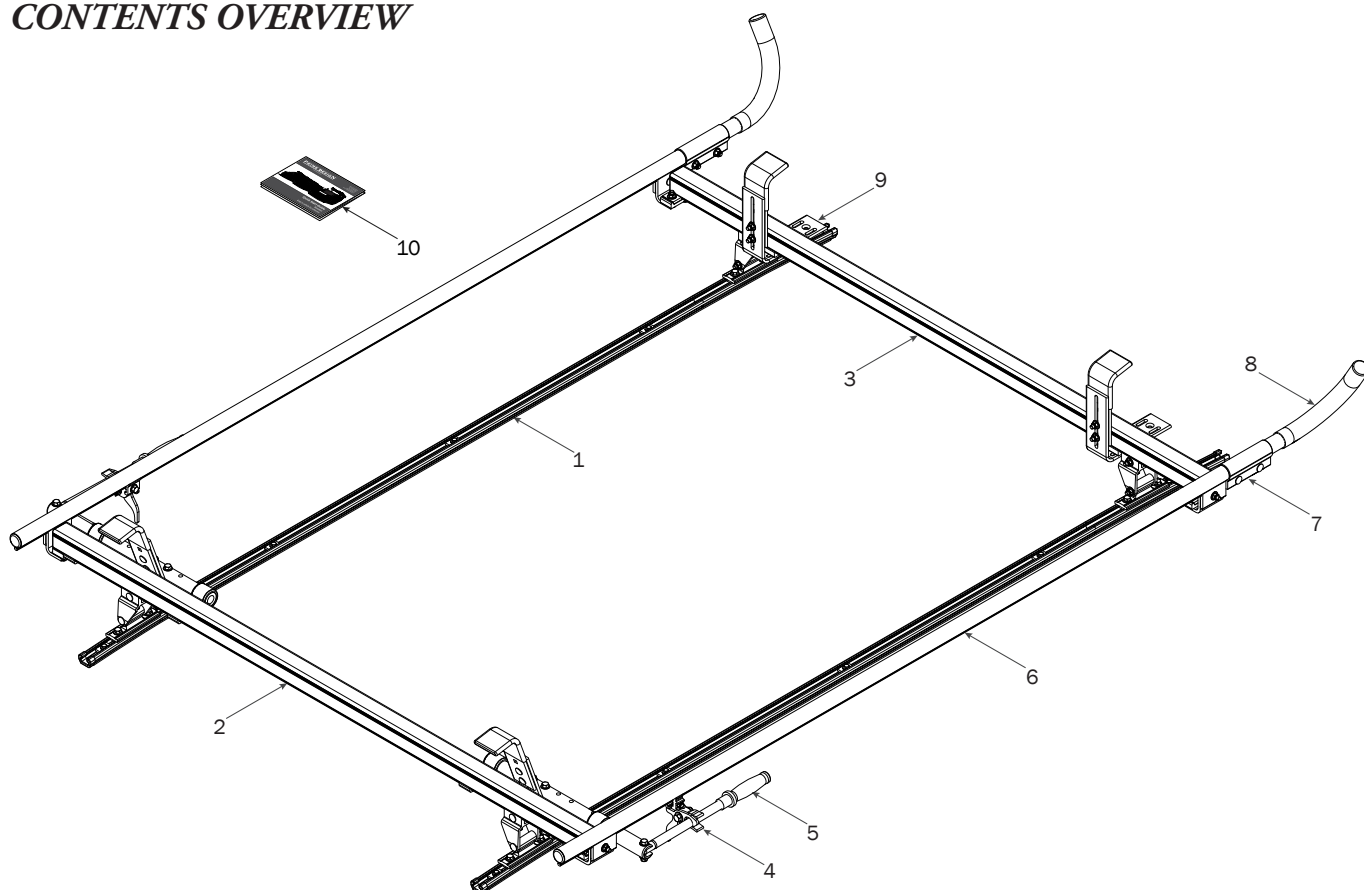

1—FBM-0007 (Qty 1)
Channels with hardware



Channels (2X)

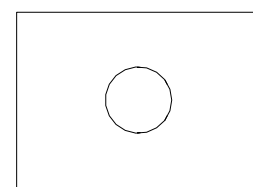
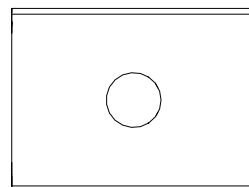
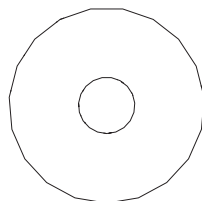
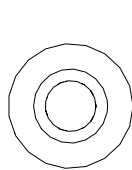
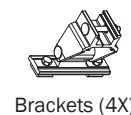
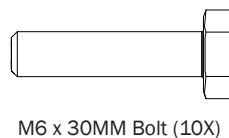
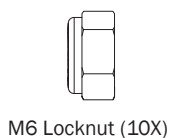

2—Rear Crossbar Assembly (Qty 1)



3—Front Crossbar Assembly (Qty 1)



4—Handle Latch Assembly (Qty 2)

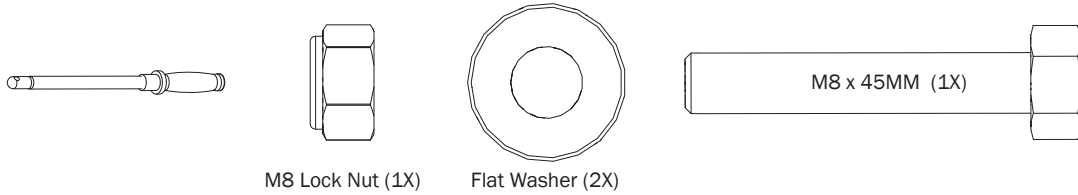
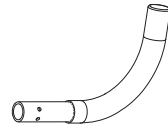

5—Clamp Down Handle Assembly (Qty 2)

6—Clamp Down Tube (Qty 2)
80.00"7—Quick Clamp Tube Splice Assembly (Qty 2)
5.00"8—Removeable Horn with Cap (Qty 2)
15.00"

9—HD Front Hook Assembly (Qty 2)

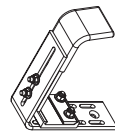
10—USQSG-Ergorack (Qty 1)
Quick Start Guide, Clamp Down

* Once rack installation is complete, place the Quick Start Guide into the vehicle's glove box for future ladder setup and adjustment.

11—Anti-Seize (Qty 1)

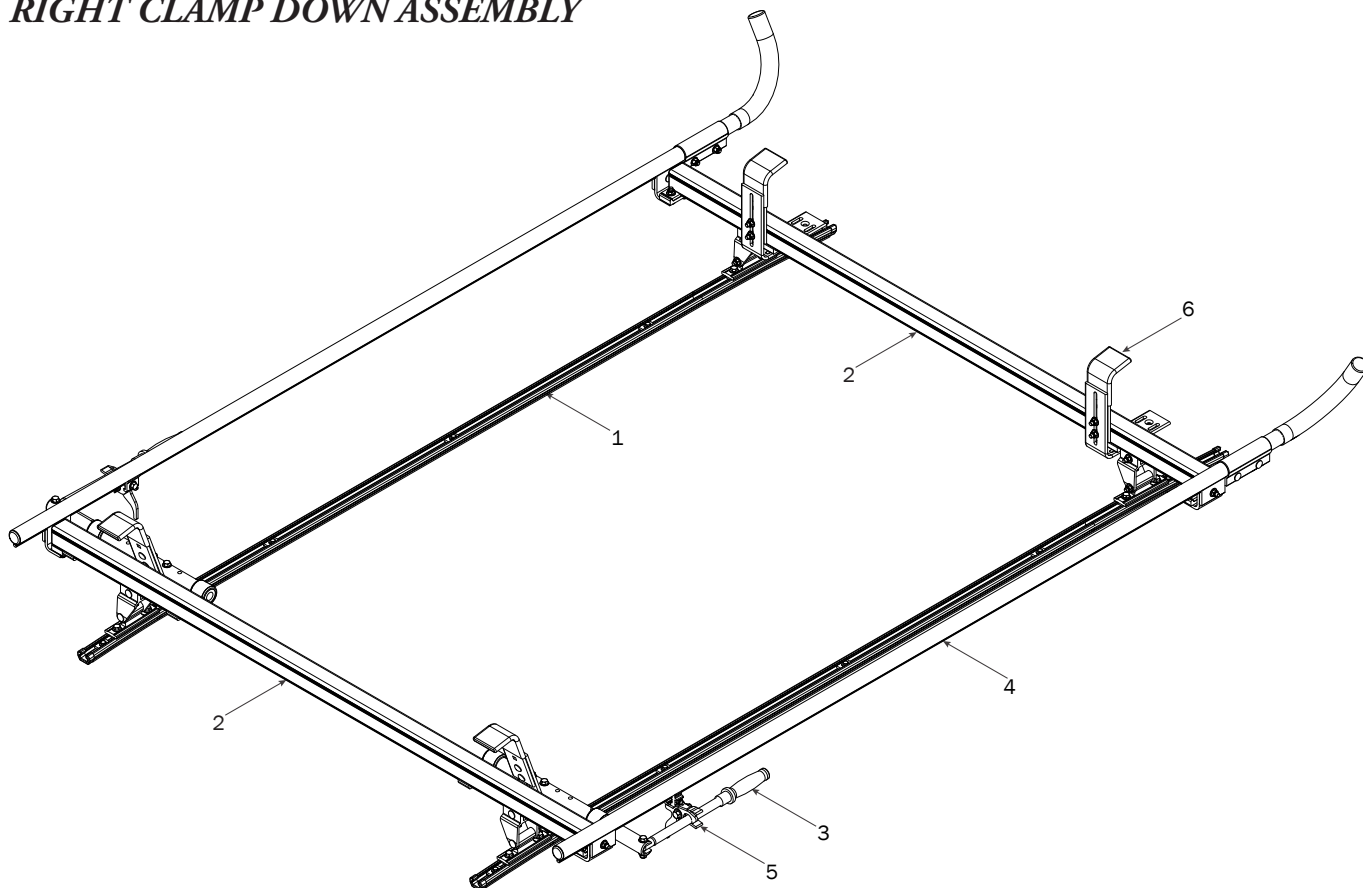

RIGHT CLAMP DOWN ASSEMBLY**FBM-0007**

- 1.1** Install three sets of Channel Hardware per channel as shown below.

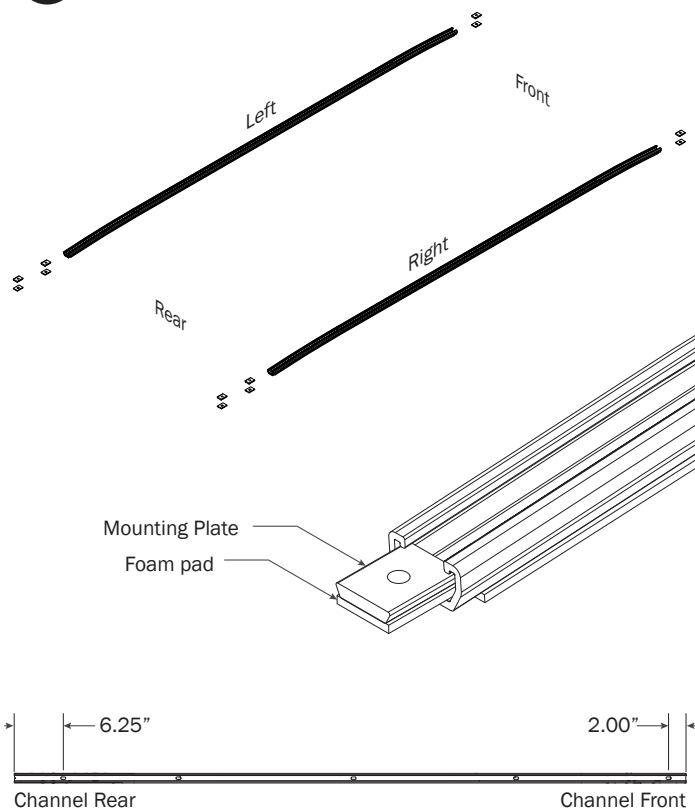

- 1.2** Install the fasteners through the innermost factory roof holes as shown then torque the nuts to 60 in-lbs.

Do not install or fasten Hardware to the outer front and rear roof holes until Step 1.4.

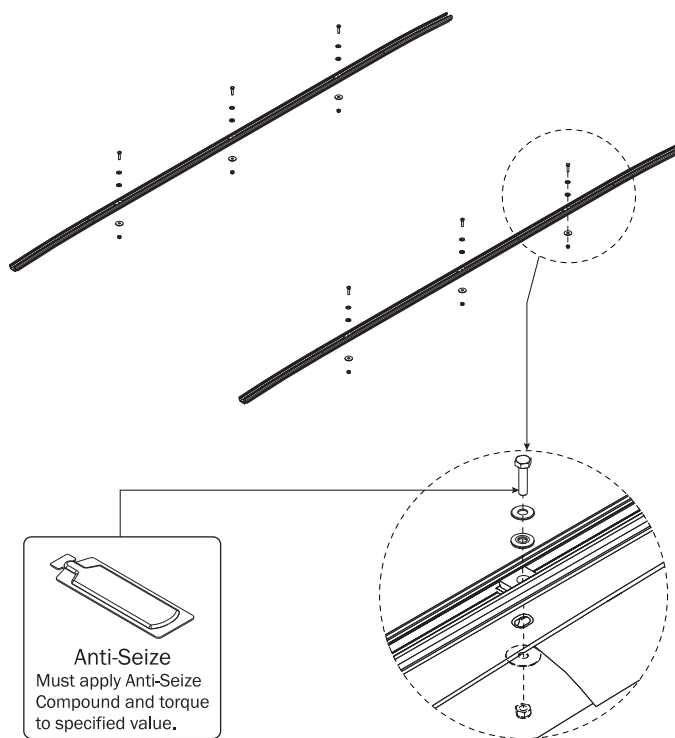

1.3

Install the Mounting Brackets along with the remaining Channel Hardware as shown below.

Do not tighten the Mounting Brackets until Step 1.5.

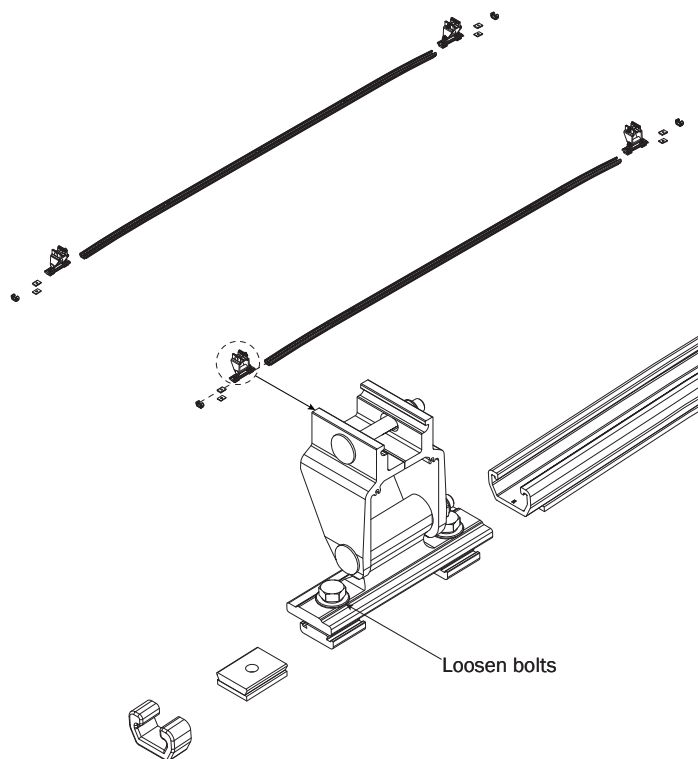

1.4

Install the remaining front and rear fasteners through the factory roof holes as shown then torque the nuts to 60 in-lbs.

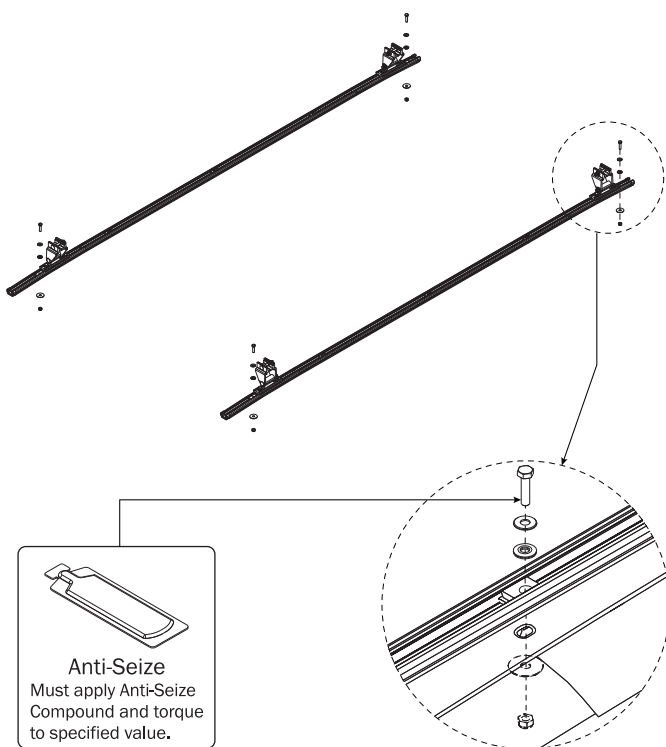

1.5

Set to distances then torque all the Mounting Brackets to 90 in-lbs.

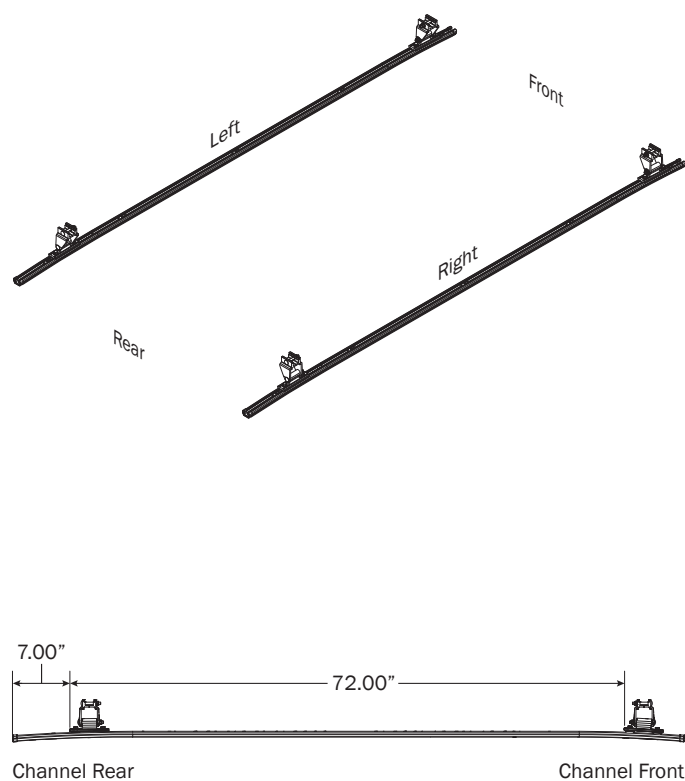

5

VCC-TC21B ASSEMBLY INSTRUCTIONS—CROSSBAR INSTALLATION

PRIME DESIGN
A Safe Fleet Brand

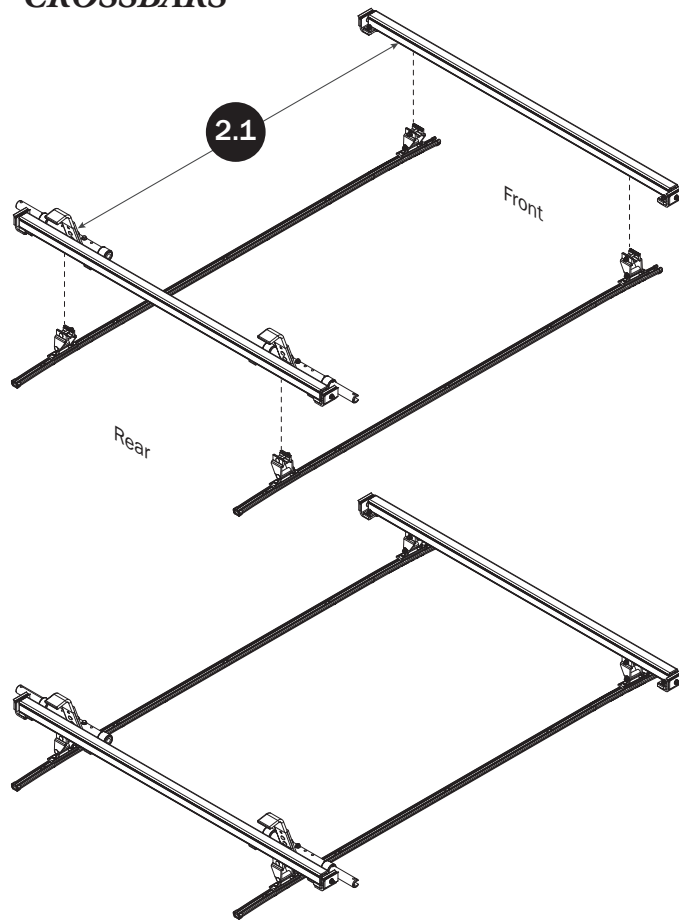
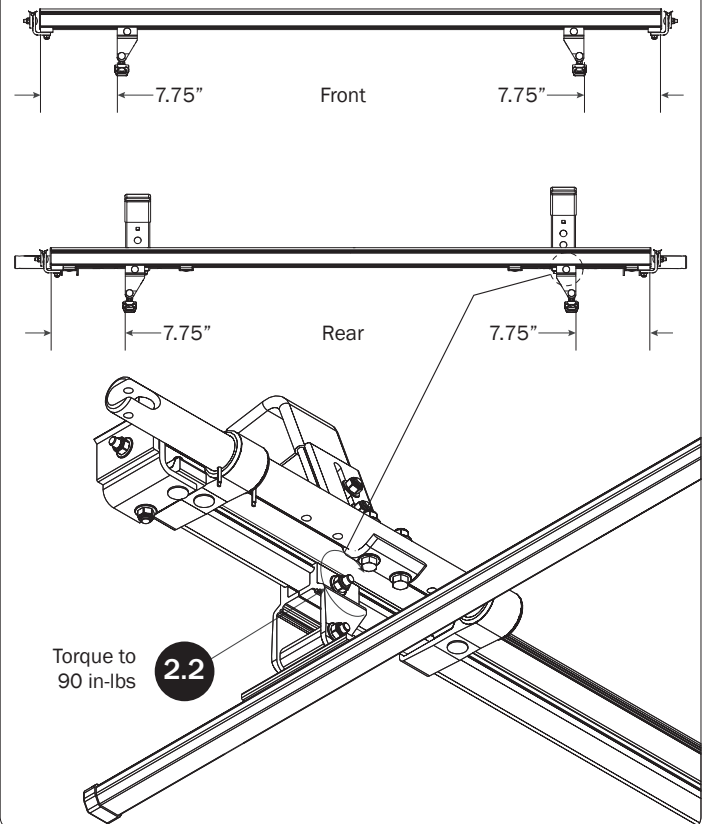
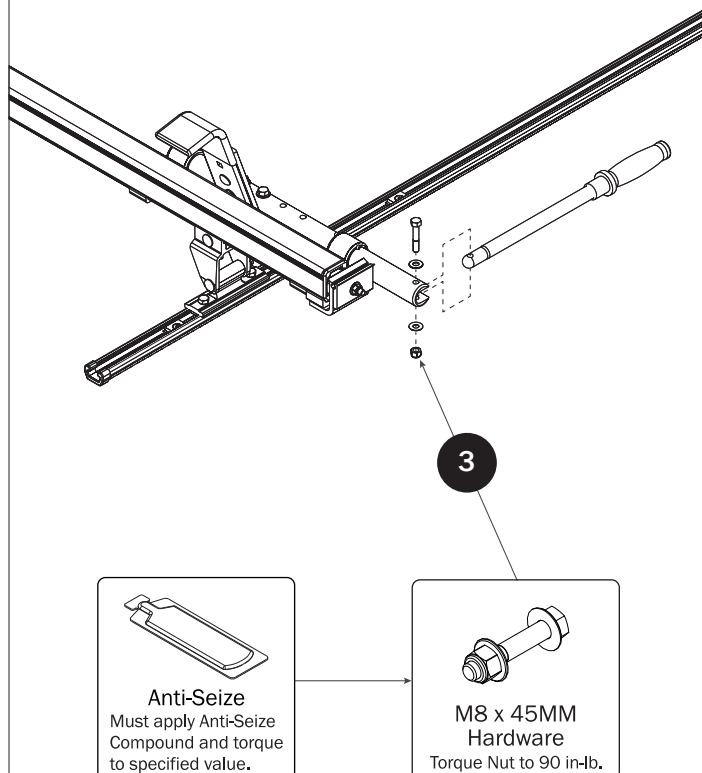
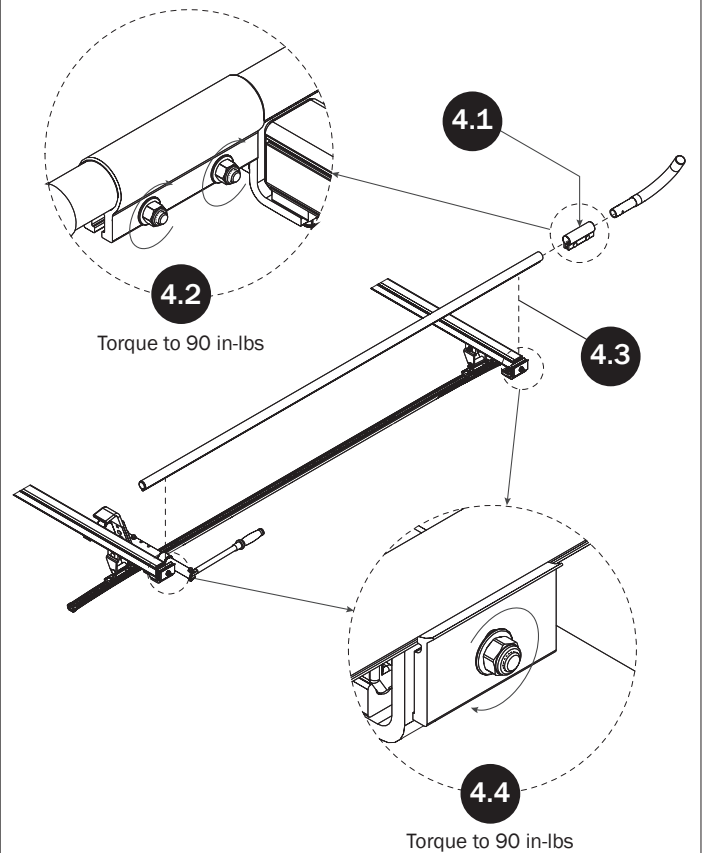
CROSSBARS**CROSSBAR ADJUSTMENT****CLAMP DOWN HANDLE****CLAMP DOWN TUBE**

HANDLE LATCH

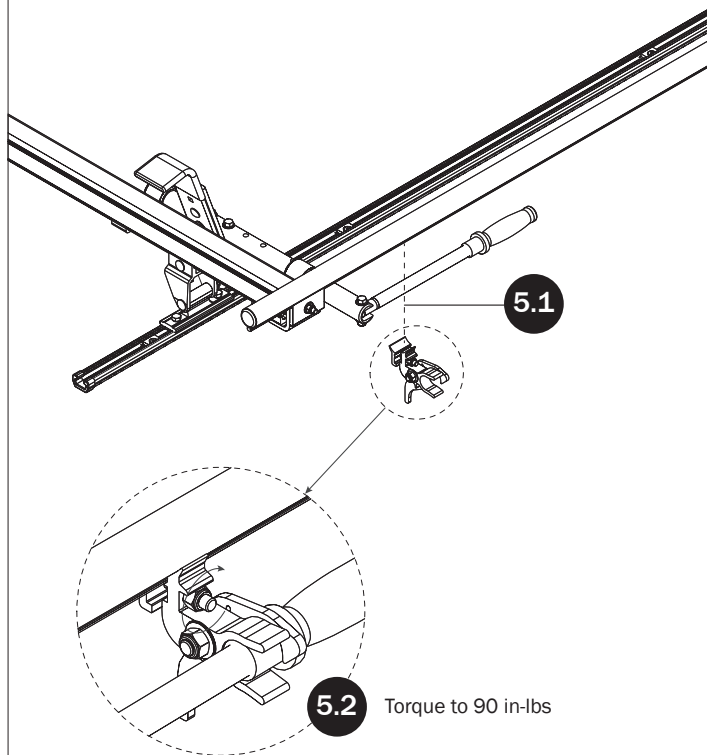

FRONT LADDER HOOK

SEE QUICK START GUIDE FOR ADJUSTMENTS

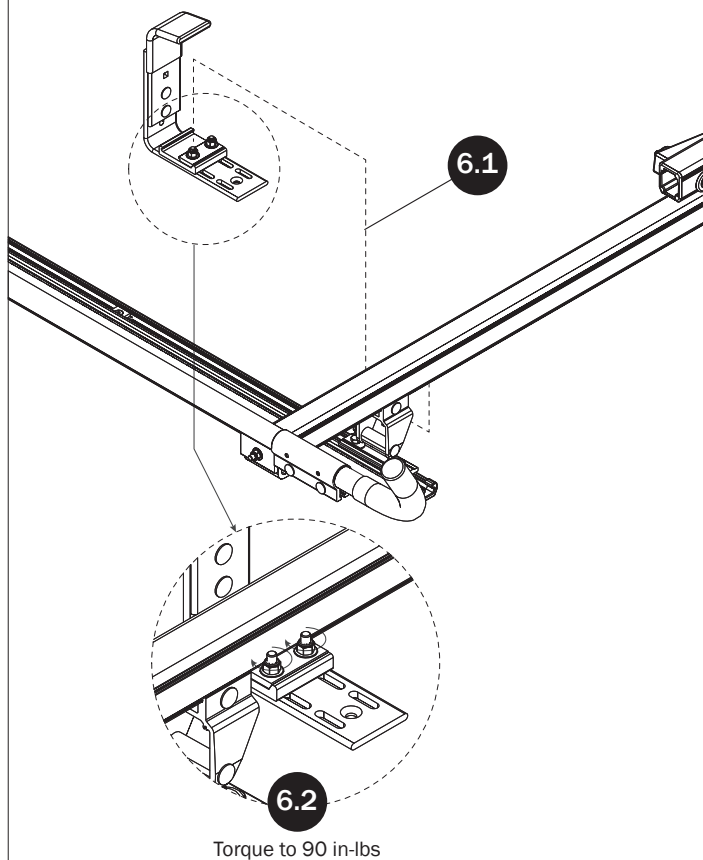

LEFT CLAMP DOWN ASSEMBLY

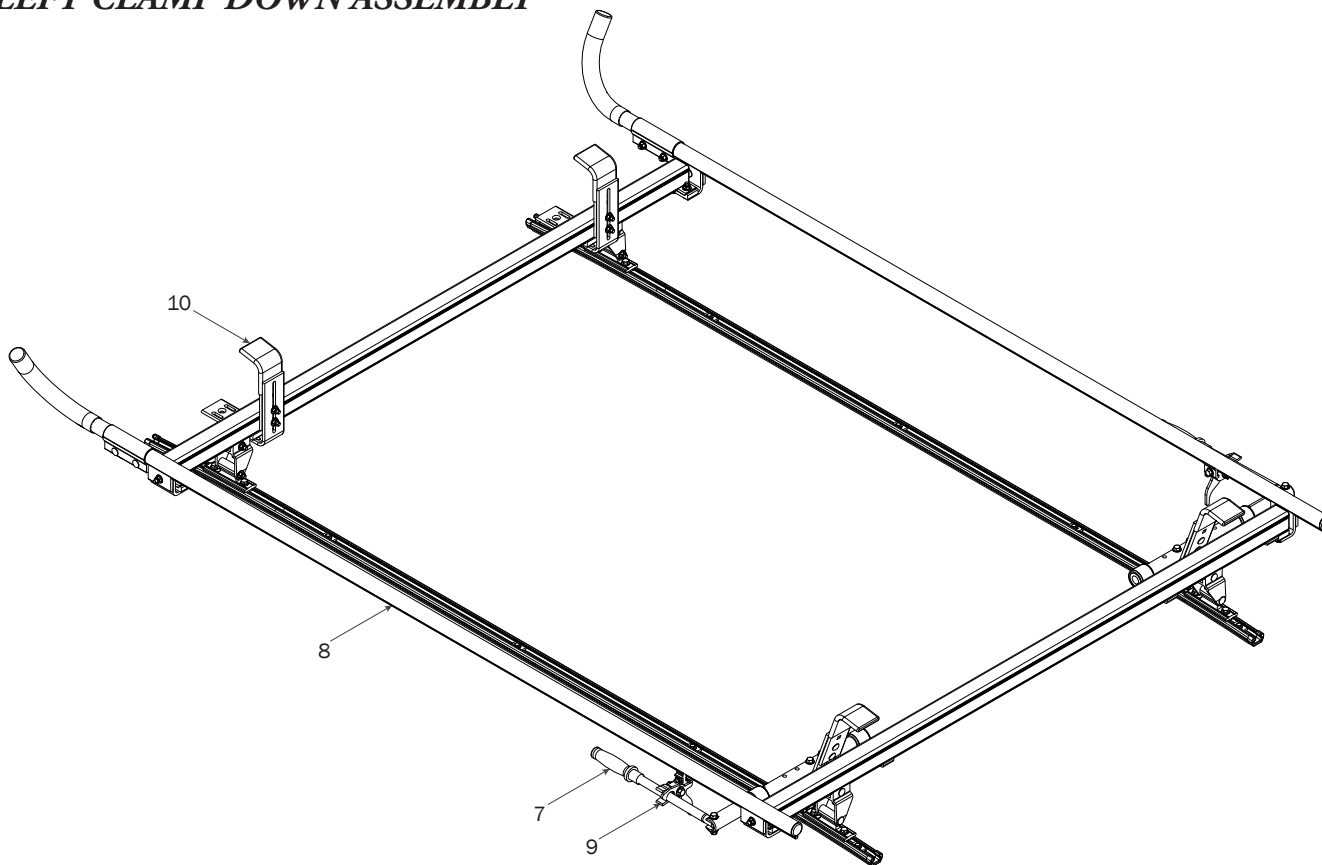

CLAMP DOWN HANDLE

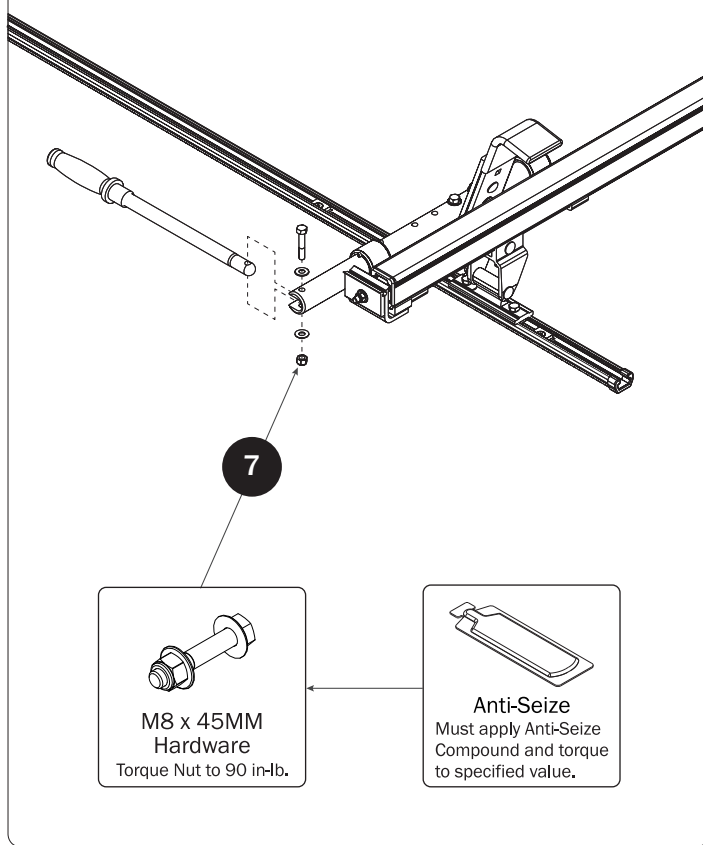

CLAMP DOWN TUBE

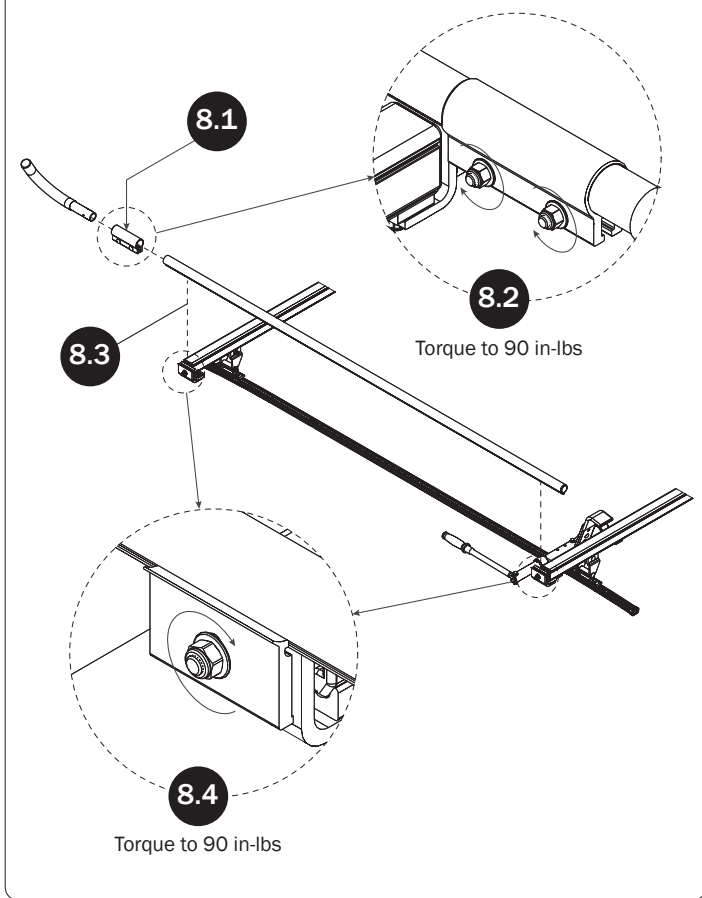

HANDLE LATCH

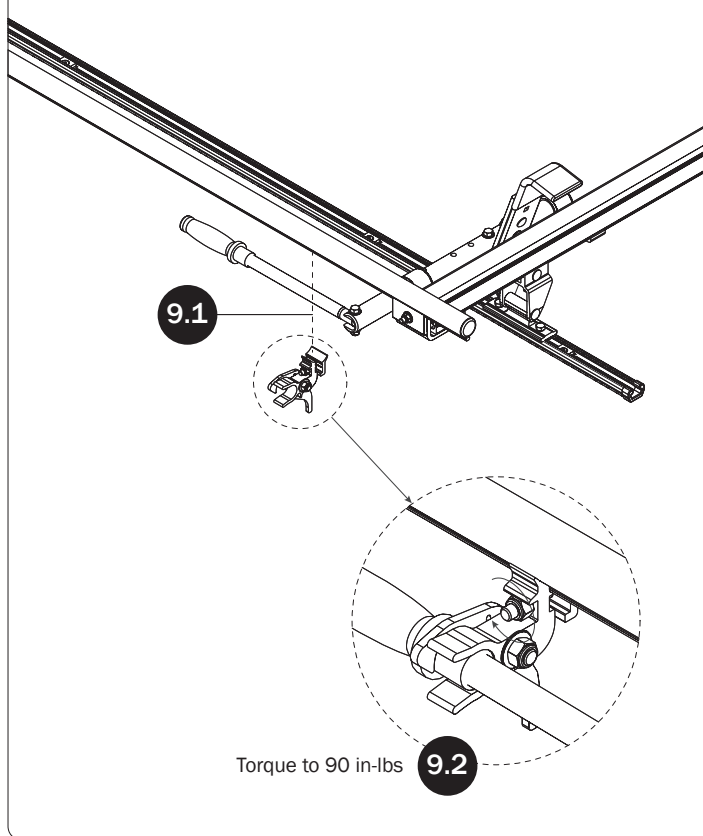

FRONT LADDER HOOK SEE QUICK START GUIDE FOR ADJUSTMENTS

