

# PRIME DESIGN™

A Safe Fleet Brand

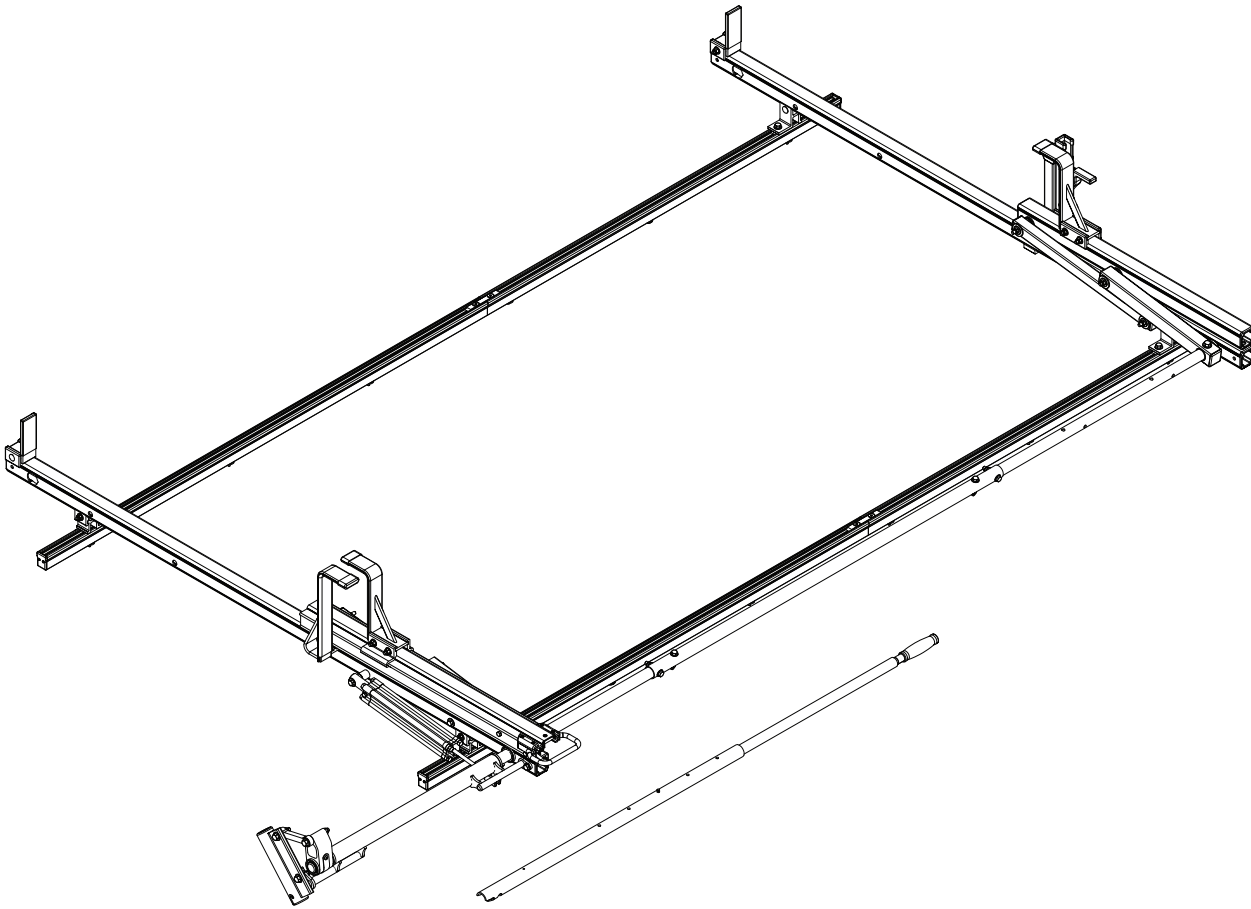

# HBR-E SP

## CONTENTS OVERVIEW

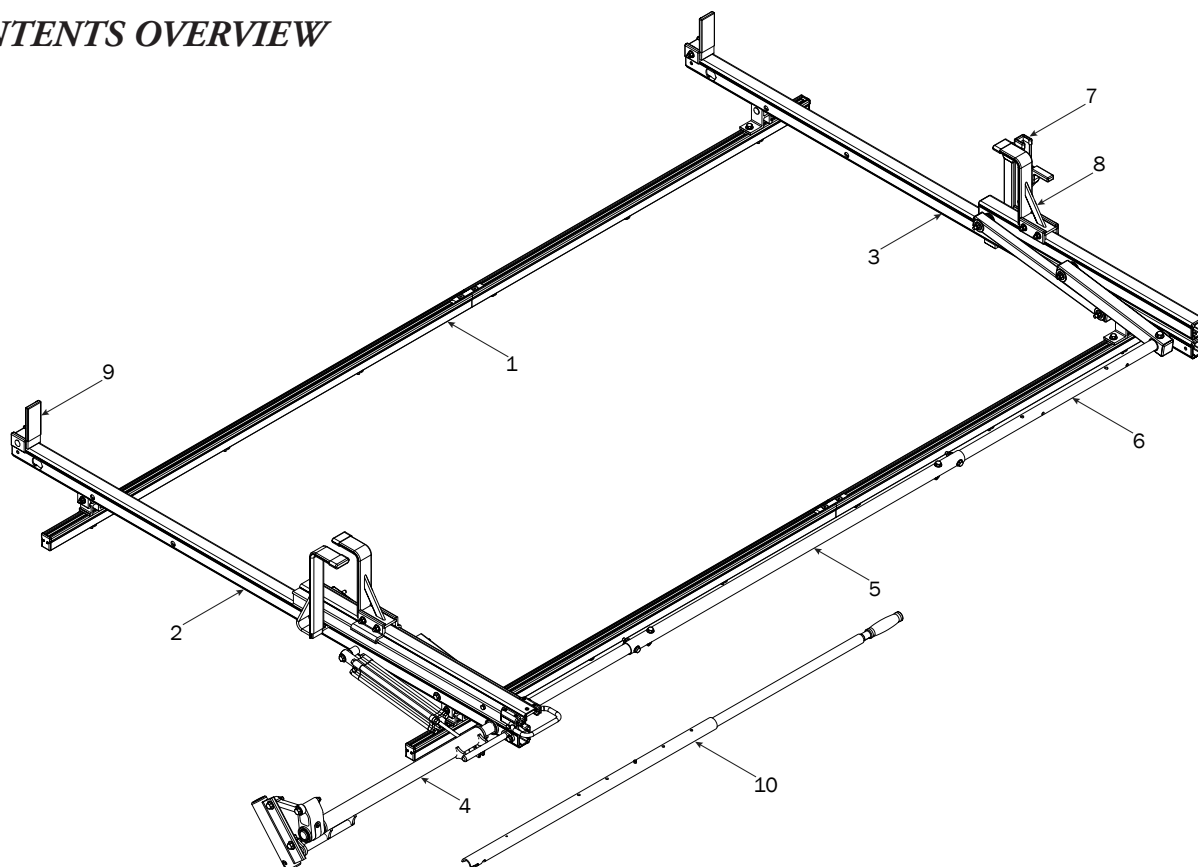

1—FBM-0057 ..... (Qty 1)  
Channels with hardware

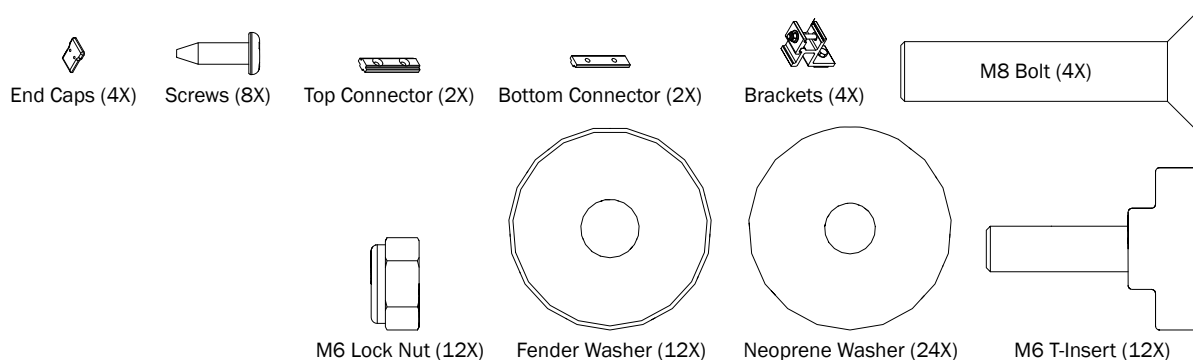

2—Rear Crossbar Assembly ..... (Qty 1)

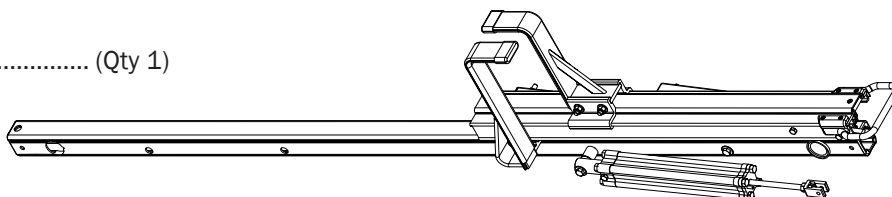

3—Front Crossbar Assembly ..... (Qty 1)

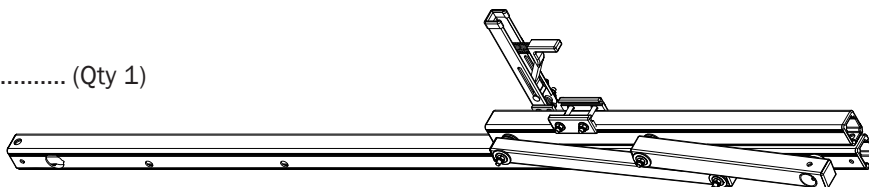

4—Drive Shaft ..... (Qty 1)  
Rear, Right Hand, 50.00"

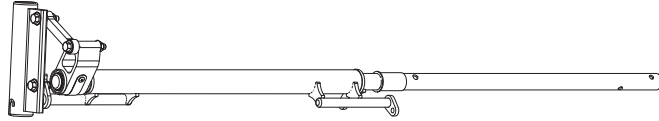

5—Connecting Bar ..... (Qty 1)  
48.00"



6—Front Drive Shaft ..... (Qty 1)  
B Version, 35.75"



7—Z Post ..... (Qty 1)  
Adjustable, 7.25"

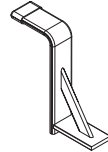

8—L Post ..... (Qty 1)  
Gen2, Roller Cap, 9.25"



9—Ladder Stop Assembly ..... (Qty 2)  
1.75"

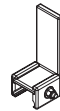

10—HRR Removeable Handle Assembly ..... (Qty 1)

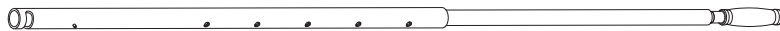

11—HKT-8163 (Not called out in Overview) ..... (Qty 1)

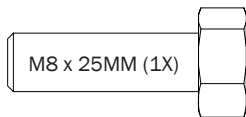

M8 x 25MM (1X)

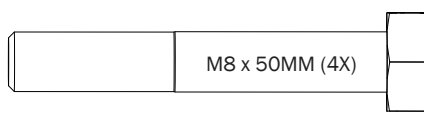

M8 x 50MM (4X)

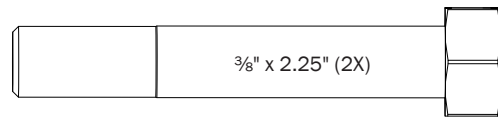

3/8" x 2.25" (2X)



Cotter Pin (1X)

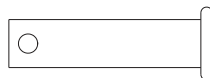

Clevis Pin (1X)

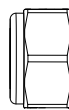

M8 Lock Nut (5X)

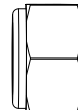

3/8" Lock Nut (2X)

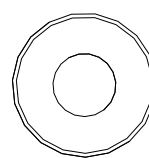

5/16" Flat Washer (10X)

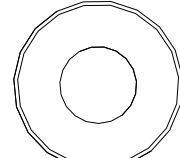

3/8" Flat Washer (4X)

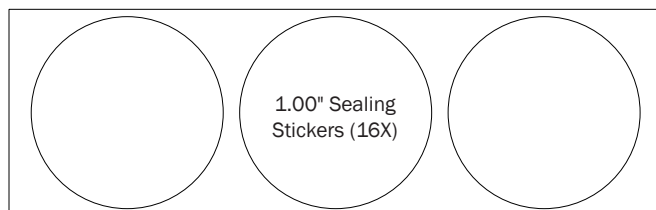

1.00" Sealing  
Stickers (16X)



Anti-Seize (1X)

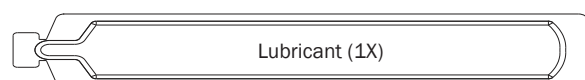

Lubricant (1X)

## FBM-0057 MOUNTING BRACKETS

0.1

Assemble Channel hardware through roof as shown, but do not tighten.

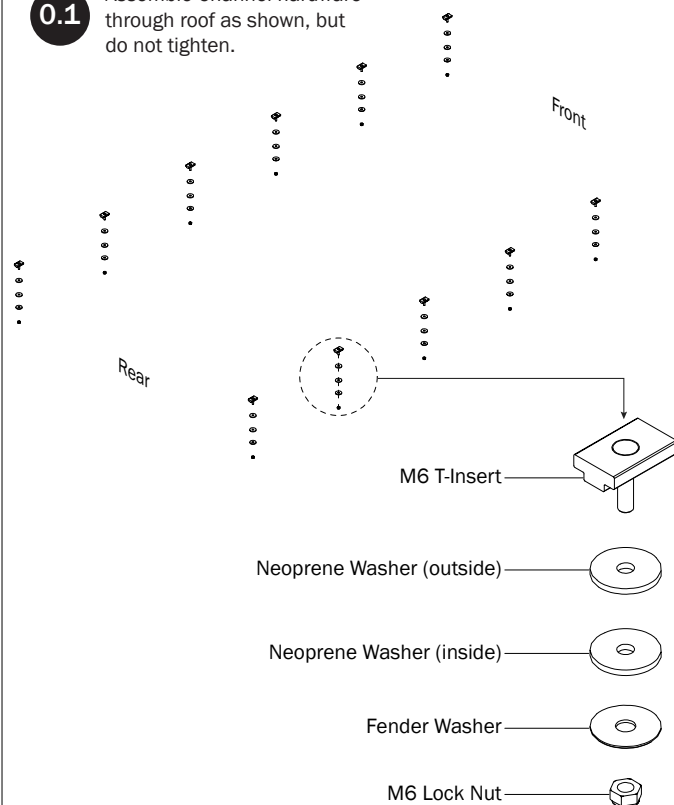

Slide Channels onto  
Mounting Brackets

0.2

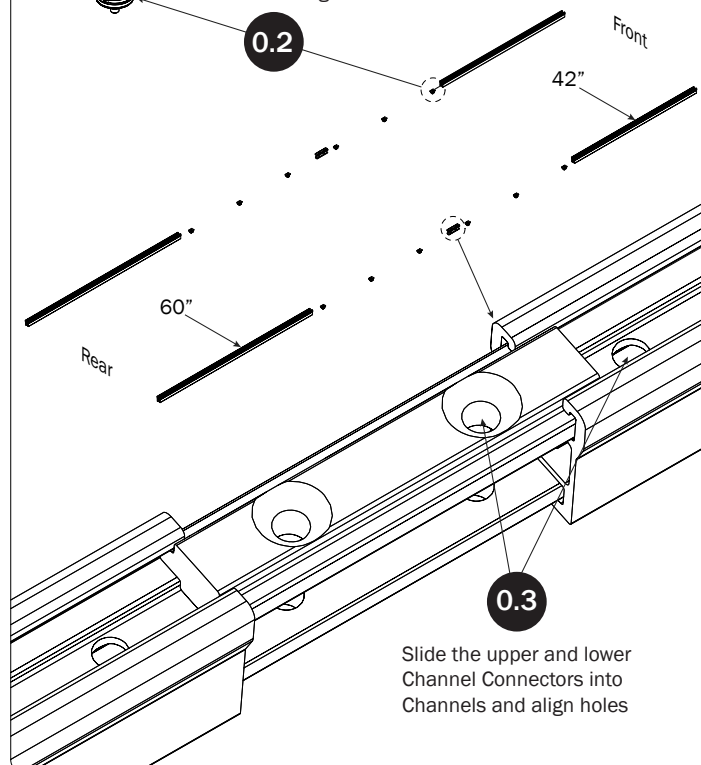

0.3

Slide the upper and lower  
Channel Connectors into  
Channels and align holes

M8 x 40MM Bolt

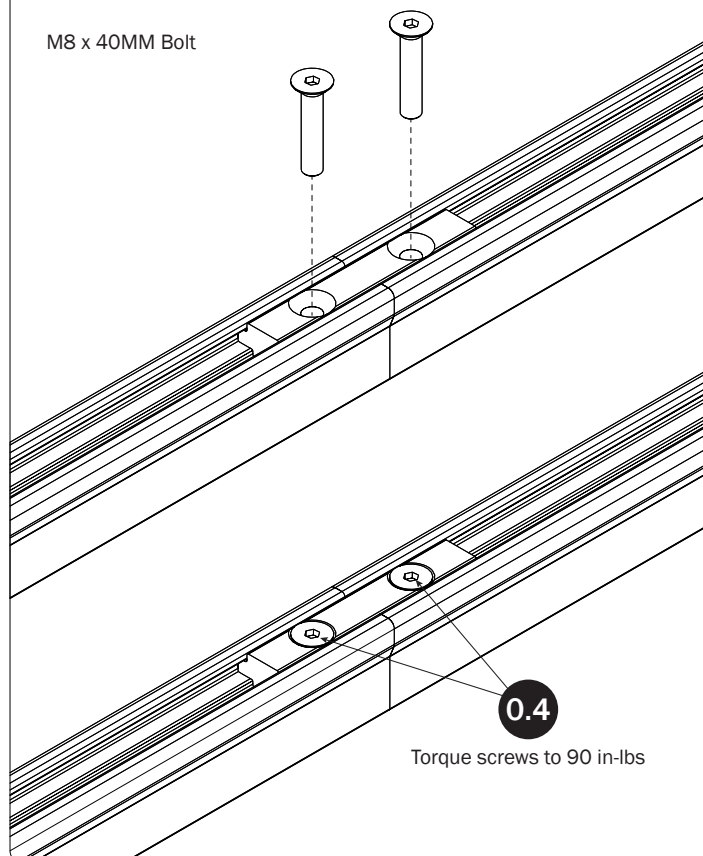

0.5

Set to specified distances shown below, then torque Mounting hardware nuts to 80 in-lbs.

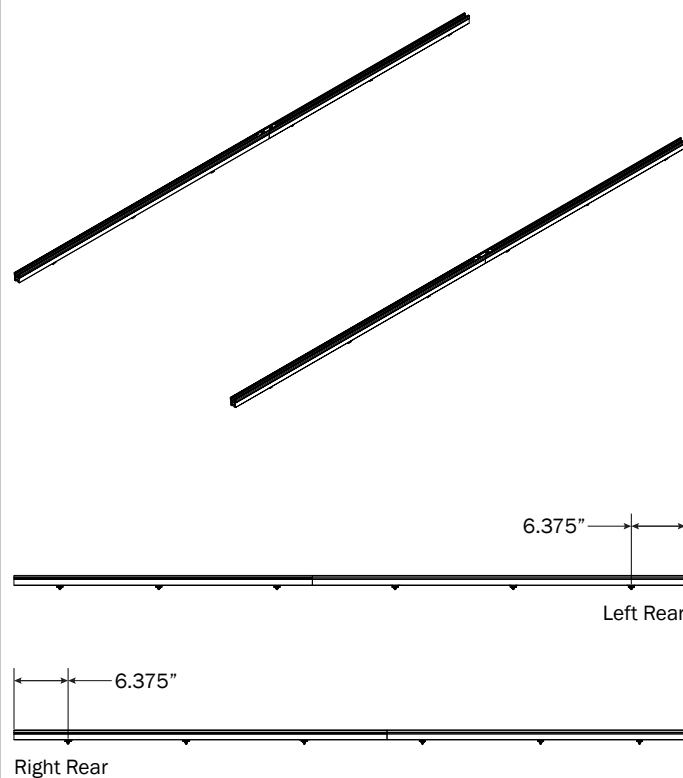

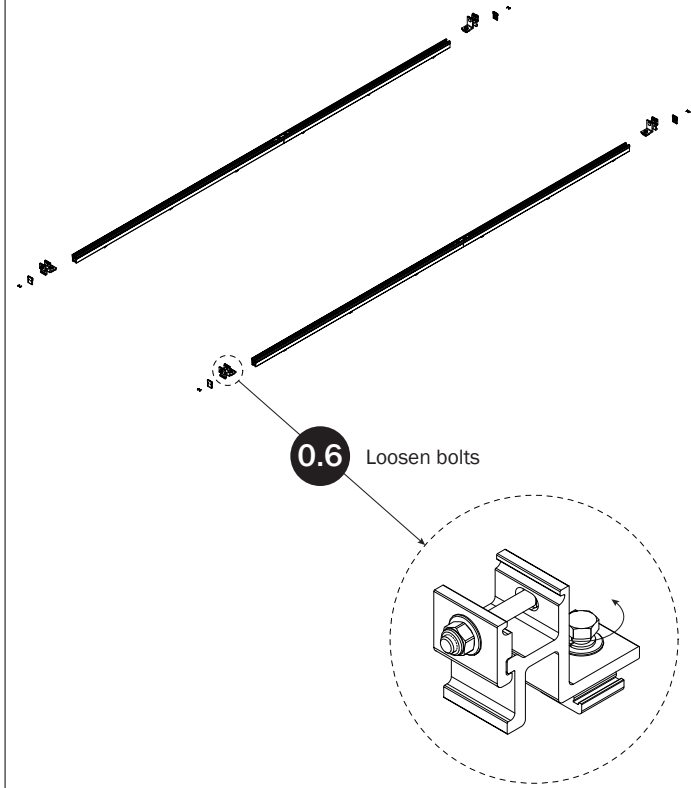

**0.7** Set to distances then torque Bracket nuts to 90 in-lbs

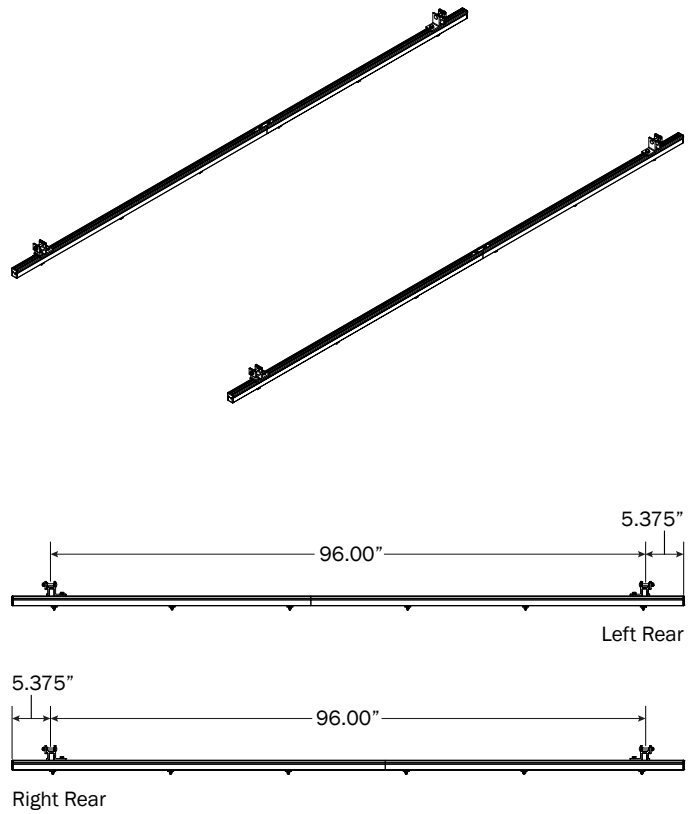

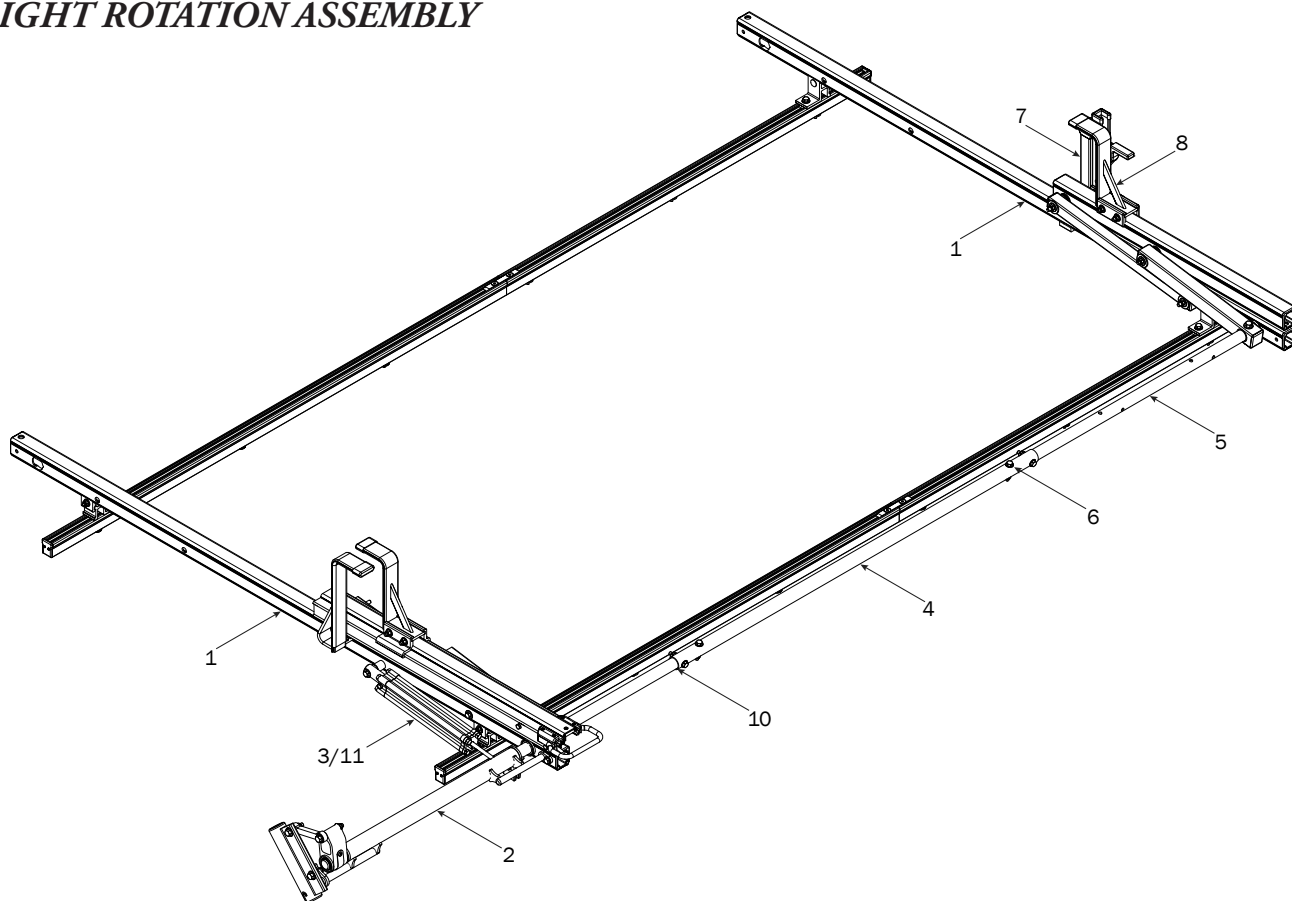
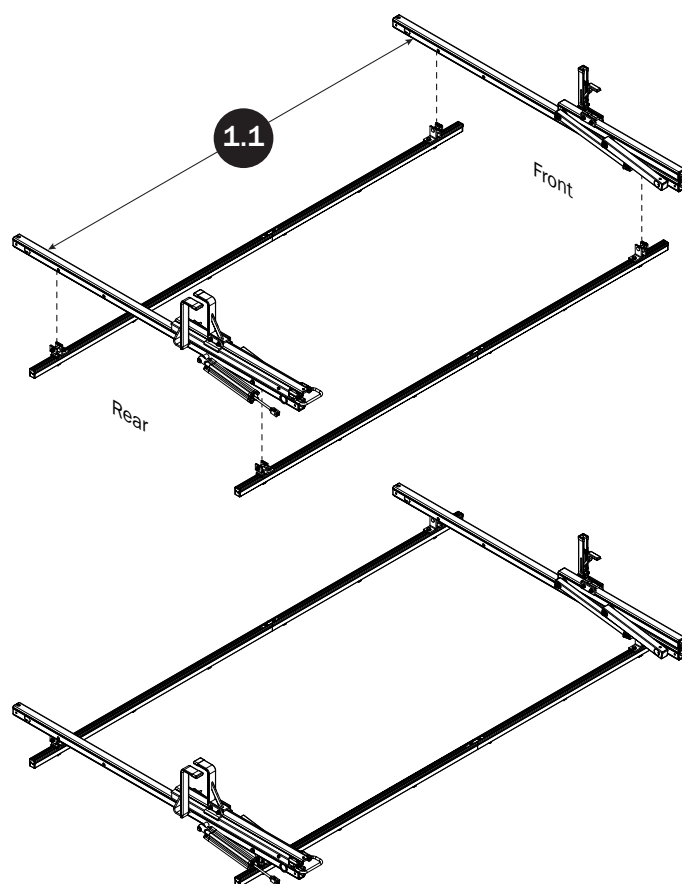
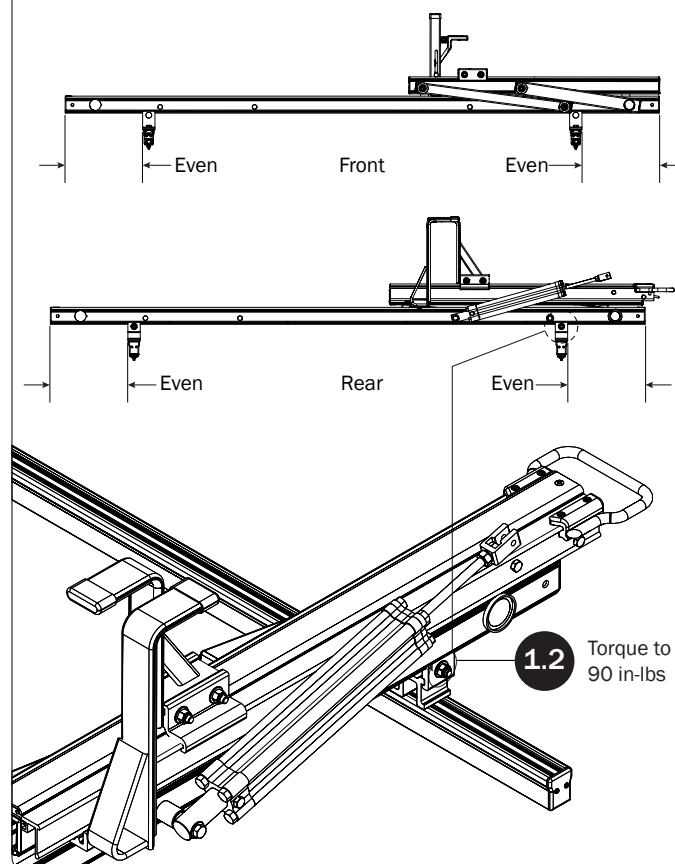
**RIGHT ROTATION ASSEMBLY****CROSSBARS****CROSSBAR ADJUSTMENT**

## REAR DRIVE SHAFT

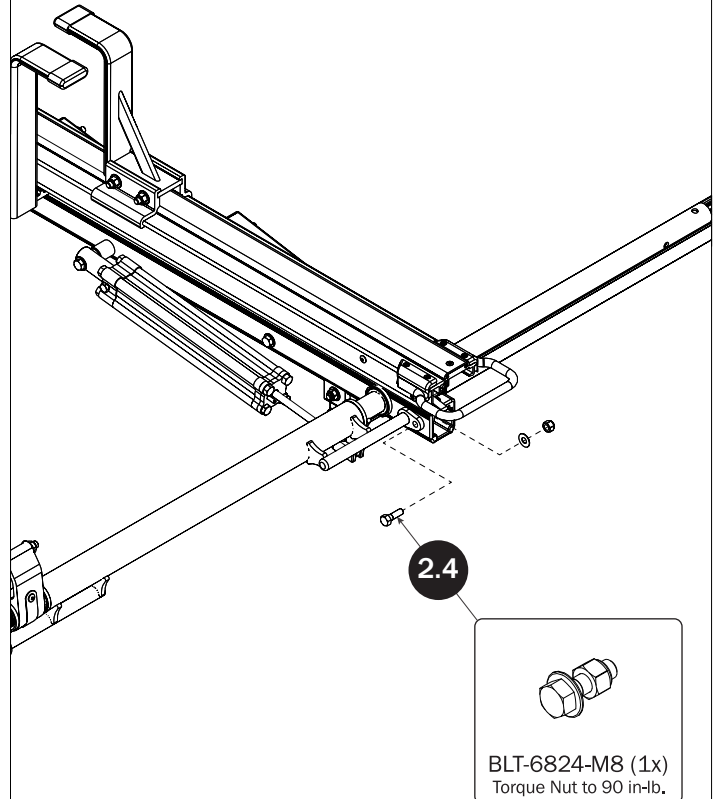
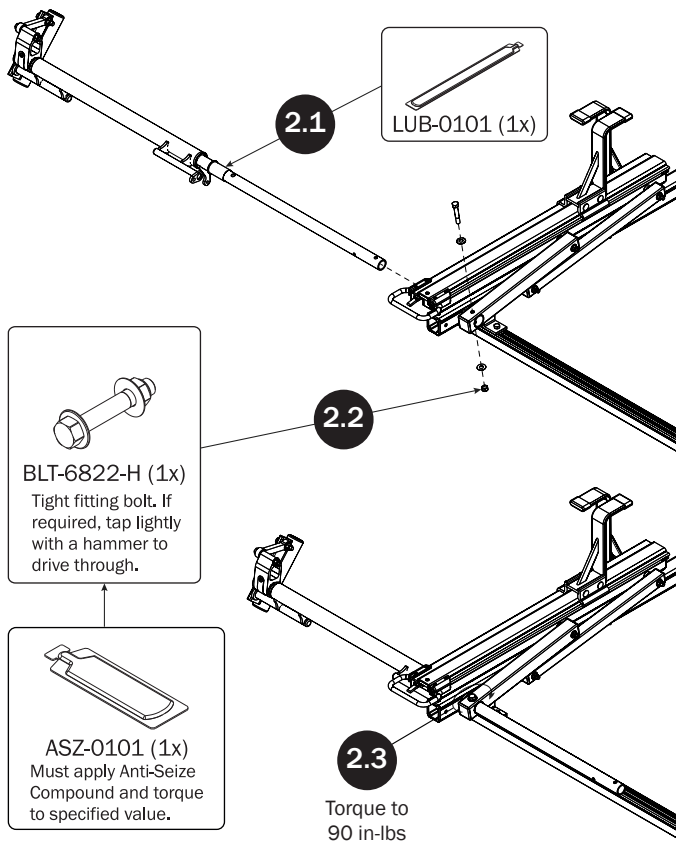

## CYLINDER HARDWARE

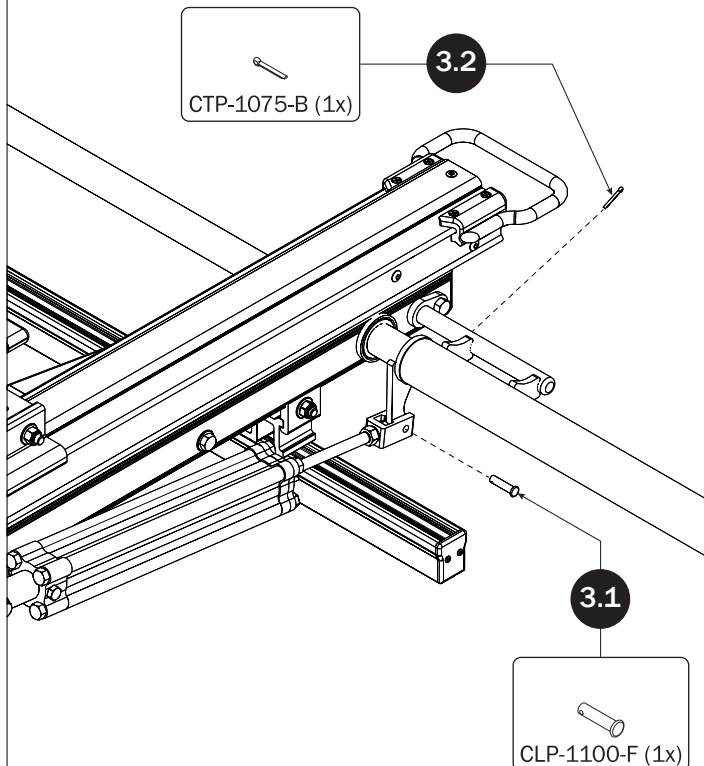

## CONNECTING BAR

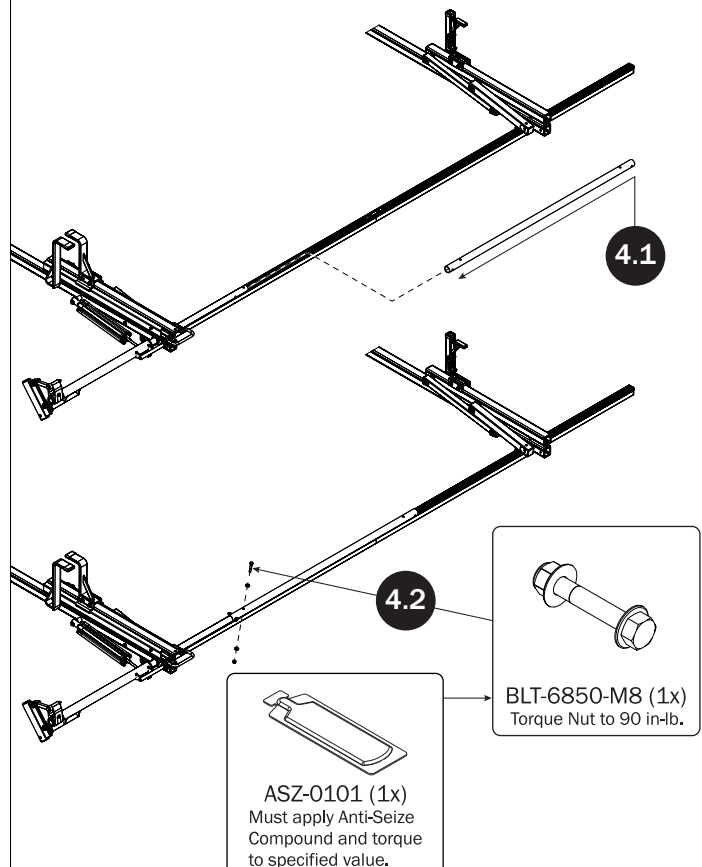

## FRONT DRIVE SHAFT

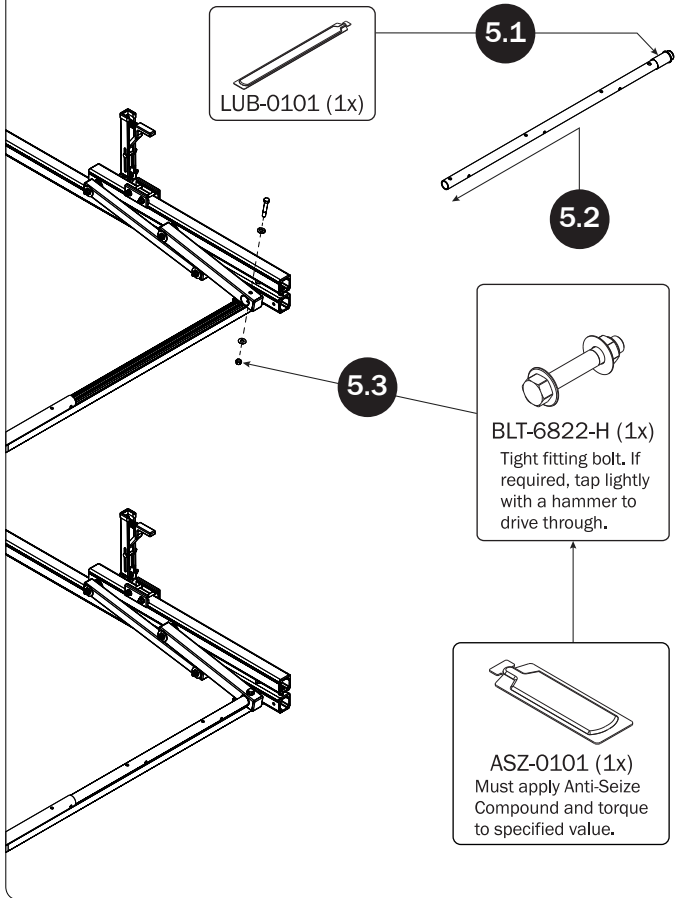

## CONNECTING BAR FASTENERS

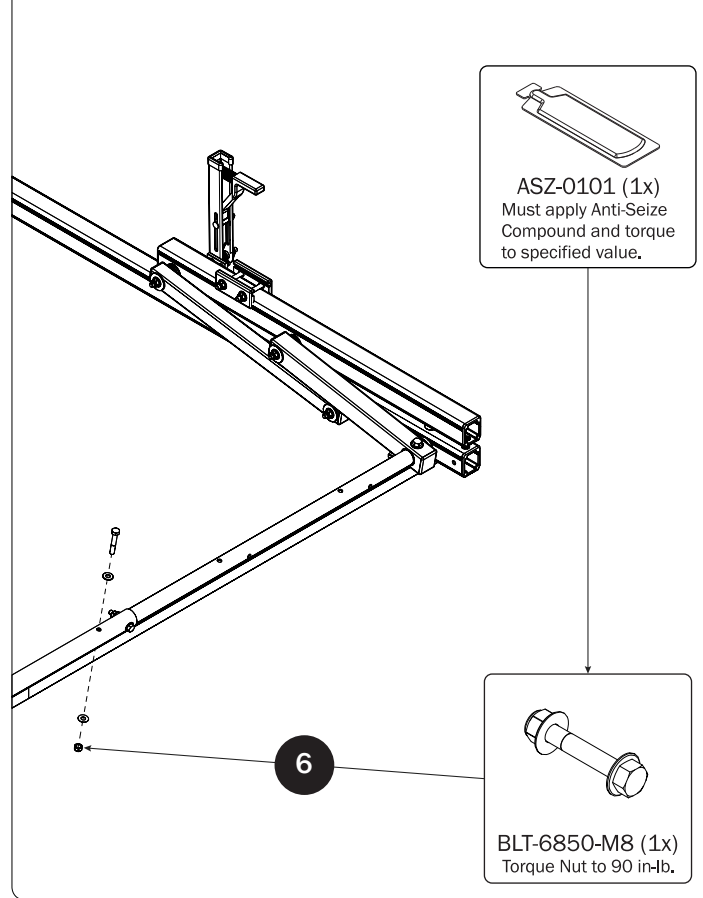

## L POST

SEE QUICK START GUIDE FOR ADJUSTMENTS

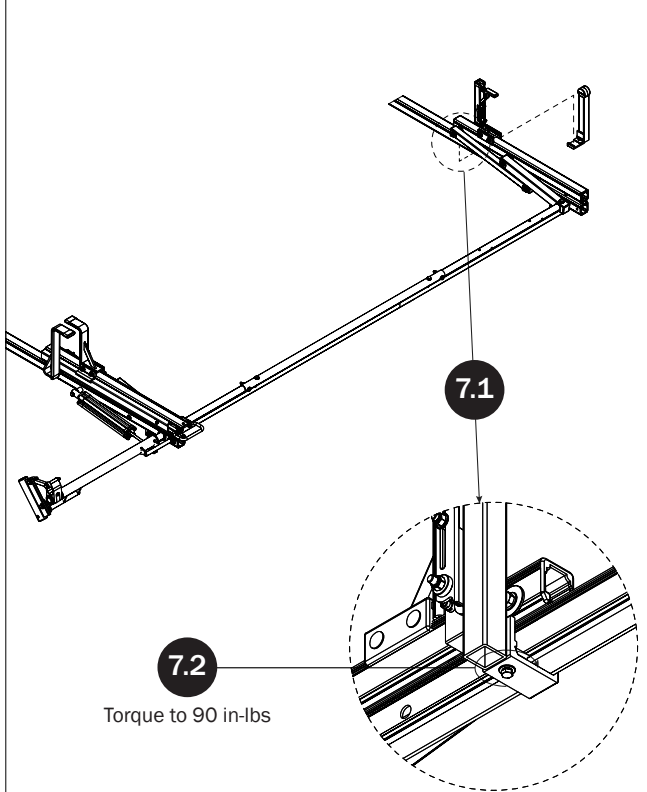

## Z POST

SEE QUICK START GUIDE FOR ADJUSTMENTS

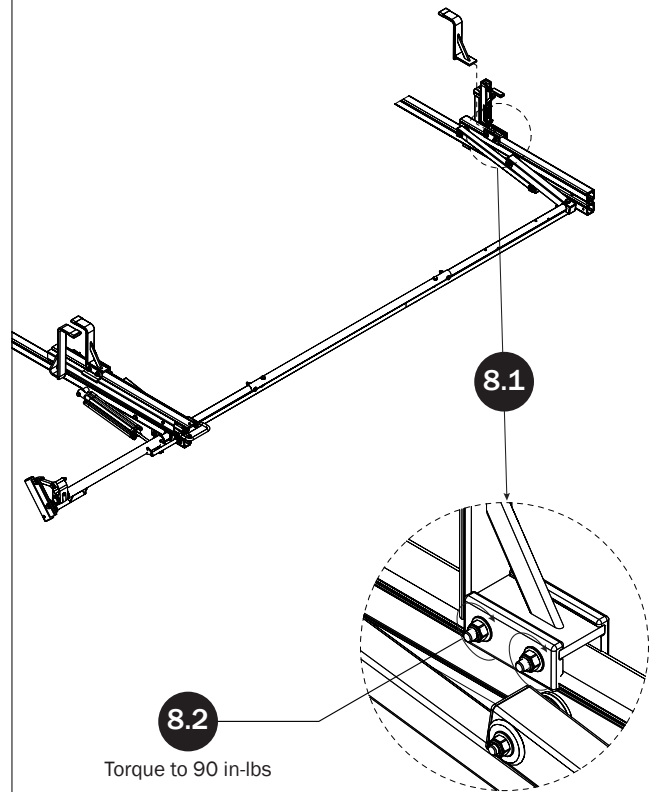



## LEFT SIDE BASE

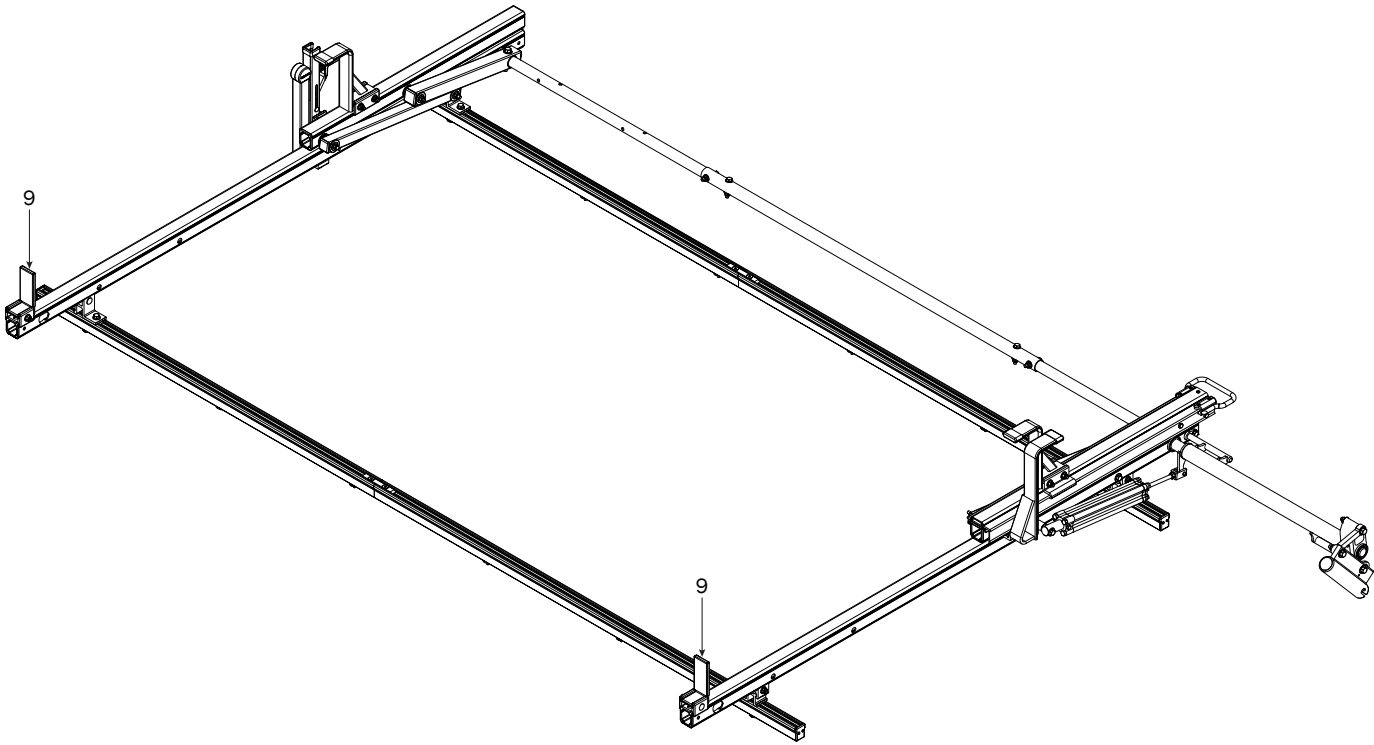

## LADDER STOPS

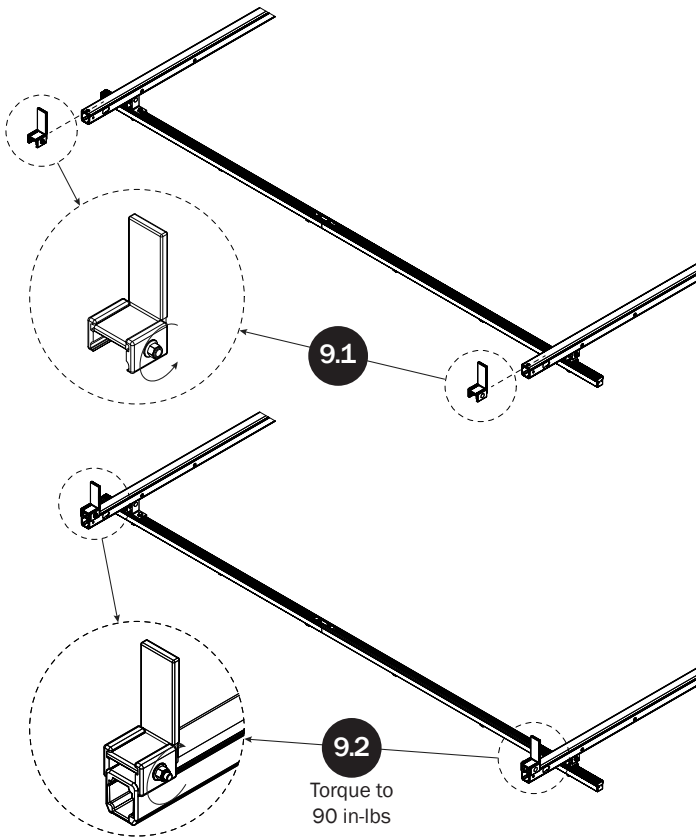

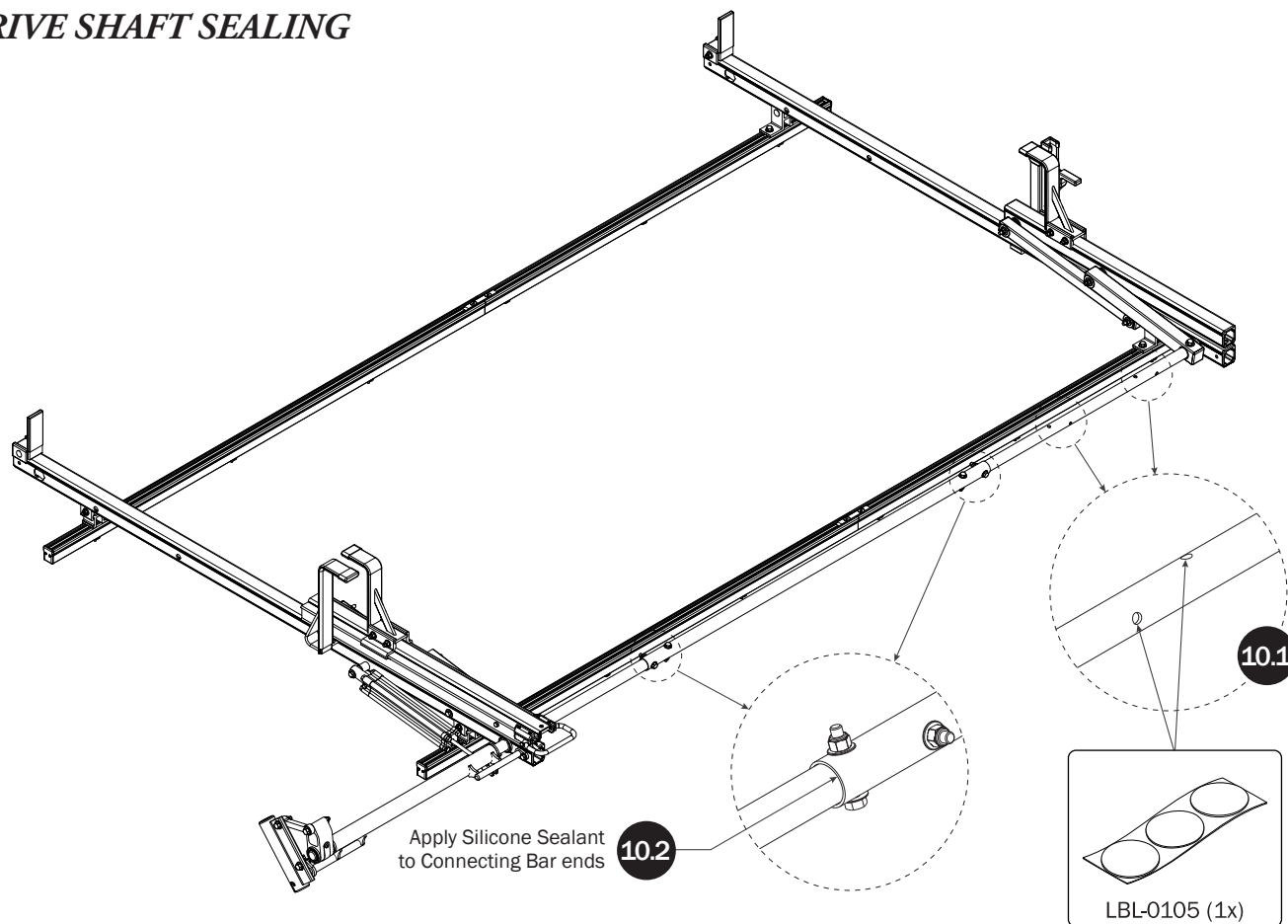
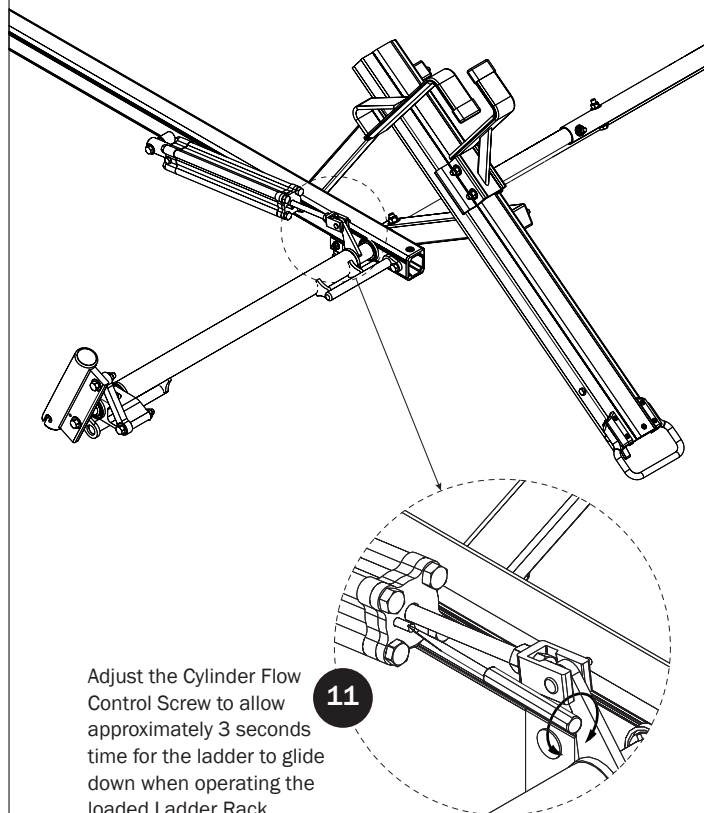
**DRIVE SHAFT SEALING****CYLINDER ADJUSTMENT**

Page Intentionally Left Blank

