

PRIME DESIGN™

A Safe Fleet Brand

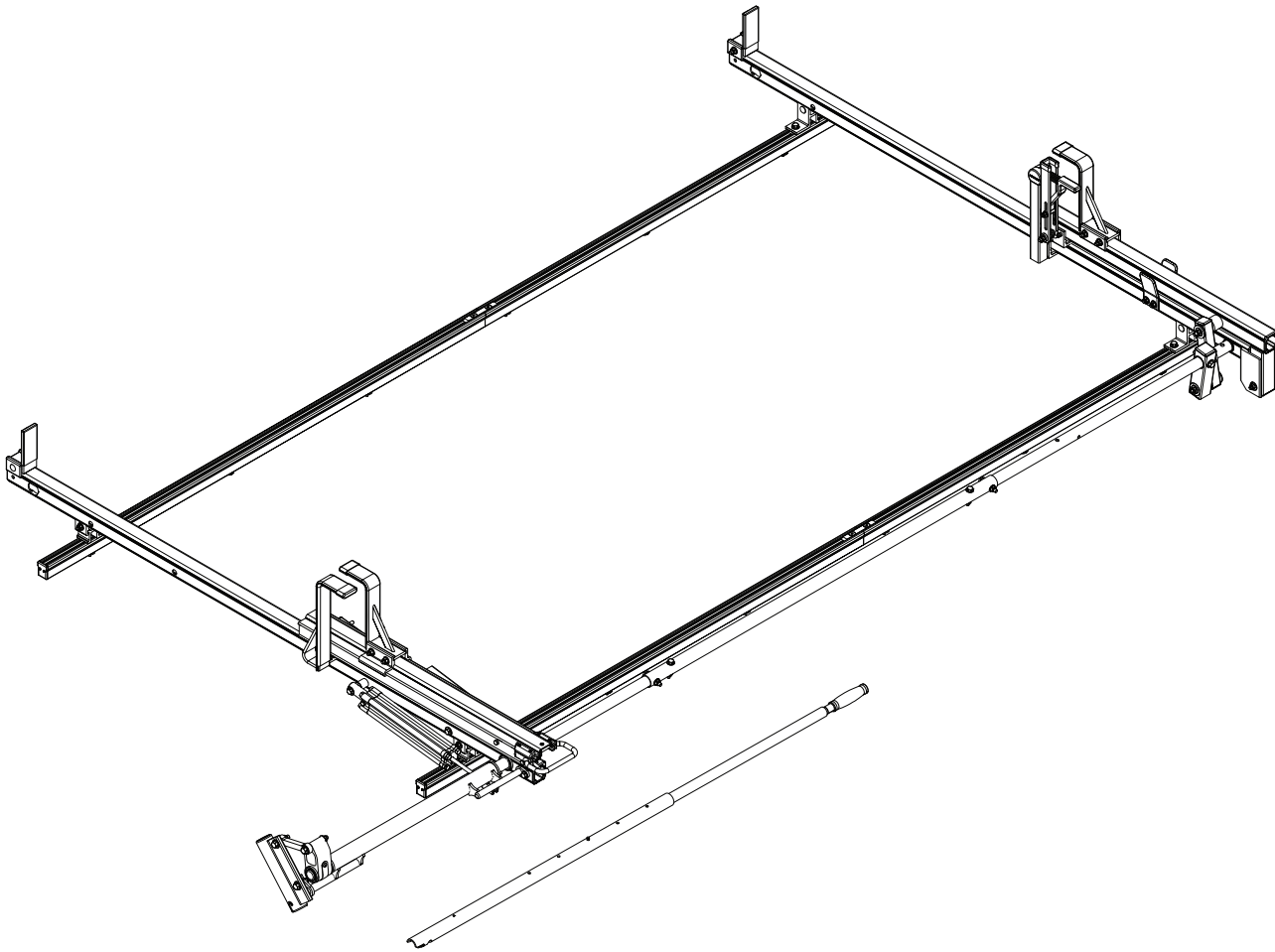

HBI-E
S
CS

CONTENTS OVERVIEW

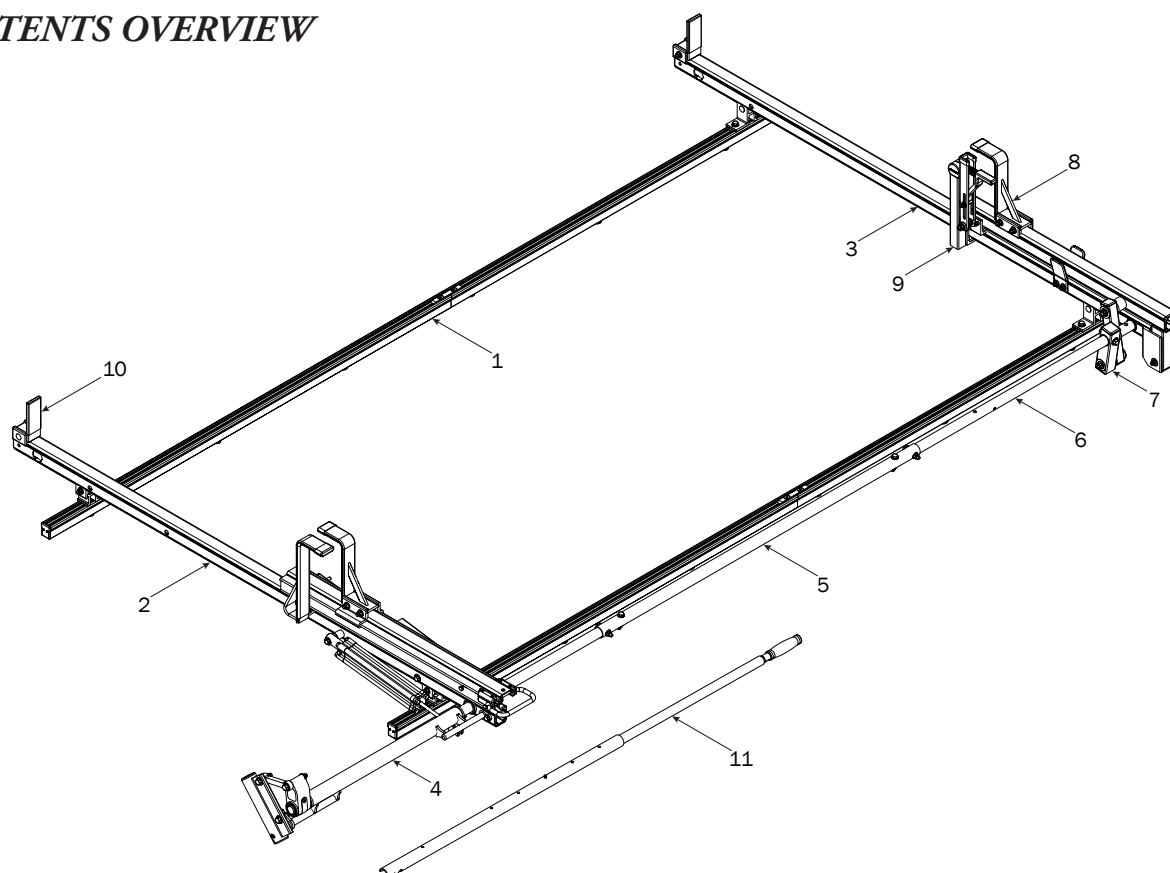

1—FBM-0057 (Qty 1)
Channels with hardware

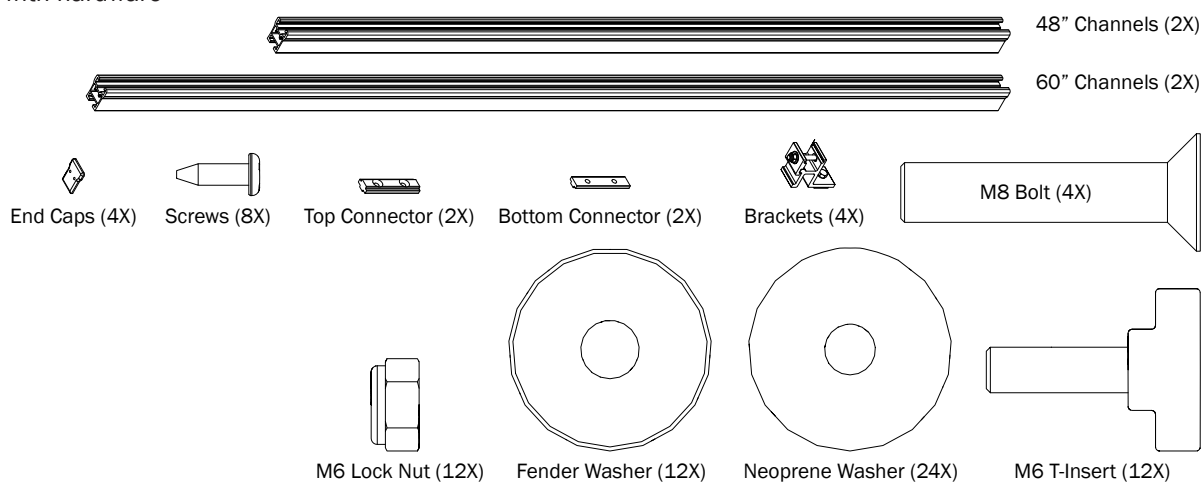

2—Rear Crossbar Assembly (Qty 1)

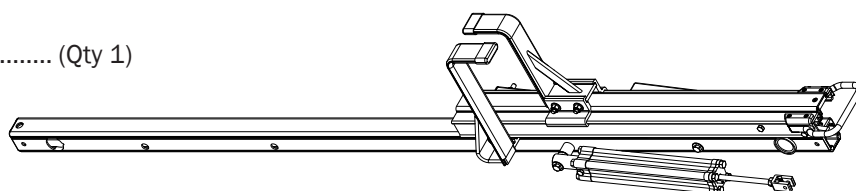

3—Front Crossbar Assembly (Qty 1)

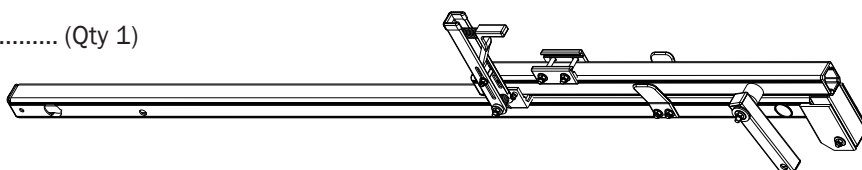

4—Drive Shaft (Qty 1)
Rear, Right Hand, 50.00"

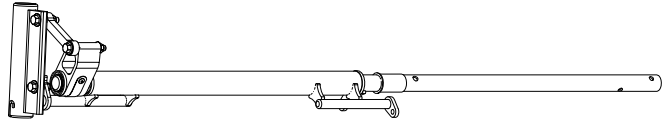

5—Connecting Bar (Qty 1)
48.00"

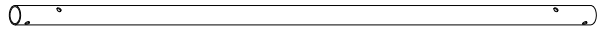

6—Front Drive Shaft (Qty 1)
B Version, 38.75"

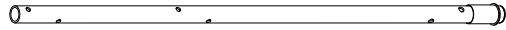

7—Drive Arm (Qty 1)
Incline Version with Bushing and Hardware

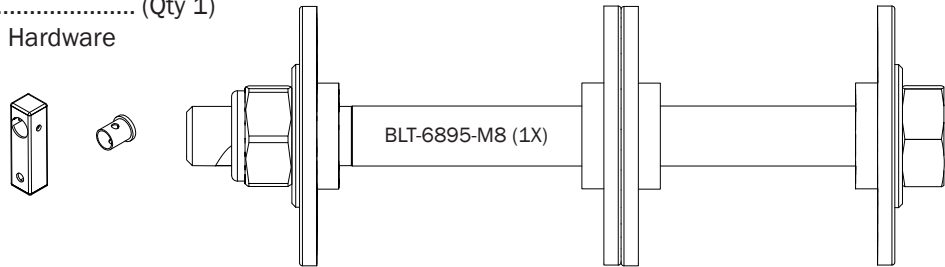

8—Z Post (Qty 1)
Adjustable 7.25"

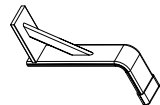

9—L Post (Qty 1)
Gen2, Roller Cap , 9.25"

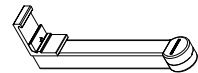

10—Ladder Stop Assembly (Qty 2)
1.75"

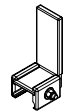

11—HRR Removeable Handle Assembly (Qty 1)

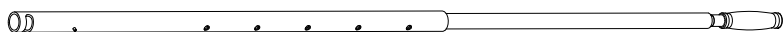

HKT-8163-Rotation Hardware Kit

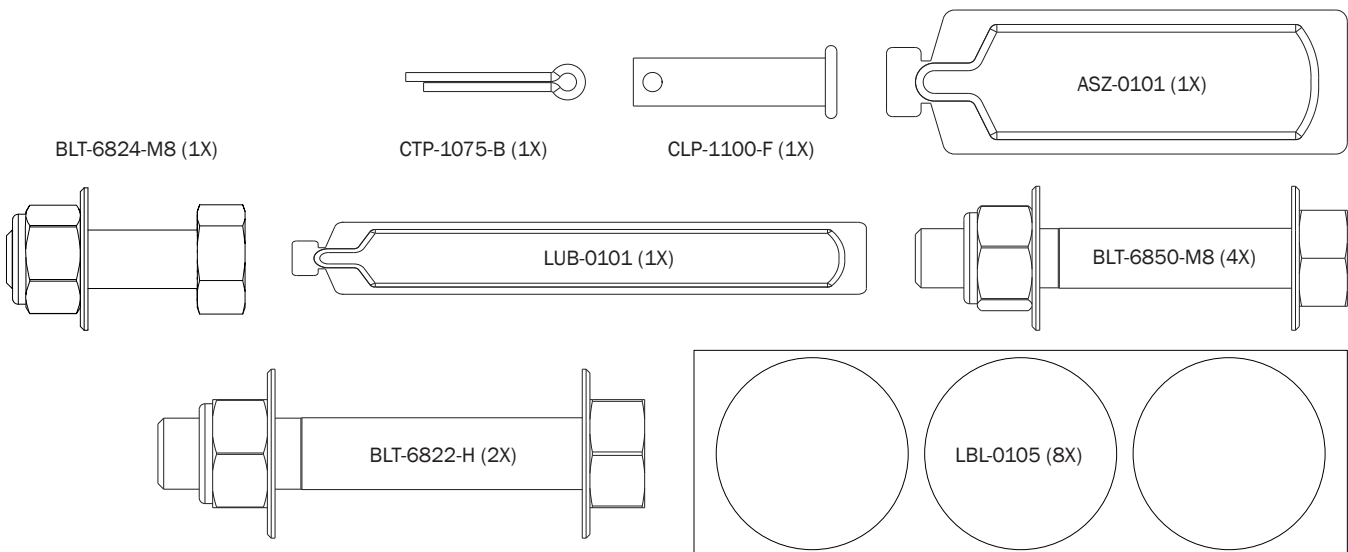

FBM-0057
MOUNTING BRACKETS**0.1**

Assemble Channel hardware through roof as shown, but do not tighten.

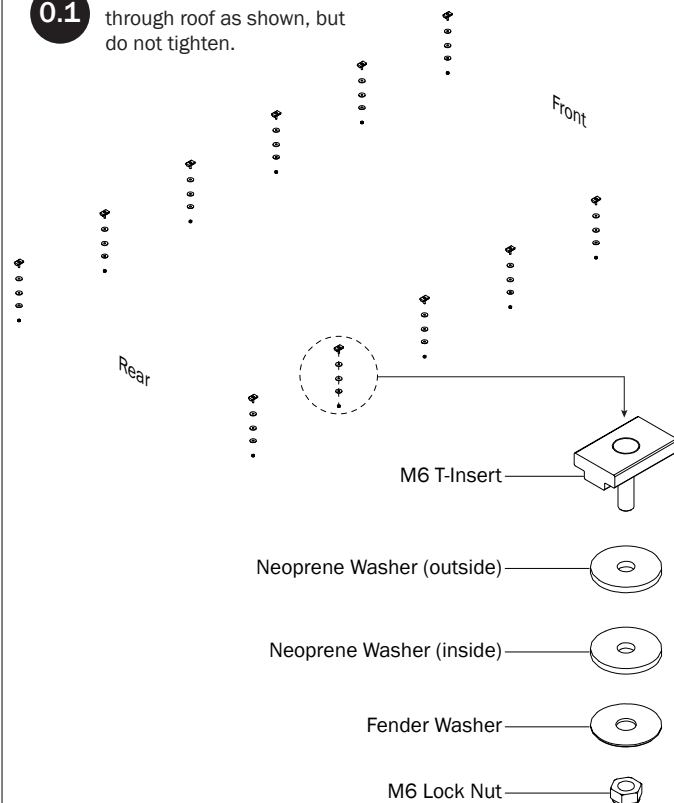

Slide Channels onto
Mounting Brackets

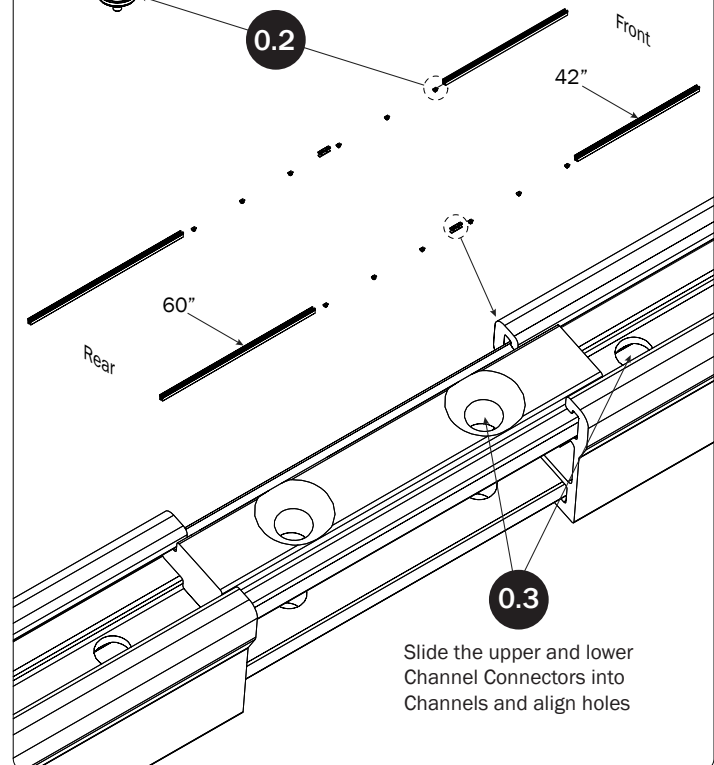
0.2**0.3**

Slide the upper and lower
Channel Connectors into
Channels and align holes

M8 x 40MM Bolt

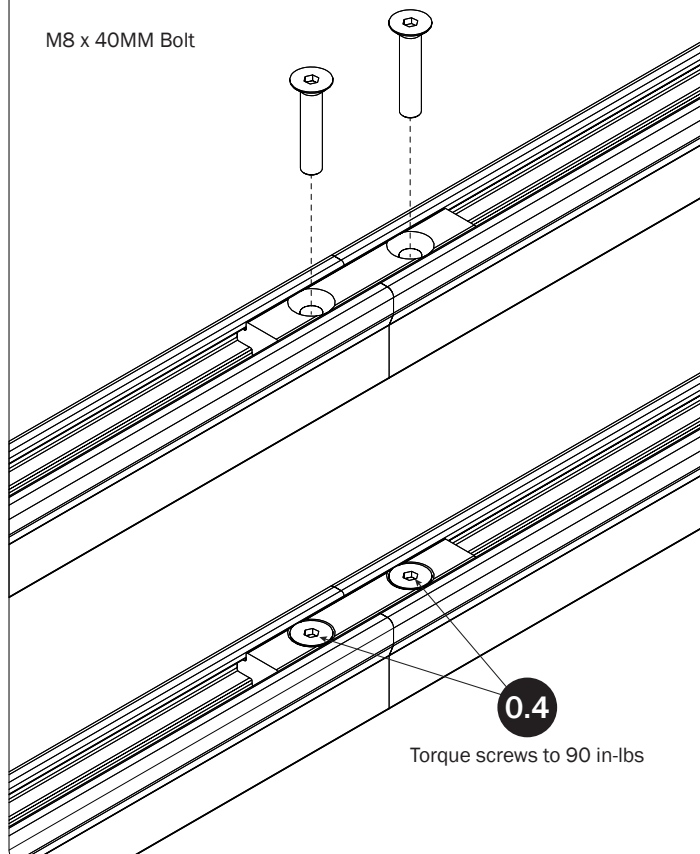
**0.5**

Set to specified distances shown below, then torque Mounting hardware nuts to 80 in-lbs.

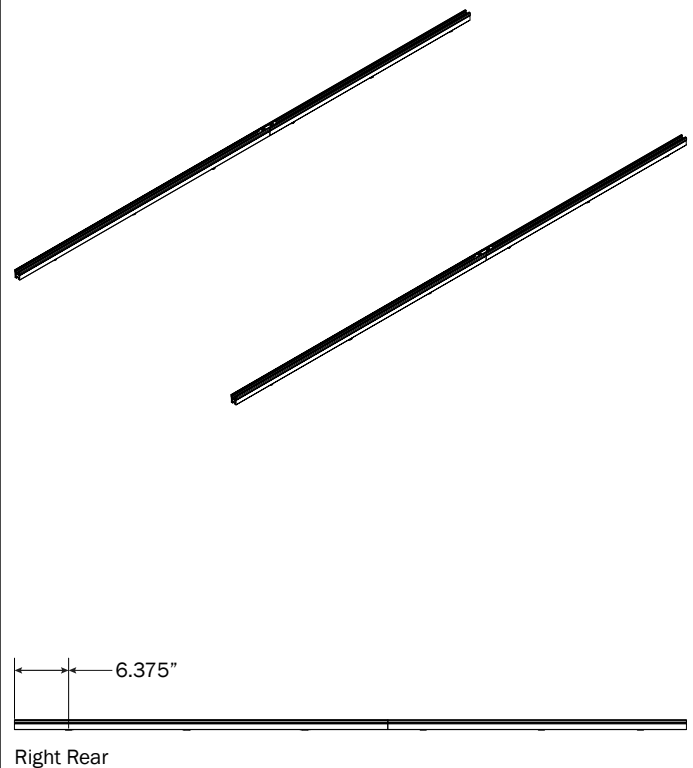

0.7 Set to distances then torque Bracket nuts to 90 in-lbs

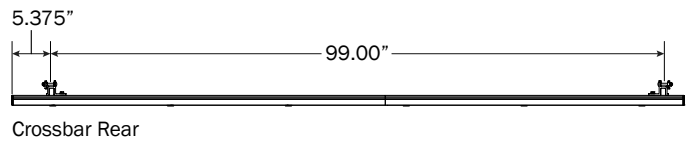

0.6 Loosen bolts

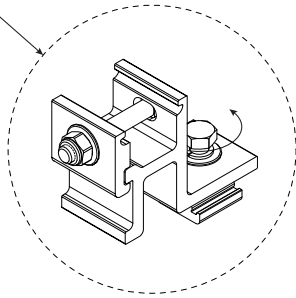

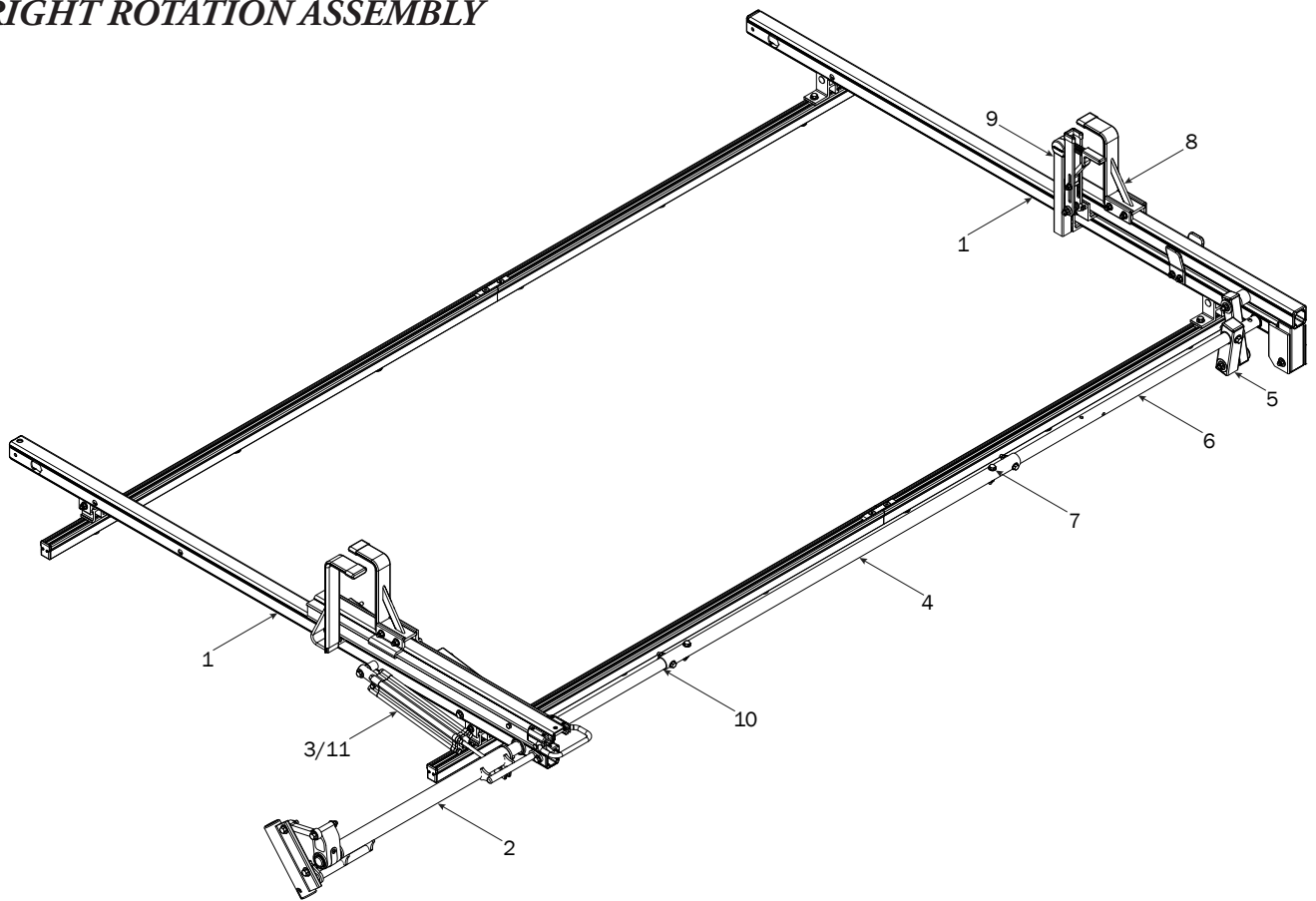
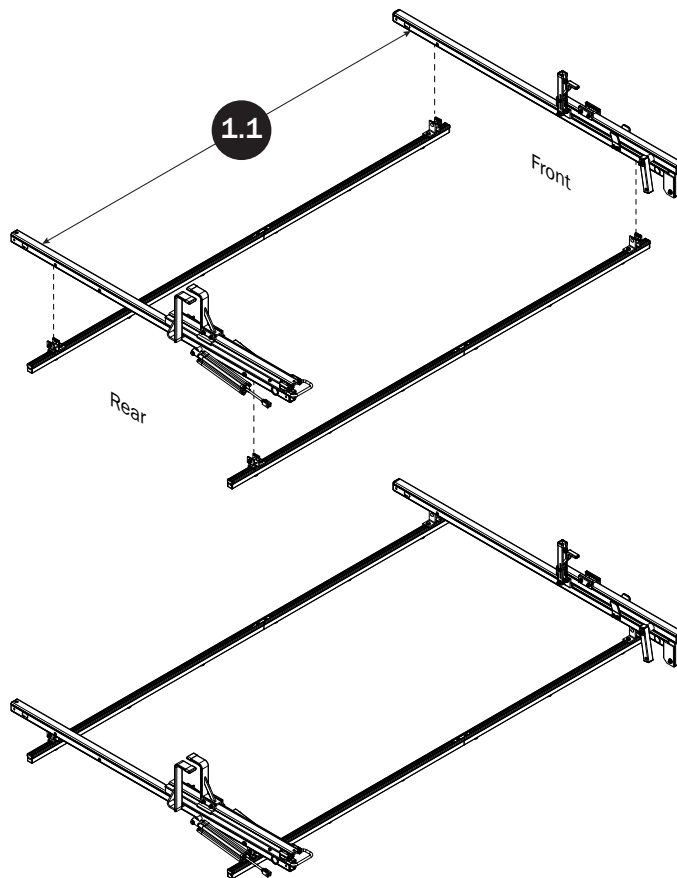
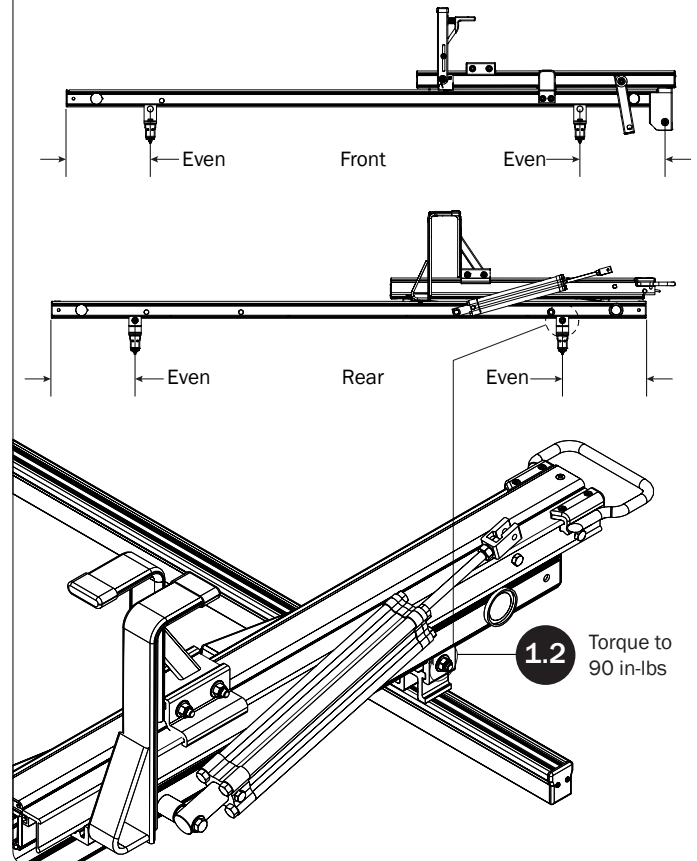
RIGHT ROTATION ASSEMBLY**CROSSBARS****CROSSBAR ADJUSTMENT**

REAR DRIVE SHAFT

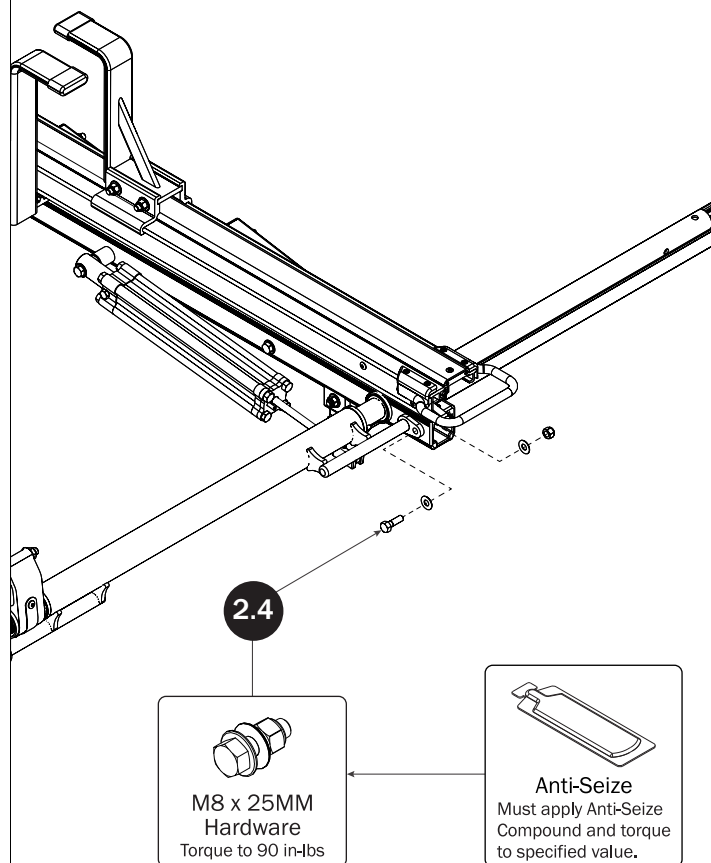
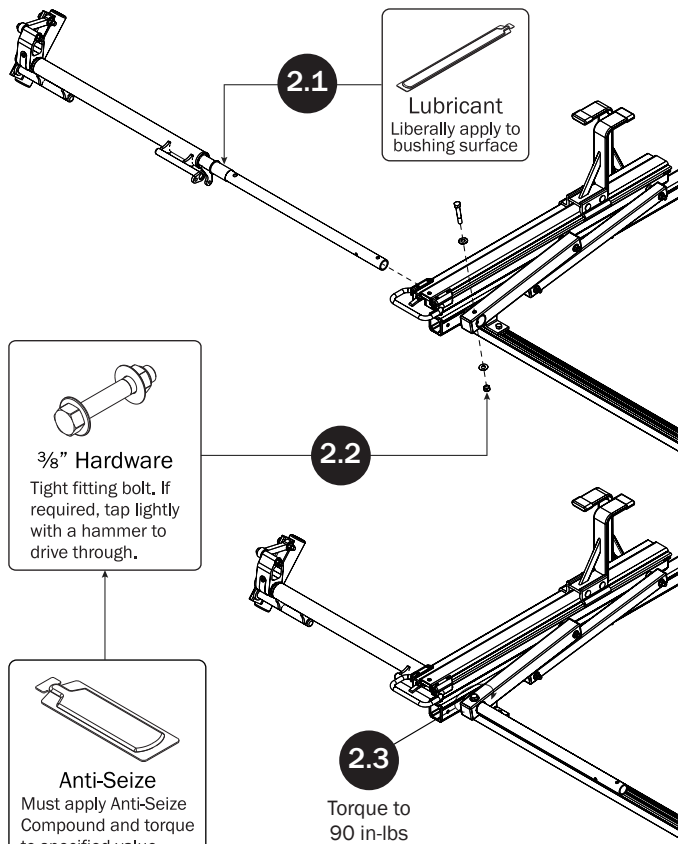

CYLINDER HARDWARE

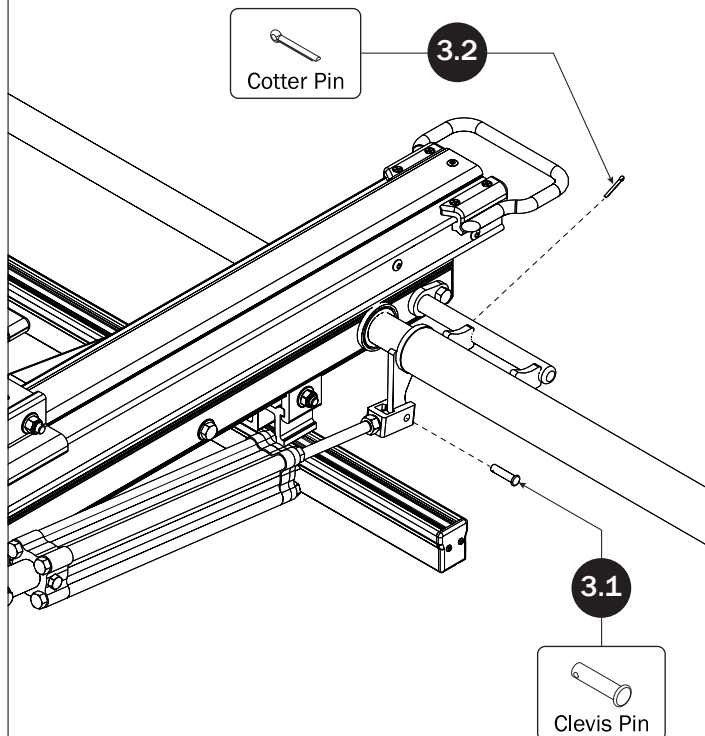

CONNECTING BAR

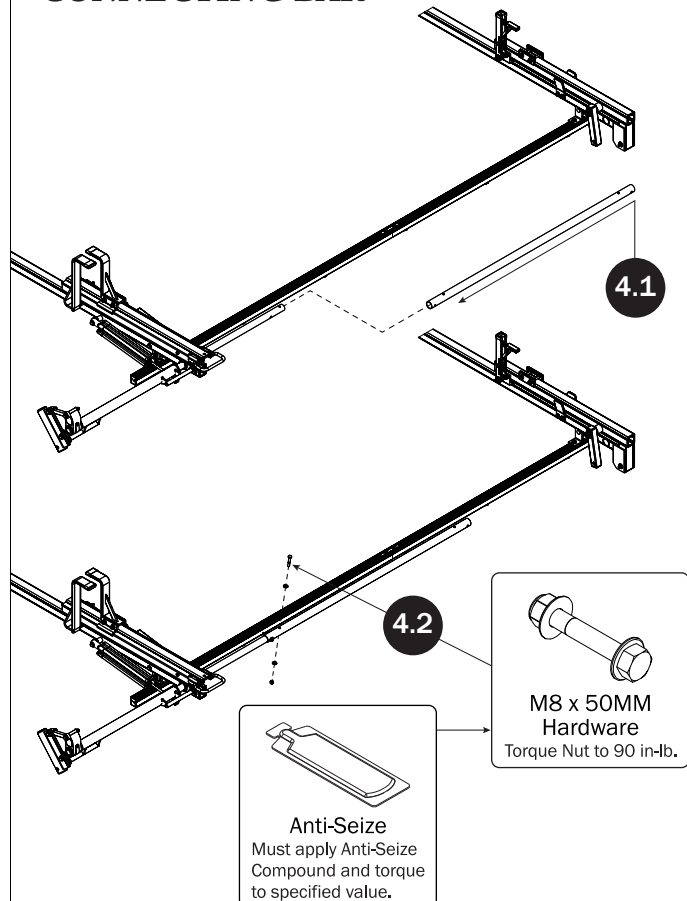

FRONT DRIVE ARM

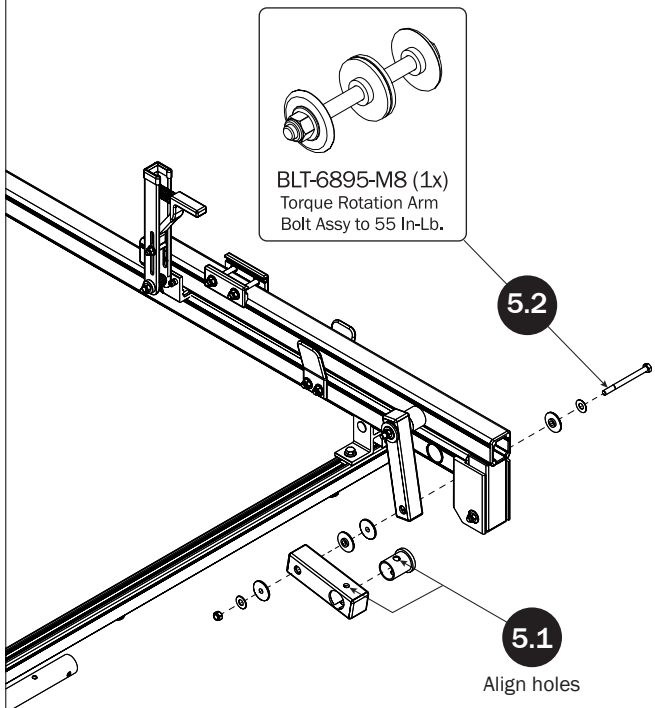

FRONT DRIVE SHAFT

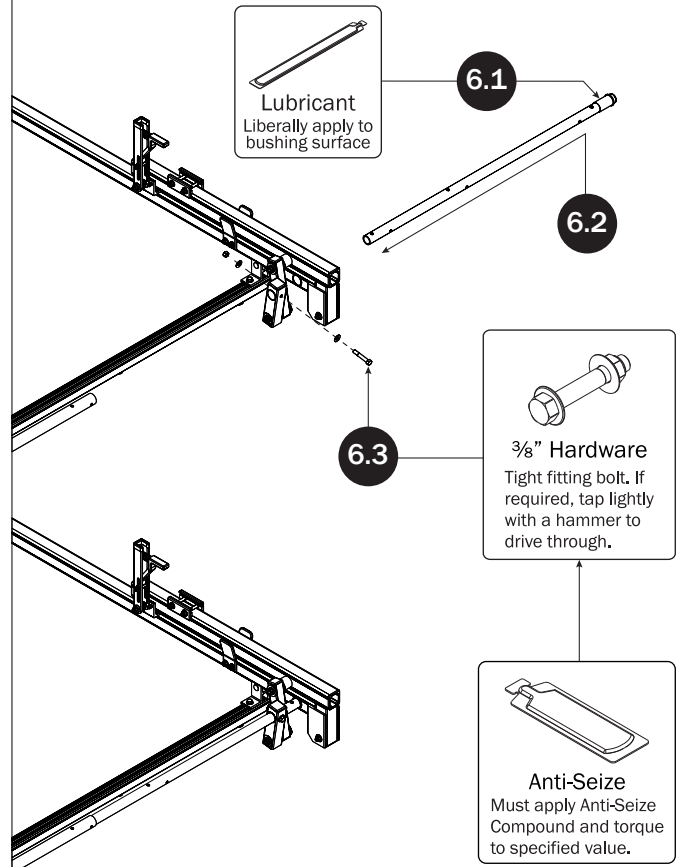

CONNECTING BAR FASTENERS

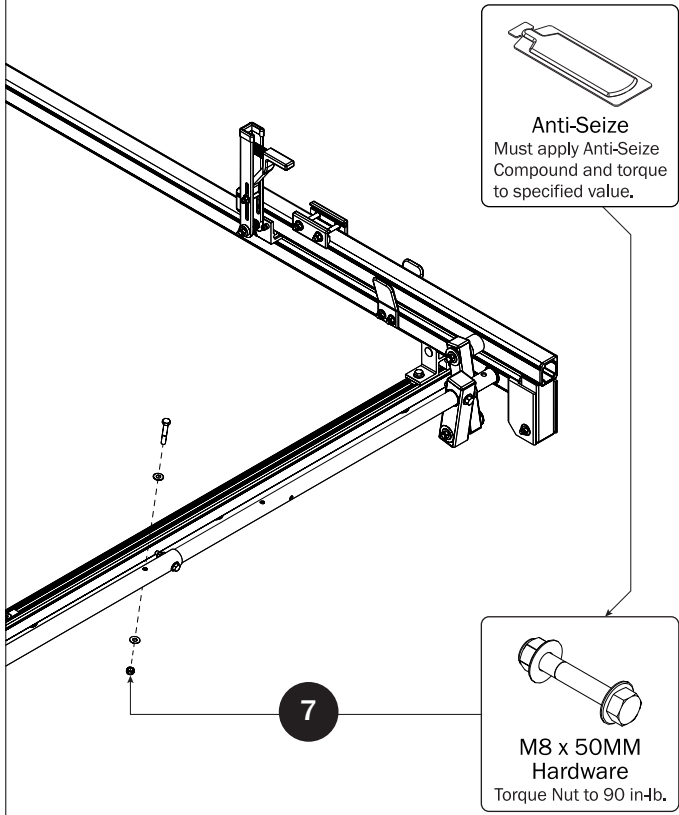

Z POST SEE QUICK START GUIDE FOR ADJUSTMENTS

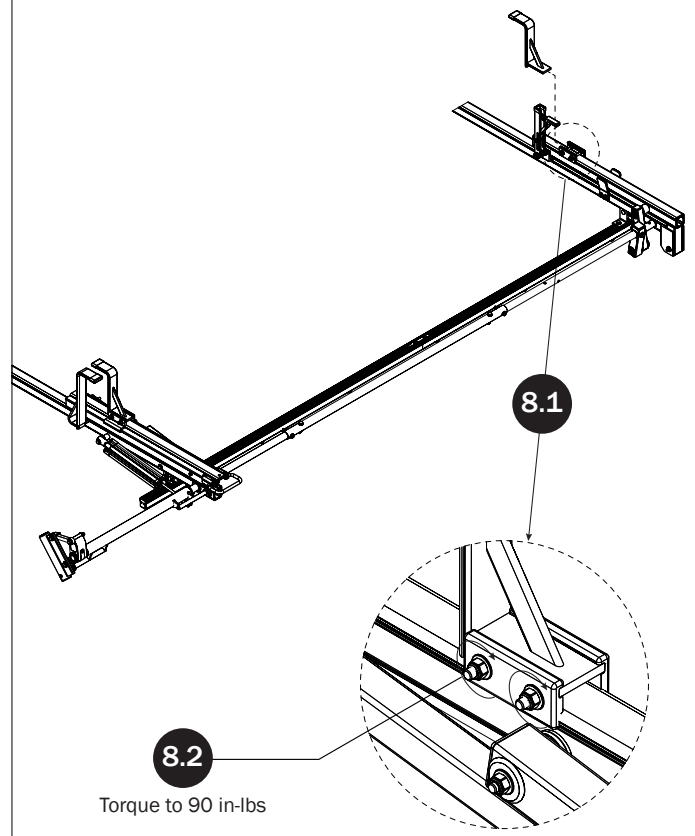

L POST

SEE QUICK START GUIDE FOR ADJUSTMENTS

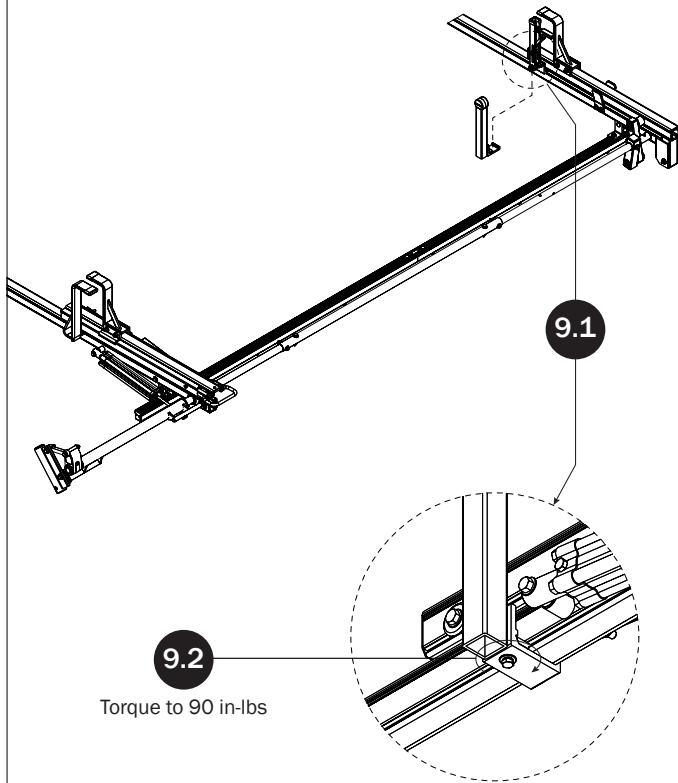
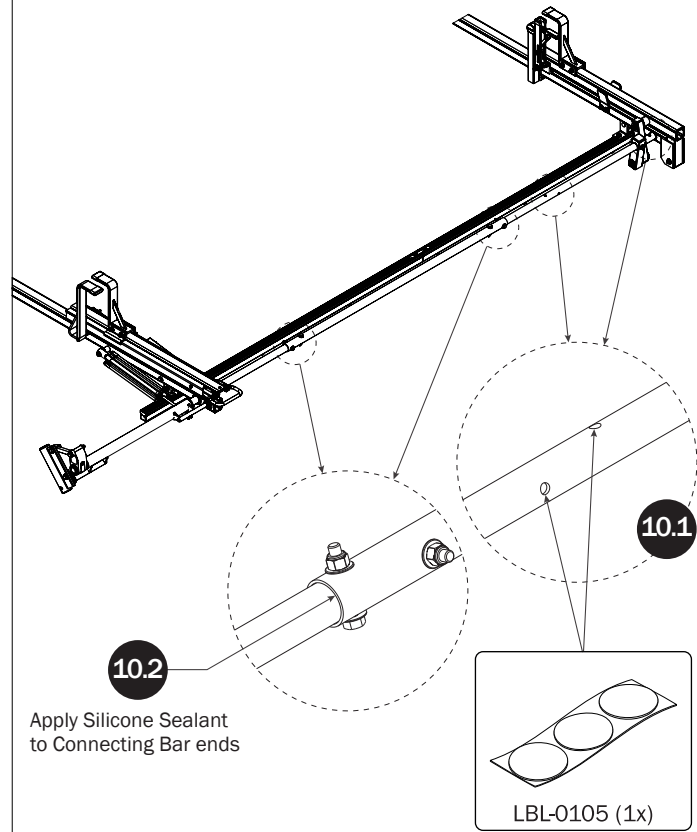
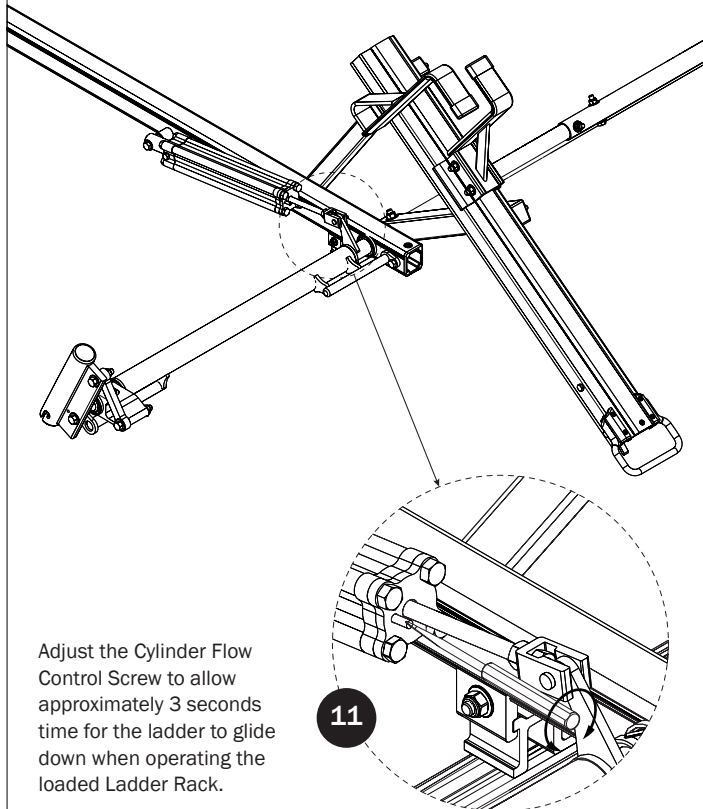
***DRIVE SHAFT SEALING******CYLINDER ADJUSTMENT***

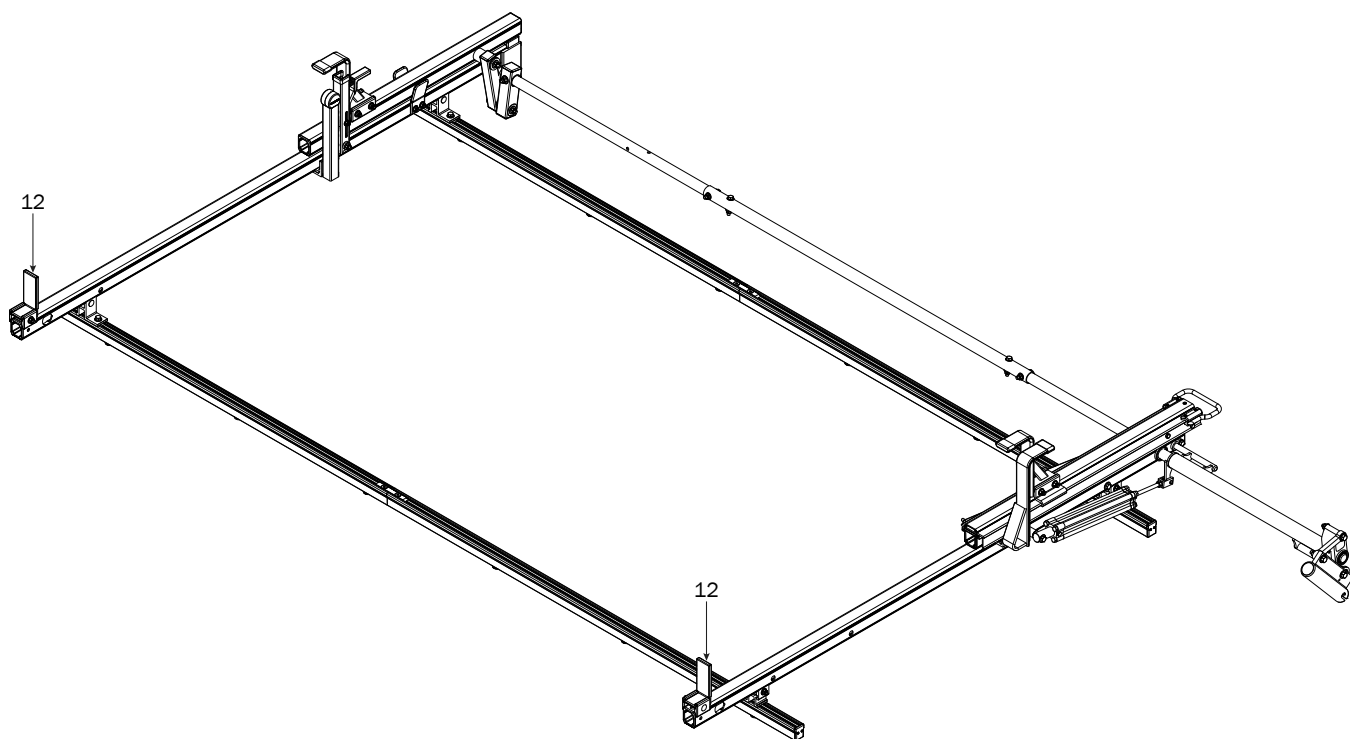
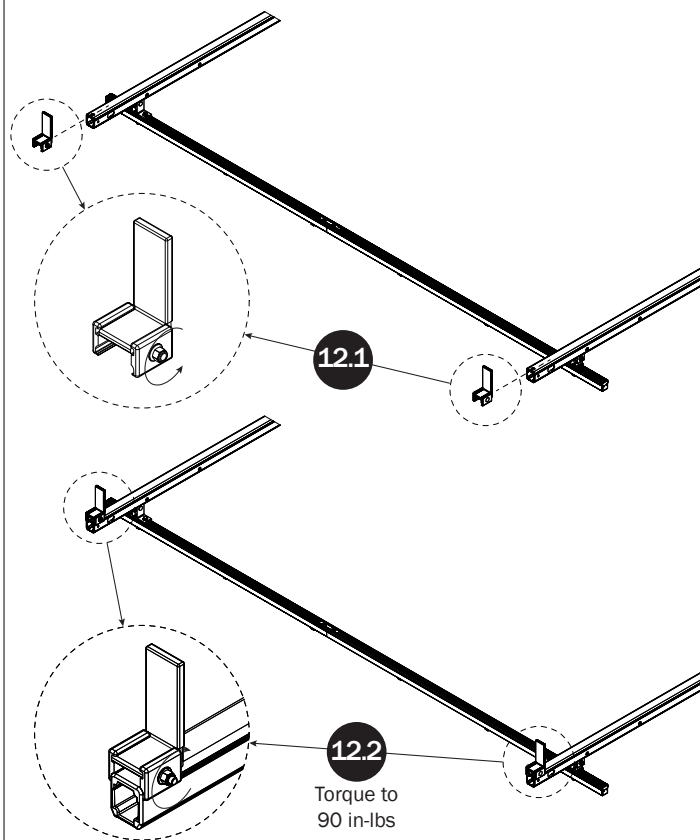
LEFT SIDE BASE**LADDER STOPS**

Page Intentionally Left Blank

