

PRIME DESIGN™

A Safe Fleet Brand

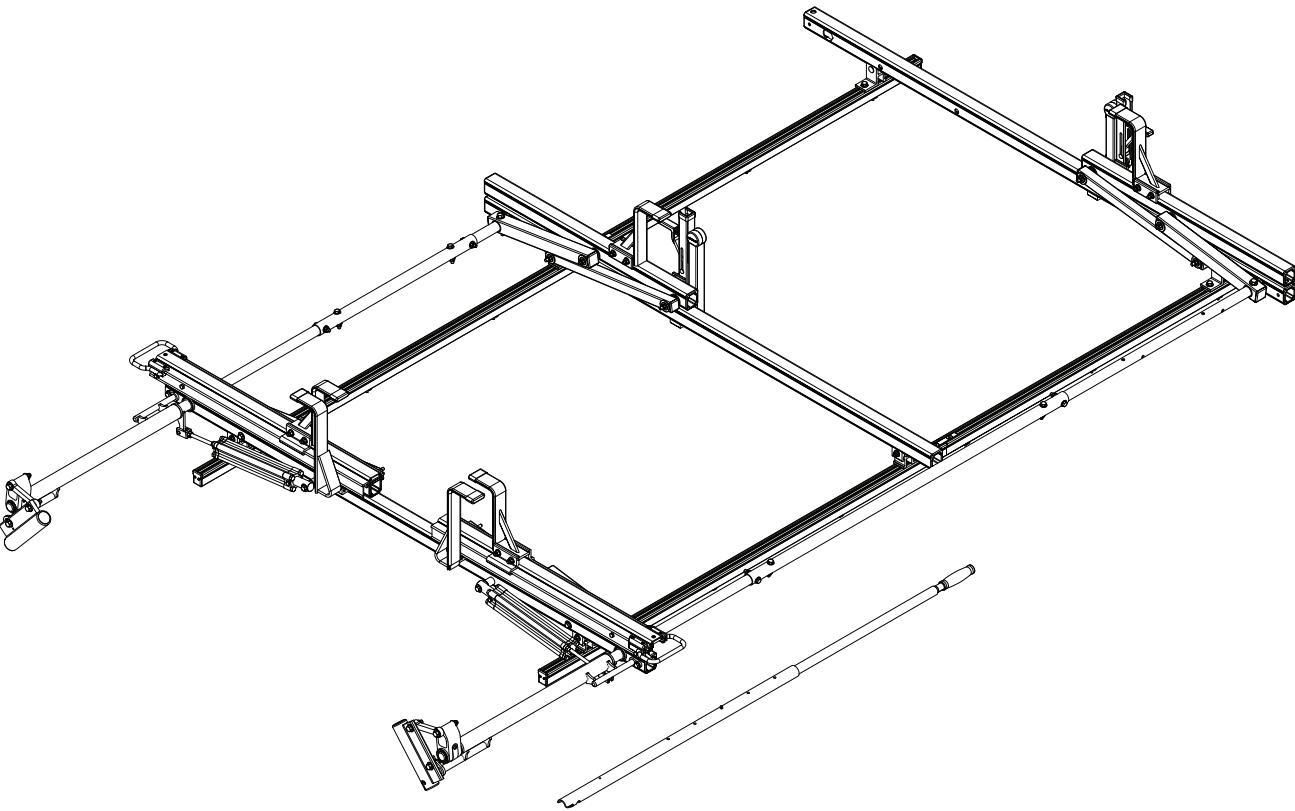

HRR3-E

CONTENTS OVERVIEW

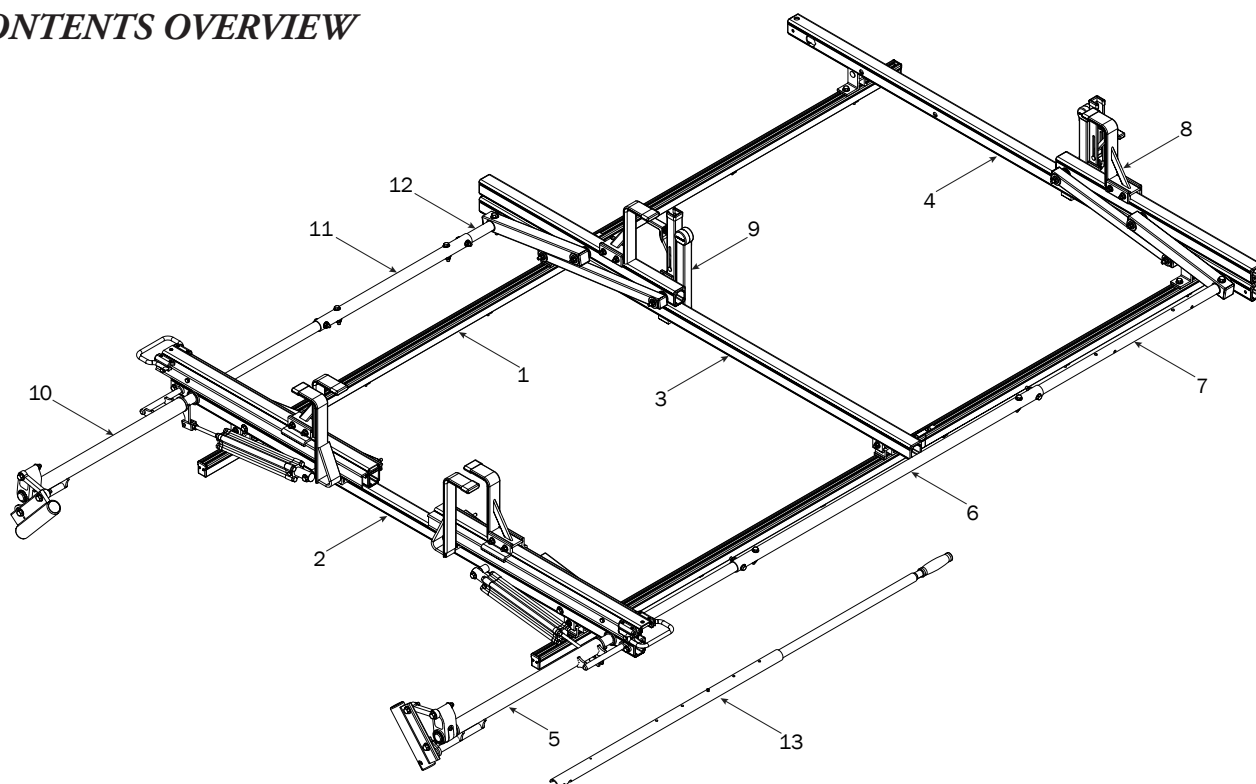

1—FBM3-0057 (Qty 1)
Channels with hardware

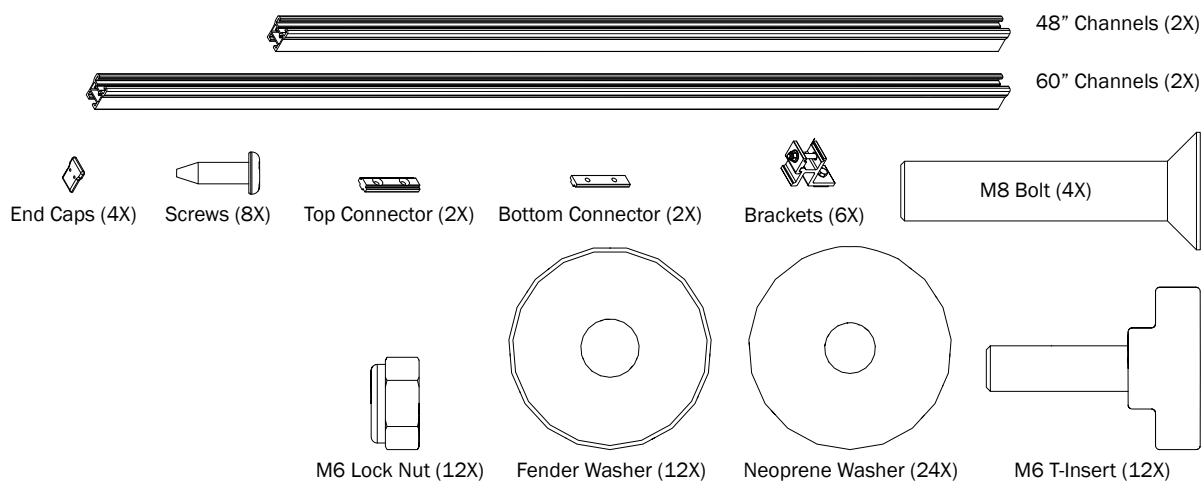

2—Rear Crossbar Assembly (Qty 1)

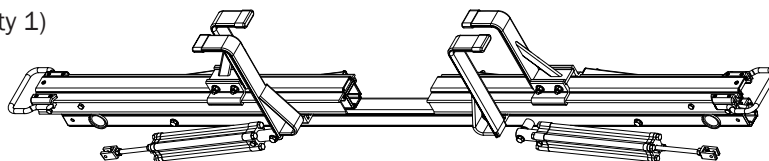

3—Front Crossbar Assembly (Qty 1)

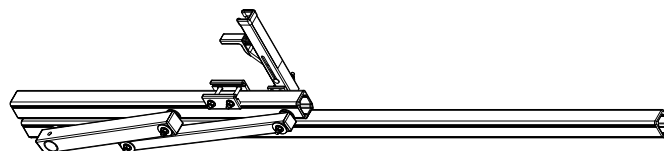

4—Front Crossbar Assembly (Qty 1)

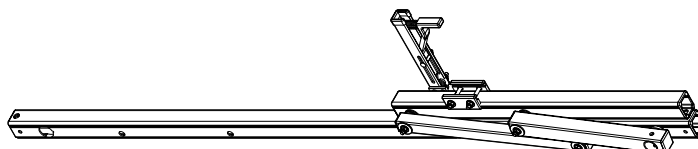

5—Drive Shaft..... (Qty 1)
Rear, Right Hand, 50.00"

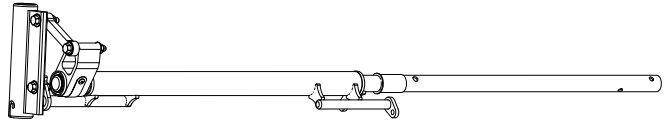

6—Connecting Bar..... (Qty 1)
48.00"

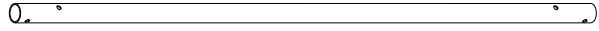

7—Front Drive Shaft..... (Qty 1)
B Version, 35.75"



8—Z Post..... (Qty 2)
Adjustable, 7.25"

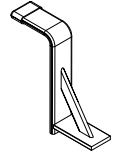

9—L Post..... (Qty 2)
Gen2, Roller Cap, 9.25"

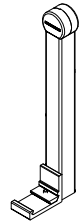

10—Drive Shaft..... (Qty 1)
Rear, Left Hand, 50.00"

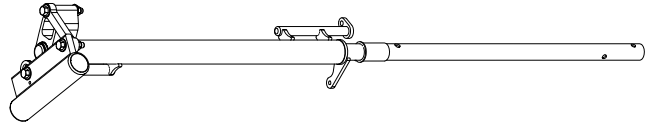

11—Connecting Bar..... (Qty 1)
24.00"

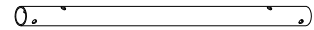

12—Front Drive Shaft..... (Qty 1)
B Version, 11.75"

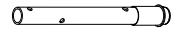

13—HRR Removeable Handle Assembly..... (Qty 1)

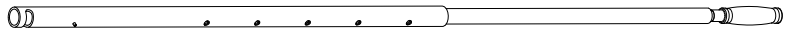

14—HKT-8163 (Not called out in Overview)..... (Qty 2)

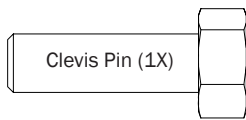

Clevis Pin (1X)

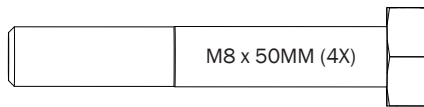

M8 x 50MM (4X)

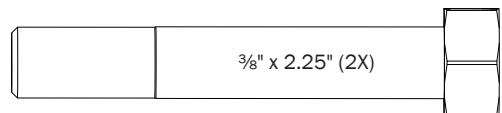

3/8" x 2.25" (2X)



Cotter Pin (1X)

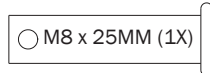

M8 x 25MM (1X)

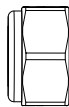

M8 Lock Nut (5X)

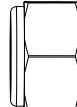

3/8" Lock Nut (2X)

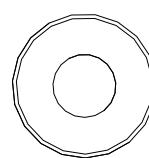

5/16" Flat Washer (10X)

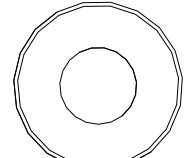

3/8" Flat Washer (4X)

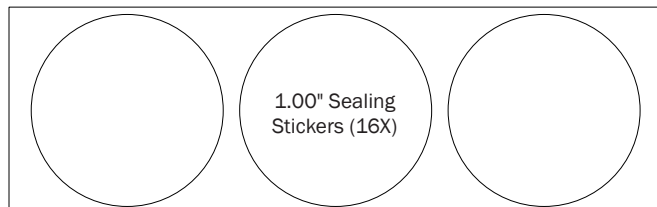

1.00" Sealing
Stickers (16X)



Anti-Seize (1X)

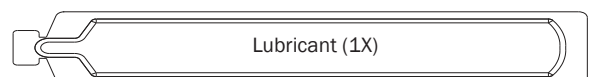

Lubricant (1X)

FBM3-0057
MOUNTING BRACKETS

- 0.1** Assemble Channel hardware through roof as shown, but do not tighten.

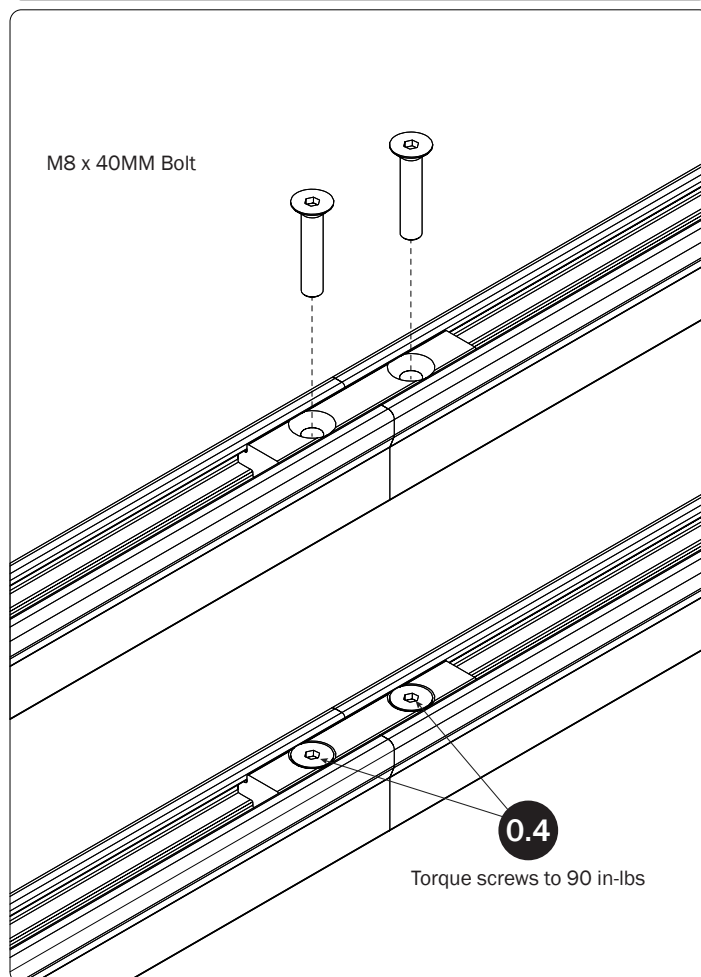
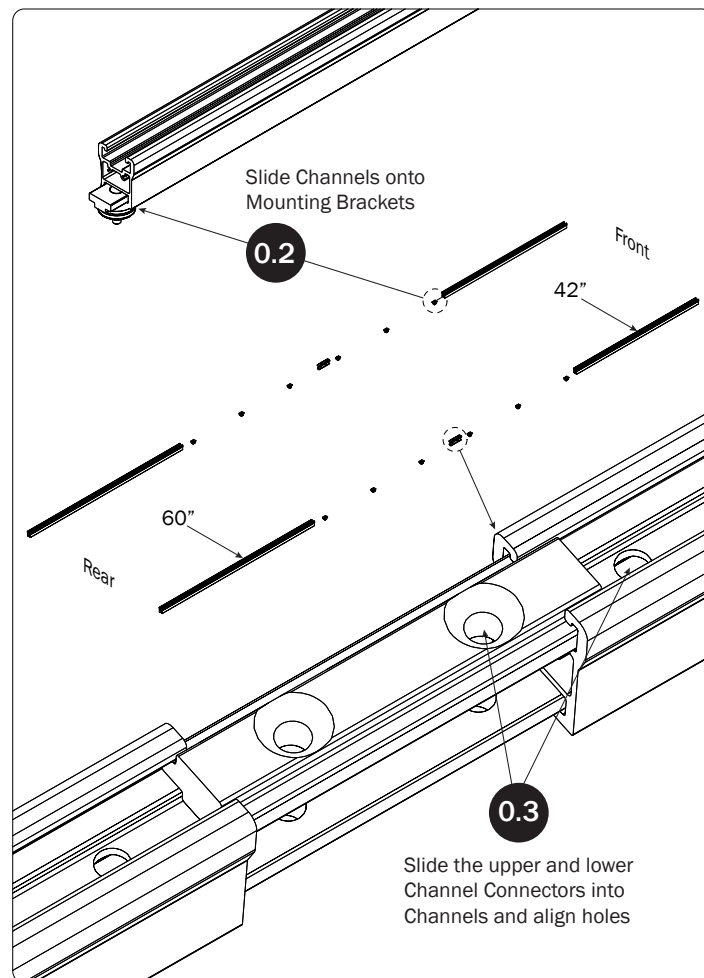
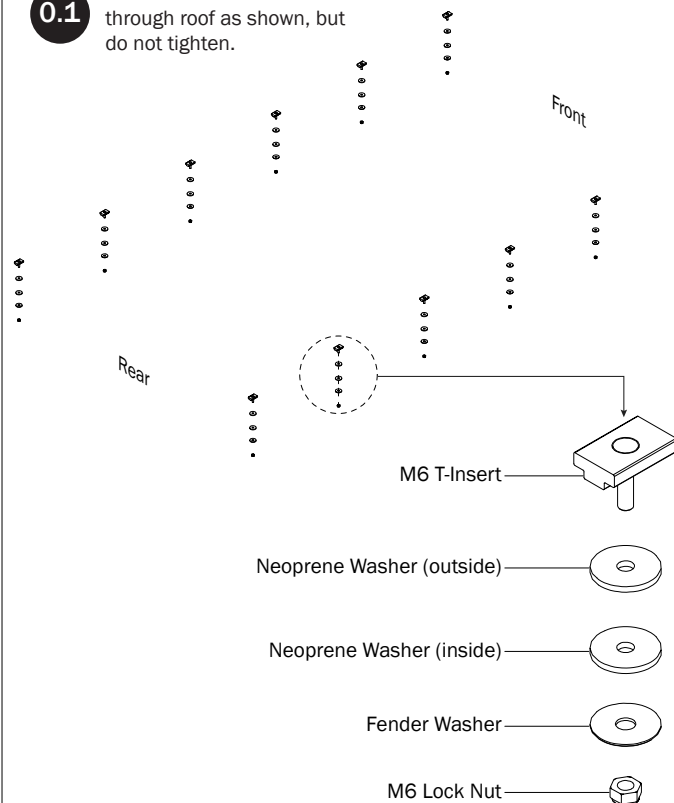

- 0.5** Set to specified distances shown below, then torque Mounting hardware nuts to 80 in-lbs.

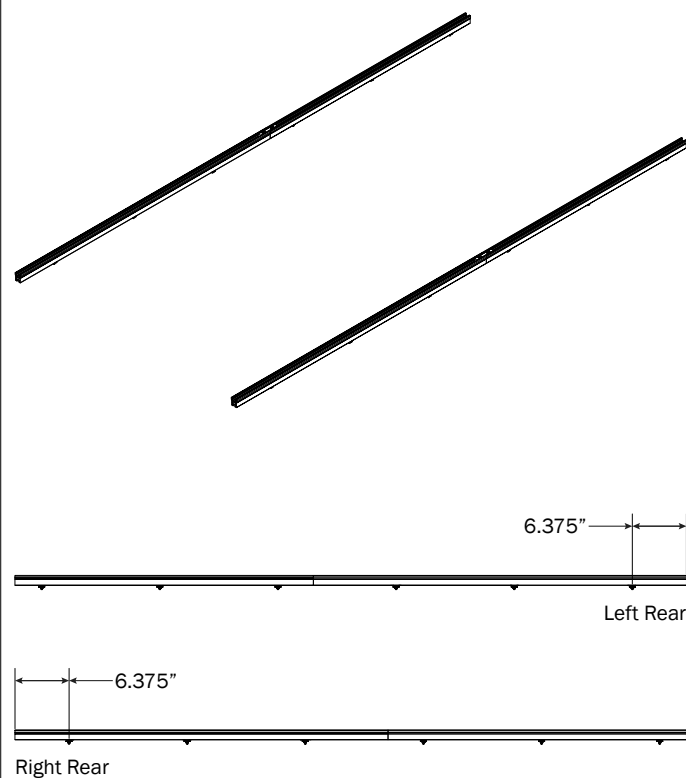

0.6 Loosen bolts

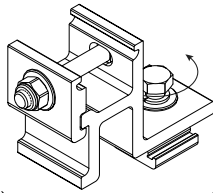

0.7 Set to distances then torque Bracket nuts to 90 in-lbs

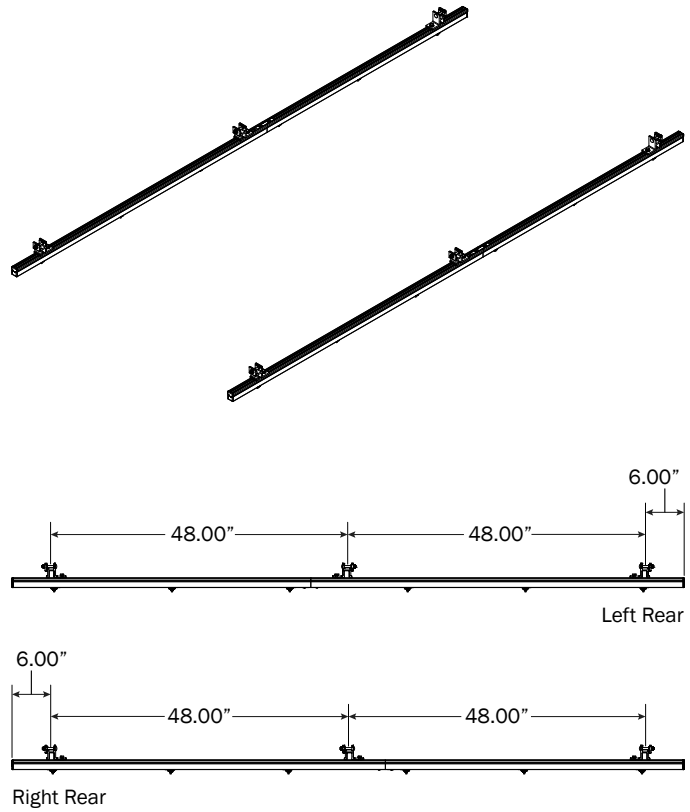

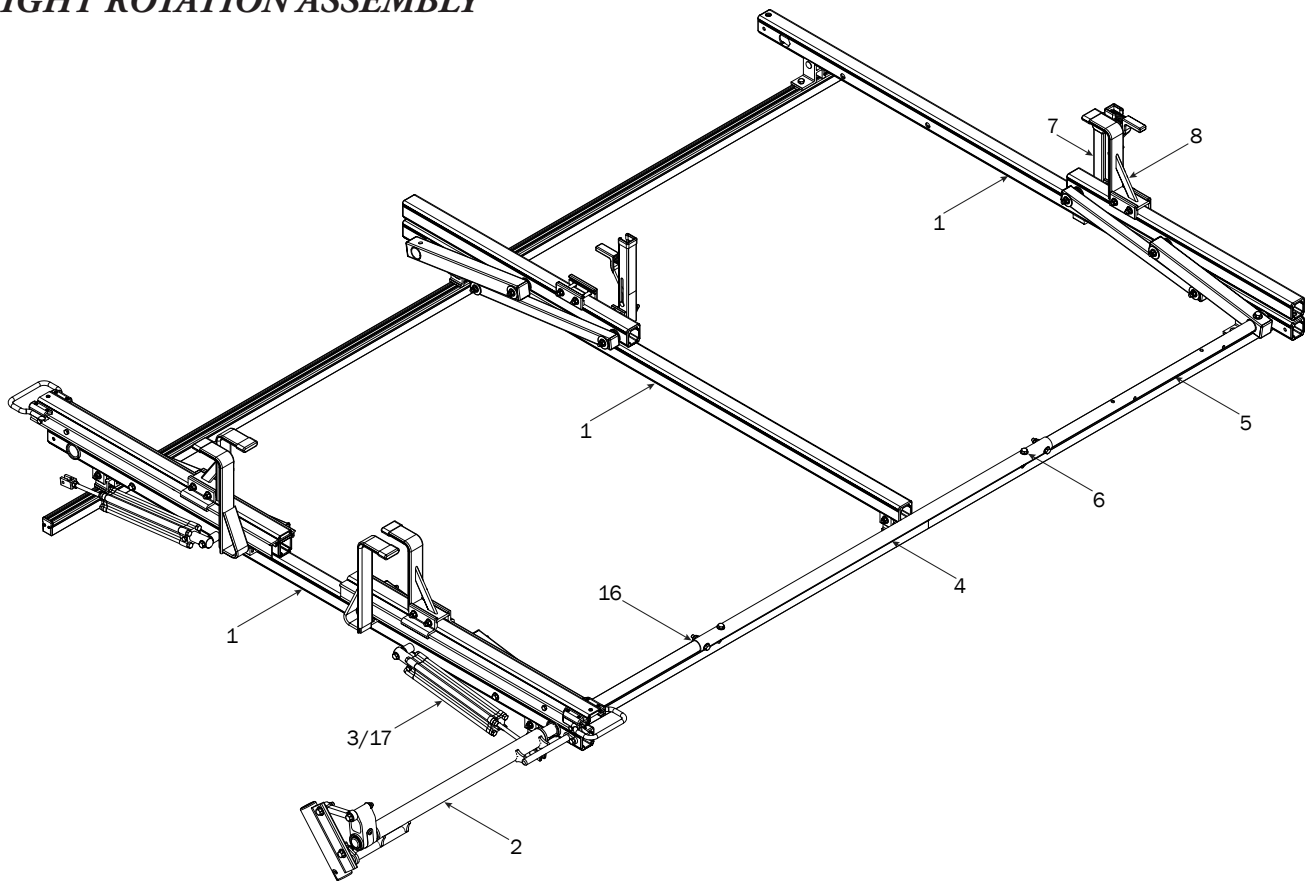
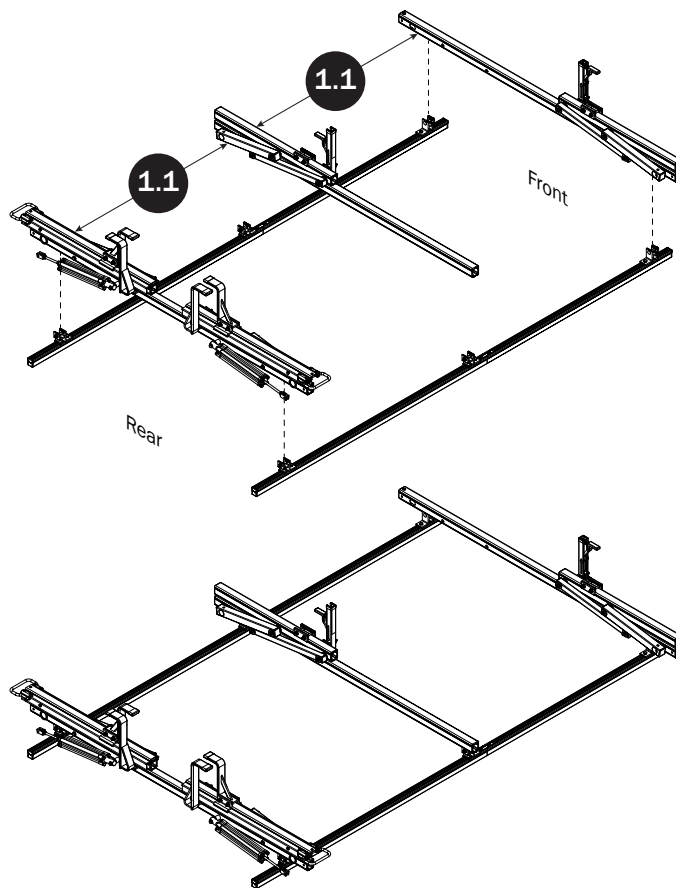
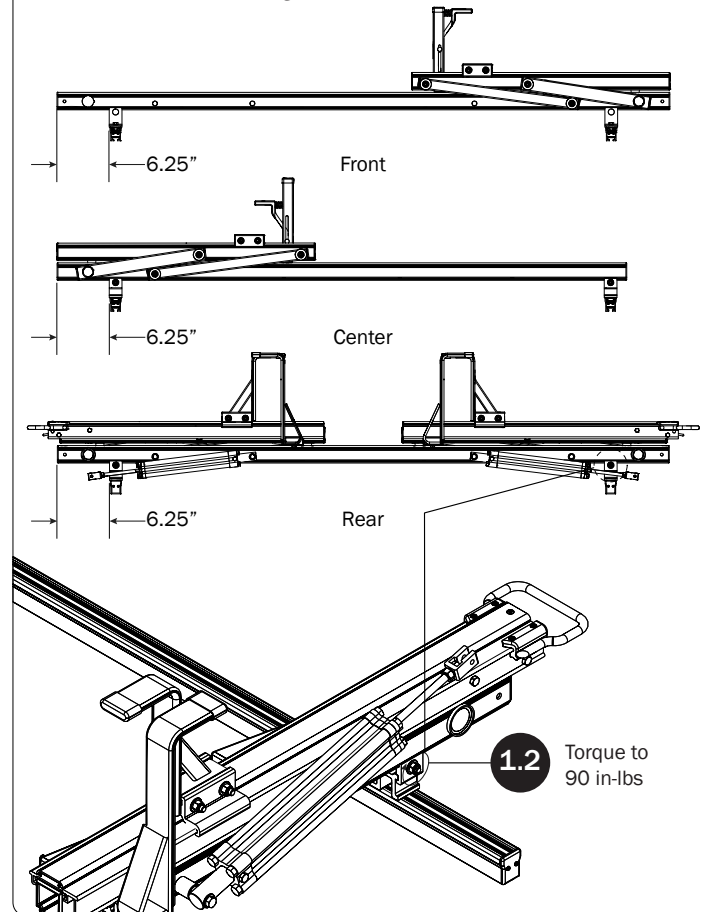
RIGHT ROTATION ASSEMBLY**CROSSBARS****CROSSBAR ADJUSTMENT**

REAR DRIVE SHAFT

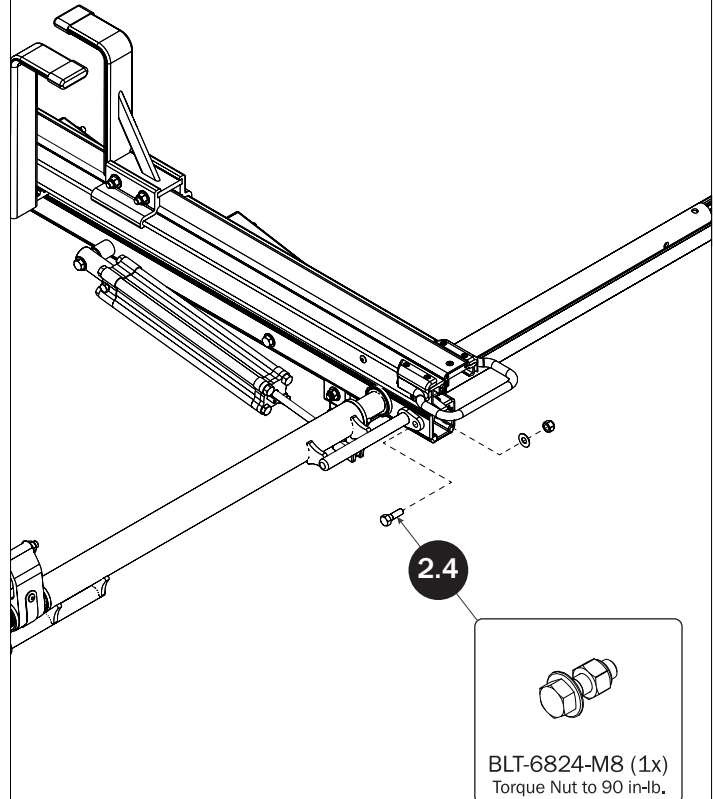
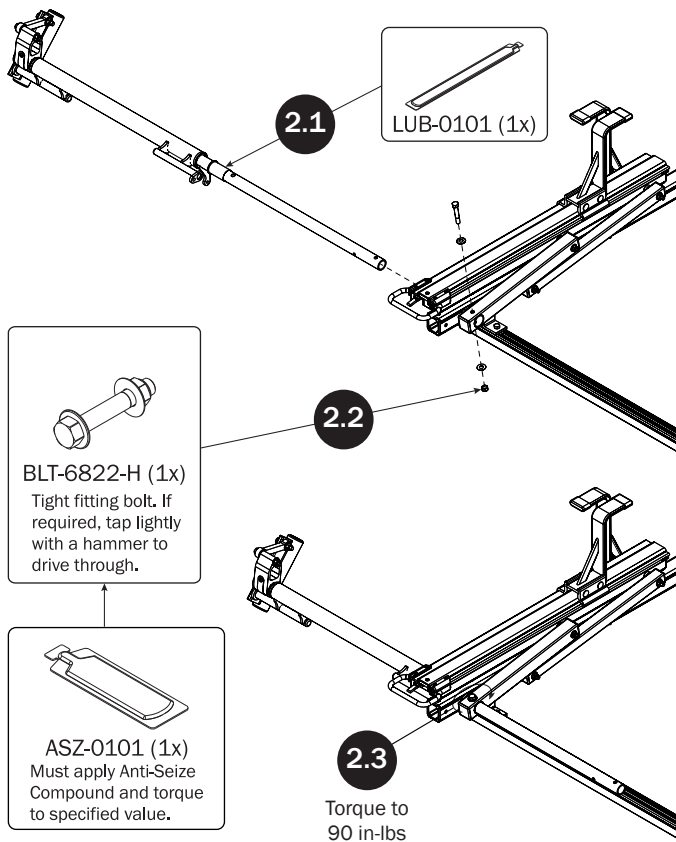

CYLINDER HARDWARE

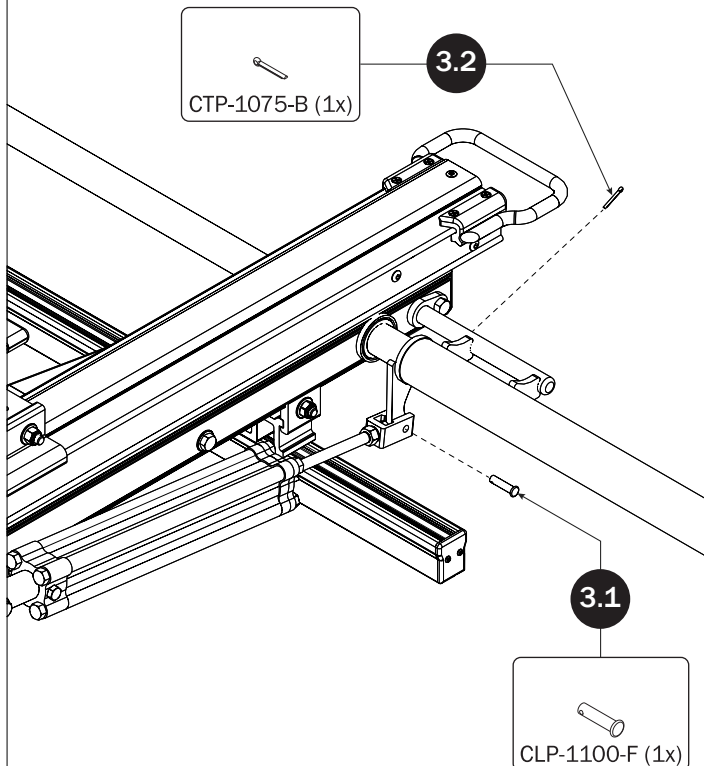

CONNECTING BAR

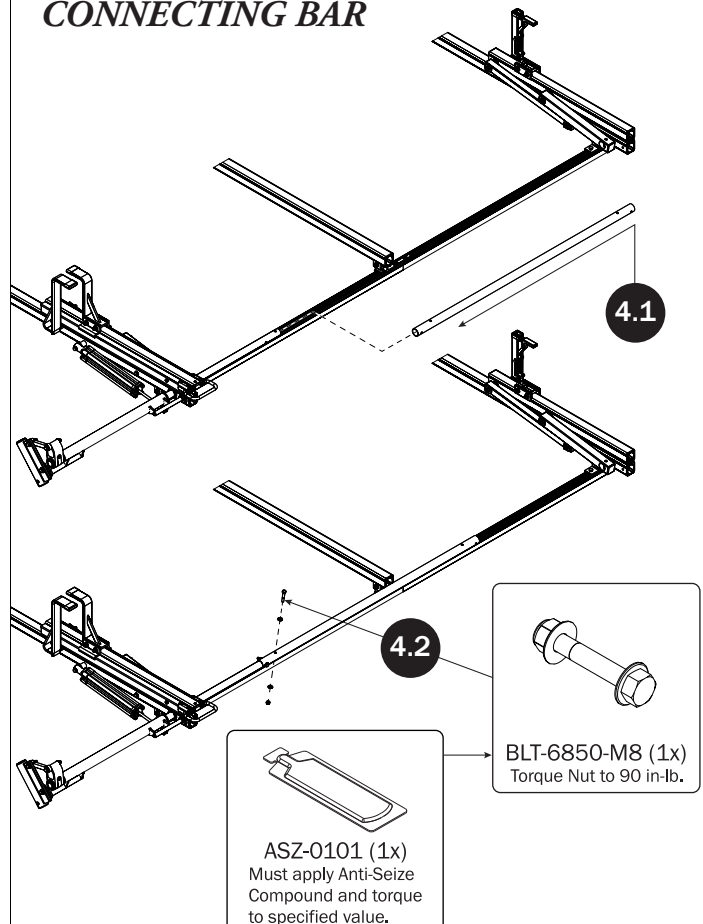

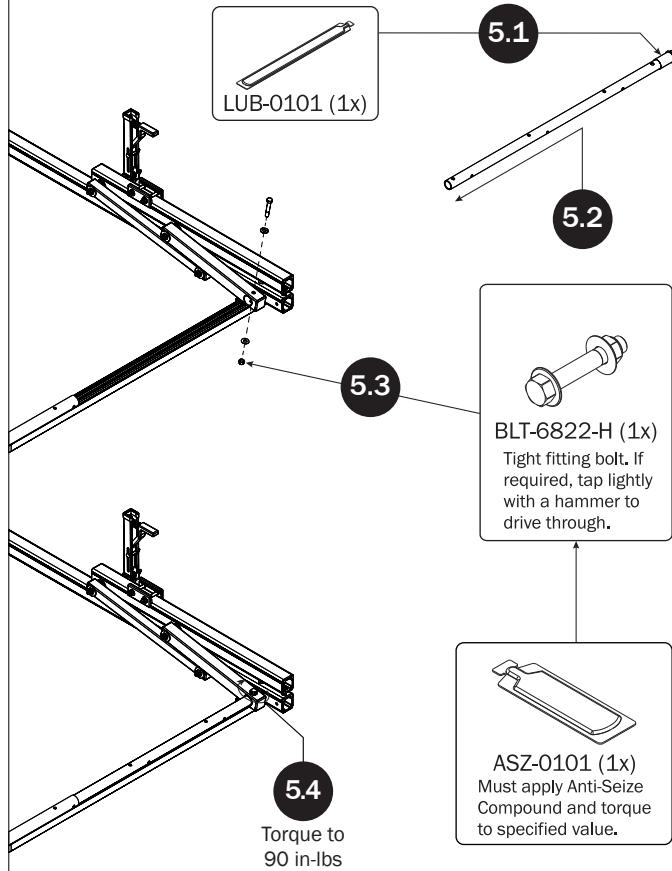
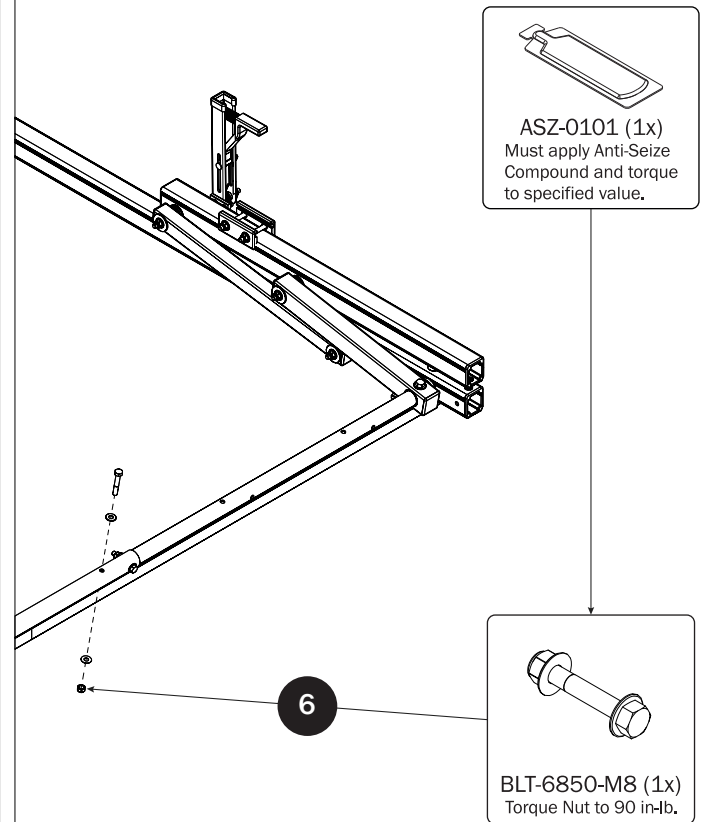
FRONT DRIVE SHAFT**CONNECTING BAR FASTENERS****L POST**

SEE QUICK START GUIDE FOR ADJUSTMENTS

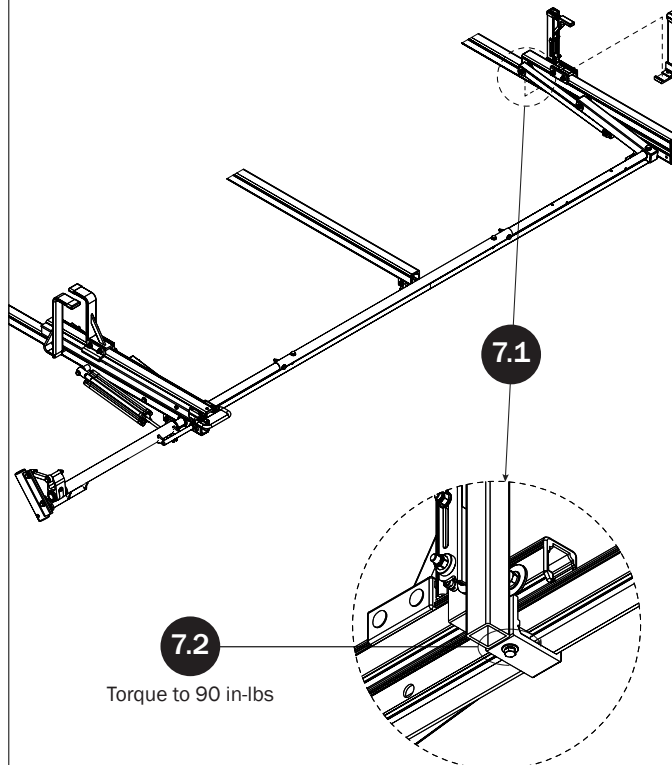
**Z POST**

SEE QUICK START GUIDE FOR ADJUSTMENTS

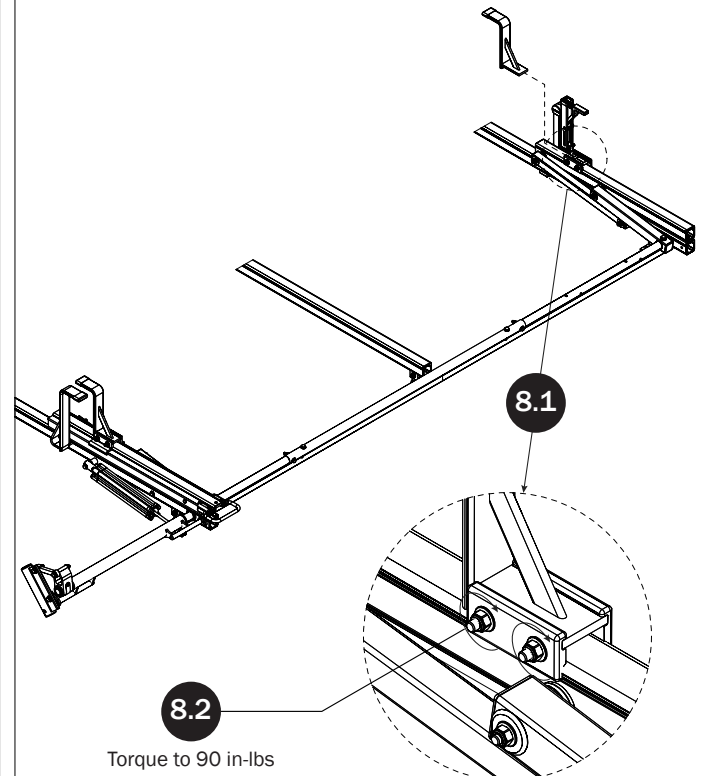

LEFT ROTATION ASSEMBLY

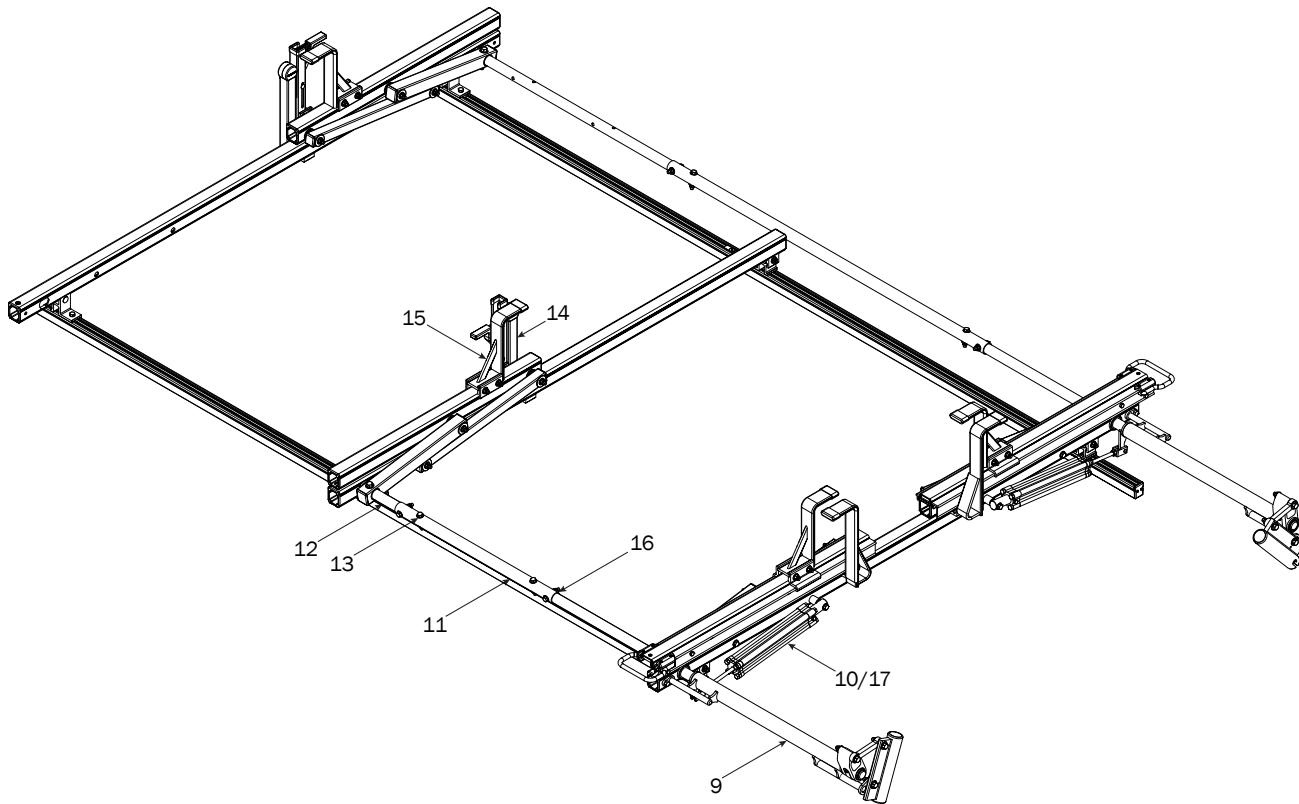

REAR DRIVE SHAFT

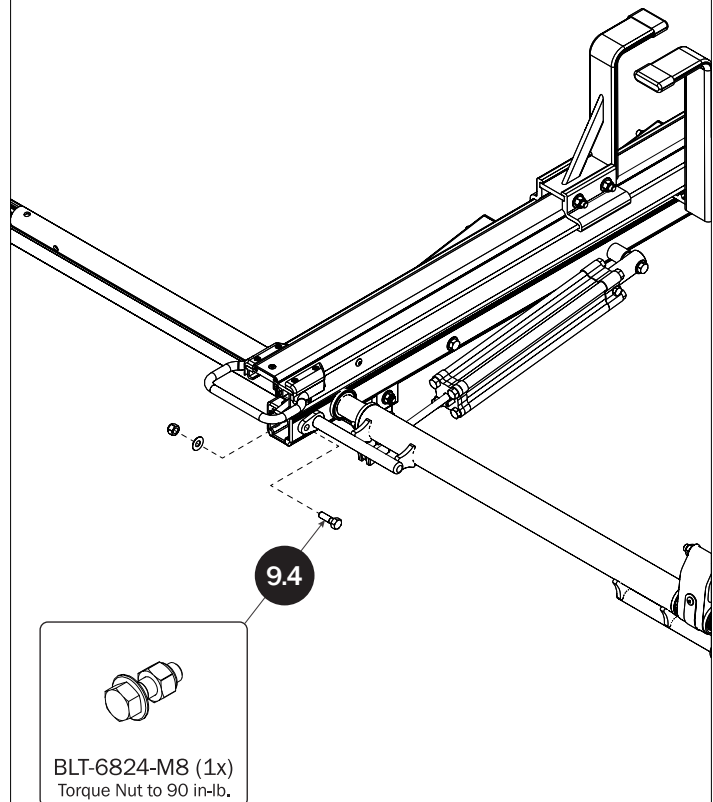
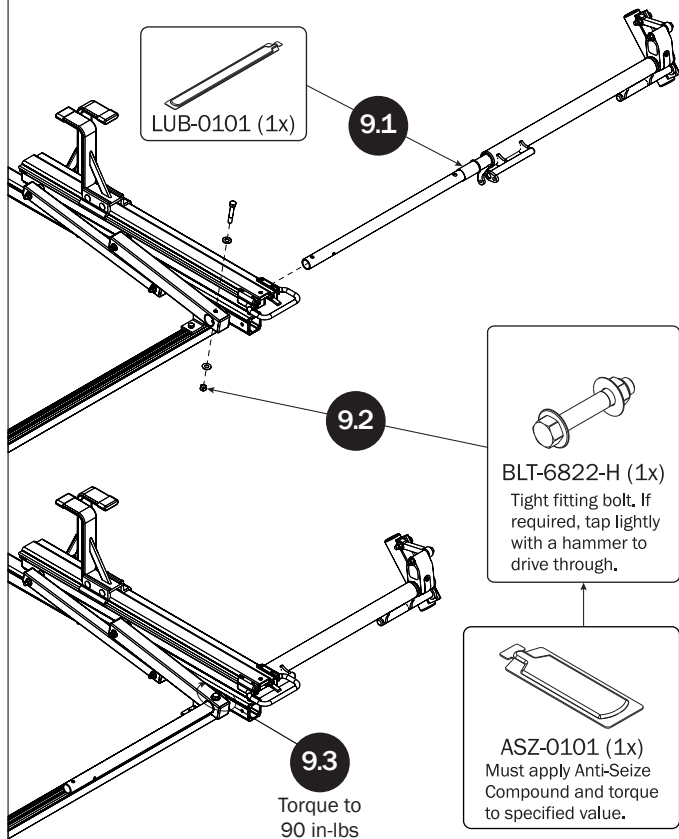

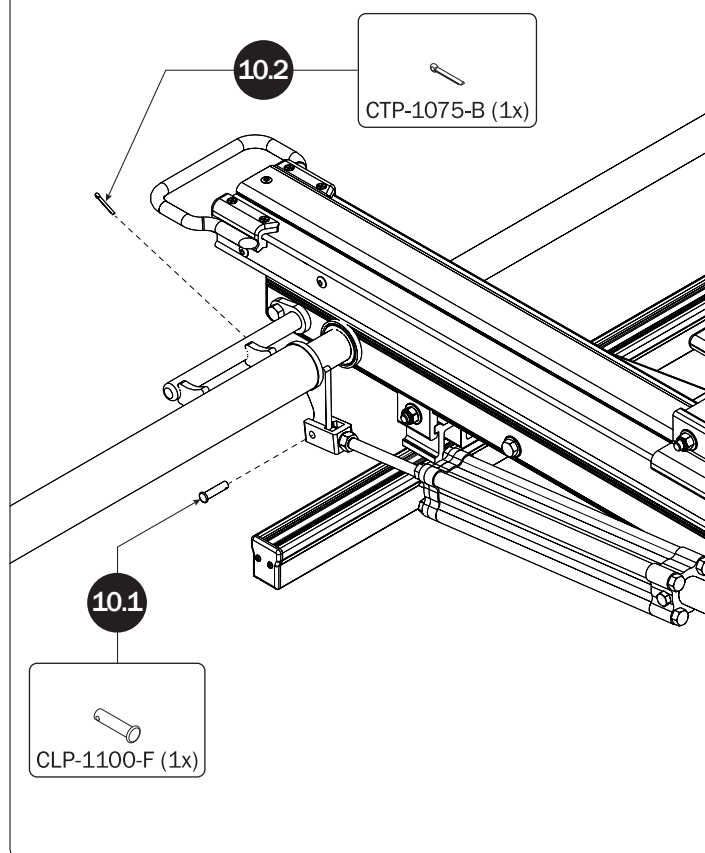
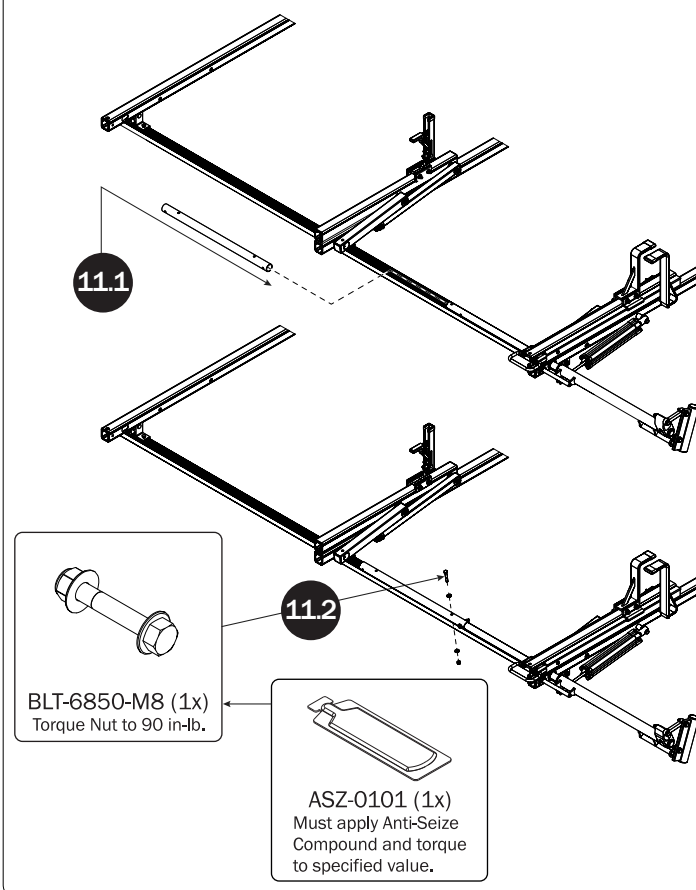
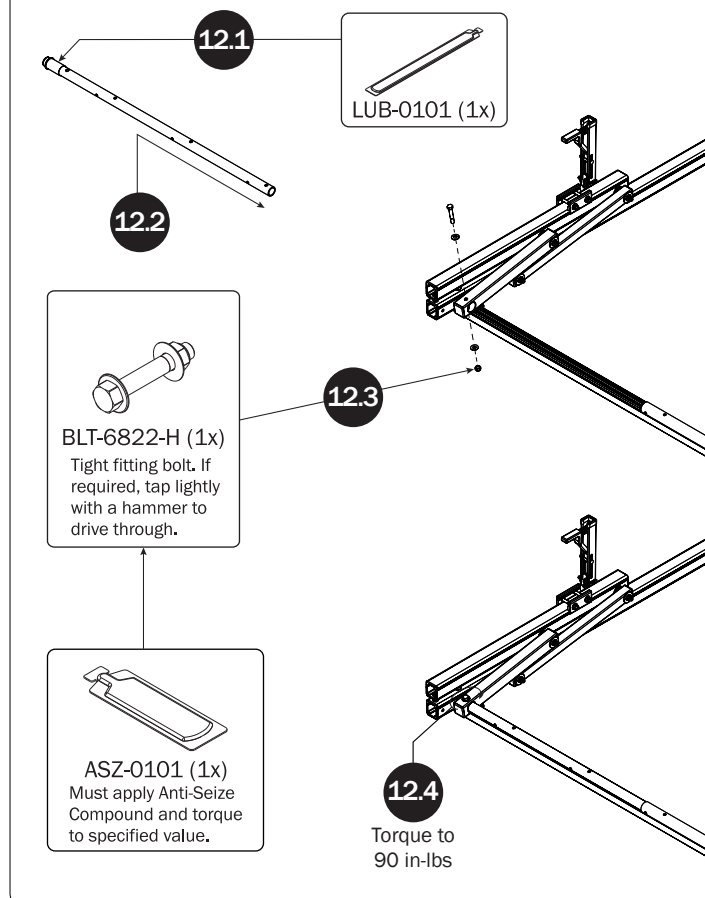
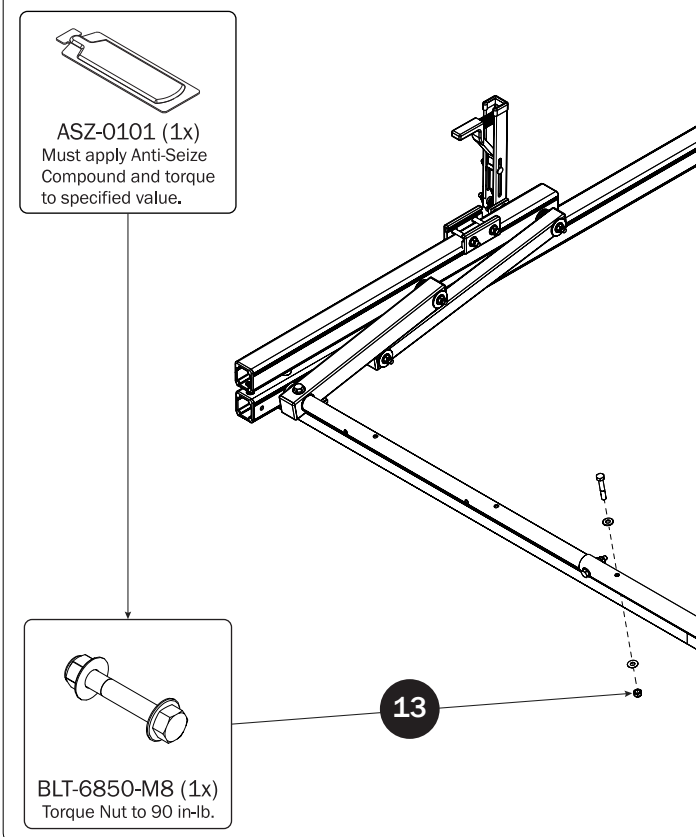
CYLINDER HARDWARE**CONNECTING BAR****FRONT DRIVE SHAFT****CONNECTING BAR FASTENERS**

SEE QUICK START GUIDE FOR ADJUSTMENTS



SEE QUICK START GUIDE FOR ADJUSTMENTS



Apply Silicone Sealant to Connecting Bar ends

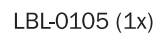

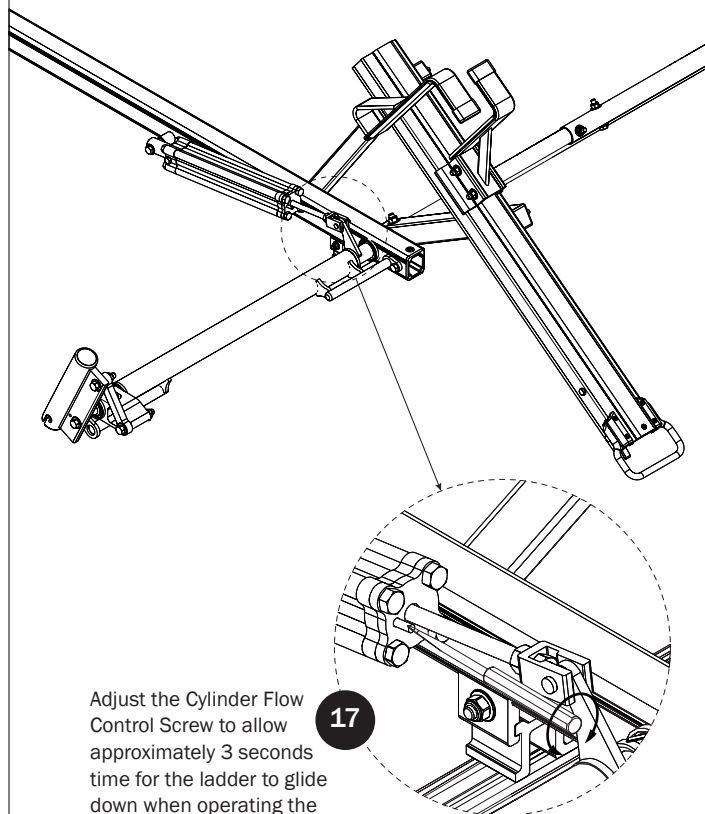
CYLINDER ADJUSTMENT

USAM-HRR3ESP-US01 Rev-A 0118