

PRIME DESIGN™

A Safe Fleet Brand

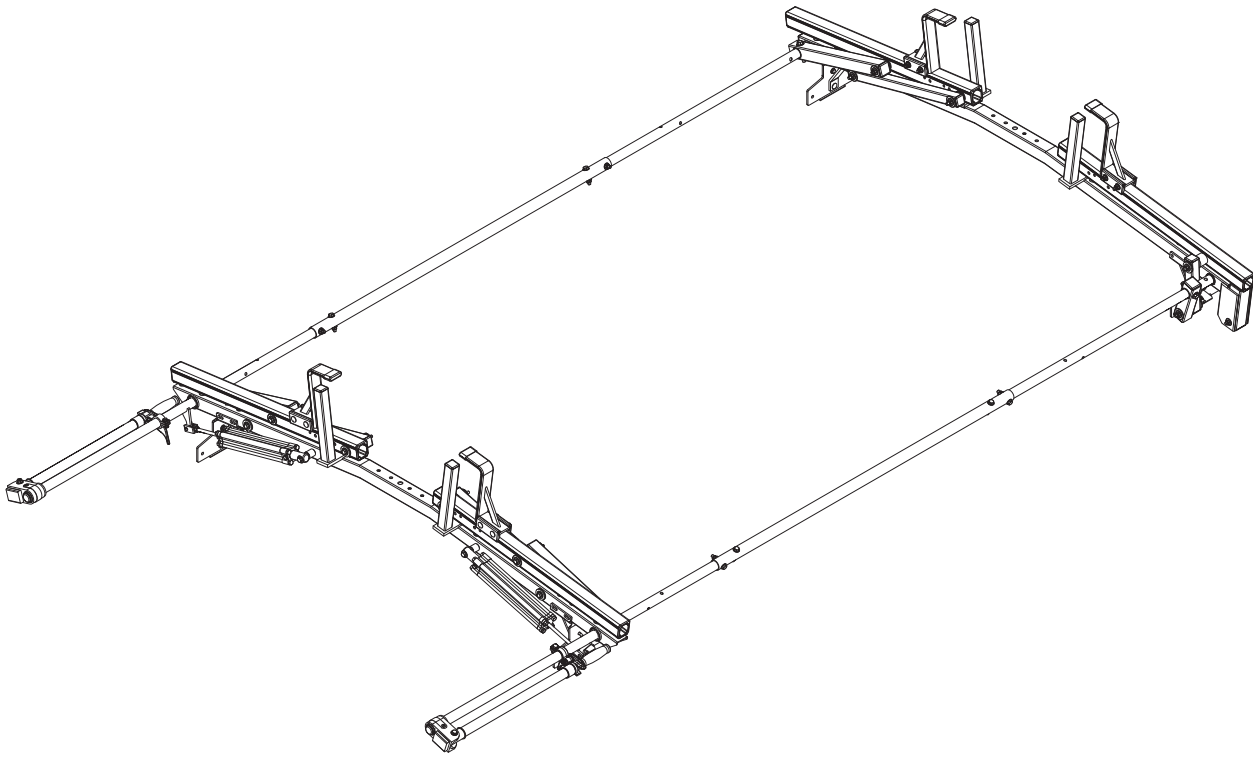

VRI 226

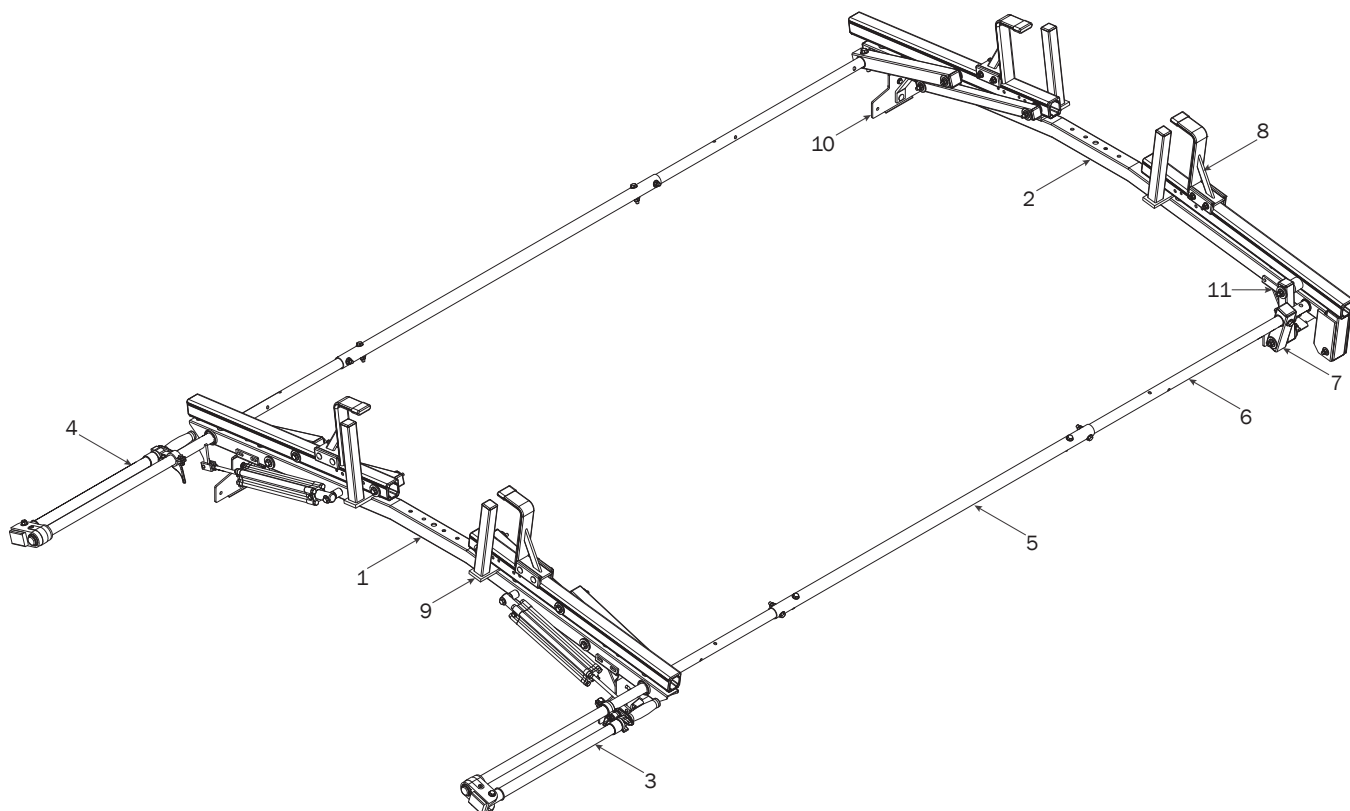

1—Rear Crossbar..... (Qty 1)

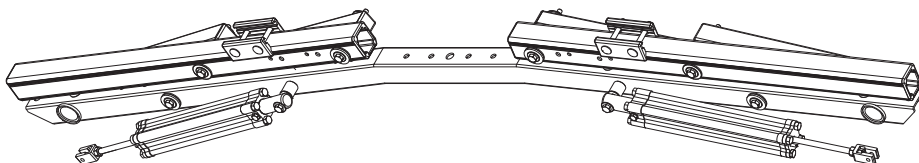

2—Front Crossbar (Qty 1)

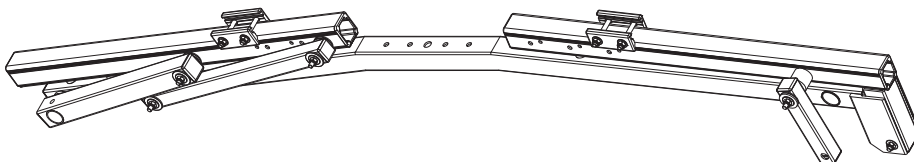

3—Rear Drive Shaft..... (Qty 1)
Right Hand, B4 Version, 50.00"

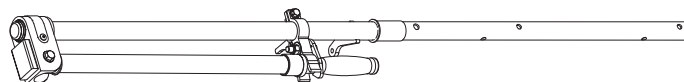

4—Rear Drive Shaft..... (Qty 1)
Left Hand, B4 Version, 50.00"

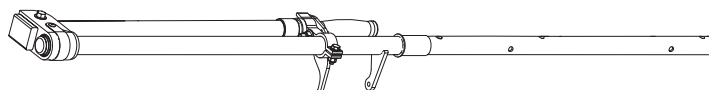

5—Connecting Bar..... (Qty 2)
48.00"

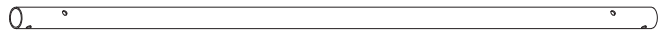

6—Front Drive Shaft..... (Qty 2)
B Version, 38.75"



7—Drive Arm..... (Qty 1)
Incline Version with Bushing and Hardware

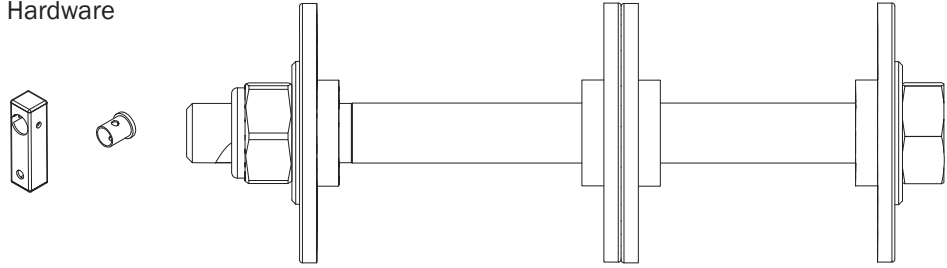

8—Z Post..... (Qty 4)
Adjustable, 7.25"

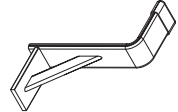

9—L Post..... (Qty 4)
9.25", Gen1

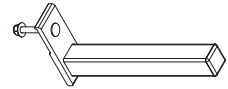

10—Mounting Bracket Assembly.....(Qty 3)
Low Mounting, 4.50", GM

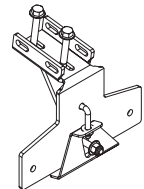

11—Mounting Bracket Assembly.....(Qty 1)
High Mounting, 5.00", GM

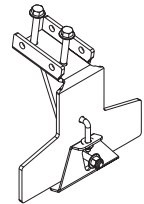

12—HKT-8163-Rotation Hardware Kit..... (Qty 2)
(Not called out in Overview)

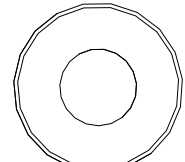
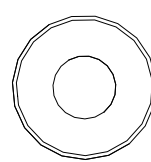
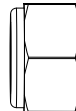
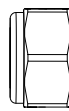
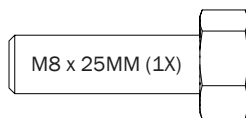
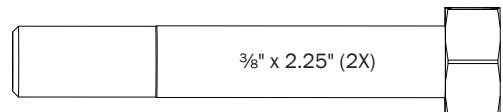
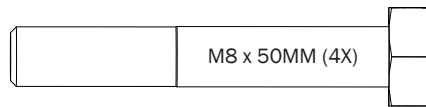

M8 Lock Nut (5X)

3/8" Lock Nut (2X)

5/16" Flat Washer (10X)

3/8" Flat Washer (4X)

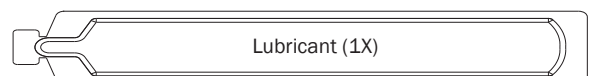
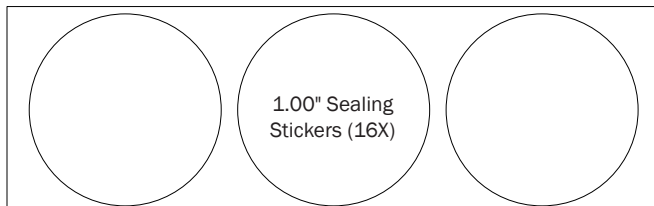

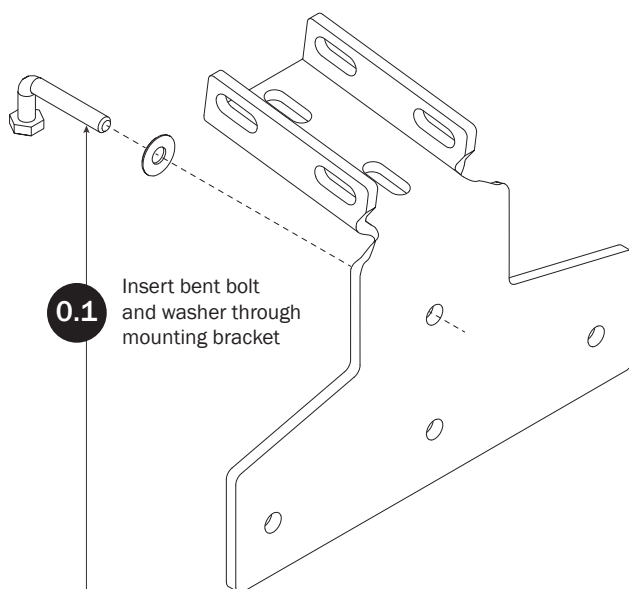
**MOUNTING BRACKETS—LOW GM 4.5”
BRACKET PRE-ASSEMBLY**

0.1 Insert bent bolt and washer through mounting bracket

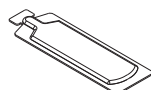

Anti-Seize
Must apply Anti-Seize Compound and torque to specified value.

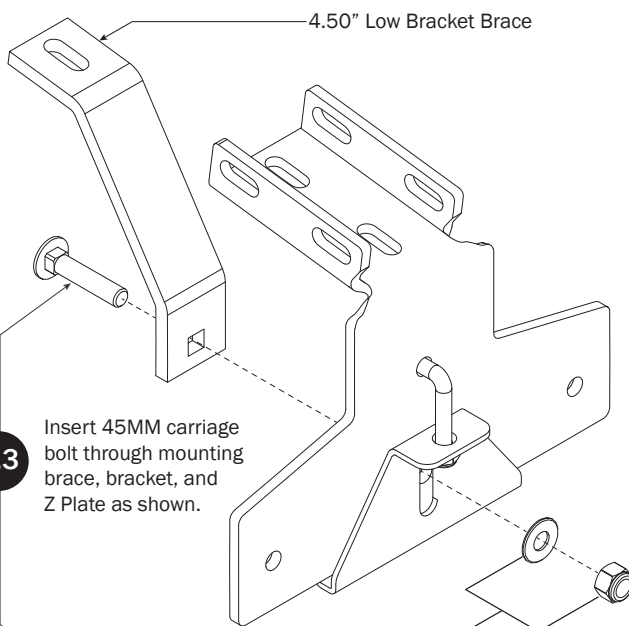

0.3 Insert 45MM carriage bolt through mounting brace, bracket, and Z Plate as shown.

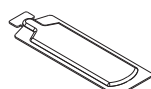

Anti-Seize
Must apply Anti-Seize Compound and torque to specified value.

0.4

Secure mounting assembly with washer and nut. Do not tighten until the rack is mounted onto the vehicle.

0.2

Assemble the Z Plate and secure with washer and nut. Do not tighten until the rack is mounted onto the vehicle.

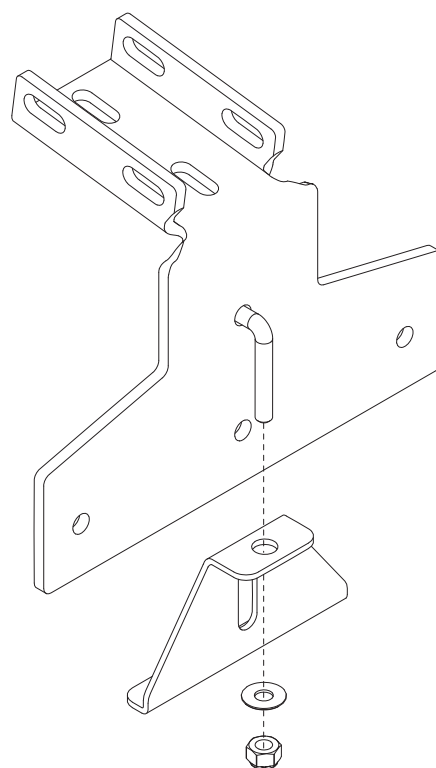

0.5

Repeat Steps 0.1–0.4 to assemble the remaining four (4) GM 4.5” Low Mounting Brackets. Proceed to Step 1.1.

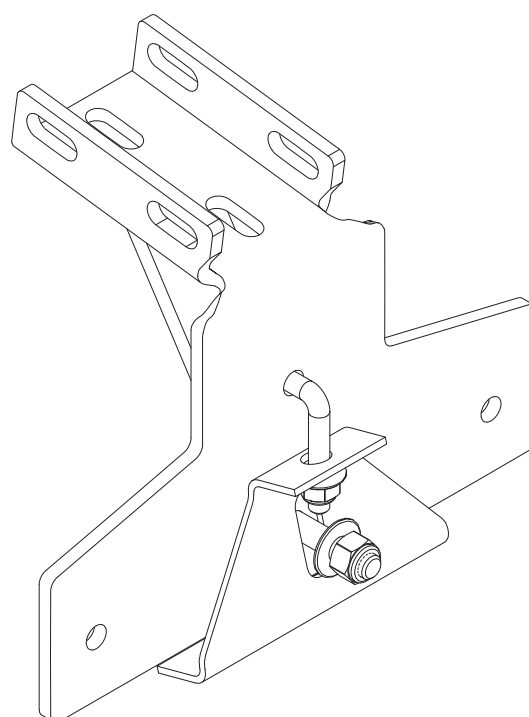

MOUNTING BRACKETS-HIGH GM 5.0" BRACKET PRE-ASSEMBLY

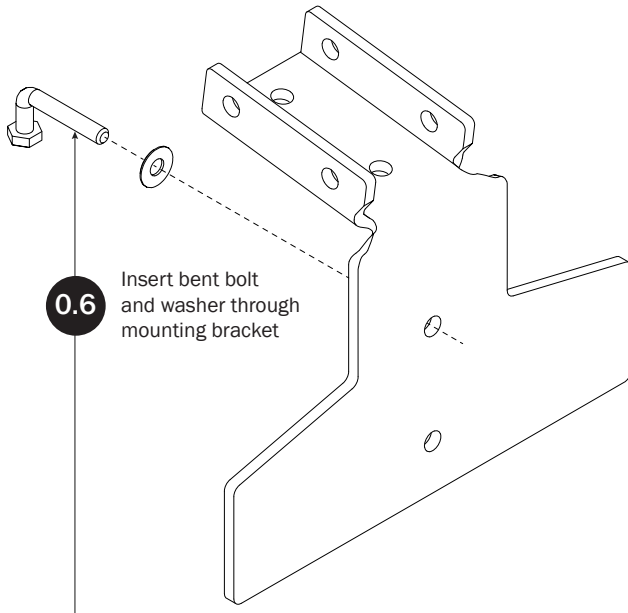

0.6 Insert bent bolt and washer through mounting bracket

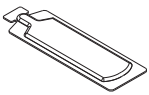

Anti-Seize
Must apply Anti-Seize Compound and torque to specified value.

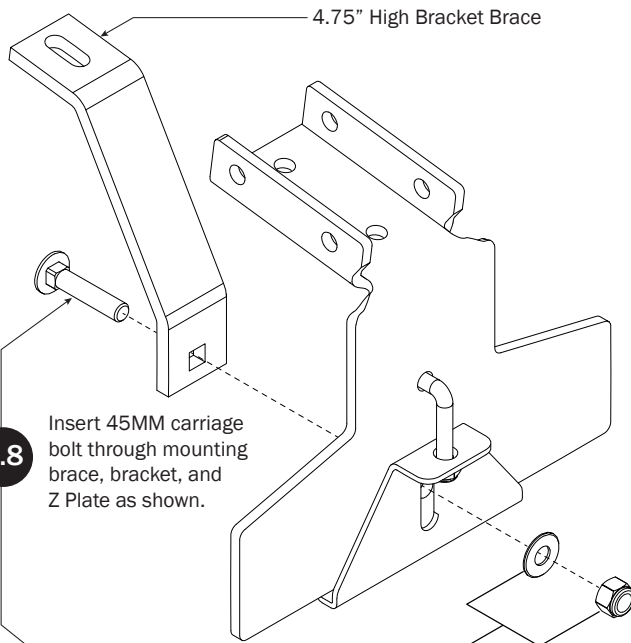

0.8 Insert 45MM carriage bolt through mounting brace, bracket, and Z Plate as shown.

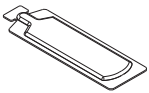

Anti-Seize
Must apply Anti-Seize Compound and torque to specified value.

0.9 Secure mounting assembly with washer and nut. Do not tighten until installed on vehicle roof.

0.7

Assemble the Z Plate and secure with washer and nut. Do not tighten until installed on vehicle roof.

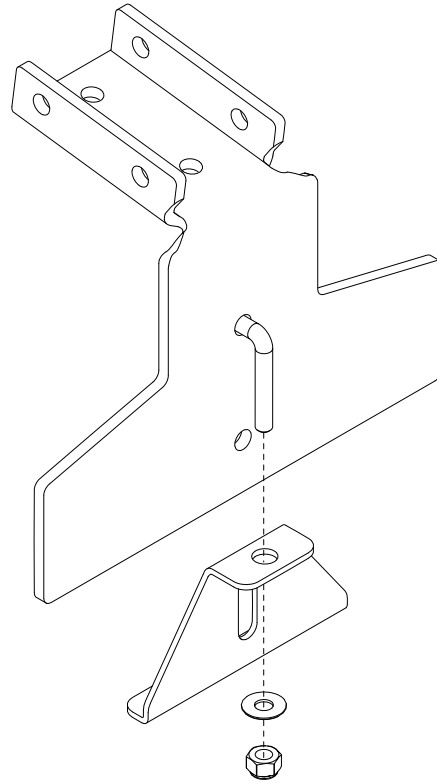

0.10

Proceed to Step 1.1

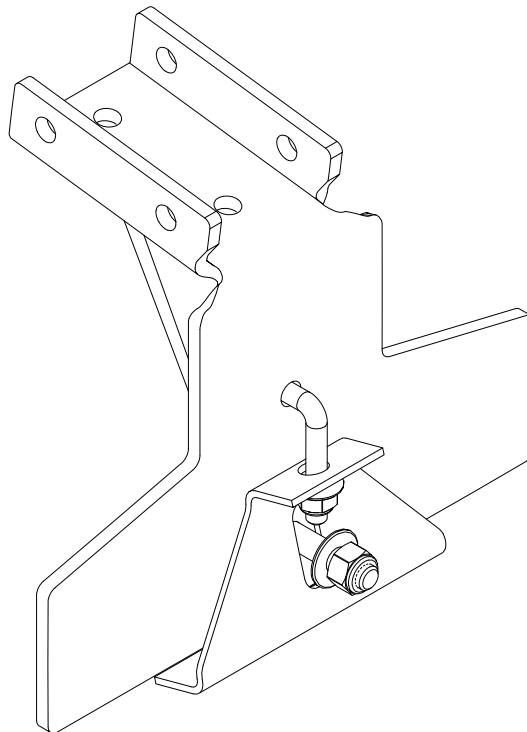

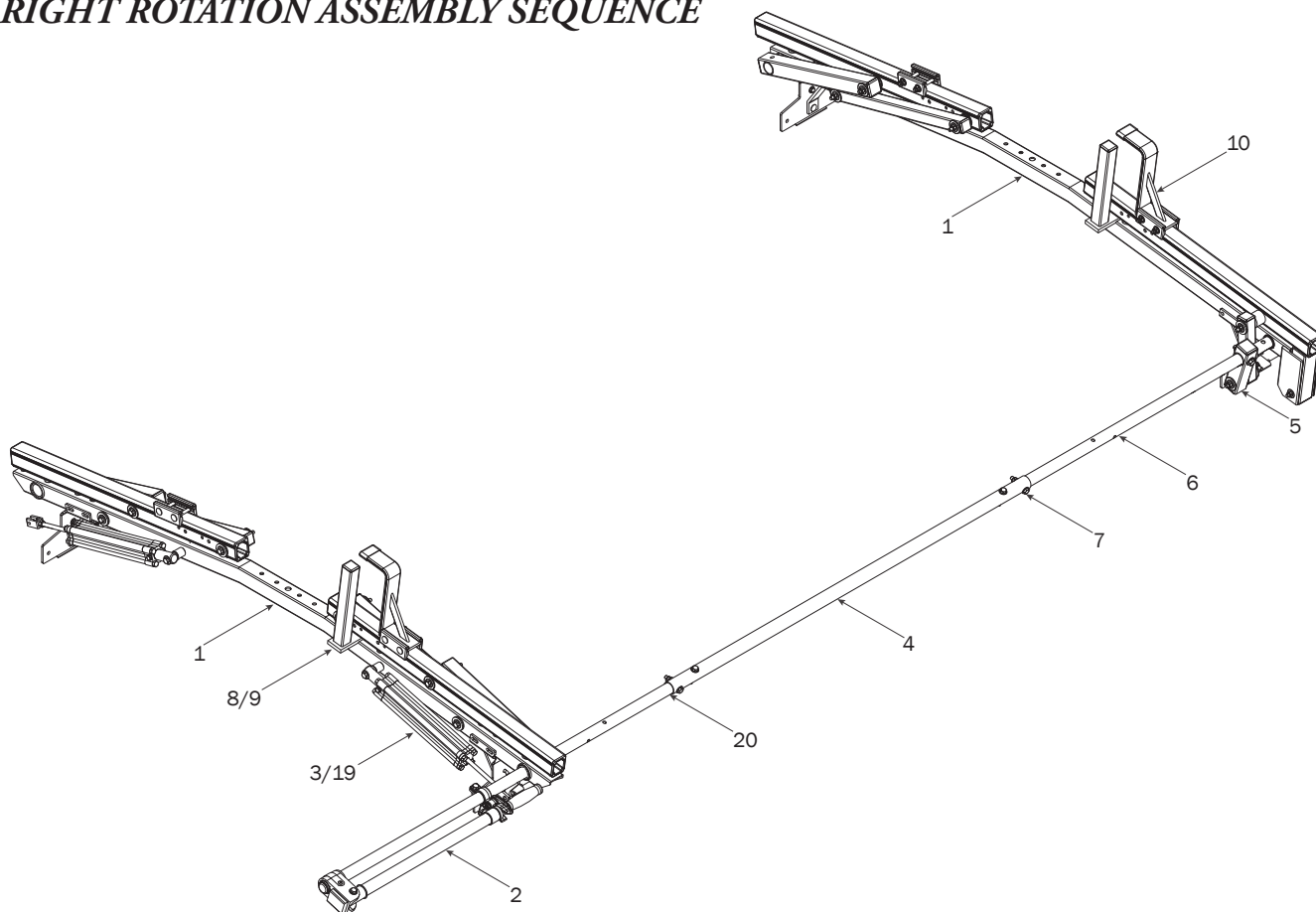
RIGHT ROTATION ASSEMBLY SEQUENCE**CROSSBARS**

- 1.1** Apply Anti-Seize compound to Mounting Bracket bolts.

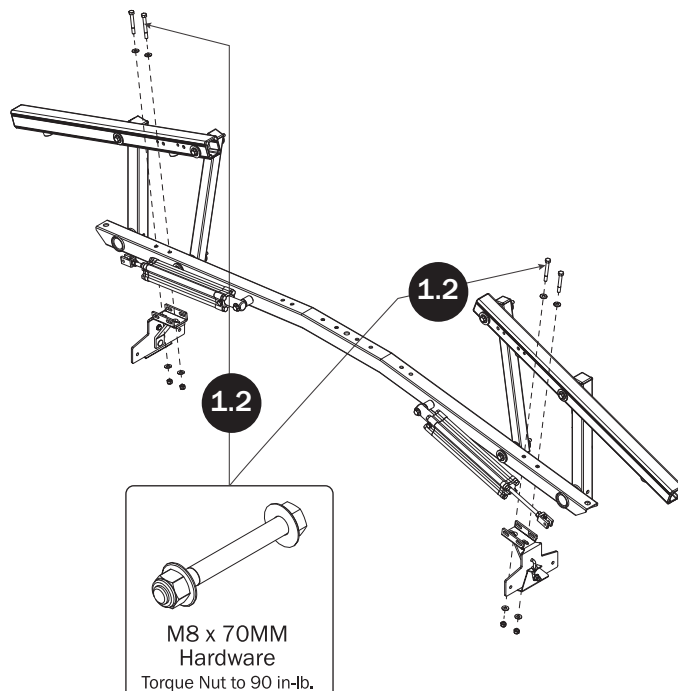

- 1.3** Repeat Steps 1.1–1.2 to install the remaining Mounting Brackets onto the Front Crossbar. Use the 5.0" Bracket on the Right hand side of the Front Crossbar.

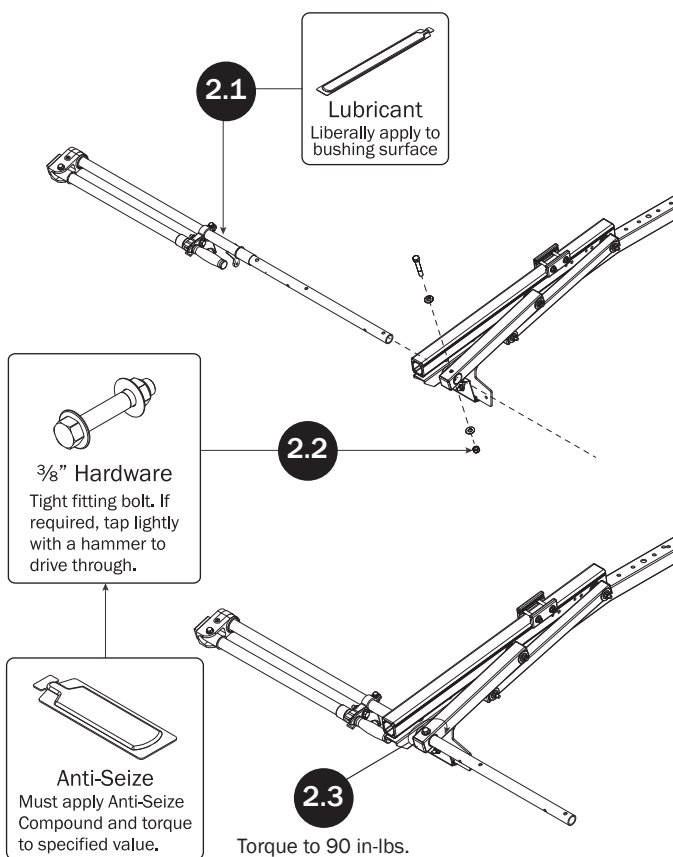
REAR DRIVE SHAFT

CYLINDER ASSEMBLY

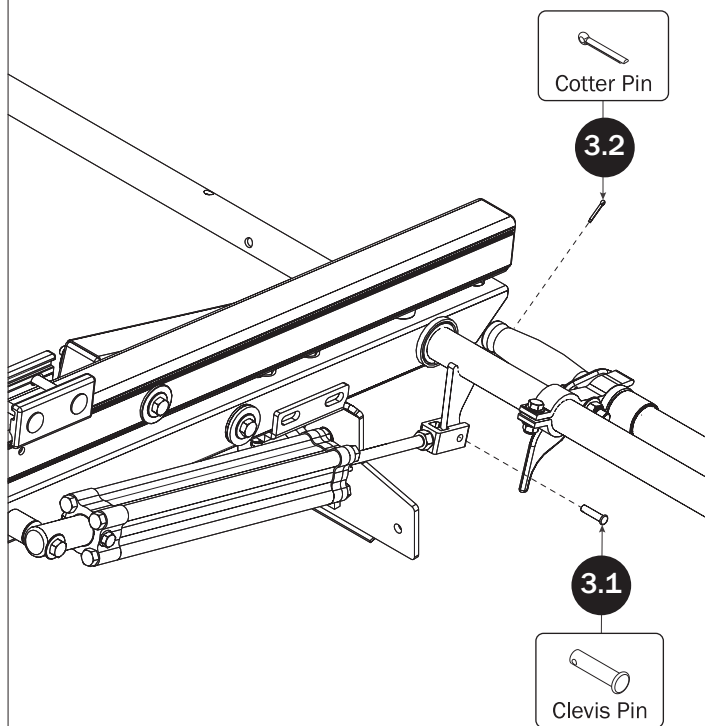

CONNECTING BAR

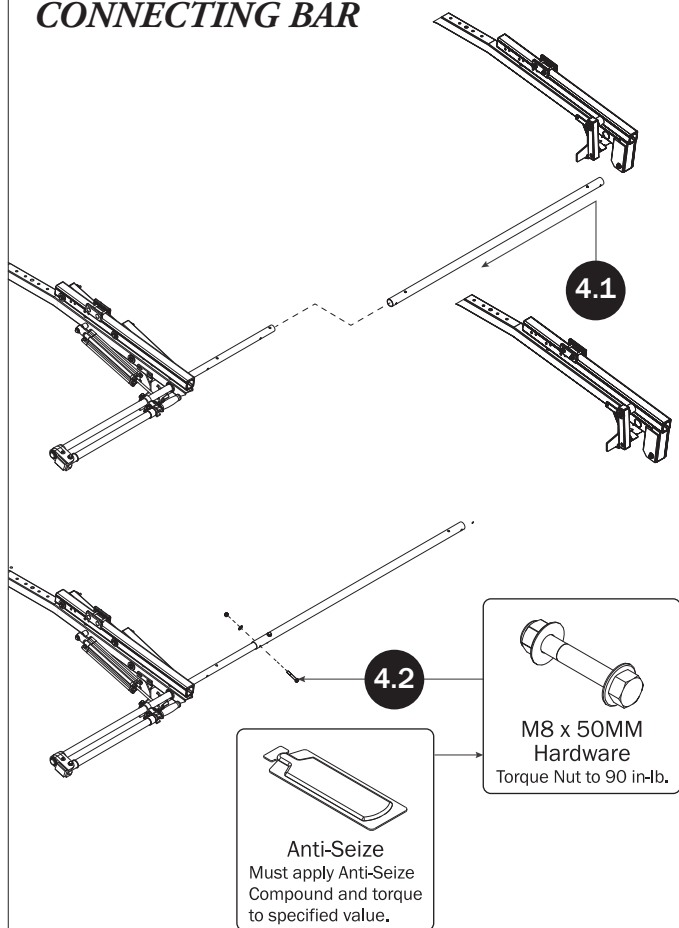

FRONT DRIVE ARM

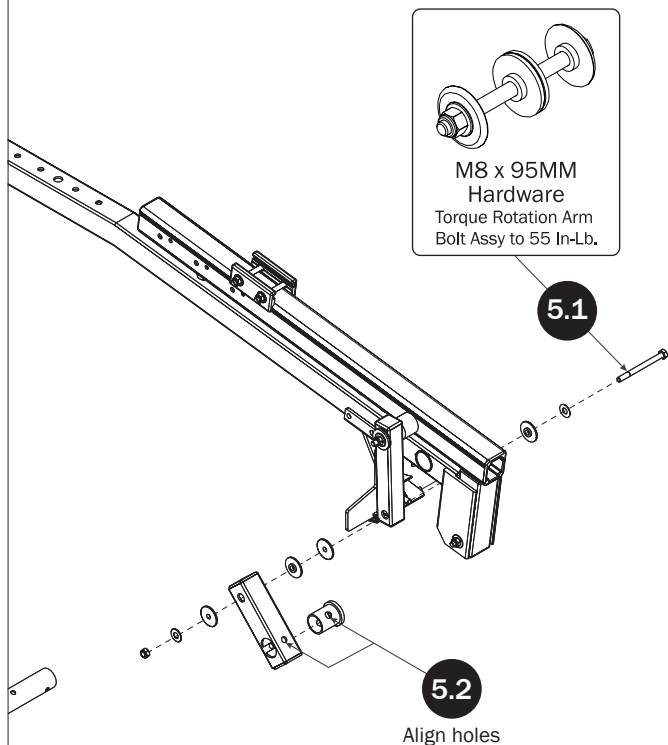

FRONT DRIVE SHAFT

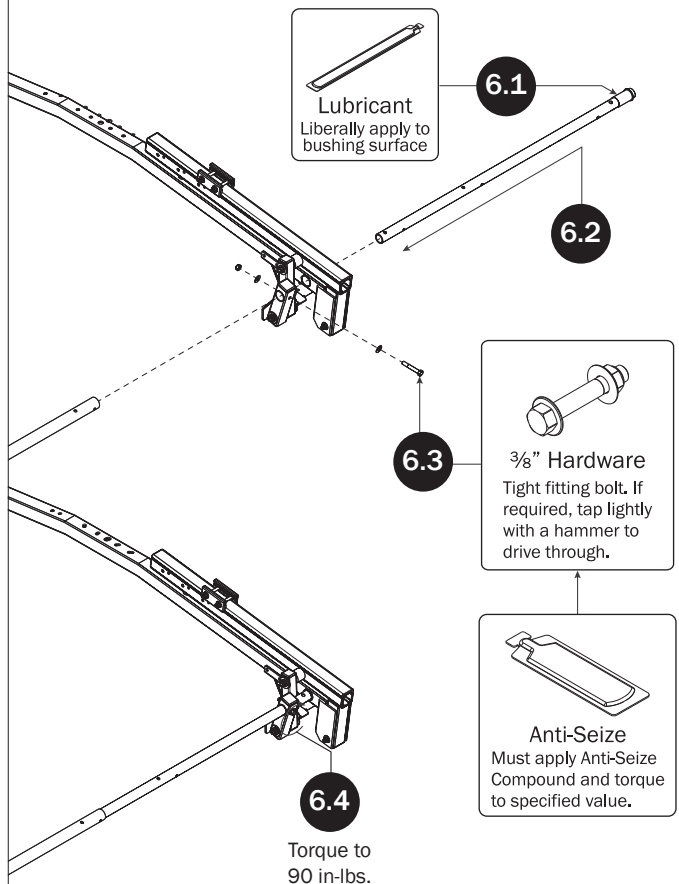

CONNECTING BAR FASTENERS

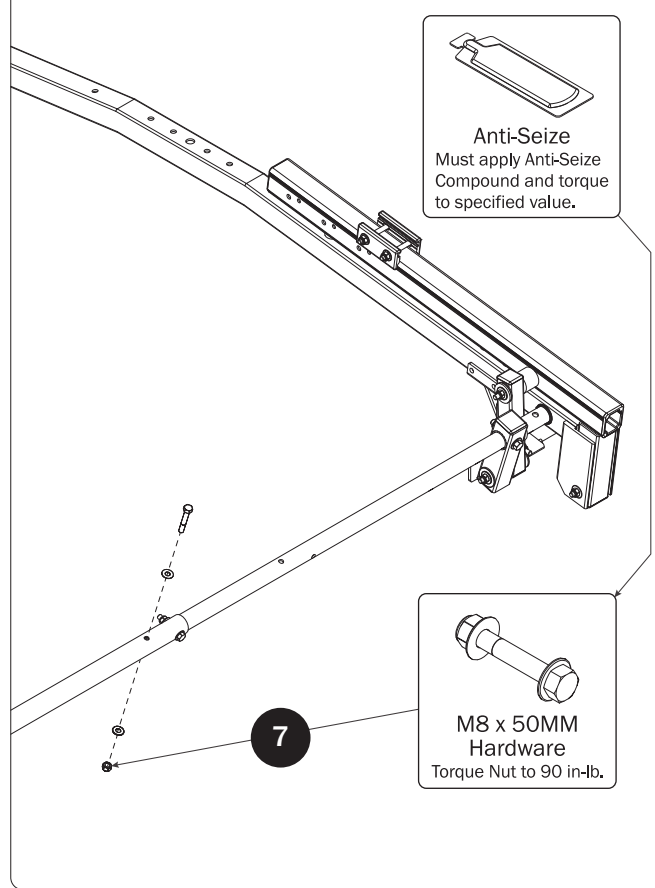

CROSSBAR SEALING

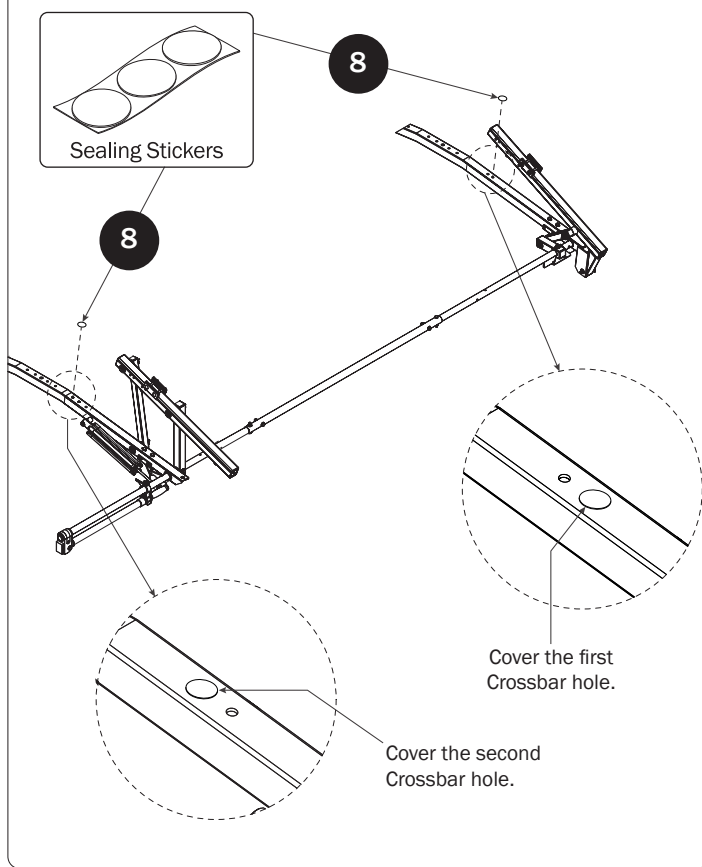

L POSTS

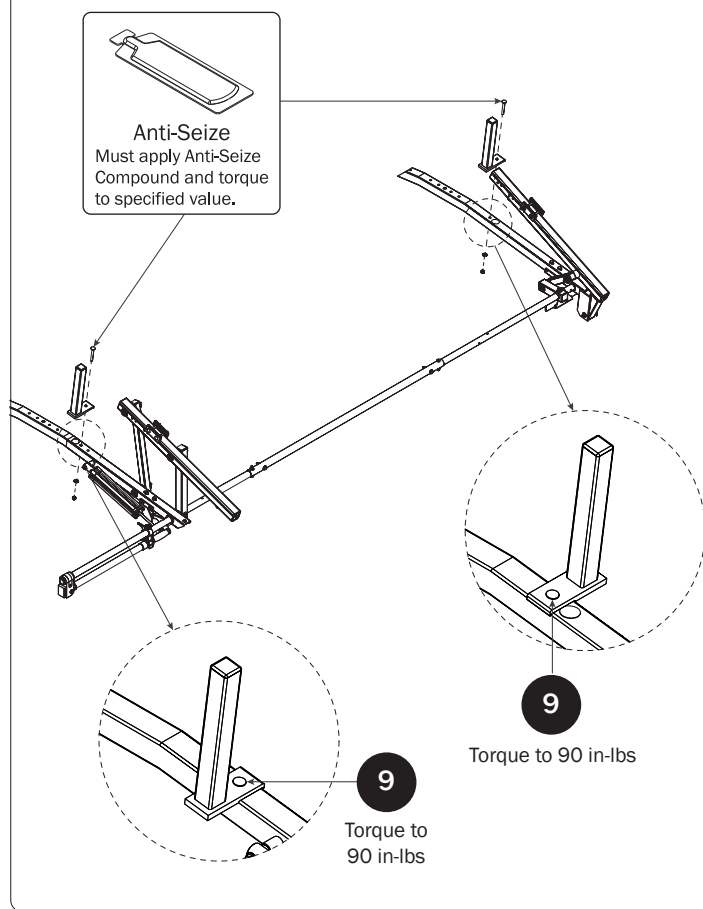

Z POSTS

SEE QUICK START GUIDE FOR ADJUSTMENTS

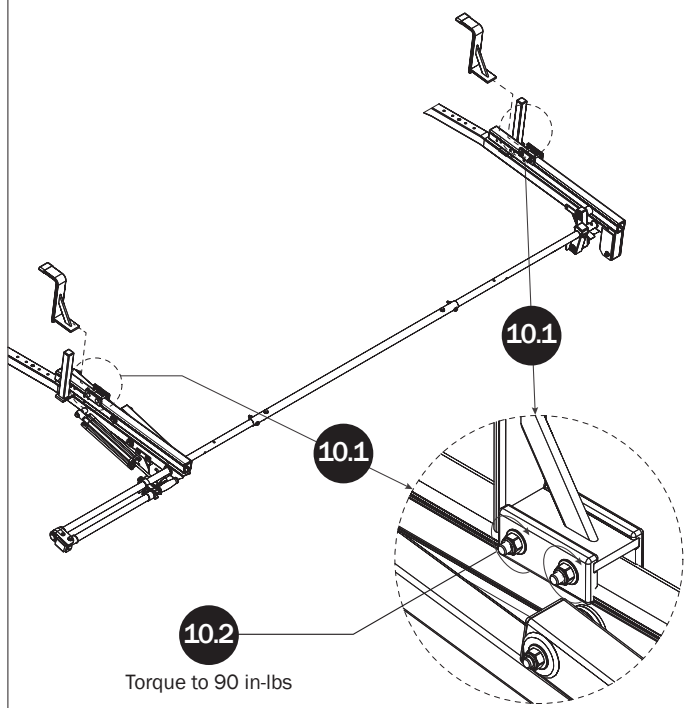

LEFT ROTATION ASSEMBLY SEQUENCE

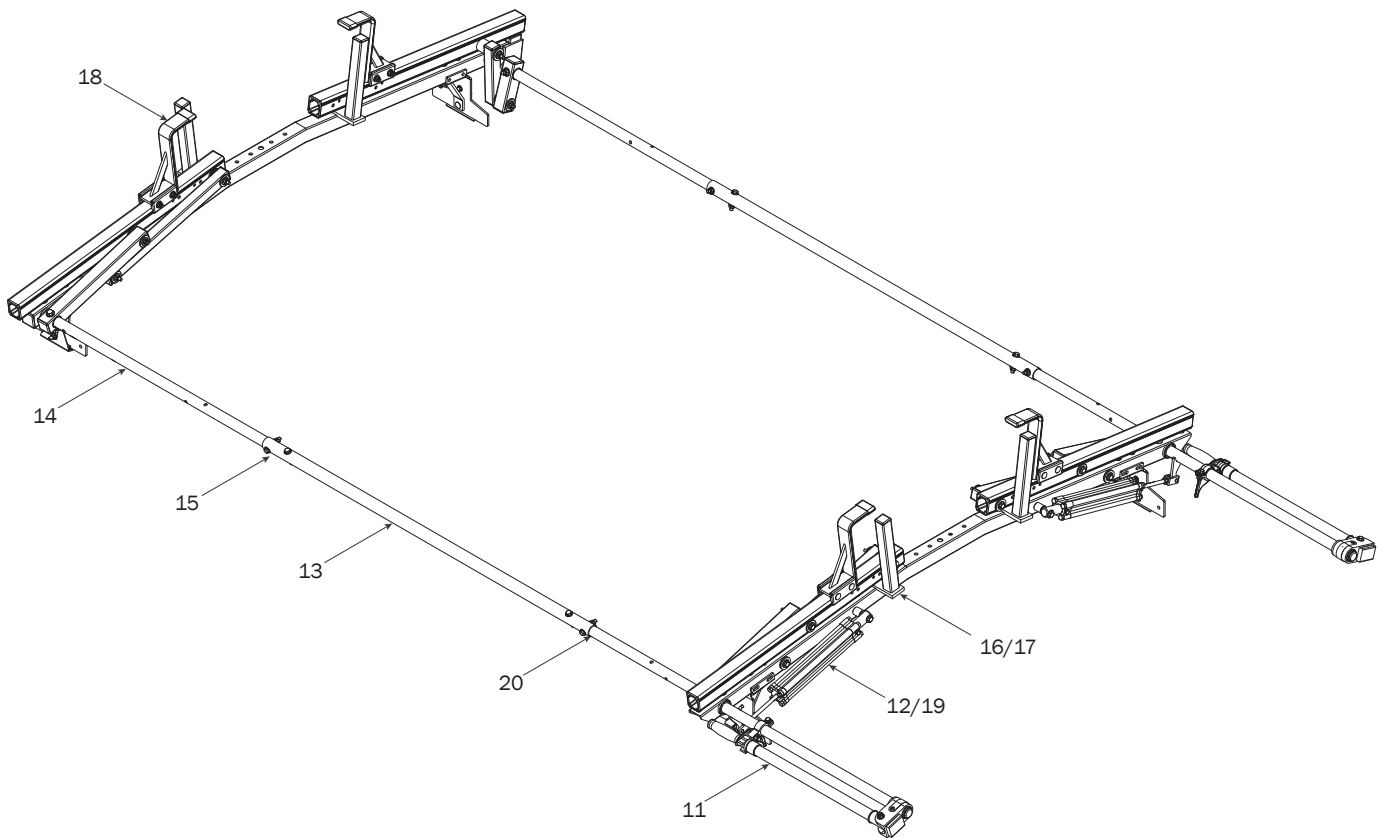

REAR DRIVE SHAFT

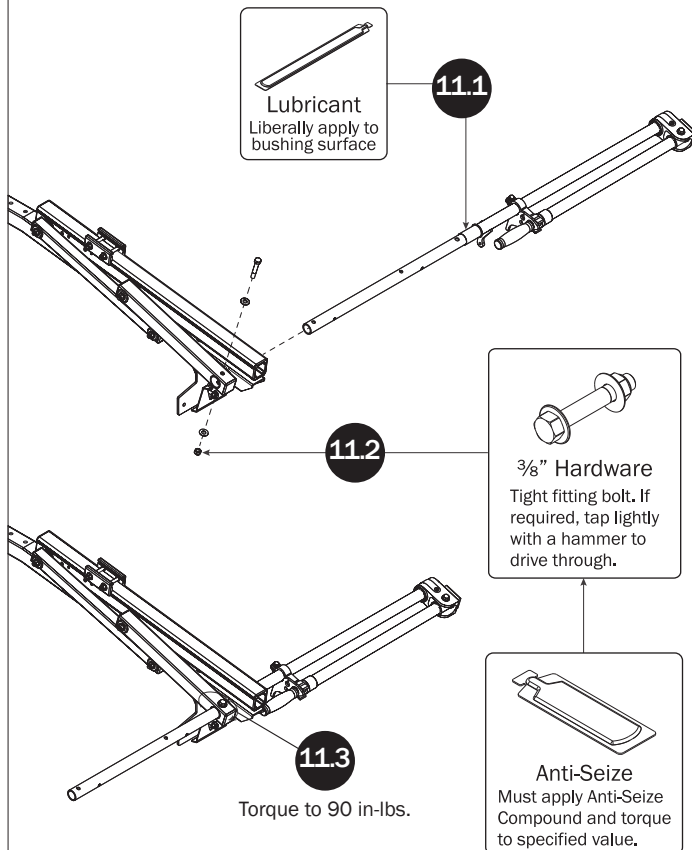

CYLINDER ASSEMBLY

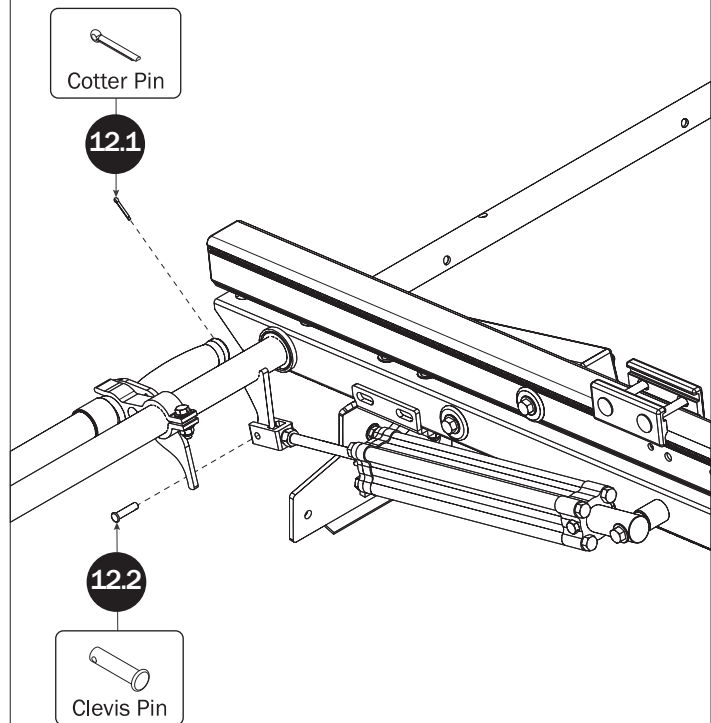

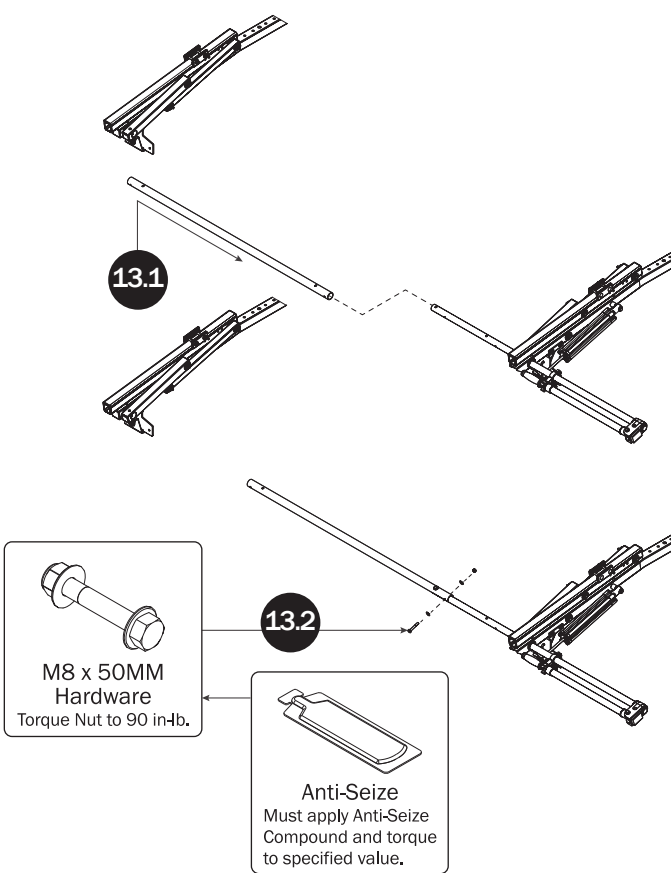
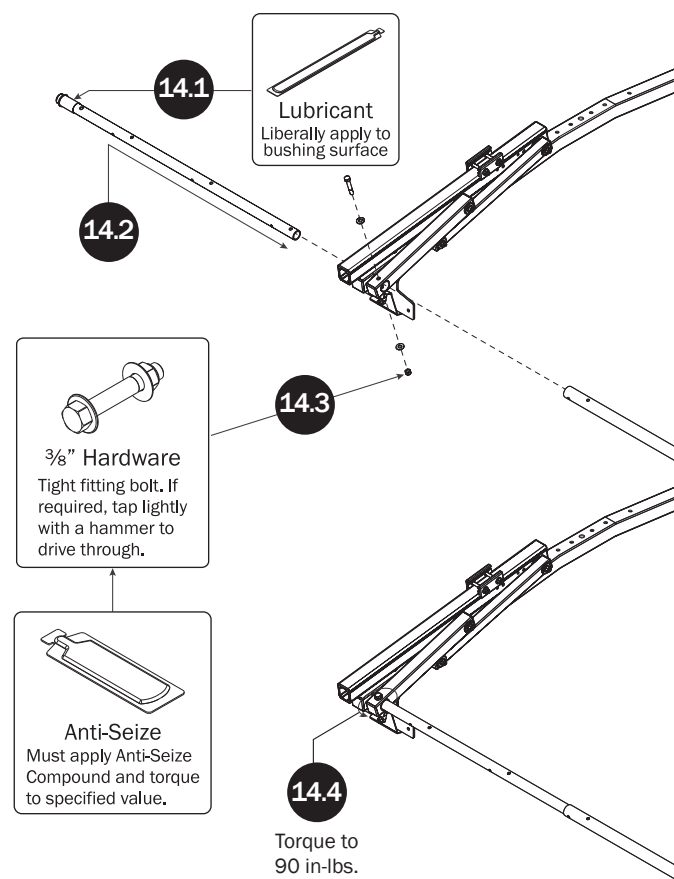
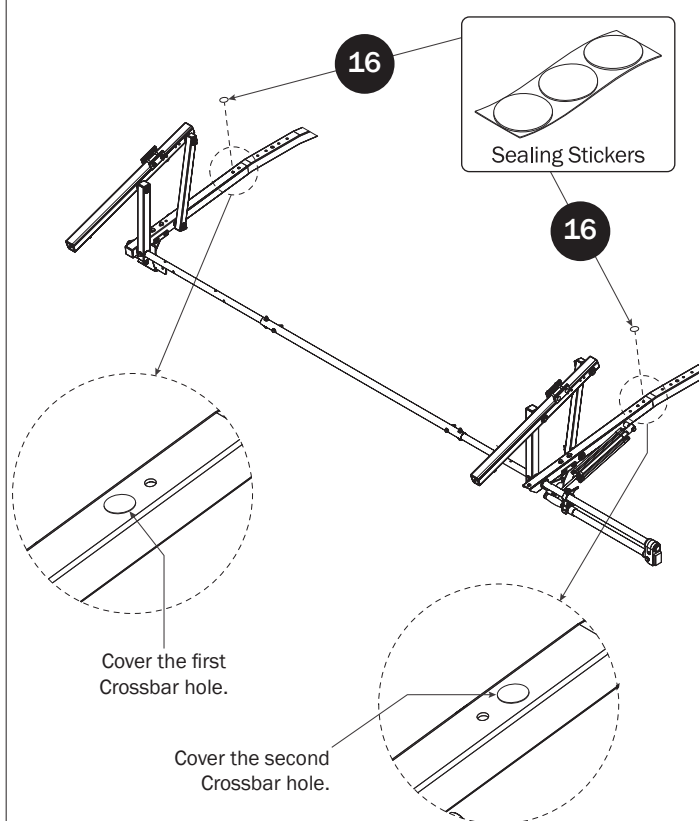
CONNECTING BAR**FRONT DRIVE SHAFT****CROSSBAR SEALING**

L POSTS

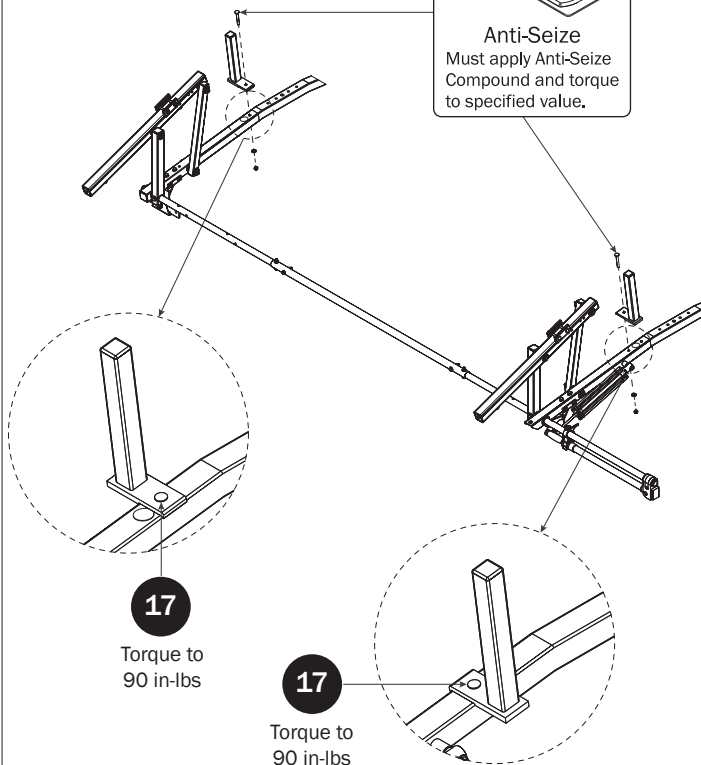

Z POSTS

SEE QUICK START GUIDE FOR ADJUSTMENTS

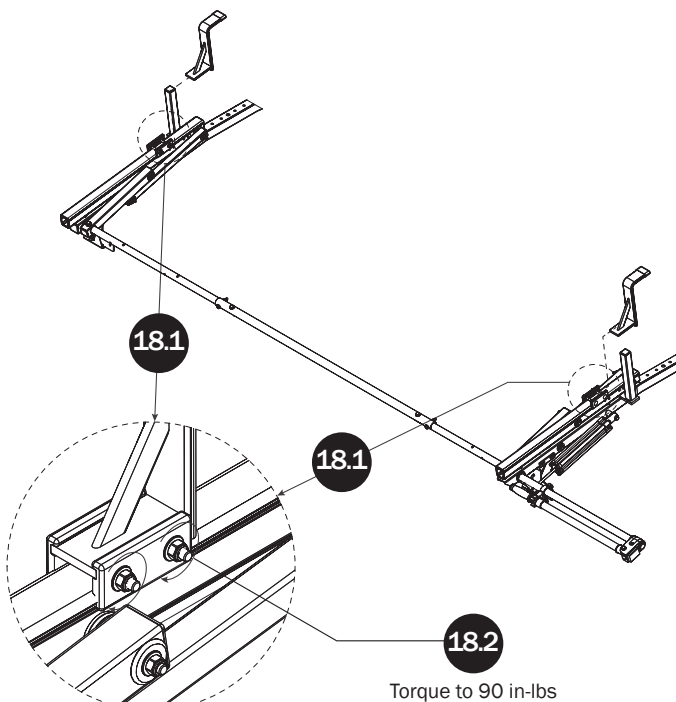

CYLINDER ADJUSTMENT

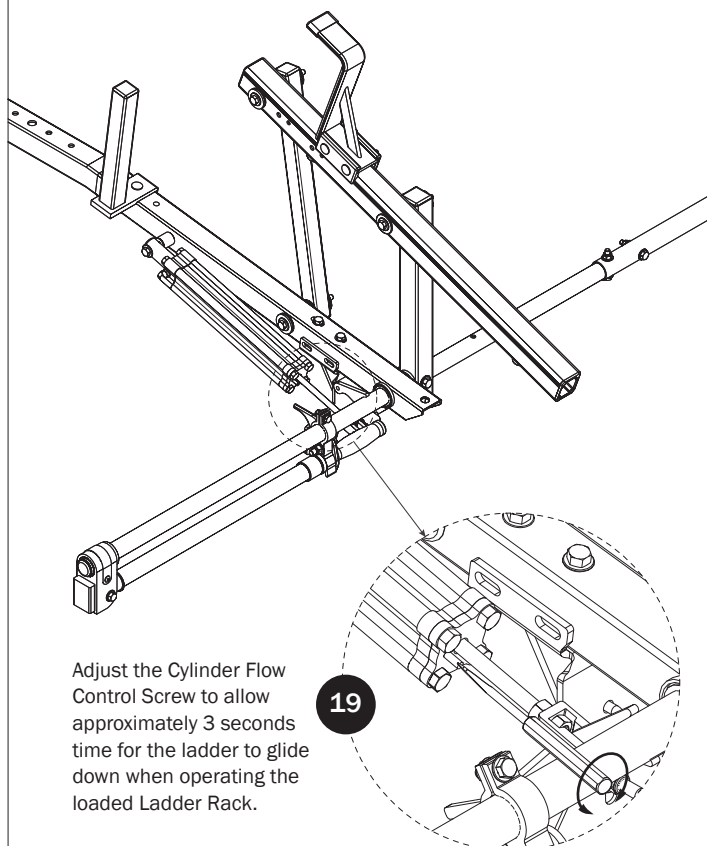

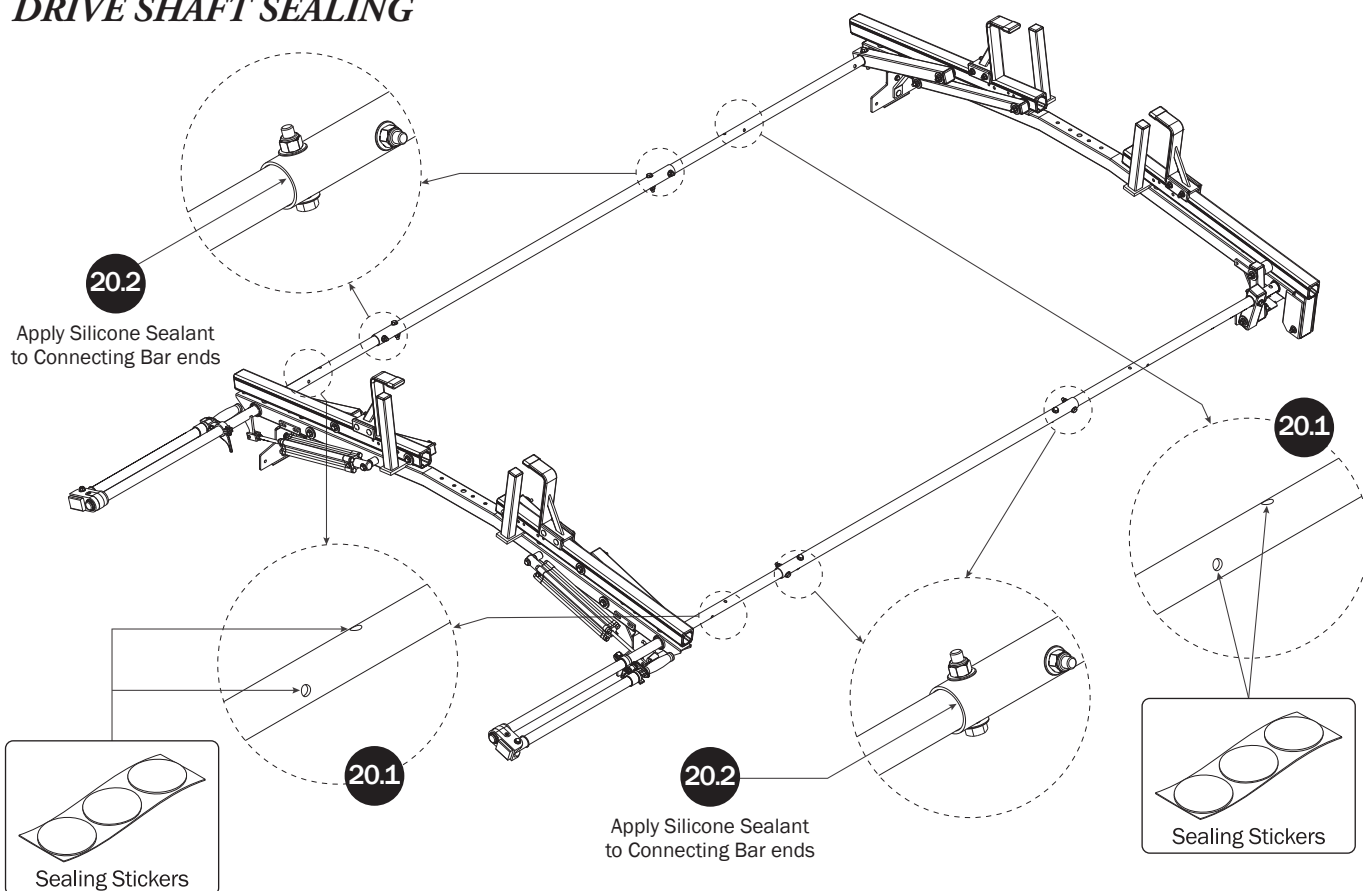
DRIVE SHAFT SEALING

USAM-VRI226-US01 Rev-B 0718