

# PRIME DESIGN™

A Safe Fleet Brand

VBC / V200

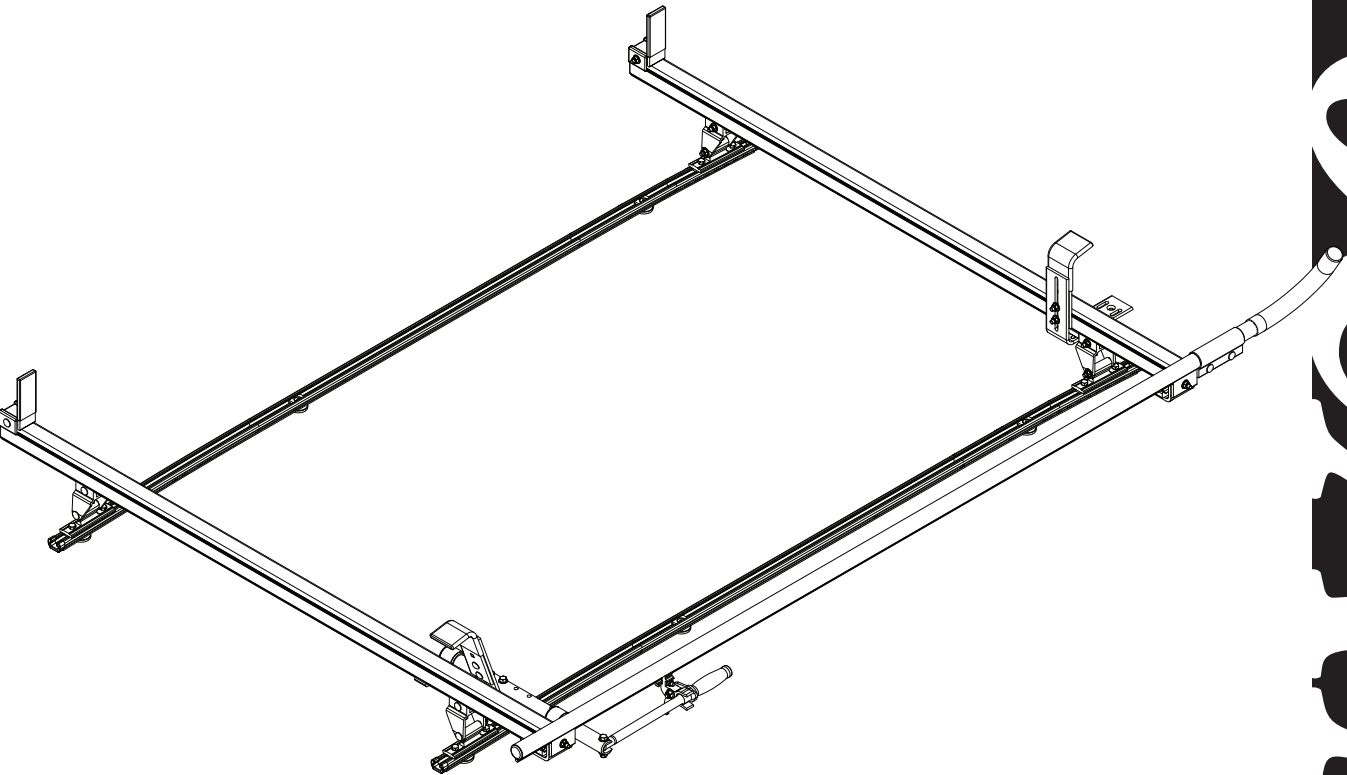

## CONTENTS OVERVIEW

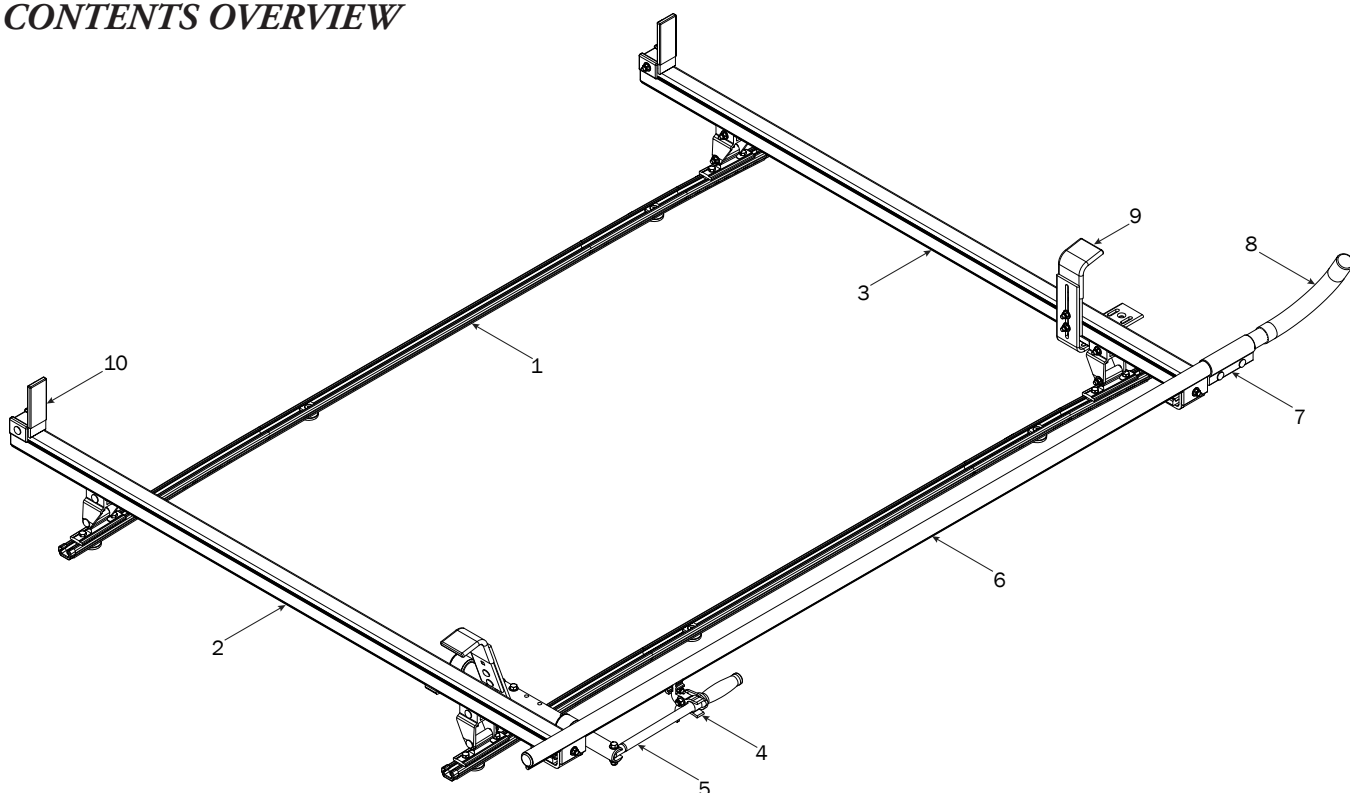

1—FBM-0045 ..... (Qty 1)  
Channels with hardware



Channels (2X)

End Caps (4X)



Brackets (4X)

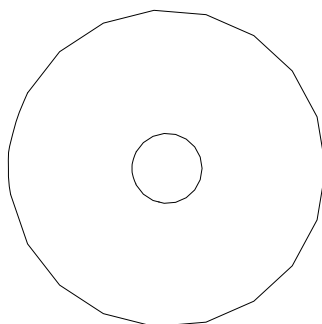

Nylon Washer (6X)

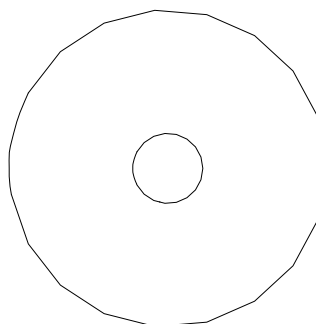

Foam Gasket (6X)

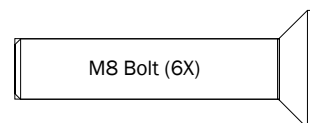

M8 Bolt (6X)

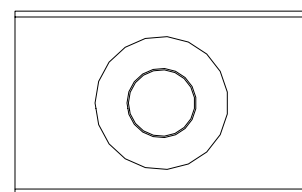

Flex Channel Connector (6X)

2—Rear Crossbar Assembly ..... (Qty 1)

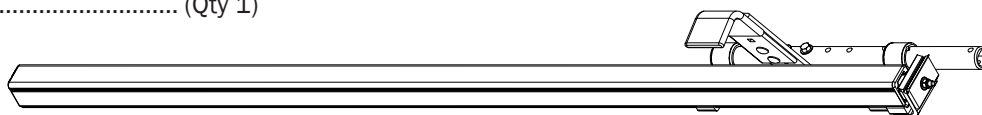

3—Front Crossbar Assembly ..... (Qty 1)

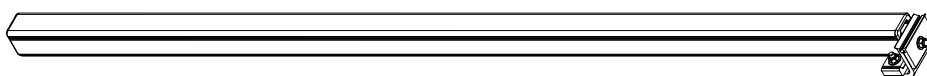

4—Handle Latch Assembly ..... (Qty 1)  
Clamp Down, Right Hand



5—Clamp Down Handle Assembly ..... (Qty 1)

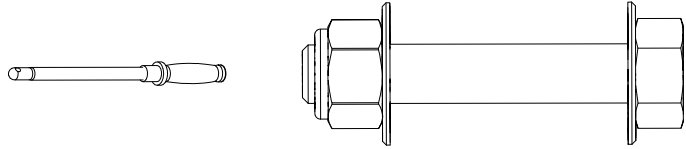

6—Clamp Down Tube ..... (Qty 1)  
80.00"

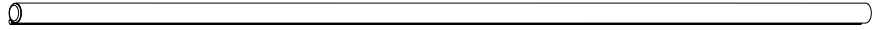

7—Quick Clamp Tube Splice Assembly ..... (Qty 1)  
5.00"



8—Removeable Horn..... (Qty 1)  
With Cap, 15.00"

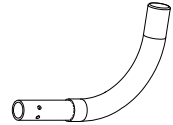

9—HD Front Hook Assembly ..... (Qty 1)

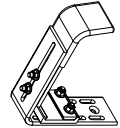

10—Ladder Stop Assembly ..... (Qty 2)  
1.75"

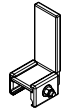

11—ASZ-0101..... (Qty 1)  
Anti-Seize (not shown)

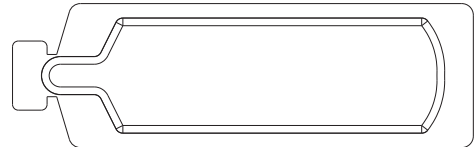

**FBM-0045**  
**CHANNELS TO ROOF**

- 0.1** Position Channels as shown below in Fig.1

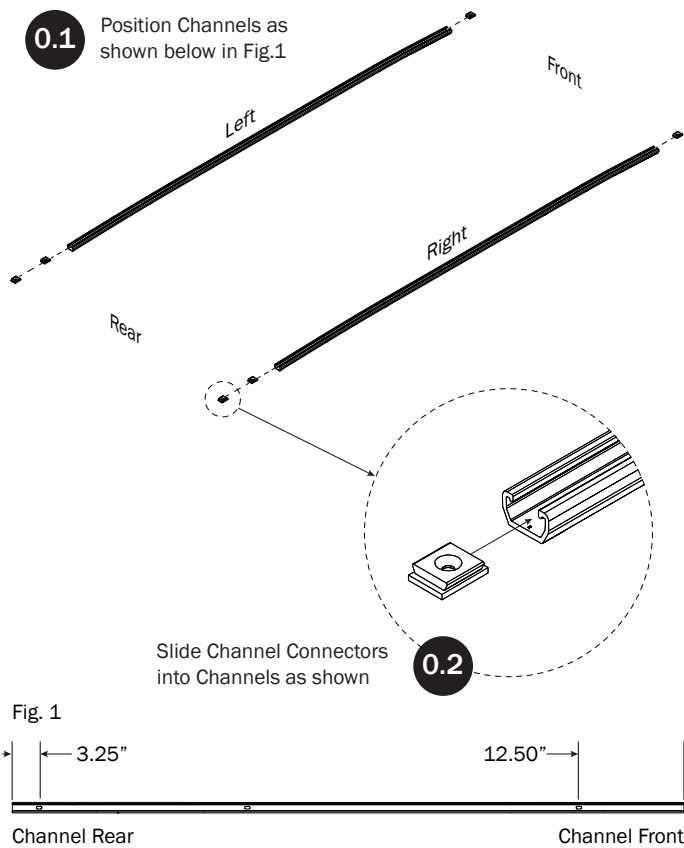

- 0.3** Install Channels into roof Channel groove as shown

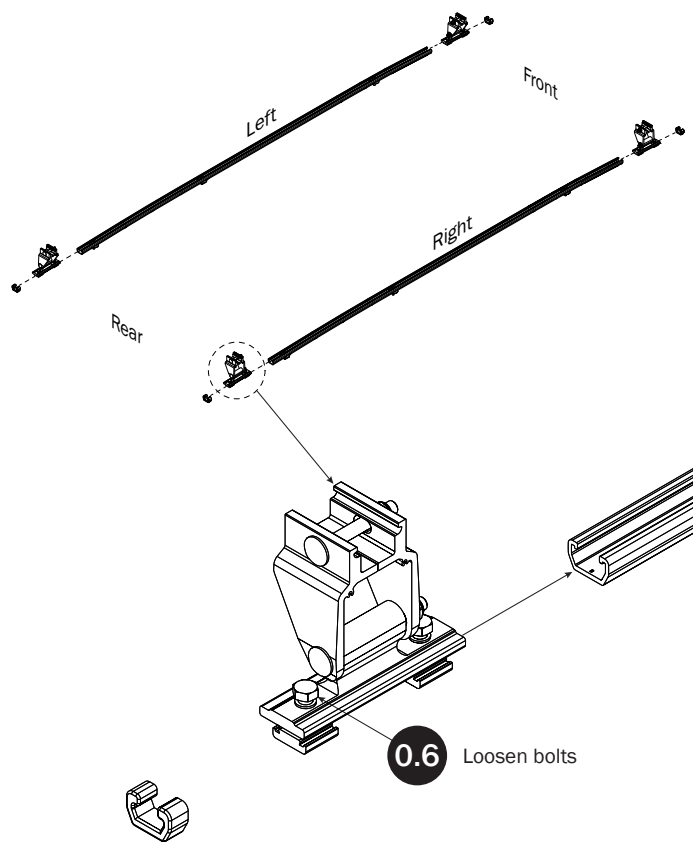
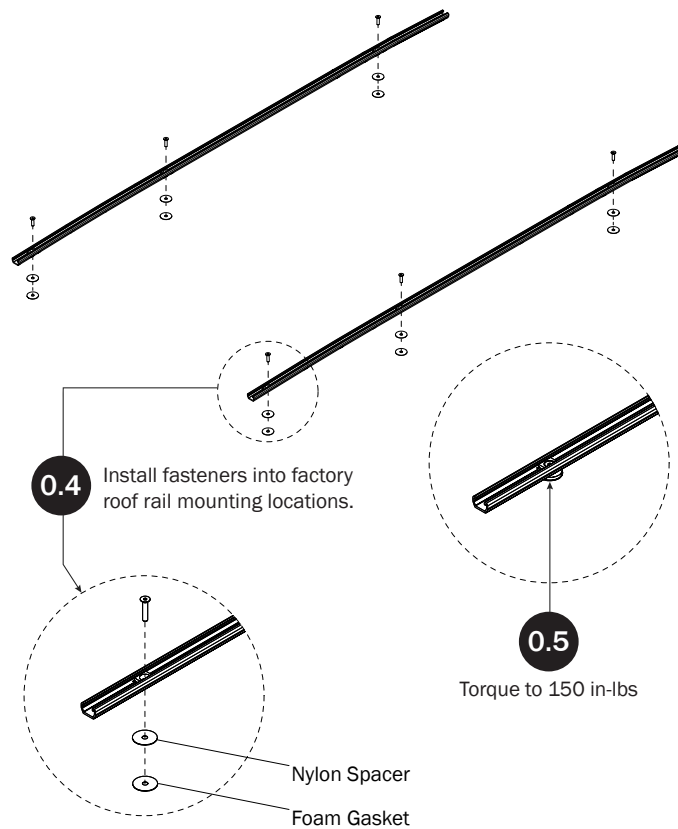

- 0.7** Set to distances then torque Rear Bracket nuts to 90 in-lbs

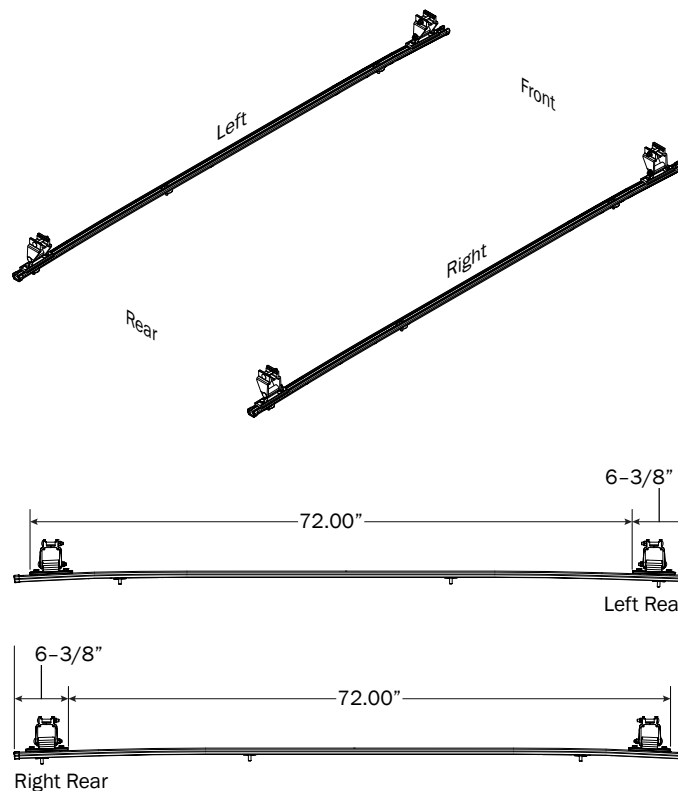

## RIGHT CLAMP DOWN ASSEMBLY SEQUENCE

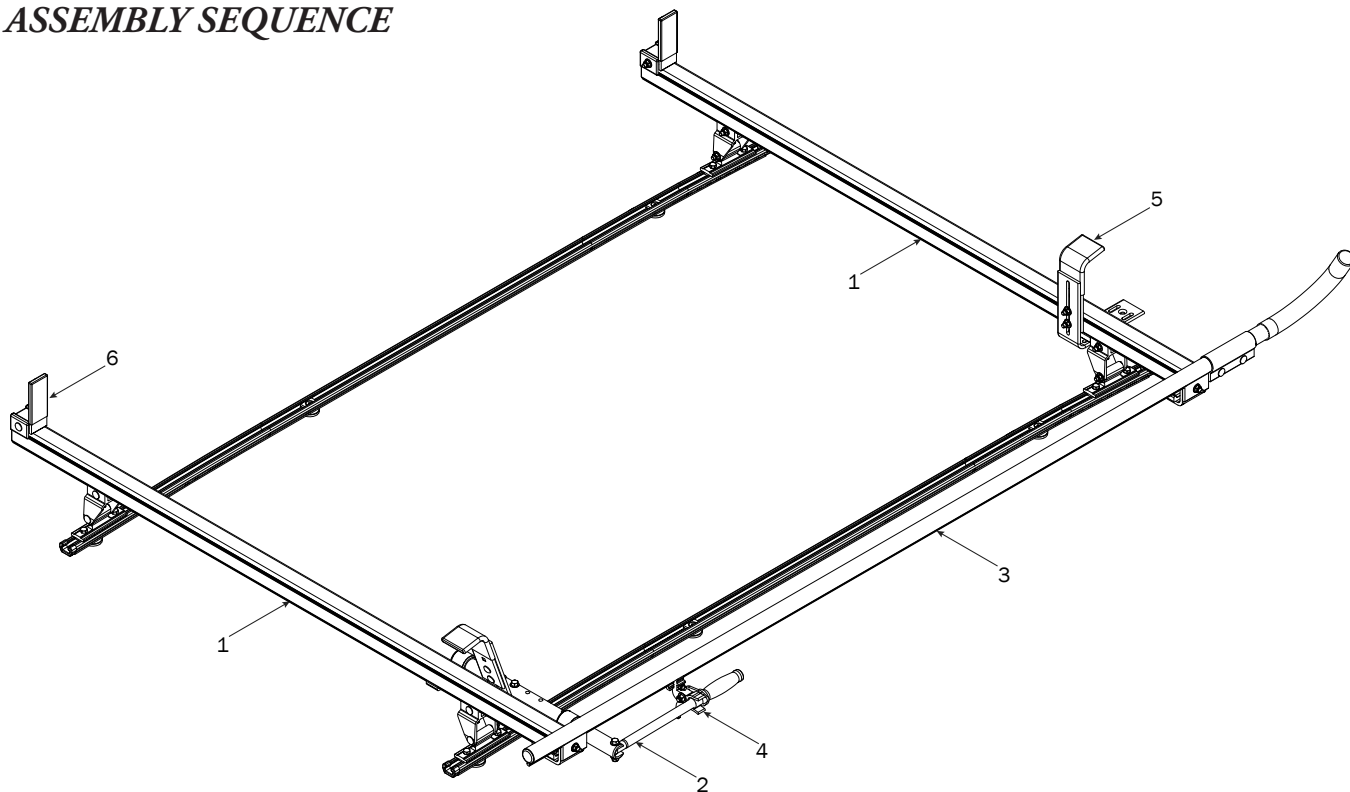

## CROSSBARS

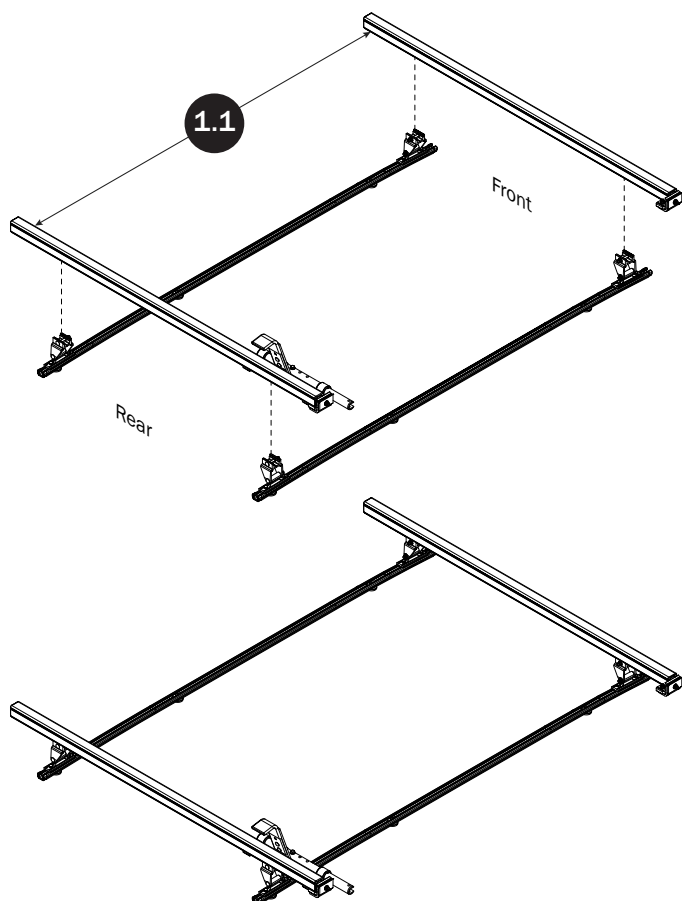

## CROSSBAR ADJUSTMENT

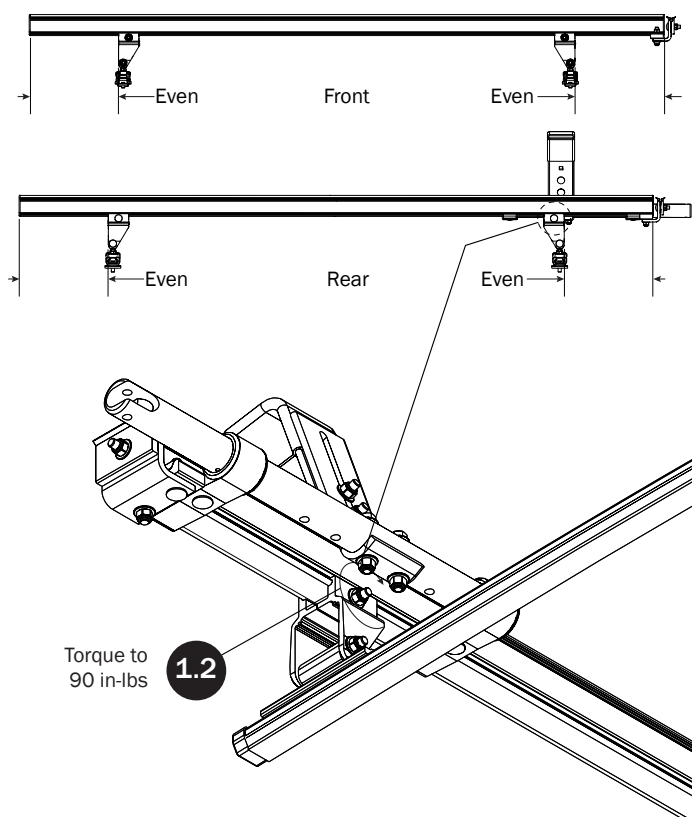

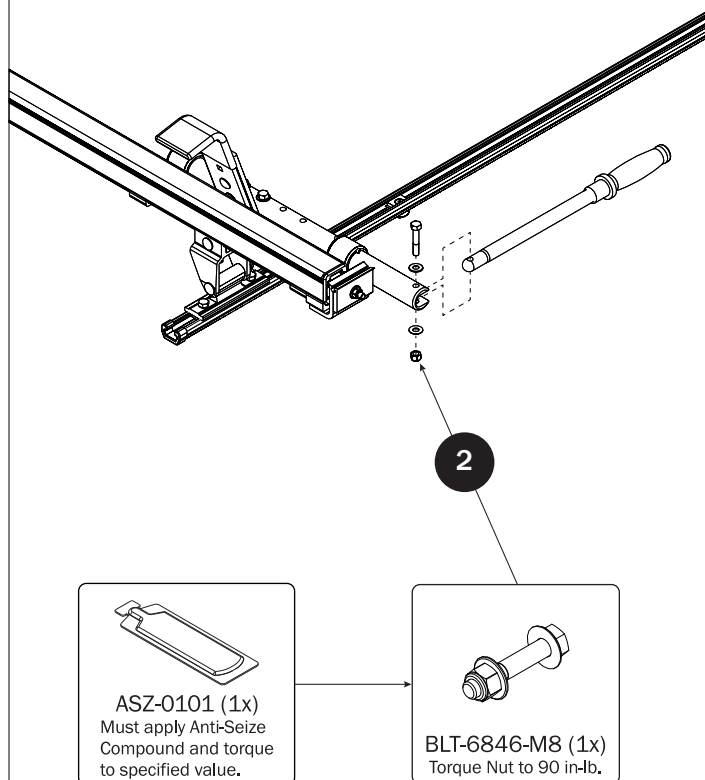
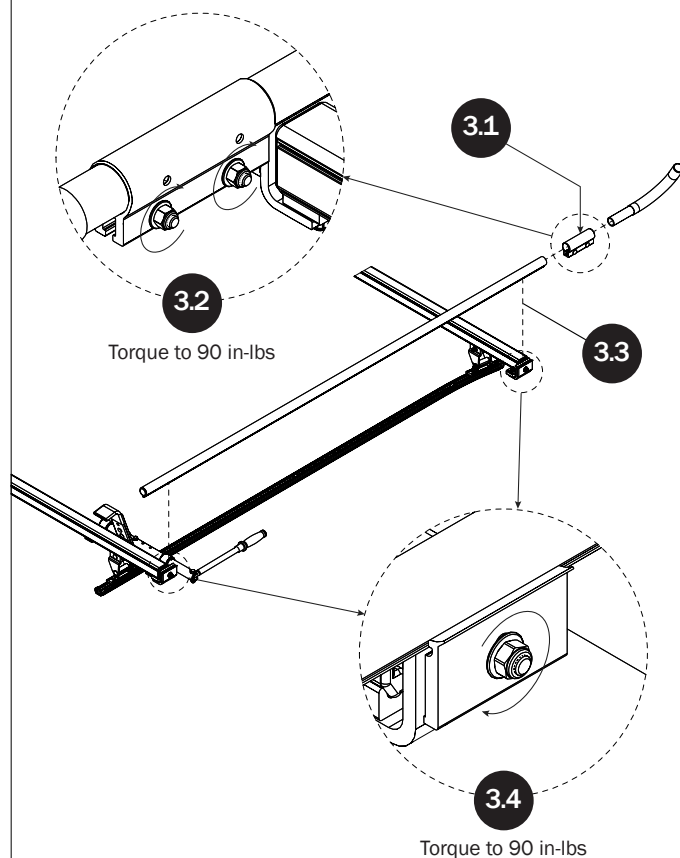
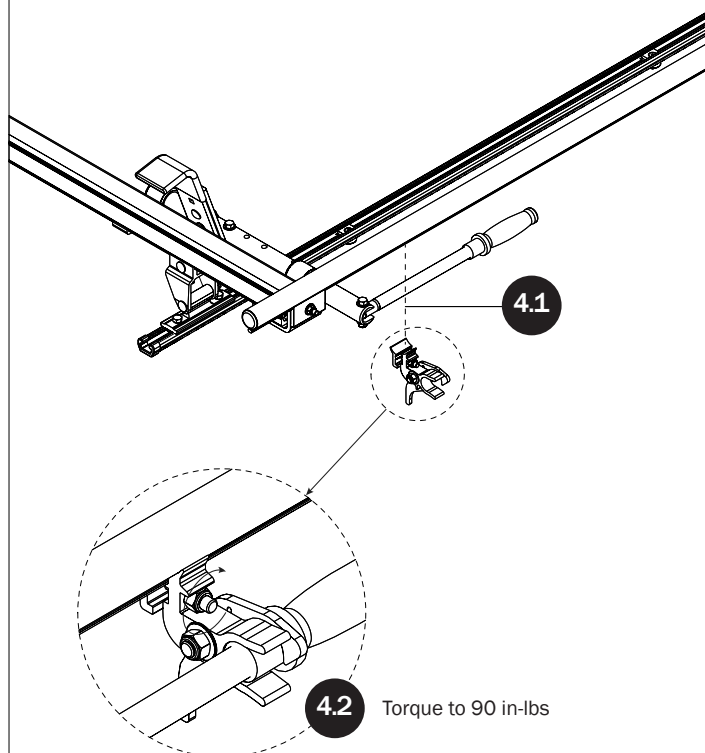
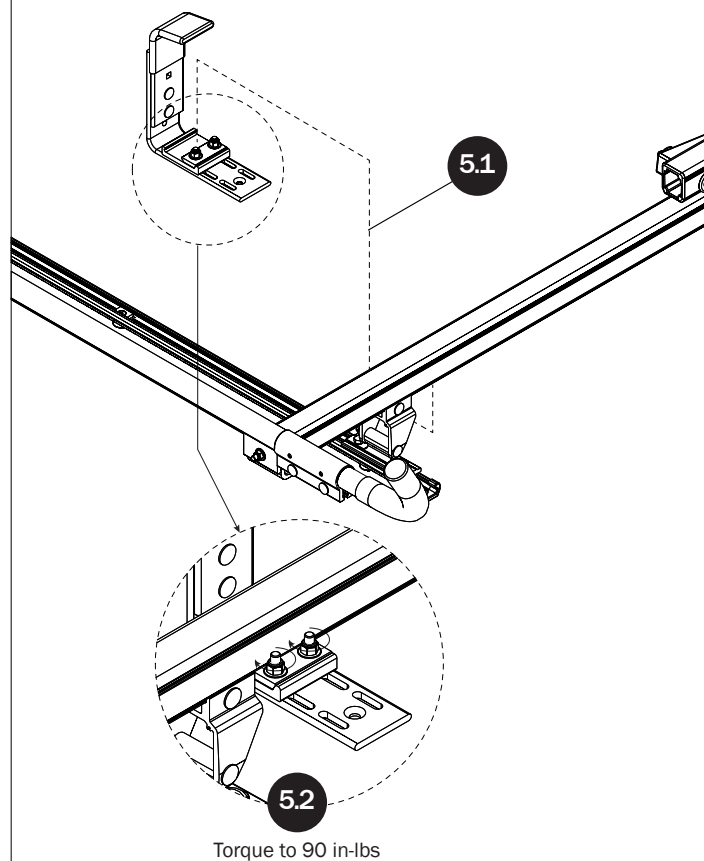
**CLAMP DOWN HANDLE****CLAMP DOWN TUBE****HANDLE LATCH****FRONT LADDER HOOK**  
SEE QUICK START GUIDE FOR ADJUSTMENTS

## LADDER STOPS

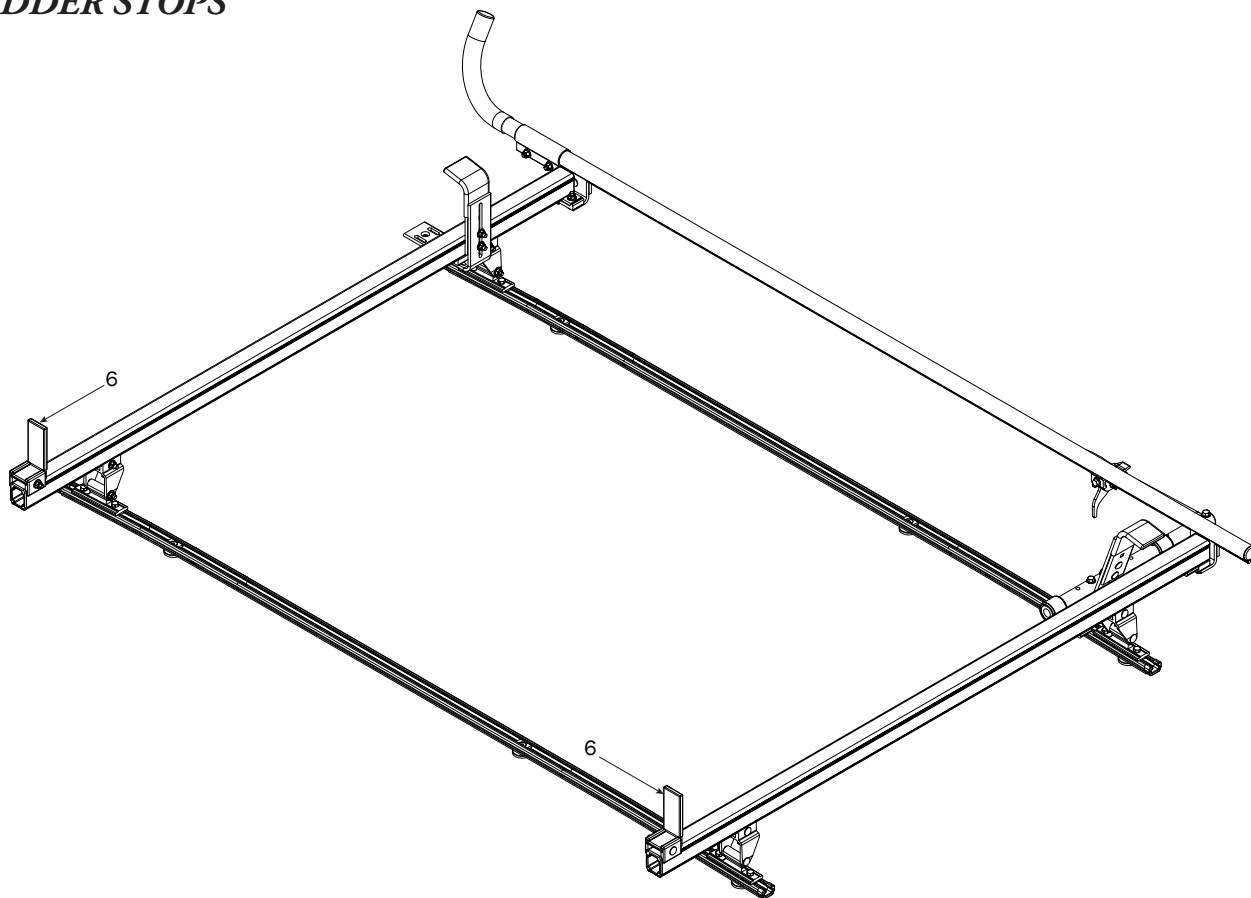

## LADDER STOPS

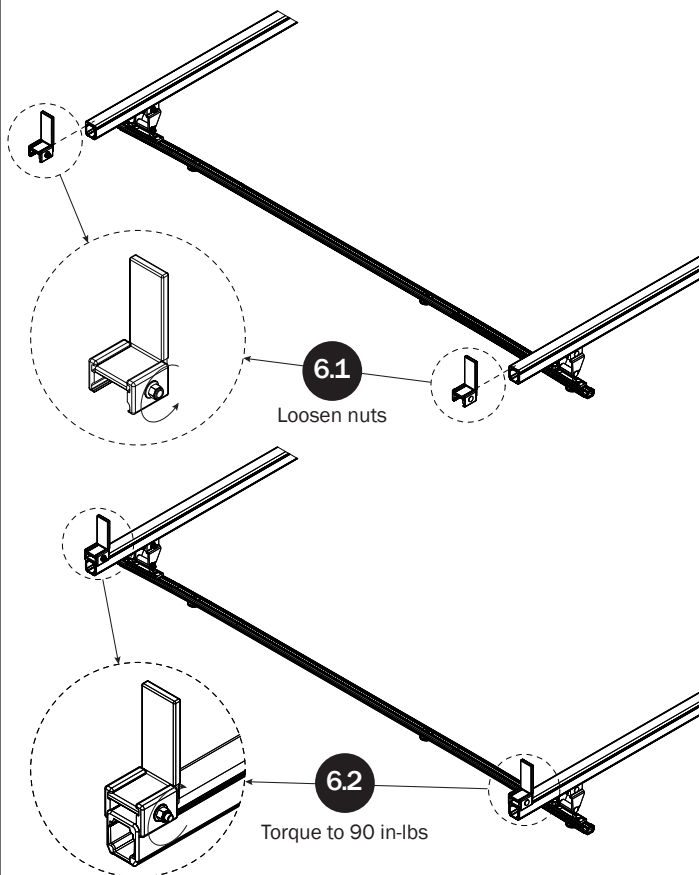

## ADDITIONAL INFORMATION

For additional information regarding your VBC-NV200 Ladder Rack, please visit the Prime Design website at: [www.primedesign.net](http://www.primedesign.net).

Using a QR code reader in your smart phone or tablet, read the QR Code shown below and follow the same steps as you would from your laptop or computer.

If you're viewing this document as an interactive PDF, you may simply click on the QR Code below to access the Prime Design website.

