

# PRIME DESIGN™

A Safe Fleet Brand

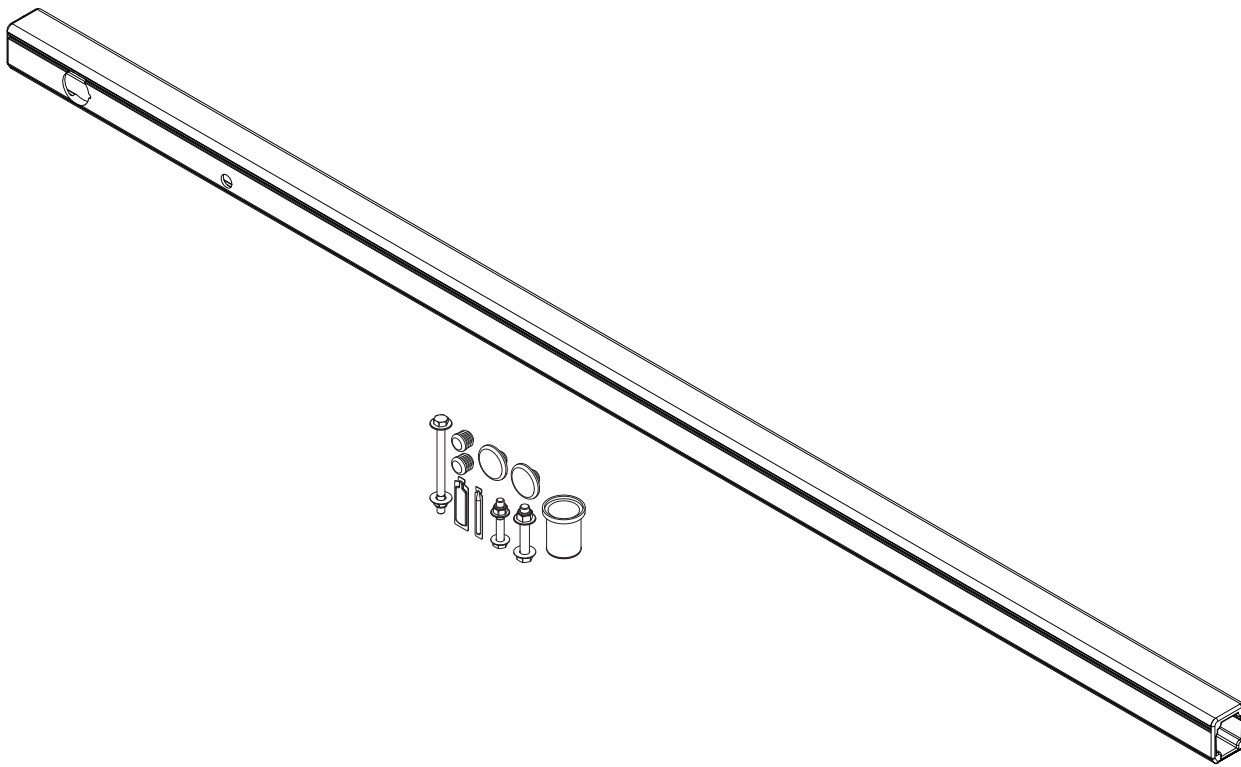

## *LOW ROOF MID CROSSBAR, 68"*

PRIME DESIGN, A SAFE FLEET BRAND

Address: 580 Opperman Drive, Eagan, MN 55123 • Toll Free: 1.8.PRIME.RACK

Fax: 651-552-1799 • Email: [info@primedesign.net](mailto:info@primedesign.net) • Website: [www.primedesign.net](http://www.primedesign.net)

# CBR 0004

# CONTENTS OVERVIEW



NOTE: This Mid Crossbar can be installed as a retrofit conversion or new install. For retrofitting purposes, this modular kit contains a complete Rotation hardware kit.

Use only the Crossbar Caps if fitting the left side with a Clamp Down or Base Ladder Stop features.

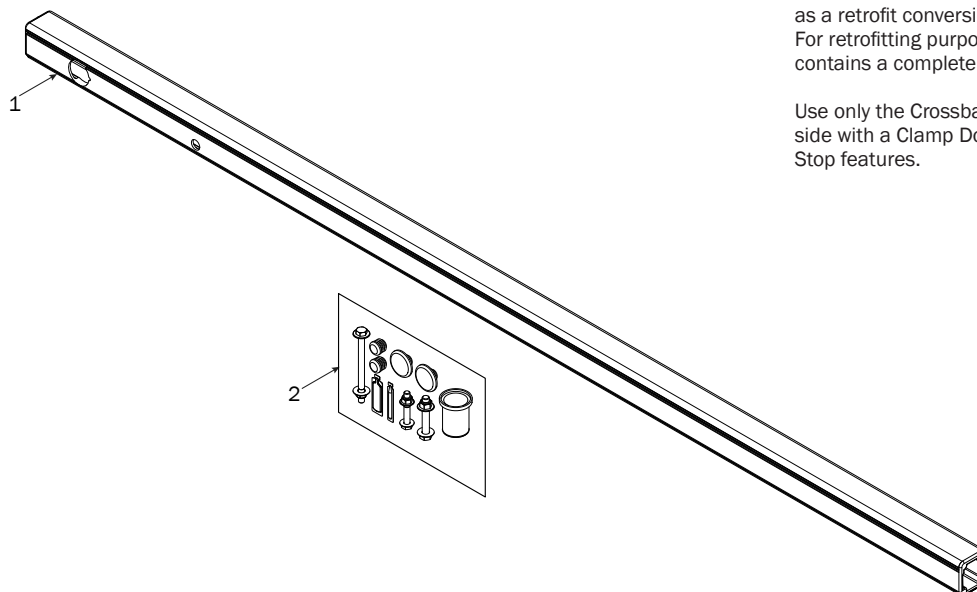

- 1—Crossbar..... (Qty 1)  
Gen 4, Mid, 63.00", 68.00" Crossbar family



- 2—HKT-8407 ..... (Qty 1)  
Hardware Kit, Retrofit w/Caps

NOTE: This hardware kit contains additional parts not needed for a new installation or LH Clamp Down.

These additional parts are included for use in retrofitting a LH Rotation previously assembled onto the Front Crossbar.

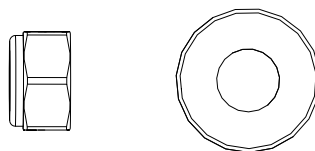
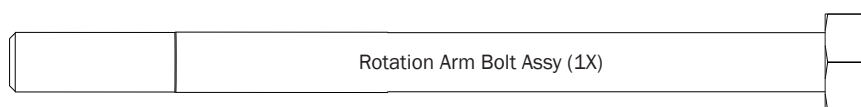

M8 Lock Nut (2X)    5/16" Flat Washer (2X)

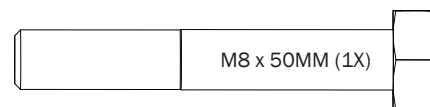

M8 x 50MM (1X)

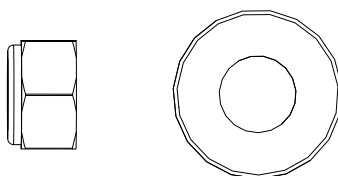

3/8" Lock Nut (1X)    3/8" Flat Washer (4X)

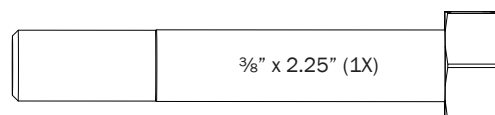

3/8" x 2.25" (1X)

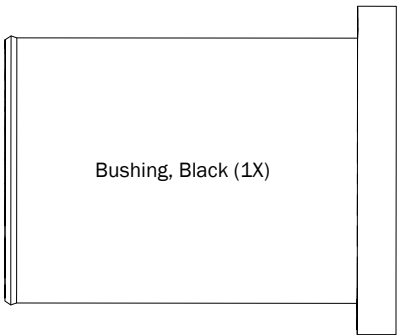

Bushing, Black (1X)

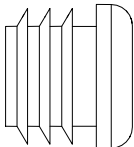

Cap, Small (2X)

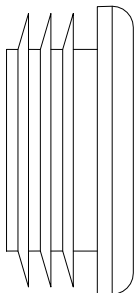

Cap, Large (2X)



Anti-Seize (1X)

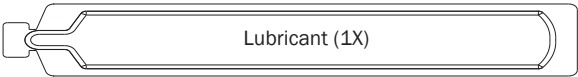

Lubricant (1X)

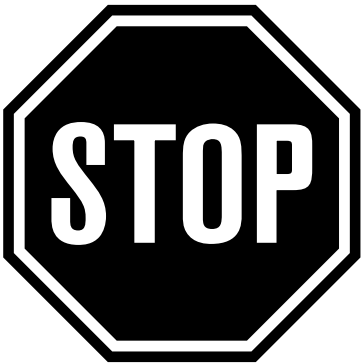

### READ FIRST!

**Do not mount the Crossbars or Mounting Brackets to an FBM system at this time.**

Refer to the respective FEA Assembly Manual(s) included with your chosen rack configuration features. Depending upon the features chosen, you may need to perform a complete feature assembly onto the Crossbars prior to mounting as noted in that feature’s Assembly Manual.

*WARNING: Failure to position the Crossbars as shown in your FBM Assembly Manual may result in damage to the sliding and/or swinging doors, and/or ladder rack.*

**INSTALLER NOTE:** Base, Clamp Down, or Rotation features are not included in this CBR kit, and must be purchased separately. To purchase applicable features and accessories, please contact your authorized distributor, or a Prime Design Sales & Service Representative.

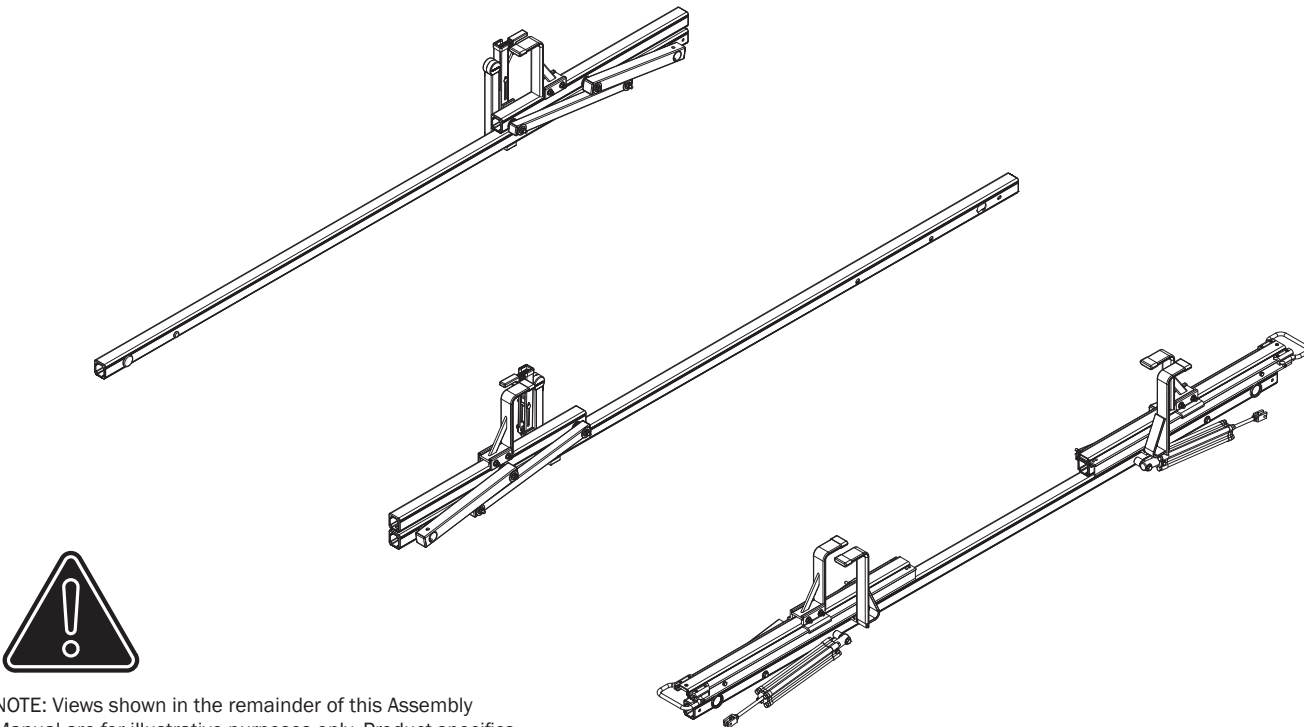
**MODIFICATION: 2 TO 3 CROSSBAR  
CONVERSION SEQUENCE**

NOTE: Views shown in the remainder of this Assembly Manual are for illustrative purposes only. Product specifics may vary, but will not affect the sequence.

**SEQUENCE OVERVIEW**

NOTE: Crossbar conversions are most commonly performed on the street side. If you require the conversion on the curb side, all instructions remain the same.

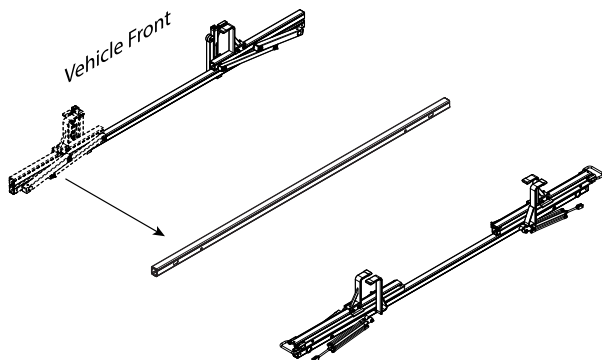
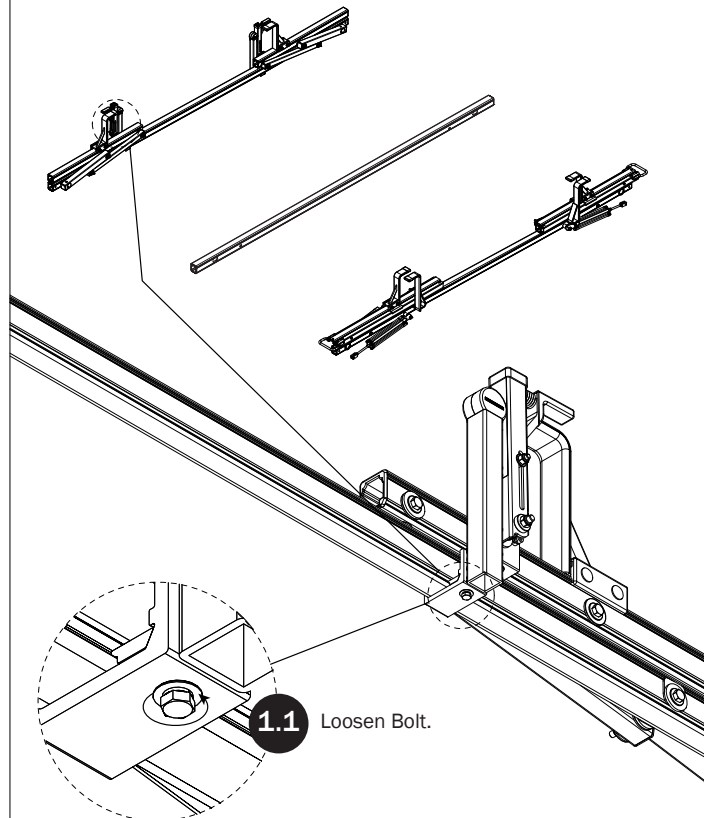
**UNINSTALLING FRONT ROTATION**

**1.2** Remove and save the L-Post.

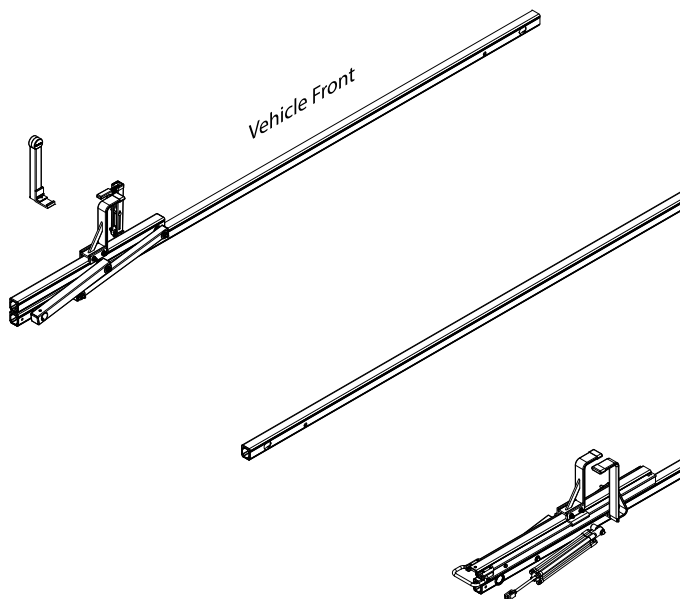

**1.3** Open the Rotation as shown.

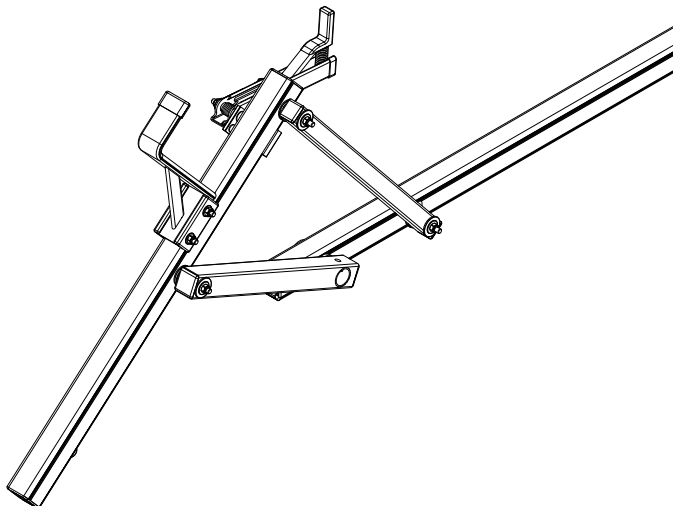

**1.4** Remove and save front Rotation and Hardware as shown.

NOTE: The front Bushing, if damaged, may be replaced with the Bushing contained in this Assembly's Hardware Kit.

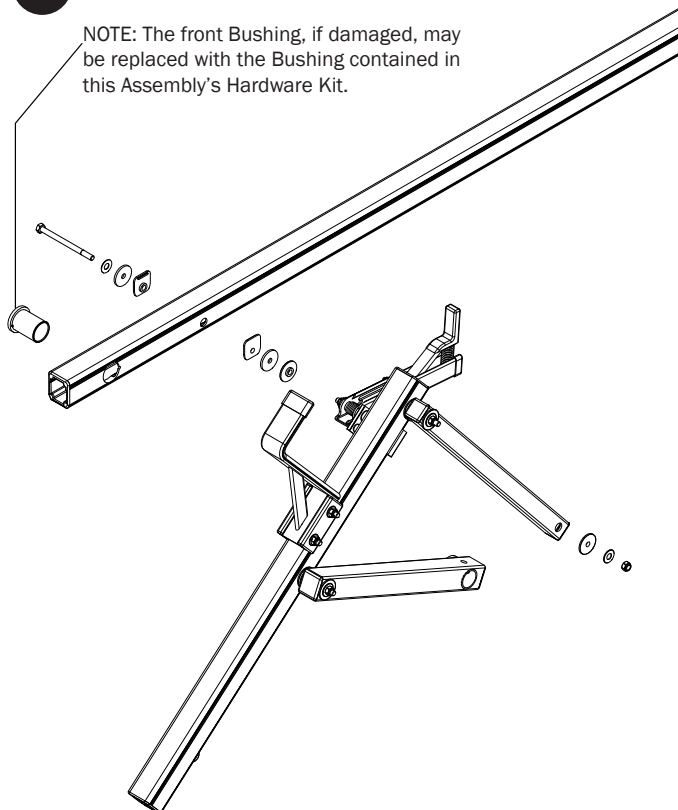

**INSTALLING MID ROTATION**  
SEE QUICK START GUIDE FOR ADJUSTMENTS

**2.1** Install the Rotation and Hardware onto the Mid Crossbar as shown.

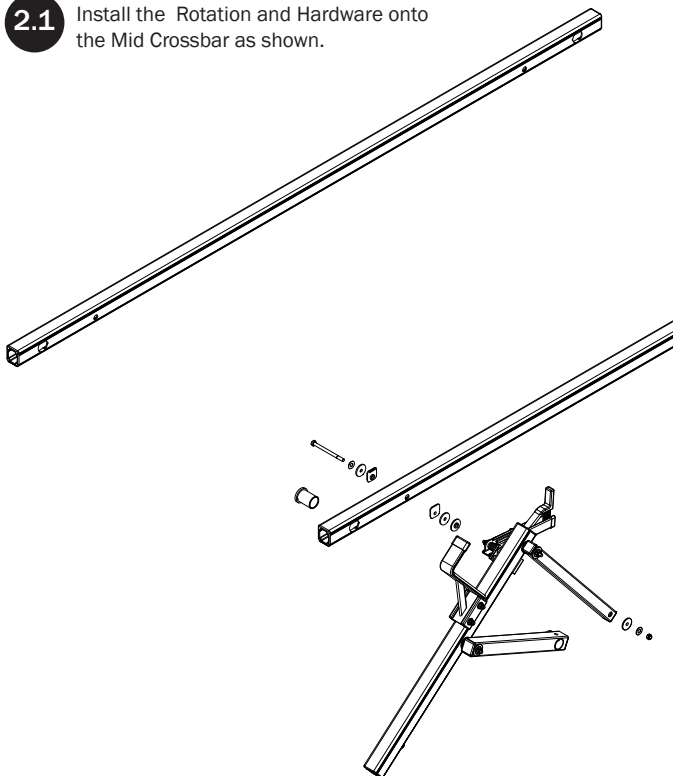

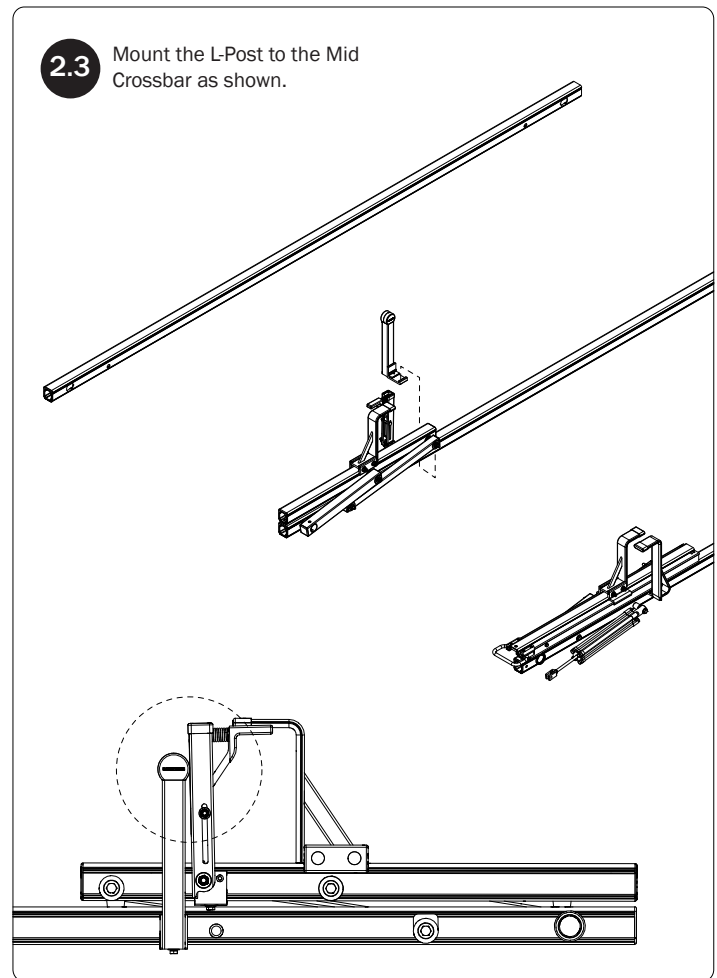
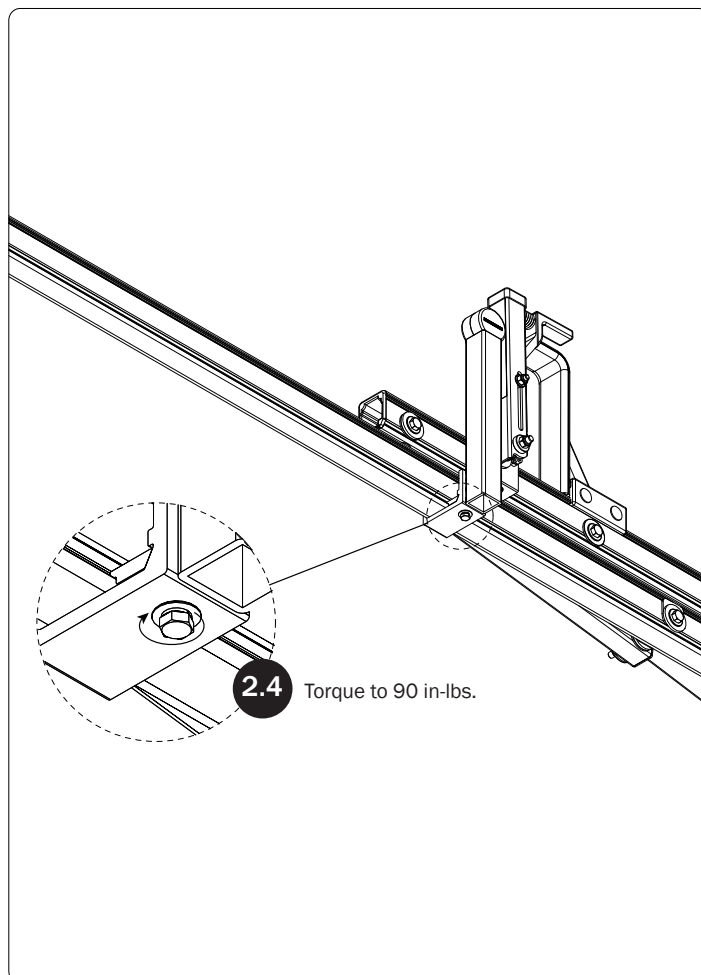
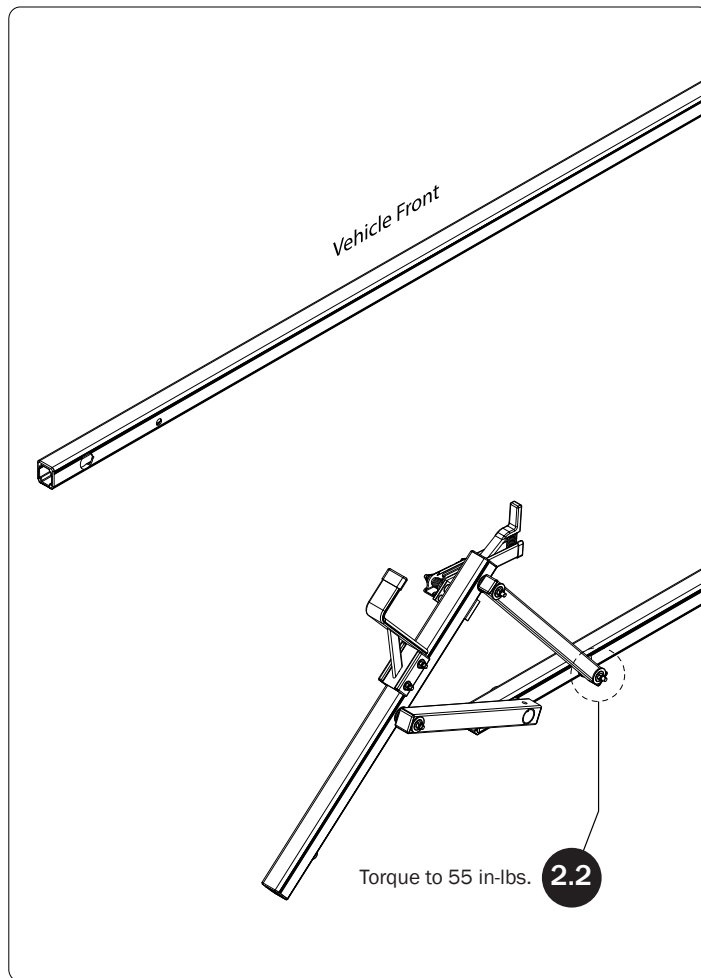

### CROSSBAR CAPS

- 3** Apply Crossbar Caps to unused Drive Shaft holes.

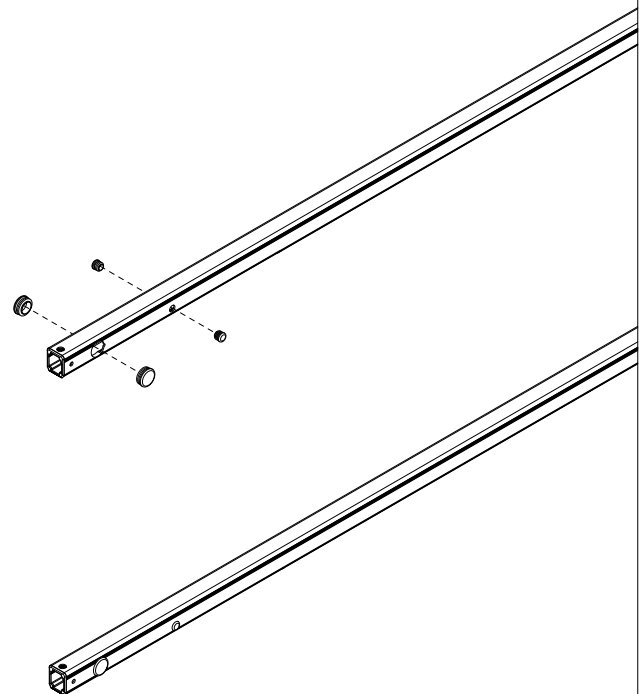

Page Intentionally Left Blank

