

PRIME DESIGN™

A Safe Fleet Brand

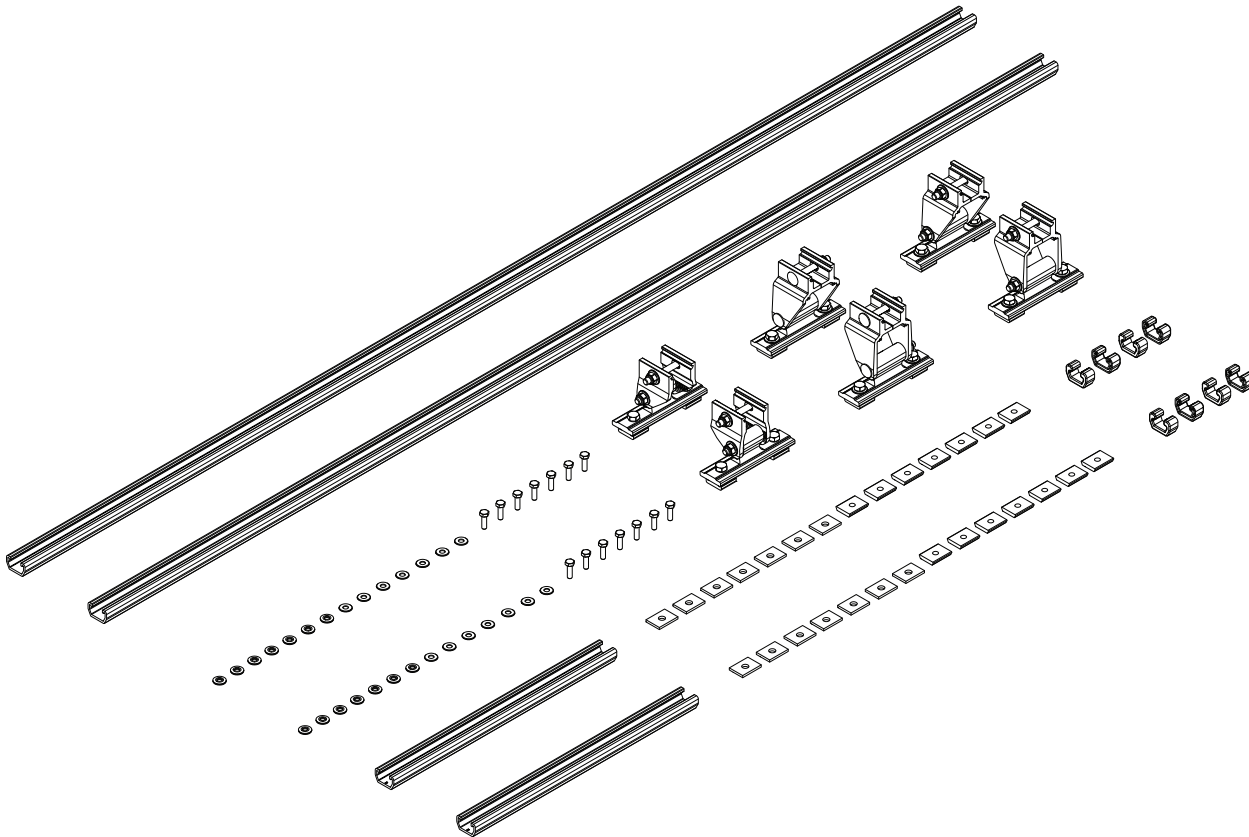

2016+ Mercedes Metris Low Roof Base Mounting Kit

Pages 2-3	Packaging Contents
Pages 4-7	Low Roof Medium Wheelbase (126")
Pages 8-11	Low Roof Long Wheelbase (135")

PRIME DESIGN, A SAFE FLEET BRAND

Address: 580 Opperman Drive, Eagan, MN 55123 • Toll Free: 1.8.PRIME.RACK
Fax: 651-552-1799 • Email: info@primedesign.net • Website: www.primedesign.net

FBM-1015

CONTENTS OVERVIEW**TWO & THREE CROSSBAR CONFIGURATIONS**

NOTE: This Manual contains information covering two and three Crossbar configurations. If your model is a two Crossbar configuration (ErgoRack only), disregard all Center Crossbar installation information.

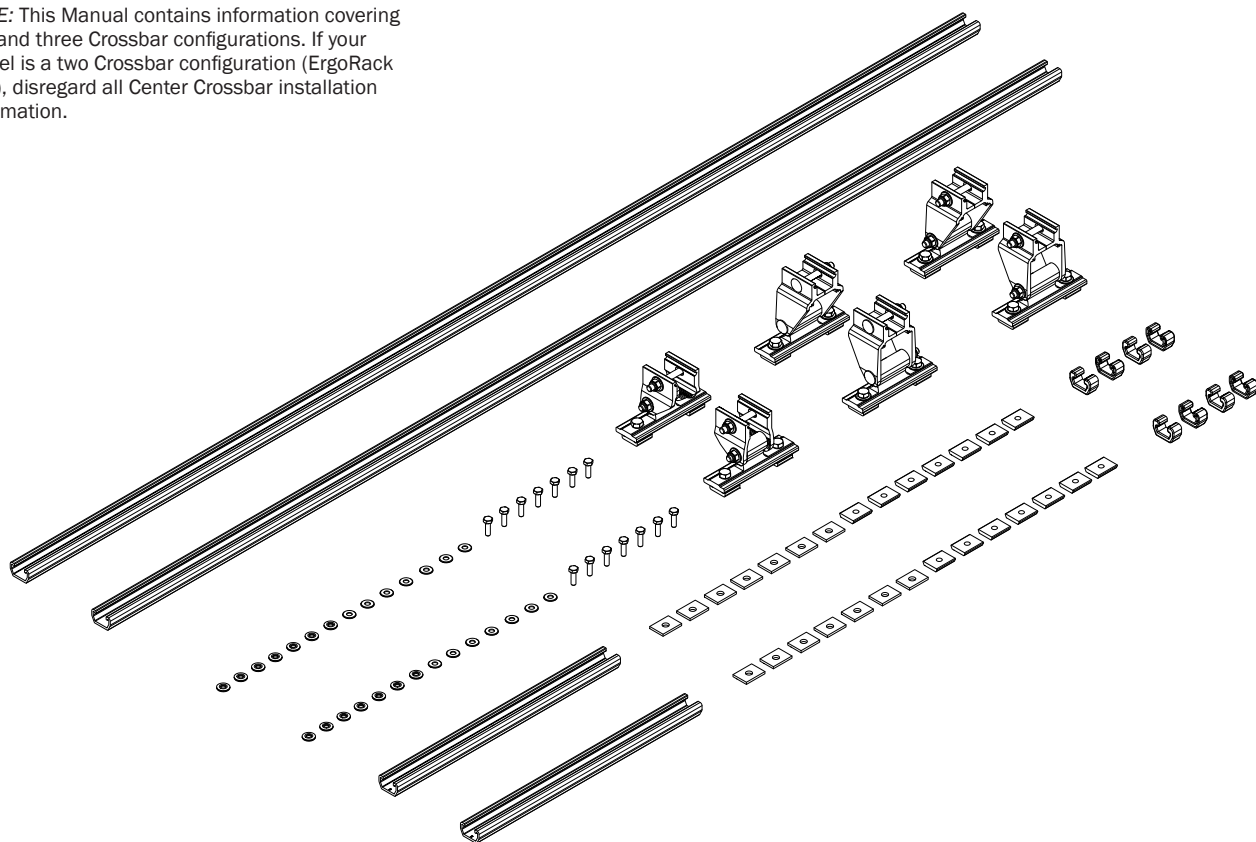

1—FBM-1015..... (Qty 1)

Channels, with Hardware Kit



Channels, 15.00" (2X)



Channels, 64.00" (2X)

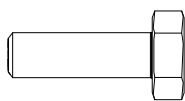

M6 x 20MM Bolt (14X)



End Caps (8X)



Mid Mounting Brackets (2X)



Mounting Brackets (4X)

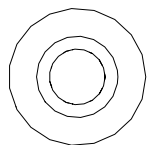

1/4" Sealing Washer (14X)

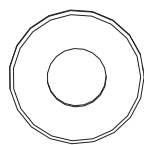

1/4" Flat Washer (14X)

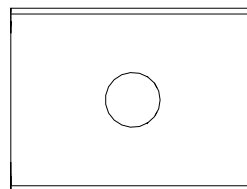

Connector Plate (14X)

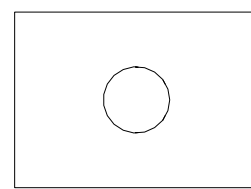

Foam Pad (14X)



Anti-Seize (1X)

2—Crossbars (shown for illustrative purposes only)
Ordered separately

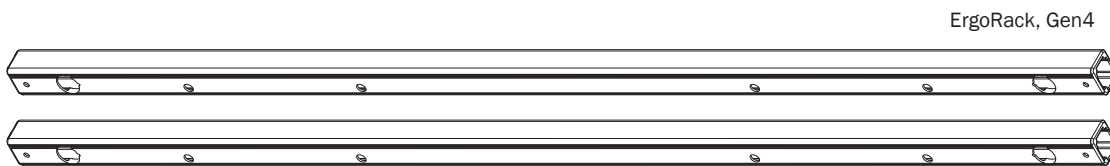

ErgoRack, Gen4

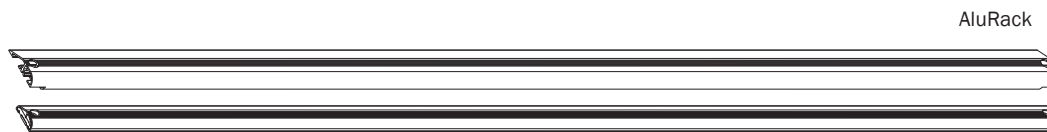

AluRack

LOW ROOF MEDIUM WHEEL BASE (126.00") FBM ASSEMBLY SEQUENCE

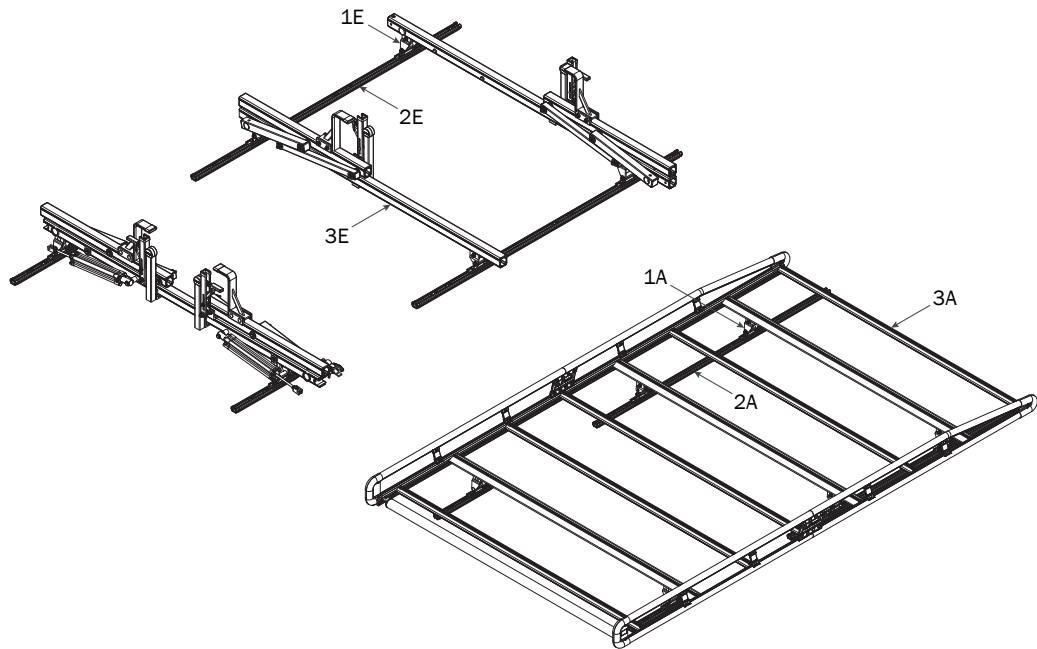

NOTE: Base, Rotation, Crossbar, and Side Rail features are shown for illustrative purposes only. These features are not included with this Base Mounting Kit, and must be purchased separately.

MOUNTING BRACKETS

- 1 Loosen the bolts on the Channel Mounting Brackets. If installing the optional Center Crossbar, loosen the bolts on the two Mid Mounting Brackets (MPK-0038).

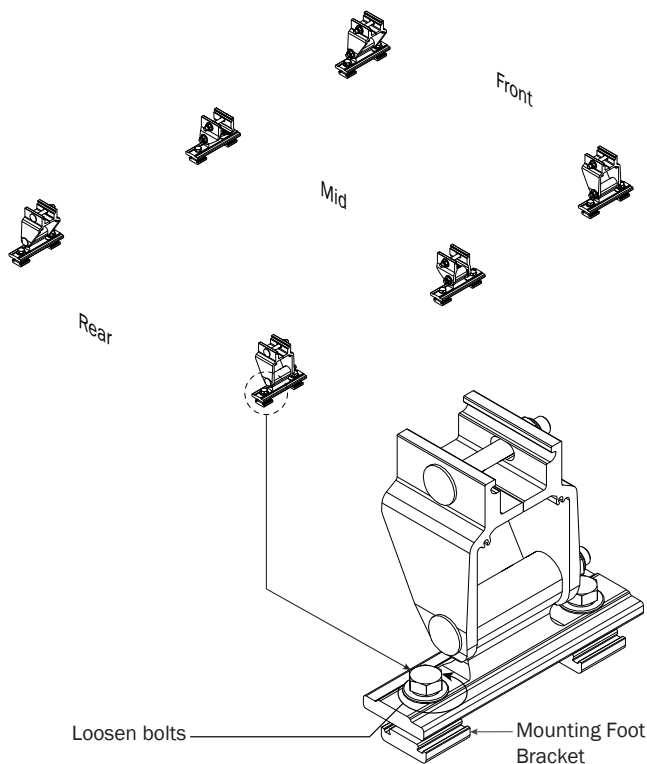

CHANNELS

- 2.1 Install the Connector Plates, Foam Pads, Mounting Brackets, and End Caps in the sequences shown below.

NOTE: If installing the ErgoRack 2 Crossbar model, see Page 12 AFTER installing all Mounting Brackets.

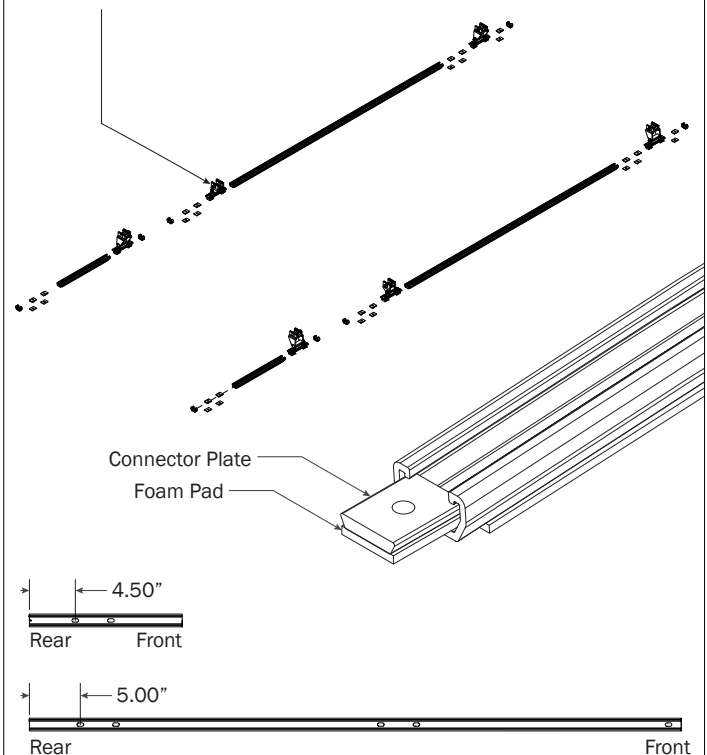

2.3

Align the channel with the hole pattern on the roof. Install the fasteners through the factory roof holes as shown then torque to 60 in-lbs.

Recommended: install the fasteners in the Front of the channels first and work your way to the back.

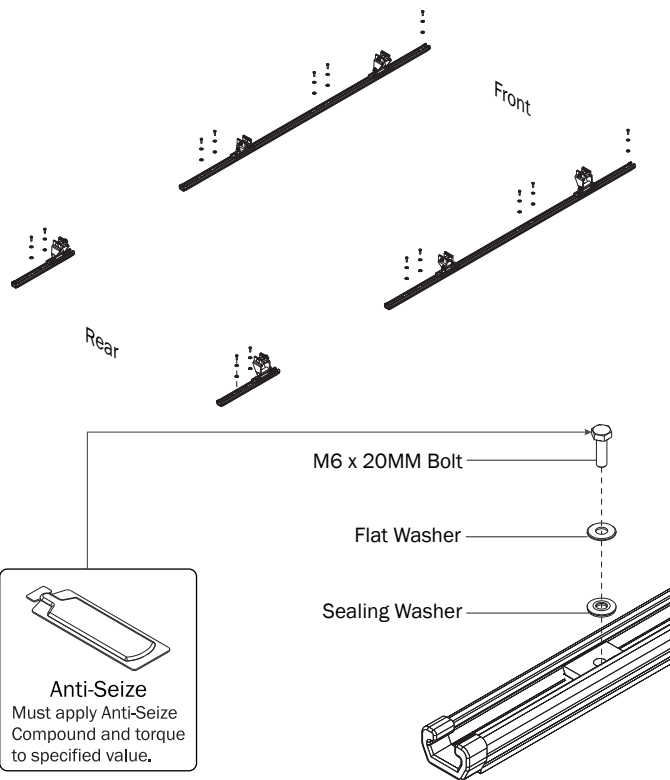

2.4

Set to distances shown below:
Use Dimensions A for 2 Crossbar models.
Use Dimensions B for 3 Crossbar models.

Do not torque the Crossbar Mounting Brackets until Step 3.4. Finger-tighten them into designated dimension to hold them in place, then proceed to your Feature (FEA) Assembly Manual.

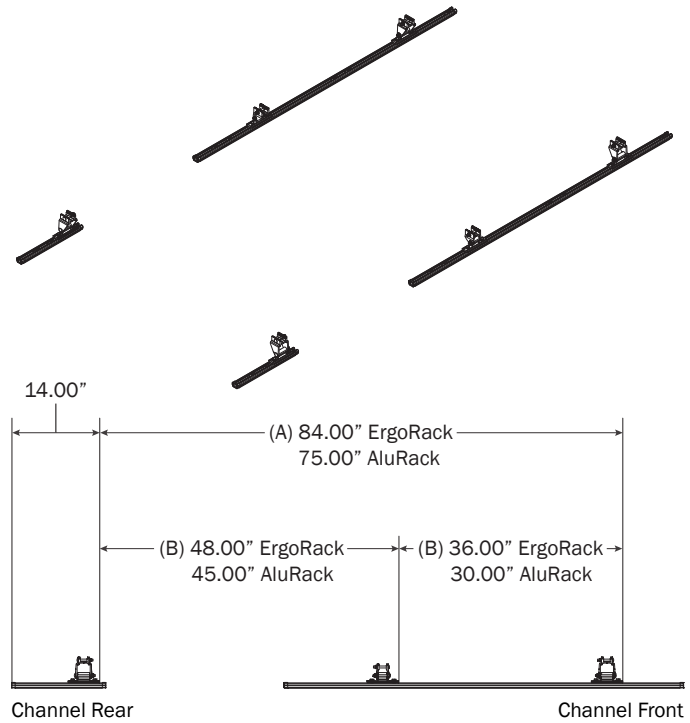

Do not mount the Crossbars to this FBM system at this time.

Refer to the respective FEA or AR Assembly Manual(s) included with your chosen rack configuration features. Depending upon the features chosen, you may need to perform a complete feature assembly onto the Crossbars or Side Rails as noted in that feature's Assembly Manual.

WARNING: Failure to position the Crossbars as shown in this FBM Assembly Manual may result in damage to the sliding door and/or ladder rack.

NOTE: Crossbars, Side Rails, Base, Clamp Down, or Rotation features are not included in this FBM kit, and must be purchased separately. To purchase applicable features and accessories, please contact your authorized distributor, or a Prime Design Sales & Service Representative.

CROSSBARS

Shown with LH/RH Rotation for illustrative purposes only

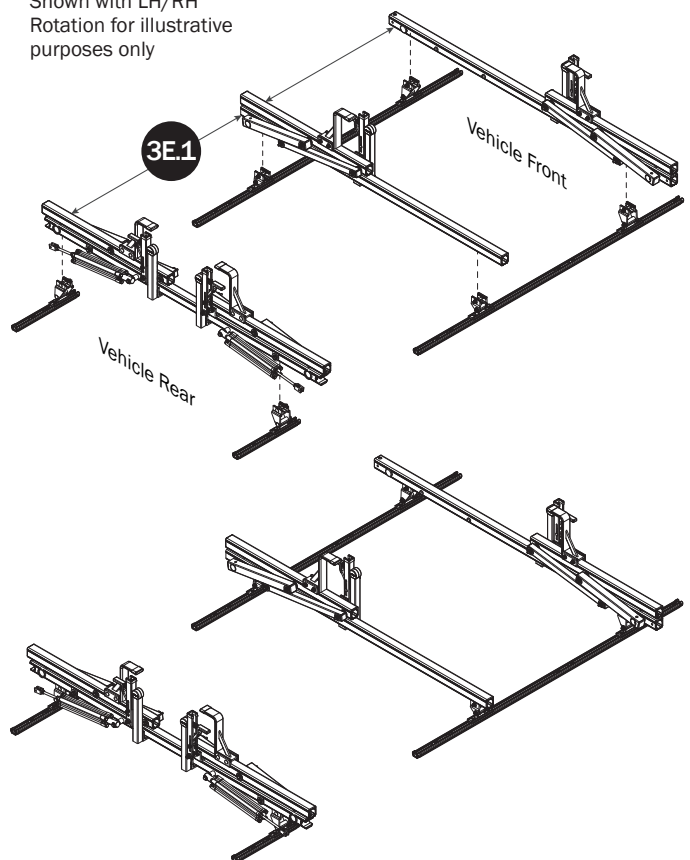

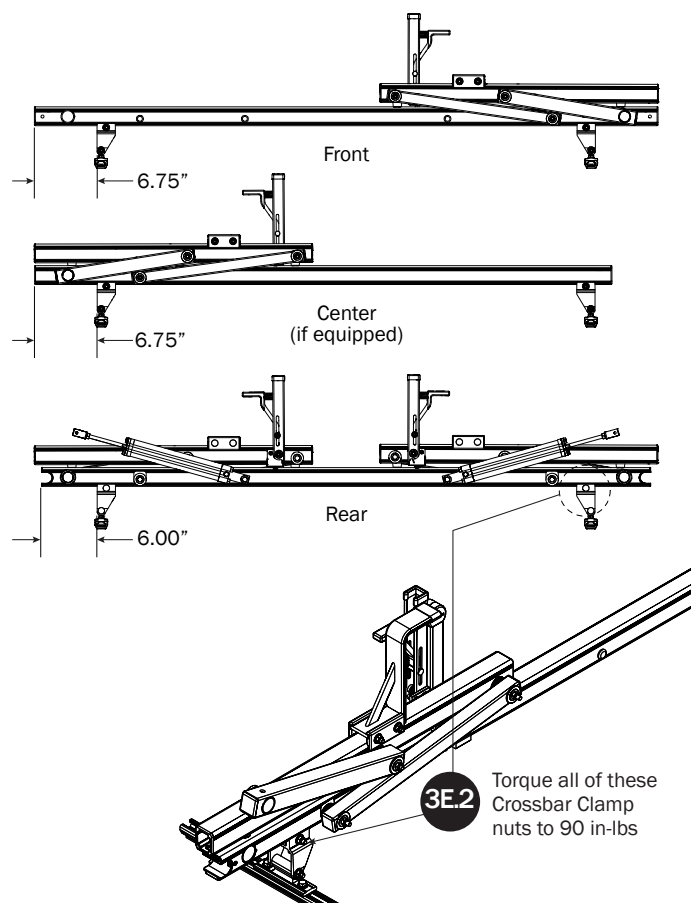
CROSSBAR ADJUSTMENT**3E.3**

Verify the specified distance from the ends of both Rear Crossbar Mounting Brackets to the ends of both Channels.

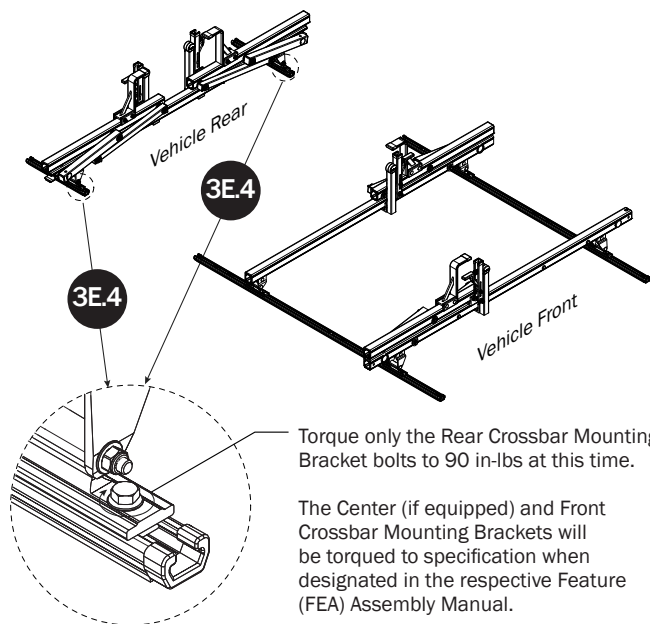
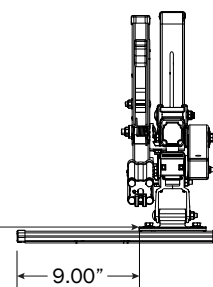

CROSSBARS (ALURACK)

Shown with L2 AluRack
for illustrative purposes only

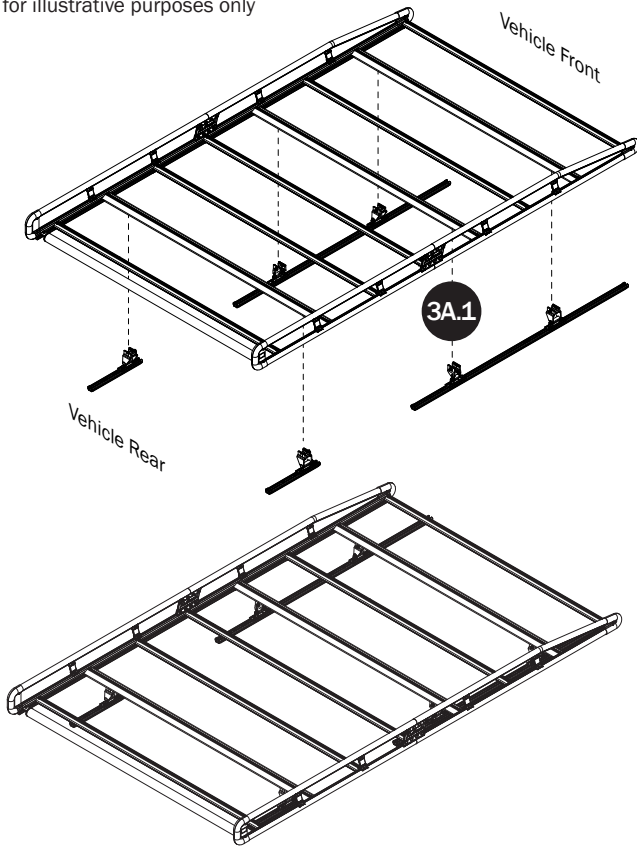

CROSSBAR ADJUSTMENT

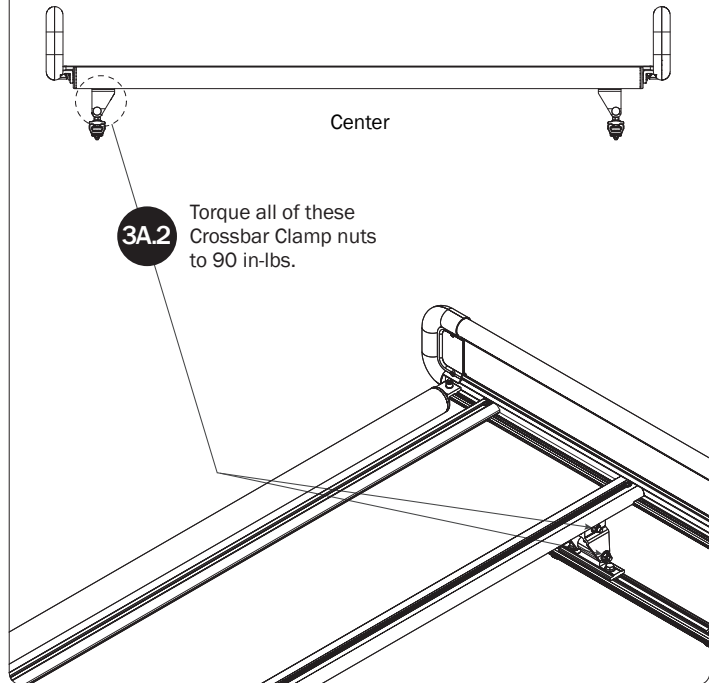

3A.3

Verify the specified
distance from the
ends of both Mounting
Bracket to the ends of
both Channels.

14.00"

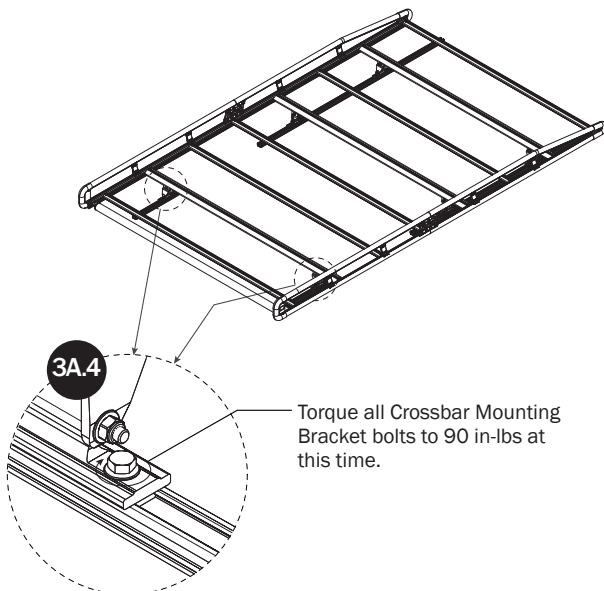

LOW ROOF LONG WHEEL BASE (135.00") FBM ASSEMBLY SEQUENCE

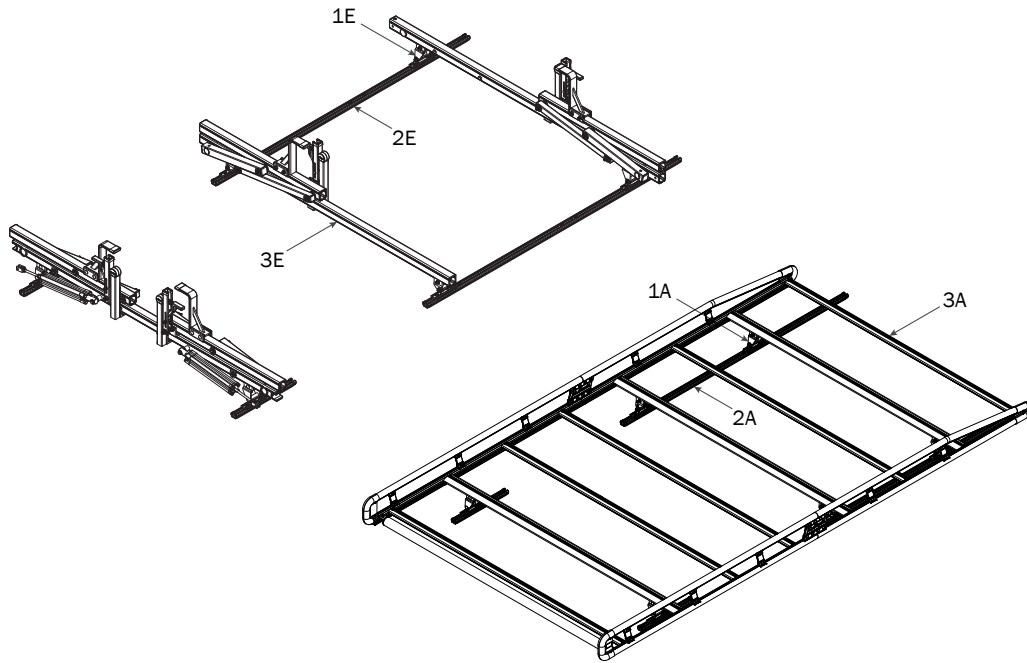

NOTE: Base, Rotation, Crossbar, and Side Rail features are shown for illustrative purposes only. These features are not included with this Base Mounting Kit, and must be purchased separately.

MOUNTING BRACKETS

- 1** Remove the hardware on all Channel Mounting Brackets.

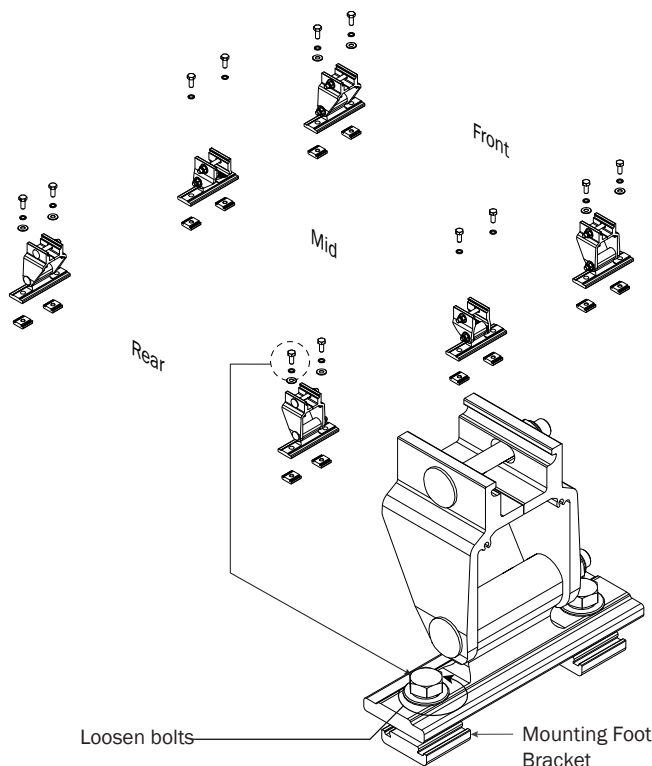

CHANNELS

- 2.1** Install the Connector Plates, Foam Pads, Mounting Foot Brackets, and End Caps in the sequences shown below.

NOTE: If installing the ErgoRack 2 Crossbar model, see Page 12 AFTER installing all Mounting Foot Brackets.

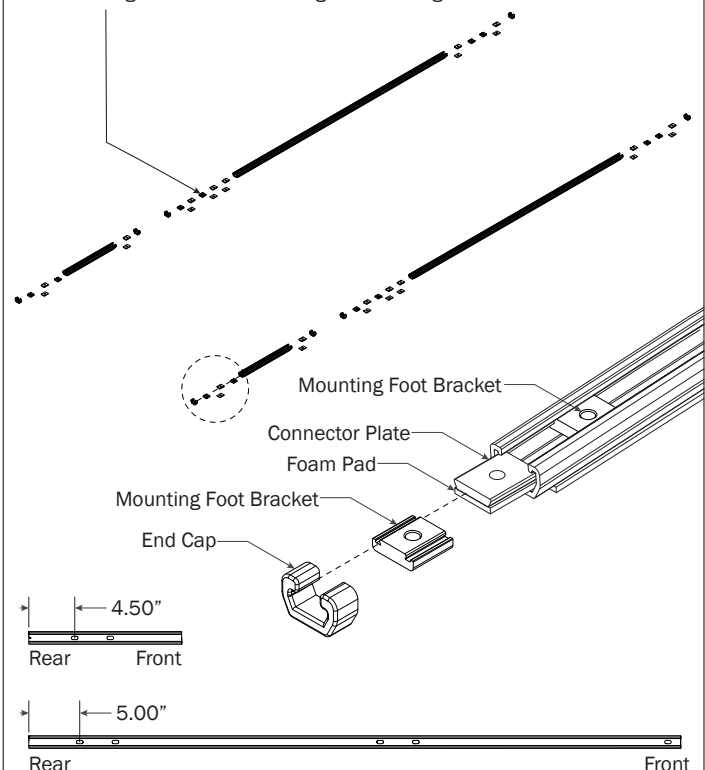

2.2

Align the channel with the hole pattern on the roof. Install the fasteners through the factory roof holes as shown then torque to 60 in-lbs.

Recommended: install the fasteners in the Front of the channels first and work your way to the back.

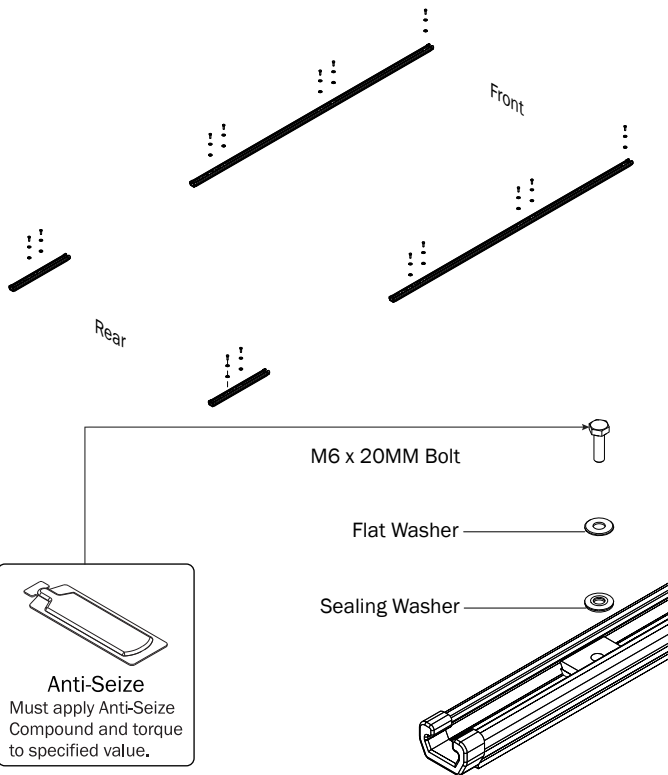

2.3

Install the Connector Plates, Foam Pads, Mounting Foot Brackets, and End Caps in the sequences shown below.

NOTE: If installing the optional Center Crossbar, insert the two Mid Mounting Foot Brackets into each Front Channel.

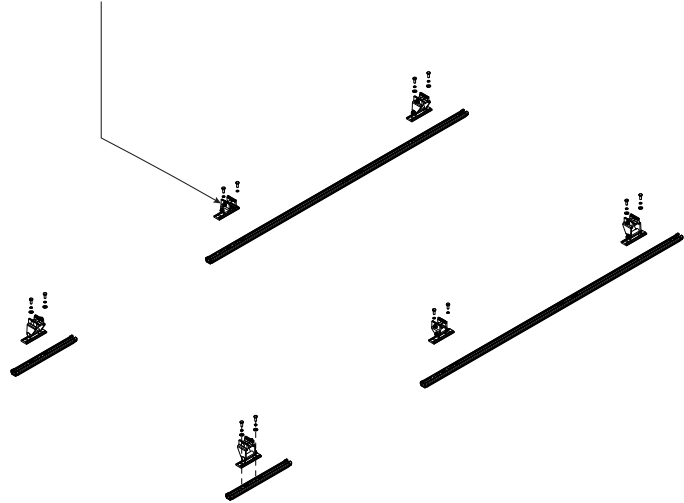

2.4

Set to distances shown below:
Use Dimensions A for 2 Crossbar models.
Use Dimensions B for 3 Crossbar models.

Do not torque the Crossbar Mounting Brackets until Step 3.4. Finger-tighten them into designated dimension to hold them in place, then proceed to your Feature (FEA) Assembly Manual.

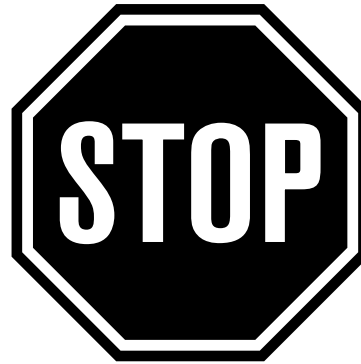
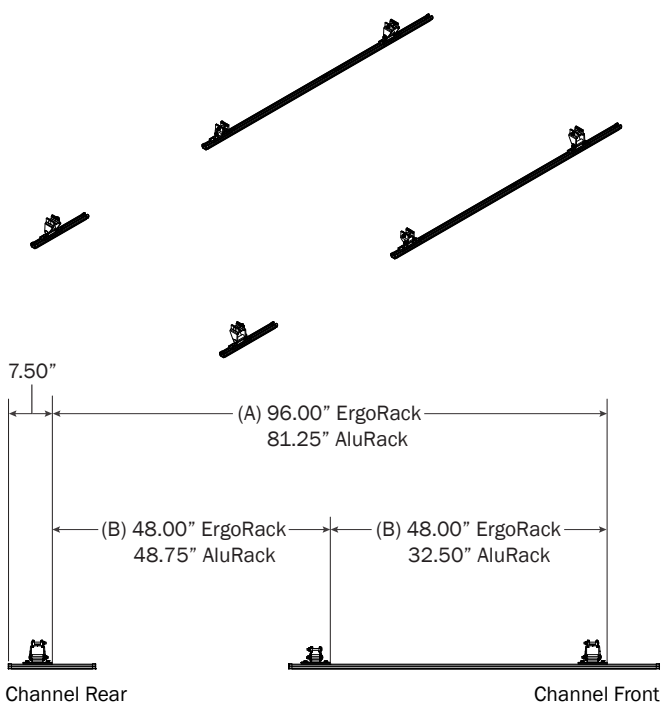

Do not mount the Crossbars to this FBM system at this time.

Refer to the respective FEA or AR Assembly Manual(s) included with your chosen rack configuration features. Depending upon the features chosen, you may need to perform a complete feature assembly onto the Crossbars or Side Rails as noted in that feature's Assembly Manual.

WARNING: Failure to position the Crossbars as shown in this FBM Assembly Manual may result in damage to the sliding door and/or ladder rack.

NOTE: Crossbars, Side Rails, Base, Clamp Down, or Rotation features are not included in this FBM kit, and must be purchased separately. To purchase applicable features and accessories, please contact your authorized distributor, or a Prime Design Sales & Service Representative.

CROSSBARS

Shown with LH/RH
Rotation for illustrative
purposes only

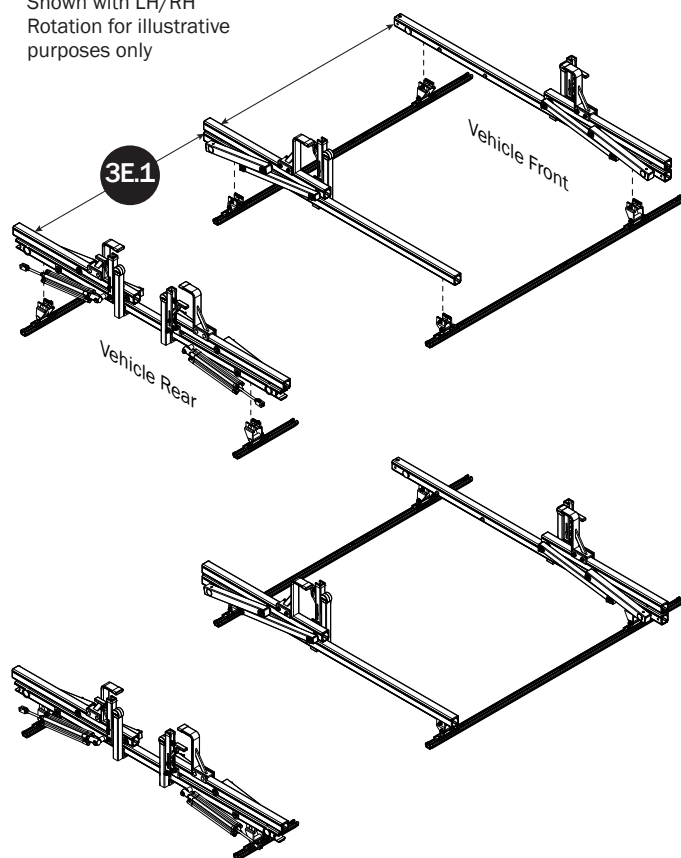
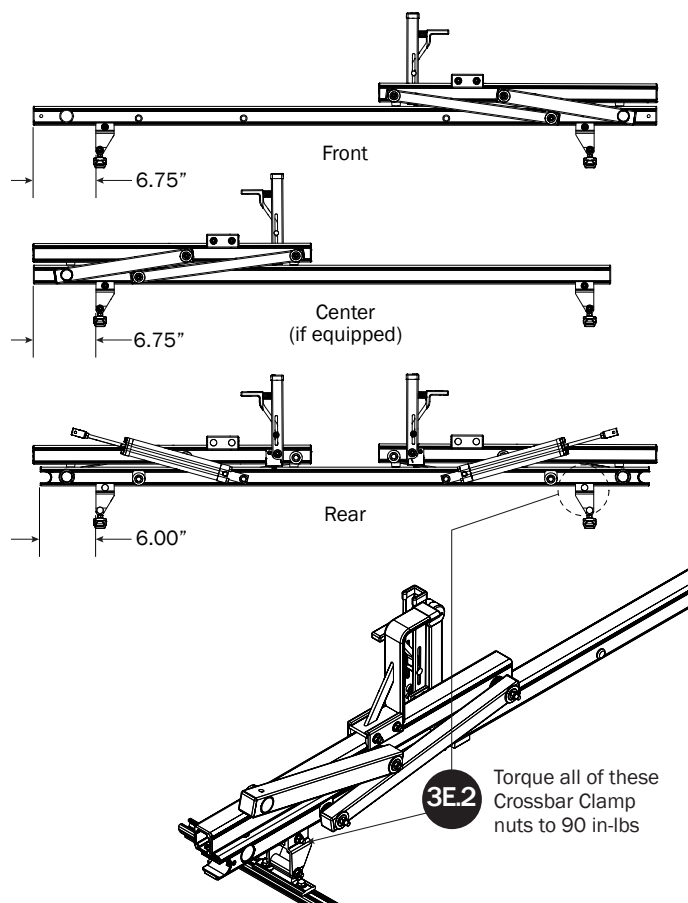
**CROSSBAR ADJUSTMENT****3E.3**

Verify the specified
distance from the
ends of both Rear
Crossbar Mounting
Brackets to the ends
of both Channels.

2.50"

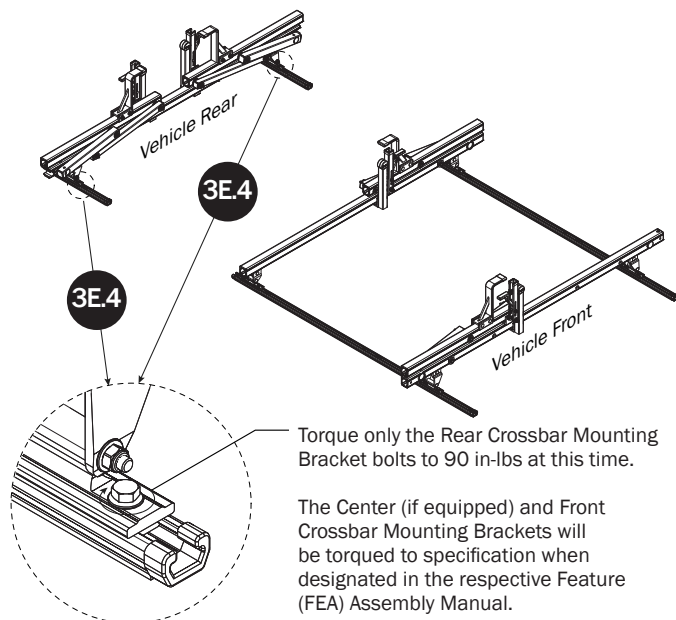

CROSSBARS (ALURACK)

Shown with L3 AluRack
for illustrative purposes only

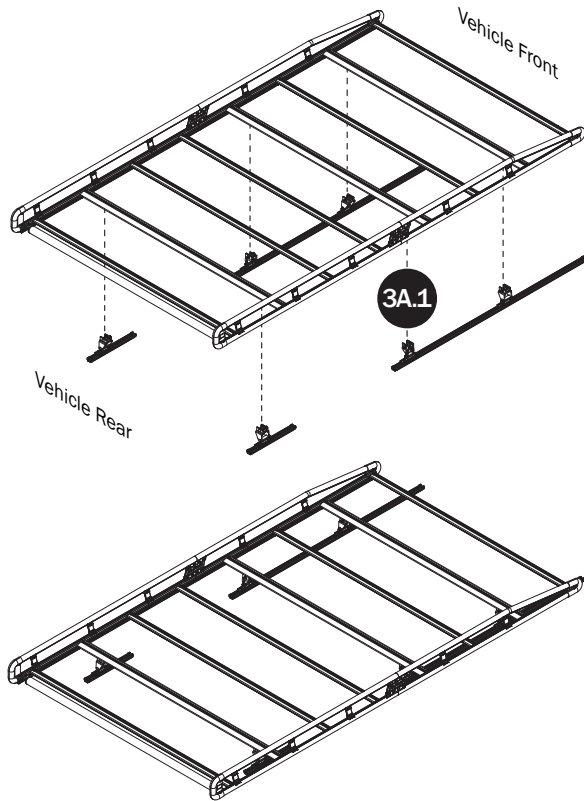

CROSSBAR ADJUSTMENT

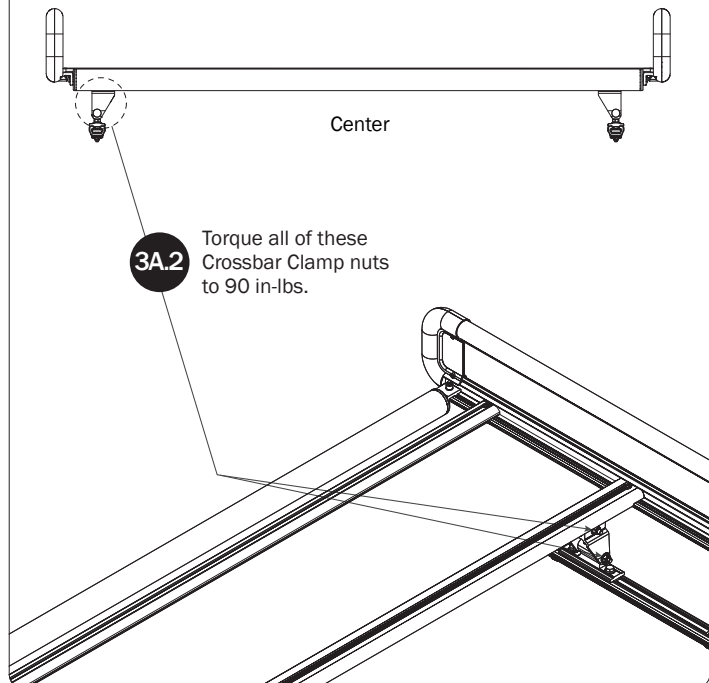

Torque all of these
Crossbar Clamp nuts
to 90 in-lbs.

3A.3

Verify the specified
distance from the
ends of both Mounting
Bracket to the ends of
both Channels.

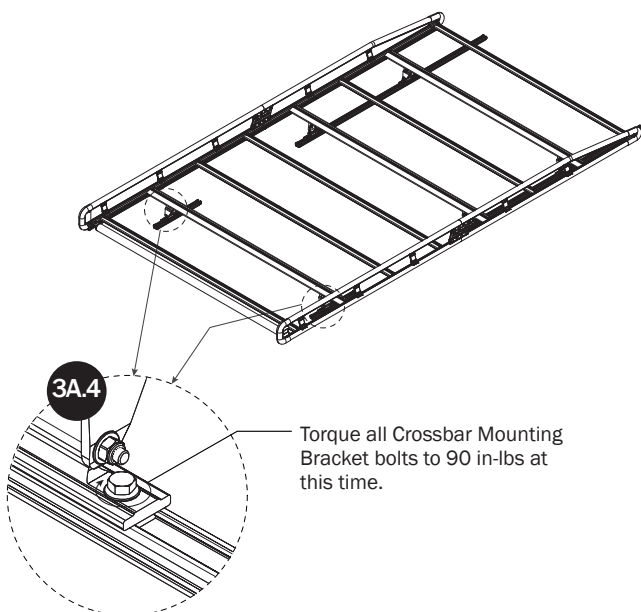
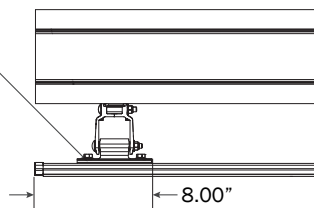

Torque all Crossbar Mounting
Bracket bolts to 90 in-lbs at
this time.

CENTER CROSSBAR MOUNTS FOR 2 CROSSBAR ERGORACK MODELS ONLY

Where applicable, remove the remaining center Crossbar Mount Hardware if desired.

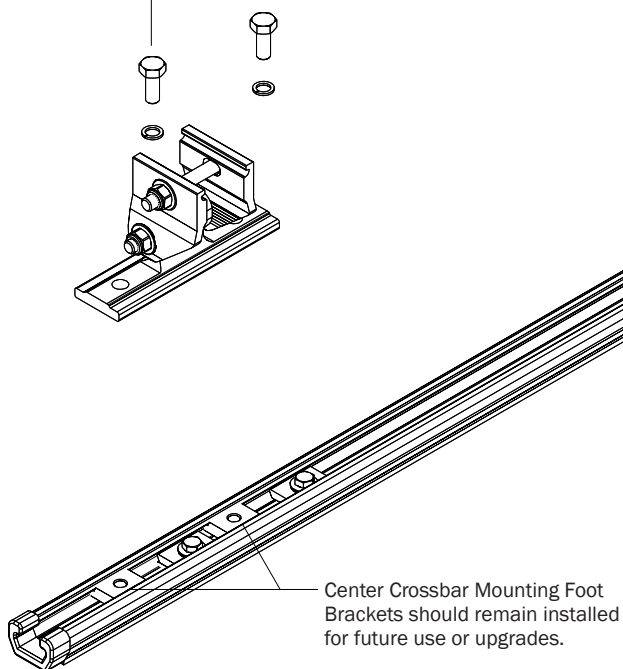

Place the center Crossbar Mounts into the vehicle's glove box for future use.

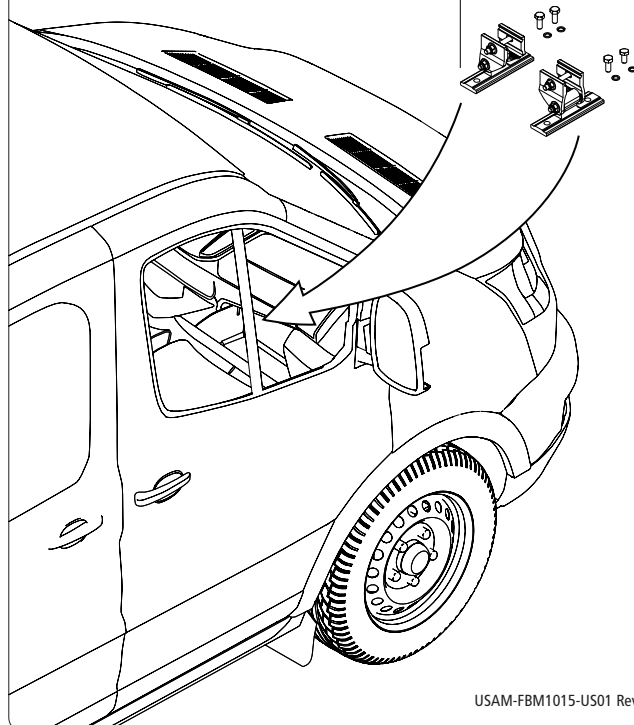

USAM-FBM1015-US01 Rev-A 0720