

# PRIME DESIGN™

A Safe Fleet Brand

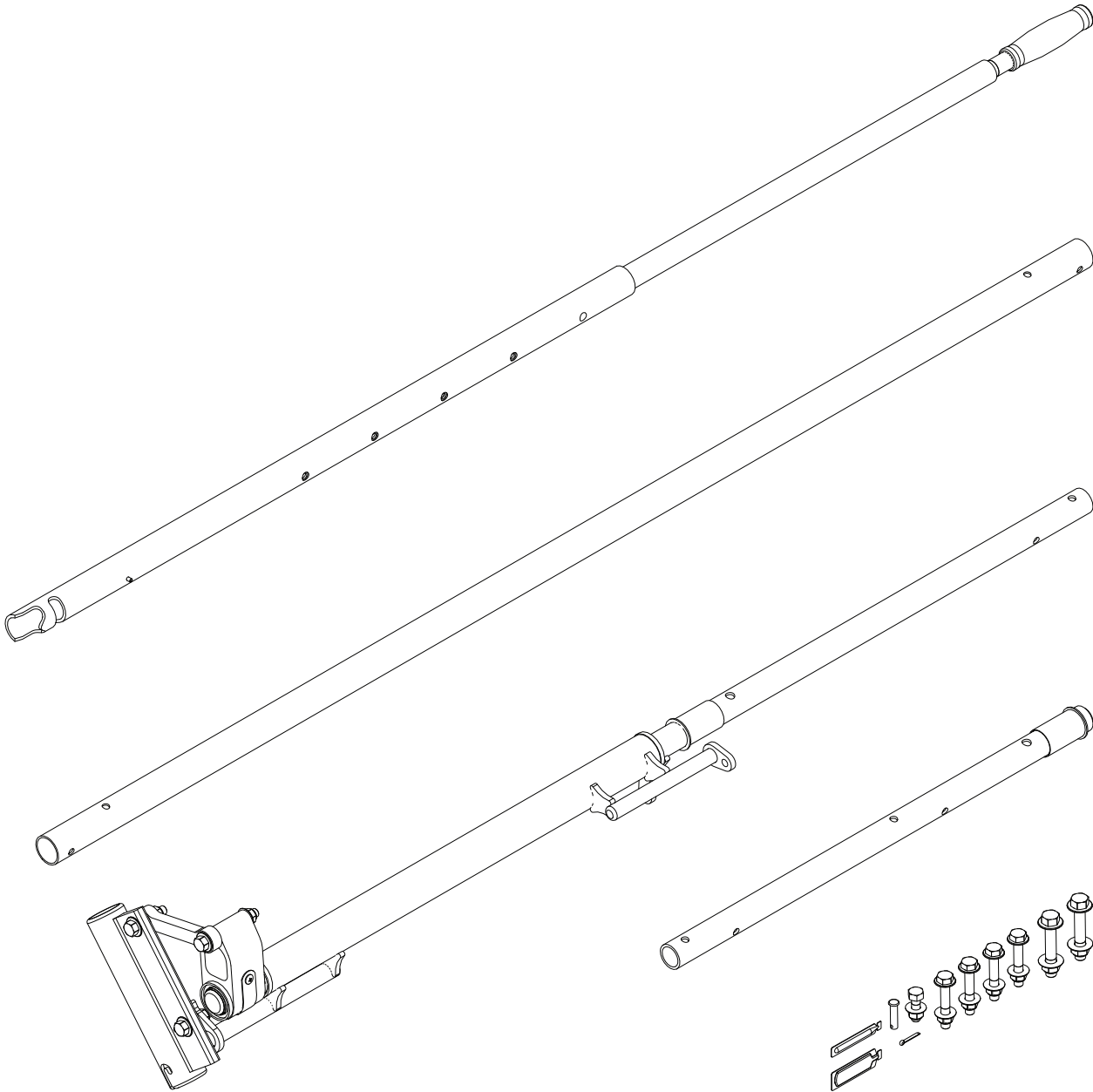

## *RIGHT SIDE DRIVE SHAFT KIT, HIGH ROOF*

PRIME DESIGN, A SAFE FLEET BRAND

Address: 580 Opperman Drive, Eagan, MN 55123 • Toll Free: 1.8.PRIME.RACK

Fax: 651-552-1799 • Email: [info@primedesign.net](mailto:info@primedesign.net) • Website: [www.primedesign.net](http://www.primedesign.net)

# FEA0019

## CONTENTS OVERVIEW

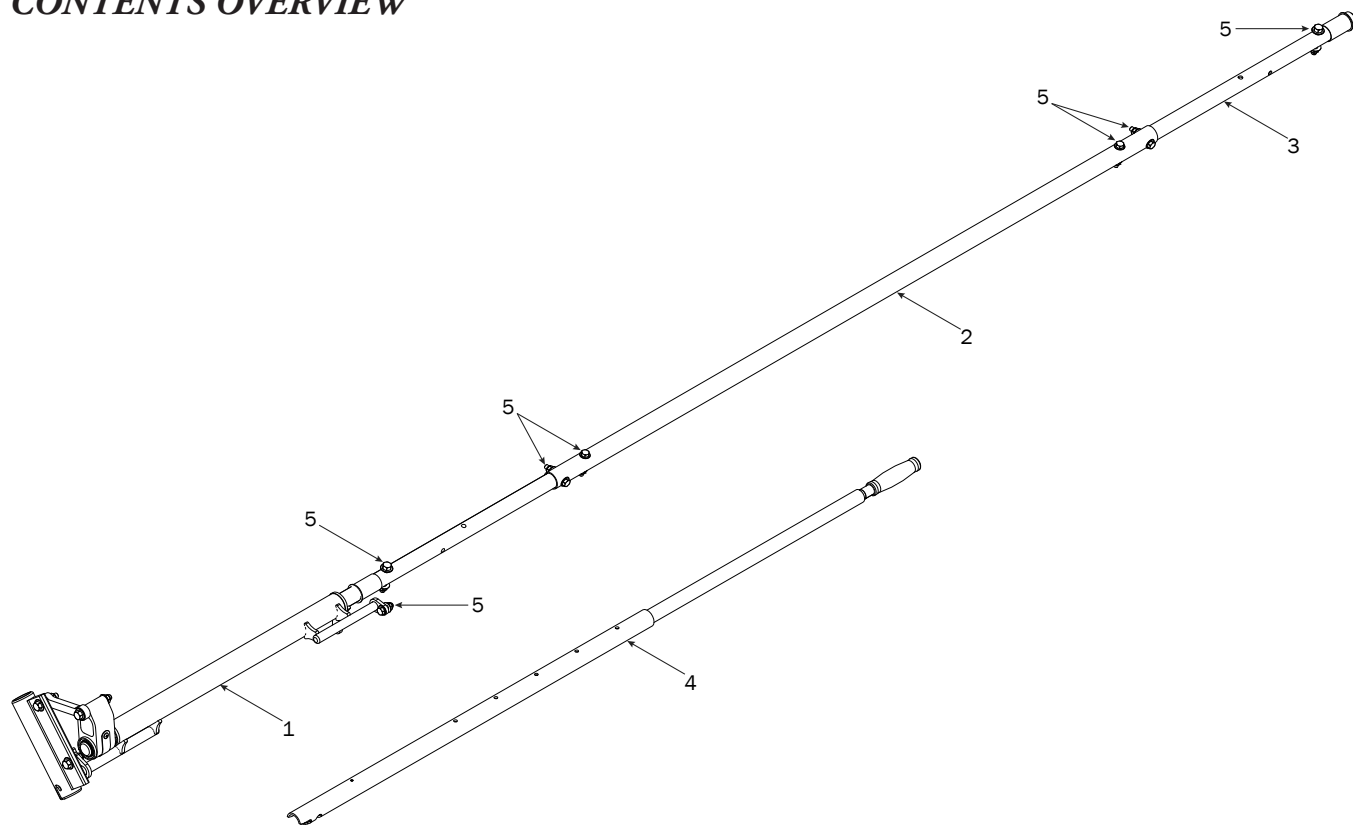

1—Drive Shaft ..... (Qty 1)  
Rear, Right Hand, 50.00"

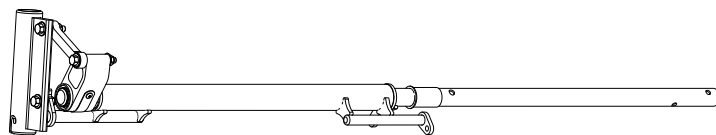

2—Connecting Bar ..... (Qty 1)  
60.00"

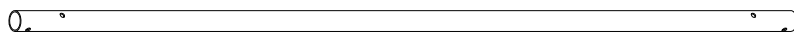

3—Front Drive Shaft ..... (Qty 1)  
B Version, 23.75"

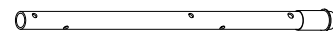

4—HRR Handle Assembly ..... (Qty 1)  
Removable, 35.00"



5—HKT-8163..... (Qty 1)  
Modular High Roof Rotation Hardware Kit

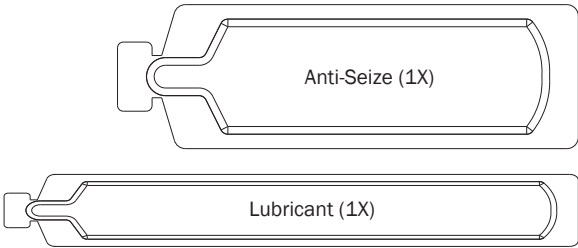
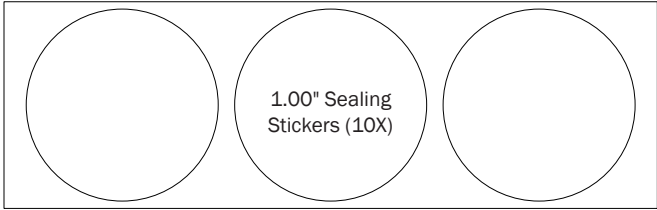
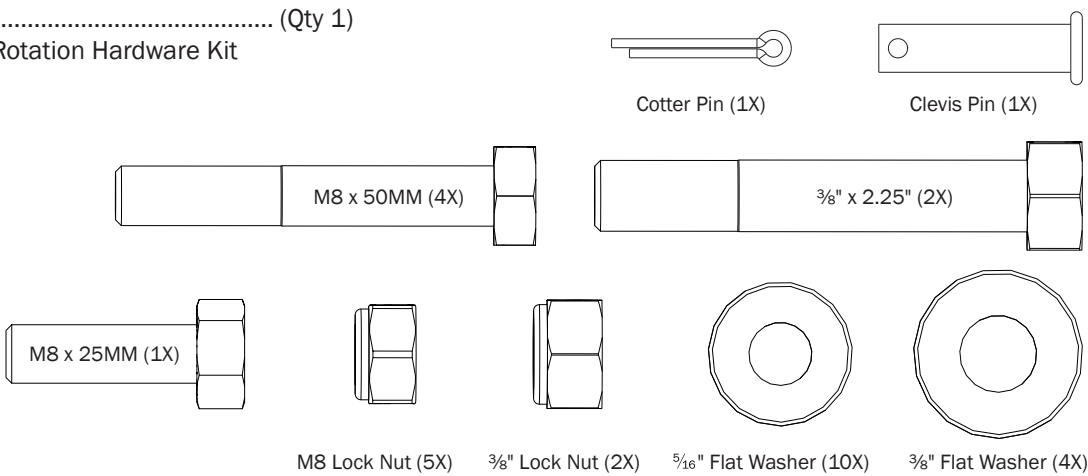

**RIGHT DRIVE SHAFT  
ASSEMBLY SEQUENCE**

**NOTE:** Crossbars and RH Rotation feature are shown for illustrative purposes only. Crossbars and Rotations are not included with this Drive Shaft feature, and must be purchased separately.

**NOTE:** Flow Control Screw faces toward vehicle rear

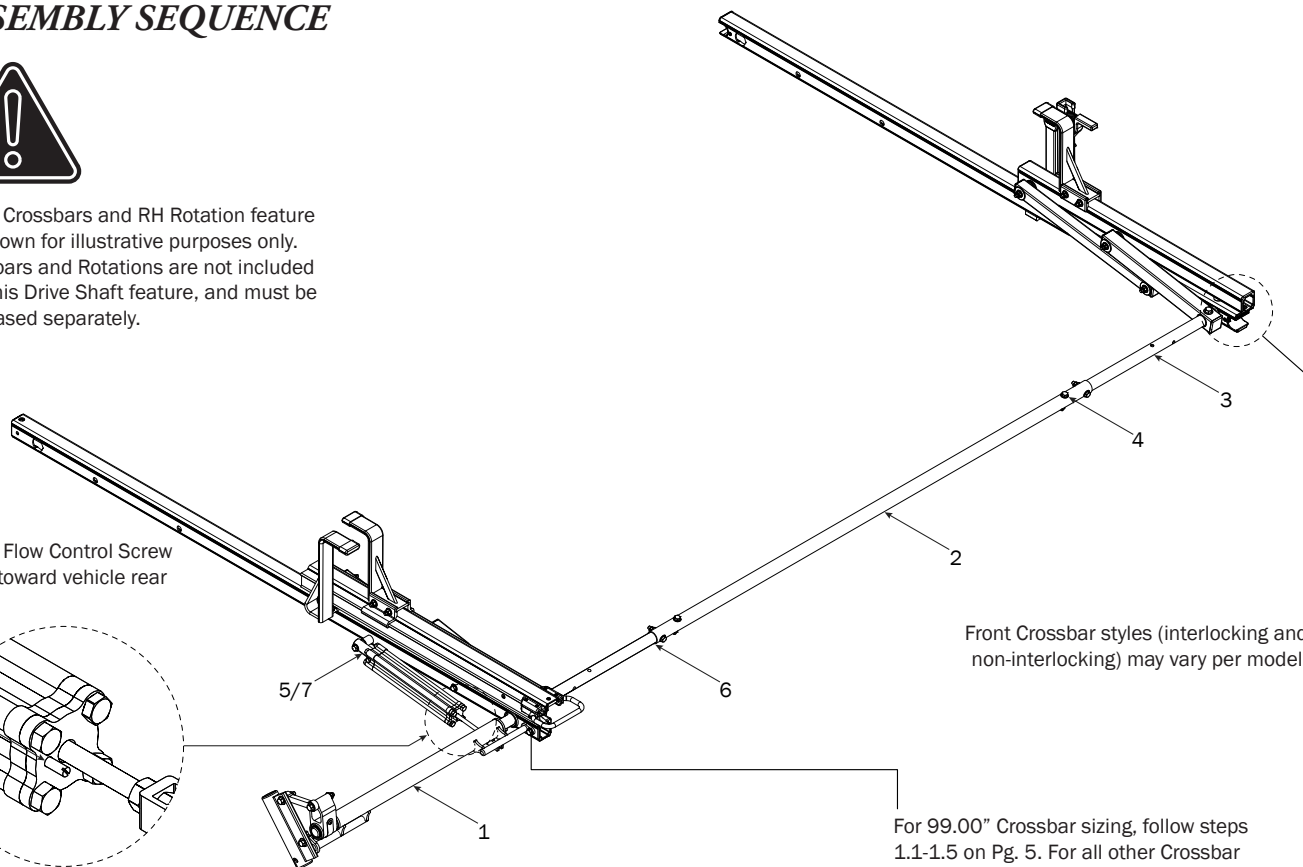
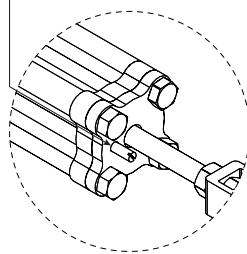

Front Crossbar styles (interlocking and non-interlocking) may vary per model.

For 99.00" Crossbar sizing, follow steps 1.1-1.5 on Pg. 5. For all other Crossbar sizes, follow Steps 1.1-1.4 on Pg. 4.

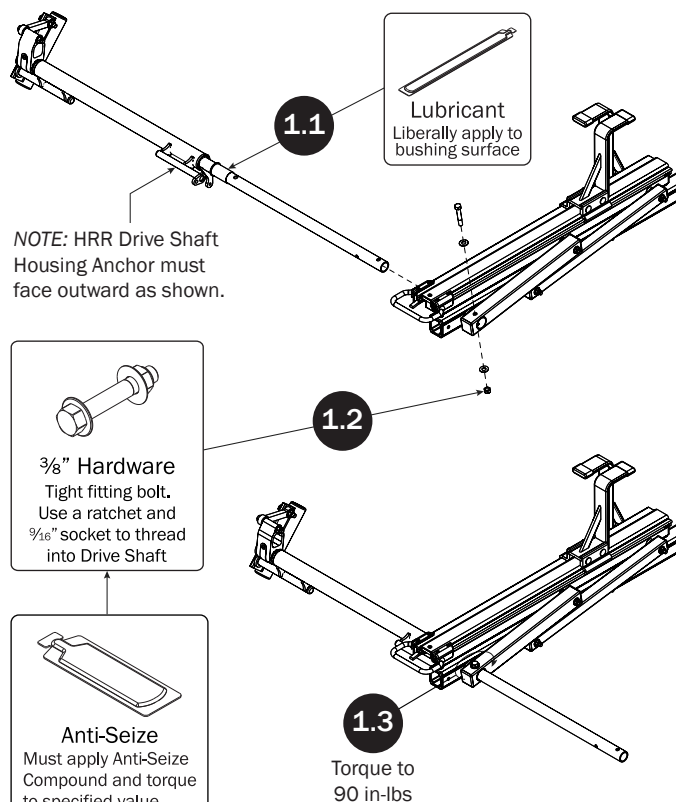
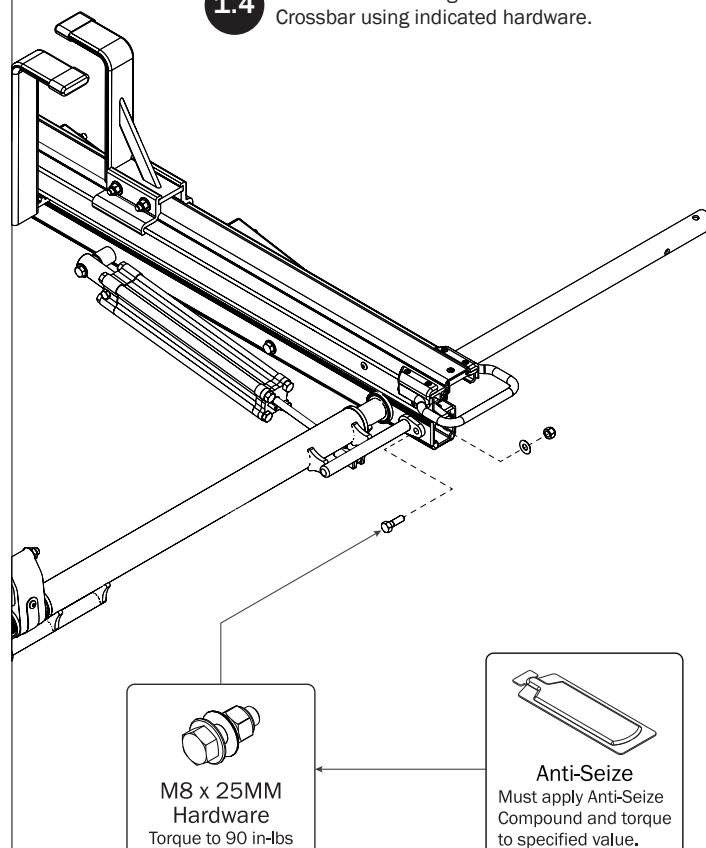
**REAR DRIVE SHAFT  
EXCEPT 99.00" CROSSBAR SIZING****1.4** Attach HHR Housing Anchor to Rear Crossbar using indicated hardware.

**REAR DRIVE SHAFT:  
99.00" CROSSBAR SIZING ONLY**

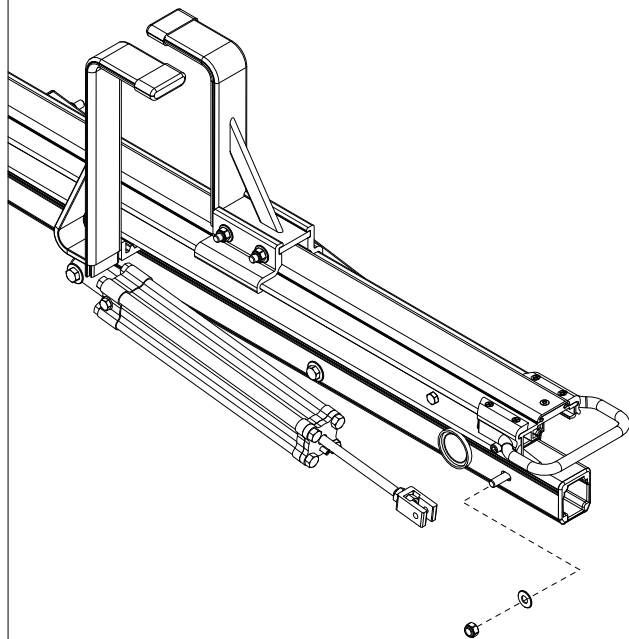

**1.1** Remove and save washer and locknut before installing Rear Driveshaft.

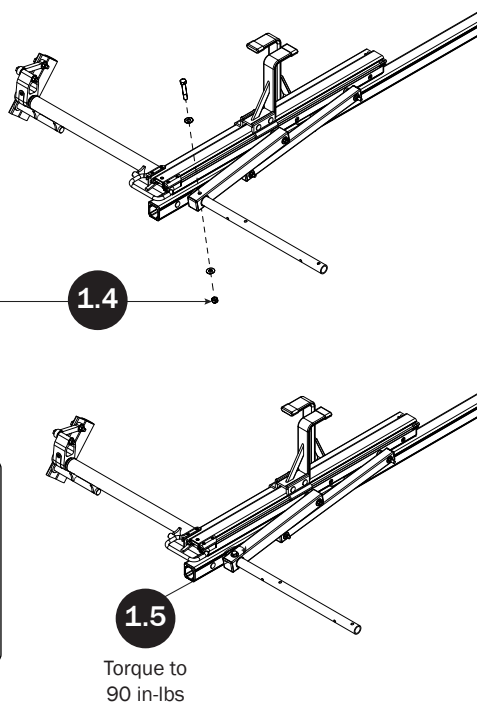
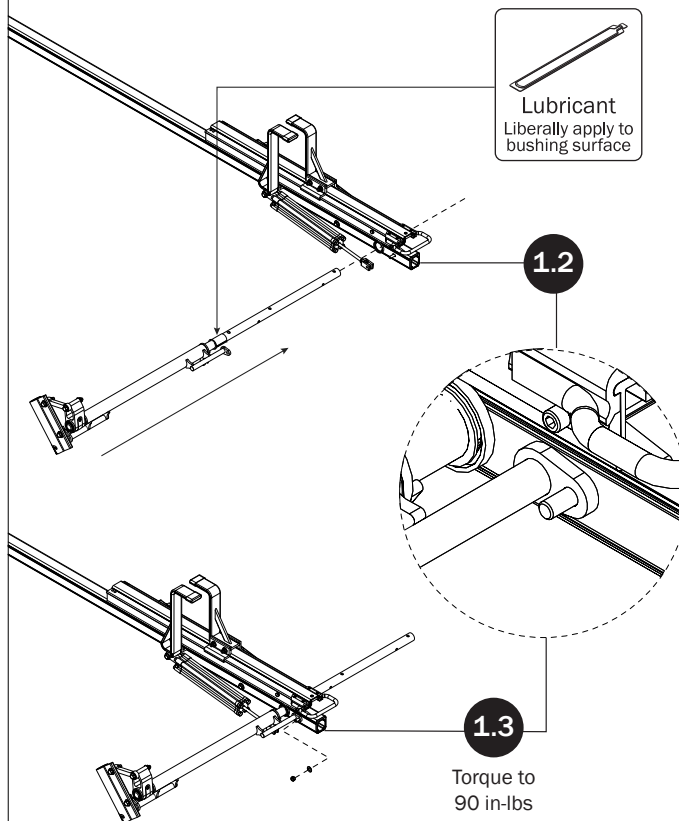

**1.5**  
Torque to 90 in-lbs

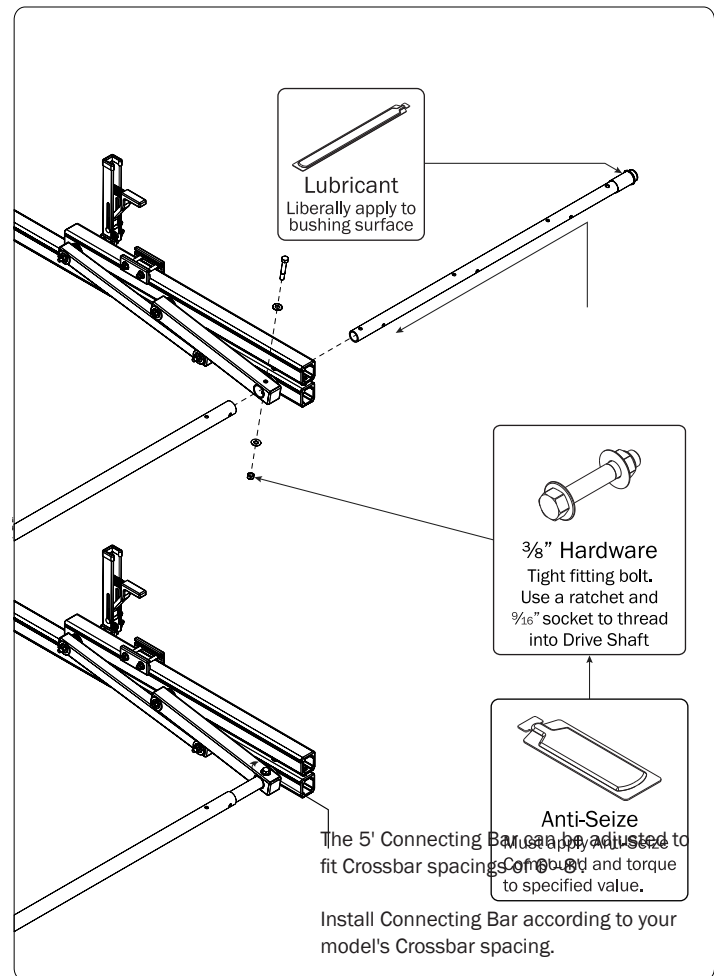
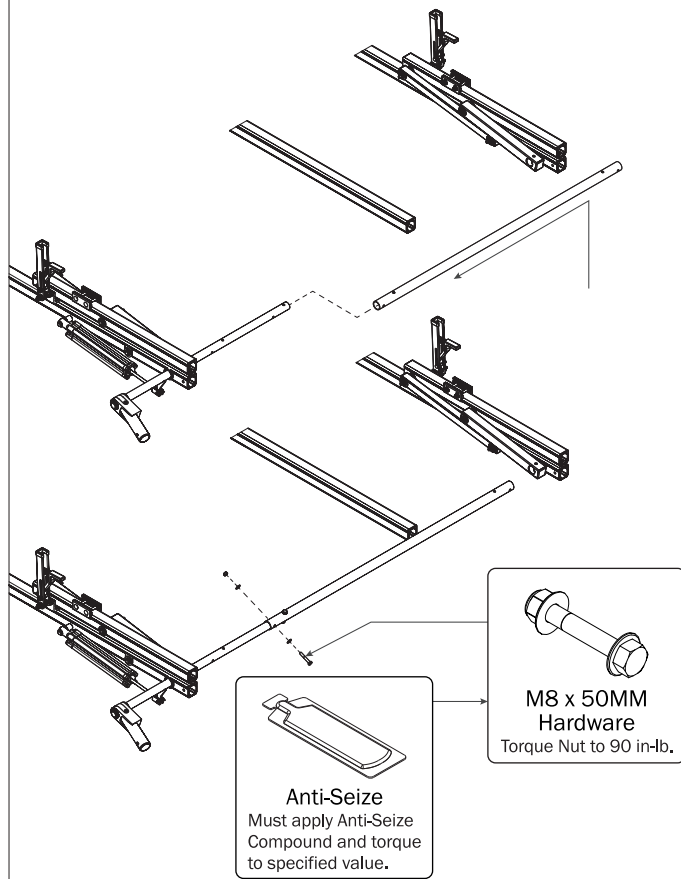
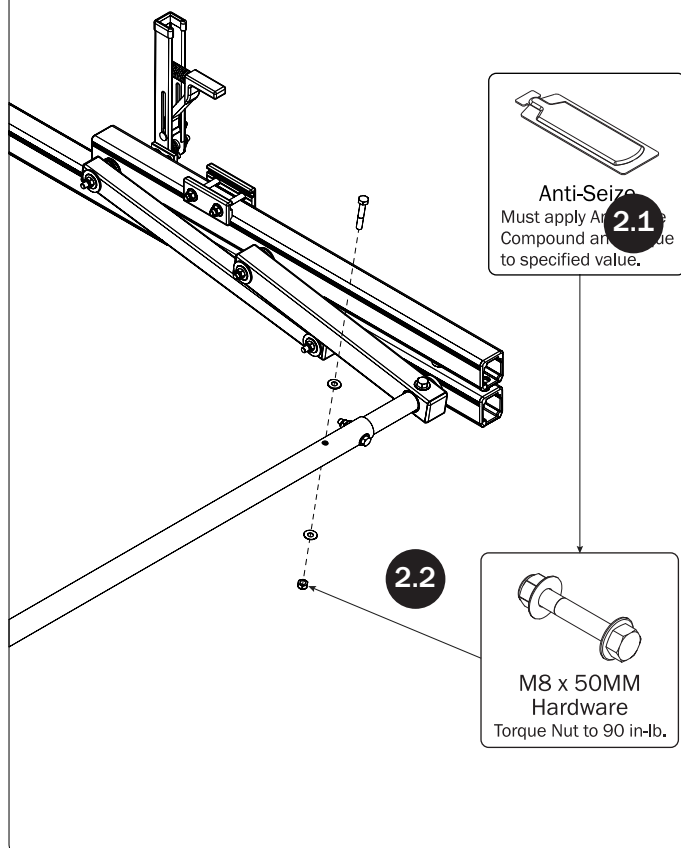
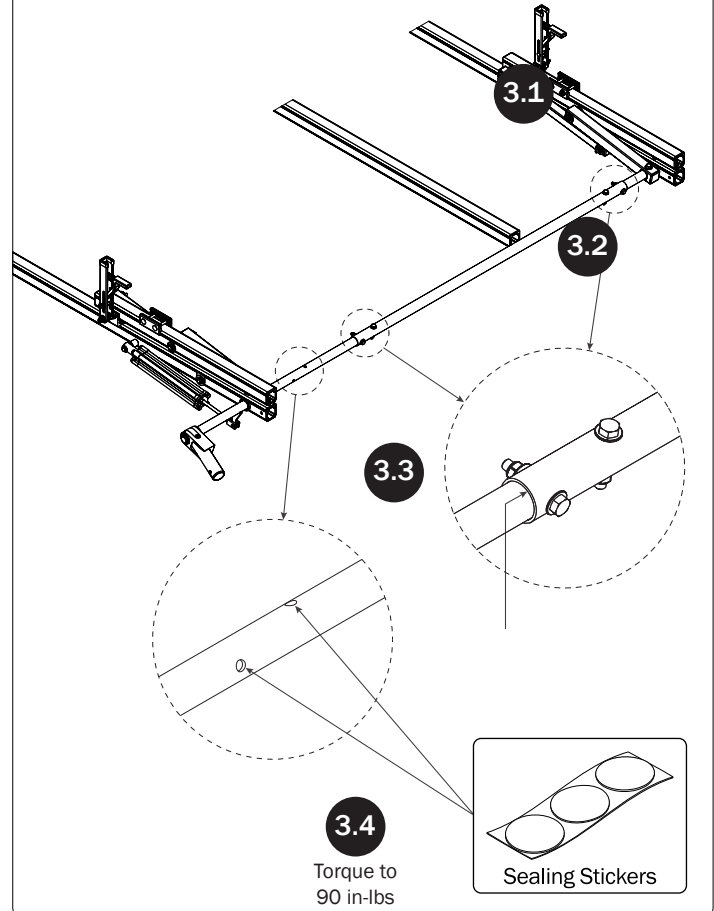
**CONNECTING BAR VARIATIONS****CONNECTING BAR****FRONT DRIVE SHAFT**

## CONNECTING BAR FASTENERS

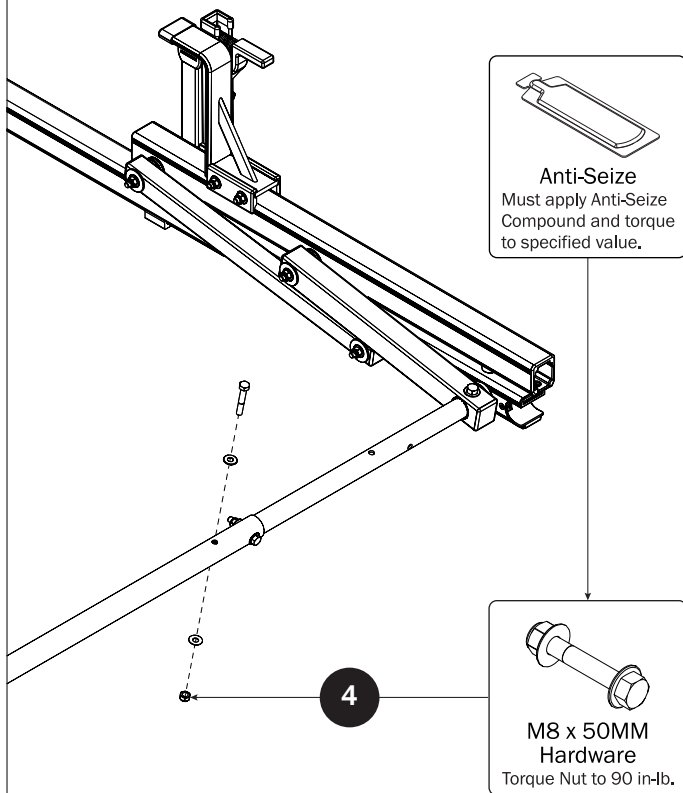

## CYLINDER HARDWARE

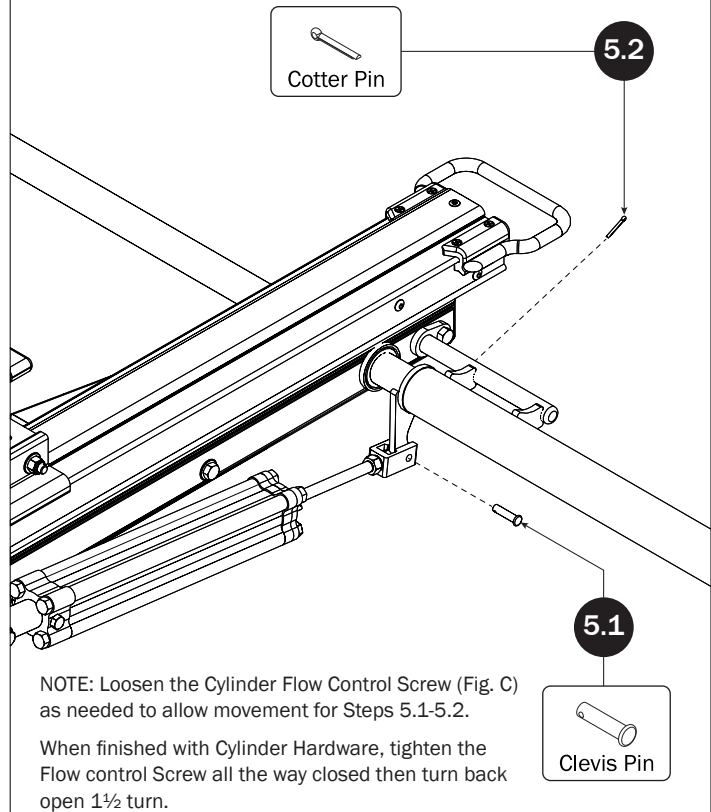

## DRIVE SHAFT SEALING

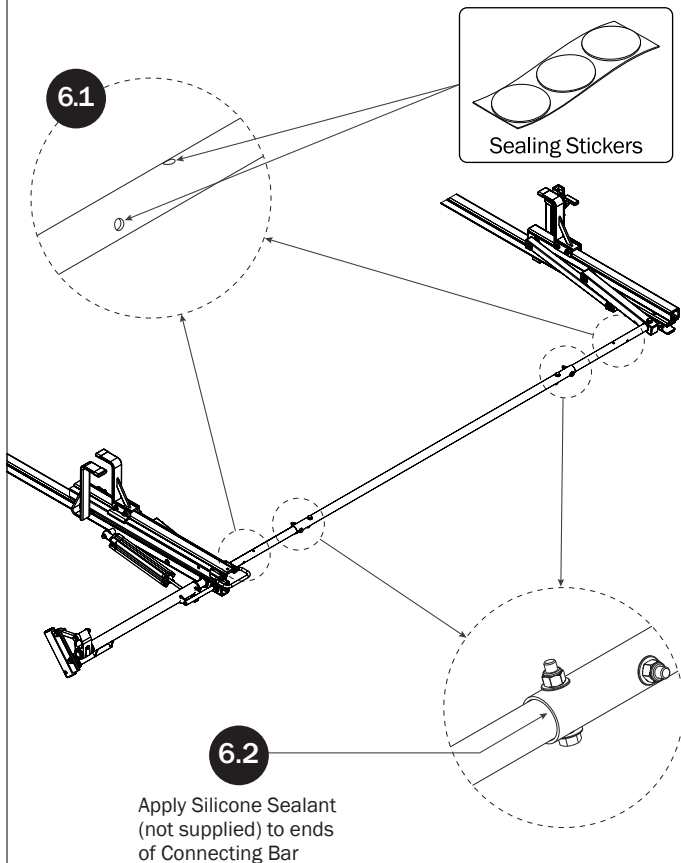

## CYLINDER ADJUSTMENT

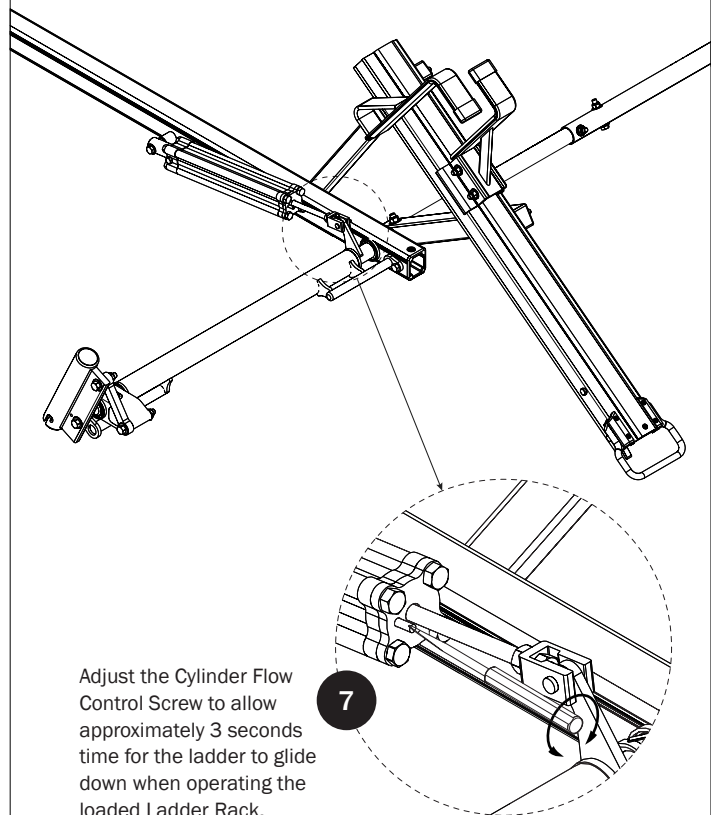

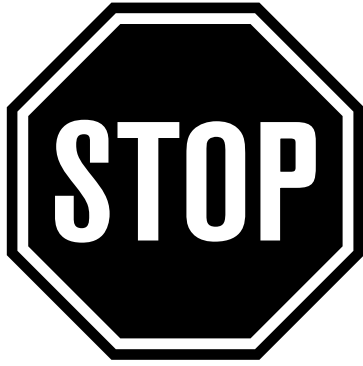

**NOTE:** This completes the right hand assembling of FEA-0019. For left side Drive Shaft assembly procedures, see FEA-0020 Assembly Manual.

If applicable, refer to your next FEA Assembly Manual.

If completed, refer back to your FBM Assembly Manual, and resume assembling at Step 3.1.

**WARNING:** Failure to position the Crossbars as shown in your FBM Assembly Manual may result in damage to the sliding door and/or ladder rack.

USAM-FEA0019-US01 Rev-B 0320