

PRIME DESIGN™

A Safe Fleet Brand

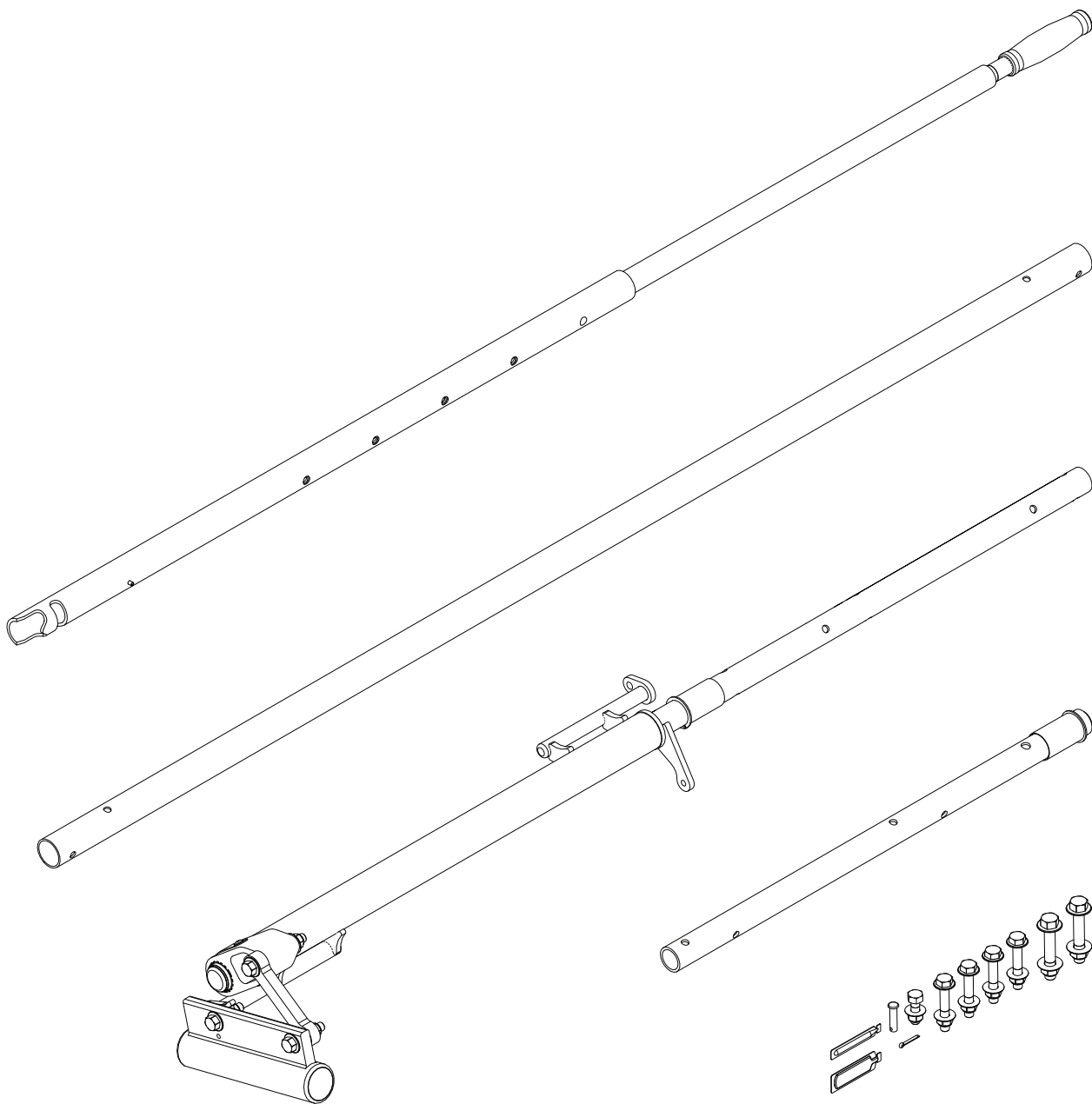

LEFT SIDE DRIVE SHAFT KIT, HIGH ROOF

PRIME DESIGN, A SAFE FLEET BRAND

Address: 580 Opperman Drive, Eagan, MN 55123 • Toll Free: 1.8.PRIME.RACK

Fax: 651-552-1799 • Email: info@primedesign.net • Website: www.primedesign.net

FEA0020

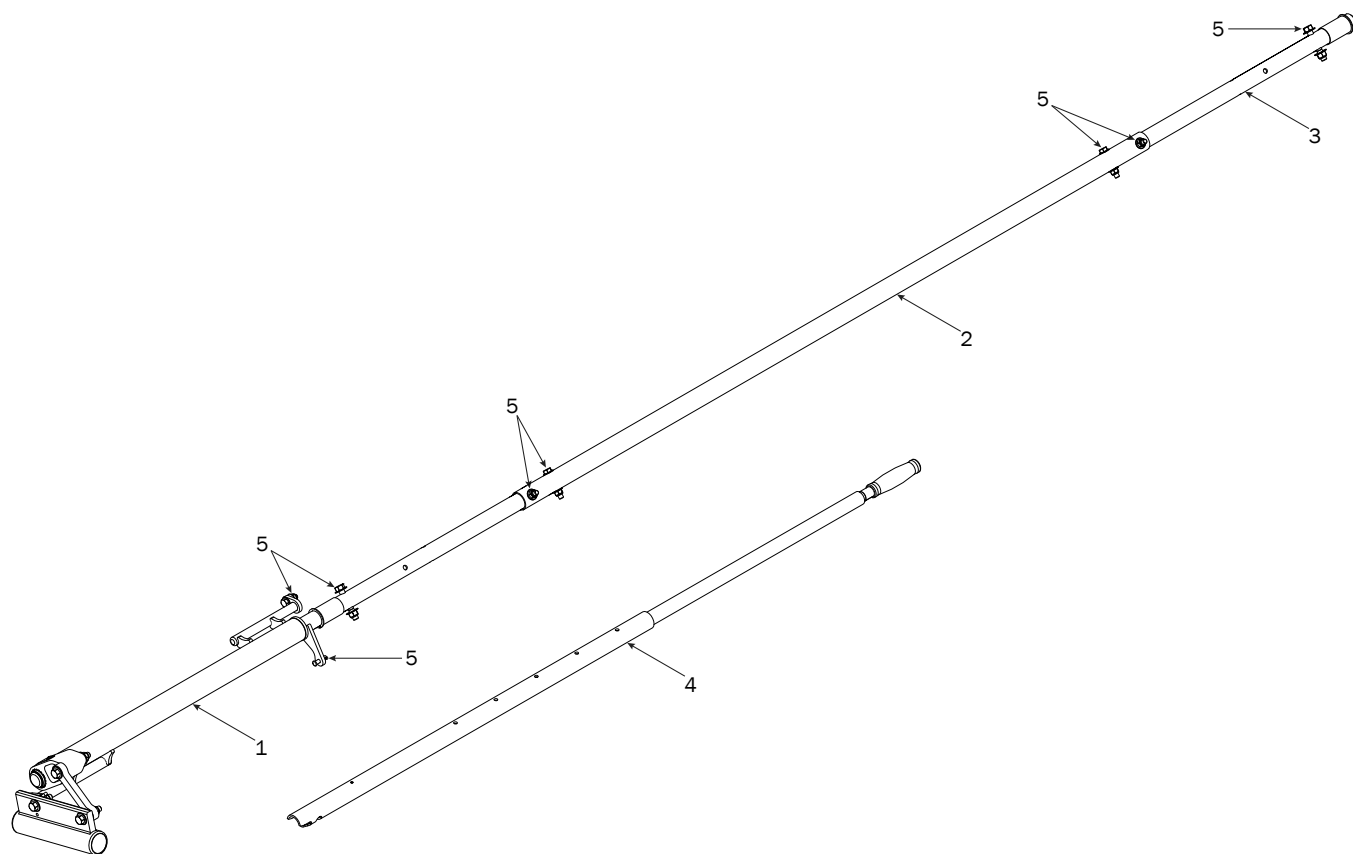

1—Drive Shaft (Qty 1)
Rear, Left Hand, 50.00"

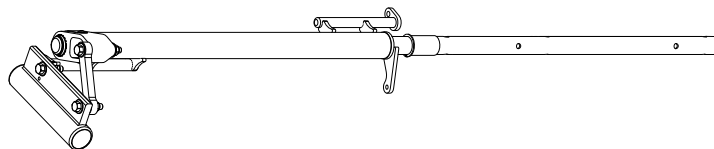

2—Connecting Bar (Qty 1)
60.00"

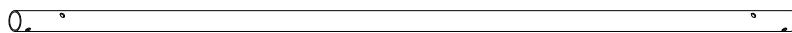

3—Front Drive Shaft (Qty 1)
B Version, 23.75"

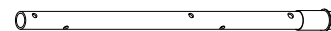

4—HRR Handle Assembly (Qty 1)
Removable, 35.00"



5—HKT-8163..... (Qty 1)
Modular High Roof Rotation Hardware Kit

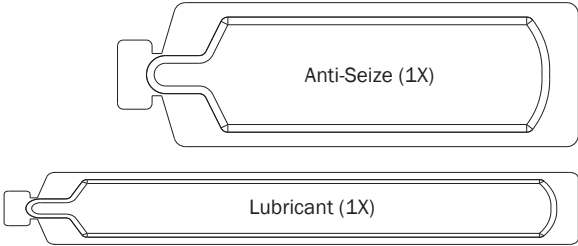
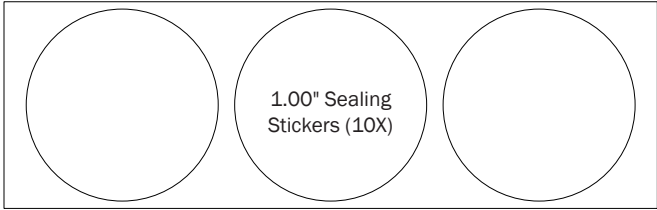
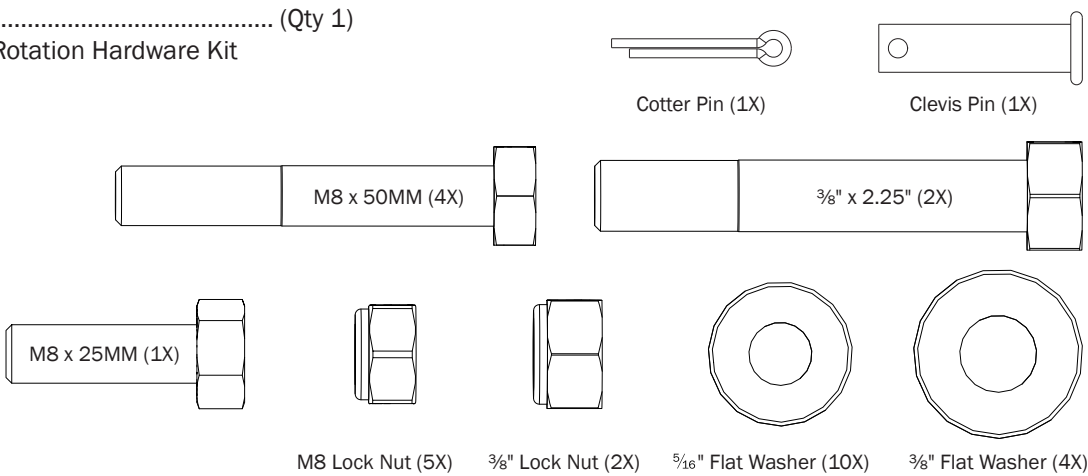

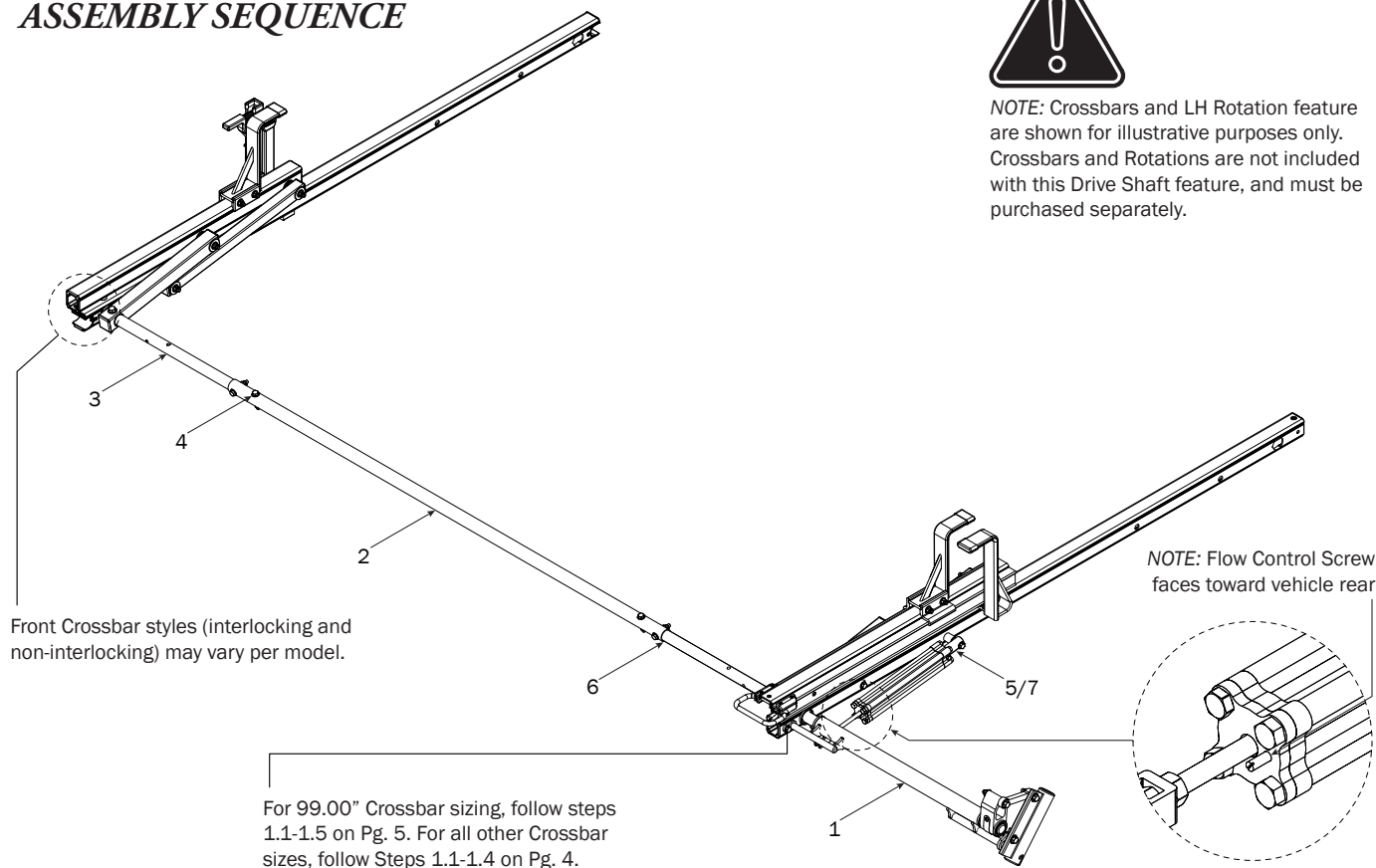
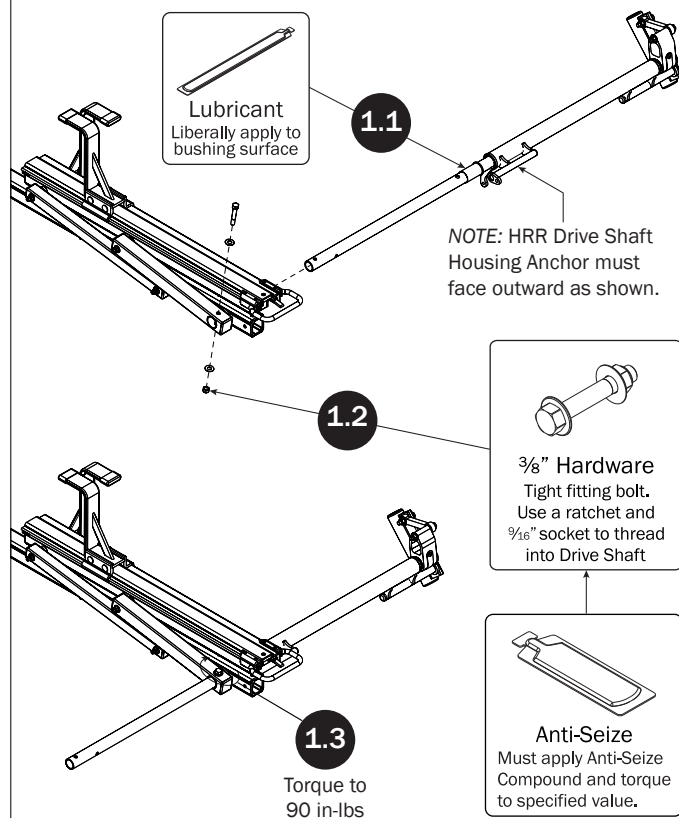
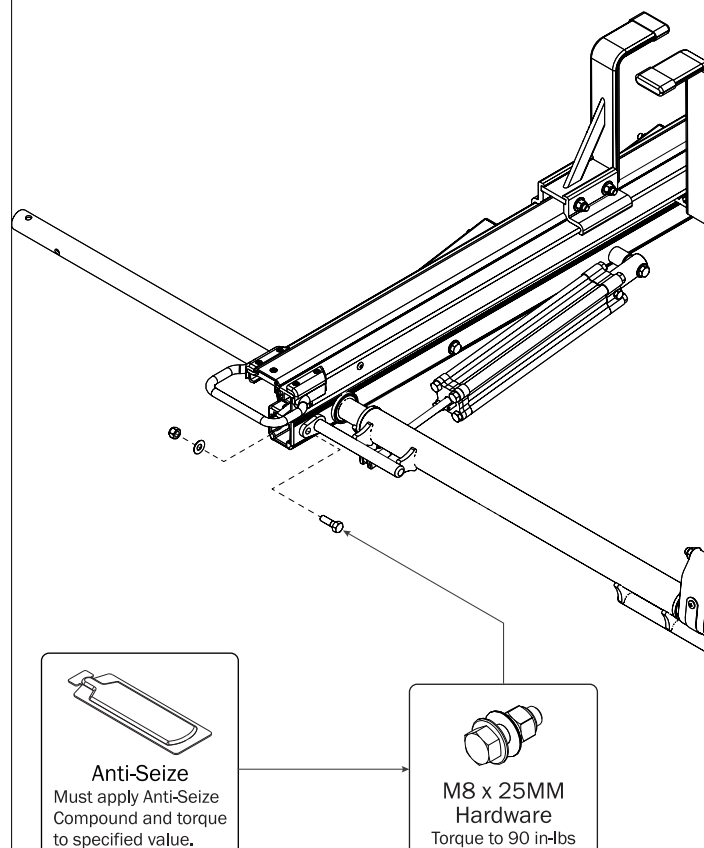
**LEFT DRIVE SHAFT
ASSEMBLY SEQUENCE****REAR DRIVE SHAFT
EXCEPT 99.00" CROSSBAR SIZING****1.4** Attach HHR Housing Anchor to Rear Crossbar using indicated hardware.

**REAR DRIVE SHAFT:
99.00" CROSSBAR SIZING ONLY**

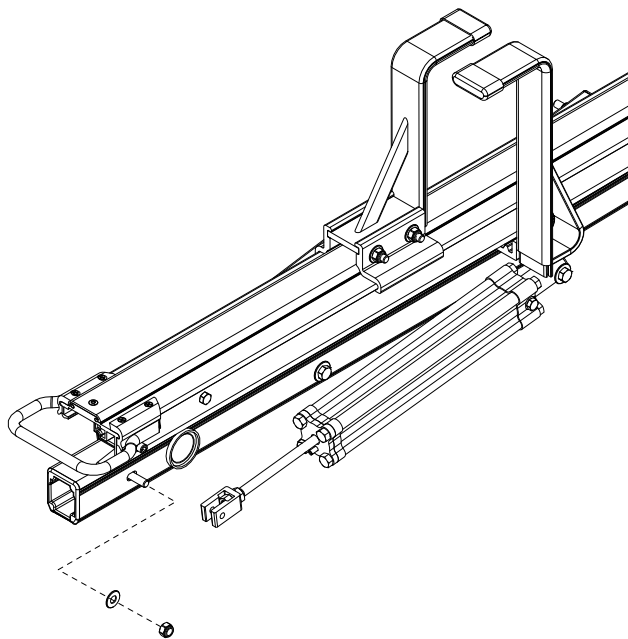

1.1 Remove and save washer and locknut before installing Rear Driveshaft.

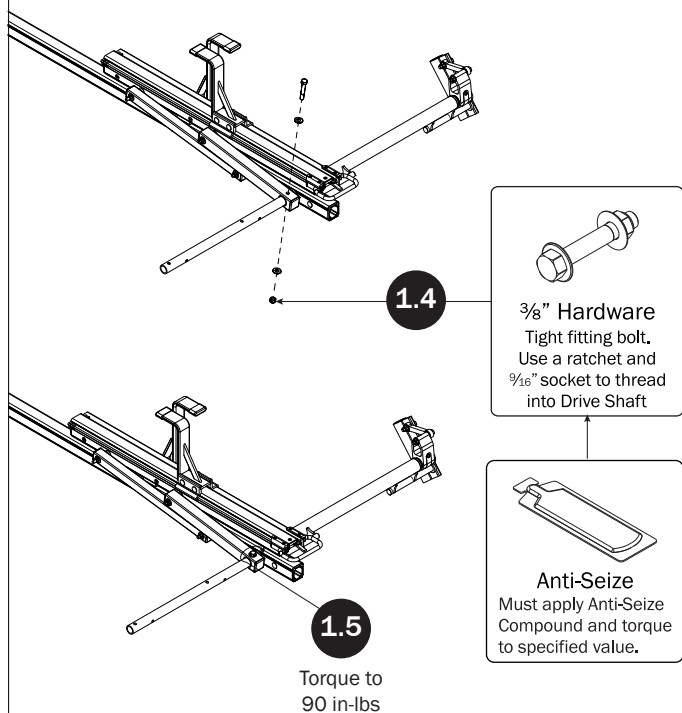
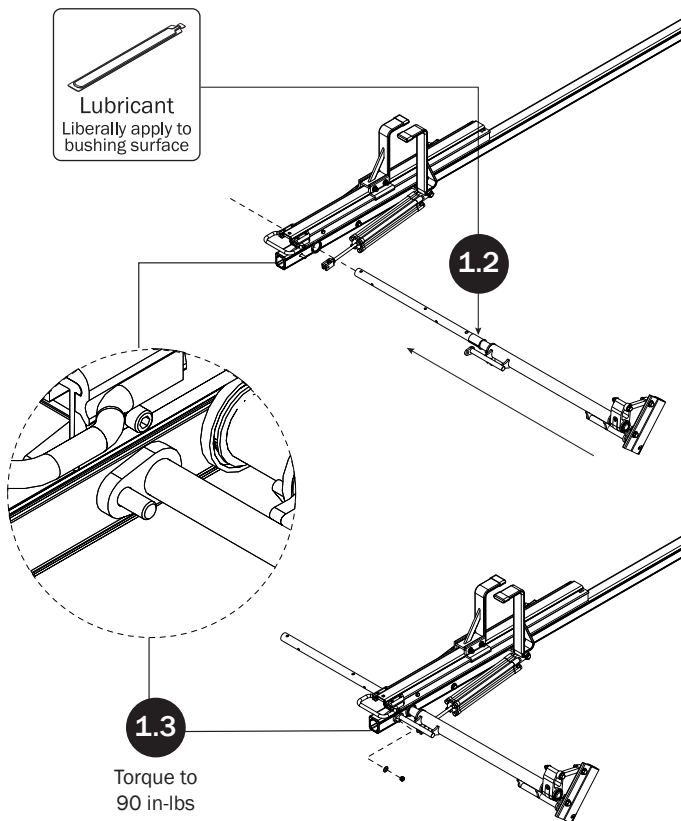

1.5
Torque to
90 in-lbs

CONNECTING BAR VARIATIONS

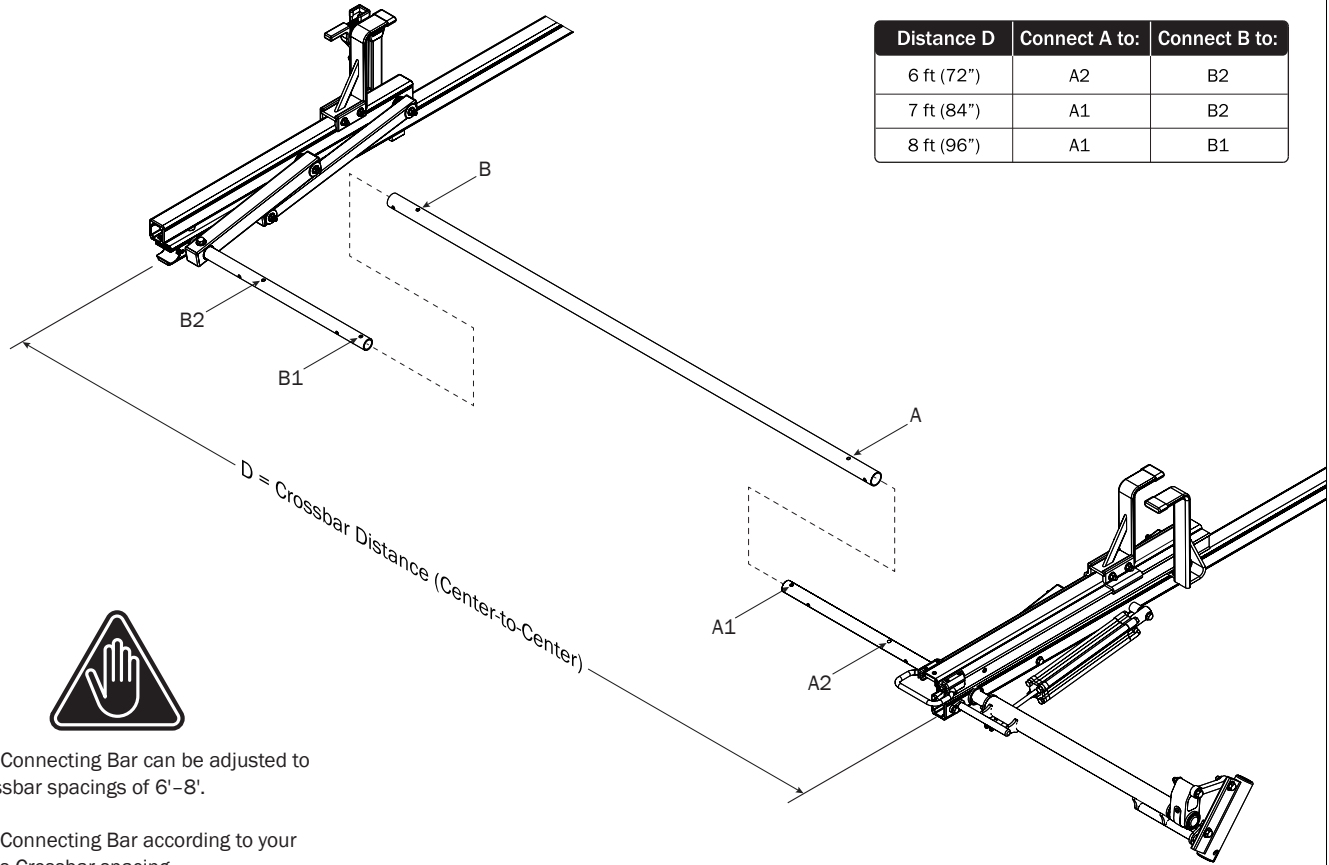

The 5' Connecting Bar can be adjusted to fit Crossbar spacings of 6'-8'.

Install Connecting Bar according to your model's Crossbar spacing.

CONNECTING BAR

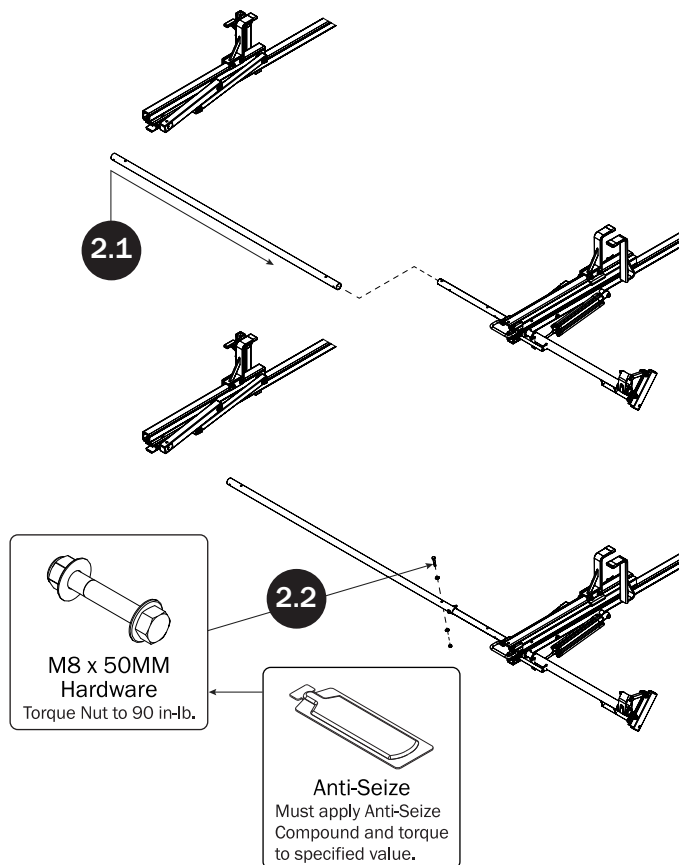

FRONT DRIVE SHAFT

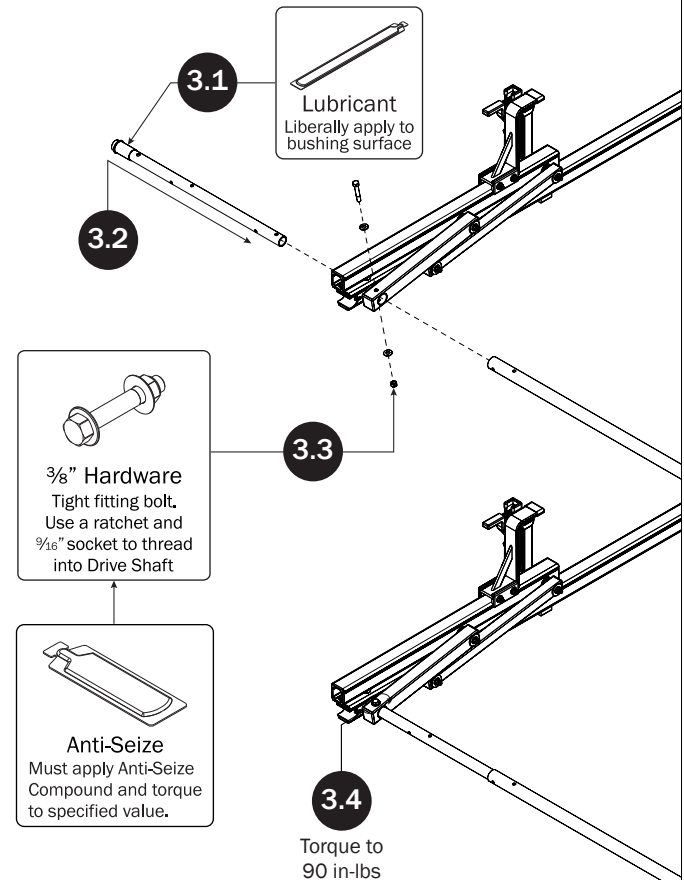

CONNECTING BAR FASTENERS

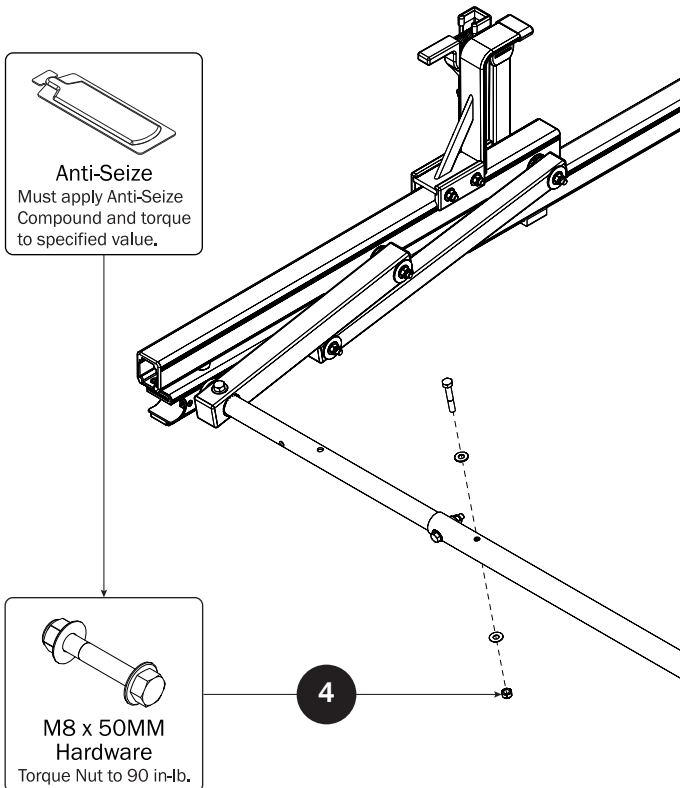

CYLINDER HARDWARE

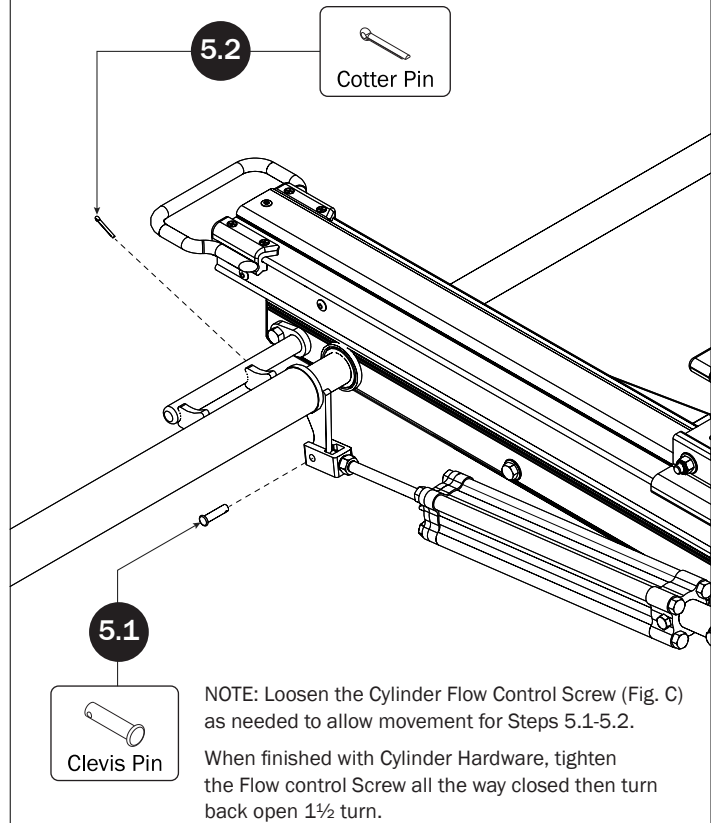

DRIVE SHAFT SEALING

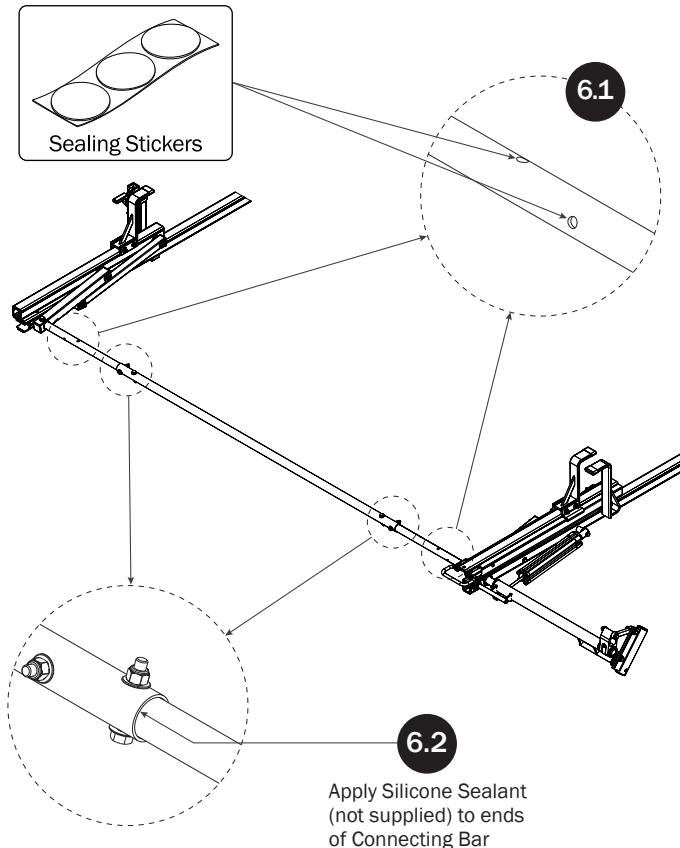

CYLINDER ADJUSTMENT

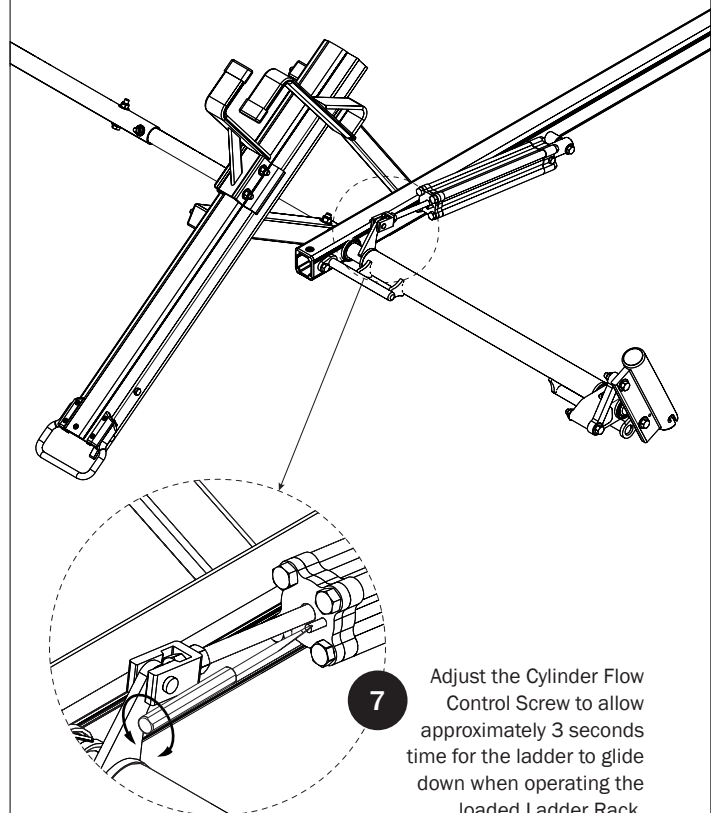

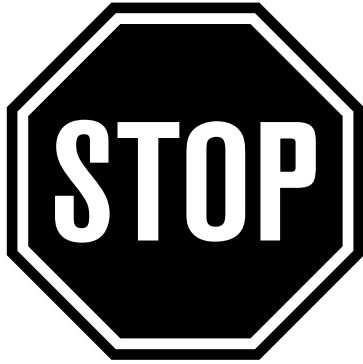

NOTE: This completes the left hand assembling of FEA-0020. For right side Drive Shaft assembly procedures, see FEA-0019 Assembly Manual.

If applicable, refer to your next FEA Assembly Manual.

If completed, refer back to your FBM Assembly Manual, and resume assembling at Step 3.1.

WARNING: Failure to position the Crossbars as shown in your FBM Assembly Manual may result in damage to the sliding door and/or ladder rack.