

# PRIME DESIGN™

A Safe Fleet Brand

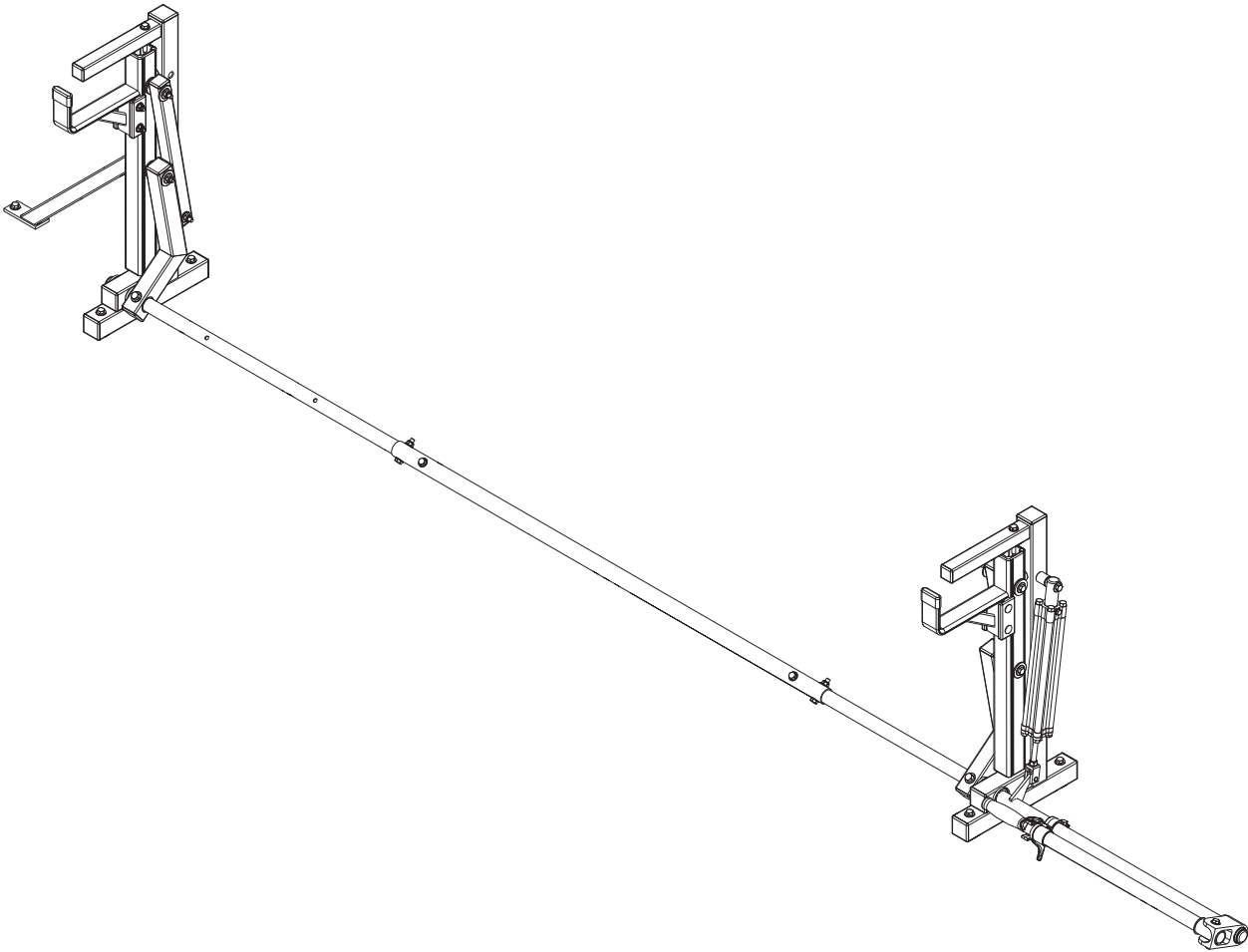

2014 JAX

PRIME DESIGN, A SAFE FLEET BRAND

Address: 580 Opperman Drive, Eagan, MN 55123 • Toll Free: 1.8.PRIME.RACK  
Fax: 651-552-1799 • Email: [info@primedesign.net](mailto:info@primedesign.net) • Website: [www.primedesign.net](http://www.primedesign.net)

## CONTENTS OVERVIEW

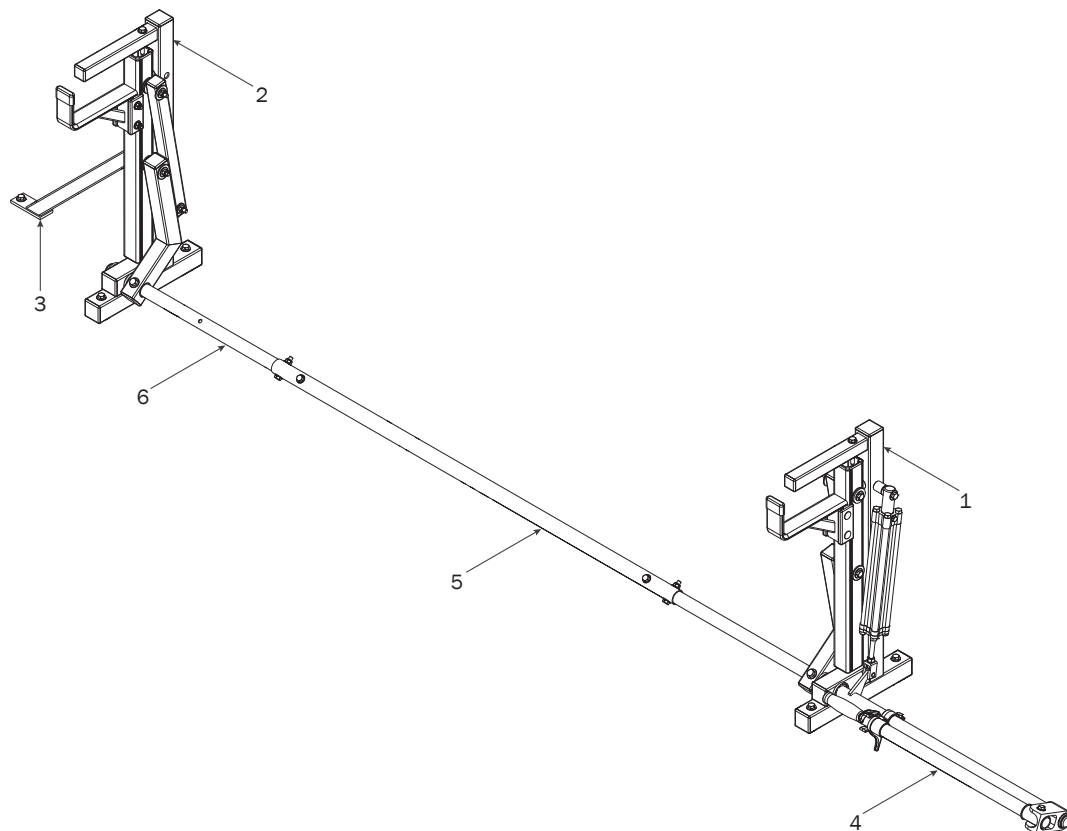

1—Rear Rotation Assembly..... (Qty 1)

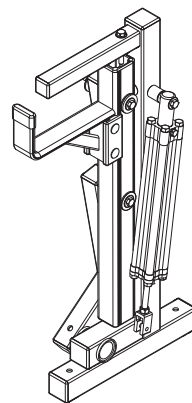

2—Front Rotation Assembly..... (Qty 1)

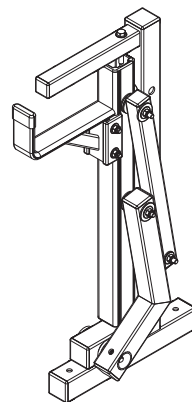

3—Mount Brace..... (Qty 1)  
20.00"



4—Rear Drive Shaft..... (Qty 1)  
Left Hand, 50.00"

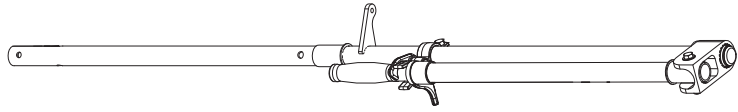

5—Connecting Bar..... (Qty 1)  
48.00"



6—Front Drive Shaft..... (Qty 1)  
B Version, 35.75"

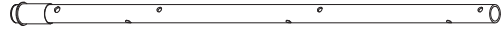

#### HKT-8163-Rotation Hardware Kit

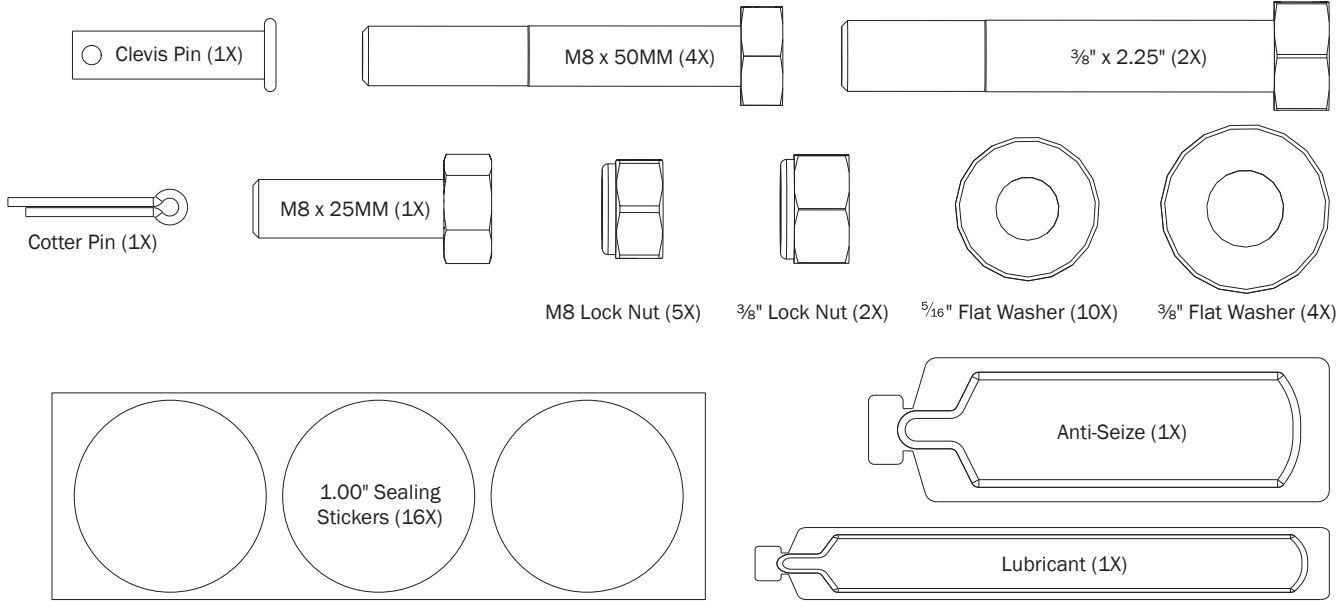

#### HKT-0055-Rotation Hardware Kit

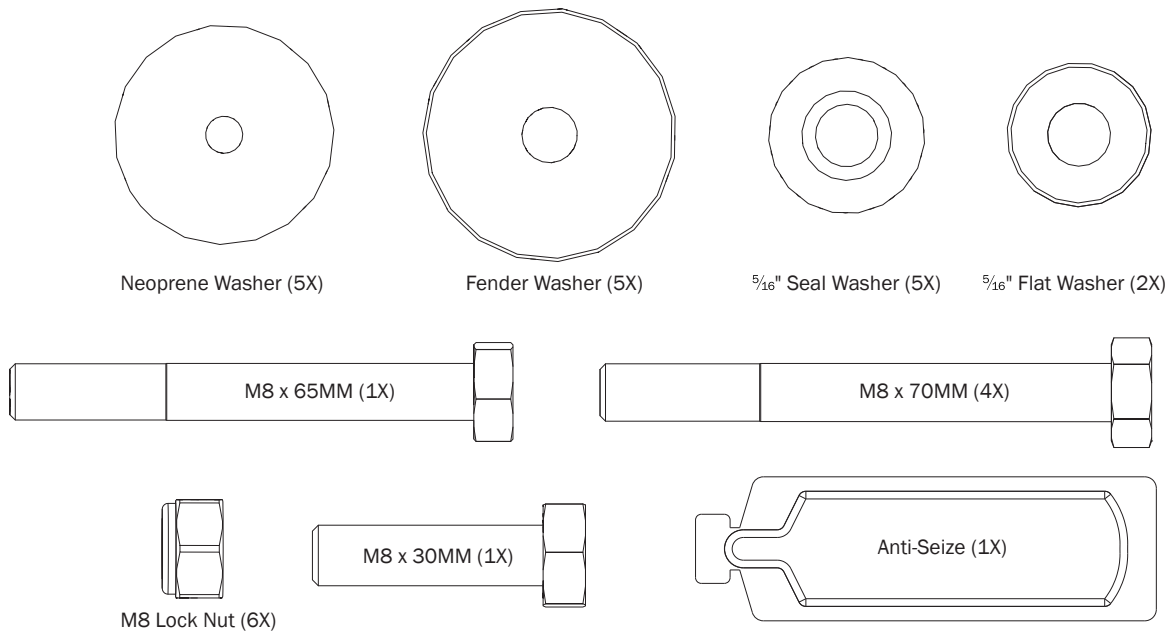

## MOUNTING DIMENSIONS



Mounting to Service Body: dimensions are dependent upon Crossbar distances of 6'-8' plus allowance for the Mount Brace from the front of the Utility Rack.

Allow spacing for the Mount Brace, but do not drill or install until Step 9.

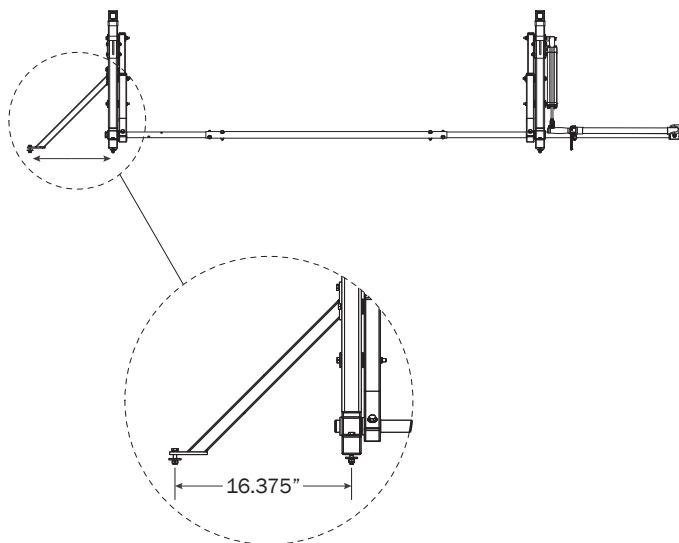

- 0.1** 6.00 Ft: Drill holes into the Service Body mounting location according to dimensions shown.

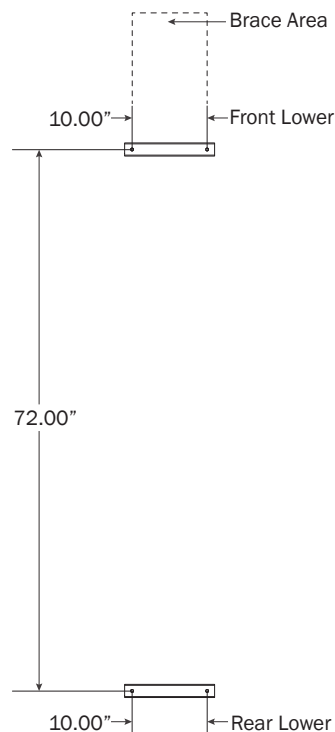

- 0.2** 7.00 Ft: Drill holes into the Service Body mounting location according to dimensions shown.

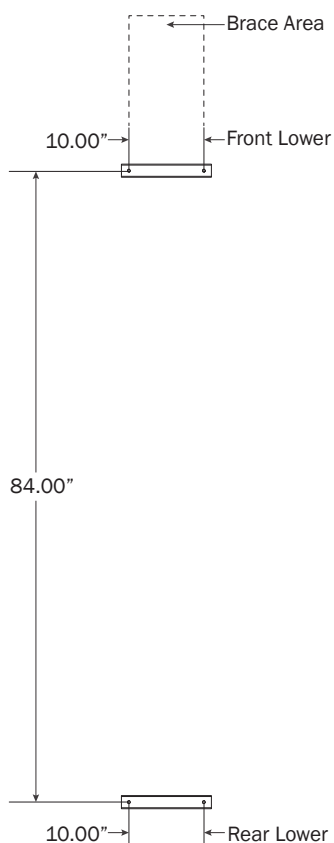

- 0.3** 8.00 Ft: Drill holes into the Service Body mounting location according to dimensions shown.

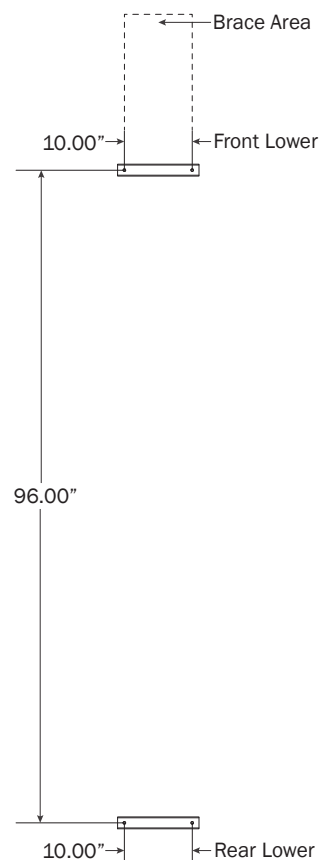

LEFT ROTATION ASSEMBLY SEQUENCE

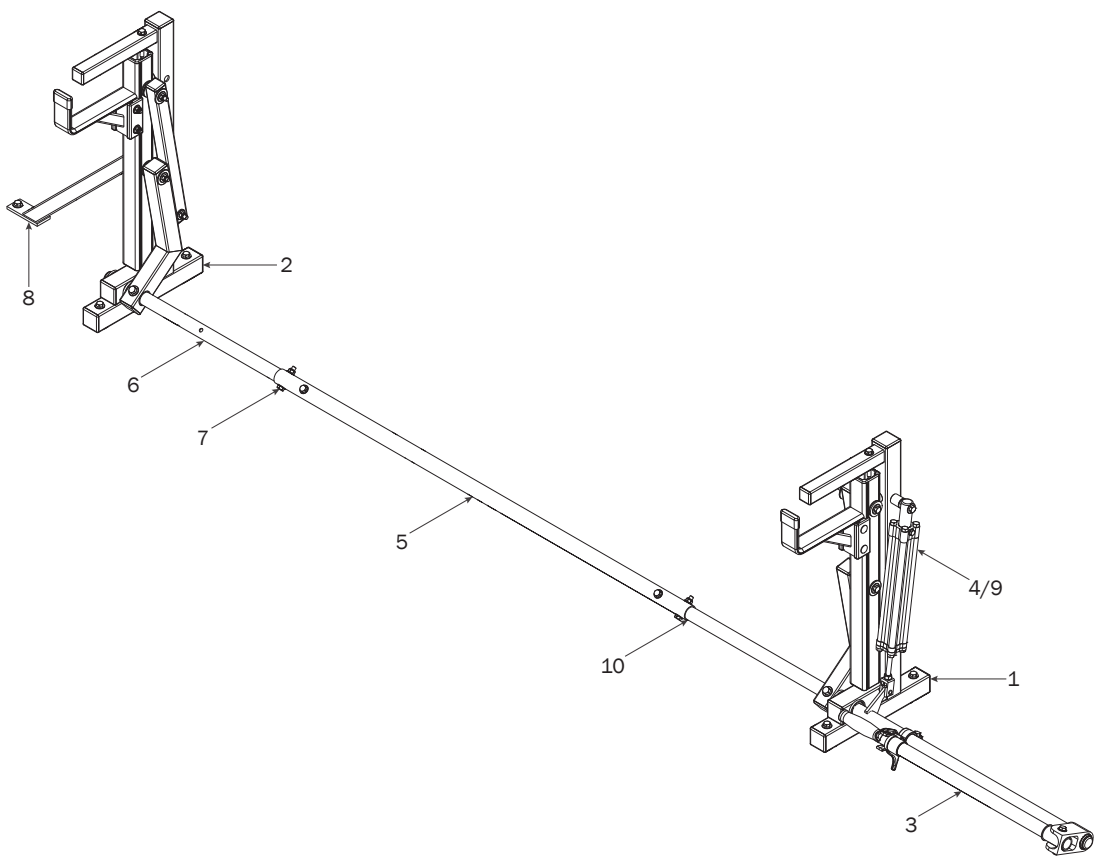

REAR ROTATION ASSEMBLY

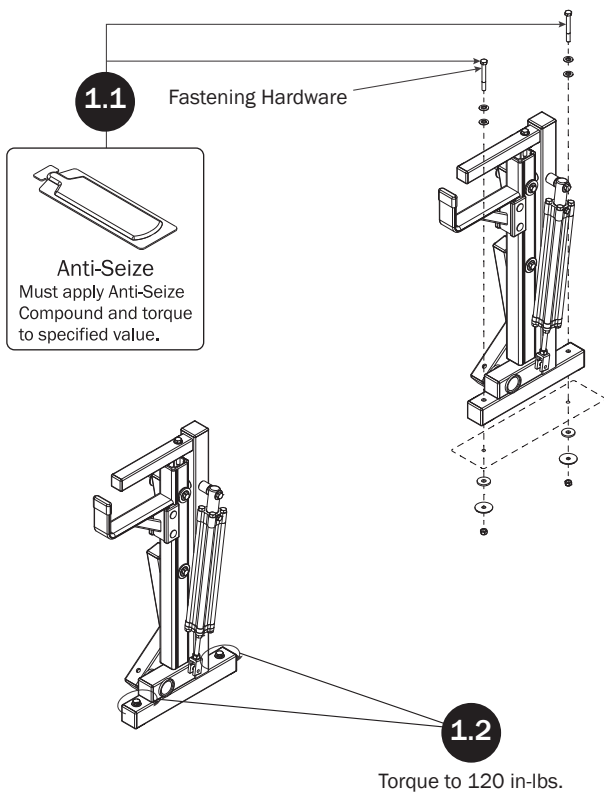

FRONT ROTATION ASSEMBLY

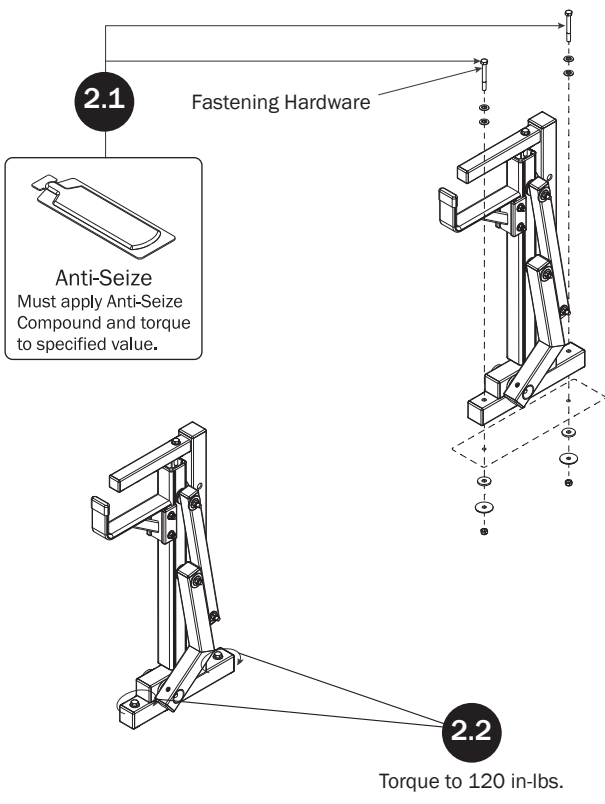

Prime Design Limited Warranty. Seller's sole and exclusive warranty (and Buyer's sole and exclusive remedy and Seller's entire liability for any breach thereof) with respect to the Goods is set forth in the Limited Warranty document available at [primedesign.net/warranty-liability](https://primedesign.net/warranty-liability) (the "Prime Design Limited Warranty"). • TM & © 2021 PRIME DESIGN. PROTECTED BY ONE OR MORE OF THE FOLLOWING PATENT NO.'s 6427889, 6764268, 6971563, 8991889, 9415726, 9506292, 9481313, 9776476, 9796340, 10470565, 10486608, 10501022 AND OTHER PATENTS PENDING

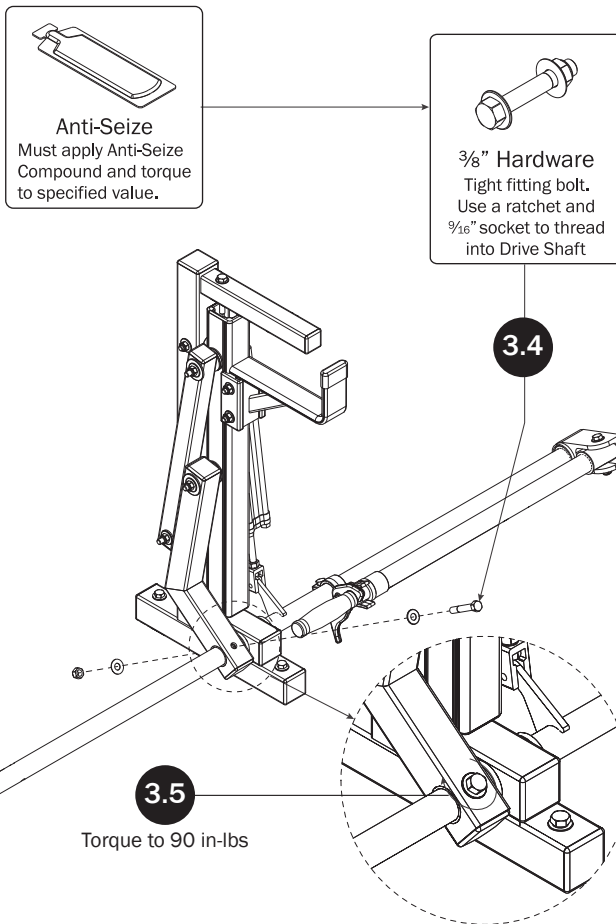
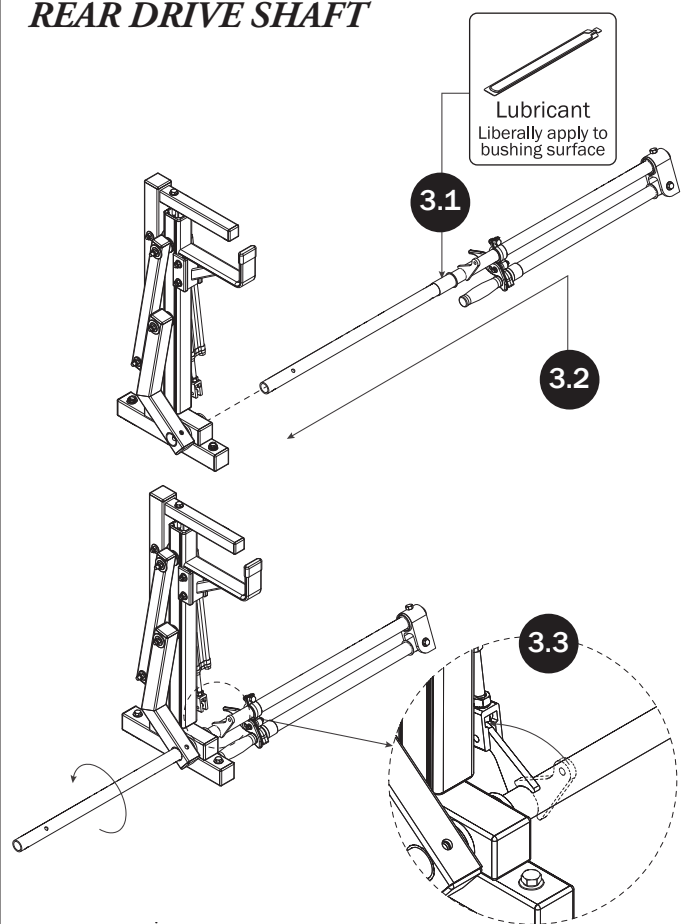
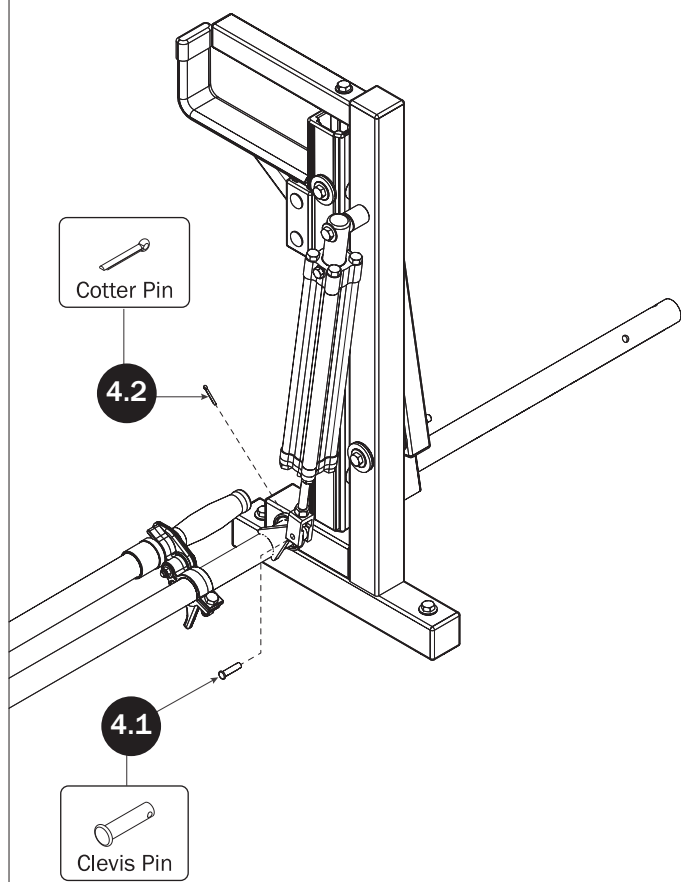
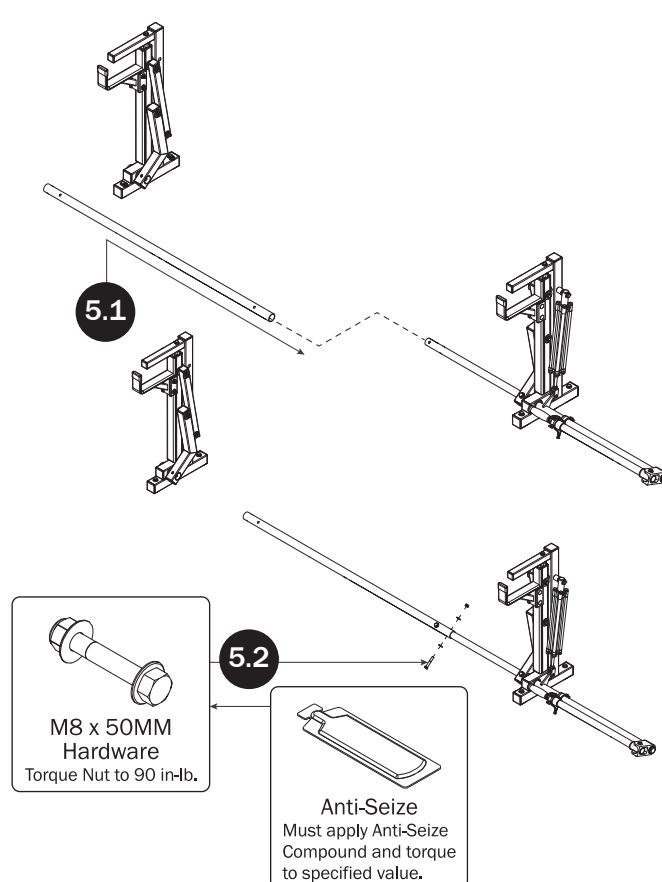
**REAR DRIVE SHAFT****CYLINDER HARDWARE****CONNECTING BAR**

## FRONT DRIVE SHAFT

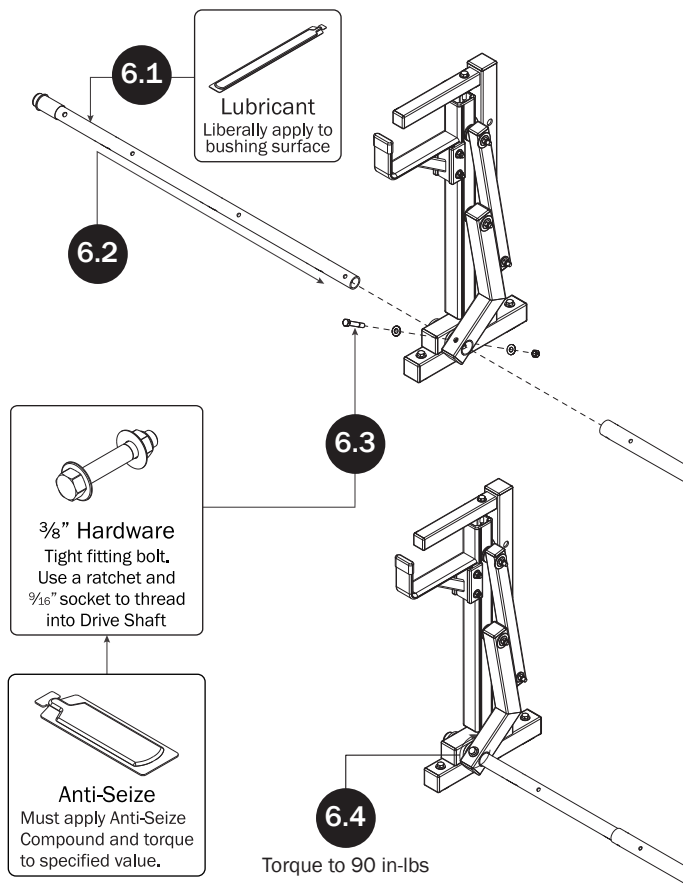

## CONNECTING BAR FASTENERS

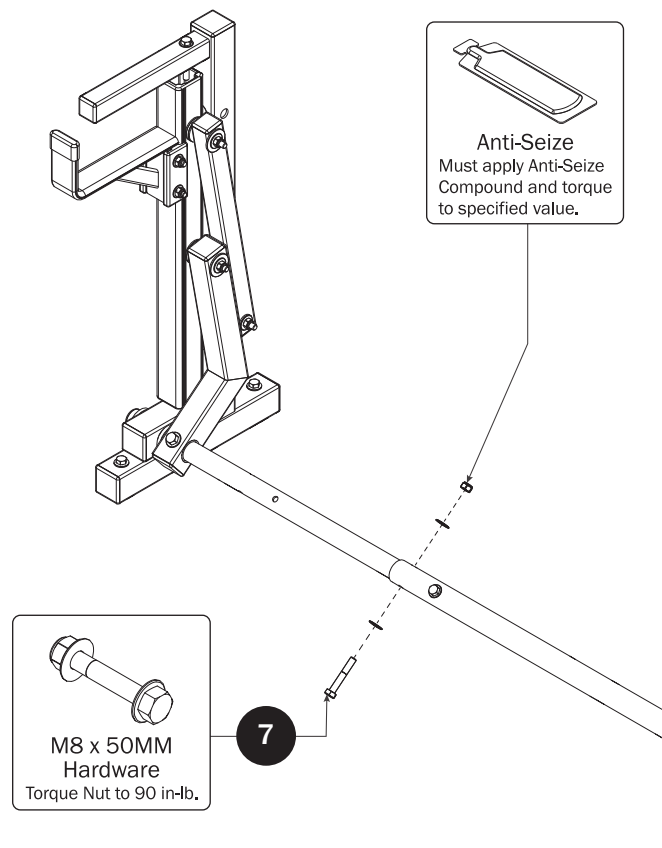

## MOUNT BRACE INSTALLATION

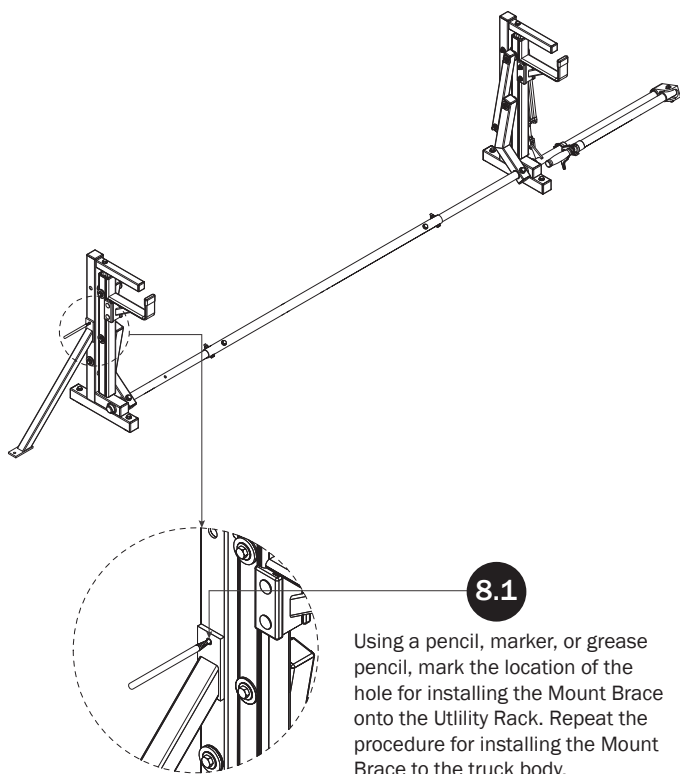

- 8.2** Remove the Mount Brace to expose the bolt hole markings. Using a 9MM, 23/64", or T size bit, drill a hole into the Utility Rack at the marked bolt hole location created during Step 8.1.

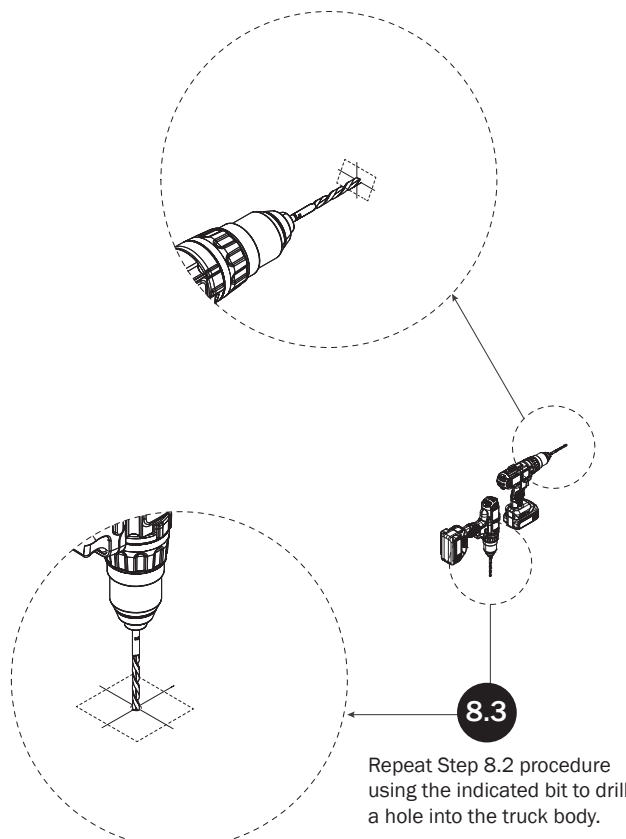

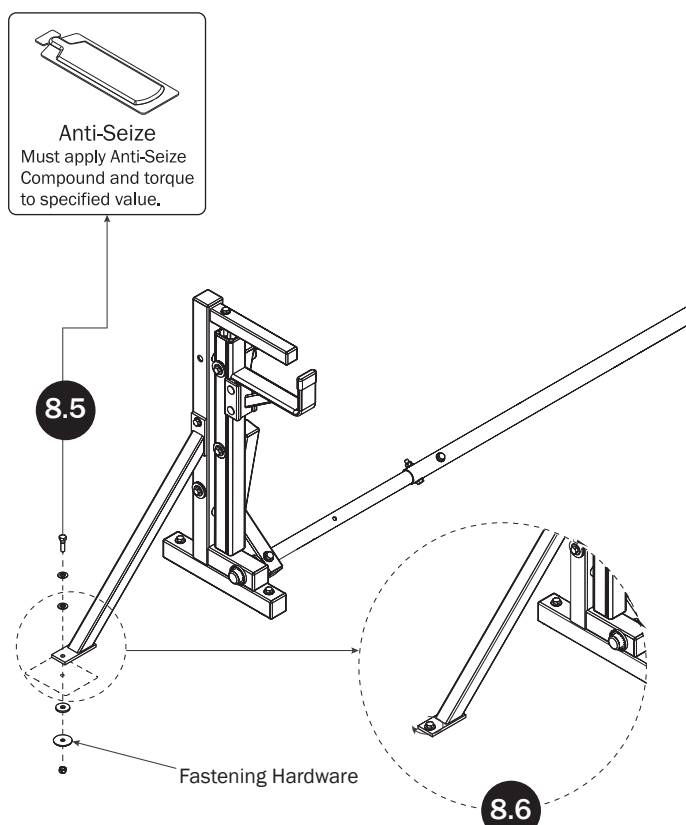
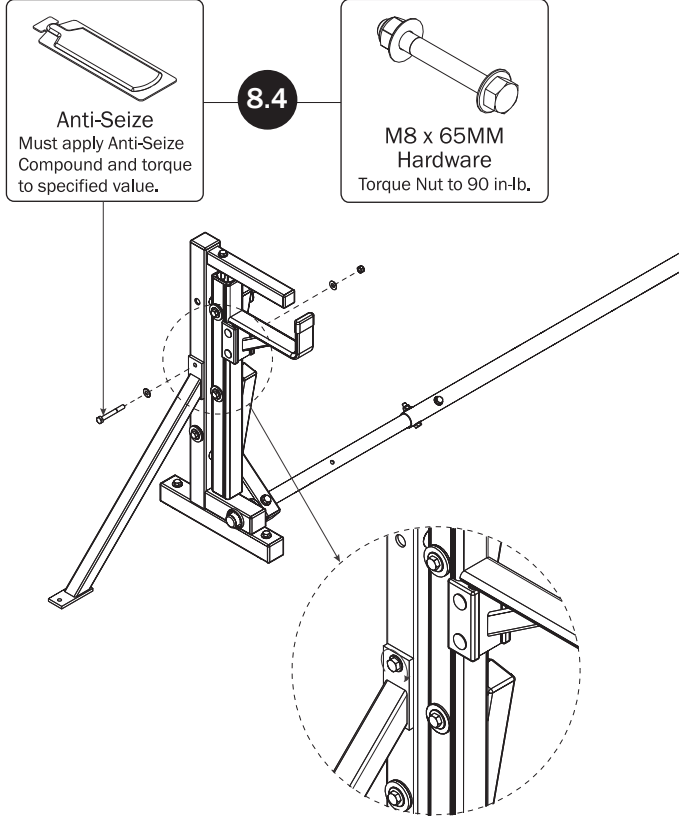

### CYLINDER ADJUSTMENT

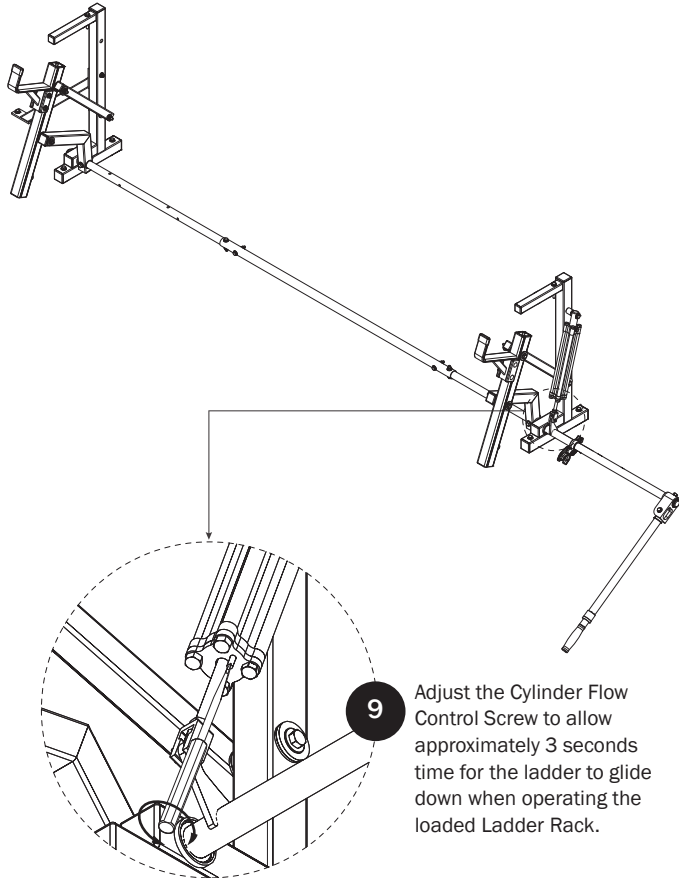

### DRIVE SHAFT SEALING

