

PRIME DESIGN™

A Safe Fleet Brand

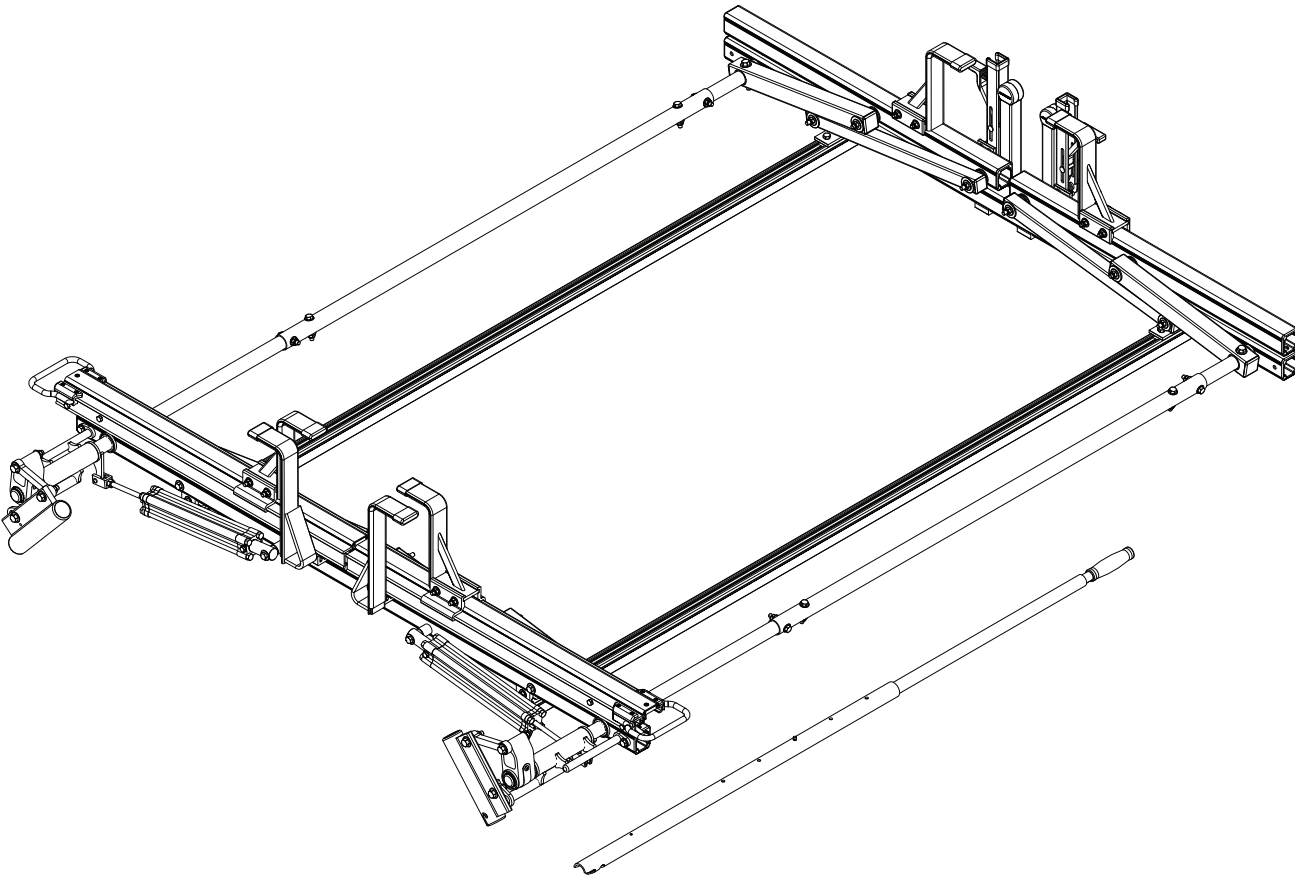

HRR-E

6000

PRIME DESIGN, A SAFE FLEET BRAND

Address: 580 Opperman Drive, Eagan, MN 55123 • Toll Free: 1.8.PRIME.RACK

Fax: 651-552-1799 • Email: info@primedesign.net • Website: www.primedesign.net

CONTENTS OVERVIEW

INSTALLER NOTE: Mounting Hardware or Brackets to attach this rack to a vehicle roof or cap are not included in this kit, and must be purchased separately.

To purchase Mounting Hardware or Brackets, please contact Prime Design Sales & Support.

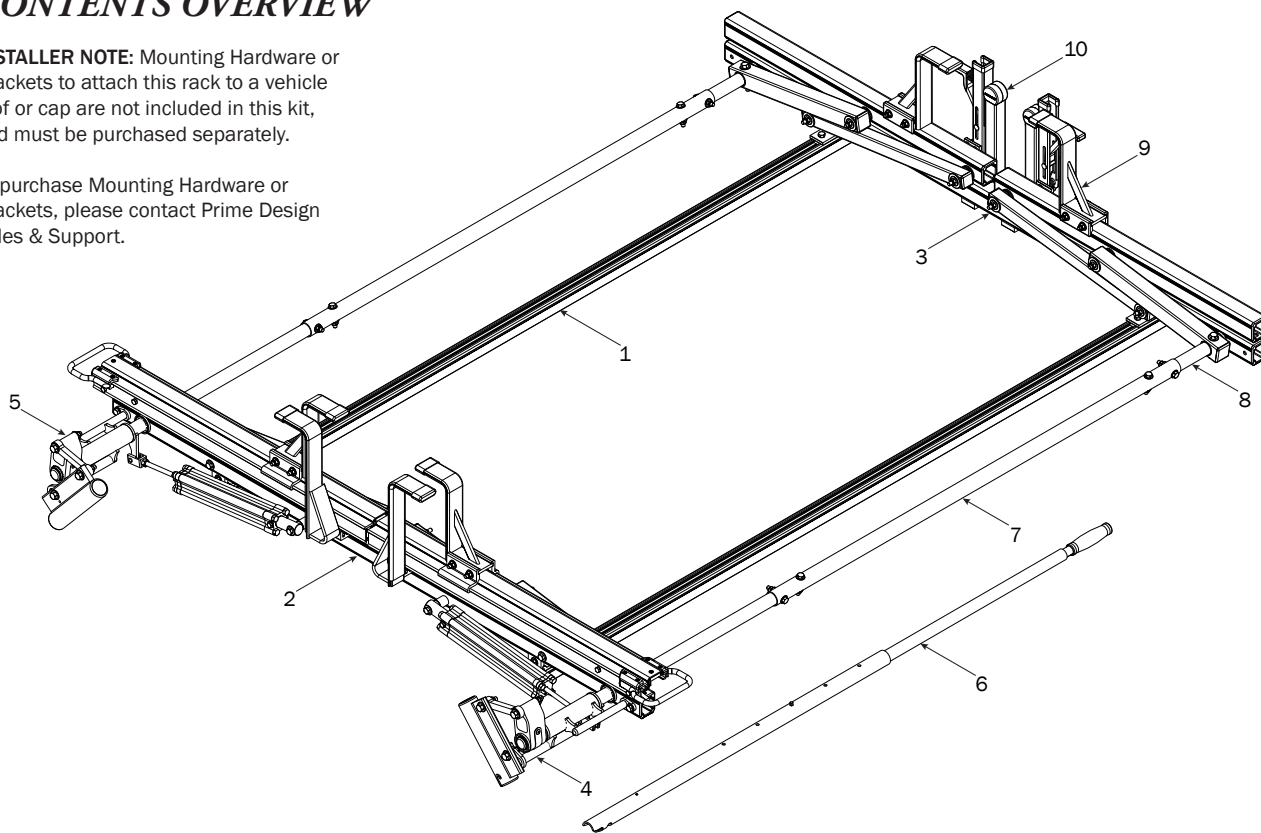

1—FBM-0001..... (Qty 1)
Channels with hardware



Channels (2X)



Screws (8X)



End Caps (4X)



Brackets (4X)

2—Rear Crossbar Assembly..... (Qty 1)

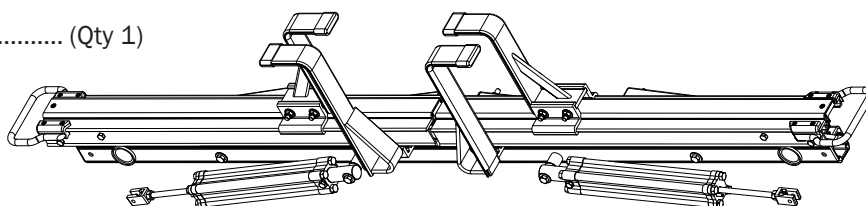

3—Front Crossbar Assembly (Qty 1)

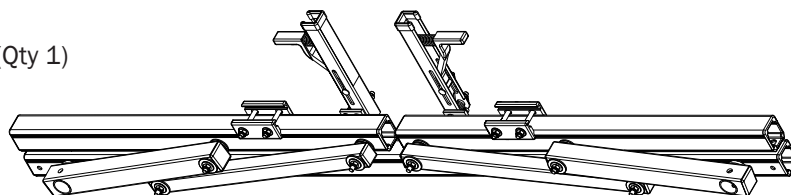

4—Rear Drive Shaft (Qty 1)
Right Hand, G4, 33.50"

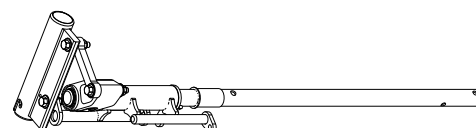

5—Rear Drive Shaft (Qty 1)
Left Hand, G4, 33.50"

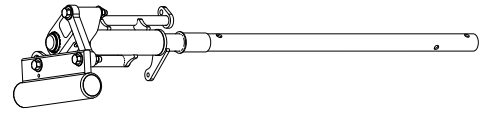

6—HRR Handle Assembly (Qty 1)
35.00"

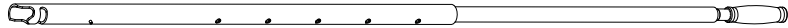

7—Connecting Bar (Qty 1)
48.00"

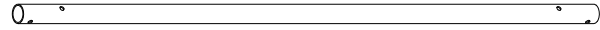

8—Front Drive Shaft (Qty 1)
B Version, 35.75"

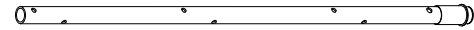

9—Z Post (Qty 1)
Adjustable 7.25"

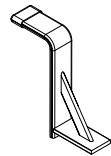

10—L Post (Qty 1)
Roller Cap, 9.25"

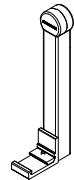

11—HKT-8163 (Not called out in Overview)..... (Qty 2)

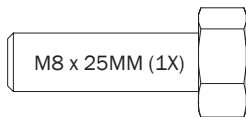

M8 x 25MM (1X)

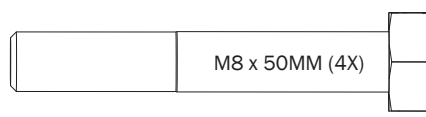

M8 x 50MM (4X)

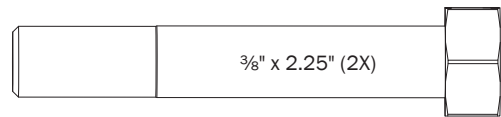

3/8" x 2.25" (2X)

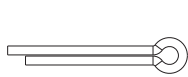

Cotter Pin (1X)

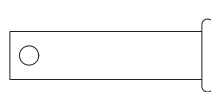

Clevis Pin (1X)

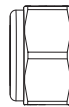

M8 Lock Nut (5X)

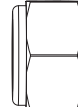

3/8" Lock Nut (2X)

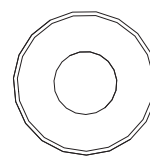

5/16" Flat Washer (10X)

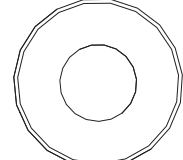

3/8" Flat Washer (4X)

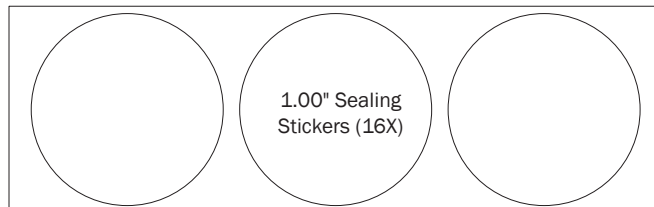

1.00" Sealing
Stickers (16X)

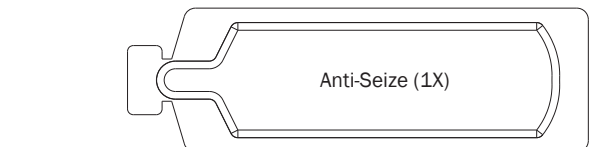

Anti-Seize (1X)

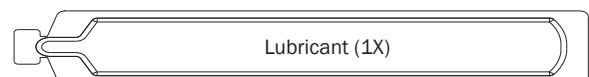

Lubricant (1X)

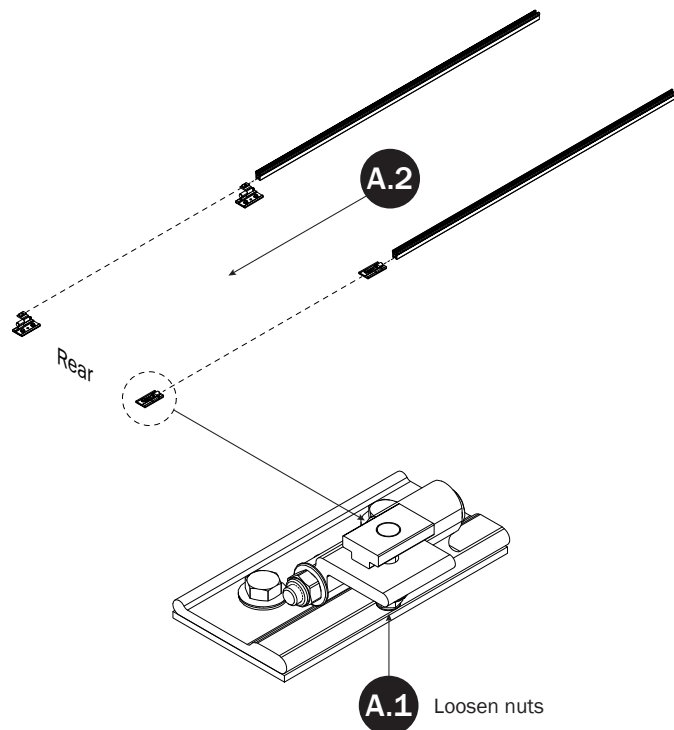
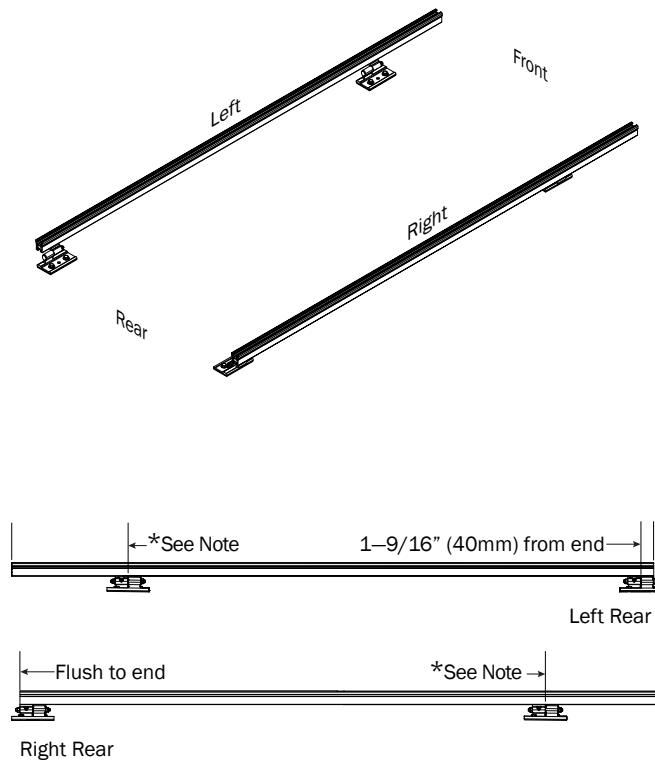
FBM-0001 FLUSH
CHANNELS TO PRE-INSTALLED
MOUNTING BRACKETS**A.3** Set to distances then torque nuts to 80 in-lbs

*Note: Use Alternate instructions if marked distances exceed 18" (457mm).

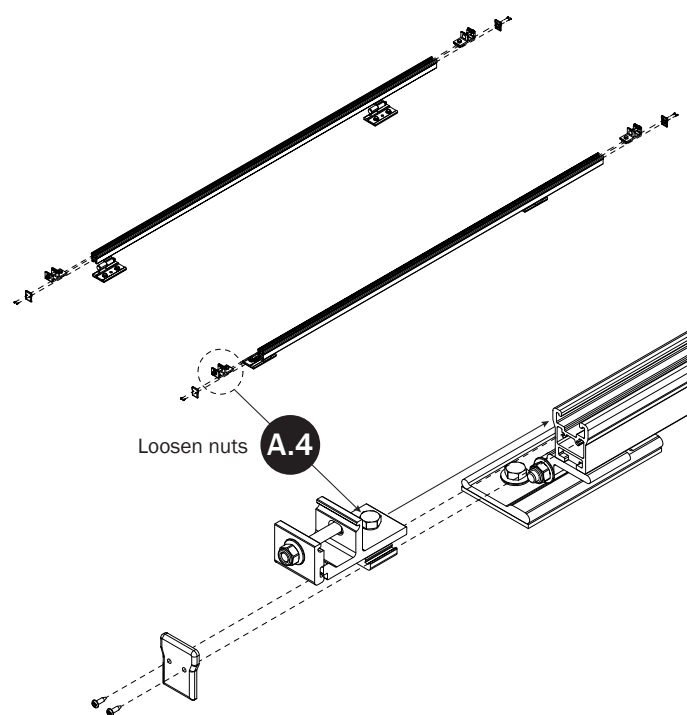
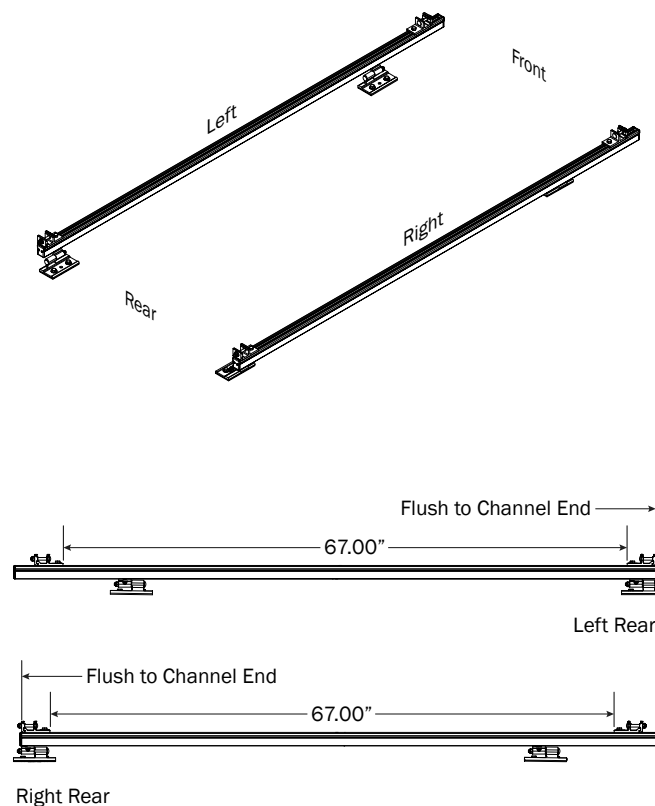
**A.5** Set to distances then torque Rear Bracket nuts to 90 in-lbs

FBM-0001 ALTERNATE
CHANNELS TO PRE-INSTALLED
MOUNTING BRACKETS

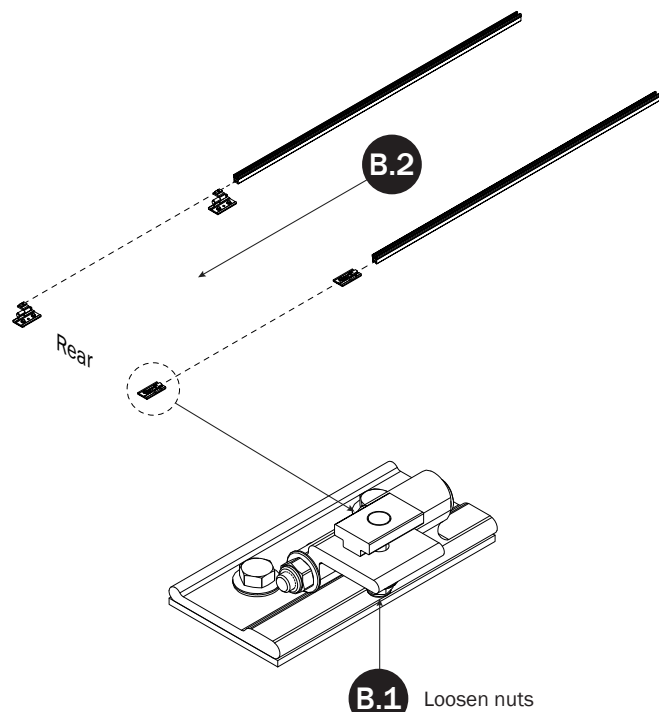

B.3 Set to distances then torque nuts to 80 in-lbs

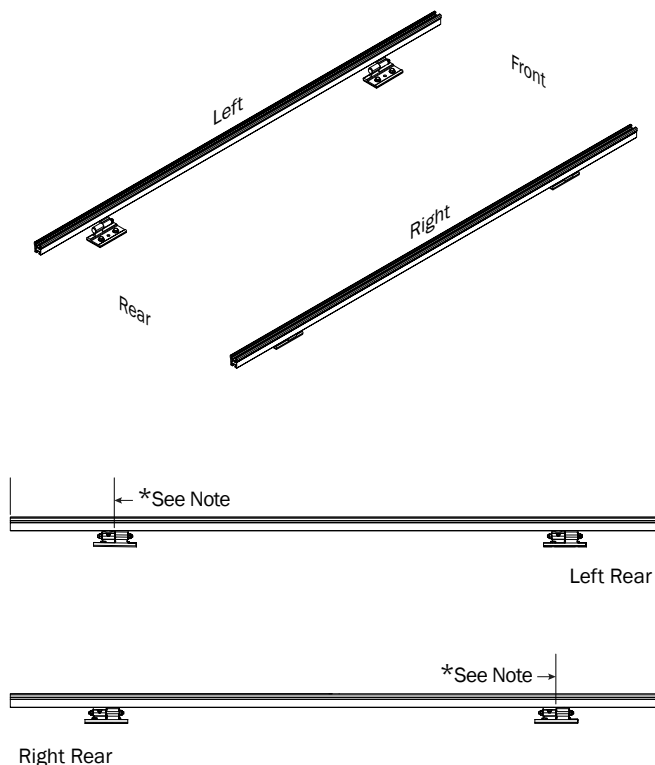

* Move Channels rearward until front distance no longer exceeds 18" (457mm).

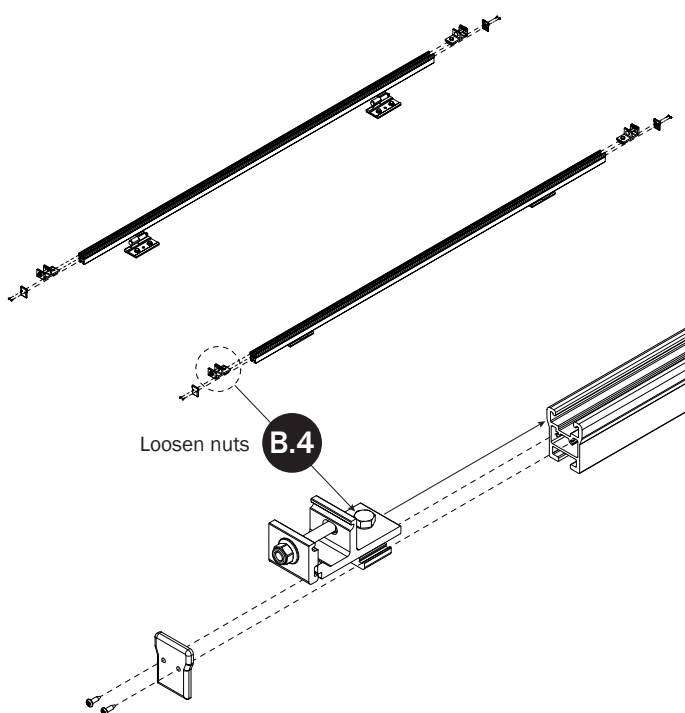

B.5 Set to distances then torque Rear Bracket nuts to 90 in-lbs

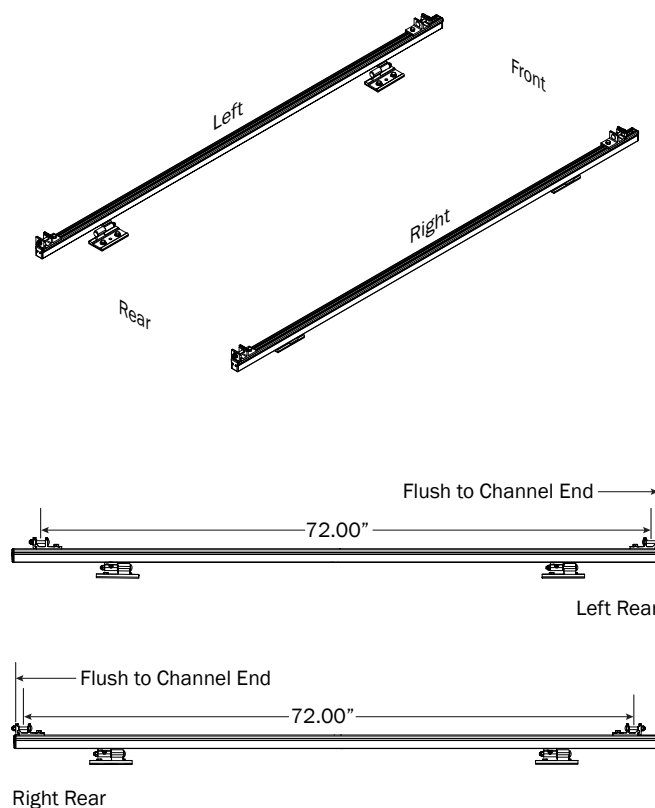

RIGHT ROTATION ASSEMBLY SEQUENCE

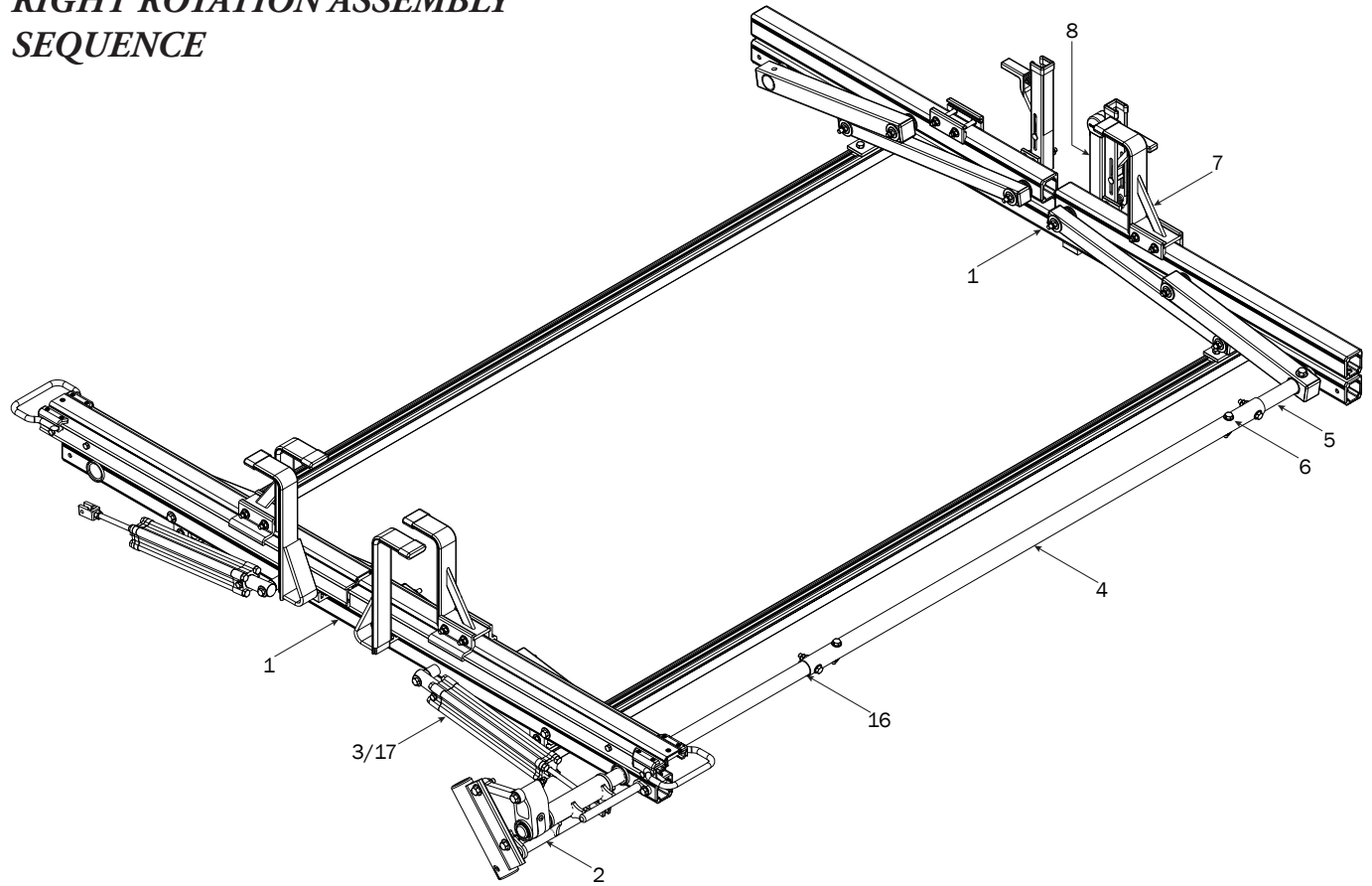

CROSSBARS

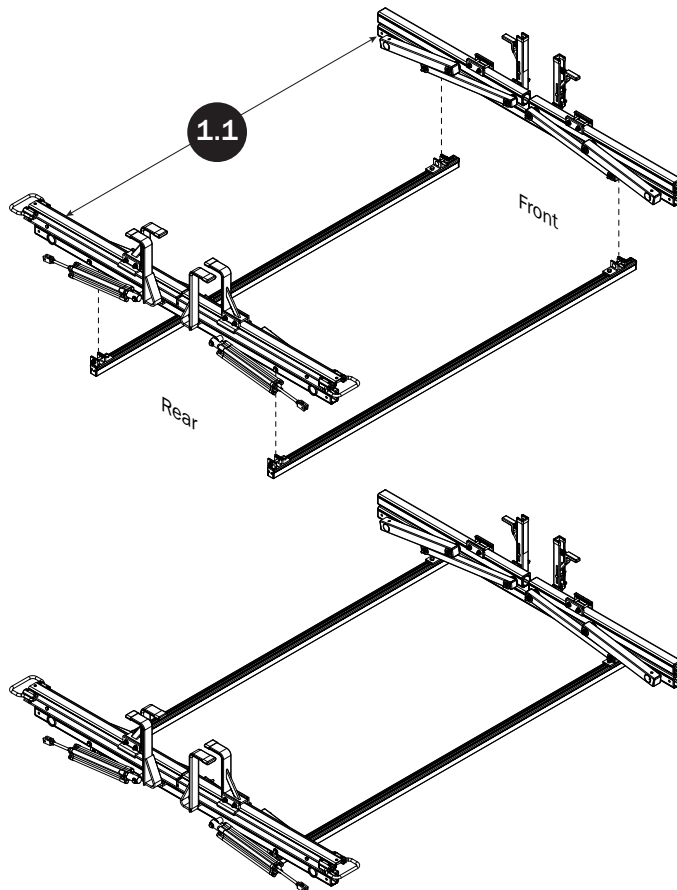

CROSSBAR ADJUSTMENT

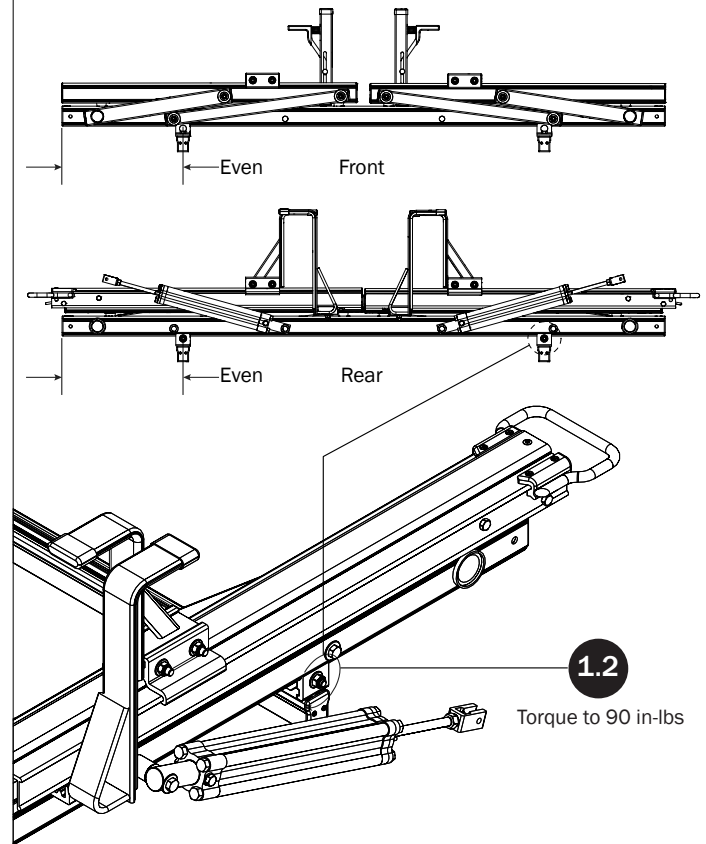

REAR DRIVE SHAFT

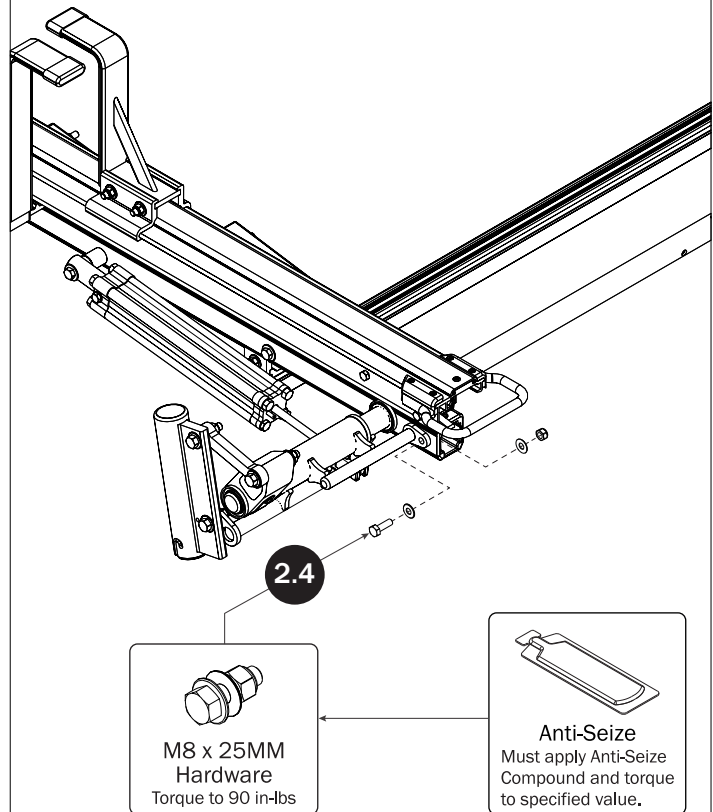
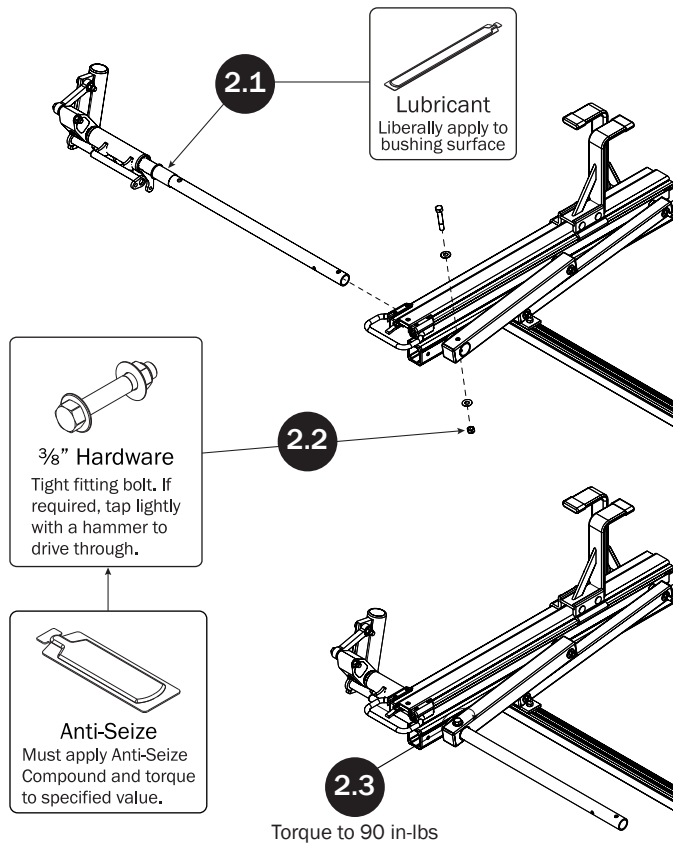

CYLINDER HARDWARE

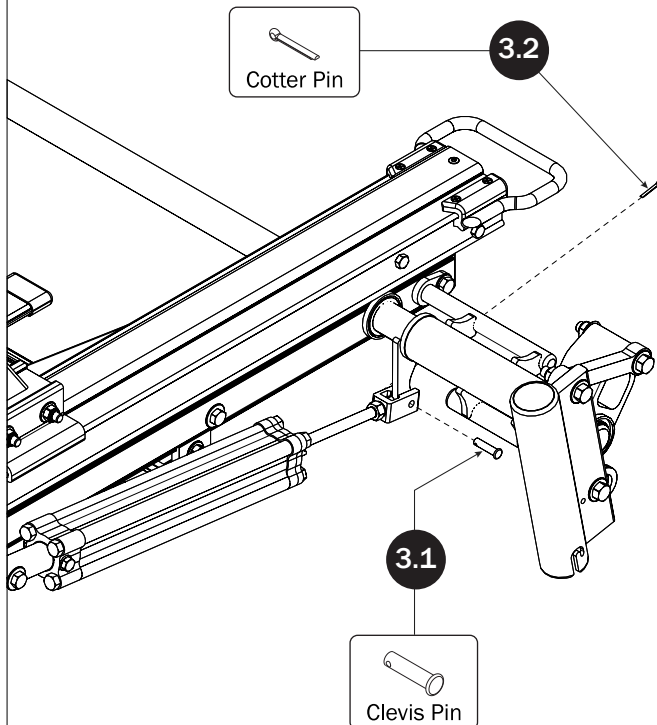

CONNECTING BAR

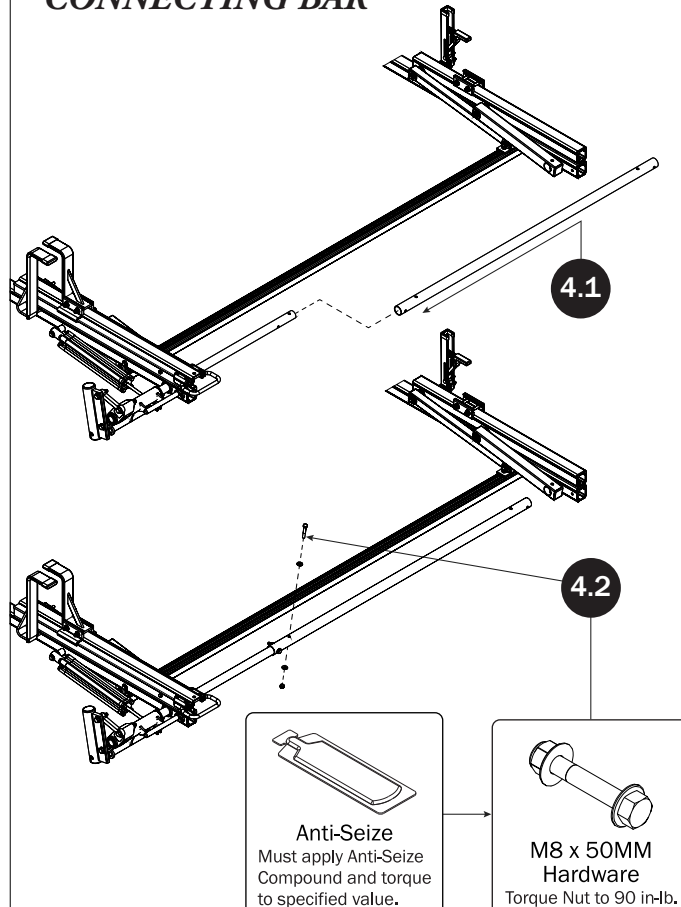

FRONT DRIVE SHAFT

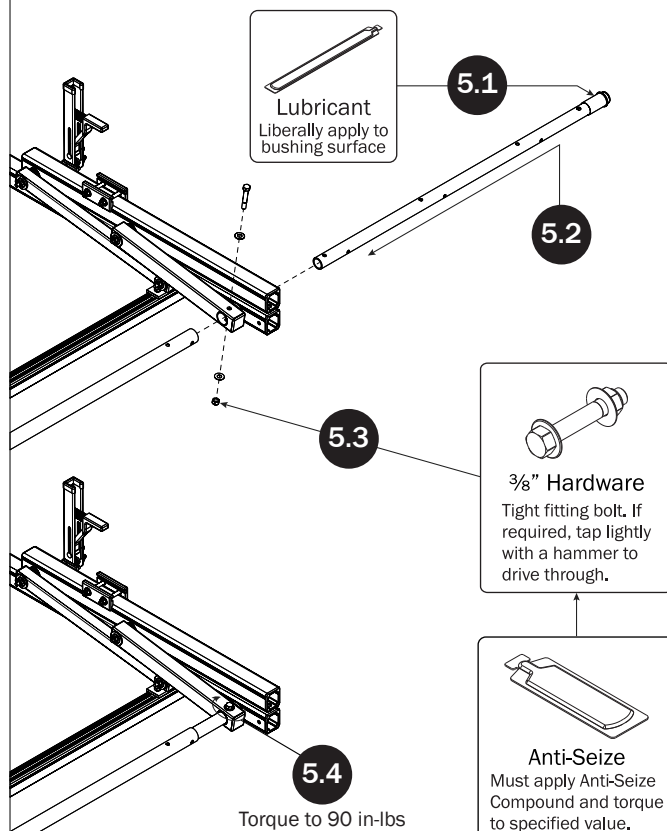

CONNECTING BAR FASTENERS

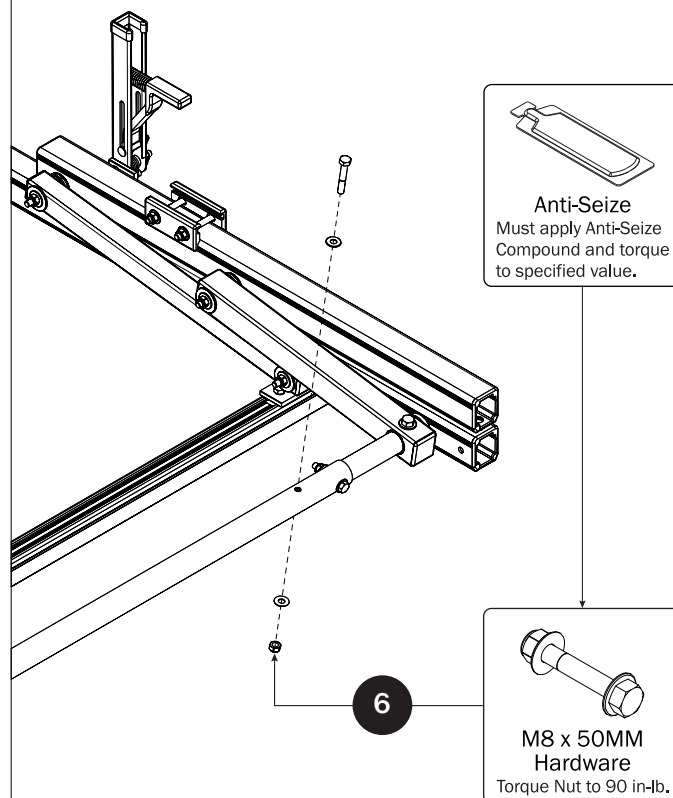

Z POSTS

SEE QUICK START GUIDE FOR ADJUSTMENTS

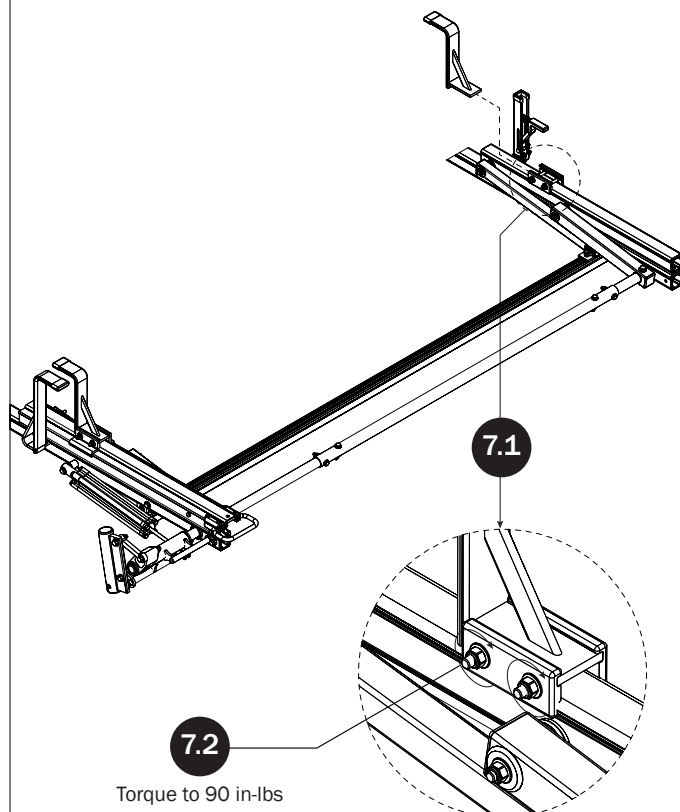

L POSTS

SEE QUICK START GUIDE FOR ADJUSTMENTS

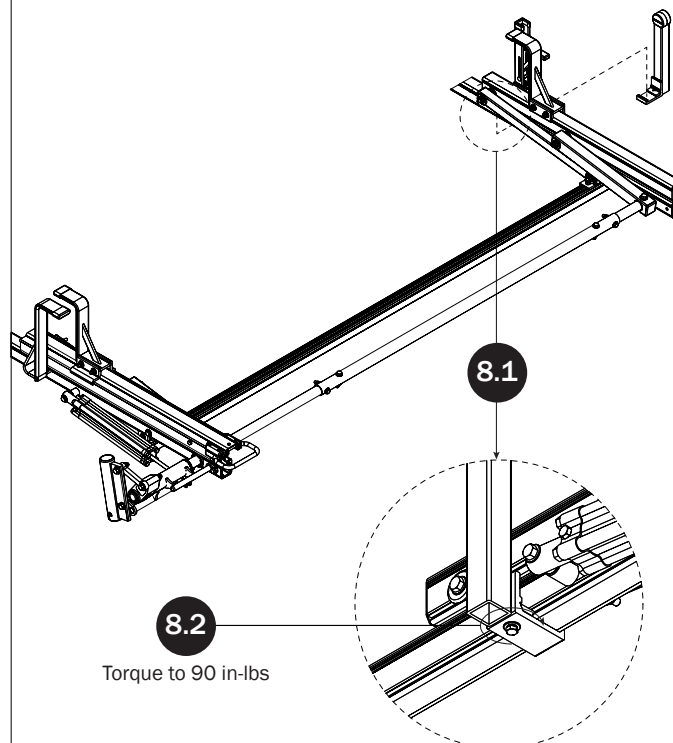

LEFT ROTATION ASSEMBLY SEQUENCE

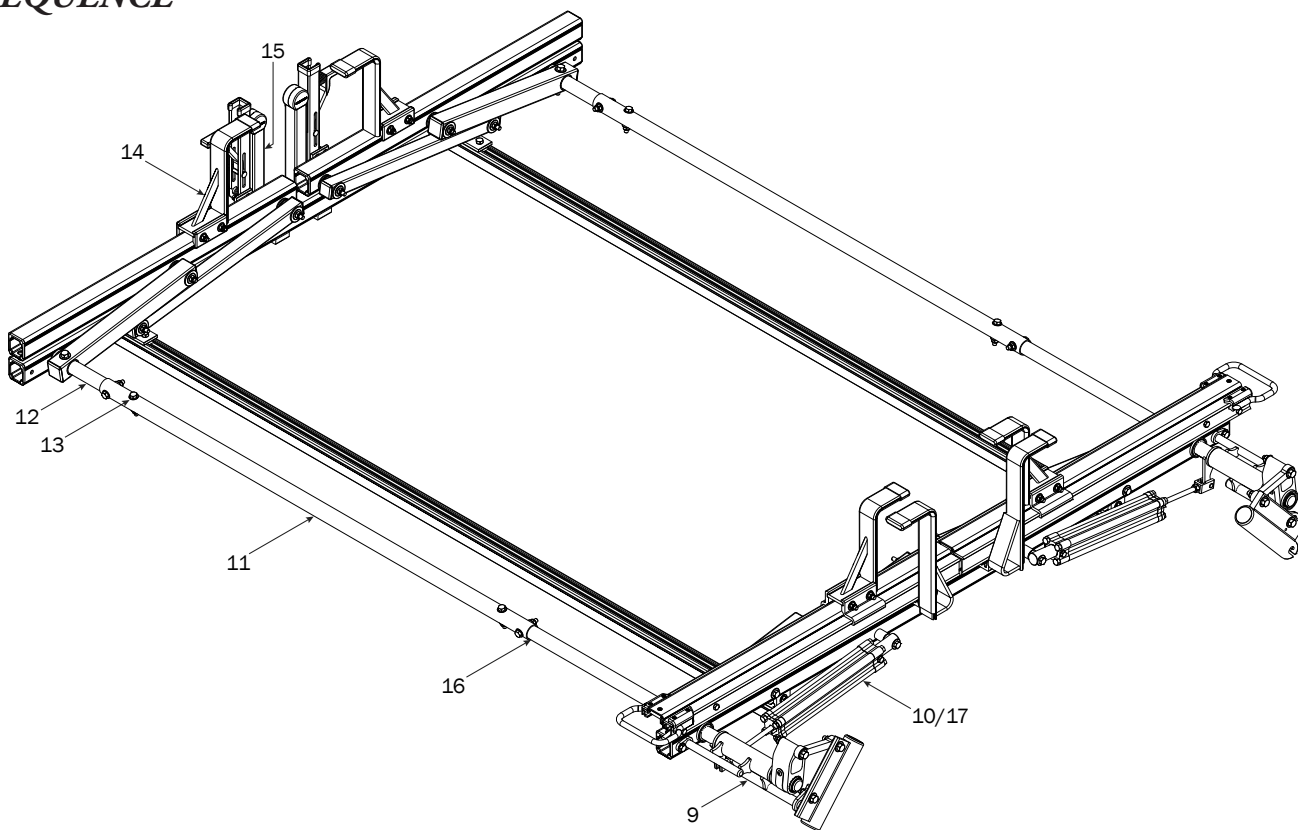

REAR DRIVE SHAFT

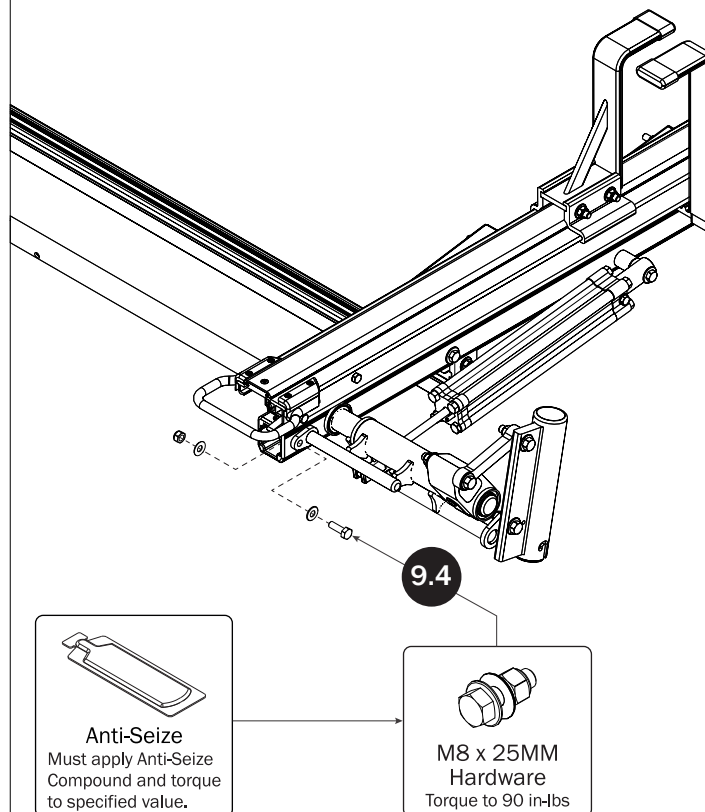
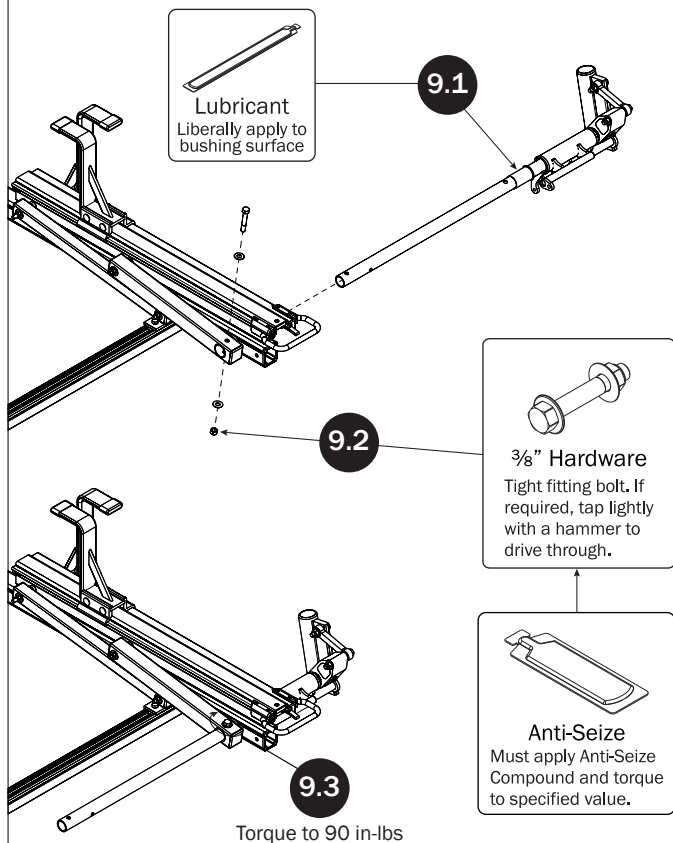

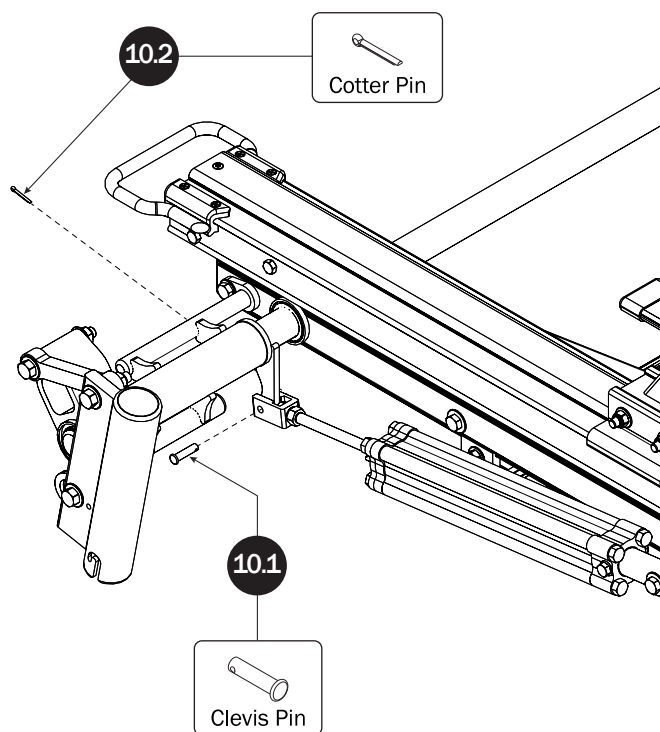
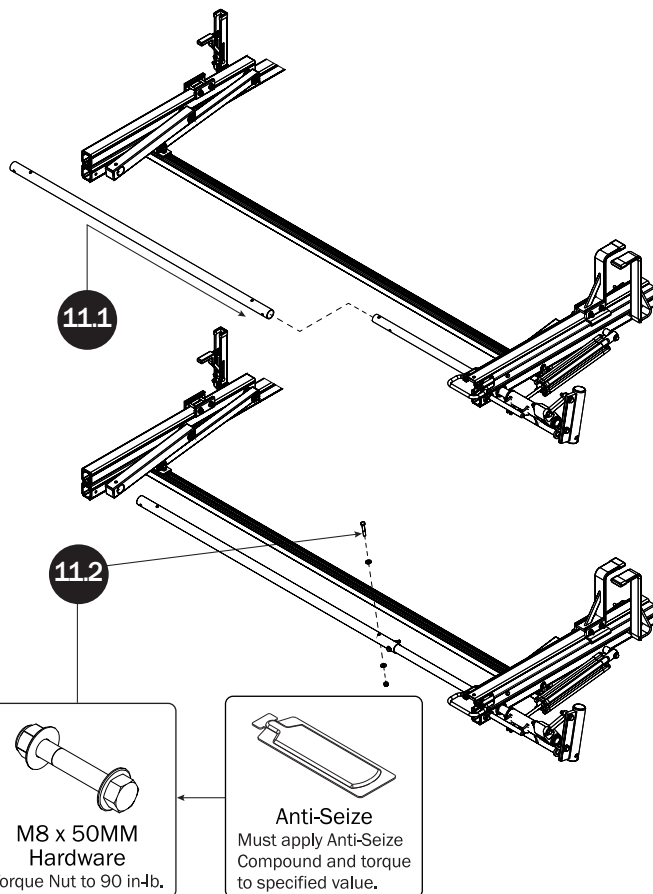
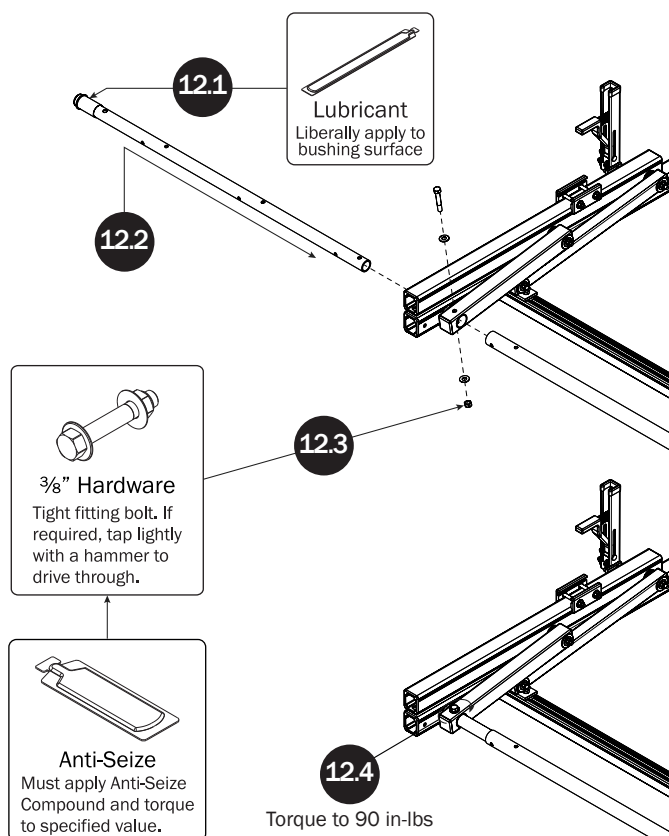
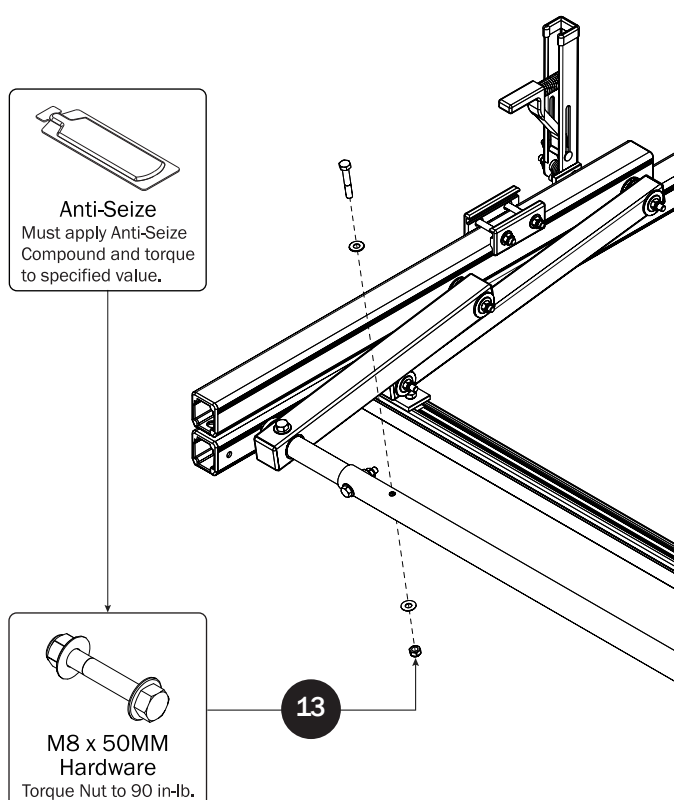
CYLINDER HARDWARE**CONNECTING BAR****FRONT DRIVE SHAFT****CONNECTING BAR FASTENERS**

Z POSTS

SEE QUICK START GUIDE FOR ADJUSTMENTS

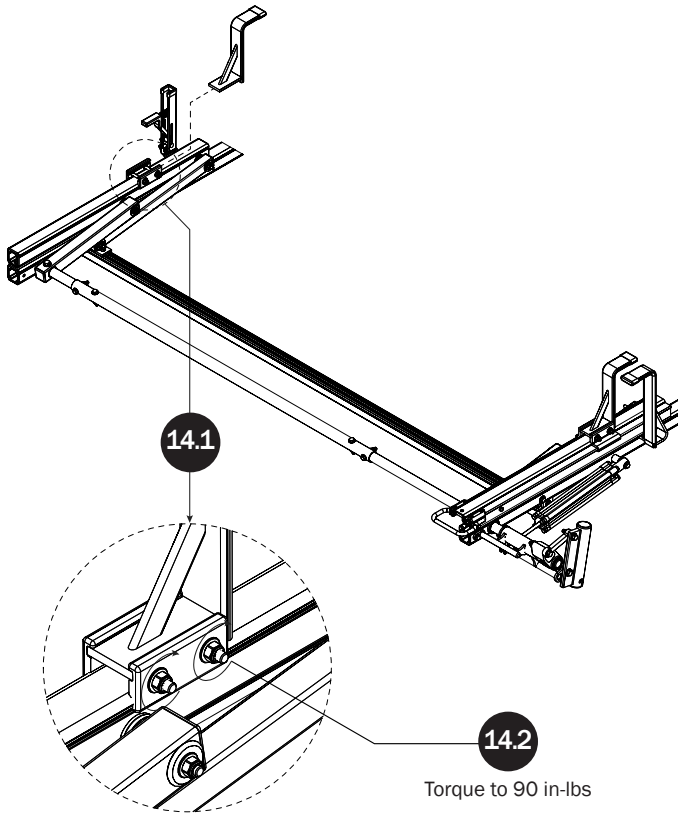

L POSTS

SEE QUICK START GUIDE FOR ADJUSTMENTS

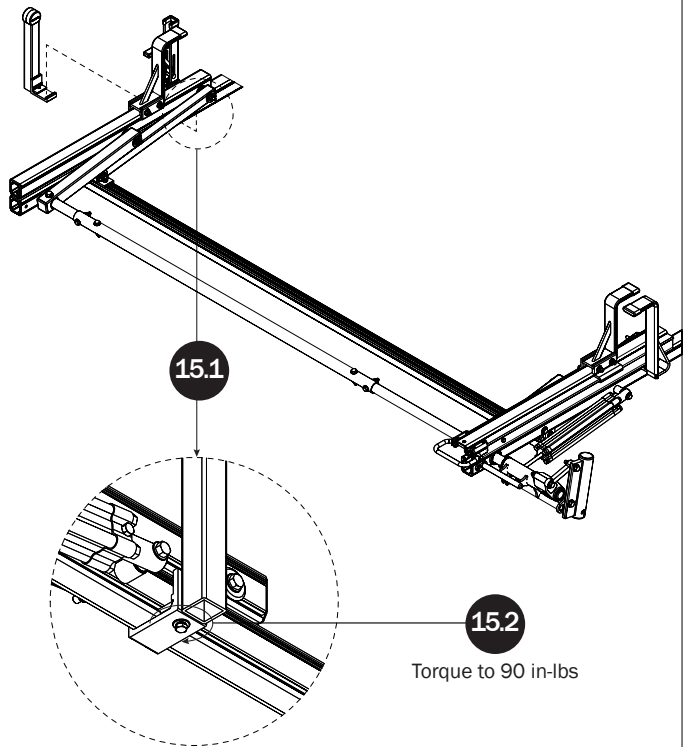

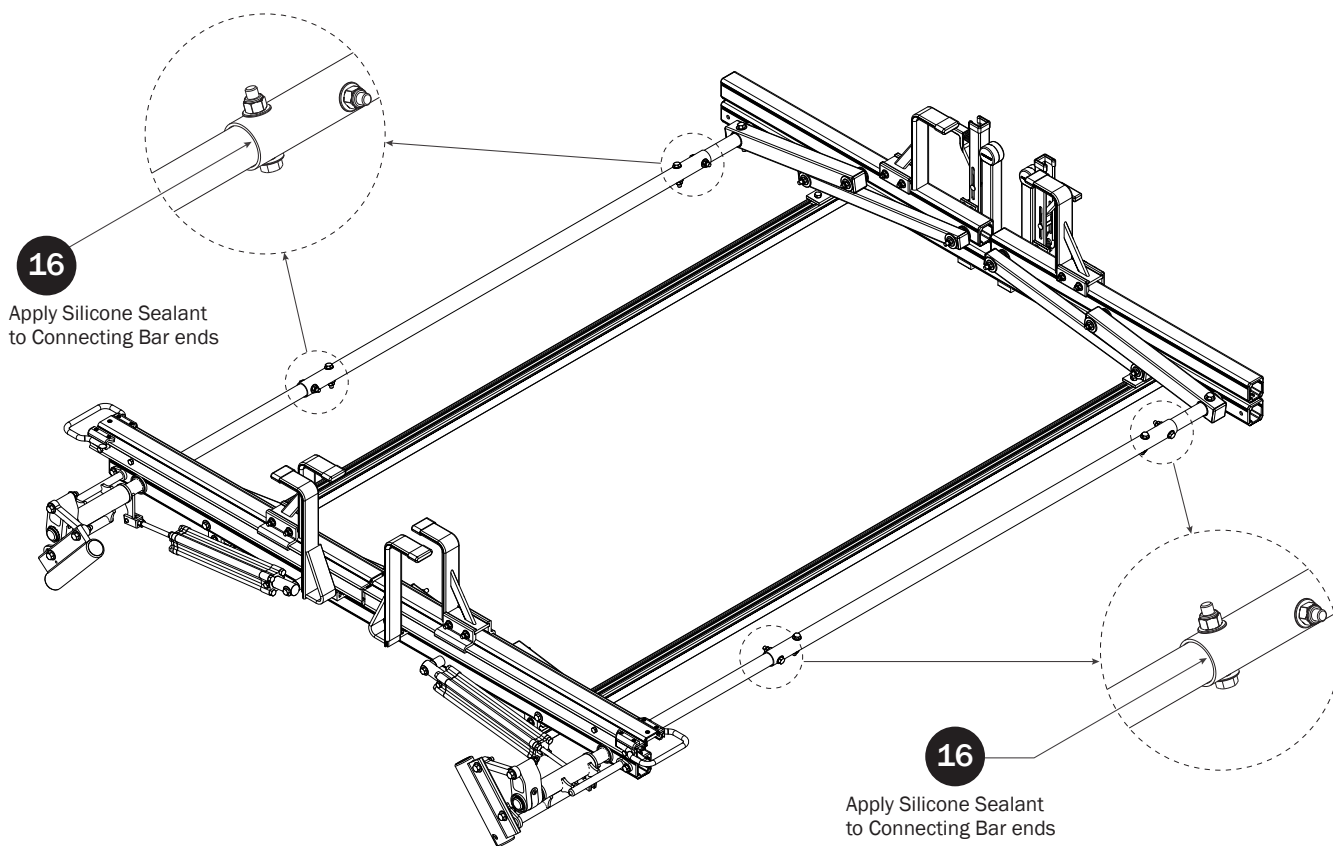
DRIVE SHAFT SEALING**CYLINDER ADJUSTMENT**

- 17** Adjust the Cylinder Flow Control Screw to allow approximately 3 seconds time for the ladder to glide down when operating the loaded Ladder Rack.

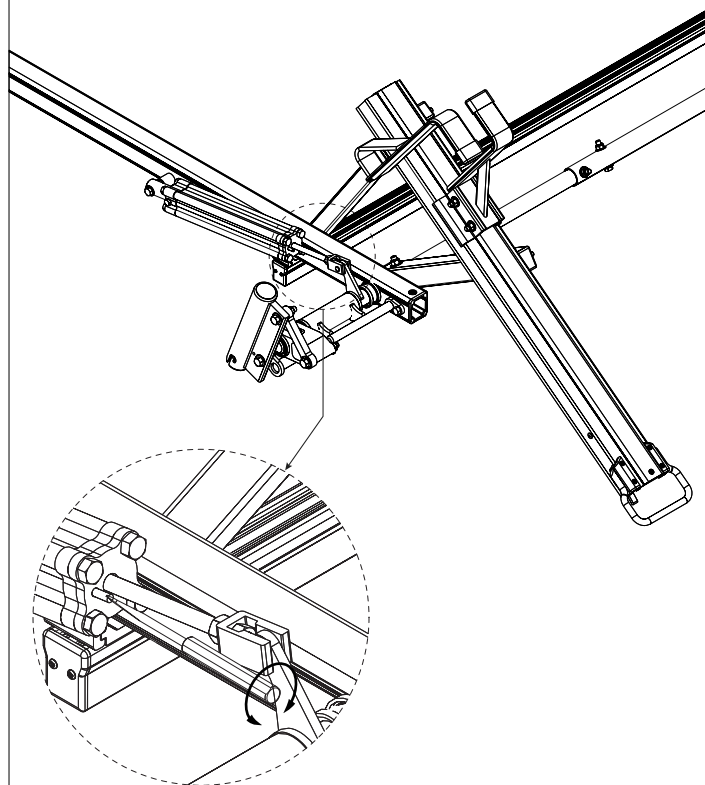

USAM-HRRE6000-US01 Rev-A 0118