

PRIME DESIGN™

A Safe Fleet Brand

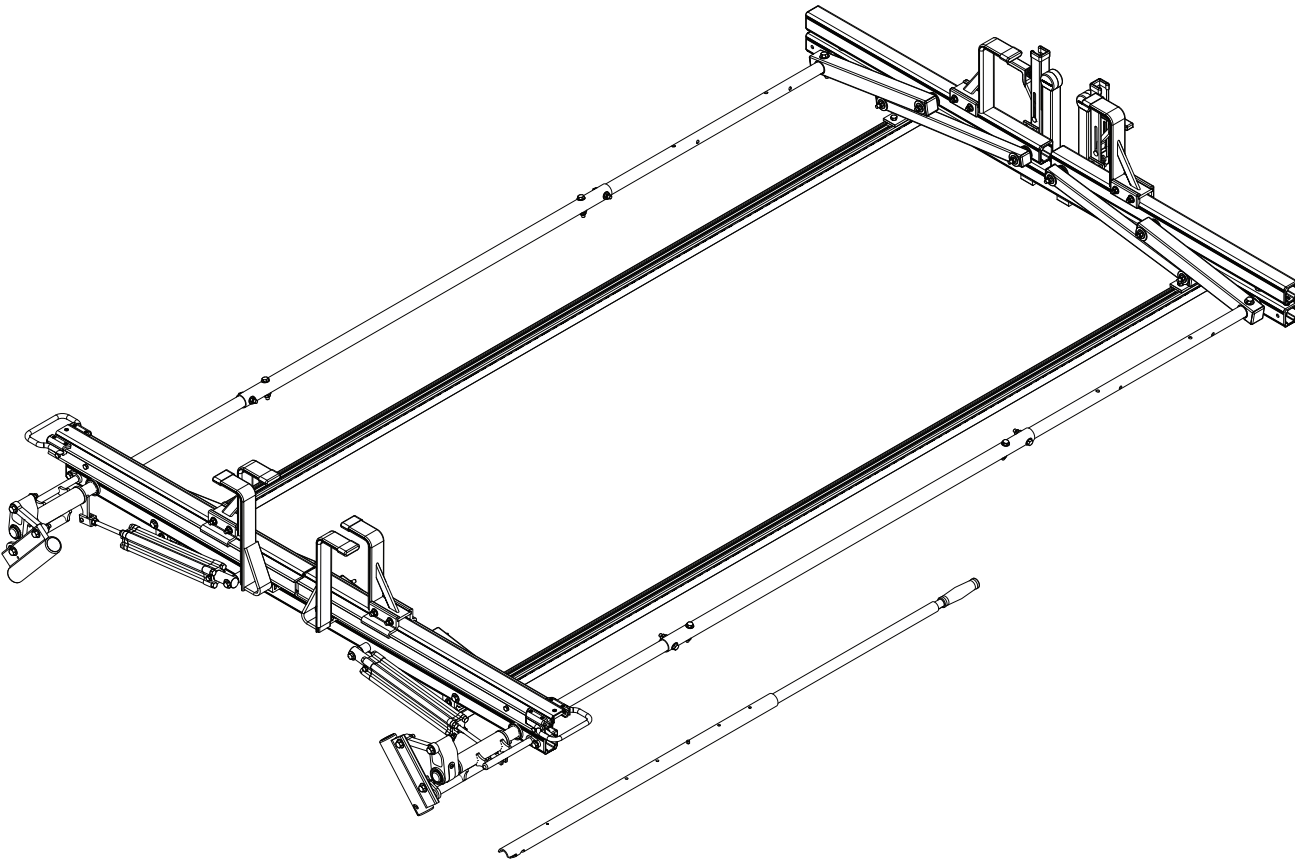

HRR-E

PRIME DESIGN, A SAFE FLEET BRAND

Address: 580 Opperman Drive, Eagan, MN 55123 • Toll Free: 1.8.PRIME.RACK
Fax: 651-552-1799 • Email: info@primedesign.net • Website: www.primedesign.net

CONTENTS OVERVIEW

INSTALLER NOTE: Mounting Hardware or Brackets to attach this rack to a vehicle roof or cap are not included in this kit, and must be purchased separately.

To purchase Mounting Hardware or Brackets, please contact Prime Design Sales & Support.

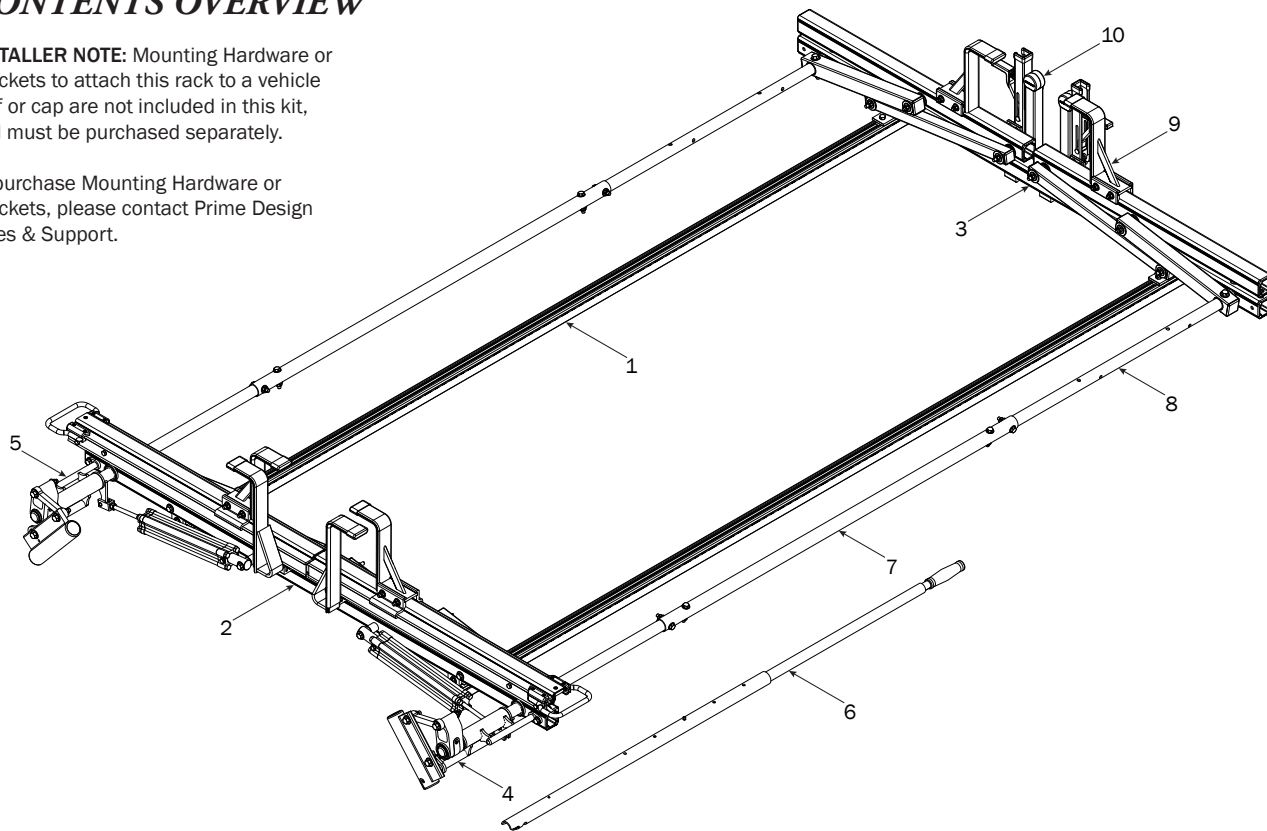

1—FBM-0002 (Qty 1)
Channels with hardware

Channels (2X)



Screws (8X)



End Caps (4X)



Brackets (4X)

2—Rear Crossbar Assembly..... (Qty 1)

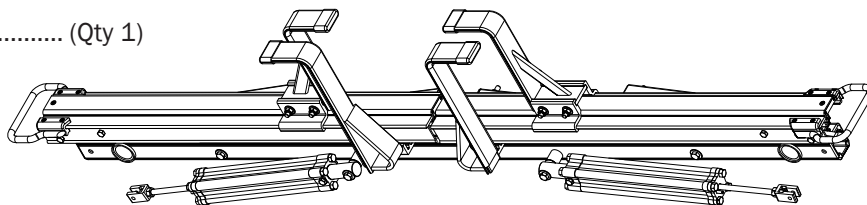

3—Front Crossbar Assembly (Qty 1)

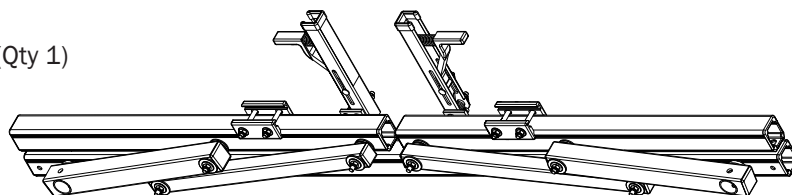

4—Rear Drive Shaft (Qty 1)
Right Hand, G4, 33.50"

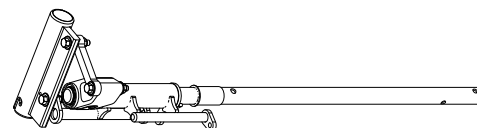

5—Rear Drive Shaft (Qty 1)
Left Hand, G4, 33.50"

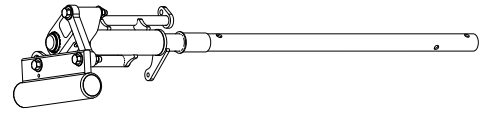

6—HRR Handle Assembly (Qty 1)
35.00"

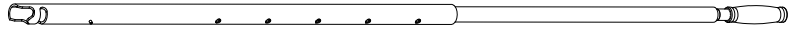

7—Connecting Bar (Qty 1)
48.00"

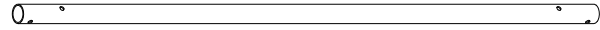

8—Front Drive Shaft (Qty 1)
B Version, 35.75"

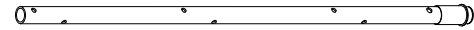

9—Z Post (Qty 1)
Adjustable 7.25"

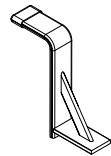

10—L Post (Qty 1)
Roller Cap, 9.25"

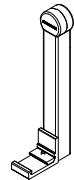

11—HKT-8163 (Not called out in Overview)..... (Qty 2)

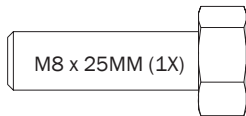

M8 x 25MM (1X)

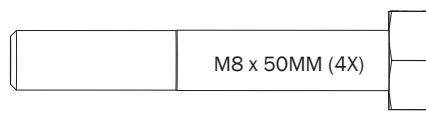

M8 x 50MM (4X)

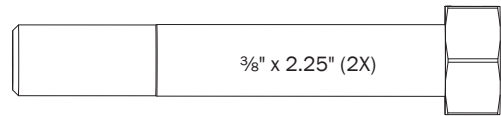

3/8" x 2.25" (2X)

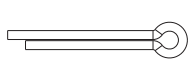

Cotter Pin (1X)



Clevis Pin (1X)

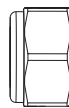

M8 Lock Nut (5X)



3/8" Lock Nut (2X)

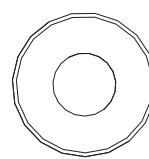

5/16" Flat Washer (10X)

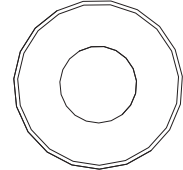

3/8" Flat Washer (4X)

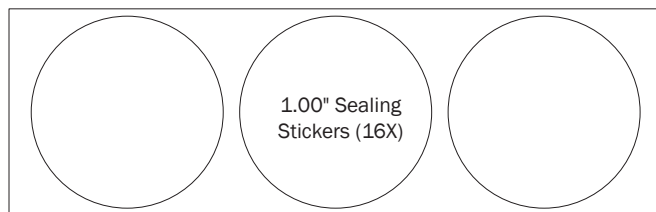

1.00" Sealing
Stickers (16X)



Anti-Seize (1X)

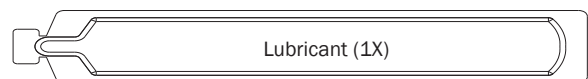

Lubricant (1X)

FBM-0002 FLUSH CHANNELS TO PRE-INSTALLED MOUNTING BRACKETS

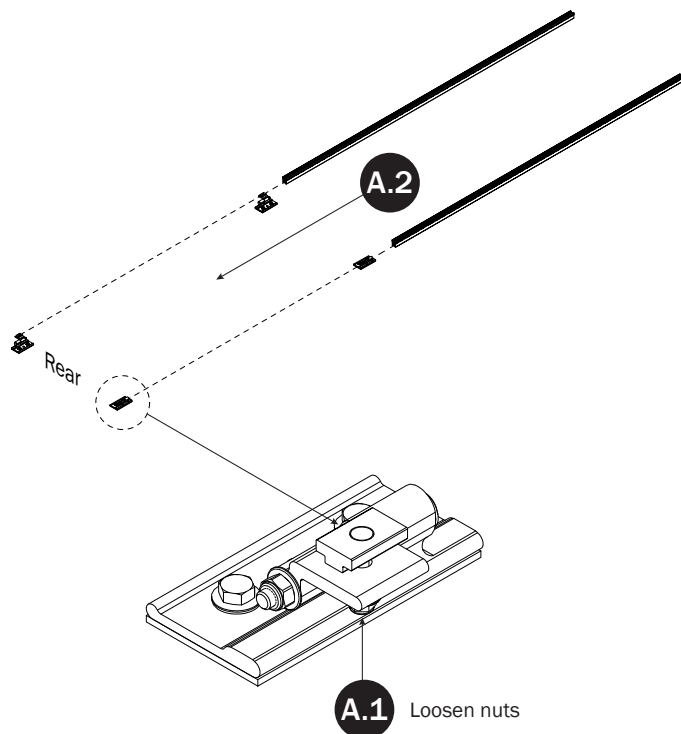

A.3 Set to distances then torque nuts to 80 in-lbs

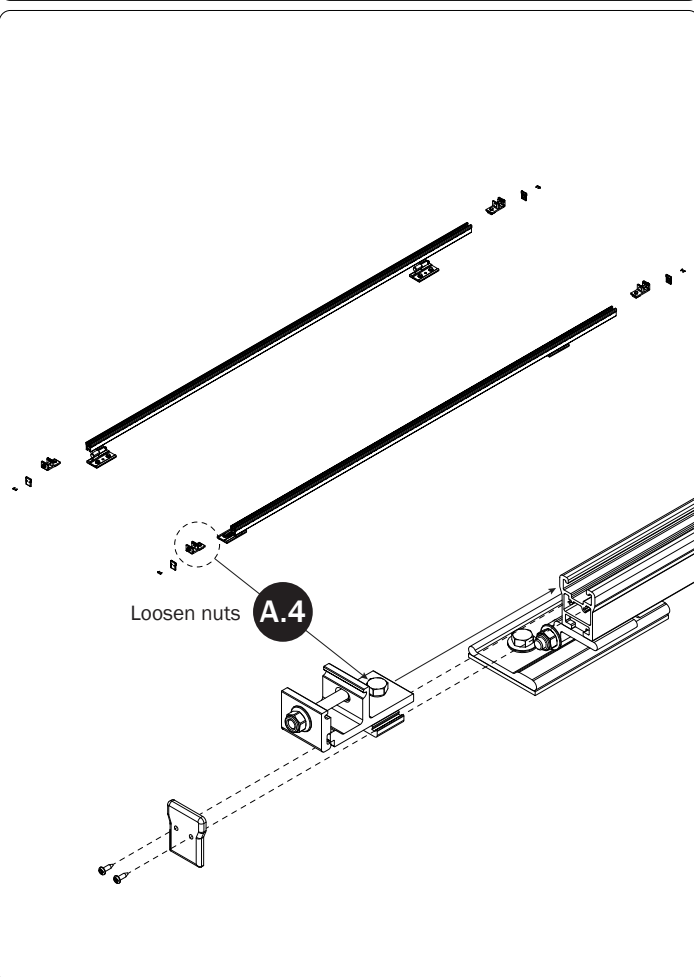
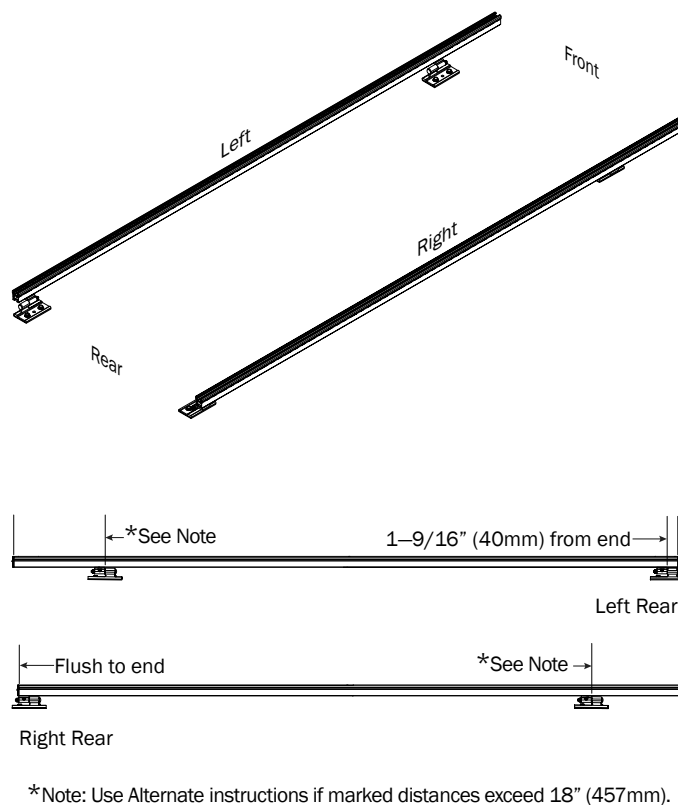

A.5 Set to distances then torque Rear Bracket nuts to 90 in-lbs

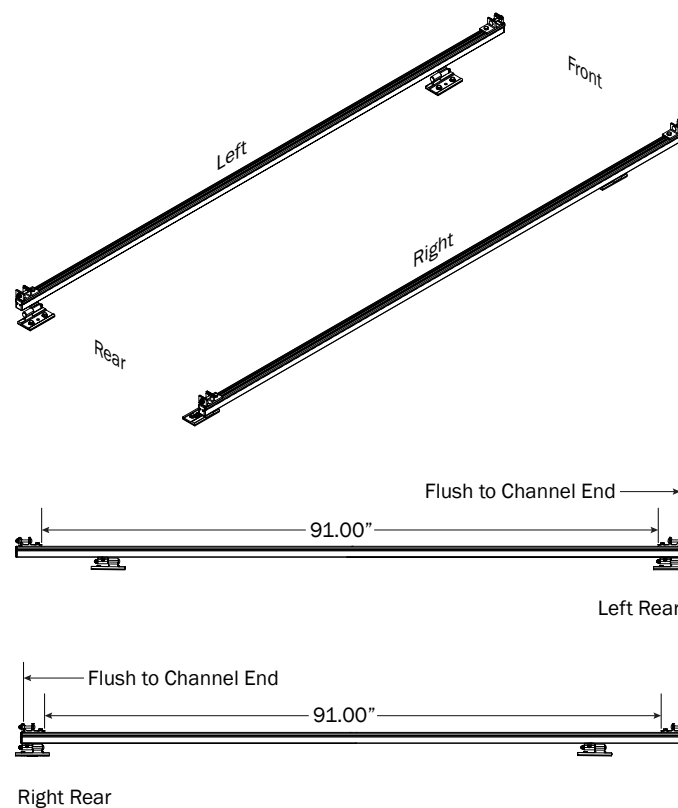

FBM-0002 ALTERNATE CHANNELS TO PRE-INSTALLED MOUNTING BRACKETS

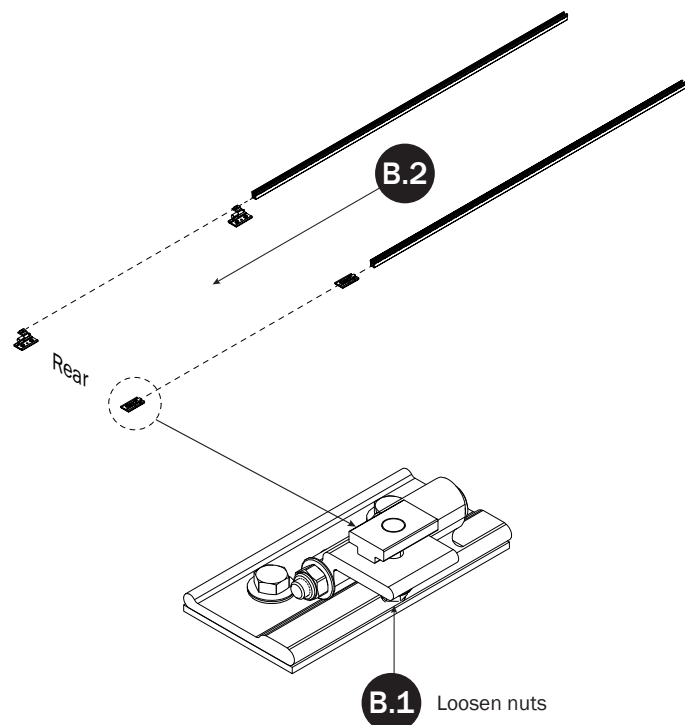

B.3 Set to distances then torque nuts to 80 in-lbs

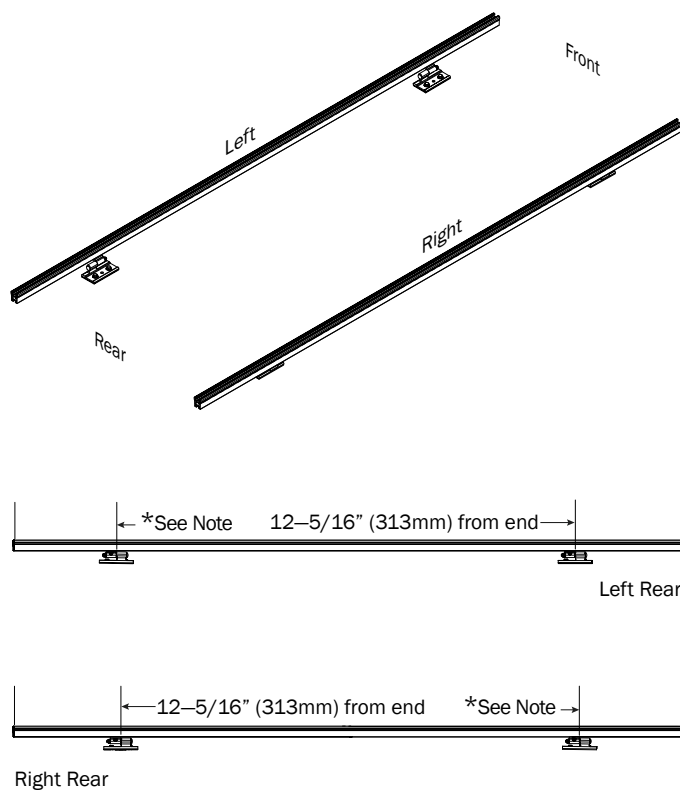

*Note: Move Channels rearward if marked front distance exceeds 18" (457mm).

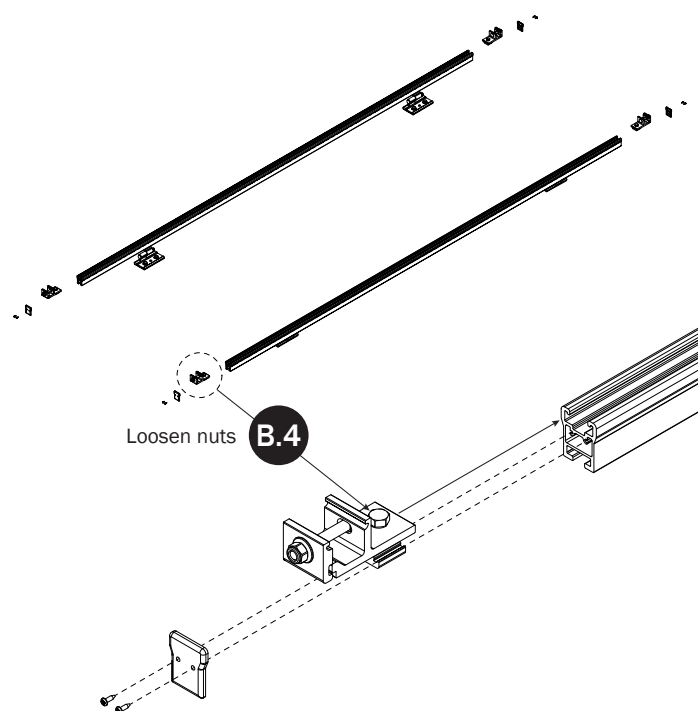

B.5 Set to distances then torque Rear Bracket nuts to 90 in-lbs

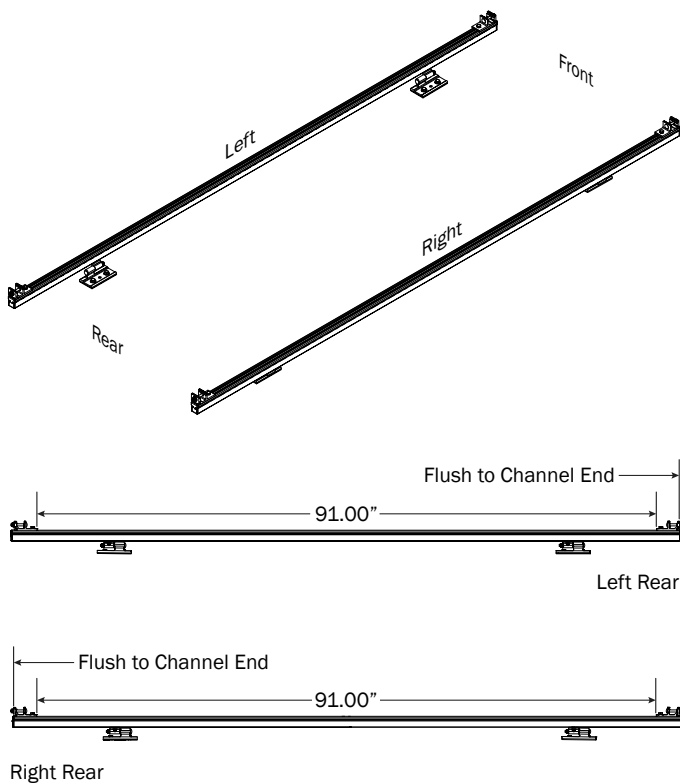

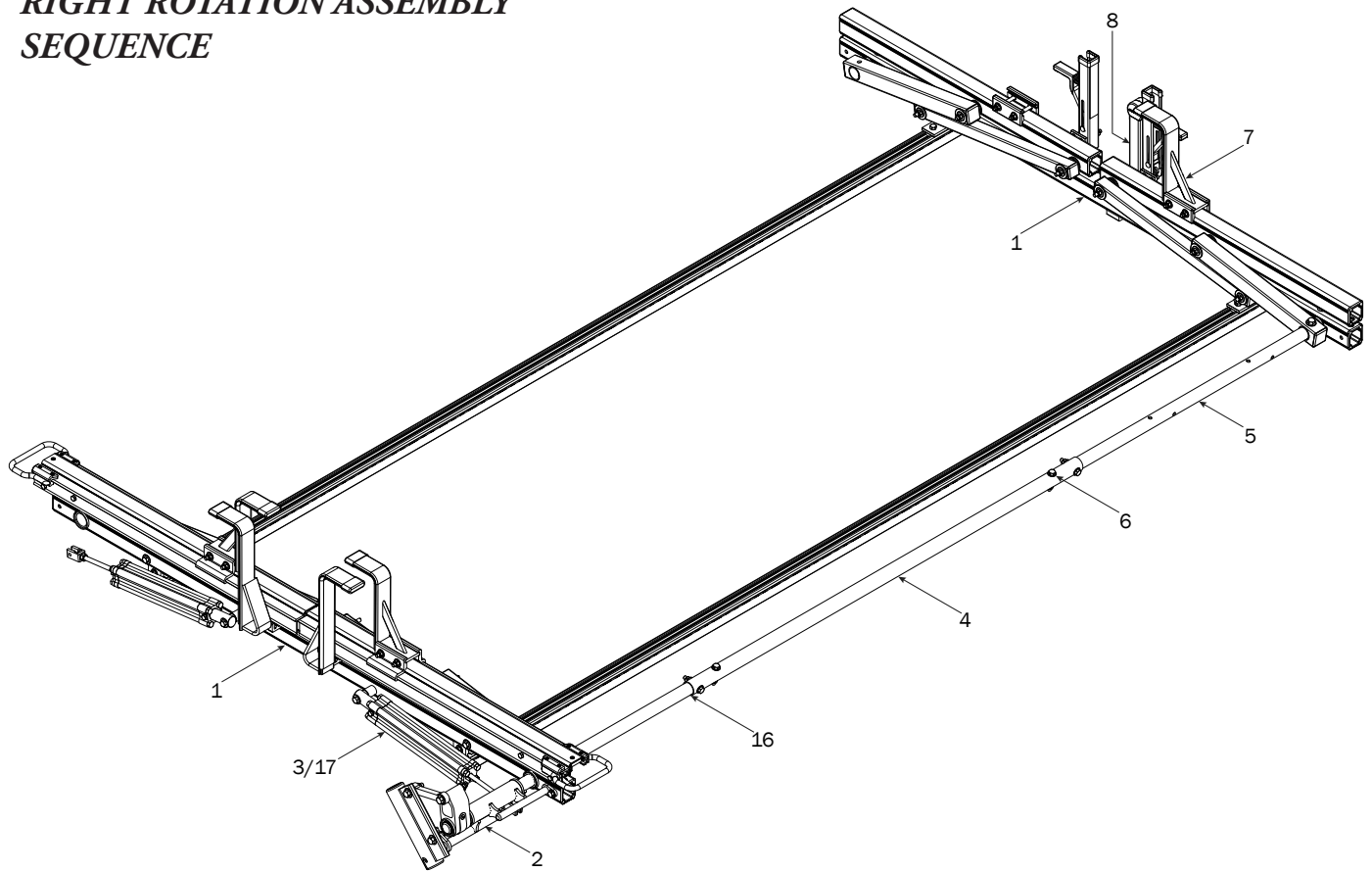
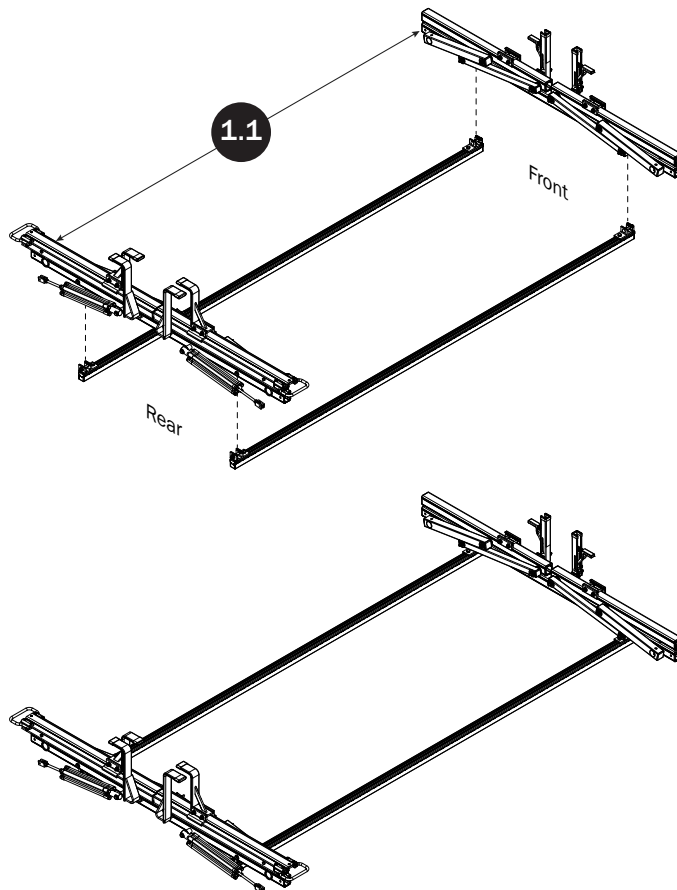
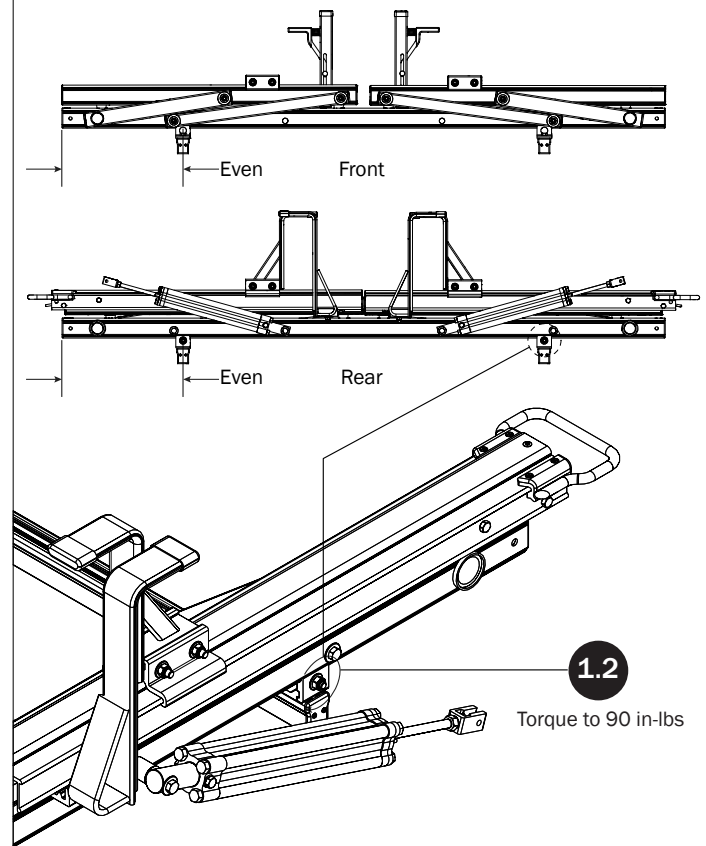
**RIGHT ROTATION ASSEMBLY
SEQUENCE****CROSSBARS****CROSSBAR ADJUSTMENT**

REAR DRIVE SHAFT

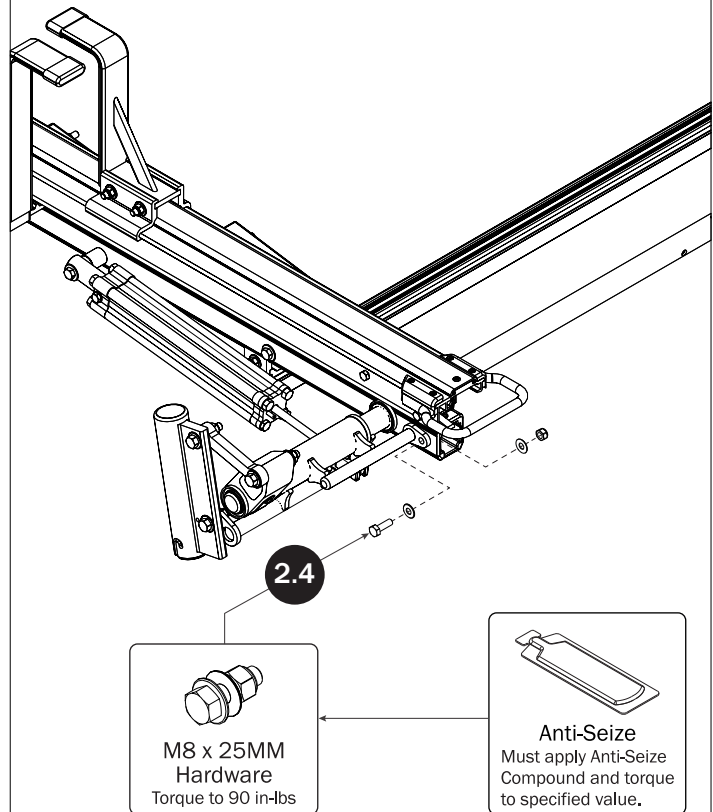
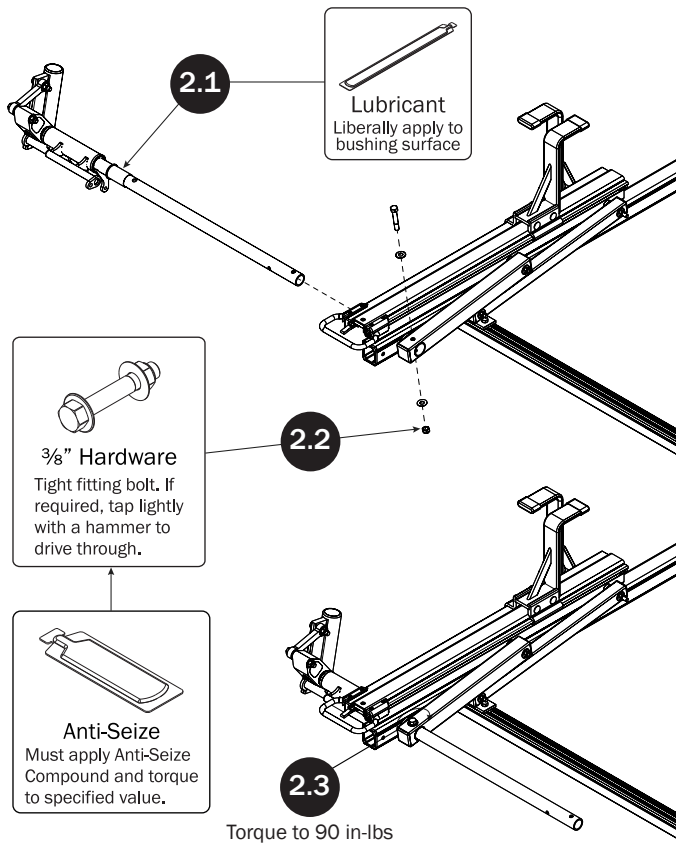

CYLINDER HARDWARE

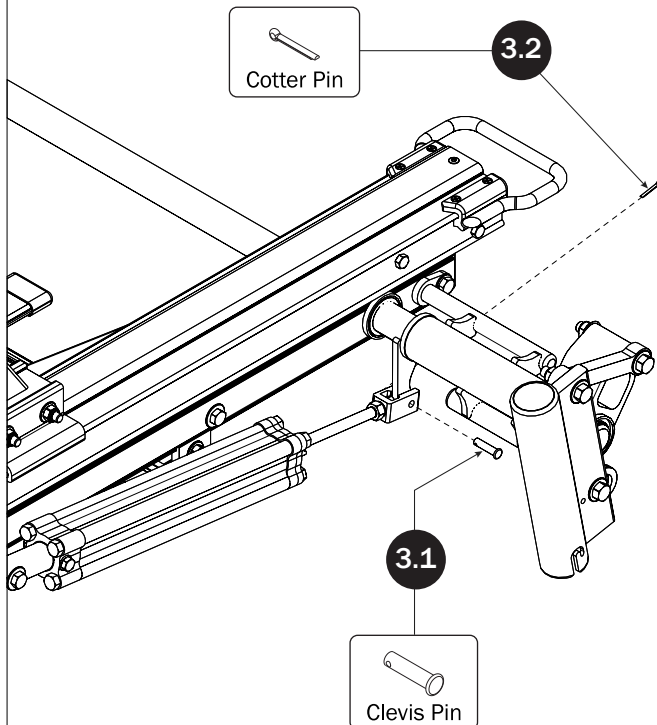

CONNECTING BAR

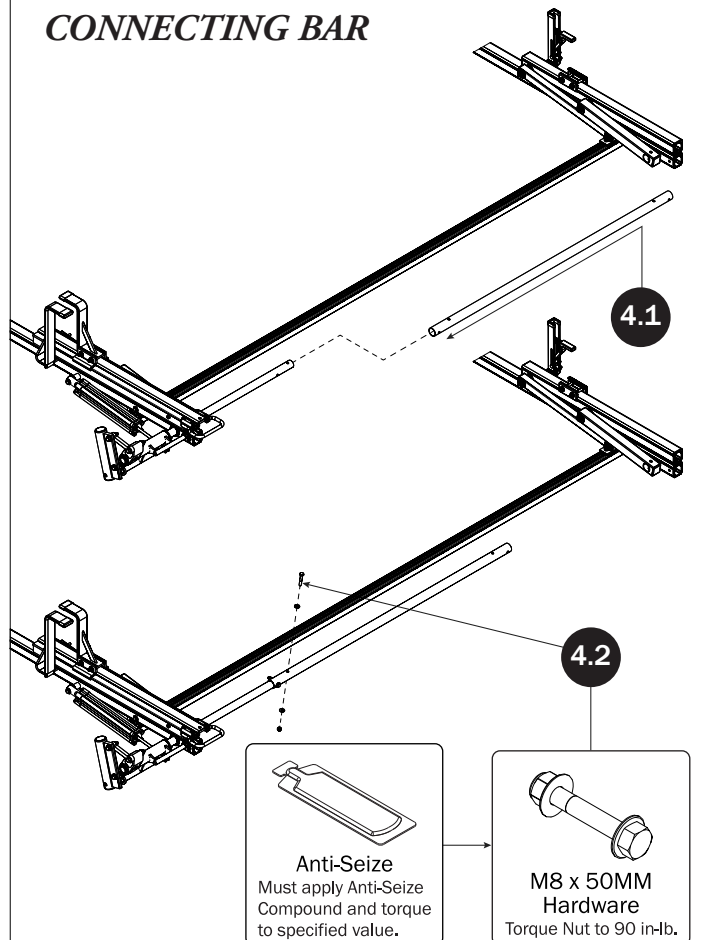

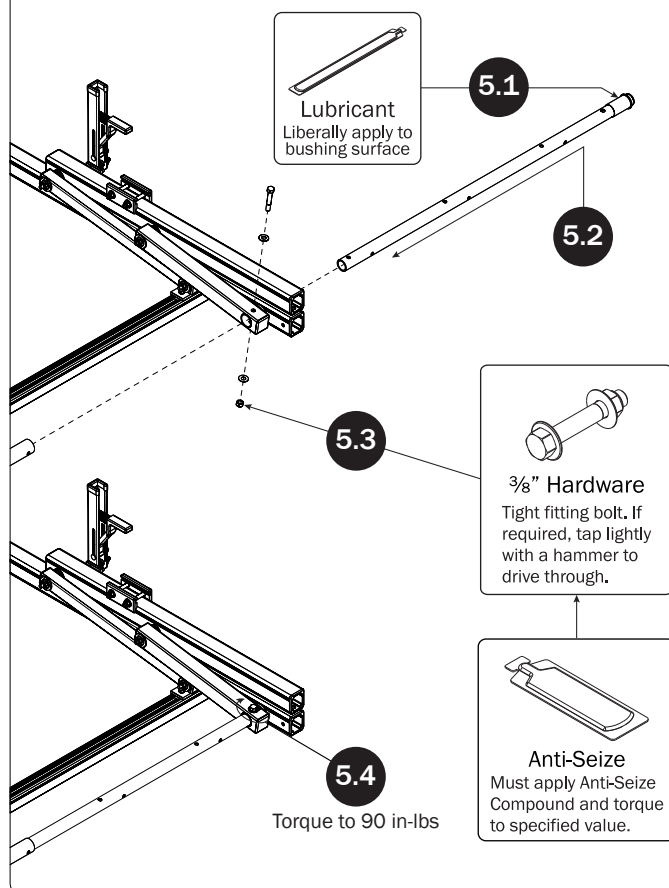
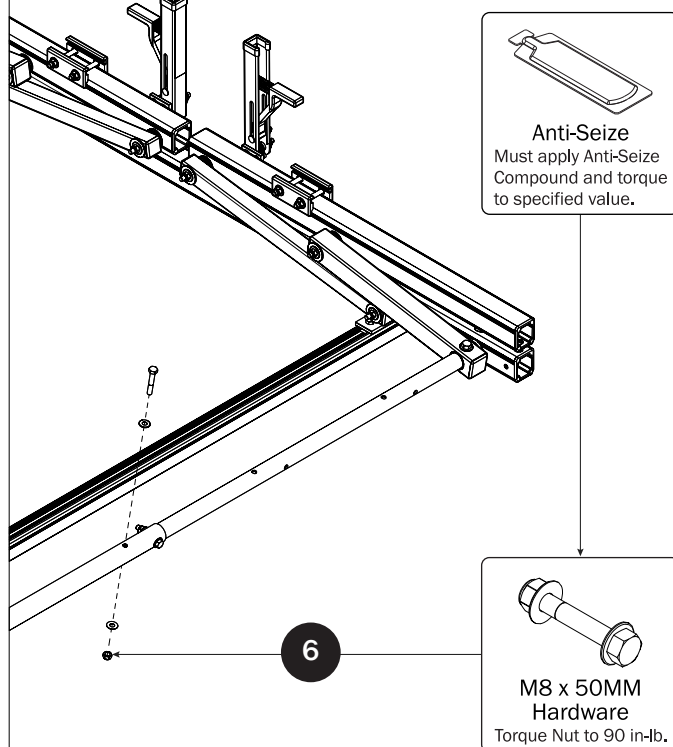
FRONT DRIVE SHAFT**CONNECTING BAR FASTENERS****Z POSTS**

SEE QUICK START GUIDE FOR ADJUSTMENTS

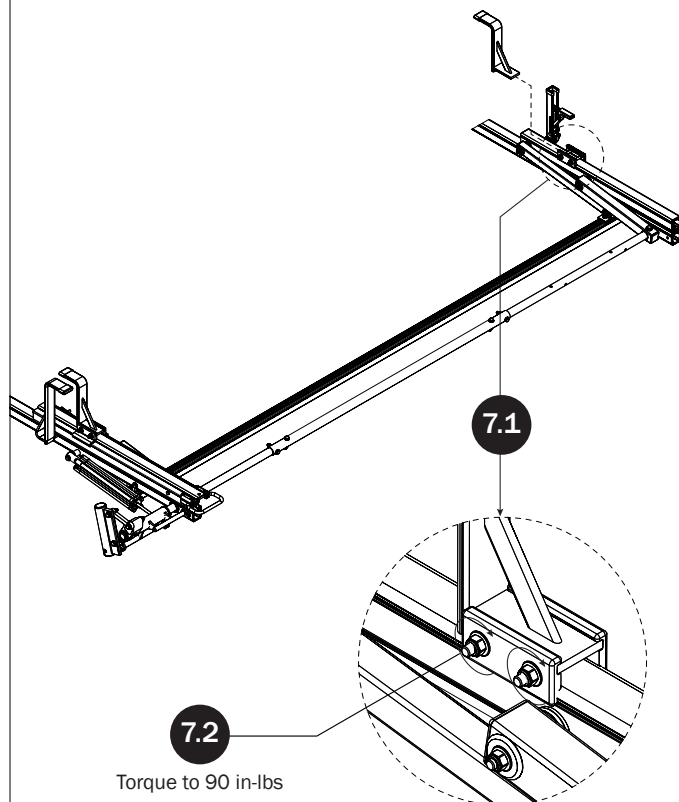
**L POSTS**

SEE QUICK START GUIDE FOR ADJUSTMENTS

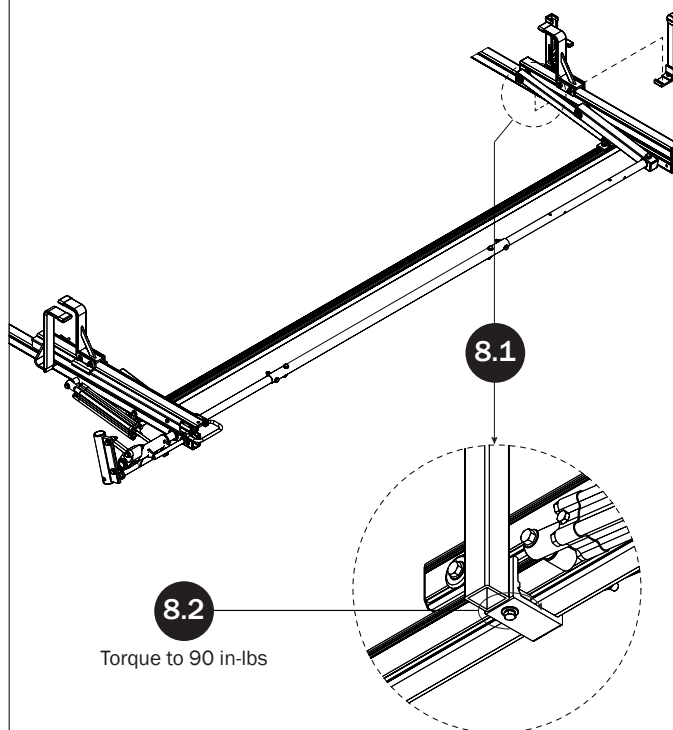

LEFT ROTATION ASSEMBLY SEQUENCE

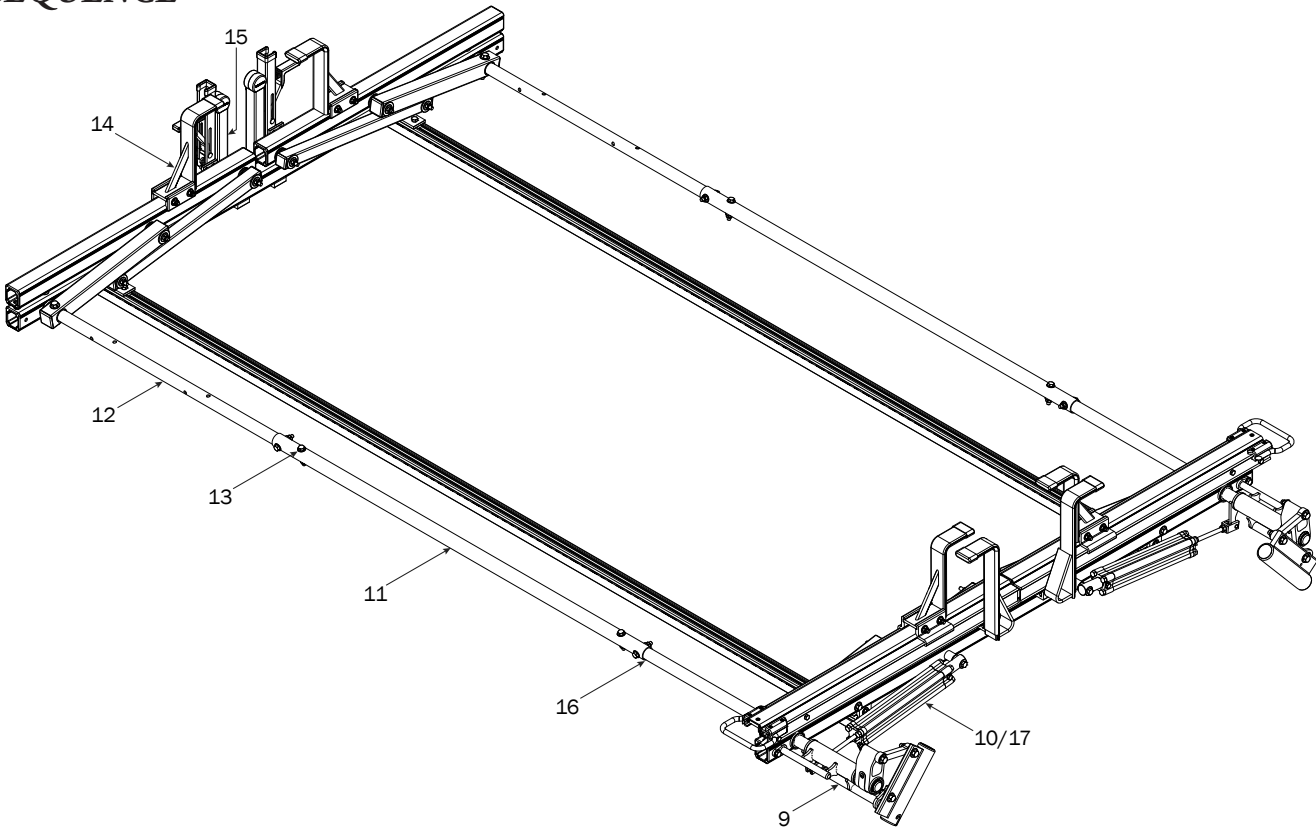

REAR DRIVE SHAFT

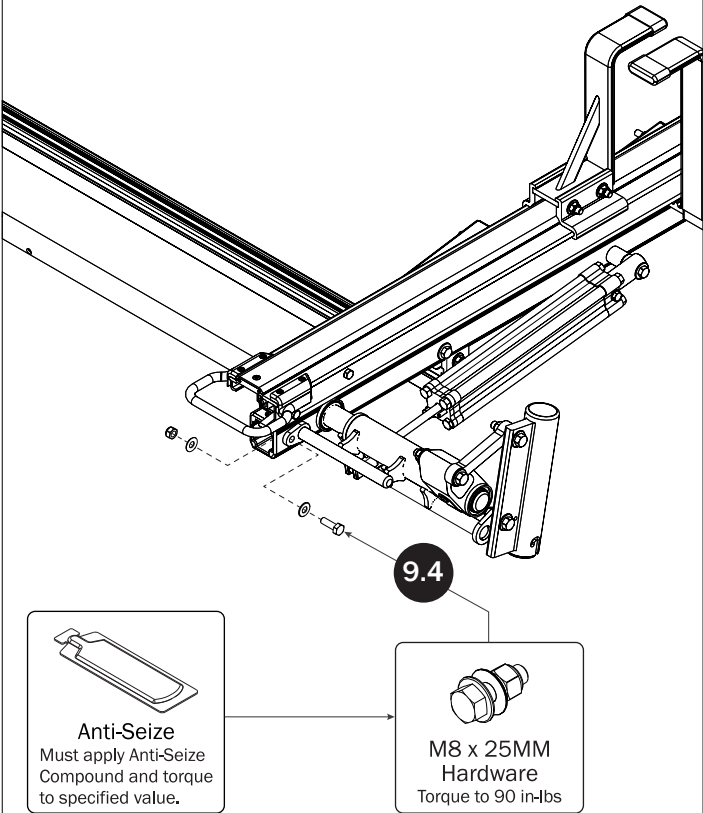
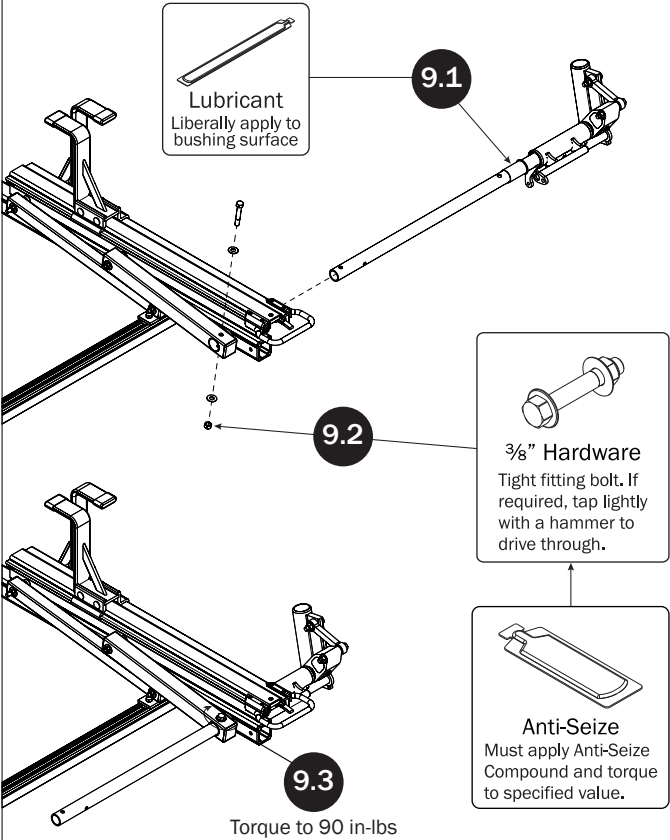

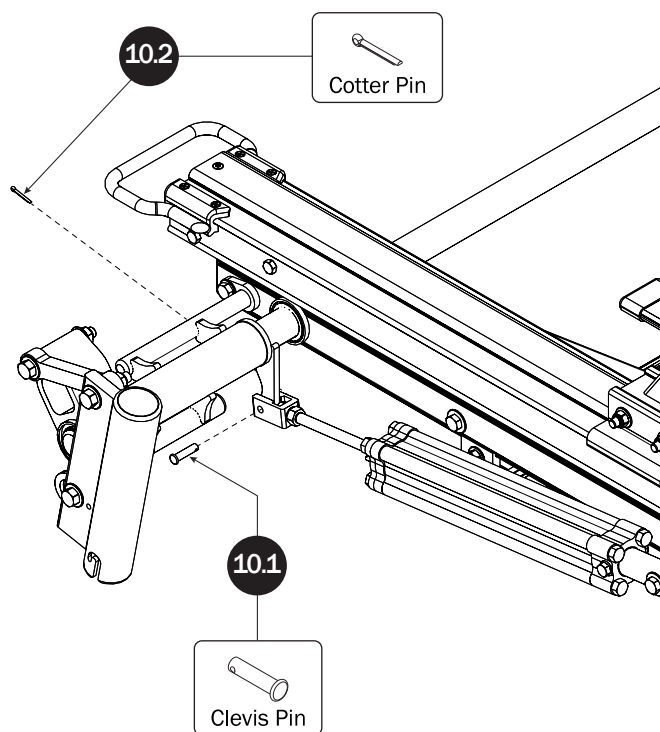
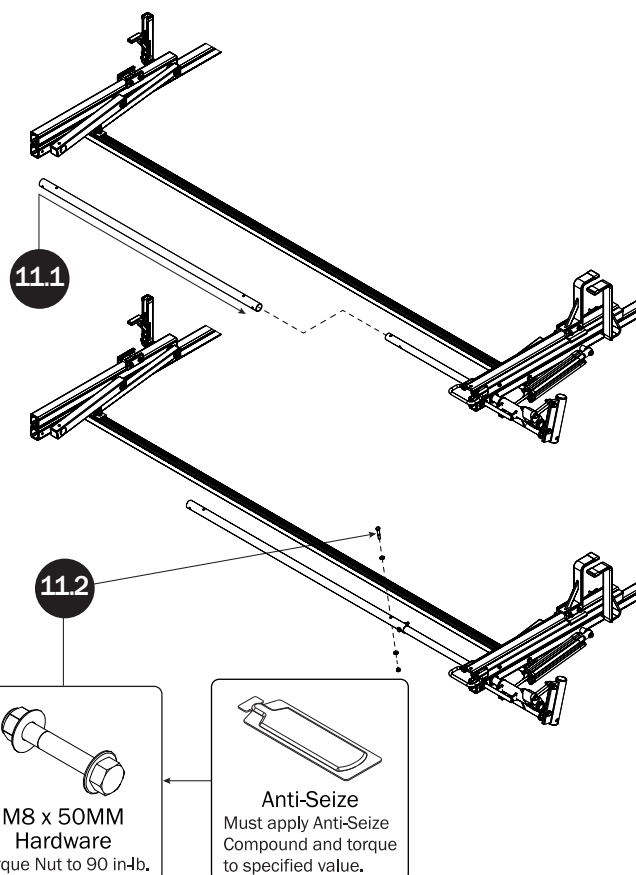
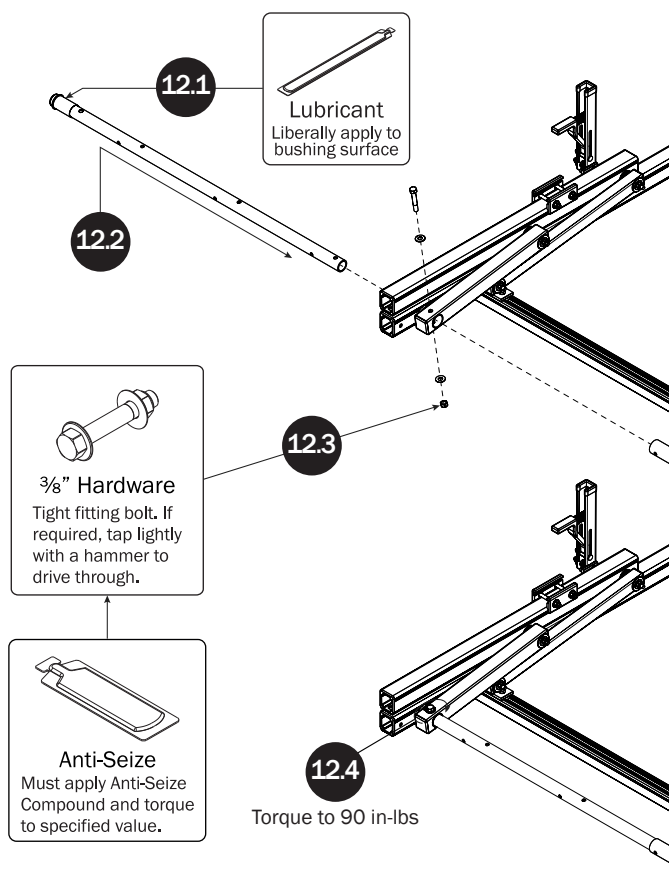
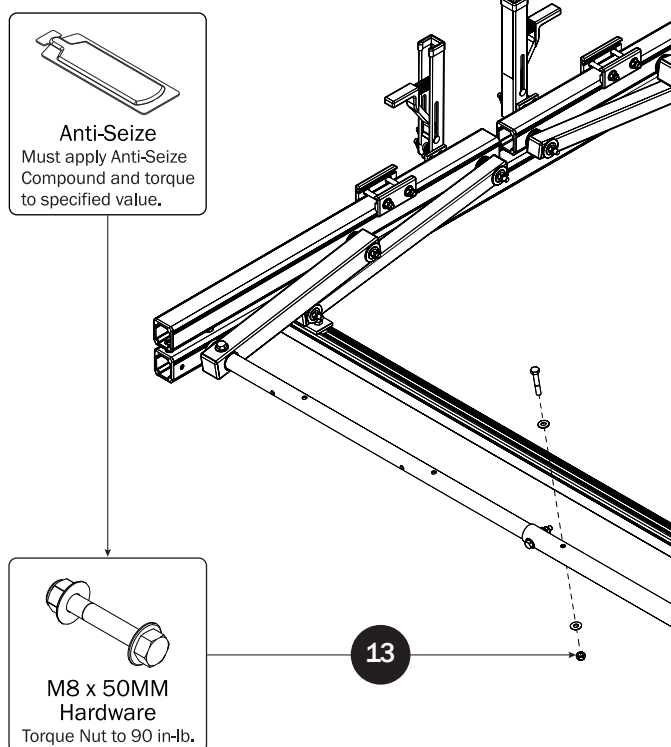
CYLINDER HARDWARE**CONNECTING BAR****FRONT DRIVE SHAFT****CONNECTING BAR FASTENERS**

Z POSTS

SEE QUICK START GUIDE FOR ADJUSTMENTS

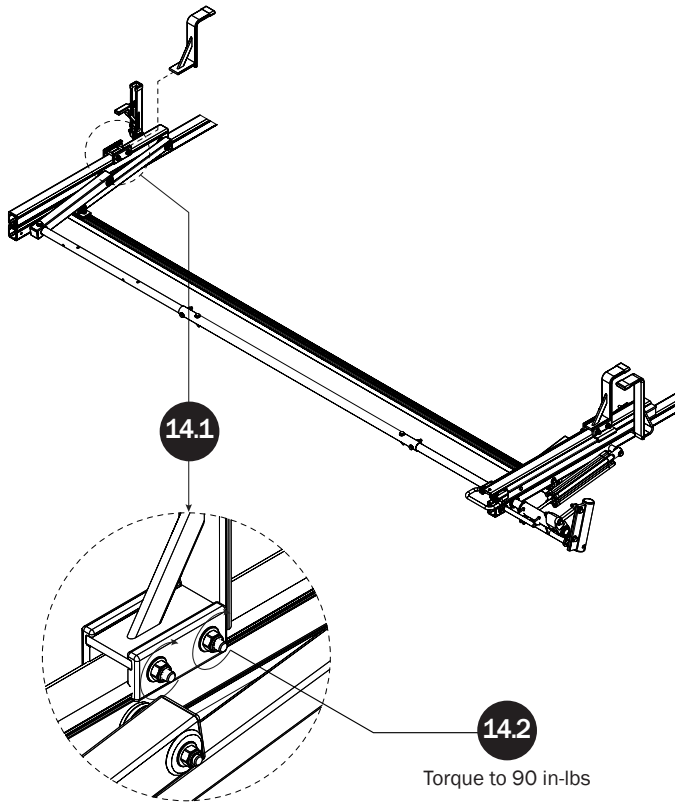

L POSTS

SEE QUICK START GUIDE FOR ADJUSTMENTS

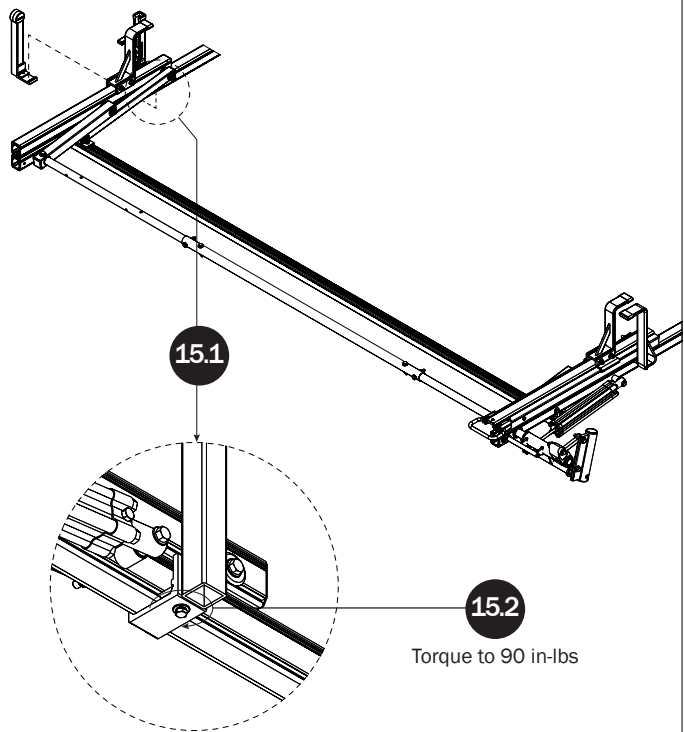

DRIVE SHAFT SEALING

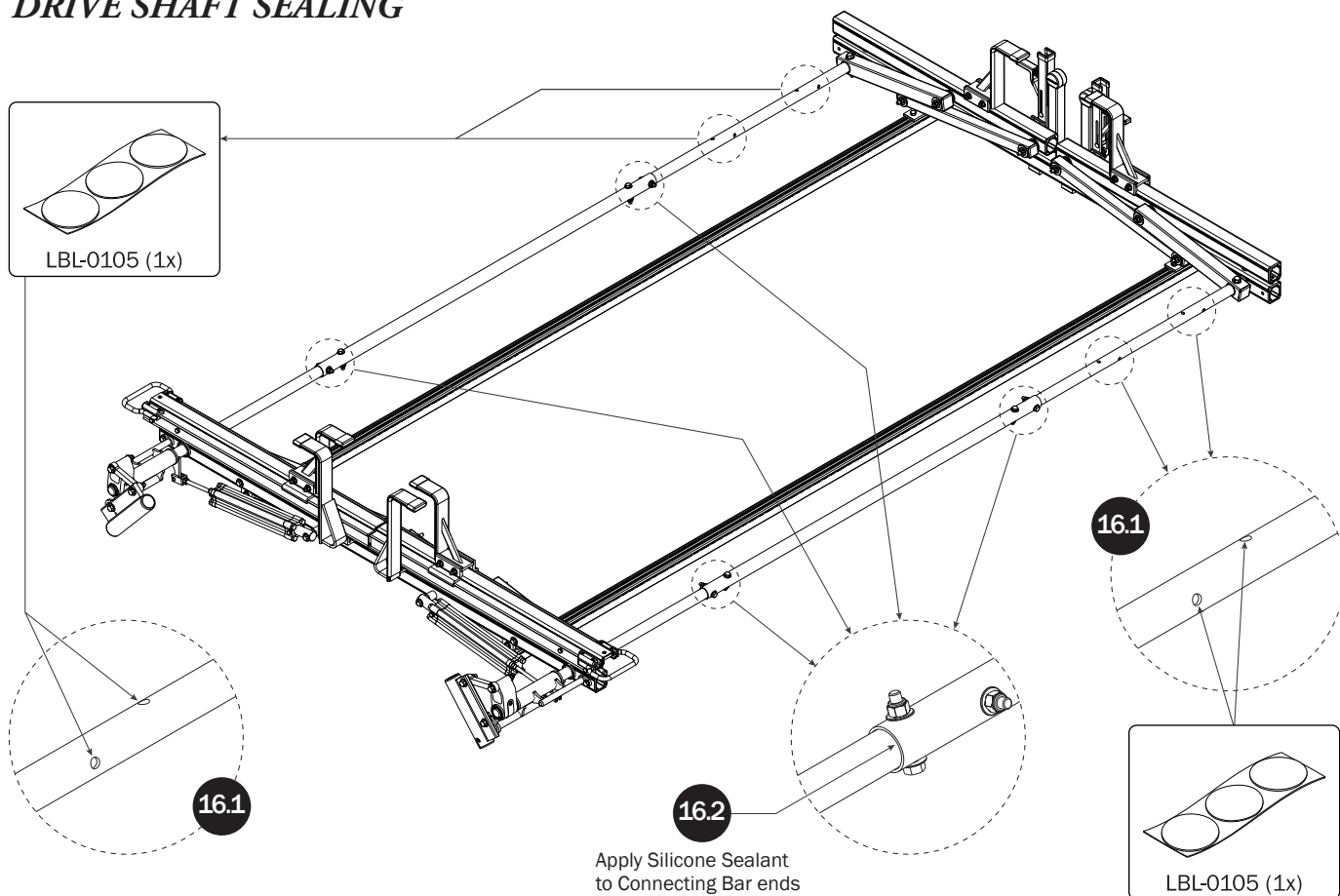

CYLINDER ADJUSTMENT

- 17** Adjust the Cylinder Flow Control Screw to allow approximately 3 seconds time for the ladder to glide down when operating the loaded Ladder Rack.

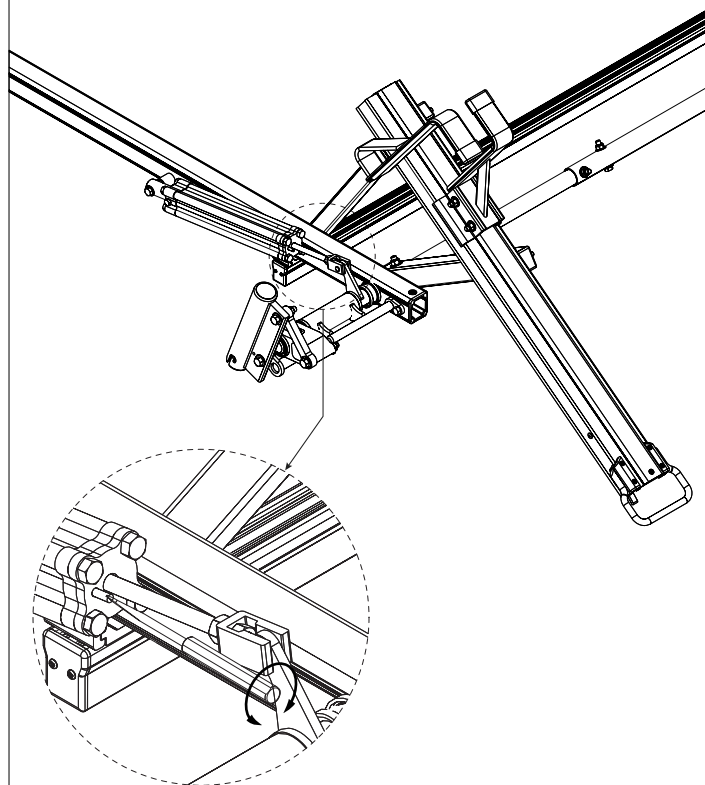

USAM-HRRE6001-US01 Rev-A 0118