

PRIME DESIGN™

A Safe Fleet Brand

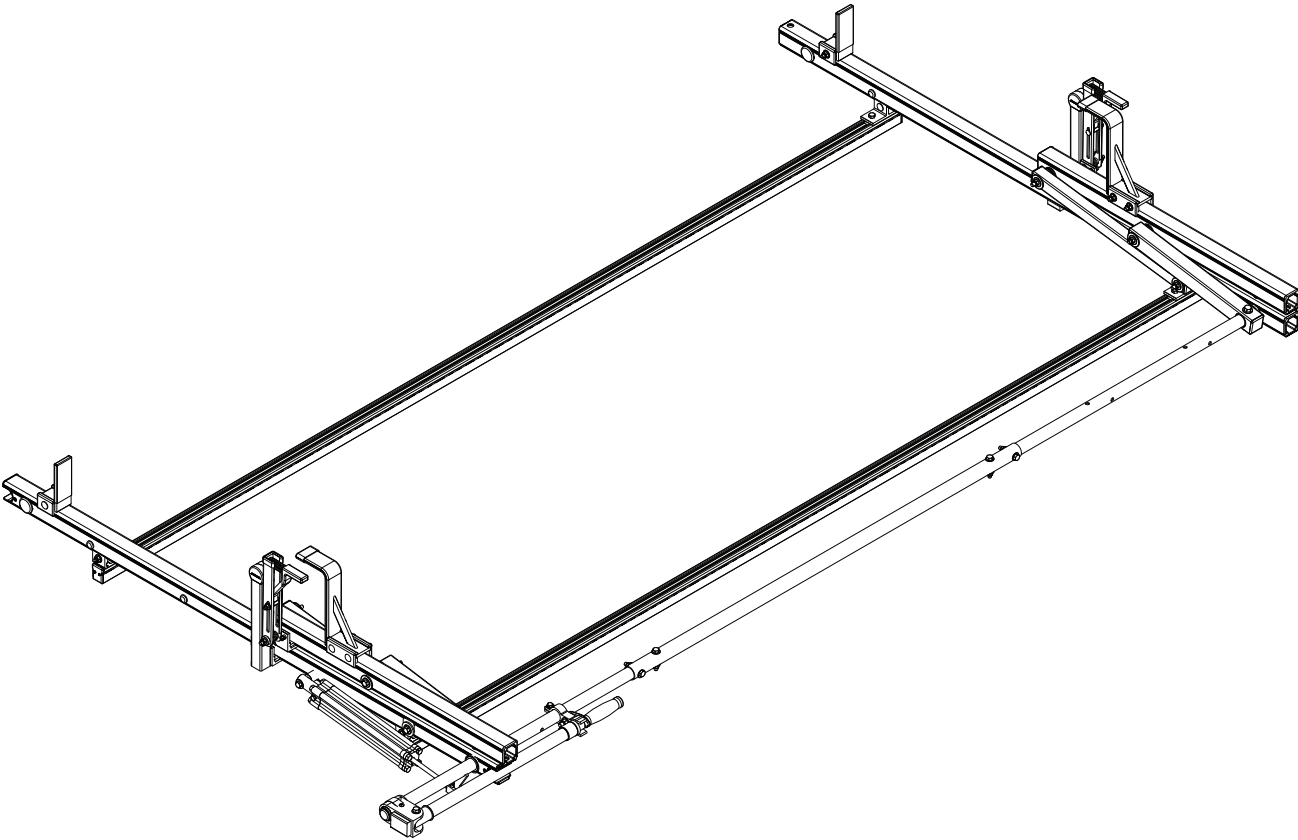

GOO
PBR

PRIME DESIGN, A SAFE FLEET BRAND

Address: 580 Opperman Drive, Eagan, MN 55123 • Toll Free: 1.8.PRIME.RACK

Fax: 651-552-1799 • Email: info@primedesign.net • Website: www.primedesign.net

CONTENTS OVERVIEW

INSTALLER NOTE: Mounting Hardware or Brackets to attach this rack to a vehicle roof or cap are not included in this kit, and must be purchased separately.

To purchase Mounting Hardware or Brackets, please contact Prime Design Sales & Support.

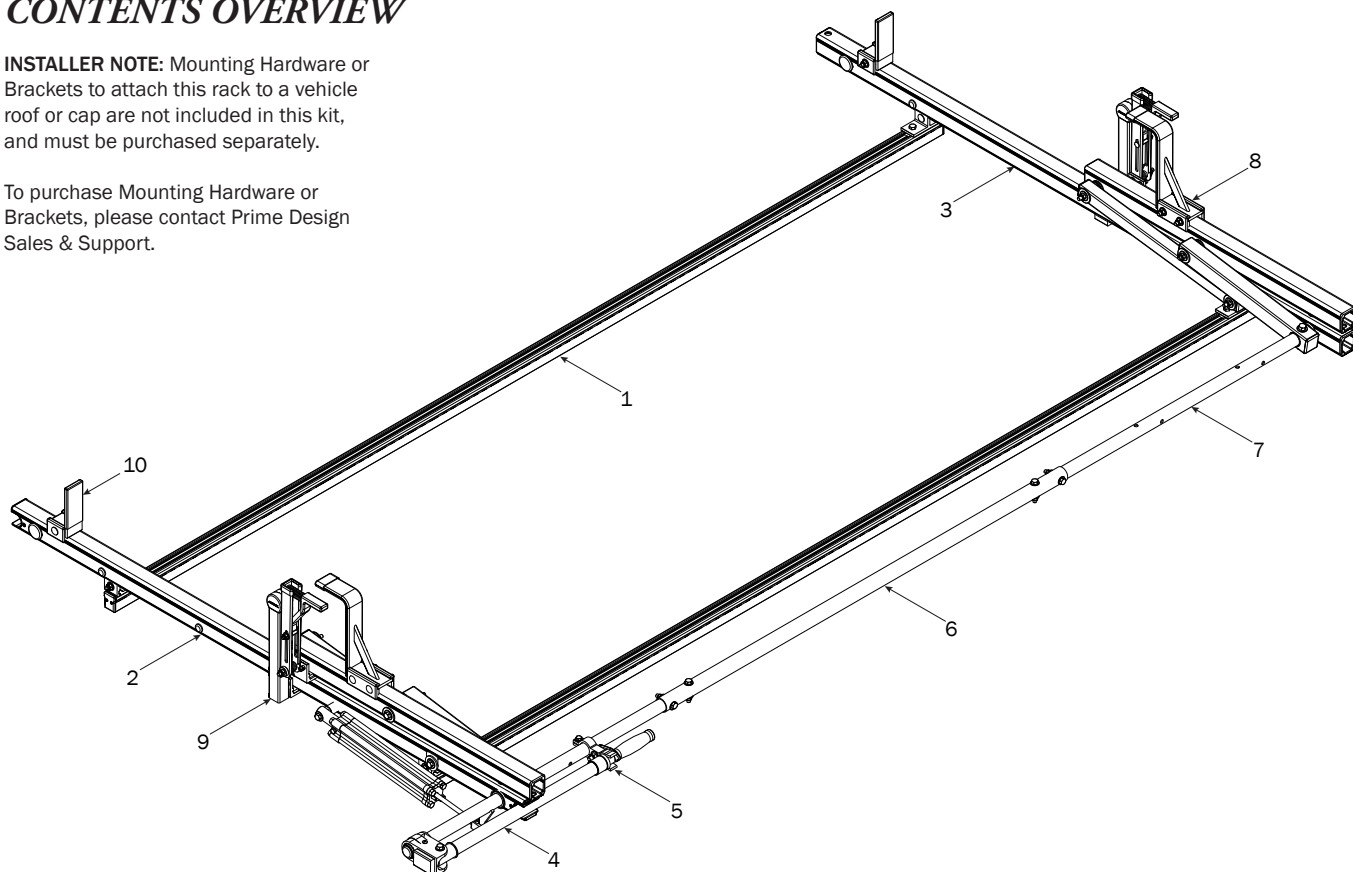

1—FBM-0002 (Qty 1)
Channels with hardware

Channels (2X)



Screws (8X)



End Caps (4X)



Brackets (4X)

2—Rear Crossbar Assembly (Qty 1)

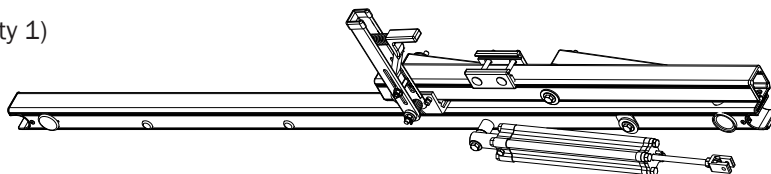

3—Front Crossbar Assembly (Qty 1)

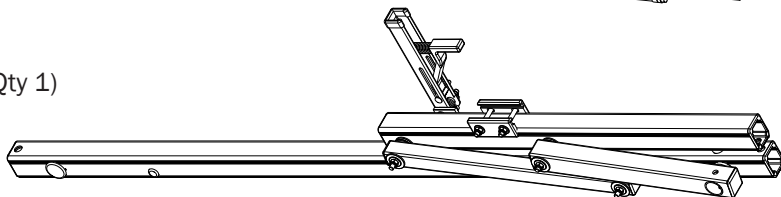

4—Rear Drive Shaft (Qty 1)
Right Hand, 34.00"

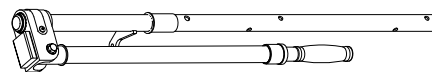

5—Handle Latch Assembly (Qty 1)
Right Hand



6—Connecting Bar (Qty 1)
48.00"



7—Front Drive Shaft (Qty 1)
B Version, 35.75"



8—Z Post (Qty 2)
Adjustable, 7.25"

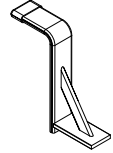

9—L Post..... (Qty 2)
Roller Cap, 9.25"

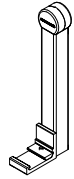

10—Ladder Stop Assembly (Qty 2)
1.75"



11—HKT-8163 (Not called out in Overview)..... (Qty 1)

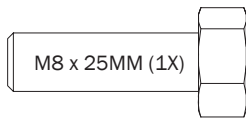

M8 x 25MM (1X)

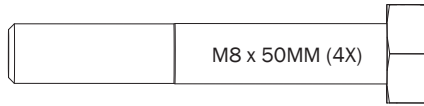

M8 x 50MM (4X)

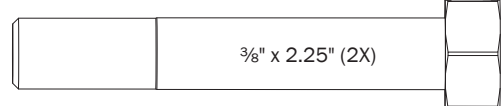

3/8" x 2.25" (2X)



Cotter Pin (1X)

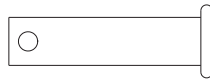

Clevis Pin (1X)



M8 Lock Nut (5X)

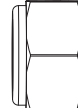

3/8" Lock Nut (2X)

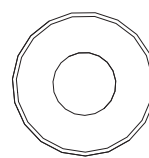

5/16" Flat Washer (10X)

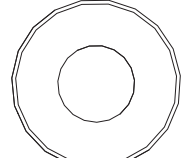

3/8" Flat Washer (4X)

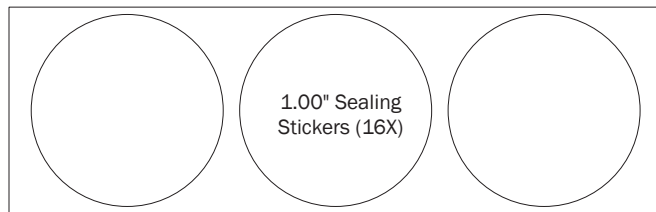

1.00" Sealing
Stickers (16X)

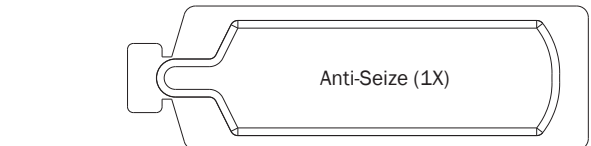

Anti-Seize (1X)

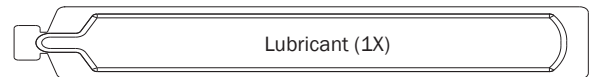

Lubricant (1X)

FBM-0002 FLUSH CHANNELS TO PRE-INSTALLED MOUNTING BRACKETS

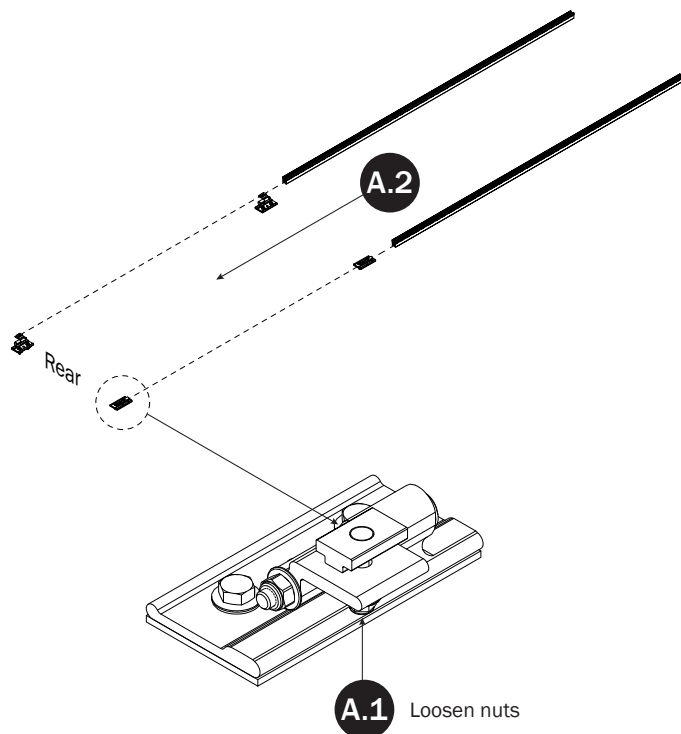

A.3 Set to distances then torque nuts to 80 in-lbs

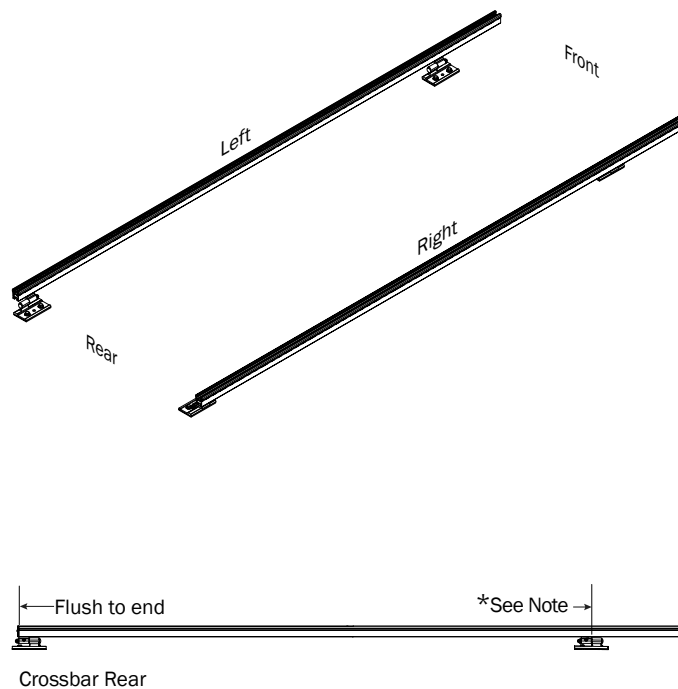

*Note: Use Alternate instructions if marked distances exceed 18" (457mm).

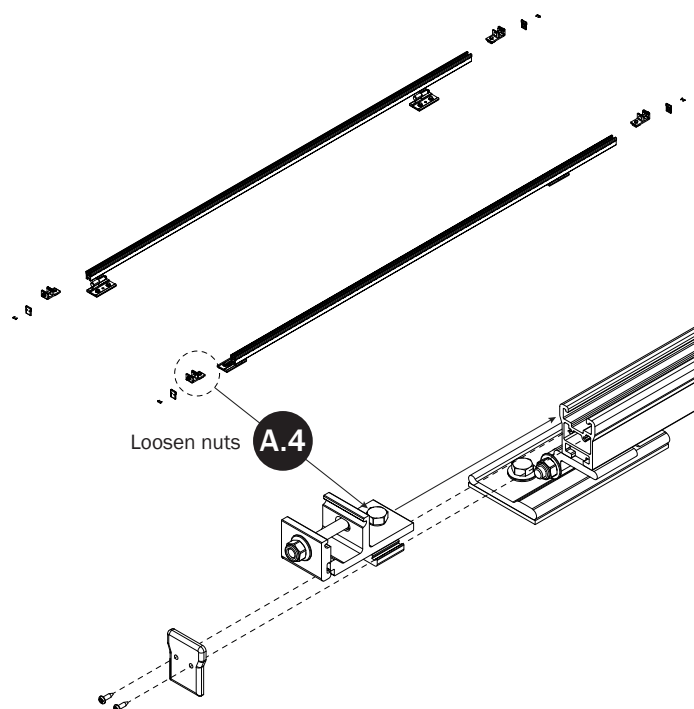

A.5 Set to distances then torque Rear Bracket nuts to 90 in-lbs

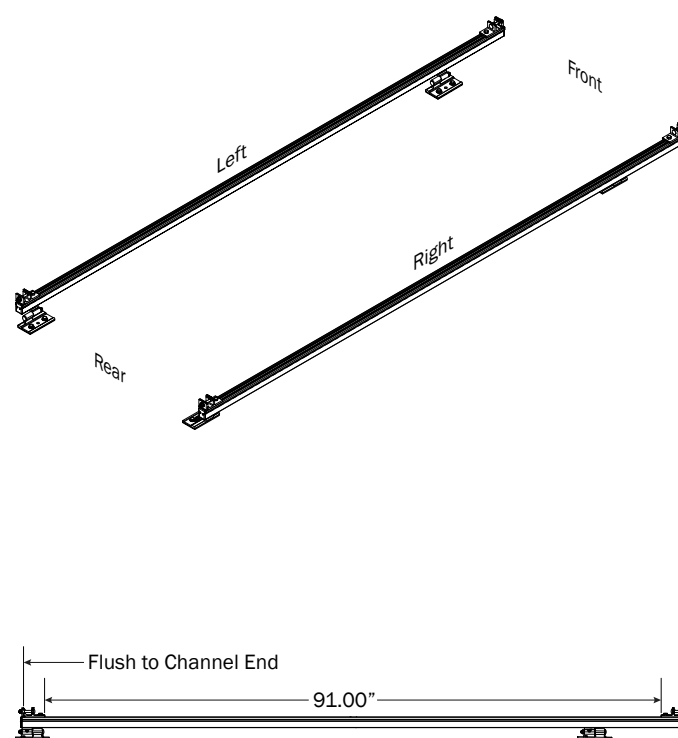

FBM-0002 ALTERNATE
CHANNELS TO PRE-INSTALLED
MOUNTING BRACKETS

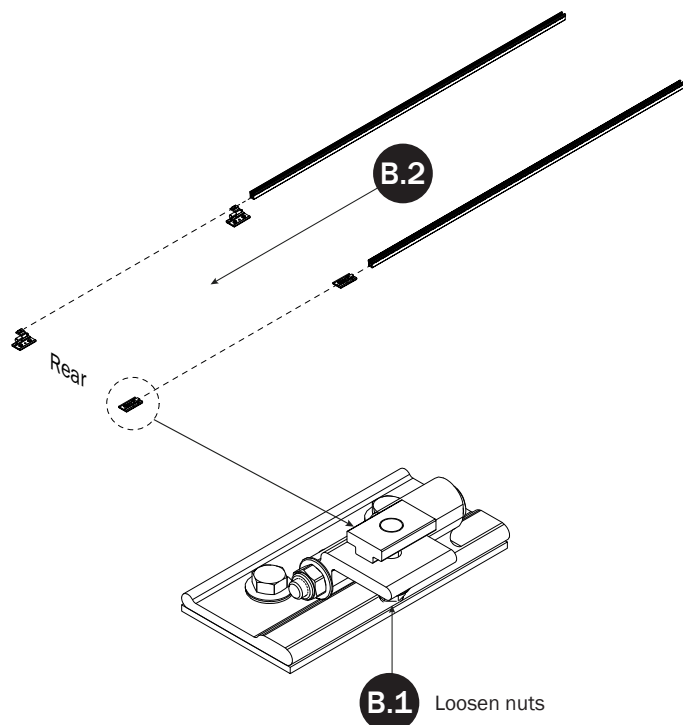

B.3 Set to distances then torque nuts to 80 in-lbs

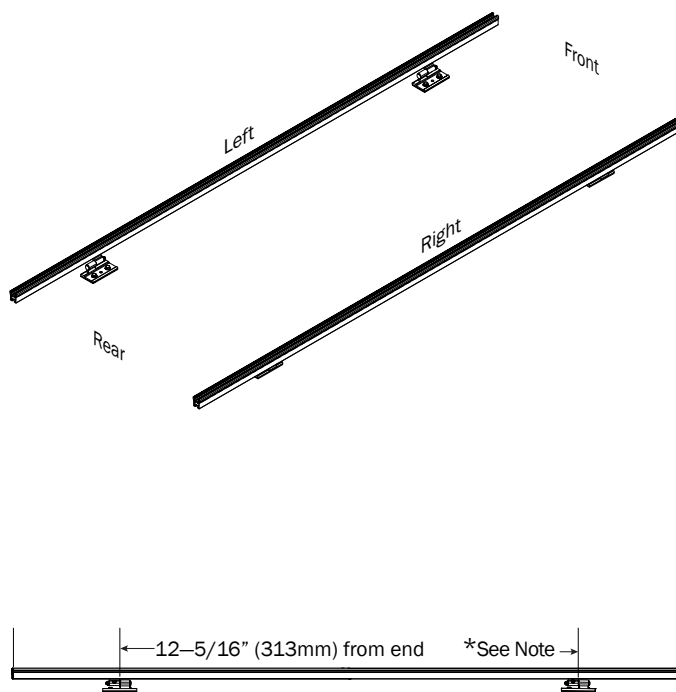

Crossbar Rear

*Note: Move Channels rearward if marked front distance exceeds 18" (457mm).

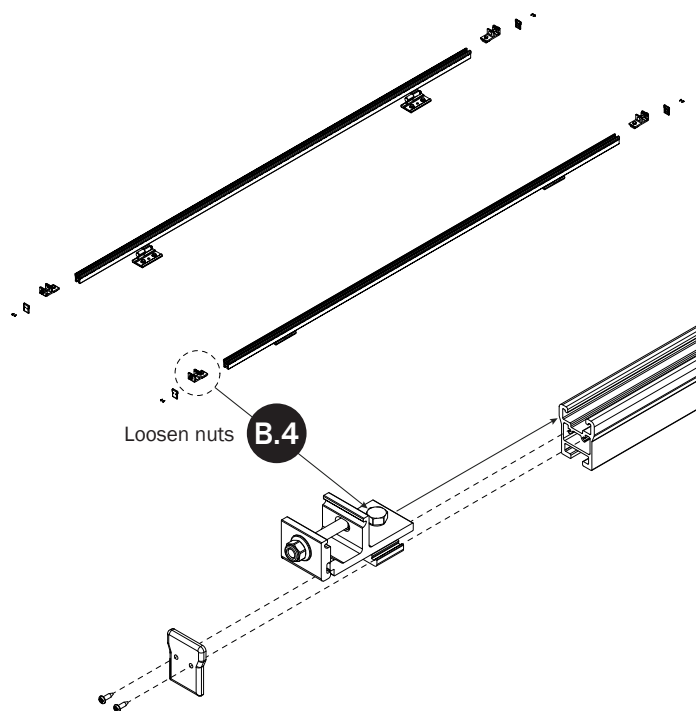

B.5 Set to distances then torque Rear Bracket nuts to 90 in-lbs

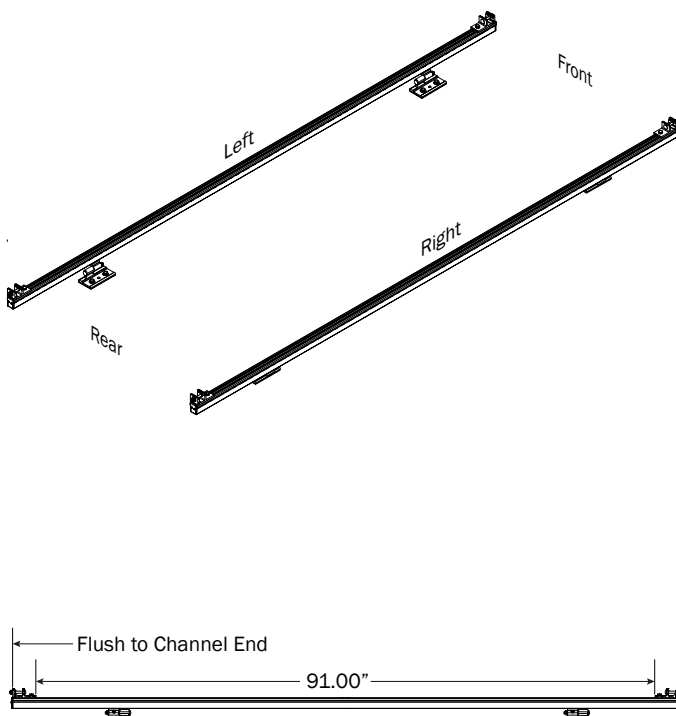

Crossbar Rear

RIGHT ROTATION ASSEMBLY SEQUENCE

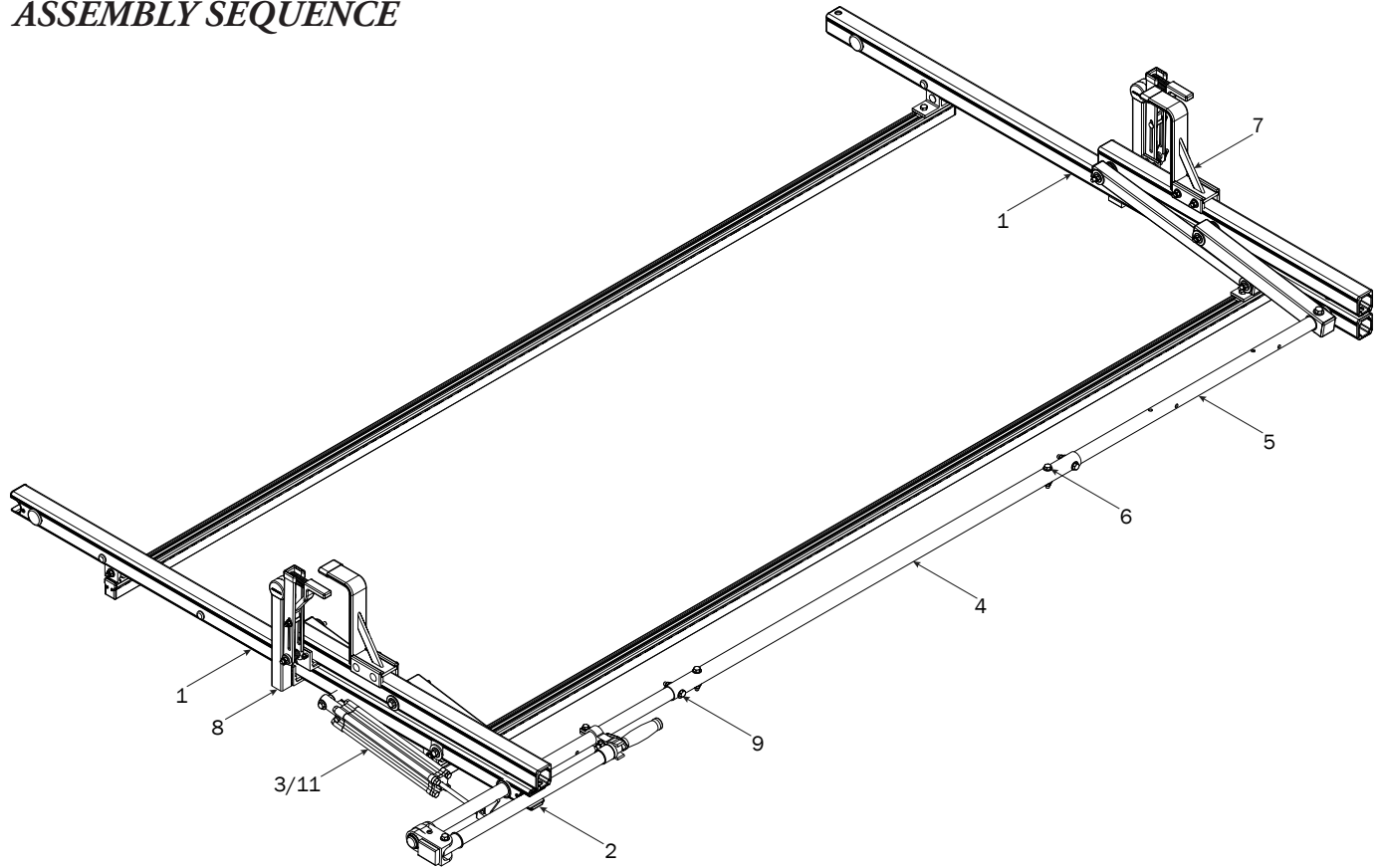

CROSSBARS

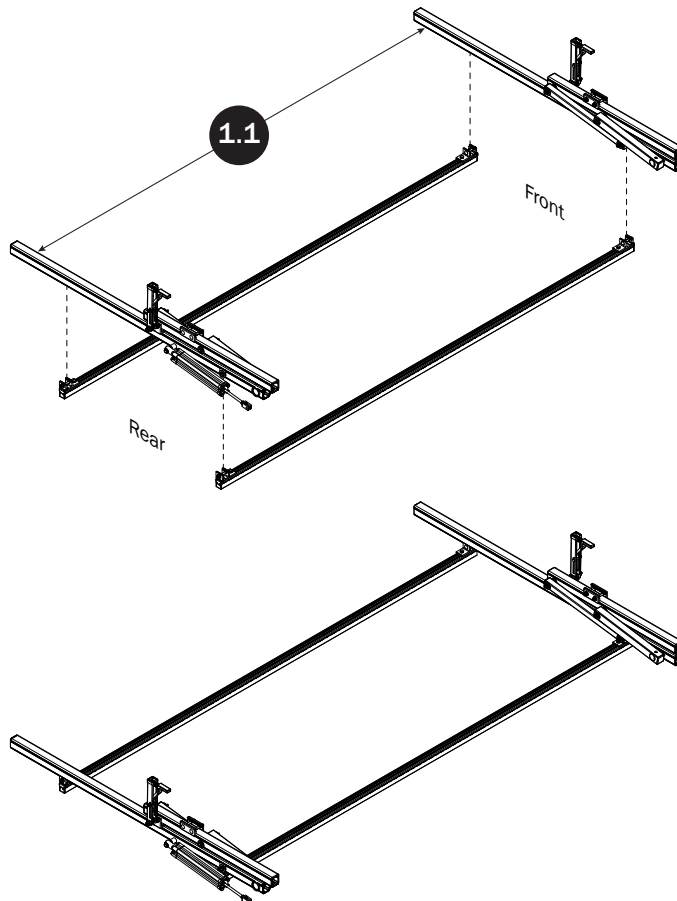

CROSSBAR ADJUSTMENT

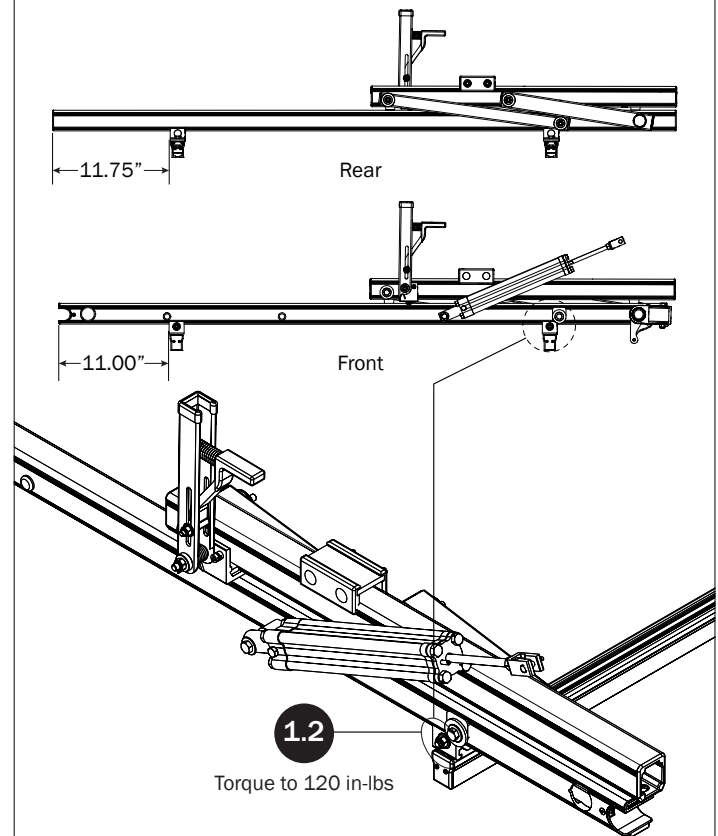

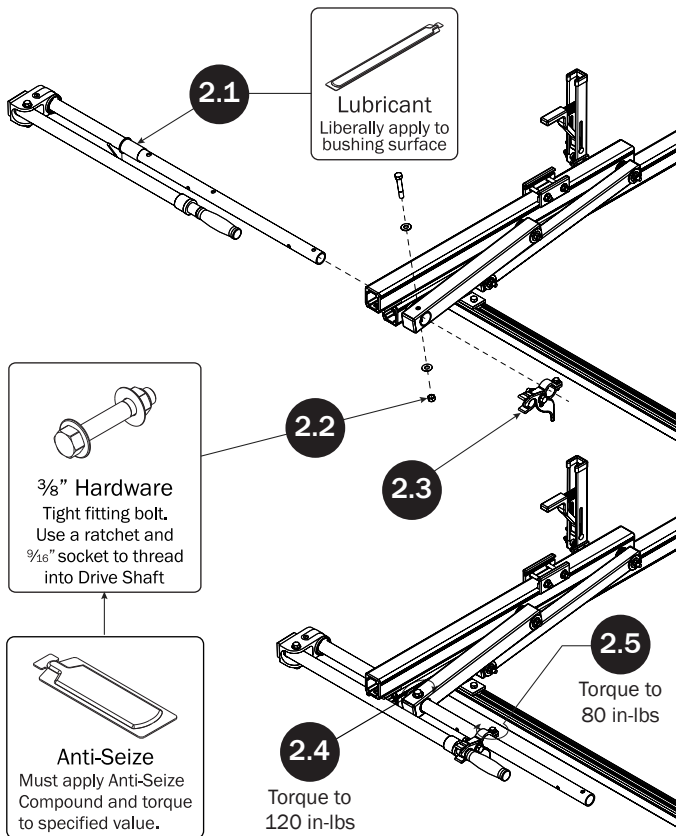
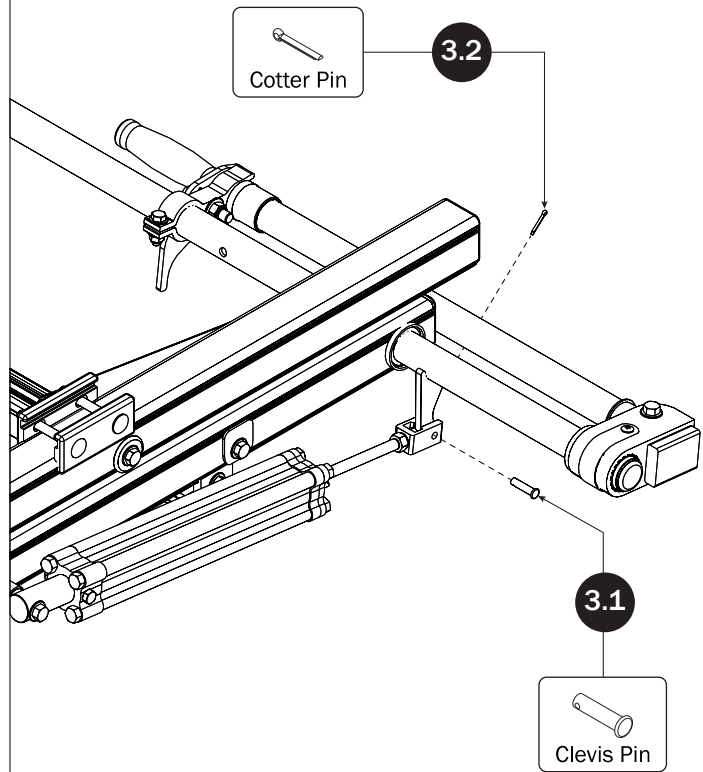
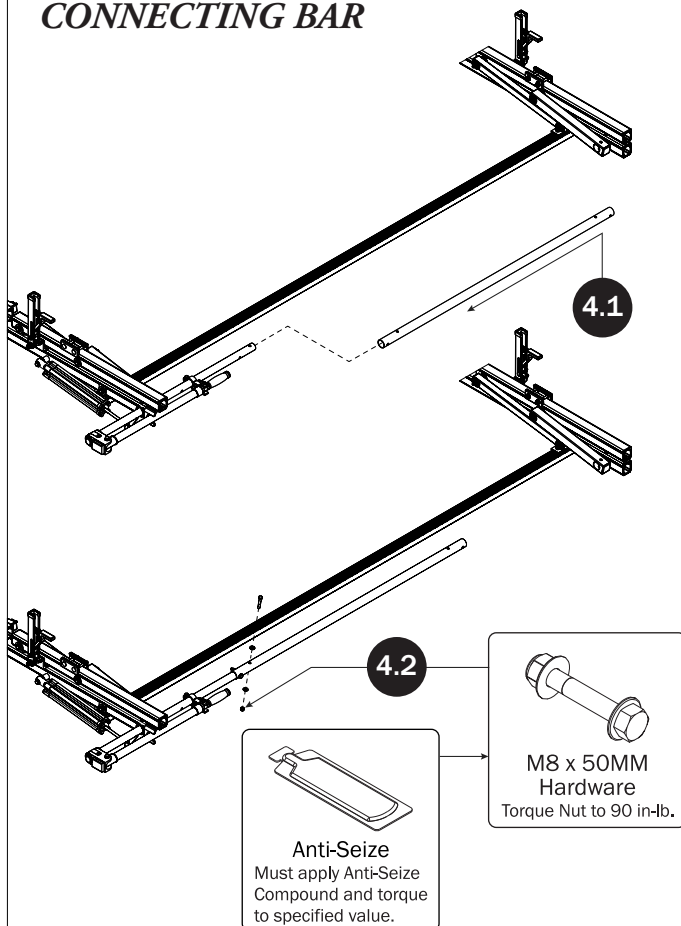
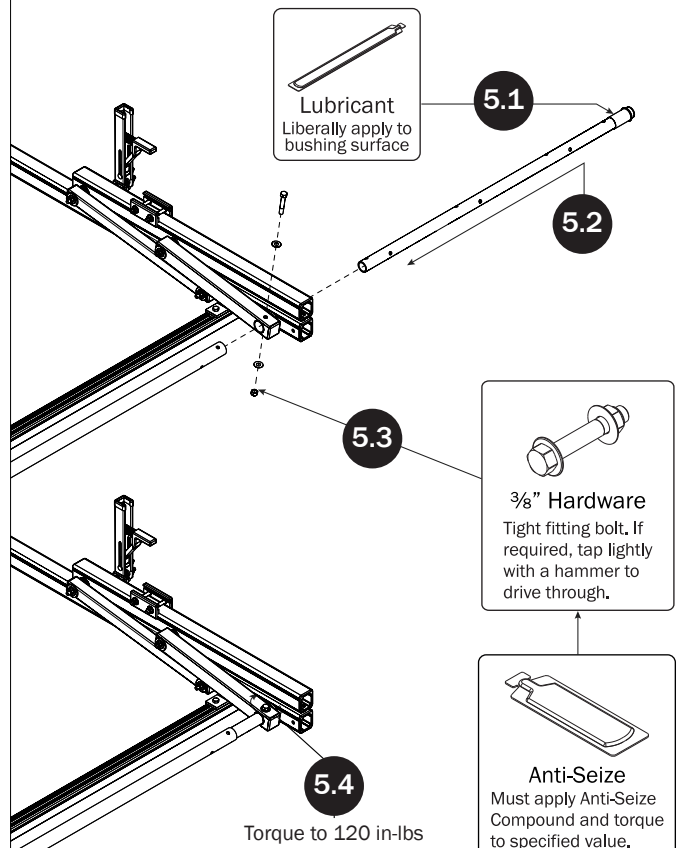
REAR DRIVE SHAFT**CYLINDER HARDWARE****CONNECTING BAR****FRONT DRIVE SHAFT**

CONNECTING BAR FASTENERS

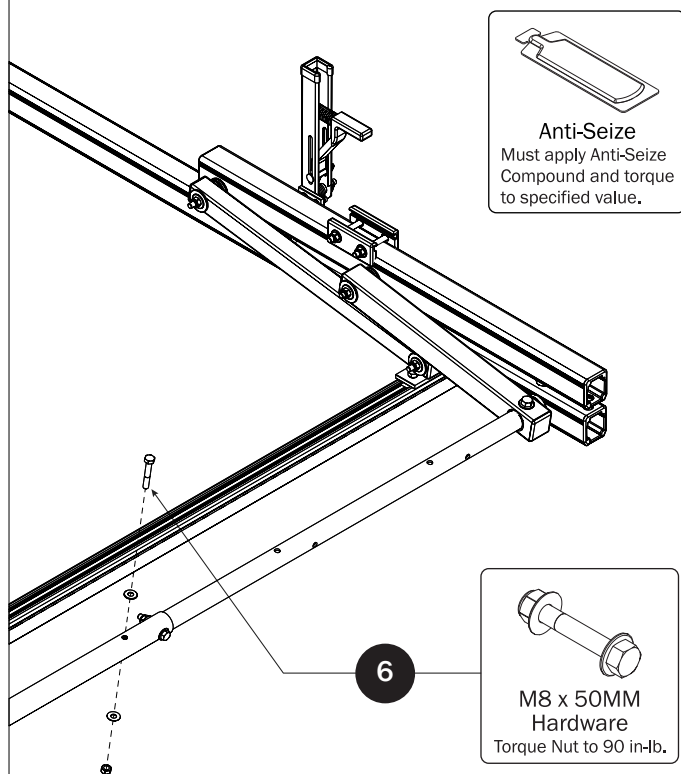

Z POSTS

SEE QUICK START GUIDE FOR ADJUSTMENTS

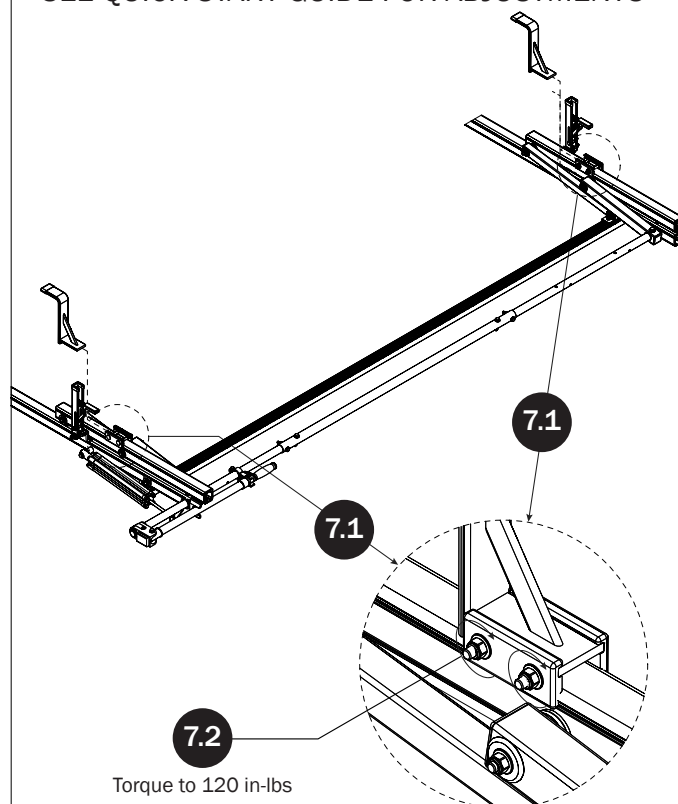

L POSTS

SEE QUICK START GUIDE FOR ADJUSTMENTS

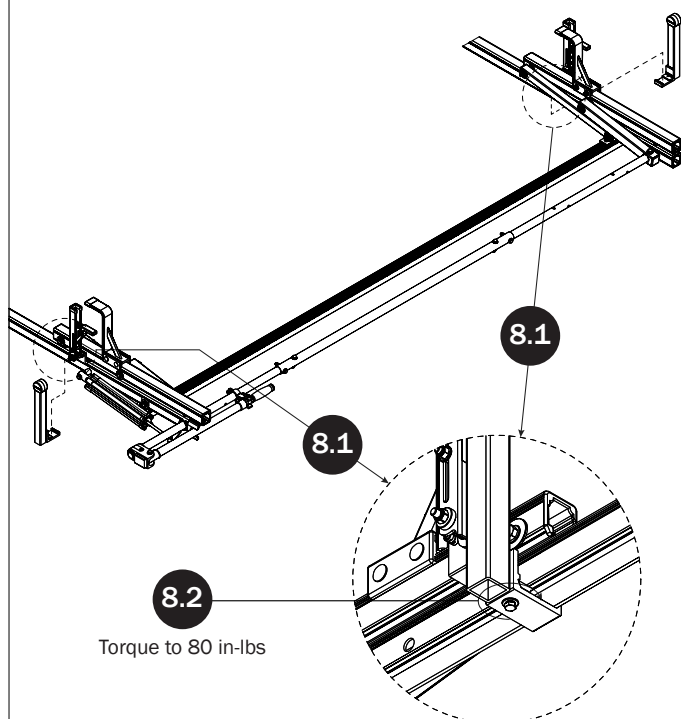

DRIVE SHAFT SEALING

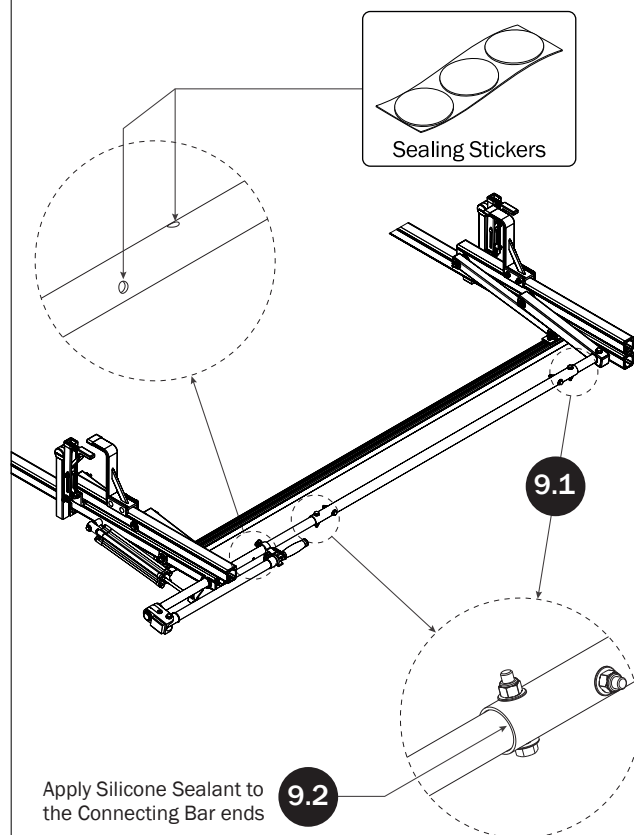

LEFT SIDE BASE ASSEMBLY SEQUENCE

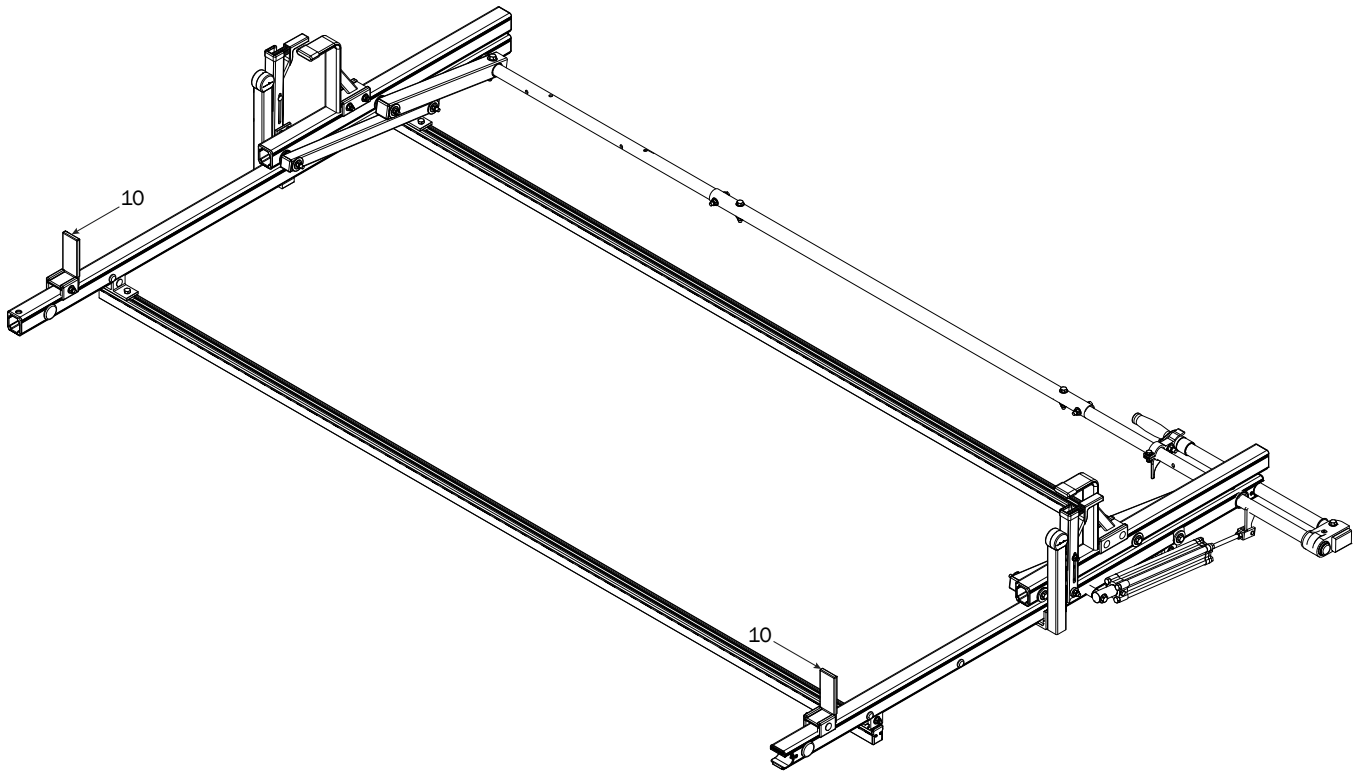

LADDER STOPS

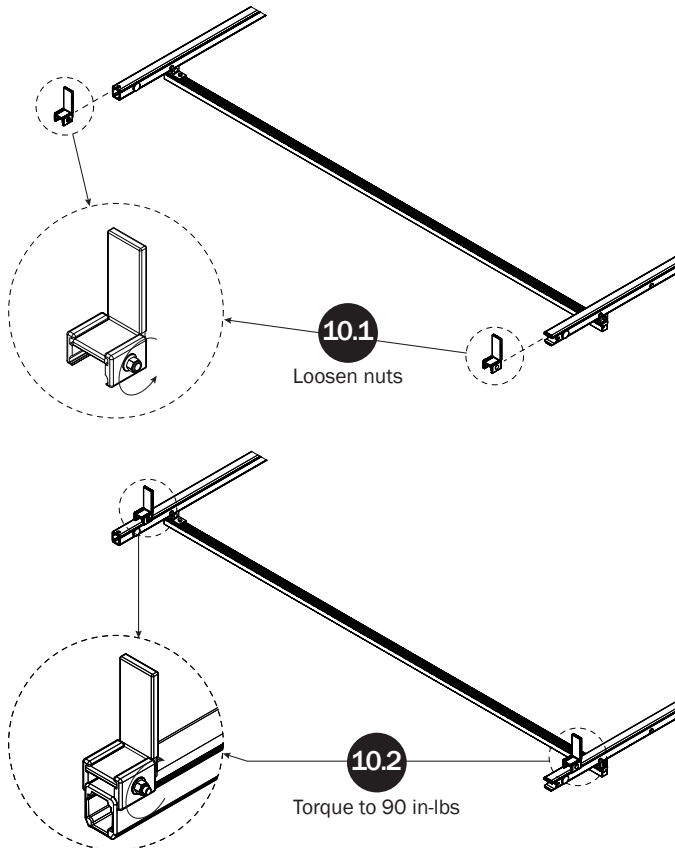

CYLINDER ADJUSTMENT

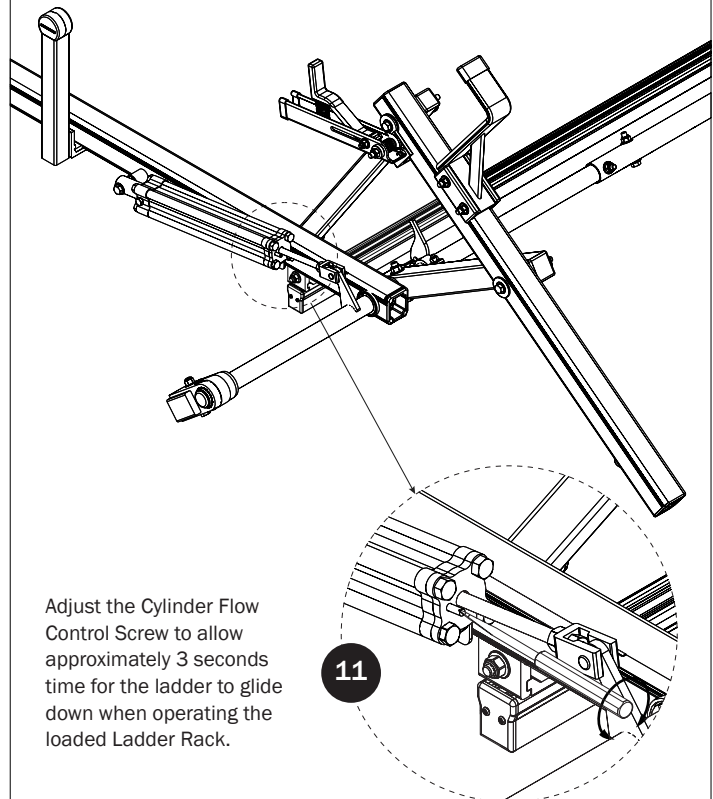

Page Intentionally Left Blank

Page Intentionally Left Blank

