

PRIME DESIGN™

A Safe Fleet Brand

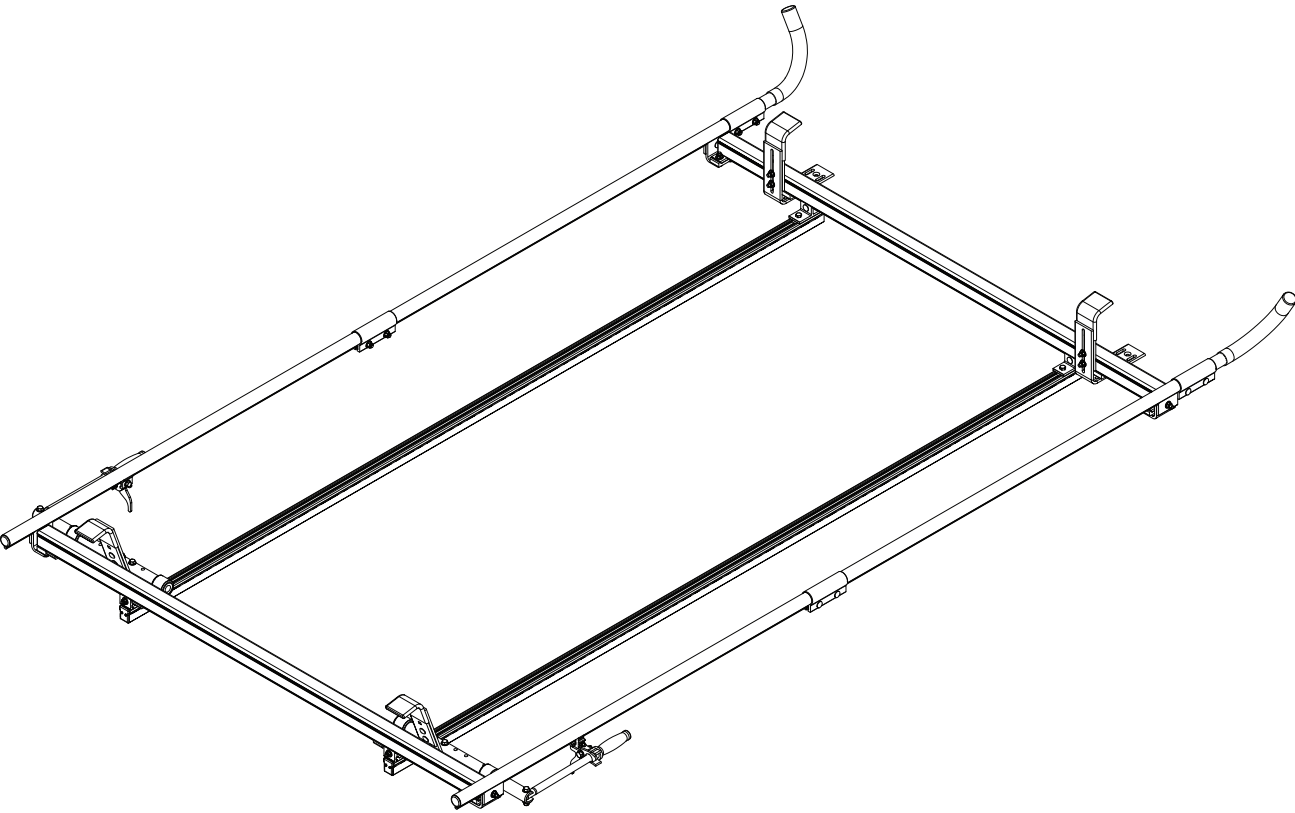

PRIME DESIGN, A SAFE FLEET BRAND

Address: 580 Opperman Drive, Eagan, MN 55123 • Toll Free: 1.8.PRIME.RACK
Fax: 651-552-1799 • Email: info@primedesign.net • Website: www.primedesign.net

PCC 6001

CONTENTS OVERVIEW

INSTALLER NOTE: Mounting Hardware or Brackets to attach this rack to a vehicle roof or cap are not included in this kit, and must be purchased separately.

To purchase Mounting Hardware or Brackets, please contact Prime Design Sales & Support.

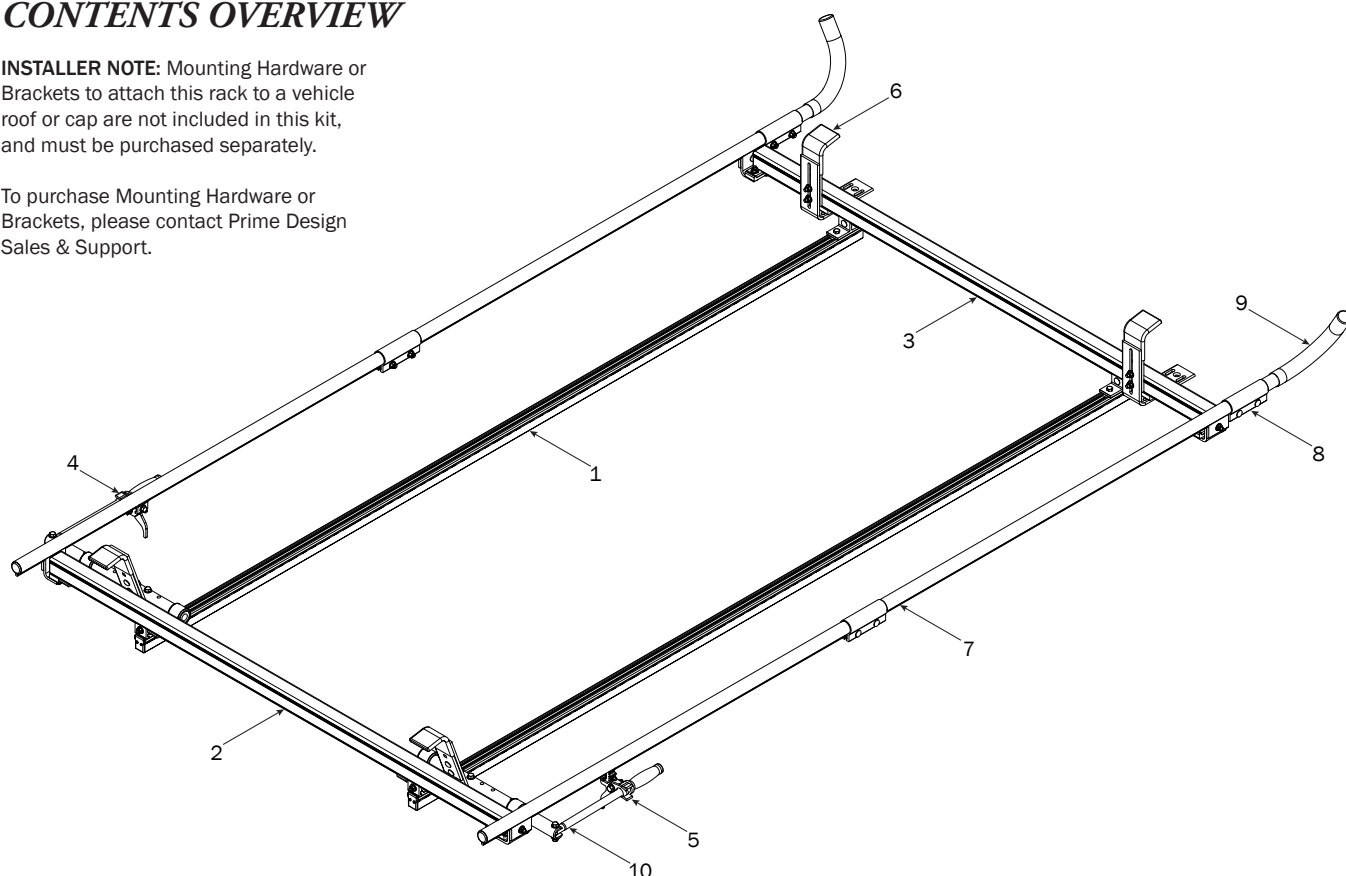

1—FBM-0002 (Qty 1)

Channels with hardware

Channels (2X)



Screws (8X)

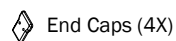

End Caps (4X)



Brackets (4X)

2—Rear Crossbar Assembly (Qty 1)



3—Front Crossbar Assembly (Qty 1)



4—Handle Latch Assembly (Qty 1)

Right Hand



5—Handle Latch Assembly (Qty 1)

Left Hand



6—Front Hook Assembly (Qty 2)

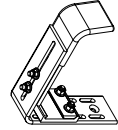

7—Clamp Down Tube (Qty 2)
104.00" w/Tube Splice

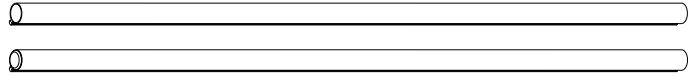

8—Quick Clamp Tube Splice Assembly (Qty 2)
5.00"



9—Removeable Horn with Cap (Qty 2)
15.00"

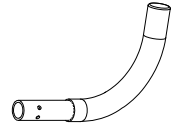

10—Clamp Down Handle Assembly (Qty 2)

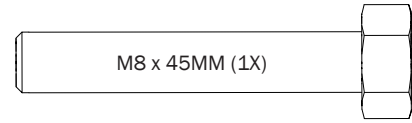
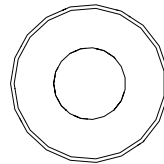
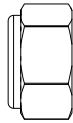
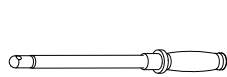

Clamp Down Handle (1X)

M8 Lock Nut (1X)

5/16" Flat Washer (2X)

M8 x 45MM (1X)

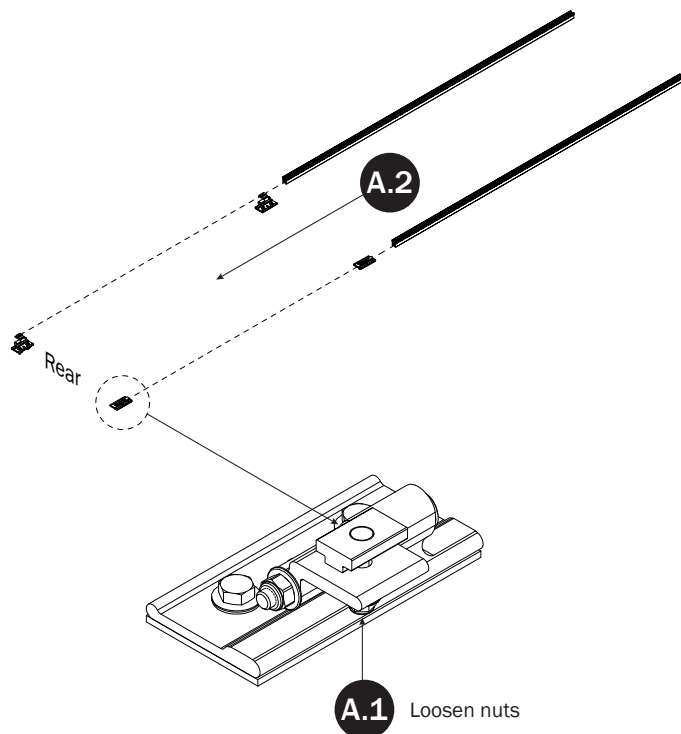
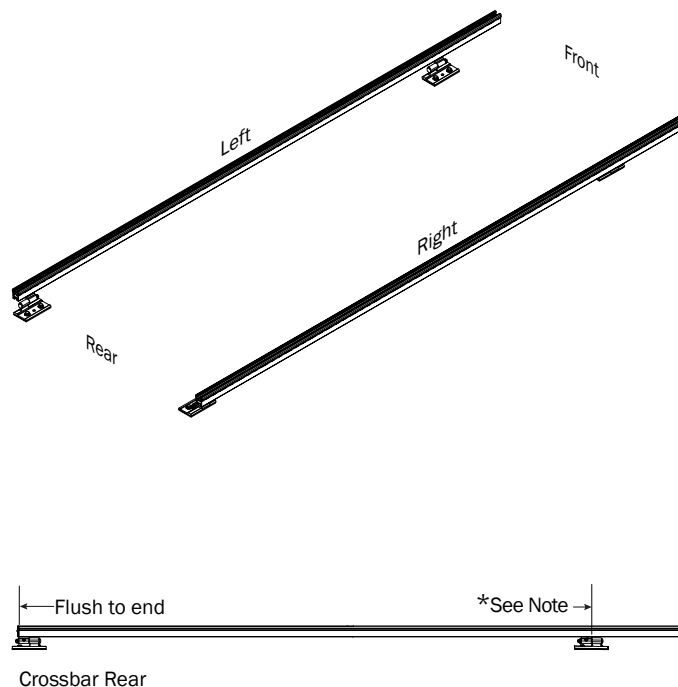
FBM-0002 FLUSH
CHANNELS TO PRE-INSTALLED
MOUNTING BRACKETS**A.3** Set to distances then torque nuts to 80 in-lbs

*Note: Use Alternate instructions if marked distances exceed 18" (457mm).

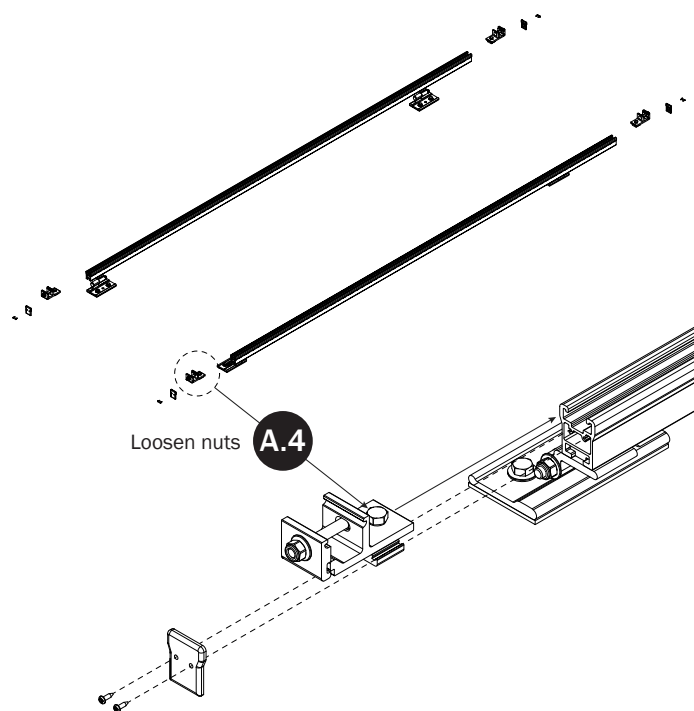
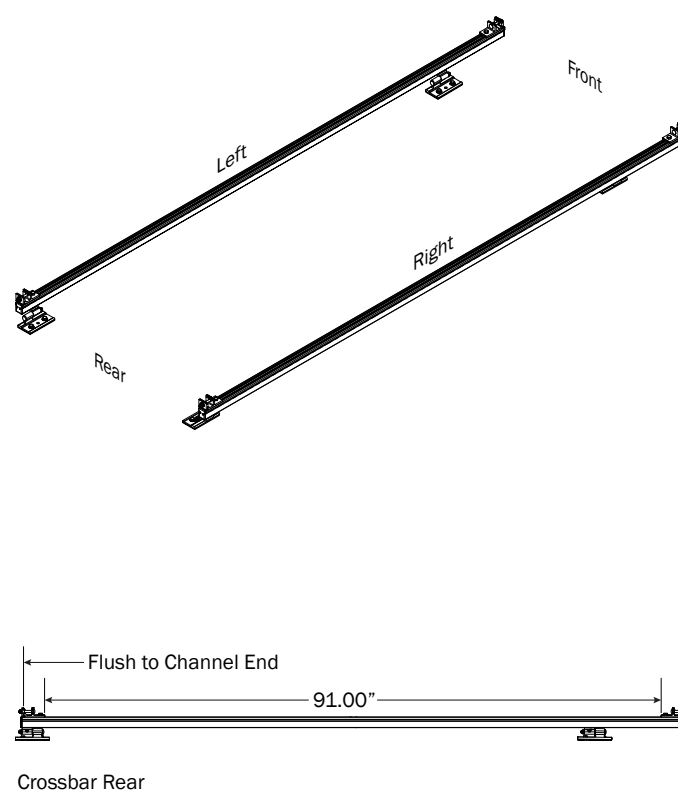
**A.5** Set to distances then torque Rear Bracket nuts to 90 in-lbs

FBM-0002 ALTERNATE
CHANNELS TO PRE-INSTALLED
MOUNTING BRACKETS

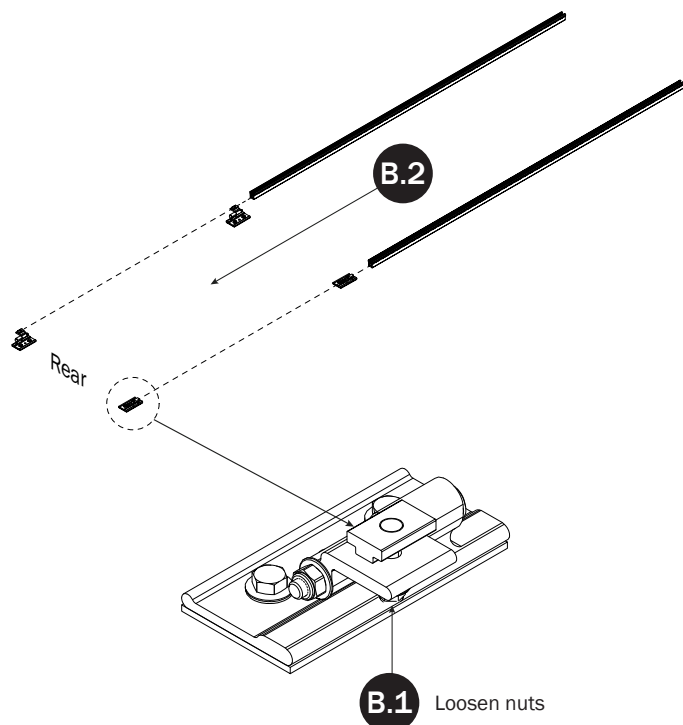

B.3 Set to distances then torque nuts to 80 in-lbs

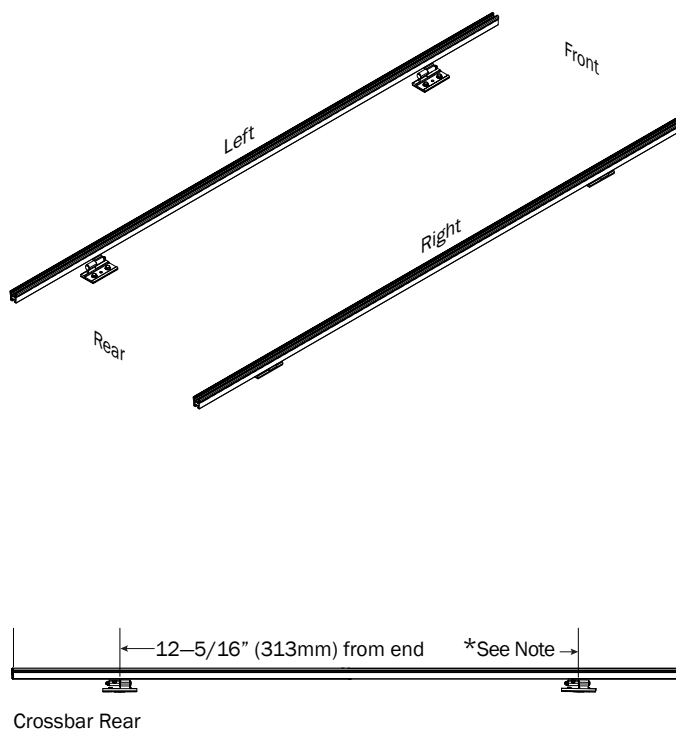

*Note: Move Channels rearward if marked front distance exceeds 18" (457mm).

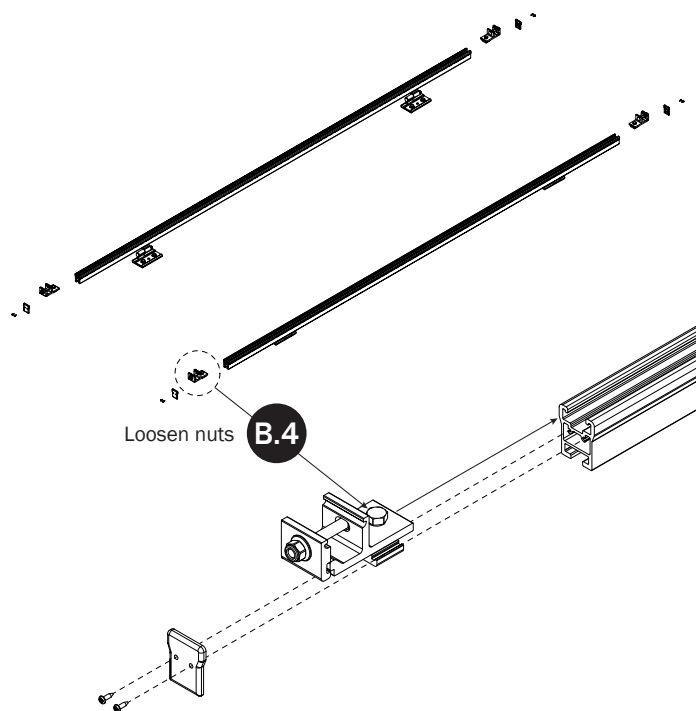

B.5 Set to distances then torque Rear Bracket nuts to 90 in-lbs

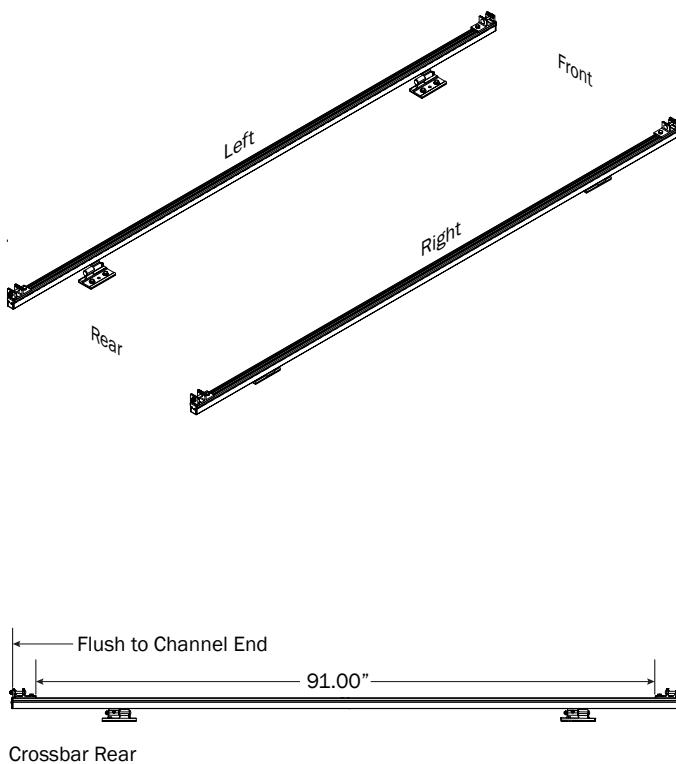

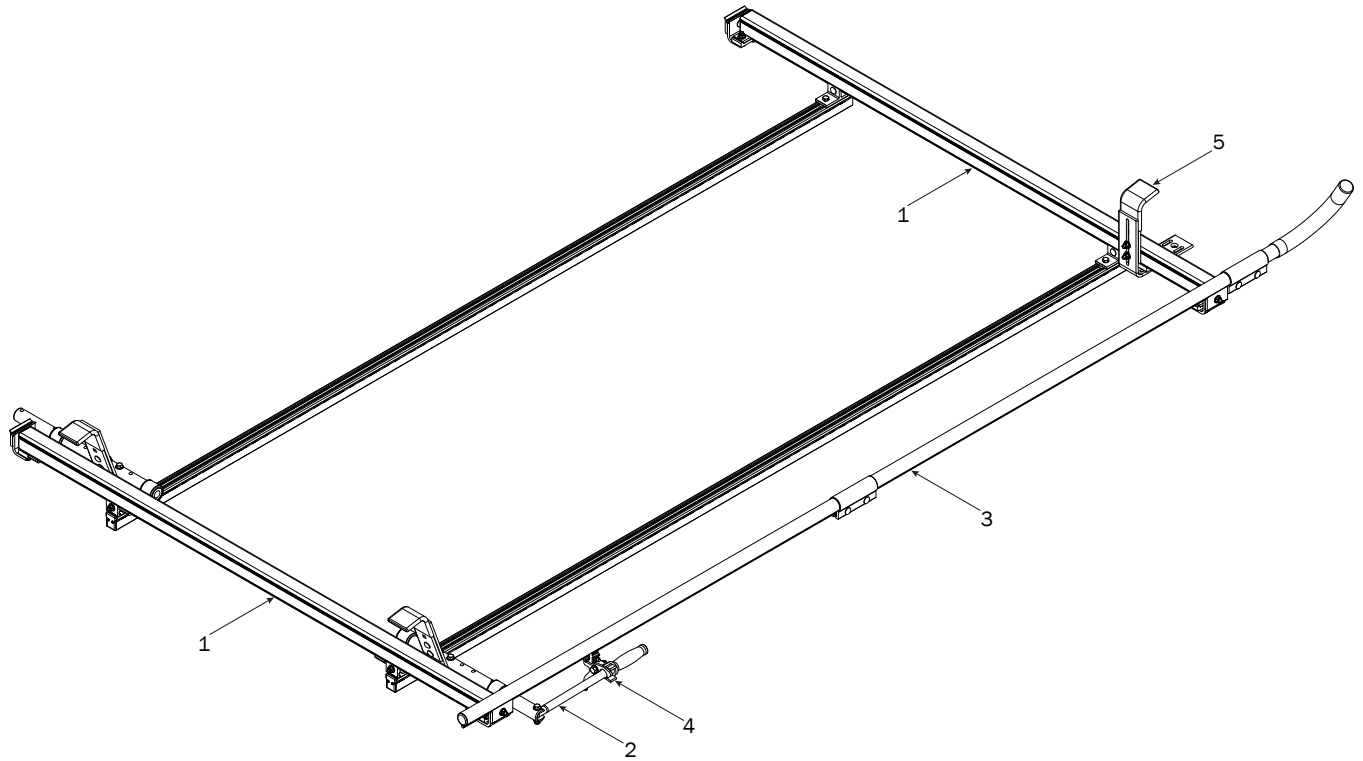
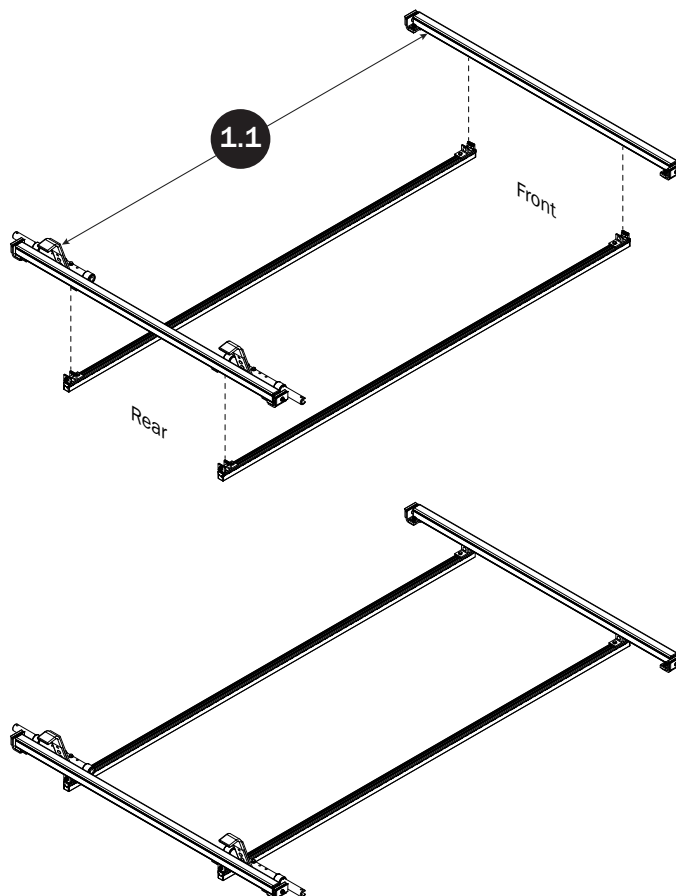
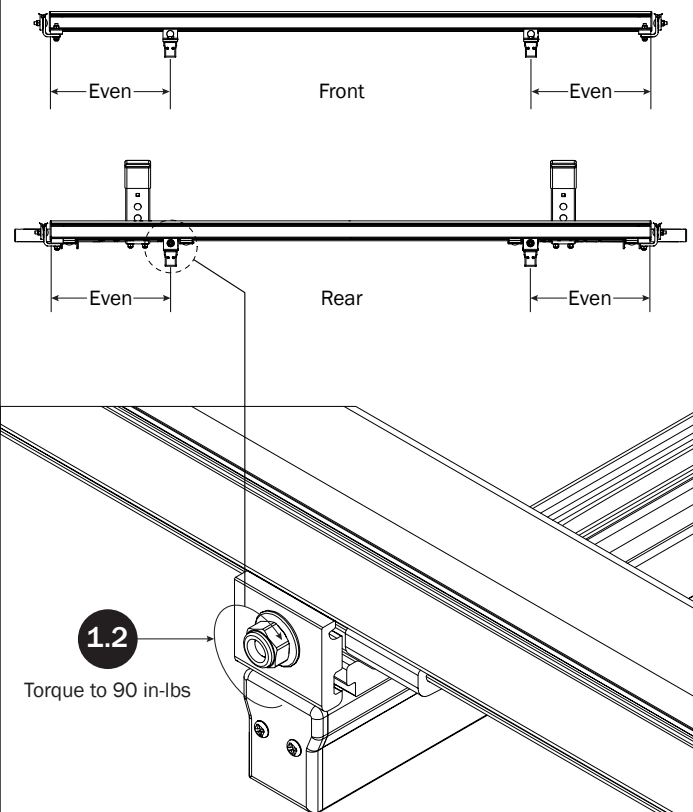
**RIGHT CLAMP DOWN
ASSEMBLY SEQUENCE****CROSSBARS****CROSSBAR ADJUSTMENT**

CLAMP DOWN HANDLE

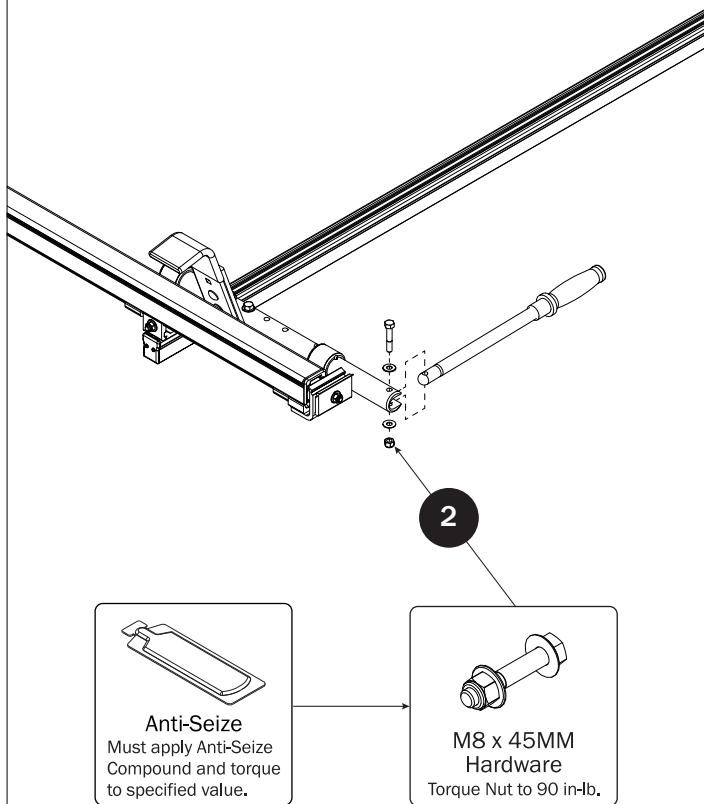

CLAMP DOWN TUBE

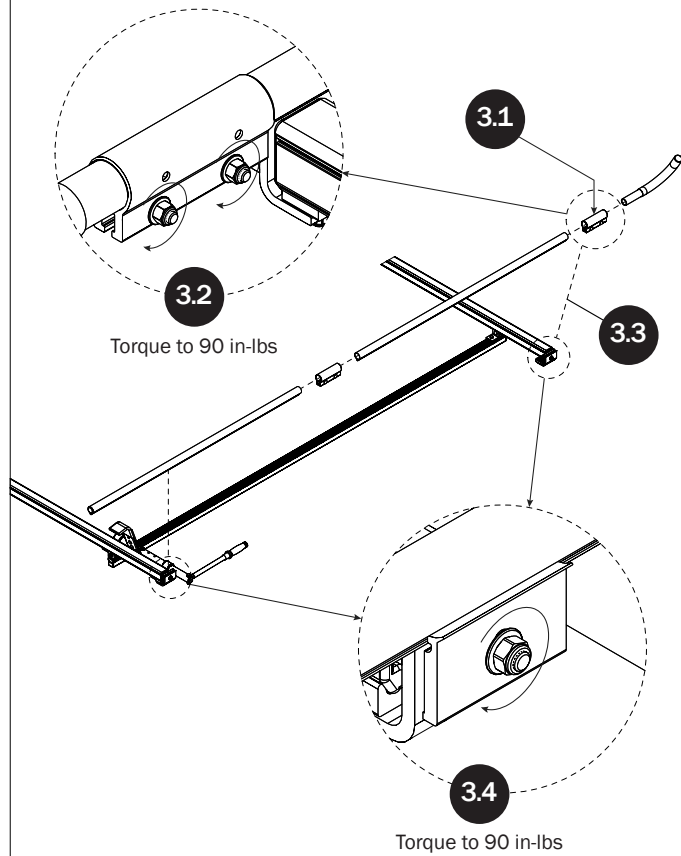

HANDLE LATCH

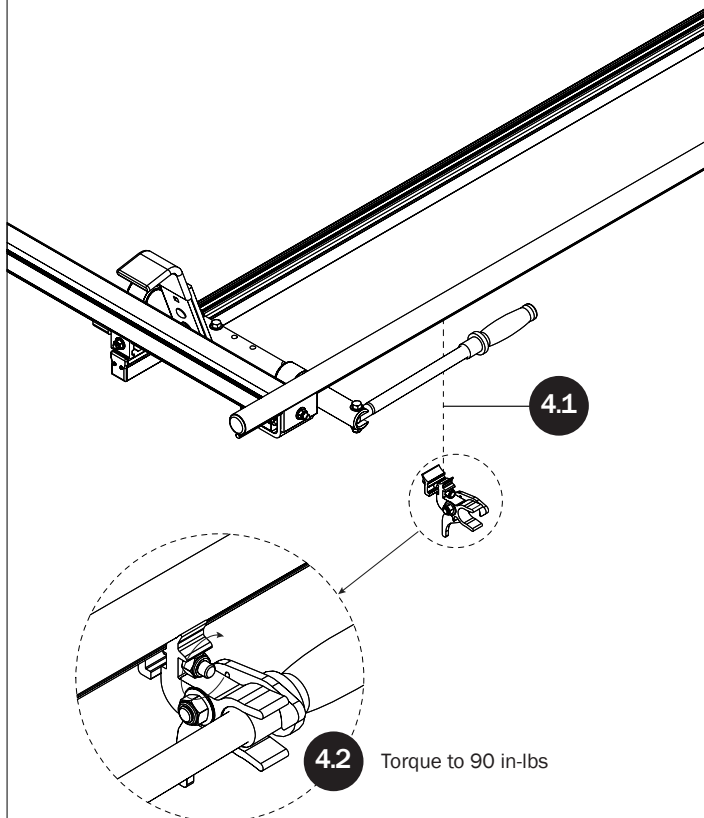

FRONT LADDER HOOK

SEE QUICK START GUIDE FOR ADJUSTMENTS

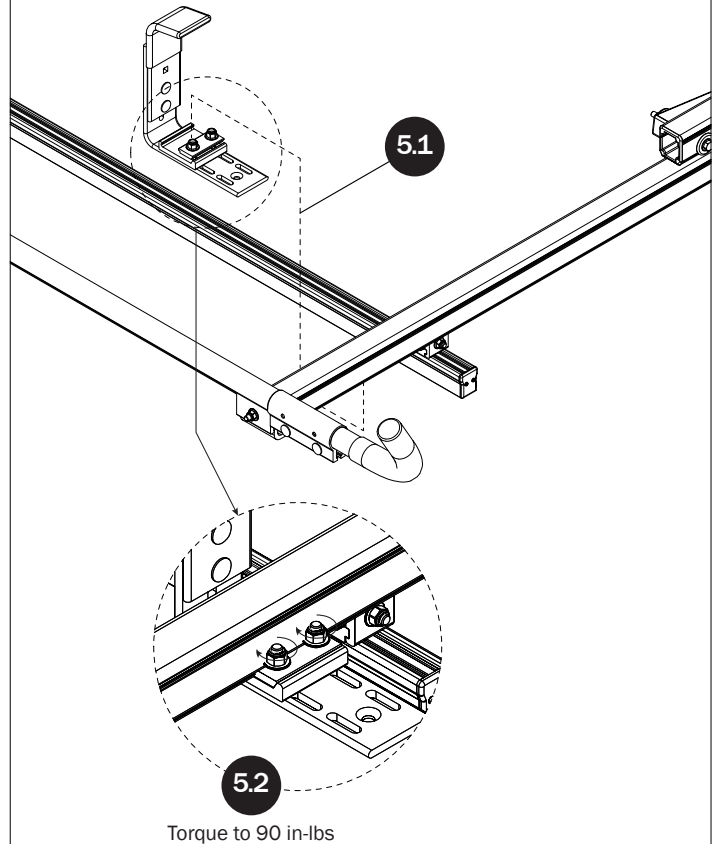

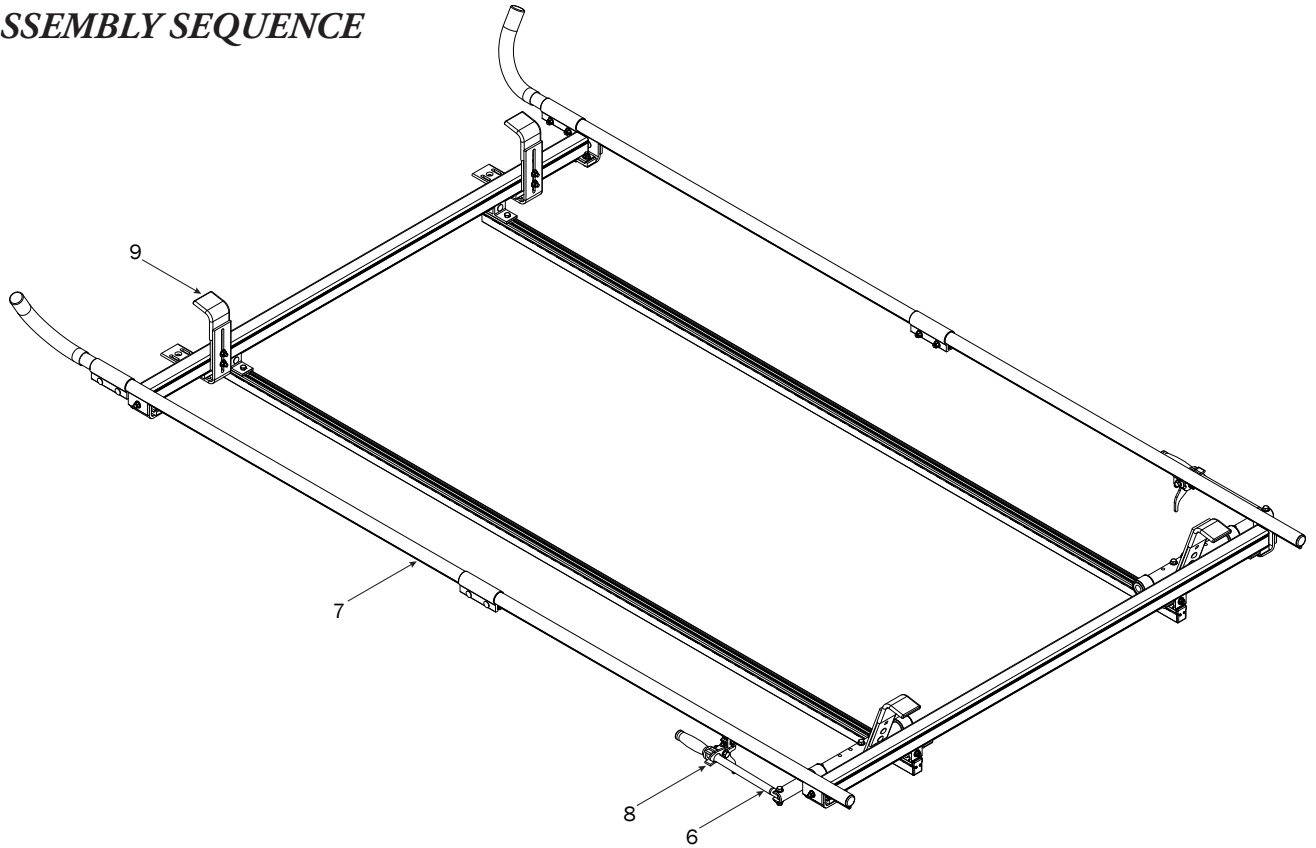
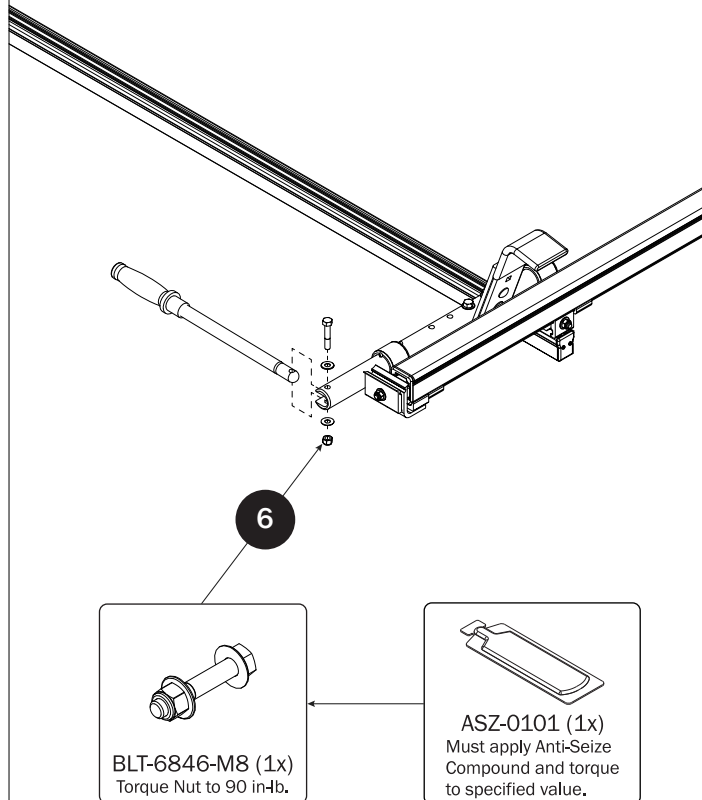
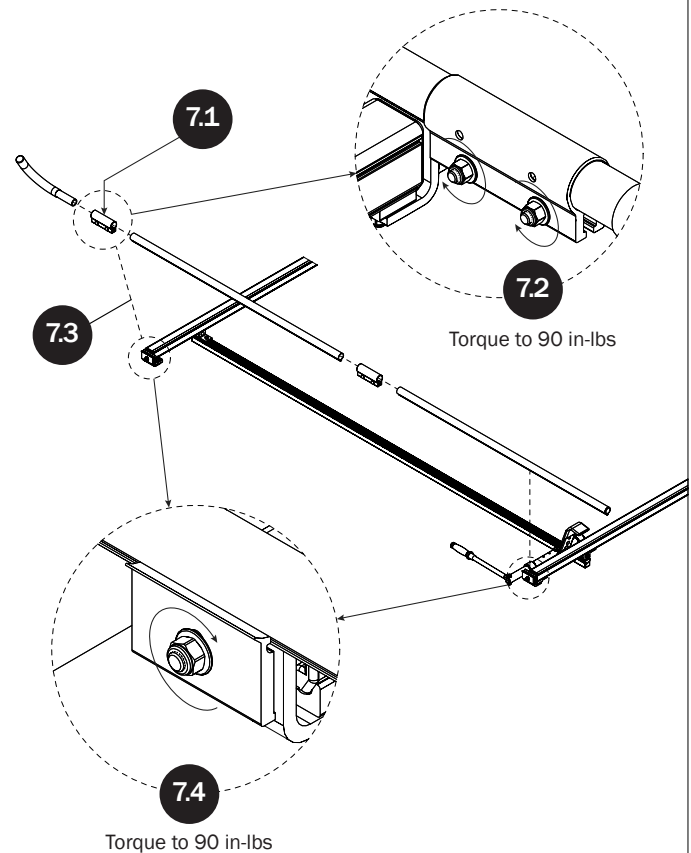
**LEFT CLAMP DOWN
ASSEMBLY SEQUENCE****CLAMP DOWN HANDLE****CLAMP DOWN TUBE**

HANDLE LATCH

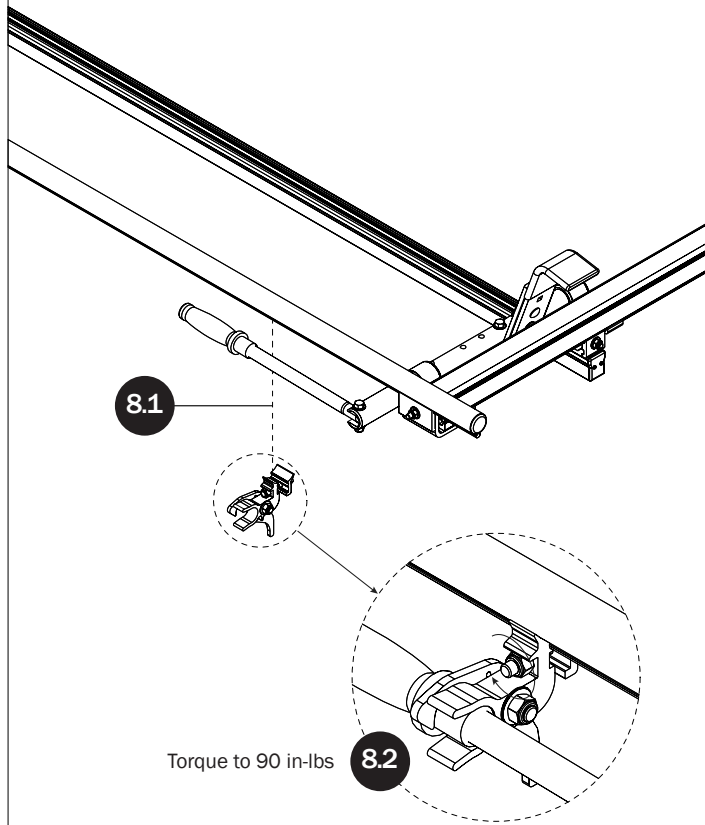

FRONT LADDER HOOK

SEE QUICK START GUIDE FOR ADJUSTMENTS

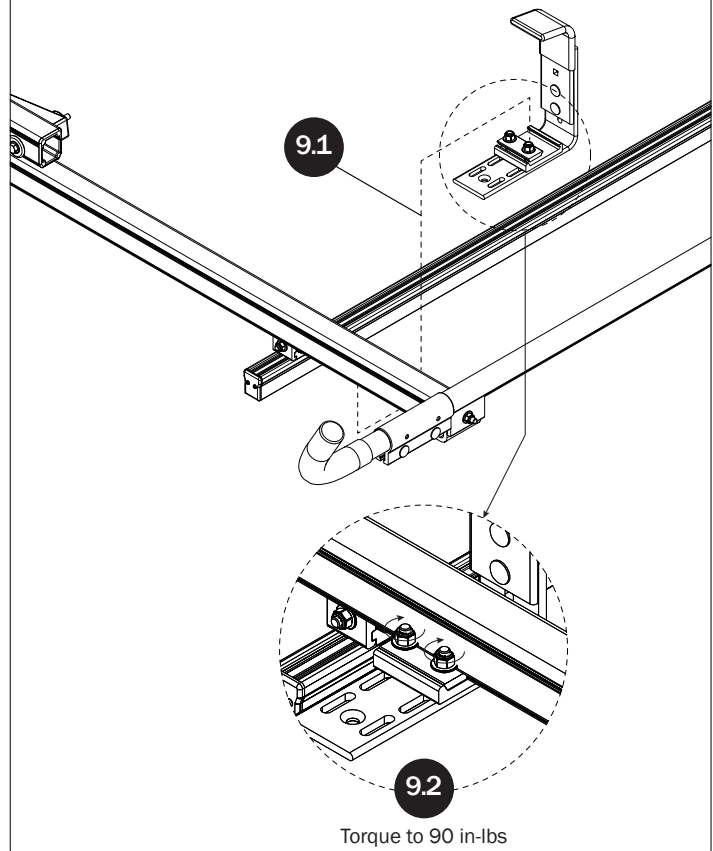

Page Intentionally Left Blank

Page Intentionally Left Blank

