

PRIME DESIGN™

A Safe Fleet Brand

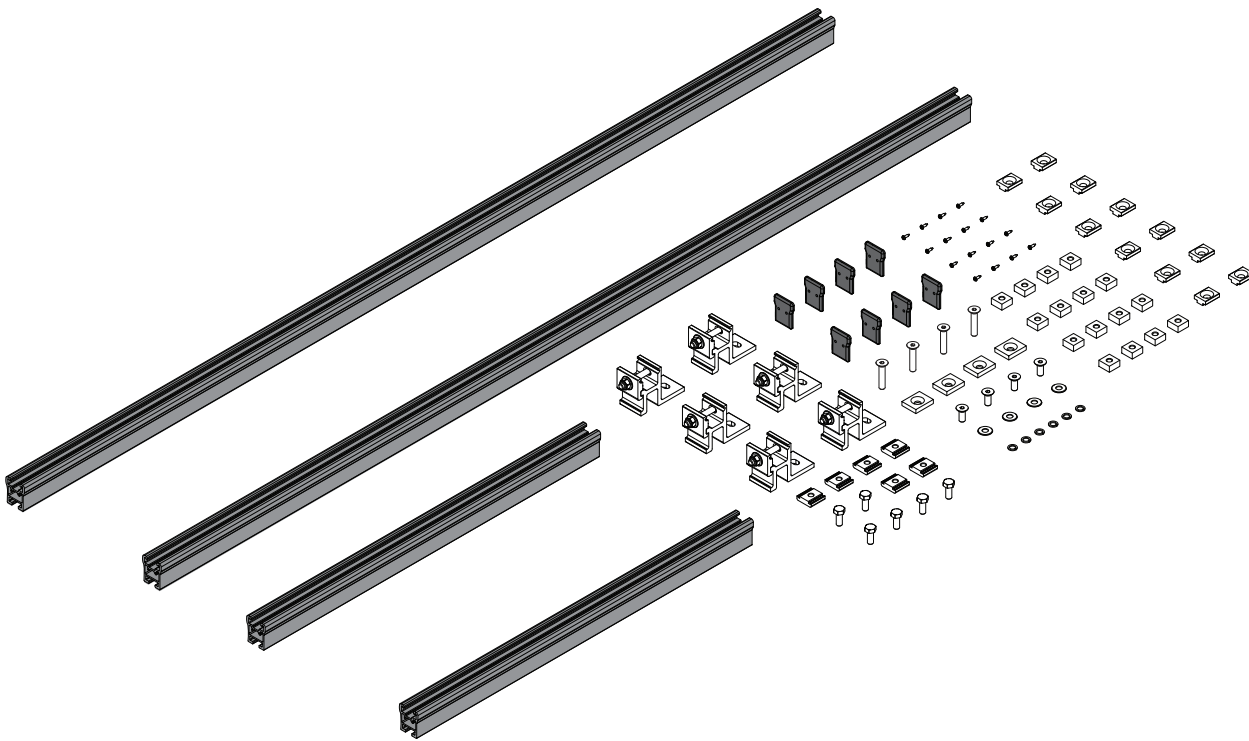

**PRIME
RACK
FBM-1010**

2014+ Nissan NV High Roof Base Mounting Kit

Page 2	Packaging Contents
Pages 3-7	High Roof H1 (83.90")
Pages 8-12	High Roof H2 (106")

PRIME DESIGN, A SAFE FLEET BRAND

Address: 580 Opperman Drive, Eagan, MN 55123 • Toll Free: 1.8.PRIME.RACK

Fax: 651-552-1799 • Email: info@primedesign.net • Website: www.primedesign.net

CONTENTS OVERVIEW**TWO & THREE CROSSBAR CONFIGURATIONS**

NOTE: This Manual contains information covering two and three Crossbar configurations. If your model is a two Crossbar configuration, disregard all Center Crossbar installation information.

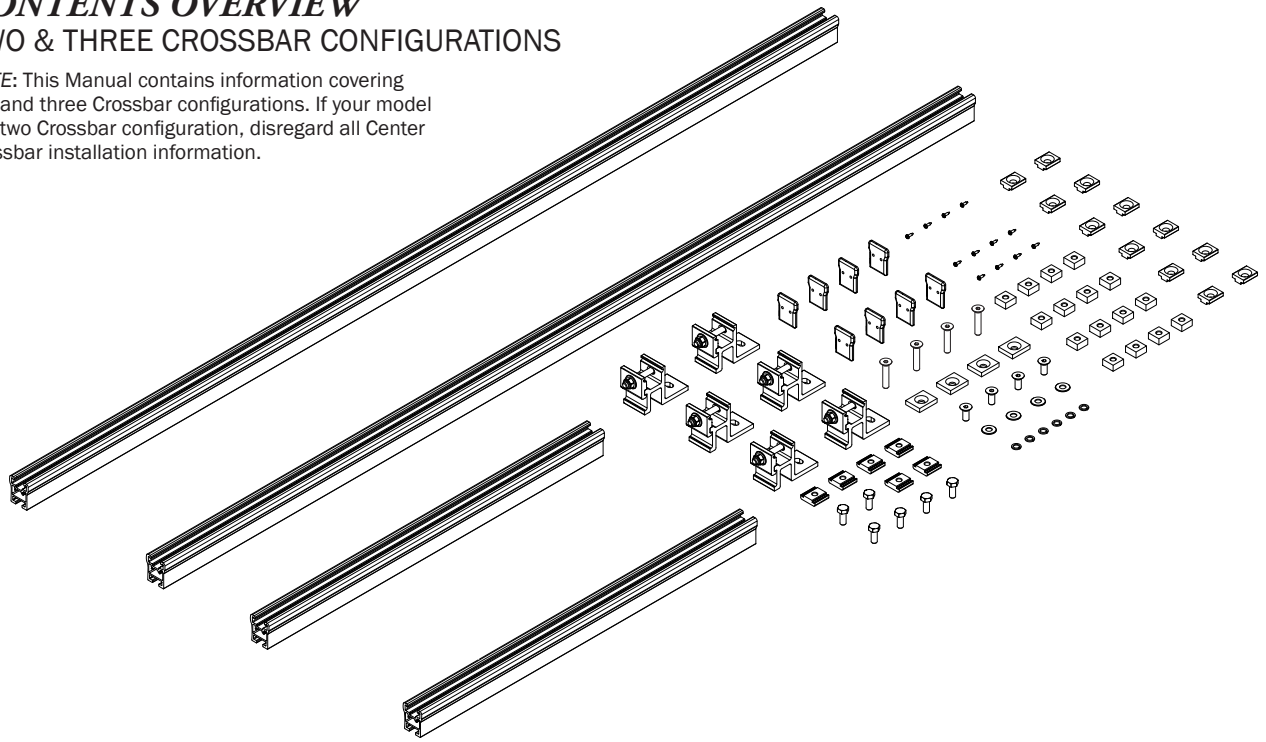

1—FBM-1010-BLK (Qty 1)
Channels, 106.00" w/Hardware Kit

24" Channels (2X)

62" Channels (2X)



Brackets (6X)

M8 X 45MM (4X)

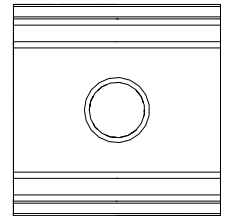

Aluminum Strip Nut (6X)



End Caps (8X)



Screws (16X)

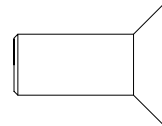

M8 x 20MM (12X)

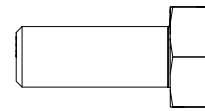

M8 x 20MM (6X)

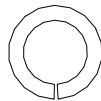

5/16" Lock Washer (6X)

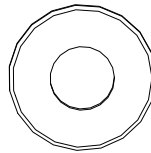

5/16" Flat Washer (6X)

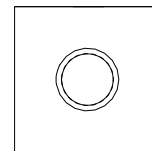

Square Nut (16X)

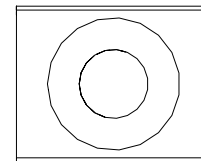

T Slot Insert (12X)

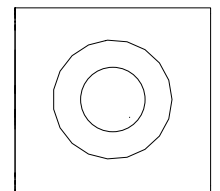

Connector Plate (4X)

2—Crossbars (shown for illustrative purposes only)
Ordered separately

ErgoRack, Gen4

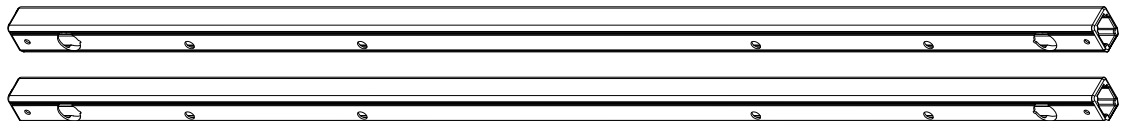

AluRack

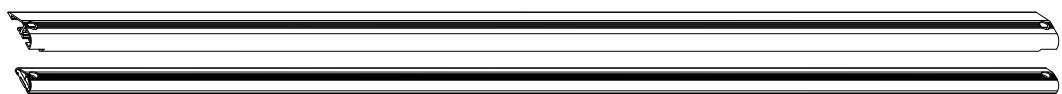

H1 HIGH ROOF (83.90")

FBM ASSEMBLY SEQUENCE

3

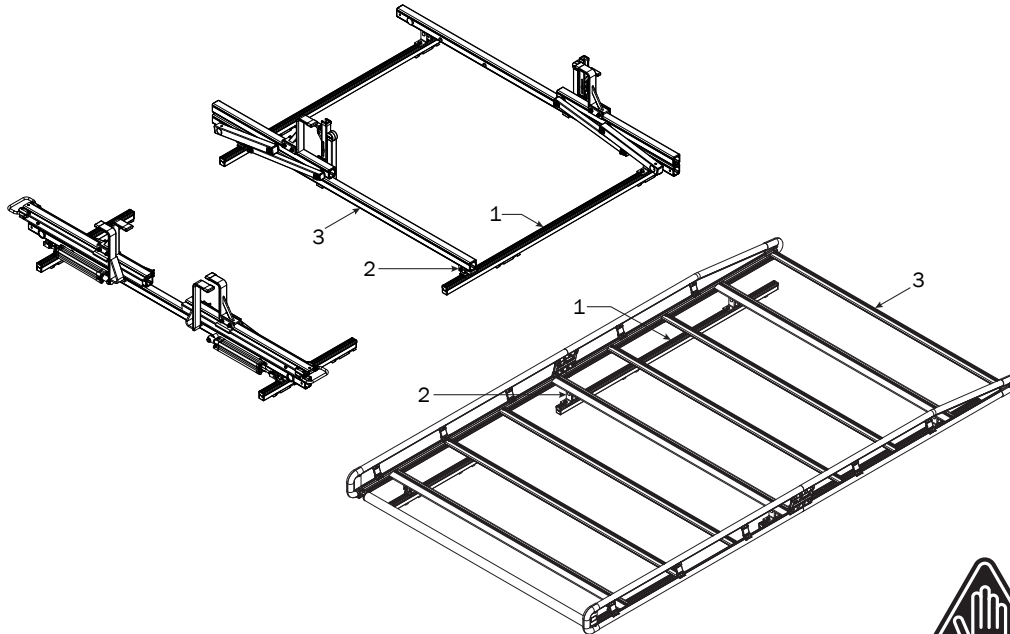

NOTE: Base, Rotation, Crossbar, and Side Rail features are shown for illustrative purposes only. These features are not included with this Base Mounting Kit, and must be purchased separately.



NOTE: Due to installation complexity, it is recommended to read through Steps 1.1 to 1.4 to understand Mounting orientation prior to assembling.

STIFF CHANNELS

- 1.1** Assemble the Channel Mounts as shown below. Mounting Bracket A front and B rear holes do not receive hardware until Step 1.4. All Mounts labeled C receive all hardware as shown.

Do not tighten the T Slot Insert bolts until Step 1.7

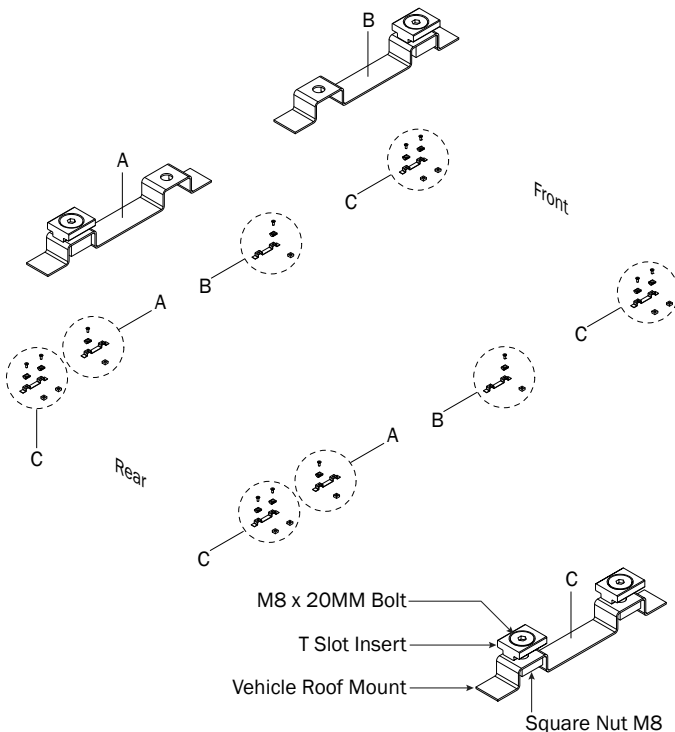

- 1.2** Slide the Front and Rear Channels onto the vehicle's OEM Roof Mounts and set distances as shown.

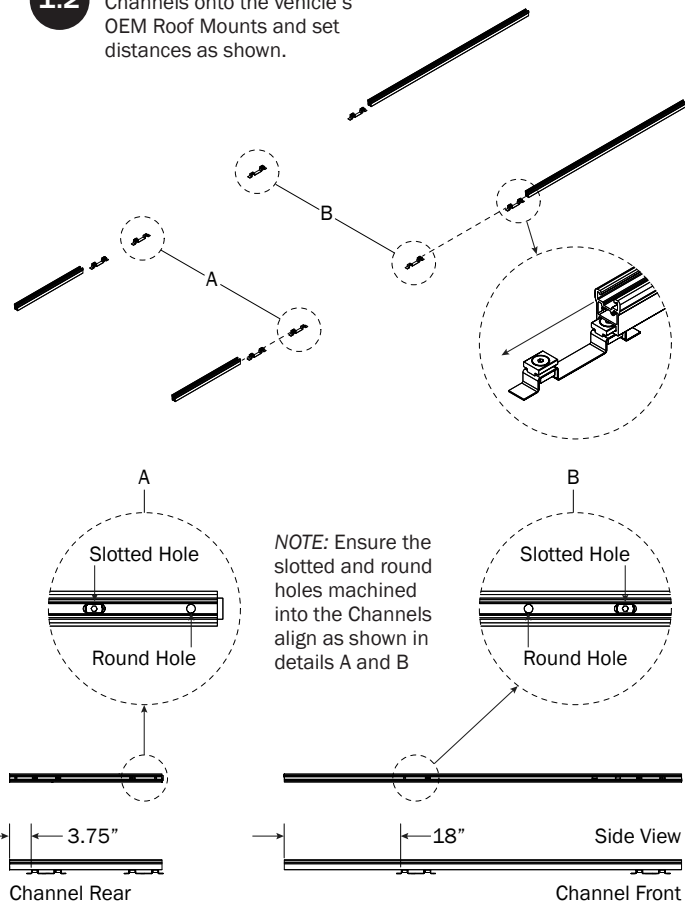

1.3

Slide one Channel Connector into the front end of each Rear Channel, and fasten with an M8 x 45MM bolt and square nut. Do not tighten until Step 1.6

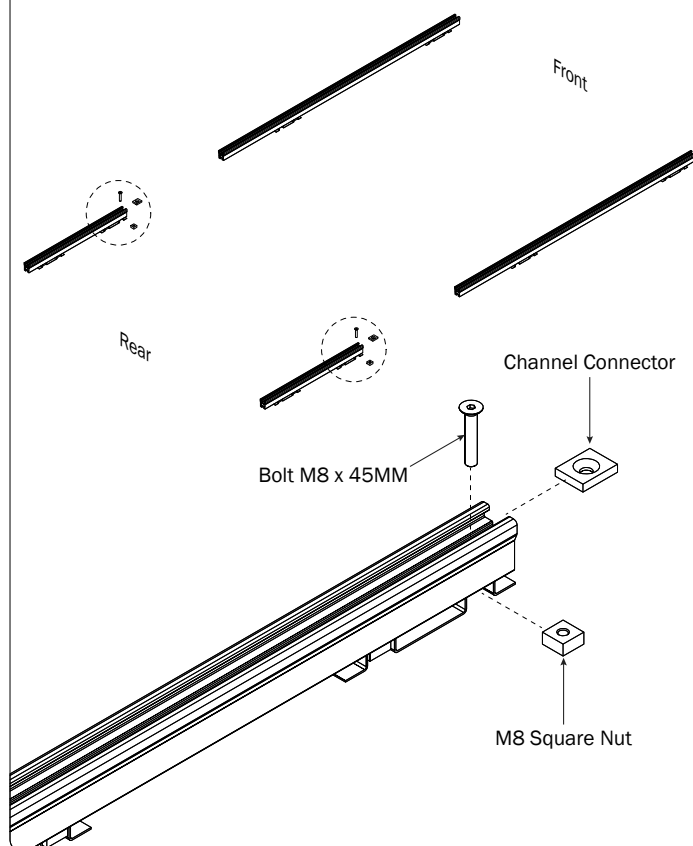
**1.4**

Slide one Channel Connector into the back end of each Front Channel, and fasten with an M8 x 45MM bolt and square nut. Do not tighten until Step 1.6

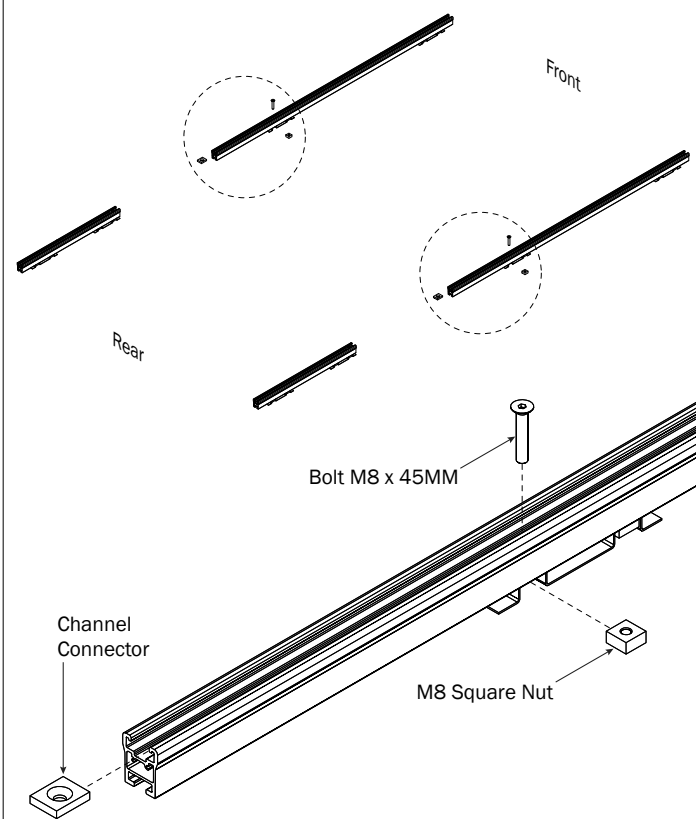
**1.5**

Using a 5MM Hex Head Socket and torque wrench, tighten the four M8 x 45MM Flat Head Bolts to 90 in-lbs shown at Step 1.6

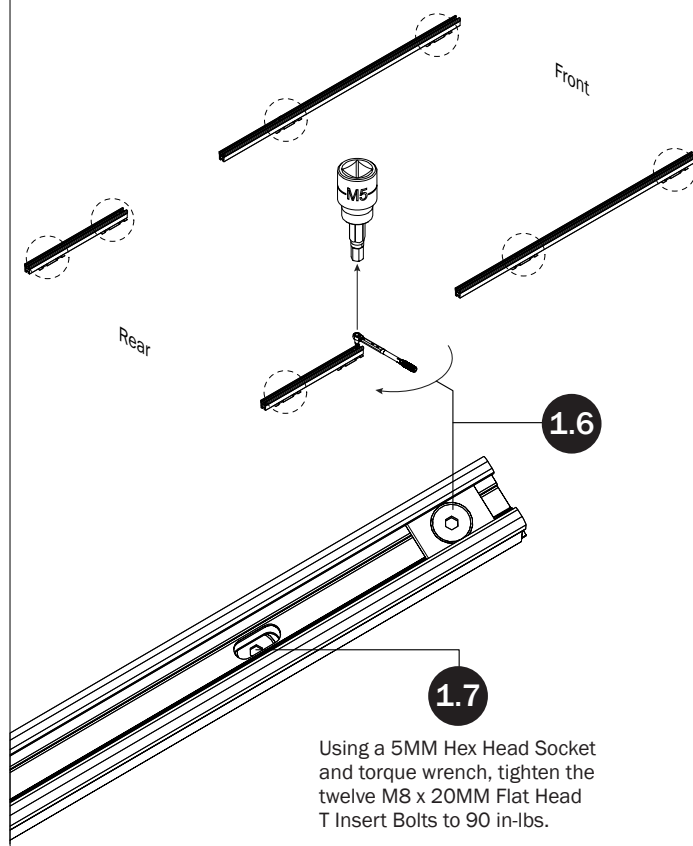
**1.6****1.7**

Using a 5MM Hex Head Socket and torque wrench, tighten the twelve M8 x 20MM Flat Head T Insert Bolts to 90 in-lbs.

MOUNTING BRACKETS

2.1

Slide one Aluminum Strip Nut into each end of the Front and Rear Channels, then attach the Channel Caps

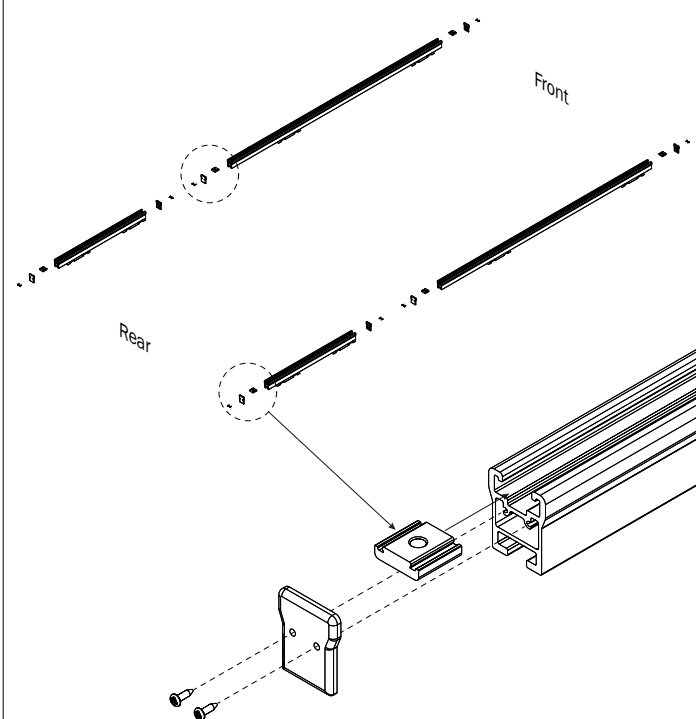

2.2

Using the supplied fastening hardware, attach the Crossbar Mounting Brackets into the Aluminum Strip Nuts placed into the Channels at Step 2.1.

3 Crossbar models:
Position the center
Mounting Brackets
as shown.

*2 & 3 Crossbar models:
Position the front Mounting
Brackets as shown.

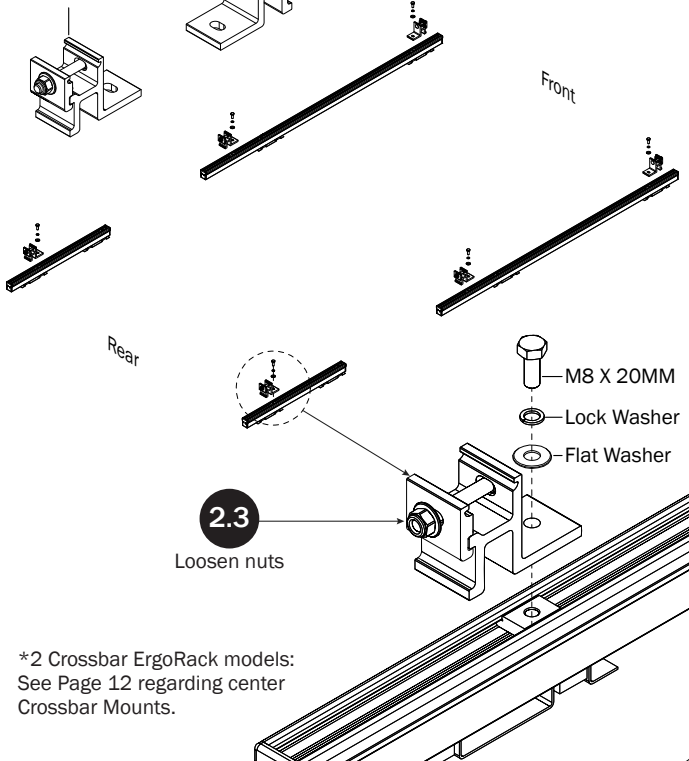

2.4

Set to distances shown below:
Use Dimensions A for 2 Crossbar models.
Use Dimensions B for 3 Crossbar models.

Do not torque the Crossbar Mounting Brackets until Step 3.4.
Finger-tighten them into designated dimension to hold them in
place, then proceed to your Feature (FEA) Assembly Manual.

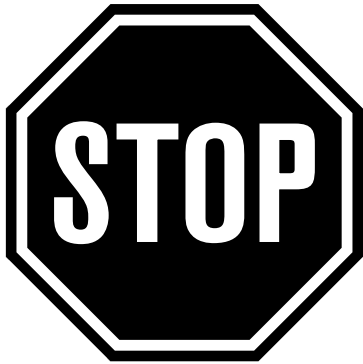
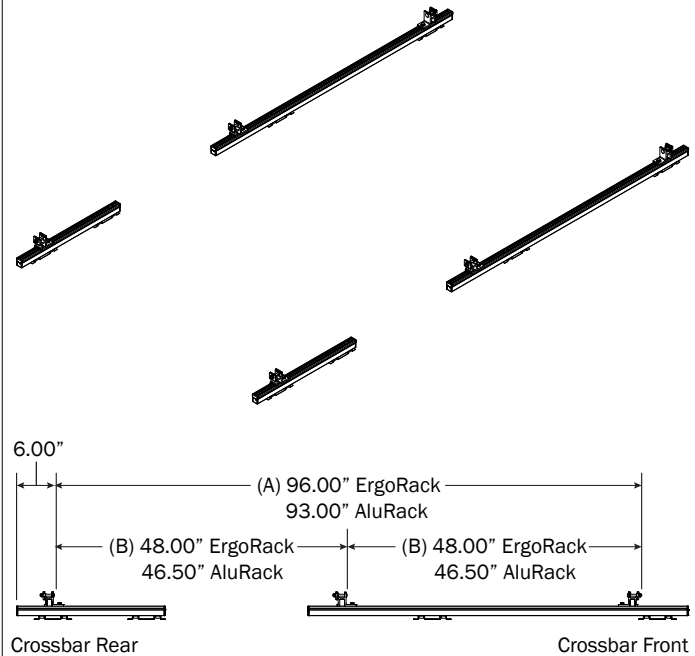

Do not mount the Crossbars to this FBM system at this time.

Refer to the respective FEA or AR Assembly Manual(s)
included with your chosen rack configuration features.
Depending upon the features chosen, you may need to
perform a complete feature assembly onto the Crossbars or
Side Rails as noted in that feature's Assembly Manual.

WARNING: Failure to position the Crossbars as shown in this
FBM Assembly Manual may result in damage to the sliding
door and/or ladder rack.

NOTE: Crossbars, Side Rails, Base, Clamp Down, or Rotation
features are not included in this FBM kit, and must be
purchased separately. To purchase applicable features and
accessories, please contact your authorized distributor, or a
Prime Design Sales & Service Representative.

5

CROSSBARS

Shown with LH Base, and
RH Rotation for illustrative
purposes only

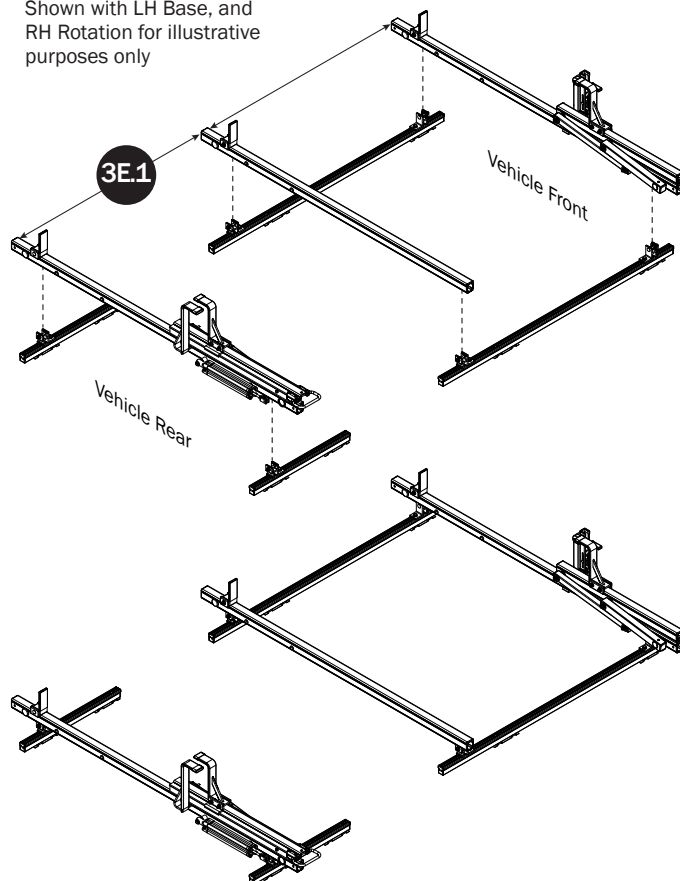
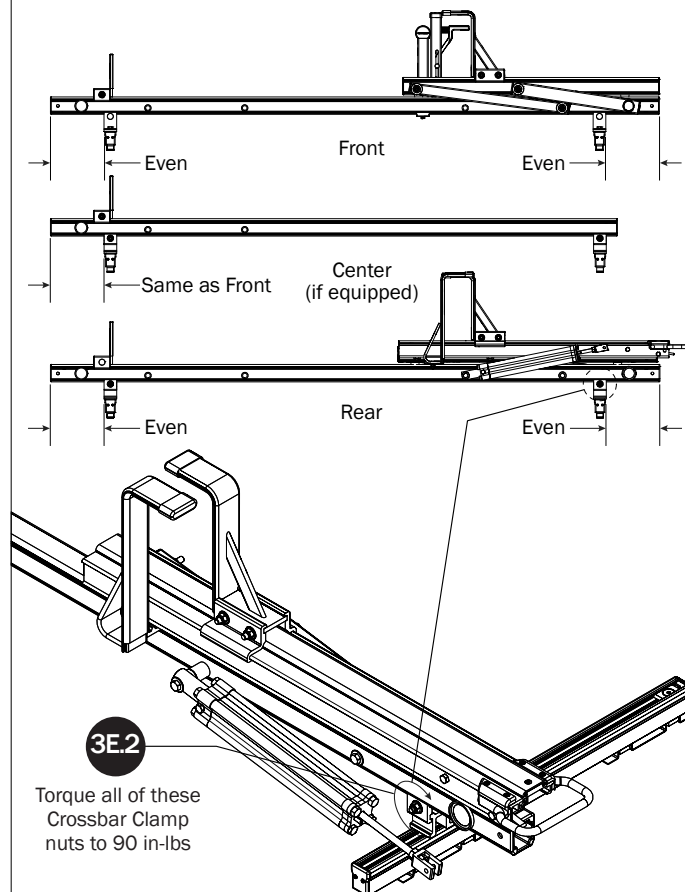
**CROSSBAR ADJUSTMENT****3E.3**

Verify the specified
distance from the
ends of both Mounting
Bracket to the ends of
both Channels.

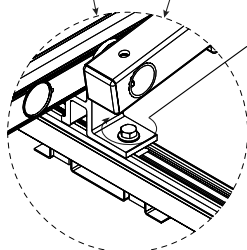
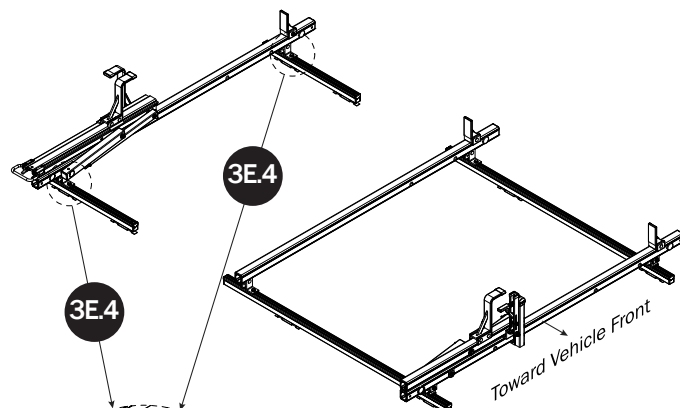
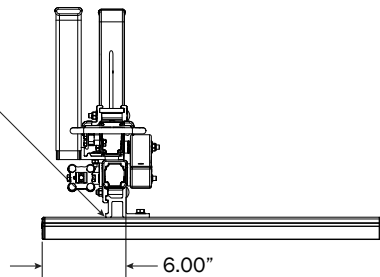

Torque only the Rear Crossbar Mounting
Bracket bolts to 90 in-lbs at this time.

The Center (if equipped) and Front
Crossbar Mounting Brackets will
be torqued to specification when
designated in the respective Feature
(FEA) Assembly Manual.

CROSSBARS (ALURACK)

Shown with H1 AluRack
for illustrative purposes only

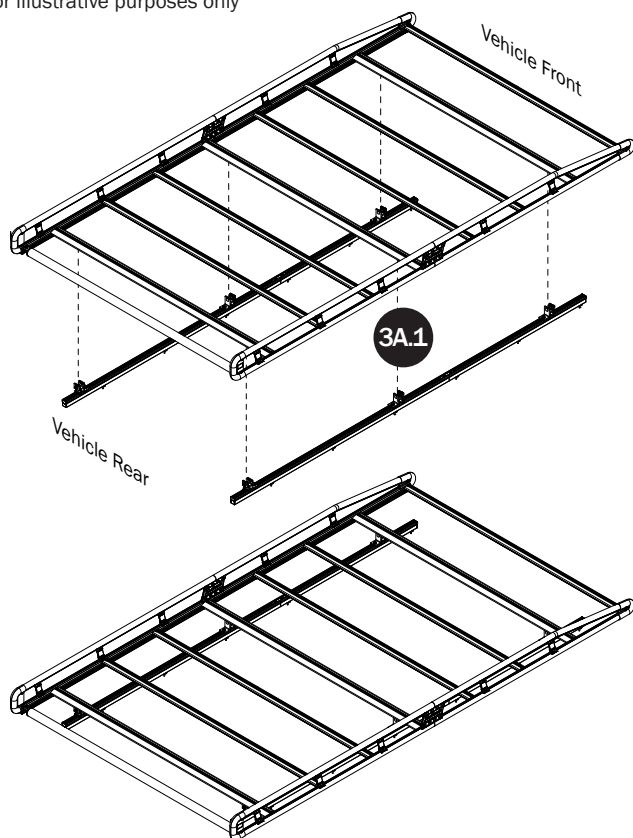

CROSSBAR ADJUSTMENT

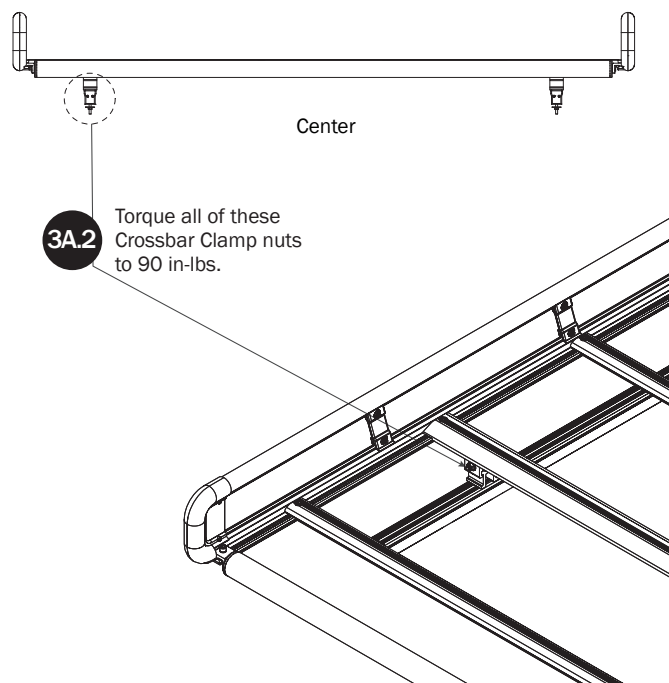

3A.3

Verify the specified distance from the ends of both Mounting Bracket to the ends of both Channels.

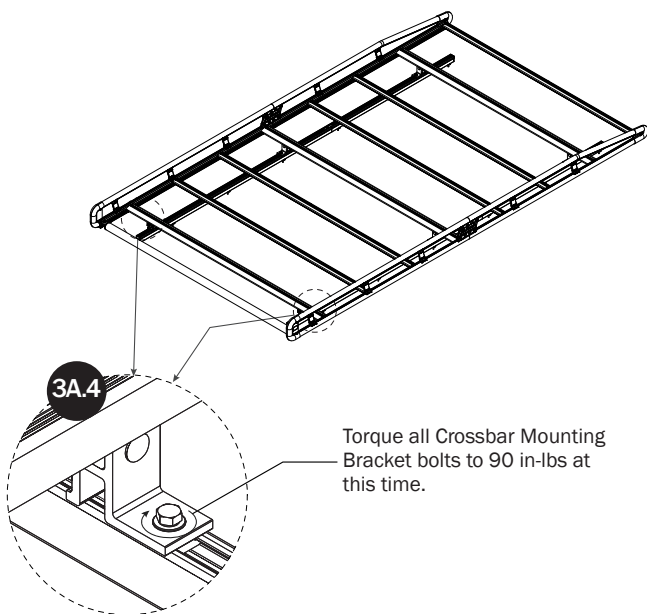
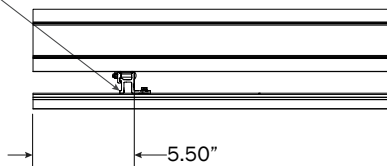

H2 HIGH ROOF (106.00")

FBM ASSEMBLY SEQUENCE

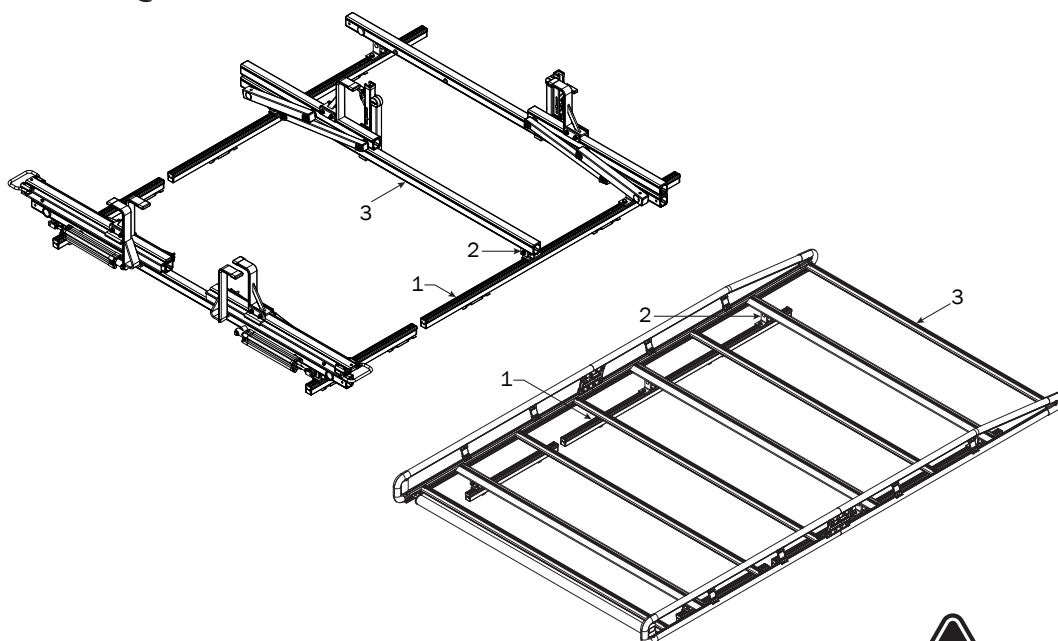

NOTE: Base, Rotation, Crossbar, and Side Rail features are shown for illustrative purposes only. These features are not included with this Base Mounting Kit, and must be purchased separately.



NOTE: Due to installation complexity, it is recommended to read through Steps 1.1 to 1.4 to understand Mounting orientation prior to assembling.

STIFF CHANNELS

1.1

Assemble the Channel Mounts as shown below. Mounting Bracket A front holes do not receive hardware until Step 1.4. All Mounts labeled B receive all hardware as shown.

Do not tighten the T Slot Insert bolts until Step 1.8

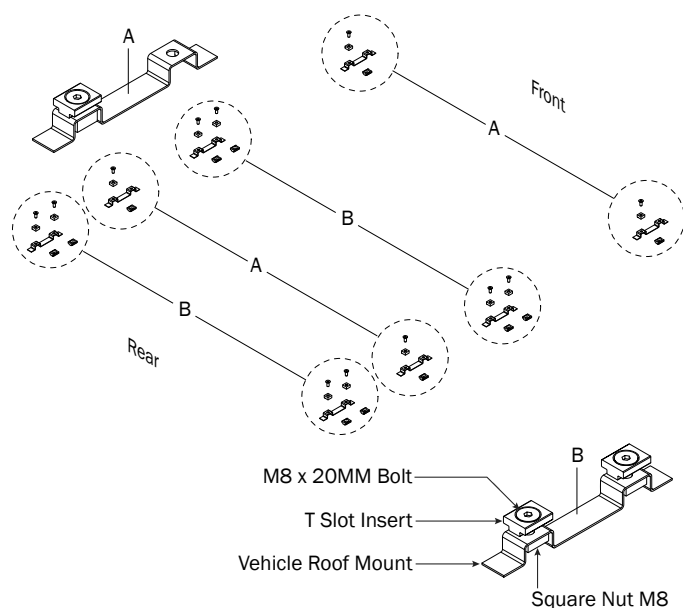

1.2

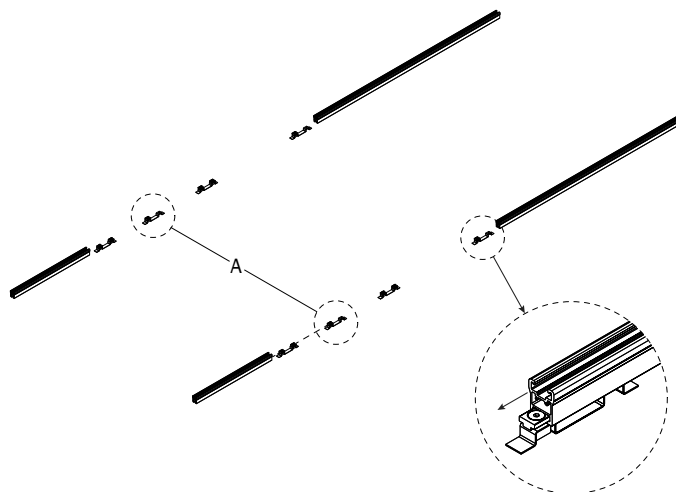
Slide the Front and Rear Channels onto the vehicle's OEM Roof Mounts. Do not position the Channels at this time.

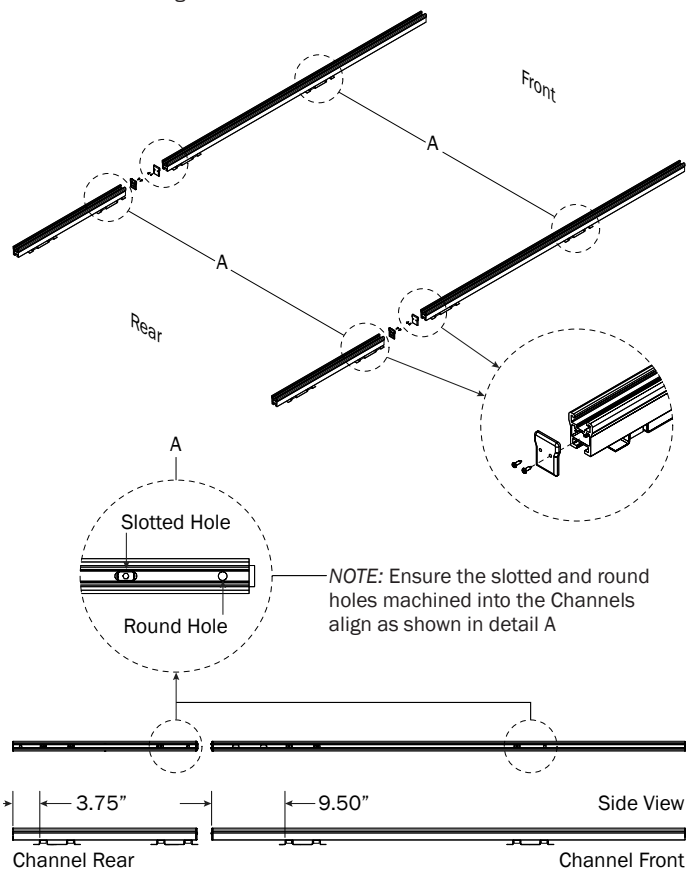

1.3

Assemble the Channel End Caps onto the front end of the Rear Channel, and back end of the Front Channel using the supplied fastening screws.



1.4

Slide one Channel Connector and one Aluminum Strip Nut into each end of the Front and Rear Channels.

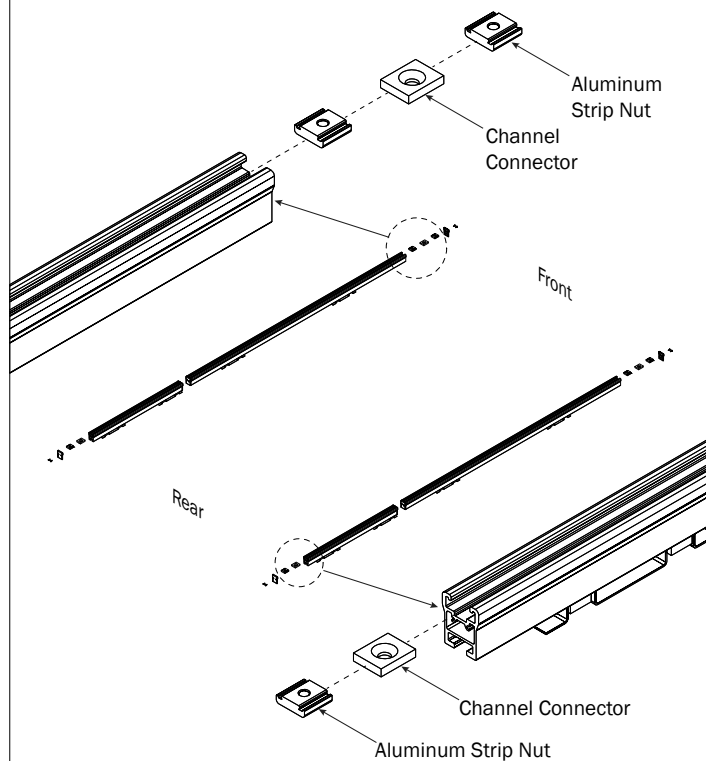

1.5

Slide one Channel Connector into the back end of each Front Channel, and fasten with an M8 x 45MM bolt and square nut. Do not tighten until Step 1.6

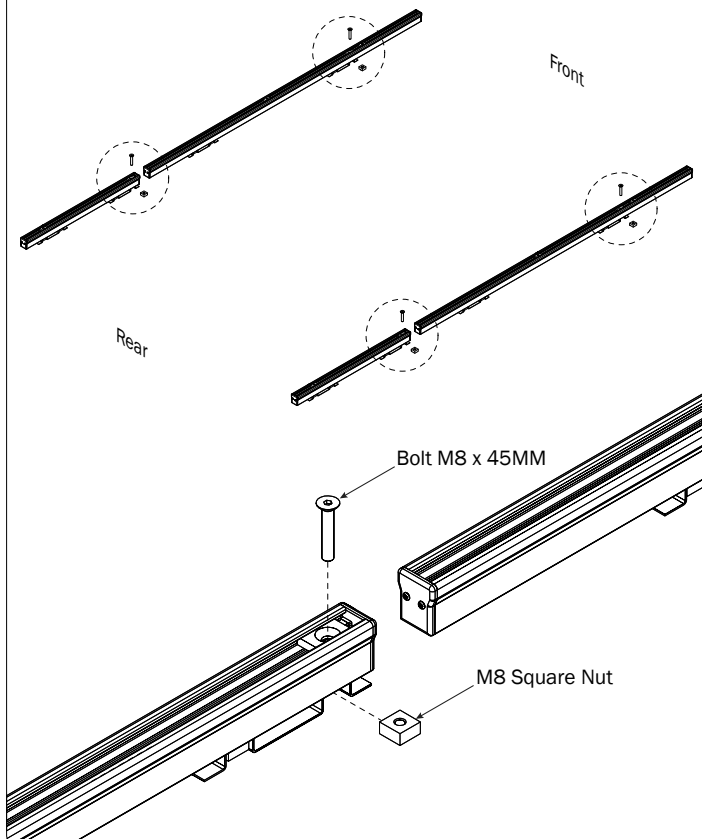

1.6

Using a 5MM Hex Head Socket and torque wrench, tighten the four M8 x 45MM Flat Head Bolts to 90 in-lbs shown at Step 1.7

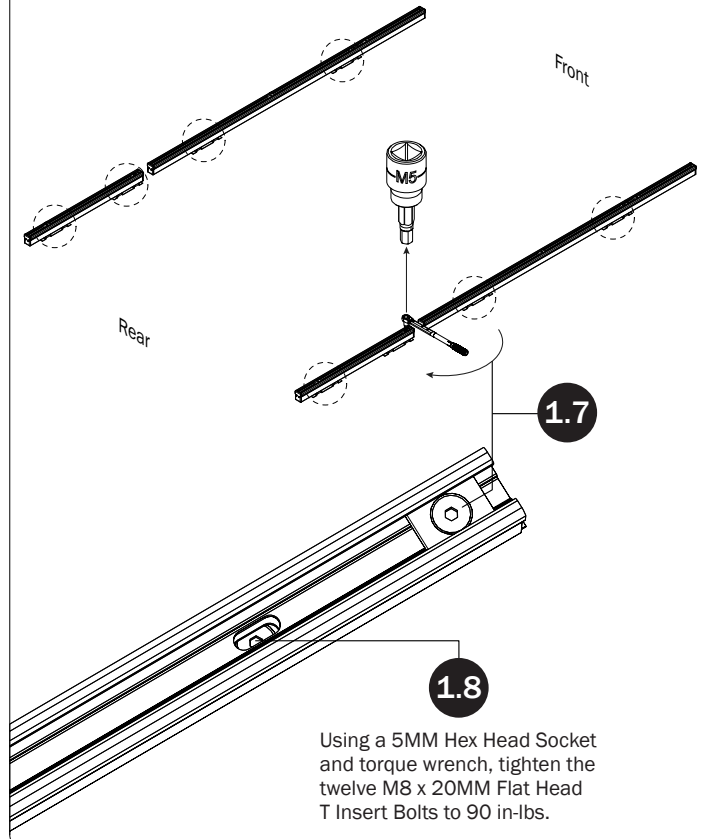

1.8

Using a 5MM Hex Head Socket and torque wrench, tighten the twelve M8 x 20MM Flat Head T Insert Bolts to 90 in-lbs.

MOUNTING BRACKETS

2.1

Using the supplied fastening hardware, attach the Crossbar Mounting Brackets into the Aluminum Strip Nuts placed into the Channels at Step 1.4

3 Crossbar models:
Position the center
Mounting Brackets
as shown.

*2 & 3 Crossbar models:
Position the front Mounting
Brackets as shown.

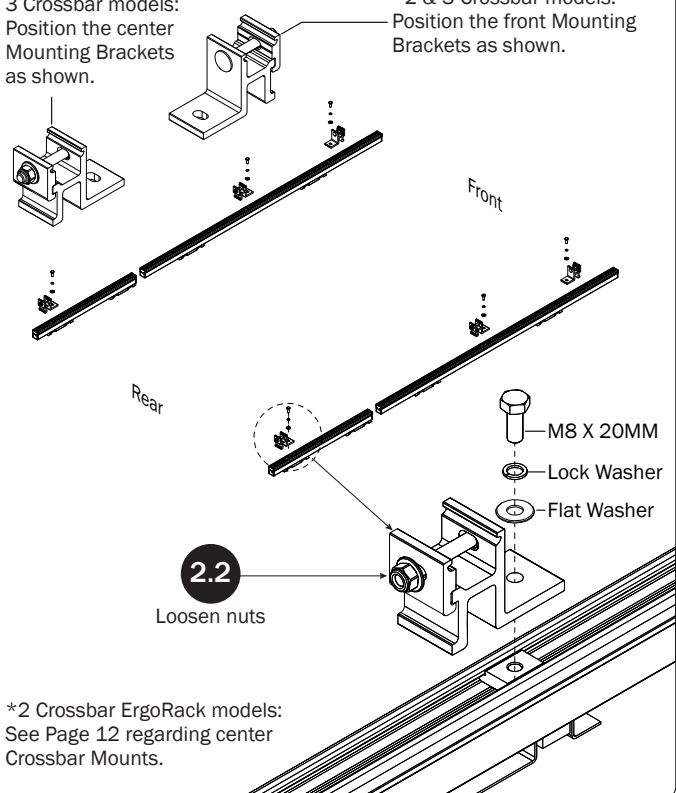

*2 Crossbar ErgoRack models:
See Page 12 regarding center
Crossbar Mounts.

2.3

Set to distances shown below:
Use Dimensions A for 2 Crossbar models.
Use Dimensions B for 3 Crossbar models.

Do not torque the Crossbar Mounting Brackets until Step 3.4.
Finger-tighten them into designated dimension to hold them in
place, then proceed to your Feature (FEA) Assembly Manual.

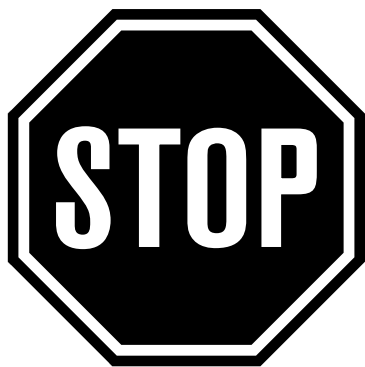
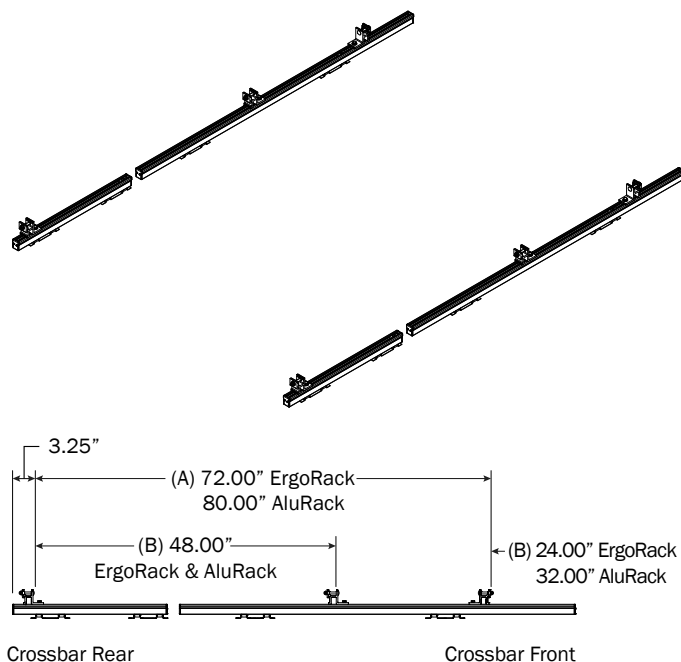

Do not mount the Crossbars to this FBM system at this time.

Refer to the respective FEA or AR Assembly Manual(s)
included with your chosen rack configuration features.
Depending upon the features chosen, you may need to
perform a complete feature assembly onto the Crossbars or
Side Rails as noted in that feature's Assembly Manual.

WARNING: Failure to position the Crossbars as shown in this
FBM Assembly Manual may result in damage to the sliding
door and/or ladder rack.

NOTE: Crossbars, Side Rails, Base, Clamp Down, or Rotation
features are not included in this FBM kit, and must be
purchased separately. To purchase applicable features and
accessories, please contact your authorized distributor, or a
Prime Design Sales & Service Representative.

CROSSBARS

Shown with LH Base, and RH Rotation for illustrative purposes only

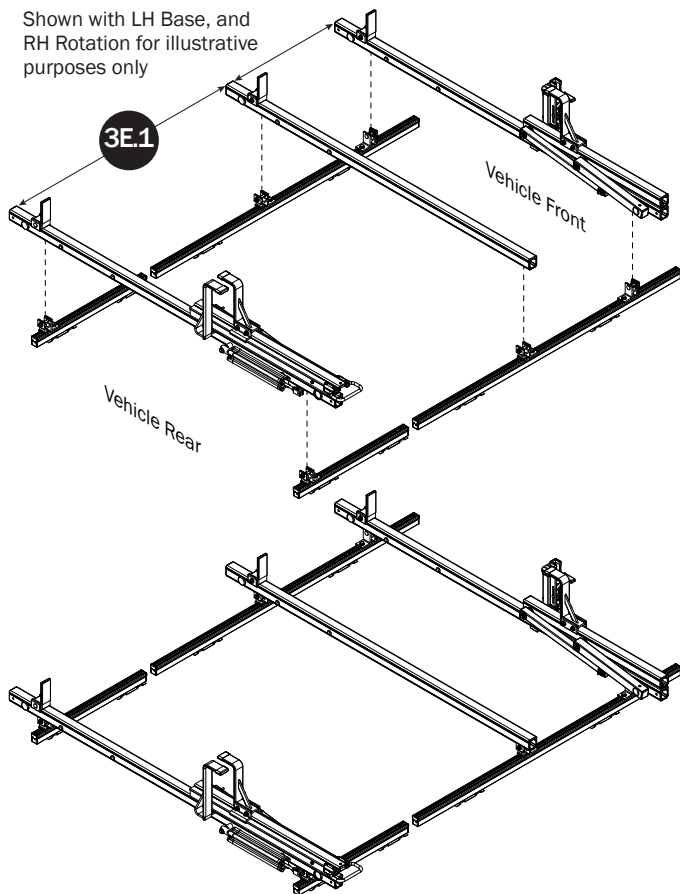

CROSSBAR ADJUSTMENT

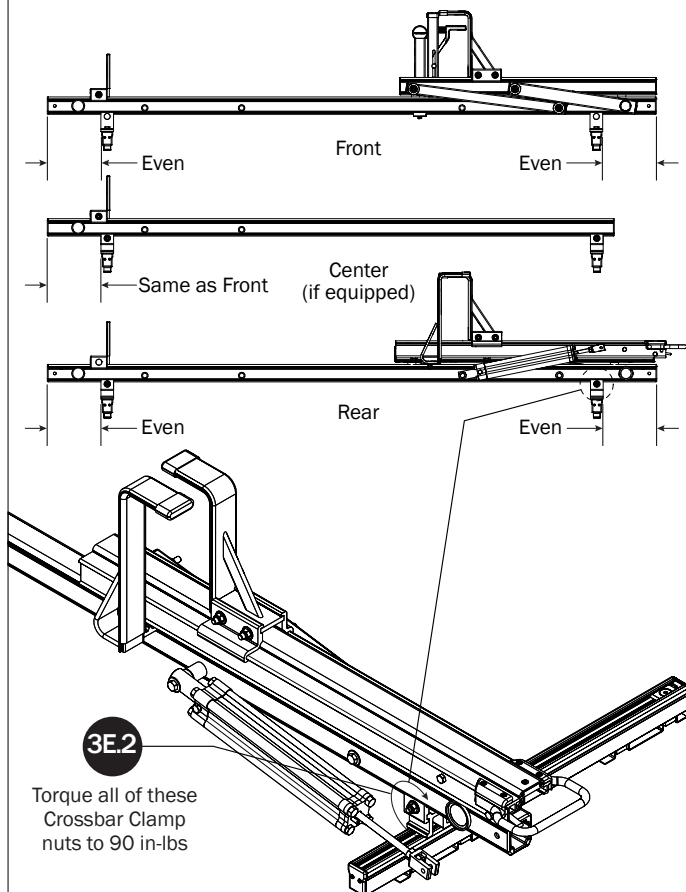

3E.3

Verify the specified distance from the ends of both Mounting Bracket to the ends of both Channels.

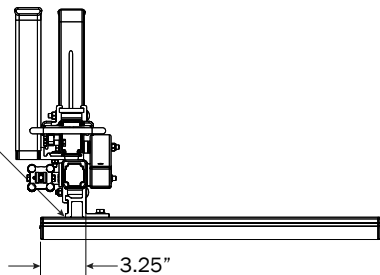

3E.4

Toward Vehicle Front

3E.4

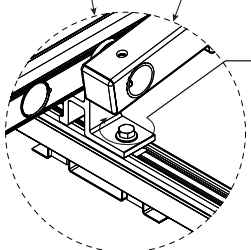

Torque only the Rear Crossbar Mounting Bracket bolts to 90 in-lbs at this time.

The Center (if equipped) and Front Crossbar Mounting Brackets will be torqued to specification when designated in the respective Feature (FEA) Assembly Manual.

CROSSBARS (ALURACK)

Shown with H2 AluRack
for illustrative purposes only

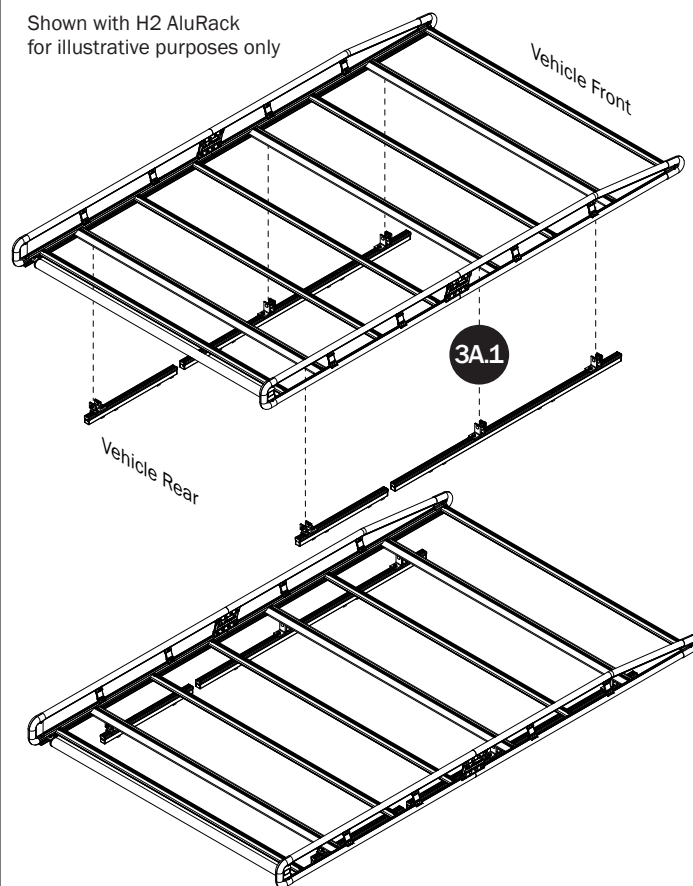
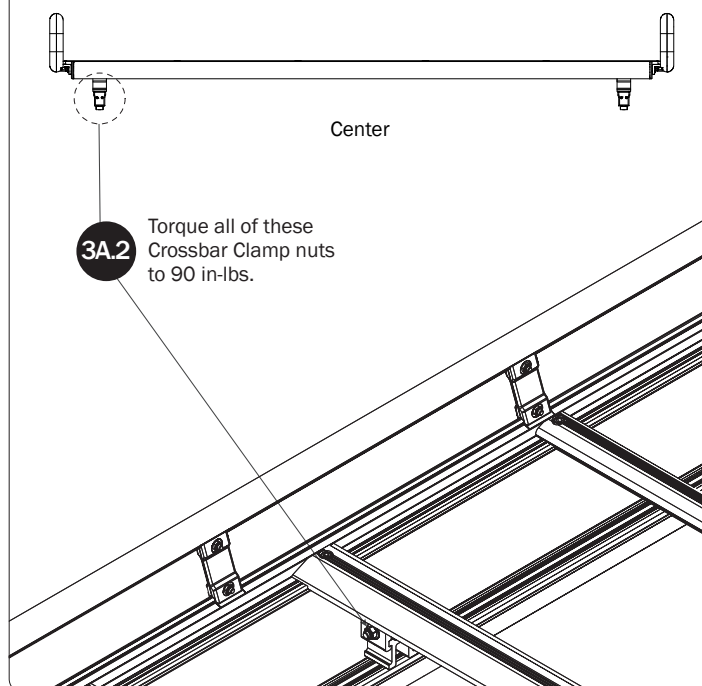
**CROSSBAR
ADJUSTMENT**

3A.3

Verify the specified
distance from the
ends of both Mounting
Bracket to the ends of
both Channels.

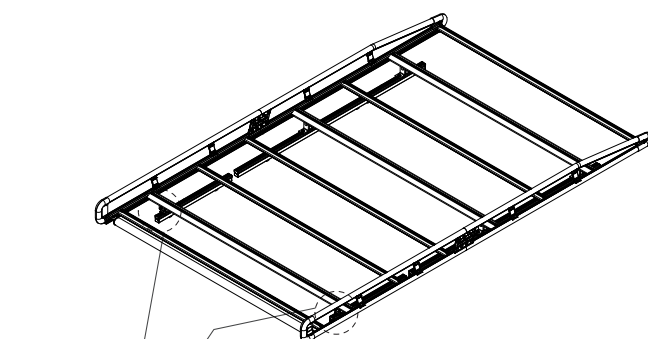
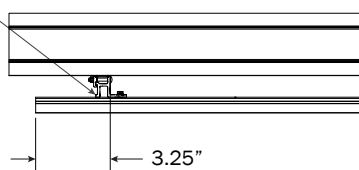

Torque all Crossbar Mounting
Bracket bolts to 90 in-lbs at
this time.

**CENTER CROSSBAR MOUNTS
FOR 2 CROSSBAR ERGORACK MODELS ONLY**

Place the center Crossbar Mounts into
the vehicle's glove box for future use.

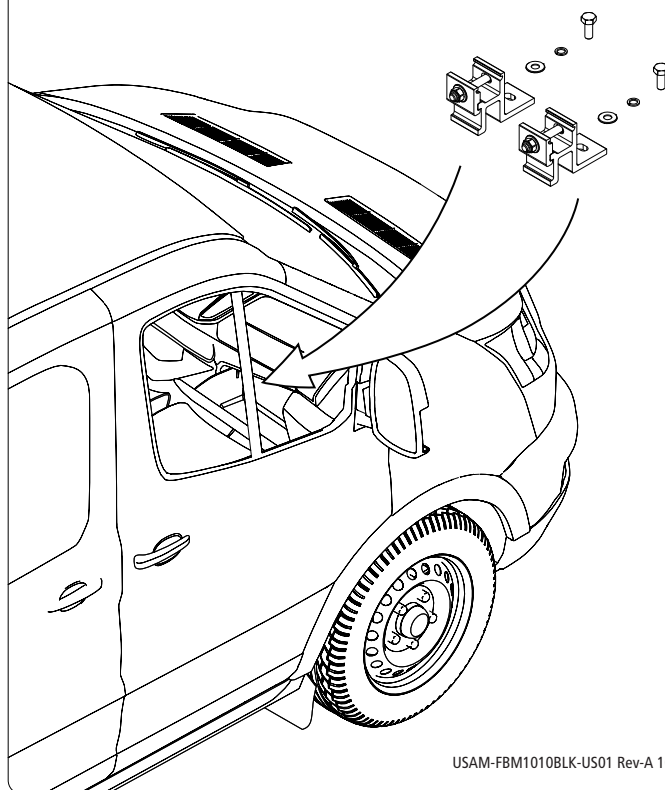

USAM-FBM1010BLK-US01 Rev-A 1019