

# PRIME DESIGN™

A Safe Fleet Brand

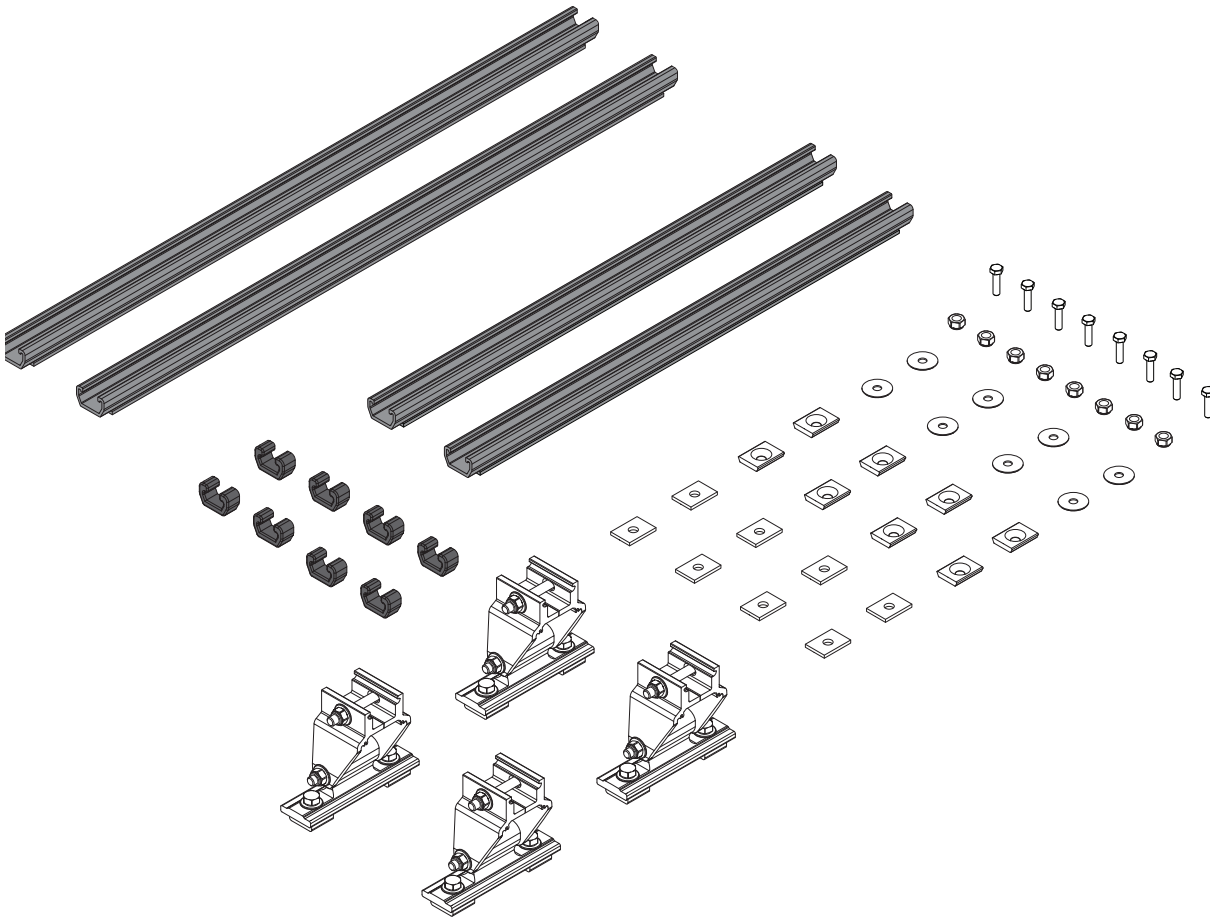

## 2014+ Ford Transit Connect L1/L2 Universal Base Mounting Kit

Page 2	Packaging Contents
Pages 3-7	Short Wheelbase (L1H1)
Pages 7-10	Medium Wheelbase (L2H1)

PRIME DESIGN, A SAFE FLEET BRAND

Address: 580 Opperman Drive, Eagan, MN 55123 • Toll Free: 1.8.PRIME.RACK  
Fax: 651-552-1799 • Email: info@primedesign.net • Website: www.primedesign.net

# PRIME RACK

# FBM-1012

# CONTENTS OVERVIEW

## TWO CROSSBAR CONFIGURATION

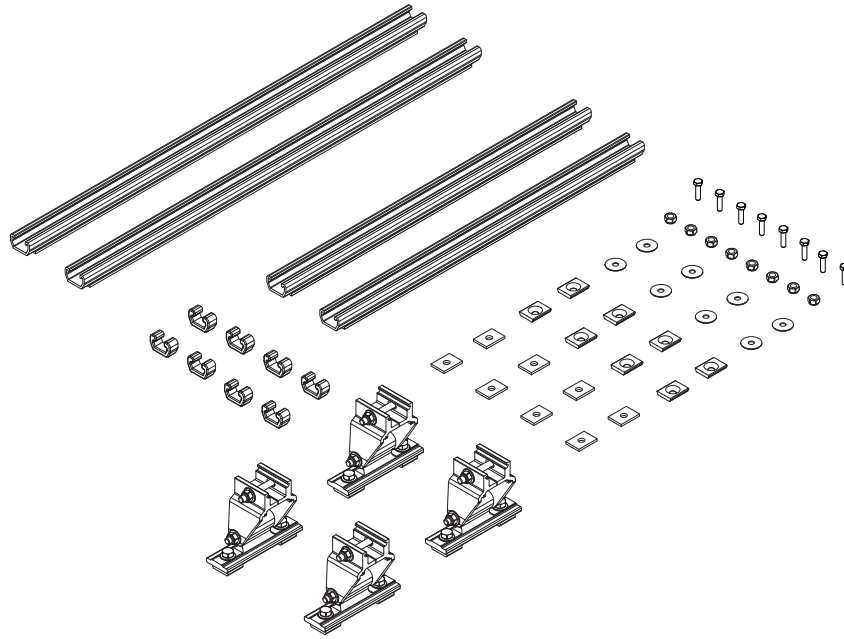

1—FBM-1012-BLK..... (Qty 1)  
Channel Pairs, w/Hardware Kit

20" Channels (2X)



26" Channels (2X)



M6 Locknut (8X)



M6 x 30MM Bolt (8X)



End Caps (8X)



Brackets (4X)

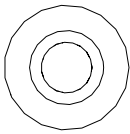

M6 Sealing Washer (8X)

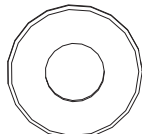

1/4" Flat Washer (8X)

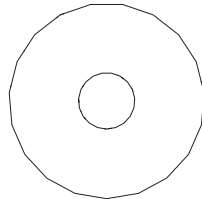

1/4" Washer (8X)

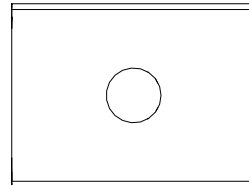

Mounting Plate (8X)

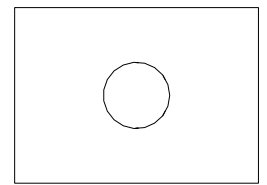

Foam Pad (8X)

2—Crossbars (shown for illustrative purposes only)  
Ordered separately

ErgoRack, Gen4

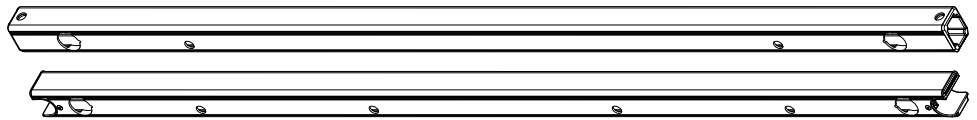

AluRack

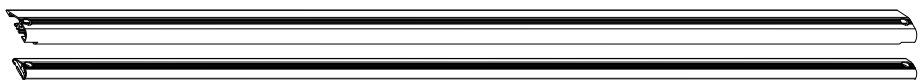

# L1 FBM ASSEMBLY SEQUENCE

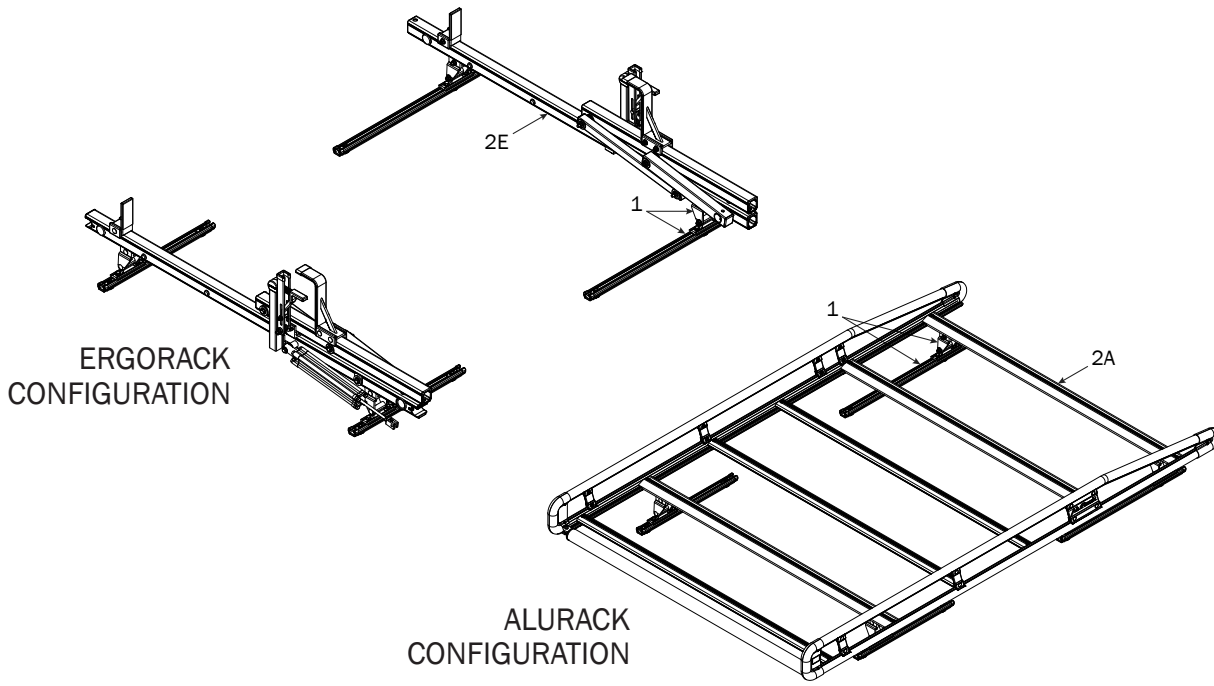

NOTE: Base, Rotation, Crossbar, and Side Rail features are shown for illustrative purposes only. These features are not included with this Base Mounting Kit, and must be purchased separately.

## L1 FBM-1012-BLK CHANNELS TO ROOF

**1.1** Front Mounting Brackets only: remove and save the hardware from the rear Bracket Nut as shown.

Set Front Mounting Brackets aside until Steps 1.5-1.6

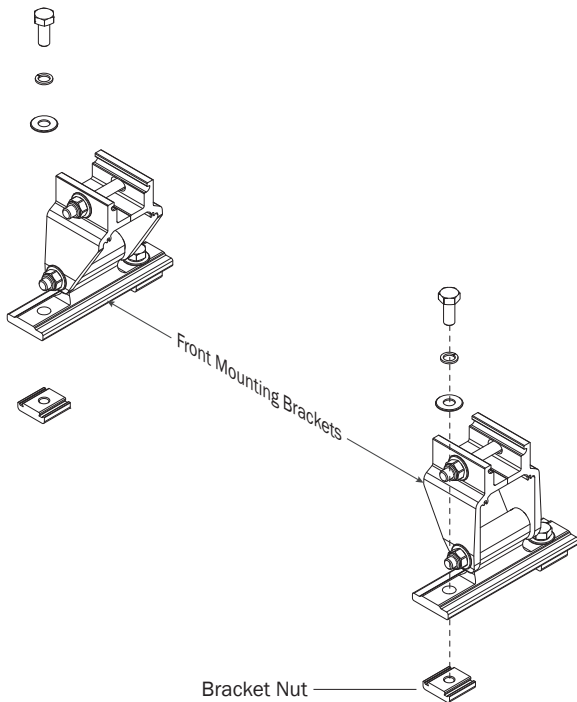

**1.2** Slide the Bracket Nuts from Step 1.1 into the Front Channels as shown.

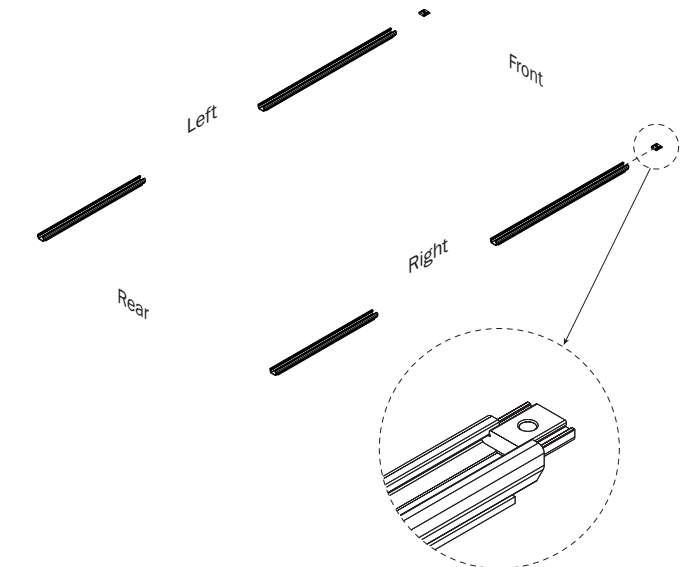
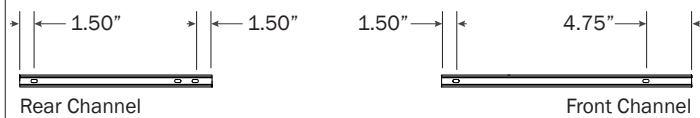
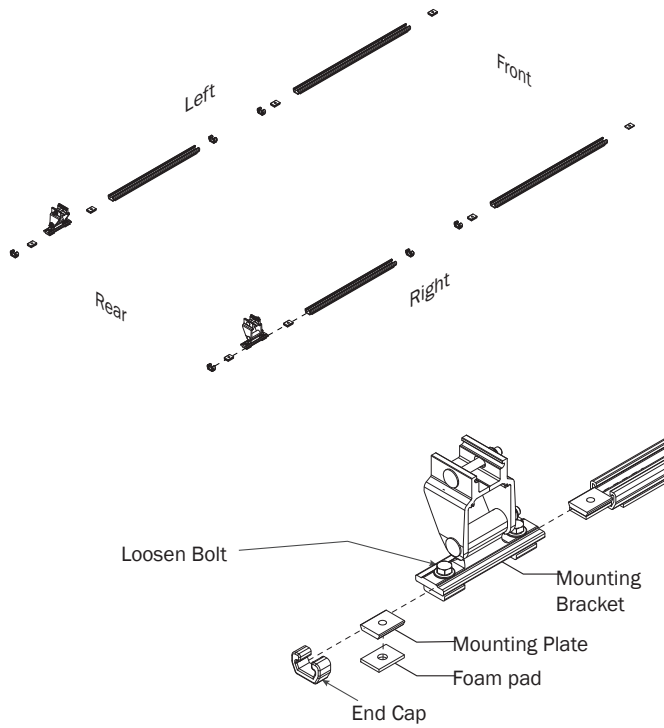

Fig. 1



**1.3** Install Channel Hardware as shown below.



**1.4** Install fastening hardware through the Channels as shown then torque the nuts to 60 in-lbs.

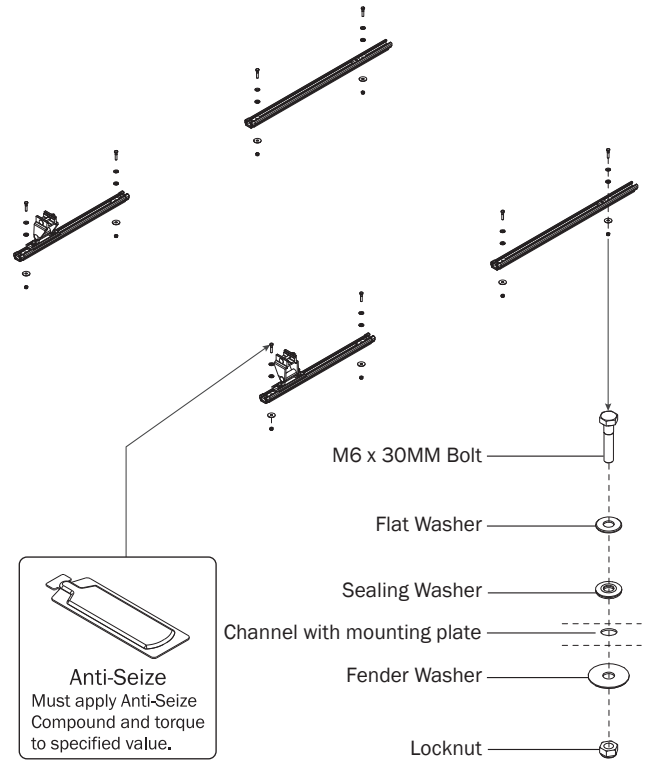

**1.5** Install the Front Mounting Brackets from Step 1.1 as shown and slide into position over the Bracket Nut.

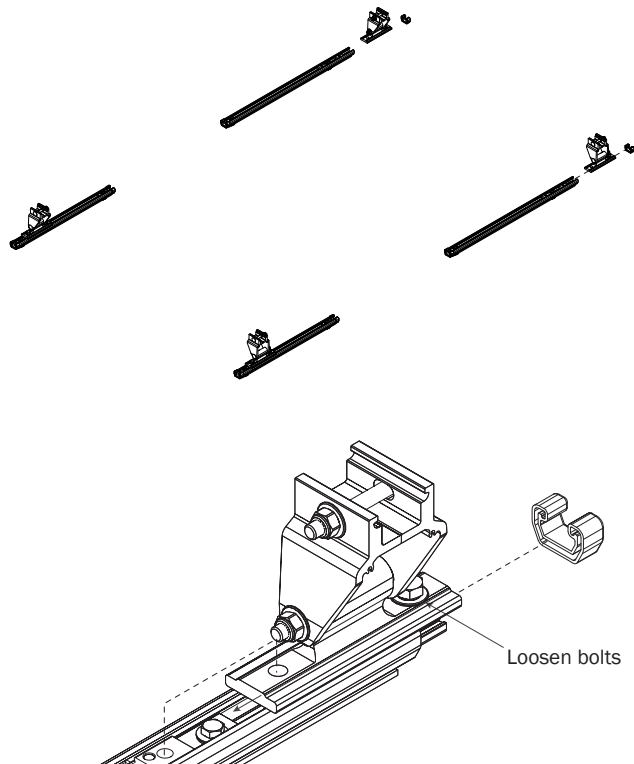

**1.6** Reinstall the Mounting Bracket Nut hardware as shown, and set Mounting Brackets to distances as shown in Fig. 2. Finger-tighten into position—do not torque until Steps 2.3–2.4.

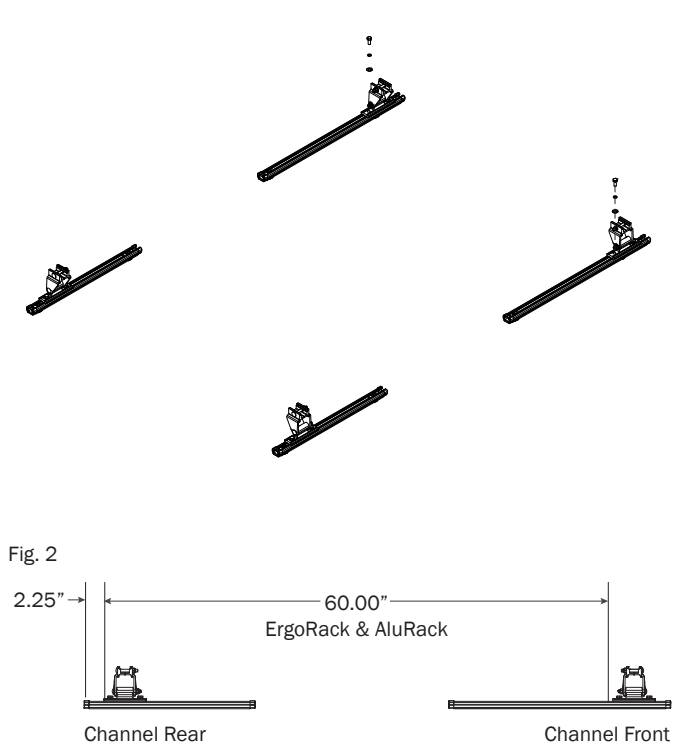



Do not mount the Crossbars to this FBM system at this time.

Refer to the respective FEA or AR Assembly Manual(s) included with your chosen rack configuration features. Depending upon the features chosen, you may need to perform a complete feature assembly onto the Crossbars or Side Rails as noted in that feature's Assembly Manual.

**WARNING:** Failure to position the Crossbars as shown in this FBM Assembly Manual may result in damage to the sliding door and/or ladder rack.

**NOTE:** Crossbars, Side Rails, Base, Clamp Down, or Rotation features are not included in this FBM kit, and must be purchased separately. To purchase applicable features and accessories, please contact your authorized distributor, or a Prime Design Sales & Service Representative.

### L1 CROSSBARS (ERGORACK)

Shown with LH Base, and RH Rotation for illustrative purposes only

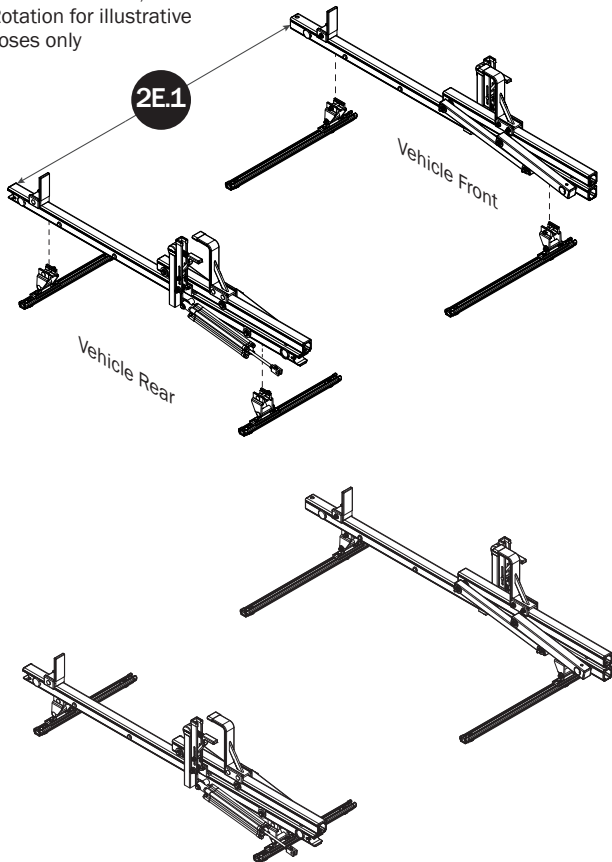

### CROSSBAR ADJUSTMENT

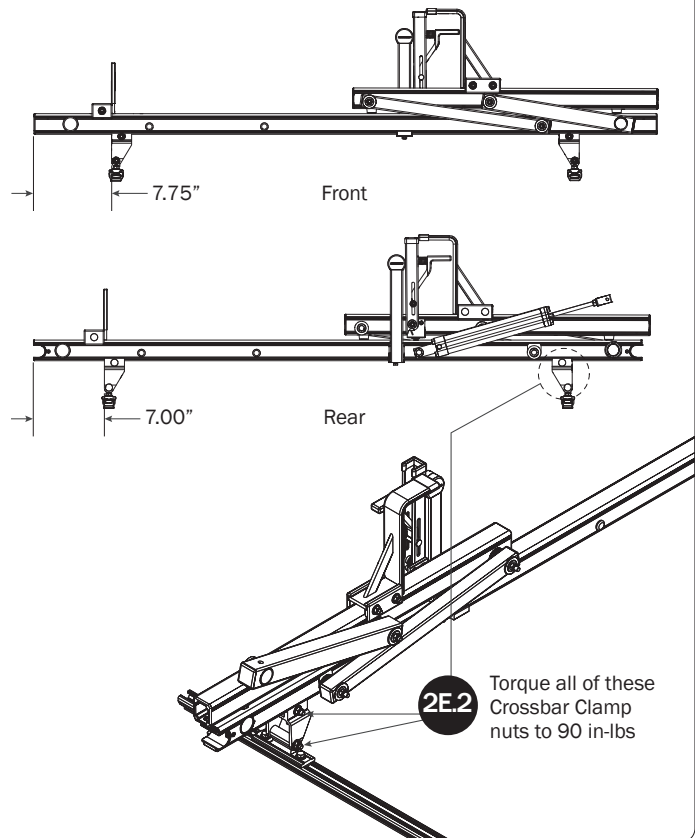

**2E.2** Torque all of these Crossbar Clamp nuts to 90 in-lbs

**2E.3**

Verify the specified distance from the ends of both Mounting Bracket to the ends of both Channels.

2.25"

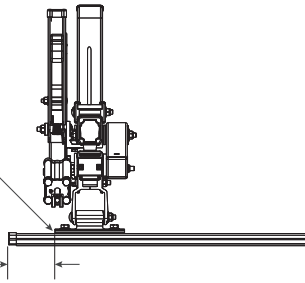

**2E.4**

Torque only the Rear Crossbar Mounting Bracket bolts to 90 in-lbs at this time.

The Front Crossbar Mounting Brackets will be torqued to specification when designated in the respective Feature (FEA or AR) Assembly Manual.

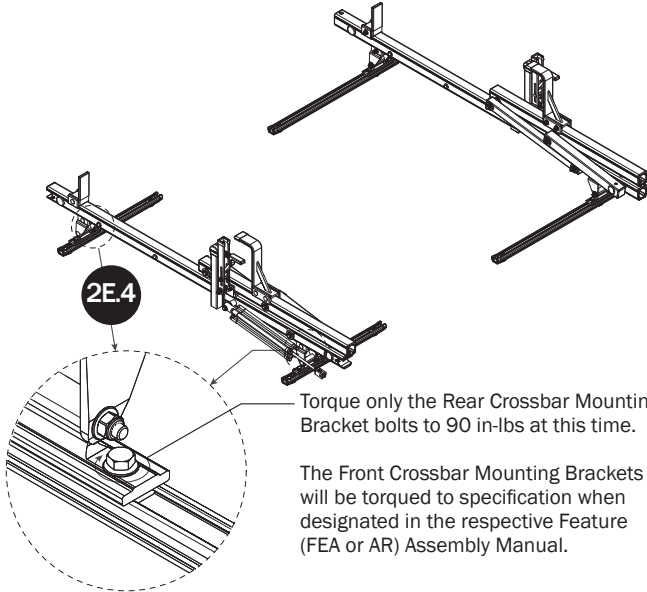

**L1 CROSSBARS (ALURACK)**

Shown with L1 AluRack for illustrative purposes only

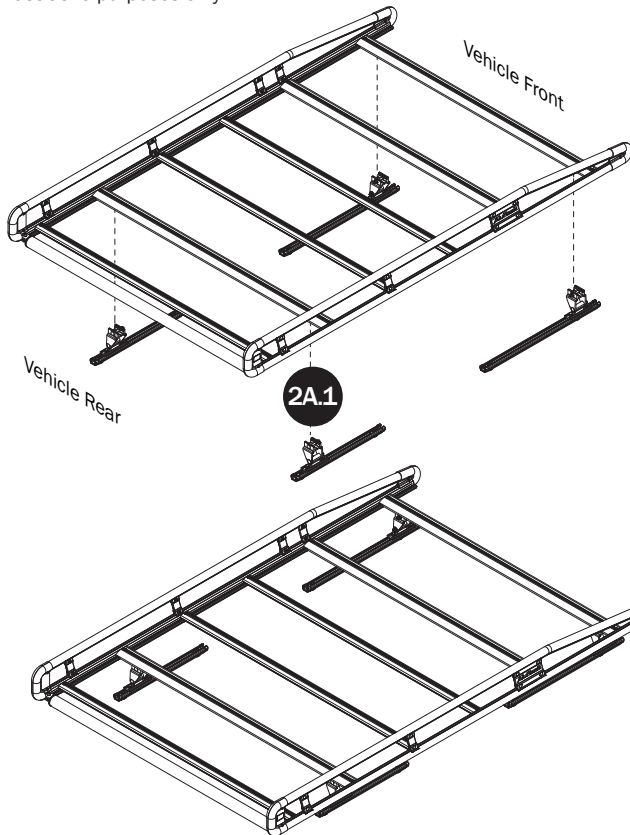

**CROSSBAR ADJUSTMENT**

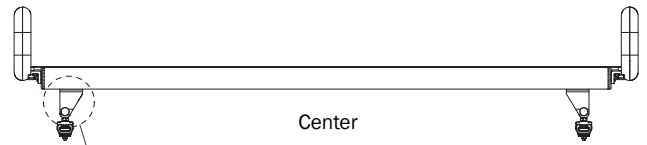

**2A.2**

Torque all of these Crossbar Clamp nuts to 90 in-lbs.

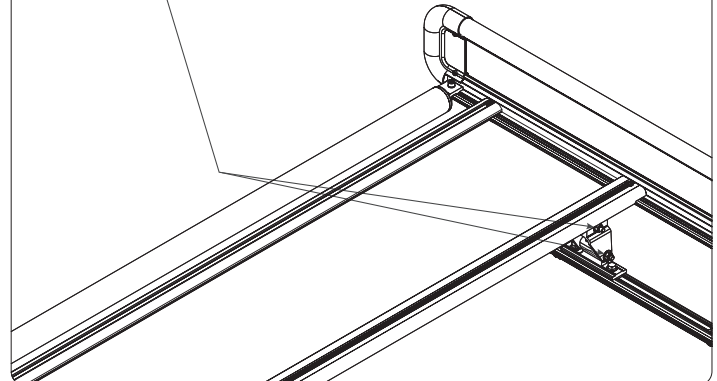

2A.3

Verify the specified distance from the ends of both Mounting Bracket to the ends of both Channels.

2.25"

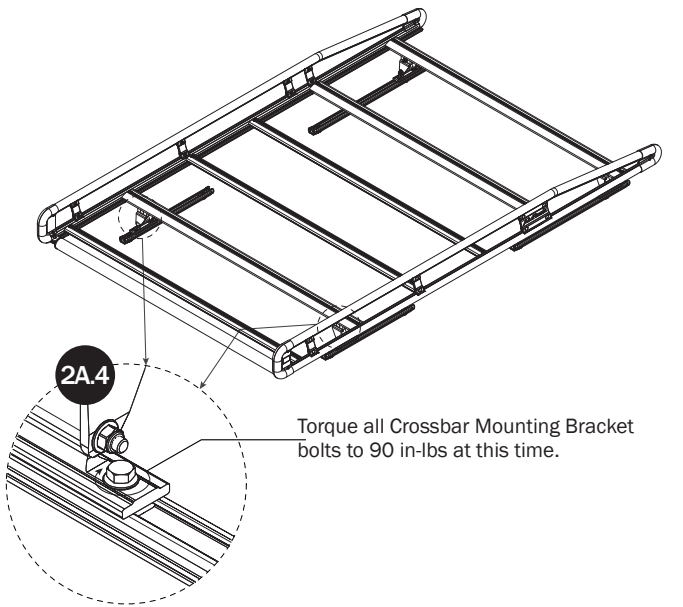

2A.4

Torque all Crossbar Mounting Bracket bolts to 90 in-lbs at this time.

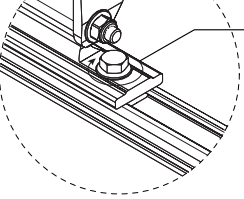

## L2 FBM ASSEMBLY SEQUENCE

ERGORACK  
CONFIGURATION

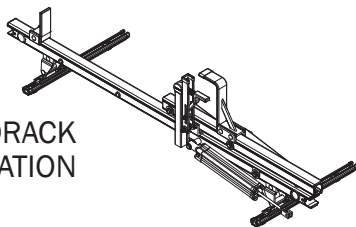

2E

1

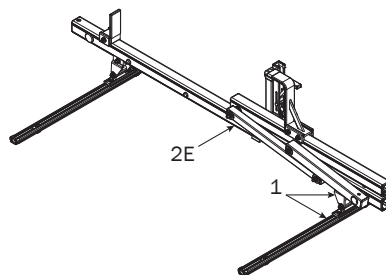

ALURACK  
CONFIGURATION

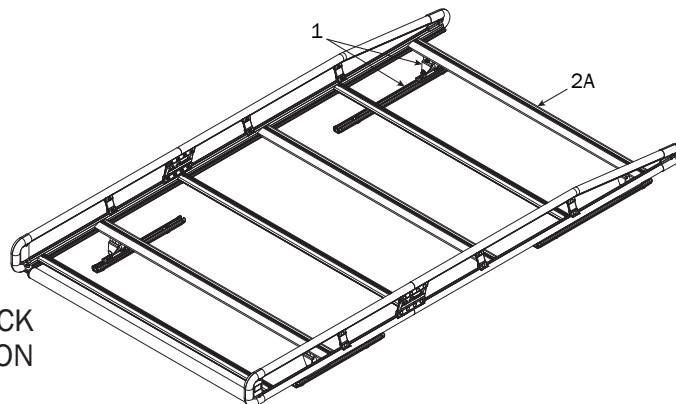

**NOTE:** Rotation, Crossbar, and Side Rail features are shown for illustrative purposes only. These features are not included with this Base Mounting Kit, and must be purchased separately.

**L2 FBM-1012-BLK**

**1.1** Install Channel Hardware as shown below.

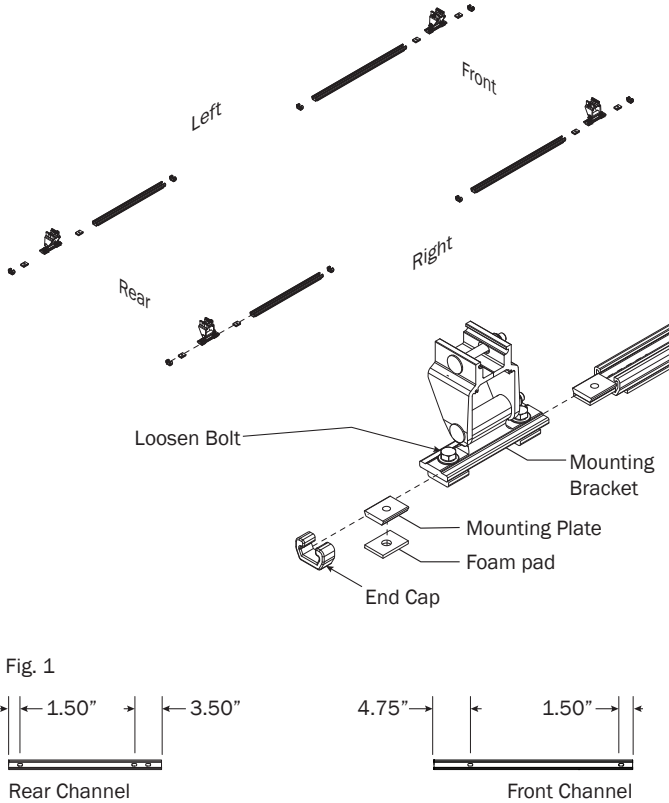

**1.2** Install fastening hardware through the Channels as shown then torque the nuts to 60 in-lbs.

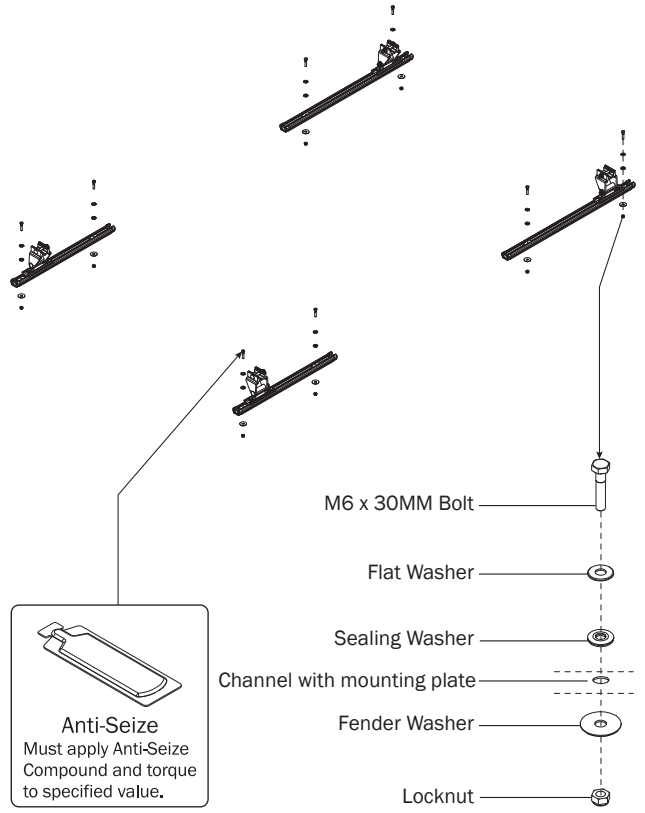

**1.3** Set Mounting Brackets to distances shown in Fig. 2. Finger-tighten into position—do not torque until Steps 2.3–2.4.

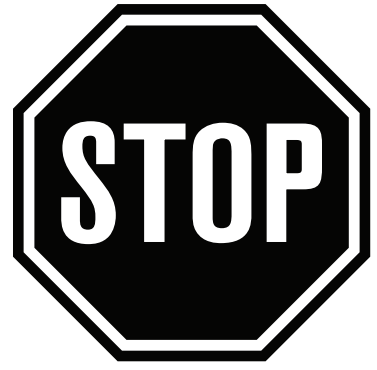
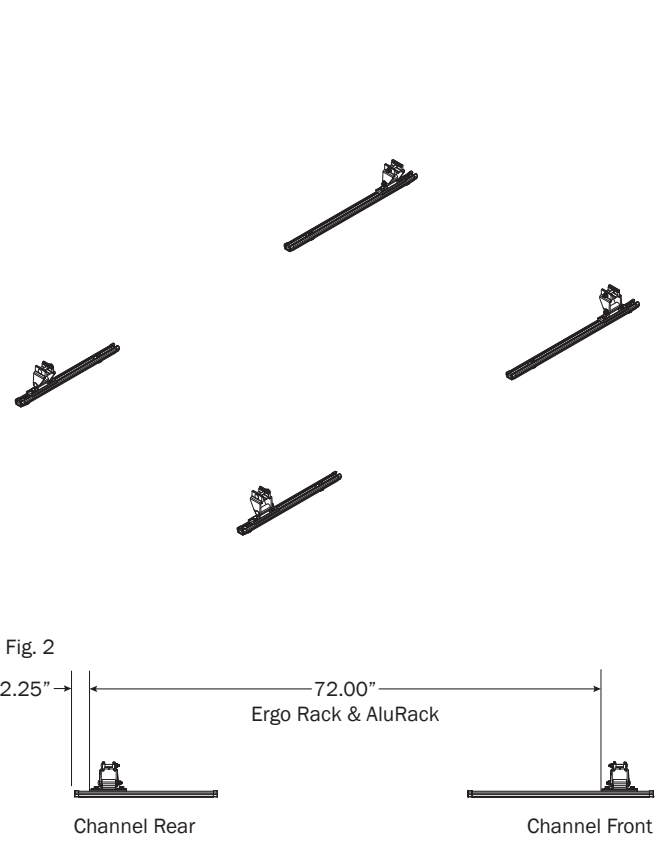

Do not mount the Crossbars to this FBM system at this time.

Refer to the respective FEA or AR Assembly Manual(s) included with your chosen rack configuration features. Depending upon the features chosen, you may need to perform a complete feature assembly onto the Crossbars or Side Rails as noted in that feature's Assembly Manual.

**WARNING:** Failure to position the Crossbars as shown in this FBM Assembly Manual may result in damage to the sliding door and/or ladder rack.

**NOTE:** Crossbars, Side Rails, Base, Clamp Down, or Rotation features are not included in this FBM kit, and must be purchased separately. To purchase applicable features and accessories, please contact your authorized distributor, or a Prime Design Sales & Service Representative.



## L2 CROSSBARS (ERGORACK)

Shown with LH Base, and RH Rotation for illustrative purposes only

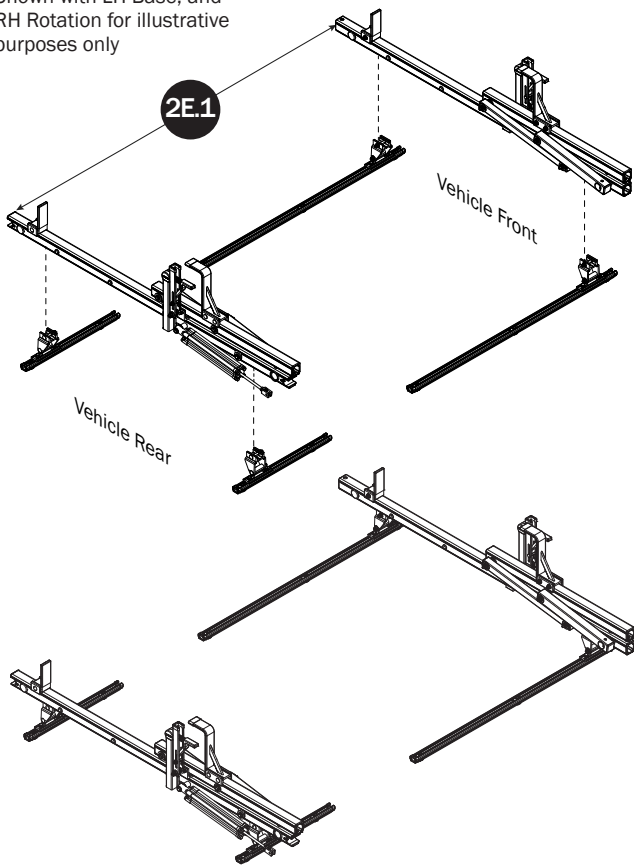

## CROSSBAR ADJUSTMENT

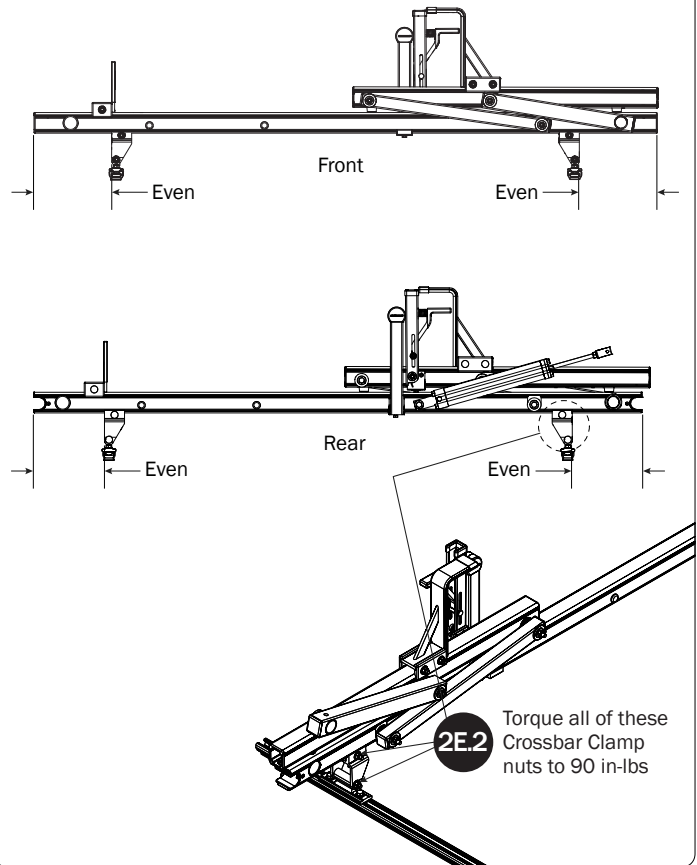

2E.3

Verify the specified distance from the ends of both Mounting Bracket to the ends of both Channels.

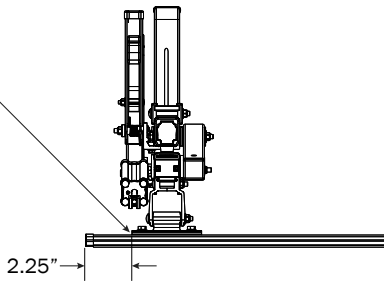

2.25"

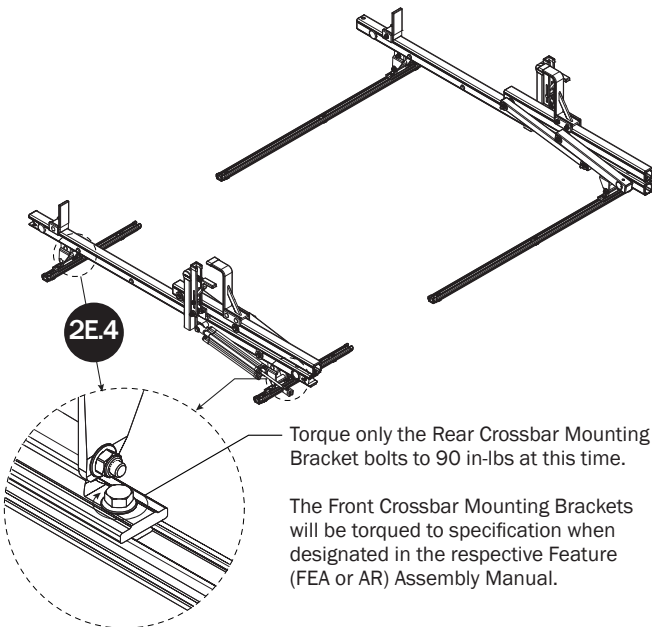

Torque only the Rear Crossbar Mounting Bracket bolts to 90 in-lbs at this time.

The Front Crossbar Mounting Brackets will be torqued to specification when designated in the respective Feature (FEA or AR) Assembly Manual.

### L2 CROSSBARS (ALURACK)

Shown with L2 AluRack for illustrative purposes only

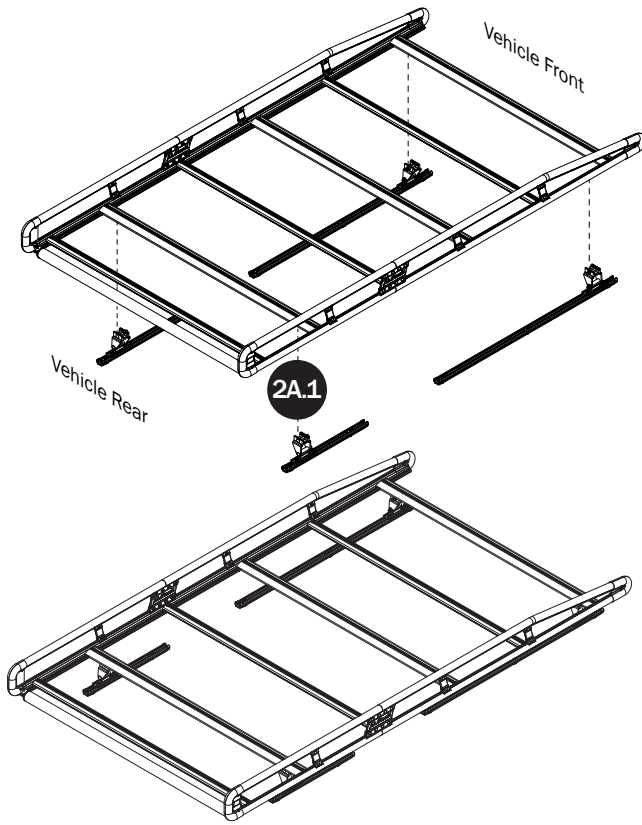

### CROSSBAR ADJUSTMENT

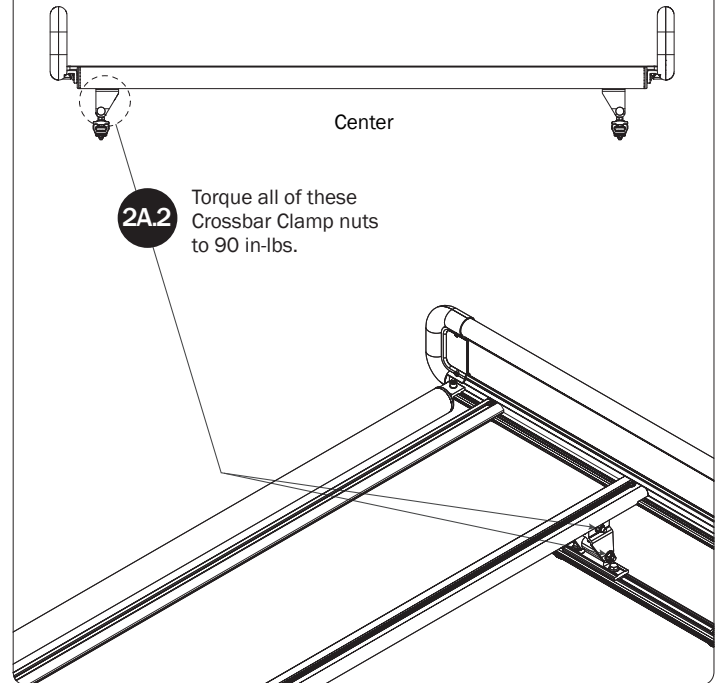

**2A.2** Torque all of these Crossbar Clamp nuts to 90 in-lbs.

**2A.3**

Verify the specified distance from the ends of both Mounting Bracket to the ends of both Channels.

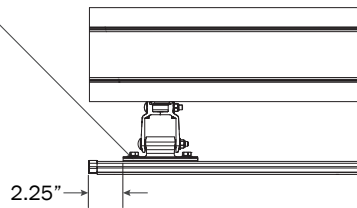

2.25"

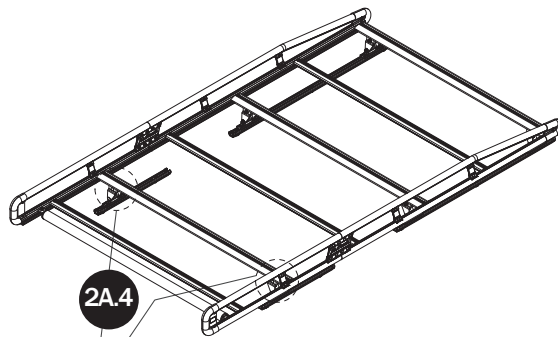

**2A.4**

Torque all Crossbar Mounting Bracket bolts to 90 in-lbs at this time.

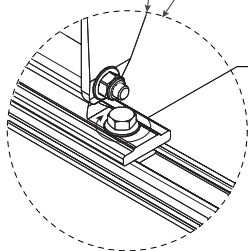

Page Intentionally Left Blank

