

PRIME DESIGN™

A Safe Fleet Brand

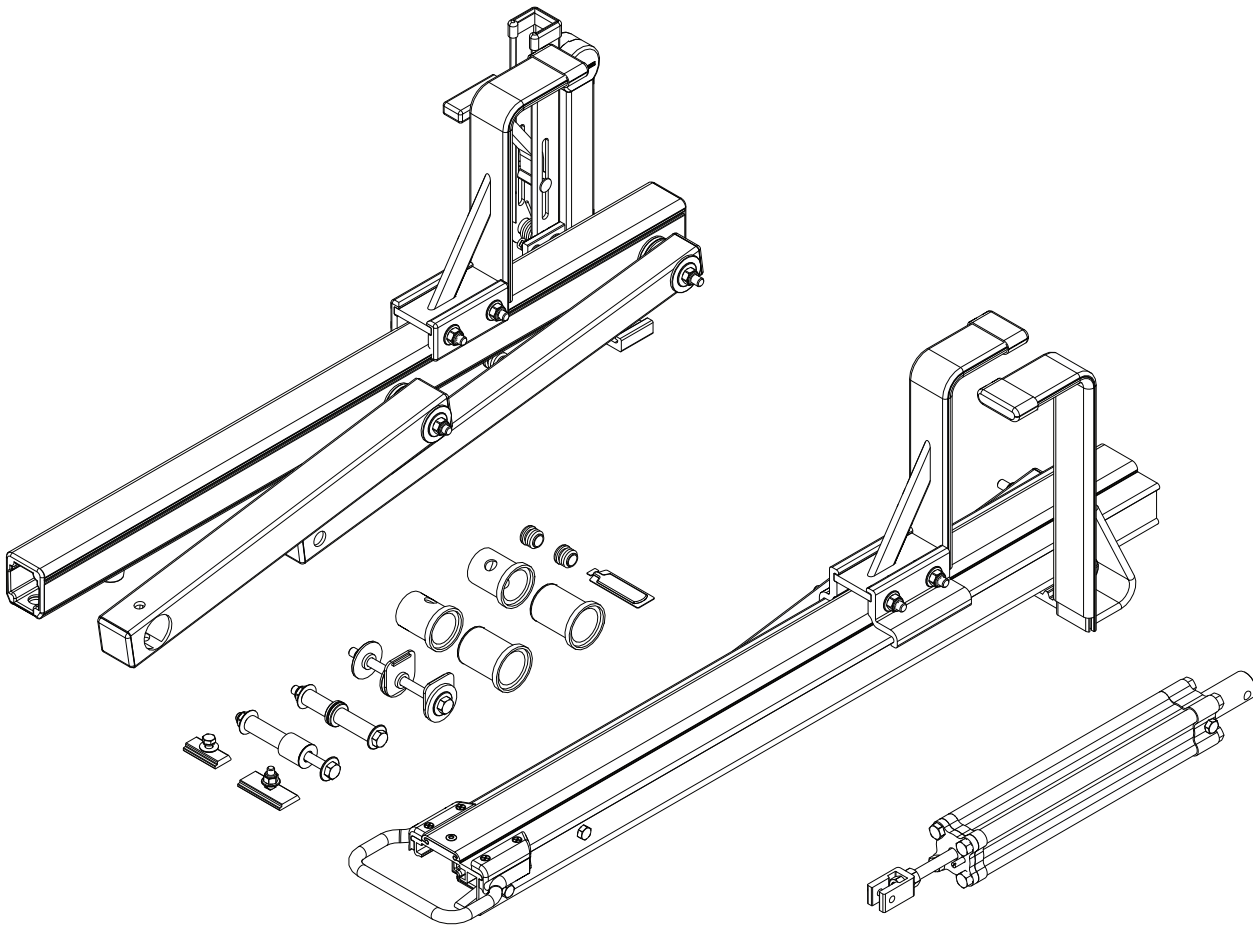

LEFT SIDE SLIDE ROTATION KIT

PRIME DESIGN, A SAFE FLEET BRAND

Address: 580 Opperman Drive, Eagan, MN 55123 • Toll Free: 1.8.PRIME.RACK

Fax: 651-552-1799 • Email: info@primedesign.net • Website: www.primedesign.net

FEA 0004

CONTENTS OVERVIEW

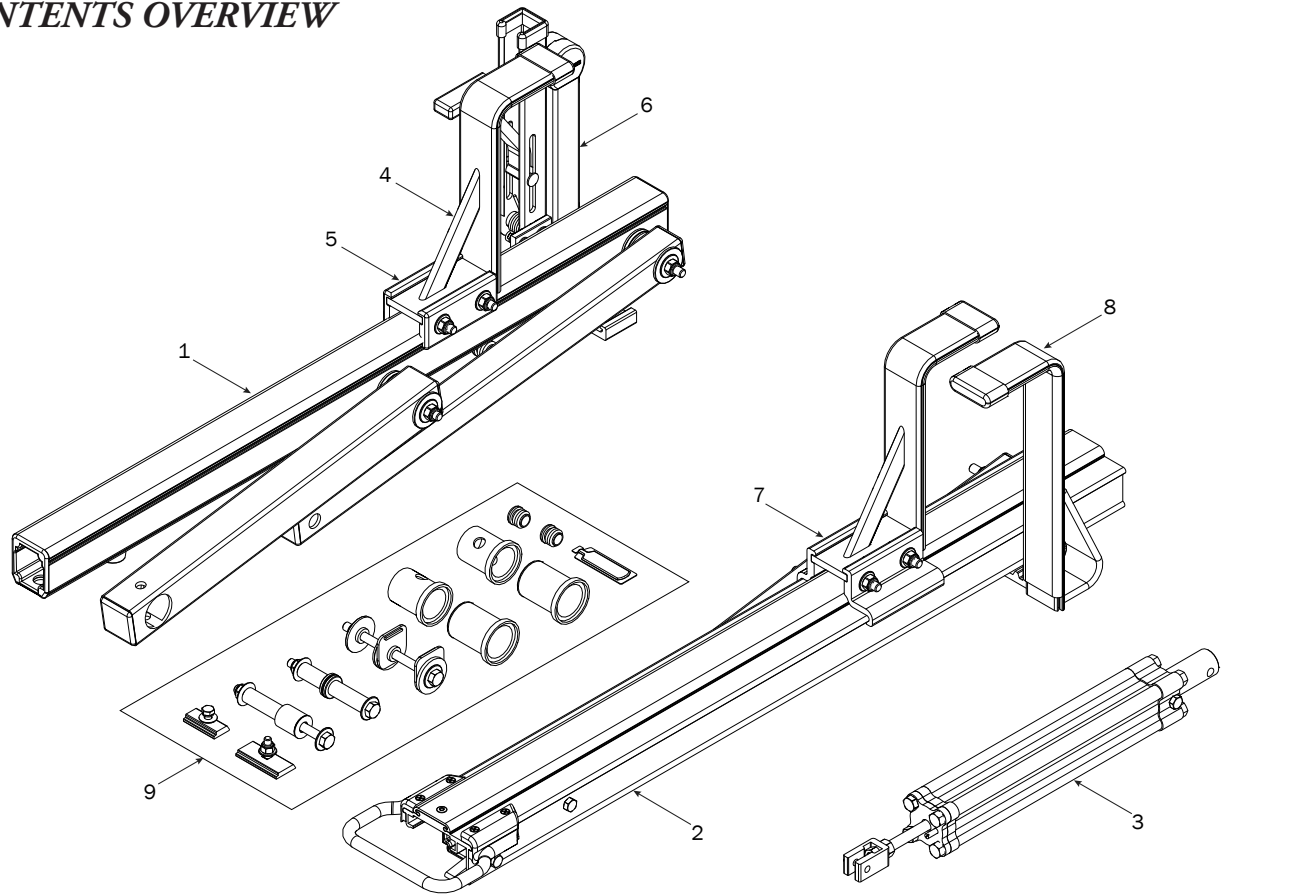

1—Left Front Rotation Assembly (Qty 1)

2—Left Rear Slide Rotation Assembly..... (Qty 1)

3—Cylinder..... (Qty 1)

4—Z Post (Qty 2)
Adjustable, 7.25"

5—Z Post Mounting Clamp Assembly..... (Qty 1)

6—L Post..... (Qty 1)
With Roller Cap, 9.25"

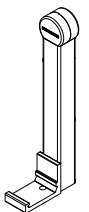
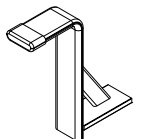
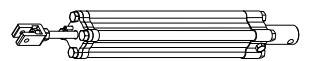
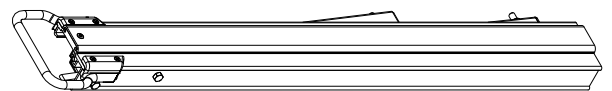
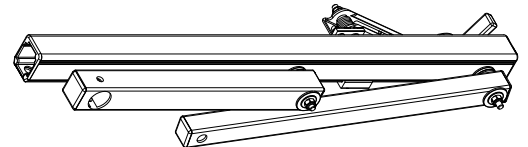

7—Z Post Bracket Assembly (Qty 1)
Adjustable, Slide

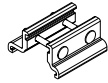

8—Z Post..... (Qty 1)
Adjustable Slide, 7.25"

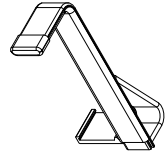

9—HKT-8400..... (Qty 1)
Modular Rotation Hardware Kit, Slide

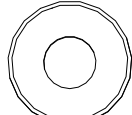
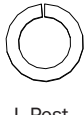
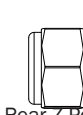
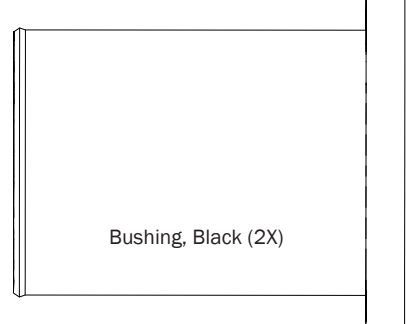
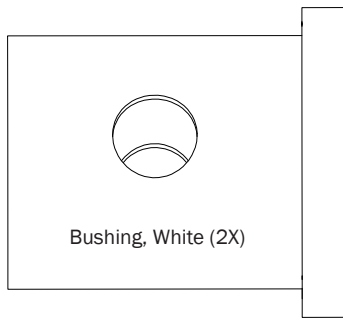
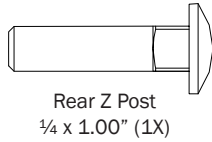
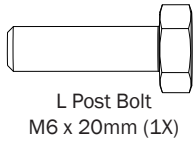
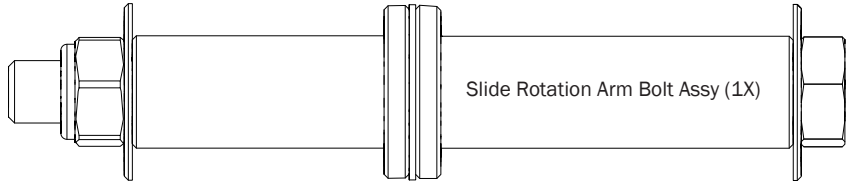
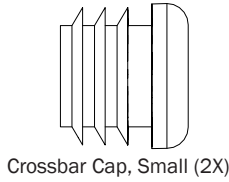

Rear Z Post 1/4 Lock Nut (1X) L Post Lock Washer (1X) L Post Flat Washer (2X)

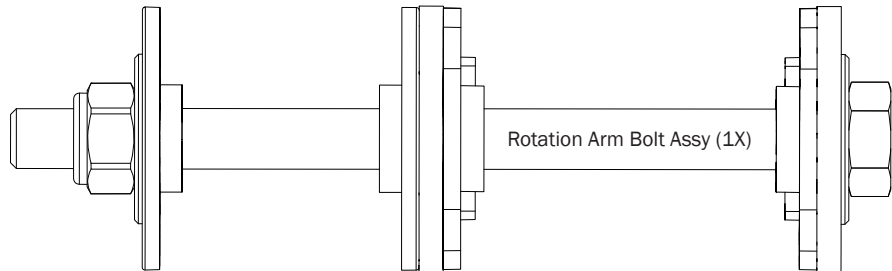
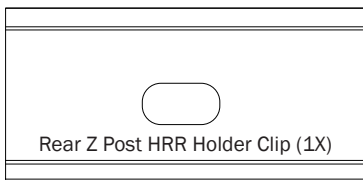
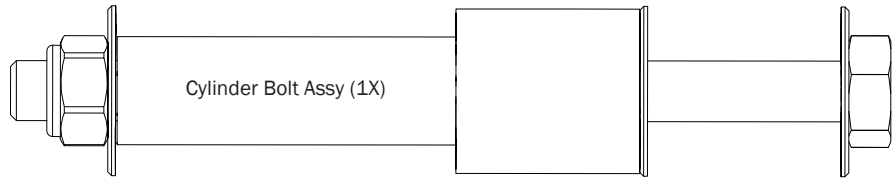
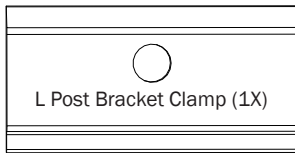

10—Crossbars (not shown on pg 2) (Qty 1)
Ordered separately, Front & Rear, Gen 4

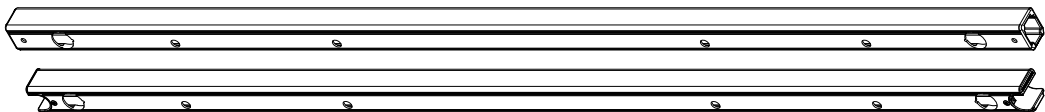

11—Crossbar (not shown on pg 2) (Qty 1)
Gen 4 (Hardware Kit not shown)

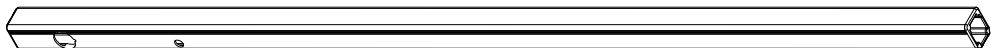
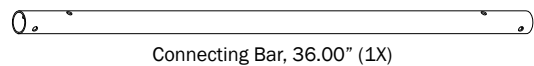

*NOTE: This module is an optional purchase according to your vehicle configuration.

ROTATION ASSEMBLY SEQUENCE

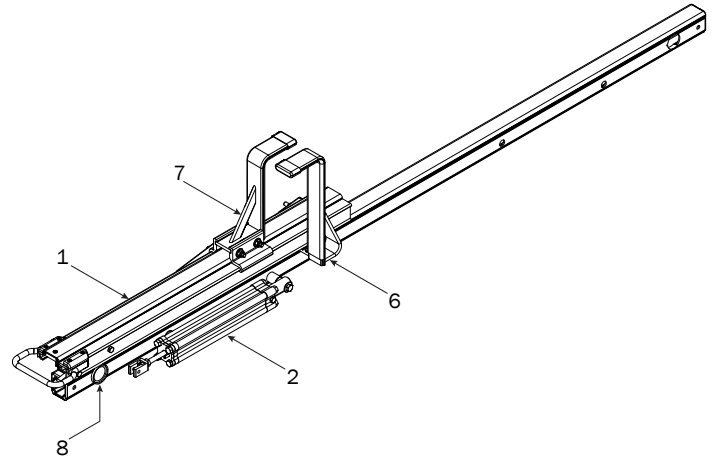
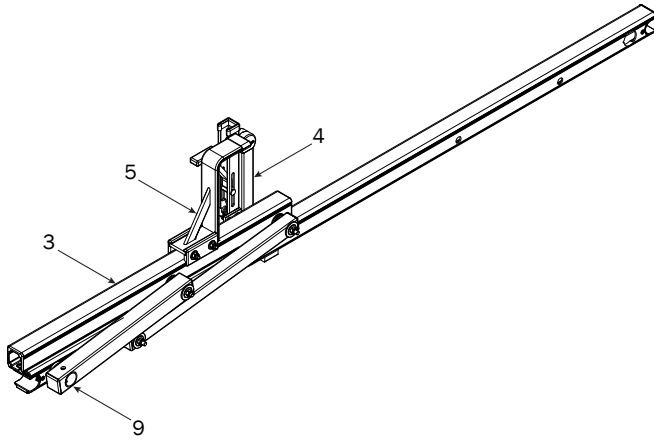

Note: For ease of installation, it's recommended to assemble any Rotations onto the Crossbars before placing them onto the FBM's mounting brackets. The use of a helper is recommended when placing built Crossbars onto the vehicle.

Note: This Rotation Kit fits only on the left side. Refer to FEA-0003 for right side Slide Rotation assembly instructions.

REAR CROSSBAR ROTATION ASSEMBLY

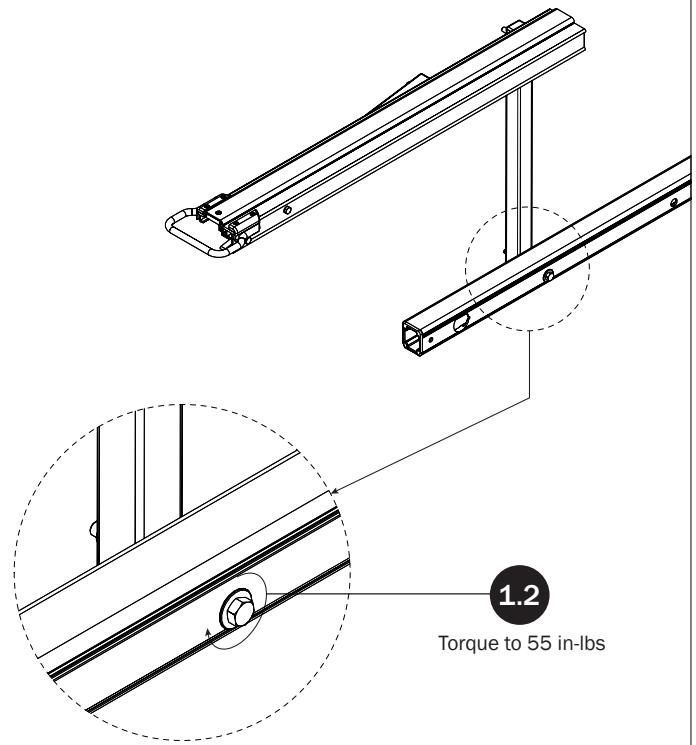
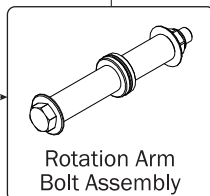
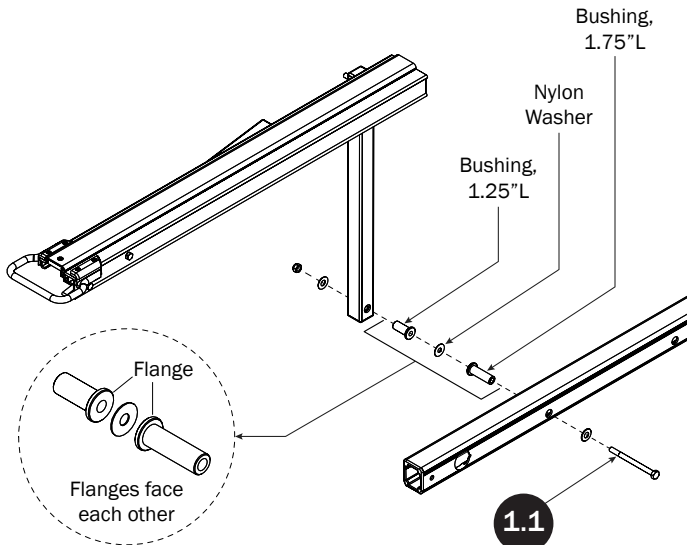

CYLINDER HARDWARE

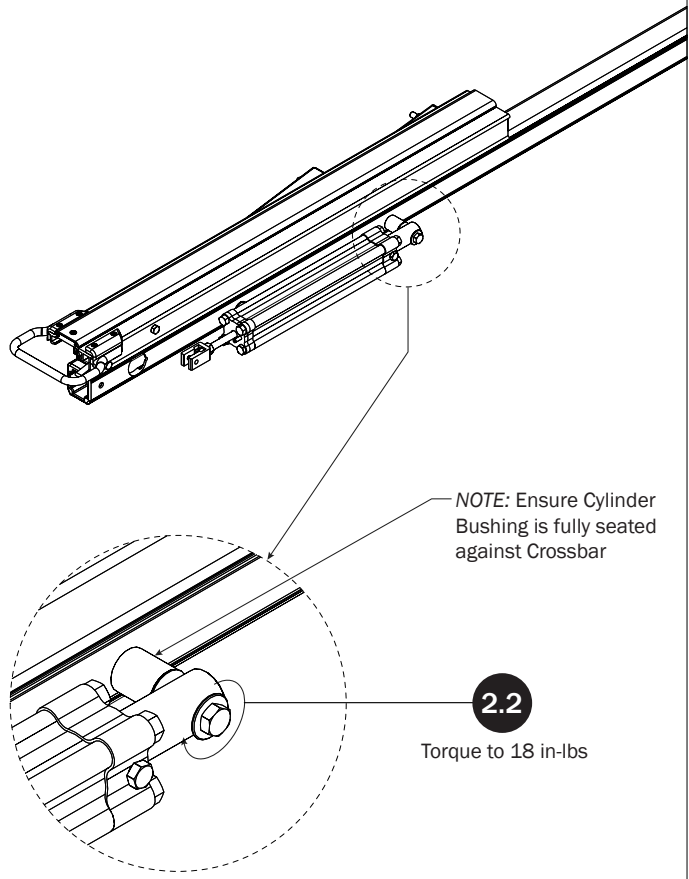
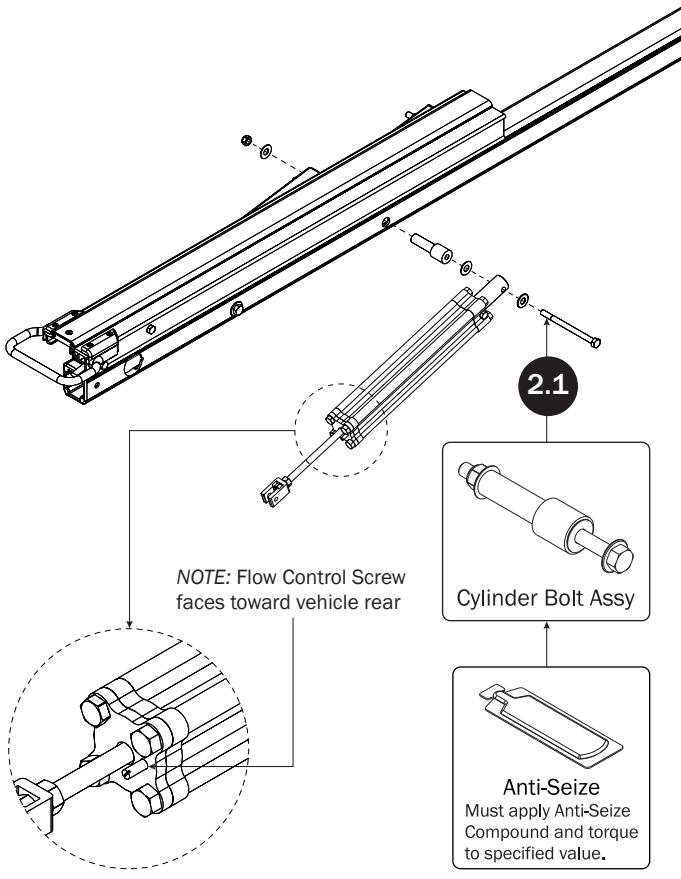

FRONT CROSSBAR ROTATION ASSEMBLY

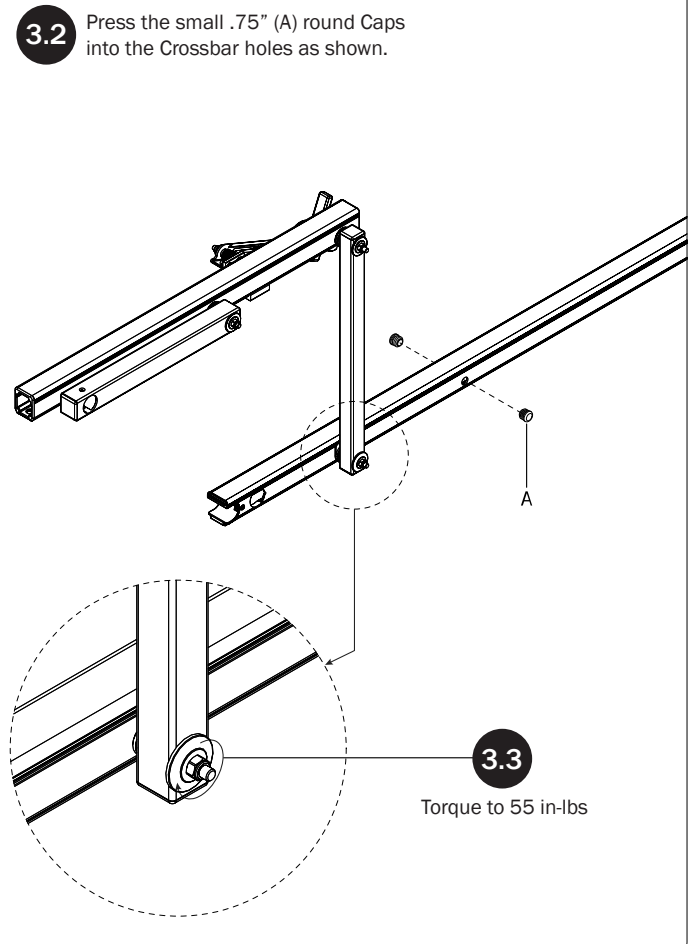
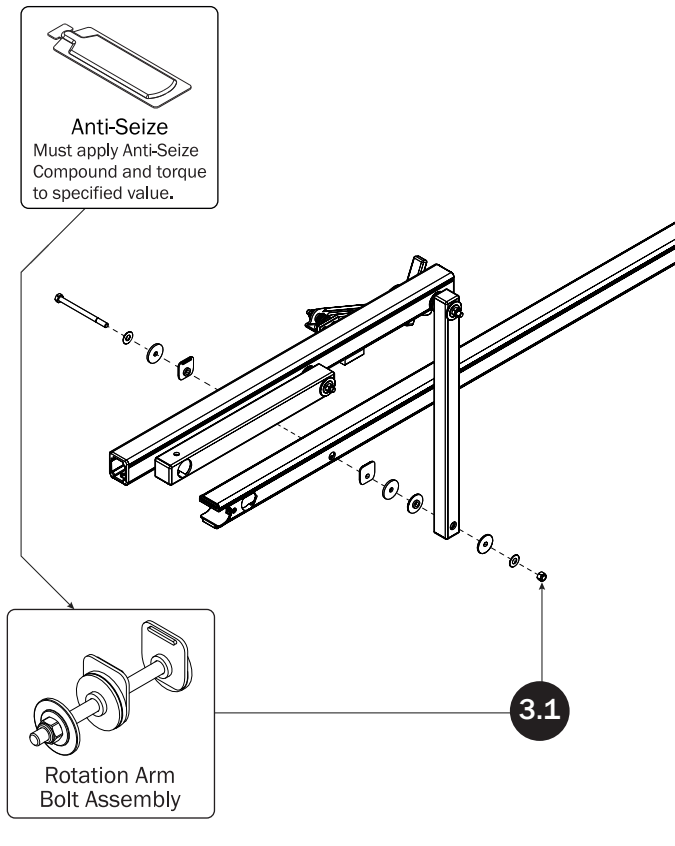

L POSTS**SEE QUICK START GUIDE FOR ADJUSTMENTS**

NOTE: The front Auto Clamp come preset from the factory for packaging purposes only. To assemble the L Post to the Crossbar, the Auto Clamps must be repositioned.

Ensure the Auto Clamp Spring is seated into the spring catch

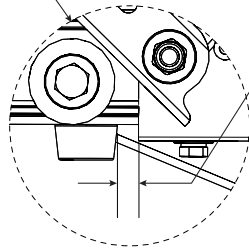
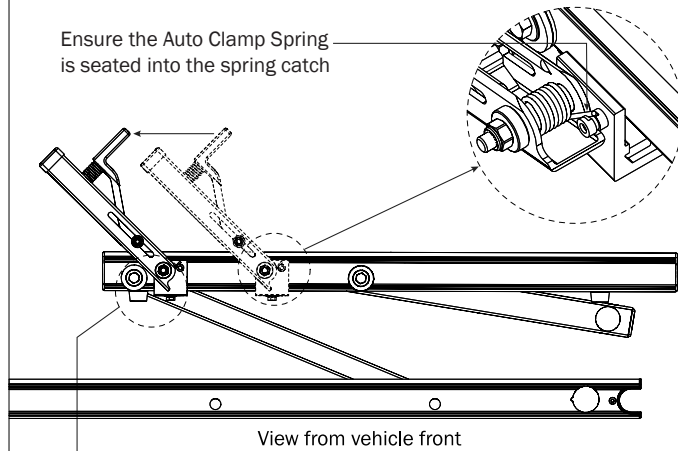

4.1 Beginning with the Front Crossbar, loosen the bolt at the bottom of the Auto Clamp, then slide the Auto Clamp toward the inside end of the Rotation Upper. Reposition the Auto Clamp leaving a minimum of 1/4" distance from the rubber bumper to the edge of the Auto Clamp Bracket as shown, then finger-tighten if adjusting later, or torque to 80 in-lbs.

4.4

Slide L Post Bracket Clamp into bottom groove, then slide into L Post Connector as shown

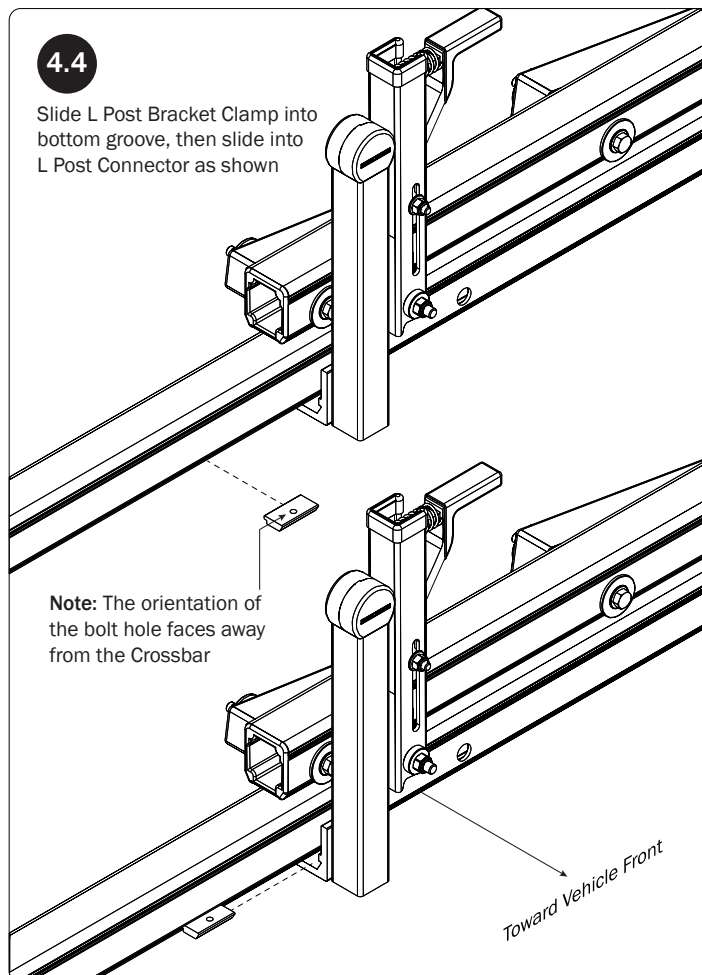
**4.2**

Place an L Post into the bottom groove of the Front Crossbar

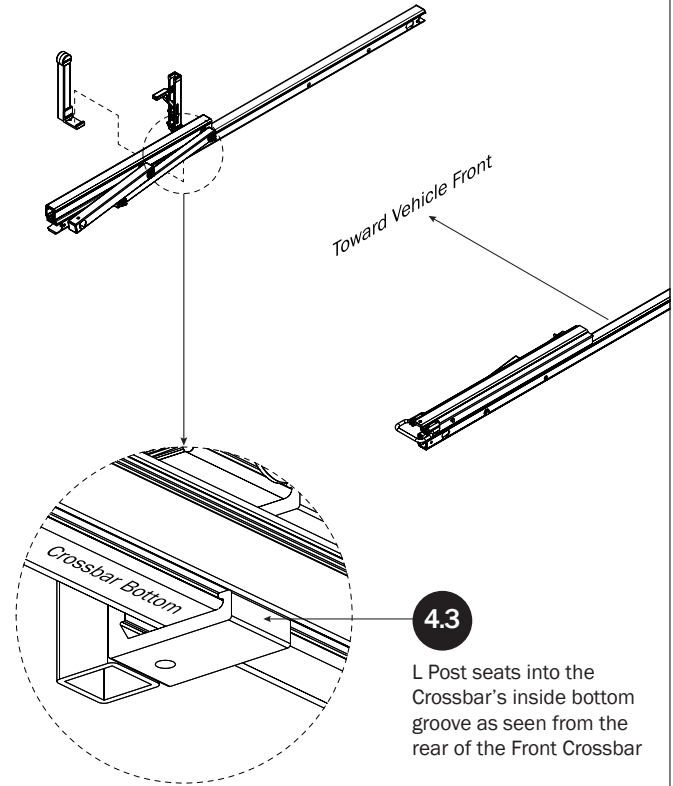
**4.3**

L Post seats into the Crossbar's inside bottom groove as seen from the rear of the Front Crossbar

4.5

Bracket Clamp sits in L Post Connector as shown

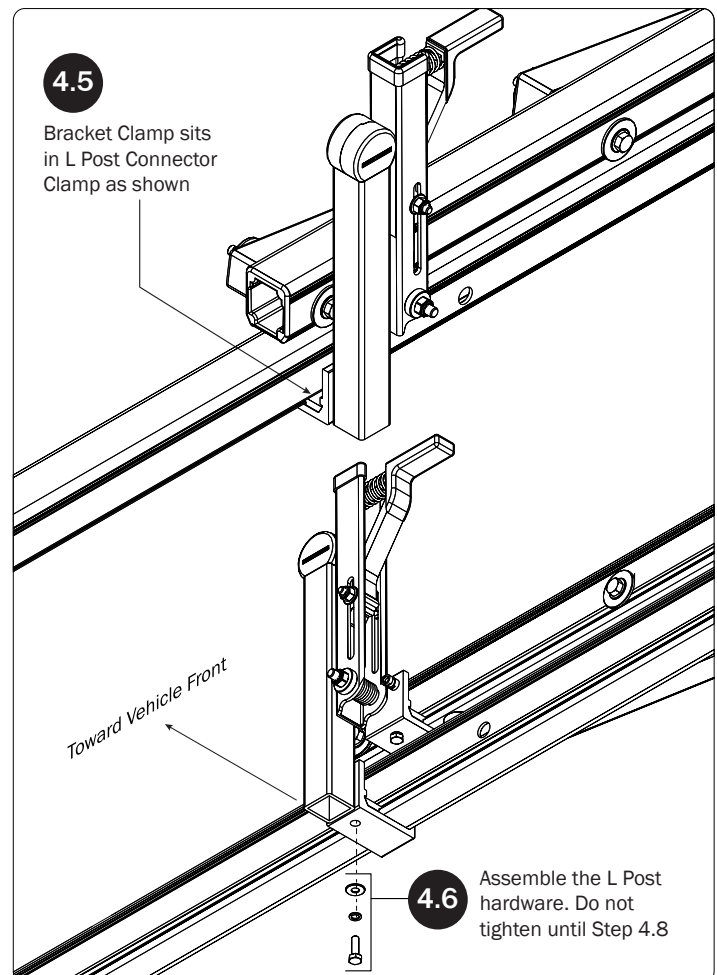
**4.6**

Assemble the L Post hardware. Do not tighten until Step 4.8

Z POSTS

SEE QUICK START GUIDE FOR ADJUSTMENTS

4.7

Slide the L Post until parallel to the Auto Clamp and the gap between the two is even from top to bottom

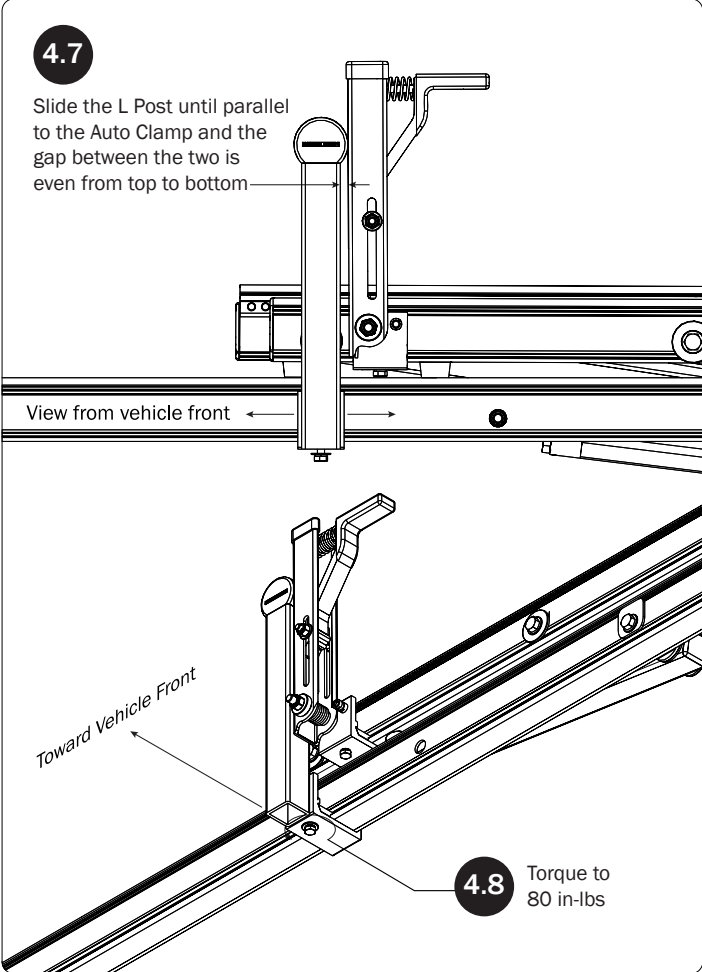

4.8 Torque to 80 in-lbs

5.1

Assemble the Z Post Mounting Clamp Assembly onto the Rotation Upper. Do not tighten until Step 5.4.

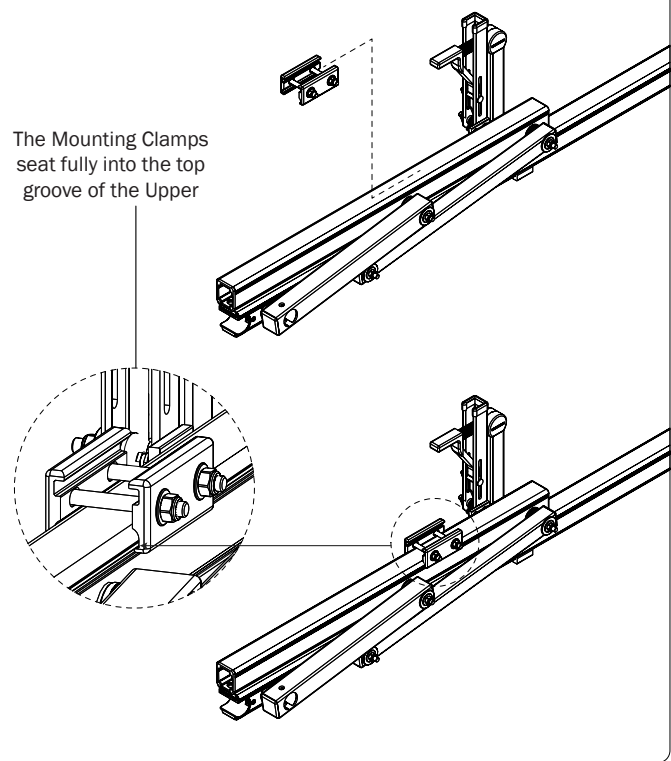

The Mounting Clamps seat fully into the top groove of the Upper

Slide the Z Post into the Mounting Clamp Assembly

5.2

The Z Post fully seats into the top slot of the Mounting Clamps

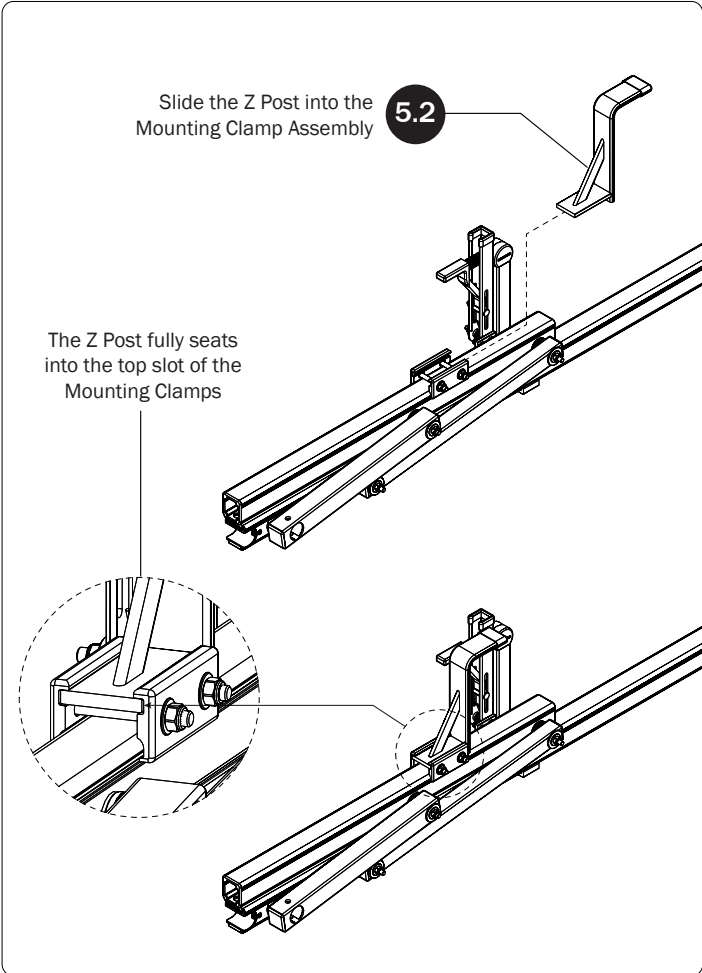

5.3

Refer to the Quick Start Guide for Z Post positioning.

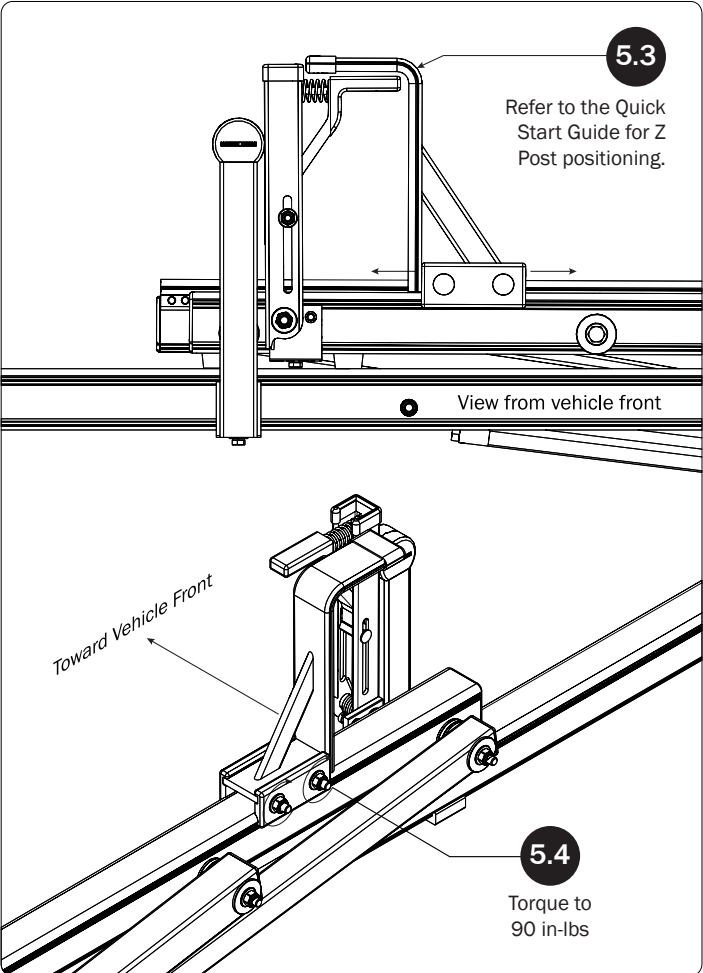

5.4

Torque to 90 in-lbs

SLIDE UPPER Z POST
SEE QUICK START GUIDE FOR ADJUSTMENTS

6.1 Prepare the parts shown below for assembling the Slide Z Post onto the bottom of the Rear Slide Rotation, but do not assemble. Assembly begins at Step 6.6

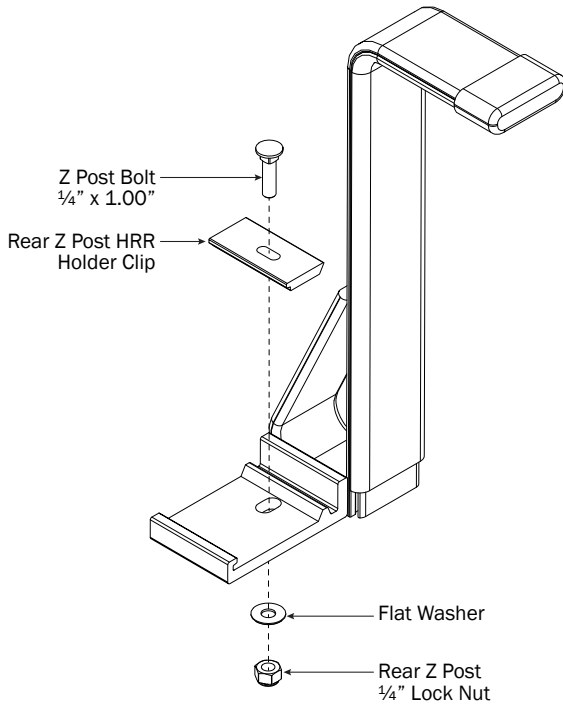

6.2 Place Slide Z Post into bottom of Rear Slide Upper

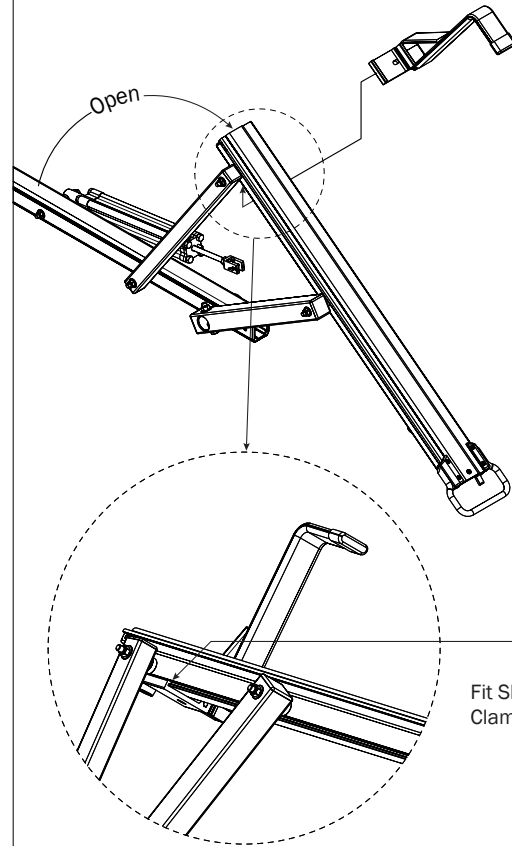

6.3
Fit Slide Z Post Bracket
Clamp into Slide groove

Press Slide Release Lever upward **6.4**

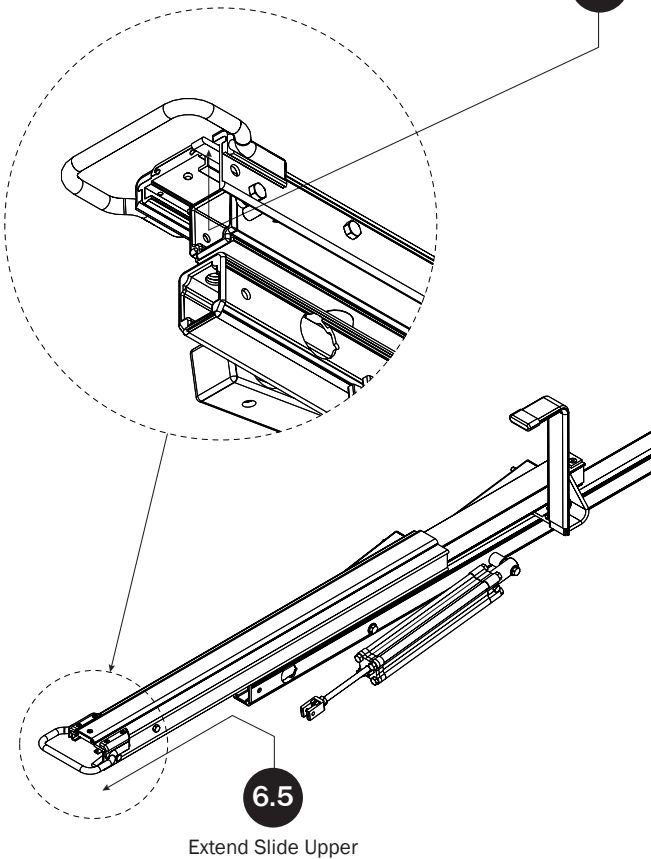

6.6 Place Slide Z Post Bracket Clamp into bottom groove, then slide into Z Post Connector as shown

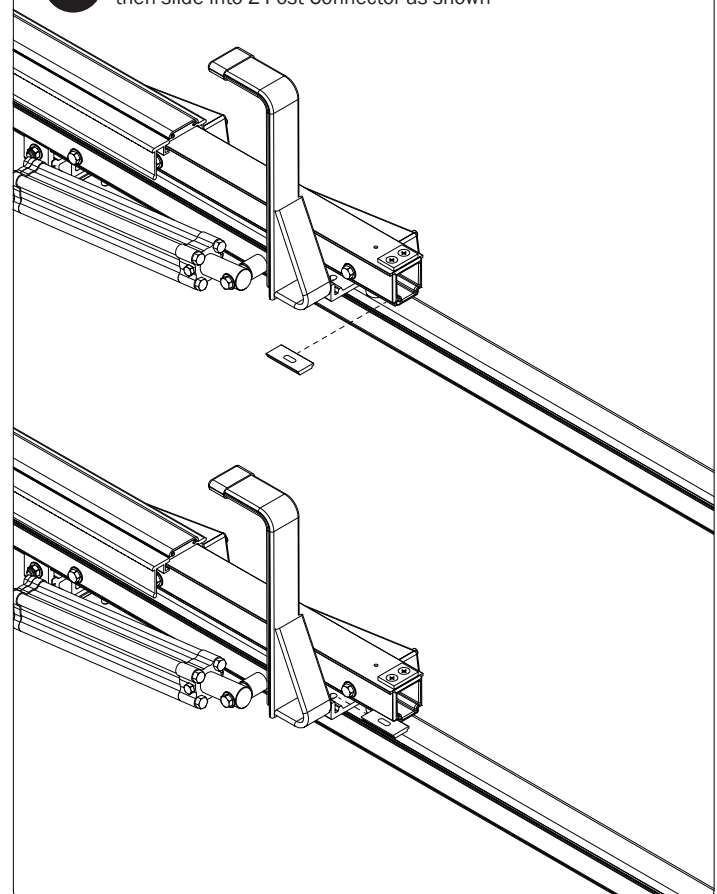

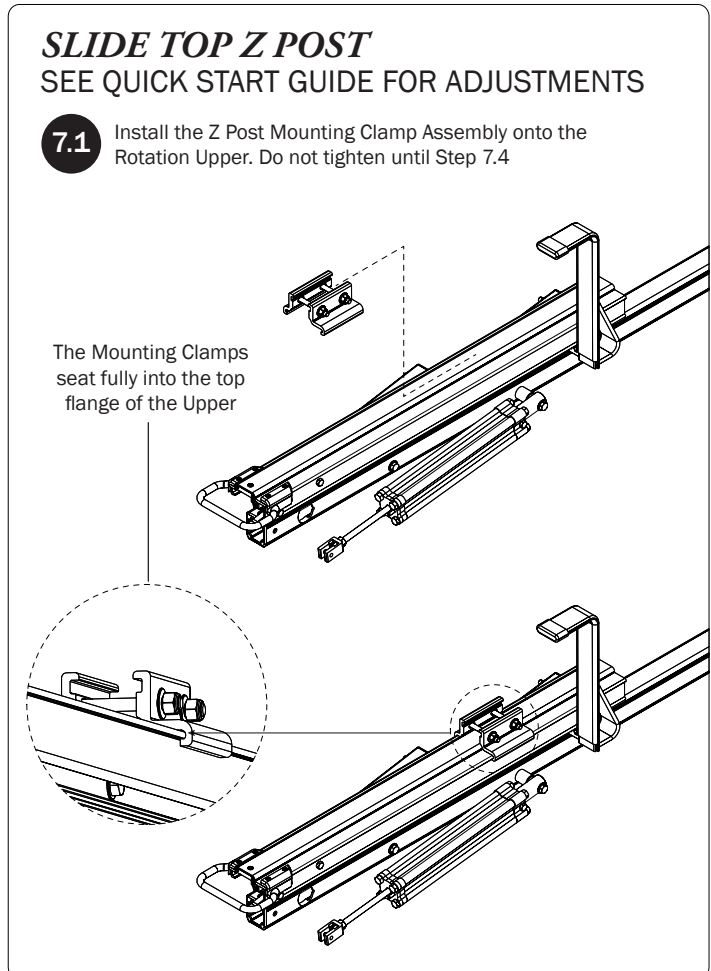
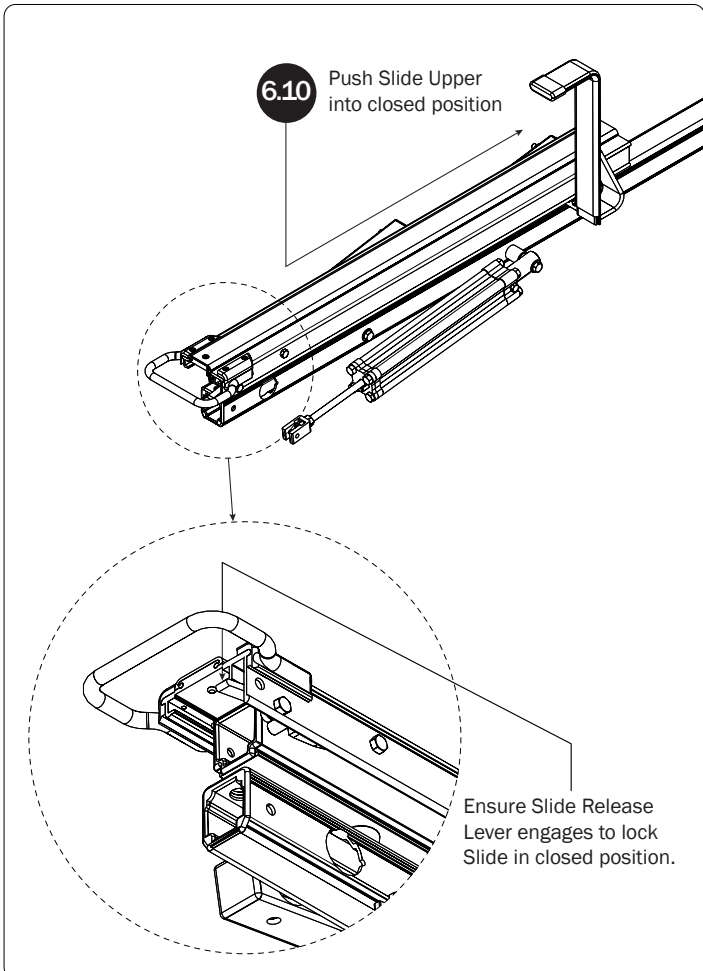
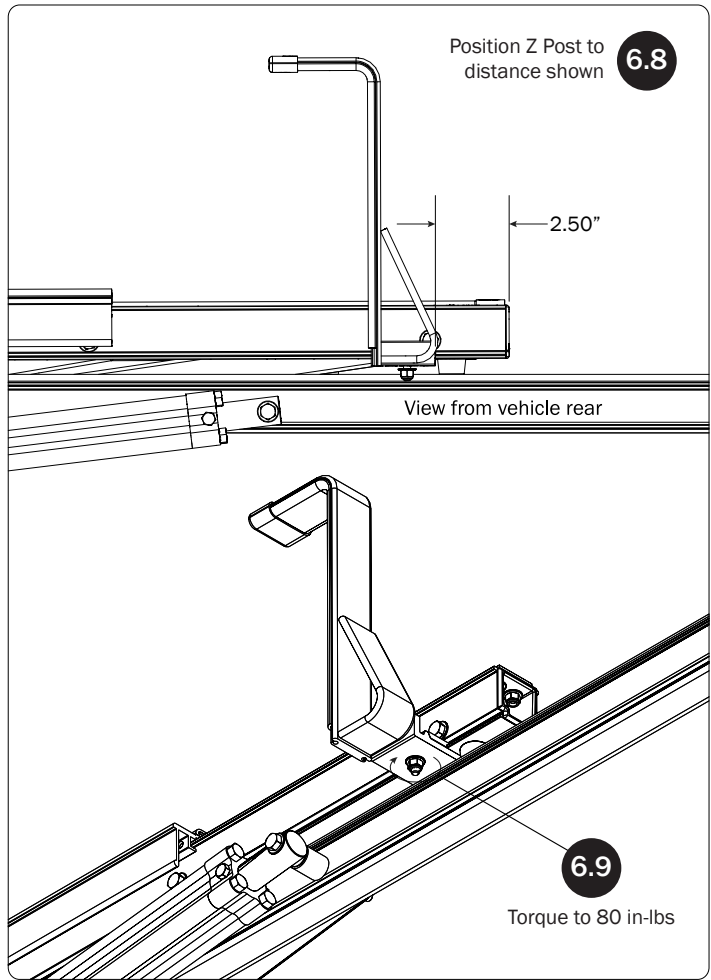
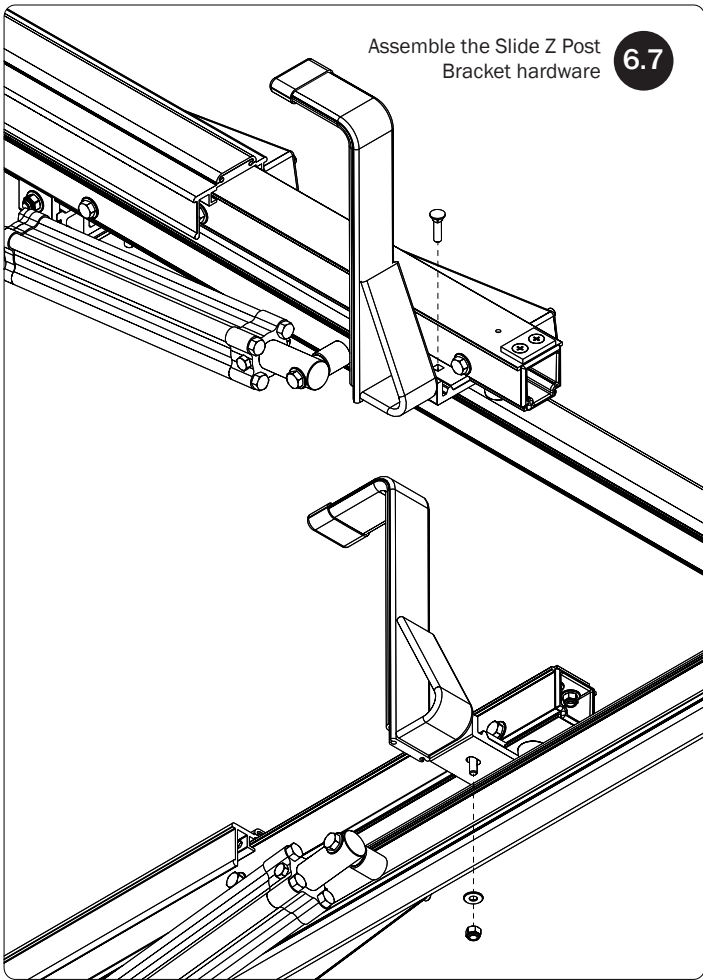

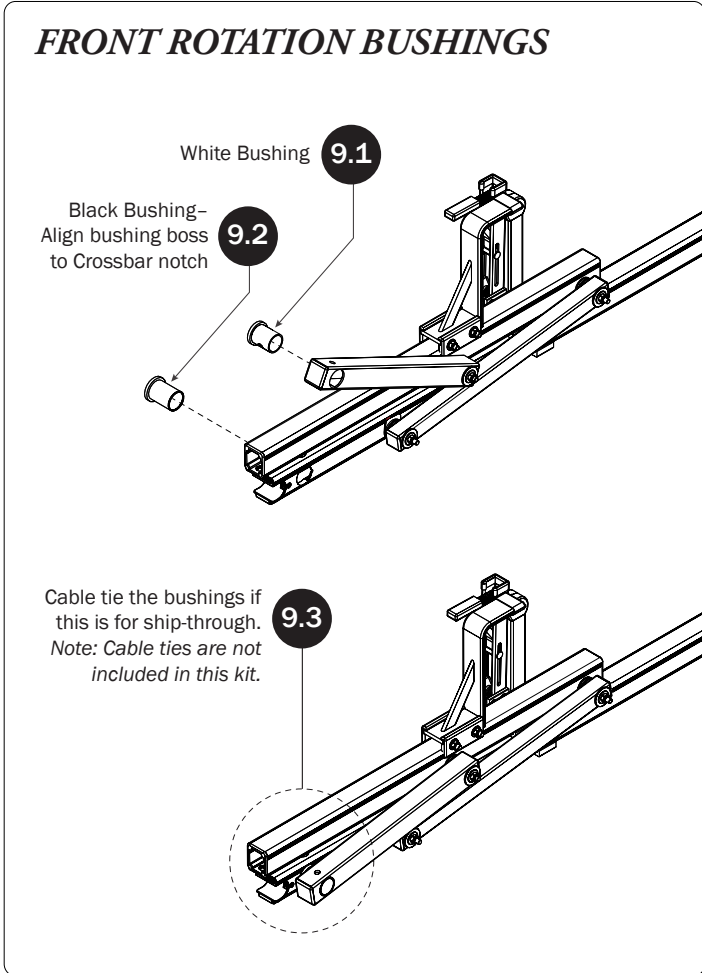
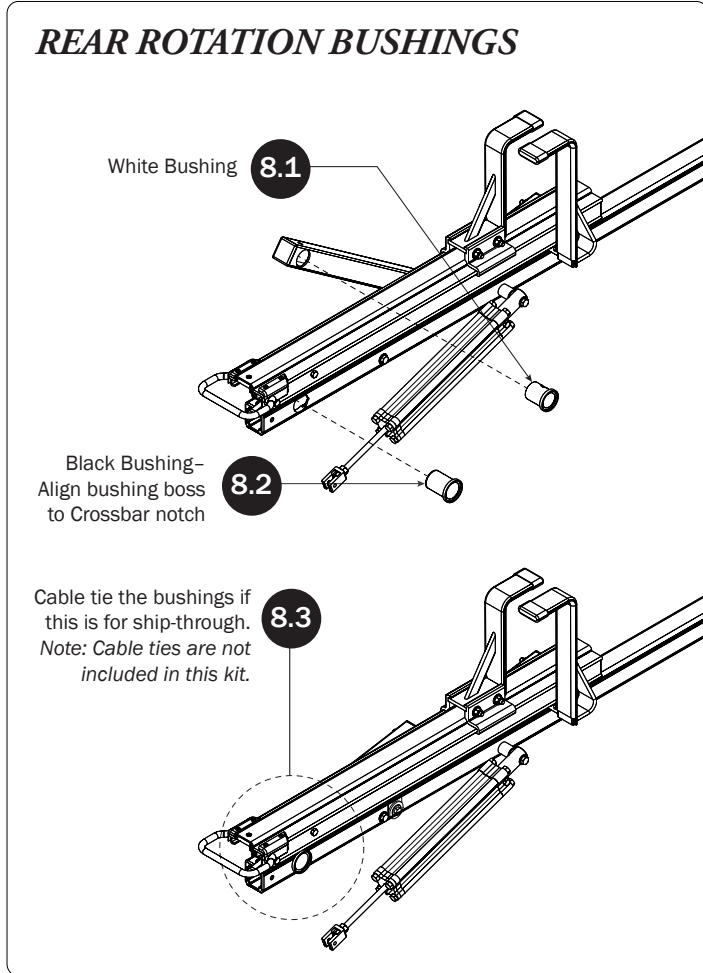
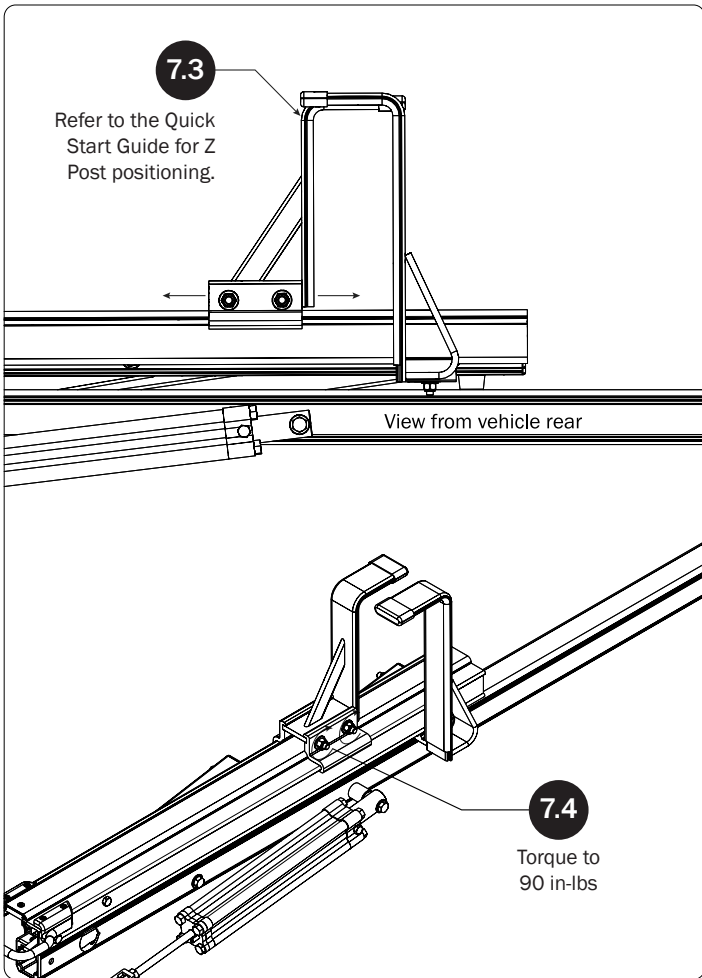
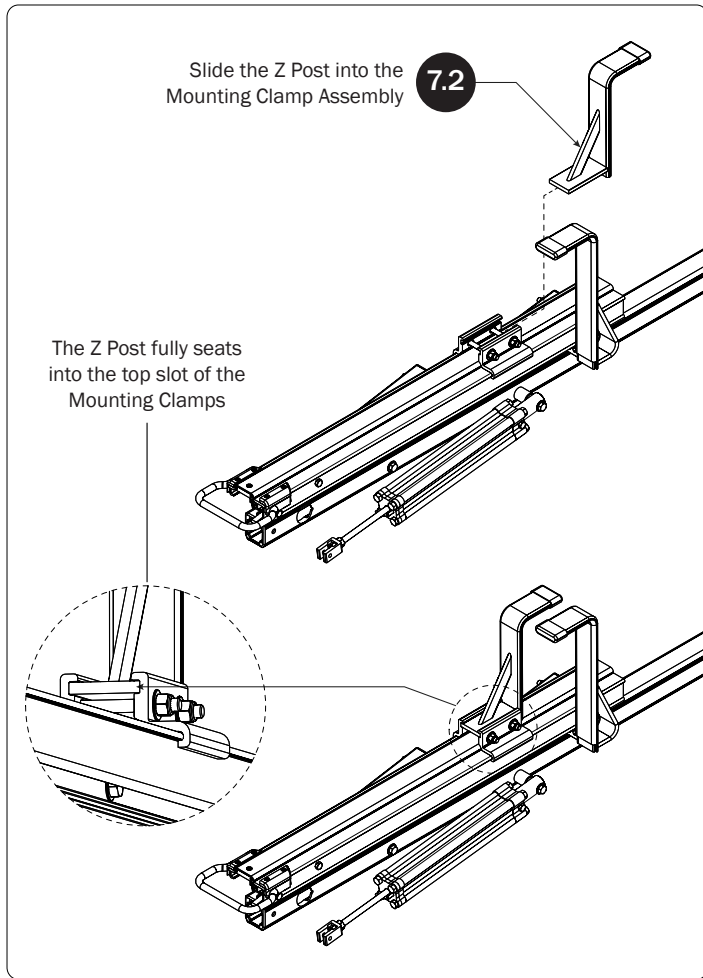

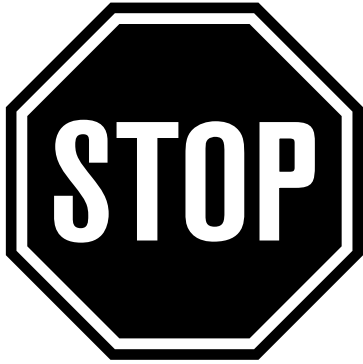

NOTE: This completes the installation of FEA-0004. For right side Slide Rotation installation, refer to the FEA-0003 Assembly Manual.

If applicable, refer to your next FEA Assembly Manual.

If completed, refer back to your FBM Assembly Manual, and resume assembling at Step 3.1.

WARNING: Failure to position the Crossbars as shown in your FBM Assembly Manual may result in damage to the sliding door and/or ladder rack.

