

HRR-E-PM-M

ErgoRack, Promaster Low/High Roof

Two Crossbars, Powder Coat Finish
Rack Weight (empty): 134 lbs

*Callouts in this Configuration Overview indicate full module assemblies only.

For details on individual parts, please refer to the linked Module Overviews below.

- A: [FEA-0020 Rotation Driveshaft Assembly](#)
- B: [FBM-1007-BLK Mounting System](#)
- C: [FEA-0004 Slide Rotation Assembly](#)
- D: [CBR-0007 Crossbar Assembly](#)
- E: [FEA-0003 Slide Rotation Assembly](#)
- F: [FEA-0019 Rotation Driveshaft Assembly](#)

[Modular Assembly Manuals](#)

ErgoRack Van—Load specifications:

Check vehicle manufacturer recommendations for roof capacity weight limits.

CROSSBAR SPACING	STEP LADDER	EXT. LADDER
4 ft Spacing	6 – 8 ft.	16 – 20 ft.
5 ft Spacing	8 – 10 ft.	16 – 24 ft.
6 ft Spacing	8 – 12 ft. [†]	16 – 28 ft.
7 ft Spacing	10 – 12 ft. [†]	20 – 32 ft.
8 ft Spacing	10 – 12 ft. [†]	20 – 36 ft.

[†]Rotation Configurations: 12 ft. step ladders require an extended upper add-on component.

*Example shown with 118" Wheelbase Configuration

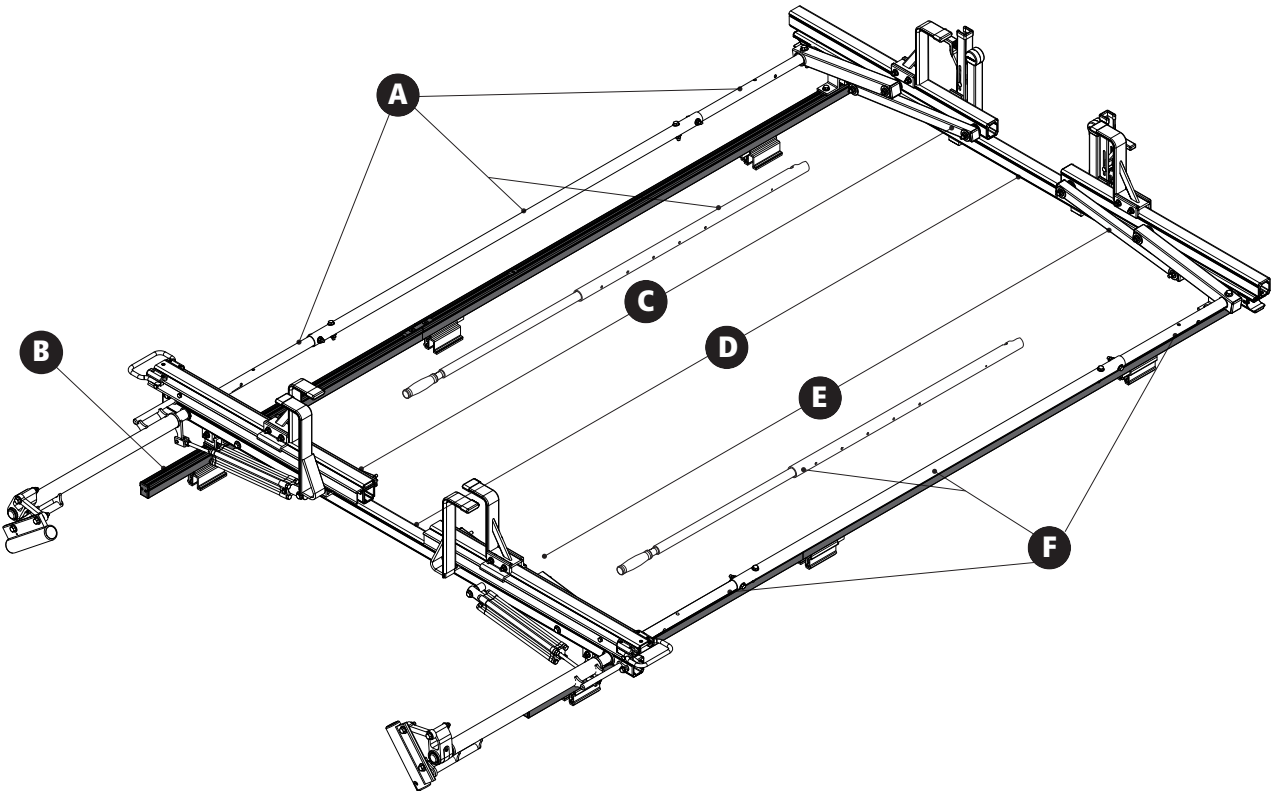

HRR-E-PM-M

ErgoRack, Promaster Low/High Roof

Approximate dimensions as shown:

All Wheelbases

A: Rack Width	79"
B: Rack Height	18.50"
C: Rear Crossbar Offset (L & R)	Even
D: Mount Bolt Spacing L/R	Set at install

118" Wheelbase, Low Roof

E: Total Crossbar Spacing	6'–8'
F: Rack Length	113"

136" Wheelbase, Low/High Roof

G: Total Crossbar Spacing	6'–8'
H: Rack Length	130"

Compatible Accessories Available

(Sold Separately)

Rear Access Ladder	AAL Series
8'–12' Conduit Carriers	CON Series
WorkPro LED Lighting	LED Series
Systems and Safety Components	RVS Series
Safety monitoring	DS2 Series

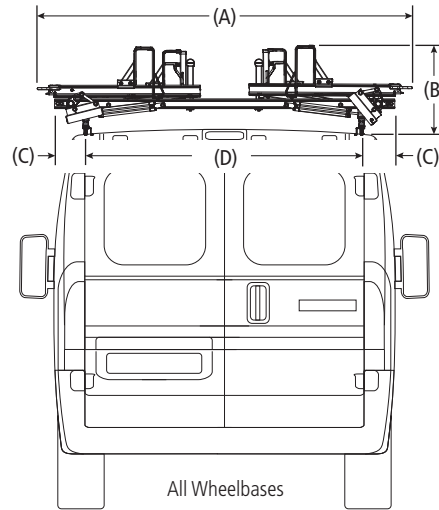

Low/High Roof Configurations

Rear Drive Shaft Offset: 29"

Note: The end of the driveshaft must not extend beyond the vehicle bumper

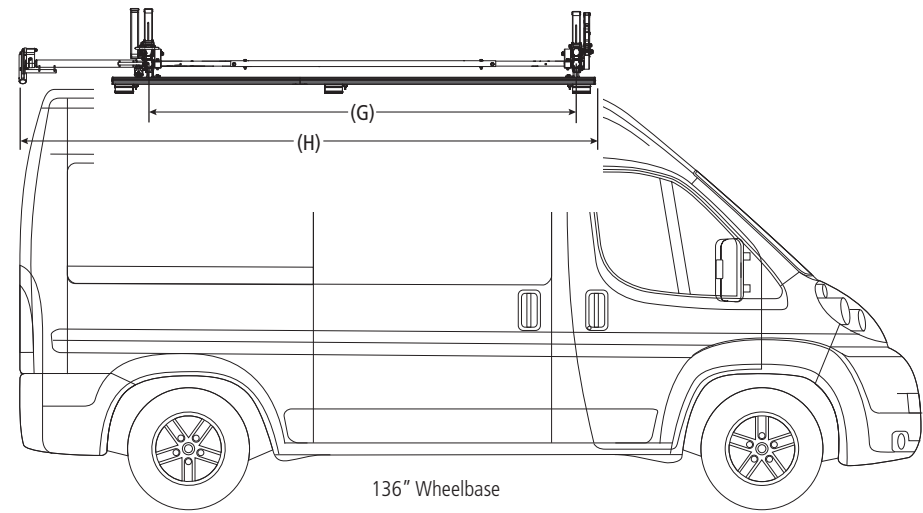
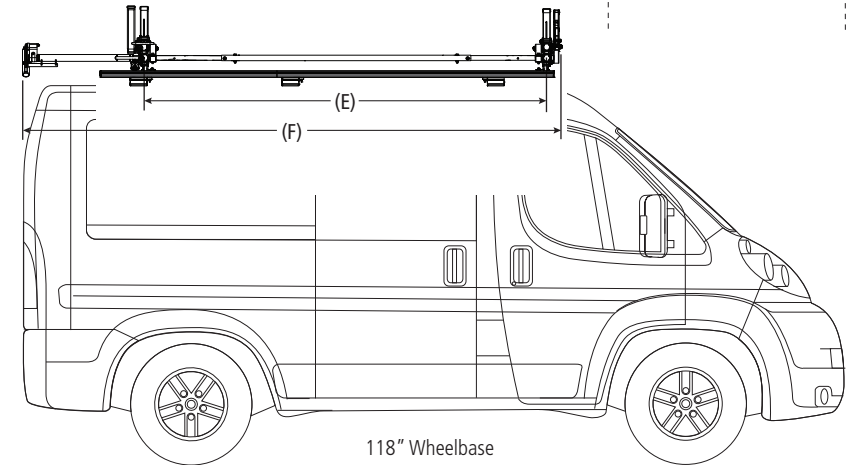
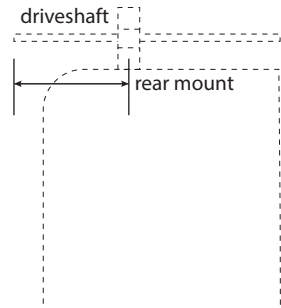

HRR-E-PM-M

ErgoRack, Promaster High Roof

Approximate dimensions as shown:

All Wheelbases

A: Rack Width	79"
B: Rack Height	18.50"
C: Rear Crossbar Offset (L & R)	Even
D: Mount Bolt Spacing L/R	Set at install

159" Wheelbase, High Roof

E: Total Crossbar Spacing	8'
F: Rack Length	154"

159" Extended Wheelbase, High Roof

G: Total Crossbar Spacing	8'
H: Rack Length	169"

Compatible Accessories Available

(Sold Separately)

Retractable Ratchet Tie-Down	ACC-8000
Rear Access Ladder	AAL Series
8'–12' Conduit Carriers	CON Series
WorkPro LED Lighting	LED Series
Systems and Safety Components	RVS Series
Safety monitoring	DS2 Series

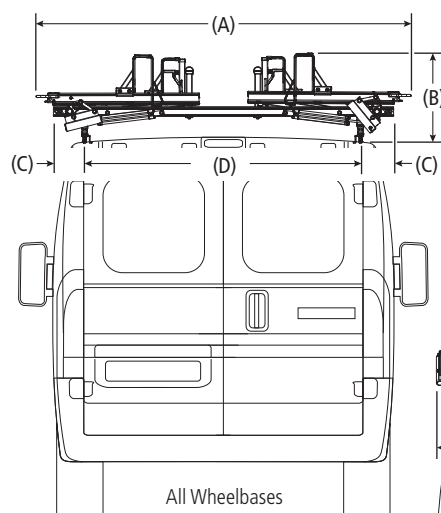

Rear Drive Shaft Offset: 29"

Note: The end of the driveshaft must not extend beyond the vehicle bumper

