

# PRIME DESIGN™

A Safe Fleet Brand

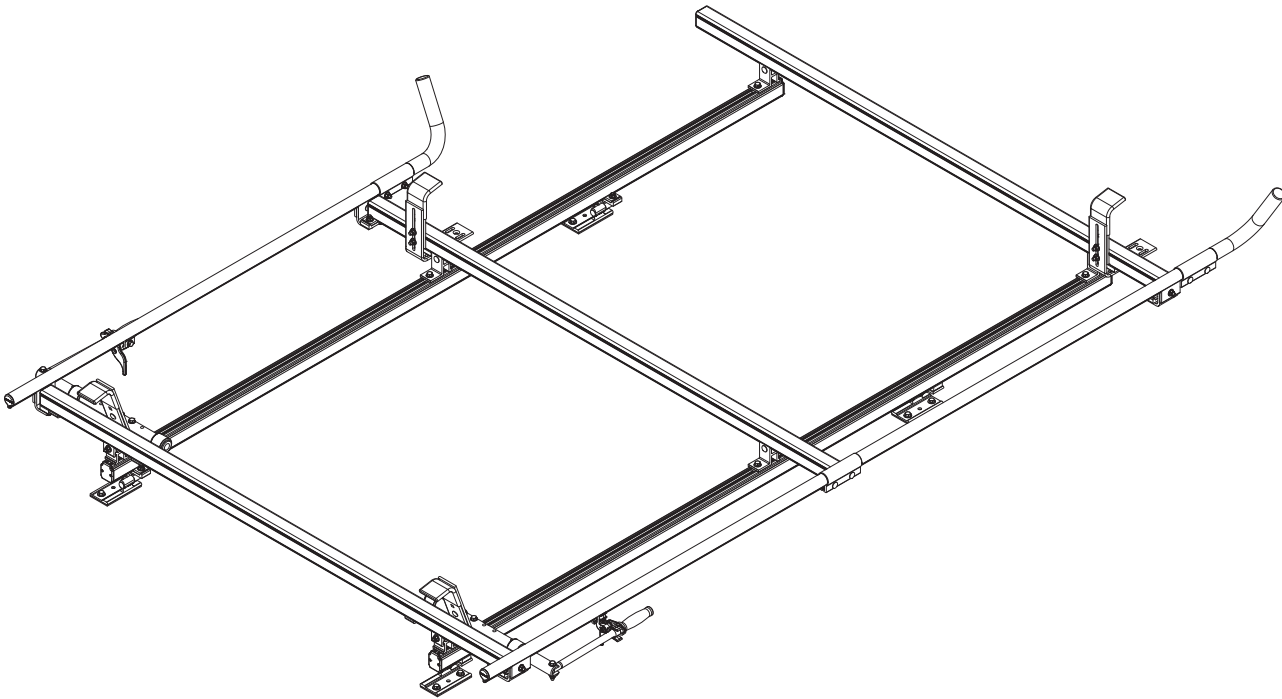

PRIME DESIGN, A SAFE FLEET BRAND

Address: 580 Opperman Drive, Eagan, MN 55123 • Toll Free: 1.8.PRIME.RACK  
Fax: 651-552-1799 • Email: [info@primedesign.net](mailto:info@primedesign.net) • Website: [www.primedesign.net](http://www.primedesign.net)

**PC03**

# CONTENTS OVERVIEW

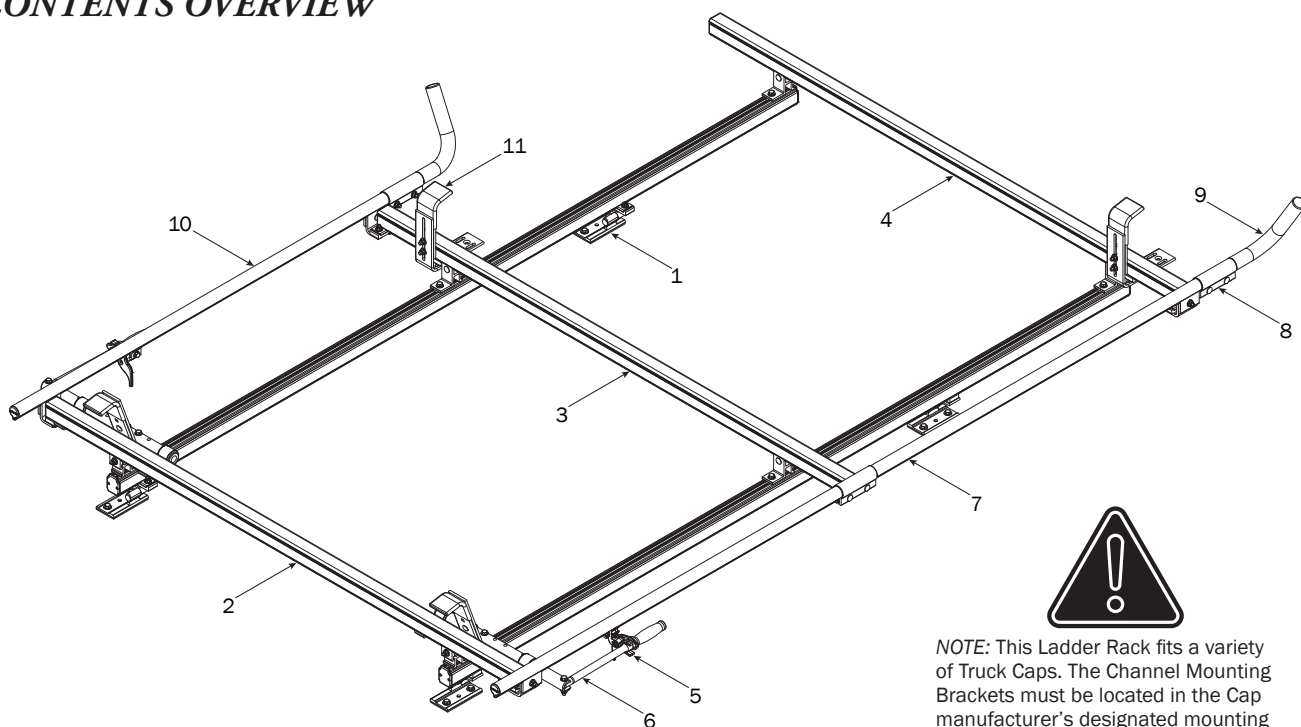

**NOTE:** This Ladder Rack fits a variety of Truck Caps. The Channel Mounting Brackets must be located in the Cap manufacturer's designated mounting locations. Locate the locations prior to drilling the Cap.

- 1—FBM3-0019 ..... (Qty 1)  
Channels with hardware



Channels (2X)



Screws (8X)



End Caps (4X)



Brackets (6X)



Mountings (4X)

- 2—Rear Crossbar Assembly ..... (Qty 1)

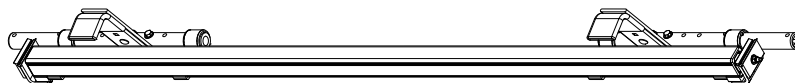

- 3—Center Crossbar Assembly ..... (Qty 1)

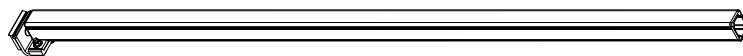

- 4—Front Crossbar Assembly ..... (Qty 1)

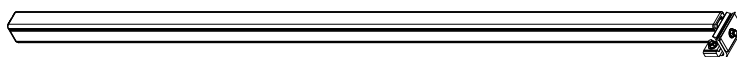

- 5—Clamp Down Handle Latch Assembly ..... (Qty 2)



- 6—Clamp Down Handle Assembly ..... (Qty 2)

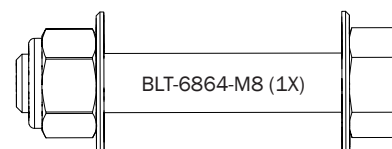
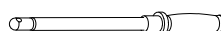

BLT-6864-M8 (1X)

7—Clamp Down Tube Assembly ..... (Qty 1)  
RH, 104.00"

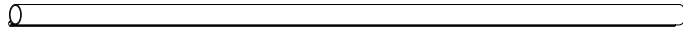

8—Quick Clamp Tube Splice Assembly ..... (Qty 2)  
5.00"



9—Removeable Horn with Cap ..... (Qty 2)  
15.00"

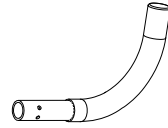

10—Clamp Down Tube ..... (Qty 1)  
LH, 56.00"



11—HD Front Hook Assembly ..... (Qty 2)  
(Requires partial disassembly for installation)

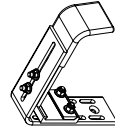

12—Anti-Seize Compound ..... (Qty 2)



**FBM3-0019**

- 0.1** Install the Mounting Brackets to the cap using the hardware shown. The Neoprene Washer, Fender Washer, and Lock Nut are installed under the cap's shell.

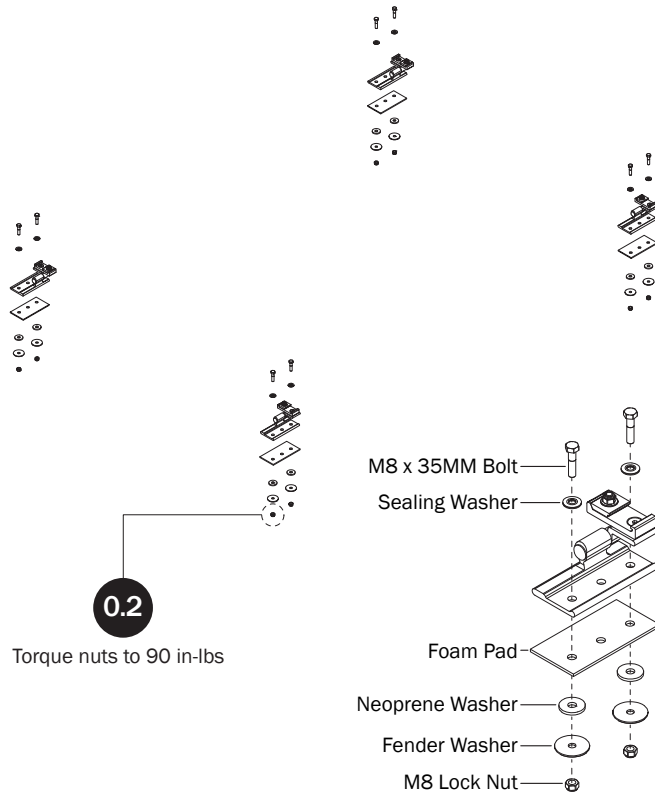

- 0.3** Loosen the Channel Mounting Clamps shown below.

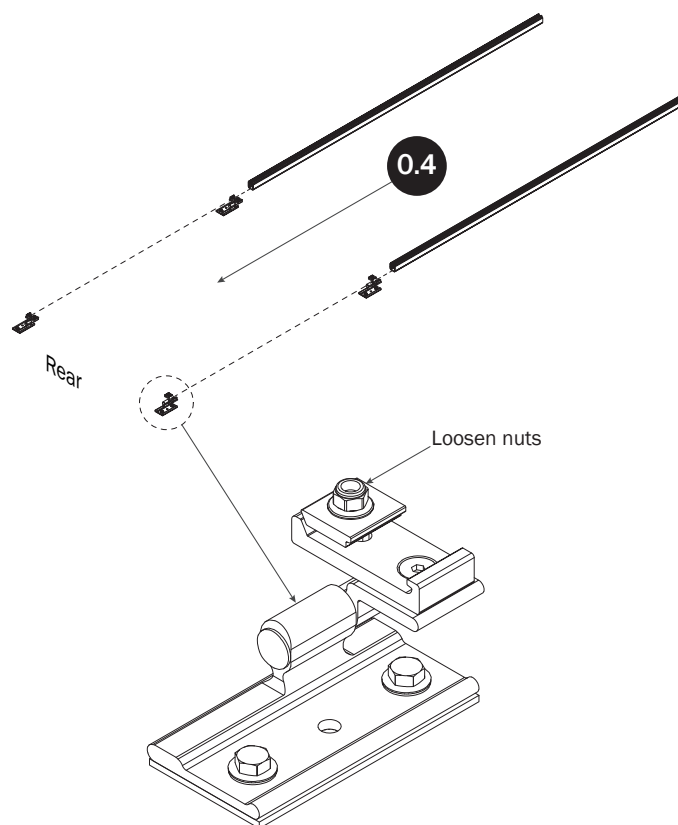

- 0.5** Set the back of the Channels to the distances shown, then torque the Clamp nuts loosened in Step 0.3 to 90 in-lbs

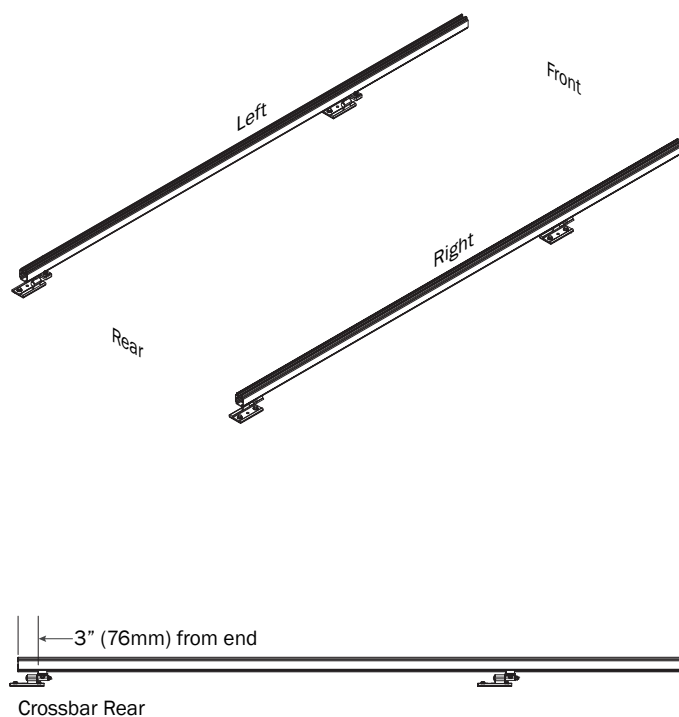

- 0.6** Loosen the Crossbar Mounting bolt, then slide into top rail of Channel.

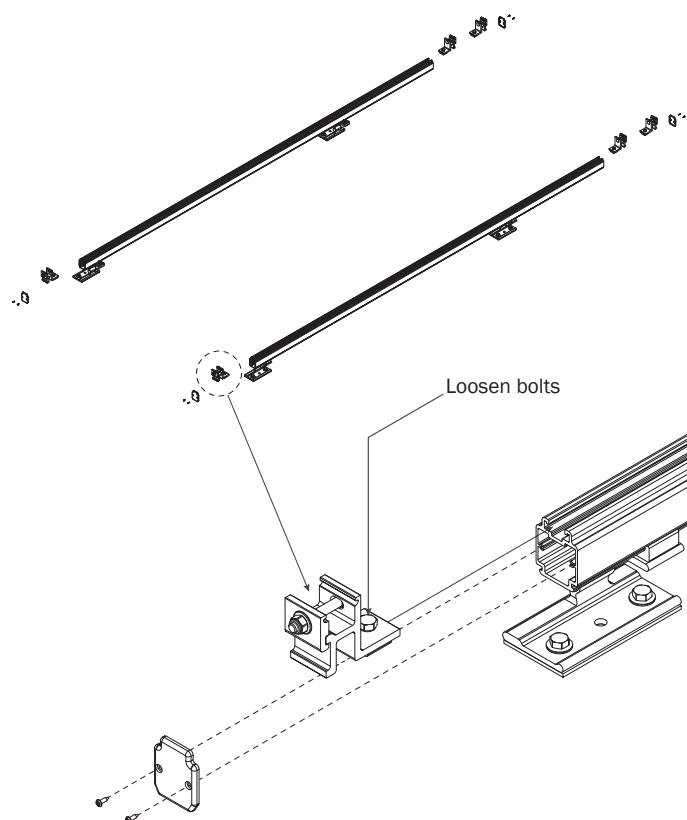

### 4' & 8' (96") CONFIGURATION

- 0.7** Set to distances shown, then torque nuts to 90 in-lbs

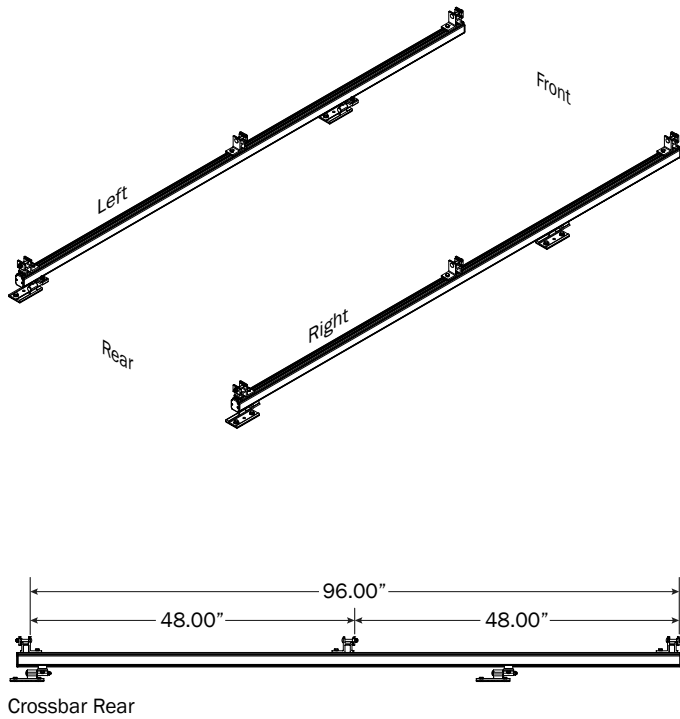

### 4' & 7' (84") CONFIGURATION

**NOTE:** This configuration requires cutting 12" off the Right Hand Front Clamp Down Tube. Do not cut the Right Hand Rear Clamp Down Tube.

- 0.8** Set to distances shown, then torque nuts to 90 in-lbs

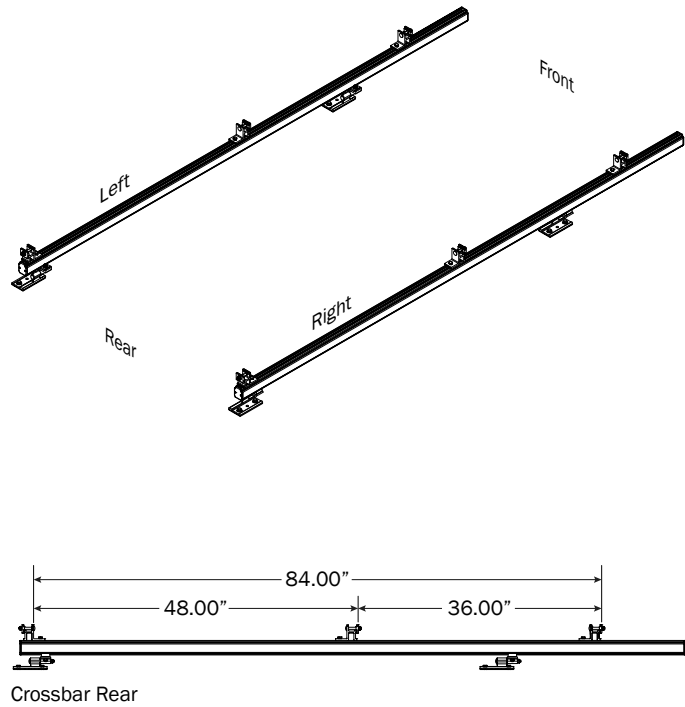

### 4' & 6' (72") CONFIGURATION

**NOTE:** This configuration requires cutting 24" off the Right Hand Front Clamp Down Tube. Do not cut the Right Hand Rear Clamp Down Tube.

- 0.9** Set to distances shown, then torque nuts to 90 in-lbs

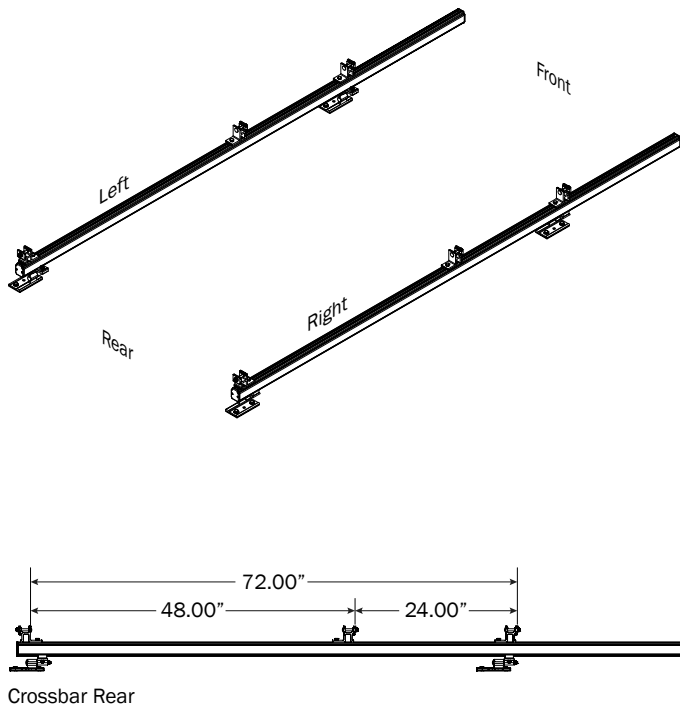

### 3' & 5' (60") CONFIGURATION

**NOTE:** This configuration requires cutting 24" off the Right Hand Front Clamp Down Tube, and 12" off the Right and Left Hand Rear Clamp Down Tubes.

- 0.10** Set to distances shown, then torque nuts to 90 in-lbs

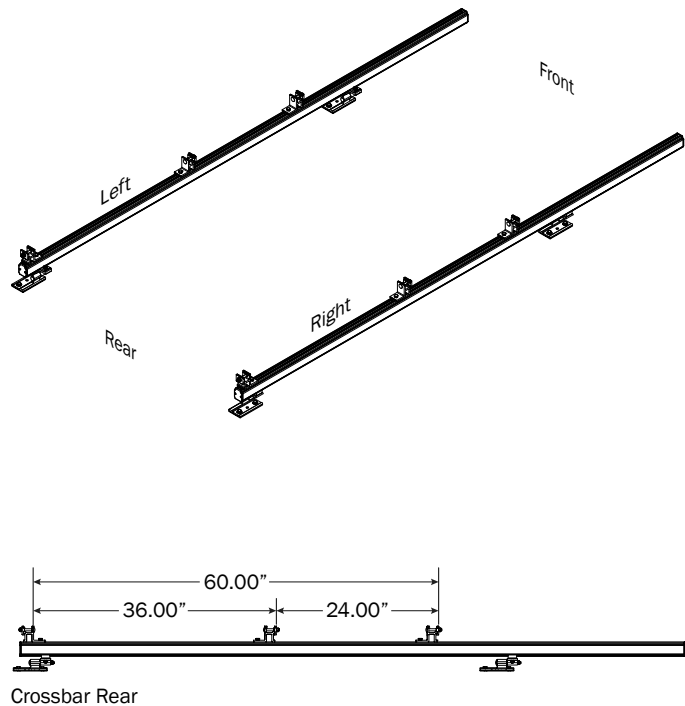

**RIGHT ROTATION ASSEMBLY SEQUENCE**

**NOTE:** This Manual shows a 4' and 8' Crossbar spacing. For different Crossbar spacing configurations, the Clamp Down Tubes will need to be cut down for correct fitment and operation. Refer to Page 5 of this Manual for correct Clamp Down Tube dimensions.

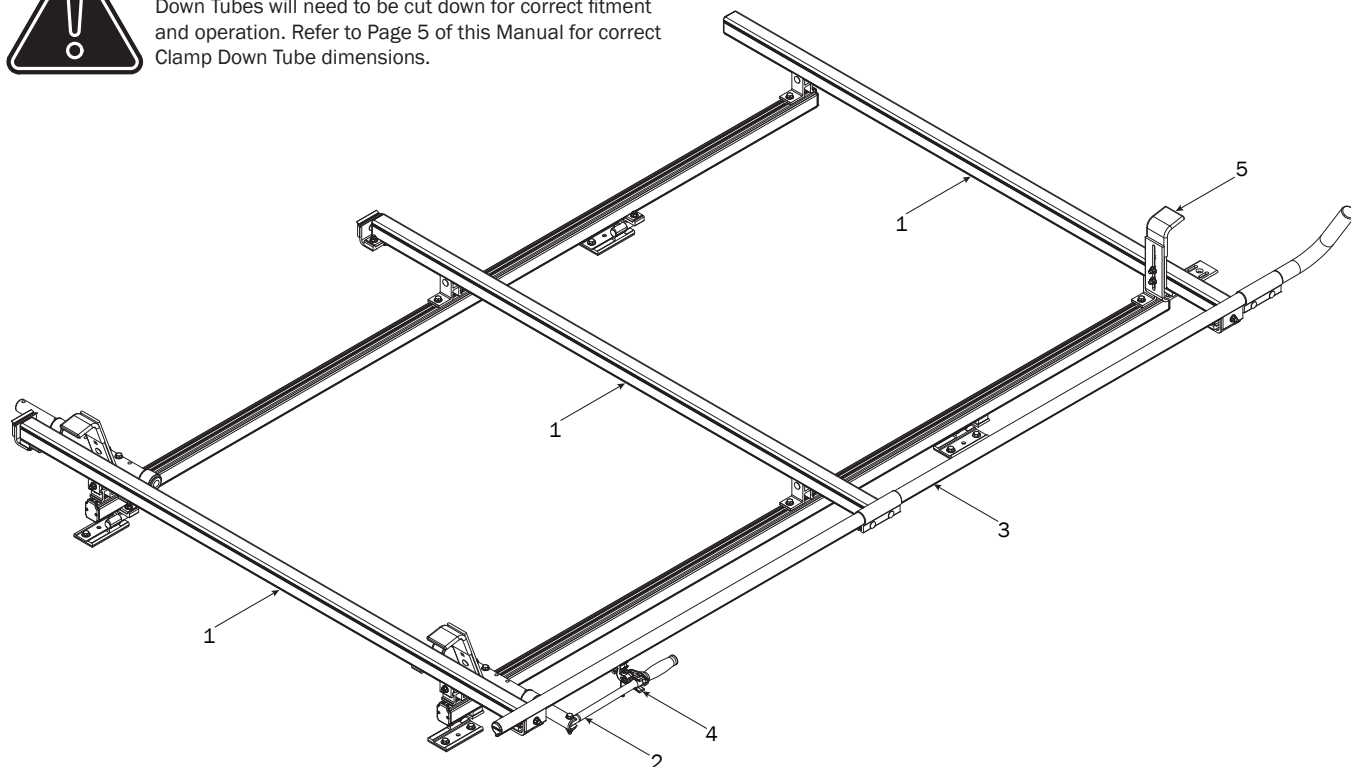
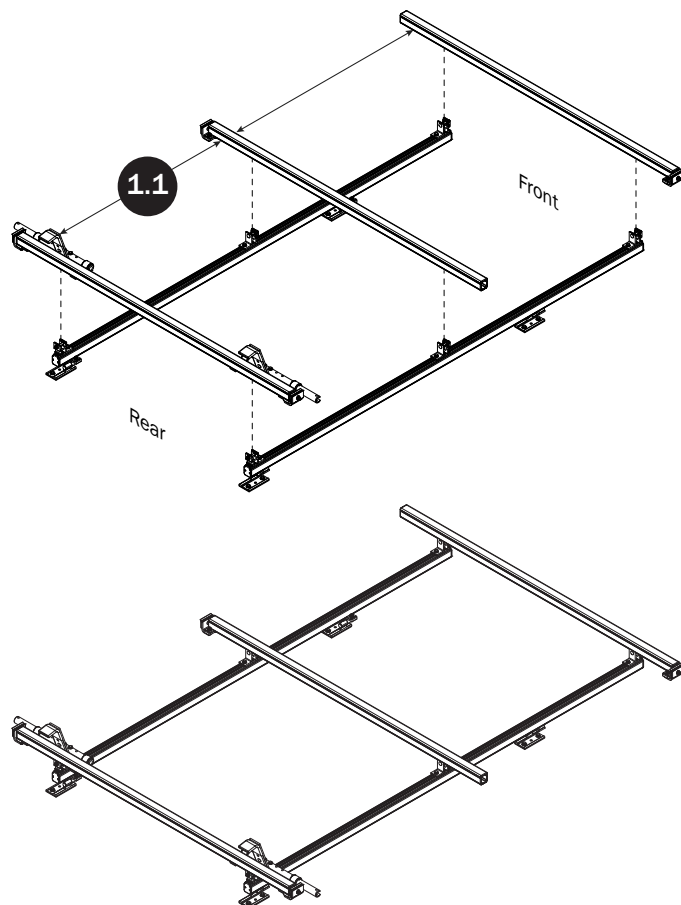
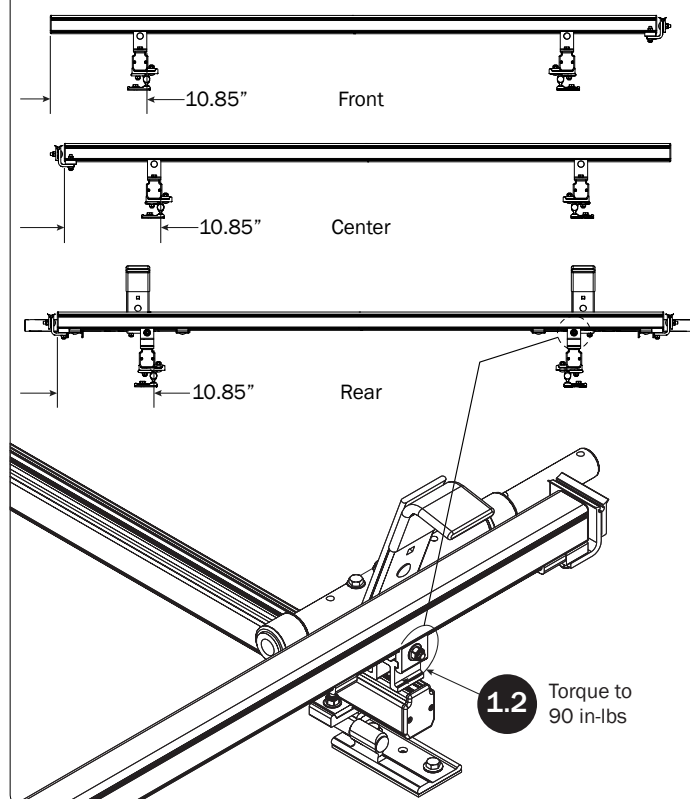
**CROSSBARS****CROSSBAR ADJUSTMENT**

## CLAMP DOWN HANDLE

**NOTE:** For instructional clarity, the FBM Mounting System will not be shown for the remainder of this Assembly Manual.

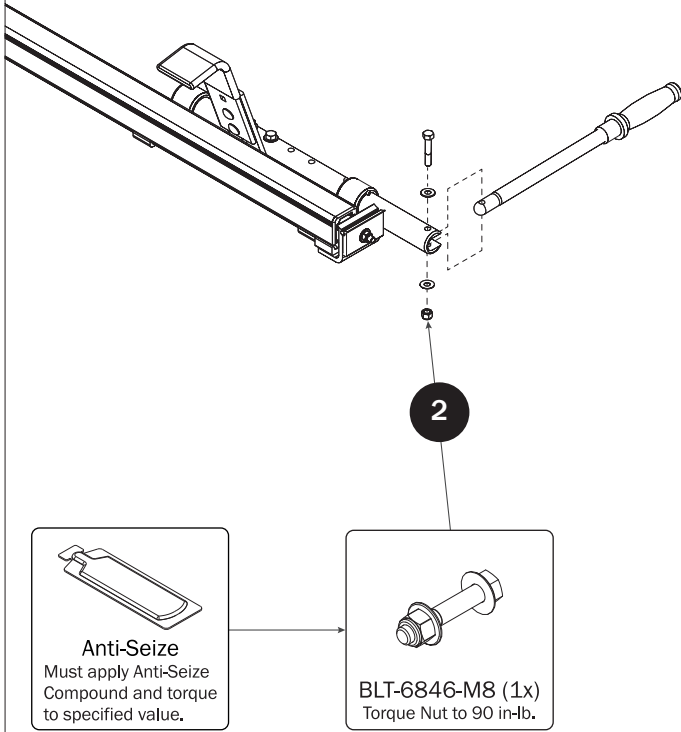

## CLAMP DOWN TUBE

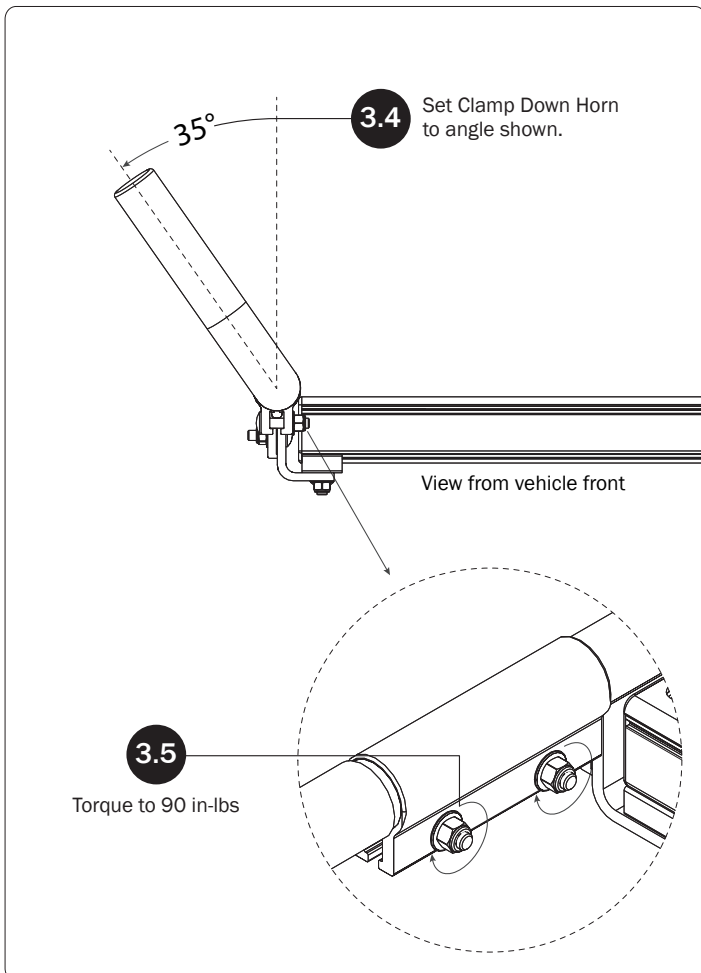
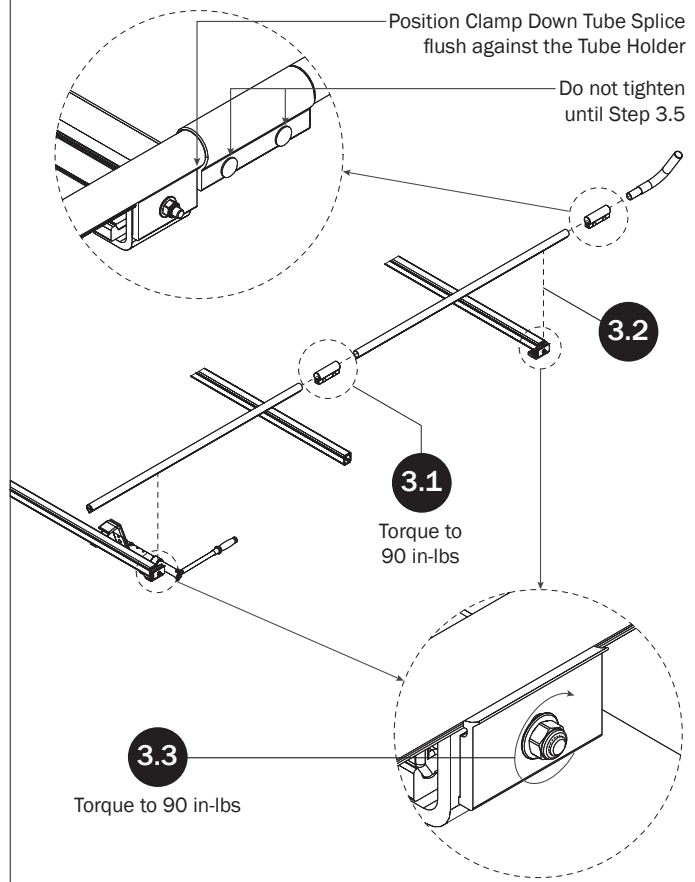

## HANDLE LATCH

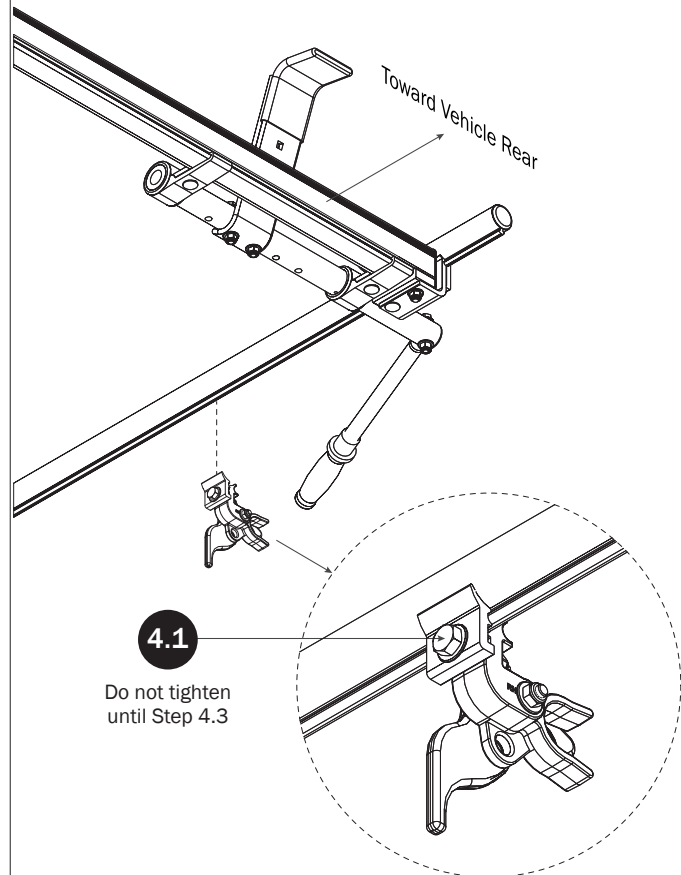

- 4.2** Position the Handle Latch until the Handle Grip is firmly seated.

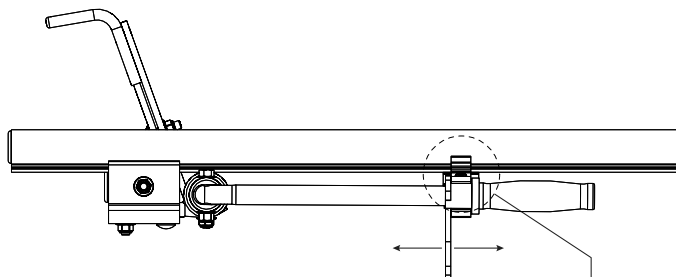

- 4.3**  
Torque to 90 in-lbs

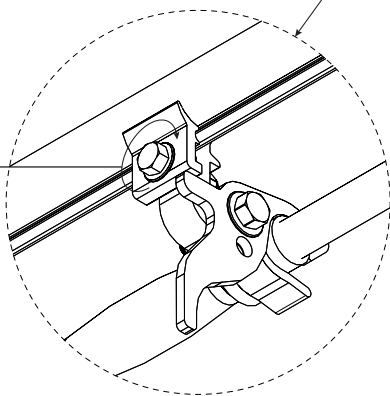

- 5.3** Place the Front Hook Clamp Bracket removed in Step 5.1 into the lower groove of the Crossbar, and slide it on top of the Front Ladder Hook Clamp

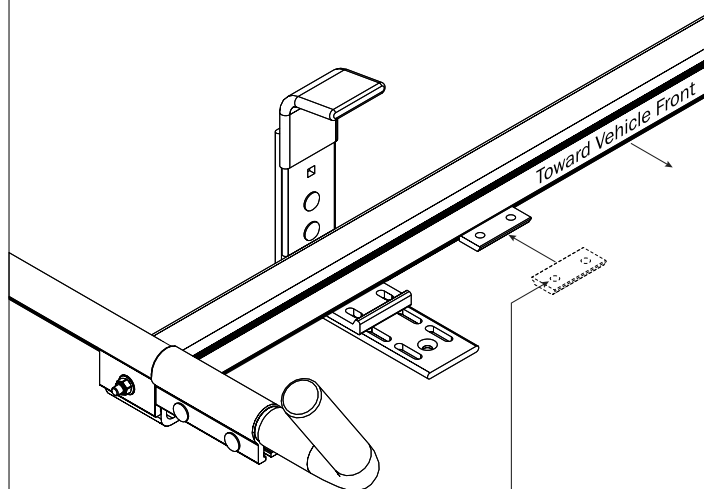

**NOTE:** The orientation of the bolt hole faces away from the Crossbar

## FRONT LADDER HOOK SEE QUICK START GUIDE FOR ADJUSTMENTS

- 5.1** Remove and retain the Front Ladder Hook fastening hardware (not shown in this view) for Steps 5.3 and 5.4

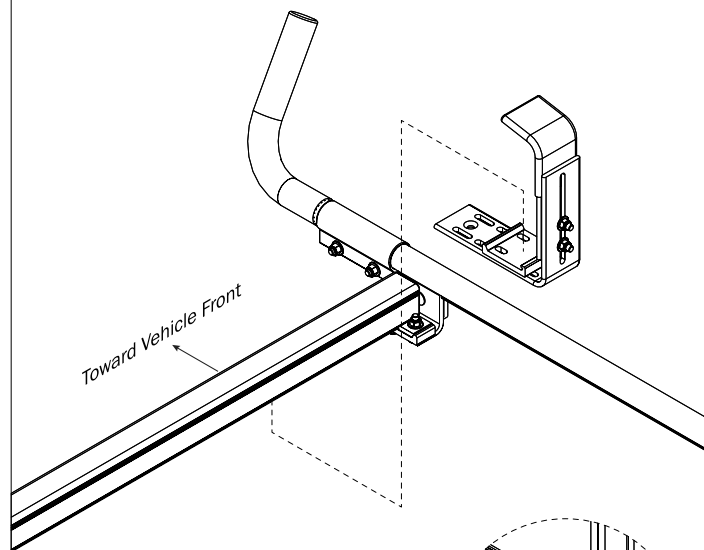

- 5.2**  
Seat the Front Ladder Hook into the lower Crossbar groove as shown in this bottom view

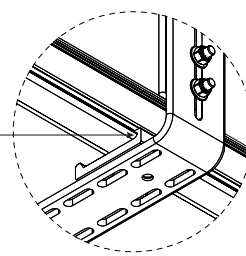

- 5.4** Reassemble the Front Clamp Down Tube Holder using the fastening hardware removed at Step 5.1. Do not tighten until Step 5.6

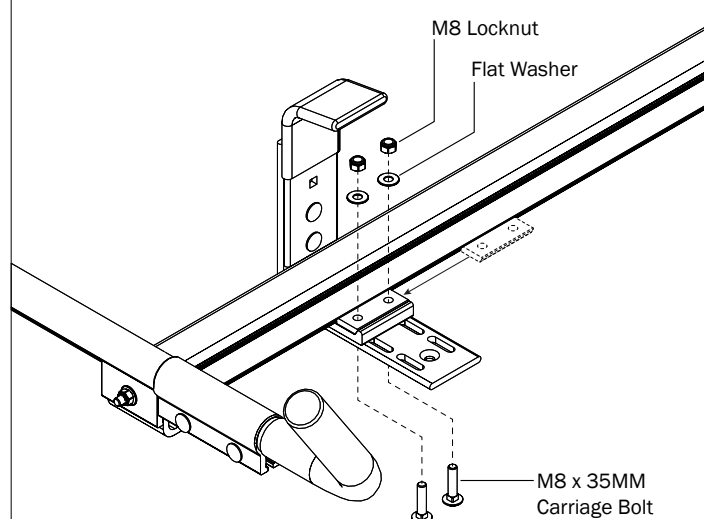



5.5

Adjust the Front Hook until it aligns with the Rear Hook. Perfect alignment may not be possible in all instances, and depends upon the location of the Crossbar Mounting Brackets. If such interference should occur, align the Hook as close as possible.

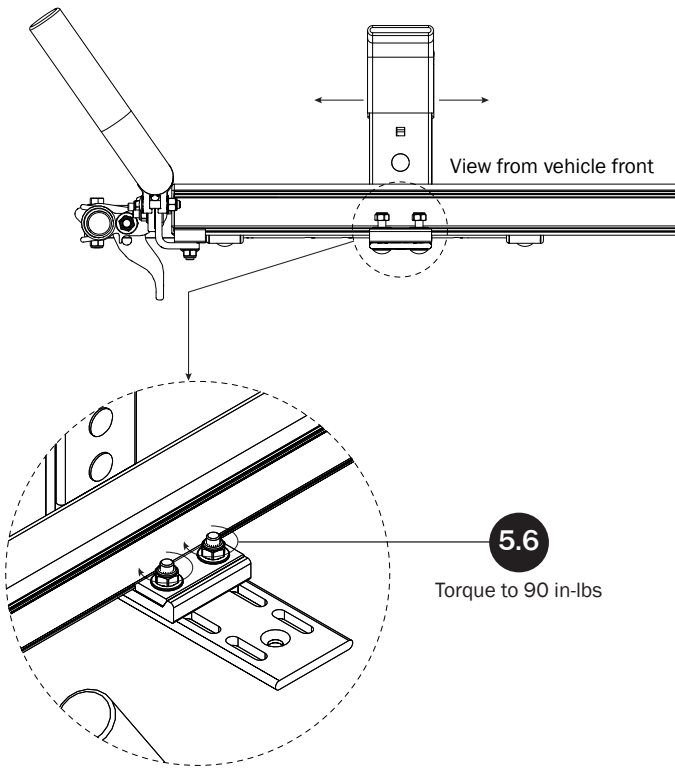

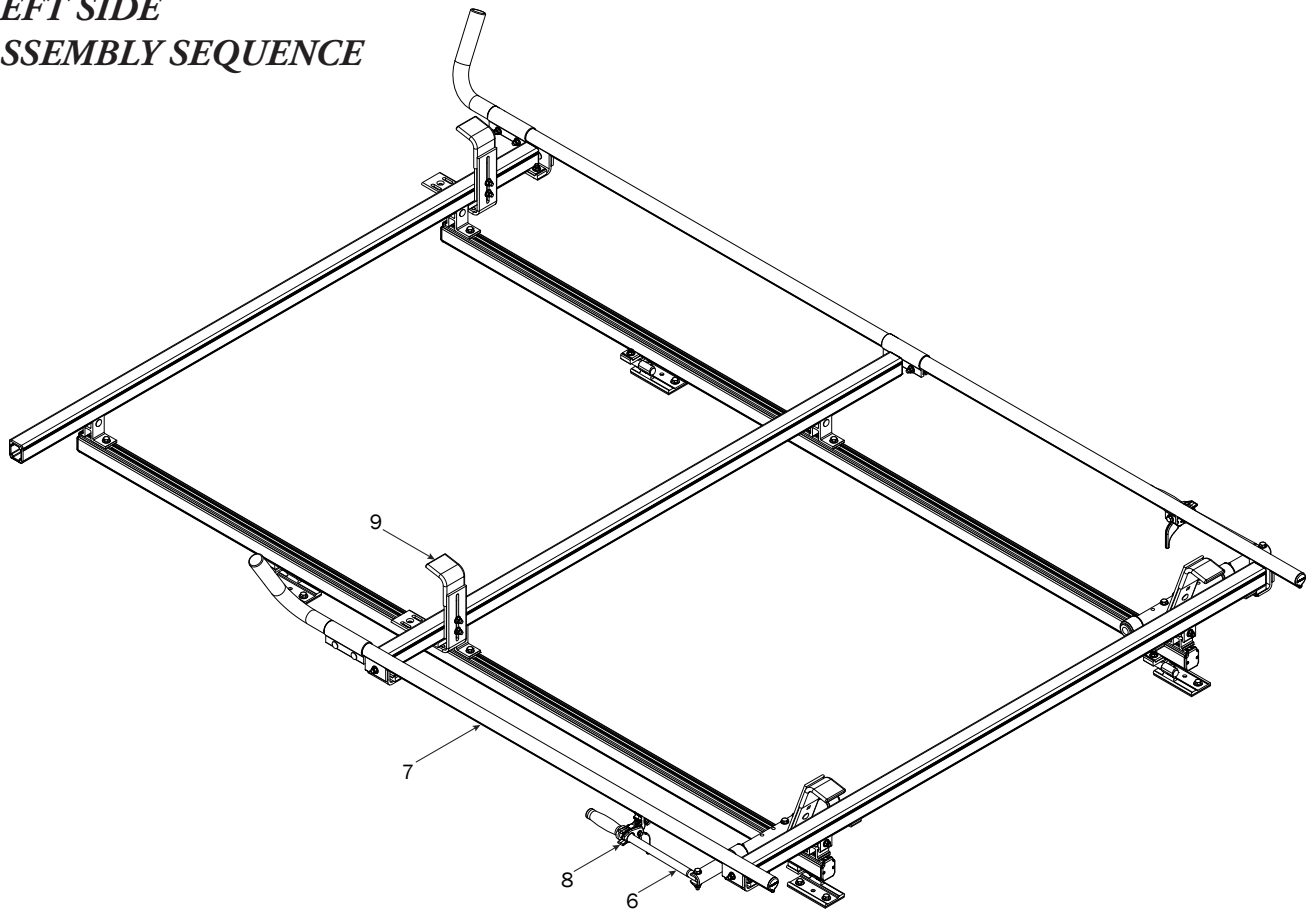
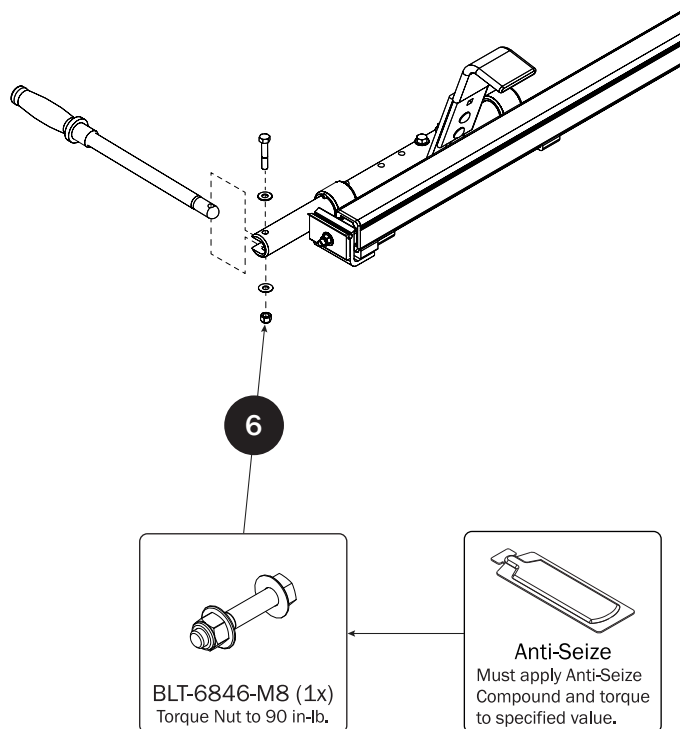
**LEFT SIDE  
ASSEMBLY SEQUENCE****CLAMP DOWN HANDLE****CLAMP DOWN TUBE**

Position Clamp Down Tube Splice  
flush against the Tube Holder

Do not tighten  
until Step 7.5

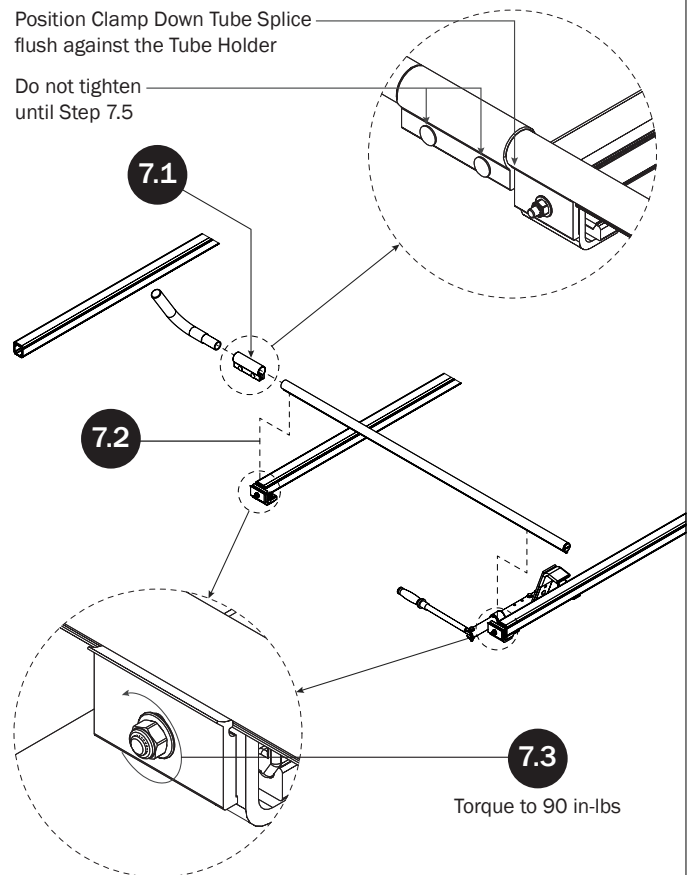

Set Clamp Down Horn  
to angle shown.

7.4

35°

View from vehicle front

7.5

Torque to 90 in-lbs

## HANDLE LATCH

Toward Vehicle Rear

8.1

Do not tighten  
until Step 8.3

8.2 Position the Handle Latch until the  
Handle Grip is firmly seated.

## FRONT LADDER HOOK

SEE QUICK START GUIDE FOR ADJUSTMENTS

9.1

Remove and retain the Front Ladder Hook  
fastening hardware (not shown in this view)  
for Steps 9.3 and 9.4

Toward Vehicle Front

8.3

Torque to 90 in-lbs

9.2

Seat the Front Ladder Hook  
into the lower Crossbar groove  
as shown in this bottom view

- 9.3** Place the Front Hook Clamp Bracket removed in Step 9.1 into the lower groove of the Crossbar, and slide it on top of the Front Ladder Hook Clamp

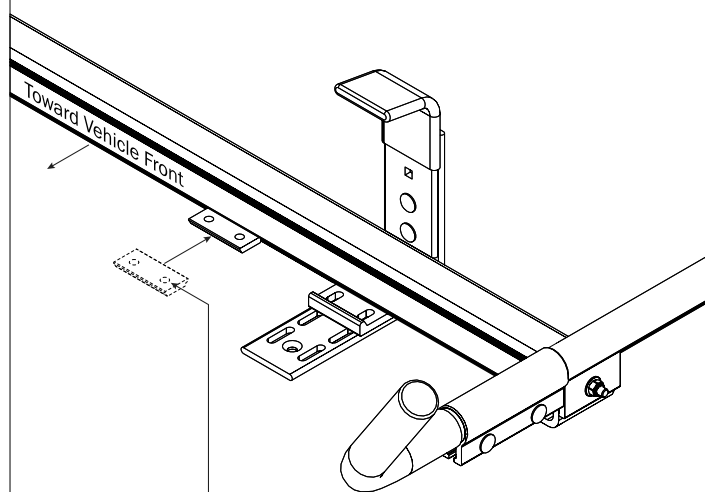

NOTE: The orientation of the bolt hole faces away from the Crossbar

- 9.4** Reassemble the Front Clamp Down Tube Holder using the fastening hardware removed at Step 9.1. Do not tighten until Step 9.6

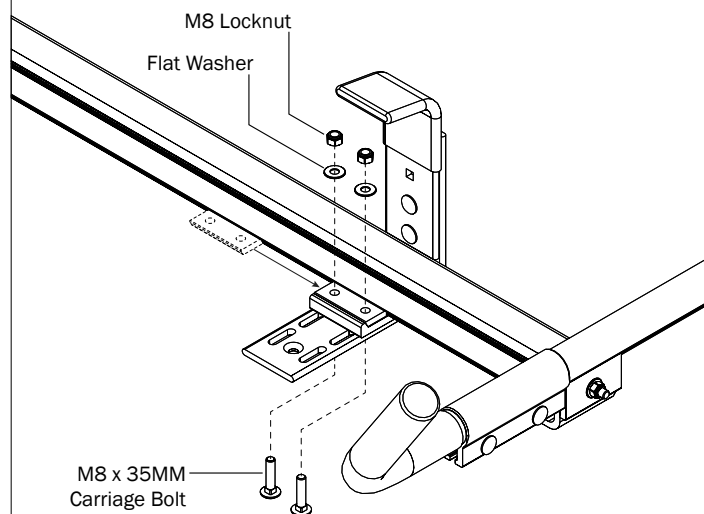

- 9.5** Adjust the Front Hook until it aligns with the Rear Hook. Perfect alignment may not be possible in all instances, and depends upon the location of the Crossbar Mounting Brackets. If such interference should occur, align the Hook as close as possible.

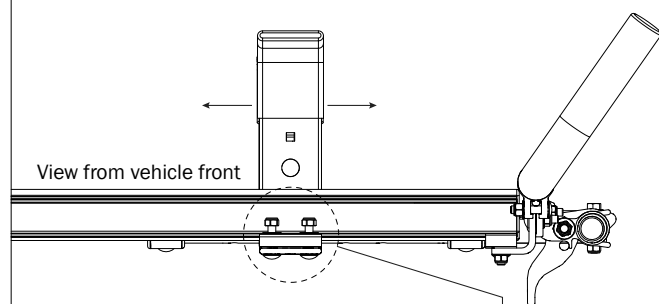

**9.6**

Torque to 90 in-lbs

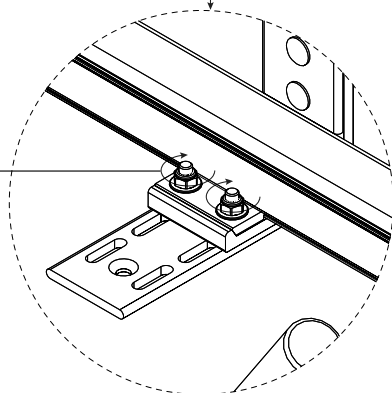

USAM-PCC30017-US01 Rev-A 0318