

PRIME DESIGN™

A Safe Fleet Brand

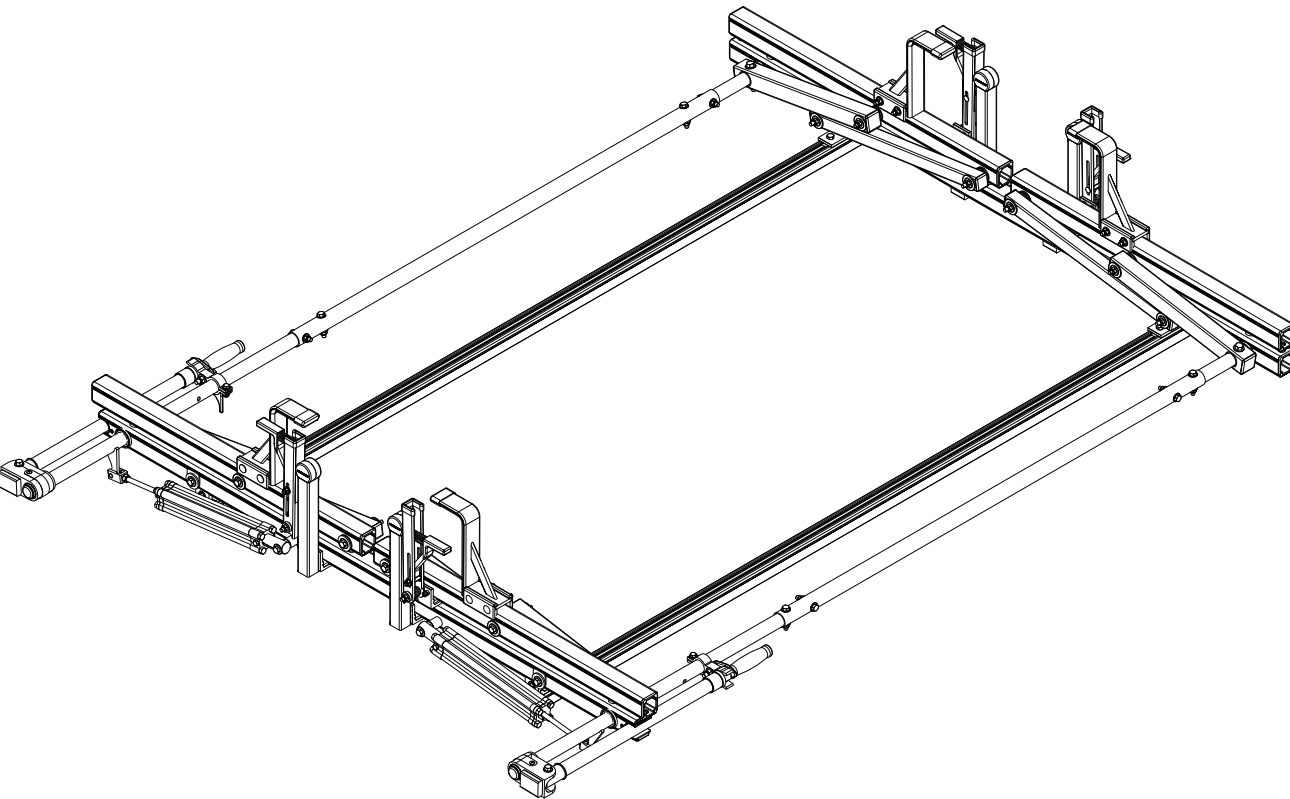

PRR
6000

PRIME DESIGN, A SAFE FLEET BRAND

Address: 580 Opperman Drive, Eagan, MN 55123 • Toll Free: 1.8.PRIME.RACK

Fax: 651-552-1799 • Email: info@primedesign.net • Website: www.primedesign.net

CONTENTS OVERVIEW

INSTALLER NOTE: Mounting Hardware or Brackets to attach this rack to a vehicle roof or cap are not included in this kit, and must be purchased separately.

To purchase Mounting Hardware or Brackets, please contact Prime Design Sales & Support.

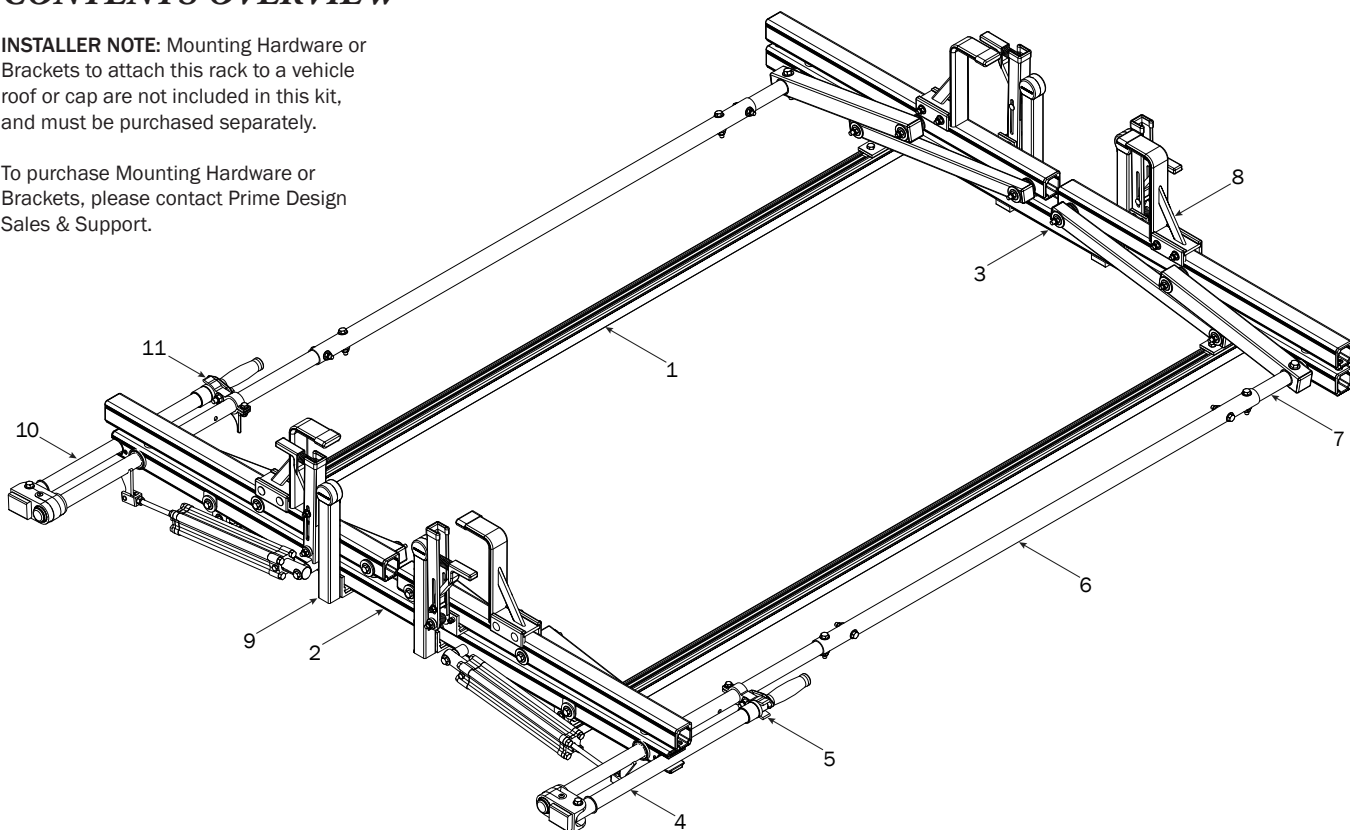

- 1—FBM-0001 (Qty 1)
Channels with hardware



Channels (2X)



Screws (8X)



End Caps (4X)



Brackets (4X)

- 2—Rear Crossbar Assembly..... (Qty 1)

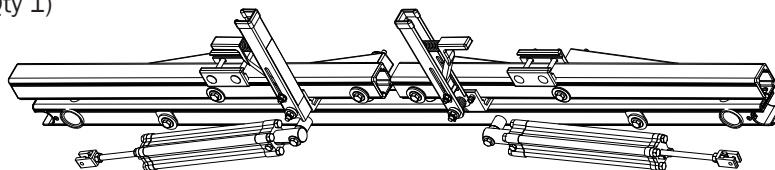

- 3—Front Crossbar Assembly (Qty 1)

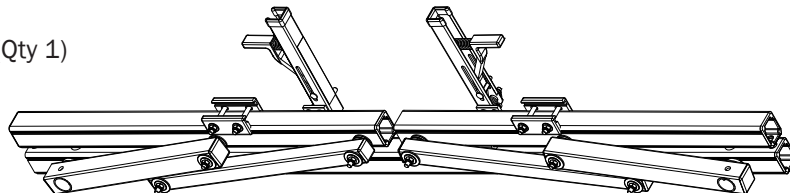

- 4—Rear Drive Shaft..... (Qty 1)
Right Hand, 34.00"

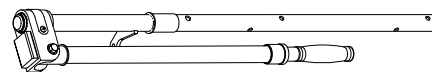

- 5—Handle Latch Assembly (Qty 1)
Right Hand



- 6—Connecting Bar..... (Qty 2)
4.00'



7—Front Drive Shaft (Qty 2)
B Version, 35.75"



8—Z Post (Qty 4)
Adjustable, 7.25"

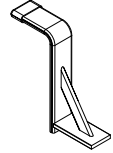

9—L Post (Qty 4)
Roller Cap, 9.25"

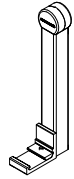

10—Rear Drive Shaft (Qty 1)
Left Hand, 34.00"

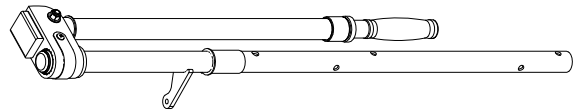

11—Handle Latch Assembly (Qty 1)
Left Hand



12—HKT-8163-Rotation Hardware Kit (Qty 2)
(Not called out in Overview)

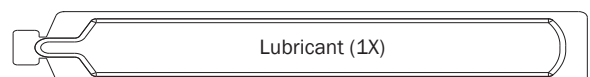
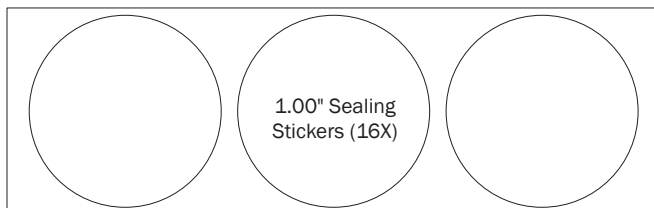
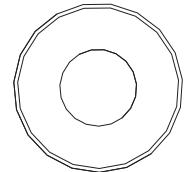
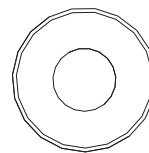
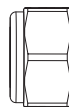
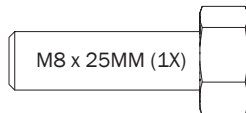
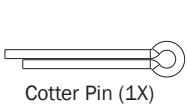
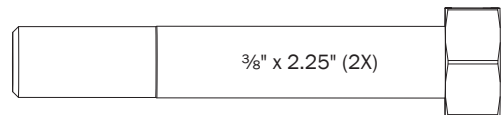
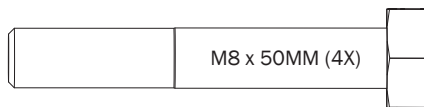
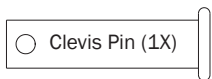

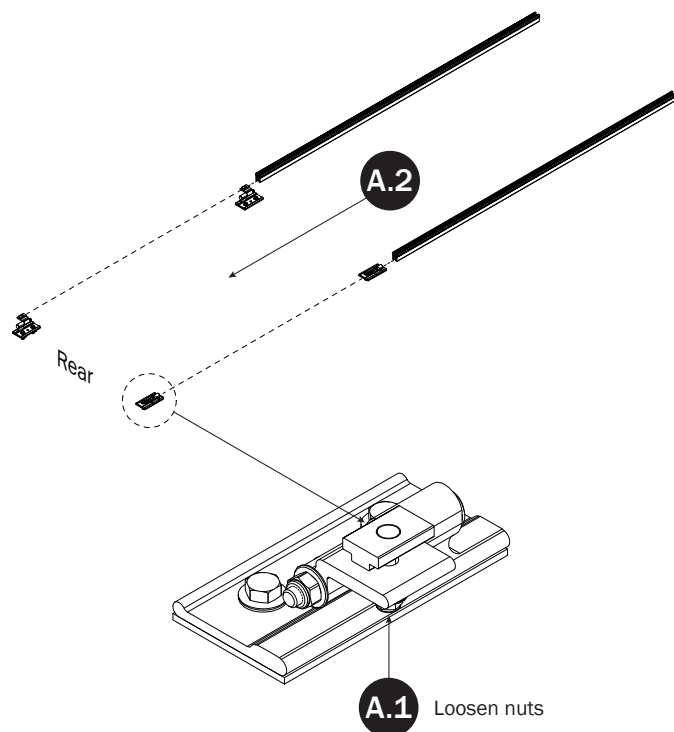
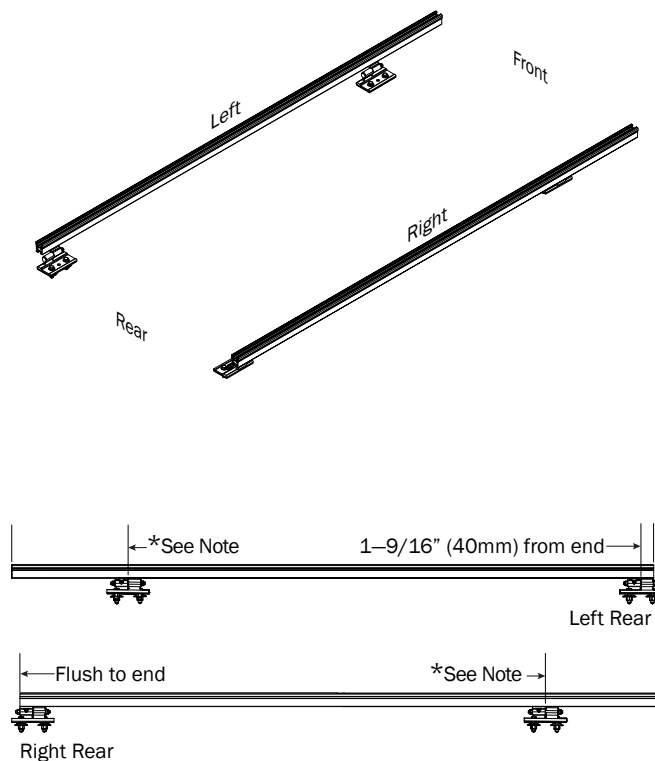
FBM-0001 FLUSH
CHANNELS TO PRE-INSTALLED
MOUNTING BRACKETS**A.3** Set to distances then torque nuts to 80 in-lbs

*Note: Use Alternate instructions if marked distances exceed 18" (457mm).

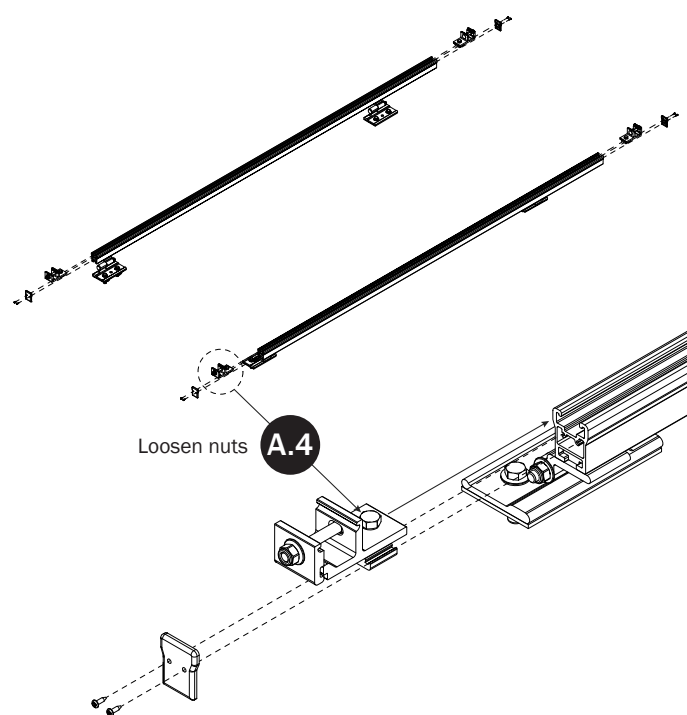
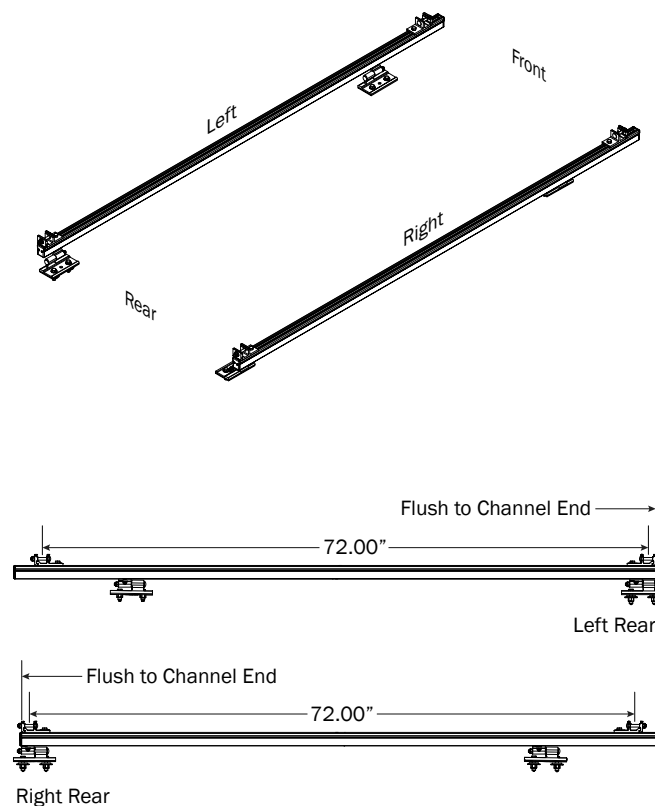
**A.5** Set to distances then torque Rear Bracket nuts to 90 in-lbs

FBM-0001 ALTERNATE
CHANNELS TO PRE-INSTALLED
MOUNTING BRACKETS

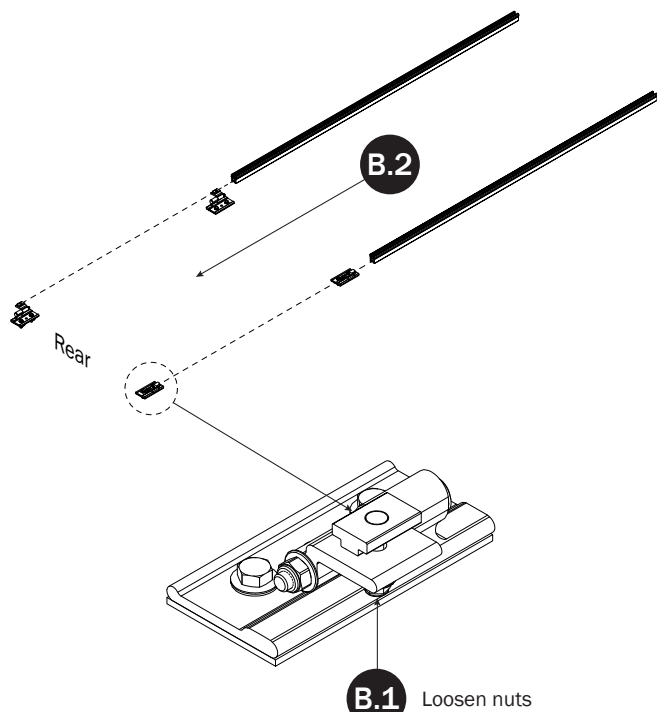

B.3 Set to distances then torque nuts to 80 in-lbs

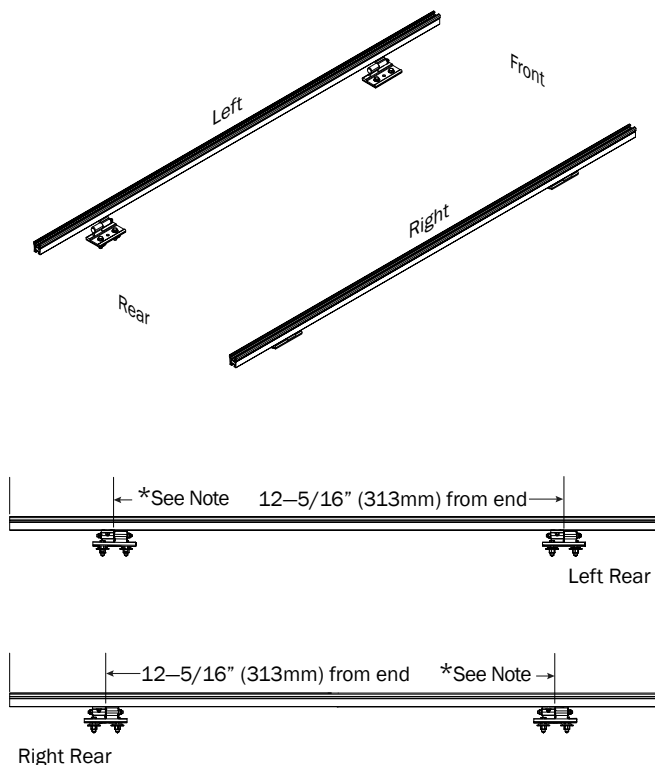

*Note: Move Channels rearward if marked front distance exceeds 18" (457mm).

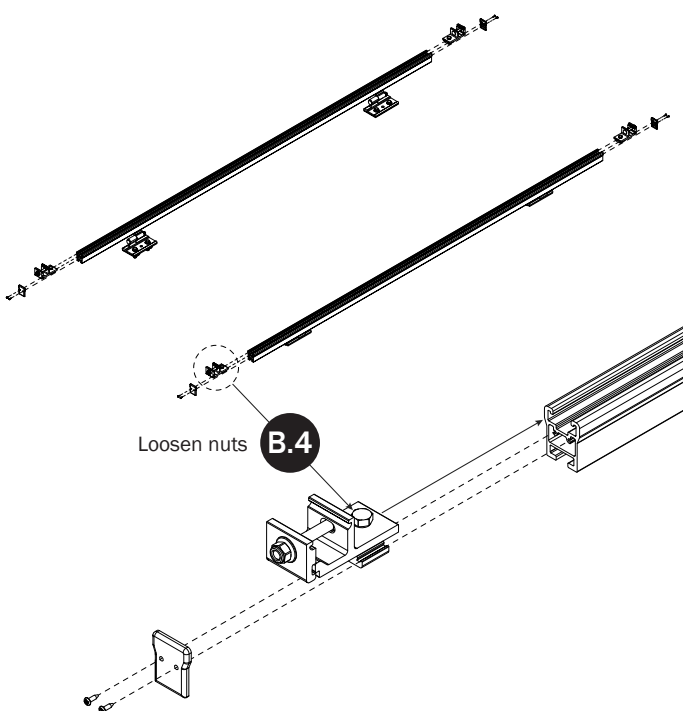

B.5 Set to distances then torque Rear Bracket nuts to 90 in-lbs

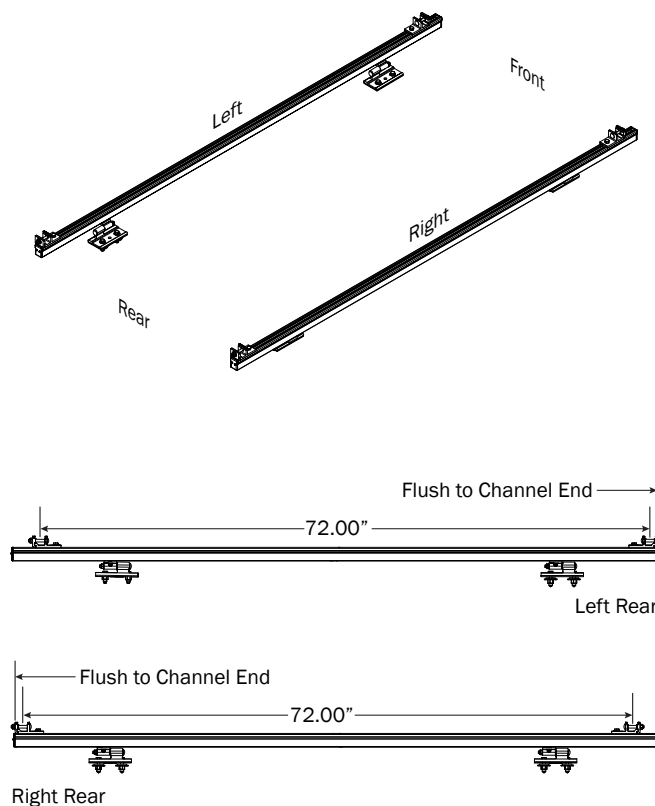

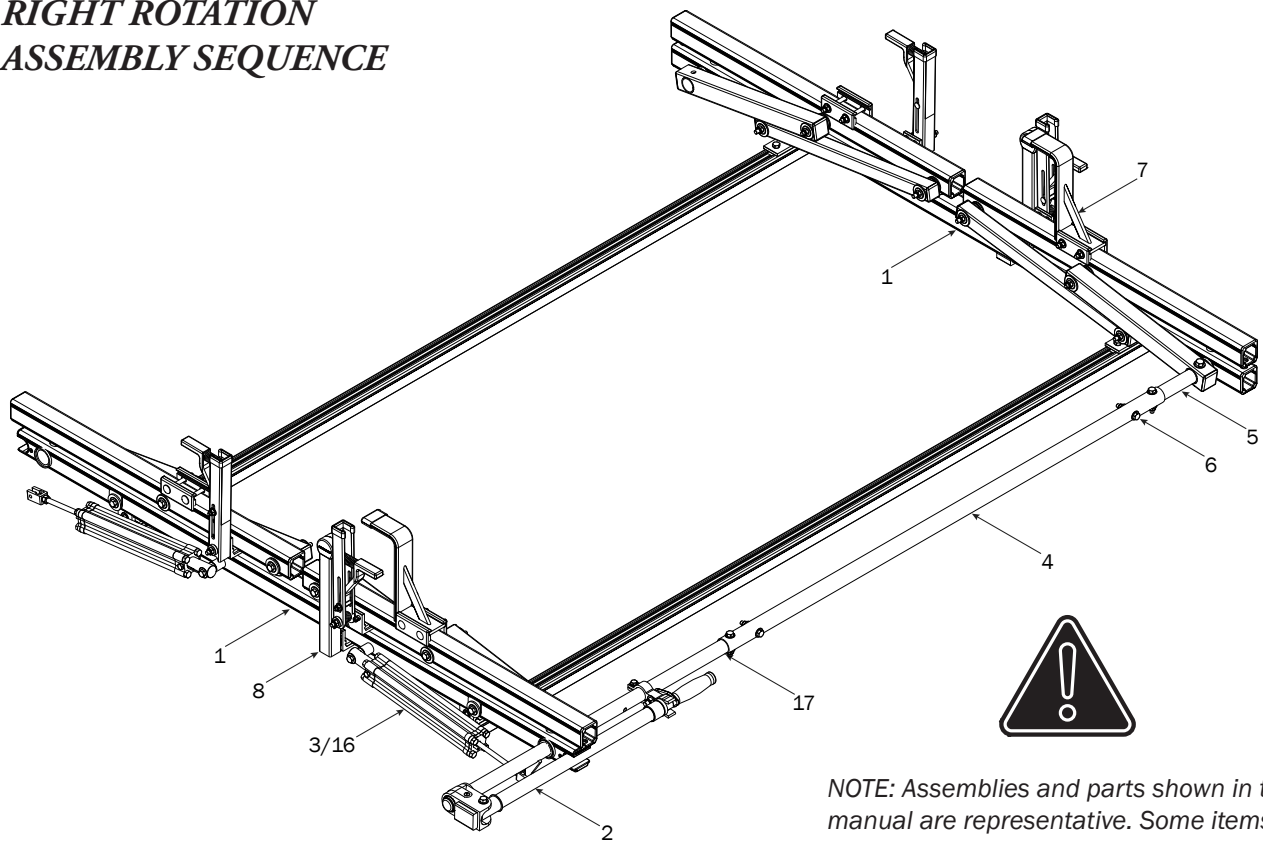
**RIGHT ROTATION
ASSEMBLY SEQUENCE**

NOTE: Assemblies and parts shown in this manual are representative. Some items may appear different from actual parts, assemblies, or components received.

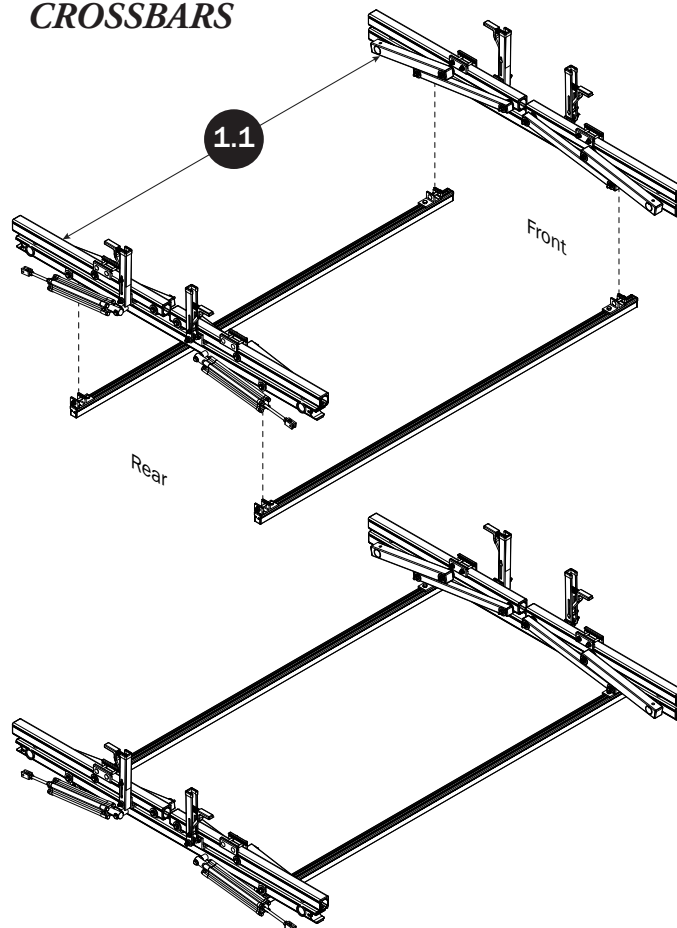
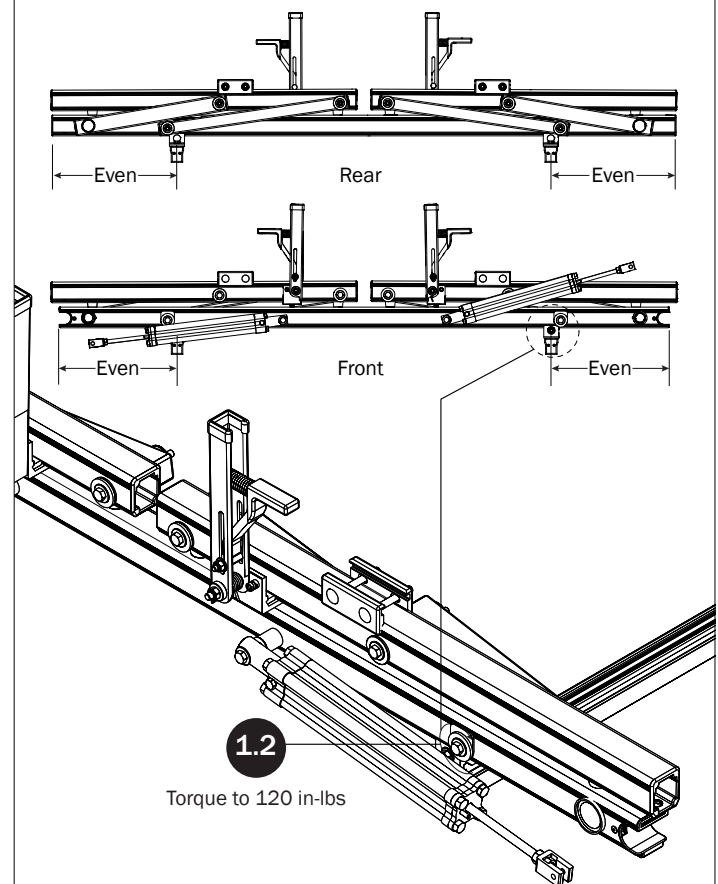
CROSSBARS**CROSSBAR ADJUSTMENT**

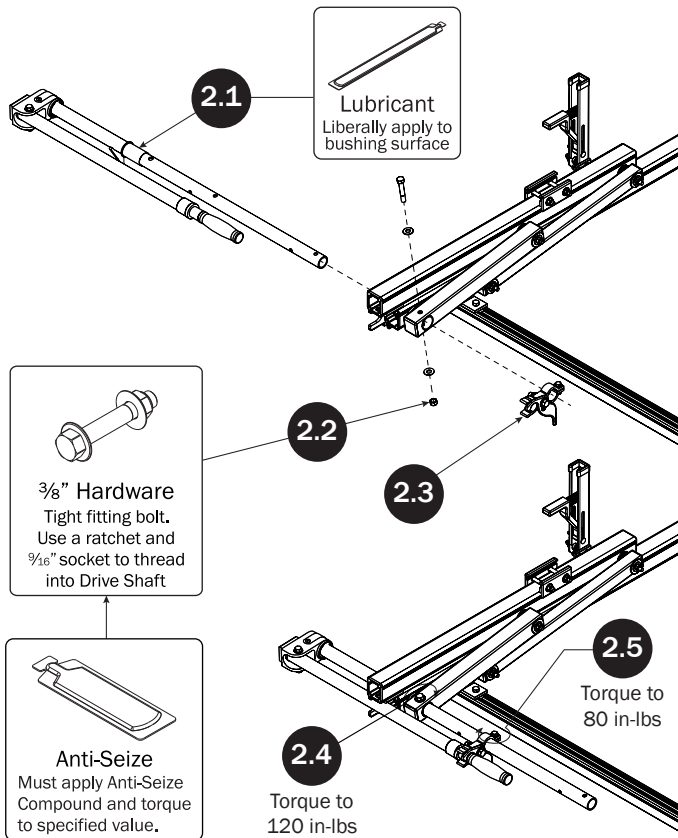
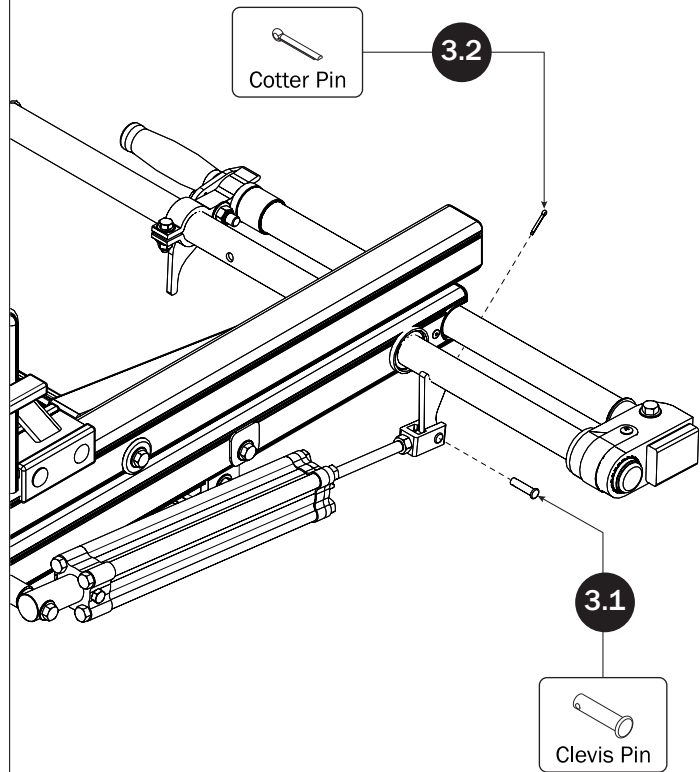
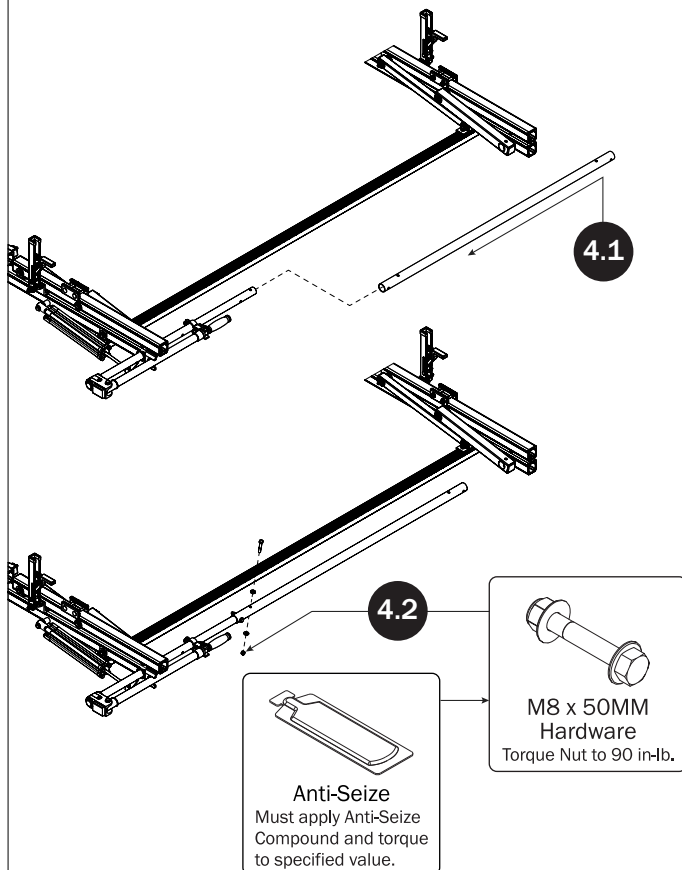
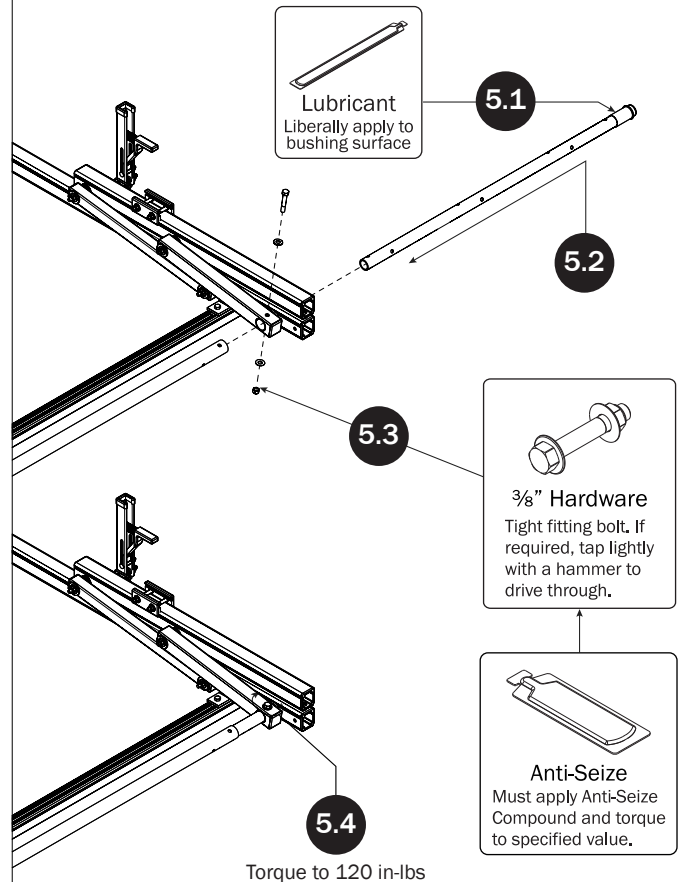
REAR DRIVE SHAFT**CYLINDER HARDWARE****CONNECTING BAR****FRONT DRIVE SHAFT**

CONNECTING BAR FASTENERS

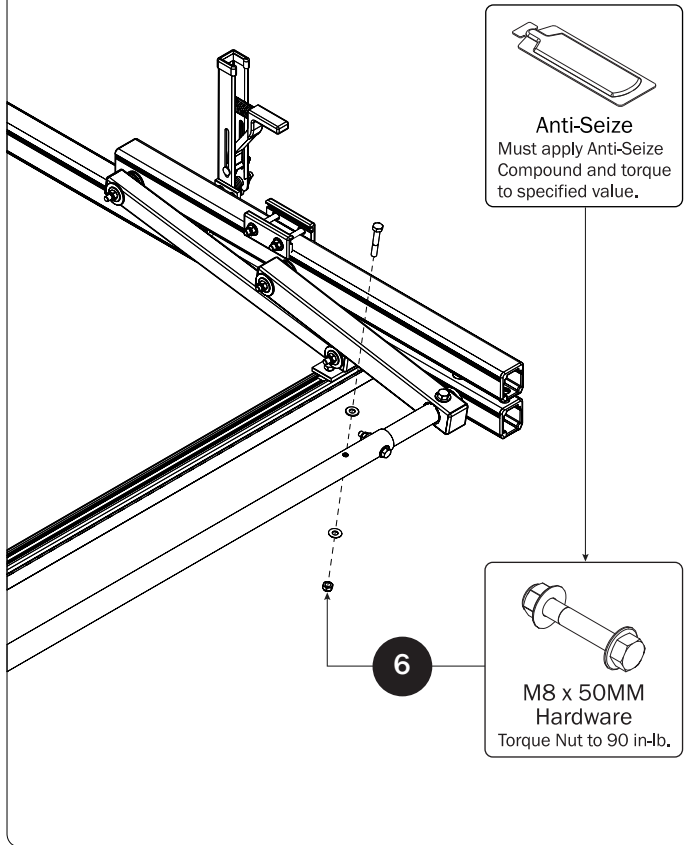

Z POSTS SEE QUICK START GUIDE FOR ADJUSTMENTS

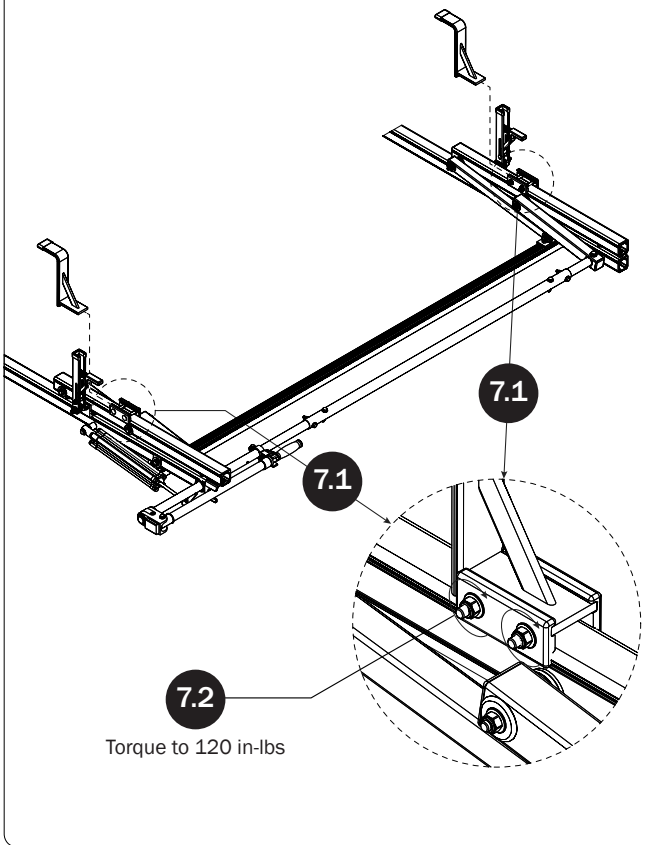

L POSTS SEE QUICK START GUIDE FOR ADJUSTMENTS

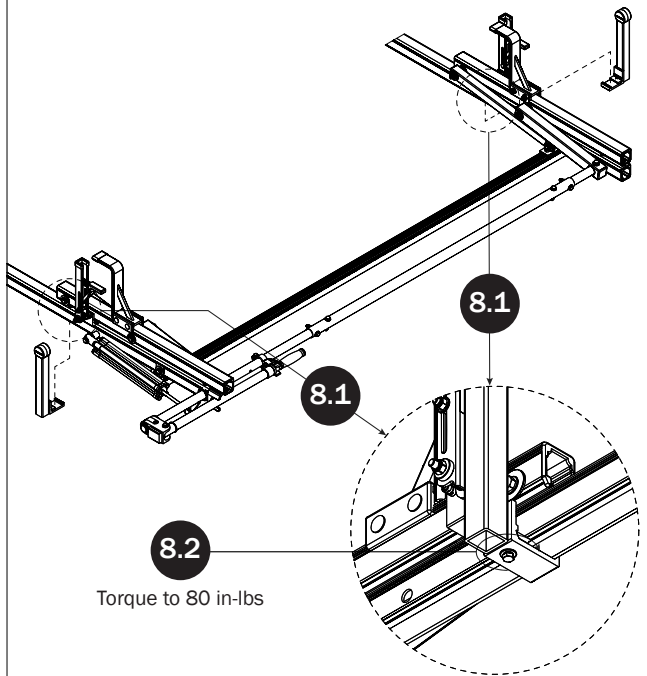

LEFT ROTATION ASSEMBLY SEQUENCE

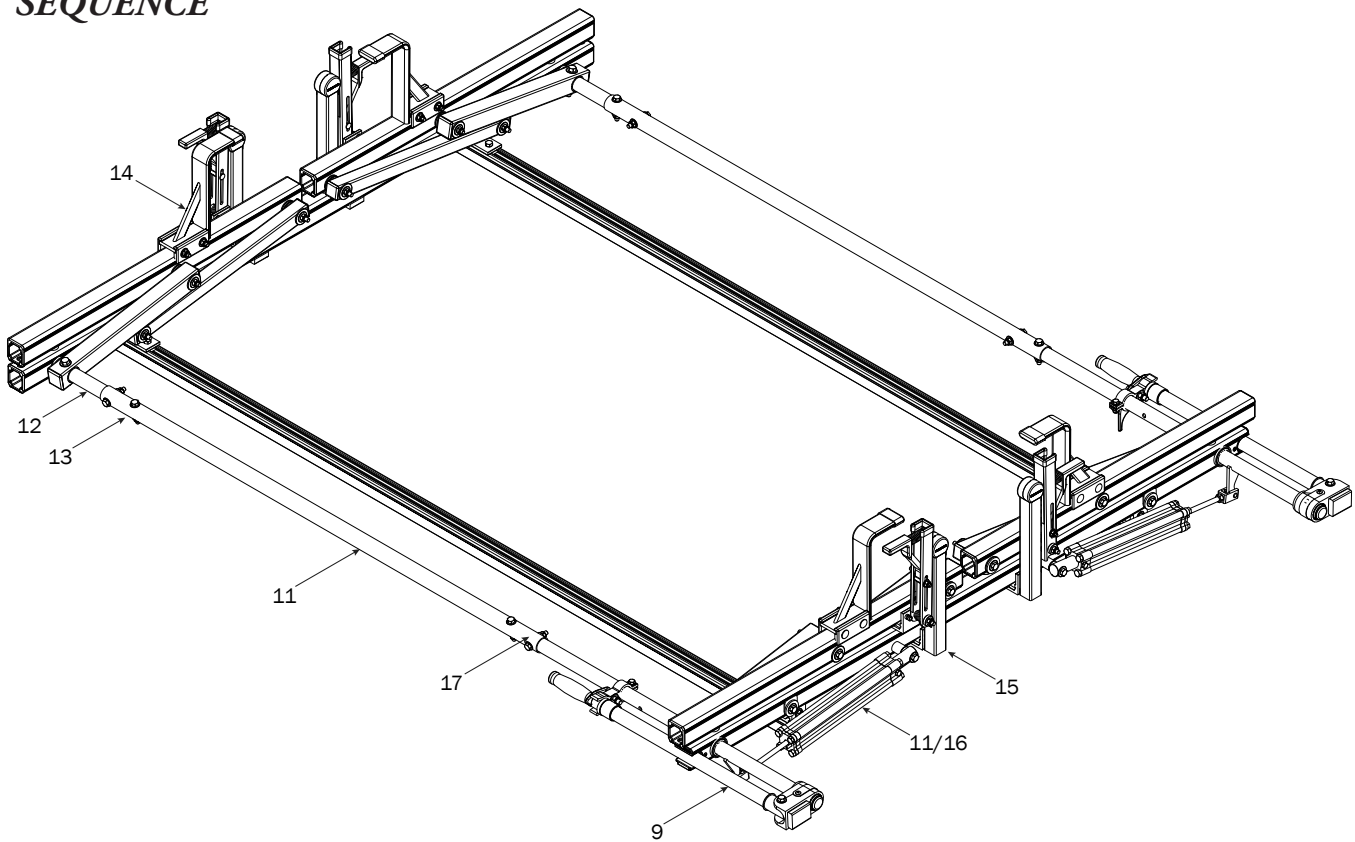

REAR DRIVE SHAFT

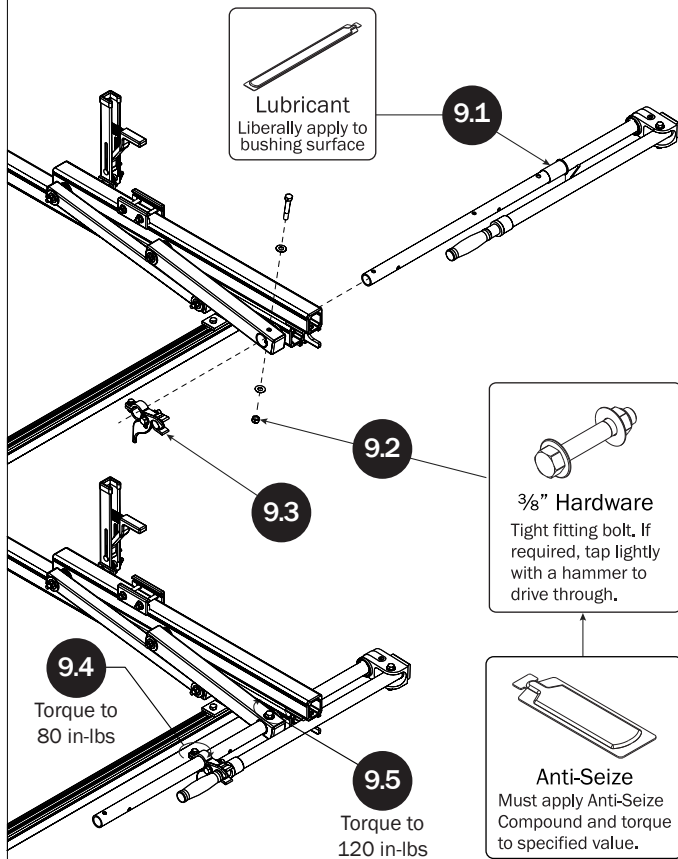

CYLINDER HARDWARE

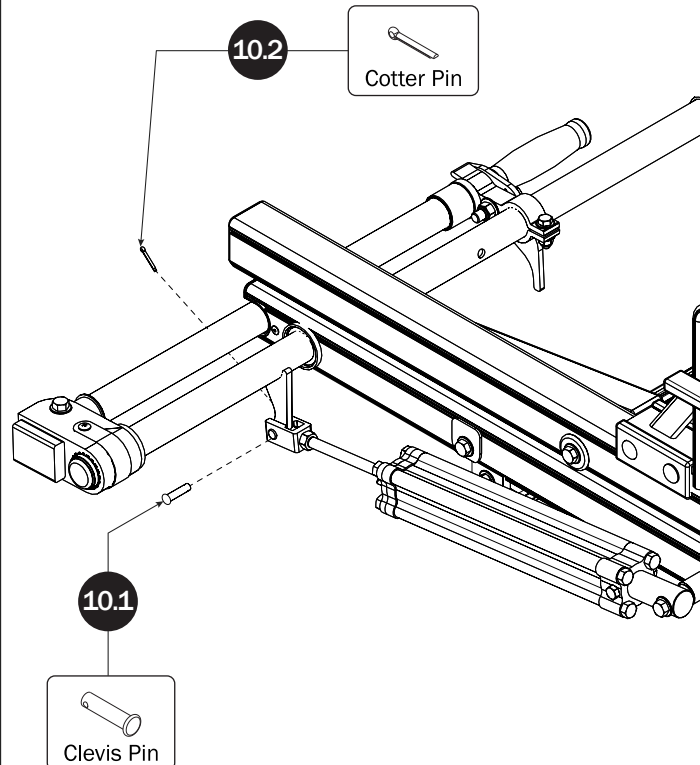

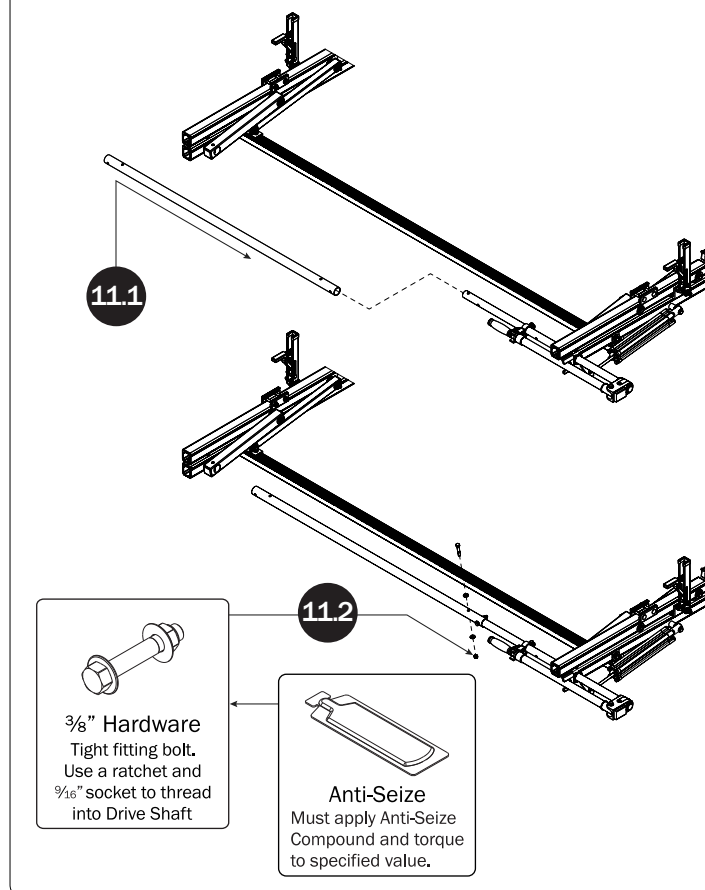
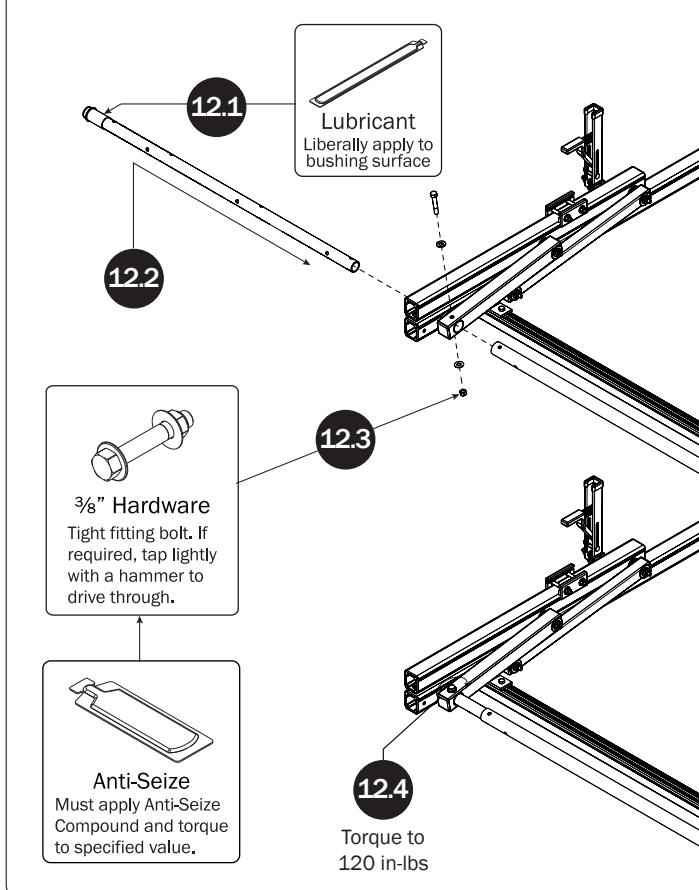
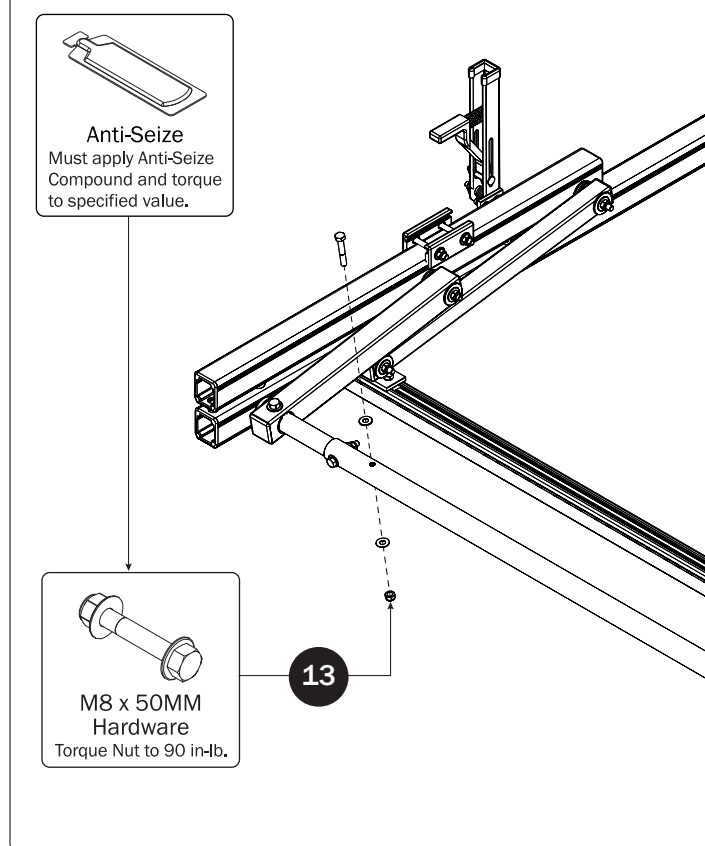
CONNECTING BAR**FRONT DRIVE SHAFT****CONNECTING BAR FASTENERS****Z POSTS**

SEE QUICK START GUIDE FOR ADJUSTMENTS

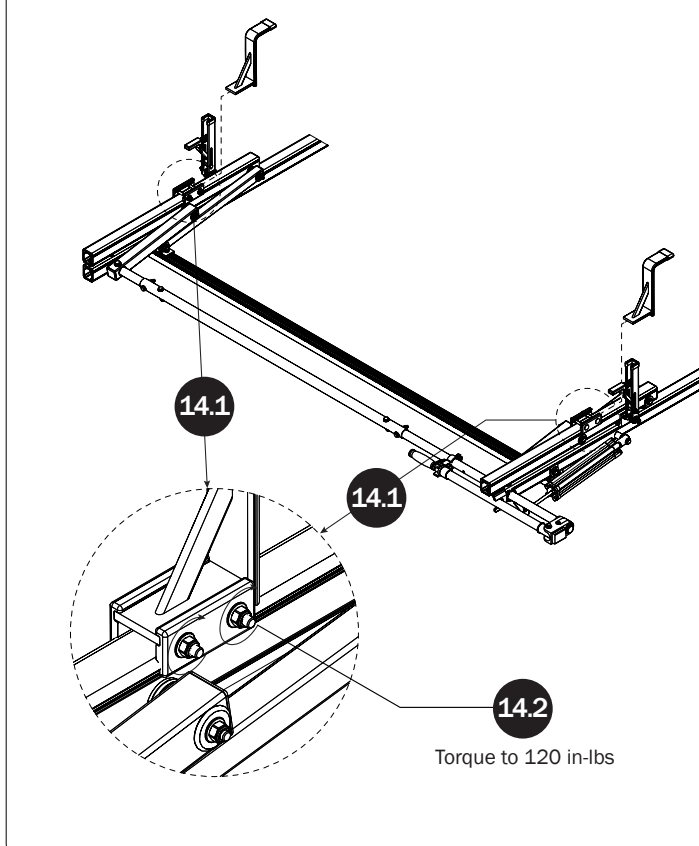

L POSTS

SEE QUICK START GUIDE FOR ADJUSTMENTS

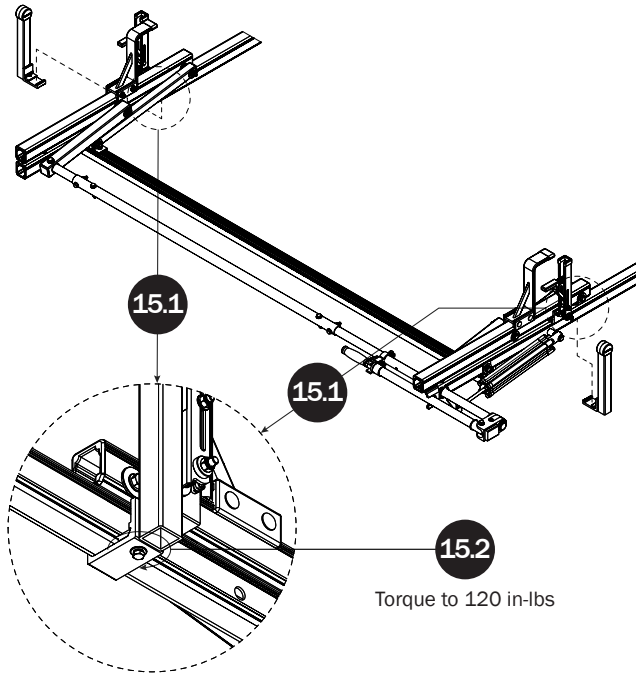

CYLINDER ADJUSTMENT

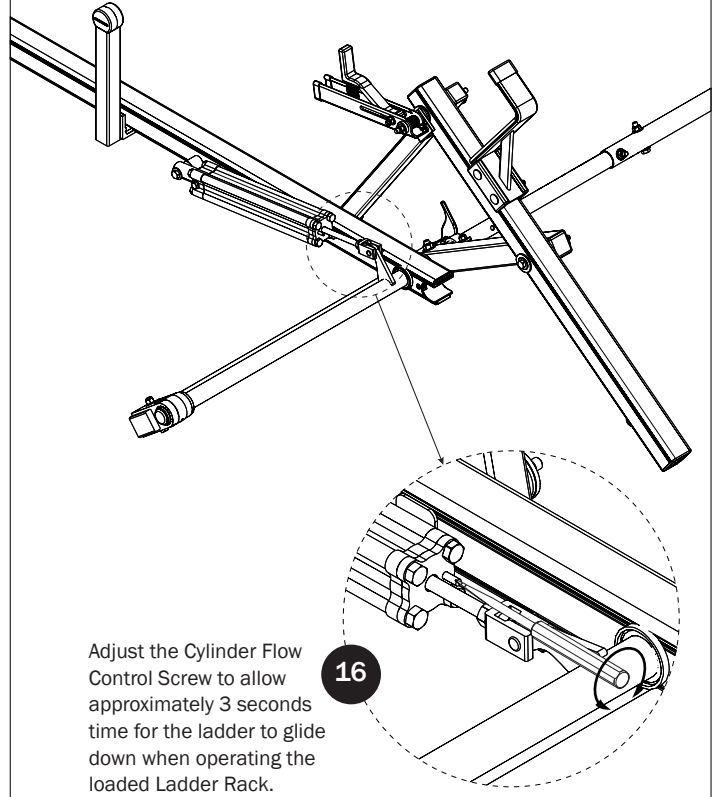

DRIVE SHAFT SEALING

