

PRIME DESIGN™

A Safe Fleet Brand

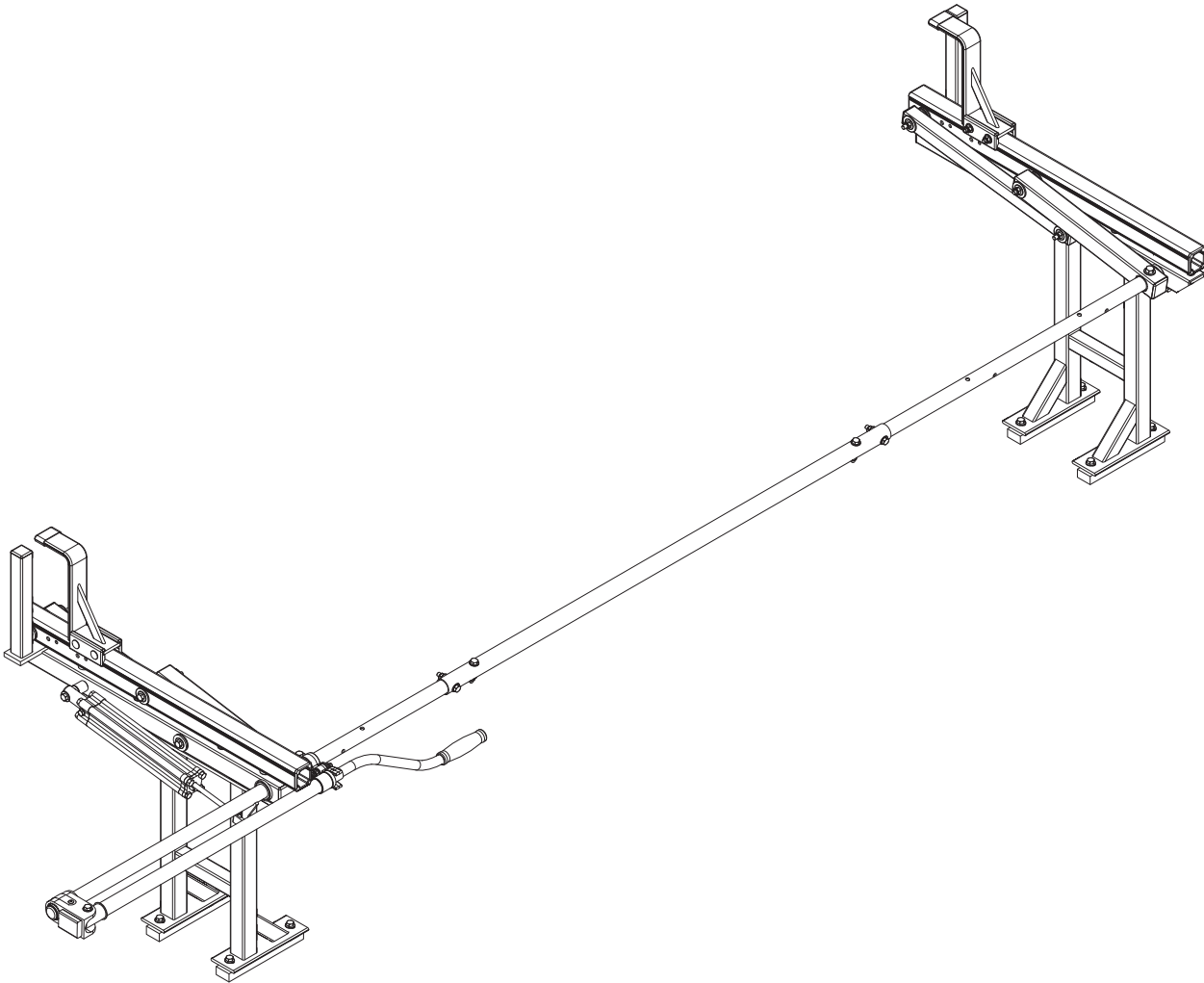

UXR 0004

PRIME DESIGN, A SAFE FLEET BRAND

Address: 580 Opperman Drive, Eagan, MN 55123 • Toll Free: 1.8.PRIME.RACK
Fax: 651-552-1799 • Email: info@primedesign.net • Website: www.primedesign.net

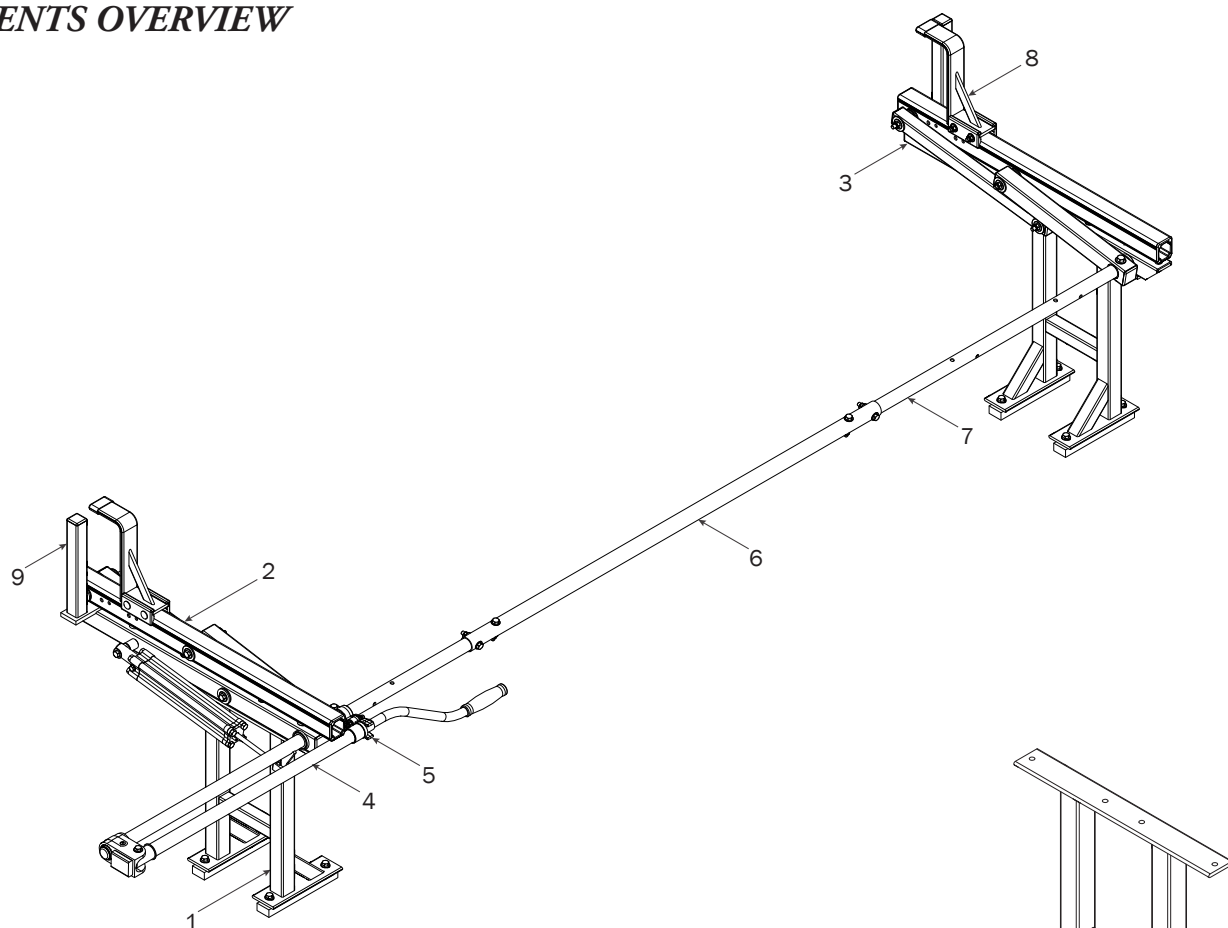

1—Utility Base Standing Mount..... (Qty 2)

2—Rear Rotation Assembly..... (Qty 1)

3—Front Rotation Assembly..... (Qty 1)

4—Rear Drive Shaft..... (Qty 1)
Right Hand, B4 Version, 46.00"

5—Handle Latch Assembly (Qty 1)
Right Hand

6—Connecting Bar..... (Qty 1)
48.00"

7—Front Drive Shaft (Qty 1)
B Version, 35.75"

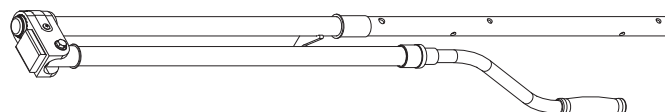
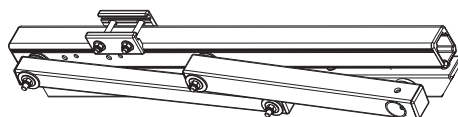
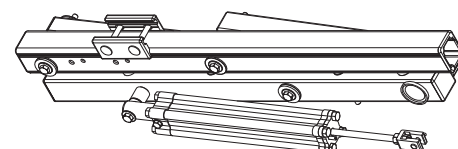
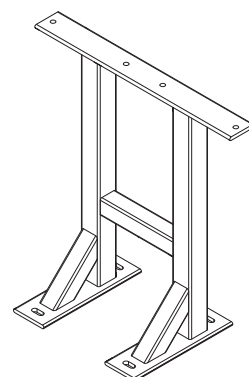

8—Z Post (Qty 2)
Adjustable, 7.25"

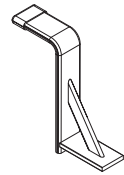

9—L Post (Qty 2)
9.25"

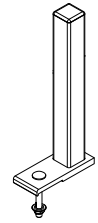

HKT-8162-Rotation Hardware Kit



Cotter Pin (1X)

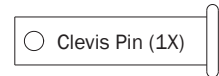

Clevis Pin (1X)

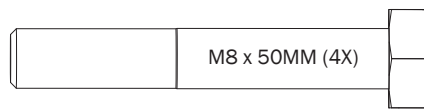

M8 x 50MM (4X)

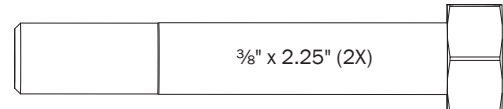

$\frac{3}{8}$ " x 2.25" (2X)



M8 Lock Nut (4X)



$\frac{3}{8}$ " Lock Nut (2X)

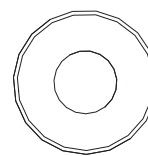

$\frac{5}{16}$ " Flat Washer (8X)

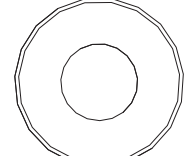

$\frac{3}{8}$ " Flat Washer (4X)

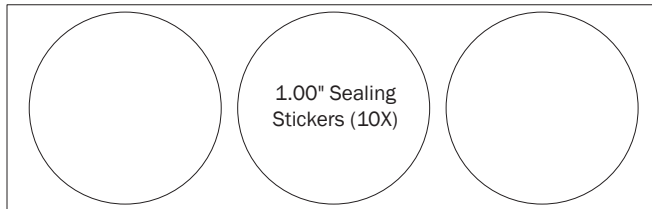

1.00" Sealing
Stickers (10X)



Anti-Seize (1X)

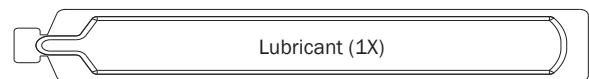

Lubricant (1X)

HKT-0125 Mounting Hardware Kit



M8 x 70MM (4X)

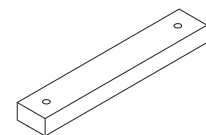

Utility Nut Plate (4X)

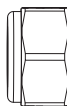

Lock Nut (4X)

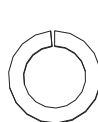

Lock Washer (12X)

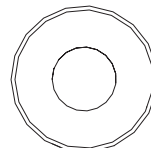

Flat Washer (16X)



M8 x 35MM (8X)



Anti-Seize (1X)

UTB MOUNTING BRACKETS

BRACKET PRE-ASSEMBLY

- 0.1** 5.00–8.00 Ft Crossbar Spacing Configurations: Drill holes into the Service Body mounting location according to dimensions shown.

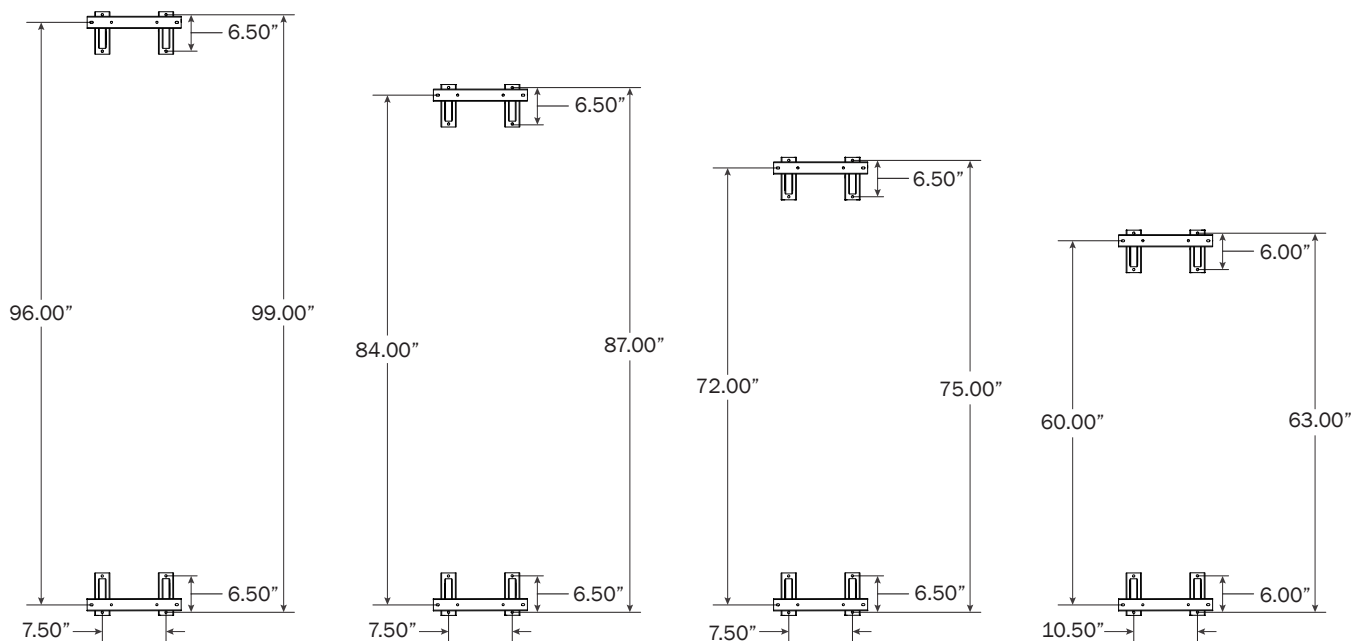

- 0.2** Apply Anti-Seize compound to Mounting Bracket bolts. The shorter Bolt Assemblies are on the outside as shown.

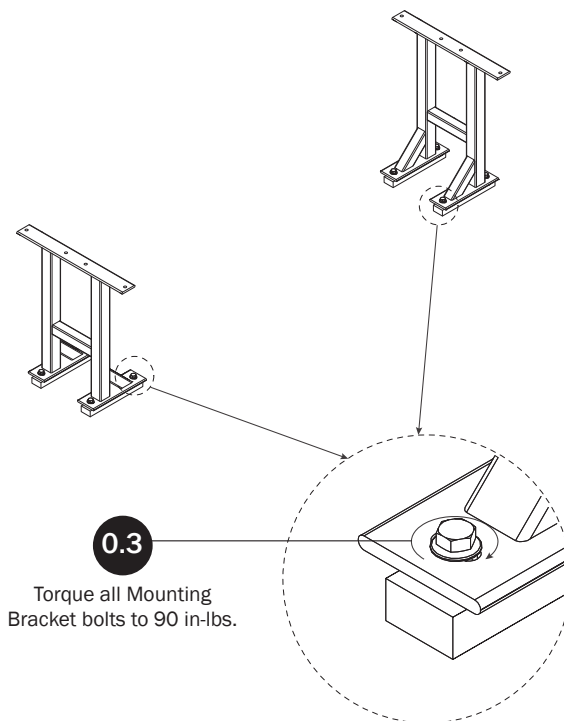
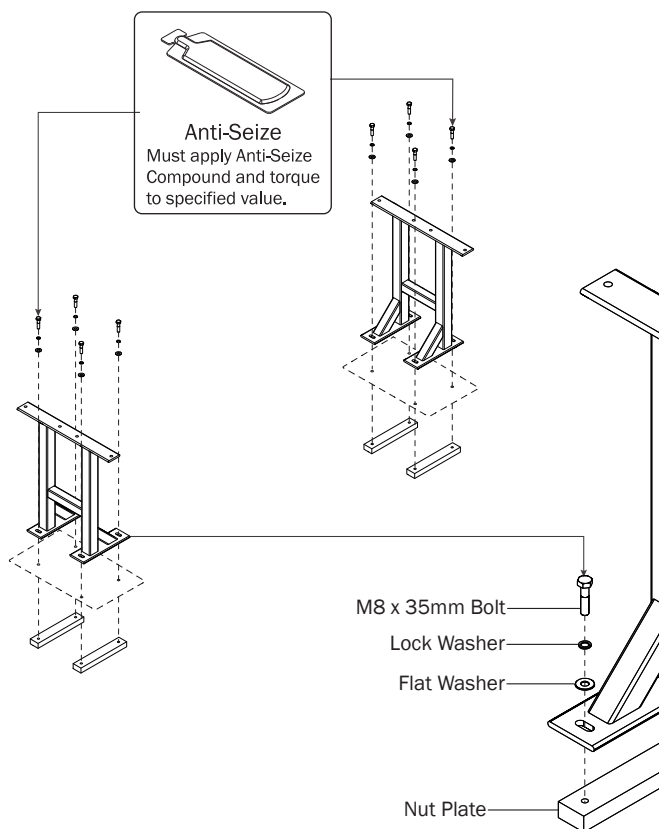

RIGHT ROTATION ASSEMBLY SEQUENCE

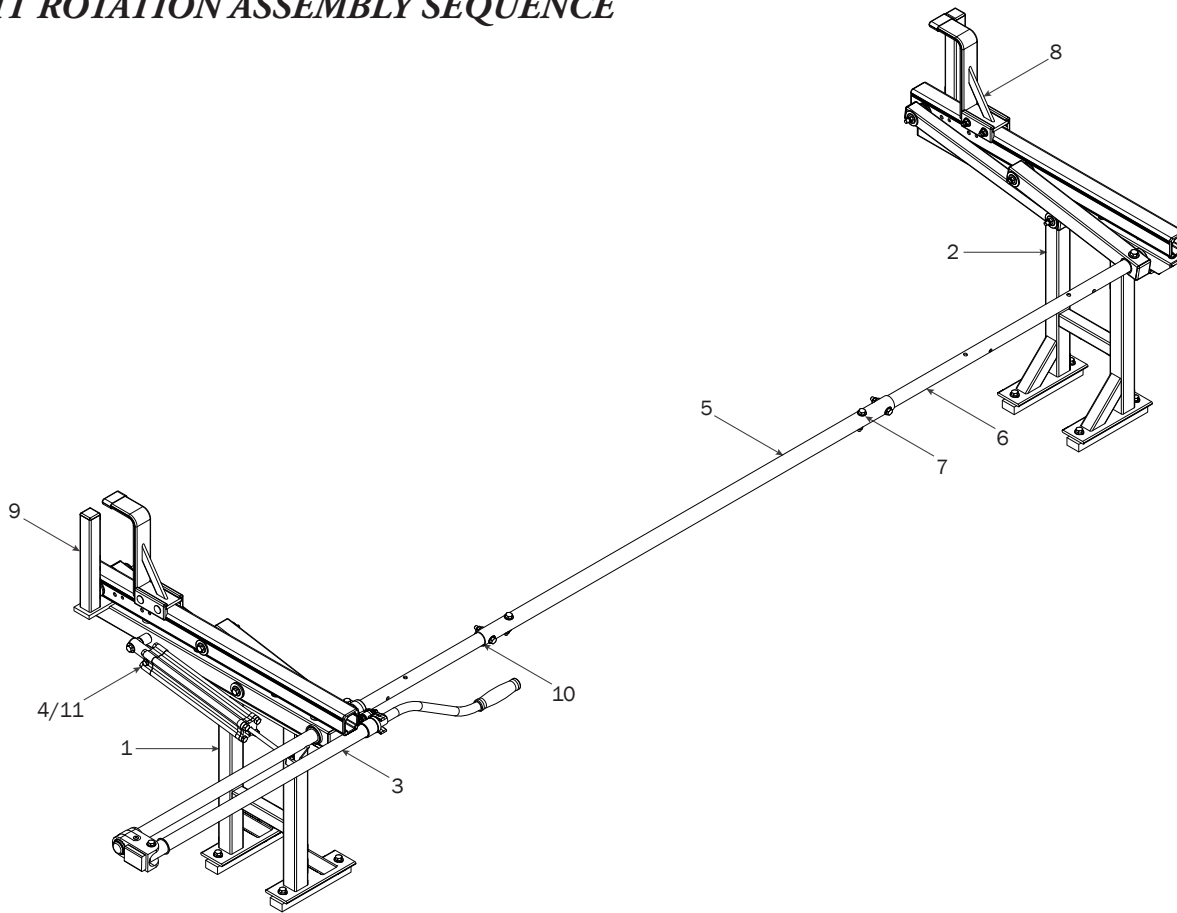

REAR ROTATION ASSEMBLY

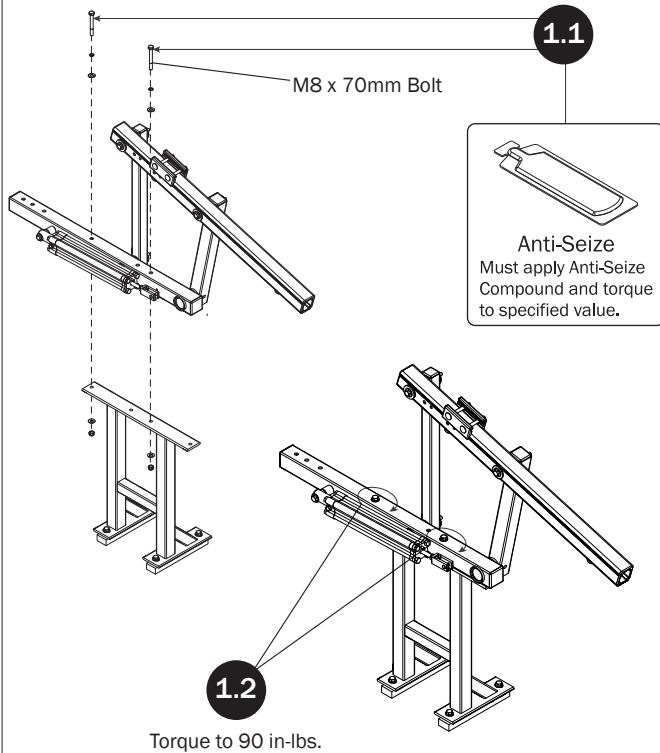

FRONT ROTATION ASSEMBLY

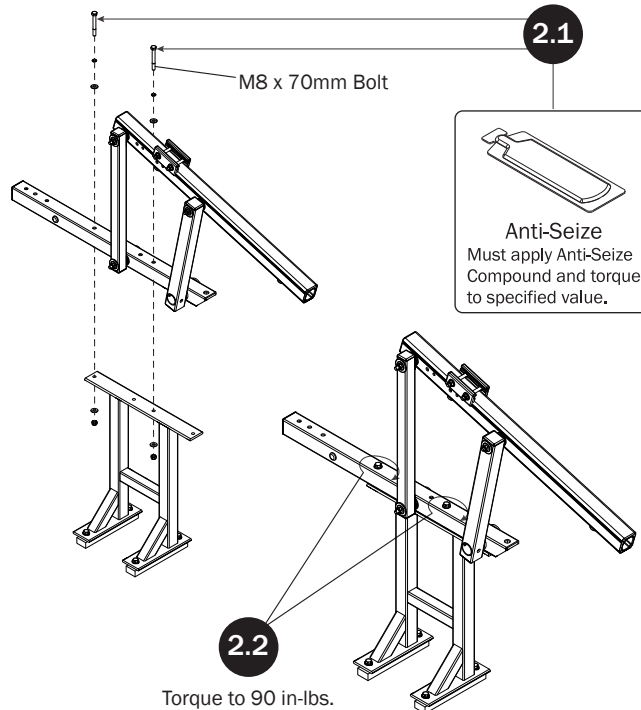

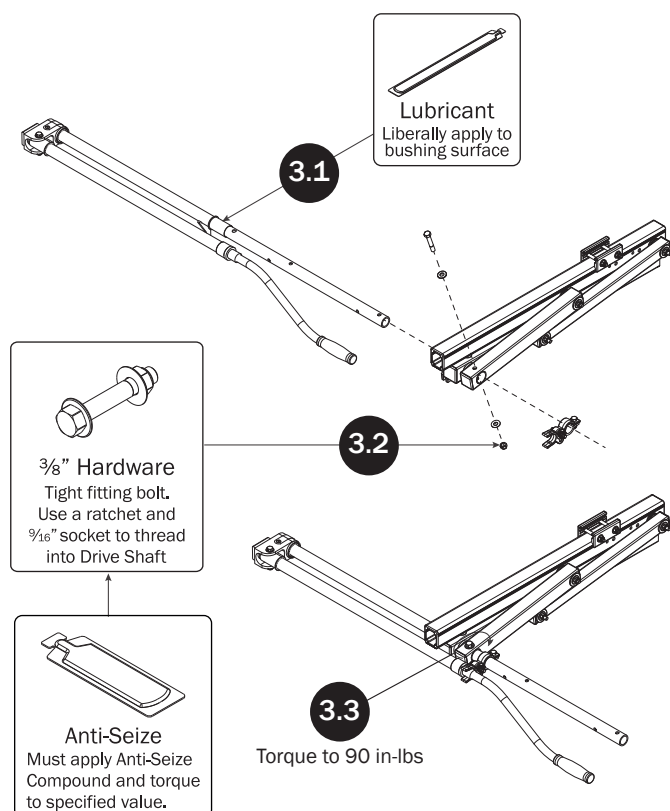
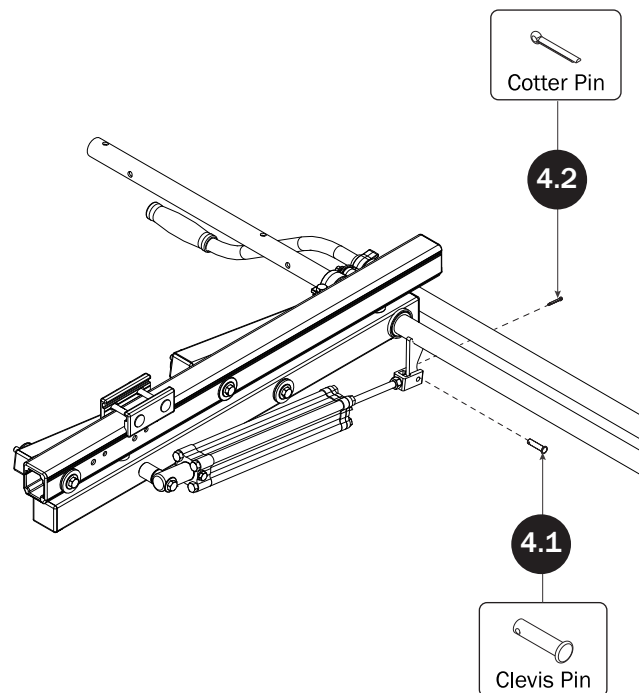
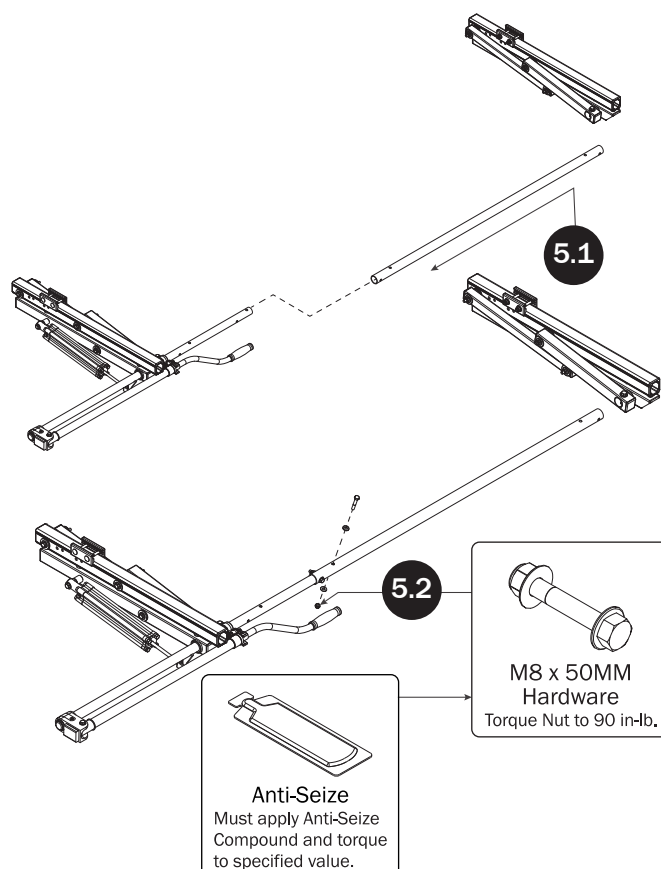
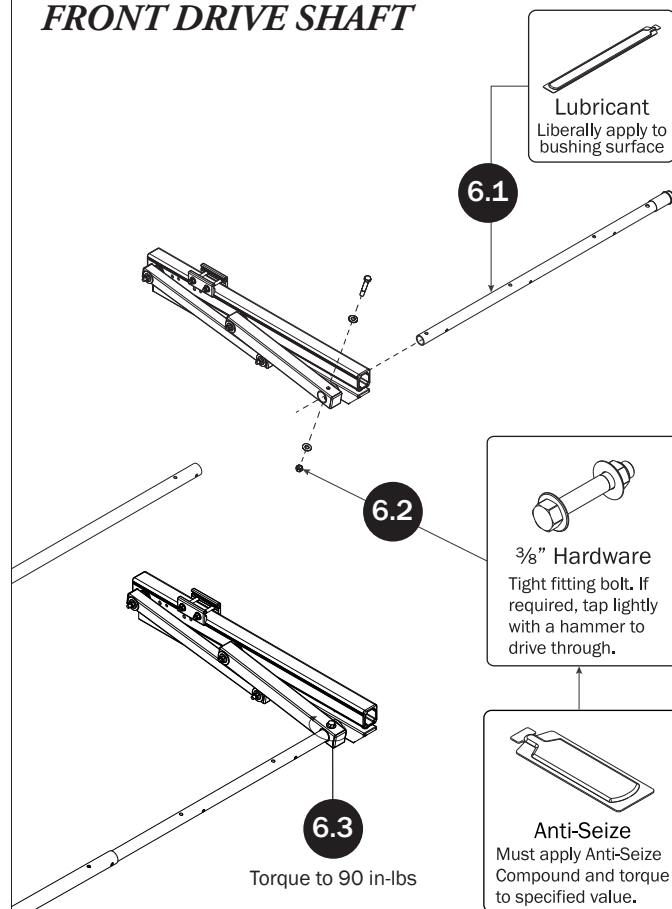
REAR DRIVE SHAFT**CYLINDER HARDWARE****CONNECTING BAR****FRONT DRIVE SHAFT**

CONNECTING BAR FASTENERS

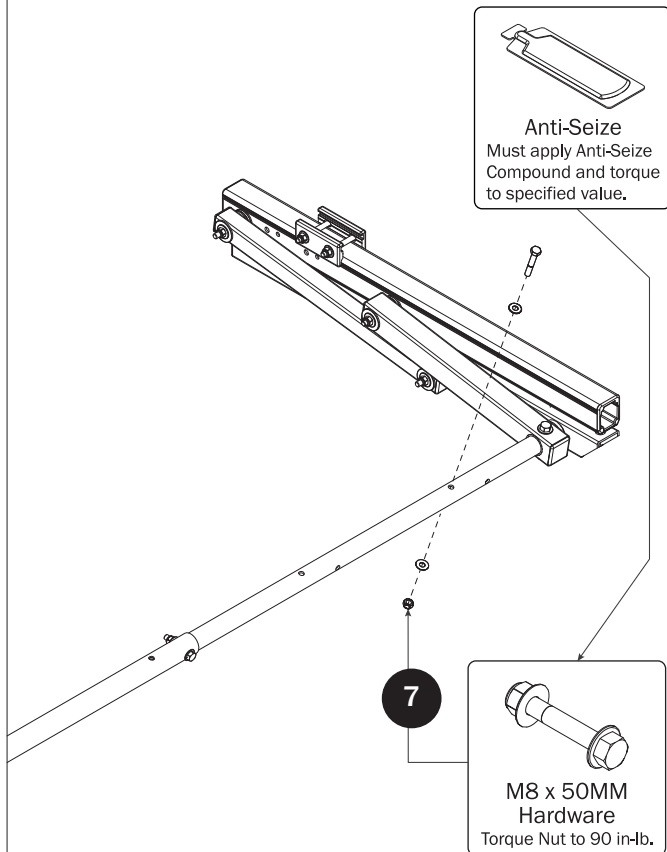

L POSTS

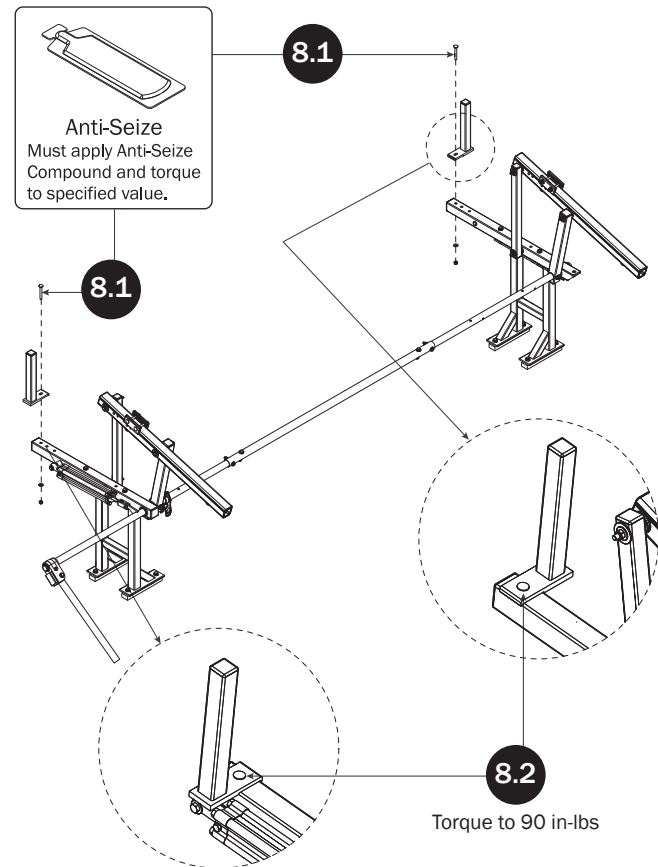

Z POSTS

SEE QUICK START GUIDE FOR ADJUSTMENTS

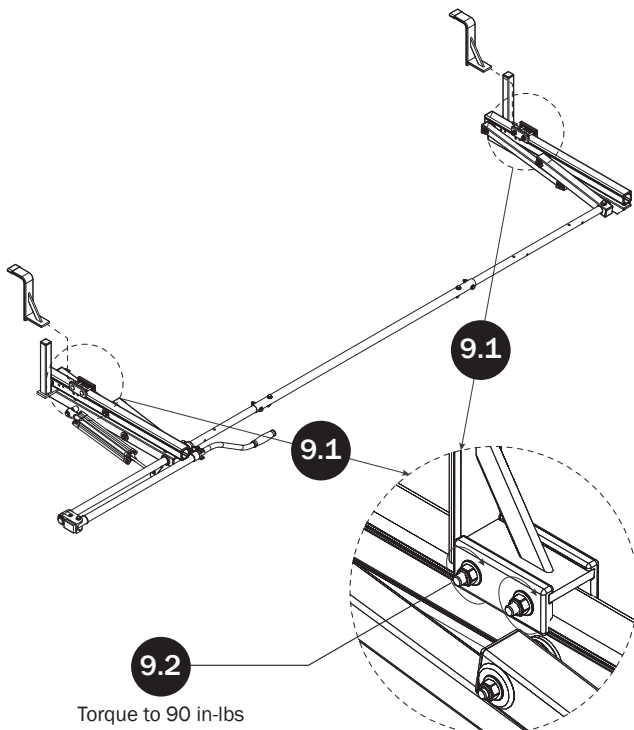

DRIVE SHAFT SEALING

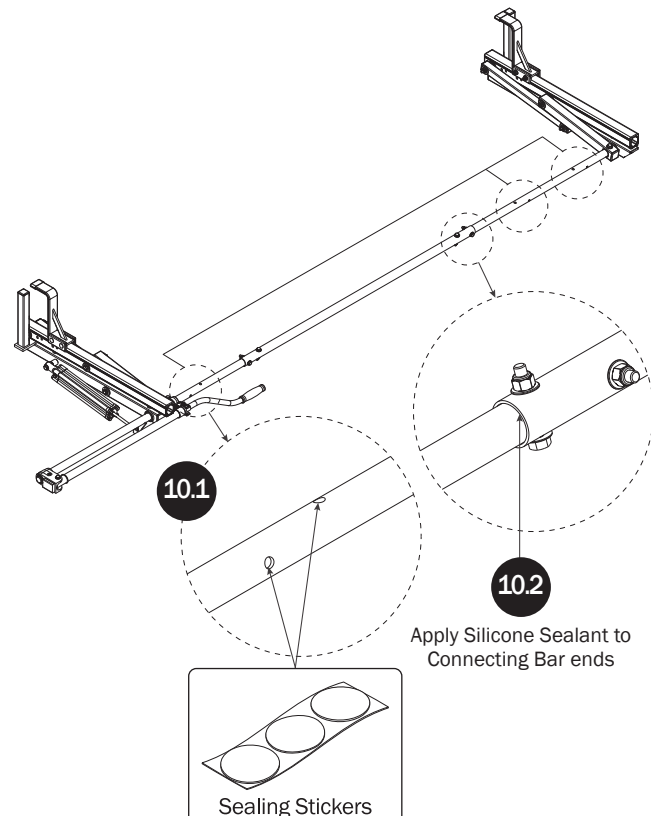

CYLINDER ADJUSTMENT

