

PRIME DESIGN™

A Safe Fleet Brand

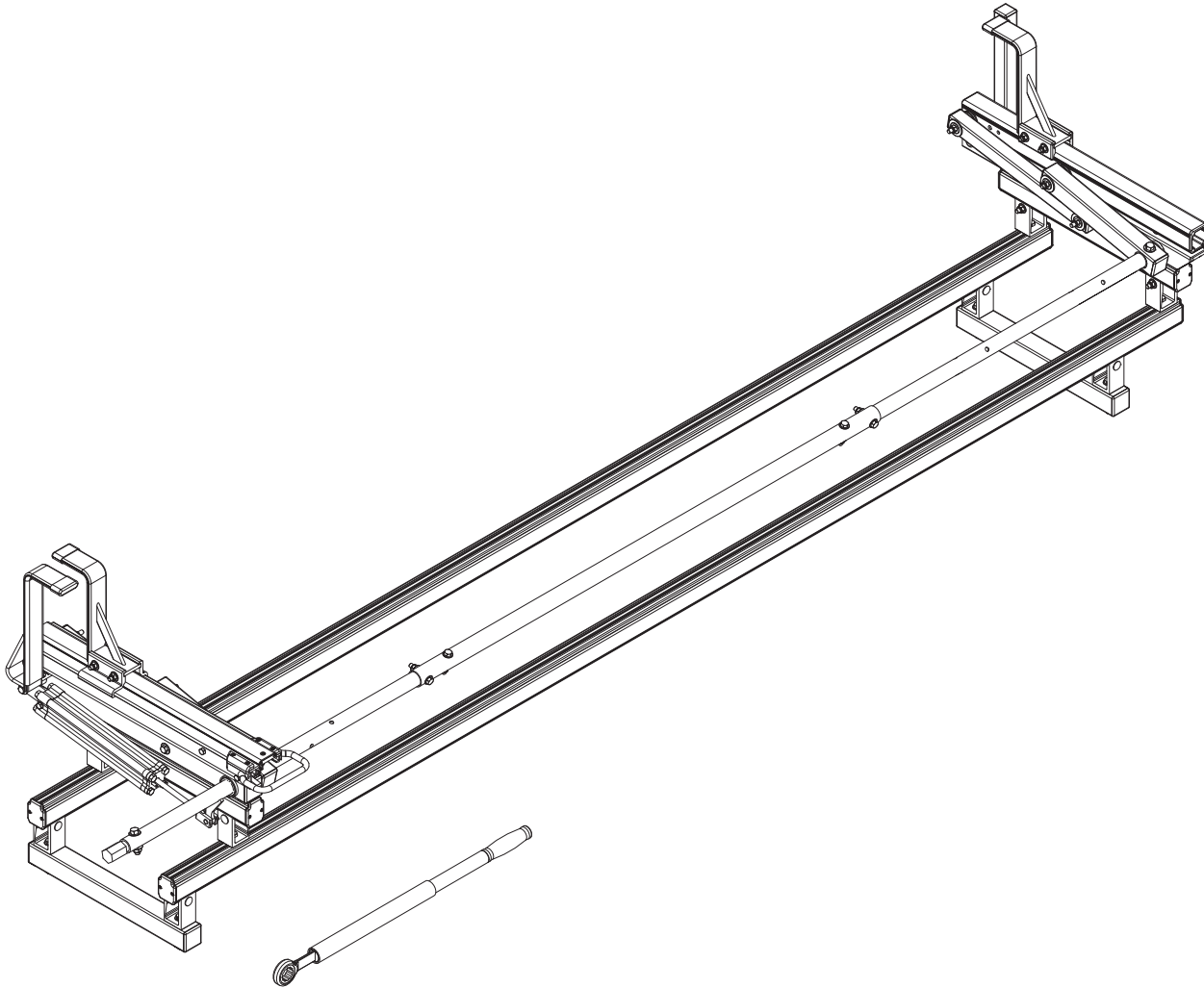

UXR 0009

PRIME DESIGN, A SAFE FLEET BRAND

Address: 580 Opperman Drive, Eagan, MN 55123 • Toll Free: 1.8.PRIME.RACK

Fax: 651-552-1799 • Email: info@primedesign.net • Website: www.primedesign.net

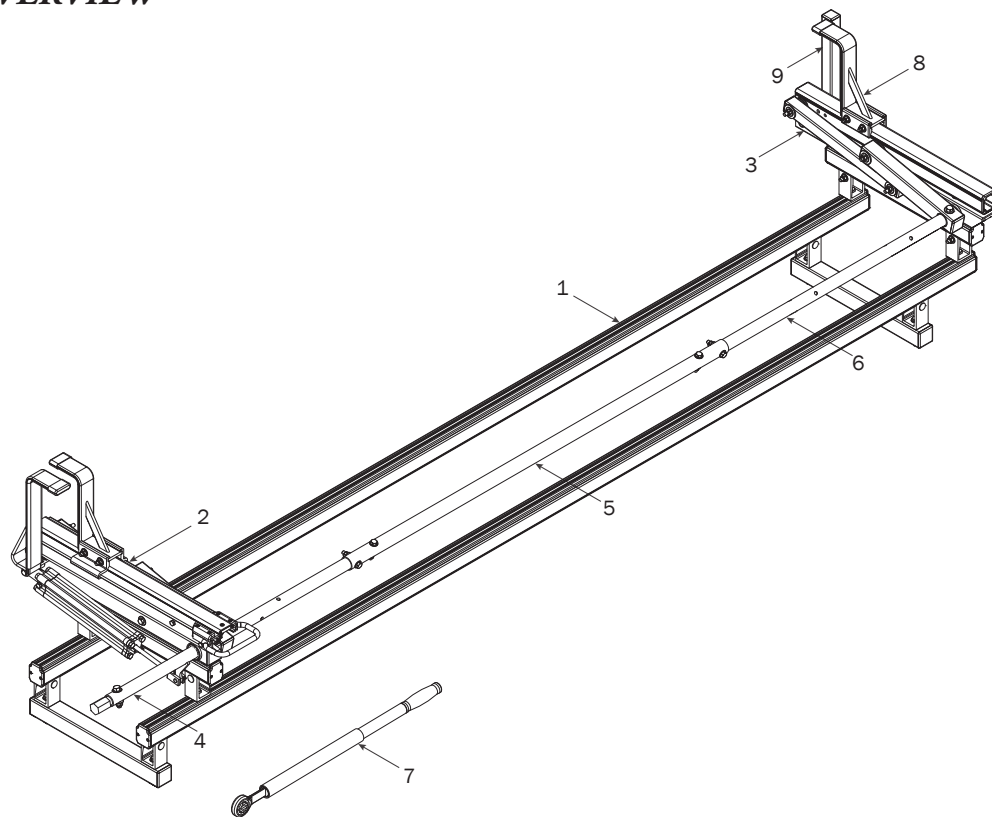

1—FBM-0073 (Qty 1)
104.00", Suspension Bar Frame, with Hardware



104".00 Suspension Bar (2X)

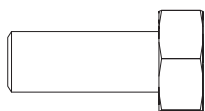

M8 x 20MM (4X)



U-Bracket (8X)

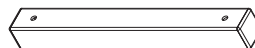

16.00" Mounting Base (2X)



18.00" Suspension Bar (2X)

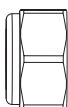

Lock Nut (12X)

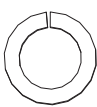

Lock Washer (8X)

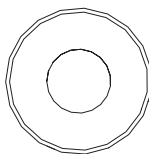

Flat Washer (20X)



M8 x 70MM (4X)



Neoprene Washer
(4X)

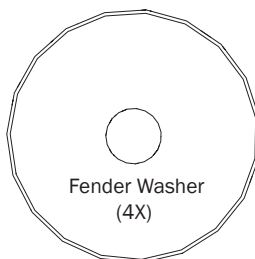

Fender Washer
(4X)

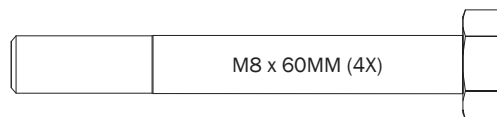

M8 x 60MM (4X)

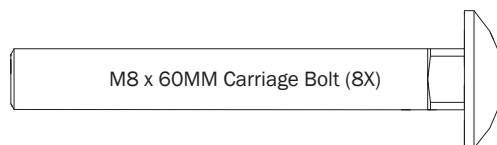

M8 x 60MM Carriage Bolt (8X)

2—Rear Rotation Assembly..... (Qty 1)

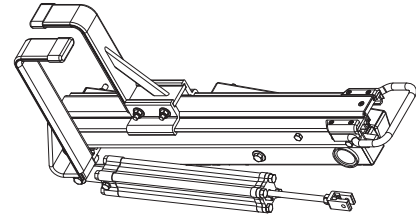

3—Front Rotation Assembly..... (Qty 1)

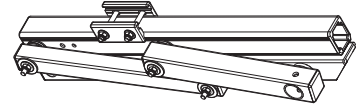

4—Rear Drive Shaft..... (Qty 1)
Right Hand, B4 Version, 50.00"



5—Connecting Bar..... (Qty 1)
48.00"



6—Front Drive Shaft..... (Qty 1)
B Version, 35.75"



7—Ratcheting Handle Assembly (Qty 1)
With Hardware

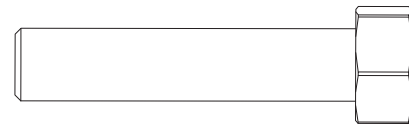
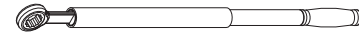
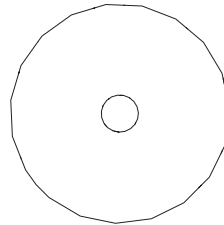
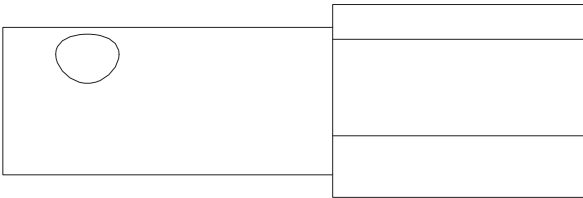

8—Z Post (Qty 1)
Adjustable, 7.25"

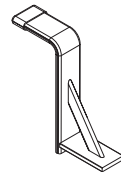

9—L Post (Qty 1)
9.25"

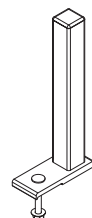

HKT-8163-Rotation Hardware Kit

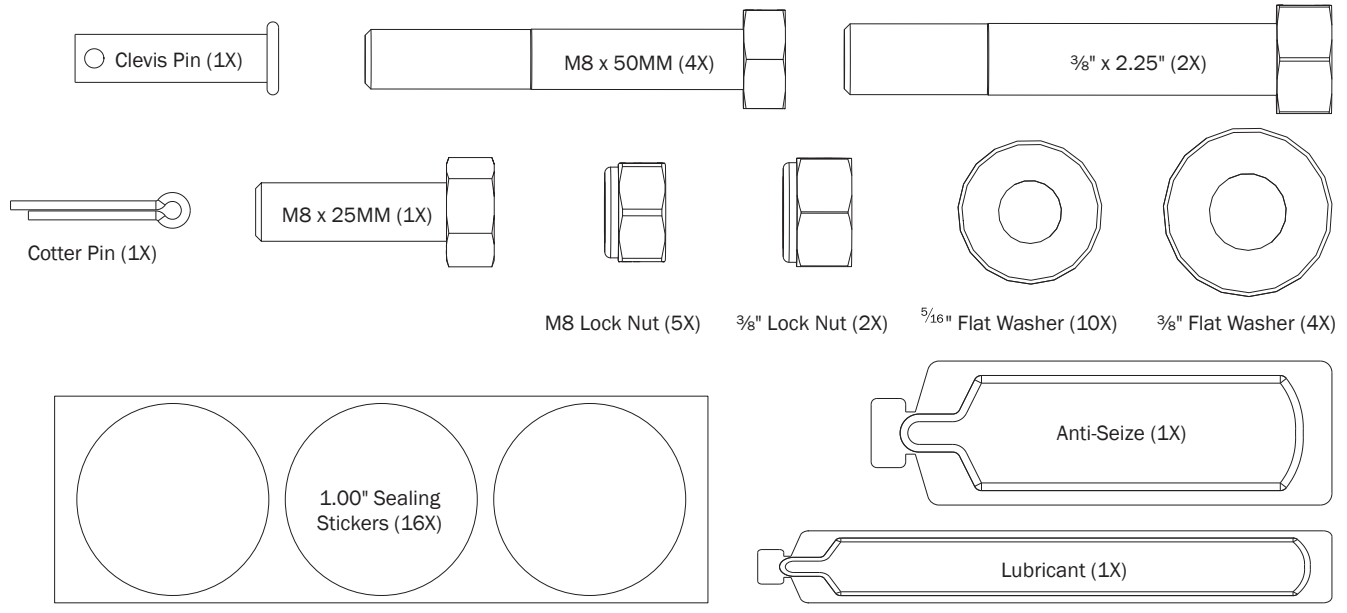

FBM-0073 MOUNTING

FBM PRE-ASSEMBLY

0.1

Drill holes into the Service Body mounting location according to dimensions shown for 8.00 ft rack configuration.

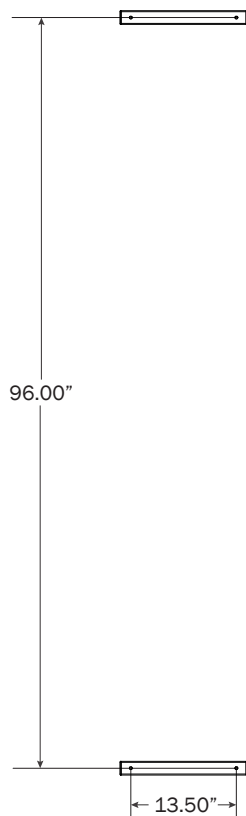

0.2

Dimensions shown below are for 5' (60.00"), 6' (72.00"), and 7' (84.00") spacing.

Dimensions are measured from center to center of top Mounting Rail.

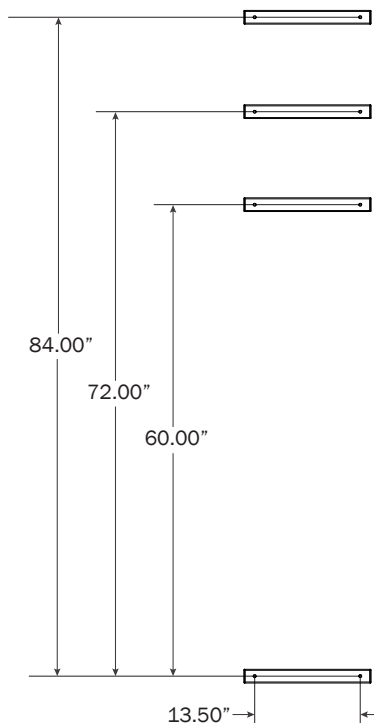

0.3

Install Mounting Base and four of the U-Brackets and torque bolts to 90 in-lbs.

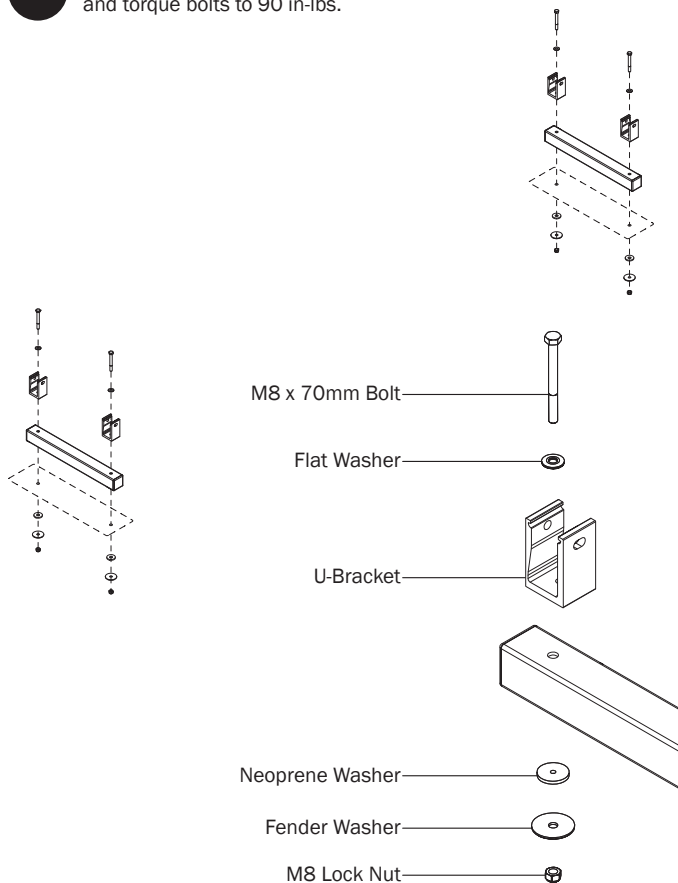

0.4

Install Carriage Bolt Assembly onto mounted U-Brackets. Do not tighten until Step 0.5.

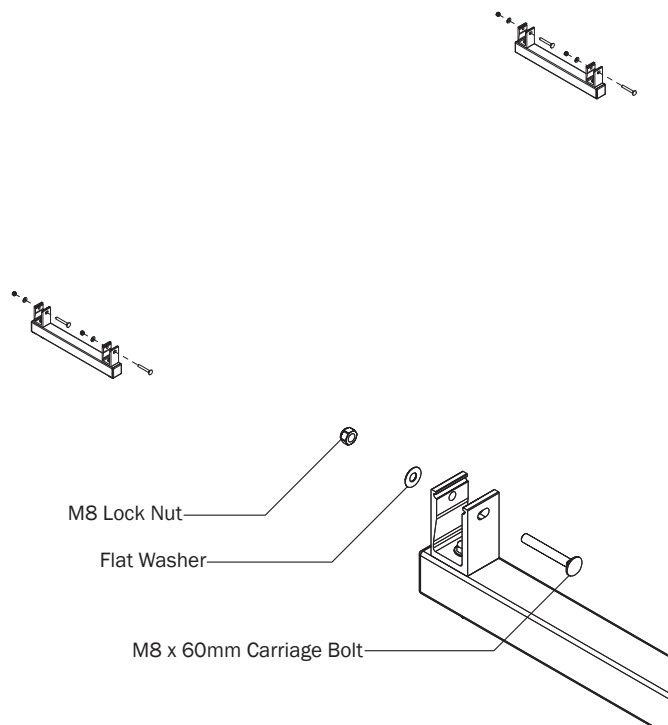

0.5

Place 104.00" Suspension Bars onto mounted U-Brackets. Finger-tighten U-Bracket nuts to hold Suspension Bars into place, but do not torque until Step 0.9

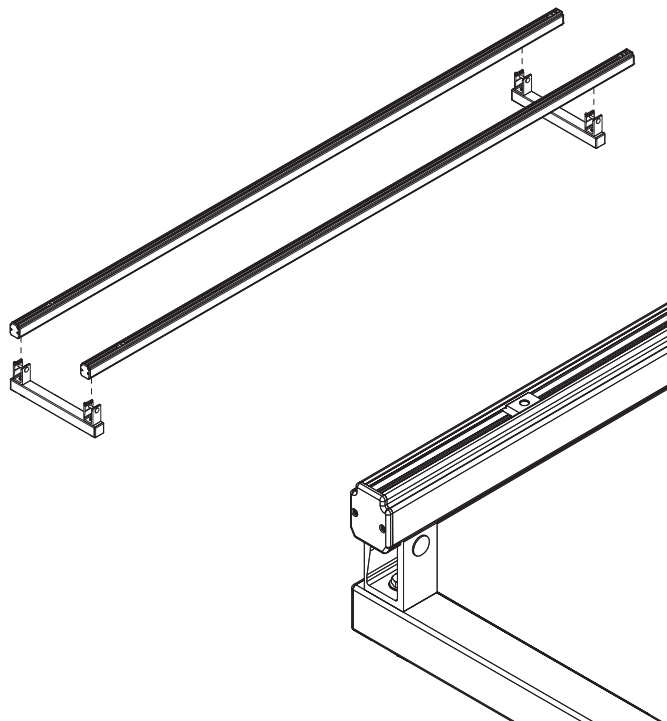

0.6

Install remaining U-Brackets and torque bolts to 90 in-lbs.

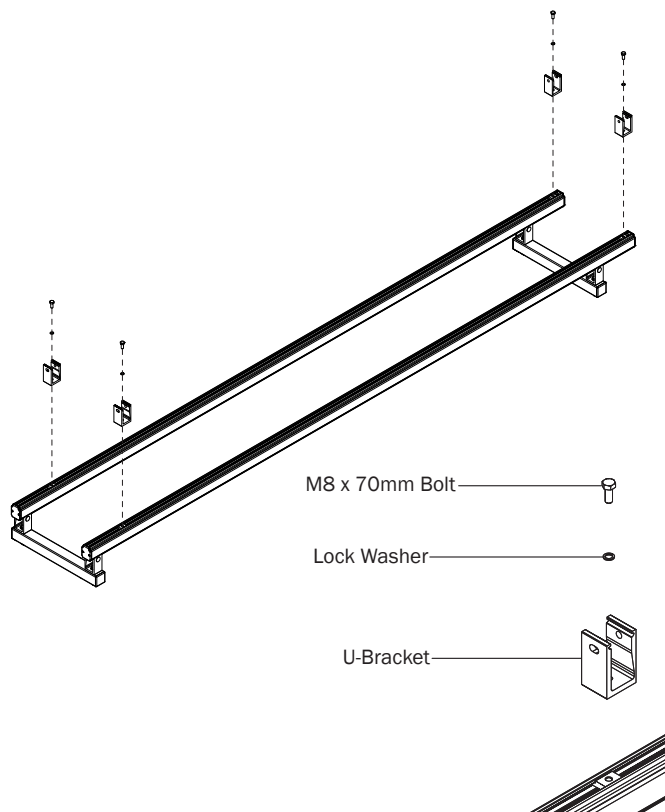

0.7

Install Carriage Bolt Assembly onto mounted U-Brackets. Do not tighten until Step 0.8.

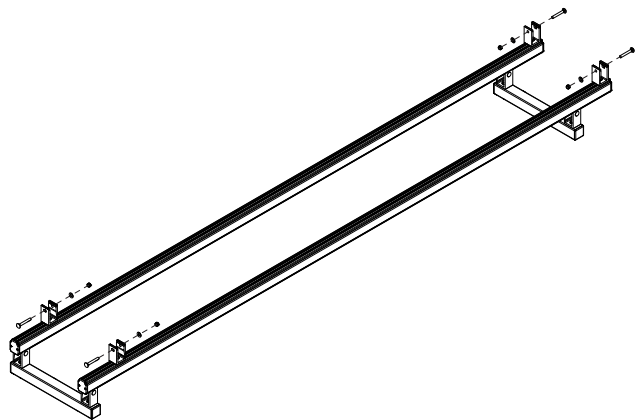

0.8

Place 18.00" Suspension Bars onto mounted U-Brackets. Finger-tighten U-Bracket nuts to hold Suspension Bars into place, but do not torque until Step 0.9

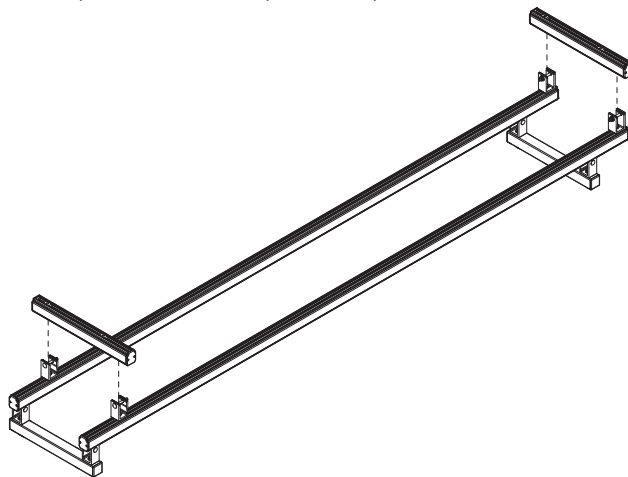

0.9

Position all Brackets on Suspension Bars as shown below for 8.00' (96.00") Crossbar Spacing. For 5' (60.00"), 6' (72.00"), and 7' (84.00") spacings, use those dimensions.

Tighten all U-Bracket nuts to 90 in-lbs.

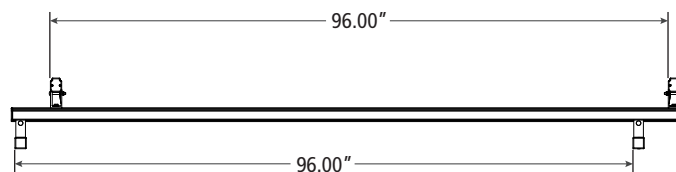

RIGHT ROTATION ASSEMBLY SEQUENCE

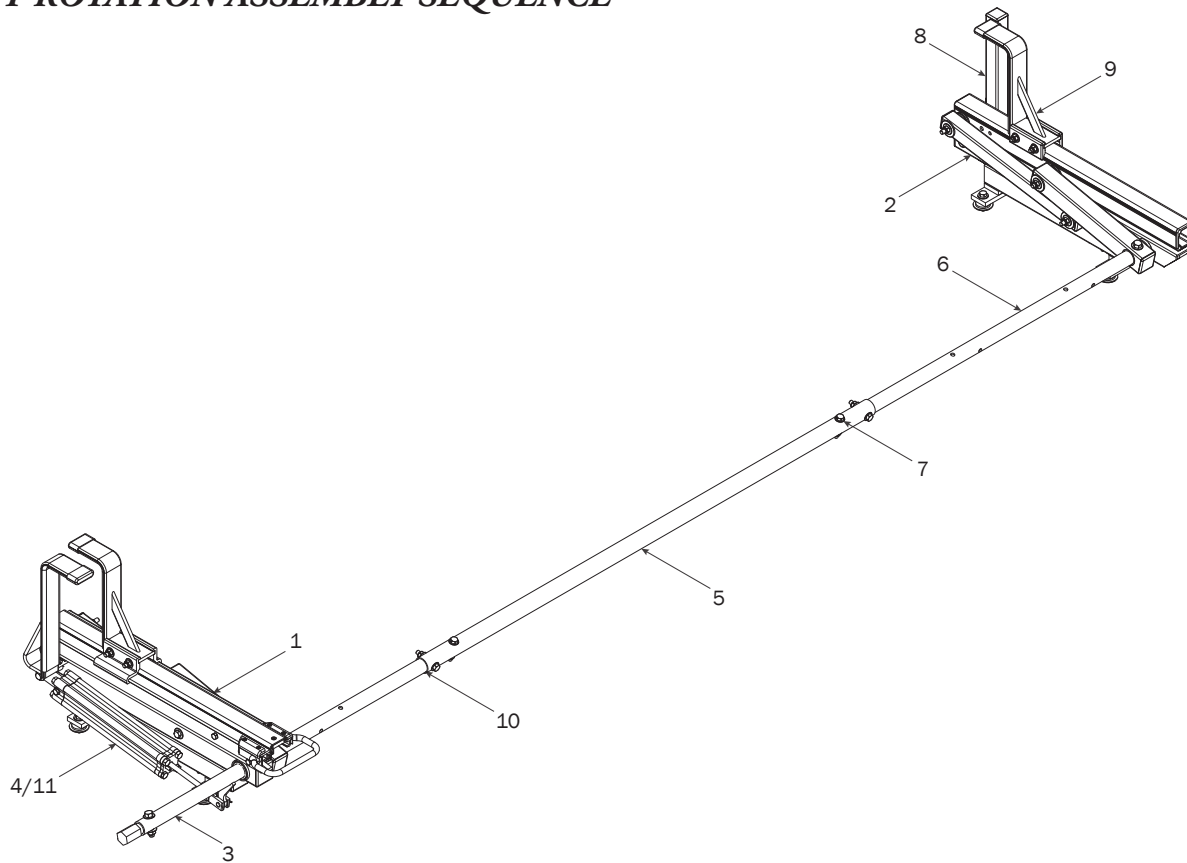

REAR ROTATION ASSEMBLY

- 1 Place Rear Crossbar onto FBM as shown and torque to 90 in-lbs.

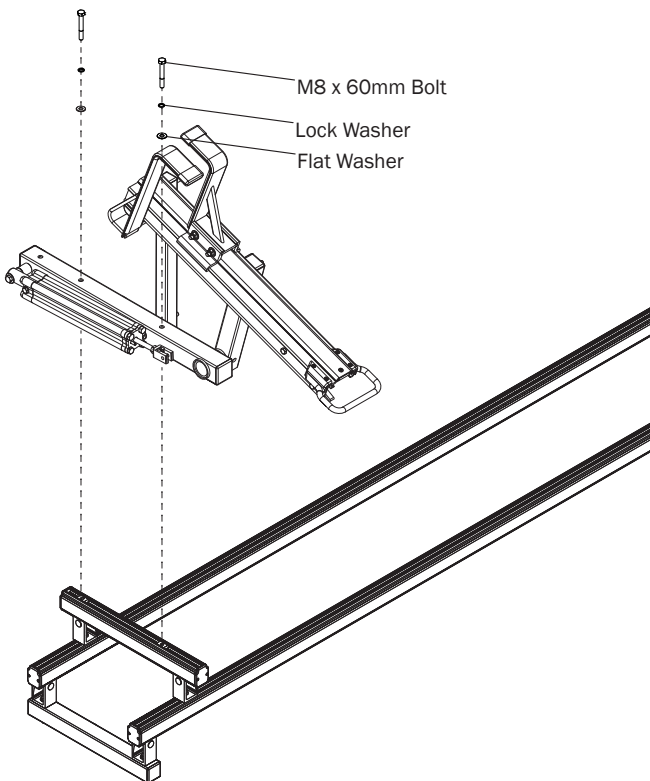

FRONT ROTATION ASSEMBLY

- 2 Place Front Crossbar onto FBM as shown and torque to 90 in-lbs.

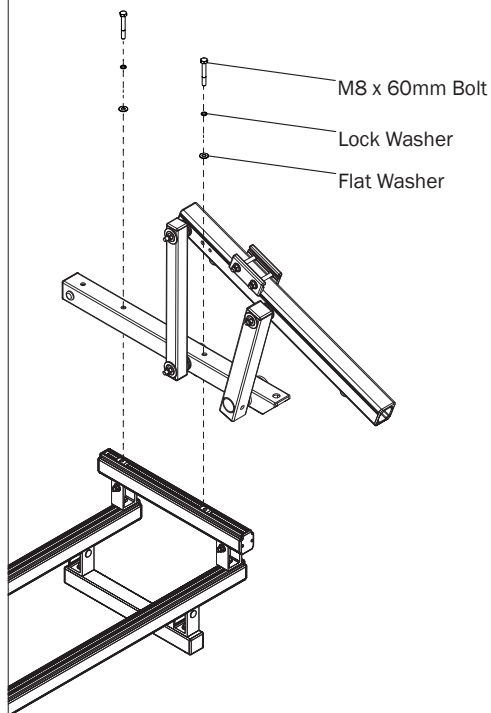

REAR DRIVE SHAFT

NOTE: For instructional clarity, the FBM Mounting System will not be shown for the remainder of this Assembly Manual.

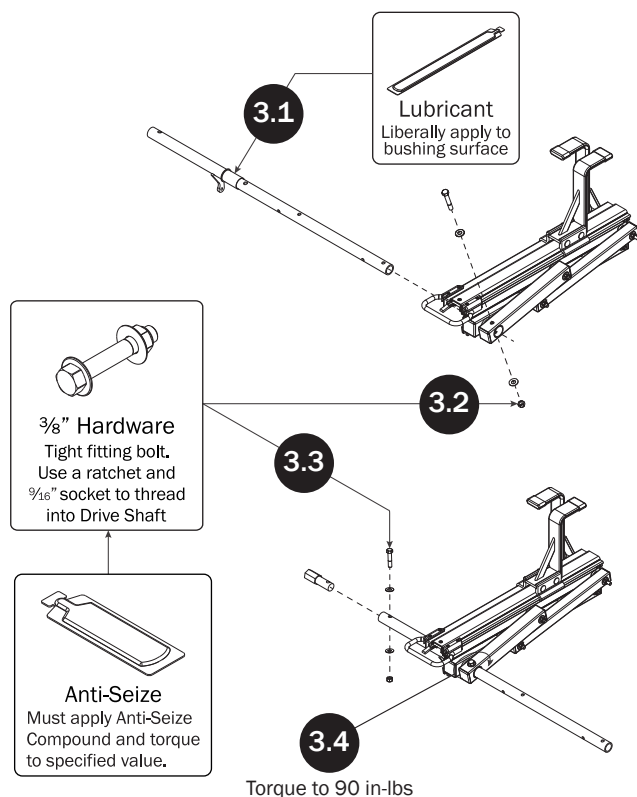
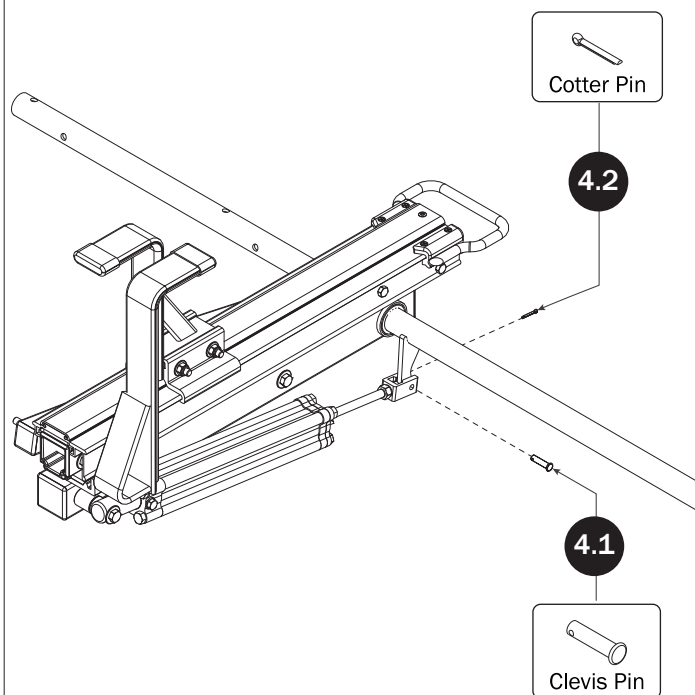
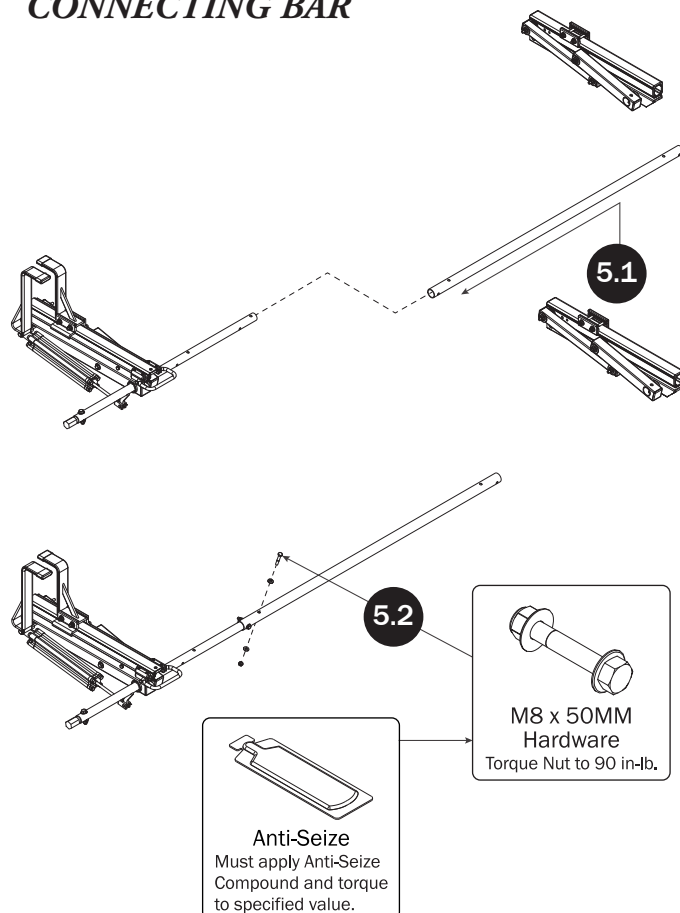
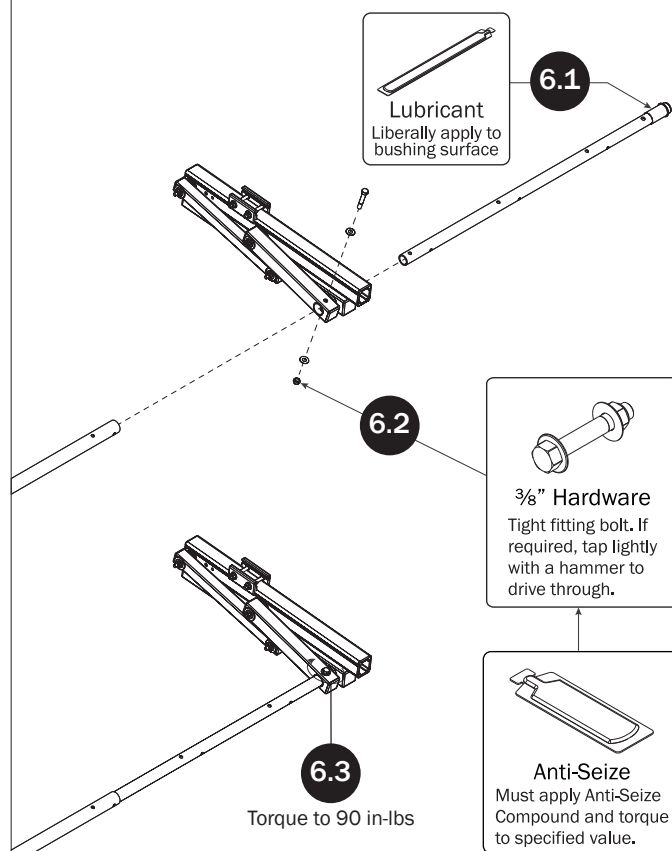
**CYLINDER HARDWARE****CONNECTING BAR****FRONT DRIVE SHAFT**

CONNECTING BAR FASTENERS

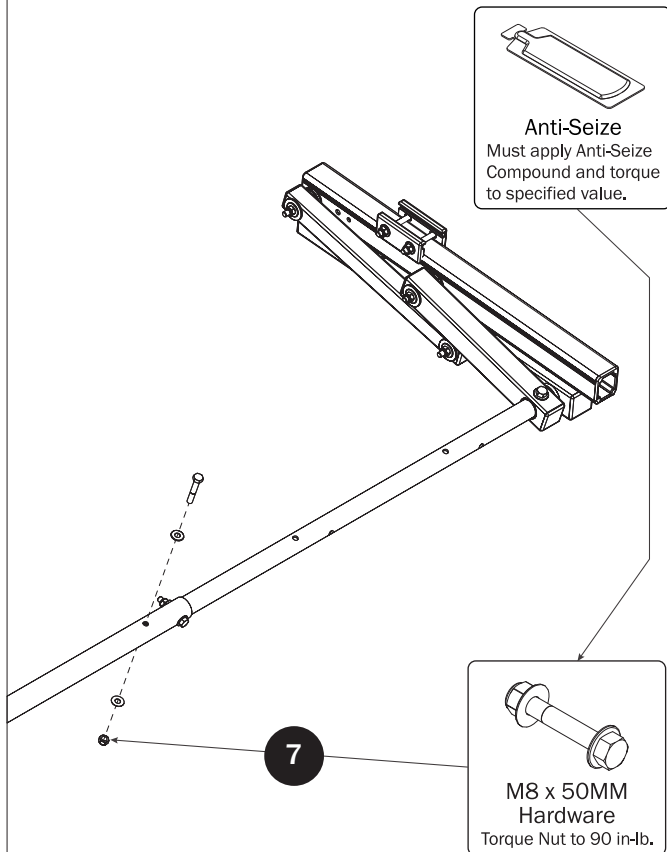

L POSTS

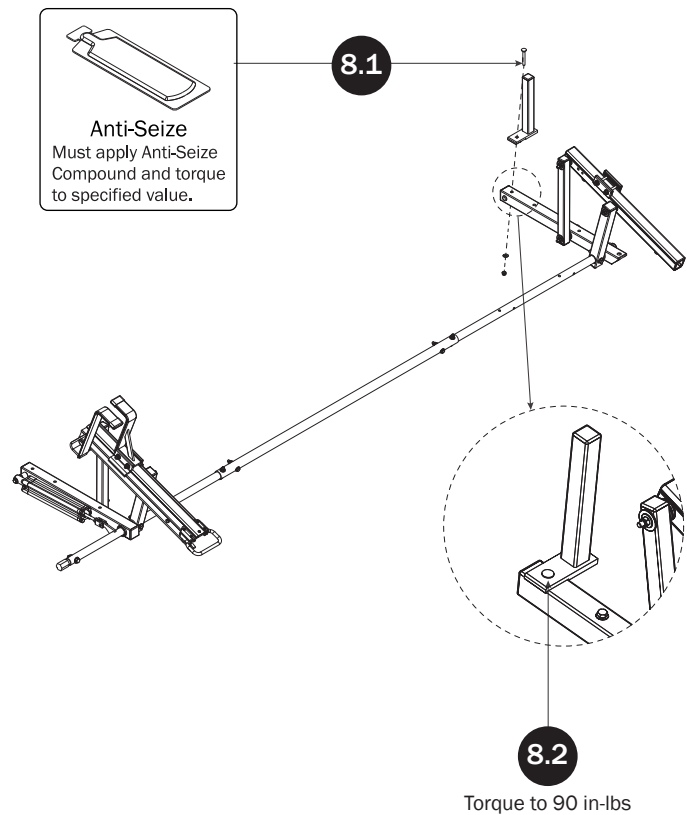

Z POSTS

SEE QUICK START GUIDE FOR ADJUSTMENTS

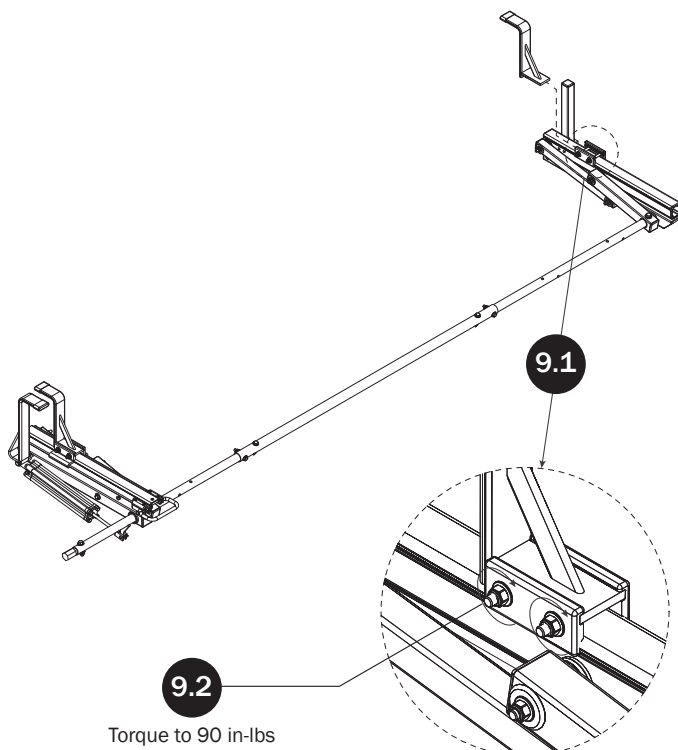

DRIVE SHAFT SEALING

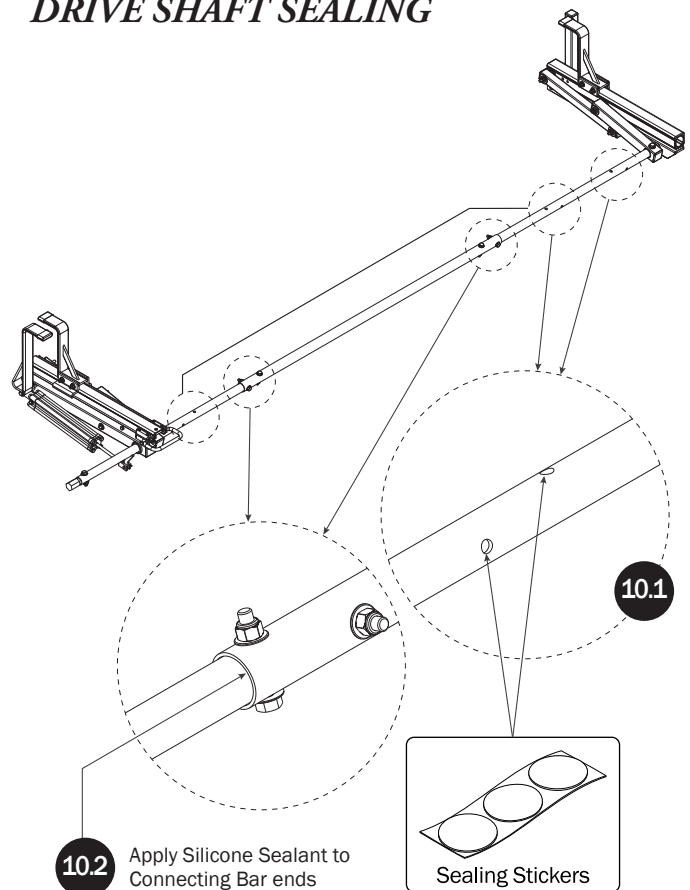

CYLINDER ADJUSTMENT

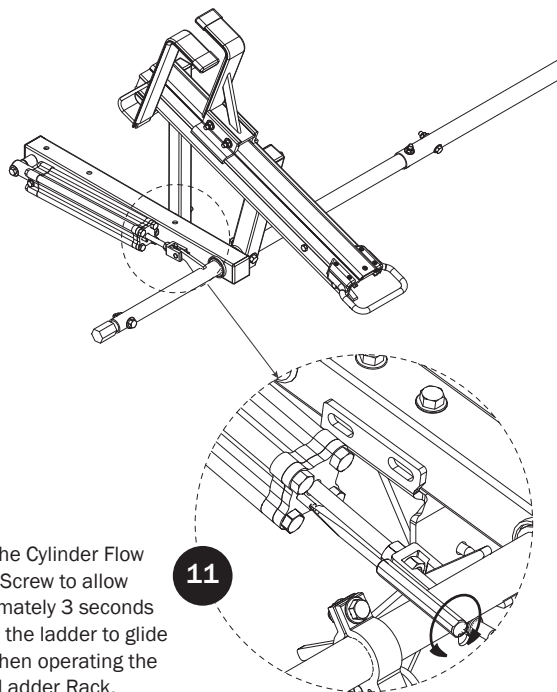

Adjust the Cylinder Flow Control Screw to allow approximately 3 seconds time for the ladder to glide down when operating the loaded Ladder Rack.

Page Intentionally Left Blank

