

PRIME DESIGN™

A Safe Fleet Brand

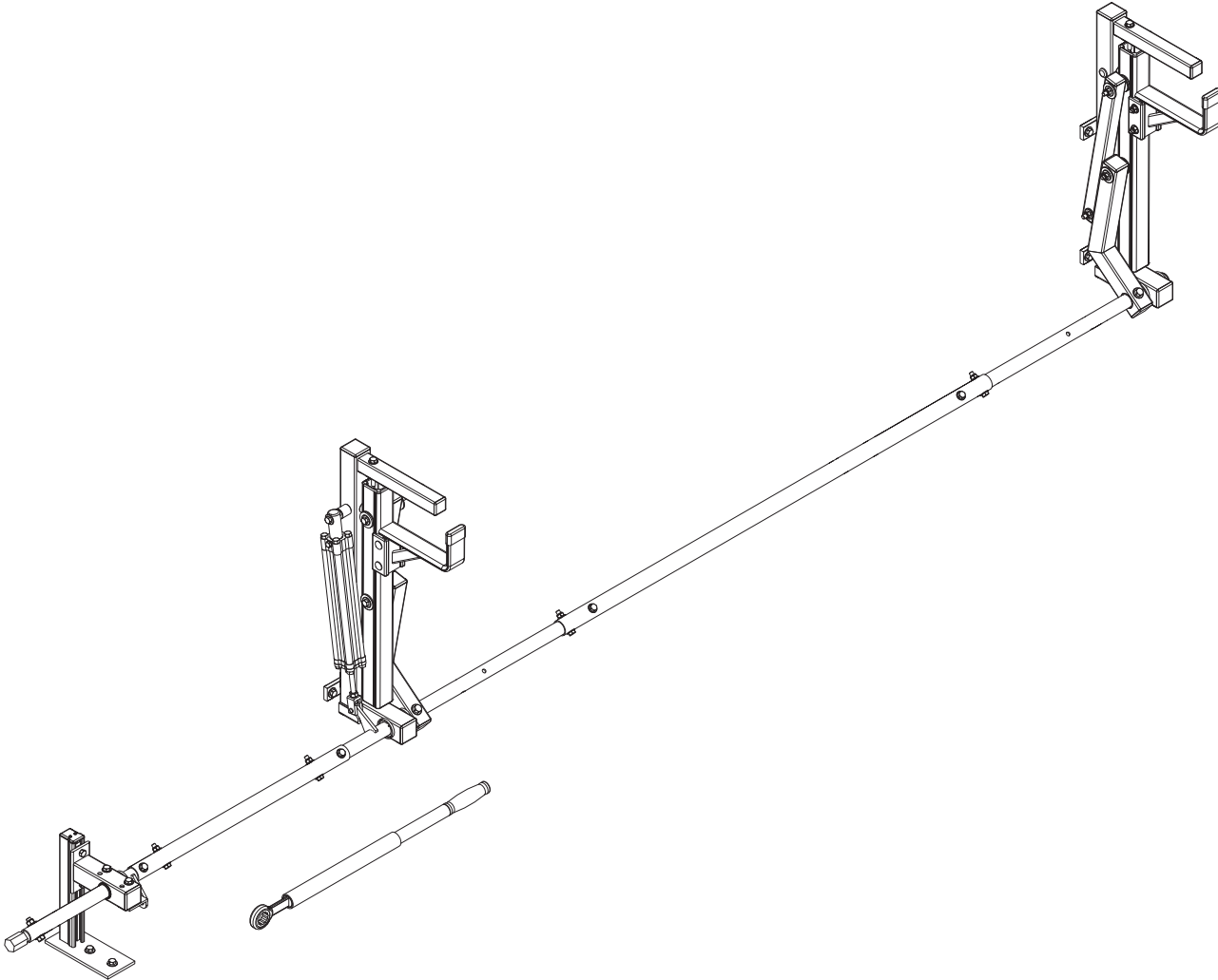

PRIME DESIGN, A SAFE FLEET BRAND

Address: 580 Opperman Drive, Eagan, MN 55123 • Toll Free: 1.8.PRIME.RACK

Fax: 651-552-1799 • Email: info@primedesign.net • Website: www.primedesign.net



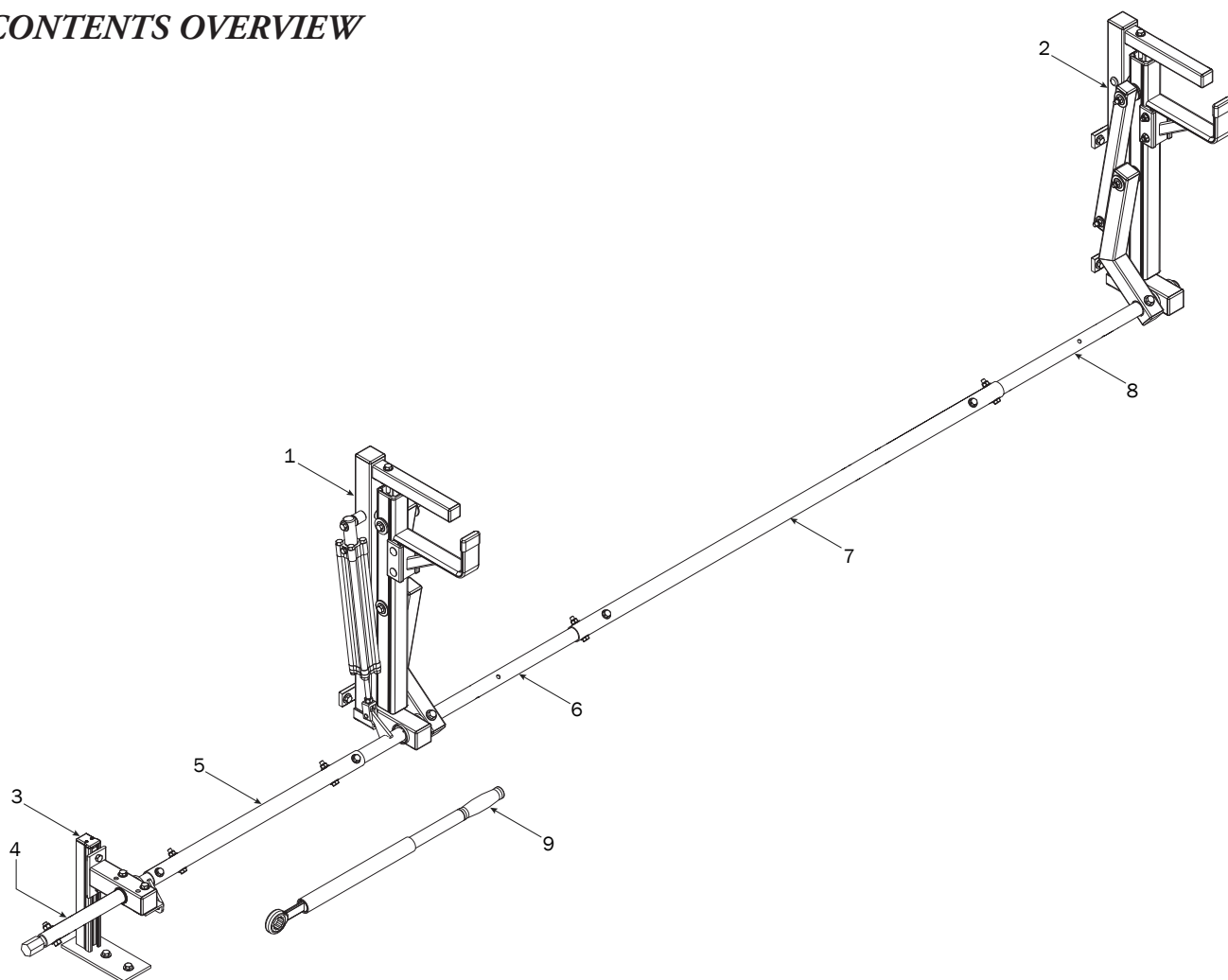

1—Rear Rotation Assembly..... (Qty 1)

2—Front Rotation Assembly..... (Qty 1)

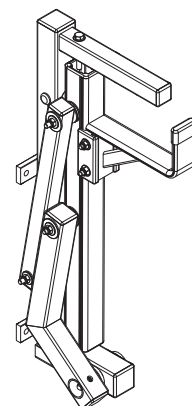
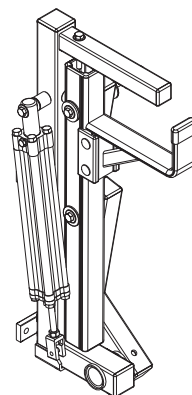

3—Vertical Drive Shaft Support..... (Qty 1)
Utility, Right Hand

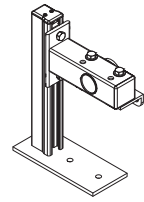

4—Drive Shaft Rear Extension..... (Qty 1)
Hex Drive

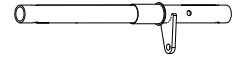

5—Connecting Bar..... (Qty 1)
24.00"

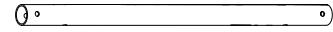

6—Drive Shaft..... (Qty 1)
Extended Rear, UV, Right hand

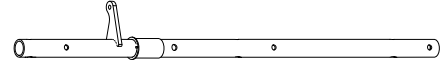

7—Connecting Bar..... (Qty 1)
48.00"

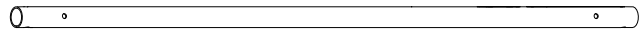

8—Front Drive Shaft..... (Qty 1)
B Version, 35.75"

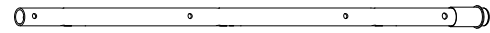

9—Ratcheting Handle Assembly (Qty 1)

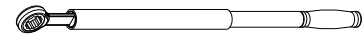

HKT-8119-Hardware Kit

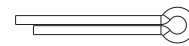

Cotter Pin (1X)



Clevis Pin (1X)

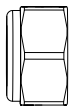

M8 Lock Nut (18X)

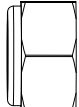

3/8" Lock Nut (3X)

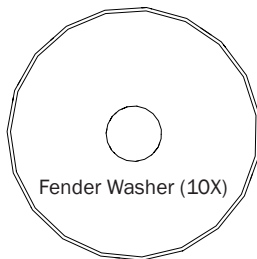

Fender Washer (10X)

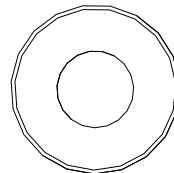

3/8" Flat Washer (6X)

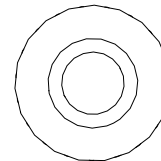

5/16" Seal Washer (10X)

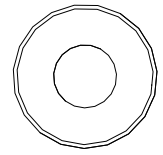

5/16" Flat Washer (16X)



M8 x 30MM (10X)

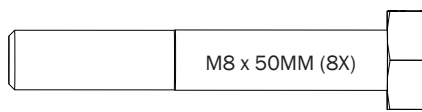

M8 x 50MM (8X)

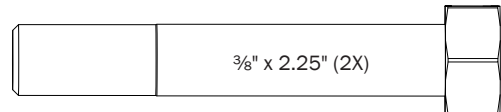

3/8" x 2.25" (2X)

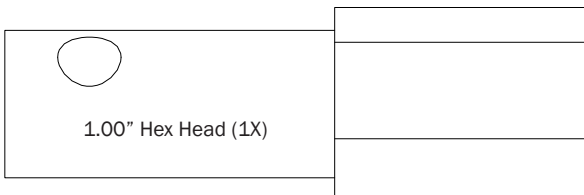

1.00" Hex Head (1X)

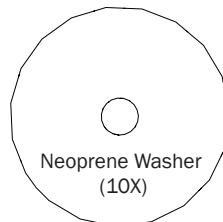

Neoprene Washer (10X)

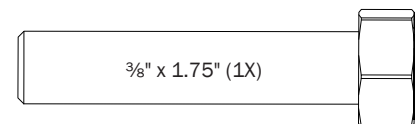

3/8" x 1.75" (1X)

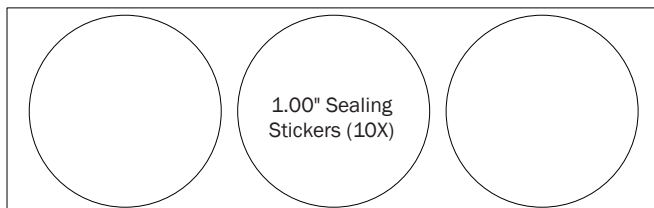

1.00" Sealing Stickers (10X)



Anti-Seize (1X)

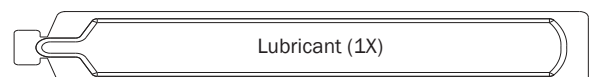

Lubricant (1X)

RIGHT ROTATION ASSEMBLY SEQUENCE

This vertical Utility Body ladder rack has been engineered to accommodate a variety of ladder lengths.

To configure this rack according to your carried ladder length, refer to the chart shown below for Steps 2 and 3.

Distance	Connect A to:	Connect C to:	Ladder Length:
1.52m (60")	B2	D1	20 Ft
1.83m (72")	B2	D2	24 Ft
2.13m (84")	B1	D2	28 Ft
2.43m (96")	B1	D3	32 Ft

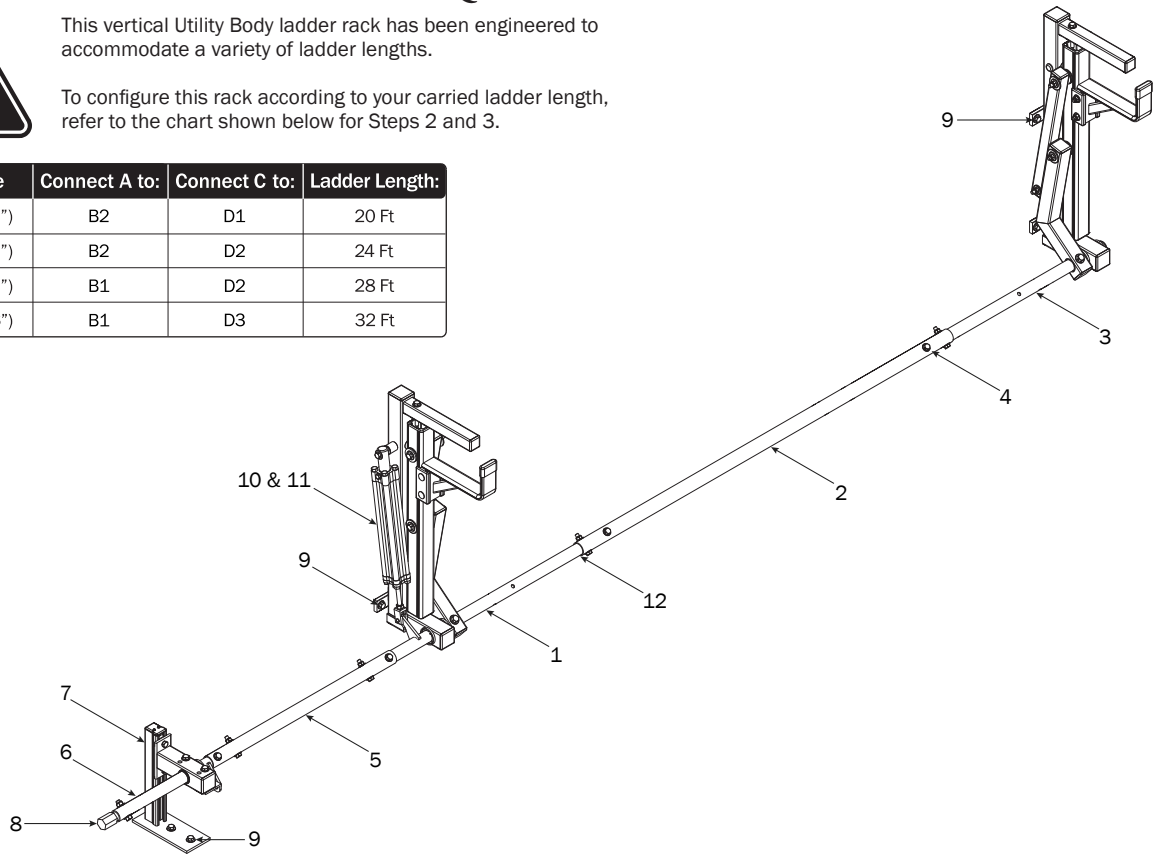
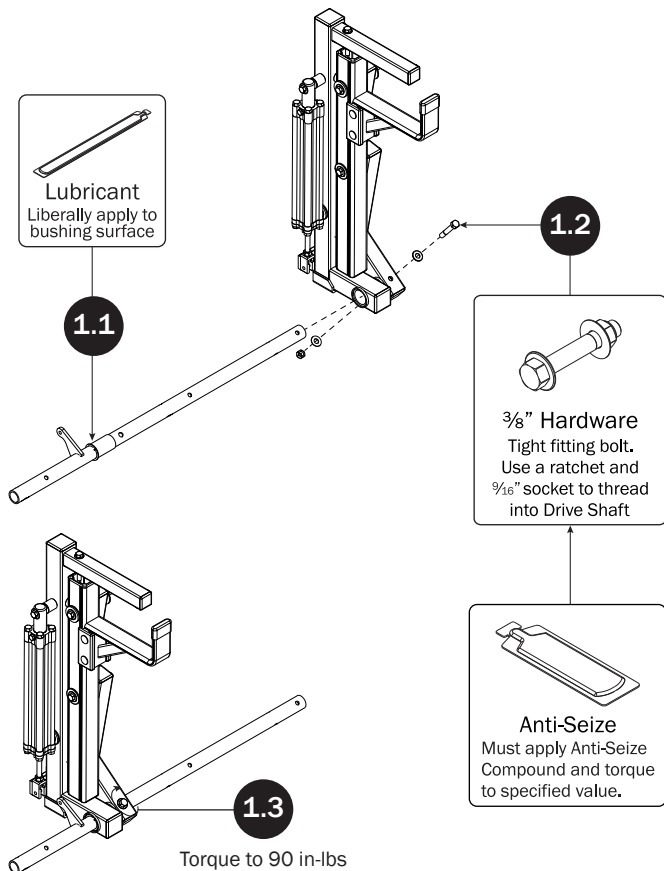
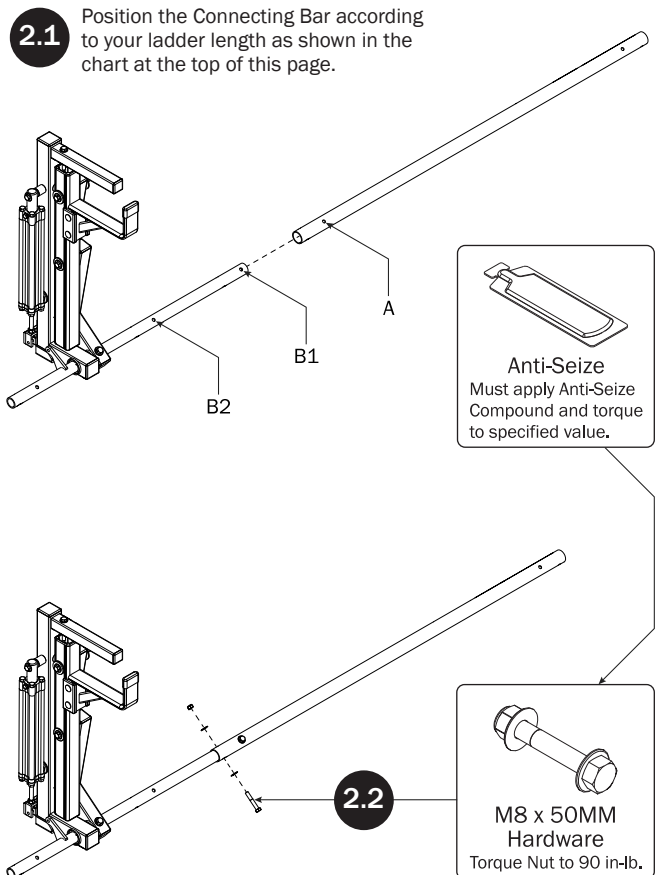
**REAR DRIVE SHAFT****CONNECTING BAR—48"**

FRONT DRIVE SHAFT

- 3.1** Position the Connecting Bar according to your ladder length as shown in the chart at the top of page 4.



3.2

3.3

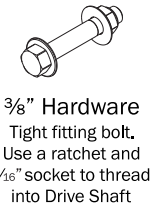

3.4

Torque to 90 in-lbs

CONNECTING BAR FASTENERS

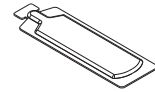

4



CONNECTING BAR-24"

5.1



5.2

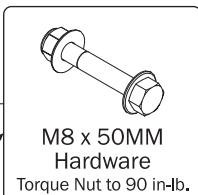

HEX DRIVE SHAFT REAR EXTENSION

6.1

Note: Position this lock lever downward and forward as shown.

6.2

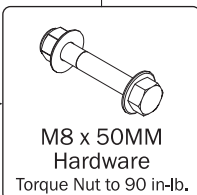

HEX DRIVE SHAFT REAR EXTENSION SUPPORT

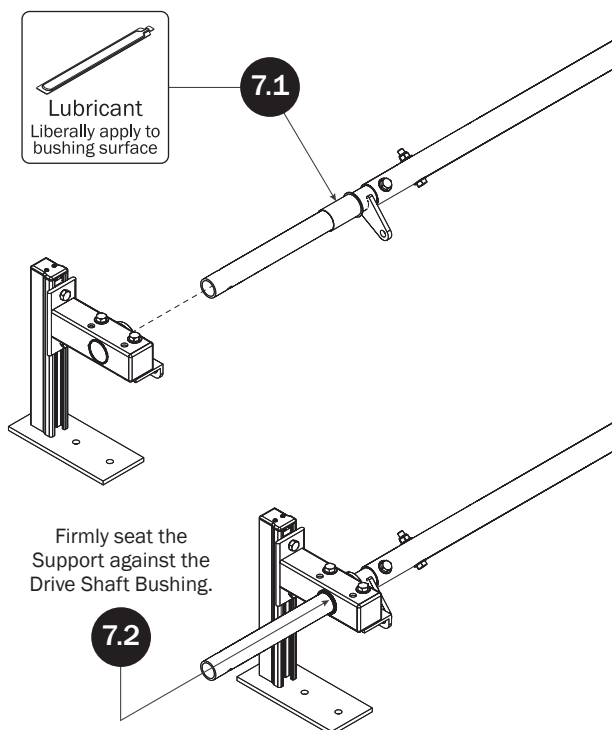

MOUNTING PREPARATION



The assembled rack is approximately 130" in length making it difficult to properly lift and place on the utility body. To prevent bodily injury and/or vehicle damage, it is recommended to use two people to safely lift and place the rack onto the vehicle.

- 9.1** Rotate the Hydraulic Cylinder upward to allow access to the mountings on the rear vertical Upright. Ensure the Hex Drive Shaft Extension Support is still firmly seated prior to marking its hole locations.

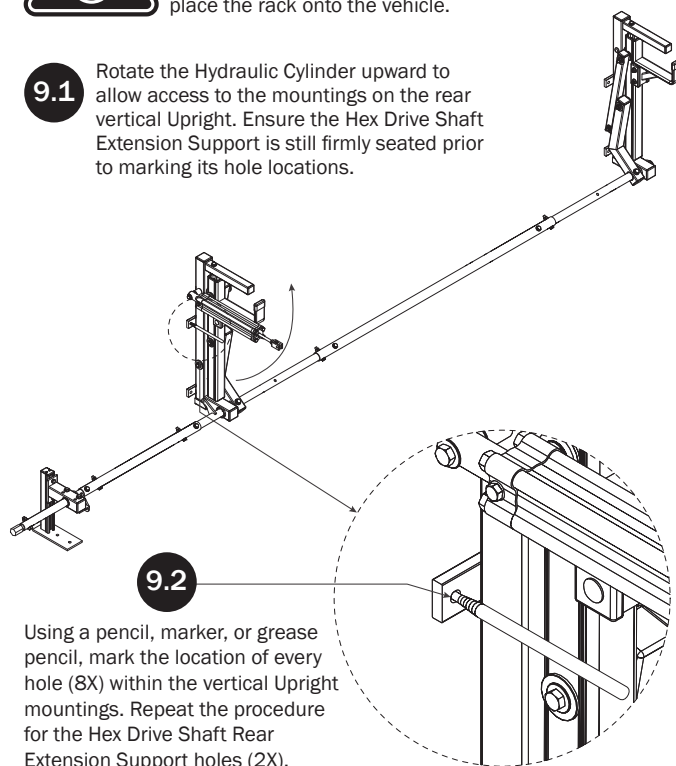

DRIVE SHAFT HEX STUD-1"

- 8.1** Insert the Drive Shaft Hex Stud into the open end of the Drive Shaft Extension. Align the bolt holes, then install the 3/8" x 1.75" Hex Stud Bolt (1X), 3/8" Washer (2X), and 3/8" Lock Nut (1X) in the order shown.

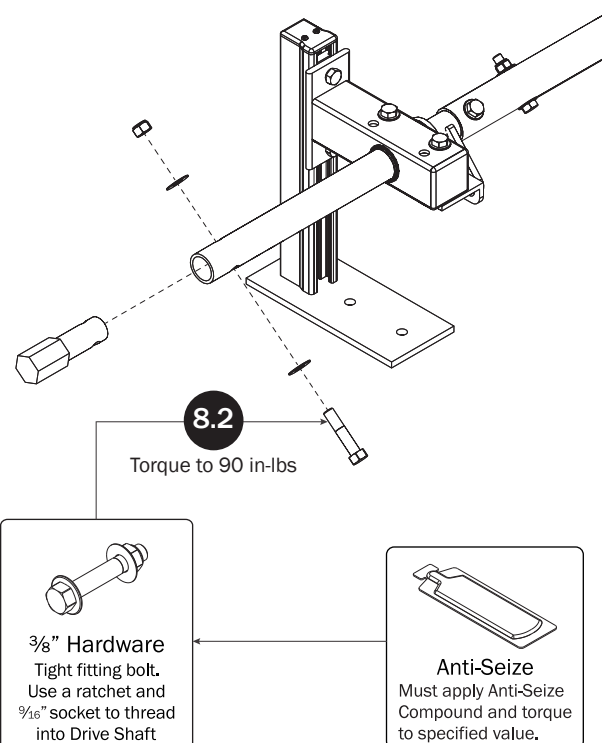

- 9.3** Remove the rack to expose the bolt hole markings. Using a 9MM, 23/64", or T size bit, drill holes into the Utility Body at the marked mounting bolt hole locations created during Step 9.2.

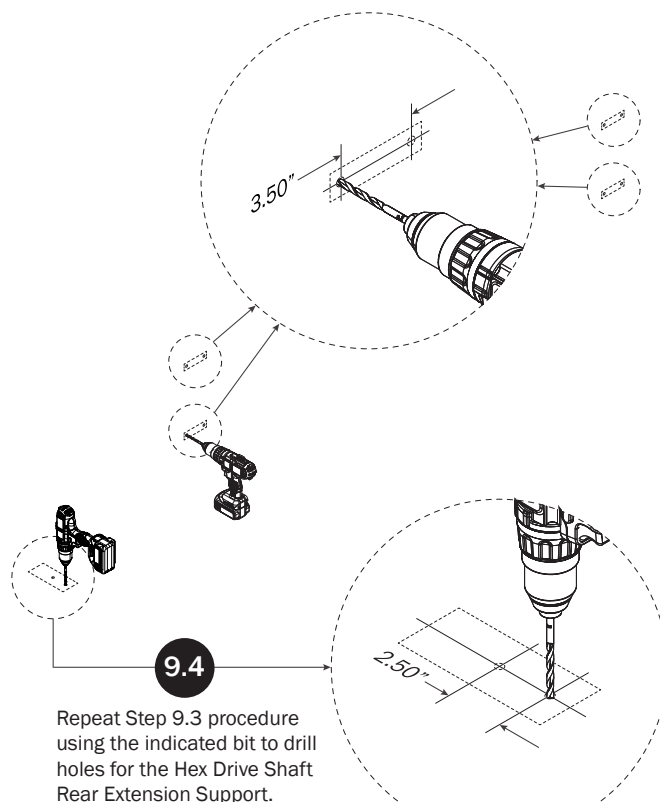

UTILITY BODY MOUNTING

9.5 Lift and position the rack back onto the Utility Body. Align the vertical Uprights until the mounting holes realign to the body holes drilled during Steps 9.3 and 9.4.

9.6 Using the fastening hardware shown below, attach the vertical Uprights to the Utility Body. The Neoprene Washer, Fender Washer, and Locknut install from the inside of the Utility Body in the order shown, while the Bolt and Seal Washer install from the outside. Do not tighten until Step 9.8

9.8 Torque to 90 in-lbs

Mounting Hardware (10X)

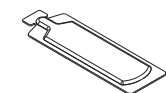

Anti-Seize
Must apply Anti-Seize Compound and torque to specified value.

9.7 Using the fastening hardware shown to the right, attach the Hex Drive Shaft Rear Extension to the Utility Body. The Neoprene Washer, Fender Washer, and Locknut install from the inside of the Utility Body in the order shown, while the Bolt and Seal Washer install from the outside. Proceed to Step 9.8

M8 x 30MM Bolt

Sealing Washer

Mounting

Utility Body

Neoprene Washer

Fender Washer

M8 Locknut

CYLINDER HARDWARE

Cotter Pin

10.2

Clevis Pin

10.1

CYLINDER ADJUSTMENT

11.1 To properly adjust the Hydraulic Cylinder for load descent speed, position the intended-use ladder onto the Vertical Z Post. Proceed to Step 11.2 and adjust accordingly.

Adjust the Cylinder Flow Control Screw to allow approximately 3 seconds time for the ladder to glide down when operating the loaded Ladder Rack.

11.2

DRIVE SHAFT SEALING

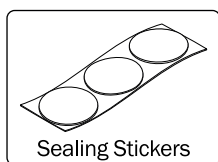

12.1

Cover all exposed
Drive Shaft holes

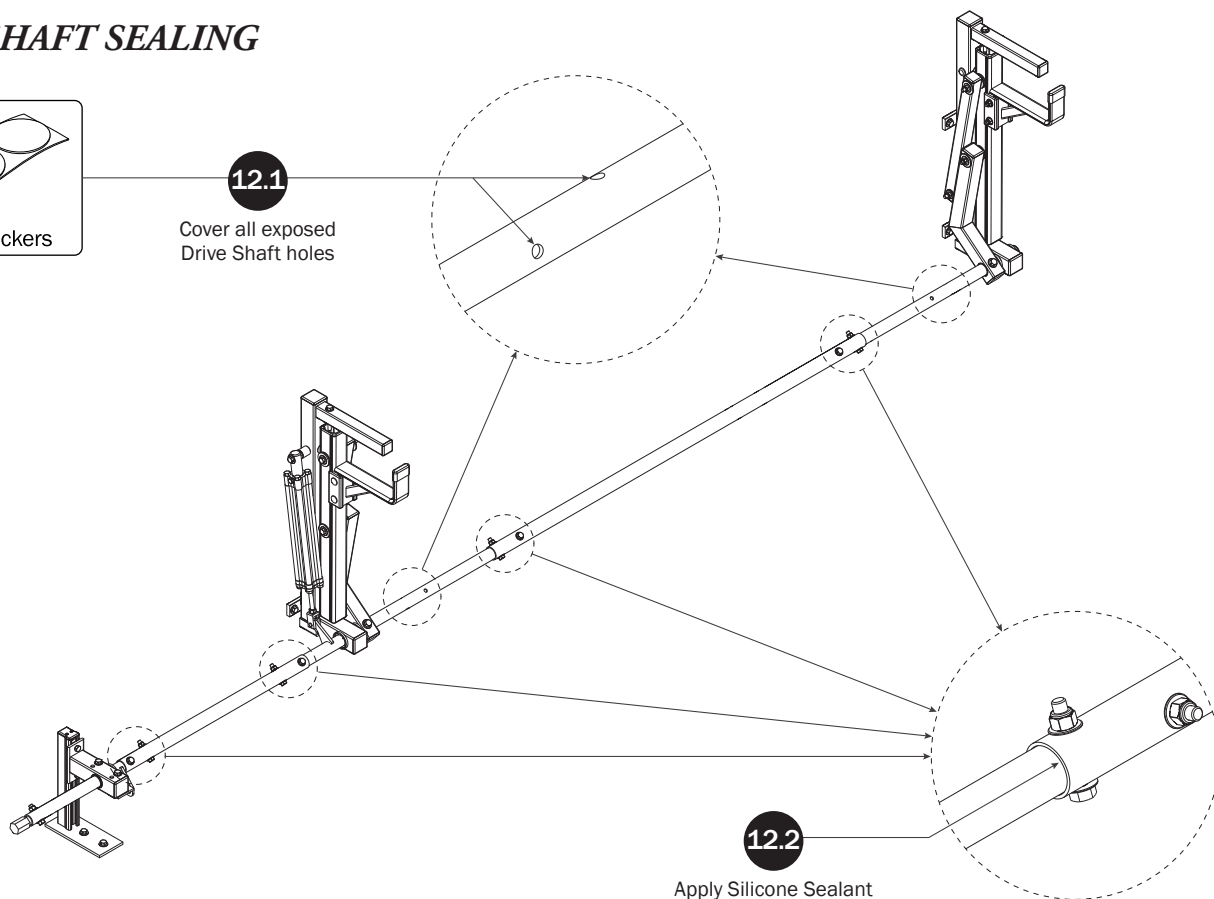

USAM-UXV212-US01 Rev-A 0618