

VRR3-FES-M

ErgoRack, Ford E-Series

Three Crossbars, Powder Coat Finish
Rack Weight (empty): 95 lbs

*Callouts in this Configuration Overview indicate full module assemblies only.

For details on individual parts, please refer to the linked Module Overviews below.

- A: [FEA-0016 Rotation Driveshaft Feature](#)
- B: [FBM-1067-BLK Mounting System](#)
- C: [FEA-0002 Rotation Assembly \(x2\)](#)
- D: [CBR-0003 Crossbar Assembly](#)
- E: [CBR-0004 Crossbar Assembly](#)
- F: [FEA-0015 Rotation Driveshaft Feature](#)
- G: [5' Connecting Bar](#)

[Modular Assembly Manuals](#)

ErgoRack Van—Load specifications:

Check vehicle manufacturer recommendations for roof capacity weight limits.

CROSSBAR SPACING	STEP LADDER	EXT. LADDER
4 ft Spacing	6 – 8 ft.	16 – 20 ft.
5 ft Spacing	8 – 10 ft.	16 – 24 ft.
6 ft Spacing	8 – 12 ft. [†]	16 – 28 ft.
7 ft Spacing	10 – 12 ft. [†]	20 – 32 ft.
8 ft Spacing	10 – 12 ft. [†]	20 – 36 ft.

[†]Rotation Configurations: 12 ft. step ladders require an extended upper add-on component.

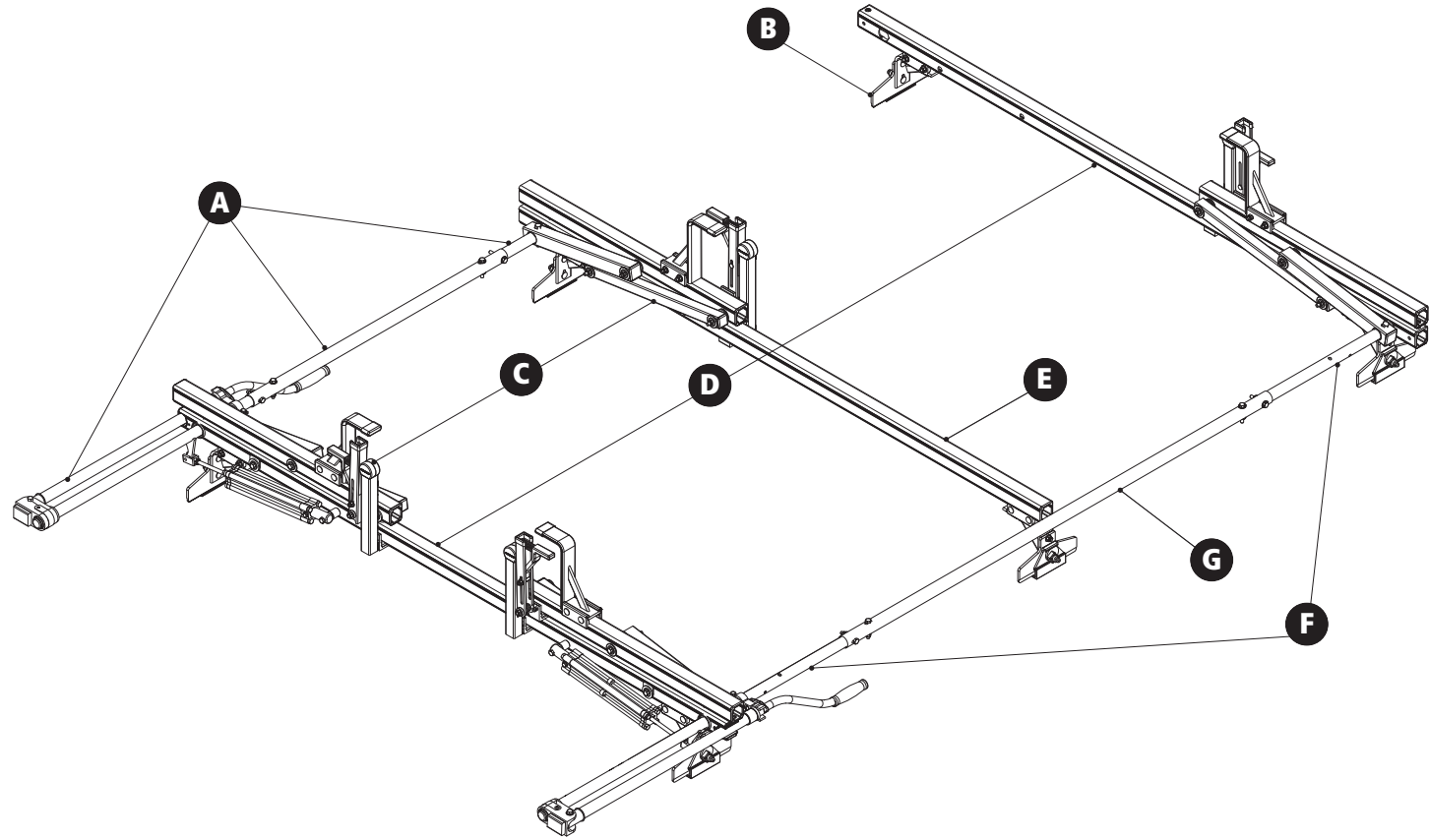

VRR3-FES-M

ErgoRack, Ford E-Series

Approximate dimensions as shown:

- A: Rack Width 68"
- B: Rack Height 18"
- C: Rear Crossbar Offset (Left)..... Even
- D: Mount Bolt Spacing L/R..... Variable
- E: Crossbar Spacing (rear to center) 4'
- F: Crossbar Spacing (center to front) 4'
- G: Total Crossbar Spacing 8'
- H: Rack Length 128"

*5' Connecting Bars (sold separately) are required for spacings that exceed 6'—contact Sales & Service.

- 3' Connecting Bar (Included in current configuration)
- 5' Connecting Bar (Sold separately)

Compatible Accessories Available (Sold Separately)

- 5' Rotation Connecting Bar [FEA-0022](#)
- 8'–12' Conduit Carriers [CON Series](#)
- WorkPro LED Lighting..... [LED Series](#)
- Systems and Safety Components [RVS Series](#)
- Safety monitoring [DS2 Series](#)

