

PRIME DESIGN™

A Safe Fleet Brand

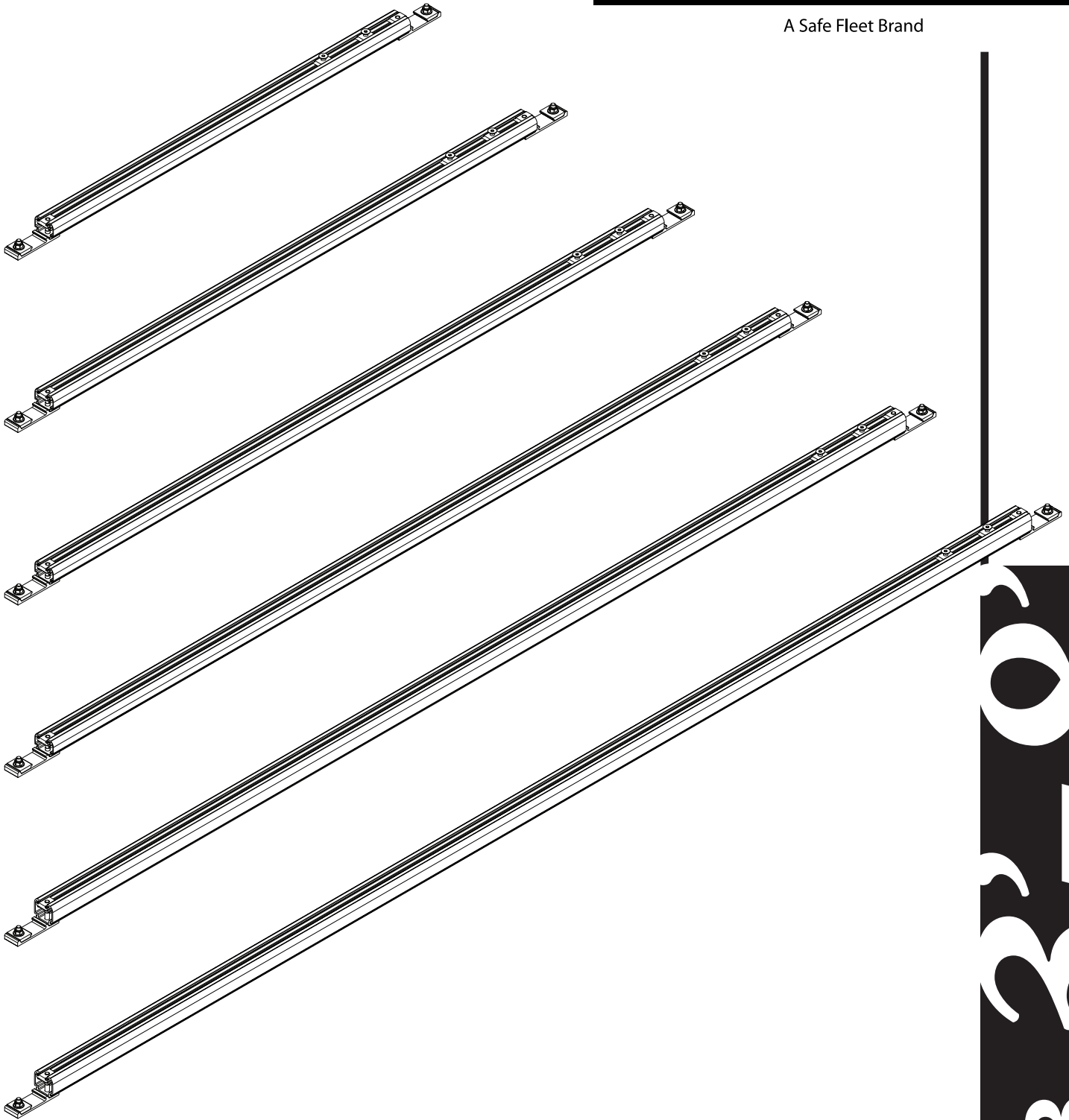

ALB 3'-8"

CONTENTS OVERVIEW

Gen 4 Ladder Rack shown for
illustrative purposes only.

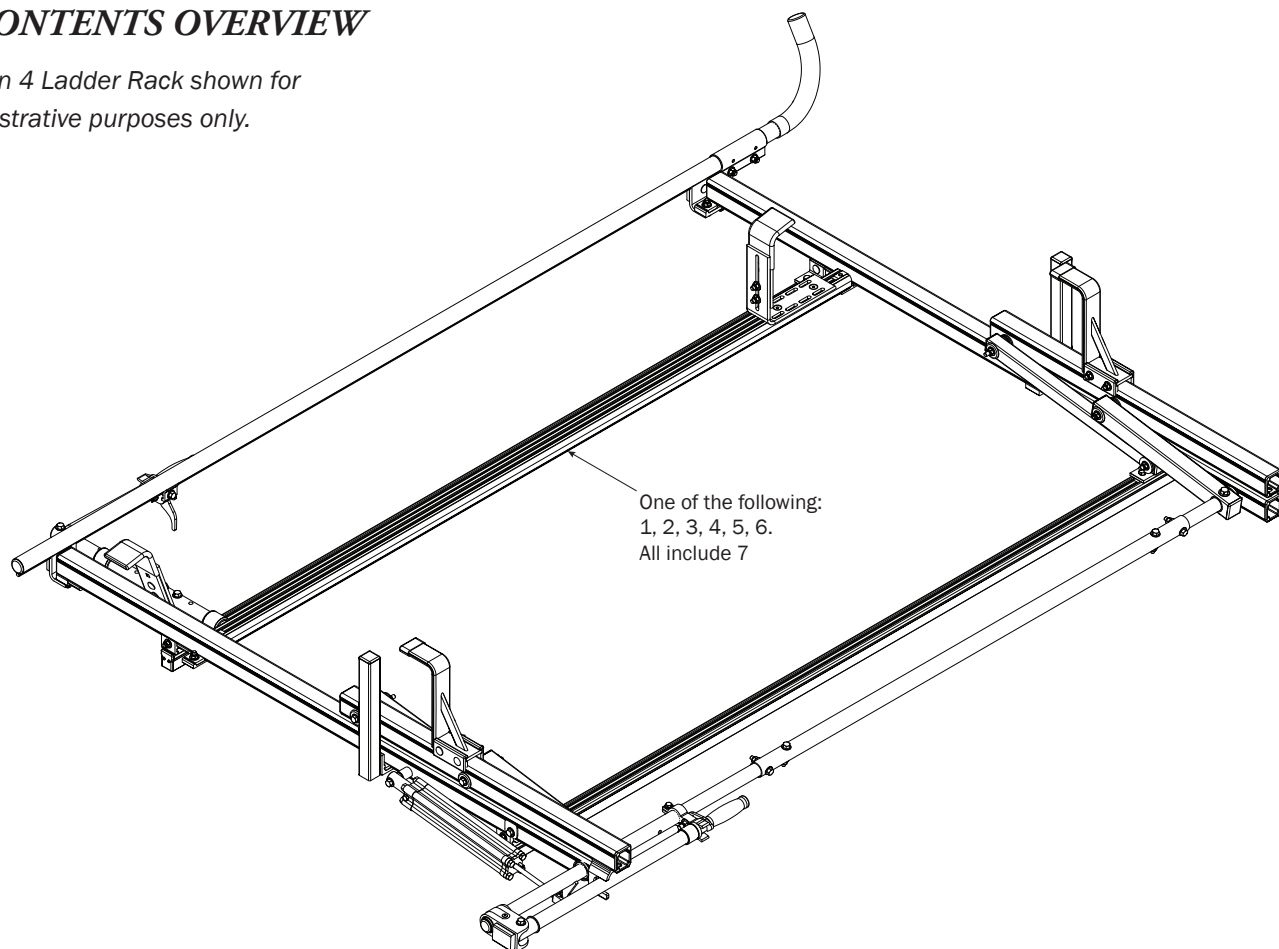

1—CDR-8148 (Qty 1)
Adjustable Ladder Bar Assembly, 96"



2—CDR-8147 (Qty 1)
Adjustable Ladder Bar Assembly, 84"



3—CDR-8146 (Qty 1)
Adjustable Ladder Bar Assembly, 72"



4—CDR-8145 (Qty 1)
Adjustable Ladder Bar Assembly, 60"



5—CDR-8144 (Qty 1)
Adjustable Ladder Bar Assembly, 48"



6—CDR-8143 (Qty 1)
Adjustable Ladder Bar Assembly, 36"



7—TLK-0005 (Qty 1)
Threadlocker Compound .5ML

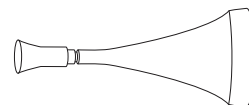

LADDER BAR PREPARATION

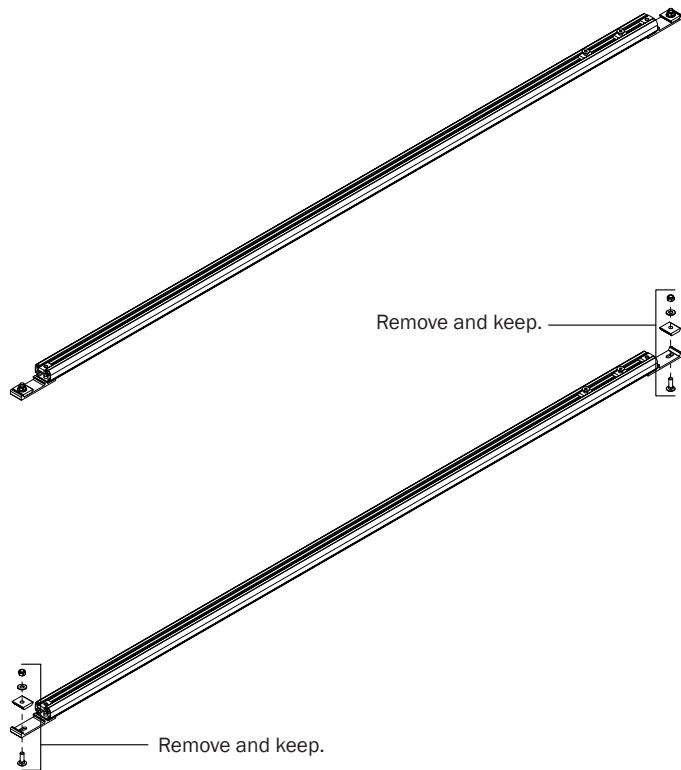

Remove and keep.

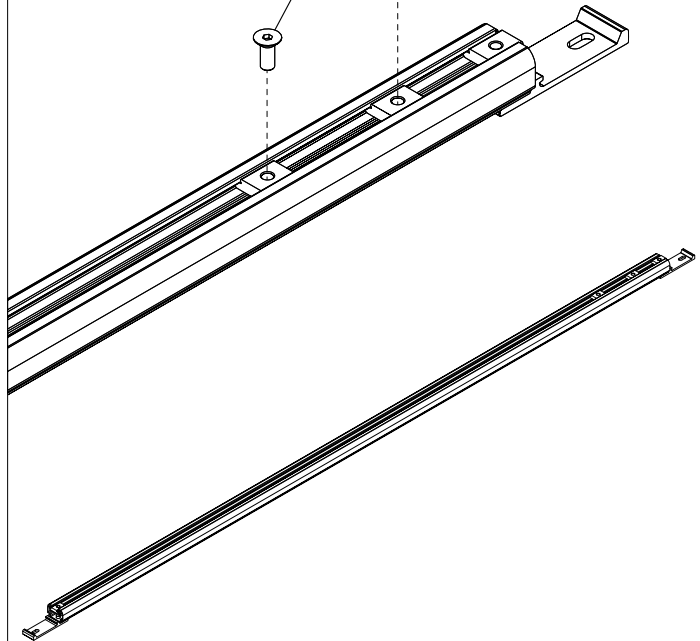

FRONT HOOK REMOVAL

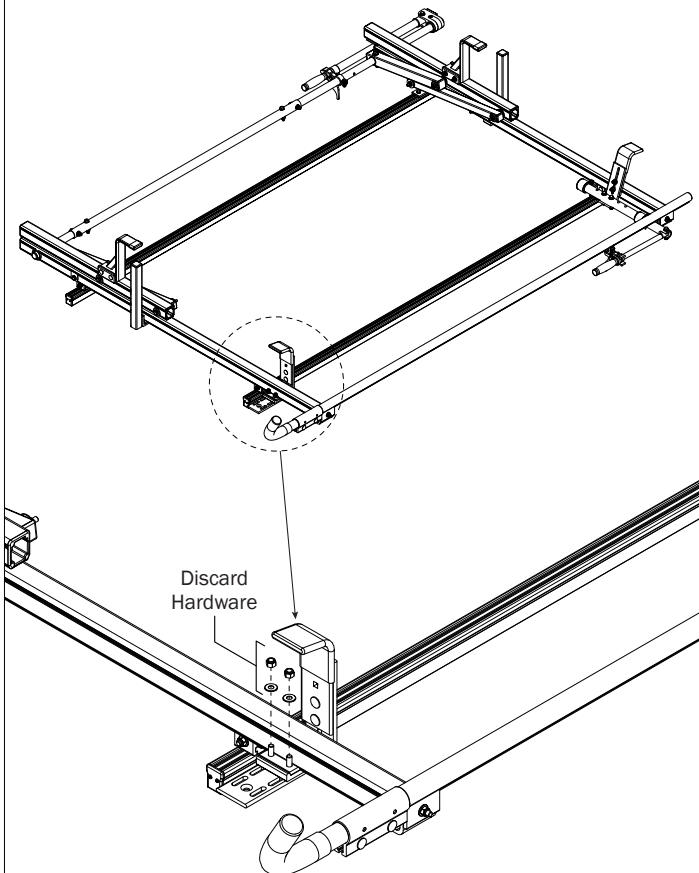

Discard Hardware

Discard Hardware

Keep This Assembly

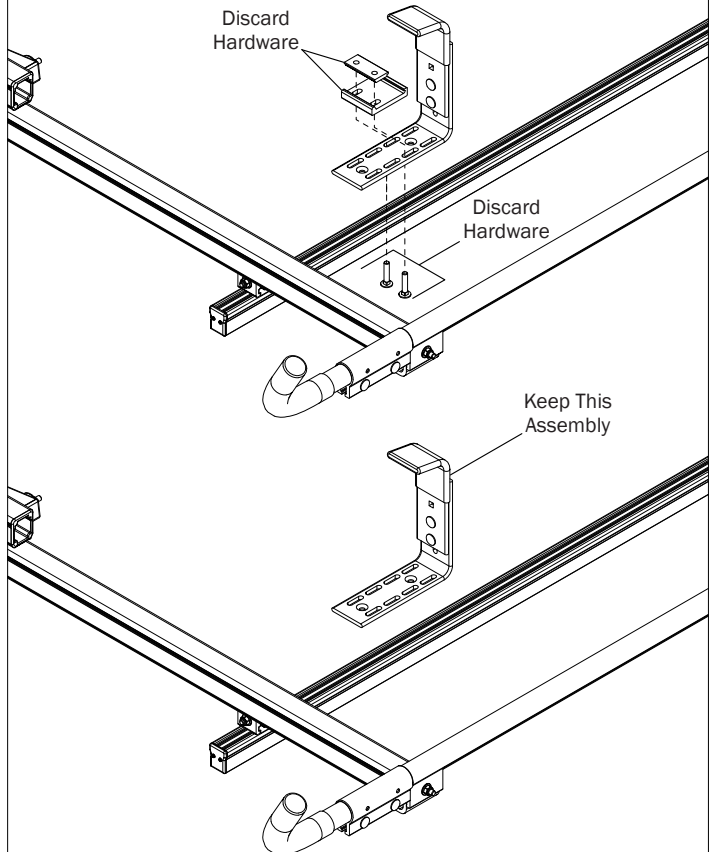

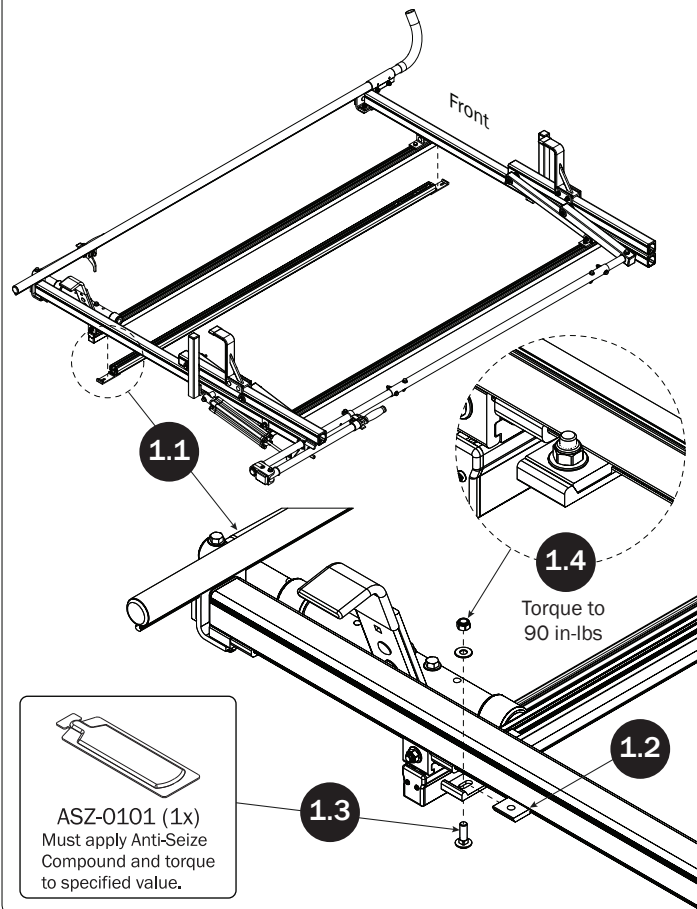
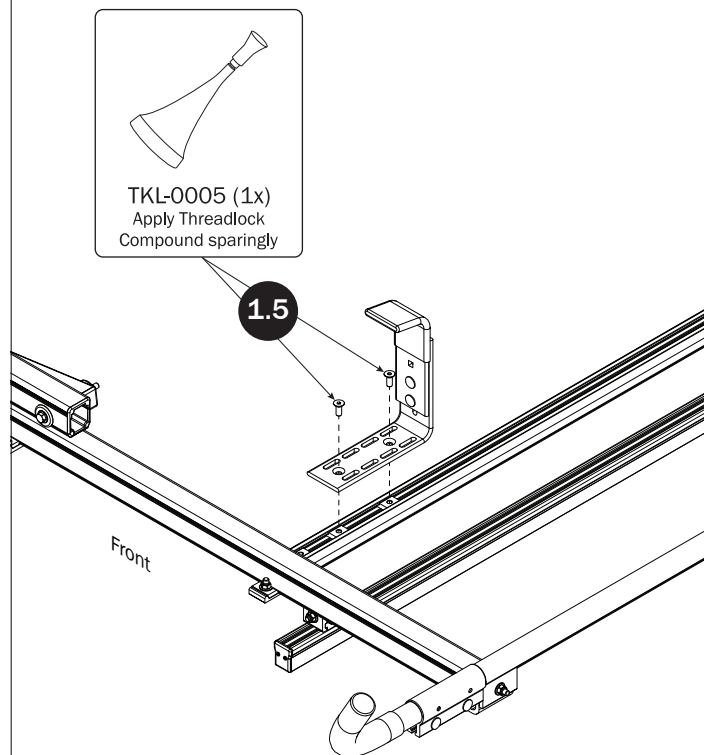
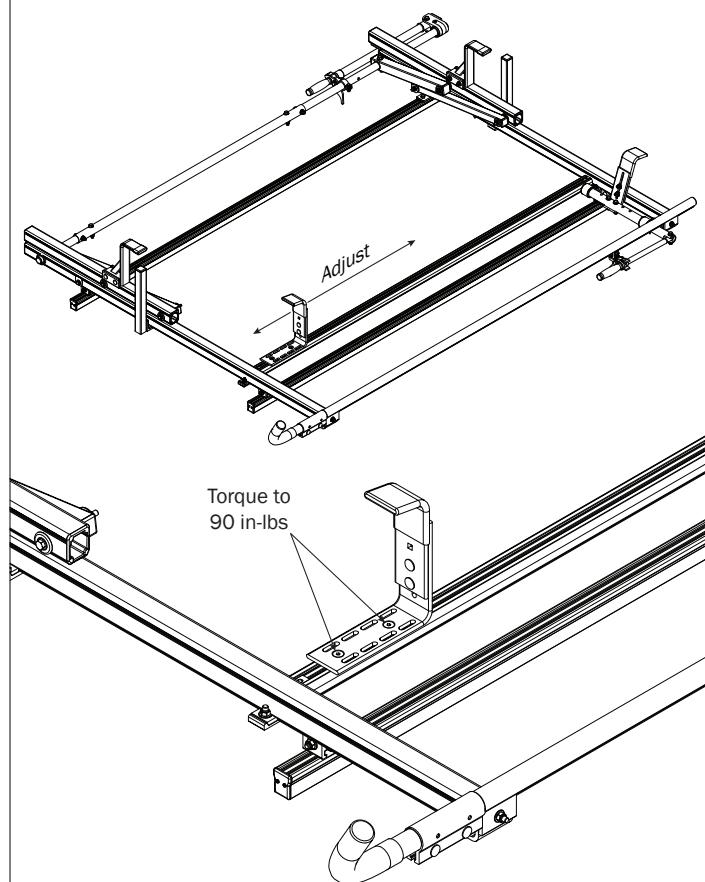
LADDER BAR INSTALLATION**FRONT HOOK INSTALLATION****FRONT HOOK ADJUSTMENT****ADDITIONAL INFORMATION**

For additional information regarding your ALB (Adjustable Ladder Bar), please visit the Prime Design Technical Communications website at: <http://pdtechcomm.com/us/>

From your computer, click on the "Products" tab on the toolbar, then find your rack model according to your vehicle manufacturer, vehicle model, then rack type.

Using a QR code reader in your smart phone or tablet, read the QR Code shown below and follow the same steps as you would from your laptop or computer.

If you're viewing this document as an interactive PDF, you may simply click on the QR Code below to access the Prime Design Technical Communications website.

