

PRIME DESIGN™

A Safe Fleet Brand

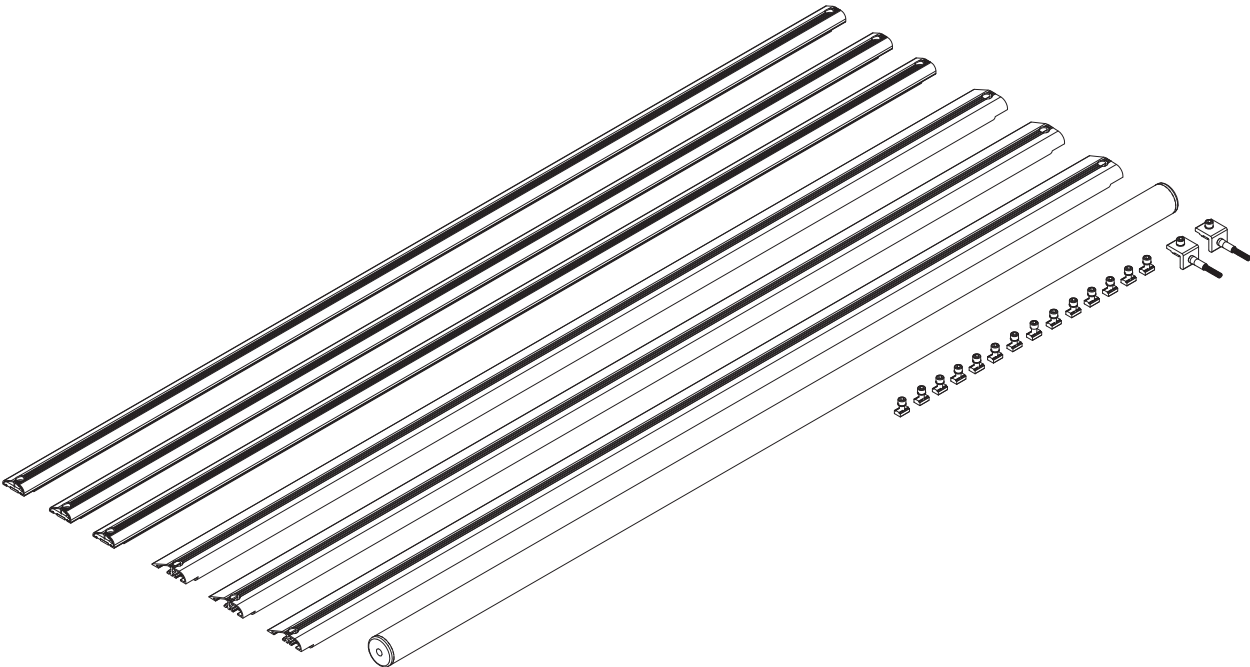

MODELS AVAILABLE:

- AR-2000 (CLEAR ANODIZED)
- AR-2000-BLK (BLACK ANODIZED)

AR-2000 AluRack Crossbar Module, 53" Kit	
Page 2	Packaging Contents
Page 3	Strip Nuts and Roller Bracket
Page 4-5	Crossbar Configurations
Page 5-6	Crossbar Installation
Page 6-7	Roller Installation
Page 7-8	Final Instructions

AR-2000

CONTENTS OVERVIEW

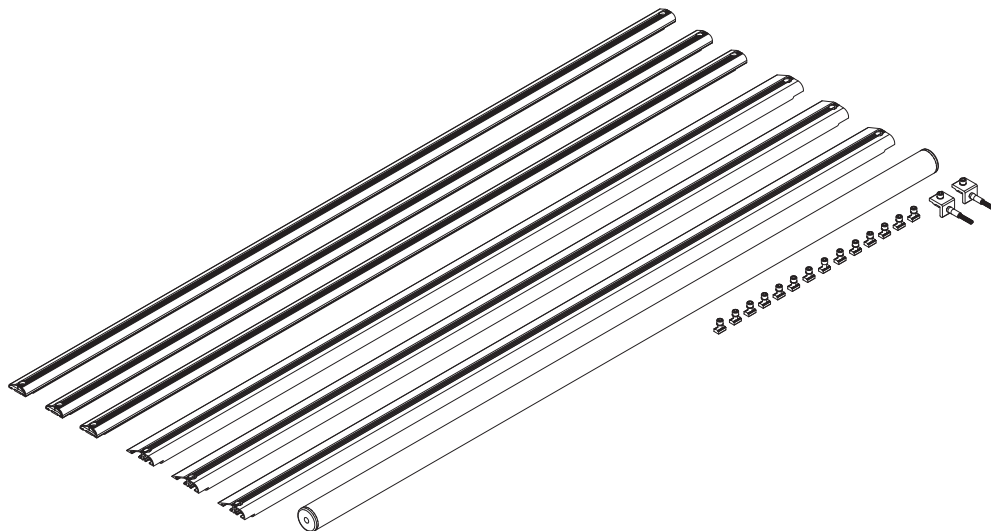

AluRack Heavy Duty Crossbar (Qty 3)
 With hardware, 53.00"
 Clear or Black (BLK), Anodized



AluRack Standard Crossbar (Qty 3)
 With hardware, 53.00"
 Clear or Black (BLK), Anodized



AluRack Roller Assembly (Qty 1)
 49.75", with Caps
 Clear or Black (BLK), Anodized



Crossbar and Roller Hardware (Qty 1)

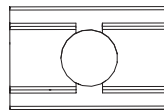

M8 Strip Nut (14X)

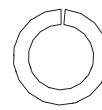

M8 Lock Washer (14X)

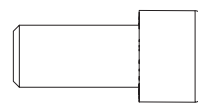

M8 Cap Head Bolt (14X)



Roller Bracket (2X)



Roller Tube Pin (2X)

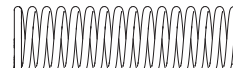

Roller Spring (2X)



Anti-Seize (1X)

STRIP NUT INSTALLATION

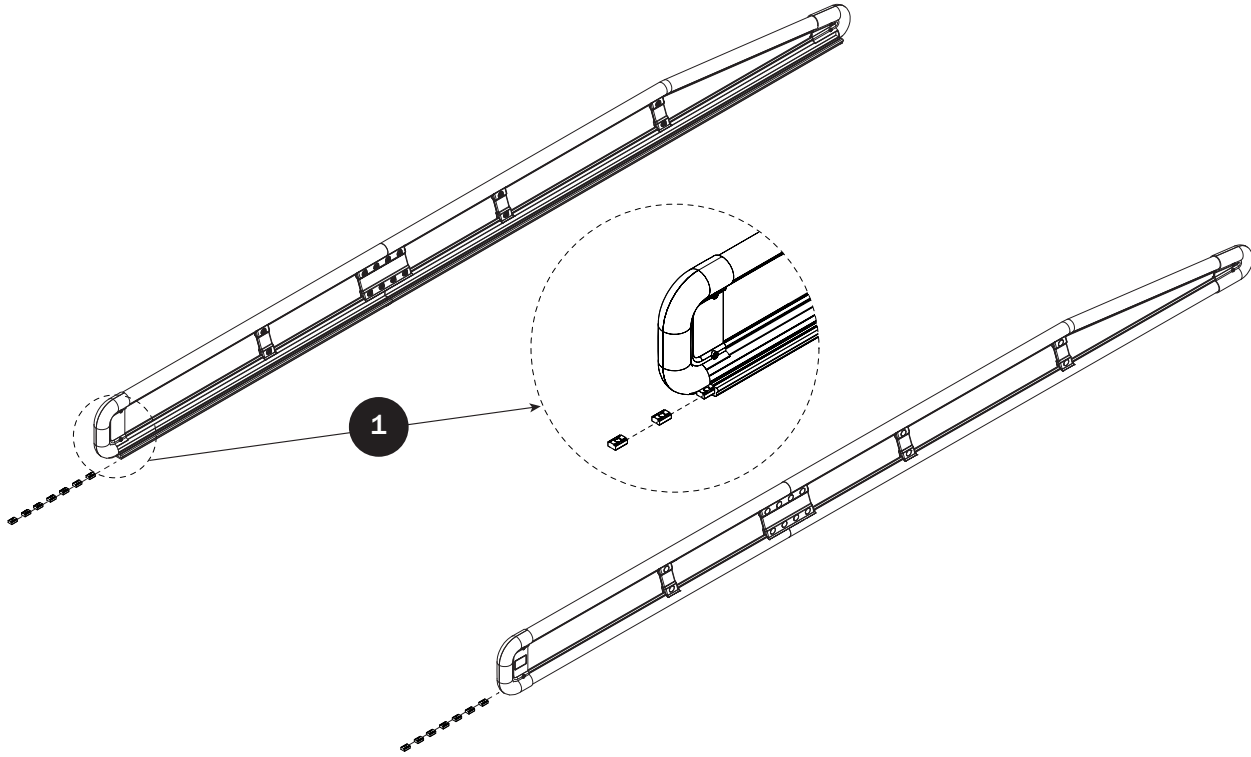

ROLLER BRACKETS

- 2** Install Roller Brackets into the rear most Strip Nuts, and align flush against the rear end of the Side Rail as shown. Torque Roller Bracket Bolts to 90 in-lbs.

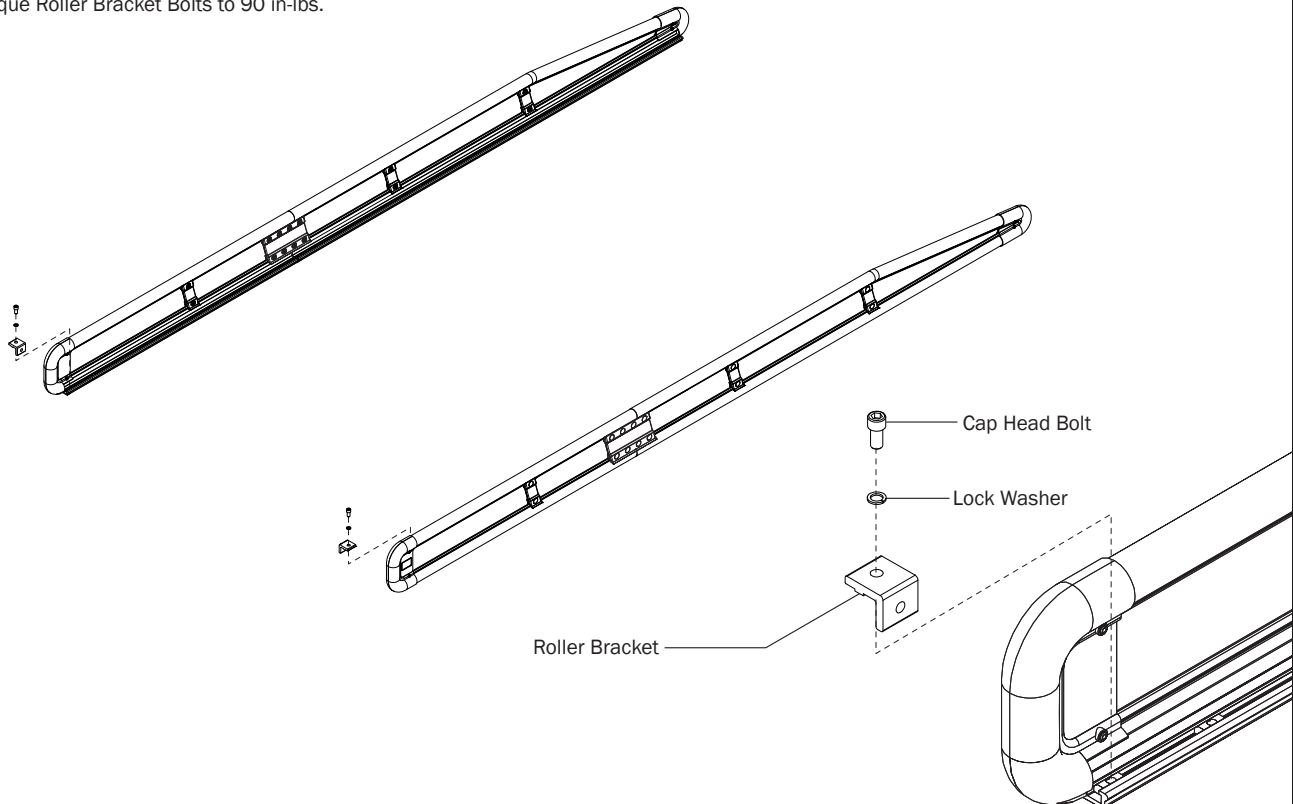

CROSSBAR CONFIGURATIONS

3

Measurements are specified according to distances from the Side Rail rear ends. It is recommended to determine your Crossbar pattern before installing them into your Strip Nuts to ensure proper order of use.

*The AluRack shown in Fig.1 is for Illustrative Purposes only, and your Configuration will vary. Refer to the table in Fig. 2-3 for your product-specific Configuration.

Fig. 1

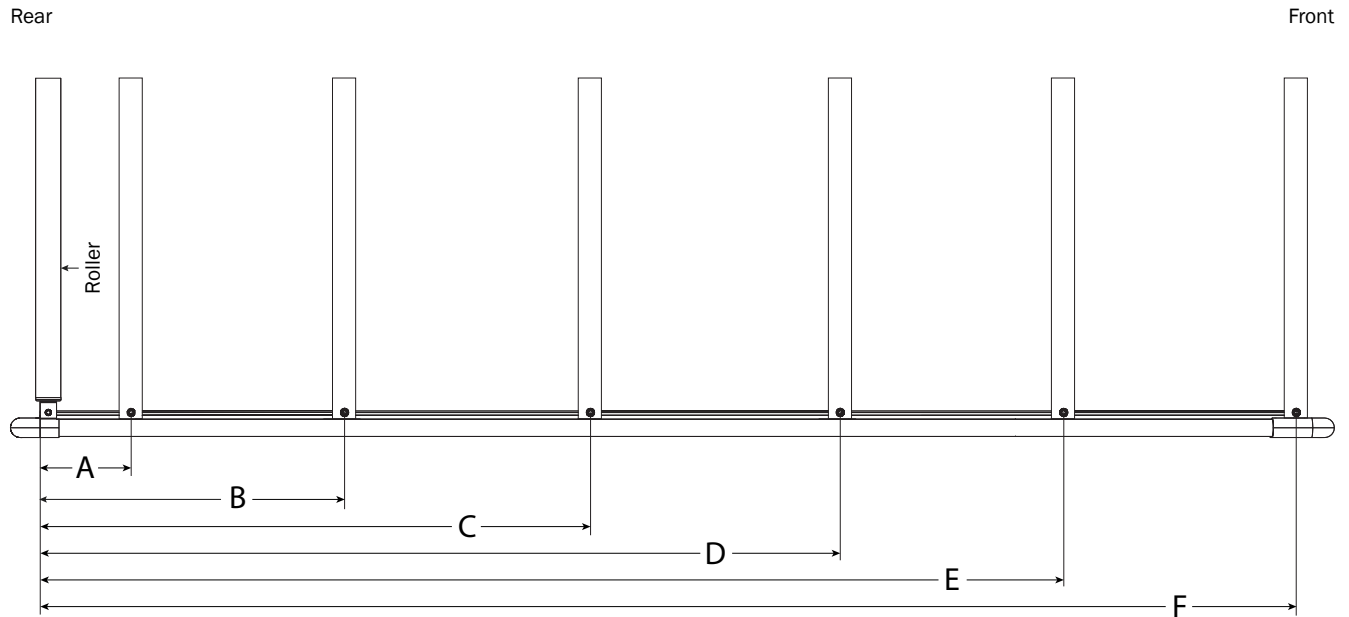

Fig. 2—VAN RACKS | STD=STANDARD CROSSBAR | HD=HEAVY DUTY CROSSBAR

VAN PRODUCT	Crossbar A	Crossbar B	Crossbar C	Crossbar D	Crossbar E	Crossbar F	FRONT SIDERAIL END
AR1221: NV200/CITY EXPRESS 115" Wheelbase, 74" Roof Height	5.50" STD	21.625" HD	40.25" STD	59.125" HD	76.00" STD	Flush to Front Side Rail End	*96.00"
AR1903: TRANSIT CONNECT (L1H1) 105" Wheelbase, 75" Roof Height	4.25" STD	17.875" HD	36.50" STD	55.375" HD	72.50" STD	Flush to Front Side Rail End	*84.00"
AR12904: TRANSIT CONNECT (L2H1) 121" Wheelbase, 73" Roof Height	4.25" STD	17.875" HD	36.50" STD	55.25" HD	72.25" STD	Flush to Front Side Rail End	*96.00"
AR1927: PROMASTER CITY 15 122" Wheelbase, 74" Roof Height	3.50" STD	19.25" HD	37.25" STD	55.25" HD	73.25" STD	Flush to Front Side Rail End	*96.00"

* Side Rail Sizes vary according to customer sizing needs - See respective AR Side Rail Kit Manual to build your Side Rails.

** When mounting your AluRack, mounts must attach to the Heavy Duty Crossbars. Customer may adjust distances as needed.

*** Custom Rack Layouts: Maximum Bolt Spacing on Crossbars and Roller is 24.00". Extra Heavy Duty Crossbars and Hardware are available as needed-contact Sales and Service.

CROSSBAR CONFIGURATIONS

Fig. 3-PICKUP RACKS | STD=STANDARD CROSSBAR | HD=HEAVY DUTY CROSSBAR

PICKUP TRUCK PRODUCT	Crossbar A	Crossbar B	Crossbar C	Crossbar D	Crossbar E	Crossbar F	FRONT SIDERAIL END
AR1211 & AR1212 5'-6' Cap (suggested)	3.50" (min.) HD	Crossbars spaced evenly				Flush to Front Side Rail End	*84.00
AR1205-S & AR1213 6.5' Cap (suggested)	3.50" (min.) HD	Crossbars spaced evenly				Flush to Front Side Rail End	*96.00
AR1208 & AR1214 8' Cap (suggested)	3.50" (min.) HD	Crossbars spaced evenly				Flush to Front Side Rail End	*112.00

* Side Rail Sizes vary according to customer sizing needs - See respective AR Side Rail Kit Manual to build your Side Rails.

** When mounting your AluRack, mounts must attach to the Heavy Duty Crossbars. Customer may adjust distances as needed.

*** Custom Rack Layouts: Maximum Bolt Spacing on Crossbars and Roller is 24.00". Extra Heavy Duty Crossbars and Hardware are available as needed-contact Sales and Service.

PICKUP TRUCK ADJUSTMENT



ADJUSTMENT FOR ALURACK
PICKUP TRUCK CAP REAR DOOR:

The rear of your AluRack must be set at a minimum of 2.00" from your rear door when it is in the open position (standard cap door).

Mounts and crossbars may need to be adjusted according to customer needs.

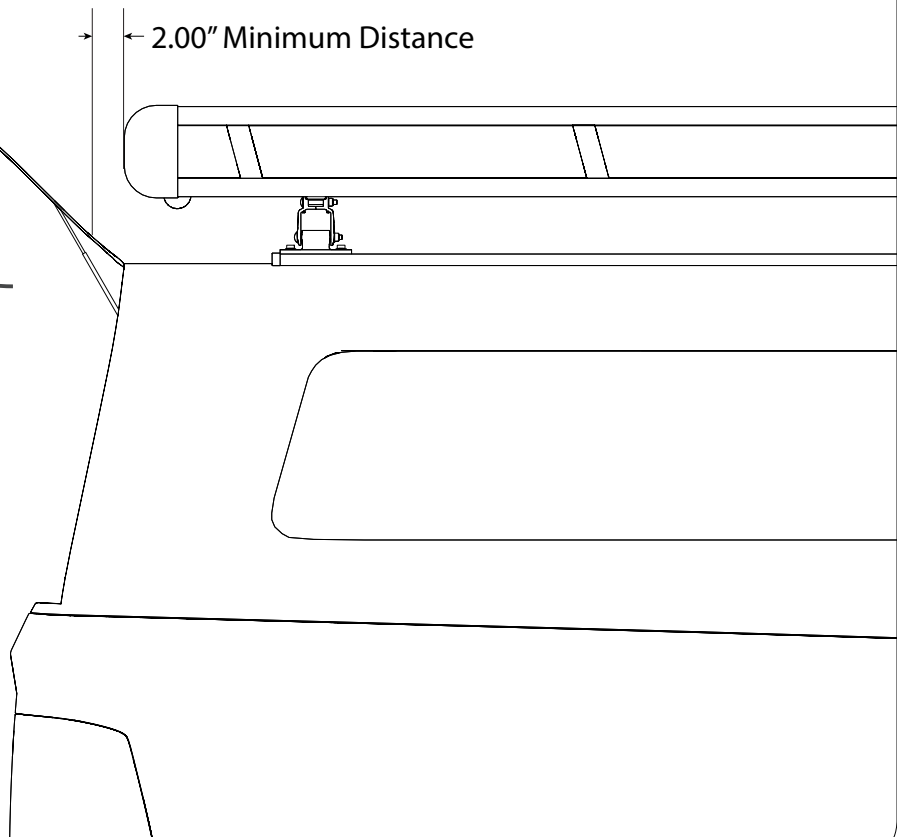

LEFT SIDE RAILS AND CROSSBARS

4

Install the Crossbars according to your configuration in the Strip Nuts as shown and torque to 90 in-lbs.

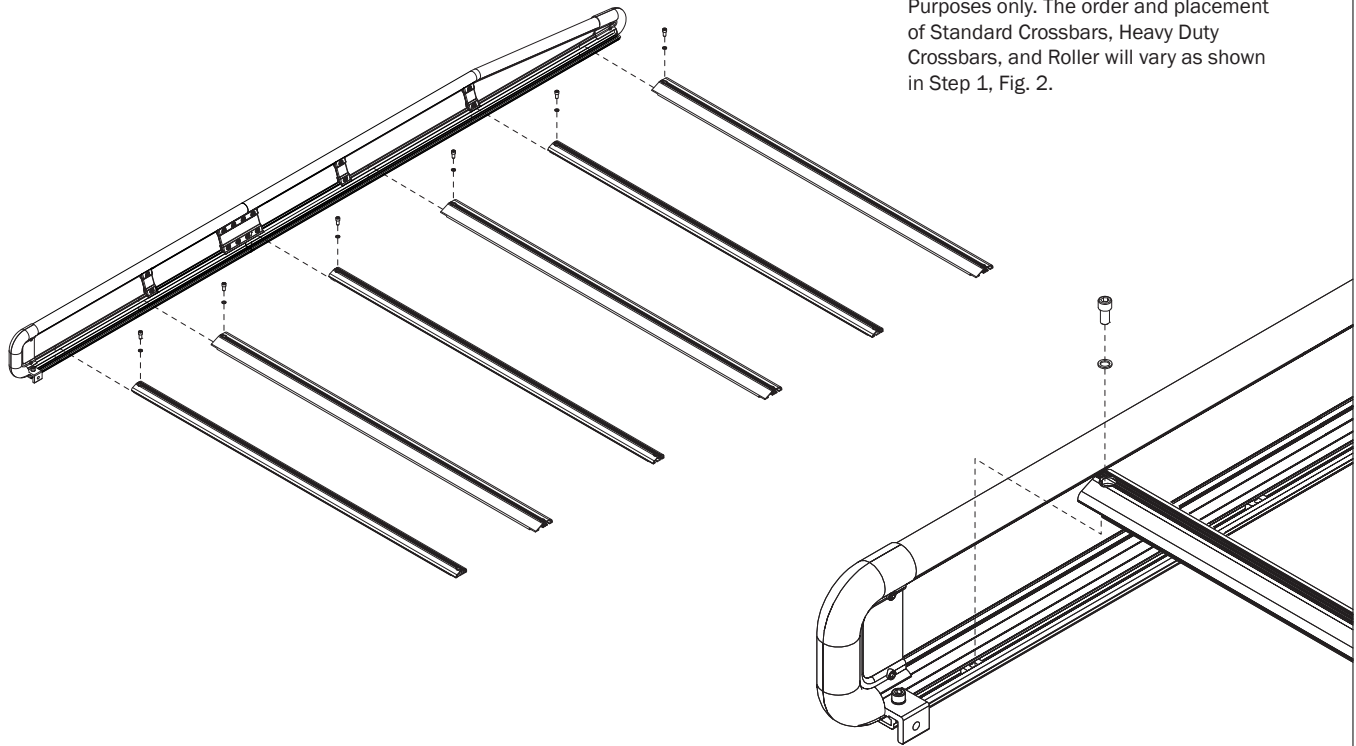

NOTE: Rack shown is for Illustrative Purposes only. The order and placement of Standard Crossbars, Heavy Duty Crossbars, and Roller will vary as shown in Step 1, Fig. 2.

**RIGHT SIDE RAILS AND CROSSBARS**

5

Install the Crossbars according to your configuration in the Strip Nuts as shown and torque to 90 in-lbs.

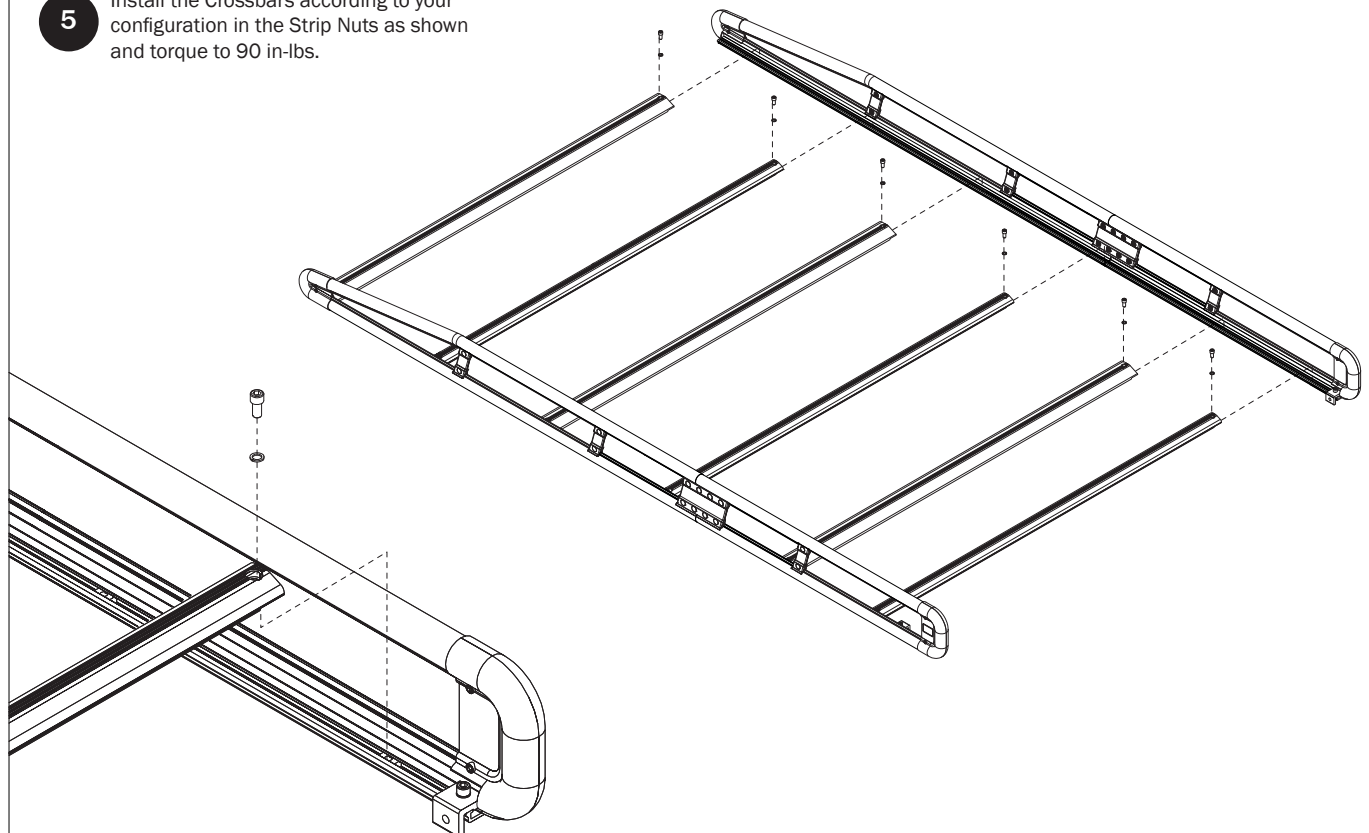

ROLLER INSTALLATION

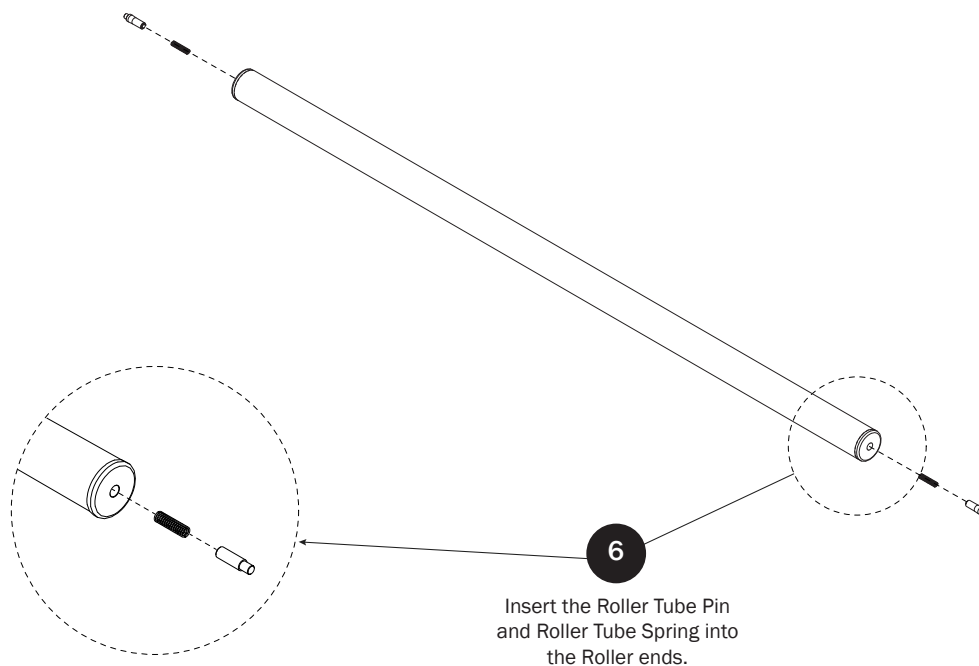

ROLLER ASSEMBLY

- 7 Insert the Roller Tube Pin on each side of the Roller Tube into the Brackets as shown.

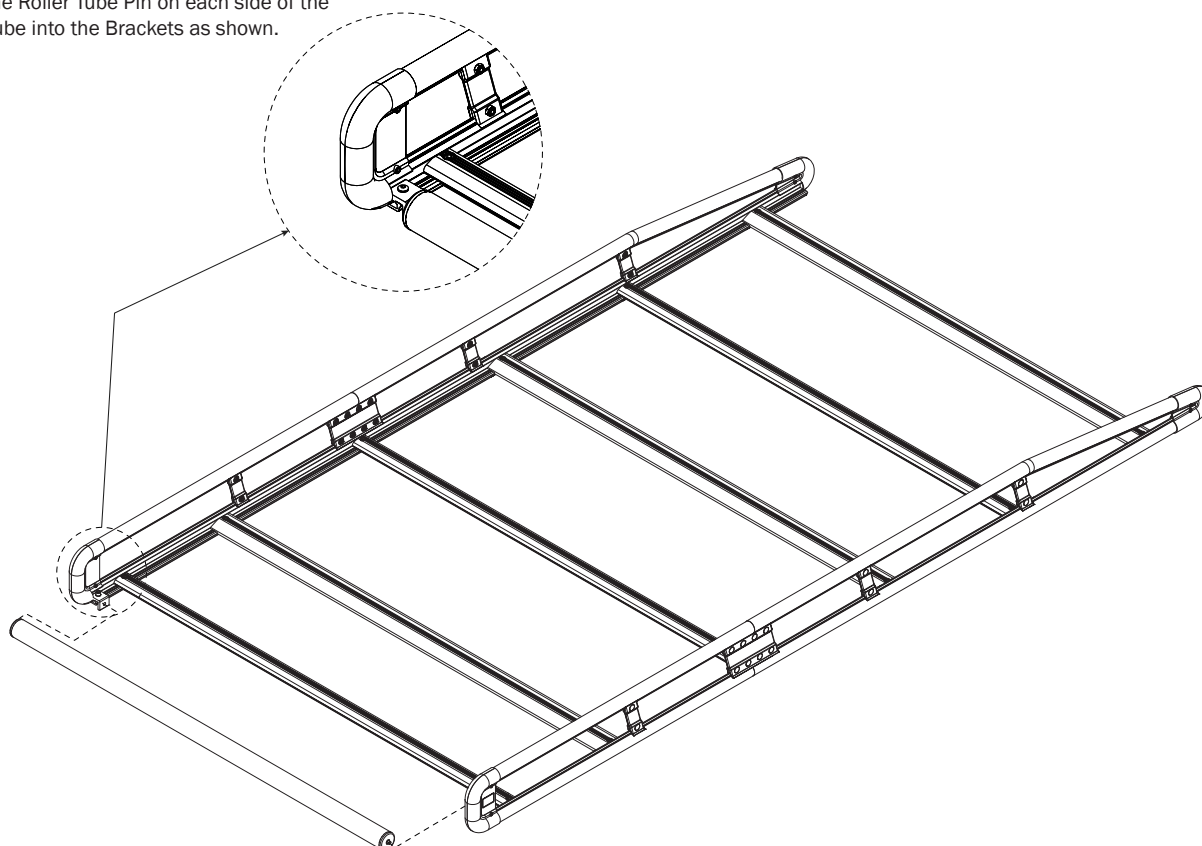

FINAL INSTRUCTIONS FOR WORK VANS**Do not mount the AluRack to an FBM system at this time.**

Refer to the respective FBM Assembly Manual(s) included with your chosen rack configuration features.

WARNING: Failure to position the AluRack as shown in your FBM Assembly Manual may result in damage to the ladder rack.

INSTALLER NOTE: To purchase applicable features and accessories, please contact your authorized distributor, or a Prime Design Sales & Service Representative.

USAM-AR2000-US01 Rev-A 0619